



41P11SE0088 W9780.00573 FAWCETT

010

**FORT KNOX GOLD RESOURCES INCORPORATED**  
**(LITTLE NICKEL PROPERTY)**  
**FAWCETT TOWNSHIP, DISTRICT OF SUDBURY**  
**REPORT OF DIAMOND DRILLING ACTIVITIES**  
**(October 1994 - February 1995)**

**A.D. Hunter, M.Sc., F.G.A.C.**

**APRIL 1995**

**FORT KNOX GOLD RESOURCES INC.**

Hole#SG-1-94

Property: Little Nickel Tshp/County: Fawcett**Acid Tests**Claim: 1180182Coord.: South GridAzimuth: 227Started: Oct. 16/94

200' - 63deg

1200' - 48deg

400' - 59deg

1400' - 45deg

Range: \_\_\_\_\_

: 3+50S,3+25EDip: -65Completed: Oct. 29/94

800' - 53deg

1700' - 41deg

1000' - 50deg

1866' - 38deg

Core Size: BQ

Elevation: \_\_\_\_\_

Length: 1900'(579.3m)Logged By: A.D.H.

Sheet No.: 1

Logged by: Douglas Hunter, Doug Art Date logged: October 30, 1994

The borehole collar is located 100 m N and 80 m W of the #2 post.

This hole tested a large magnetic anomaly corresponding to the strike extent of the host rocks which contain the Cu - Ni deposit 250m to the northwest. Very local weak copper enrichment in gabbro without coincident anomalous nickel.

# FORT KNOX GOLD RESOURCES INC.

DRILL LOG Drill Program

Hole# SG-1-94 p.2

DEPTH	ROCK TYPE	GRAIN SIZE COLOUR	TEXTURE AND STRUCTURE	ALTERATION	MINERALIZATION	COMMENTS/ SAMPLE NO.
0-82'	Casing					Sand with the last few feet in boulders.
82-110.5	Felsic dike	Pale pink to salmon coloured.	Feldspar-phyric; 5-10% 1mm grains set in v.fn.gr. to aphanitic groundmass. Well foliated to banded at 20-25 degrees c.a. Tiny quartz lenses and 1cm veinlets parallel to banding. The structure resembles flow-banding seen in dikes of similar composition on surface.	Pink hematitic.		Very hard.
110.5-111.3	Calcite vein	Pale grey	Dark mafic volcanic fragments parallel to contacts at 20 degrees c.a.			
111.3-128.2	Mafic volcanic or possible dike.	Dark green, very fine grain.	Generally massive, fine grained, local foliation at 20-25 degrees c.a.			Tiny veinlets of felsic material resembling dike from 82-110.5
128.2-131.5	Tuff	Dark green	Distinctly bedded/laminated at 30-35 degrees c.a.			Some grey siliceous intervals.
131.5-142.4	Mafic, volcanic; possible dike.		As from 111.3-128.2 above.			Pink, feldspar-phyric dike 134.8-135.8 contacts at 20-30 degrees c.a.
142.4-163.4	Felsic dike		As described from 82-110.5 feet. Foliated/banded 25-35 degrees c.a.			Mafic volcanic inclusion or screen at 147.5-147.9. Contacts 20-30 degrees c.a.

**FORT KNOX GOLD RESOURCES INC.**

DRILL LOG -- Drill Program

Hole# SG-1-94 p.3

DEPTH	ROCK TYPE	GRAIN SIZE COLOUR	TEXTURE AND STRUCTURE	ALTERATION	MINERALIZATION	COMMENTS/ SAMPLE NO.
163.4-181.3	Mafic volcanic	Fine grained dark green.	Massive and foliated sections (30degrees c.a.). Possible indistinct bedding 175-176. 176-177.6-Grey laminated felsic dike. 177.6-177.7-Fine grained feldspar-phyric dike.		Trace amounts of disseminated pyrite with chalcopyrite noted.	Sample 177.7-181.2
181.3-206.5	Feldspar porphyry.	Medium grey.	Porphyritic with 15-20% 0.5-3.0mm equant feldspar grains. Massive aspect, very distinct from pink felsic dikes in this respect.			
206.5-219.5	Felsic dike	Pink and grey.	As described from 82-110.5 and 142.4-163.4. Large scale colour banding marked by varying degree of hematization, foliation/banded at 25 degrees c.a.			
219.5-226.0	Intrusive breccia		30-40% mafic fragments in feldspar porphyry which in sections resembles closely the porphyry dike at 181.3-206.5. Fragments are dark green, v.fn.gr. and fn.gr. diabasic textured. Some fragments are pale green-bleached with conspicuous epidote and pale garnet. Generally very angular and aligned at 30 degrees c.a. Bottom contact banded and foliated at 20-30 degrees c.a.	Late epidote.	Trace pyrite.	219.7-224.7-Literally mixed in with the porphyry is pink, coarse grained and quartz rich material. Breccias of this type are closely spatially related the main Cu-Ni zone 250m to the northwest.
226.0-242.5	Felsic dike		As described above 206.5-219.5 feet.			

**FORT KNOX GOLD RESOURCES INC.**

DRILL LOG Drill Program

Hole# SG-1-94 p.4

DEPTH	ROCK TYPE	GRAIN SIZE COLOUR	TEXTURE AND STRUCTURE	ALTERATION	MINERALIZATION	COMMENTS/ SAMPLE NO.
242.5-247.3	Feldspar porphyry	Dark grey	Fine to medium grained with chalky white feldspar up to 5mm, really a subporphyritic texture. Also conspicuous are dark blocky relict pyroxene phenocrysts in the 1-3mm size range. A few fragments of fn. gr. diabasic textured gabbro noted, e.g. 242.9feet. Foliated 20 degrees c.a.			Gabbroic composition.
247.3-257.5	Felsic porphyry					
249.3-257.5	Mafic volcanic	Dark green fine grained.	Laminated at 5-10 degrees c.a. 255.7-257.5 bedding.		Traces of pyrite and chalcopyrite in fractures at 252.8 feet.	
257.5-276.8	Felsic porphyry	Light to medium grey-green.	Well foliated at 25 degrees c.a. throughout lower contact at 55 degree c.a.			
276.8-289.5	Mafic dike or volcanic.	Fine grained dark green.	Diabasic texture to 289.5 composite dike zone from 282.4-289.5.			282.4-289.5
289.5-314	Mafic volcanic	Fine grained, dark green.	289.5-314.4-Massive fine grained flow and coloured banded/foliated sections which could represent tuffaceous material.	Minor silicification.		Contact at 314 feet was chosen for textural change.

**FORT KNOX GOLD RESOURCES INC.**

DRILL LOG -- Drill Program

Hole# SG-1-94 p.5

DEPTH	ROCK TYPE	GRAIN SIZE COLOUR	TEXTURE AND STRUCTURE	ALTERATION	MINERALIZATION	COMMENTS/ SAMPLE NO.
314-426.7	Mixed diorite-intrusive fragmental zone.	Dark green fine grained.	Highly variable texture, fine to coarse grained with a heterogenous hybrid appearance. Numerous dikes or distinct textural zones. Dark green ultramafic fragments and veinlets-dikes noted from about 406-409. Foliated/banded composite dike zone 409.1-411.2. Very fine grained (mylonite?). Banding at 35 degrees c.a. Laminated pyritic felsic tuff screen at 411.2-413 degrees c.a. Contents at 20 degrees c.a.	Late chlorite-calcite infilling brecciated gashes and small slips and faults, e.g. see 374-376 and 411.2-411.6 ft.	Trace pyrite in fractures and as disseminations.	This lithology is closely associated with the Cu-Ni zone 250m to the northwest. Weakly anomalous Cu here-see essays attached.
426.7-445.5	Intermediate dike	Fine grained, brown grey colour.	Weakly feldspar-phyric in places only very local relict textures preserved. Generally nondescript.		Traces of chalcopyrite noted on chloritic fractures.	Geochemically anomalous copper.
445.5-477.5	Tectonic breccia zone in felsic dike	Pale grey brown to brick red.	Fault breccia 445.5-451-Microfractured and cemented (calcite-epidote) pale brown dike. 451-466-Hematized breccia zone with best development of breccia from 451-456. 466-472.9-As from 445.5-451. 472.9-477.5 More chloritic section with conspicuous disseminated pyrite, foliated at 70 degrees c.a. 474.4-477.5 ft.	Hematite	Traces of fine grained disseminated pyrite in the orange hematitic sections.	Calcite veins at a shallow angle to c.a.
477.5-490	Volcanics	Medium green to brown.	Both mafic and felsic volcanics; siliceous brecciated (primary) section from 486-490.		Mineralized with conspicuous tiny fracture fillings of chalcopyrite.	

# FORT KNOX GOLD RESOURCES INC.

DRILL LOG -- Drill Program

Hole# SG-1-94 p.6

DEPTH	ROCK TYPE	GRAIN SIZE COLOUR	TEXTURE AND STRUCTURE	ALTERATION	MINERALIZATION	COMMENTS/ SAMPLE NO.
490-562.5	Composite mafic intrusion.	Fine grained, dark green.	Fine to medium grained with diabasic textured intervals-the same unit as logged from 314-426.7 ft. A coarse grained veinlet of anorthositic gabbro at 525.2 ft.	Weak epidote, the original texture is sometimes obscured.	Trace pyrite except in an inclusion of volcanic rock 520-521.4ft. Blebby chalcopyrite in a calcite vein at 559.5.	Milky quartz vein at 536.2-536.8. Conspicuously blocky from 520-536 ft.
562.5-618.5	Felsic pyroclastic	Pale to dark grey	Tuff and lapilli-tuff with some dark chloritic/chloritoid rich sections. Very cherty aphanitic white lapilli fragments. Brown spotted fine grained dikes 572.6-574.8, 592.1-593.3, 607.8-608.1. Diorite dike 611.5-612.5.	Minor chlorite/chloritoid (?)	Pyritic; 2-5% sulphide as fine disseminations and foliation parallel seams and irregular patches/aggregates of pyrite. Traces of galena, sphalerite and rare chalcopyrite.	No visible pyrrhotite or magnetite. Whole rock analyses attached. Anomalous Cu and Pb.
618.5-640.4	Mafic dike	Fine grained, dark green.	Very similar to diabasic textured sections in interval from 490-562.5 feet. Inclusion of tuff 625-628.6			Cemented calcite epidote breccia at 625 feet.
640.4-681.5	Diabase dike	Olive	Massive, medium grained with chilled margins well developed on both contacts.	Minor late chlorite in tiny seams and fractures.		Magnetic
681.5-697.5	Felsic dike	Grey to pink to salmon	Fine grained massive, very weakly porphyritic locally inclusion of mafic volcanic or mafic dike 689.6-690.6. Olive coloured feldspar porphyry 692.9-693.4 From 689.6-691.2 mafic volcanic and 690.6-691.2 tuff inclusions in screens.	Hematite-weak to moderate development.		

# FORT KNOX GOLD RESOURCES INC.

DRILL LOG -- Drill Program

Hole# SG-1-94 p.7

DEPTH	ROCK TYPE	GRAIN SIZE COLOUR	TEXTURE AND STRUCTURE	ALTERATION	MINERALIZATION	COMMENTS/ SAMPLE NO.
697.5-727.0	Mafic volcanic	Fine grained medium grey green	Weakly feldspar-phyric and locally amygdaloidal.	Moderate silicification, and conspicuous quartz epidote garnet in bleached areas of fractured and amygdule controlled alteration.	Traces of pyrite both in amygdules and as local fine grained disseminations.	716-721 Silicified mafic volcanics have also been logged on the southwest side of the gabbro anorthosite intrusive complex (DDH SG-8).
727.0-739.1	Mixed zone of siliceous tuff and felsic dikes	Medium grey	Feldspar-phyric, laminated felsic dikes at 727-728 and 732.8-734.5 cut fine grained banded tuff, this banding appears to reflect bedding at 25-30 degrees c.a. Fabric in dikes is also shallow to c.a.	Calcite and hematite in a fracture zone 727.2-728.0 feet.		
739.1-740.7	Felsic dike	Pink to salmon colour	Distinctly feldspar-phyric with feldspar up to 2-3mm. The section exhibits cataclasis with feldspar grains pulled apart and quartz-calcite injection veinlets.			
740.7-801.4	Mafic intrusion	Medium to dark green.	Fine to medium grain diabasic texture-fine grained upper contact. Generally massive aspect with local foliation evident at 50-60 degrees c.a. Contains 5-10% darker bands, patches and tiny veinlets of pyroxenitic material. Some conspicuous coarser grained pyroxene; overall very homogenous looking. 769.3-775.8-Laminated (subparallel to c.a.) feldspar-phyric dike and grey quartz vein material. 784.3-789.6-diabase dike	Late chloritized slips with calcite.	Contains traces of pyrite with no conspicuous magnetite.	No magnetic attraction.



**FORT KNOX GOLD RESOURCES INC.**

DRILL LOG - Drill Program

Hole# SG-1-94 p.8

DEPTH	ROCK TYPE	GRAIN SIZE COLOUR	TEXTURE AND STRUCTURE	ALTERATION	MINERALIZATION	COMMENTS/ SAMPLE NO.
801.4-1112.4	Diabase dike	Medium grey-green.	Fine grained with much coarser medium grained central portion. Massive with late chlorite-calcite slips (up to 1mm) throughout. Felsic dike inclusion at 805.4-806.5			Weakly magnetic Blocky at upper contact for about 6 feet.
1112.4-1117.9	Mafic Volcanic or dike.	Fine grained medium green.	Massive, with some brecciation at upper contact. Feldspar-porphyry at 1112.4-1113.		Trace of pyrite	1112.4-1117.9
1117.9-1152.8	Feldspar porphyry	Medium grey	Highly foliated at 25-35 degrees c.a. but conspicuous feldspar phenocrysts 1-3mm in size.			Intensity of foliation increase downhole. Contact drawn at the last appearance of phenocrysts.
1152.8-1169	Intermediate volcanic/tuff?	Coloured banded; grey-green to mauve.	Well foliated at 45 degrees c.a. Between 1166-1169 has a fragmental (tuffaceous) appearance.	Fine grained biotite rich bands and patchy sections alternate with pale green mottled sections.		
1169-1174.6	Volcanic (?)	Fine grained, pale green to pinkish brown mottled texture.	Tiny feldspar phenocrysts.			This looks like a highly altered volcanic rock. Lower contact sharp at 60 degrees c.a.
1174.6-1246.2	Mafic intrusion Diorite-gabbro	Dark green medium to coarse grained	Diabasic texture; coarse grained quartz rich patches and bands, irregular veinlets and more mafic pyroxenitic zones and bands. Possible pyroxenitic dikes. Felsic dikes-1227.5-1228.9 and 1229.9-1230.6 Diabase dike-1244.3-1245.0		Pyrite occurs as disseminations and in minute fracture fillings, varying from only a trace to 1-2% over short intervals. Traces of Cpy noted rarely. Conspicuous magnetite after 1220 feet.	Strongly magnetic-very magnetic-rich after 1220 feet. Units of this type with the distinct bluish quartz are also present in the nearby Cu-Ni-Pt Pd-Au zone.

**FORT KNOX GOLD RESOURCES INC.**

DRILL LOG --- Drill Program

Hole# SG-1-94 p.9

DEPTH	ROCK TYPE	GRAIN SIZE COLOUR	TEXTURE AND STRUCTURE	ALTERATION	MINERALIZATION	COMMENTS/ SAMPLE NO.
1246.2-1348	Diabase dike	Medium green-grey	Massive, generally featureless with the exception of a few amygule-like structures up to 5mm across. Dike contacts 40 degrees c.a. 1249.7-1253.6-Inclusion of well mineralized, dark green, fine grained dioritic intrusion. Fine disseminations and aggregates of pyrite-about 5% by volume.			
1348-1406.3	Mafic intrusion; Diorite-Gabro	Dark green, Bluish green	Diabasic texture common in a section that varies from fine to coarse grain. Salient features include banding on a gross scale and irregular quartz-rich patches and veinlets cutting fine grained zones. Generally resembles closely the section from 1174.6-1246.2 above. Very massive with only hint of structure being the local banded appearance.		Disseminated and fracture filling pyrite; highly variable amount from trace to 5% over very short (0.2-0.5ft) intervals. Disseminated magnetite throughout.	Distinctly to strongly magnetic.
1406.3-1416	Feldspar porphyry	Pinkish grey to medium grey	About 5-10% blocky feldspar grains to 2mm common. There is a definite grain-gradation finer downhole to the contact at 1416.8. Contact 25 degrees c.a.			Granitic-composition likely.
1416.8-1418	Tuff	Medium green	Laminated, siliceous sediment/tuff. Lamination (bedding) at 15 degrees c.a.		Fine grained, dissemination pyrite.	

**FORT KNOX GOLD RESOURCES INC.**

DRILL LOG -- Drill Program

Hole # SG-1-94 p. 10

DEPTH	ROCK TYPE	GRAIN SIZE COLOUR	TEXTURE AND STRUCTURE	ALTERATION	MINERALIZATION	COMMENTS/ SAMPLE NO.
1418-1582.7	Diorite-Gabbro	Medium green.	<p>Diabasic texture predominant with grain size, fine to medium to medium decreasing downhole. This is a composite intrusion which may exhibit gross, large scale banding. Very fine grained pyroxenitic zones noted. Also, leucocratic (anorthositic) veinlets-discreet cross cutting phase occur at 1466.1 and 1469.4 feet.</p> <p>1491-1521-Spotted texture due to pyroxene 'megacrysts' up to 1cm across set in a diabasic groundmass.</p> <p>1521-1559.6-Diabasic textured with local feldspar phenocrysts and pyroxene relict phenocrysts, patches and cross cutting veins carrying disseminated pyrite strongly magnetic. Coarse grained CLAG at 1555.1-1556 feet.</p> <p>1559.6-1567.9-CLAG and subporphyritic CLAG with dark fine grained fragments noted. Trace pyrite.</p> <p>1567.9-1582.7-Diabasic texture with local coarse cross cutting sulphidic pyroxenite and CLAG zones (dikes).</p>		<p>In general trace pyrite with 0.5 % to 1% over short sections.</p> <p>Trace chalcopyrite in calcite stringers at 1581 feet.</p>	<p>A few milky quartz veins and stringers without chlorite or epidote alteration. Disseminated pyrite in dark pyroxenitic zones is anomalous in copper.</p>
1582.7-1614.0	CLAG	Medium grey	<p>Coarse grained equigranular to sub-porphyritic anorthositic gabbro. Conspicuous quartz. A few dark fine grained fragments. Possible dike or screen of very fine grained material 1609.6-1611 feet.</p>		<p>Trace disseminated pyrite</p>	<p>This is the CLAG unit that hosts the mineralized, Cu, Ni, Pt, Au zone.</p>

**FORT KNOX GOLD RESOURCES INC.**

DRILL LOG -- Drill Program

Hole# SG-1-94 p.11

DEPTH	ROCK TYPE	GRAIN SIZE COLOUR	TEXTURE AND STRUCTURE	ALTERATION	MINERALIZATION	COMMENTS/ SAMPLE NO.
1614-1627	Mafic intrusion	Medium green.	Medium green diabasic texture with dark sulphidic pyroxenitic and blue quartz patches segregations and veinlets.		Fine grained sulphide interstitial to coarse blocky relict pyroxenes.	
1627-1631.5	Volcanic	Pale green to grey-green	Vague fragmental character.		Trace pyrite.	
1631.5-1641.6	Mafic intrusion		Diabasic texture as above from 1614-1627 feet.			
1641.6-1653.3	CLAG		As described above from 1582.7-1614.0		Trace disseminated pyrite.	
1653.3-1658	Mixed zone of CLAG and diabasic textured gabbro		There appears to be fragments of fine grained diabasic textured rock in the CLAG as noted in sections above.	Minor epidotization with or without calcite veinlets and seams.		
1658-1900	CLAG		As described above from 1582.7-1614.0. A few fragments of fine grained diabasic textured gabbro. Fine grained late diabase dike at 1709.1-1713.5 feet. Contacts at 40 degrees c.a. Banded/laminated feldspar-phyric granitic dike 859.5-861.5. Contacts 70 degrees c.a.		Traces of pyrite except where there are small isolated veinlets of pyroxenite which carry 1-2% fine grained sulphide.	Generally massive undeformed.
EOH 1900						

# Fort Knox Gold Resources Inc.

Drilling Analysis / Geo-Chem Analysis

Hole: SG-1-94

Page: 1 of 4

Sample #	From	To	Interval feet	Au PPB	Au/Check PPB	Ag PPM	Cu PPM	Ni PPM	Pb PPM	Zn PPM	Pd PPB
H-8952	136.0	141.0	5.0	3	0.3	0.1	67	45	-	-	<2
H-8953	177.7	181.2	3.5	nil	-	0.2	104	83	28	100	-
H-8954	219.7	224.7	5.0	nil	-	0.1	55	41	-	-	<2
H-8956	318.7	323.7	5.0	3	-	-	61	38	-	-	<2
H-8957	336.0	341.0	5.0	nil	-	-	75	46	-	-	<2
H-8958	381.0	386.0	5.0	2	-	-	153	42	-	-	<2
H-8959	396.0	401.0	5.0	nil	-	-	207	55	-	-	<2
H-8960	401.0	406.0	5.0	nil	-	-	70	36	-	-	3
H-8961	406.0	409.1	3.1	7	-	-	157	53	-	-	<2
H-8962	426.7	431.0	4.3	nil	-	0.1	518	47	1	71	<2
H-8963	431.0	436.0	5.0	nil	-	0.1	342	43	4	61	-
H-8964	451.0	456.0	5.0	nil	-	0.1	100	36	-	-	<2
H-8965	456.0	461.0	5.0	7	5	0.1	17	35	-	-	<2
H-8966	461.0	466.0	5.0	nil	-	0.1	19	44	-	-	<2
H-8967	472.9	477.5	4.6	nil	-	0.1	91	30	-	-	3
H-8968	477.5	481.0	3.5	nil	-	0.1	159	46	-	-	-
H-8969	481.0	486.0	5.0	nil	-	0.1	53	-	1	54	-
H-8970	486.0	490.0	4.0	24	17	0.1	538	-	1	54	-
H-8971	562.5	566.0	3.5	nil	-	0.1	232	-	27	68	-
H-8972	566.0	572.6	6.6	nil	-	0.1	85	-	161	75	-
H-8973	574.8	580.6	5.8	nil	-	0.1	40	-	710	400	-
H-8974	581.3	585.8	4.5	nil	-	0.1	62	-	109	117	-
H-8975	585.8	591.0	5.2	nil	-	0.2	104	-	137	119	-
H-8976	591.0	596.0	5.0	nil	-	0.1	64	-	570	190	-
H-8977	596.0	601.0	5.0	nil	nil	0.1	57	-	88	149	-
H-8978	601.0	606.0	5.0	nil	-	0.8	63	-	660	218	-
H-8979	606.0	607.8	1.8	3	-	0.1	80	-	260	112	-
H-8980	608.1	611.5	3.4	nil	-	0.1	270	-	21	101	-
H-8981	612.5	616.0	3.5	nil	-	0.1	370	-	6	91	-
H-8982	616.0	618.5	2.5	nil	-	0.2	323	-	24	173	-

# Fort Knox Gold Resources Inc.

Drilling Analysis / Geo Chem Analysis

Hole: SG-1-94

Page: 2 of 4

Sample #	From	To	Interval feet	Au PPB	Au/Check PPB	Ag PPM	Cu PPM	Ni PPM	Pb PPM	Zn PPM	Pd PPB
H-8983	716.0	721.0	5.0	21	27	0.1	58	-	4	45	-
H-8984	756.0	761.0	5.0	5	-	-	116	38	-	-	2
H-8985	761.0	766.0	5.0	nil	-	-	114	34	-	-	<2
H-8986	775.8	781.0	5.2	nil	nil	-	145	27	-	-	2
H-8987	781.0	784.3	3.3	nil	-	-	215	32	-	-	<2
H-8988	1112.4	1117.9	5.5	nil	-	-	103	358	-	-	<2
H-8989	1117.9	1122.9	5.0	nil	-	-	8	45	1	62	<2
H-8990	1176.0	1181.0	5.0	nil	-	-	14	30	-	-	<2
H-8991	1181.0	1186.0	5.0	nil	-	-	24	22	-	-	<2
H-8992	1186.0	1191.0	5.0	nil	-	-	47	23	-	-	<2
H-8993	1191.0	1194.2	3.2	nil	-	-	39	21	-	-	<2
H-8994	1194.2	1197.4	3.2	nil	-	-	61	18	-	-	<2
H-8995	1197.4	1201.0	3.6	7	3	-	77	14	-	-	2
H-8996	1201.0	1206.0	5.0	nil	-	-	145	27	-	-	3
H-8997	1206.0	1211.0	5.0	nil	-	-	80	23	-	-	<2
H-8998	1211.0	1216.0	5.0	nil	-	-	28	22	-	-	<2
H-8999	1216.0	1221.0	5.0	nil	-	-	65	24	-	-	<2
H-9000	1221.0	1226.0	5.0	3	-	-	197	22	-	-	<2
FX-774001	1226.0	1227.5	1.5	nil	-	-	114	20	-	-	2
FX-774002	1230.6	1236.0	5.4	nil	-	-	130	18	-	-	<2
FX-774003	1236.0	1239.0	3.0	3	5	-	151	18	-	-	<2
FX-774004	1239.0	1244.3	5.3	5	-	-	122	22	-	-	3
FX-774005	1245.0	1246.2	1.2	nil	-	-	178	19	-	-	2
FX-774006	1246.2	1249.7	3.5	nil	-	-	84	47	-	-	<2
FX-774007	1249.7	1253.6	3.9	nil	nil	-	1220	88	-	-	7
FX-774008	1361.0	1366.0	5.0	nil	-	-	121	17	-	-	<2
FX-774009	1366.0	1371.0	5.0	nil	-	-	120	19	-	-	2
FX-774010	1371.0	1376.0	5.0	nil	-	-	103	17	-	-	2
FX-774011	1376.0	1379.0	3.0	nil	-	-	94	14	-	-	<2
FX-774012	1379.0	1382.2	3.2	nil	-	-	64	17	-	-	<2

# Fort Knox Gold Resources Inc.

Drilling Analysis / Geo-Chem Analysis

Hole: SG-1-94

Page: 3 of 4

Sample #	From	To	Interval feet	Au PPB	Au/Check PPB	Ag PPM	Cu PPM	Ni PPM	Pb PPM	Zn PPM	Pd PPB
FX-774013	1382.2	1386.0	3.8	nil	-	-	545	26	-	-	9
FX-774014	1386.0	1391.0	5.0	5	-	-	238	21	-	-	2
FX-774015	1391.0	1396.0	5.0	nil	-	-	462	20	-	-	<2
FX-774016	1396.0	1401.0	5.0	nil	nil	-	58	16	-	-	2
FX-774017	1401.0	1406.3	5.3	nil	-	-	195	27	-	-	<2
FX-774018	1406.3	1411.0	4.7	nil	-	-	83	28	-	-	<2
FX-774019	1416.8	1418.0	1.2	nil	-	-	426	22	-	-	2
FX-774020	1418.0	1426.0	8.0	nil	-	-	62	14	-	-	<2
FX-774021	1426.0	1431.0	5.0	nil	-	-	29	21	-	-	<2
FX-774022	1431.0	1436.0	5.0	nil	-	-	35	13	-	-	7
FX-774023	1461.0	1466.0	5.0	nil	-	-	46	11	-	-	<2
FX-774024	1466.0	1471.0	5.0	nil	-	-	56	12	-	-	<2
FX-774025	1471.0	1476.0	5.0	5	9	-	48	11	-	-	<2
FX-774026	1486.0	1491.0	5.0	10	-	-	211	58	-	-	<2
FX-774027	1491.0	1496.0	5.0	10	12	-	232	54	-	-	<2
FX-774028	1501.0	1506.0	5.0	nil	-	-	142	46	-	-	3
FX-774029	1506.0	1509.8	3.8	nil	-	-	158	43	-	-	<2
FX-774030	1509.8	1516.0	6.2	nil	-	-	134	44	-	-	<2
FX-774031	1536.0	1541.0	5.0	nil	-	-	116	16	-	-	<2
FX-774032	1546.0	1548.5	2.5	nil	-	-	250	23	-	-	3
FX-774033	1548.5	1550.5	2.0	2	-	-	127	19	-	-	<2
FX-774034	1550.5	1553.8	3.3	nil	-	-	64	19	-	-	<2
FX-774035	1553.8	1555.1	1.3	14	-	-	446	24	-	-	<2
FX-774036	1555.1	1556.0	0.9	22	17	-	573	49	-	-	2
FX-774037	1556.0	1559.6	3.6	26	31	-	254	35	-	-	<2
FX-774038	1559.6	1566.0	6.4	nil	-	-	61	79	-	-	<2
FX-774039	1576.0	1581.0	5.0	nil	-	-	91	19	-	-	3
FX-774040	1581.0	1582.7	1.7	nil	-	-	369	42	-	-	<2
FX-774041	1582.7	1586.0	3.3	nil	-	-	103	90	-	-	<2
FX-774042	1586.0	1591.0	5.0	nil	-	-	80	82	-	-	<2





**FORT KNOX GOLD RESOURCES INC.**

Hole # SG-2-94

Property: Little Nickel Tshp/County: Fawcett

**Acid Tests**

187ft >> -44 deg

287ft >> -46 deg

Claim: 1180182 Coord.: South Grid Azimuth: 227 Started: Dec. 3/94

Range: \_\_\_\_\_ : 1+60E, 0+47S Dip: -45 Completed: Dec. 10/94

Core Size: BQ Elevation: \_\_\_\_\_ Length: 287' (87.5m) Logged By: A.D.H.

Sheet No.: p. 1

Logged by: DOUGLAS HUNTER Douglas Hunter Date logged: Dec. 11, 1994

The borehole collar is located 190 m S and 10 m E of the #4 post.

This hole drilled to define the known Cu - Ni deposit near surface.

**Abbreviations:**

PCLAG - Porphyritic Coarse Grained Anorthositic Gabbro

Po - pyrrhotite

Cpy - chalcopyrite

# FORT KNOX GOLD RESOURCES INC.

DRILL LOG --- Drill Program

Hole# SG-2-94 p.2

DEPTH	ROCK TYPE	GRAIN SIZE COLOUR	TEXTURE AND STRUCTURE	ALTERATION	MINERALIZATION	COMMENTS/ SAMPLE NO.
0-75	Casing in gravel					
75-129	Mixed gabbo and pyroxenite	Medium to dark green	Breccia zone with pyroxenite cutting diabasic textured gabbro-fine to medium grained and with minor CLAG. Local shearing but overall this section is best described as an intrusive breccia.		Disseminated and fracture filling sulphide-1-5%. Minor pyrrhotite.	
129-157	Pyroxenite	dark green	Distinctive feature is blocky relict pyroxene crystals up to 1cm across. Also, this section contains some diabasic textured fragments and other dark fine grained aphyric pyroxenite. Diabasic texture. About 10% of this interval is mineralized pyroxenite.		About 10% sulphides as fine grained disseminations and net-textured wrapping around pyroxenes. Low content of pyrrhotite. Some chalcopyrite rich fracture fillings.	
157-167	Gabbro	Dark green	Diabasic texture. About 10% of this interval is mineralized pyroxenite.		1-5% total sulphide.	
167-182	Pyroxenite	Dark blue green	Massive with blocky pyroxene crystals (relief).		Low sulphide content	Magnetic
182-201	Mixed gabbo and pyroxenite		As described above from 75-129 feet. Fine grained well mineralized fragments set in a pyroxenite crystal rich groundmass.		5-10% total sulphides, locally conspicuous pyrrhotite and fracture filling chalcopyrite.	
201-215	Pyroxenite	Dark blue green	As described from 167-182 feet.			

**FORT KNOX GOLD RESOURCES INC.**

DRILL LOG -- Drill Program

Hole# SG-2-94 p.3

DEPTH	ROCK TYPE	GRAIN SIZE COLOUR	TEXTURE AND STRUCTURE	ALTERATION	MINERALIZATION	COMMENTS/ SAMPLE NO.
215-237.7	Mixed pyroxenite and gabbro		Breccia with gabbro and anorthosite fragments set in well mineralized pyroxenite. Similar to other sections described above; eg; 182-201 feet.		About 10-15% total sulphide conspicuous cpy in fractures. Locally po appears to be predominant but pyrite is more common.	
237.7-244	Mafic dike	Dark blue green	Massive and feldspar phyric. Probable gabbroic composition.		Barren of sulphide	
244-268.1	Sulphide zone		Main sulphide zone; net textured with 40-50% sulphides and blocky pyroxene crystals 5mm in size and rock fragments including gabbro and anorthosite.		40-50% total sulphides; po rich and containing coarse fracture filling cpy.	
268.1-287	PCLAG and anorthositic gabbro	Medium grey	Sharp contact with PCLAG at 268.1 to 269.8 followed by medium grained anorthositic gabbro 269.8-280. PCLAG 280-287 feet.		No conspicuous sulphide.	
E0H 287						

# Fort Knox Gold Resources Inc.

Drilling Analysis / Geo-Chem Analysis

Hole: SG-2-94

Page: 1 of 3

Sample #	From	To	Interval feet	Au PPB	Au/Check PPB	Cu PPM	Ni PPM	Pt PPB	Pd PPB
FX-774201	73.7	76.0	2.3	nil	-	53	91	<10	5
FX-774202	76.0	81.0	5.0	26	31	1020	3140	38	60
FX-774203	81.0	87.0	6.0	14	-	922	1090	<10	26
FX-774204	87.0	92.0	5.0	nil	-	1000	2860	15	45
FX-774205	92.0	94.0	2.0	2	-	446	547	<10	7
FX-774206	94.0	97.6	3.6	nil	-	873	1230	12	22
FX-774207	97.6	101.4	3.8	nil	nil	856	994	14	24
FX-774208	101.4	104.7	3.3	nil	-	454	492	<10	15
FX-774209	104.7	107.0	2.3	9	-	446	500	<10	14
FX-774210	107.0	112.0	5.0	nil	-	433	710	<10	19
FX-774211	112.0	117.0	5.0	nil	-	348	540	34	17
FX-774212	117.0	121.0	4.0	39	-	1050	1110	<10	27
FX-774213	121.0	123.2	2.2	5	-	1740	2700	70	50
FX-774214	123.2	126.2	3.0	nil	-	1100	1760	41	41
FX-774215	126.2	129.0	2.8	43	-	1910	2480	75	51
FX-774216	129.0	132.0	3.0	33	-	3160	5600	103	91
FX-774217	132.0	135.1	3.1	77	-	4280	8620	159	137
FX-774218	135.1	137.0	1.9	108	105	5470	7500	130	118
FX-774219	137.0	139.8	2.8	81	-	3540	9040	183	129
FX-774220	139.8	142.0	2.2	72	62	3960	8680	155	145
FX-774221	142.0	144.4	2.4	12	-	2000	6440	154	106
FX-774222	144.4	147.0	2.6	60	41	6300	5720	159	99
FX-774223	147.0	149.7	2.7	51	-	3540	6740	156	117
FX-774224	149.7	152.4	2.7	34	-	3020	5160	89	84
FX-774225	152.4	155.4	3.0	63	-	3600	3280	101	63
FX-774226	155.4	157.8	2.4	69	-	4810	3760	98	67
FX-774227	157.8	159.2	1.4	57	62	5100	4480	223	108
FX-774228	159.2	161.6	2.4	3	-	1970	5220	82	89
FX-774229	161.6	167.0	5.4	nil	-	491	646	22	15
FX-774230	167.0	171.2	4.2	21	-	2080	4200	74	72

# Fort Knox Gold Resources Inc.

Drilling Analysis / Geo-Chem Analysis

Hole: SG-2-94

Page: 2 of 3

Sample #	From	To	Interval feet	Au PPB	Au/Check PPB	Cu PPM	Ni PPM	Pt PPB	Pd PPB
FX-774231	171.2	174.9	3.7	57	65	2320	4650	100	77
FX-774232	174.9	177.0	2.1	nil	-	178	489	<10	<2
FX-774233	177.0	182.0	5.0	nil	-	244	751	<10	,2
FX-774234	182.0	184.8	2.8	72	-	3020	4480	31	67
FX-774235	184.8	187.0	2.2	14	-	1780	4300	67	60
FX-774236	187.0	192.0	5.0	31	-	2020	3560	72	58
FX-774237	192.0	194.3	2.3	123	165	6400	8380	170	120
FX-774238	194.3	197.0	2.7	55	-	3400	4500	53	70
FX-774239	197.0	200.4	3.4	31	-	1820	3500	19	51
FX-774240	200.4	203.7	3.3	3	-	633	902	<10	19
FX-774241	203.7	207.0	3.3	nil	-	286	436	<10	7
FX-774242	207.0	212.0	5.0	34	-	205	544	<10	<2
FX-774243	212.0	217.0	5.0	5	-	1050	2020	7	27
FX-774244	217.0	222.0	5.0	43	-	2620	2440	26	43
FX-774245	222.0	227.0	5.0	58	53	3320	6920	58	78
FX-774246	227.0	230.7	3.7	137	151	8630	5640	151	91
FX-774247	230.7	233.9	3.2	155	-	8510	8120	167	113
FX-774248	233.9	237.7	3.8	81	-	4900	9820	166	108
FX-774249	237.7	240.9	3.2	nil	-	161	241	<10	2
FX-774250	240.9	244.0	3.1	nil	-	60	227	<10	<2
FX-774251	244.0	247.0	3.0	120	-	6860	16900	305	230
FX-774252	247.0	250.3	3.3	89	-	8170	22400	401	237
FX-774253	250.3	252.0	1.7	99	-	8170	22800	415	185
FX-774254	252.0	255.7	3.7	225	-	8840	24400	401	243
FX-774255	255.7	257.0	1.3	158	-	9200	23700	449	213
FX-774256	257.0	260.7	3.7	93	-	10700	18900	336	233
FX-774257	260.7	262.2	1.5	250	309	16400	21200	374	233
FX-774258	262.2	265.3	3.1	216	-	15400	18100	432	192
FX-774259	265.3	268.1	2.8	199	-	14100	19600	374	195
FX-774260	268.1	272.0	3.9	nil	-	258	384	<10	7



**FORT KNOX GOLD RESOURCES INC.**

Hole# SG-3-94

Property: Little Nickel Tshp/County: Fawcett

**Acid Tests**

Claim: 1180181

Coord.: South Grid

Azimuth: 227

Started: Dec. 12/94

80' - 45deg

297' - 44deg

400' - 42deg

Range: \_\_\_\_\_

: 1+90E,0+20S

Dip: -45

Completed: Dec. 18/94

Core Size: BQ

Elevation: \_\_\_\_\_

Length: 402'(122.6m)

Logged By: A.D.H.

Sheet No.: 1

Logged by: DOUGLAS HUNTER Douglas Hunter Date logged: Dec. 19, 1994

The borehole collar is located 190 m S and 20 m W of the #1 post.

This hole was drilled to define the known Cu - Ni deposit near the surface.

# FORT KNOX GOLD RESOURCES INC.

DRILL LOG -- Drill Program

Hole# SG-3-94 p.2

DEPTH	ROCK TYPE	GRAIN SIZE COLOUR	TEXTURE AND STRUCTURE	ALTERATION	MINERALIZATION	COMMENTS/ SAMPLE NO.
0-80	Casing in gravel					
80-256.8	CLAG	Medium grey green	Massive, coarse grained equigranular anorthositic gabbro (CLAG). 118.5-119.5-inclusion of fine grained diabasic textured gabbro. 196.9-197.5-very feldspar-rich anorthositic dike.	Very local grey saussuritized zones associated with quartz stringers.		Very massive homogenous appearance, with local foliation over 1 foot sections at 50-60 degrees c.a.
256.8-296.5	Gabbro and pyroxenite.					
296.5-385.6	Mineralized zone		296.5-336.6-Mixed diabasic textured gabbro and mineralized pyroxenite. Fine grained, sheared pyroxenite cuts the gabbro. Cu-Ni values directly related to the amount of mineralized pyroxenite.  336.6-364.2-Distinct fragments of gabbro and anorthositic gabbro in mineralized pyroxenite. Pyrite rich-10% total sulphides.  364.2-385.6-Net textured sulphides in pyroxenite and fragmental pyroxenite. Total sulphides 30-40% with pyrrhotite predominant - much more than sections above. Chalcopyrite salient in fracture fillings.			
385.6-402	PCLAG	Medium grey green	Texturally distinct from the section 80.0-256.8 only by the porphyritic texture.			The mineralization occurs at a textural boundary in the CLAG/PCLAG
402 EOH						



# Fort Knox Gold Resources Inc.

Drilling Analysis / Geo-Chem Analysis

Hole: SG-3-94

Page: 1 of 1

Sample Number	From	To	Interval feet	Au PPB	Au/Check PPB	Ag PPM	Cu PPM	Ni PPM	Pb PPM	Zn PPM
774263	314.5	317.0	2.5	2	-	-	222	173	-	-
774264	317.0	320.9	3.9	3	-	-	233	301	-	-
774265	320.9	324.2	3.3	5	-	-	518	666	-	-
774266	324.2	327.0	2.8	26	-	-	561	2310	-	-
774267	327.0	329.3	2.3	41	48	-	1580	1090	-	-
774268	329.3	332.0	2.7	153	110	-	1440	1000	-	-
774269	332.0	336.1	4.1	45	-	-	3980	3810	-	-
774270	336.1	338.2	2.1	27	-	-	3570	18500	-	-
774271	338.2	341.3	3.1	34	-	-	2310	5580	-	-
774272	341.3	345.0	3.7	21	-	-	1880	4620	-	-
774273	345.0	347.0	2.0	21	-	-	2170	6000	-	-
774274	347.0	351.2	4.2	10	-	-	2030	9520	-	-
774275	351.2	354.0	2.8	45	-	-	2750	8980	-	-
774276	354.0	357.0	3.0	51	-	-	4320	7720	-	-
774277	357.0	359.6	2.6	69	-	-	4430	10600	-	-
774278	359.6	362.0	2.4	31	-	-	2470	9860	-	-
774279	362.0	364.2	2.2	96	-	-	4760	6940	-	-
774280	364.2	367.0	2.8	165	185	-	9670	17000	-	-
774281	367.0	369.4	2.4	89	-	-	4730	2440	-	-
774282	369.4	372.0	2.6	82	-	-	3710	23200	-	-
774283	372.0	374.5	2.5	223	336	-	11400	18200	-	-
774284	374.5	377.0	2.5	185	-	-	10400	16300	-	-
774285	377.0	379.5	2.5	144	-	-	7840	14300	-	-
774286	379.5	382.0	2.5	210	-	-	5280	14700	-	-
774287	382.0	384.6	2.6	168	-	-	6720	12700	-	-
774288	384.6	385.8	1.2	65	-	-	1960	10400	-	-
774289	385.8	387.8	2.0	45	-	-	697	546	-	-

**FORT KNOX GOLD RESOURCES INC.**

Hole # NG-1-94

Property: Little Nickel Tshp/County: Fawcett

**Acid Tests**

Claim: 1180178

Coord.: North Grid

Azimuth: 41

Started: Nov. 18/94

107'(32.6m) -66 deg	717'(218.6m) 54deg
237'(72.2m) 66deg	807'(246m) 47deg
367'(111.9m) 64deg	905'(289.6m) 44deg
497'(151.5m) 61deg	1067'(325.3m) 40deg
597'(182.9) 58deg	

Range: \_\_\_\_\_

: 1+80N,0+62W

Dip: -68

Completed: Nov.29/94

Core Size: BQ

Elevation: \_\_\_\_\_

Length: 1117'  
(340.5m)

Logged By: A.D.H.

Sheet No.: 1

Logged by: DOUGLAS HUNTER, Douglas Hunter Date logged: Nov. 30, 1994

The borehole collar is located 200 m S and 80 m W of the #1 post.

The hole was drilled in order to test an off - hole pulse EM response resulting from surveying of nearby hole NG - 3 (1992). At a point about 40m below and 75m north of this off - hole anomaly a pyrrhotite rich zone containing graphite was intersected. This explains the geophysical anomaly. The pyroclastics and sediments here are anomalously high in their contents of Cu, Pb, Zn and Ag as they were in the nearby DDH NG - 3.

Deeper in the hole another thick section of felsic pyroclastics, argillite and cherty bedded tuff was intersected. Here there is 1 - 10% sulphide and coarse grained stringers/veins of Py and Po with conspicuous fine grained Gn and Sph. This section is highly anomalous in Pb, Zn and in a few samples Ag and Cu.

**Abbreviations:**

py - pyrite

po - pyrrhotite

gn - galena

cpy - chalcopyrite

sph - sphalerite

QFP - Quartz Feldspar Porphyry

**FORT KNOX GOLD RESOURCES INC.**

DRILL LOG -- Drill Program

Hole# NG-1-94, p.2

DEPTH	ROCK TYPE	GRAIN SIZE COLOUR	TEXTURE AND STRUCTURE	ALTERATION	MINERALIZATION	COMMENTS/ SAMPLE NO.
0 - 5'	Casing					
5-17.1	Felsic tuff	Medium grey to brown	Laminated cherty tuff, Foliation/bedding 35 deg c.a.		Trace pyrite, locally in bedding foliation planes	Very hard cherty
17.1-207.6	Gabbro	Medium to dark green.	Medium to coarse grained locally subporphyritic texture. Shearing/foliation evident throughout. Foliation variable but in general 45 - 55degrees c.a.	Local quartz - epidote patchy development.	Traces of pyrite on chloritic fractures and in tiny quartz stringers.	Quartz veins up to 0.5 feet, but commonly 1-3cm. Some contain traces of pyrite. Non-magnetic.
207.6-220.6	Felsic tuff	Medium grey to brown.	As above from 5-17.1 feet foliated/laminated at 30-35 degrees c.a. Gabbro dike? 214.6-216.		Trace pyrite	Quartz breccia vein 209.7-210.2
220.6-250.5	Gabbro		As above 17.1-207.6 feet			
250.5-288.8	Diabase dike	Dark green	Fine grained, massive late dike. Locally fractured with dark chlorite filling fractures-distinctive.			Distinctly magnetic
288.8-642.5	Gabbro		As above 17.1-207.6 feet. and 220.6-250.5 feet.			1mm to 1cm quartz stringers - joint fillings common throughout.
642.5-651.7	Diabase dike	Dark green to olive.	Fine to medium grained massive.			
651.7-669.8	Mafic Volcanic	Dark green fine grained	Flow with minor interflow sediment/tuff and flow breccia at 669.4-669.8 feet.		Trace pyrite	
669.8-678.3	Diabase dike	Dark green	As above 642.5-651.7			





**FORT KNOX GOLD RESOURCES INC.**

DRILL LOG -- Drill Program

Hole# NG-1-94 p.6

DEPTH	ROCK TYPE	GRAIN SIZE COLOUR	TEXTURE AND STRUCTURE	ALTERATION	MINERALIZATION	COMMENTS/ SAMPLE NO.
886.5-968.1 cont'd			912.3-917 Pyritic(2-10%) tuff, cherty tuff. 917-947 Sericitic tuff and minor cherty tuff with local well developed biotitic alteration. Low sulphide content (0.5-1%) . Minor dark argillite beds. 947-950.3 Graphitic sulphide rich argillite. Massive stringes of po, py, cpy at 948.3-948.4 feet. 950.3-968.1 Pyritic tuff and lapilli-tuff; somewhat sericitic. Pyrite content 1-10% as stringers-foliation parallel and beds to 0.1 feet.			
968.1-1004.3	Mafic-tuff/lava with QFP fragments.		As logged above 849.8-865.5 but sheared and altered. Foliated at 55-70 degrees c.a.	Strong biotite development from 968.1-973.5 and local bleached carbonate alteration with QC veinlets and local shearings.		
1004.3-1117  EOH 1117	Massive and pillowed basalt lava.	Medium green	Generally massive, fine to medium grained. Weakly amygdaloidal. Pillow structure best developed below 1070 feet.	Local bleached carbonatized (fracture controlled) in pillow lava/ breccia	Quartz veining, shearing and brecciated 1105.9-1117 feet. At 1008.6 traces of cpy and py in quartz.	Ubiquitous quartz-albite fracture fillings and veinlets conspicuous throughout.

**FORT KNOX GOLD RESOURCES INC.**

DRILL LOG -- Drill Program

Hole# NG-1-94 p.5

DEPTH	ROCK TYPE	GRAIN SIZE COLOUR	TEXTURE AND STRUCTURE	ALTERATION	MINERALIZATION	COMMENTS/ SAMPLE NO.
849.8-865.5 145-	Mafic tuff/lava with QFP fragments	Dark green	Distinctive unit, dark mafic volcanic with pale grey brown QFP lapilli and blocks (5-10%) as texturally described from 765.2-785.5 feet. Other fragments are mafic and siliceous, aphanitic-cherty.			This unit was not logged in NG-3(1992) although QFP units were intersected.
865.5-874	Gabbro and mafic volcanics	dark green	Fine to medium grained with possible 0.1-0.2 interflow fragmental/sediments. Fault zone 872.3-872.9 brecciated with muddy pyritic gouge and calcite veinlets - stringers ? c.a.			
874-875.5	Gabbro		Medium grained			
875.5-876.5	Cherty ash	Dark grey	Hard, cherty, pyritic ash (cherty exhalite).		Fine disseminated bedded pyrite and galena in fractures	Muddy pyritic fault gouge at 875.5-875.6 feet.
876.5-886.5	Gabbro	Medium green	Medium grained equigranular			
886.5-968.1	Pyroclastic/ sedimentary mineralized zone	Pale to dark grey to black	Interbedded felsic tuff, lapilli-tuff, argillite and cherty +- graphitic argillite. Thin bedded to laminated with sulphide mineralization concentrated in cherty ash tuff and black graphitic beds 886.5-902. Hard cherty tuff, lapilli-tuff. 902-907.8 Dark grey tuff and graphitic/chloritic tuff argillite with local garnet and magnetite 907.8-912.3. Graphitic argillite with up to 20% sulphides and chert.		Well mineralized (1-10%) sulphides; fine grained disseminated py, po, stringers and disrupted beds of coarse po, py. Traces of sph, gn noted locally. Black magnetite rich layers 906.3-907.8. Garnet rich here also.	Very hard cherty sections as between 889-892 contain fine dustings and coatings on fragments of reddish sphalerite. About 0.5 feet of ground core 897-902 feet.

# FORT KNOX GOLD RESOURCES INC.

DRILL LOG -- Drill Program

Hole # NG-1-94 p.4

DEPTH	ROCK TYPE	GRAIN SIZE COLOUR	TEXTURE AND STRUCTURE	ALTERATION	MINERALIZATION	COMMENTS/ SAMPLE NO.
731.4-758.1 cont'd	Mixed pyroclastics sediments		741.3-758.1, medium green, well foliated chloritic section. Heterolithic-many fragment types, mafic and siliceous-cherty and some feldspar - phytic. Intense flattening of fragments at 50-55 degrees c.a. Po-rich cherty ash bed 757-757.2 (20% sulphide).			
758.1-765.2	Intermediate dike	Medium grey-green	Massive, fine to medium grained. Weakly feldspar-phyric.	Minor bleaching		
765.2-785.5	Tuffaceous siltstone and mudstone with blocks/beds of QFP	Grey - green	Well bedded/laminated sediment/tuff with QFP blocks, beds. Very distinctive 10-15% blocky feldspar phenocrysts (1-5mm) and round blue quartz eyes (2-3mm). Cleavage/bedding at 40-50 degrees c.a.		Fine disseminated pyrite in sediments and in QFP blocks. Also stringers and lens-like concentrations of pyrite. Overall 0.5%, locally up to 1% py.	Diabase dikes 771-772.5, 777.2-777.9
785.5-800	Gabbro	Medium green	Medium grained, inclusion of mineralized pyritic mudstone with minor graphite in black cherty layers. Lower contact indistinct due to tan coloured alteration.	Minor bleaching		Quartz vein with sheared chloritic gabbro fragments 791.9-792.9. Hard to draw lower contact.
800-807	Tuff and cherty pyritic sediment	Grey to tan	Well bedded, laminated disrupted bedding in pyritic graphitic zone from 801.4-804.8. Highly brecciated zone with calcite veins and stringers 801.4-805.2 feet.		Up to 10-20% bedded pyrite 801.4-803.4 feet	
807-849.8	Gabbro	Medium to dark green	Massive, medium grained contact zone 849.1-850.5 contains a fine grained tan coloured dike and quartz stringers/breccia.	Tan bleached upper contact at 50degrees c.a.		



# FORT KNOX GOLD RESOURCES INC.

DRILL LOG - Drill Program

Hole# NG-1-94 p.3

DEPTH	ROCK TYPE	GRAIN SIZE COLOUR	TEXTURE AND STRUCTURE	ALTERATION	MINERALIZATION	COMMENTS/ SAMPLE NO.
678.3-711	Mineralized pyroclastic/ sediments (siltstone/argillite).	Medium to dark grey.	Tuff, lapilli - tuff. Bedded grey to charcoal grey argillite (graphitic in places), tuffaceous argillite, lapilli tuff, some beds feldspar +- quartz rich. Foliation/bedding 50 degrees c.a. 706-711. Black laminated argillite, containing 10 % sulphides; predominately po and py, but also conspicuous epy. Sulphide forms sub mm beds and occurs as extremely fine grained disseminations. The unit is graphitic in places (eg. 710-711) but also is very hard in other sections. Lamination at 55 degrees c.a.		Conspicuous sulphide with fine disseminated pyrite, pyrrhotite and reddish sphalerite. Traces of galena and chalcopyrite. Content of sulphide 0.5-3% with local foliation parallel lenses and stringers.	Mineralized zone containing the target conductor detected from bore hole EM surveyed of DDH NG-3 (1992)
711-717.1	Diabase dike	Pale brown to olive.	Fine grained, massive with late chlorite and calcite fracture fillings.		Very fine grained disseminated pyrite - traces.	
717.1-718.7	Felsic tuff					
718.7-731.4	Mafic volcanic or dike	Medium green, fine grained.	Numerous pale/bone coloured zones containing fiamme like fragments; tuff dikes in lava possible interpretation.			Very unusual. This unit not seen before. Highly fractured with quartz veins some containing coarse grained pyrrhotite.
731.4-758.1	Felsic pyroclastics	Medium grey	Tuff and lapilli - tuff. Hard/cherty with some fine cherty ash tuff beds. Conspicuous (1-2%) feldspar phenocrysts; also quartz eyes noted. Well foliated at 45-50 degrees c.a.		Fine grained disseminated pyrite (1-2%) Throughout.	

**FORT KNOX GOLD RESOURCES INC.**

Hole#NG-2-94

Property: Little Nickel Tshp/County: Fawcett**Acid Tests**Claim: 1180229Coord.: North GridAzimuth: 043Started: Nov 5/94

100' - 50deg

237' - 50deg

367' - 48deg

497' - 46deg

605' - 44deg

Range: \_\_\_\_\_ : 2+67E,7+92SDip: -50Completed: Nov 11/94Core Size: BQElevation: 5m above lakeLength: 637 ft.Logged By: A.D.H.

Sheet No.: 1

Logged by: DOUGLAS HUNTER Douglas Hunter Date Logged: Nov. 12, 1994

The borehole collar is located 200 m N and 20 m E of the #3 post.

This hole was targeted on a magnetic anomaly which occurs along strike of sulphide mineralization in a geological environment favourable for VMS base metal mineralization. The anomaly has its origin in magnetite rich gabbro. No significant base metal mineralization was encountered.

W.R. Whole rock analyses.

**FORT KNOX GOLD RESOURCES INC.**

DRILL LOG Drill Program

Hole# NG-2-94 p.2

DEPTH	ROCK TYPE	GRAIN SIZE COLOUR	TEXTURE AND STRUCTURE	ALTERATION	MINERALIZATION	COMMENTS/ SAMPLE NO.
0-18	Casing in sand and gravel					
18-44.3	Felsic volcanic	Bone to pale yellow brown	Coarse fragmental unit, possible flow. Large blocks up to 0.5 feet set in sericitic finer grained material. Weakly feldspar phytic; 1-2% 1mm blocky grains set in a cherty aphanitic ground mass. Well foliated at 45-50 degrees c.a.	Minor sericite in foliation in bands contrasting with white highly siliceous fragments.	Traces of pyrite as fine crystalline disseminations in darker chloritic, sericitic bands. Also noted locally in siliceous blocks.	Similar hard cherty unit was intersected in DDH NG-2 (1991) below 200m. WR 23-33 feet.
44.3-53.8	Mafic dike	Dark green, fine grained	Deformed, locally fractured with quartz filling. Gash-like fractures. Foliated locally, highly variable angle to c.a.		Locally pyrite in fractures.	Despite fracturing the core is not blocky.
53.8-101.1	Felsic pyroclastic	Pale yellow green	Lapilli-tuff/tuff breccia highly foliated, banded at average 50 degrees c.a. (45-55 degrees c.a.). Mafic dikes 54.7-55.1, 55.7-57.3, 62.8-64.3 (reddish biotitic).	Sericitic, much more than siliceous section above at 18-44.3 feet. Pink, salmon hematitic mottling and banding conspicuous spots after 87 feet.	Trace pyrite	Milky quartz veins 193.1-193.7 196.3-196.5 WR 77-87 feet.
101.1-109.4	Felsic pyroclastic Tuff/cherty tuff.	Medium green	Harder, cherty aspect and less sericitic than previous section. Brecciated 108.3-109.4.			Very hard cherty locally laminated appearance.
109.4-224.5	Diabase dike	Dark green to olive	Chilled upper contact at 70 degrees c.a./lower 80-85 degrees c.a. Late chlorite +-calcite fracture fillings.			Distinctly magnetic.

**FORT KNOX GOLD RESOURCES INC.**

DRILL LOG Drill Program

Hole# NG-2-94 p.3

DEPTH	ROCK TYPE	GRAIN SIZE COLOUR	TEXTURE AND STRUCTURE	ALTERATION	MINERALIZATION	COMMENTS/ SAMPLE NO.
224.5-269.8	Gabbro	Dark green, fine to medium grained	Locally sheared, chloritic. Deformed fractured zones with conspicuous calcite veining and orange hematitic discolouration, e.g.241.2-242.2 and 257-257.8 feet. Sheared lower contact at 30 degrees c.a.			Probably a composite dike
269.8-305.2	Felsic pyroclastics	Pale yellow to grey	Tuff/lapilli-tuff tiny quartz grains noted in grey coloured sections. Well foliated at 40-45 degrees c.a.		Trace pyrite.	Brecciated locally with bull quartz veins, e.g. 285-286'
305.2-351.5	Diabase dike	Dark green	Massive with chilled contacts.			Distinctly magnetic
351.5-356	Mafic (gabbroic dike)	Fine grained	Foliated at 30 degrees c.a.			
356-380	Felsic pyroclastics	Grey to pinkish grey	Coarse fragmental with grey cherty lapilli and large feldspar-phyric blocks up to 1 ft. Fragments flattened into foliation at 40-45 degrees c.a. Diabase dike 359.2-359.8.		Trace pyrite	WR 361-371.
380-513.1	Gabbro	Medium to dark green	Foliated, with only local preservation of texture, 40-45 degrees c.a. Calcite veining throughout conspicuously foliation parallel. Deformed/brecciated zone 477-477.8 ft. Diabase 455.6-459.9		Pyrite in calcite veins common along with maroon stained coarse crystalline calcite.	Conspicuous magnetite from about 433 feet. Strongly magnetitic to about 500 ft.

**FORT KNOX GOLD RESOURCES INC.**

DRILL LOG -- Drill Program

Hole# NG-2-94 p.4

DEPTH	ROCK TYPE	GRAIN SIZE COLOUR	TEXTURE AND STRUCTURE	ALTERATION	MINERALIZATION	COMMENTS/ SAMPLE NO.
513.1-565	Felsic pyroclastics	Grey	<p>Grey cherty lapilli-tuff with red hematitic (jasper-like) fragments in one section.</p> <p>513.1-522.6-Grey cherty fragmental section with conspicuous 1mm feldspar grains. Trace pyrite.</p> <p>522.6-530.3-Distinct red-pink-maroon lapilli size cherty fragments in a dark chloritic/amphibole rich/garnet rich groundmass. About 5-10% garnet as irregular flattened grains-parallel to foliation and as larger up to 1cm clusters in bull quartz vein as at 529 ft. Traces of pyrite. Distinctly magnetic.</p> <p>530.3-546-Grey tuff, lapilli-tuff with conspicuous pinhead quartz grains and 1-3mm feldspar crystals in some large block size fragments. 2-3% pyrite generally as coarse grained aggregates in the plane of foliation at 55-60 degrees c.a.</p> <p>546-547-Dark grey, siliceous pyritic argillite. Bedding 60-70 degrees c.a.</p> <p>547-552-Cherty sulphidic lapilli-tuff. Conspicuous sub mm quartz eyes. About 5-10% pyrite as bands and lenses in foliation planes 55-60 degrees c.a.</p> <p>552-555-Dark garnet rich sections, distinctly magnetic.</p> <p>555-563-Grey quartz eye rich tuff; approximately 5% quartz crystals 1-2mm size range. Foliated at 60 degrees c.a.</p> <p>563-565-Pale yellow sericitic tuff, trace pyrite.</p>	Traces to conspicuous sericite locally	Highly variable content of pyrite from traces to 10%.	Brecciated with bull quartz veining 514.9-515.3 ft.

**FORT KNOX GOLD RESOURCES INC.**

DRILL LOG -- Drill Program

Hole# NG-2-94 p.5

DEPTH	ROCK TYPE	GRAIN SIZE COLOUR	TEXTURE AND STRUCTURE	ALTERATION	MINERALIZATION	COMMENTS/ SAMPLE NO.
565-567.5	Sheared zone	Medium brown	Sheared, brown biotitic zone; possible dike. Foliation 55 degrees c.a.			
567.5-570.2	Gabbro	Fine to medium grained				
570.2-571.8	Sheared zone	Pale green	Sheared tuff or dike			
571.8-605.7	Sericitic tuff	Pale yellow to grey	Very soft sericite rich section, quite distinct from hard siliceous lapilli-tuff unit above. Well foliated 40-55 degrees c.a.	Sericite, very minor chlorite in slips	Trace pyrite with chloritic slips/foliation surfaces.	WR 577-588 Strongly soda-Na,Ca depleted, K enriched.
605.7-608.3	Sheared zone	Medium brown	Mixed tuff and fine grained dike. Primary textures largely obliterated by shearing.			
608.3-637	Pillow basalt	Medium green	Massive and pillowed sections. Locally flow brecciation e.g. at 613 ft.			
EOH 637						

Fort Knox Gold Resources Inc.

Drilling Analysis / Geo-Chem Analysis

Hole NG-2-94

Page: 1 of 1

Sample Number	From	To	Interval feet	Au PPB	Au/cwt	Ag PPM	Cu PPM	Ni PPM	Pb PPM	Zn PPM	SiO2 %	Al2O %	Fe2O %	CaO %	MgO %	Na2O %	K2O %	TiO2 %	MnO %	P2O5 %	Ba PPM	Sr PPM	Zr PPM	Y PPM	Sc PPM	Nb PPM	Be PPM	Cr PPM	V PPM	Co PPM	Zn PPM	LOI %	Total %	
774047	517.0	522.6	5.6	nil	-	0.1	13	-	25	14																								
774048	522.6	527.0	4.4	nil	-	0.2	14	-	4	43																								
774049	527.0	532.0	5.0	2	3	0.1	17	-	2	36																								
774050	532.0	537.0	5.0	7	-	0.1	23	-	12	27																								
774051	537.0	540.0	3.0	14	-	0.1	31	-	13	146																								
774052	540.0	543.5	3.5	10	-	0.2	86	-	10	53																								
774053	544.6	546.0	1.4	15	-	0.5	77	-	6	27																								
774054	546.0	547.0	1.0	46	48	0.8	189	-	23	36																								
774055	547.0	552.0	5.0	75	75	0.6	37	-	20	41																								
774056	552.0	553.0	1.0	2	-	0.3	18	-	3	30																								
774057	555.0	558.0	3.0	48	-	0.3	34	-	9	35																								
774058	558.0	562.0	4.0	nil	-	0.1	25	-	4	41																								
NG-2-94 23-33							15	40			78.26	11.29	1.81	1.32	0.59	3.64	1.8	0.11	0.04	0.04	440	90	110	28	3	<30	1	1345	60	27.95	50	1.27	100.2	
NG-2-94 77-94							<5	25			75	11.44	1.05	2.18	0.27	2.36	2.66	0.06	0.03	0.04	310	60	70	30	3	<30	2	655	15	5.06	20	2.51	97.61	
NG-2-94 361-371							15	15			76.86	12.75	1.83	0.62	0.52	4.22	2.28	0.08	0.03	0.04	450	40	90	32	4	<30	1	495	20	9.84	5	1.03	100.3	
NG-2-94 577-588							10	45			76.86	13.32	1.71	0.8	0.45	0.42	3.72	0.03	0.03	0.04	460	30	60	26	2	<30	2	800	25	15.02	25	2.28	99.65	

**FORT KNOX GOLD RESOURCES INC.**

Hole#307-1-95

Property: Little Nickel Tshp/County: Fawcett

**Acid Tests**

Claim: 1180186

Coord.: 106+005

Azimuth: 217

Started: Feb. 18/95

96' - 44deg

226' - 44deg

Range: \_\_\_\_\_

L10,300

Dip: -45

Completed: Feb. 24/95

324' - 42deg

: (307 Grid)

Core Size: BQ

Elevation: \_\_\_\_\_

Length: 404'(123.2m)

Logged By: A.D.H.

Sheet No.: 1

Logged by: DOUGLAS HUNTER Douglas Hunter Date logged: Feb. 25, 1995

The borehole collar is located 50 m S and 20 m W of the #1 post.

The hole tested a broad I.P. anomaly, the source of which is an abrupt change in geology: from massive gabbro to pyritic bedded tuff.

Abbreviation:  
QC - Quartz-carbonate



**FORT KNOX GOLD RESOURCES INC.**

DRILL LOG -- Drill Program

Holo# 307-1 p.2

DEPTH	ROCK TYPE	GRAIN SIZE COLOUR	TEXTURE AND STRUCTURE	ALTERATION	MINERALIZATION	COMMENTS/ SAMPLE NO.
0-15	Casing in sand					
15-42	Hybrid-mixed gabbro and anorthositic gabbro (AGb)	Light grey-green	Intrusive breccia; dark mafic fragments set in a medium to coarse grained CLAG rock. Some diabasic textured gabbro fragments. The CLAG is locally porphyritic.		Pyrite is conspicuous mainly as fine grained patchy aggregates and local disseminations. Content tr.-0.1%.	Heterogenous aspect-very similar to host intrusive breccia at the Cu, Ni deposit 1km to the NW.
42-56	Gabbroic section	Medium to dark green.	Massive fine grained diabasic texture with highly siliceous quartz rich zones.	Greyish alterations and local silicification.	Chlotty conspicuous po, py, cpy in several places associated with blue quartz rich zones.	
56-98	Gabbro	Dark green	Massive diabasic textured coarse blocky relict pyroxene from place to place and pyroxene-blue opalescent quartz veinlets/patches. Local fabric-defined by compositional changes and foliation 35-45 degrees c.a.		Trace pyrite in fractures and as fine to medium grained disseminations in quartz-pyroxene veinlets.	A few bull quartz veins e.g. 56.5-56.7' and 59.9-60.1'.
98-108.2	Volcanic or dike	Dark green	Massive fine grained non-descript except locally at 105.3-105.5 where fine lamination/bedding is evident.		Fine pyrite on bedding planes in ash-tuff at 105.3-105.5.	Irregular fracturing with QC veining in several sections over 0.1-0.5 feet.

**FORT KNOX GOLD RESOURCES INC.**

DRILL LOG - Drill Program

Hole # 307-1-95 p.3

DEPTH	ROCK TYPE	GRAIN SIZE COLOUR	TEXTURE AND STRUCTURE	ALTERATION	MINERALIZATION	COMMENTS/ SAMPLE NO.
108.2-216.7	Gabbro	Dark green	Medium grained diabasic textured as from 56-98 feet. Very local hybrid/breccia CLAG-gabbro. A few feldspar-rich veinlets. Massive unfoliated. From 199.5-216.7 patches, veins and dikes of anorthositic gabbro and CLAG (e.g. 179.5-181'). Also, small porphyritic granitic dikelets; one of these is flow banded at 213.3-213.7'.	Minor patchy-fracture controlled epidote.	Trace pyrite with coarse py, cpy at 120'. Minor fracture controlled pyrite not significant content.	A few siliceous feldspar-phyrlic dikes 0.1' wide associated with strong fabric at 35-45 degrees c.a. Fine grained foliated/sheared 213.7 216.7'.
216.7-258.7	Mixed zone of dikes and volcanics	Medium to dark grey to green.	Banded, foliated zone of highly deformed dikes and minor volcanic-looks like a composite intrusion. Gabbroic and anorthositic composition, highly variable grain size. Feldspar grains flattened into foliation at 40-45degrees c.a.	Minor, local fracture controlled epidote.		Generally non-descript although there are some texturally well preserved dikes of CLAG, e.g. 220.1-222.3 and 224.6-226 feet. This zone marks a structure.
258.7-308.3	Gabbro	Medium to dark green	Massive, medium grained diabasic texture as described from 56-98 feet. Veinlets, patches and mixed anorthosite/gabbro sections.			Foliated, fragmental lower contact area from 305.7-308.3 at 65-70 degrees c.a.





**FORT KNOX GOLD RESOURCES INC.**

Hole# 307-2-95

Property: Little Nickel Tshp/County: Fawcett

Acid Tests

Claim: 1180186

Coord.: 106 + 008  
L10, 300

Azimuth: 037 degrees

Started: Feb. 26

Range: \_\_\_\_\_

: 3+50S, 3+25E  
(307 Grid)

Dip: -45

Completed: Feb. 27

Lot: BQ

Elevation: \_\_\_\_\_

Length: 106' (32.3m)

Logged By: A.D.H.

Sheet No.: 1

Logged by: Douglas Hunter Douglas Hunter Date logged: Feb. 27, 1995

The borehole collar is located 50 m S and 20 m W of the #1 post.

This hole tested a narrow strong I.P. response. The hole contains negligible sulphides and the anomaly source is unknown.

**FORT KNOX GOLD RESOURCES INC.**

DRILL LOG -- Drill Program

Hole# 307-2-95 p.2

DEPTH	ROCK TYPE	GRAIN SIZE COLOUR	TEXTURE AND STRUCTURE	ALTERATION	MINERALIZATION	COMMENTS/ SAMPLE NO.
0-13.5	Casing in sand					
13.5-18.6	Gabbro	Dark green.	Fine to medium grained with distinct blocky pyroxene.			
18.6-34.7	CLAG	Medium grey to green.	Fragmental; about 10% fragments of fine grained dark volcanic (?) and fine to medium grained diabasic texture - up to 5 cm in size.		Trace pyrite.	
34.7-40.6	Gabbro	Green.	Medium to coarse grained. Vague to indistinct contacts with CLAG at 39' - 40.6'.			
40.6-44.4	Zone of dikes.		40.6 - 41.3 Siliceous cherty dike or fragment. 41.3 - 42.7 CLAG containing fragments. 42.7 - 44.4 Banded felsic dike; banding at 20-30 degrees c.a.			
44.4-51.9	Gabbro		Conspicuous fragments foliated at 30-45 degrees c.a.			Minor CLAG

**FORT KNOX GOLD RESOURCES INC.**

DRILL LOG -- Drill Program

Hole# 307-2-95 p.3

DEPTH	ROCK TYPE	GRAIN SIZE COLOUR	TEXTURE AND STRUCTURE	ALTERATION	MINERALIZATION	COMMENTS/ SAMPLE NO.
51.9-53.1	Banded felsic dike.	Pale grey to salmon pink.	Coarse grained feldspar rich and cherty grey bands. Banding at 60 degrees c.a.			
53.1-88	Mixed CLAG and Gabbro.		About equals amounts of coarse grained zones (phases) showing both sharp and indistinct gradational contacts. Coarse grained bluish opalescent quartz is salient.			
88-95.5	Breccia Zone.		About 40% fine grained mafic and diabasic textured gabbro fragments set in a quartz-feldspar rich ground mass comprised of CLAG and Gabbro phases and very coarse pegmatitic veinlets.		Traces of pyrite.	
95.5-106	Gabbro.	Dark green.	Coarse grained diabasic texture; massive homogeneous.			
	ROH 106'					





**FORT KNOX GOLD RESOURCES INC.**

Hole#SG-1-95

Property: Little Nickel Tshp/County: Fawcett

**Acid Tests**

Claim: 1180181

Coord.: South Grid

Azimuth: 137

Started: Jan. 10/95

96' - 53deg

216' - 48deg

Range: \_\_\_\_\_

: 1+10E/L00

Dip: -50

Completed: Jan. 18/95

326' - 50deg

436' - 48deg

Core Size: BQ

Elevation: \_\_\_\_\_

Length: 475 feet

Logged By: A.D.H.

Sheet No.: 1

Logged by: DOUGLAS HUNTER Douglas Hunter Date logged Jan. 19, 1995

The borehole collar is located 200 m N and 95 m W of the #2 post.

This hole was drilled to define the known Cu - Ni deposit near the surface.

**Abbreviations:**

PCLAG - Porphyritic Coarse Grained Anorthositic Gabbro

Po - pyrrhotite

Cpy - chalcopyrite

**FORT KNOX GOLD RESOURCES INC.**

DRILL LOG -- Drill Program

Hole# SG-1-95 p.3

DEPTH	ROCK TYPE	GRAIN SIZE COLOUR	TEXTURE AND STRUCTURE	ALTERATION	MINERALIZATION	COMMENTS/ SAMPLE NO.
354-442	Mineralized zone cont'd.		<p>374-387-Diabasic textured, medium grained gabbro. Coarser grained with blue quartz grains and minor (0.5%) disseminated sulphide.</p> <p>387-396.6-Net texture sulphide breccia as from 365.3-374 feet. This interval is po and cpy rich. Total sulphide is 25-40% by volume. Characteristic feature is blocky relict pyroxene crystals and mafic fragments-some containing blue quartz.</p> <p>396.6-407.5-Mafic dikes; both coarse diabasic gabbro/anorthosite and dark green grey fine grained dike material.</p> <p>407.5-419.5-As described from 387-396.6 feet. Total sulphide 35 to 50%.</p> <p>419.5-442-Mixed pyroxenite, diabasic textured gabbro and net-textured sulphide sections- commonly 0.5 to 2 feet. Sulphide content variable; a few % to 20%. Locally Cpy rich.</p>			
442-475	PCLAG		<p>As described at the top of the hole-80-141.8 feet. Quartz veins 444.9-445.4 and in a altered sheared section from 454.6-456.2 feet. Here foliation is 40-45 degrees c.a.</p>			The host rock anorthositic gabbro is characteristically porphyritic on the south side of the sulphide zone.
475 EOH						

**FORT KNOX GOLD RESOURCES INC.**

DRILL LOG -- Drill Program

Hole# SG-1-95 p.2

DEPTH	ROCK TYPE	GRAIN SIZE COLOUR	TEXTURE AND STRUCTURE	ALTERATION	MINERALIZATION	COMMENTS/ SAMPLE NO.
0-80	Casing in gravel and sand					
80-141.8	PCLAG	Medium grey	Porphyritic, blocky feldspar crystals-1mm to 2cm size range (seriate-texture). Common or average grain size 2-4mm. Ground mass texture varies from fine grained to fine grained porphyritic-very heterogenous appearance.		Traces of pyrite.	Negligible sulphide quartz veining at 128.2-128.6.
141.8-193	PCLAG	Medium grey	Massive porphyritic section, much finer grained than section from 80-141.8 feet.			Massive
193-354	PCLAG	Medium grey	As from 80-141.8. Dike from 274.3-276.2; grey speckled-intermediate composition. Also, mafic feldspar-phyric dike at 336.2-336.7 feet. Contacts at 55 degrees c.a.			1% quartz epidote and quartz fracture fillings (1-2mm). From 261-261.5 altered section with milky quartz veining at 40-50 degrees c.a.
354-442	Mineralized zone		354-365.3-Mixed gabbro and proxenite. Brecciated appearance; sulphide-rich intrudes diabasic textured gabbro. 365.3-374-Net textured sulphides and breccia. Po-rich section with 25% total sulphide. Cpy rich over short sections where this sulphide is conspicuous in fractures.		Very local net textured po-rich sulphides.	

# Fort Knox Gold Resources Inc.

Drilling Analysis / Geo-Chem Analysis

Hole: SG-1-95

Page: 1 of 1

Sample #	From	To	Interval feet			Cu PPM	Ni PPM		
FX-774401	354.0	355.2	1.2			3860	12300		
FX-774402	355.2	358.3	3.1			570	1090		
FX-774403	358.3	362.5	4.2			2300	3060		
FX-774404	362.5	365.3	2.8			1030	2820		
FX-774405	365.3	370.4	5.1			5940	13100		
FX-774406	370.4	374.0	3.6			5660	13400		
FX-774407	374.0	379.0	5.0			401	178		
FX-774408	379.0	382.0	3.0			141	100		
FX-774409	382.0	385.1	3.1			186	98		
FX-774410	385.1	387.0	1.9			959	539		
FX-774411	387.0	392.0	5.0			2460	18100		
FX-774412	392.0	396.6	4.6			6440	13500		
FX-774413	396.6	400.3	3.7			542	195		
FX-774414	400.3	405.5	5.2			113	124		
FX-774415	405.5	407.5	2.0			2200	3040		
FX-774416	407.5	411.7	4.2			8220	12100		
FX-774417	411.7	416.1	4.4			2730	26600		
FX-774418	416.1	419.5	3.4			3310	13900		
FX-774419	419.5	420.8	1.3			2080	3280		
FX-774420	420.8	426.0	5.2			2790	8510		
FX-774421	426.0	431.0	5.0			3450	12000		
FX-774422	431.0	434.9	3.9			1630	5470		
FX-774423	434.9	436.0	1.1			590	2410		
FX-774424	436.0	440.0	4.0			6760	11300		
FX-774425	440.0	442.0	2.0			1500	3770		

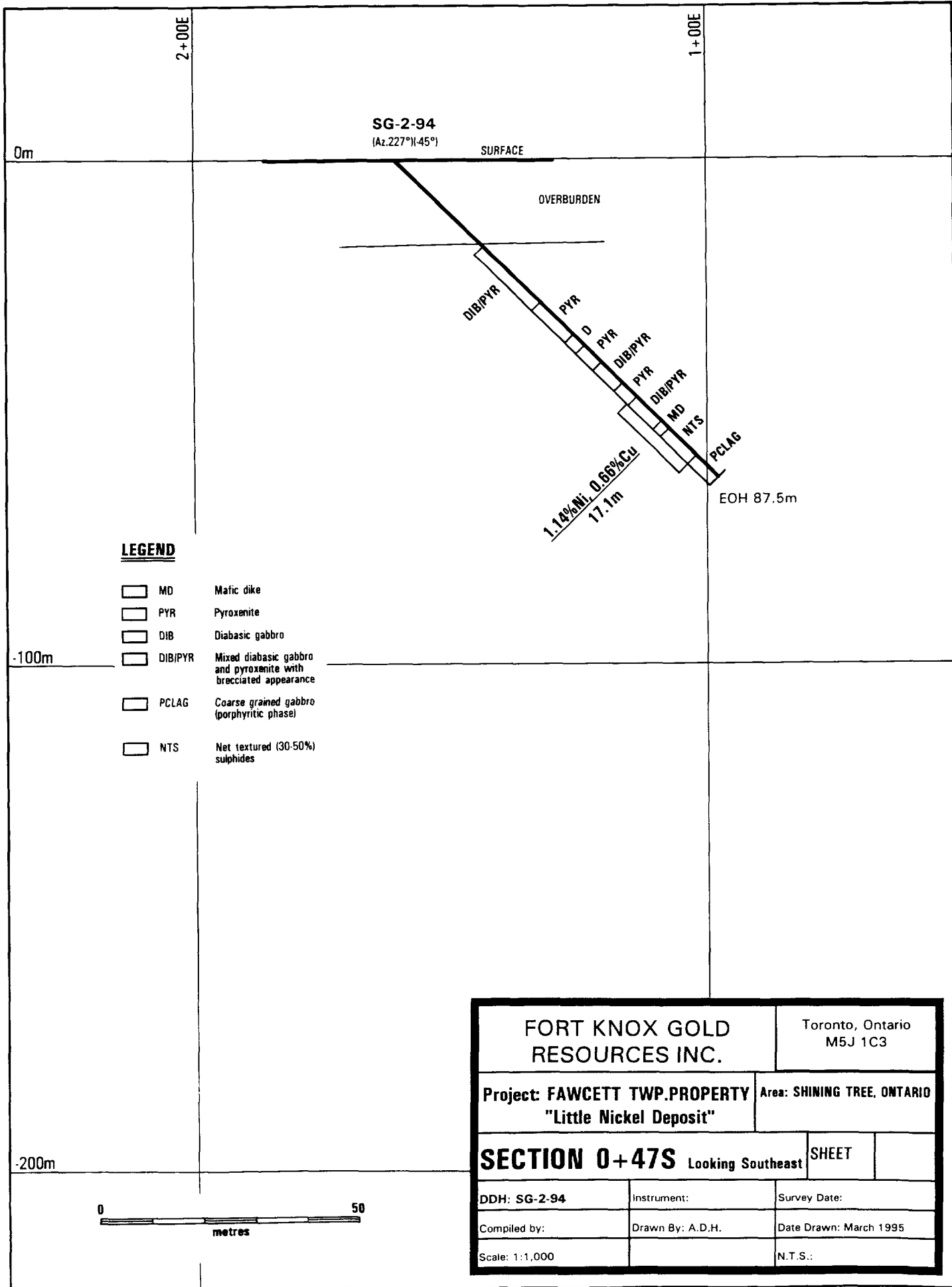

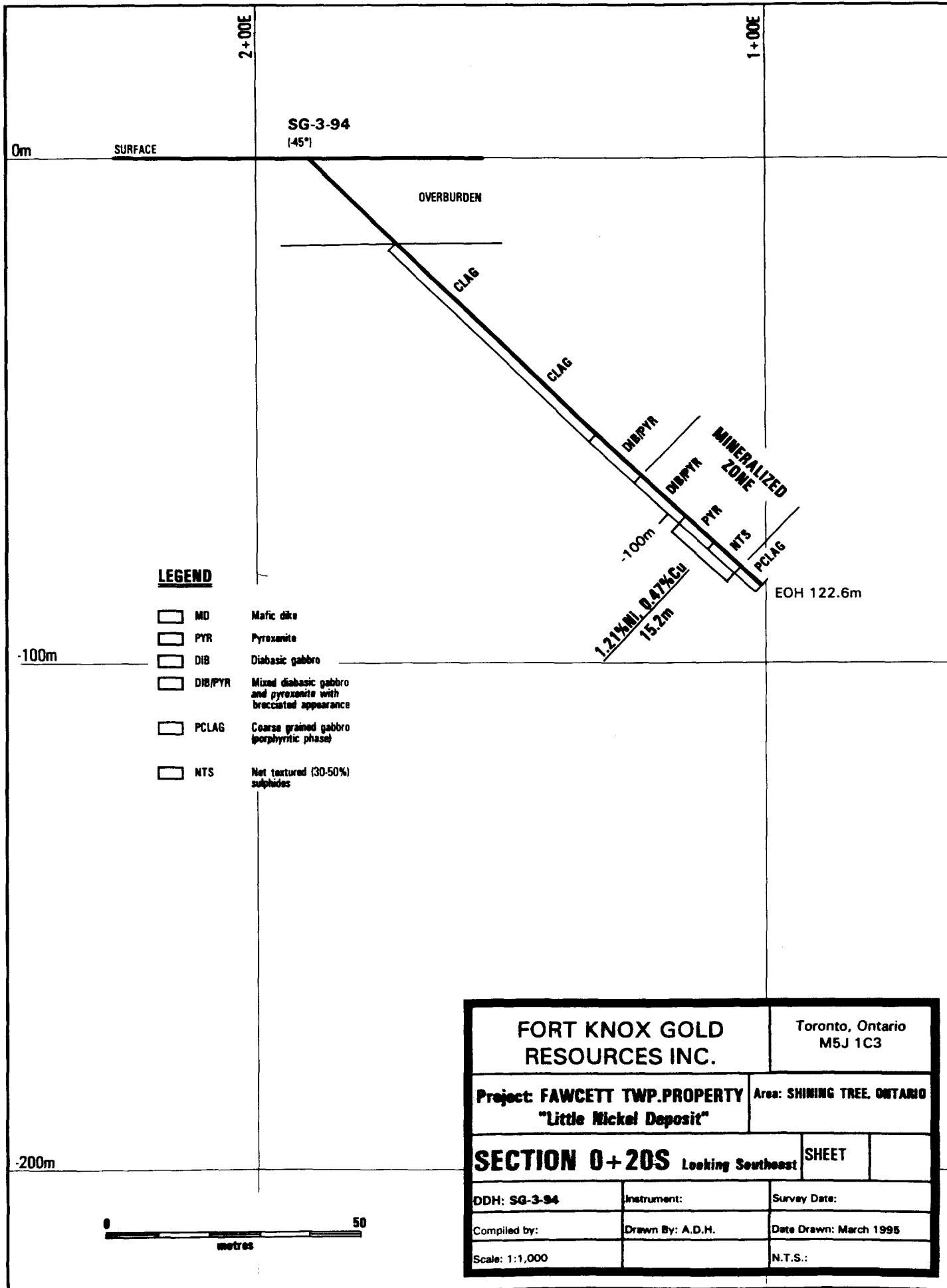

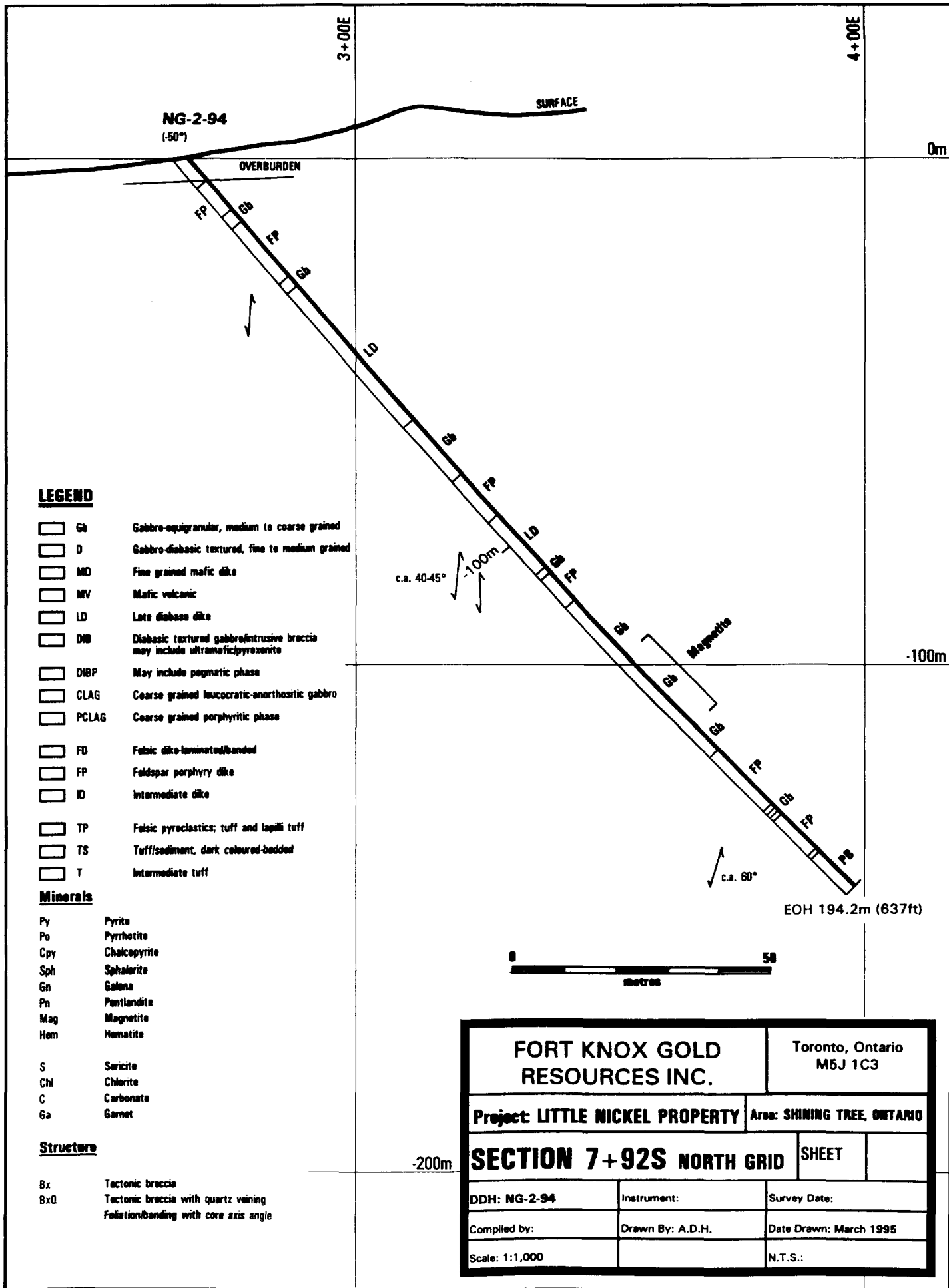

<b>FORT KNOX GOLD RESOURCES INC.</b>		Toronto, Ontario M5J 1C3	
Project: <b>LITTLE NICKEL PROPERTY</b>		Area: <b>SHINING TREE, ONTARIO</b>	
<b>SECTION 7+92S NORTH GRID</b>			<b>SHEET</b>
DDH: <b>NG-2-94</b>	Instrument:	Survey Date:	
Compiled by:	Drawn By: <b>A.D.H.</b>	Date Drawn: <b>March 1995</b>	
Scale: <b>1:1,000</b>		N.T.S.:	





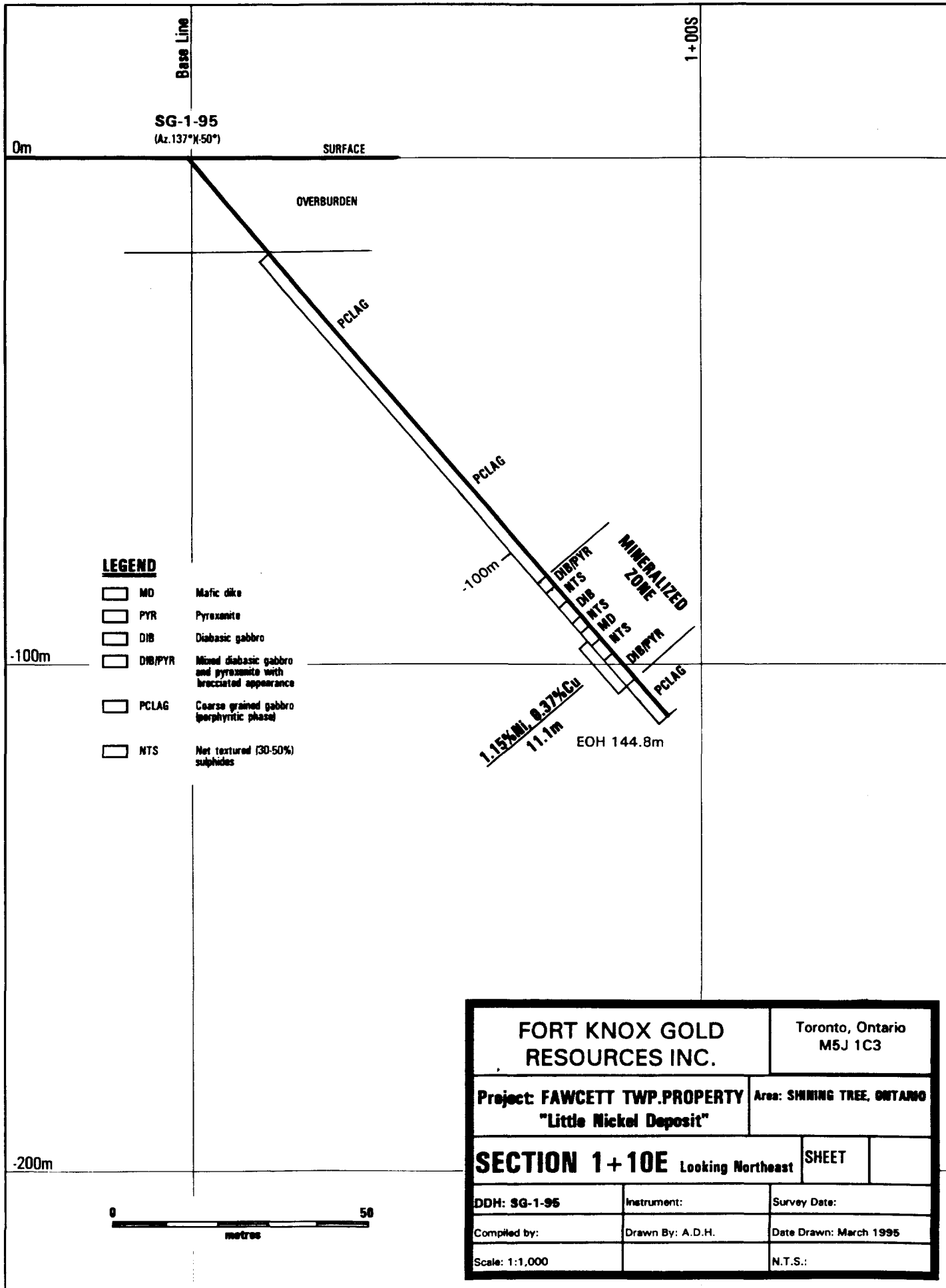



# Swastika Laboratories

A Division of TSL/Assayers Inc.

Established 1928

Assaying - Consulting - Representation

Page 1 of 4

## Geochemical Analysis Certificate

4W-2953-RG1

Company: **FORT KNOX GOLD RESOURCES INC**

Date: NOV-21-94

Project:

Attn: D. Hunter / D. Humby

We hereby certify the following Geochemical Analysis of 94 Split Core samples submitted NOV-16-94 by .

Sample Number	Au PPB	Au Check PPB	Ag PPM	Cu PPM	Ni PPM	Pb PPM	Zn PPM	Pd PPB
H-8952	3	3	0.1	67	45	-	-	<2
H-8953	Nil	-	0.2	104	83	28	100	-
H-8954	Nil	-	0.1	55	41	-	-	<2
H-8956	3	-	-	61	38	-	-	<2
H-8957	Nil	-	-	75	46	-	-	<2
H-8958	2	-	-	153	42	-	-	<2
H-8959	Nil	-	-	207	55	-	-	<2
H-8960	Nil	-	-	70	36	-	-	3
H-8961	7	-	-	157	53	-	-	<2
H-8962	Nil	-	0.1	518	47	1	71	<2
H-8963	Nil	-	0.1	342	43	4	61	-
H-8964	Nil	-	0.1	100	36	-	-	<2
H-8965	7	5	0.1	17	35	-	-	<2
H-8966	Nil	-	0.1	19	44	-	-	<2
H-8967	Nil	-	0.1	91	30	-	-	3
H-8968	Nil	-	0.1	159	46	-	-	-
H-8969	Nil	-	0.1	53	-	1	54	-
H-8970	24	17	0.1	538	-	1	54	-
H-8971	Nil	-	0.1	232	-	27	68	-
H-8972	Nil	-	0.1	85	-	161	75	-
H-8973	Nil	-	0.1	40	-	710	400	-
H-8974	Nil	-	0.1	62	-	109	117	-
H-8975	Nil	-	0.2	104	-	137	119	-
H-8976	Nil	-	0.1	64	-	570	190	-
H-8977	Nil	Nil	0.1	57	-	88	149	-
H-8978	Nil	-	0.8	63	-	660	218	-
H-8979	3	-	0.1	80	-	260	112	-
H-8980	Nil	-	0.1	270	-	21	101	-
H-8981	Nil	-	0.1	370	-	6	91	-
H-8982	Nil	-	0.2	323	-	24	173	-

One assay ton portion used.

Certified by

P.O. Box 10, Swastika, Ontario P0K 1T0

Telephone (705) 642-3244

FAX (705) 642-3300



# Swastika Laboratories

A Division of TSL/Assayers Inc.

Established 1928

Assaying - Consulting - Representation

Page 2 of 4

## Geochemical Analysis Certificate

4W-2953-RG1

Company: **FORT KNOX GOLD RESOURCES INC**

Date: NOV-21-94

Project:

Attn: D. Hunter / D. Humby

We hereby certify the following Geochemical Analysis of 94 Split Core samples submitted NOV-16-94 by .

Sample Number	Au PPB	Au Check PPB	Ag PPM	Cu PPM	Ni PPM	Pb PPM	Zn PPM	Pd PPB
H-8983	21	27	0.1	58	-	4	45	-
H-8984	5	-	-	116	38	-	-	2
H-8985	Nil	-	-	114	34	-	-	<2
H-8986	Nil	Nil	-	145	27	-	-	2
H-8987	Nil	-	-	215	32	-	-	<2
H-8988	Nil	-	-	103	358	-	-	<2
H-8989	Nil	-	-	8	45	1	62	<2
H-8990	Nil	-	-	14	30	-	-	<2
H-8991	Nil	-	-	24	22	-	-	<2
H-8992	Nil	-	-	47	23	-	-	<2
H-8993	Nil	-	-	39	21	-	-	<2
H-8994	Nil	-	-	61	18	-	-	<2
H-8995	7	3	-	77	14	-	-	2
H-8996	Nil	-	-	145	27	-	-	3
H-8997	Nil	-	-	80	23	-	-	<2
H-8998	Nil	-	-	28	22	-	-	<2
H-8999	Nil	-	-	65	24	-	-	<2
H-9000	3	-	-	197	22	-	-	<2
FX-774001	Nil	-	-	114	20	-	-	2
FX-774002	Nil	-	-	130	18	-	-	<2
FX-774003	3	5	-	151	18	-	-	<2
FX-774004	5	-	-	122	22	-	-	3
FX-774005	Nil	-	-	178	19	-	-	2
FX-774006	Nil	-	-	84	47	-	-	<2
FX-774007	Nil	Nil	-	1220	88	-	-	7
FX-774008	Nil	-	-	121	17	-	-	<2
FX-774009	Nil	-	-	120	19	-	-	2
FX-774010	Nil	-	-	103	17	-	-	2
FX-774011	Nil	-	-	94	14	-	-	<2
FX-774012	Nil	-	-	64	17	-	-	<2

One assay ton portion used.

Certified by

P.O. Box 10, Swastika, Ontario P0K 1T0

Telephone (705) 642-3244

FAX (705) 642-3300



# Swastika Laboratories

A Division of TSL/Assayers Inc.

Established 1928

Assaying - Consulting - Representation

Page 3 of 4

## Geochemical Analysis Certificate

4W-2953-RG1

Company: **FORT KNOX GOLD RESOURCES INC**

Date: NOV-21-94

Project:

Attn: D. Hunter / D. Humby

We hereby certify the following Geochemical Analysis of 94 Split Core samples submitted NOV-16-94 by .

Sample Number	Au PPB	Au Check PPB	Ag PPM	Cu PPM	Ni PPM	Pb PPM	Zn PPM	Pd PPB
FX-774013	Ni 1	-	-	545	26	-	-	9
FX-774014	5	-	-	238	21	-	-	2
FX-774015	Ni 1	-	-	462	20	-	-	<2
FX-774016	Ni 1	Ni 1	-	58	16	-	-	2
FX-774017	Ni 1	-	-	195	27	-	-	<2
FX-774018	Ni 1	-	-	83	28	-	-	<2
FX-774019	Ni 1	-	-	426	22	-	-	2
FX-774020	Ni 1	-	-	62	14	-	-	<2
FX-774021	Ni 1	-	-	29	21	-	-	<2
FX-774022	Ni 1	-	-	35	13	-	-	7
FX-774023	Ni 1	-	-	46	11	-	-	<2
FX-774024	Ni 1	-	-	56	12	-	-	<2
FX-774025	5	9	-	48	11	-	-	<2
FX-774026	10	-	-	211	58	-	-	<2
FX-774027	10	12	-	232	54	-	-	<2
FX-774028	Ni 1	-	-	142	46	-	-	3
FX-774029	Ni 1	-	-	158	43	-	-	<2
FX-774030	Ni 1	-	-	134	44	-	-	<2
FX-774031	Ni 1	-	-	116	16	-	-	<2
FX-774032	Ni 1	-	-	250	23	-	-	3
FX-774033	2	-	-	127	19	-	-	<2
FX-774034	Ni 1	-	-	64	19	-	-	<2
FX-774035	14	-	-	446	24	-	-	<2
FX-774036	22	17	-	573	49	-	-	2
FX-774037	26	31	-	254	35	-	-	<2
FX-774038	Ni 1	-	-	61	79	-	-	<2
FX-774039	Ni 1	-	-	91	19	-	-	3
FX-774040	Ni 1	-	-	369	42	-	-	<2
FX-774041	Ni 1	-	-	103	90	-	-	<2
FX-774042	Ni 1	-	-	80	82	-	-	<2

One assay ton portion used.

Certified by 



# Swastika Laboratories

A Division of TSL/Assayers Inc.

Established 1928

Assaying - Consulting - Representation

Page 4 of 4

## Geochemical Analysis Certificate

4W-2953-RG1

Company: **FORT KNOX GOLD RESOURCES INC**

Date: NOV-21-94

Project:

Attn: D. Hunter / D. Humby

We hereby certify the following Geochemical Analysis of 94 Split Core samples submitted NOV-16-94 by .

Sample Number	Au PPB	Au Check PPB	Ag PPM	Cu PPM	Ni PPM	Pb PPM	Zn PPM	Pd PPB
FX-774043	Ni 1	-	-	111	95	-	-	2
FX-774044	Ni 1	-	-	94	90	-	-	2
FX-774045	15	12	-	132	100	-	-	2
FX-774046	9	-	-	134	71	-	-	<2

One assay ton portion used.

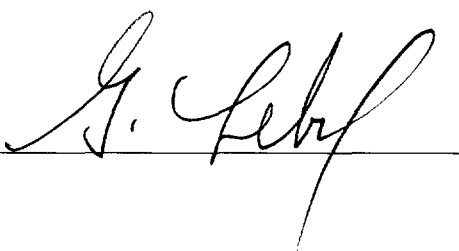
Certified by 



# Swastika Laboratories

A Division of TSL/Assayers Inc.

Established 1928

Assaying - Consulting - Representation

Page 1 of 3

## Geochemical Analysis Certificate

4W-4229-RG1

Company: **FORT KNOX GOLD RESOURCES INC**

Date: DEC-30-94

Project:

Attn: **D. Hunter/D. Humby**

We hereby certify the following Geochemical Analysis of 62 Core samples submitted DEC-20-94 by .

862-70

Sample Number	Au PPB	Au Check PPB	Cu PPM	Ni PPM	Pt PPB	Pd PPB
FX-774201	Nil	-	53	91	<10	5
FX-774202	26	31	1020	3140	38	60
FX-774203	14	-	922	1090	<10	26
FX-774204	Nil	-	1000	2860	15	45
FX-774205	2	-	446	547	<10	7
FX-774206	Nil	-	873	1230	12	22
FX-774207	Nil	Nil	856	994	14	24
FX-774208	Nil	-	454	492	<10	15
FX-774209	9	-	446	500	<10	14
FX-774210	Nil	-	433	710	<10	19
FX-774211	Nil	-	348	540	34	17
FX-774212	39	-	1050	1110	<10	27
FX-774213	5	-	1740	2700	70	50
FX-774214	Nil	-	1100	1760	41	41
FX-774215	43	-	1910	2480	75	51
FX-774216	33	-	3160	5600	103	91
FX-774217	77	-	4280	8620	159	137
FX-774218	108	105	5470	7500	130	118
FX-774219	81	-	3540	9040	183	129
FX-774220	72	62	3960	8680	155	145
FX-774221	12	-	2000	6440	154	106
FX-774222	60	41	6300	5720	159	99
FX-774223	51	-	3540	6740	156	117
FX-774224	34	-	3020	5160	89	84
FX-774225	63	-	3600	3280	101	63
FX-774226	69	-	4810	3760	98	67
FX-774227	57	62	5100	4480	223	108
FX-774228	3	-	1970	5220	82	89
FX-774229	Nil	-	491	646	22	15
FX-774230	21	-	2080	4200	74	72

One assay ton portion used.

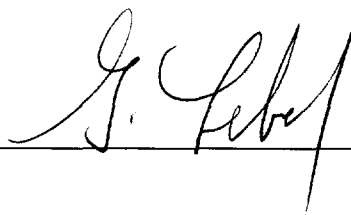
Certified by 



# Swastika Laboratories

A Division of TSL/Assayers Inc.

Established 1928

Assaying - Consulting - Representation

Page 2 of 3

## Geochemical Analysis Certificate

4W-4229-RG1

Company: **FORT KNOX GOLD RESOURCES INC**

Date: DEC-30-94

Project:

Attn: D. Hunter/D. Humby

We hereby certify the following Geochemical Analysis of 62 Core samples submitted DEC-20-94 by .

Sample Number	Au PPB	Au Check PPB	Cu PPM	Ni PPM	Pt PPB	Pd PPB
FX-774231	57	65	2320	4650	100	77
FX-774232	Ni 1	-	178	489	<10	<2
FX-774233	Ni 1	-	244	751	<10	<2
FX-774234	72	-	3020	4480	31	67
FX-774235	14	-	1780	4300	67	60
FX-774236	31	-	2020	3560	72	58
FX-774237	123	165	6400	8380	170	120
FX-774238	55	-	3400	4500	53	70
FX-774239	31	-	1820	3500	19	51
FX-774240	3	-	633	902	<10	19
FX-774241	Ni 1	-	286	436	<10	7
FX-774242	34	-	205	544	<10	<2
FX-774243	5	-	1050	2020	7	27
FX-774244	43	-	2620	2440	26	43
FX-774245	58	53	3320	6920	58	78
FX-774246	137	151	8360	5640	151	91
FX-774247	155	-	8510	8120	167	113
FX-774248	81	-	4900	9820	166	108
FX-774249	Ni 1	-	161	241	<10	2
FX-774250	Ni 1	-	60	227	<10	<2
FX-774251	120	-	6860	16900	305	230
FX-774252	89	-	8170	22400	401	237
FX-774253	99	-	8170	22800	415	185
FX-774254	225	-	8840	24400	401	243
FX-774255	158	-	9200	23700	449	213
FX-774256	93	-	10700	18900	336	233
FX-774257	250	309	16400	21200	374	233
FX-774258	216	-	15400	18100	432	192
FX-774259	199	-	14100	19600	374	195
FX-774260	Ni 1	-	258	384	<10	7

One assay ton portion used.

Certified by 

P.O. Box 10, Swastika, Ontario P0K 1T0

Telephone (705) 642-3244

FAX (705) 642-3300



Established 1928

# Swastika Laboratories

A Division of TSL/Assayers Inc.

Assaying - Consulting - Representation

Page 3 of 3

4W-4229-RG1

## Geochemical Analysis Certificate

Company: **FORT KNOX GOLD RESOURCES INC**

Date: DEC-30-94

Project:

Attn: D. Hunter/D. Humby

We hereby certify the following Geochemical Analysis of 62 Core samples submitted DEC-20-94 by .

Sample Number	Au PPB	Au Check PPB	Cu PPM	Ni PPM	Pt PPB	Pd PPB
FX-774261	Nil	-	115	185	<10	9
FX-774262	Nil	-	102	141	<10	<2

One assay ton portion used.

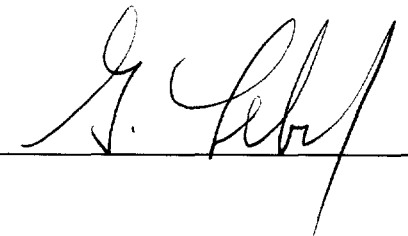
Certified by 

P.O. Box 10, Swastika, Ontario P0K 1T0

Telephone (705) 642-3244

FAX (705) 642-3300





Established 1928

# Swastika Laboratories

A Division of TSL/Assayers Inc.

Assaying - Consulting - Representation

Page 1 of 2

## Geochemical Analysis Certificate

4W-4227-RG1

Company: **FORT KNOX GOLD RESOURCES INC**

Date: DEC-30-94

Project:

Attn: D. Humby/ D. Hunter

We hereby certify the following Geochemical Analysis of 43 Core samples submitted DEC-20-94 by .

*209 1-94*

Sample Number	Au PPB	Au Check PPB	Ag PPM	Cu PPM	Pb PPM	Zn PPM
FX-774059	Nil	-	0.2	30	152	106
FX-774060	Nil	-	0.5	81	581	1640
FX-774061	130	103	0.5	100	233	462
FX-774062	Nil	-	2.7	133	438	1100
FX-774063	3	-	0.6	112	36	450
FX-774064	Nil	-	0.3	151	15	827
FX-774065	7	10	1.1	912	50	1720
FX-774066	Nil	-	0.3	149	29	405
FX-774067	10	-	0.6	252	30	974
FX-774068	14	-	0.1	59	12	276
FX-774069	7	-	0.2	16	8	72
FX-774070	3	-	0.3	85	7	281
FX-774071	Nil	-	0.4	224	5	232
FX-774072	7	-	0.2	36	15	61
FX-774073	3	-	0.5	113	12	210
FX-774074	Nil	-	0.1	116	5	107
FX-774075	7	-	0.4	118	1	109
FX-774076	151	144	0.8	227	35	1510
FX-774077	14	-	0.1	218	1	91
FX-774078	Nil	-	0.1	133	4	59
FX-774079	Nil	-	1.1	136	1900	3110
FX-774080	3	-	1.0	281	4420	875
FX-774081	3	-	1.3	147	2000	2100
FX-774082	Nil	-	0.8	158	87	960
FX-774083	Nil	-	0.8	47	90	298
FX-774084	Nil	-	0.4	86	55	255
FX-774085	10	17	3.2	408	320	2680
FX-774086	Nil	-	0.6	45	23	131
FX-774087	7	-	0.3	30	21	84
FX-774088	10	-	0.4	41	15	165

Certified by



# Swastika Laboratories

A Division of TSL/Assayers Inc.

Assaying - Consulting - Representation

Established 1928

Page 2 of 2

## Geochemical Analysis Certificate

4W-4227-RG1

Company: **FORT KNOX GOLD RESOURCES INC**

Date: DEC-30-94

Project:

Attn: D. Humby/ D. Hunter

We hereby certify the following Geochemical Analysis of 43 Core samples submitted DEC-20-94 by .

Sample Number	Au PPB	Au Check PPB	Ag PPM	Cu PPM	Pb PPM	Zn PPM
FX-774089	3	-	0.4	66	11	126
FX-774090	10	-	0.1	6	1	25
FX-774091	Nil	-	0.2	27	1	79
FX-774092	7	-	0.2	85	2	146
FX-774093	Nil	-	0.2	96	20	361
FX-774094	14	10	1.4	192	48	1530
FX-774095	Nil	-	0.5	64	20	149
FX-774096	3	-	0.3	45	150	415
FX-774097	Nil	-	0.3	44	10	119
FX-774098	3	-	0.4	51	9	42
FX-774099	10	-	0.3	81	16	376
FX-774100	14	-	0.1	105	1	74
FX-774101	3	-	0.1	114	1	45

Certified by



Established 1928

# Swastika Laboratories

A Division of TSL/Assayers Inc.

Assaying - Consulting - Representation

Page 1 of 3

4W-4229-RG1

## Geochemical Analysis Certificate

Company: **FORT KNOX GOLD RESOURCES INC**

Date: DEC-30-94

Project:

Attn: **D. Hunter/D. Humby**

We hereby certify the following Geochemical Analysis of 62 Core samples submitted DEC-20-94 by .

Sample Number	Au PPB	Au Check PPB	Co PPM	Cu PPM	Ni PPM	Pt PPB	Pd PPB
FX-774201	Nil	-	16	53	91	<10	5
FX-774202	26	31	122	1020	3140	38	60
FX-774203	14	-	64	922	1090	<10	26
FX-774204	Nil	-	114	1000	2860	15	45
FX-774205	2	-	62	446	547	<10	7
FX-774206	Nil	-	78	873	1230	12	22
FX-774207	Nil	Nil	68	856	994	14	24
FX-774208	Nil	-	87	454	492	<10	15
FX-774209	9	-	43	446	500	<10	14
FX-774210	Nil	-	46	433	710	<10	19
FX-774211	Nil	-	41	348	540	34	17
FX-774212	39	-	53	1050	1110	<10	27
FX-774213	5	-	124	1740	2700	70	50
FX-774214	Nil	-	90	1100	1760	41	41
FX-774215	43	-	104	1910	2480	75	51
FX-774216	33	-	189	3160	5600	103	91
FX-774217	77	-	278	4280	8620	159	137
FX-774218	108	105	199	5470	7500	130	118
FX-774219	81	-	289	3540	9040	183	129
FX-774220	72	62	338	3960	8680	155	145
FX-774221	12	-	230	2000	6440	154	106
FX-774222	60	41	220	6300	5720	159	99
FX-774223	51	-	218	3540	6740	156	117
FX-774224	34	-	189	3020	5160	89	84
FX-774225	63	-	115	3600	3280	101	63
FX-774226	69	-	200	4810	3760	98	67
FX-774227	57	62	184	5100	4480	223	108
FX-774228	3	-	201	1970	5220	82	89
FX-774229	Nil	-	48	491	646	22	15
FX-774230	21	-	162	2080	4200	74	72

One assay ton portion used.

Certified by

P.O. Box 10, Swastika, Ontario P0K 1T0

Telephone (705) 642-3244

FAX (705) 642-3300



Established 1928

# Swastika Laboratories

A Division of TSL/Assayers Inc.

Assaying - Consulting - Representation

Page 2 of 3

4W-4229-RG1

## Geochemical Analysis Certificate

Company: **FORT KNOX GOLD RESOURCES INC**

Date: DEC-30-94

Project:

Attn: **D. Hunter/D. Humby**

We hereby certify the following Geochemical Analysis of 62 Core samples submitted DEC-20-94 by .

Sample Number	Au PPB	Au Check PPB	Co PPM	Cu PPM	Ni PPM	Pt PPB	Pd PPB
FX-774231	57	65	188	2320	4650	100	77
FX-774232	Nil	-	35	178	489	<10	<2
FX-774233	Nil	-	57	244	751	<10	<2
FX-774234	72	-	142	3020	4480	31	67
FX-774235	14	-	175	1780	4300	67	60
FX-774236	31	-	146	2020	3560	72	58
FX-774237	123	165	338	6400	8380	170	120
FX-774238	55	-	176	3400	4500	53	70
FX-774239	31	-	128	1820	3500	19	51
FX-774240	3	-	65	633	902	<10	19
FX-774241	Nil	-	33	286	436	<10	7
FX-774242	34	-	37	205	544	<10	<2
FX-774243	5	-	85	1050	2020	7	27
FX-774244	43	-	78	2620	2440	26	43
FX-774245	58	53	267	3320	6920	58	78
FX-774246	137	151	232	8360	5640	151	91
FX-774247	155	-	282	8510	8120	167	113
FX-774248	81	-	327	4900	9820	166	108
FX-774249	Nil	-	18	161	241	<10	2
FX-774250	Nil	-	12	60	227	<10	<2
FX-774251	120	-	638	6860	16900	305	230
FX-774252	89	-	663	8170	22400	401	237
FX-774253	99	-	684	8170	22800	415	185
FX-774254	225	-	760	8840	24400	401	243
FX-774255	158	-	719	9200	23700	449	213
FX-774256	93	-	558	10700	18900	336	233
FX-774257	250	309	530	16400	21200	374	233
FX-774258	216	-	621	15400	18100	432	192
FX-774259	199	-	607	14100	19600	374	195
FX-774260	Nil	-	38	258	384	<10	7

One assay ton portion used.

Certified by

P.O. Box 10, Swastika, Ontario P0K 1T0

Telephone (705) 642-3244

FAX (705) 642-3300



Established 1928

# Swastika Laboratories

A Division of TSL/Assayers Inc.

Assaying - Consulting - Representation

Page 3 of 3

## Geochemical Analysis Certificate

4W-4229-RG1

Company: **FORT KNOX GOLD RESOURCES INC**

Date: DEC-30-94

Project:

Attn: **D. Hunter/D. Humby**

*We hereby certify* the following Geochemical Analysis of 62 Core samples submitted DEC-20-94 by .

Sample Number	Au PPB	Au Check PPB	Co PPM	Cu PPM	Ni PPM	Pt PPB	Pd PPB
FX-774261	Ni 1	-	26	115	185	<10	9
FX-774262	Ni 1	-	16	102	141	<10	<2

One assay ton portion used.

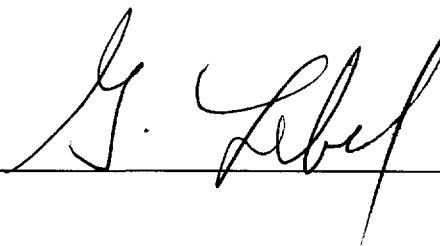
Certified by 

P.O. Box 10, Swastika, Ontario P0K 1T0  
Telephone (705) 642-3244 FAX (705) 642-3300



Established 1928

# Swastika Laboratories

A Division of TSL/Assayers Inc.

Assaying - Consulting - Representation

Page 1 of 2

4W-4251-RG1

## Geochemical Analysis Certificate

Company: **FORT KNOX GOLD RESOURCES INC**

Date: JAN-10-95

Project:

Attn: **D. Hunter/D. Humby**

We hereby certify the following Geochemical Analysis of 39 Core samples submitted DEC-29-94 by .

Sample Number	Au PPB	Au Check PPB	Ag PPM	Cu PPM	Ni PPM	Pb PPM	Zn PPM	Pd PPB	Pt PPB
774047	Nil	-	0.1	13	-	25	14	-	-
774048	Nil	-	0.2	14	-	4	43	-	-
774049	2	3	0.1	17	-	2	36	-	-
774050	7	-	0.1	23	-	12	27	-	-
774051	14	-	0.1	31	-	13	146	-	-
774052	10	-	0.2	86	-	10	53	-	-
774053	15	-	0.5	77	-	6	27	-	-
774054	46	48	0.8	189	-	23	36	-	-
774055	75	75	0.6	37	-	20	41	-	-
774056	2	-	0.3	18	-	3	50	-	-
774057	48	-	0.3	34	-	9	35	-	-
774058	Nil	-	0.1	25	-	4	41	-	-
774263	2	-	-	222	173	-	-	12	<10
774264	3	-	-	255	301	-	-	24	<10
774265	5	-	-	518	666	-	-	26	<10
774266	26	-	-	561	2310	-	-	34	<10
774267	41	43	-	1580	1090	-	-	21	<10
774268	153	110	-	1440	1000	-	-	30	<10
774269	45	-	-	3580	3810	-	-	75	130
774270	27	-	-	3570	18500	-	-	300	162
774271	34	-	-	2310	5580	-	-	96	112
774272	21	-	-	1880	4620	-	-	43	101
774273	21	-	-	2170	6000	-	-	76	75
774274	10	-	-	2050	9520	-	-	106	129
774275	45	-	-	2750	8980	-	-	111	85
774276	51	-	-	4320	7720	-	-	101	238
774277	69	-	-	4430	10600	-	-	108	180
774278	31	-	-	2470	9860	-	-	123	187
774279	96	-	-	4760	6940	-	-	111	167
774280	165	185	-	9670	17000	-	-	211	276

One assay ton portion used.

Certified by

P.O. Box 10, Swastika, Ontario P0K 1T0

Telephone (705) 642-3244

FAX (705) 642-3300



Established 1928

# Swastika Laboratories

A Division of TSL/Assayers Inc.

Assaying - Consulting - Representation

Page 2 of 2

4W-4251-RG1

## Geochemical Analysis Certificate

Company: **FORT KNOX GOLD RESOURCES INC**

Date: JAN-10-95

Project:

Attn: D. Hunter/D. Humby

We hereby certify the following Geochemical Analysis of 39 Core samples submitted DEC-29-94 by .

Sample Number	Au Au Check	Ag	Cu	Ni	Pb	Zn	Pd	Pt
	PPB PPB	PPM	PPM	PPM	PPM	PPM	PPB	PPB
774281	89 -	-	4730	24400	-	-	320	434
774282	82 -	-	3710	23200	-	-	270	405
774283	223 336	-	11400	18200	-	-	332	402
774284	185 -	-	10400	16300	-	-	223	343
774285	144 -	-	7840	14300	-	-	165	249
774286	210 -	-	5280	14700	-	-	176	295
774287	168 -	-	6720	12700	-	-	189	247
774288	65 -	-	1960	10400	-	-	129	218
774289	45 -	-	697	546	-	-	24	55

One assay ton portion used.

Certified by



Established 1928

# Swastika Laboratories

A Division of TSL/Assayers Inc.

Assaying - Consulting - Representation

Page 1 of 2

## Geochemical Analysis Certificate

4W-4251-RG1

Company: **FORT KNOX GOLD RESOURCES INC**

Date: JAN-25-95

Project:

Attn: D. Hunter/D. Humby

We hereby certify the following Geochemical Analysis of 39 Core samples submitted DEC-29-94 by .

Sample Number	Au PPB	Au Check PPB	Ag PPM	Co PPM	Cu PPM	Ni PPM	Pb PPM	Zn PPM	Pd PPB	Pt PPB
774047	Nil	-	0.1	-	13	-	25	14	-	-
774048	Nil	-	0.2	-	14	-	4	43	-	-
774049	2	3	0.1	-	17	-	2	36	-	-
774050	7	-	0.1	-	23	-	12	27	-	-
774051	14	-	0.1	-	31	-	13	146	-	-
774052	10	-	0.2	-	86	-	10	53	-	-
774053	15	-	0.5	-	77	-	6	27	-	-
774054	46	48	0.8	-	189	-	23	36	-	-
774055	75	75	0.6	-	37	-	20	41	-	-
774056	2	-	0.3	-	18	-	3	50	-	-
774057	48	-	0.3	-	34	-	9	35	-	-
774058	Nil	-	0.1	-	25	-	4	41	-	-
774263	2	-	-	38	222	173	-	-	12	<10
774264	3	-	-	43	255	301	-	-	24	<10
774265	5	-	-	48	518	666	-	-	26	<10
774266	26	-	-	107	561	2310	-	-	34	<10
774267	41	43	-	64	1580	1090	-	-	21	<10
774268	153	110	-	44	1440	1000	-	-	30	<10
774269	45	-	-	136	3580	3810	-	-	75	130
774270	27	-	-	304	3570	18500	-	-	300	162
774271	34	-	-	188	2310	5580	-	-	96	112
774272	21	-	-	139	1880	4620	-	-	43	101
774273	21	-	-	164	2170	6000	-	-	76	75
774274	10	-	-	206	2050	9520	-	-	106	129
774275	45	-	-	294	2750	8980	-	-	111	85
774276	51	-	-	276	4320	7720	-	-	101	238
774277	69	-	-	338	4430	10600	-	-	108	180
774278	31	-	-	359	2470	9860	-	-	123	187
774279	96	-	-	184	4760	6940	-	-	111	167
774280	165	185	-	514	9670	17000	-	-	211	276

One assay ton portion used.

Certified by





Established 1928

# Swastika Laboratories

A Division of TSL/Assayers Inc.

Assaying - Consulting - Representation

Page 2 of 2

## Geochemical Analysis Certificate

4W-4251-RG1

Company: **FORT KNOX GOLD RESOURCES INC**

Date: JAN-25-95

Project:

Attn: **D. Hunter/D. Humby**

We hereby certify the following Geochemical Analysis of 39 Core samples submitted DEC-29-94 by .

Sample Number	Au Au Check	Ag	Co	Cu	Ni	Pb	Zn	Pd	Pt	
	PPB	PPB	PPM	PPM	PPM	PPM	PPM	PPB	PPB	
774281	89	-	-	484	4730	24400	-	-	320	434
774282	82	-	-	794	3710	23200	-	-	270	405
774283	223	336	-	471	11400	18200	-	-	332	402
774284	185	-	-	476	10400	16300	-	-	223	343
774285	144	-	-	425	7840	14300	-	-	165	249
774286	210	-	-	474	5280	14700	-	-	176	295
774287	168	-	-	346	6720	12700	-	-	189	247
774288	65	-	-	477	1960	10400	-	-	129	218
774289	45	-	-	41	697	546	-	-	24	55

One assay ton portion used.

Certified by

P.O. Box 10, Swastika, Ontario P0K 1T0

Telephone (705) 642-3244

FAX (705) 642-3300



Established 1928

# Swastika Laboratories

A Division of TSL/Assayers Inc.

Assaying - Consulting - Representation

## Geochemical Analysis Certificate

5W-0500-RG1

Company: **FORT KNOX GOLD RESOURCES INC**

Date: MAR-03-95

Project:

Attn: D. Hunter

We hereby certify the following Geochemical Analysis of 25 Core samples submitted FEB-24-95 by .

Sample Number	Au PPB	Au Check PPB	Cu PPM	Ni PPM	Pt PPB	Pd PPB
FX-774401	88	-	3860	12300	130	130
FX-774402	10	-	570	1090	21	15
FX-774403	29	-	2300	3060	36	63
FX-774404	21	-	1030	2820	41	45
FX-774405	79	62	5940	13100	215	140
FX-774406	144	-	5660	13400	220	150
FX-774407	3	-	401	178	<10	<2
FX-774408	Ni l	-	141	100	<10	7
FX-774409	Ni l	-	186	98	14	7
FX-774410	12	-	959	539	12	10
FX-774411	12	-	2460	18100	305	171
FX-774412	41	24	6440	13500	226	151
FX-774413	10	-	542	195	19	3
FX-774414	Ni l	-	113	124	27	7
FX-774415	17	-	2200	3040	62	39
FX-774416	31	-	8220	12100	202	154
FX-774417	24	34	2730	26600	463	257
FX-774418	48	38	3310	13900	295	134
FX-774419	57	-	2080	3280	69	45
FX-774420	10	-	2790	8510	123	96
FX-774421	120	-	3450	12000	127	89
FX-774422	5	-	1630	5470	70	65
FX-774423	Ni l	-	590	2410	27	27
FX-774424	69	72	6760	11300	276	127
FX-774425	26	-	1500	3770	62	38

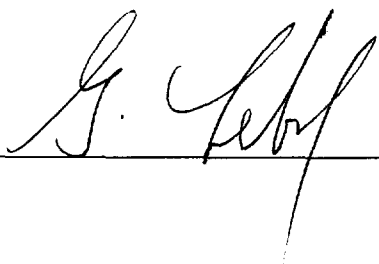
Certified by 

P.O. Box 10, Swastika, Ontario P0K 1T0

Telephone (705) 642-3244

FAX (705) 642-3300



Established 1928

# Swastika Laboratories

A Division of TSL/Assayers Inc.

Assaying - Consulting - Representation

## Geochemical Analysis Certificate

**5W-1100-RG1**

Company: **FORT KNOX GOLD RESOURCES INC**

Date: APR-19-95

Project:

Attn: D. Humby / D. Hunter

We hereby certify the following Geochemical Analysis of 2 Core samples submitted APR-12-95 by D. Hunter.

Sample Number	Au PPB	Ag PPM	Cu PPM	Pb PPM	Zn PPM
774426	3	0.6	60	4	102
774427	27	0.5	72	24	851

Certified by \_\_\_\_\_

P.O. Box 10, Swastika, Ontario P0K 1T0

Telephone (705) 642-3244

FAX (705) 642-3300



Established 1928

# Swastika Laboratories

A Division of TSL/Assayers Inc.

Assaying - Consulting - Representation

## Geochemical Analysis Certificate

5W-2732-RG1

Company: **FORT KNOX GOLD RES INC**

Date: JUN-28-95

Project:

Attn: **D. Hunter/D. Humby**

We hereby certify the following Geochemical Analysis of 5 Rock samples submitted JUN-21-95 by D. Hunter.

Sample Number	Au PPB	Au Check PPB	Ag PPM	Cu PPM	Ni PPM	Pb PPM	Zn PPM	Pt PPB	Pd PPB
Fx 774428	103	178	-	576	235	200	117	<10	<5
Fx 774429	98	-	-	761	130	-	-	<10	<5
Fx 774430	34	38	0.7	286	-	17	115	-	-
Fx 774431	21	-	0.8	264	-	5	102	-	-
Fx 774432	3	-	0.1	353	-	1	120	-	-

PAID BY CHEQUE No. 781  
DATE July 4/95

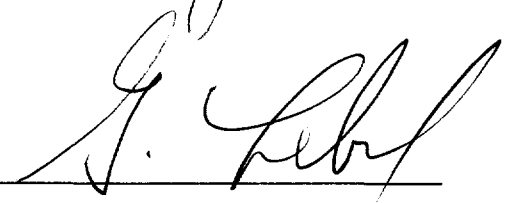
Certified by 

**Declaration of Assessment Work Performed on Mining Land**

Mining Act, Subsection 65(2) and 66(3), R.S.O. 1990

DOCUMENT ID: <u>W9780.00573</u>
Transaction Number (office use)
Assessment Files Research Imaging

Personal Informatic Mining Act, the info Questions about t 933, Ramsey Lake



nd 66(3) of the Mining Act. Under section 8 of the it work and correspond with the mining land holder. of Northern Development and Mines, 6th Floor.

Instructions: - Please type or print in ink.

900 record

MENT No. W9780.00573 now  
 use form 0240.  
W9780.00573

**1. Recorded holder(s) (Attach a list if necessary)**

Name Inco Limited	Client Number 147534
Address c/o Field Exploration Office, Hwy 17 West	Telephone Number 705 682 8451
Copper Cliff, Ontario	Fax Number 705 682 8243
Name	Client Number
Address	Telephone Number
	Fax Number

**2. Type of work performed: Check (✓) and report on only ONE of the following groups for this declaration.**

Geotechnical: prospecting, surveys, assays and work under section 18 (regs)       Physical: drilling, stripping, trenching and associated assays       Rehabilitation

Work Type Diamond Drilling	Office Use
	Commodity
	Total \$ Value of Work Claimed 60286
Dates Work Performed From 16 Day 10 Month 94 Year To 27 Day 02 Month 95 Year	NTS Reference
Global Positioning System Data (if available)	Mining Division
Township/Area Fawcett	Resident Geologist District
M or G-Plan Number	

Please remember to: - obtain a work permit from the Ministry of Natural Resources as required;  
 - provide proper notice to surface rights holders before starting work;  
 - complete and attach a Statement of Costs, form 0212;  
 - provide a map showing contiguous mining lands that are linked for assigning work;  
 - include two copies of your technical report.

**3. Person or companies who prepared the technical report (Attach a list if necessary)**

Name Doug Hunter	Telephone Number 705 932 3130
Address R.R. 2, Millbrook, Ontario L0A 1G0	Fax Number As above
Name	Telephone Number
Address	Fax Number
Name	Telephone Number
Address	Fax Number

**4. Certification by Recorded Holder or Agent**

I, Brian Randa (Print Name), do hereby certify that I have personal knowledge of the facts set forth in this Declaration of Assessment Work having caused the work to be performed or witnessed the same during or after its completion and, to the best of my knowledge, the annexed report is true.

Signature of Recorded Holder or Agent <u>Brian Randa</u>	AGENT FOR INCO LIMITED	Date January 28, 1997
Agent's Address 6 FIELD EXPLORATION, HWY 17 WEST COPPER CLIFF, ONTARIO P0M1N0	Telephone Number 705 682 8447	Fax Number 705 682 8243

5. Work to be recorded and distributed. Work can only be assigned to claims that are contiguous (to be r) the mining land where work was performed, at the time work was performed. A map showing the contiguous land w/ company tr. must accompany this form.

Mining Claim Number. Or if work was done on other eligible mining land, show in this column the location number indicated on the claim map.	Number of Claim Units. For other mining land, list hectares.	Value of work performed on this claim or other mining land.	Value of work applied to this claim.	Value of work assigned to other mining claims.	Bank. Value to be distributed at a future date.
eg TB 7827	16 ha	\$26, 825	N/A	\$24,000	\$2,825
eg 1234567	12	0	\$24,000	0	0
eg 1234568	2	\$ 8, 892	\$ 4,000	0	\$4,892
1 L1177030	1	0	400 ✓	0	0
2 L1177031	1	0	400 ✓	0	0
3 L1177032	1	0	400 ✓	0	0
4 L1177034	1	0	400 ✓	0	0
5 L1180178	1	11, 533	400 ✓	0	11,133 ✓
6 L1180179	1	0	400 ✓	0	0
7 L1180180	1	0	400 ✓	0	0
8 L1180181	1	9,055	400 ✓	0	8,655 ✓
9 L1180182	1	22,600	400 ✓	<del>10,000</del> 10,400 BR	<del>12,200</del> 11,800 BR ✓
10 L1180183	1	0	400 ✓	0	0
11 L1180184	1	0	400 ✓	0	0
12 L1180185	1	0	400 ✓	0	0
13 L1180186	1	10,531	400 ✓	0	10,131 ✓
14 L1180228	1	0	400 ✓	0	0
15 L1180229	1	6,567	400 ✓	0	6,167 ✓
<i>Continued on next page</i> Column Totals					

I, Brian Randa (Print Full Name), do hereby certify that the above work credits are eligible under subsection 7 (1) of the Assessment Work Regulation 6/96 for assignment to contiguous claims or for application to the claim where the work was done.

Signature of Record Holder or Agent Authorized in Writing: Brian Randa Agent For INCO LIMITED Date: January 28, 1997

6. Instructions for cutting back credits that are not approved.

Some of the credits claimed in this declaration may be cut back. Please check (✓) in the boxes below to show how you wish to prioritize the deletion of credits:

- 1. Credits are to be cut back from the Bank first, followed by option 2 or 3 or 4 as indicated.
- 2. Credits are to be cut back starting with the claims listed last, working backwards; or
- 3. Credits are to be cut back equally over all claims listed in this declaration; or
- 4. Credits are to be cut back as prioritized on the attached appendix or as follows (describe):

Note: If you have not indicated how your credits are to be deleted, credits will be cut back from the Bank first, followed by option number 2 if necessary.

For Office Use Only

Received Stamp 1109	Deemed Approved Date <u>97 MAY 31</u>	Date Notification Sent <u>April 29/97</u>
	Date Approved <u>97 MAY 31</u>	Total Value of Credit Approved <u>60286</u>
Approved for Recording by Mining Recorder (Signature)		

Mining Claim Number. Or if work was done on other eligible mining land, show in this column the location number indicated on the map.

Received  
June 1997

to be recorded and distributed. Work can only be assigned to claims that are contiguous (adjoining) to  
 g land where work was performed, at the time work was performed. A map showing the contiguous link  
 company this form.

DOCUMENT No.  
 W 9780 • 00064

Claim Number. Or if work was done on other eligible mining land, show in this column the location number indicated on the claim map.	Number of Claim Units. For other mining land, list hectares.	Value of work performed on this claim or other mining land.	Value of work applied to this claim.	Value of work assigned to other mining claims.	Bank. Value of work to be distributed at a future date.
eg TB 7827	16 ha	\$26,825	N/A	\$24,000	\$2,825
eg 1234567	12	0	\$24,000	0	0
eg 1234568	2	\$ 8,892	\$ 4,000	0	\$4,892
1 L1180230	1	0	400	0	0
2 L1180231	1	0	400	0	0
3 L1180232	1	0	400	0	0
4 L1180233	1	0	400	0	0
5 L1180234	1	0	400	0	0
6 L1180235	1	0	400	0	0
7 L1180236	1	0	400	0	0
8 L1180237	1	0	400	0	0
9 L1180248	1	0	400	0	0
10 <sup>2 ha</sup> L1180849	1	0	400	0	0
11 L1180258	1	0	400	0	0
12 L1180259	1	0	400	0	0
13 L1180260	1	0	400	0	0
14 L1180261	1	0	400	0	0
15 L1180262	1	0	400	0	0
<b>Column Totals</b>		<b>-60,286 BA</b>	<b>-12,000 BA</b>	<b>-10,000 BA</b>	<b>40,286 BA</b>

I, BRIAN RANDA (Print Full Name), do hereby certify that the above work credits are eligible under subsection 7 (1) of the Assessment Work Regulation 6/96 for assignment to contiguous claims or for application to the claim where the work was done.

Signature of Record Holder or Agent Authorized in Writing: Brian Randa / Agents for INCO LIMITED Date: January 28, 1997

6. Instructions for cutting back credits that are not approved.

Some of the credits claimed in this declaration may be cut back. Please check (✓) in the boxes below to show how you wish to prioritize the deletion of credits:

- 1. Credits are to be cut back from the Bank first, followed by option 2 or 3 or 4 as indicated.
- 2. Credits are to be cut back starting with the claims listed last, working backwards; or
- 3. Credits are to be cut back equally over all claims listed in this declaration; or
- 4. Credits are to be cut back as prioritized on the attached appendix or as follows (describe):

Note: If you have not indicated how your credits are to be deleted, credits will be cut back from the Bank first, followed by option number 2 if necessary.

For Office Use Only

Received Stamp	Deemed Approved Date	Date Notification Sent
	Date Approved	Total Value of Credit Approved
	Approved for Recording by Mining Recorder (Signature)	





Statement of Costs for Assessment Credit

Transaction No./N° de transaction

État des coûts aux fins du crédit d'évaluation

Mining Act/Loi sur les mines

Personal information collected on this form is obtained under the authority of the Mining Act. This information will be used to maintain a record and ongoing status of the mining claim(s). Questions about this collection should be directed to the Provincial Manager, Minings Lands, Ministry of Northern Development and Mines, 4th Floor, 159 Cedar Street, Sudbury, Ontario P3E 6A5, telephone (705) 670-7264

Les renseignements personnels contenus dans la présente formule sont recueillis en vertu de la Loi sur les mines et serviront à tenir à jour un registre des concessions minières. Adresser toute question sur la collecte de ces renseignements au chef provincial des terrains miniers, ministère du Développement du Nord et des Mines, 159, rue Cedar, 4<sup>e</sup> étage, Sudbury (Ontario) P3E 6A5, téléphone (705) 670-7264.

1. Direct Costs/Coûts directs

Type	Description	Amount Montant	Totals Total global
Wages Salaires	Labour Main-d'oeuvre	15230	
	Field Supervision Supervision sur le terrain		15230
Contractor's and Consultant's Fees Droits de l'entrepreneur et de l'expert-conseil	Drilling	78826	
	Assaying	6074	
	Core Sawing and Haulage	4747	89647
Supplies Used Fournitures utilisées	Supplies	1384	
			1384
Equipment Rental Location de matériel			
<b>Total Direct Costs Total des coûts directs</b>			<b>106261</b>

2. Indirect Costs/Coûts indirects

\*\* Note: When claiming Rehabilitation work Indirect costs are not allowable as assessment work. Pour le remboursement des travaux de réhabilitation, les coûts indirects ne sont pas admissibles en tant que travaux d'évaluation

Type	Description	Amount Montant	Totals Total global
Transportation Transport	Truck Rental	1013	
			1013
Food and Lodging Nourriture et hébergement	Food & Lodging	2768	2768
Mobilization and Demobilization Mobilisation et démoblisation			
<b>Sub Total of Indirect Costs Total partiel des coûts indirects</b>			<b>3781</b>
<b>Amount Allowable (not greater than 20% of Direct Costs) Montant admissible (n'excédant pas 20 % des coûts directs)</b>			
<b>Total Value of Assessment Credit (Total of Direct and Allowable Indirect costs)</b>		<b>Valeur totale du crédit d'évaluation (Total des coûts directs et Indirects admissibles)</b>	<b>110042</b>

Note: The recorded holder will be required to verify expenditures claimed in this statement of costs within 30 days of a request for verification. If verification is not made, the Minister may reject for assessment work all or part of the assessment work submitted.

Note : Le titulaire enregistré sera tenu de vérifier les dépenses demandées dans le présent état des coûts dans les 30 jours suivant une demande à cet effet. Si la vérification n'est pas effectuée, le ministre peut rejeter tout ou une partie des travaux d'évaluation présentés.

Working Discounts

Work filed within two years of completion is claimed at 100% of the above Total Value of Assessment Credit

Work filed three, four or five years after completion is claimed at 50% of the above Total Value of Assessment Credit. See calculations below

$$\frac{10531}{10531} \times 100\% = \$10,531$$

$$\frac{99511}{199022} \times 0.50 = 49,755$$

\$60,286

Certification Verifying Statement of Costs

I hereby certify:

that the amounts shown are as accurate as possible and these costs were incurred while conducting assessment work on the lands shown in the accompanying Report of Work form.

as Landman I am authorized (Recorded Holder, Agent, Position in Company)

I make this certification

Remises pour dépôt

1. Les travaux déposés dans les deux ans suivant leur achèvement sont remboursés à 100 % de la valeur totale susmentionnée du crédit d'évaluation

2. Les travaux déposés trois, quatre ou cinq ans après leur achèvement sont remboursés à 50 % de la valeur totale du crédit d'évaluation susmentionné. Voir les calculs ci-dessous.

$$\frac{\text{Valeur totale du crédit d'évaluation}}{\text{Évaluation totale demandée}} \times 0,50 =$$

Attestation de l'état des coûts

J'atteste par la présente :

que les montants indiqués sont le plus exact possible et que ces dépenses ont été engagées pour effectuer les travaux d'évaluation sur les terrains indiqués dans la formule de rapport de travail ci-joint.

Et qu'à titre de Brian Randa je suis autorisé (titulaire enregistré, représentant, poste occupé dans la compagnie)

à faire cette attestation.

Signature Brian Randa Date January 28, 1997  
 Brian Randa  
 Agent for  
 Inco Limited



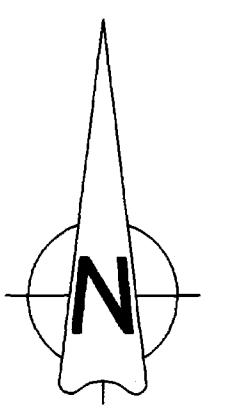
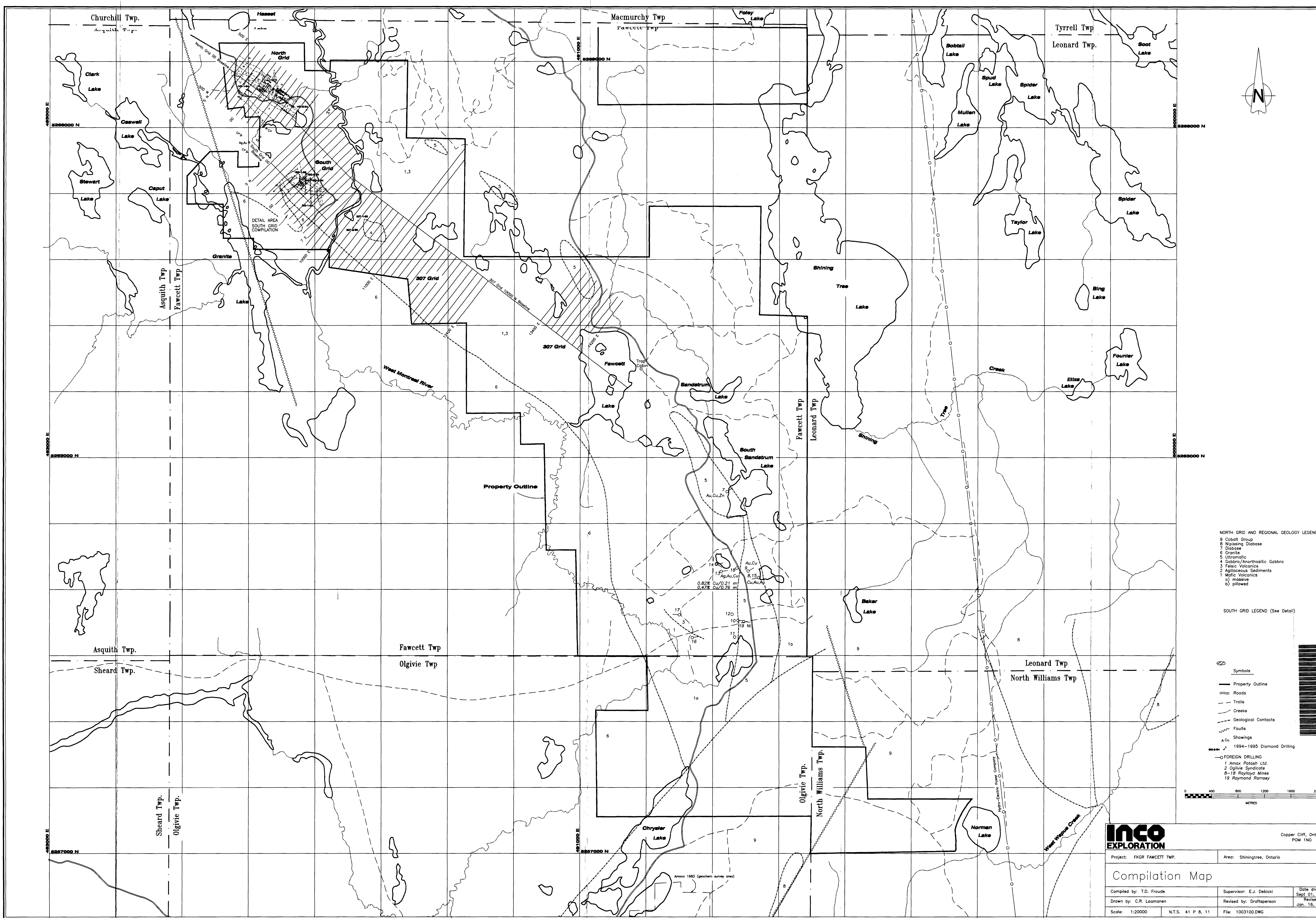

**NORTH GRID AND REGIONAL GEOLOGY LEGEND**

- 9 Cobalt Group
- 8 Nipissing Diabase
- 7 Diabase
- 6 Granite
- 5 Ultramafic
- 4 Gabbro/Anorthositic Gabbro
- 3 Felsic Volcanics
- 2 Agglomerous Sediments
- 1 Mafic Volcanics
  - a) massive
  - b) pillowed

**SOUTH GRID LEGEND (See Detail)**

- Symbols**
- Property Outline
  - Roads
  - Trails
  - Creeks
  - Geological Contacts
  - Faults
  - Showings
    - ▲ Cu
    - FOREIGN DRILLING
      - 1 Amax Potash Ltd.
      - 2 Olgivie Syndicate
      - 8-19 Rayloyd Mines
      - 19 Raymond Ramsey

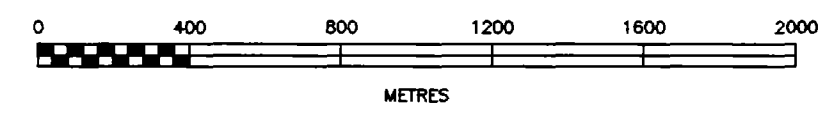

**INCO EXPLORATION**

Copper Cliff, Ontario  
POM 1N0

Project: FKGR FAWCETT TWP. Area: Shiningtree, Ontario

**Compilation Map**

Compiled by: T.D. Froude	Supervisor: E.J. Debicki	Date drawn: Sept. 01, 1994
Drawn by: C.R. Loamanen	Revised by: Draftsperson	Revised: Jan. 16, 1997
Scale: 1:20000	N.T.S. 41 P 8, 11	File: 1003100.DWG

210

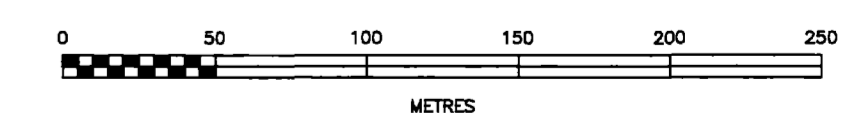
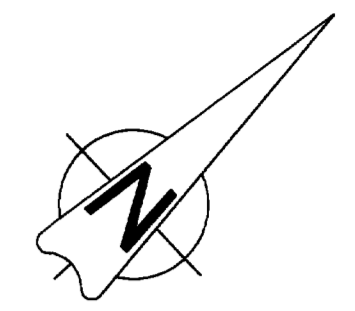
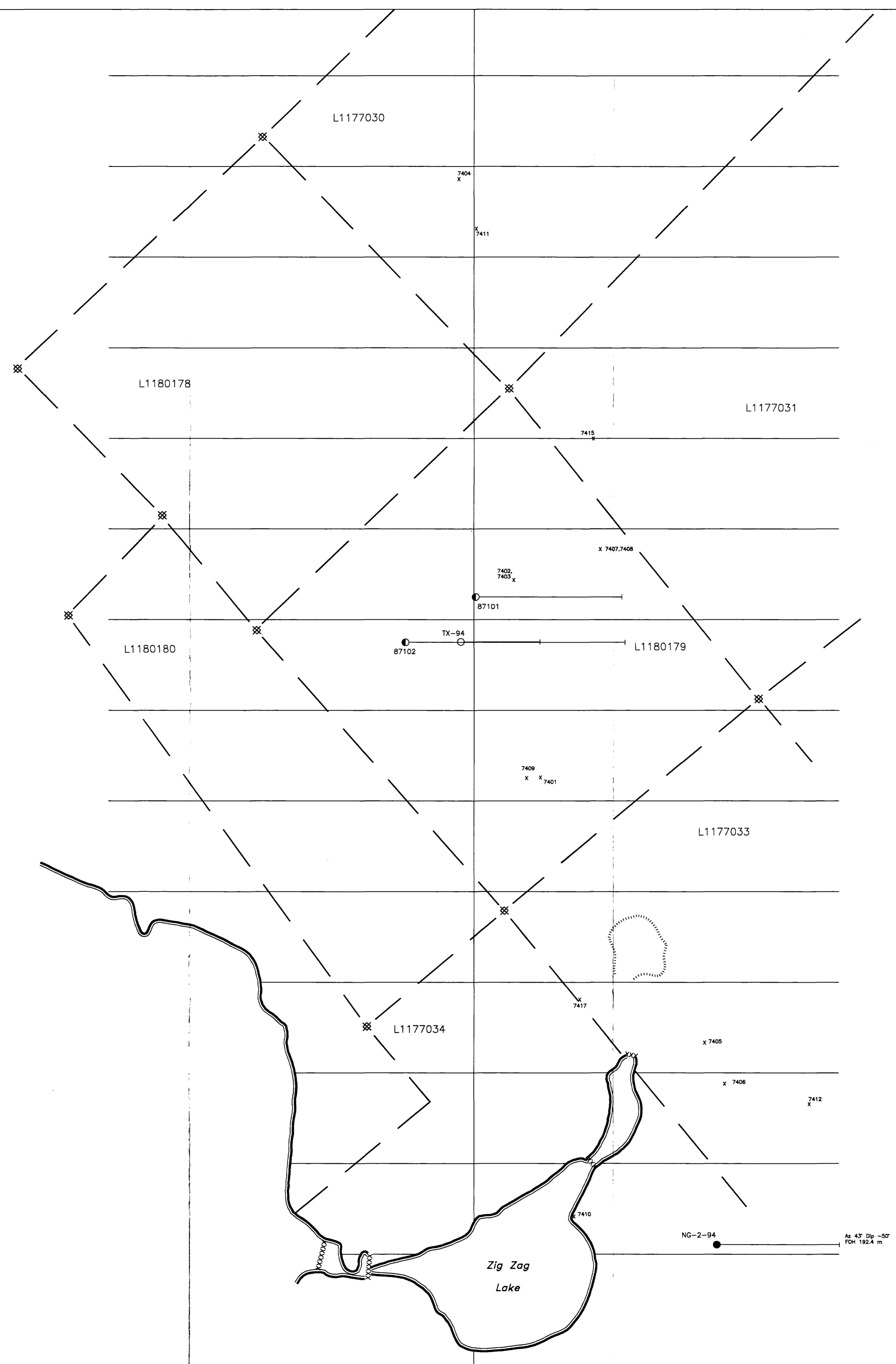

D4	D8
E4	E8
F4	
G3	G4

Copper Cliff, Ontario PDM 1ND			
Project: FAWCETT TOWNSHIP		Area: Fawcett Township, Ontario	
DRILL PLAN			SHEET 1
Supervisor: Ed Debicki	Instrument:	Survey date: June 1991	
Compiled by: Doug Hunter	Drawn by: L. J. Valade	Date drawn: January 1992	Revised: May 1997
Scale: 1:2500	File: FTGEONG.DWG	N.T.S. 41 P 11	



1	2	3	4
5	6		

SHEET INDEX

41P1182008 10/18/2007 FAWCETT 230

AUTHOR(S) OF REPORT:  
A. KING (ETS)  
W. WHYMARK (FORT KNOX)

0 50 100 150 200 METRES

<b>INCO EXPLORATION AND TECHNICAL SERVICES INC.</b>		Copper Cliff, Ontario POM 1N0	
Project: FAWCETT	Area: FAWCETT TOWNSHIP, ONTARIO	SHEET	FIGURE
DRILL PLAN		2	
Supervisor: A. KING	Instrument: EDA OMNI	Survey date: 04/91 08/91	11/91 02/92
Compiled by: G.J. GERECHTY GÉOTERREX LTD.	Drawn by: W.E. MARSAW	Date drawn: 04/08/92	Revised:
Scale: 1:2500	File: FKM02.DWG	N.T.S. 41P/11	

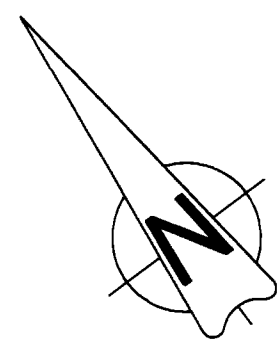
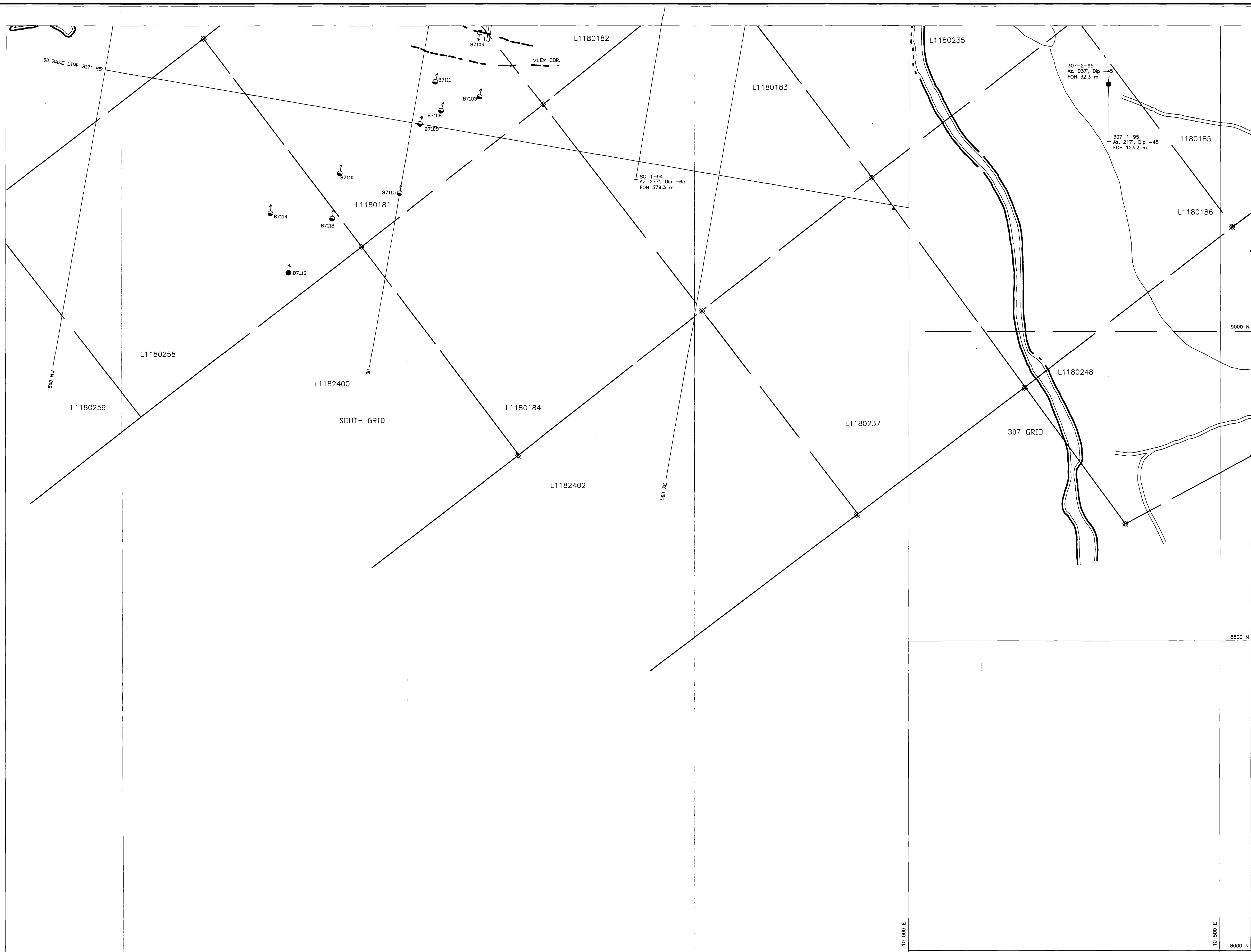

AUTHOR(S) OF REPORT:  
 A.KING (ETS)  
 W.WHYMARK (FORT KNDX)

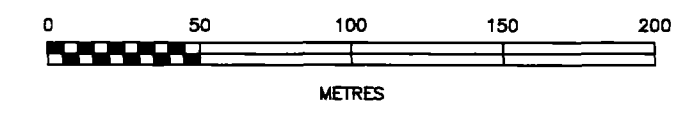

1	2	3	4
		5	

SHEET INDEX

<b>INCO EXPLORATION AND TECHNICAL SERVICES INC.</b>		Copper Cliff, Ontario POM 1ND	
Project: FAWCETT	Area: FAWCETT TOWNSHIP, ONTARIO		
<b>DRILL PLAN</b>			FIGURE <b>5</b>
Supervisor: A. KING	Instrument: EDA OMNI	Survey date: 04/91	08/91
Compiled by: G.J. CERECHTY GENTERREX LTD.	Drawn by: W.E. MARSAW	Date drawn: 04/05/92	Revised: 02/92
Scale: 1:2500	File: FKMG5.DWG	N.T.S. 41P/11	

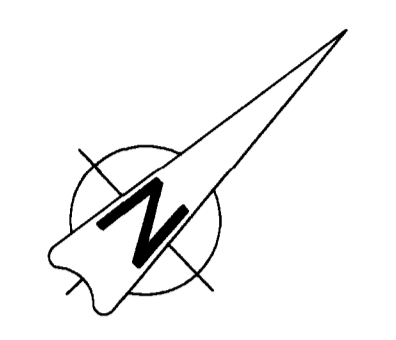
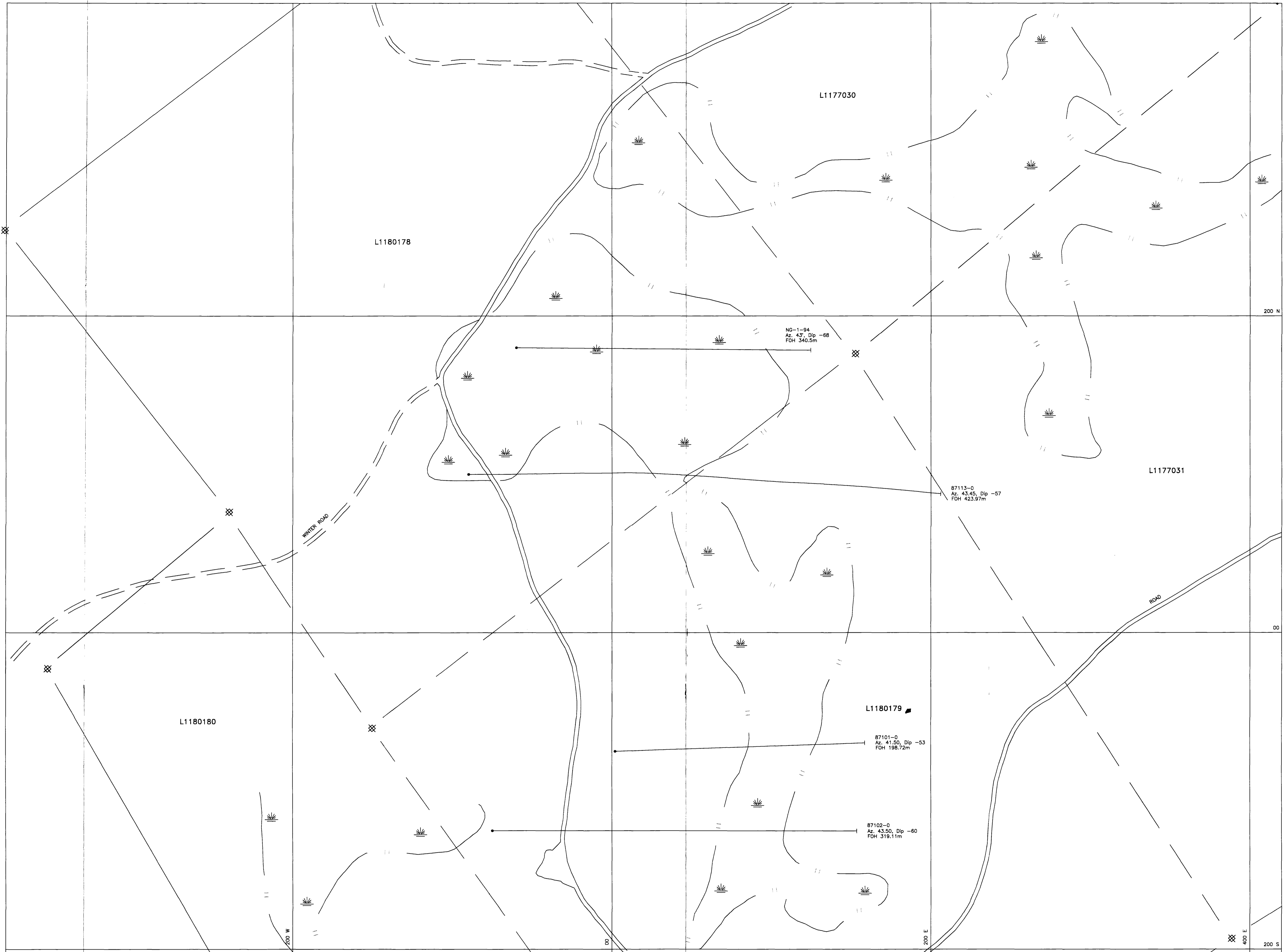

**LEGEND**

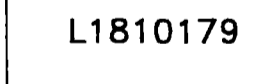
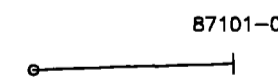
-  L1180179 Claim Line and Number
-  87101-0 Borehole Trace and Number

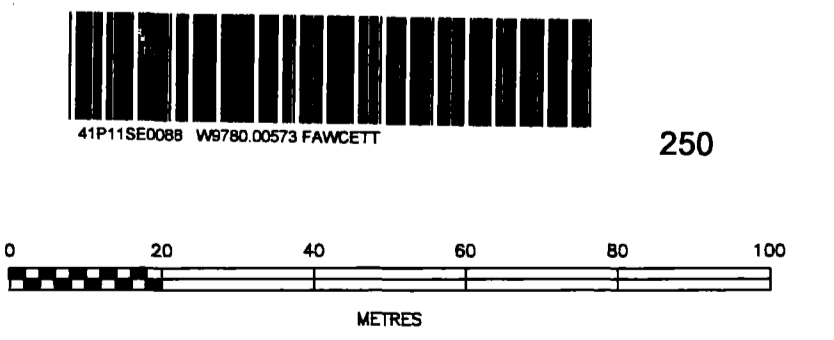

<b>INCO EXPLORATION AND TECHNICAL SERVICES INC.</b>		Copper Cliff, Ontario POM 1N0	
Project: FAWCETT TOWNSHIP PROPERTY	Area: Fawcett Township, Ontario	SHEET	FIGURE
<b>DRILL PLAN</b>		1	1
Supervisor: J. Perry	Instrument:	Survey date:	
Compiled by: T. Froude	Drawn by: D.W. Walsh	Date drawn: 03/05/92	Revised: 05/28/93
Scale: 1: 1000	File: 1000014.DWG	N.T.S. 41 P 11	





**LEGEND**

- Gb Gabbro-equigranular, medium to coarse grained
- D Gabbro-diabasic textured, fine to medium grained
- MD Fine grained mafic dike
- MV Mafic volcanic
- LD Late diabase dike
- DIB Diabasic textured gabbro/intrusive breccia may include ultramafic/pyroxenite
- DIBP May include pegmatic phase
- CLAG Coarse grained leucocratic-anorthositic gabbro
- PCLAG Coarse grained porphyritic phase
- FD Felsic dike-laminated/banded
- FP Feldspar porphyry dike
- ID Intermediate dike
- TP Felsic pyroclastics; tuff and lapilli tuff
- TS Tuff/sediment, dark coloured-bedded
- T Intermediate tuff

**Minerals**

- Py Pyrite
- Po Pyrrhotite
- Cpy Chalcopyrite
- Sph Sphalerite
- Gn Galena
- Pn Pentlandite
- Mag Magnetite
- Hem Hematite
  
- S Sericite
- Chl Chlorite
- C Carbonate
- Ga Garnet

**Structure**

- Bx Tectonic breccia
- BxQ Tectonic breccia with quartz veining
- Foliation/banding with core axis angle

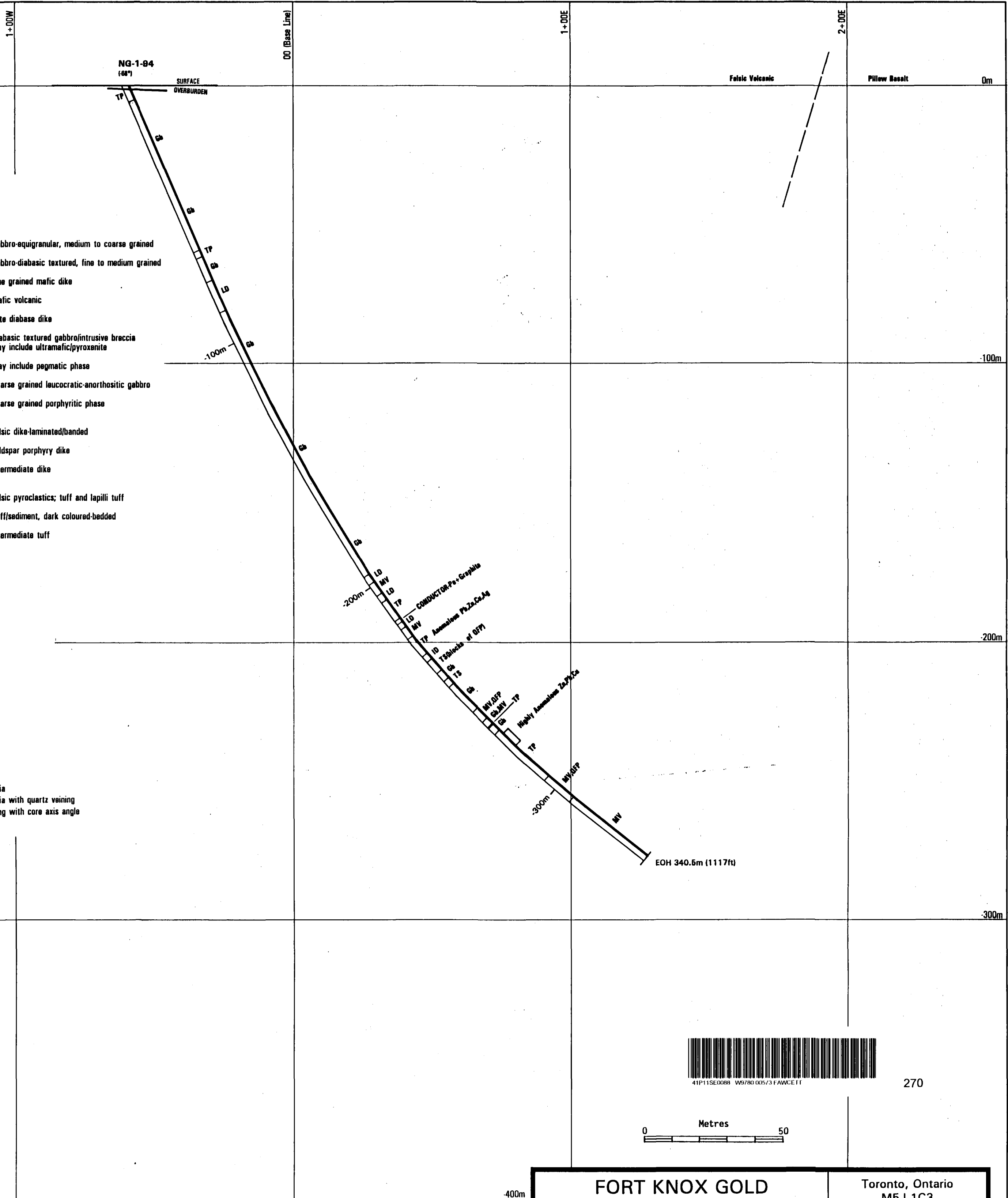

<b>FORT KNOX GOLD RESOURCES INC.</b>		Toronto, Ontario M5J 1C3	
Project: LITTLE NICKEL PROPERTY		Area: SHINING TREE, ONTARIO	
<b>SECTION 1+80N NORTH GRID</b>			SHEET
DDH: NG-1-94	Instrument:	Survey Date:	
Compiled by:	Drawn By: A.D.H.	Date Drawn: March 1995	
Scale: 1:1,000		N.T.S.:	

