

41P11SE0150 63.5498 ASQUITH

010

J. L. TINDALE & ASSOCIATES

Suite 907 - 110 Erskine Avenue
Toronto, Ontario, Canada M4P 1Y4

Telephone
(416) 481-5781

ASSESSMENT WORK REPORT

PROSPECTING, TRENCH CLEANUP AND SAMPLING

ON

CLAIMS 980040 AND 979554

ASQUITH TOWNSHIP

FOR

ASQUITH RESOURCES INC.

May 10, 1991

J. L. Tindale, P. Eng.

RECEIVED
LARDER LAKE
MINING DIVISION

MAY 16 1991

TIME 11:34 am *B*

INTRODUCTION

Asquith Resources Inc., 907 - 110 Erskine Avenue, Toronto, Ontario M4P 1Y4 is the registered owner of some 72 contiguous claims located in east central Asquith Township, Shining Tree Area of Ontario. During the summer of 1990 several areas were prospected to locate old workings and gold showings, one of which is described in the following. The area under discussion is located east of the Buckingham Mine and work was designed to determine if an on strike extension or mineralization of similar character could be located.

WORK CARRIED OUT

The writer, a geologist, accompanied by Roy Annett, a prospector, traversed claims 980040 and 979554 on August 3 and 4, 1990 and located a number of old pits and trenches. These were badly caved or filled with debris necessitating cleanout with grubhoes and shovels to permit examination of the vein structures and host rocks. Two of the areas are described in the following with assay results:

a) Claim 980040 - 29+00E, 20+00S "A" Grid.

A series of trenches follow a east-west striking 24" wide white quartz vein for approximately 80 feet. The vein is poorly mineralized and returned only trace Au value upon chip sample. Approximately 50 feet east of the trench a shallow (± 1 foot) pit exposes green carbonate rich mafic volcanic rock, well sheared and injected with $\frac{1}{4}$ - $\frac{1}{2}$ inch blue-grey quartz veins. Intensity of shearing and style of veining is reminiscent of the Buckingham Mine Area. Samples 148832-33, 4 foot chips across the zone returned 300 ppb and 46 ppb Au suggesting elevated gold values in the shear.

b) Claim 979554 - 2+80E, 8+00N "C" Grid.

Grubhoe cleanout along a series of east-west striking trenches and pits, over a lateral distance of 100 feet, exposed a strong series of blue-grey quartz veins with highly sheared, heavily carbonated mafic volcanics. Pyrite and minor chalcopyrite are common accessory minerals. The best exposure was cleaned out of a shallow open cut at the east end of the structure at the edge of a swamp. The zone was exposed across ten feet and chip sampled results as follows:

<u>Sample No.</u>	<u>Description</u>	<u>Value (ppb Au)</u>
148835	Pit with blue qtz, sheared wall rock, grab	707
148836	H. W. shear with blue qtz, stringers, pyrite, 2.5' chip	584
148837	Adjacent sheared wall rock, 4' chip	901
148838	Grab of best of latter	89
148839	12" blue qtz vein with highly sheared W. R., pyrite	1,137
148840	Grab of latter, all vein	2,733

This showing is a strong example of the type of shearing and veining that carries gold values in the area. The exposure enters deep overburden to the west and the swamp to the east. Stripping and washing of the occurrence are recommended.

CONCLUSION

Both showings are of interest and carry elevated gold values. As mentioned above the 979554 claim occurrence is the most promising with intense shearing, heavy carbonate alteration, strong veining and elevated gold values. Stripping, washing and channel sampling are warranted to better evaluate this showing.

The northerly showing on 980040 while close to being on strike with the Buckingham does not appear to be of sufficient strength to warrant further expenditure.

ATTACHMENT

Map, scale 1" = 200', depicts the showings and sample locations on claims 980040 and 979554 and is appended to this report.

Respectfully submitted,

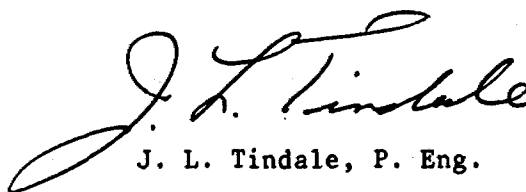
J. L. Tindale, P. Eng.

May 10, 1991.

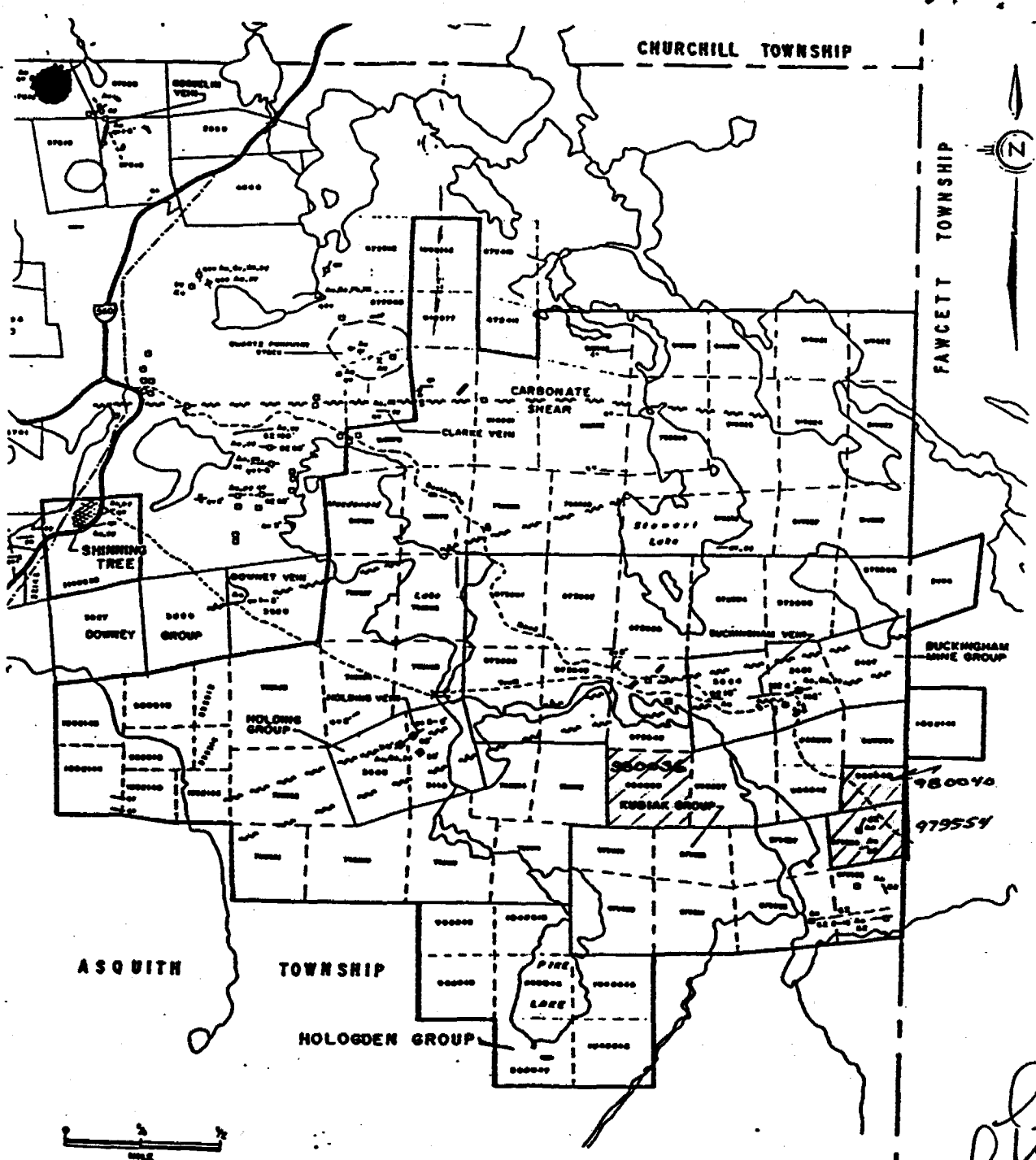

ASQUITH RESOURCES INC.
 PROPERTY LOCATION MAP
 ASQUITH TOWNSHIP
 Revised Mar., 1989
 MAY 1987 FIGURE 2

J. L. T.
 MAY 10/91

ASQUITH RESOURCES INC.
 PLAN OF TRENCH CLEANOUT
 and SAMPLING
 CL 980040 & 979554
 ASQUITH TOWNSHIP
 SCALE 1" = 200'
 J.L.T. MAY 10/91

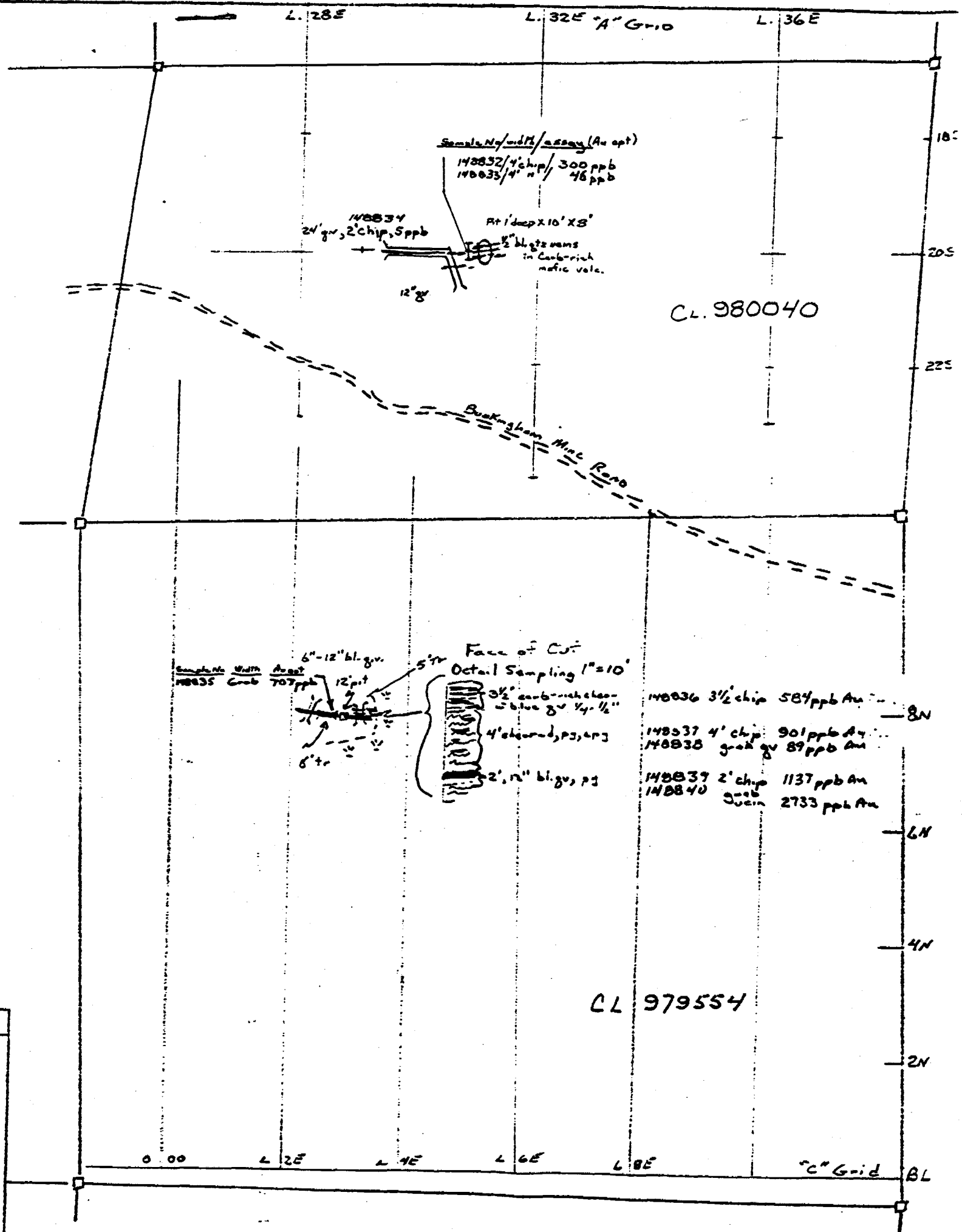

WORK



900

DOCUMENT NO.
W9180-00215.

Mining Act Report of Work

Name and Address of Recorded Holder <i>ASQUITH RESOURCES INC.</i>	Prospector's Licence No. <i>74759</i>
<i>907-110 ERSKINE AVE TORONTO ONT M4P1Y4</i>	Telephone No. <i>416-481-5781</i>

Summary of Distribution of Credits and Work Performance

Mining Division <i>LARGER LAKE</i>	Mining Claim			Work Days Cr.	Mining Claim			Work Days Cr.	Mining Claim			Work Days Cr.
	Prefix	Number			Prefix	Number			Prefix	Number		
Township or Area <i>ASQUITH</i>	<i>L</i>	<i>980036</i>		<i>4</i>								
Total Assessment Credits Claimed <i>4 days</i>												
Type of Work Performed (Check one only)												
<input checked="" type="checkbox"/> Manual Work												
<input type="checkbox"/> Shaft Sinking Drifting or other Lateral Work												
<input type="checkbox"/> Mechanical equipment												
<input type="checkbox"/> Power Stripping other than Manual (maximum credit allowed - 100 days per claim)												
<input type="checkbox"/> Diamond or other Core drilling												
<input type="checkbox"/> Core Specimens												

Dates when work was performed From: <i>Aug 3/90</i> To: <i>Aug 4/90</i>	Total No. of Days Performed <i>4</i>	Total No. of Days Claimed <i>4</i>	Total No. of Days to be Claimed at a Future Date
--	---	---------------------------------------	--

All the work was performed on Mining Claim(s): Indicate no. of days performed on each claim. * (See note No. 1 on reverse side)		Mining Claim	No. of Days	Mining Claim	No. of Days	Mining Claim	No. of Days	Mining Claim	No. of Days
		<i>980040</i>	<i>2</i>	<i>979554</i>	<i>2</i>				

Required Information eg. type of equipment, Names, Addresses, etc. (See Table on reverse side)
If space below is insufficient, attach schedules with required information and location sketches

Work consisted of cleaning old trenches and pits with grub hoes and shovels and chip sampling with moil and hammer.

Work carried out by:

J.L. TINDALE, geologist, 907-110 ERSKINE AVE TORONTO ONT M4P1Y4

ROY ANNETT, prospector, Box 101, Shining Tree, Ont., P0M 2X0

ONTARIO GEOLOGICAL SURVEY
GIS - ASSESSMENT FILES

JUN 1 9 1991

RECEIVED

Certification of Beneficial Interest * (See Note No. 2 on reverse side)

I hereby certify that, at the time the work was performed, the claims covered in this report of work were recorded in the current recorded holder's name or held under a beneficial interest by the current recorded holder.

Date _____ Recorded Holder or Agent (Signature) _____

Certification Verifying Report of Work

I hereby certify that I have a personal and intimate knowledge of the facts set forth in the Report of Work annexed hereto, having performed the work or witnessed same during and/or after its completion and the annexed report is true.

Name and Address of Person Certifying
J.L. TINDALE 907-110 ERSKINE AVE

Toronto Ont M4P1Y4 Telephone No. *416-481-5781* Date *MAY 10/91* Certified By (Signature) *J.L. Tindale*

For Office Use Only

Work Assignments	Received Stamp
<i>L- 980040 2 3998</i>	<p>RECEIVED LARGER LAKE MINING DIVISION MAY 16 1991</p> <p>TIME <i>11:34am</i></p>
<i>L- 979554 2 3998</i>	
<i>(x20) 980040 2 days performed.</i>	
<i>(x20) 979554 2 day performed.</i>	

FROM KLK MINING RECORDER

PAGE.002

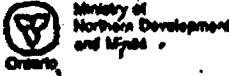

Instructions: Please type or print. For each type of work performed, a separate Report of Work should be completed. For geo-technical work, use form no. 1002 'Report of Work (Geological, Geophysical, Geochemical)' and form no. 873 for Expenditures. Refer to Sections 76 and 77, the Mining Act for assessment work requirements and the reverse side of this form for table of information.

DOCUMENT No. V9180-00215.

WORK

Mining Act Report of Work

Name and Address of Record Holder: ASQUITH RESOURCES INC. 907-110 ESKINE AVE TORONTO ONT M4P1Y4. Proprietor's License No. T-4759. Telephone No. 416-481-5781.

Summary of Distribution of Credits and Work Performance table with columns for Mining Claims (Picks, Number, Mine Days Cr.), Work Days Cr., and Type of Work Performed (Manual, Lateral, Mechanical, etc.).

Period when work was performed: From Aug 3/90 to Aug 4/90. Total No. of Days Performed: 4. Total No. of Days Claimed: 4. Total No. of Days to be Claimed at a Future Date: 0.

Table showing work performed on Mining Claims: 980040 (2 days), 979554 (2 days).

Required information eg. type of equipment, Names, Addresses, etc. (See Table on reverse side). Work consisted of cleaning old trenches and pits with grub hoes and shovels and chip sampling with mail and hammer. Work carried out by J.L. THORNTON, geologist, 907-110 Eskine Ave Toronto Ont M4P1Y4 and Roy Annett, prospector, Orillia, Shining Town, Ont, P.O. 2X0.

Certification of Beneficial Interest: I hereby certify that, at the time the work was performed, the claims covered in this report of work were recorded in the current registered holder's name or held under a beneficial interest by the current registered holder. Date: May 10/91.

Certification Verifying Report of Work: I hereby certify that I have a personal and intimate knowledge of the facts set forth in the Report of Work annexed hereto, having performed the work or witnessed same during and/or after its completion and the annexed report is true.

Name and Address of Person Verifying: J.L. Thornton, 907-110 Eskine Ave, Toronto Ont M4P1Y4. Telephone No. 416-481-5781. Date: May 10/91.

For Office Use Only: Work Assignments table listing L-980040 (2) 3998 and L-979554 (2) 3998. Includes RECEIVED stamp from LARDER LAKE MINING DIVISION dated MAY 16 1991 and TIME 11:30 AM.

