

41P11SW0028 13 CHURCHILL

Diamond Drilling

010

Township of Churchill

Report NO: 13

Work performed by: Tri-Bridge Cons. Gold Mines Ltd.

Claim NO	Hole NO	Footage	Date	Note
L342854	T-3	346'	June/75	(1)

Notes: (1) #212-75 Asquith Twp.

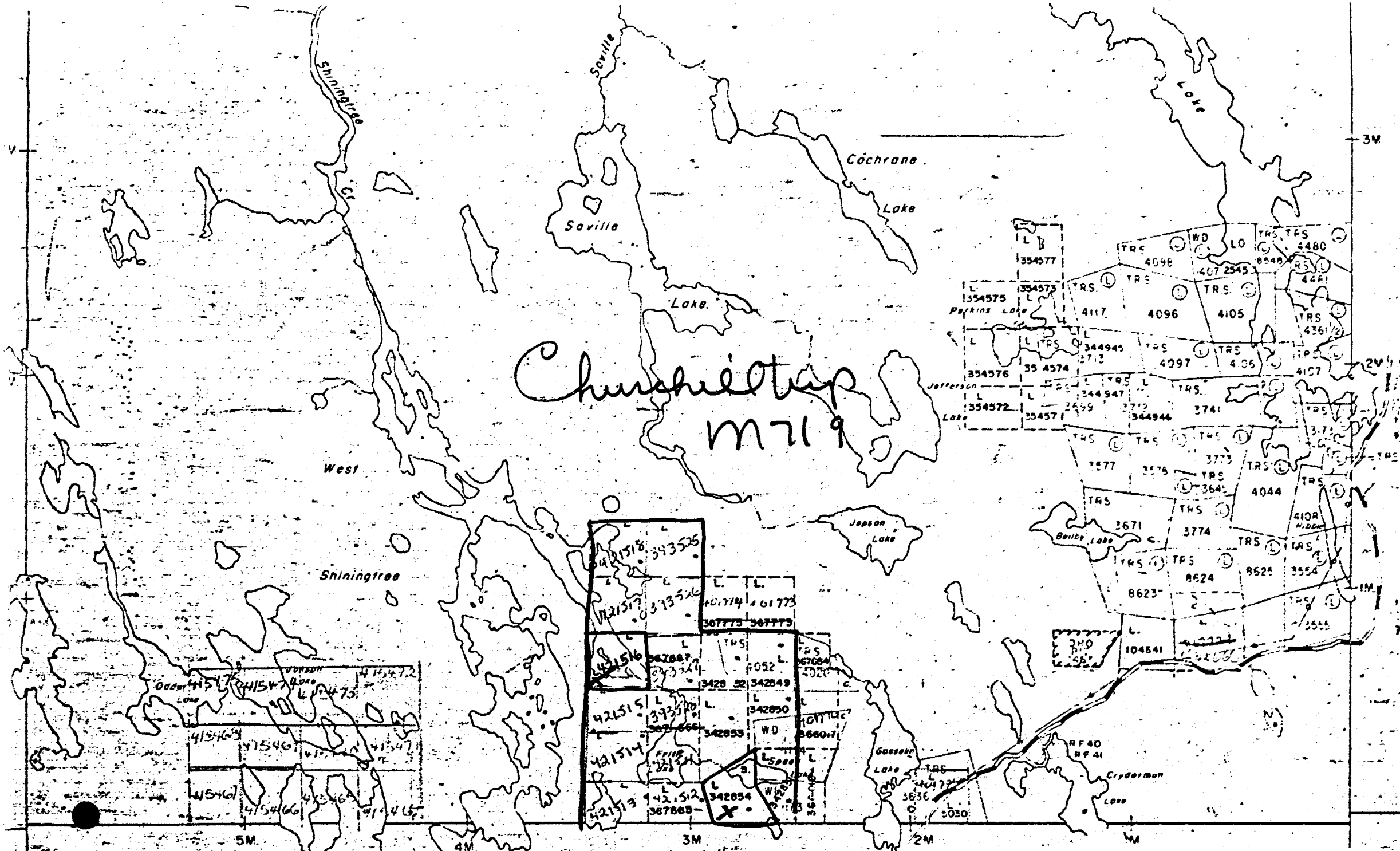

Churchill
M719

Macmurchy Twp

#212 hrs Asquith Twp
Tri-Bridge Mines

Asquith Twp (M-637)

DIAMOND DRILL RECORD

PROPERTY	: Tri-Bridge Cons. Gold Mines Ltd.	HOLE NO.	: T-3
LOCATION	: Speed Lake Area, MacMurphy Twp., District of Sudbury, Ont.	DIP	: -45°
CLAIM NO.	: 342854	BEARING	: N 60° E
LATITUDE	: 36-N	LENGTH	: 346 ft.
DEPARTURE	: 0+00 (Base Line)	BEGUN	: June 29/75
DRILLED BY	: Ferguson Mining Services	COMPLETED	: July 5/75
		LOGGED BY	: H. Dowhaluk
		CORE SIZE	: IAX

6-----

0.0-17.5 : OVERBURDEN. Casing.
 17.5-18.5 : CARBONATE. Boulder. Buff colored.
 18.5-70.9 : RHYOLITE. Lt greenish gray to buffy and greenish white.
 Compact, fractured w graphite and chlorite in fractures.
 Slight carbonate content, mostly in small lenses or
 veinlets. Small amounts of pyrite up to about 1% or more
 as small cubes up to 1/8 mm.
 30.0-32.5: Lost core.
 34.9-37.3: About 40% qtz+carb lenses at sharp angle to
 core, somewhat parallel.
 37.3-38.4: Over 60% quartz.
 53.3-55.8: QUARTZ VEIN (2.5 ft.) w rusty carbonate spots.
 70.9-74.8 : MARIPOSITE-CARBONATE. Bright emerald green, quite massive,
 w white carbonate stringers and lenses. Some fine pyrite.
 74.8-128.0 : GRAY-GREEN CARBONATE-TUFF. Lt greenish gray. About half
 carbonate. Some small amounts of mariposite present but
 not enough to give distinctive color. Slightly schistose
 and abundant small carbonate lines and lenses. Fairly
 abundant pyrite.
 75.0-76.1: QUARTZ VEIN. White.
 128.0-135.2: MARIPOSITE-CARBONATE-TUFF. As above but w mariposite, fine
 pyrite.
 130.8-133.8: Lost core.
 135.2-140.2: GRAY-GREEN CARBONATE-TUFF. As above.
 135.6-136.4: QUARTZ VEIN. Rusty bits of carbonate.
 136.8-137.2: QUARTZ VEIN. " " " "
 140.2-141.8: QUARTZ VEIN. White. Some chlorite-mariposite-carbonate
 remnants.
 141.8-142.8: LOST CORE.
 142.8-175.0: MARIPOSITE-CARBONATE. Abundant (30%) qtz-carb lenses.
 146.3-148.3: QUARTZ VEIN.
 155.0-155.9: QUARTZ VEIN.
 160.5-161.9: QUARTZ VEIN.
 Grades into next.
 175.0-195.0: CARBONATE-TUFF. Greenish gray. Chloritic w about 30% qtz-
 carb lenses and lines.
 180.6-181.6: Lost core.
 187.4-188.9: QUARTZ-CALCITE VEIN. White.
 188.9-189.8: No core.
 195.0-200.6: TALCY GREENSTONE. Dk greenish gray. Chloritic and talcy,
 soft, altered, massive.
 200.6-205.4: LOST CORE.
 205.4-207.2: TALCY GREENSTONE. As above but crumbled. Some qtz fragments.
 207.2-208.7: LOST CORE.
 208.7-212.0: CARBONATIZED GREENSTONE. Much brown carbonate in specks and
 tiny veinlets.

(cont. pg 2)

212.0-213.1:QUARTZ VEIN. White. Greenstone fragments.
213.1-213.5:GREENSTONE.
213.5-215.0:LOST CORE.
215.0-215.6:QUARTZ VEIN.
215.6-217.0:LOST CORE.
217.0-346.0:GREENSTONE. Gray-green, altered, slightly talcy.
217.0-221.5: 20% qtz stringers.
240.0-242.4; 243.5-247.0; 252.6-254.4: Lost core.
Rapidly passes into massive andesite.

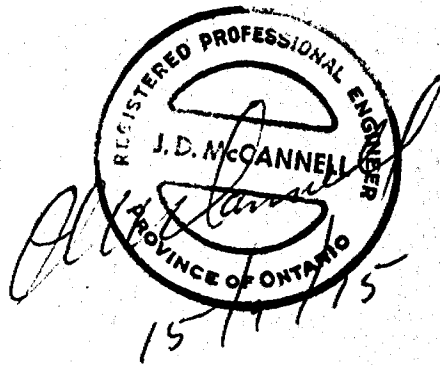

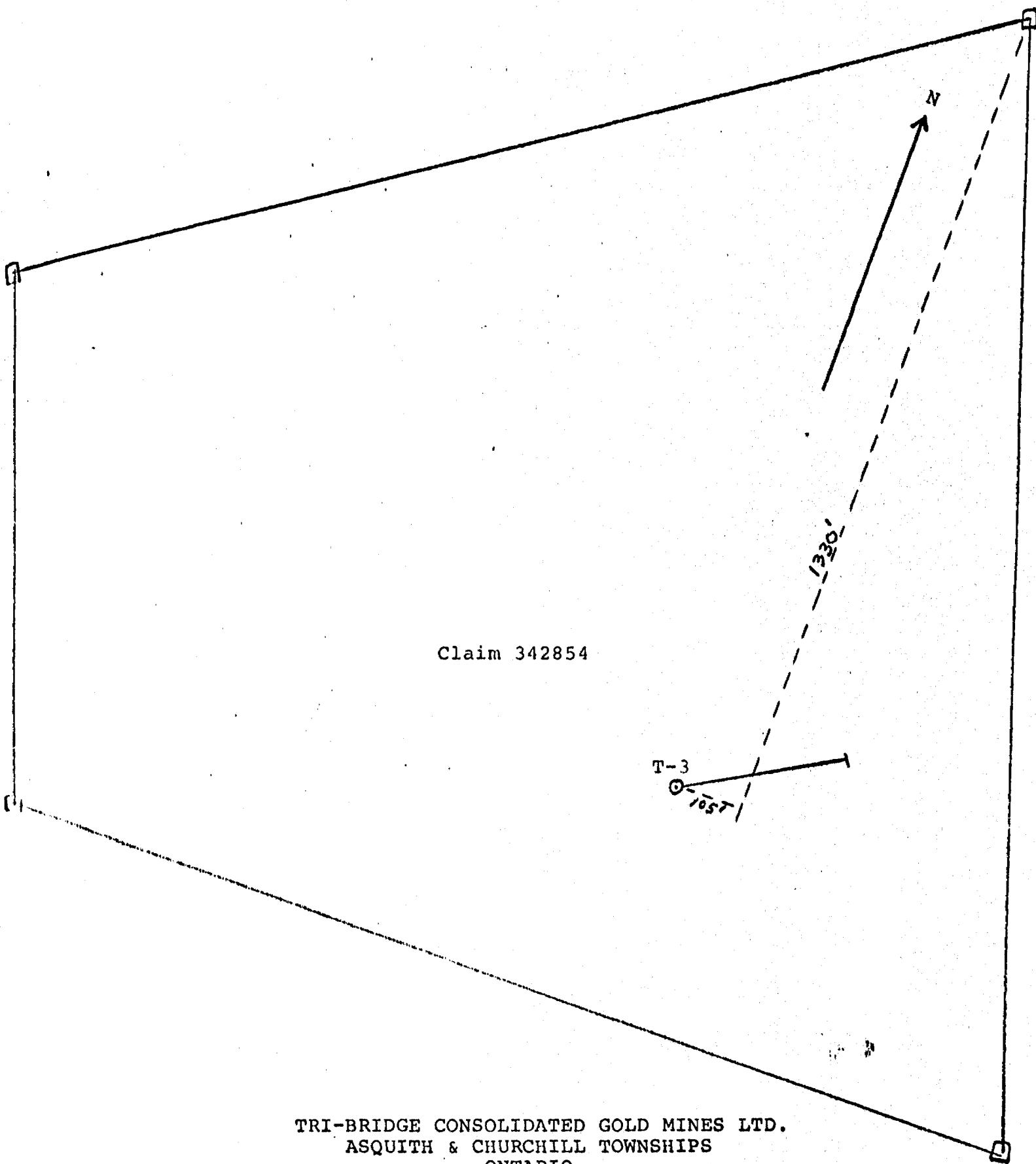

Claim 342854

TRI-BRIDGE CONSOLIDATED GOLD MINES LTD.
ASQUITH & CHURCHILL TOWNSHIPS
ONTARIO
Scale 1" = 200'



15/9/75