

2.4349

SERVICES EXPLORATION SERVICES Enq. Reg'd

TELEPHONE: (819) 762 5498

81 RUE GATINEAU STREET
NORANDA, QUE., CANADA
J9X 1N1

Dessin et Reproduction
Labournement de Claims
Coutage de Lignes

Drafting and Reproduction Services
Claim Staking
Line Cutting



41P11SW0250 2.4349 ASQUITH

010

M A G N E T O M E T E R S U R V E Y

J. SAUVE CLAIM GROUP

Asquith Twp.

Ontario

RECEIVED

NOV 3 01981

MINING LANDS SECTION

October 1981

L.D.

I - INTRODUCTION: A magnetometer survey was undertaken during the month of October, 1981, on the J. Sauvé claim group, as a preliminary phase to an elaborate exploration program.

II - PROPERTY: The property consists of 10 contiguous claims numbered as follows:

L 579123, L 579125, L 579127, L 579128, L552910
620914, 620915, 620916, 620917 & 620918.

III - LOCATION & ACCESSIBILITY:

The said property is located in the northwestern quadrant of Asquith Twp., south of Highway 560 at an approximate distance of 1 mile southwest of the town of Shiningtree, Ont.

The area is readily accessible as the northwestern corner of the claim group intercepts Highway 560.

IV - MAGNETOMETER SURVEY:

The survey was carried out on a previously cut grid whose 3,600' long base line strikes at 90°; cross lines occur at every 400' and extend to the south up to a maximum distance of 2,200' and to the north for a maximum distance of 1,800'.

A total of 8.0 line miles have thus been cut and surveyed.

An Exploranium Geometrics G-816 proton magnetometer was used for the survey: readings were taken at every 50' intervals.

Numerous narrow and discontinuous anomalies have been outlined throughout the grid area, the alignment of which suggests an east-west geological trend.

V - CONCLUSIONS & RECOMMENDATIONS:

Because of the numerous gold occurrences in the immediate area of the claim group, the property should be subject to systematic prospecting including a detailed geological survey.

Respectfully submitted:

E. Chartré: 

Oct. 30, 1981.

ASQUITH TWP

12 W
8 W
4 W
L - O
4 E
8 E
12 E
16 E
20 E
24 E

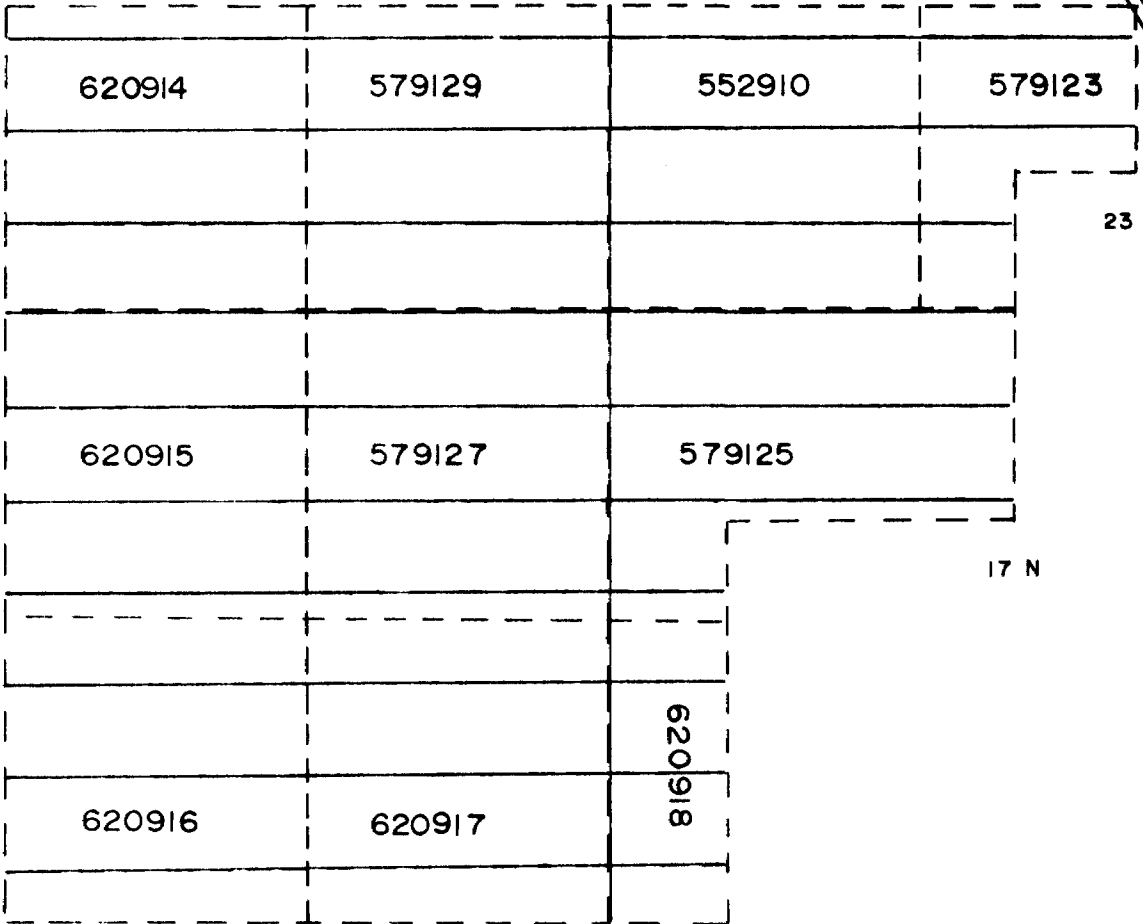

26 S

B.L.

5 N

J. SAUVE CLAIM GROUP

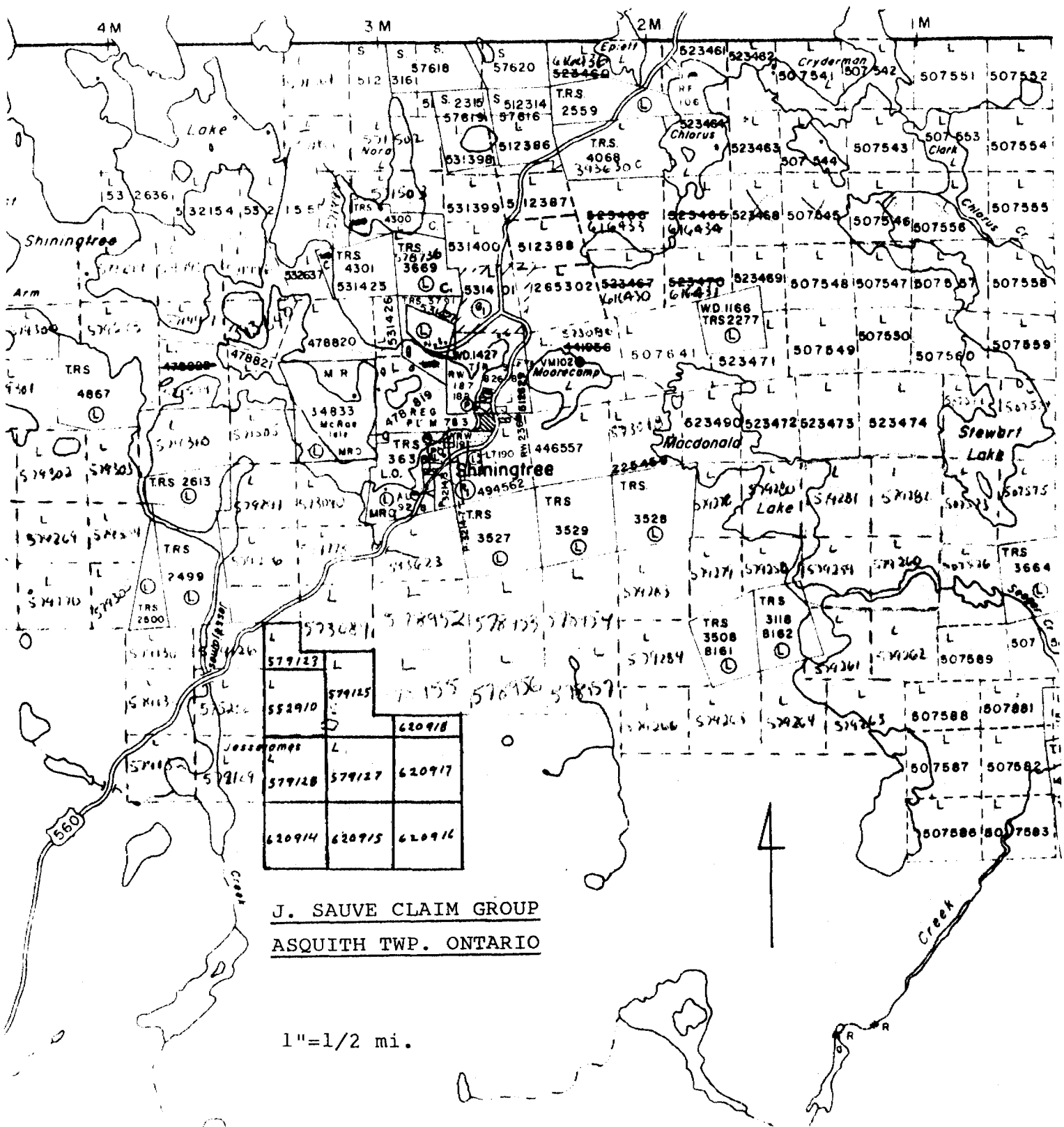

J. SAUVE CLAIM GROUP
ASQUITH TWP. ONTARIO

1"=1/2 mi.

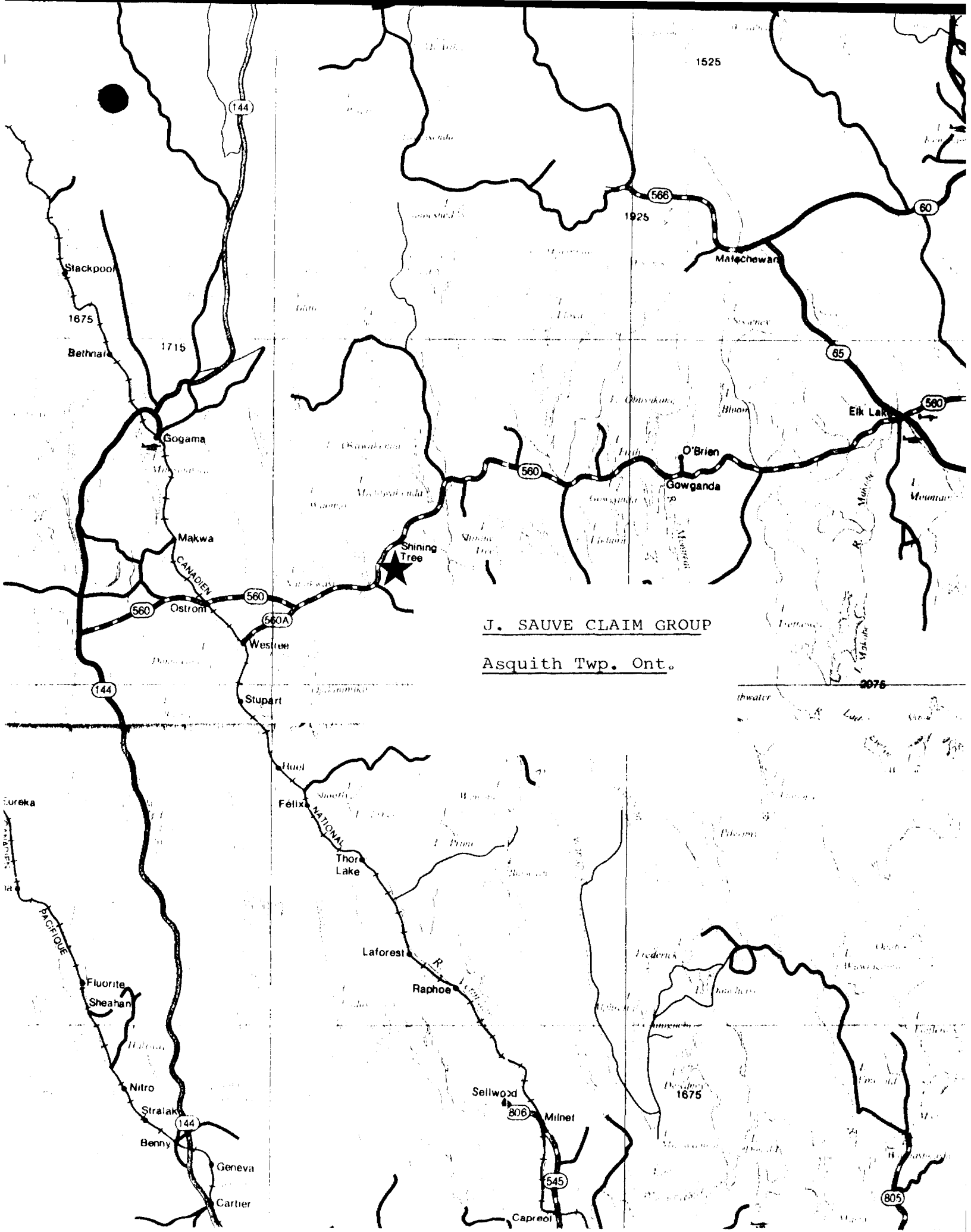

J. SAUVE CLAIM GROUP
Asquith Twp. Ont.

2076



41P11SW0250 2.4349 ASQUITH

900



Ministry of
Natural
Resources
Ontario

Report of Work
(Geophysical, Geological,
Geochemical and Expenditures)

Instructions: - Please type or print. # 516
- If number of mining claims traversed exceeds space on this form, attach a list.
Note: - Only days credits calculated in the "Expenditures" section may be entered in the "Expend. Days Cr." columns
- Do not use shaded areas below.

2.4349

The Mining Act

| | | | |
|--|--|---|-------------------------------------|
| Type of Survey(s) Magnetometer | | Township or Area Asquith | |
| Claim Holder(s) Joe Sauvé | | Prospector's Licence No. 32175 | |
| Survey Company Exploration Services Reg'd | | Survey Dates (linecutting to office) Day Mo. Yr. 03 10 81 30 10 81 | Total Miles of line Cut 8 |
| Name and Address of Author (of Geo-Technical report) E. Chartré 765 boul. Québec, Rouyn, Qué. C.P. 428 | | | |

Special Provisions Credits Requested

| Instructions | Geophysical | Days per Claim |
|---|-------------------|----------------|
| For first survey: Enter 40 days. (This includes line cutting) | - Electromagnetic | 40 |
| | - Magnetometer | |
| For each additional survey: using the same grid: Enter 20 days (for each) | - Radiometric | |
| | - Other | |
| | Geological | |
| | Geochemical | |

Man Days

| Instructions | Geophysical | Days per Claim |
|---|-------------------|----------------|
| Complete reverse side and enter total(s) here | - Electromagnetic | |
| | - Magnetometer | 40 |
| | - Radiometric | |
| | - Other | |
| | Geological | |
| | Geochemical | |

Airborne Credits

| Note: Special provisions credits do not apply to Airborne Surveys. | | Days per Claim |
|--|-----------------|----------------|
| | Electromagnetic | |
| | Magnetometer | |
| | Radiometric | |

Expenditures (excludes power stripping)

Type of Work Performed

Performed on Claim(s)

Calculation of Expenditure Days Credits

Total Expenditures ÷ = Total Days Credits

Instructions
Total Days Credits may be apportioned at the claim holder's choice. Enter number of days credits per claim selected in columns at right.

Report Completed

Date of Report Recorded Holder or Agent (Signature) *E. Chartré*

Mining Claims Traversed (List in numerical sequence)

| Mining Claim | | | Mining Claim | | |
|--------------|--------|------------------|--------------|--------|------------------|
| Prefix | Number | Expend. Days Cr. | Prefix | Number | Expend. Days Cr. |
| L | 579123 | 40 | | | |
| L | 579125 | 40 | | | |
| L | 579127 | 40 | | | |
| L | 579128 | 40 | | | |
| L | 552910 | 40 | | | |
| | 620914 | 40 | | | |
| | 620915 | 40 | | | |
| | 620916 | 40 | | | |
| | 620917 | 40 | | | |
| | 620918 | 40 | | | |

RECEIVED
OCT 30 1981
AM 7:18 19:10 11:21 11:23 14:15 16

RECEIVED
NOV 13 1981
MINING LANDS SECTION

Total number of mining claims covered by this report of work.

For Office Use Only

Total Days Cr. Recorded Date Recorded

Date Approved as Recorded Mining Recorder *[Signature]*

Region/ Branch Director *[Signature]*

Certification Verifying Report of Work

I hereby certify that I have a personal and intimate knowledge of the facts set forth in the Report of Work annexed hereto, having performed the work or witnessed same during and/or after its completion and the annexed report is true.

Name and Postal Address of Person Certifying



Mining Lands Comments

[Handwritten signature]

To: Geophysics

Mr Barlow

Comments

Approved

Wish to see again with corrections

Date
JUN 15 / 82

Signature
R. Barlow

To: Geology - Expenditures

Comments

Approved

Wish to see again with corrections

Date

Signature

To: Geochemistry

Comments

Approved

Wish to see again with corrections

Date

Signature

To: Mining Lands Section, Room 6462, Whitney Block.

(Tel: 5-1380)

December 7, 1981

2.4349

Office of the Mining Recorder
Ministry of Natural Resources
4 Government Road East
P.O. Box 984
Kirkland Lake, Ontario
P2N 1A2

Dear Sir:

We have received reports and maps for a Geophysical
(Magnetometer) Survey submitted under Special Provisions
(credit for Performance and Coverage) on Mining Claims
L.620914 et al, in the Township of Asquith.

This material will be examined and assessed and a statement
of assessment work credits will be issued.

Yours very truly,

E.F. Anderson
Director
Land Management Branch

Whitney Block, Room 6450
Queen's Park
Toronto, Ontario
M7A 1W3
Phone: 416/965-1380

J. Skura/bk

cc: E. Chartra
Rouyn, Quebec

cc: J. Sauve Claim Group
Noranda, Quebec

Churchill Twp. - M.719

THE TOWNSHIP OF
OF

ASQUITH

DISTRICT OF
SUDBURY

LARDER LAKE
MINING DIVISION

SCALE: 1-INCH=40 CHAINS

LEGEND

| | |
|-----------------------|----------|
| PATENTED LAND | ● or (P) |
| CROWN LAND SALE | C.S. |
| LEASES | (L) |
| LOCATED LAND | Loc. |
| LICENSE OF OCCUPATION | L.O. |
| MINING RIGHTS ONLY | M.R.O. |
| SURFACE RIGHTS ONLY | S.R.O. |
| ROADS | — |
| IMPROVED ROADS | — |
| KING'S HIGHWAYS | — |
| RAILWAYS | — |
| POWER LINES | — |
| MARSH OR MUSKEG | — |
| MINES | ⊛ |
| CANCELLED | C. |
| PATENTED FOR S. R. O. | e |

NOTES

400' Surface Rights Reservation along
the shores of all lakes and rivers

| | |
|--------------------------------|---|
| SAND and GRAVEL | RESERVES |
| (1) MTC Pit 489 | (1) MNR SRO Reserve File 163003 |
| (2) MTC Gravel Pit No 3C-14 | (2) M.N.R. S.R.O. RESERVE FILE 163005 |
| (3) M.T.C. PIT 3C-16 | (3) Waste Disposal Site Buffer Zone 2/9/81 |
| (4) Gravel Pit File 12-4425 | |
| (5) M.T.C. GRAVEL PIT. 3C-15 | |

Areas withdrawn from staking under Section
43 of the Mining Act (R.S.O. 1970).

| Order No | File | Date | Disposition |
|--------------|--------|---------|-------------|
| (6) W. 91/81 | 100017 | 20/9/81 | S.R.O. |

DATE OF ISSUE
JUL 16 1982
Ministry of Natural Resources
TORONTO

PLAN NO. - **M.637**

ONTARIO
MINISTRY OF NATURAL RESOURCES
SURVEYS AND MAPPING BRANCH

Miramichi Twp. - M.865

Fawcett Twp. - M.803

Sheard Twp. - M.1107

2.4349



41P11SW0250 2.4349 ASQUITH

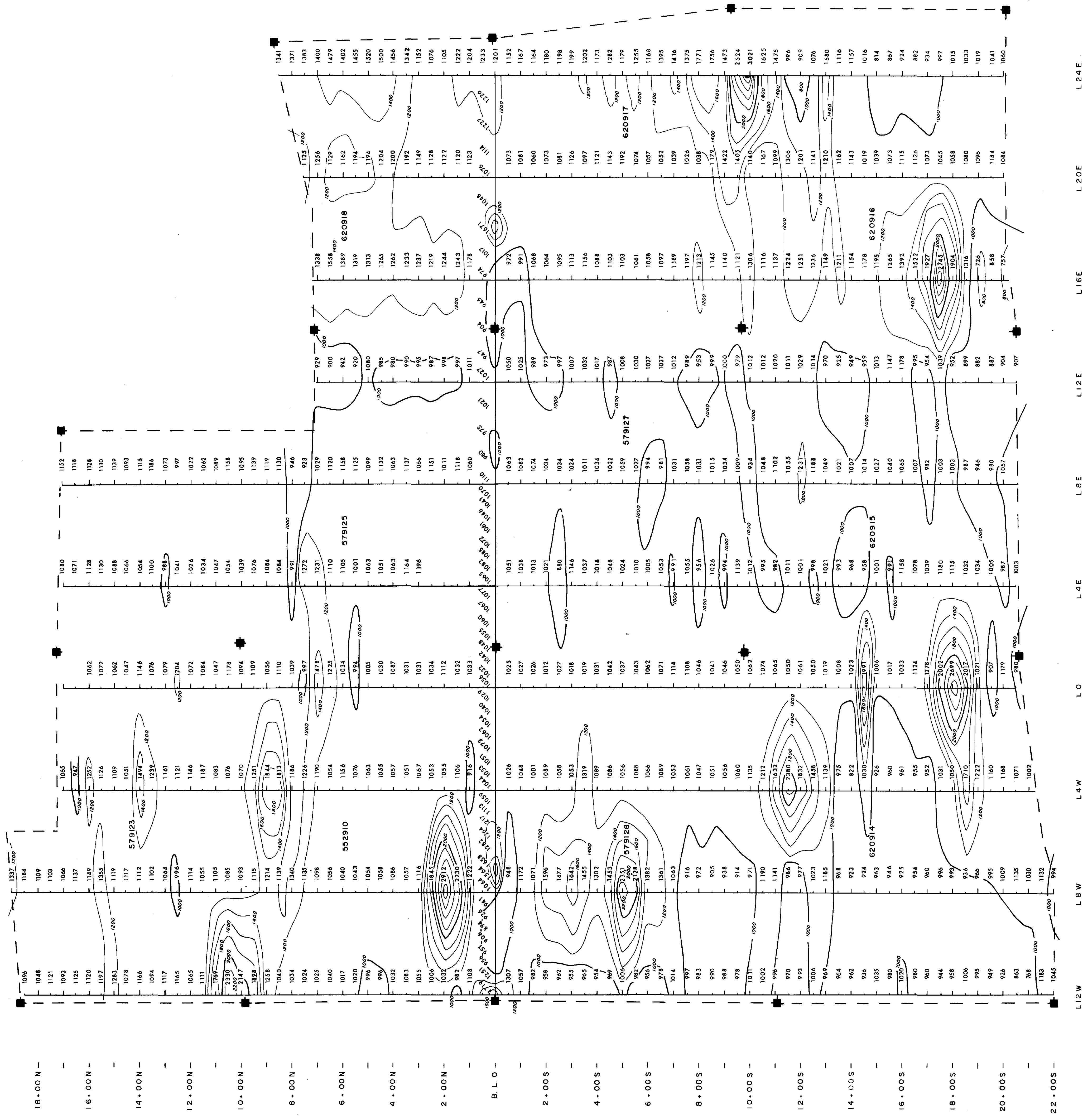
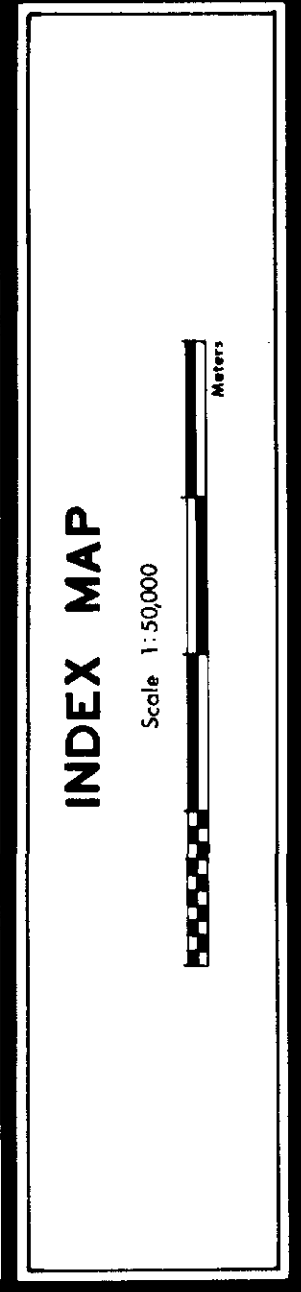
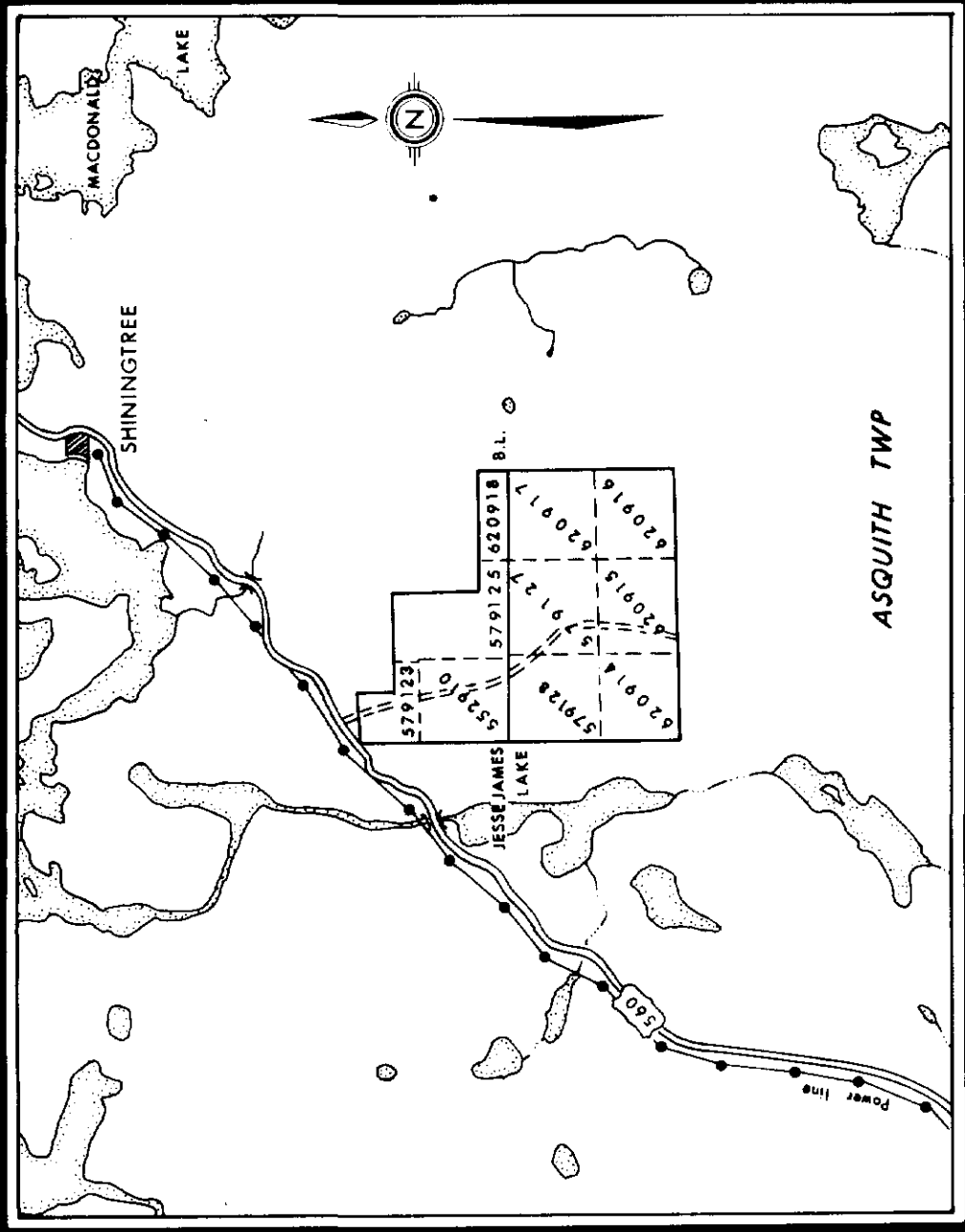

All readings in range of 58 000 gammas

MAGNETOMETER SURVEY
FOR
J. SAUVE

PROJECT: ASQUITH
SURVEYED BY: P.S.
DRAWN BY: M.A.
SERVICES: EXPLORATION SERVICES

DATE: SEPT. 81
SCALE: 1:200'
EMRG
REC'D

INSTRUMENT:
Geometrics
G-816
TWP Asquith