

DIAMOND DRILLING



010

TOWNSHIP: Asquith

REPORT No.: 22

WORK PERFORMED BY: Timmins Gold Resources Ltd.

<u>CLAIM No.</u>	<u>HOLE No.</u>	<u>FOOTAGE</u>	<u>DATE</u>	<u>NOTE</u>
L 512315	STI-1	151.0	Feb/81	(1)
	STI-3	123.0	Apr/81	(1)
	<u>2</u>	<u>274.0</u>		

NOTES: (1) #225-82

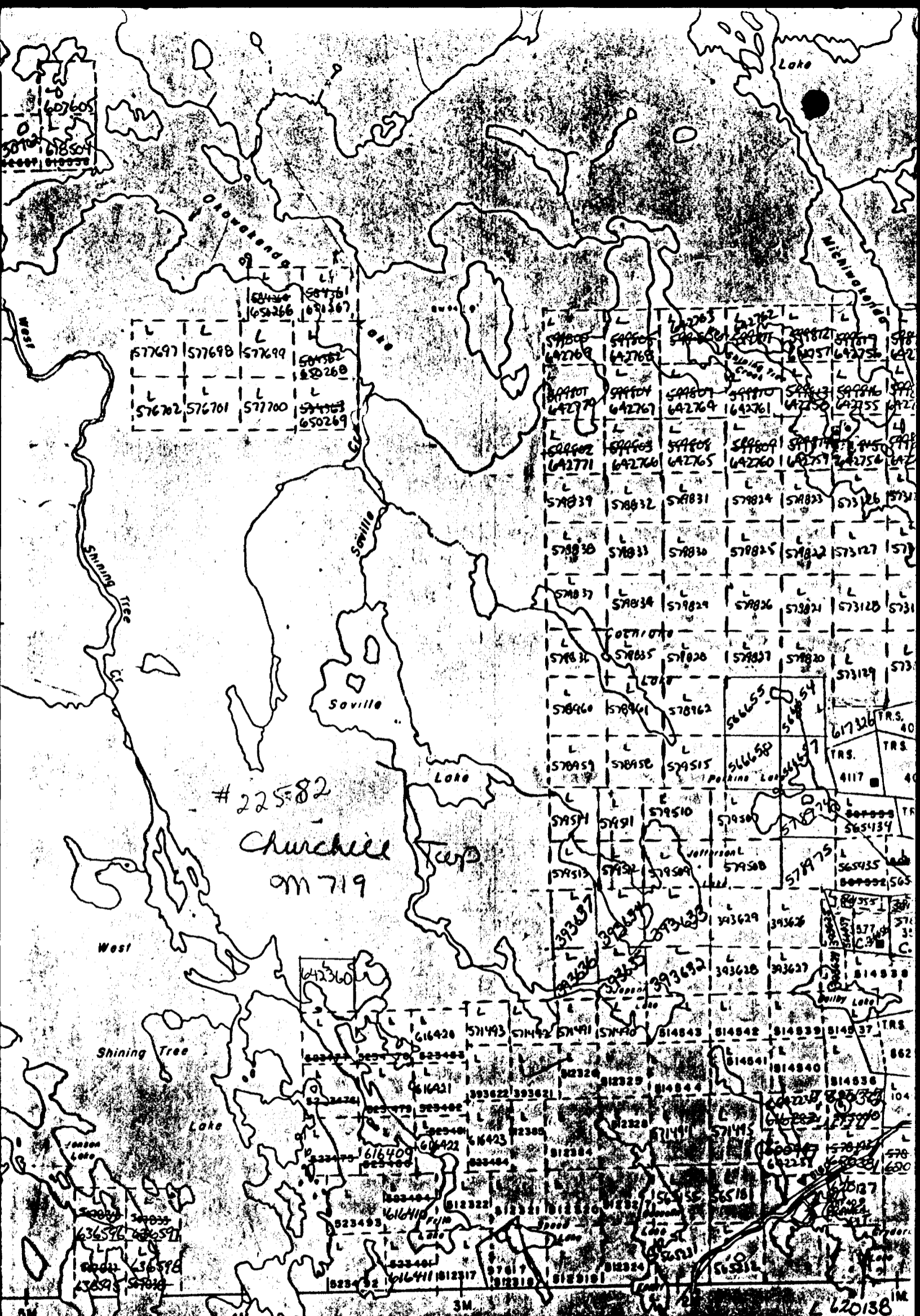

Asquith Twp. M. 637

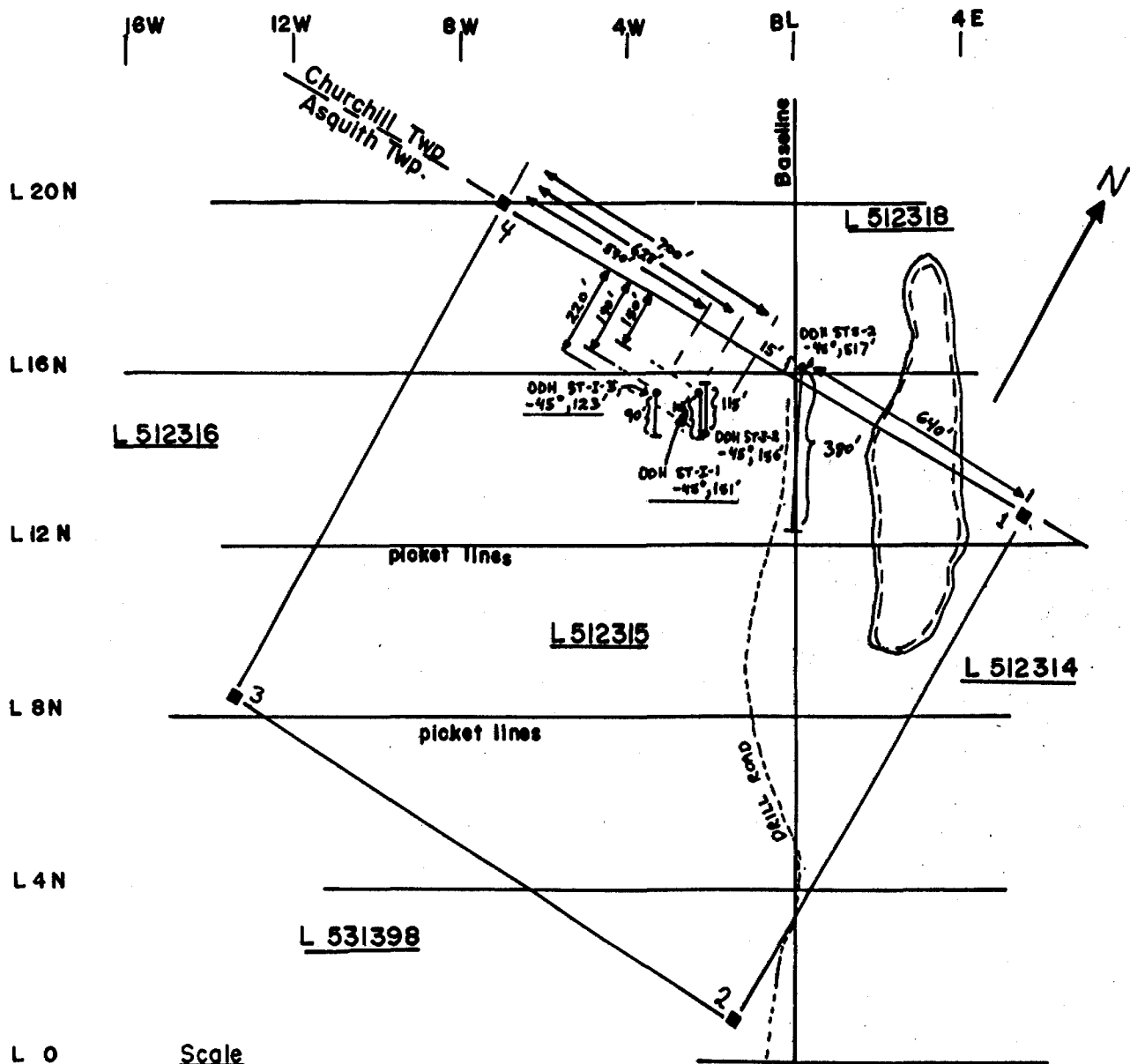

Scale
1" to 400'

Location Sketch
Diamond Drill Holes
STS-2, ST-I-1,
ST-I-2, ST-I-3
Asquith Twp. Ont.



TIMMINS GOLD
RESOURCES LTD.
 SHINING TREE I PROPERTY

DIP TEST			LEVEL		ELEVATION		HOLE No. STI-1	
FOOTAGE	ANGLE		LOCATION 15+50 N		BEARING 170°		SHEET No. 1 of 4	
	RECORDING	CORRECTED	SECTION 2+30 W		LENGTH 151'		LOGGED BY P. Born	
			LATITUDE -		CORE SIZE XRT		PURPOSE Exploration	
			DEPARTURE -45°		FINISHED February, 1981		TOT. RECOVERY	

FOOTAGE		DESCRIPTION	GRADE ESTIMATE	SAMPLE NO.	FOOTAGE			ASSAYS				RECOVERY	
FROM	TO				FROM	TO	LENGTH					RUN	SHORT
0	12	OVERBURDEN											
2.0	22.0	Basalt											
		f.g. basaltic rock type with chlorite 30% - 40% rather massive to weakly foliated - 40° to CA. Alteration - slight - chlorite + minor siderite + spotty epidote (16.3 - 17.0) no distinctive flow features but some scattered 1% pyrite, somewhat rusty in a few places with minor shearing Veining - mainly qtz veining with lesser qtz-carb veining which may also have minor siderite (yellow brown colour) generally 5% veining - minor vein (6.0 - 16.3)											
22.0	30.0	QTZ Vein											
		Generally one main vein but slightly stockwork in places with sections (6") of sericitized "rhyolite" f.g. (presumably) volcanic rock at: 24.5-25.5'; 27.9-28.1, 29.0-29.5' the vein material f.g. white colour, mainly qtz with lesser (minor) calcite. Alteration - 1-3% siderite + 1-3% spotty fuchsite (Cr mica)- bright green colour Sulphides - trace (<1%) pyrite + oreplace trace cpy at 27.8'											
30.0	151.0	Rhyolite											
		F.g massive (no fabric) hard rock, could be considered as a rhyolite although it has no qtz eyes, light greenish-grey colour (type of yellow) No flow features or bedding or any other pyroclastic features Alteration variable, with definite sericitization (usually strong)+ variable silicification + poss. siderite in a few places											

Peter Born

FOOTAGE		DESCRIPTION	GRADE ESTIMATE	SAMPLE NO.	FOOTAGE			ASSAYS				RECOVERY	
FROM	TO				FROM	TO	LENGTH					RUN	SHORT
		contact at 139.0 very distinct with hm'd section - 75° to CA 1% py associated with chlt veinlet and in groundmass											
		139.0 - 140 med pk-red colour f.g. massive homogeneous tr py											
		140-140.4 andesite section pale green colour											
		140.4 - 144.7 broken and lost core fractured andesite section med green colour with intense fracturing intense Fe (limonitic) staining in proximity to veining 3% black chlorite veinlets <1 mm wide throughout section tr amt of py - but less than before core is broken - black chlorite is abundant											
		144.7 - 146 med red-plum colour hm'd rhyolite f.g. massive homogeneous 1-2% f.g. py in fractured and dissem'd throughout groundmass chlorite hairline veinlets cross cut by O-C veinlets.											
		146-151 broken and mainly ground - lost core											
151		End of hole ST-I-1 6 boxes											

Handwritten signature



TIMMINS GOLD
RESOURCES LTD.
 SHINING TREE I PROPERTY

DIP TEST		LEVEL	ELEVATION	HOLE No. ST-I-3
FOOTAGE	ANGLE		LOCATION 15+50 N	SHEET No. 1 of 3
	RECORDING	CORRECTED	SECTION 2+70 W	LOGGED BY A Born
			LATITUDE	PURPOSE Exploration
			DEPARTURE -45°	TOT. RECOVERY
			FINISHED April 13-27, 1981	
			CORE SIZE XRT	
			LENGTH 119'+4'OB=123'	
			BEARING 170°	

FOOTAGE		DESCRIPTION	GRADE ESTIMATE	SAMPLE NO.	FOOTAGE			ASSAYS				RECOVERY	
FROM	TO				FROM	TO	LENGTH					RUN	SHORT
0	4	OVERBURDEN											
		Footages approx due to lost core											
4	11.5	QZ Siderite Veining In sericitized rhyolite - aphanitic, lt yellow-green colour, massive < 50% veining in this section trace f.g. specks of py											
11.5	19	Chloritized Andesite Bright med green colour, fine-grained moderately schistose Q-C vein contains 3-3% f.c. + black chlorite is 2' hairline qz veins cross cut main vein < 1% weathered py											
19	22	Altered Zone Strongly sericitized - fc - bearing bright green fc occurs as micaceous material in association with QV carrying 1-2% py as well as specks in sericitized zone (may be chl) 21' strongly brecciated + gossaned zone over 0.2'											
22	49.5	Sericitized (silicified) Rhyolite med green to green-yellow colour fine grained massive 2% Q-cbt veining which are hairline to 1cm width 30.5 low specks of f.g. silver-grey metallic mineral in cct. veining - arsenopyrite/telluride/silver Section is generally void of py - < 0.5% specks in association with veining											

A Born

