

Diamond Drilling

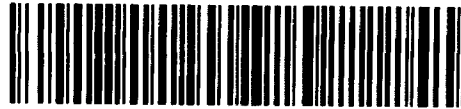

41P11SW0279 11 ASQUITH

010

Township of Asquith

Report NO: 11

Work performed by: Tri-Bridge Mines Ltd.

Claim NO	Hole NO	Footage	Date	Note
L342765	T-1	354'	June/75	(1)
	T-2	365'	June/75	(1)
	<u>2</u>	<u>719'</u>		

Notes: (1) #212-75

Churchill Twp. - M. 719

OF

ASQUITH

m637

DISTRICT OF  
SUDBURY

LARDER LAKE  
MINING DIVISION

SCALE: 1-INCH=40 CHAIN

LEGEND

- PATENTED LAND ● or ⊕
- CROWN LAND SALE CS
- LEASES ⊙
- LOCATED LAND L
- LICENSE OF OCCUPATION LO
- MINING RIGHTS ONLY M.R.
- SURFACE RIGHTS ONLY S.R.
- ROADS =====
- IMPROVED ROADS =====
- KING'S HIGHWAYS =====
- RAILWAYS =====
- POWER LINES -----
- MARSH OR MUSKEG \* \*
- MINES X
- CANCELLED C
- PATENTED FOR S. R. O. ○

NOTES

**ASQUITH & CHURCHILL TOWNSHIP**  
**# 212**  
**TRI-BRIDGE CONS. GOLD MINES**

Fawcett Twp. - M. 808

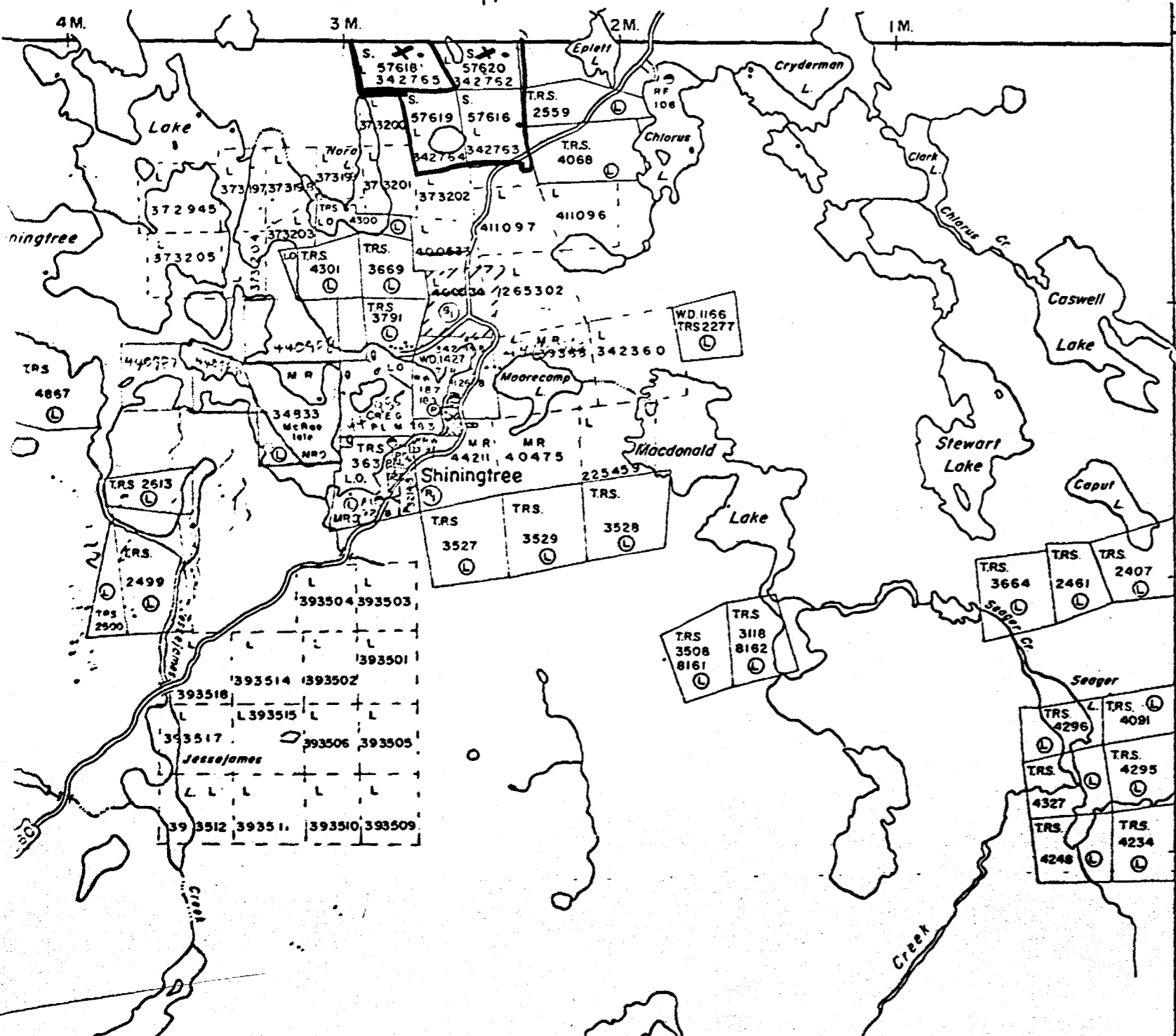

DIAMOND DRILL RECORD

PROPERTY	: Tri-Bridge Mines Ltd. <i>Asquith</i>	HOLE NO.	: T-1
LOCATION	: Speed Lake Area, MacMurchy Twp., District of Sudbury, Ontario.	DIP	: -45°
		BEARING	: N 60° E
CLAIM NO.	: 342765	LENGTH	: 354 ft.
LATITUDE	: 22-N	BEGUN	: June 13, 1975
DEPARTURE	: 1+00 W	COMPLETED	: June 19, 1975
DRILLED BY	: Ferguson Mining Services	LOGGED BY	: H. Dowhaluk
		CORE SIZE	: IAX

-----

0.0-13.7 :OVERBURDEN. Casing.  
 13.7-30.3 :RHYOLITE. Lt buffy gray. F-grd to dense, may be tuffaceous  
 in part. Hard, massive, compact. Shattered somewhat  
 with chlorite in cracks. Does not effervesce (no carb-  
 onate). Scattered fine pyrite cubes. Grades into next.  
 22.5-23.8: Brecciated Zone. Pieces of quartz up to 1/2",  
 angular, in chloritic matrix  
 23.4: 1" white calcite at 90°.  
 Many 1/4" qtz veinlets.

30.3-104.0 :KAOLINITIC ASHSTONE & TUFF. Med green-gray w ash-size part  
 icles and abundant white specks of kaolin. Some fine  
 quartz lines and stringers. High quartz content as  
 small grains, often gray-blue. Some carbonate present.  
 56.1-58.2: QUARTZ VEIN. White. Few small fragments  
 of tuff and carbonate. Very rare py mostly on edges.

104.0-124.0 :PINK KAOLINITIC ASHSTONE & TUFF. As above but pinkish  
 in color w some small gray sections. Highly feldspathic  
 Well mineralized with fine crystals of pyrite dissemin-  
 ated throughout. Py content about 1% or slightly more.  
 Abundant fine quartz lines and somewhat brecciated in  
 spots.

124.0-125.8 :KAOLINITIC ASHSTONE & TUFF. As before. Not much py.  
 125.8-131.3 :QUARTZ VEIN ZONE. White. Few smears and remnants of chl-  
 oritic material, often w a little py. Minor rusty  
 carbonate in fractures.  
 125.8-126.4: Qtz stringers and schist w py.

131.3-149.0 :KAOLINITIC TUFF. As before. Silicified from 145.0-149.0.  
 149.0-150.8 :QUARTZ VEIN. White. Chloritic streaks.  
 150.8-183.0 :PINK-GRAY TUFF. Grayish to pinkish, carbonate present  
 and abundant 1/4" veinlets of qtz-carbonate. Occasional  
 sprinkling of fine pyrite and minor specular hematite.  
 Pinkish phases tend to carry more py.

183.0-226.5 :GRAY CARBONATE-TUFF. Lt gray w greenish tinge and tiny  
 white specks of plagioclase. Silicified in places and  
 possibly very small amounts of mariposite. Low pyrite  
 in places as disseminated tiny crystals.  
 211.0-212.2: QUARTZ VEIN. White, w chloritic material.  
 Rusty carbonate in fractures.  
 213.5-213.7: QUARTZ VEIN. Few specks of py.

226.5-229.5 :PINK RHYOLITE. Very dense, hard and siliceous. Some fine  
 py.

229.5-234.6 :CARBONATE. Overall lt greenish gray color with rather dull  
 grass-green chlorite-mariposite streaking. Py 1/2%.

234.6-239.9 :QUARTZ VEIN. Abundant streaks and remnants of chl-carb-  
 mariposite. Very little py. Rusty bits of carbonate.  
 About 85-90% qtz.

239.9-251.7 :CARBONATE. Mostly massive carbonate w blotchy spots of  
 chlorite-mariposite. Very sparse pin-point py. Some  
 rusty carbonate sections (from weathering).

(cont.)

- 251.7-252.7: QUARTZ VEIN. White, greasy-looking. Some carbonate & chlorite inclusions w minor py. Grading into next.
- 252.7-270.3: CHLORITIC CARBONATE. Transitional from green carbonate to chloritic carbonate-tuff. Gradually increasing chlorite and decreasing carbonate. Abundant qtz-carb stringers.
- 252.7-255.4: Over 50% qtz-carb veinlets & lenses. Slight py.
- 270.3-272.2: QUARTZ VEIN. White, some chloritic remnants on far end.
- 272.2-274.2: CHLORITIC TUFF. 50% carbonate lenses.
- 274.2-354.0: ANDESITE. Dk green-blue-gray. Dense, massive. Flow breccia in spots, i.e., 292.5, 296.9. Occasional tuffaceous fragment. Minor py or specular hematite on fractures.



DIAMOND DRILL RECORD

PROPERTY	: Tri-Bridge Mines Ltd. <i>Asquith</i>	HOLE NO.	: T-2
LOCATION	: Speed Lake Area, <del>MacMurphy</del>	DIP	: -45°
	Twsp., District of Sudbury,	BEARING	: N 60° E
	Ontario.	BEGUN	: June 22, 1975
CLAIM NO.	: 342765	COMPLETED	: June 27, 1975
LATITUDE	: 10' N30°W of L-30-N	LOGGED BY	: H. Dowhaluk
DEPARTURE	: 0+50 W	CORE SIZE	: IAX
DRILLED BY	: Ferguson Mining Services		

0.0-9.0 : OVERBURDEN. Casing.  
 9.0-89.8 : RHYOLITE. Buff to pinkish and lt gray. Appears to be shattered into blocks w chlorite in cracks. Some small tuffaceous sections. Small amounts of carbonate in the cracks but otherwise quite siliceous. Small qtz and qtz-carbonate lenses, veinlets, etc. Pyrite disseminated throughout in small amounts (1/2-1 %).  
 15.8-18.8: CHLORITIC TUFF. Med green-gray. F-med grd (dust to ash size), some carbonate.  
 56.2-58.2: PINK RHYOLITE.  
 89.8-139.0 : GRAY TUFF. Lt-med gray. F-grd w some feldspathic material. Contains some carbonate. Medium hardness, quite uniform and fairly massive. Disseminated pyrite (less than 1%).  
 139.0-241.5: CARBONATE-ACID TUFF. Quite siliceous, lt gray to buffy w carbonate a noticeable constituent. Pyrite less than 1%.  
 185.0-189.5; 230.7-234.7: Lost core.  
 241.5-365.0: TALCY ALTERED ANDESITE. Chloritic and talcy, partially altered to soapstone. Dk gray w soapy feel, soft. About 5-10% qtz-carb lensing.  
 241.2-243.7: Over 50% qtz-carb.  
 Decreasing qtz-carb; after 300', mostly plain altered andesite.



15/6/51

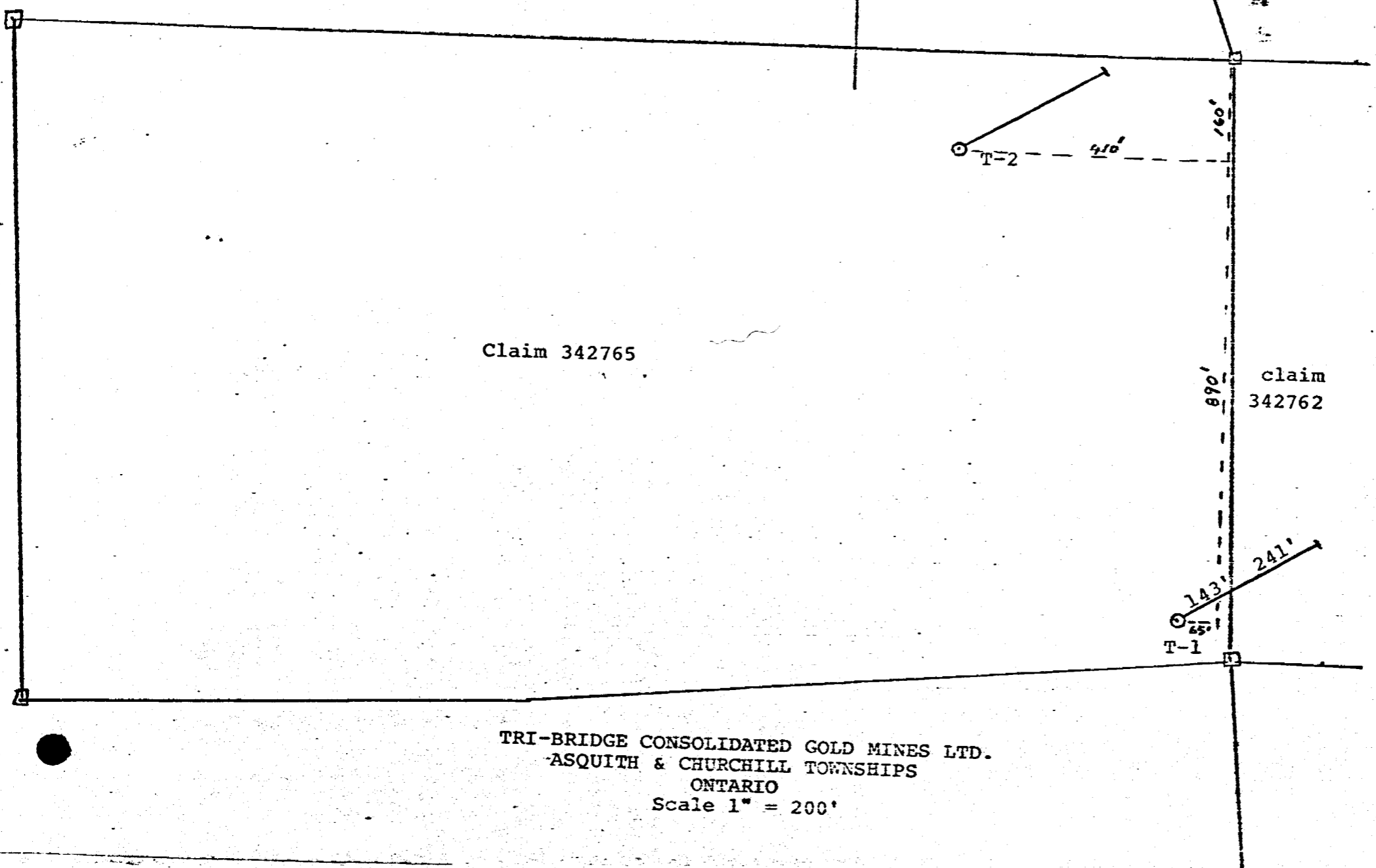
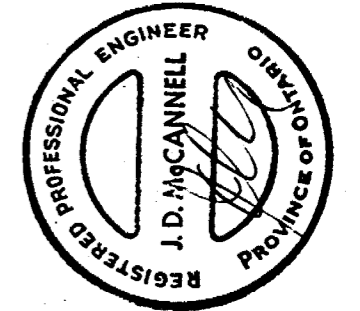

Claim 342765

claim 342762

TRI-BRIDGE CONSOLIDATED GOLD MINES LTD.  
ASQUITH & CHURCHILL TOWNSHIPS  
ONTARIO  
Scale 1" = 200'