

Diamond Drilling

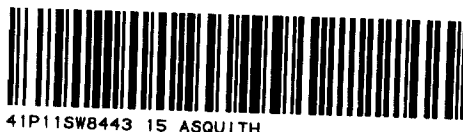

010

Township ASQUITH

Report NO 15

Work performed by: William J. Sullivan

Claim NO	Hole NO	Footage	Date	Note
L 532154	79-1	100.0	Sept/79	(1)

Notes: (1) # 199-79

79-1

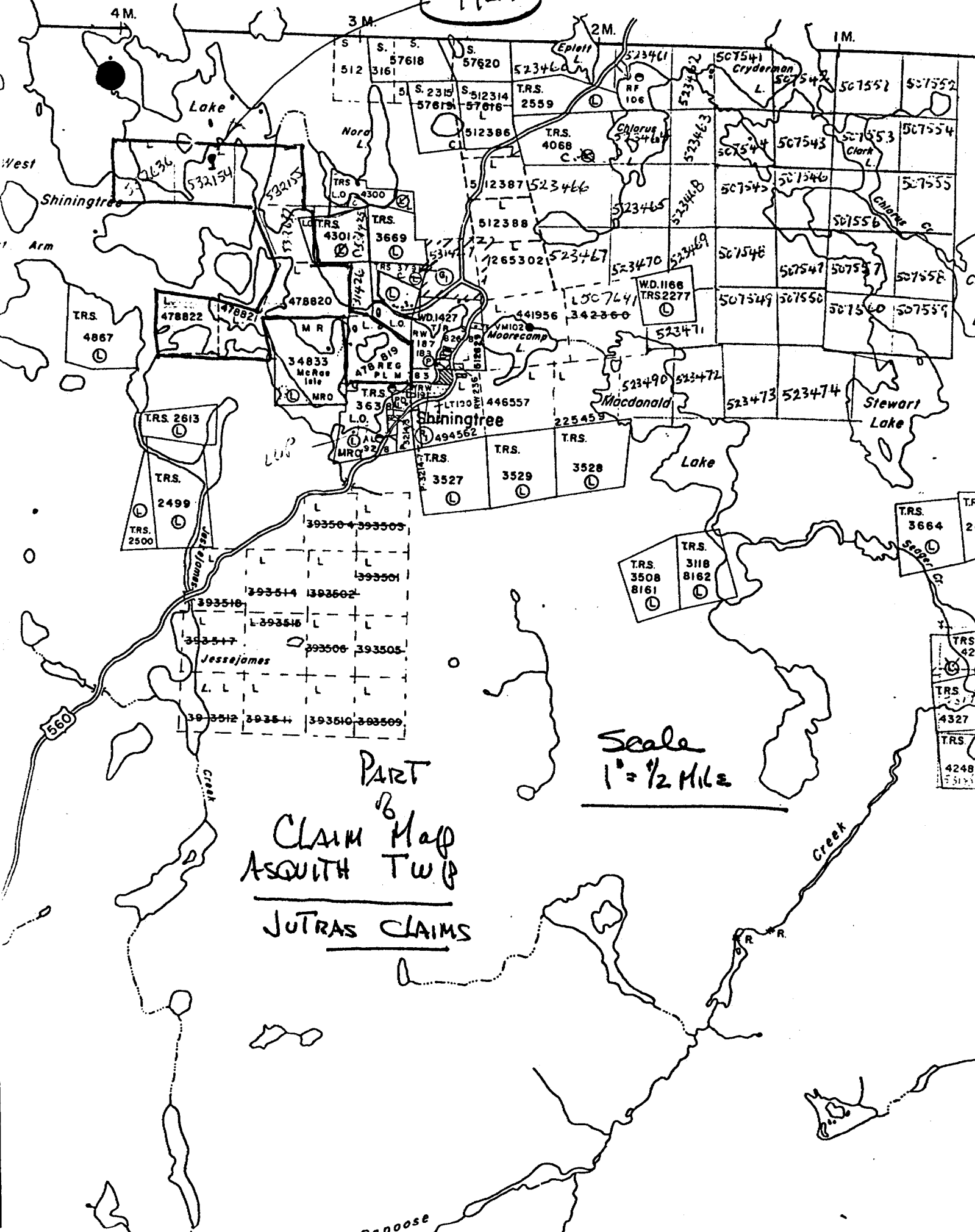

PROPERTY JUTRAS Property

OWN. (38817) 252154  
M.R.

LOCATION: SOUTH Twp. West SHININGTREE LAKE Ontario  
 ATTITUDE: 54° EAST and STRIKE: SOUTH (114°)  
 DEPARTURE: 360' NORTH of #3 post DIP: COLLAR 23°  
 ELEVATION: 411M M.R. 30 DATE DRILLED: 6-12 Sept 79

HOLE NO. 79-1

PAGE NO. 11

PURPOSE: TO TEST the "steep" VEIN

FOOTAGE	DESCRIPTION	SAMPLE NO.	WIDTH	ASSAY VALUE
0-1	CASING			
1-28.5	Mafic Volcanic - pale green-grey - f.g soft, shaly - regular narrow 1"-3" sections of whitish-grey-green material often with irregular quartz + calcite suggestive of interflow material numerous flz-carbonate 1/8"-1/4" irregular + random Qtz-carbonate stringers cutting the core			
28.5 -	3" white Qtz - broken, barren - core angle undetermined			
28.5-30.0	Lost core			
30-100	same as 1-28.5 except 36-37 - Lost core 38-39 - bedding evident - 40° core with a small amt of diss. pyrite - interflow sediment 48.5 - 3" irregular Qtz - white 57.5 - 3/4" wh. grey Qtz - irregular but approx 40° core - a small amt ± 1% pyrite over 1" 56-57 - irregular grey Qtz with splash of epidote over 8" length 59 - 3/4" irregular discontinuous blue Qtz TOTAL core samples 50-75 50-55 - 1/2 blue Qtz - 30° core - few Xls pyrite 55-60 60-65 - @ 67.5 - 1/2 blue Qtz - irregular core angle 65-70 70-75 - @ 71 - 3/4" blue Qtz - 20° core conformable bedding evident which is evident at 70-71 75-80 - interflow bedding - 30° core 95-96.5 - Lost core. 100' - End of Hole			
		724		
		720		
		721		
		722		
		723		

DRILLED BY ART JUTRAS  
Box 322 NORTH BAY, ONTARIO

SIGNED [Signature]