



41P12SW0031 63.5312 CHESTER

010

ERANA MINES LIMITED

106 FIELDING RD., RR #2
LIVELY, ONTARIO POM 2E0

SIB / AAC BURNS METALS INC.
TO: Fromat - Energy
5 Peppertree Drive
WESTHILL, Ontario.
M1C 1N5

INVOICE NO. *IBM-04* ~~FE-09~~
DATE: December 5/88

Attn: Mr. Al Pattie

TERMS: DUE UPON RECEIPT

Reference: Exploration, Chester Township
Nov. 12 - Dec. 2/88

Stripping & Trenching

- Mobilizing D7 Bulldozer from
Sudbury to Gogama; 110 miles @
\$3.00/mile

*not allowed
SIB/DR*
\$ 330.00

- Equipment:

Nov. 14/88 10 hours @ \$85.00/hr
Nov. 15/88 10 hours @ \$85.00/hr
Nov. 16/88 10 hours @ \$85.00/hr

850.00
850.00
850.00

- Labour:

L. R. 30 hours @ \$15.00/hour

450.00

Drill, Blast, Sample and Map Chester
Showing November 26 & 27/88

- L. Restoule, 2 days @ \$150.00/day
E. Blanchard, 2 days @ \$150.00/day

300.00
300.00

Expenses:

Meals

*not allowed
SIB/DR*
31.25
150.00

- Powder fuse caps and 1/2 ton rental
2 days

Demobilizing, Dec. 2/88

- D7 Bulldozer from Gogama to Sudbury
110 miles @ \$3.00/mile

*not allowed
SIB/DR*
330.00
\$ 4,441.25



ENTERED DEC 02 1988
55-195

COY

MINING RIGHTS ONLY
SURFACE RIGHTS ONLY
MINING AND SURFACE RIGHTS

Order No. Disposition File
ONLY WITHDRAWN UNDER 43 OF THE MINING ACT
ORDER # W 77/80 DATED FEB. '9/80.

Handwritten scribbles

Handwritten scribbles

ND GRAVEL

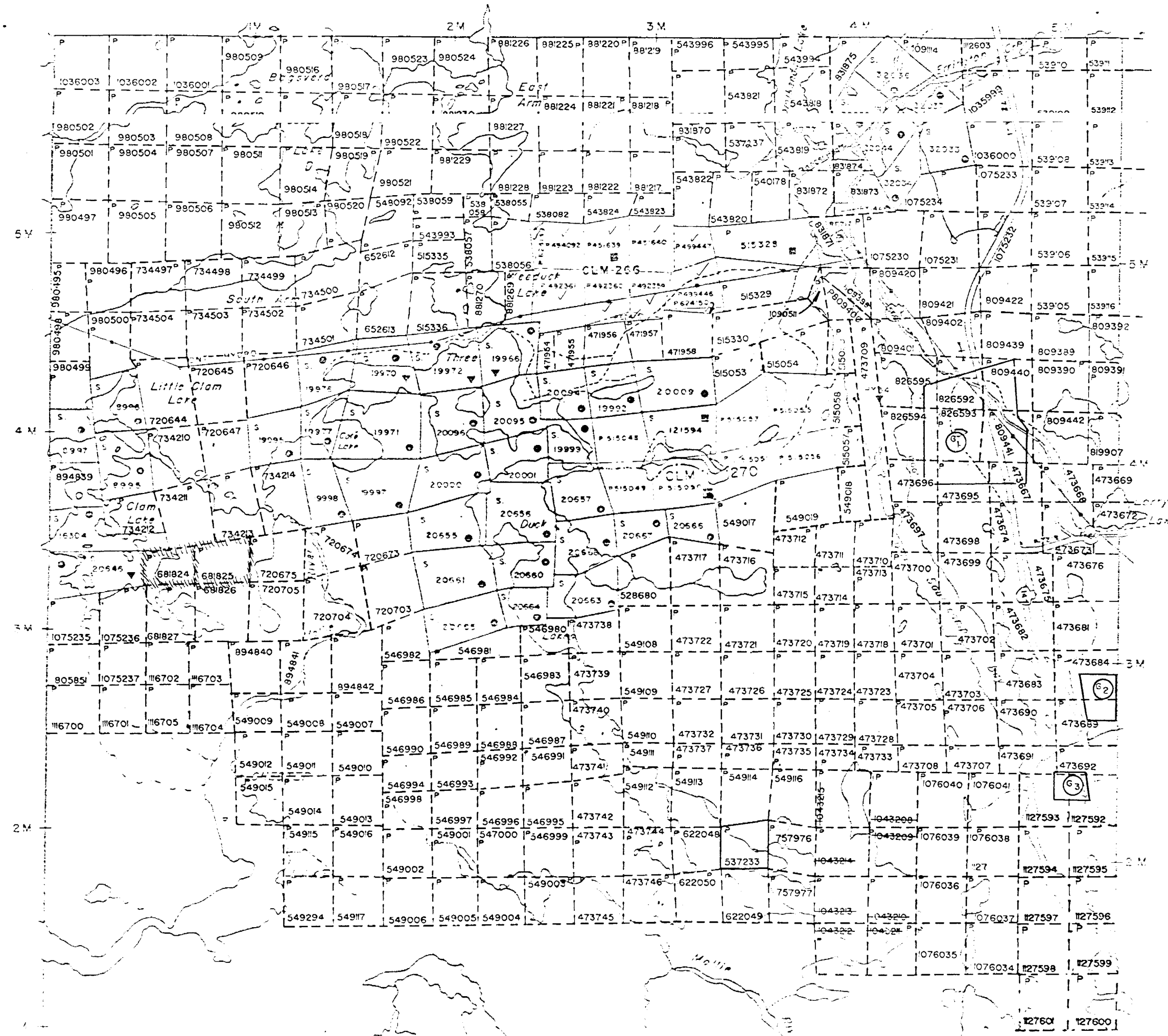

TEO III

NOTES

CONTOUR 200' RESERVED TO ONTARIO HYDRO
7543, FILE 1062.

127601 127600



DOCUMENT NO. W9006-077



41P125W0031 63.5312 CHESTER

Mining Act

900

Name and Postal Address of Record Holder: EDWARD J. BLAIR, SR. ISAAC BURNS METALS INC. | G-27521 T-4751
 106 Fielding Road Lively Ontario POM 2E0
 Summary of Work Performance and Distribution of Credits

| Total Work Days Cr. claimed for Performance of the following work. (Check one only) | Mining Claim | | | Mining Claim | | | Mining Claim | | |
|---|--------------|--------|---------------|--------------|--------|---------------|--------------|--------|---------------|
| | Prefix | Number | Work Days Cr. | Prefix | Number | Work Days Cr. | Prefix | Number | Work Days Cr. |
| 44.25 360 | P | 720705 | 48.1 | P | 681825 | 44.0 | | | |
| <input type="checkbox"/> Manual Work | | 720704 | 44.0 | | 681824 | 44.0 | | | |
| <input type="checkbox"/> Shaft Sinking Drifting other Lateral Work. | | 720703 | 44.0 | | | | | | |
| <input type="checkbox"/> Compressed Air, other Power driven or mechanical equip. | | 720675 | 44.0 | | | | | | |
| <input checked="" type="checkbox"/> Power Stripping | | 720674 | 44.0 | | | | | | |
| <input type="checkbox"/> Diamond or other Core drilling | | 720673 | 44.0 | | | | | | |
| <input type="checkbox"/> Land Survey | | 681827 | 44.0 | | | | | | |
| | | 681826 | 44.0 | | | | | | |

All the work was performed on Mining Claim(s): P-681824 and P-681825

Required Information regarding type of equipment; Names, Addresses, etc. (See Table Below)

From November 12 - December 2, 1988
 ERANA MINES LIMITED
 106 Fielding Road
 Lively, Ontario
 POM 2E0

ONTARIO GEOLOGICAL SURVEY
 ASSESSMENT FILES
 OFFICE
 MAR - 8 1989
 RECEIVED

RECORDED
 MAY 15 1989

Completed Stripping and Blasting of Rock

Equipment: D Caterpillar Tractor/Operator: Leo Restoule

TOTAL COST: ~~4,441.25~~ 3,600 AS PER ATTACHED

MAY 15 1989
 1000-75

Date of Report: May 12/89
 Record Holder or Agent (Signature): [Signature]

Certification Verifying Report of Work

I hereby certify that I have personal and intimate knowledge of the facts set forth in the Report of Work annexed hereto, having performed the work and/or after its completion and the annexed report is true.

Name and Postal Address of Person Certifying: David W. Constable 10 Kingston Court (566-5931) 682-0649

Location: SUDBURY, Ontario P3A 1C9
 Date Certified: May 12/89
 Certified by (Signature): [Signature]

Table of Information/Attachments Required by the Mining Recorder

| Type of Work | Specific information per type | Other information (Common to 2 or more types) | Attachments |
|---|---|---|--|
| Manual Work | Nil | Names and addresses of men who performed manual work/operated equipment, together with dates and hours of employment. | Work Sketch: these are required to show the location and extent of work in relation to the nearest claim post. |
| Shaft Sinking, Drifting or other Lateral Work | Type of equipment | | |
| Compressed air, other power driven or mechanical equip. | Type of equipment and amount expended. Note: Proof of actual cost must be submitted within 30 days of recording. | Names and addresses of owner or operator together with dates when drilling/striping | |
| Power Stripping | | | |



FROM: M.R. PORCUPINE MIN. DIV.
 and Mines

TO:

705 682 2447

JAN 19, 1990 4:18 PM P.22

type of work to be recorded (see table below).
 - For Geo-technical work use form no. 1382 "Report of Work (Geological, Geophysical, Geochemical and Expenditures)".

Mining Act

Name and Postal Address of Record Holder: **EDWARD J. BLA CHARD, SR.**
 Prospector's Licence No.: **C-27521**

106 Fielding Road Lively Ontario POM 2E0

| Mining Claim | | Work Days Cr. | Mining Claim | | Work Days Cr. | Mining Claim | | Work Days Cr. |
|--------------|--------|---------------|--------------|--------|---------------|--------------|--------|---------------|
| Prefix | Number | | Prefix | Number | | Prefix | Number | |
| P | 720705 | 36.0 | P | 681825 | 36.0 | | | |
| | 720704 | 36.0 | | 681824 | 36.0 | | | |
| | 720703 | 36.0 | | | changed | | | |
| | 720675 | 36.0 | | | | | | |
| | 720674 | 36.0 | | | | | | |
| | 720673 | 36.0 | | | | | | |
| | 681827 | 36.0 | | | | | | |
| | 681826 | 36.0 | | | | | | |

All the work was performed on Mining Claim(s): **P-681824 and P-681825**

Required Information eg: type of equipment, Names, Addresses, etc. (See Table Below)

From November 12 - December 2, 1988

ERANA MINES LIMITED
 106 Fielding Road
 Lively, Ontario
 POM 2E0

Completed Striping and Blasting of Rock

Equipment: D7 Caterpillar Tractor/Operator: Leo Restoule

TOTAL COST: \$4,441.25

(Handwritten notes and signatures)
 MAY 15 1989

Date of Report: **May 12/89**
 Record Holder or Agent (Signature): *[Signature]*

Location Verifying Report of Work

I hereby certify that I have a personal and intimate knowledge of the facts set forth in the Report of Work annexed hereto, having performed the work and witnessed same during and after its completion and the annexed report is true.

Name and Postal Address of Person Certifying: **David W. Constable 10 Kingston Court (566-5931) (82-1649)**

Date Certified: **May 12/89**
 Certified by (Signature): *[Signature]*

Address of Information/Attachments: **P3A 109**

| Type of Work | Specific Information per type | Other Information (Common to 2 or more types) | Attachments |
|--|---|---|---|
| Manual Work | | | |
| Shaft Sinking, Drifting or other Lateral Work | Nil | Names and addresses of men who performed manual work/operated equipment, together with dates and hours of employment. | Work Sketch: these are required to show the location and extent of work in relation to the nearest claim post |
| Compressed air, other power or mechanical equip. | Type of equipment | | |
| Power Stripping | Type of equipment and amount expended. Receipt proof of actual cost must be submitted | | |

Ministry of Northern Development and Mines

Report of Work

Mining Act

Instructions - Supply required data on appropriate type of work to be recorded (see table below). For Geo-technical work use form no. 1362 "Report of Work (Geological, Geophysical, Geochemical and Expenditures)".

Name and Postal Address of Person: DUARD J. BLANCHARD, SR. ISAAC BURNS METALS INC. 5 PEPPER TREE DRIVE WEST HILL, ONT. M1C 1Y5

Table with columns: Mining Claim Prefix, Mining Claim Number, Work Days Cr., Mining Claim Prefix, Mining Claim Number, Work Days Cr., Mining Claim Prefix, Mining Claim Number, Work Days Cr. Includes entries for claims 720705, 720704, 720703, 720675, 720674, 720673, 681827, 681826.

The work was performed on Mining Claim(s): P-681824 and P-681825

Additional Information eg: type of equipment, Names, Addresses, etc. (See Table Below)

From November 12 - December 2, 1988

IRANA MINES LIMITED, 106 Fielding Road, WILSONVILLE, Ontario, M1M 2E0

Completed Stripping and Blasting of Rock

Equipment: D7 Caterpillar Tractor/Operator: Leo Restoule

TOTAL COST: \$41,250 AS PER ATTACHED

Signature: David W. Constable, Date: MAY 15 1989

Date of Report: May 12/89, Recorded Holder or Agent (Signature): David W. Constable

I hereby certify that I have a personal and intimate knowledge of the facts set forth in the Report of Work annexed hereto, having performed the work and witnessed same during and/or after its completion and the annexed report is true.

Name and Postal Address of Person Certifying: David W. Constable, 10 Kingston Court (566-5931) (22-0649)

Date Certified: May 12/89, Certified by (Signature): David W. Constable

Table with columns: Type of Work, Specific Information per type, Other information (Common to 2 or more types), Attachments. Includes 'Manual Work' and 'Work Sketch' instructions.

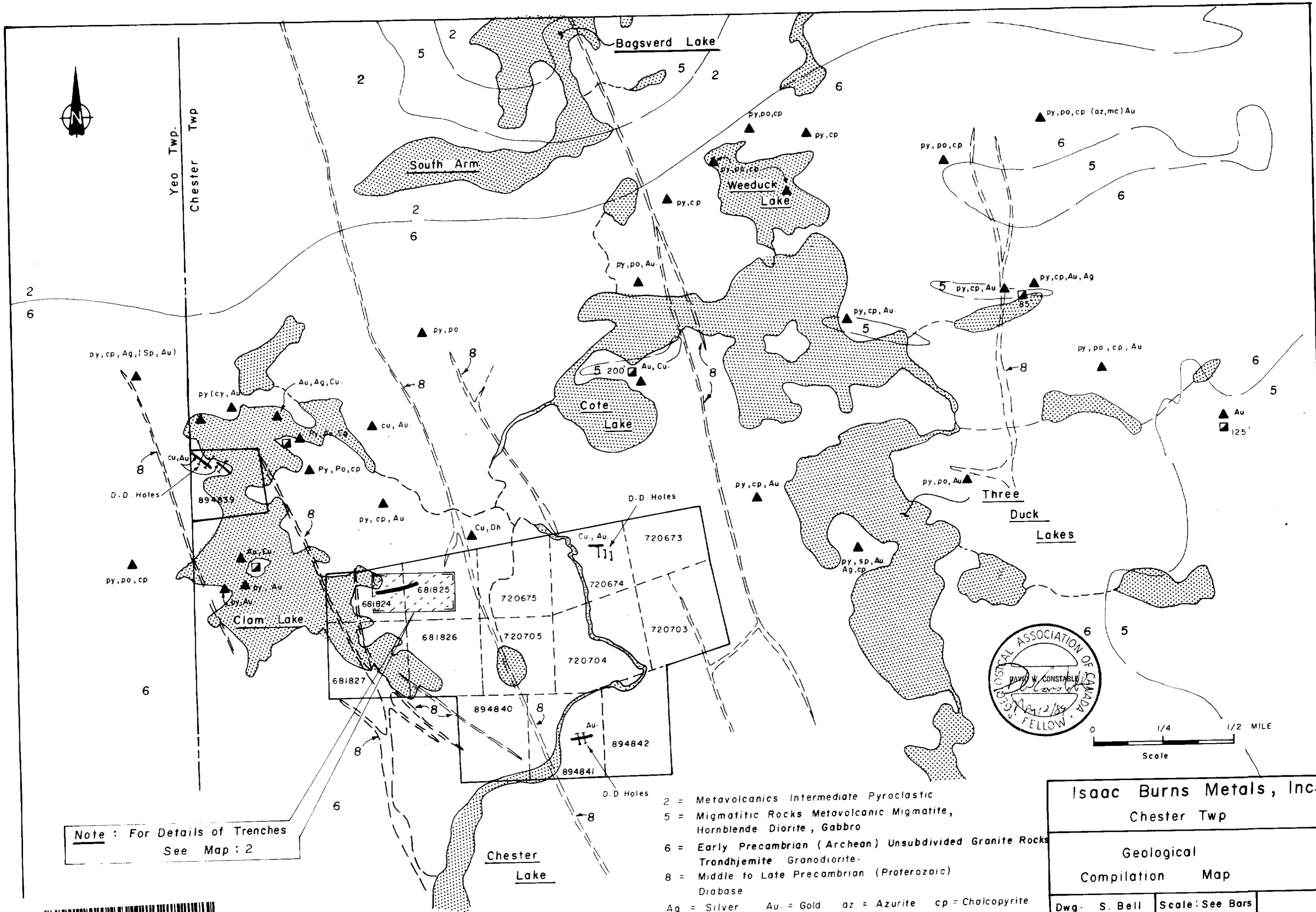

Note: For Details of Trenches See Map: 2

- 2 = Metavolcanics Intermediate Pyroclastic
 - 5 = Migmatitic Rocks Metavolcanic Migmatite, Hornblende Diorite, Gabbro
 - 6 = Early Precambrian (Archean) Unsubdivided Granite Rocks Trondhjemite Granodiorite.
 - 8 = Middle to Late Precambrian (Proterozoic) Diabase
- Ag = Silver Au = Gold az = Azurite cp = Chalcopyrite
 Cu = Copper py = Pyrite po = Pyrrhotite sp = Sphalerite

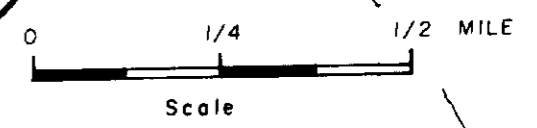

| | | | |
|--------------------------|---------|-----------------|--------|
| Isaac Burns Metals, Inc. | | | |
| Chester Twp | | | |
| Geological | | | |
| Compilation Map | | | |
| Dwg. | S. Bell | Scale: See Bars | Map: 1 |
| App. | | Chk'd: | |



200

63.5312



Clam
Lake

Road

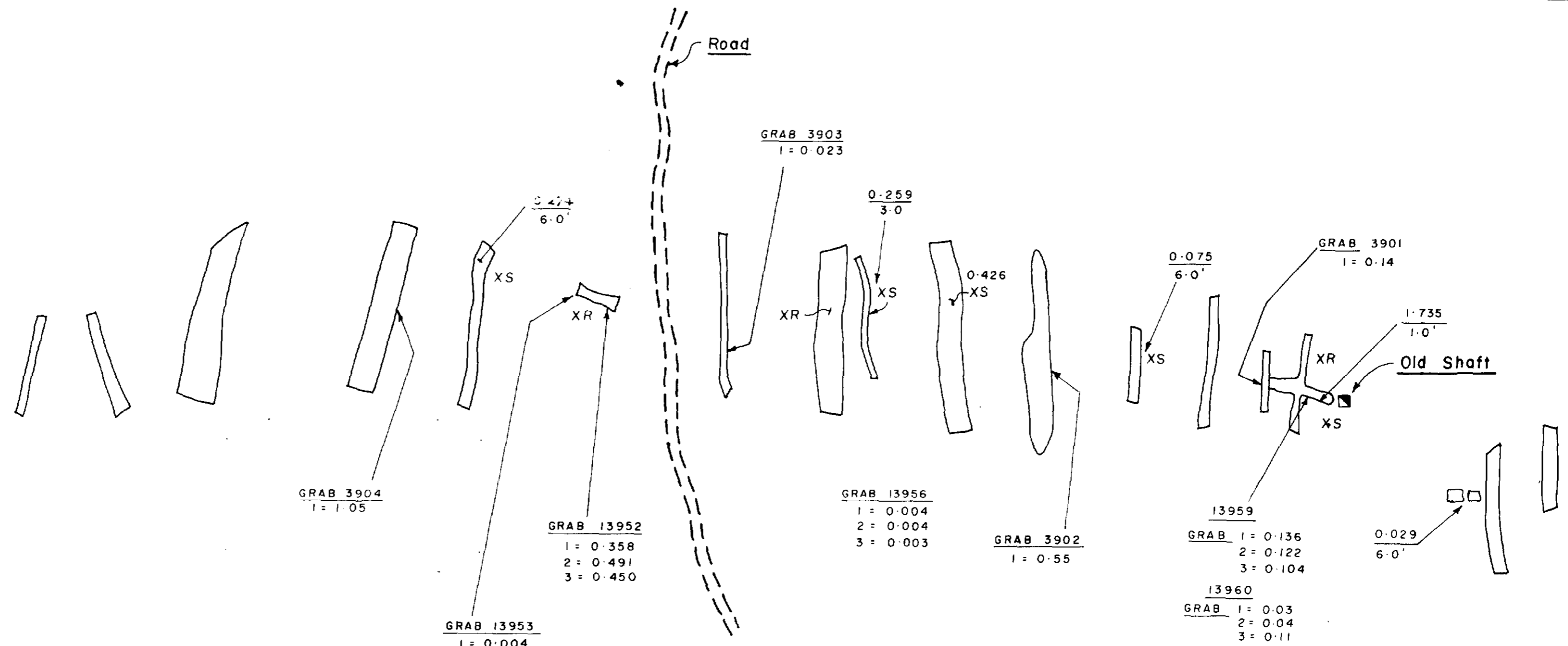

GRAB 3904
1 = 1.05

0.474
6.0'

GRAB 13952
1 = 0.358
2 = 0.491
3 = 0.450

GRAB 3903
1 = 0.023

0.259
3.0'

GRAB 13956
1 = 0.004
2 = 0.004
3 = 0.003

GRAB 3902
1 = 0.55

0.426
XS

0.075
6.0'

GRAB 3901
1 = 0.14

1.735
1.0'

Old Shaft

13959
GRAB 1 = 0.136
2 = 0.122
3 = 0.104

0.029
6.0'

13960
GRAB 1 = 0.03
2 = 0.04
3 = 0.11

XS = Surface Stripping
XR = Surface Trench

Note : For Location of Trenches
See Map : 1

0.25 = Gold Grade Ounces / Ton
7.0' = Sample Width in Feet

2 = Sample Number

ONTARIO GEOLOGICAL SURVEY
ASSESSMENT FILES
OFFICE
MAR - 8 1990
RECEIVED

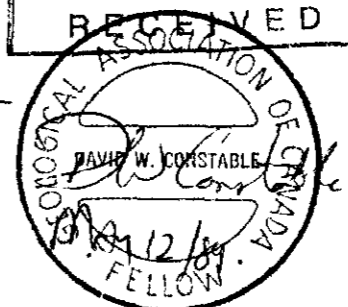

Isaac Burns Metals, Inc.
Chester Twp

Detailed Plan — of Trenching

Dwg. S. Bell Scale: 1" = 100'

App. Chk'd:

Map : 2

