



41P12SW0042 43 CHESTER

DIAMOND DRILLING

TOWNSHIP: CHESTER TWP.

REPORT NO: 43

WORK PERFORMED FOR: Emerald Isle Resources Inc.

RECORDED HOLDER: SAME AS ABOVE (xx)

: OTHER ()

<u>CLAIM NO.</u>	<u>HOLE NO.</u>	<u>FOOTAGE</u>	<u>DATE</u>	<u>NOTE</u>
P 734210	87-14	300'	Oct/87	(1)
	87-15	294'	Oct/87	(1)

NOTES: (1) # W8906.532, filed Dec/89

Post No. 4

Post No. 1

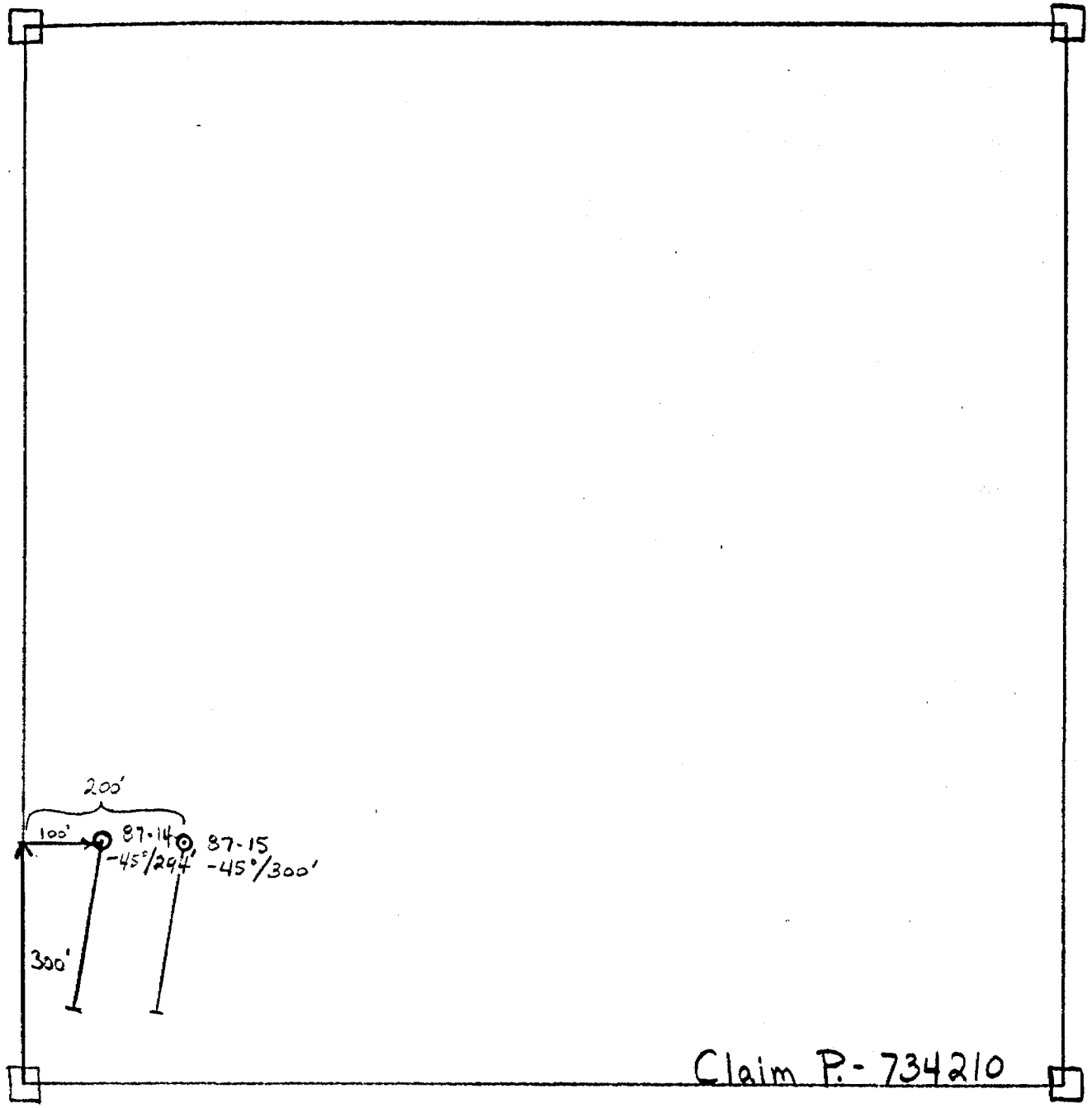

Post No. 3

Post No. 2

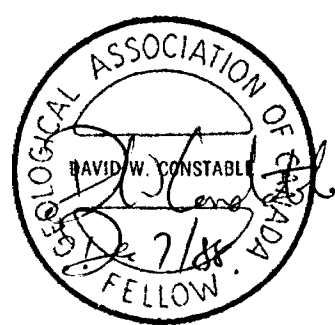

EMERALD ISLE RESOURCES INC.
 GLENROY OPTION PROPERTY

Chester Twp. ONTARIO

Scale 1 inch = 200 feet



Ministry of Natural Resources

Diamond Drilling Log

CLAM above Lake

15 BOXES of CORE at Young Shannon - Cote Lake

Fit in on every page

Hole No. 87-14 Page No. 1

Drilling Company TRIANGLE DRILLING Co

Collar Elevation +50' Bearing of hole from true North 190° Total Footage 294 Dip of Hole at Collar 45

Location of hole in relation to a fixed point on the claim. DDH

Map Reference No. NTS 41 P/12 Claim No. 734210

Date Hole Started October 1/87 Date Completed October 3/87

Date Logged DEC 15/87 Logged by C.G. CHERITON

Location of hole in relation to a fixed point on the claim. DDH

Location (Twp., Lot, Con. or Lat. and Long.) CHESTER TWP. Approx 47° 34' N 81° 57' W.

Exploration Co., Owner or Optionee GLEN ROY RESOURCES INC.

Date Submitted DEC 22/87 Submitted by (Signature) [Signature]

Location of hole in relation to a fixed point on the claim. DDH

Property Name GLEN ROY RESOURCES INC

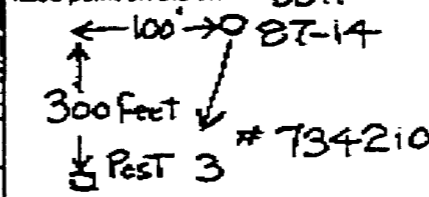
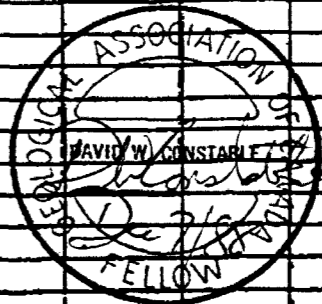

Table with columns: Footage (From, To), Rock Type, Description, Planar Feature Angle, Core Specimen Passage, Your Sample No., Sample Footage (From, To), Sample Length, Assays. Rows include casing, granodiorite, quartz schist, and chlorite schist.





Ministry of
Natural
Resources

Diamond
Drilling
Log

above CLAM LAKE Level feet : 16 BOXES OF CORE AT YOUNG SHANNON Lake

Drilling Company TRIANGLE DRILLING CO.		Collar Elevation + 50'	Bearing of hole from true North	Total Footage 300	Dip of Hole at Collar 45°	Location of hole in relation to a fixed point on the claim. DDH 08715 CL # T34210 Post 3	Map Reference No NTS 41 Location (Twp., Loc) CHEST Approx 4
Date Hole Started OCTOBER 3/87	Date Completed OCTOBER 5/87	Date Logged DEC 16/87	Logged by CHERITON		FL		
Exploration Co., Owner or Options GLEN ROY RESOURCES INC.		Date Submitted Dec 22/87	Submitted by (Signature) <i>[Signature]</i> ONTRARIO		FL		
					FL		

Footage		Rock Type	Description <small>Colour, grain size, texture, remarks, alteration, etc.</small>	Placer Factors Anger	Core Specimen Footage	Your Sample No.	Sample Footage		Sample Length	
From	To						From	To		
0	109	GRANODIORITE	MAINLY LIGHT BLUE GREY MEDIUM GRAINED patchy 20% Fe Mag locally gneissic	60°						
			12-43 - SURFACE Altn and some SILICIFICATION with Sericite chlorite SCHIST AND RUSTY BARRETE some QUARTZ CARBONATE VUGS and sericite in slivers but negligible sulphides. Scattered dark inclusions in rock and showing reticulated fracture pattern. Many seams and spots FeS ₂ at 40 feet, 59 and 109 feet.	60°						
109	133	CHLORITE SCHIST BANDS	DARK FINE GRAINED SCHISTOSE BANDS with QUARTZ and CARBONATE VEINS - some veins are dense white QUARTZ sulphides inter py + cp at 117 & 123 feet	40° 60°			10367	117.0	117.5	0.5
133	162	GRANODIORITE	AS ABOVE with scattered FeS ₂ at 134 feet + 138 feet				10368	122.5	125.0	2.5
162	182	TWY DYKES	2 dark fine grained dykes cut the GRANODIORITE and have 6 feet of GRANODIORITE best used dykes. 1st dyke - 162-174 dark fine grained with 1% slab of FeS ₂ and some narrow quartz carbonate veins. The dykes have chilled borders.							
182	257	GRANODIORITE	AS ABOVE cut by dark seams and FRACTURES and some quartz veins with sulphide at 185 feet & 234 feet. Hand up vein with Qtz at 278 feet contains sulphide cutting schist at 40° P.C.A.	30°			10369	234.0	235.0	1.0
257	282	CHLORITE SCH	AS ABOVE with Quartz Carb veins	90°			10370	244.0	245.20	
282	300	GRANODIORITE	AS ABOVE							
	300	END OF HOLE								

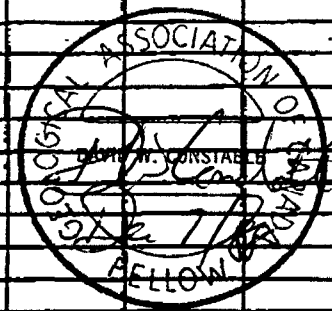



Mining Act

Name and Postal Address of Recorded Holder: **EMERALD ISLE RESOURCES INC.**
106 FIELDING ROAD, LIVELY, ONTARIO POM 2E0

Prospector's Licence No.: **T-1861**

Summary of Work Performance and Distribution of Credits

Total Work Days Cr. claimed	Mining Claim		Work Days Cr.	Mining Claim		Work Days Cr.	Mining Claim		Work Days Cr.
	Prefix	Number		Prefix	Number		Prefix	Number	
594.0	P	734210 ✓	60.0	P	734499 ✓	30.0	P	720647	35.0
for Performance of the following work. (Check one only) <input type="checkbox"/> Manual Work <input type="checkbox"/> Shaft Sinking Drifting or other Lateral Work. <input type="checkbox"/> Compressed Air, other Power driven or mechanical equip. <input type="checkbox"/> Power Stripping <input checked="" type="checkbox"/> Diamond or other Core drilling <input type="checkbox"/> Land Survey		734214 ✓	30.0		734500 ✓	40.0			
		734497 ✓	60.0		734501 ✓	30.0			
		734504 ✓	30.0		734502 ✓	30.0			
		734211 ✓	34.0		734503 ✓	40.0			
		734212 ✓	30.0		720644	25.0			
		734213 ✓	30.0		720645	25.0			
		734498 ✓	40.0		720646	25.0			

All the work was performed on Mining Claim(s): **P-734210**

Required Information eg: type of equipment, Names, Addresses, etc. (See Table Below)

TRIANGLE DRILLING CO. LTD. OF 106 FIELDING ROAD, LIVELY, ONTARIO, COMPLETED 594 FEET OF BQ CORE IN TWO HOLES BETWEEN OCTOBER 1, 1987 AND OCTOBER 5, 1987. A LONGYEAR MODEL 38 DIAMOND DRILL WAS UTILIZED.

RECORDED
DEC 9 1988
@ 1:00 pm

RECORDED
DEC - 9 1988

ONTARIO GEOLOGICAL SURVEY
ASSESSMENT FILES
OFFICE
DEC 12 1989
RECEIVED

Date of Report: **DEC. 7, 1988**
 Recorded Holder or Agent (Signature): *[Signature]*

Certification Verifying Report of Work

I hereby certify that I have a personal and intimate knowledge of the facts set forth in the Report of Work annexed hereto, having performed the work or witnessed same during and/or after its completion and the annexed report is true.

Name and Postal Address of Person Certifying: **DAVID CONSTABLE, CONSTABLE CONSULTING INC.**
10 KINGSTON COURT, SUDBURY, ONT. P3A1C9

Date Certified: **DEC. 7, 1988**
 Certified by (Signature): *[Signature]*

Table of Information/Attachments Required by the Mining Recorder

Type of Work	Specific information per type	Other information (Common to 2 or more types)	Attachments
Manual Work	Nil	Names and addresses of men who performed manual work/operated equipment, together with dates and hours of employment.	Work Sketch: these are required to show the location and extent of work in relation to the nearest claim post.
Shaft Sinking, Drifting or other Lateral Work			
Compressed air, other power driven or mechanical equip.	Type of equipment	Names and addresses of owner or operator together with dates when drilling/stripping	
Power Stripping	Type of equipment and amount expended. Note: Proof of actual cost must be submitted within 30 days of recording.		

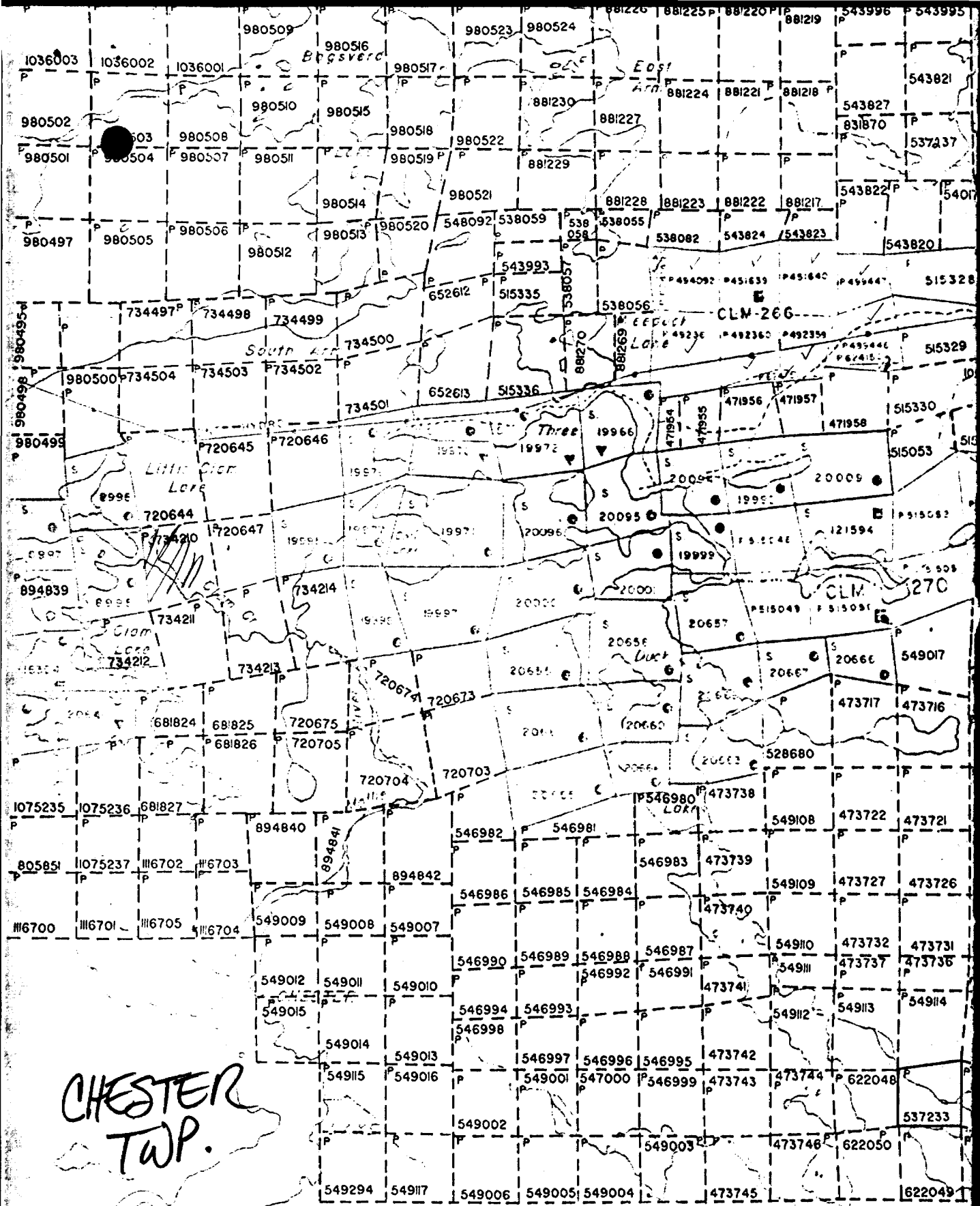

CHESTER
TWP.