

41P12SW0053 37 CHESTER

010

DIAMOND DRILLING

TOWNSHIP: CHESTER

REPORT NO.37

WORK PERFORMED FOR: Isaac Burns

RECORDED HOLDER: Same as above [xx]
: Other []

<u>Claim No.</u>	<u>Hole No.</u>	<u>Footage</u>	<u>Date</u>	<u>Note</u>
P 894839	CH-87-1	' 300'	Feb/87	(1)
	CH-87-2	280'	Feb/87	(1)
	CH-87-3	290'	Feb/87	(1)

870'

NOTES: (1) # 93/87, filed Jan 25/88.

DIAMOND DRILL RECORD

LOGGED BY D. CONSTABLE

CONSTABLE CONSULTING INC.

PROPERTY CHESTER TOWNSHIP PROPERTY - ISAAC BURNS

D.D.H. No. CH-87-2

PAGE 4 of 4

LATITUDE _____ BEARING OF HOLE 217° (Ast) STARTED Feb. 14, 1987

DEPARTURE _____ DIP OF HOLE -45° COMPLETED Feb. 16, 1987

ELEVATION _____ DIP TESTS Nil DEPTH 280.0'

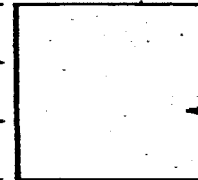

CLAIM No. P-894839

DIRECTION AND DISTANCE FROM

NE. CLAIM POST

FOOTAGE		DESCRIPTION	SAMPLE No.	FOOTAGE		SAMPLE LENGTH	ASSAY						
FROM	TO			FROM	TO								
254.9	273.5	<u>DIABASE</u>											
		Black-green, fine-grained, soft iron-rich (hematite) and barren with a few yellow feldspar phenocrysts.											
273.5	280.0	<u>GRANODIORITE</u>											
		Grey, massive, hard medium-grained rock with slight mylonization and traces of sulfide.											
		<u>END OF HOLE CH-87-2 is at 280.0'</u>											

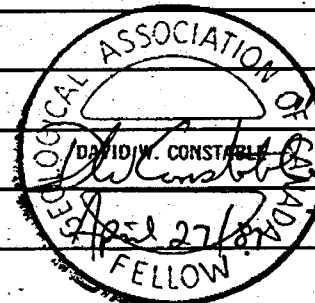

DIAMOND DRILL RECORD

LOGGED BY D. CONSTABLE

CONSTABLE CONSULTING INC.

PROPERTY CHESTER TOWNSHIP PROPERTY

D.D.H. No. CH-87-3 PAGE 5 of 5

LATITUDE _____ BEARING OF HOLE 217° (Ast)

STARTED Feb. 16, 1987

DEPARTURE _____ DIP OF HOLE -45°

COMPLETED Feb. 18, 1987

ELEVATION _____ DIP TESTS Nil

DEPTH 290.0'

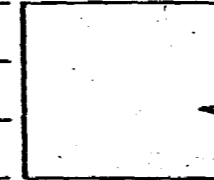

CLAIM No. P-894839

DIRECTION AND DISTANCE FROM
NE. CLAIM POST

FOOTAGE		DESCRIPTION	SAMPLE No.	FOOTAGE		SAMPLE LENGTH	ASSAY							
FROM	TO			FROM	TO									
		From 275.9 - 277.7 - two bands of slightly gneissic biotite-rich meta sediments with a conformable sharp contacted blue eyed quartz granodiorite band.												
		1/2 to 1% disseminated pyrite.												
		From 279.2 - 279.5' black gneissic barren metasediment.												
		From 289.0 - 290.0' - green mafic metatuff.												
		END OF HOLE CH-87-3 is at 290.0'												

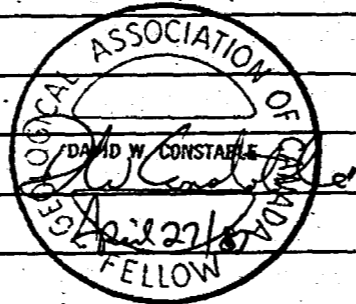



Name and Postal Address of Recorded Holder

ISAAC BURNS C-23428

1073 Stafford Street, Sudbury, Ontario

Summary of Work Performance and Distribution of Credits

Total Work Days Cr. claimed	Mining Claim		Work Days Cr.	Mining Claim		Work Days Cr.	Mining Claim		Work Days Cr.
	Prefix	Number		Prefix	Number		Prefix	Number	
870	P	894839	870						
for Performance of the following work. (Check one only)									
<input type="checkbox"/> Manual Work									
<input type="checkbox"/> Shaft Sinking Drifting or other Lateral Work.									
<input type="checkbox"/> Compressed Air, other Power driven or mechanical equip.									
<input type="checkbox"/> Power Stripping									
<input checked="" type="checkbox"/> Diamond or other Core drilling									
<input type="checkbox"/> Land Survey									

All the work was performed on Mining Claim(s): **P-894839**

Required Information eg: type of equipment, Names, Addresses, etc. (See Table Below)

970 FEET OF BQ CORE

CONTRACTOR: Triangle Drilling Company Limited
106 Fielding Road
Lively, Ontario
POM 2E0

DATES OF WORK: February 12 - February 18, 1987

RECORDED

APR 28 1987

ONTARIO GEOLOGICAL SURVEY
ASSESSMENT FILES
RESEARCH OFFICE

JUN 17 1987

RECEIVED

Date of Report	Recorded Holder or Agent (Signature)
April 27, 1987	<i>DW Constable</i>

Certification Verifying Report of Work

I hereby certify that I have a personal and intimate knowledge of the facts set forth in the Report of Work annexed hereto, having performed the work or witnessed same during and/or after its completion and the annexed report is true.

Name and Postal Address of Person Certifying

DAVID CONSTABLE, Constable Consulting Inc.

10 Kingston Court, Sudbury, Ont., P3A 1C9

Date Certified	Certified by (Signature)
April 27, 1987	<i>DW Constable</i>

Table of Information/Attachments Required by the Mining Recorder

Type of Work	Specific Information per type	Other information (Common to 2 or more types)	Attachments
Shaft Sinking, Drifting or other Lateral Work	Nil	Names and addresses of men who performed manual work /operated equipment, together with dates and hours of employment.	Work Sketch: these are required to show the location and extent of work in relation to the nearest claim post.
Compressed Air, other power driven or mechanical equip.	Type of equipment	Names and addresses of owner or operator together with dates when drilling/stripping done.	Work Sketch (as above) in duplicate
Power Stripping	Type of equipment and amount expended. Note: Proof of actual cost must be submitted within 30 days of recording.		
Diamond or other core drilling	Signed core log showing: footage, diameter of core, number and angles of holes.		
Land Survey	Name and address of Ontario land surveyor.	Nil	Nil

SAND AND GRAVEL

PERMIT

- PIT No. 1349
- GRAVEL PIT No. 1649
- GRAVEL PIT No. 1385

*Chester
Twp.*

YEO TR.

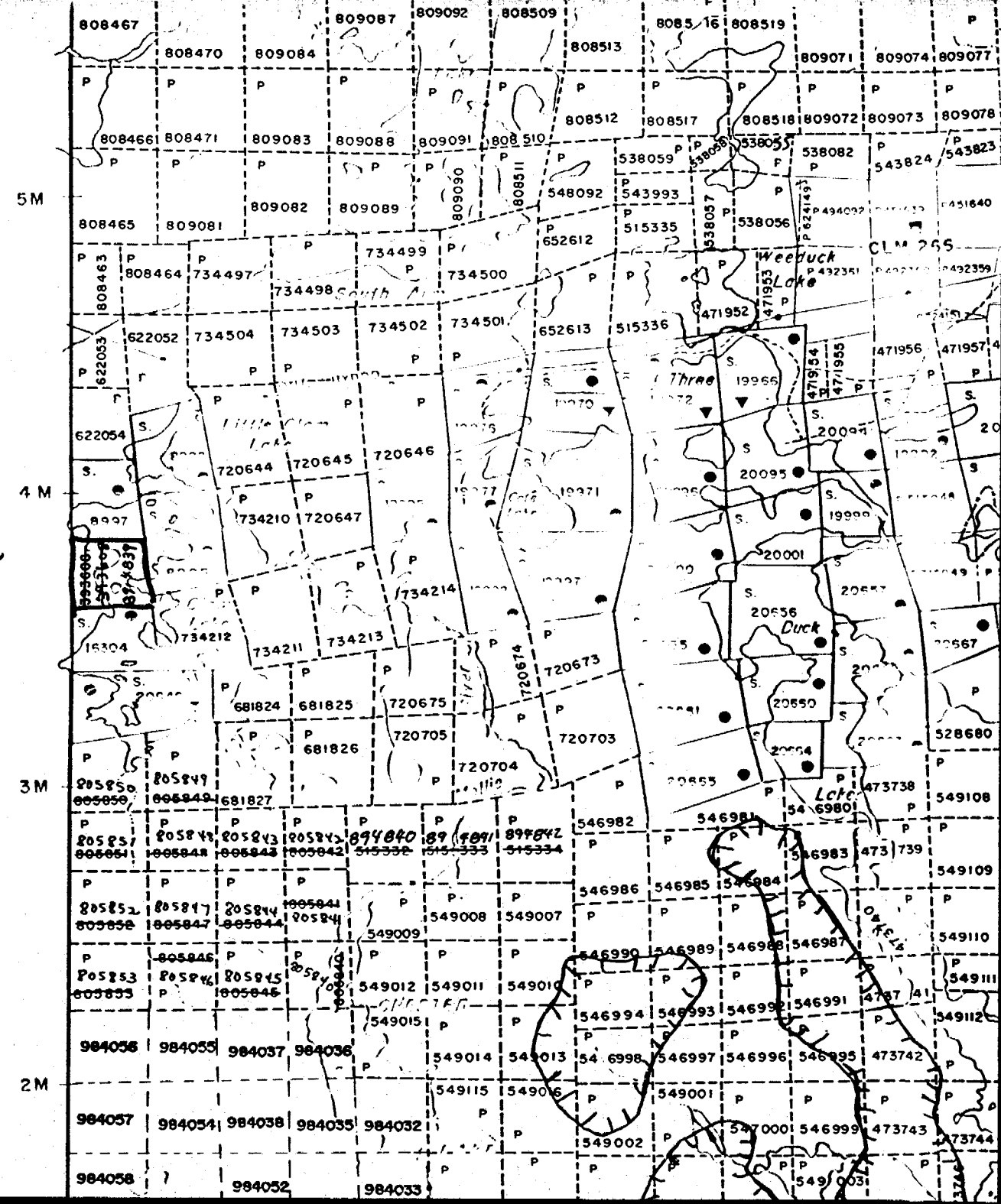

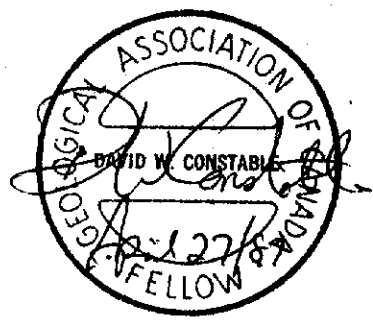
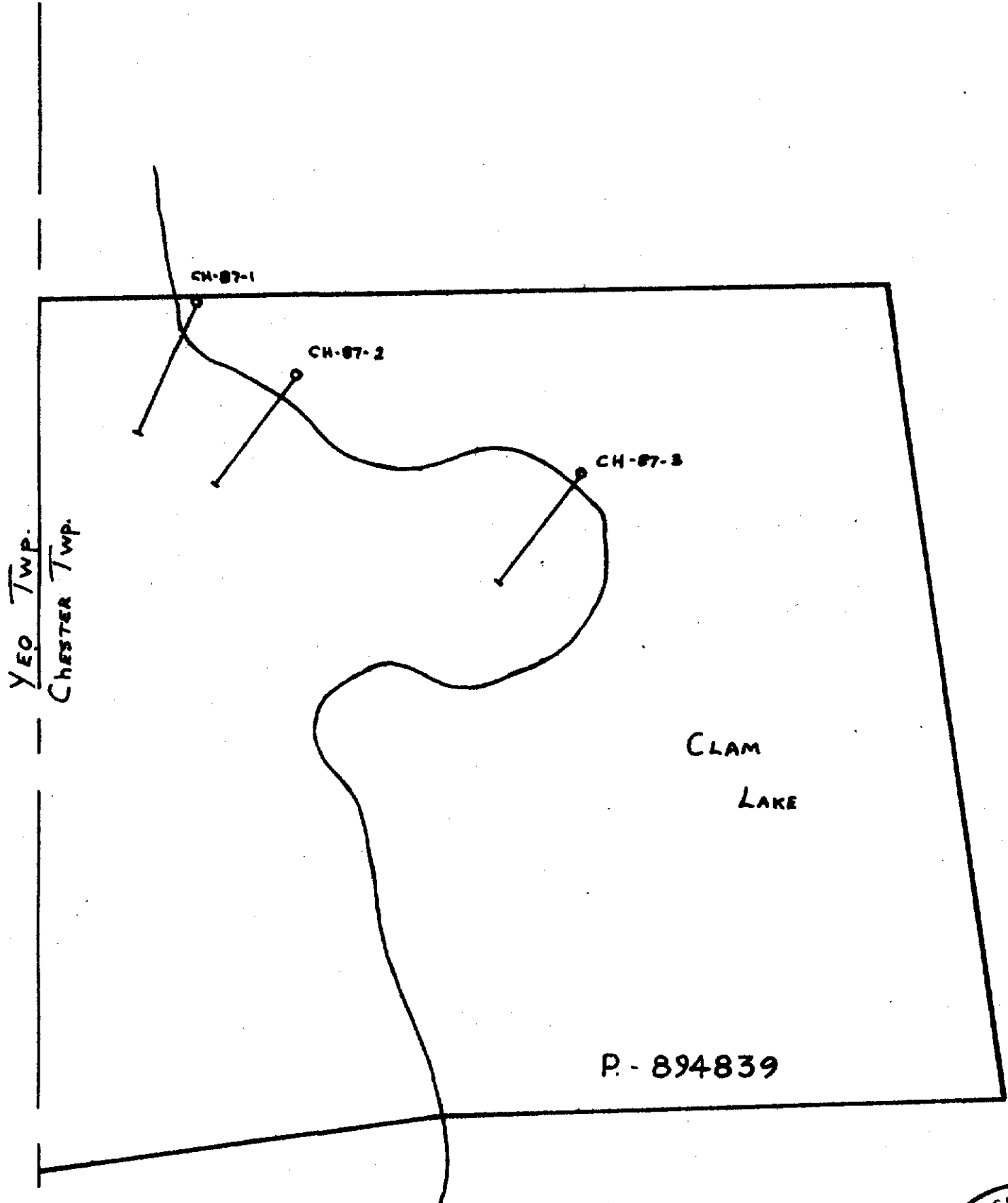

ISAAC BURNS

DIAMOND DRILL PLAN

CHESTER TWP. ONTARIO

SCALE 1 inch = 200 feet

April 1987

