



41P12SW0064 2.8372 CHESTER

010

NOV 14/84

GEOLOGICAL AND GEOPHYSICAL REPORT

EMERALD ISLE RESOURCES INC.

CHESTER TOWNSHIP PROPERTY

ONTARIO

RECEIVED
PORCUPINE MINING DIVISION
AUG 19 1985

RECEIVED
AUG 22 1985
MINING LANDS SECTION

August 10, 1985

David W. Constable H.BSc., F.G.A.C.

SUMMARY

Emerald Isle Resources Inc. holds a contiguous block of 17 unpatented mining claims in northwestern Chester township, Porcupine Mining Division, Ontario. The area is accessible by fair-weather bush road from highway 144.

The subject property lies in the Swayze Greenstone Belt, a series of east-west trending steeply dipping, Archean metavolcanics and metasediments. These rocks are the host for numerous gold-bearing sheared, quartz veins which occur both on the boundary and within Emerald Isle Resources' property.

Recently, line cutting, geological and geophysical surveys were completed over the property. This report summarizes these results. Numerous east-west trending, weak to moderate strength EM-VLF conductors were defined and together with known gold and base metal showings on the subject property require follow-up exploration.

Thus, we have recommended a two-phase exploration program on Emerald Isle Resources Inc.'s Chester township property totalling \$142,000.



TABLE OF CONTENTS

	<u>PAGE</u>
SUMMARY.....	1
INTRODUCTION.....	1
PROPERTY DESCRIPTION, LOCATIONS, ACCESS, PHYSIOGRAPHY AND FACILITIES.....	3
FIGURE 1: CLAIMS LOCATION SKETCH.....	5
EXPLORATION HISTORY.....	6
REGIONAL AND ECONOMIC GEOLOGY.....	13
GEOLOGICAL SURVEY.....	16
EM-VLF SURVEY.....	19
CONCLUSIONS, RECOMMENDATIONS AND COST ESTIMATES.....	22
CERTIFICATION.....	24
APPENDIX I: BIBLIOGRAPHY.....	25
APPENDIX II: CLAIMS ABSTRACTS.....	27

MAPS IN POCKET

- GEOLOGICAL MAP (Scale 1 inch = 200 feet)
- EM-VLF MAP: Cutter Station. (Scale 1 inch = 200 feet)
- EM-VFL MAP: Annapolis Station. (Scale 1 inch = 200 feet)

1/11

INTRODUCTION

This report was prepared at the request of Mr. Ed Blanchard, a director of Emerald Isle Resources Inc., in order to analyse the results of geological and geophysical surveys recently completed on their Chester Township property and, if warranted, to recommend a further phase of gold exploration. The subject property consists of seventeen (17) contiguous unpatented mining claims located in western Chester Township. Access is from highway 144 via a fair-weather bushroad west along the northern side of Three Duck Lake and across the property.

The claim group lies in the Swayze Greenstone Belt, a series intercalated Archean metasediments and metavolcanics which are part of the Superior Province of the Canadian Precambrian Shield. Gold has been sought in the area since the early 1900's. In 1930 a spectacular native gold discovery was made on Three Duck Lake, a mile east of Emerald Isle Resources Inc's property. This was followed by a rapid succession of gold discoveries in the Three Duck Lake and Clam Lakes area. Most of these gold discoveries were in east-west trending shear zones with quartz veins. Possible extensions of known gold shears are the targets sought in this present exploration program.

During June and July, 1985 two geological technicians completed a linecutting grid over the entire group, except for a water-flooded claim in the southeast corner of the group. These

lines were then mapped, sampled and EM-VLF separate readings of Cutter and Annapolis stations were completed. The results of this program are analysed in this report. During the preparation of this report the author has utilized government files, reports and maps; results of the present program and has personally examined Emerald Isle Resources Inc.'s Chester Township property in both 1984 and 1985.

PROPERTY DESCRIPTION, LOCATION, ACCESS,
PHYSIOGRAPHY AND FACILITIES

The Chester property consists of a contiguous block of seventeen (17) unpatented mining claims (SEE FIGURE 1) covering an area of roughly 560 acres in west-central Chester township. The claims' status is further described in Appendix II of this report. All the claims were recorded on December 21st, 1983 and are presently in good standing. They will each require 20 assessment man-days of work on their first anniversary and 40 additional man-days of work on the second anniversary. The subject claims are held in trust by the stakers pending completion of the terms of an option agreement between Mr. P. Hytti, vendor, and Emerald Isle Resources Inc.

The Chester township claim block is located 13 miles southwest of the village of Gogama, approximately 70 miles southwest of Timmins and 80 miles northwest of Sudbury. More specifically, the claims are at latitude 47°33'30" north and longitude 81°56'45" west, near the Chester-Yeo township boundary.

Access is via highway 144 south from Timmins and north from Sudbury to a point 22 miles south of Gogama. Eddy Paper Products Limited's main haulage road heads westward from this point and at the 2-mile junction another haulage road, marked Chester township, heads northward 7 miles to the southern boundary of the subject property. Smaller bush roads allow access to the balance of the group. Access is also available from the C.G.M. Camp on Mesomikenda Lake on highway 144, 12 miles south of Gogama, thence westward along the bushroad to Three Duck Lake and Clam Lake, a distance of 4 miles to the property. This bushroad meets

Eddy Paper Products Limited's haulage road near the property's southern boundary.

The topography is typical of the Canadian Precambrian Shield, namely moderately low with relief seldom exceeding 50 feet. The height of land passes along the southern boundary of Chester township, thus all the streams in the property area drain northward toward James Bay. The soil coverage is extremely variable due to the presence of extensive but erratic glacial deposits. Generally, overburden seldom exceeds 25 feet in depth, but locally may be 200 feet deep. Overburden is a mixture of sand and silt moraines, tills, clays and muskeg. Much of the timber has been recently removed in Chester township and the remaining forest is immature. Jackpine is the dominant tree with isolated stands of white and red pines. Poplars, tamaracks, birches, black spruce, balsam and alders are also present. The last observed ice movement was from north to south.

Timber and water are sufficient for a mining operation, hydro could be brought 4 miles from highway 144 where a large hydro line crosses the highway. The nearest town is Gogama, 16 miles away, but Timmins, would be the nearest community with the resources necessary for a mining operation, including extensive custom gold milling capacity. The main transcontinental Canadian National rail line is 12 miles eastward while the main Canadian Pacific rail line is approximately an equal distance southwestward. Roads could easily be upgraded for any mining operation.

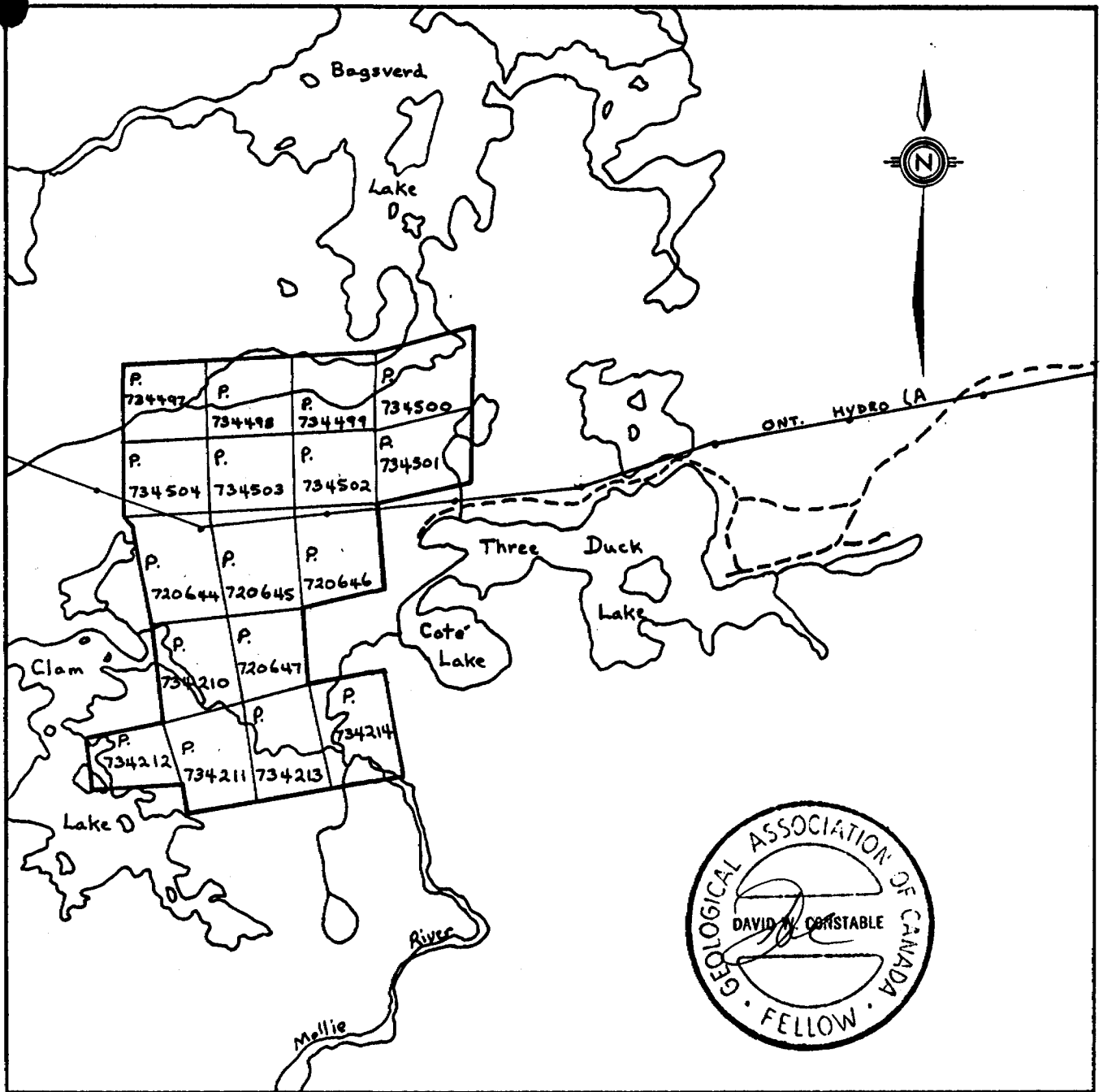

Figure 1.

EMERALD ISLE RESOURCES
INC.

LOCATION SKETCH



EXPLORATION HISTORY

The Swayze area has been the focus of gold exploration since the early 1900's as a spillover from the Porcupine and Elk Lake - Shining Tree Camps. The first real success in the area occurred in the summer of 1930 when a spectacular free gold showing was found by Alfred Gosselin on the east shore of Three Duck Lake, Chester township. This led to an influx of prospectors in 1930-31 resulting in a flurry of gold discoveries, chiefly in the Three Duck and Clam Lakes area. The discoveries were mostly quartz veins in diorites and granodiorites. In addition to gold, significant quantities of copper (chalcopyrite) are present in the vein systems together with pyrite, pyrrhotite, tourmaline, sphalerite, bornite, covellite, malachite, azurite, molybdenite, molybdite and tellurides. Gangue minerals include quartz, calcite, ankerite and sericite. The vein structures trend east-west and along strike they pinch and swell from hair-line fractures to several feet wide.

The first record of work in the area consists of a 1934 consultant's report on Young Shannon Gold Mine Limited's property, east of the subject property on Coté Lake. The 1934 report describes the geological setting of the gold showing. Earliest work on this prospect consisted of stripping and trenching in 1930-31 by the Three Ducks Syndicate. In 1932 the Martin Syndicate completed diamond drilling, but no details are available. Additional pitting, trenching and 600 feet of drilling were completed in 1935. The 1934 consultant report's recommendation to sink and drift on the showing was carried out

in 1936. The shaft was sunk to 200 feet with 172 feet of lateral development on the 100-foot level and 2196 feet of diamond drilling. All this work was done by Young Shannon Gold Mines Limited. In 1937, 160 feet of lateral development was completed on the 200-foot level and 500 feet of diamond drilling. In addition a 20-ton mill was installed. No production is recorded. In 1941 Young Shannon Gold Mines Limited completed a diamond drilling program and in 1944 a geophysical survey. More diamond drilling was completed in 1946 but again no public record of this drilling is available. In 1964 Chester Minerals Limited completed geological mapping and in 1965 performed a geophysical survey. According to the Gold Deposits of Ontario, Part 2 (Ontario Mineral Deposits Circular Number 18, 1979) the work outlined a zone 70 feet long, 3 feet wide and 250 feet deep containing 3,680 tons averaging 0.46 ounces per ton gold with minor silver and copper values. In 1980 Erana Mines Limited established an 85-ton custom gold mill and, in addition to milling material from other showings, a small tonnage was raised from the Young Shannon deposit. During our recent visit to the property we were able to find several samples of free gold on a pile of mineralized material from the Young Shannon deposit.

The first written record of work on the Chester Shannon prospect, located a half claim west of the subject property, is a 1938 consultant's report for Clam Lake Gold Mines Limited. The report describes drill results on the property on a shear zone striking N63°W and dipping 45° northward.

Gold values ranged from 4.37 to trace ounces per ton gold.

over widths from 5.5 inches to 39 inches, respectively. The property was discovered in 1927 and in 1931 had stripping, trenching and diamond drilling performed by the Chester Shannon Syndicate. In 1932 the zone was traced for 200 feet along strike and four diamond drill holes tested the vein to the 500 foot depth. A ten-ton metallurgical test was taken in 1932 and yielded 3.40 ounces per ton gold, 3.40 ounces per ton silver and 4.68 per cent copper (Ontario Government Technical Survey File Number 63.2957).

In 1933 a new zone was discovered on the west shore of Clam Lake and it was stripped and test pitted. In 1938 eleven (11) diamond drill holes were drilled. It was this drill program which was described in the 1938 consultant's report. In 1965, geological and electromagnetic surveys were completed and in 1971 an induced polarization program was followed by limited diamond drilling. The main zone is 260 feet long and, while widths are up to 24 feet, the average is only 1.5 feet. Below 115 feet (vertically) the shear becomes erratic. The west zone extension is comprised of irregular quartz lenses, striking N78°W and dipping 54° north, which lie at the contact between quartz porphyry and lamprophyre. The west zone has been exposed along 440 feet and consists of siderite, ankerite, quartz, biotite, pyrite, chalcopyrite and native gold.

During our recent visit to the property we took a grab sample from the shaft showing (2) and it returned 0.354 ounces per ton gold. There is presently an old headframe on the property, however all the buildings have been removed or destroyed.

The Shannon Island prospect is also located in Clam Lake but on an island, south of the Chester Shannon prospect. This property was trenched in 1933 and a 26-foot pit put down by Young-Shannon Gold Mines Limited. In 1934 a two-compartment shaft was sunk to 100 feet. Lateral development on the 100-foot level totalled 100 feet and 3000 feet of diamond drilling was also completed, all by Young-Shannon Gold Mines Limited. In 1973 Park Precious Metals Incorporated initiated geophysical surveys with follow-up drilling. They also de-watered the shaft and old workings for re-sampling. Best values in the shaft ranged from 0.32 to 1.82 ounces per ton gold and from 1.61 to 6.66 per cent copper. No widths are given for the assays.

(Ontario Mineral Deposits Circular number 18)

On Emerald Isle Resources Inc.'s Chester township property are several mineral showings. One in claim 720645 is described as being "a 56-foot section of massive fine-grained andesite or latite...fairly heavily sulphidized" (Siragusa, 1981). No assay values are given. A second in claim 734210 consists of a trenched vein 4 to 6 feet wide which yielded values in grab samples of 3 to 9 per cent copper and 0.24 ounces per ton gold. (Siragusa, 1981) There is no record of drilling on this prospect. A third showing in claim 734213 was from the core of diamond drill hole 3-71 drilled in 1971 by Coniston Holdings and Explorations Limited. From 276 to 403 feet the core is logged as "Various

acidic rocks, sheared, brecciated and fractures; sulphides, including chalcopryrite mainly in brecciated sections. Minor native copper widespread." (Siragusa, 1981). No assays are given. A fourth in claim 734211 consisted of two auriferous quartz viens occupying well-defined fractures in granodiorite "the southern vein is 2 feet wide and contains pyrite, chalcopryrite, native gold and tellurides. A chip sample assayed 6.12 ounces per ton gold" (Siragusa, 1981). No diamond drilling is reported on this showing. During the course of our property examination we discovered and sampled a number of new mineralized shear zones and/or quartz veins. The results are summarized below:

<u>Sample Number</u>	<u>Gold (ppbs)</u>	<u>Gold ounces per ton</u>
9351	1406	0.041
9352	66	-----
9353	3	-----
9354	63	-----
9356	43	-----
9357	18	-----
9358	43	-----
9359	27	-----
9360	2091	0.061
9361	714	0.021
9362	25	-----
9363	687	0.02

On Emerald Isle Resources Inc.'s Chester township property sporadic work has been completed as a result of its strategic position between several old gold prospects whose possible extensions trend from east-west to west-northwest. The possible extensions of these zones could lie under Emerald Isle Resources Inc.'s property. This suggestion is further encouraged by the presence of gold values on the subject property in a geological environment characteristic of the area.

The first recorded work on Emerald Isle Resources Inc.'s property was in 1965 for Shannon Minerals Limited. The report by W. Walker reported the results of a geological survey on the southern seven claims of the subject group. He also reports an electromagnetic survey (Ronka Mark III) which failed to define any strong conductors. In 1966 Chester Minerals Ltd. drilled five holes in the southern 7 claims of the subject block. These holes cut a succession of sheared andesites, dacites and diorites with quartz veins, carbonates and mineralization. No assays are reported. Most work up to 1965 was for gold, however several companies tried to find porphyry copper - molybdenum - gold - silver deposits. In 1970 Gogama Minerals Limited attempted exploration for porphyry-type deposits over the central portion of Emerald Isle's property. They completed geological, EM-VLF and induced polarization surveys. The latter results were never submitted while the former results yielded several weak to moderate conductors.

Also in 1970 Darwin Mines Limited held the northern part

of the subject claims and again an electromagnetic (EM-16) survey was completed delineating only weak to moderate conductors. Drilling was never completed and there is no record of a recommended induced polarization survey. In 1971 Gogama Minerals Limited completed three holes; 1-71, 2-71 and 3-71; on claims 734212 and 734214. The holes intersected sheared and brecciated granodiorites with pyrite, chalcopyrite; pyrrhotite, covellite, and chalcocite in quartz-filled shear zones. Assay results were not known.

In 1979 Canadian Crest Gold Mines Ltd. held a block of 9 claims which cover the centre of Emerald Ilse's property. Some trenching was reported on claims 720646 and 734210. Assays were not given. Also in 1979 Canadian Crest Gold Mines Ltd. drilled two holes in claim 734210. The holes cut sheared diorite and quartz-diorite porphyry with up to 10 per cent pyrite and chalcopyrite present over 6 feet. Although split for assay no assays are recorded.

The Emerald Isle Resources Inc. property has been the object of sporadic work, firstly and most successfully in the 1930's by prospecting for gold-copper-quartz shears in granites, granoliorites and quartz-diorites. The second pulse of exploration activity was from 1965 to 1979 when geophysics and diamond drilling were utilized to test for gold-copper-quartz shear zones and for porphyry copper-molybdenum-gold-silver deposits. These attempts were not successful due to the unresponsiveness of the area's mineral deposits to electromagnetic surveys.

REGIONAL AND ECONOMIC GEOLOGY

The Emerald Isle Resources Inc. Chester township property lies within the Canadian Precambrian Shield's Superior Province, the host for numerous base metal and precious metal deposits. More particularly, the property is located in the Swayze Greenstone Belt, an area of Archean metasediments and meta-volcanics which lies southwest of Timmins. The Swayze Greenstone Belt is 60 miles long from north to south and 40 miles wide at its widest. The belt is roughly bounded on the north and west by highway 101, on the east by highway 144, and on the south by the Canadian Pacific transcontinental rail line. (See insert-FIGURE 1). Intercalated Archean metasediments and metavolcanics comprise the majority of the belt. They strike 110° and dip steeply. The metasediments include polymictic conglomerates, argillites, arkoses, sulfide and/or oxide facies iron formations and cherts; the metavolcanics include mafic flows, felsic flows, agglomerates, pyroclastics, breccias and sub-volcanic porphyries. The entire assemblage has been tightly folded with fold axes sub-parallel to the regional strike and axes' plunge shallowly ($15-30^{\circ}$) in either direction. The folding has imparted a pervasive S_1 cleavage to the less competent rocks, which in most cases is parallel to local bedding and is often indistinguishable from bedding. Faulting is common and can trend in almost any direction locally, however regional fault trend northeast, north or northwest. Strike-slip faults are common and fault structures are extremely important for the development of gold deposits in the Swayze Belt. The metasediments and

metavolcanics have been intruded by granitic to gabbroic intrusions, also of Archean age. It appears that the intrusions were either syn- or pre-deformation because clearly some of the folding and related faulting affects the intrusions. The regional metamorphism is lower and upper greenschist facies, however contact metamorphic halos around the intrusions are common.

Proterozoic-aged diabase dykes intrude all other rock units and trend northerly. The diabase dykes appear to intrude lamprophyre dykes where the two are present together.

Gold deposits in the Swayze Greenstone include the following types:

(a) Gold in quartz veins related to shear zones in metavolcanics and metasediments and shear zones in intrusions, e.g. The Orofino deposit.

(b) Gold in replacement zones in intrusions, e.g. The Orofino deposit.

(c) Gold in chemical sediments (cherts and iron formations), e.g. Woman River Gold showing.

(d) Gold in sulfides disseminated along sheared contacts, e.g. The Jerome deposit.

Emerald Isle Resources Inc.'s Chester township property contains gold in quartz-filled shears in west-north-westerly trending shears in granodiorites (TYPE a). Also associated with the gold, which is in a free state, is pyrite, pyrrhotite, chalcopyrite, black tourmaline, sphalerite, bornite, covellite, malachite, azurite, molybdenite, molybdite and tellurides. The

shears may also trend northwest and east northeast but are dominantly west north-westerly. The deposits by their nature will be of limited tonnage but of high grade.

The area's mineralization, according to a 1931 Ore Dressing and Metallurgical Laboratories' report, could be successfully treated by amalgamation followed by flotation.

GEOLOGICAL SURVEY

The geological survey was completed by two geological technicians, Derek Erickson and Luc Laforest during July, 1985. They cut and chained an east-west base line and turned off picket lines at 200- and 400- foot intervals in a north-south direction. Stations were established at 100- foot intervals. The entire grid was traversed and used for control during the geological survey. All features were tied to the grid and all outcrop located were described and plotted on the map in the back pocket of this report.

Emerald Isle Resources Inc.'s Chester township property is underlain by an intercalated group of Archean metasediments, intermediate metavolcanics, felsic volcanics and granodiorite and monzonite intrusions. A late diabase dyke was located in claim P-734213. The author's experience in the Swayze Belt suggests that much of the intrusive units are in fact conformable and of volcanic origin.

The northern portion of the claim group is underlain by units c and e which are metasediments and intermediate metavolcanics, respectively. They strike east-west and dip steeply. A well-developed S_1 cleavage is also present in most of these units and the S_1 generally parallels the bedding where distinguishable.

South of the contact the rocks are "quartz monzonite" (unit d) "granodiorite" (unit a) intercalated with felsic volcanics (unit b).

The intermixing of units d, a and b strongly suggests a non-intrusive origin for units d and a or very narrow and frequent sills and dykes.

Clearly there are three areas to follow up based on the geological survey. Firstly, in claims P-734210, P-720647, P-734213 and P-734211 are a group of mineralized outcrops. Chalcopyrite, pyrite, malachite and hematite were observed in an assemblage of units b and d. Also observed are quartz veins in the same areas. An old pit was noted in the northwestern corner of claim P-734211 containing pyrite and chalcopyrite. The possibility of an extension of the Shannon Island gold prospect into claim P-734212 should also be considered.

The second area of potential interest occurs in claims P-720644 and P-720645 where several areas of pyrite and/or chalcopyrite were noted as well as a small pit. These showings are just south of a single drill hole in P-720645 which was described in 1981 by Siragusa as being a 56 - foot section of massive fine-grained andesite or latite...heavily mineralized.

The third interesting area occurs in the northern row of claims where several quartz veins or pods are present. As well there is a reported gold showing at the west end of the South Bay of Bagsverd Lake which yielded values of up to 0.28 ounces per ton.

The Emerald Isle property has excellent potential to contain

extensions of the main gold trends in Chester township. In addition, there is good potential to discover new trends and new gold zones.

EM-VLF SURVEYS

A Ronka (Geonics) EM-16 instrument was utilized for the survey. This is a one-man instrument which utilized the signals VLF transmitter stations located around the world to aid in navigation. The instrument measures in degrees or as a percentage of the primary field, the vertical distortion of the primary field caused by a local secondary electrical field. The local secondary field may be graphite, clay topography or sulfides.

In this case only the In Phase readings were recorded (in percentage). All readings were taken facing either Cutler or Annapolis stations. The results were plotted in profile on the maps in the pocket of this report.

The results show a series of weak to moderate, east-west trending conductors which appear to be near vertical. Several conductors which appear to be near vertical. Several conductors can be attributed to superficial features, while others are unexplained.

The conductors and their priority are listed below for Cutler Station:

<u>CONDUCTOR</u>	<u>LINES</u>	<u>STATIONS</u>	<u>STRENGTH AND SOURCE</u>
A	20W to 32W	18N to 20N	Weak, Superficial
B	16W to 24W	15N to 17N	Moderate, Poss. Bedrock
C	8W to 12W	18N	Moderate, Poss. Bedrock (Vertical Dip)
D	2W to 8W	16N to 18N	Weak, Superficial

<u>CONDUCTOR</u>	<u>LINES</u>	<u>STATIONS</u>	<u>STRENGTH AND SOURCE</u>
E	0 to 8E (open)	14N	Weak, Superficial
F	28W to 32W (open)	4N to 6N	Moderate, Poss. Bedrock
G	4W to 6W	7N	Moderate, Poss. Bedrock
H	4W to 12W	4N to 6N	Moderate, Poss. Bedrock (Poss. South Dip)
I	32W to 34W (open)	0 to 2S	Moderate, Poss. Bedrock
J	24W to 26W	0 to 2S	Moderate, Poss. Bedrock (Vertical Dip)
K	26W to 32W (open)	5S	Moderate, Poss. Bedrock
L & M	22W to 32W (open)	6+50S	Weak, Superficial
N	14W to 22W (open)	8S to 10S	Weak, Superficial
O	28W to 30W (open)	14S and 16S	Moderate, Poss. Bedrock
P	20W to 26W	19S	Weak, Superficial
Q	14W to 20W (open)	22S to 25S	Moderate, Poss. Bedrock
R	16W to 20W	27S to 29S	Weak, Superficial
S	32W to 38W (open)	21S to 23S	Moderate, Poss. Bedrock
T	34W to 38W (open)	26S	Moderate, Poss. Bedrock (Poss. North Dip)

There are also several single cross over conductors, the most interesting of which coincides with a mineralized pit on line 30+00W at 23+75S.

The Annapolis station was read separately on a different day than the Cutler readings. Basically the major Annapolis conductors coincide with a Cutter conductor:

<u>CUTLER CONDUCTOR</u>	<u>ANNAPOLIS CONDUCTORS</u>	<u>STRENGTH AND SOURCE</u>
B	BB	Weak, Superficial
D	DD	Weak, Superficial
E	EE	Weak, Superficial
F	FF (open)	Moderate Poss. Bedrock
G	GG	Moderate, Poss. Bedrock
I-J	II-JJ (open)	Moderate, Poss. Bedrock
K	KK	Weak, Superficial
L-M	LL-MM	Weak Superficial
N	NN	Weak, Superficial
O	OO	Weak, Superficial
T	TT	Moderate, Poss. Bedrock

Only BB, KK and OO conductors vary in strength from the Cutler Conductors.

CONCLUSIONS, RECOMMENDATIONS AND COST ESTIMATES

There are several areas worthy of stripping, trenching and sampling on Emerald Isle's Chester township property:

Area 1: Northwest corner of P-734211 and all of P-734212 for an extension of Shannon Island Showing.

Area 2: Claim P-734210 where a 4- to 6- foot wide vein ran 3 to 9 percent copper and 0.24 o.p.t. gold.

Area 3: Claim P-734213 where native copper, chalcopryrite and quartz veins over 125 feet wide was reported in old drill holes.

Area 4: Claims P-720645 and P-720644 where chalcopryrite and pyrite is known as well as a 56- foot wide zone of heavy mineralization.

Based on the presence of gold showings, both on and near the subject property we recommend a two-phase exploration program totalling \$142,000.

PHASE I

STRIPPING, TRENCHING AND SAMPLING

20 days X \$1000. per day.....	\$20,000.00
(included 2 men, equipment and sampling costs)	
Contingencies (10%).....	<u>2,000.00</u>
Total of Phase I.....	\$22,000.00

PHASE II

STRIPPING, TRENCHING AND SAMPLING

10 days X \$1000. per day.....\$ 10,000.00
(includes 2 men, equipment and sampling costs)...

Diamond Drilling (B.Q. Core)

5000 feet at \$20. per foot..... 100,000.00
(included drilling costs, core boxes, supervision
and analysis)

Contingencies (10%)..... 10,000.00

Total of Phase II.....\$120,000.00

Total of Phase I and II.....\$142,000.00

Phase I is designed to expose and assess the areas out-
lined above. Dependent on the results of Phase I, we would
proceed to Phase II which is designed to further assess the
area from Phase I and some of the other lower priority targets
on the property. The best of these area would be diamond
drill - tested

Dated August 10th, 1985
At Sudbury, Ontario.

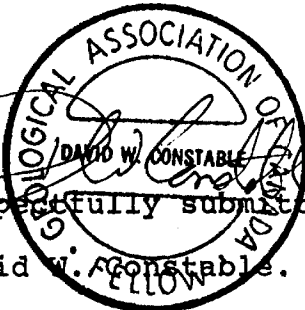

Respectfully submitted,
David W. Constable.

CERTIFICATION

I, DAVID W. CONSTABLE, certify that:

1. I am a consulting geologist, president of Constable Consulting Inc. with an office at 10 Kingston Court, Sudbury, Ontario.
2. I am a 1970 graduate of Mount Allison University, New Brunswick, with an Honours Bachelor of Science -(geology) degree; and in 1970-71 performed a years post graduate work at OXFORD University, ENGLAND.
3. I am a Fellow of the Geological Association of CANADA since 1975.
4. I have been continuously employed in mineral exploration and development since graduation in all of Canada and parts of the United States.
5. This report is based on supervision of the work program and personal experience in the Swazye Belt and the Chester township property in particular.
6. I have no interest, direct or indirect, in Emerald Isle Resources Inc.'s Chester township property nor do I expect to receive any interest. I have disclosed all data which I am aware of which may have a bearing on my recommendations relevant to Emerald Isle's Chester township property.

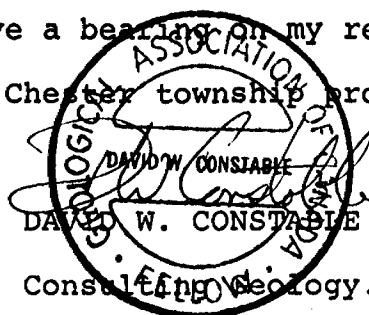
Dated the 10th of August
At Sudbury, Ontario.

 DAVID W. CONSTABLE
 Consulting Geology.

APPENDIX IBIBLIOGRAPHY

- Gordon et al 1979, Gold Deposits of Ontario Part II, Ontario Geological Survey, Mineral Deposits Circular 18
- Laird, H. C. 1932, Ontario Department of Mines Annual Report Volume 41 Part 3 Geology of the Three Duck Lakes Area
- Laird, H. C. 1934, Ontario Department of Mines Annual Report Volume 43 Part 3
- Siragusa, G.M. and assistants, 1981, Precambrian Geology of Chester and Yeo Townships Ontario Geological Survey Preliminary Map P 2449, Geological Series, Scale 1:15,840
- Young, C.T. 1934, Report on Young-Shannon Gold Mines Limited Properties, Chester Township, Ontario Department of Mines Property Description

ONTARIO GEOLOGICAL SURVEY

ASSESSMENT FILES

<u>File Number</u>	<u>Year</u>	<u>Company</u>
T-2016	1938	Clam Lake Gold Mines Limited
T-2016	1939	Erie Canadian Mines
T-2016	1939	Sylvanite Gold Mines Ltd.
T-2034	1955	W. S. Savage
T-2034	1965	Shannon Minerals Limited
T-2020	1965	Gogama Gold Mines Limited
T-2023	1965	Chester Minerals Limited
T-2023	1966	Chester Minerals Limited
T-2013	1970	Darwin Mines Limited
T-2482	1970	Gogama Minerals Limited
T-2021	1970	Gogama Minerals Limited
T-2017	1971	Gogama Minerals Limited
T-2017	1972	Coniston Explorations Ltd.
T-2030	1973	Park Precious Metals Incorporated
T-1751	1979	Baxter Minerals Ltd.
T-1751	1981	Canadian Crest Mines Ltd.

APPENDIX II

CLAIM ABSTRACTS

DIT NUMBER

415603



Ministry of Natural Resources

Mining Claim

The Mining Act

CLAIM NO.

P-734504 ✓

RECORDED IN THE NAME OF Wilfred MacAdams	LICENCE NO. C-31567	RECEIPT NO. 341249	DATE RECORDED December 21, 1983
--	-------------------------------	------------------------------	---

ADDRESS 1327 Arvo St., Sudbury, Ont.	DATE AND TIME OF STAKING Dec. 17/83 at 7:05 A.M.
--	--

ASSESSMENT WORK CREDITS ASSIGNED TO OTHER CLAIMS	OFFICE USE ONLY	DATE RECORDED	BALANCE	DESCRIPTION OF CLAIM
				<p>CHESTER TOWNSHIP</p> <p>RESERVATIONS — 400 FOOT SURFACE RIGHTS RESERVATION AROUND ALL LAKES AND RIVERS SAND AND GRAVEL RESERVED. PEAT RESERVED.</p> <p>Excluding Hydro right-of-way</p>

FILE NO.

734497

DATE	DAYS WORK		RECEIPT NO.

This Abstract is a copy of the entries in the Record Book and is not to be construed as assurance of the validity of the claim.

APR 12 1984

[Signature]

Mining Recorder
PORCUPINE MINING DIVISION

LOT NUMBER
415606



Ministry of
Natural
Resources

Mining Claim

The Mining Act

CLAIM NO

P-734501

RECORDED IN THE NAME OF Wilfred MacAdams	LICENCE NO. C-31567	RECEIPT NO. 341249	DATE RECORDED December 21, 1983
ADDRESS 1327 Arvo St., Sudbury, Ont.		DATE AND TIME OF STAKING Dec. 17/83 at 1:00 P.M.	

ASSESSMENT WORK CREDITS ASSIGNED TO OTHER CLAIMS	OFFICE USE ONLY	DAYS RECORDED	BALANCE	DESCRIPTION OF CLAIM
				CHESTER TOWNSHIP RESERVATIONS — 400 FOOT SURFACE RIGHTS RESERVATION AROUND ALL LAKES AND RIVERS SAND AND GRAVEL RESERVED. PEAT RESERVED. Including Land Under Water
				FILE NO 734497

DATE	DAYS WORK	RECEIPT NO.

This document is a copy of the entries in the Record Book maintained to give effect to the assurance of the validity of the claim.

APR 12 1984

Mining Recorder
PROSPECTIVE MINING DIVISION

LOT NUMBER
415607



Ministry of
Natural
Resources

Mining Claim

The Mining Act

CLAIM NO
P-734500

RECORDED IN THE NAME OF Wilfred MacAdams		LICENCE NO. C-31567	RECEIPT NO. 341249	DATE RECORDED December 21, 1983
--	--	-------------------------------	------------------------------	---

ADDRESS 1327 Arvo St., Sudbury, Ont.	DATE AND TIME OF STAKING Dec. 17/83 at 3:10 P.M.
--	--

ASSESSMENT WORK CREDITS ASSIGNED TO OTHER CLAIMS	OFFICE USE ONLY	DATE RECORDED	BALANCE	DESCRIPTION OF CLAIM CHESTER TOWNSHIP RESERVATIONS — 400 FOOT SURFACE RIGHTS RESERVATION AROUND ALL LAKES AND RIVERS SAND AND GRAVEL RESERVED. PEAT RESERVED. Including Land Under Water FILE NO 734497

DATE	DAYS WORK		RECEIPT NO

This Abstract is a copy of the entries in the
 ... as
 assurance of the validity of the claim.

APR 12 1984

Mining Recorder
 MINING DIVISION

CLAIM NUMBER
415619



Ministry of Natural Resources

Mining Claim

The Mining Act

CLAIM NO
P-720647 ✓

RECORDED IN THE NAME OF Michael Brady	LICENCE NO. C-34162	RECEIPT NO. 341249	DATE RECORDED December 21, 1983
---	-------------------------------	------------------------------	---

ADDRESS 1605 Bancroft Drive, Sudbury, Ont.	DATE AND TIME OF STAKING Dec. 17/83 at 2:10 P.M.
--	--

ASSESSMENT WORK CREDITS ASSIGNED TO OTHER CLAIMS	OFFICE USE ONLY	DAYS RECORDED	BALANCE	DESCRIPTION OF CLAIM CHESTER TOWNSHIP RESERVATIONS — 400 FOOT SURFACE RIGHTS RESERVATION AROUND ALL LAKES AND RIVERS SAND AND GRAVEL RESERVED. PEAT RESERVED

FILE NO
720644

DATE	DAYS WORK			RECEIPT NO
------	--------------	--	--	------------

This Abstract is a copy of the entries in the Record Book and is not to be considered as assurance of the validity of the claim.

APR 12 1984

Mining Recorder
PORCUPINE MINING DIVISION

ADDITIONAL NUMBER

415618



Ministry of Natural Resources

Mining Claim

The Mining Act

CLAIM NO.

P-720646

RECORDED IN THE NAME OF Michael Brady	LICENCE NO. C-34162	RECEIPT NO. 341249	DATE RECORDED December 21, 1983
---	-------------------------------	------------------------------	---

ADDRESS 1605 Bancroft Drive, Sudbury, Ont.	DATE AND TIME OF STAKING Dec. 17/83 at 12:00 NOON
--	---

ASSESSMENT WORK CREDITS ASSIGNED TO OTHER CLAIMS	OFFICE USE ONLY	DATE RECORDED	BALANCE	DESCRIPTION OF CLAIM

RESERVATIONS — 400 FOOT SURFACE RIGHTS RESERVATION AROUND ALL LAKES AND RIVERS
SAND AND GRAVEL RESERVED. PEAT RESERVED.

FILE NO.
720644

DATE	DAYS WORK	RECEIPT NO.
------	-----------	-------------

This Abstract is a copy of the entries in the Record Book and is to be used for all purposes as evidence of the validity of the claim.

APR 12 1984

Mining Recorder
PROCLERK MINING DIVISION

AUDIT NUMBER

415616



Ministry of
Natural
Resources

Mining Claim

The Mining Act

CLAIM NO

P-720644

RECORDED IN THE NAME OF Michael Brady	LICENCE NO. C-34162	RECEIPT NO. 341249	DATE RECORDED December 21, 1983
---	-------------------------------	------------------------------	---

ADDRESS
1605 Bancroft Drive, Sudbury, Ont.

DATE AND TIME OF STAKING
**Dec. 17/83
at 7:05 A.M.**

ASSESSMENT WORK CREDITS ASSIGNED TO OTHER CLAIMS	OFFICE USE ONLY	DATE RECORDED	BALANCE

DESCRIPTION OF CLAIM
CHESTER TOWNSHIP

RESERVATIONS — 400 FOOT SURFACE RIGHTS RESERVATION AROUND ALL LAKES AND RIVERS
BAND AND GRAVEL RESERVED. PEAT RESERVED.

Including Land Under Water

FILE NO

720644

DATE	DATE WORK		RECEIPT NO

This Abstract is a copy of the entries in the
Record Book and is not to be treated as
evidence of the validity of the claim.

APR 12 1984

[Signature]
Mining Recorder
PROBATIONARY MINING DIVISION



Type of Survey(s): Linecutting, Geological & EM-VLF (2) Township or Area: Chester Township
 Claim Holder(s): Emerald Lake Resources Inc. Prospector's Licence No.: T 1861
 Address: 106 Fielding Road Lively Ont. P0M 2E0
 Survey Company: CONSTABLE CONSULTING INC. Date of Survey (from & to): 01 06 85 to 08 08 85 Total Miles of line Cut: 13.03
 Name and Address of Author (of Geo-Technical report): DAVID CONSTABLE 10 KINGSTON COURT SUDBURY ONT. P3A1C9

Credits Requested per Each Claim in Columns at right

Special Provisions	Geophysical	Days per Claim
For first survey: Enter 40 days. (This includes line cutting)	- Electromagnetic	40
	- Magnetometer	
	- Radiometric	
	- Other	
For each additional survey: using the same grid: Enter 20 days (for each)	Geological	40
	Geochemical	

Man Days	Geophysical	Days per Claim
Complete reverse side and enter total(s) here	- Electromagnetic	
	- Magnetometer	
	- Radiometric	
	- Other	
	Geological	
	Geochemical	

Airborne Credits	Geophysical	Days per Claim
Note: Special provisions credits do not apply to Airborne Surveys.	Electromagnetic	
	Magnetometer	
	Radiometric	

Mining Claims Traversed (List in numerical sequence)

Prefix	Mining Claim Number	Expend. Days Cr.	Prefix	Mining Claim Number	Expend. Days Cr.
P	734497	40			
	734498	40			
	734499	40			
	734500	40			
	734501				
	734502				
	734503				
	734504				
	720644				
	720645				
	720646				
	720647				
	734210				
	734211				
	734212				
	734213				

RECEIVED
AUG 19 1985

RECORDED
AUG 19 1985

RECEIVED
AUG 17 1985
MINING SECTION

Expenditures (excludes power stripping)

Type of Work Performed: LINE CUTTING

Performed on Claim(s): 734497-734504

Calculation of Expenditure Days Credits

Total Expenditures \$ ÷ 15 = Total Days Credits

Instructions: Total Days Credits may be apportioned at the claim holder's choice. Enter number of days credits per claim selected in columns at right.

Total number of mining claims covered by this report of work. 16

Date: Aug 13/85 (Recorded Holder or Agent Signature): David Constable

For Office Use Only

Total Days Cr. Recorded: 1,120 Date Recorded: Aug 19/85 Mining Reporter: Stanley

Date Approved as Recorded: 1,280 Branch Director:

Certification Verifying Report of Work

I hereby certify that I have a personal and intimate knowledge of the facts set forth in the Report of Work annexed hereto, having performed the work or witnessed same during and/or after its completion and the annexed report is true.

Name and Postal Address of Person Certifying: DAVID CONSTABLE, CONSTABLE CONSULTING INC.

10 KINGSTON CRT. SUDBURY ONT P3A1C9 Date Certified: August 13/85 Certified by (Signature): David Constable



Report of Work
(Geophysical, Geological,
Geochemical and Expenditures)

263/85
28372

The Mining Act

- Instructions: - Please type or print.
- If number of mining claims traversed exceeds space on this form, attach a list.
Note: - Only days credits calculated in the "Expenditures" section may be entered in the "Expend. Days Cr." columns.
- Do not use shaded areas below.

Type of Survey(s) Linecutting, Geological & EM-VLF (2)	Township or Area Chester Township
Claim Holder(s) Emerald Lake Resources Inc.	Prospector's Licence No. T 1861
Address 106 Fielding Road Lively Ont. P0M 2E0	
Survey Company CONSTABLE CONSULTING INC.	Date of Survey (from & to) Day Mo. Yr. Day Mo. Yr. 01 06 85 08 08 85
Name and Address of Author (of Geo-Technical report) DAVID CONSTABLE, 10 KINGSTON COURT SUDBURY ONT. P3A1C9	
Total Miles of line Cut 13.03	

Credits Requested per Each Claim in Columns at right

Mining Claims Traversed (List in numerical sequence)

Special Provisions	Geophysical	Days per Claim
For first survey: Enter 40 days. (This includes line cutting)	- Electromagnetic	40
	- Magnetometer	
	- Radiometric	
	- Other	
For each additional survey: using the same grid: Enter 20 days (for each)	Geological	40
	Geochemical	

Man Days	Geophysical	Days per Claim
Complete reverse side and enter total(s) here	- Electromagnetic	
	- Magnetometer	
	- Radiometric	
	- Other	
	Geological	
	Geochemical	

Airborne Credits	Days per Claim
Note: Special provisions credits do not apply to Airborne Surveys.	
Electromagnetic	
Magnetometer	
Radiometric	

Mining Claim		Expend. Days Cr.	Mining Claim		Expend. Days Cr.
Prefix	Number		Prefix	Number	
P	734497				
	734498				
	734499				
	734500				
	734501				
	734502				
	734503				
	734504				
	720644				
	720645				
	720646				
	720647				
	734210				
	734211				
	734212				
	734213				

*Geological Only
not included in geophysical*

RECEIVED

AUG 22 1985

MINING DIVISION
AUG 19 1985

RECORDED
AUG 19 1985

See journal work statements

Expenditures (excludes power stripping)

Type of Work Performed

Performed on Claim(s)

Calculation of Expenditure Days Credits

Total Expenditures \$ ÷ 15 = Total Days Credits

Total number of mining claims covered by this report of work. **16**

Instructions: Total Days Credits may be apportioned at the claim holder's choice. Enter number of days credits per claim selected in columns at right.

For Office Use Only	
Total Days Cr. Recorded 1120	Date Recorded Aug 19/85
Date Approved as Recorded	Miner's Report <i>Chenley</i>
	Branch Director

Date **Aug 13/85** (Recorded Holder or Agent Signature) *DW Constable*

Certification Verifying Report of Work

I hereby certify that I have a personal and intimate knowledge of the facts set forth in the Report of Work annexed hereto, having performed the work or witnessed same during and/or after its completion and the annexed report is true.

Name and Postal Address of Person Certifying
DAVID CONSTABLE, CONSTABLE CONSULTING INC.

10 KINGSTON CRT. SUDBURY ONT P3A1C9

Date Certified **August 13/85** Certified by (Signature) *DW Constable*



Ontario

Ministry of
Natural
Resources

Technical Assessment Work Credits

File 2.8372

Date 1985 09 18	Mining Recorder's Report of Work No. 263
--------------------	---

Recorded Holder Emerald Isle Resources Inc
Township or Area Chester Township

Type of survey and number of Assessment days credit per claim	Mining Claims Assessed
Geophysical Electromagnetic <u>2 VLF</u> <u>40</u> days Magnetometer _____ days Radiometric _____ days Induced polarization _____ days Other _____ days Section 77 (19) See "Mining Claims Assessed" column Geological <u>40</u> days Geochemical _____ days Man days <input type="checkbox"/> Airborne <input type="checkbox"/> Special provision <input checked="" type="checkbox"/> Ground <input checked="" type="checkbox"/> <input type="checkbox"/> Credits have been reduced because of partial coverage of claims. <input type="checkbox"/> Credits have been reduced because of corrections to work dates and figures of applicant.	P 734497 734500 to 04 incl 720644 to 47 incl 734210 to 13 incl

Special credits under section 77 (16) for the following mining claims

20 days Electromagnetic &
20 days Magnetometer.

P 734498-99

No credits have been allowed for the following mining claims

not sufficiently covered by the survey Insufficient technical data filed

The Mining Recorder may reduce the above credits if necessary in order that the total number of approved assessment days recorded on each claim does not exceed the maximum allowed as follows: Geophysical — 80; Geological — 40; Geochemical — 40; Section 77 (19)—60:



GEOPHYSICAL - GEOLOGICAL - GEOCHEMICAL
TECHNICAL DATA STATEMENT

TO BE ATTACHED AS AN APPENDIX TO TECHNICAL REPORT
FACTS SHOWN HERE NEED NOT BE REPEATED IN REPORT
TECHNICAL REPORT MUST CONTAIN INTERPRETATION, CONCLUSIONS ETC.

Type of Survey(s) Geological and EM-VLF (2)
Township or Area Chester Township
Claim Holder(s) EMERALD Isle Resources INC
106 Fielding Rd. Kirkby ont. P0M 2E0
Survey Company CONSTABLE CONSULTING INC.
Author of Report DAVID CONSTABLE
Address of Author 10 KINGSTON COURT Sudbury
P3A1C9
Covering Dates of Survey 01/06/85 to 08/08/85
(linecutting to office)
Total Miles of Line Cut 13.03

SPECIAL PROVISIONS CREDITS REQUESTED	DAYS per claim	
	Geophysical	
ENTER 40 days (includes line cutting) for first survey.	-Electromagnetic	<u>40</u>
	-Magnetometer	_____
	-Radiometric	_____
ENTER 20 days for each additional survey using same grid.	-Other	_____
	Geological	<u>40</u>
	Geochemical	_____

AIRBORNE CREDITS (Special provision credits do not apply to airborne surveys)

Magnetometer _____ Electromagnetic _____ Radiometric _____
(enter days per claim)

DATE: Aug 13/85 SIGNATURE: [Signature]
Author of Report or Agent

Res. Geol. _____ Qualifications 2.3493

Previous Surveys			
File No.	Type	Date	Claim Holder

MINING CLAIMS TRAVERSED List numerically	
P-720644	(prefix) (number)
P-720645	
P-720646	
P-720647	
P-734210	
P-734211	
P-734212	
P-734213	
P-734497	
P-734498	
P-734499	
P-734500	
P-734501	
P-734502	
P-734503	
P-734504	
RECEIVED AUG 22 1985 MINING LANDS SECTION	
TOTAL CLAIMS <u>16</u>	

If space insufficient, attach list

OFFICE USE ONLY

GEOPHYSICAL TECHNICAL DATA

GROUND SURVEYS - If more than one survey, specify data for each type of survey

Number of Stations 648 Number of Readings 648
Station interval 100 feet Line spacing 400 and 200 feet
Profile scale 1 inch = 50'
Contour interval N/A

MAGNETIC

Instrument
Accuracy - Scale constant
Diurnal correction method
Base Station check-in interval (hours)
Base Station location and value

ELECTROMAGNETIC

Instrument EM-16
Coil configuration HORIZONTAL
Coil separation INFINITE
Accuracy +/- 1'
Method: [X] Fixed transmitter [] Shoot back [] In line [] Parallel line
Frequency Cutler Maine and Annapolis Md. (specify V.L.F. station)
Parameters measured IN-Phase in degrees

GRAVITY

Instrument
Scale constant
Corrections made
Base station value and location
Elevation accuracy

INDUCED POLARIZATION RESISTIVITY

Instrument
Method [] Time Domain [] Frequency Domain
Parameters - On time Frequency
- Off time Range
- Delay time
- Integration time
Power
Electrode array
Electrode spacing
Type of electrode

SELF POTENTIAL

Instrument _____ Range _____

Survey Method _____

Corrections made _____

RADIOMETRIC

Instrument _____

Values measured _____

Energy windows (levels) _____

Height of instrument _____ Background Count _____

Size of detector _____

Overburden _____

(type, depth - include outcrop map)

OTHERS (SEISMIC, DRILL WELL LOGGING ETC.)

Type of survey _____

Instrument _____

Accuracy _____

Parameters measured _____

Additional information (for understanding results) _____

AIRBORNE SURVEYS

Type of survey(s) _____

Instrument(s) _____

(specify for each type of survey)

Accuracy _____

(specify for each type of survey)

Aircraft used _____

Sensor altitude _____

Navigation and flight path recovery method _____

Aircraft altitude _____ Line Spacing _____

Miles flown over total area _____ Over claims only _____

August 29, 1985

File: 2.8372

**Emerald Isle Resources Inc
106 Fielding Road
Lively, Ontario
POM 2E0**

Dear Sir:

**RE: Geophysical (Electromagnetic) &
Geological Surveys submitted on
Mining Claims P 720644, et al,
in Chester Township**

**Enclosed are the plans (in duplicate) for the
above-mentioned surveys. In order to complete
your submission, please show the actual readings
at each station.**

**When returning this material, please quote file
2.8372.**

**For further information, please contact Dennis Kinvig
at (416)965-4888.**

Yours sincerely,

**S.E. Yundt
Director
Land Management Branch**

**Whitney Block, Room 6643
Queen's Park
Toronto, Ontario
M7A 1W3
Phone:(416)965-4888**

D. Kinvig:mc

**cc: Mining Recorder
Timmins, Ontario
File: 263/85**

**cc: David Constable
10 Kingston Court
Sudbury, Ontario
P3A 1C9**

Encl.

1985 10 08

Your File: 263
Our File: 2.8372

Mining Recorder
Ministry of Natural Resources
60 Wilson Avenue
Timmins, Ontario
P4N 2S7

Dear Sir:

RE: Notice of Intent dated September 18, 1985
Geophysical (Electromagnetic, VLF) and
Geological Surveys on Mining Claims P734497
et al, in Chester Township

The assessment work credits, as listed with the
above-mentioned Notice of Intent, have been approved
as of the above date.

Please inform the recorded holder of these mining
claims and so indicate on your records.

Yours sincerely,

S.E. Yundt
Director
Land Management Branch

Whitney Block, Room 6643
Queen's Park
Toronto, Ontario
M7A 1W3
Phone:(416)965-4888

DK/mc

cc: Emerald Isle Resources Inc
106 Fielding Road
Lively, Ontario
POM 2E0

cc: Resident Geologist
Timmins, Ontario

Encl.

cc: David Constable
Constable Consulting Inc
10 Kingston Court
Sudbury, Ontario
P3A 1C9

cc: Mr. G.H. Ferguson
Mining & Lands Commissioner
Toronto, Ontario

Mining Lands Section

File No 28372

Control Sheet

TYPE OF SURVEY

- GEOPHYSICAL
- GEOLOGICAL
- GEOCHEMICAL
- EXPENDITURE

MINING LANDS COMMENTS:

- V.L.F. surveys done on separate days.

< Chester >

h.s.

[Signature]

Signature of Assessor

Sept 10/85

Date



Oct. 3/85

1985 09 18

Your File: 263
Our File: 2.8372

Mining Recorder
Ministry of Natural Resources
60 Wilson Avenue
Timmins, Ontario
P4N 2S7

Dear Sirs: .

Enclosed are two copies of a Notice of Intent with statements listing a reduced rate of assessment work credits to be allowed for a technical survey. Please forward one copy to the recorded holder of the claims and retain the other. In approximately fifteen days from the above date, a final letter of approval of these credits will be sent to you. On receipt of the approval letter, you may then change the work entries on the claim record sheets.

For further information, if required, please contact Mr. R.J. Pichette at 416/965-4888. .

Yours sincerely,

S.E. Yundt
Director
Land Management Branch

Whitney Block, Room 6643
Queen's Park
Toronto, Ontario
M7A 1W3

R.R.K. D. Kinvig:mc

Encls.

cc: Emerald Isle Resources Inc
106 Fielding Road
Lively, Ontario
POM 2E0
cc: David Constable
Constable Consulting Inc.
10 Kingston Court
Sudbury, Ontario
P3A 1C9

cc: Mr. G.H. Ferguson
Mining & Lands Commissioner
Toronto, Ontario



Ministry of
Natural
Resources

Notice of Intent
for Technical Reports

1985 09 18

2.8372/263

An examination of your survey report indicates that the requirements of The Ontario Mining Act have not been fully met to warrant maximum assessment work credits. This notice is merely a warning that you will not be allowed the number of assessment work days credits that you expected and also that in approximately 15 days from the above date, the mining recorder will be authorized to change the entries on his record sheets to agree with the enclosed statement. Please note that until such time as the recorder actually changes the entry on the record sheet, the status of the claim remains unchanged.

If you are of the opinion that these changes by the mining recorder will jeopardize your claims, you may during the next fifteen days apply to the Mining and Lands Commissioner for an extension of time. Abstracts should be sent with your application.

If the reduced rate of credits does not jeopardize the status of the claims then you need not seek relief from the Mining and Lands Commissioner and this Notice of Intent may be disregarded.

If your survey was submitted and assessed under the "Special Provision-Performance and Coverage" method and you are of the opinion that a re-appraisal under the "Man-days" method would result in the approval of a greater number of days credit per claim, you may, within the said fifteen day period, submit assessment work breakdowns listing the employees names, addresses and the dates and hours they worked. The new work breakdowns should be submitted direct to the Land Management Branch, Toronto. The report will be re-assessed and a new statement of credits based on actual days worked will be issued.

September 4, 1985

File: 2.8372

Whitney Block, Room 6643

Queen's Park

Toronto, Ontario

M7A 1W3

Dear: Dennis Kinvig

RE: Geophysical (Electromagnetic) & Geological Surveys
submitted on Mining Claims P 720644, et, al, in Chester Township.

Enclosed are the plans (in duplicate) for the mentioned survey. These plans now include the survey readings at each station respectively.

Yours Sincerely,



Derek M. Erickson

Field Technician

RECEIVED	
LAND MANAGEMENT BRANCH	
SEP - 9 '85	
PREPARE REPLY	<input type="checkbox"/>
COMMENTS PLEASE	<input type="checkbox"/>
BY	
S. E. YLINDT	
J. R. MORTON	
J. C. SMITH	
W. P. BROOK	
M. J. HOGAN	
D. W. SCOTT	
S. KEEN	
Return To: R.6643	

Emerald Isle Resources Inc.

106 Fielding Road

Lively, Ontario

POM 2EO

RECEIVED

SEP 09 1985

MINING LANDS SECTION

2.8372

on different days

	<u>1.11.</u>	<u>1.12.</u>		<u>T.M.</u>	<u>Seeds</u>				
P. 734497		✓	720644		✓				
. 98	1/2	1/2	. 45		✓				
99	1/2	1/2	46		✓				
00		✓	720647		✓				
01		✓	734210		✓				
02		✓	11		✓				
03		✓	12		✓				
734504		✓	734213		✓				

D.K.

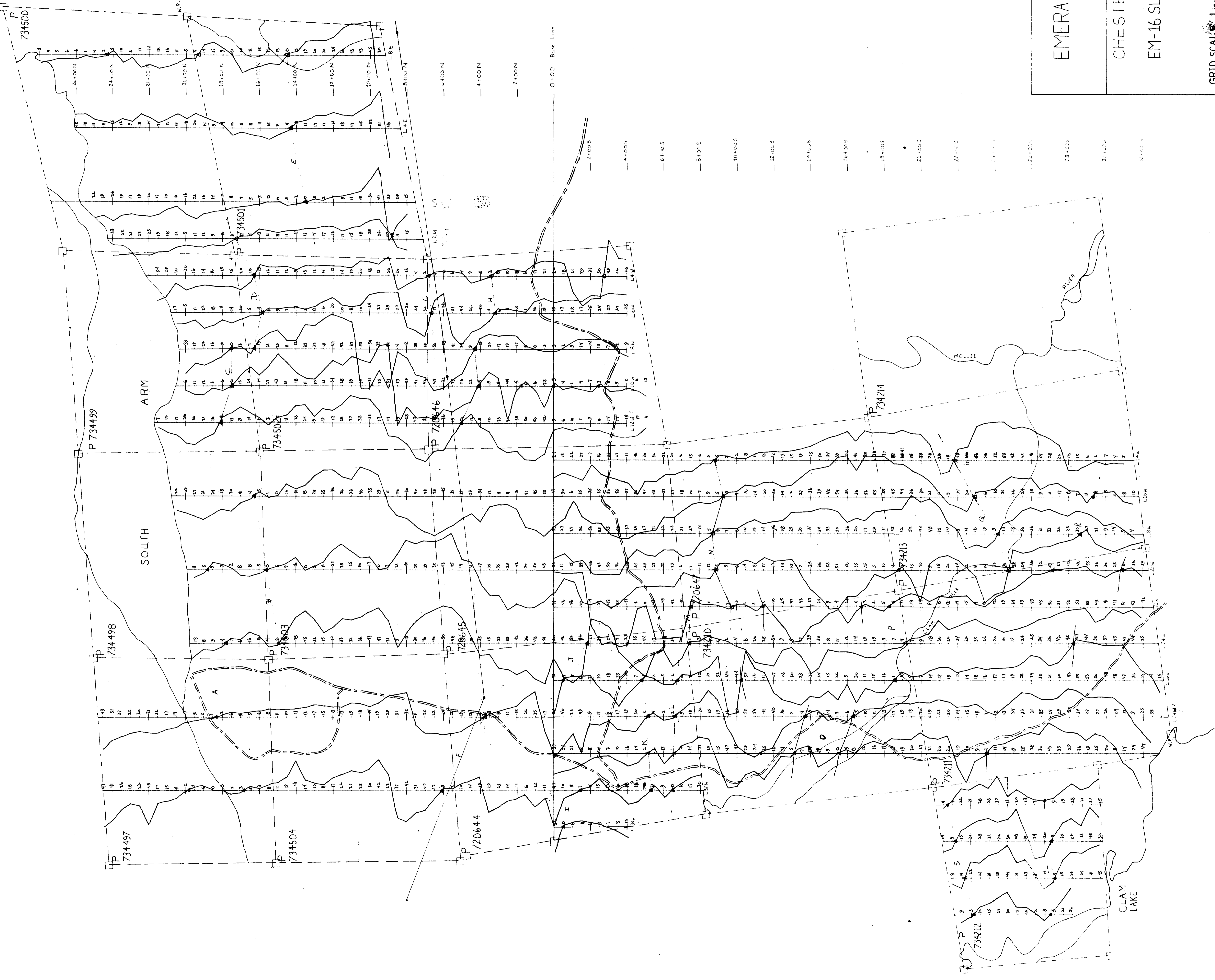
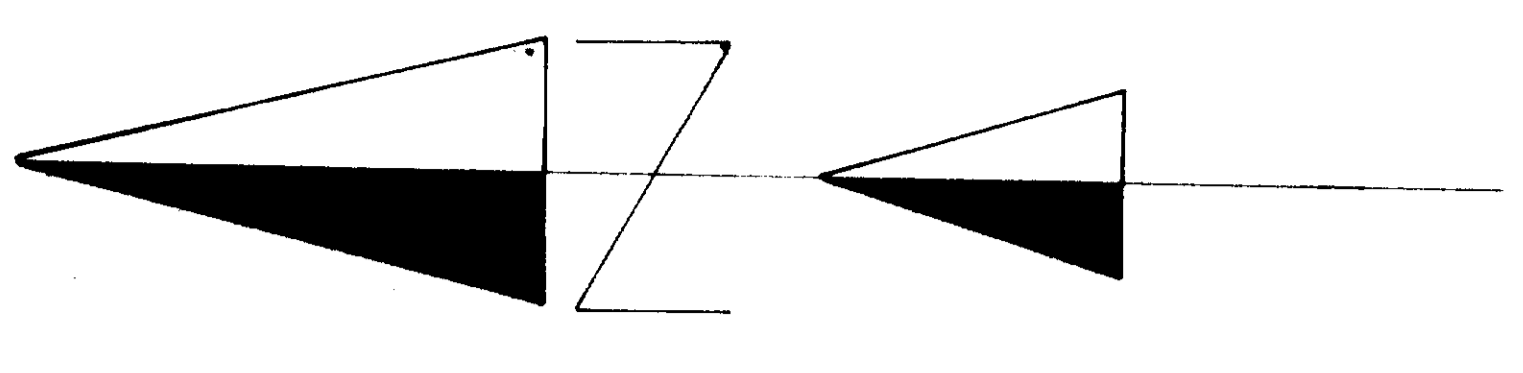

LEGEND :

- ROADWAY
- CLAIM LINE
- HYDRO LINE
- CONDUCTOR AXIS

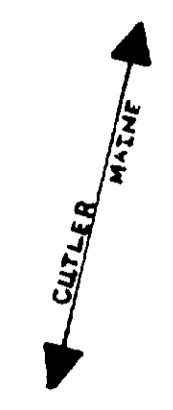

IN-PHASE ANGLE SCALE
0 25 50 75 100 Degrees

Note: Claim # 734214 was not measurable.

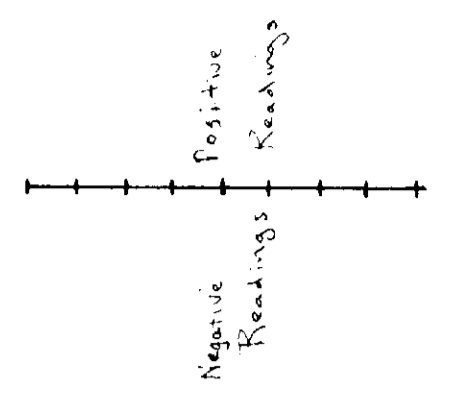

EMERALD ISLE RESOURCES LIMITED

CHESTER TOWNSHIP PROPERTY

EM-16 SURVEY RESULTS

28372

GRID SCALE: 1 inch = 200 feet

DATE: Wednesday July 24, 1985
Drawn by: D. Erickson



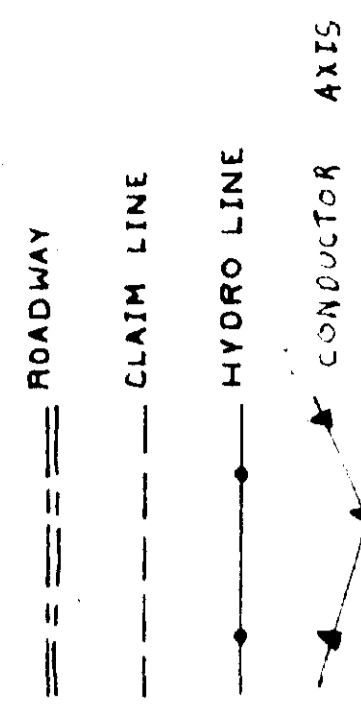
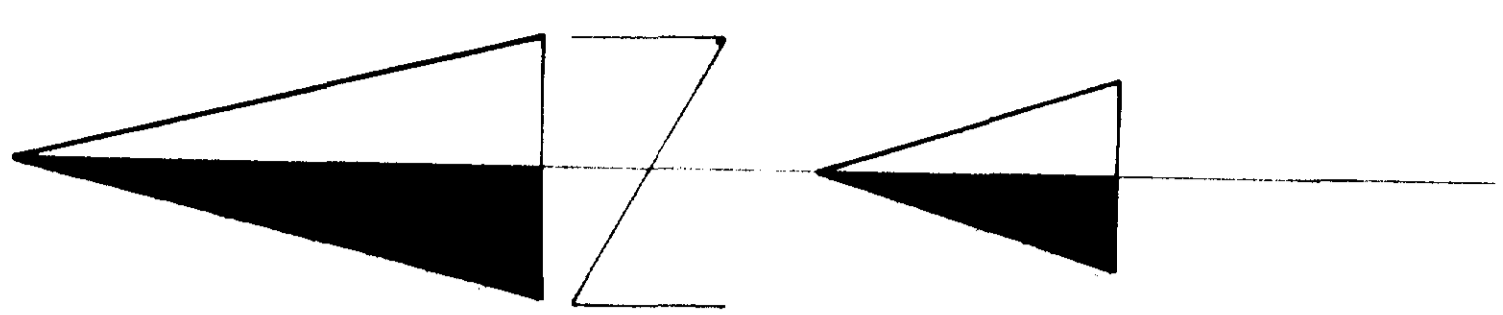

LEGEND :

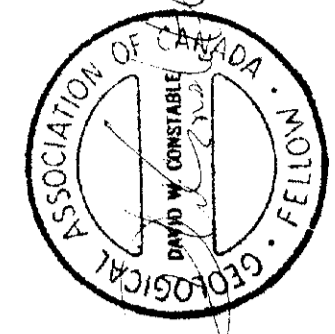
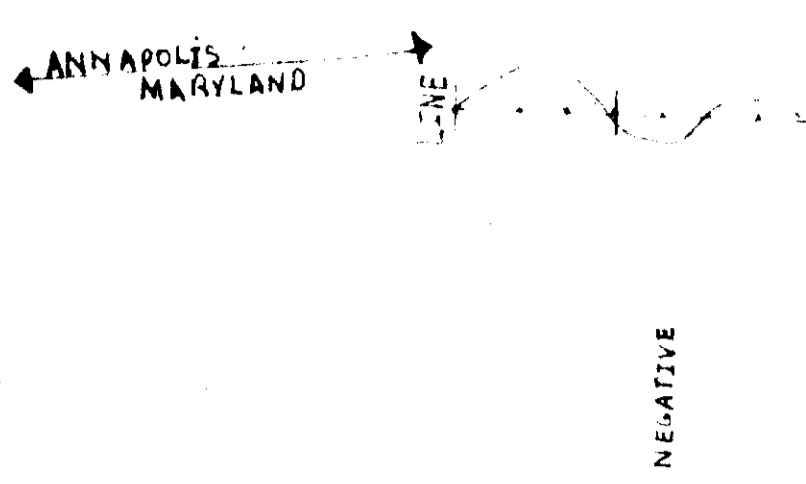

EMERALD ISLE RESOURCES
LIMITED

CHESTER TOWNSHIP PROPERTY

EM - 16 28372
SURVEY RESULTS

GRID SCALE 1 inch = 200 feet
DRAWN BY: LUC LAFORGET
DATE: 05/08/85

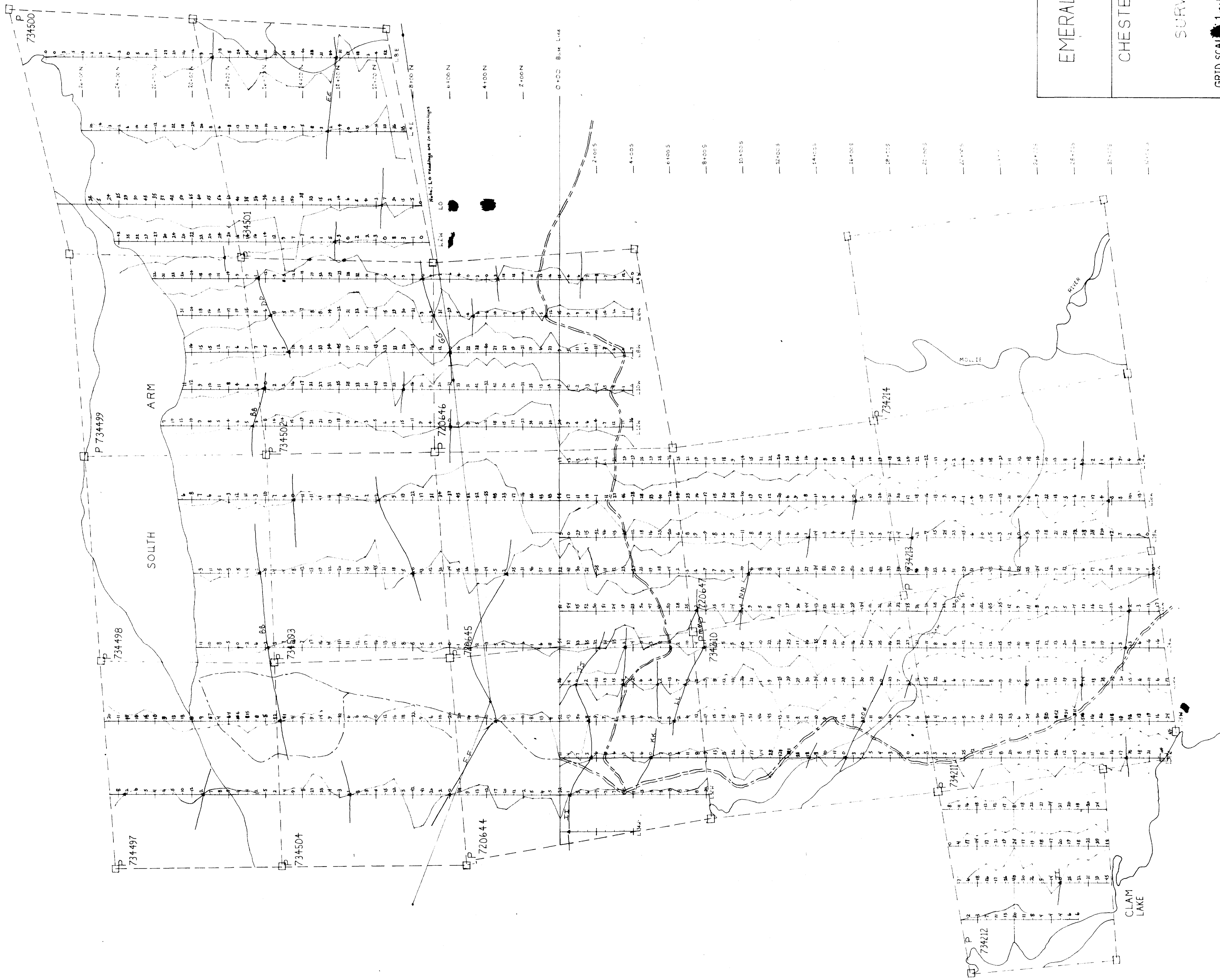

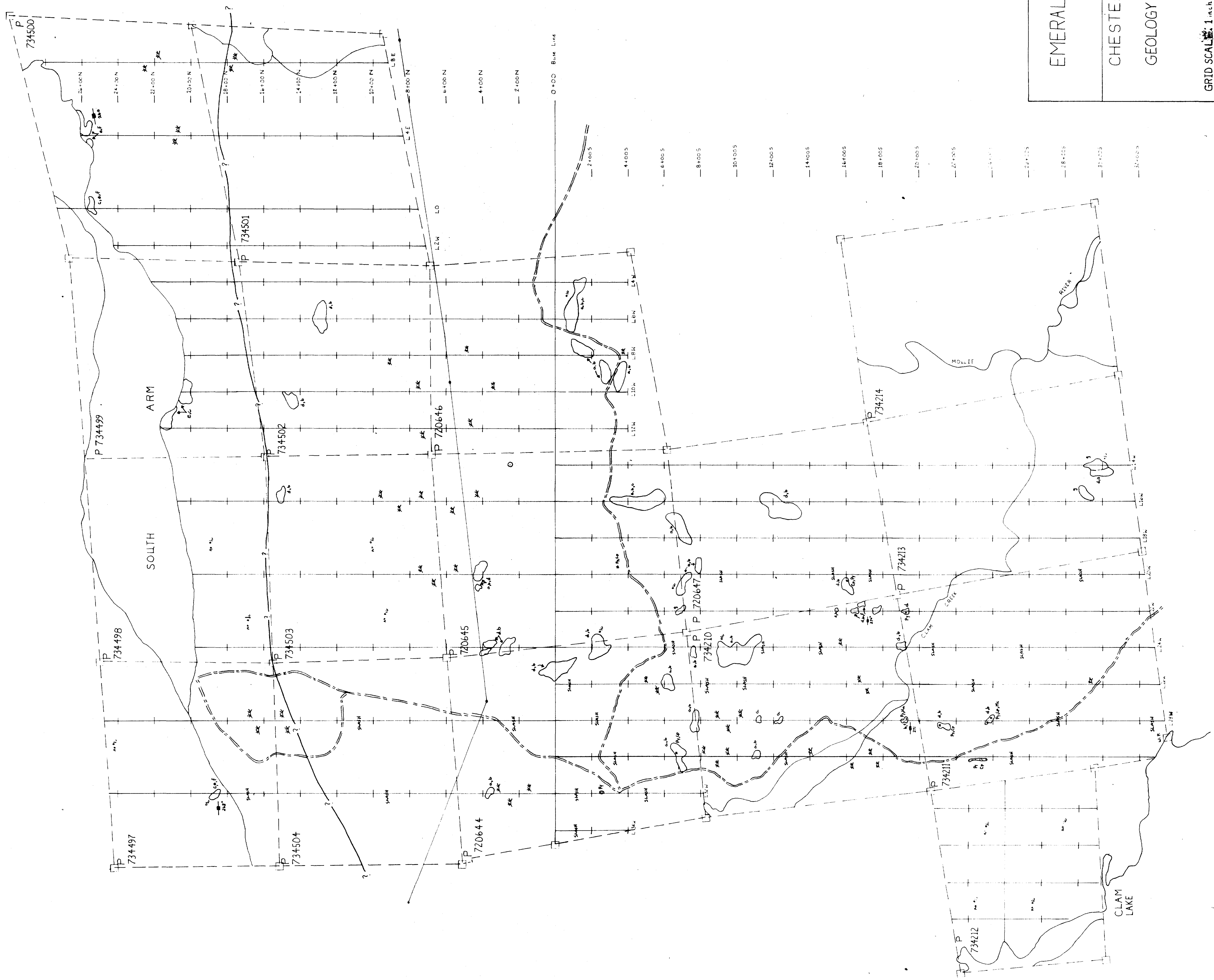
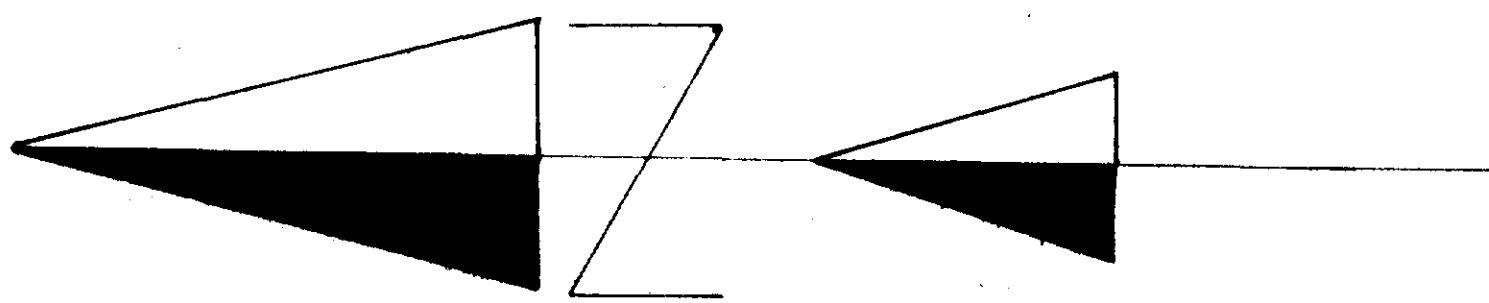

LEGEND :

Geology :

- a - Gravel drifts
- b - felsic volcanic rock bed
- c - schist (metamorphic)
- d - quartz monzonite
- e - intermediate metamorphic
- f - mafic volcanic rock
- g - diabase (igneous intrusion)

Symbols :

- * - mineralization
- P₁ - Pit
- C₁ - fault crack
- H₁ - hydro line
- R₁ - roadway
- CL - trench or water
- CL - fault
- - shaft
- - approximate center
- - old diamond drill hole

Note: Claim # 734214 was not located.



EMERALD ISLE RESOURCES LIMITED

CHESTER TOWNSHIP PROPERTY

GEOLOGY MAP

78372

GRID SCALE: 1 inch = 200 feet

DATE: Wednesday July 26, 1986
Drawn by: D. Erickson

