

41P12SW0082 29 CHESTER

010

DIAMOND DRILLING

TOWNSHIP: Chester

REPORT No.: 29

WORK PERFORMED BY: Murgold Resources Inc.

<u>CLAIM No.</u>	<u>HOLE No.</u>	<u>FOOTAGE</u>	<u>DATE</u>	<u>NOTE</u>
P 471953	M-19	346.0	May/82	(1)
P 538056	M-20	606.0	May/82	(1)
P 471953	M-21	400.0	June/82	(1)
P 471953	22	476.0	June/82	(1)
P 471952	23	506.0	June/82	(1)
P 515336	24	306.0	June/82	(1)
P 515336	25	308.0	June/82	(1)
P 515335	M-26	568.0	June/82	(1)
	8 HOLES	3516		

Note: record incomplete: there should be 12 holes (M19 to M30) for a total of 5,036 feet).

NOTES: (1) #300-82

164000E

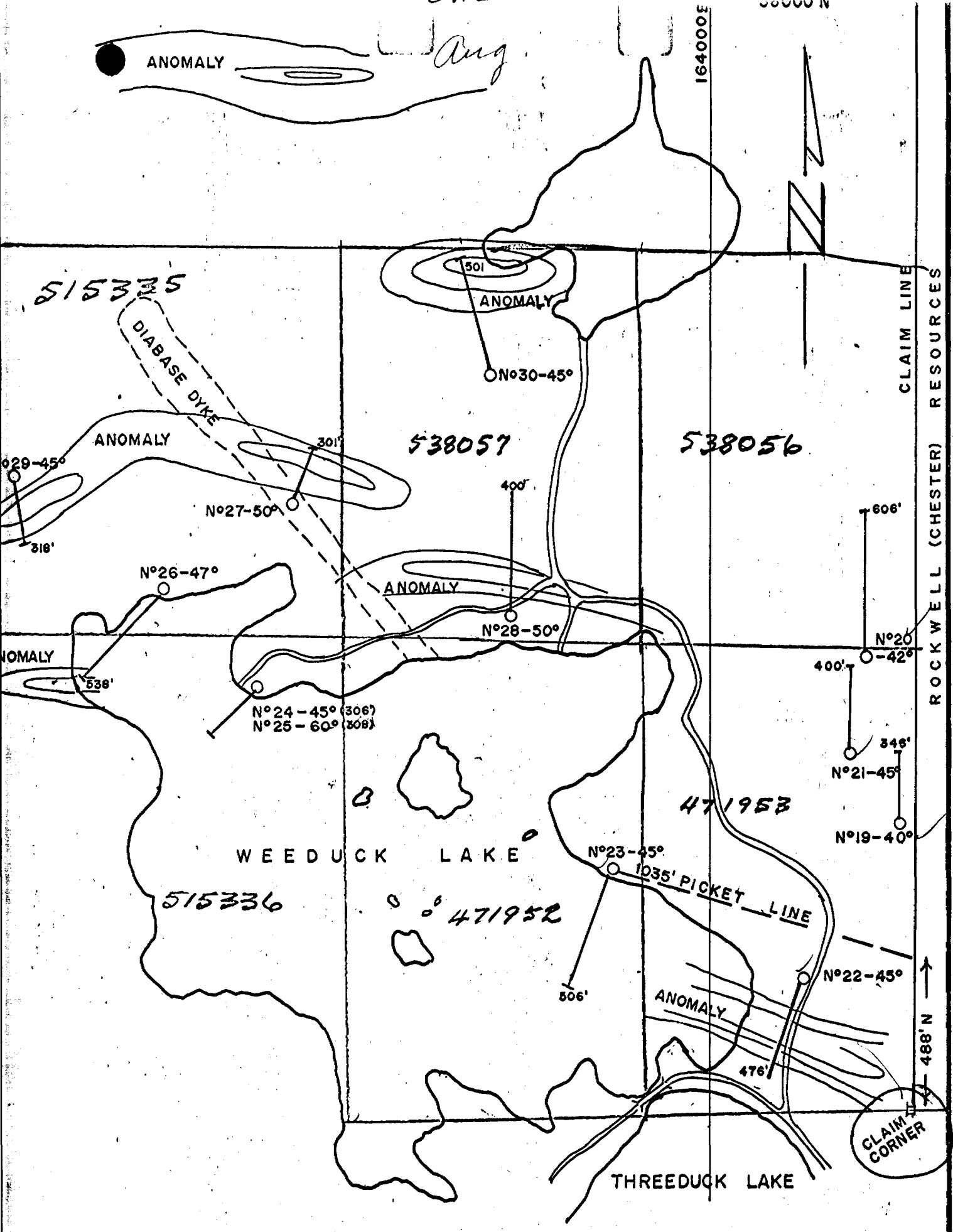

CLAIM LINE
ROCKWELL (CHESTER) RESOURCES

488' N

MURGOLD RESOURCES INC., PORCUPINE MINING DIVISION SUDBURY DISTRICT ONTARIO	
D. D. HOLES-WEEDUKE LAKE Nos. 19 TO 30	
SCALE: 1" = 400'	DATE: JULY /82
	MAP N°

PROPERTY Morgan Resources Inc. HOLE NO. M-19

HEET NUMBER 1
 TITUDE _____
 PARTURE _____
 EVATION _____

SECTION FROM _____ TO _____
 DATUM 590' North of claim corner
 on boundary line and 50' W.
 on Base line
 BEARING North
 DIP - 40°

STARTED _____
 COMPLETED May 27/92
 ULTIMATE DEPTH 346
 PROPOSED DEPTH _____

DEPTH FEET	FORMATION	SAMPLE NO.	WIDTH OF SAMPLE	GOLD \$	SLUDGE GOLD \$
3-14	limestone				
14-220	alaskite, acid, fine grained speckled with dark spots. (probably) bit of mica. grey in appearance. at 66" 1" massy white quartz at 210.5 - 1" white quartz @ 30° to cor. at 215 - 1/4" quartz with chalc. pyrite				
220-250	alaskite gradually changing slight reddish in colour				
250-287	gradually changing to blue grey acid grey, fine grained alaskite. at 259 - 3/4" irregular white quartz at 259.5 - 1" " " " @ 31 1/2° over and section of core slightly reddish. at 263 - Biscuited reddish alteration to diabase contact				
287-346	diabase 346 end of hole				

Handwritten signature

DIAMOND DRILL RECORD

PROPERTY Margot of Beauville Inc. HOLE NO. M-20

DEPTH NUMBER 1 SECTION FROM _____ TO _____ STARTED _____
 ALTITUDE _____ DATUM 525' N. of Base Level and 150' W. of Boundary line COMPLETED May 27/82
 DEPARTURE _____ BEARING N. ULTIMATE DEPTH 606
 ELEVATION _____ DIP -42 Test - 39 @ 560' PROPOSED DEPTH _____

DEPTH FEET	FORMATION	SAMPLE NO.	WIDTH OF SAMPLE	GOLD \$	SLUDGE GOLD \$
2-7	casing				
7-174	gray, even grained (med) alackite				
174-175	mixed up contact zone with fine grained diorite				
178-301	fine grained diorite. at 219-222' mic material mineralized with iron pyrite. at very slight angle down. followed by very fine grained material with a few quartz filled cavities	6558	3.0'	TR.	
301-606	alackite - very acid. at 304 - 2" porous white qtz at 323.5 - 1/2" " " " at 410 - 1/2" " " " at 418.5 - 1" milky q with Diabase 574-579 - highly silicious mic material with bands of whit. qtz heavy alteration - chlorite streaks and heavy fine iron pyrite	6559	5.0'	TR.	

M 21 - 45° at 390 - 48°

Completed June 2/82

DEPTH FEET	FORMATION	SAMPLE No.	WIDTH OF SAMPLE	GOLD \$	SLUDGE GOLD \$
0-11	Casing				
11-14'	Alaskite				
14-31	dark fine gr'd diorite				
31-96	Alaskite - sections of alaskite showing blue eyes at 42.5 splash of chalc. py. grading to coarse grained acid-mottled appearing with reddish sections and gray sections.				
93-96'	alaskite mixed with dark fine grained diorite at contact gradually getting coarse grained, scattered fine chalc pyrite in 3' sections				
96-192.5	med grained diorite fine grained & dark near contact.				
192.5-400'	med. & fine grained brownish red matrix with quartz eyes - porphyritic in appearance, in places grading to practically all silver with a rhyolite appearance. Very slight mineralization of chalc & l.p. gradually grading to gray-medium gray alaskite				
400'	End of hole				
	logged by Harold Kenty transcribed from field notes by L. N. FRANKS July 26/82				

DIAMOND DRILL RECORD

PROPERTY MURCOLD RESOURCES INC. HOLE No. 22

FEET NUMBER 1 SECTION FROM _____ TO _____ STARTED _____
 LATITUDE 163670 E DATUM WEE DUCK LAKE COMPLETED June 14/82
 DEPARTURE 32780 N BEARING S 20° W ULTIMATE DEPTH 476'
 ELEVATION _____ DIP -4.5° PROPOSED DEPTH _____

DEPTH FEET	FORMATION	SAMPLE No.	WIDTH OF SAMPLE	GOLD \$	SLUDGE GOLD \$
0 - 5	Claystone				
5 - 6.3	Alaskite				
6.3 - 7	Quartz with Pyrite. Calc. mat.	15251	.7'	.002	
7 - 29.1	Alaskite - mass of stringer with pyrite at 29' also at 24.6-24.8' (Not Sampled)				
29.1 - 31	Alaskite fine grained with blue eyes and disseminated pyrite				
31 - 64	Alaskite coarse with pyrite dissemination				
64 - 70	fine grained - acid				
70 - 75	coarser grained Alaskite with pyrite min				
75 - 77	Harder rock				
77 - 121	Alaskite well mineralized with pyrite some blue eyes - finer gr.				
121 - 136.5	Coarser gr. Alaskite with minor pyrite & graphite				
136.5 - 137.5	fine gr. - black - chert or buff?				
137.5 - 156	Alaskite coarse gr. well mineralized with pyrite & graphite				
156 - 156.7	Black fine grained chert or buff?				

DIAMOND DRILL RECORD

PROPERTY _____

 HOLE No. 22.

 FEET NUMBER 2.

SECTION FROM _____ TO _____

 STARTED June - 1982

 TITUDE 163670 E

 DATUM Wine Duck Lake

 COMPLETED June - 1982

 PARTURE 32780 N

 BEARING S - 20 W

 ULTIMATE DEPTH 476'

EVATION _____

 DIP - 45°

PROPOSED DEPTH _____

DEPTH FEET	FORMATION	SAMPLE No.	WIDTH OF SAMPLE	GOLD \$	SLUDGE GOLD \$
56.7 - 176	Course gr. chlorite with pyrite minor calc.				
76 - 190	fine gr. chlorite				
90 - 200	Course gr. chlorite heavily mineralized with perthite & pyrite				
100 - 200.5	Quartz with calc.	15252	.5'	.068	
105 - 307	chlorite course gr. heavily mineralized with perthite & pyrite				
117 - 314	fine grained				
124 - 317	Course grained				
127 - 325	Fine gr. well mineralized with pyrite				
135 - 337	coarser grained				
147 - 359.5	Fine grained				
159.5 - 360	Blue gr. with calc.	15253	.5'	.008	
167 - 380	fine grained				
167 - 385	Schist? Mark fine grained with numerous calcite stringers. Does not appear to be min.				
	Clearly argillaceous. Member of this zone??				
176 - 476	chlorite - well mineralized with perthite & pyrite End of Hole.				

DIAMOND DRILL RECORD

PROPERTY Murgold Resources Inc. HOLE No. 23

FEET NUMBER 1 SECTION FROM _____ TO _____ STARTED June 1982
 ALTITUDE 163700 DATUM _____ COMPLETED June 14, 1982
 DEPARTURE 33140 N BEARING S - 20° W ULTIMATE DEPTH 506
 ELEVATION _____ DIP -45° PROPOSED DEPTH _____

DEPTH FEET	FORMATION	SAMPLE No.	WIDTH OF SAMPLE	GOLD \$	SLUDGE GOLD \$
0 - 20	Casing				
20 - 56	Alaskite - fine gr. 1" barren gr. at 56'				
56 - 82	" fine gr. acidic & altered				
82 - 87	" coarse gr. 1" gr. at 87' no min.				
87 - 110	" fine pyrite dissemination				
110 - 135	" altered (acidic) no min.				
135 - 152	" coarse gr.				
152 - 153.5	" acidic.				
153.5 - 153.9	Quartz Vein (no mineral)				
153.9 - 171	" coarse gr. minor pyrite & peroxide dissemination				
171 - 171.2	Quartz stringer minor pyrite				
171.2 - 191	Alaskite - coarse gr.				
191 - 232	" - fine gr. altered				
232 - 252	Dark fine grained with light green spots possibly believed to be. Alvine diabase				
252 - 272	Alaskite - altered (acidic)				
272 - 273.5	Diabase				
273.5 - 275	Alaskite				
275 - 281	Diabase				

DIAMOND DRILL RECORD

PROPERTY Murgold Resources Inc. HOLE No. 23

SHEET NUMBER 2 SECTION FROM _____ TO _____ STARTED June 1982
 ALTITUDE 163700 E DATUM Wee Duck Lake COMPLETED June 1982
 DEPARTURE 33140 N BEARING S. 20° W ULTIMATE DEPTH 506'
 ELEVATION _____ DIP - 45° PROPOSED DEPTH _____

DEPTH FEET	FORMATION	SAMPLE No.	WIDTH OF SAMPLE	GOLD \$	SLUDGE GOLD \$
281 - 303	Alaskite - coarse grained with peridotite min & fine specks. of iron pyrite				
303 - 318	" - fine gr. alidic				
318 - 375	" - coarse gr. with fine iron pyrite dissemination				
375 - 376	Quartz vein with calcite pyrite	15254	1 FT. 1.5 FT	.012	
376 - 406	Alaskite - minor pyrite & calcite des.				
406 - 408.5	Shear zone - dark fine gr. with numerous calcite stringers seems soft but has a cherty appearance?				
408.5 - 409	Quartz & Calcite with pyrite and calcite	15255	.5'	T.R.	
409 - 411	Shear zone - same as 406 - 408.5				
411 - 417	Alaskite - fine gr. (alidic)				
417 - 423	" - very fine gr. alidic or altered				
423 - 428	" - coarse gr.				
428 - 436	" - fine gr. (altered)				
436 - 506	" - coarse gr. with minor pyrite & peridotite min.				
End of hole.					

PROPERTY

Murgold Resources Inc.

HOLE No.

21

SHEET NUMBER

1

SECTION FROM

TO

STARTED

June 19

LATITUDE

16 25 30 E

DATUM

Wee Duck Lake

COMPLETED

June 22, 19

DEPARTURE

33 680 N

BEARING

S 45° W

ULTIMATE DEPTH

306'

ELEVATION

DIP

- 45°

PROPOSED DEPTH

DEPTH FEET	FORMATION	SAMPLE No.	WIDTH OF SAMPLE	GOLD \$	SLUDGE GOLD \$
0 - 14	Casing				
14 - 27	Alaskite - broken ground				
27 - 27.1	1" qtz vein (no mineralization)				
27.1 - 31	Alaskite - trace amount of holes - very fine				
31.1	1" quartz (no mineralization)				
31.1 - 44	Alaskite				
44 - 44.3	Diorite				
44.3 - 47	Micrite?				
47 - 76	Alaskite - coarse grained				
76 - 78	Pyrite ?? very acidic				
78 - 78.1	1" qtz some iron pyrite				
78.1 - 115	Alaskite - trace amounts of iron pyrite & holes				
115 - 120	Micrite? fine grained				
120 - 151	Alaskite - coarse grained very minor mineralization				
151 - 152	Quartz - no visible vein				
152 - 156.5	Quartz - some mica?				
156.5 - 176	Alaskite				

DRILLED BY

SIGNED

T.D. Brown

PROPERTY _____

HOLE No. 24SHEET NUMBER 2

SECTION FROM _____ TO _____

STARTED June 182LATITUDE 16 25 30 EDATUM Wee Duck LakeCOMPLETED June 182DEPARTURE 33680 NBEARING S. 45° WULTIMATE DEPTH 306'

ELEVATION _____

DIP - 45'

PROPOSED DEPTH _____

DEPTH FEET	FORMATION	SAMPLE No.	WIDTH OF SAMPLE	GOLD \$	SLUDGE GOLD \$
176 - 187.5	Diorite fine grained				
187.5 - 188.5	Quartz (blue) heavily min. with pyrite - Calcs & Perotite	15256	1'	.012	
188.5 - 189.5	Diorite - heavily mineralized with Calcs	15257	1'	.020	
189.5 - 191.5	Massive Sulphides	15258	1'	.044	
191.5 - 192.5	Sulphides	15259	1'	.042	
192.5 - 195.5	Diorite well min. with iron pyrite				
195.5 - 199	" fine grained				
199 - 202	Alasite - coarse grained				
202 - 223	Alasite - fine grained altered				
223 - 234	Shear zone - numerous stringers of Calcite no visible mineralization.				
234 - 238.5	Alasite - fine grained acidic or altered with minor pyrite desin.				
238.5 - 239	Quartz with Calcs.	15260	.5'	.054	
239 - 306	Diorite or syolite?? fine gr. and altered to end of hole				
	- End of Hole -				

DRILLED BY

SIGNED L.D. Brown

PROPERTY

Tunggold Resources Inc.

HOLE No.

25

SHEET NUMBER

1

SECTION FROM

TO

STARTED

June 10

LATITUDE

16 25 30 EAST.

DATUM

Wes. Duck Lake

COMPLETED

June 22/82

DEPARTURE

33 680 N

BEARING

S - 45° W

ULTIMATE DEPTH

308

ELEVATION

DIP

- 60

PROPOSED DEPTH

DEPTH FEET	FORMATION	SAMPLE No.	WIDTH OF SAMPLE	GOLD \$	SLUDGE GOLD \$
0 - 9	Casing				
9 - 20	Alaskite no vis. min. - 1" qtz vein at 10' no min.				
20 - 22	Alaskite - altered				
22 - 48	" Coarser gr. no min.				
48 - 50	Diorite - fine grained				
50 - 51	Alaskite - coarse grained				
51 - 65	Alaskite - fine grained some sparse specs of calcs				
65 - 95	Alaskite - coarse grained - 1" qtz vein at 84' no visible min 1" qtz vein at 88' - 1" qtz vein at 90' no visible min				
95 - 96.5	Specs - (Schist) grey color some qtz very minor specs Calcs				
96.5 - 117	Alaskite - coarse gr. some iron pyrite and calcs (very minor)				
117 - 117.5	Schist - 1" Calcite				
117.5 - 121	Diorite - fine gr.				
121 - 147	Alaskite - 2" qtz vein 125' 1" qtz at 126' no mineralization				

DRILLED BY

SIGNED

T.S. Brown

PROPERTY

Murgold Resources Inc.

HOLE No.

25

SHEET NUMBER

2

SECTION FROM

TO

STARTED

June 18

LATITUDE

162530 E

DATUM

Wet Duck Lake

COMPLETED

June 1

DEPARTURE

33680 N

BEARING

S - 45 W

ULTIMATE DEPTH

308

ELEVATION

DIP

- 60

PROPOSED DEPTH

DEPTH FEET	FORMATION	SAMPLE No.	WIDTH OF SAMPLE	GOLD \$	SLUDGE GOLD \$
<u>147 - 147.3</u>	<u>Quartz vein (no mineralization)</u>				
<u>147.3 - 209</u>	<u>Alaskite - 3" qtz @ 150' - 3" qtz at 182' minor perotite & calc. & pyrite - 205 - 209 - altered</u>				
<u>209 - 224</u>	<u>Steer - Schist - fine grained dark with green spots.</u>				
<u>224 - 254</u>	<u>Alaskite - altered</u>				
<u>254 - 263</u>	<u>Alonite</u>				
<u>263 - 276</u>	<u>Alonite - @ 276' 6" qtz vein (no visible vein)</u>				
<u>276 - 288</u>	<u>Alonite</u>				
<u>288 - 308</u>	<u>Alaskite - altered some minor mineralization (perite - perotite & calc.)</u>				
	<u>End of Hole</u>				
<u>Remarks:</u>					
<u>This hole was stopped because it was felt we were missing the zone or running with the dip of the structure.</u>					

DRILLED BY

SIGNED

T.D. Brown

DIAMOND DRILL SAMPLING RECORD

DIP AT COLLAR -47°

DIRECTION S 40° W

LENGTH FEET 568 PROPERTY Chester Township - Murgold Resources Inc.

HOR. COMP. VER. COMP. ELEV. LAT. DEP.

LOCATION N. shore of Weeduck Lake

82/6/24

(1)

LOGGED BY REW & RAC

STARTED...

FINISHED... June 22/82

199

DISTANCE FEET		DESCRIPTION	Shorts	Sample No.	Length Feet	CORE ASSAY			Sands Sample
From	To					Gold oz.	Silver oz.	Copper %	
0	15	Casing							
5	169	Granodiorite - grey to lt. grey med to c gr. rich with cent blue quartz eyes and variable amounts of mafic mineral which is probably biotite. Rock is finer grained adjacent to biotite rich zones							
	75-79.5	f. gr dk grey fld'd biotite-rich zone (20-25% biot.)							
		fldn @ 75° to core, trace of pyrite							
	87.5-95	dissem'd po, py in mottled quartz in a finer grained lighter grey phase. Occ 1/4" qtz strgs with py; biotite selvages.							
	107.5-109.5	biot-rich rock as above fld'd @ 75° to core							
	109.5-122.5	finer grained, lighter grey phase, mottled with quartz in patches and strgs.							

DIAMOND DRILL SAMPLING RECORD

DIP AT C AR.....

DIRECTION.....

LENGTH FEET..... PROPERTY.....

HOR. COMP..... VER. COMP..... ELEV..... LAT..... DEP.....

LOCATION.....

LOGGED BY.....

STARTED.....

FINISHED.....

cont'd

(2)

DISTANCE FEET		DESCRIPTION	Shorts	Sample No.	Length Feet	CORE ASSAY			Sands Sample
From	To					Gold oz.	Silver oz.	Copper %	
						128.5 - 129.5 irregular quartz with po. and py. both dissemin'd and in fractures - no well defined vein		15262	
		129.5 - 135 - lighter grey m-e grained phase of Granodiorite with 5-10% mafic minerals							
		131.5 irregular qtz-rich zone with po and cpy		15263	0.25	.004			Sample
		135 - 161 Granodiorite with a higher proportion of biotite than usual							
		161 - 166.5 highly altered Granodiorite; felds creamy coloured, rock appears finer grained, po & cpy occur as streaks and patches, former @ 60° to core							
		166.5 - 169 biot-rich rock feld ^{id} @ 55° to core.							
	3905	Altered Granodiorite - light gray with creamy coloured feldspar and							

DIAMOND DRILL SAMPLING RECORD

 DIP AT AR

DIRECTION

LENGTH FEET

PROPERTY

HOR. COMP.

VER. COMP.

ELEV.

LAT.

DEP.

LOGGED BY

STARTED...

FINISHED...

199

LOCATION

DK # M-26

com. 11

3

DISTANCE FEET		DESCRIPTION	Shorts	Sample No.	Length Feet	CORE ASSAY			Sands Sample
From	To					Gold oz.	Silver oz.	Copper %	
		172-173 normal Granodiorite							
		173-176.5 highly altered Granodiorite with dissem'd cpy. and po. as well as patches and stringers the latter @ 60° to core		15264	3.5	.006			Sample
		176.5-181 highly altered Granodiorite as above		15265	4.5	.0012			Sample
		181-183 alt'd Granodiorite.							
		183-185.5 highly alt'd Granodiorite with coarse cpy. & po. in vein with Qtz mostly between 184 and 185 ft. The po. is enclosed by cpy.		15266	2.5	.002			Sample
		185.5-188 highly altered Granodiorite with small patches of Qtz and some coarse cpy & po. as stringers and patches.		15267	2.5	.0016			Sample
		200 1" Qtz vein @ 45° to core axis, Tr. cpy. & some biot.							
		205-206 minor brecciation							
		218.5-222.5 highly alt'd Granodiorite		15268	4.0	.0200			Sample

DIAMOND DRILL SAMPLING RECORD

DIP AT C ... AR

DIRECTION

LENGTH FEET

HOR. COMP.

PROPERTY

VER. COMP.

ELEV.

LAT.

DEP.

LOCATION

cont'd

④

LOGGED BY

STARTED

FINISHED

199

DISTANCE FEET		DESCRIPTION	Shorts	Sample No.	Length Feet	CORE ASSAY			Sands Sample
From	To					Gold oz.	Silver oz.	Copper %	
		at 75° to core axis.							
		227-230 highly alt'd Granodio with irreg patches & strgr cpy and po.		15269	3.0	.022			Sample
		234.5-235 Qtz strgr @ 45° or less to core axis, cpy & lem.		15270	0.5	.072			Sample
		239-240 irreg. Qtz strgr and biot. rich zone, minor cpy. & lem. dissemin'd py.		15271	1.0	.002			Sample
		240-242.5 biot.-rich zone @ 45° to core and fol'd.							
		249.5-251.5 biot.-rich zone, fol'd @ 60° to core							
		262-265 Chln-biot. rock, gngy with books of biot. oriented across core nearly at rt. angles to axis.							
		288-308.5 highly altered phase, pink coloration, some brecciation, and patches of py. & po.							
		296.5-298 dissemin'd py, po, cpy in irregularly fractured pink fields		15272	1.5	.012			Sample



DIAMOND DRILL SAMPLING RECORD

DIP AT CLAR.....

DIRECTION.....

LENGTH FEET.....

HOR. COMP.....

199

PROPERTY.....

VER. COMP.....

LOCATION.....

ELEV.....

LAT.....

DEP.....

DH # M-26

Cont. 1-1

(5)

LOGGED BY.....

STARTED.....

FINISHED.....

DISTANCE FEET		DESCRIPTION	Shorts	Sample No.	Length Feet	CORE ASSAY			Sands Sample
From	To					Gold oz.	Silver oz.	Copper %	
		309.5 4" shrd biot-rich rock							
		fld @ 60° to core axis							
		309.5-318 highly alt'd Granodio.							
		with cream-coloured feldspar alteration							
		318-338.5 very highly altered, bleached Granodio with patches of py. & po.							
		351.5-353 Qtz & carb zone containing 3" coarse po. vein with Qtz and trace of cpy.		15273	1.5	.004			Sample.
		358-363 altered Granodio with scattered patches of po & cpy.		15274	5.0	.016			Sample
		369.5-370.5 patches cpy & po							
		377-378.5 " " " "							
		383-387 dissem'd po. with minor cpy.							
		389.5-390.5 irregular bull qtz veins.							

DIAMOND DRILL SAMPLING RECORD

DIP AT C ... AR

DIRECTION

LENGTH FEET PROPERTY

HOR. COMP. VER. COMP. ELEV. LAT. DEP.

LOCATION

Conf'd

(6)

LOGGED BY

STARTED

FINISHED

199

DISTANCE FEET		DESCRIPTION	Shorts	Sample No.	Length Feet	CORE ASSAY			Sands Sample
From	To					Gold oz.	Silver oz.	Copper %	
10.5	392					Biot-chlor. rock fold @ 70° to core axis. Six inch Diabase dyke in centre.			
92	399	fold biot-rock rock with carb. strgs @ 70° to core 392-394 silicified zone with dissem'd py.							
99	408	Altered Granodiorite 406' - 3" Qtz-carb vein.							
28	414	Biot-rich rock and Granodio in alternating narrow zones.							
4	441	Granodiorite - grey, m-cgr.							
11	466.5	Altered granodiorite, lt. grey 441-449 appears silicified and cut by chlor strgs.							
6.5	467.5	fold biot-chlor rich rock with carb strgs @ 70° to core axis.							
7.5	527	Highly altered, lt. grey Granodio with dissem'd po & py and maybe some pentlandite. Folds show pale green (creamy-colored) alt'n.							

DIAMOND DRILL SAMPLING RECORD

DIP AT ° DIR

DIRECTION

D.H. # M-26

Cont'd

(7)

LENGTH FEET

PROPERTY

LOGGED BY

HOR. COMP.

VER. COMP.

ELEV.

LAT.

DEP.

STARTED

199

LOCATION

FINISHED

DISTANCE FEET		DESCRIPTION	Shorts	Sample No.	Length Feet	CORE ASSAY			Sands Sample
From	To					Gold oz.	Silver oz.	Copper %	
		467.5 - 471		15275	3.5	.024			Sample
		471 - 475		15276	4.0	TR			"
		475 - 479		15277	4.0	.004			"
		492.5 - 494		15278	1.5	.012			"
		gtz vein with cpy & po runs almost // core							
		494 - 496		15279	2.0	.036			Sample
		498 - 501		15280	3.0	.020			"
		518 - 530 brecciated with fragments of alt'd Granodior and very f.g. siliceous rock which looks like chert but probably is just silicified Granodior.							
		520 - 524		15281	4.0	.012			Sample
27	568	Altered Granodiorite, gy, m-c grained.							
		543 po & py both dissem'd and in strgs							
		550 - 552 very fine grained, lt. gy aplitic (?) zone.							
	568	End of hole							

NEVILLE

ST. LOUIS

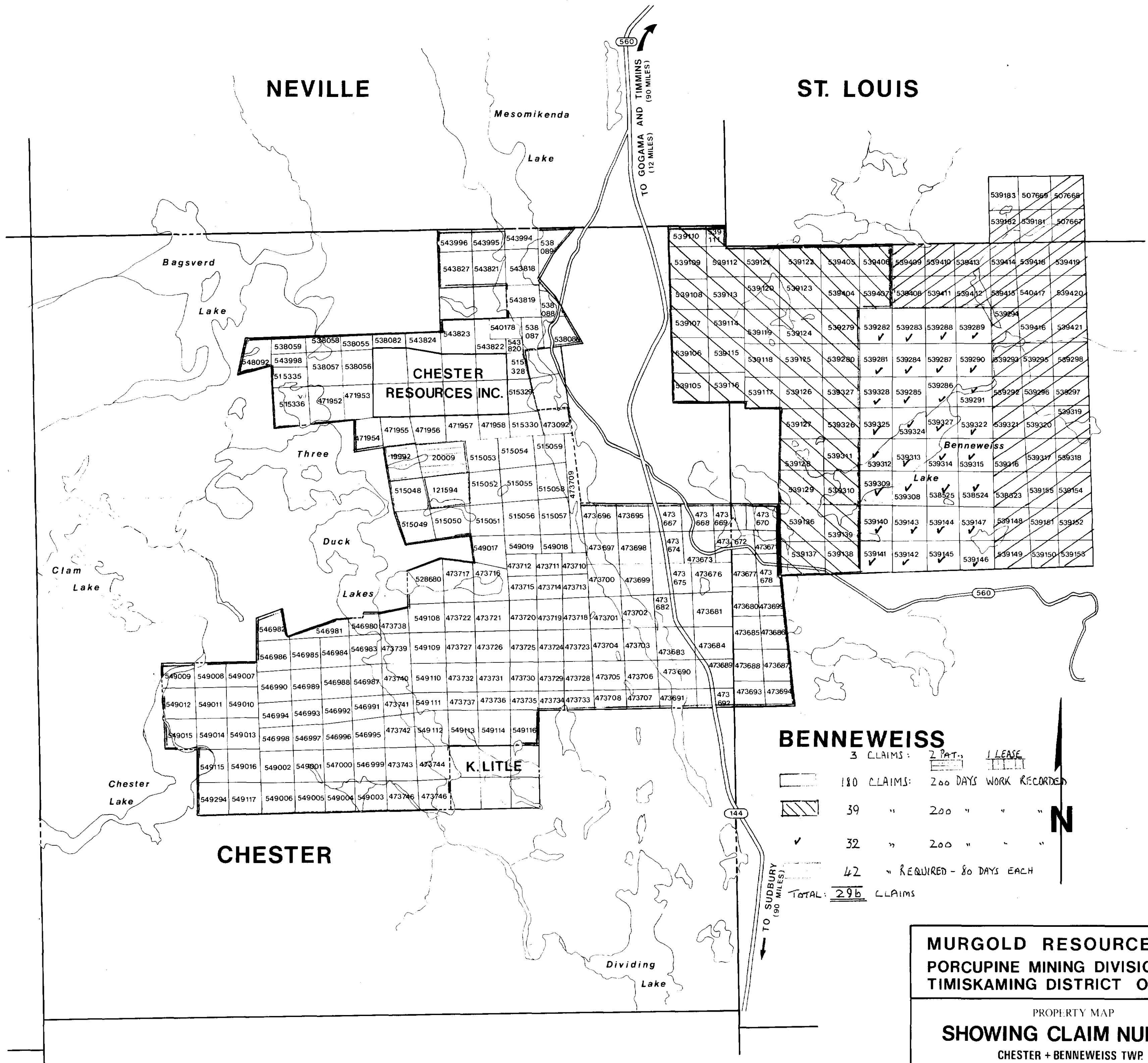

CHESTER RESOURCES INC.

K. LITTLE

BENNEWEISS

3 CLAIMS:	2 PAT.	1 LEASE
180 CLAIMS:	200 DAYS WORK RECORDED	
39 "	200 " " "	
32 "	200 " " "	
42 "	REQUIRED - 80 DAYS EACH	
TOTAL: <u>296</u> CLAIMS		

**MURGOLD RESOURCES, INC.,
PORCUPINE MINING DIVISION
TIMISKAMING DISTRICT ONTARIO**

PROPERTY MAP
SHOWING CLAIM NUMBERS
CHESTER + BENNEWEISS TWP.

SCALE: 1" = 1/2 MILE

DATE: NOV. 1980

MAP NO 3

