

41P125W0095 21 CHESTER

010

Diamond Drilling

Township of CHESTER

Report N^o 21

Work performed by: Coniston Exploration

Claim N ^o	Hole N ^o	Footage	Date	Note
S 269255	3-71	403.0'	Feb/71	

Notes: 64/72

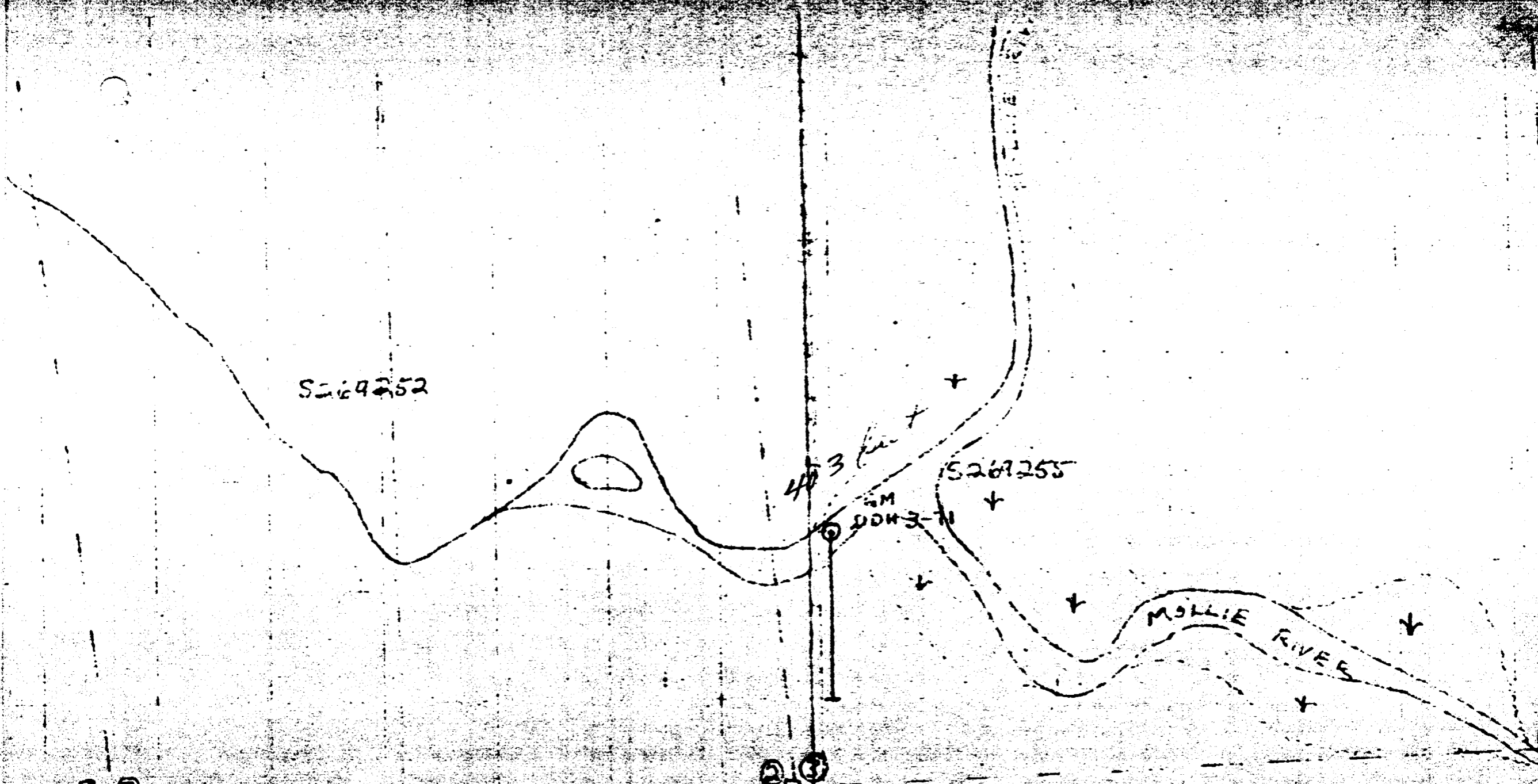

S264252

403
403-11

5267255

MOLLIE RIVER

3
4

S264254

S264250

DRAWN

JUNE 15 1971

Miller

MINE
REMARKS
LEVEL
LOCATION

GOGANA MINERALS LIMITED

DRILL SIZE
CORE SIZE **AXT**
COMMENCED **22 Feb 1971**
COMPLETED **2 Mar 1971**

FOOTAGE	DIP	AZIMUTH	FOOTAGE	DIP	AZIMUTH

DEPARTURE **S4400E** LENGTH **403 FEET**
ELEVATION SHEET NO. **9**
AZIMUTH **SOUTH** LOGGED BY **W. WALKER**
DIP **45°**

DIAMOND DRILL RECORD

FOOTAGE		DESCRIPTION	% SOL	SAMPLE				COPPER		ZINC		LEAD		SILVER		GOLD	
FROM	TO			No.	From	To	Length	%	Cum.	%	Cum.	%	Cum.	Oz./Ton	Cum.	Oz./Ton	Cum.
0	117																
117	117.5	Medium grained massive pinkish mauve granodiorite pale blue quartz white plagioclase chloritized biotite magnetite & dispersed hematite and much alteration															
117.5	151	Shear Zone 117-137 acid intrusives 137-151 andesite or dacite Fine grained sheared light grey acid section dark grey basic section shearing @ 45° to long core axis Minor calcite veining in various directions Sulphides disseminated in the shear plain, largely pyrite and some chalcopyrite, from 1/2 inch bands of sulphides and 6 inches of braconated sulphides @ 146 ft.															
151	276	Medium to fine grained massive grey granitized andesite? some section feldspar porphyritic pale blue to clear quartz milky feldspar chlorite. 173-174.5 shear zone 235-240 shear zone.															

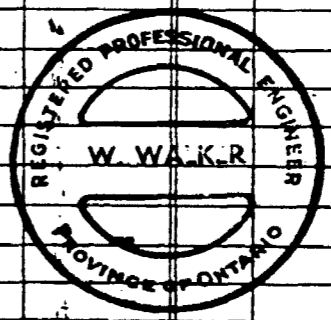

[Handwritten signature]

GOGANA MINERALS LTD.

MINE
REMARKS
LEVEL
LOCATION

DRILL SIZE
CORE SIZE **AXT**

COMMENCED *22 Feb 1971*
COMPLETED *2 Mar 1971*

FOOTAGE	DIP	AZIMUTH	FOOTAGE	DIP	AZIMUTH

LATITUDE *27+00S* HOLE NO. *3-710*
 DEPARTURE *54+00E* LENGTH *403* FEET
 ELEVATION SHEET NO. *2*
 AZIMUTH *SOUTH* LOGGED BY *W. WALKER*
 DIP *45°*

DIAMOND DRILL RECORD

FOOTAGE		DESCRIPTION	% Sol.	SAMPLE				COPPER		ZINC		LEAD		SILVER		GOLD	
FROM	TO			No.	From	To	Length	%	Cum.	%	Cum.	%	Cum.	Oz./Ton	Cum.	Oz./Ton	Cum.
<i>151</i>	<i>276</i>			Some brecciation @ 214 ft & 222 ft Some of the more granitic phases are vein like. No significant mineralization Much broken core from 291 to 276 with abundant limonite stain.													
<i>276</i>	<i>403</i>	Fault zone Various acid rocks, sheared brecciated & fractured, sulphides including chalcopyrite mainly in brecciated sections. Minor native copper widespread. Some lost core from 349 to 356 & 365 to 373.															
		<i>END</i>															

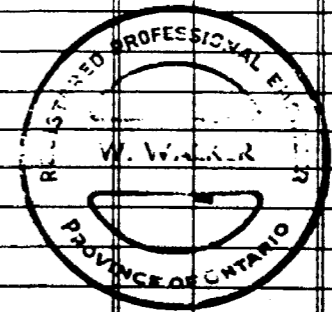

Walker