



41P12SW0096 20 CHESTER

010

# Diamond Drilling

Township of CHESTER

Report N<sup>o</sup> 20

Work performed by: Coniston Exploration

Claim N <sup>o</sup>	Hole N <sup>o</sup>	Footage	Date	Note
S 269250	1-71	305.0'	Jan/71	
	2-71	323.0'	Feb/71	

Notes: 64/72 Autopositive enclosed

MINE

GOGANA MINERALS LTD.

LEVEL

DRILL SIZE

COMMENCED 19 Jan 1971

LOCATION

CORE SIZE

AXT

COMPLETED 21 Feb 1971

FOOTAGE	DIP	AZIMUTH	FOOTAGE	DIP	AZIMUTH

LATITUDE 16400S  
 DEPARTURE 26700C  
 ELEVATION  
 AZIMUTH S20W  
 DIP 45°

HOLE NO. 1-71  
 LENGTH 305 FEET  
 SHEET NO. 1  
 LOGGED BY W WALKER

DIAMOND DRILL RECORD

FOOTAGE		DESCRIPTION	% Sol.	SAMPLE				COPPER		ZINC		LEAD		SILVER		GOLD	
FROM	TO			No.	From	To	Length	%	Cum.	%	Cum.	%	Cum.	Oz./Ton	Cum.	Oz./Ton	Cum.
0	10	Casing															
8	41.2	Medium fine grained, massive, light grey granodiorite, pale blue quartz, white feldspar, black biotite pyrite. Some metasomatic quartz zones fracture controlled. Minor fracturing in various directions No shearing. No brecciation Various sulphides in chloritic fracture slips.															
41.2	43.2	Fine grained, poorly foliated dark grey-green, dacite? blue quartz white feldspar, chlorite fengas sulphided, 1-2 mm. dark spots with light centres probably secondary. Foliation 55° to long core axis, shearing? No other rock types. few fractures No brecciation Few quartz stringers.															
43.2	66	Varying amounts primary? sulphides Medium fine grained, massive, grey quartz porphyry, very pale blue quartz white feldspar, chloritized biotite, sulphide. No foliation Well sorted quartz attraction up to 1 cm wide in sides of venalets Few fractures in various directions.															

#64/72 Consistor Expl. Holdings  
 Chester Disp.

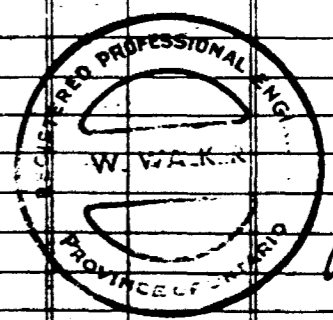

*W. Walker*  
 1971

MINE

GOGANA MINERALS LTD

REMARKS

L

DRILL SIZE

COMMENCED 19 Jan 1971

LOCATION

CORE SIZE AXT

COMPLETED 21 Jan 1971

FOOTAGE	DIP	AZIMUTH	FOOTAGE	DIP	AZIMUTH

LATITUDE 16<sup>00</sup>S  
 DEPARTURE 26<sup>00</sup>E  
 ELEVATION  
 AZIMUTH S 20<sup>0</sup>W  
 DIP

HOLE NO. 1-11  
 LENGTH 305 FEET  
 SHEET NO. 2  
 LOGGED BY W. WALKER

DIAMOND DRILL RECORD

FOOTAGE		DESCRIPTION	% Sol.	SAMPLE				COPPER		ZINC		LEAD		SILVER		GOLD	
FROM	TO			No.	From	To	Length	%	Cum.	%	Cum.	%	Cum.	Oz./Ton	Cum.	Oz./Ton	Cum.
43.2	66	No shearing No brecciation Chlorite slips with wallrock alteration and scattered sulphides, pyrite and chalcopyrite.															
66	85	Medium fine grained, massive, grey. Granodiorite, pale blue quartz, white feldspar, black biotite sulphides No foliation. Minor fractures, various directions. 68.2 to 70.6 fault zone with shearing and quartz enrichment. Scattered sulphides in the shear. Alteration in fractures @ 75.7 and 80.7 No shearing No brecciation Veinlets with pyrite pyrrhotite chalcopyrite covellite? chalcocite? @ 84 ft.															
85	138	Fault zone Sheared porphyry, sheared rhyolite tuff secondary quartz enrichment Sulphides probably re mobilized and introduced & include chalcopyrite Faulty at 550 to 125 Chalcopyrite and pyrite in the stringers Secondary calcite spots from 125 to 127															

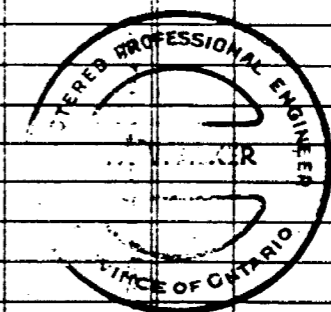

*[Handwritten signature]*

MINE **GOGAMA MINERALS LTD.**

REMARKS

LEVEL

DRILL SIZE

COMMENCED *19 Jan 1971*

LOCATION

CORE SIZE **AXT**

COMPLETED *21 Jan 1971*

FOOTAGE	DIP	AZIMUTH	FOOTAGE	DIP	AZIMUTH

LATITUDE *16+00S*  
 DEPARTURE *26+00E*  
 ELEVATION  
 AZIMUTH *S 20° W*  
 DIP *45°*

HOLE NO. *1-71*  
 LENGTH *305* FEET  
 SHEET NO. *3*  
 LOGGED BY *W. WALKER*

DIAMOND DRILL RECORD

FOOTAGE		DESCRIPTION	% Sol.	SAMPLE				COPPER		ZINC		LEAD		SILVER		GOLD	
FROM	TO			No.	From	To	Length	%	Cum.	%	Cum.	%	Cum.	Oz./Ton	Cum.	Oz./Ton	Cum.
<i>138</i>	<i>146.6</i>	Medium fine grained, massive grey granodiorite Pale blue quartz, white feldspar, chlorite sulphides, pyrite magnetite No foliation Minor fracturing various directions No shearing No brecciation Chlorite slips with pyrite															
<i>146.6</i>	<i>225</i>	Medium fine grained, massive grey granodiorite with many sheared and brecciated sections, quartz enrichment, and veining includes mineralization disseminated & veinlets pyrite chalcopyrite of maly, secondary calcite spots in the shears.															
<i>225</i>	<i>265</i>	Medium fine grained massive, grey granodiorite pale blue quartz, white feldspar, black biotite, minor sulphides. Faults from 242 to 246 (maybe dacite) Few minor fractures No shearing No brecciation Sulphide veinlets pyrite, chalcopyrite and gold? @ 248.5															

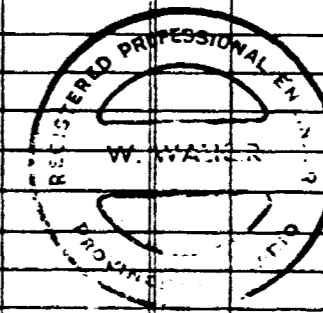

*W. Walker*

**GOGANA MINERALS LTD.**

FOOTAGE	DIP	AZIMUTH	FOOTAGE	DIP	AZIMUTH

LATITUDE **16°00'S** HOLE NO. **1-71**  
 DEPARTURE **26+00 E** LENGTH **305** FEET  
 ELEVATION SHEET NO. **4**  
 AZIMUTH **S 20° W** LOGGED BY **W. WALKER**  
 DIP **45°**

MINE  
 REFERENCE  
 LEVEL  
 LOCATION

DRILL SIZE  
 CORE SIZE **AXT**

COMMENCED **19 Jan 1971**  
 COMPLETED **21 Jan 1971**

DIAMOND DRILL RECORD

FOOTAGE		DESCRIPTION	% Sol.	SAMPLE				COPPER		ZINC		LEAD		SILVER		GOLD	
FROM	TO			No.	From	To	Length	%	Cum.	%	Cum.	%	Cum.	Oz./Ton	Cum.	Oz./Ton	Cum.
265	305	Medium fine grained, massive, pale pinkishgrey granodiorite clear quartz pale pink & white feldspar biotite chlorite sulphides No foliation Some remnants of fine grained mafic rock Few fractures various directions No shearing No brecciation Few chlorite calcite stringers with wallrock quartz enrichment No mineralization.  END															

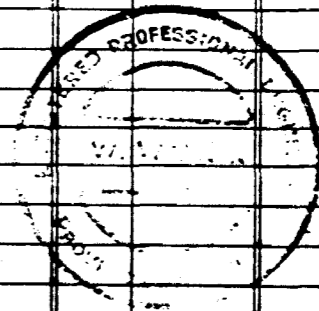

*W. Walker*

GOGANA MINERALS LTD.

NAME  
REMARKS  
LEVEL  
LOCATION

DRILL SIZE  
CORE SIZE

AXT

COMMENCED 9 Feb 1971  
COMPLETED 13-6-1971

FOOTAGE	DIP	AZIMUTH	FOOTAGE	DIP	AZIMUTH

LATITUDE 16°00'S  
DEPARTURE 2400E  
ELEVATION  
AZIMUTH S20W  
DIP 45°

HOLE NO. 2-71  
LENGTH 323 FEET  
SHEET NO. 1  
LOGGED BY W. WALKER

DIAMOND DRILL RECORD

FOOTAGE		DESCRIPTION	% Sol.	SAMPLE				COPPER		ZINC		LEAD		SILVER		GOLD	
FROM	TO			No.	From	To	Length	%	Con.	%	Con.	%	Con.	Oz./Ton	Con.	Oz./Ton	Con.
0	15	CASING															
13	86	Fault zone															
		13.0 - 14.5 quartz porphyry much fractured with potash feldspar and disseminated pyrite															
		14.5 - 24.7 Aplitic quartz porphyry much fractured with disseminated pyrite, pyrrhotite and chalcopyrite.															
		24.7 - 40 quartz porphyry altered feldspar disseminated pyrite and pyrrhotite and sulphides in fractures.															
		40 - 41.8 Dark carbonitized shear with disseminated pyrite and pyrrhotite carbonate spots. Shearing @ 70° to long core axis.															
		41.8 - 52.3 quartz porphyry, pink potash feldspar with disseminated pyrite. Many fine fractures and stringers various directions															
		52.3 - 54 Dark carbonitized shear with disseminated pyrite & pyrrhotite, carbonate spots actinolite needles K. feldspar															
		54 - 56 Broken rock K enriched quartz porphyry															
		see page 2															



*W. Walker*

MINE GOGAMA MINERALS LTD.

REMARKS

LL LOCATION

DRILL SIZE

CORE SIZE AXT

COMMENCED 9 Feb 1971

COMPLETED 13 Feb 1971

FOOTAGE	DIP	AZIMUTH	FOOTAGE	DIP	AZIMUTH

LATITUDE 16.25  
 DEPARTURE 24700 E  
 ELEVATION  
 AZIMUTH 520° W  
 DIP 45°  
 LENGTH  
 SHEET NO. 2  
 LOGGED BY W. WALKER

DIAMOND DRILL RECORD

FOOTAGE		DESCRIPTION	% Sol.	SAMPLE				COPPER		ZINC		LEAD		SILVER		GOLD	
FROM	TO			No.	From	To	Length	%	Cum.	%	Cum.	%	Cum.	Oz./Ton	Cum.	Oz./Ton	Cum.
13	86	56-63 K Enriched dacite or andisite? scattered sulphides.															
		63-83 metasomatized andesite with scattered and disseminated pyrite crude foliation & 30° to long core axis, probably gneissosity.															
		83-86 Brecciated andosite with quartz porphyry matrix & quartz veining, pyrite veinlets, End of Fault.															
86	89.6	Massive metasomatized andisite															
89.6	232.8	Medium fine grained massive grey quartz porphyry, pale blue quartz, altered feldspar & feldspars pyrite, pyrrhotite and chalcopyrite. Few minor fractures various direction. Fault from 140 to 166 section sheared & 70° to long core axis, other sections with recrystallized quartz porphyry, from 186 to 199 with densely packed carbonate spots - maybe fault or original rock possibly andesite or dacite. no shearing no brecciation															
		next page															

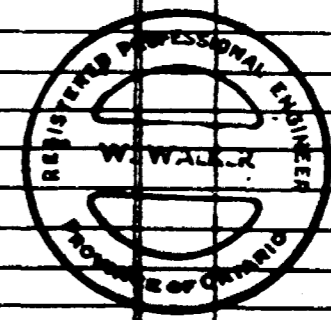

*[Handwritten signature]*

REMARKS

LOCATION

DRILL SIZE  
CORE SIZE AXT

COMMENCED 9 Feb 1971  
COMPLETED 13 Feb 1971

FOOTAGE	DIP	AZIMUTH	FOOTAGE	DIP	AZIMUTH

DEPARTURE 181003 24100E  
LENGTH 323 FEET  
ELEVATION  
SHEET NO. 3  
AZIMUTH S 20° W  
LOGGED BY W. WALKER  
DIP 45°

DIAMOND DRILL RECORD

FOOTAGE		DESCRIPTION	% Sol.	SAMPLE				COPPER		ZINC		LEAD		SILVER		GOLD	
FROM	TO			No.	From	To	Length	%	Con.	%	Con.	%	Con.	Oz./Ton	Con.	Oz./Ton	Con.
89.6	232.8	cont'd															
		Little veining, several sections with disseminated sulphides, pyrite pyrrhotite and chalcopyrite. 6 inch matachewan diabase dike @ 214.															
232.8	237	Medium fine grained massive pinkish grey granodiorite, clear quartz, white and pale pink feldspar chlorite, scattered sulphides, unmineralized.															
237	240	Fault. Sheared pale greenish grey granite of dacite. shearing @ 70° to long core axis gneissosity unmineralized.															
240	273.5	Fine & medium grained matachewan diabase dike.															
273.5	277	Medium fine grained, massive, pinkish grey granodiorite, clear quartz, white and pale pink feldspar chloritized biotite and scattered sulphides. Minor fracturing in various directions with chlorite, pyrite and pyrrhotite.															
		next page															



*[Handwritten signature]*





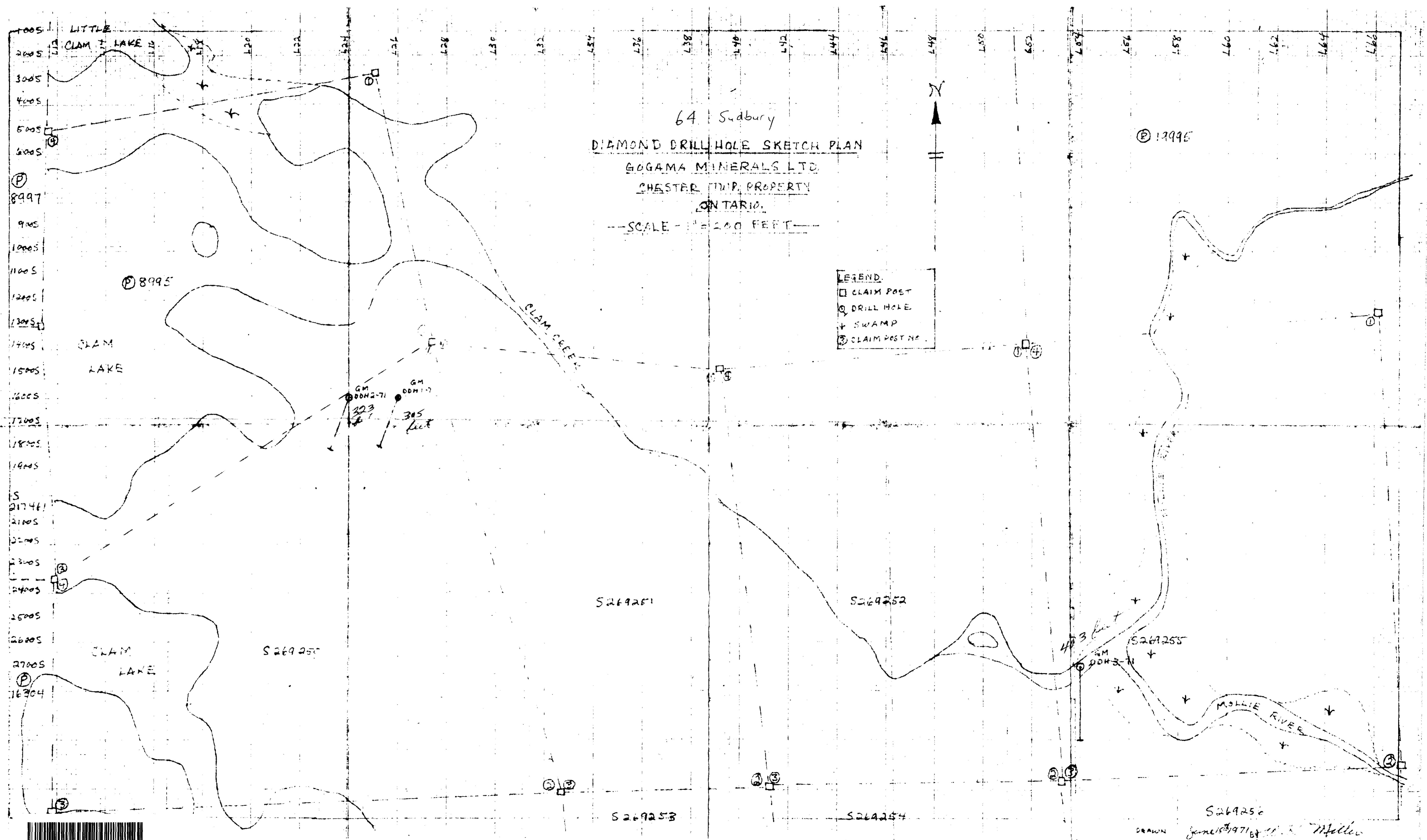

64 Sudbury  
 DIAMOND DRILL HOLE SKETCH PLAN  
 GOGAMA MINERALS LTD.  
 CHESTER TWP. PROPERTY  
 ONTARIO.  
 --SCALE = 1" = 200 FEET--

LEGEND.  
 □ CLAIM POST  
 ⊙ DRILL HOLE  
 + SWAMP  
 ⊕ CLAIM POST NO.

S269251

S269252

S269255

S269253

S269254

S269256

DRAWN June 18, 1971 by J. Miller

