



41P12SW0140 24 CHESTER

010

DIAMOND DRILLING

TOWNSHIP: CHESTER

REPORT No.: 24

WORK PERFORMED BY: TEXASGULF INCORPORATED

<u>CLAIM No.</u>	<u>HOLE No.</u>	<u>FOOTAGE</u>	<u>DATE</u>	<u>NOTE</u>
P 492360	53-2	93.3	Oct./79	(1)
	53-3	100.8	Oct./79	(1)
	53-5	77.1	Nov/79	(1)
	53-6	93.2	Nov./79	(1)
	53-7	76.2	Nov./79	(1)
	53-8	90.0	Nov./79	(1)
	53-1	115.8	Oct./79	(2)
	53-4	99.4	Oct./79	(2)
	53-9	99.5	Nov./79	(2)
	<u>9</u>	<u>845.3</u>		

NOTES: (1) # 77-80
(2) # 82-80

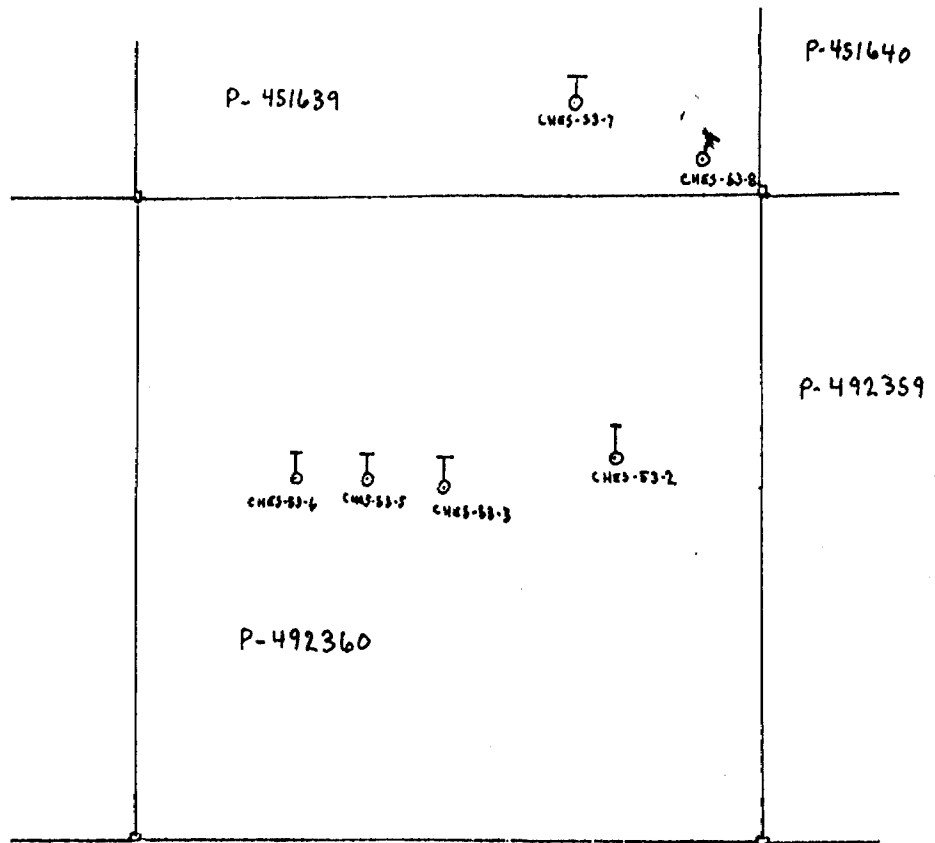

TEXASGULF INC.
DIAMOND DRILLING
CHESTER TWP

SCALE: 1" TO 400'
DRAWN BY: D.V. MULLEN

D.V. Mullen

PROPERTY Chester 53

PROJECT #64

Texasgulf

CONTRACTOR Bradley Bros

START 25/10/79 FINISH 28/10/79

HOLE No. Ches-53-2 LAT. _____

DEP. _____

ELEV. _____

LOC 31+25W, 1+65N

AZ. ^{due} North

ANGLE 63°

DEPTH 93.3'

CASING _____

FROM - TO	DESCRIPTION	SAMPLE No.	FROM - TO	SAMPLE LENGTH	ASSAYS				AVERAGES AND REMARKS
					Cu	Zn	Au	Ag	
0	93.3 93.3 GRANODIORITE:								
	- light to medium grey, medium grained								
	- porphyritic - blue Qtz-eyes								
	- speckled throughout - chlorite as fibrous masses,								
	- weak foliation at 40-50°								
	- moderately sericitized								
	Numerous short altered sections								
	- medium blue-grey, medium grained								
	- porphyritic - blue Qtz-eyes								
	- quite noticeable								
	Chlorite as fine grained masses - not speckled. The altered zones								
	generally occur in association with the mineralization	9135	7 10	3ft	0.03	0.00	Tr	0.01	
	Altered Zones (1) 8.4 to 9.3								
	(2) 18.0 to 18.6	9136	13 15	2ft	0.02	0.00	Tr	0.01	
	(3) 20.0 to 23.2								
	(4) 39.0 to 39.5)	9137	15 20	5ft	0.03	0.00	Tr	0.01	
	(5) 39.5 to 42.5)								
	(6) 43.2 to 47.3								
	(7) 48.3 to 49.1								

LOGGED BY: J. Der Weduwen DATE: Nov. 1979

PROPERTY Chester 53

HOLE No. Ches-53-2 PAGE No. 1

FROM - TO		DESCRIPTION	SAMPLE No.	FROM - TO		SAMPLE LENGTH	ASSAYS				AVERAGES AND REMARKS
				Cu	Zn		Au	Ag			
0	93.8	Con't									
		(8) 72.8 to 73.2									
		(9) 74.8 to 75.3									
		(10) 76.1 to 77.0									
		Disseminated sulphides occur from 16.0 to 27.0									
		37.5 to 49.3									
		54.6 to 56.0									
		Main sulphides zones: 8.0 to 10.5									
		13.0 to 27.0									
		37.5 to 42.0									
		45 to 47.5									
		predominately as (1) strongly disseminated masses	9138	20	22.5	2.5'	0.43	0.015	.015	.16	
		(2) fracture fillings, 1/6" to 1/8" wide	9139	22.5	23.5	1'	0.65	0.013	.02	.24	
		At 22.9 Qtz-carb zone, 2" wide at 75° to C.A., parallel chloritic, 20% sulphides	9140	37	39	2'	0.042	0.002	Tr	.04	
		At 39.8 7" Qtz veined zone - very irregular - 5% sulphides	9141	39	41	2'	1.92	0.022	.07	.77	
		At 42.9 1" Qtz-carb vein at 45° to C.A., perpendicular 5% sulphides	9142	41	45	4'	1.04	0.018	.015	.33	
			9143	45	50	5'	0.58	0.010	.02	.26	
		At 45.7 1" Qtz vein - very irregular 40% sulphides	9144	54	56	2'	0.013	0.002	Tr	.02	
		At 62.1 3½" Qtz vein at 60° to C.A., parallel barren, chloritic on contacts	9145	62	63	1'	0.005	0.002	Tr	.02	

FROM - TO	DESCRIPTION	SAMPLE No.	FROM - TO		SAMPLE LENGTH	ASSAYS				AVERAGES AND REMARKS
						Cu	Zn	Au	Ag	
0	93.8	Con't								
		At 71.8	¼" Qtz vein at 60° to C.A., perpendicular							
		5-7% sulphides	9146	71.5	73.5	2'	0.11	0.004	Tr	.05
		At -76.1	¼" Qtz-carb-vein at 80°, parallel							
		5% sulphides								
		At 76.3	½" - 3" Qtz-carb vein at 70-80°, parallel							
		5% sulphides	9147	73.5	77	3.5'	0.23	0.006	.12	.13
		At 84.0	1" Qtz vein at 75° to C.A., parallel							
		5% sulphides, chloritic on contacts	9148	83	85	2'	0.017	0.001	Tr	Tr
	93.3	END OF HOLE								
		<i>Dug North</i>								
		<i>J. Der Weduwen</i>								

LOGGED BY: J. Der Weduwen DATE: Nov. 1979

PROPERTY Chester 53

HOLE No. Ches-53-2 PAGE No. 3

PROPERTY Chester 53

PROJECT #64

Texasgulf

CONTRACTOR Bradley Bros START 28/10/79 FINISH 30/10/79

HOLE No. Ches-53-3 LAT. _____

DEP. _____

ELEV. _____

LOC. 34+65W, 0+90N

AZ. Due North

ANGLE -60°

DEPTH 100.8

CASING 8'

FROM - TO	DESCRIPTION	SAMPLE No.	FROM - TO	SAMPLE LENGTH	ASSAYS				AVERAGES AND REMARKS
					Cu	Zn	Au	Ag	
0	8								
	OVERBURDEN								
8	12								
	GRANODIORITE;								
	Altered from 8.0 to 10.2								
	Medium blue-grey, medium grained								
	Porphyritic - blue Qtz-eyes								
	Disseminated								
	Unaltered from 10.2 to 12.0								
	Light grey, medium grained								
	Occasional blue Qtz-eyes								
	Minor chlorite specks								
	Sericitic								
	At 8.0 3" Qtz zone - very irregular, limonitic, minor sulphides								
	At 9.1 9/16" Qtz vein at 55° to C.A., parallel, 2% sulphides								
	At 10.1 1 1/4" Qtz-carb-Chlorite zone at 60° to C.A., parallel, 2% sulphides	9149	8	12	4'	0.17	0.006	.005	.04
	At 11.2' 1/2 to 1" Qtz vein at 65° to C.A., parallel, minor sulphides								
	12.0 to 15.4 - mafic xenolith								
	- light to medium green fine grained								

LOGGED BY: J. Der Weduwen DATE: Nov. 1979

PROPERTY Chester 53

HOLE No. Ches-53-3 PAGE No. 1

FROM - TO		DESCRIPTION	SAMPLE No.	FROM - TO	SAMPLE LENGTH	ASSAYS				AVERAGES AND REMARKS
						Cu	Zn	Au	Ag	
8	12	Con't								
		12.0 to 15.4 Con't								
		- banded - often contorted								
		- strongly foliated at 50-55° to C.A.								
		- minor Py, Cpy								
		At 12.7 1" granodiorite dyke at 45-70° to C.A.								
		At 13.0 1-1½" granodiorite dyke at 55° to C.A.								
		At 13.5 3" granodiorite zone - very irregular								
		At 14.1 4" granodiorite dyke at 50° to C.A.								
15.4	100.8	GRANODIORITE								
		- light to medium grey, medium grained								
		- scattered blue Qtz-eyes, porphyritic								
		- minor chlorite 2-3%, occasionally speckled, weak to strong sericitization								
		- very weak foliation at 50-60° to C.A.								
		Several strongly sericitized zones								
		- light yellow-grey, fine to medium grained								
		- have short irregular Qtz stringers - wormy quartz								
		- not mineralized at (1) 33 to 42.0								
		(2) 64.5 to 71.6								
		(3) 81.1 to 82.0								
		from 75.0 to 100' only a few mineralized zones generally associated with								
LOGGED BY: J. Der Weduwen		DATE: Nov. 1979	PROPERTY: Chester 53		HOLE No. Ches-53-3		PAGE No. 2			

FROM - TO	DESCRIPTION	SAMPLE No.	FROM - TO	SAMPLE LENGTH	ASSAYS				AVERAGES AND REMARKS
					Cu	Zn	Au	Ag	
15.4 - 100.8	Con't quartz vein or fracture fillings								
	At 21.7 ½" Qtz-carb vein at 75° to C.A., perpendicular minor Py								
	At 26.8 1 to 3" Qtz-carb-chlorite zone at 65°, parallel 5% sulphides								
	At 31.0 ½" Qtz-carb zone at 55° to C.A., perpendicular chloritic								
	At 37.5 2" patchy Qtz zone, irregular								
	At 44.0 ½" Qtz-carb zone, very irregular, perpendicular barren								
	At 66.1 ½" Qtz-carb stringer at 60° to C.A., parallel minor sulphides								
	At 66.5 ½" Qtz-carb stringer at 55° to C.A., parallel barren								
	At 74.8 Carb zone at 35° to C.A., parallel chloritic	9150	75 - 79	4'	0. 15	0. 005		005	03
	At 78.0 1" Qtz-carb vein at 35° to C.A., parallel 10% sulphides	9151	79 - 80	1'	0. 62	0. 028		.02	.31
	At 79.0 6" Qtz-carb vein, very irregular 5% sulphides	9152	80 - 82	2'	0. 10	0. 003	Tr		.02
	At 84.1 ½" Qtz vein at 30° to C.A., parallel, 2-3% sulphides								

FROM - TO	DESCRIPTION	SAMPLE No.	FROM - TO		SAMPLE LENGTH	ASSAYS				AVERAGES AND REMARKS
						Cu	Zn	Au	Ag	
15.4	100.8									
	Con't									
	At 86.1 ¼" Qtz vein at 40° to C.A., parallel	9153	84	86	2'	0.099	0.003	Tr	.02	
	2% sulphides									
	At 87.2 ½" Qtz-carb vein at 70° to C.A., perpendicular									
	minor sulphides, chloritic									
	At 87.9 1-2" wide Qtz-carb vein at 80° to C.A., perpendicular									
	5% sulphides	9154	87	88	1'	0.026	0.002	Tr	.02	
	At 89.5 ¼" Qtz-carb zone at 60° to C.A. perpendicular	9155	88	89	1'	0.044	0.002	Tr	.02	
	10% sulphides									
	At 90.0 1" Qtz vein at 50° to C.A., parallel									
	minor sulphides, chloritic	9156	89	91.5	2.5'	0.044	0.002	Tr	.02	
	At 91.2 2" Qtz-carb vein at 80° to C.A., parallel									
	2% sulphides									
	At 92.5 ¼" Qtz vein at 80° to C.A., parallel									
	chloritic									
	At 92.7 1" Qtz vein at 85° to C.A., parallel									
	barren									
100.8	END OF HOLE									
	<i>De Muller</i>									
	<i>J. Der Weduwen</i>									

LOGGED BY: J. Der Weduwen DATE: Nov. 1979

PROPERTY Chester 53

HOLE No. Ches-53-3 PAGE No. 4

PROPERTY Chester 53PROJECT #64**Texasgulf**CONTRACTOR Bradley Bros. START 1/11/79 FINISH 4/11/79HOLE No. Ches-53-5 LAT. _____

DEP. _____ ELEV. _____

LOC. 36+25W, 1+15NAZ. ^{DUE}NORTH ANGLE -60° DEPTH 77.1' CASING 5'

FROM - TO		DESCRIPTION	SAMPLE No.	FROM - TO	SAMPLE LENGTH	ASSAYS				AVERAGES AND REMARKS
0	5	OVERBURDEN:								
5	6.3	GRANODIORITE:								
		- medium-dark grey, medium grained								
		- strongly foliated at 40° to C.A.								
		- scattered small blue Qtz-eyes								
		- 20% chlorite present - accounts for dark colour								
6.3	8.7	QUARTZ DIORITE:								
		- dark-medium grey-green, coarse grained								
		- scattered blue Qtz-eyes - generally are small								
		- minor Mt. throughout								
		- moderate foliation at 40° to C.A.								
		- contacts with granodiorite irregular and hazy - often strongly chloritic								
8.7	11.7	GRANODIORITE:								
		- medium grey-green, coarse grained								
		- strongly chloritic								
		- small blue Qtz-eyes								

LOGGED BY: J. Der Weduwen DATE: Nov. 1979PROPERTY Chester 53HOLE No. Ches-53-5 PAGE No. 1

FROM - TO	DESCRIPTION	SAMPLE No.	FROM - TO	SAMPLE LENGTH	ASSAYS				AVERAGES AND REMARKS
					Cu	Zn	Au	Ag	
8.7	11.7								
	Con't								
	- foliated at 30° to C.A.								
	- minor sulphides (Py, Po, Cpy) plus Mt								
11.7	77.1								
	QUARTZ DIORITE:								
	- medium to dark green, coarse grained								
	- large blue Qtz-eyes								
	- strongly foliated at 35-40° to C.A.								
	- 30% chlorite - often stretched parallel to foliation								
	- minor Py, Mt								
	Strongly contorted from 23.8-28.3' (Shear Zone?)								
	Altered zone from 41.1 to 52.2' (Shear Zone?)								
	dark blue-green, coarse grained								
	large blue Qtz-eyes								
	strongly foliated at 50° to C.A.								
	mineralized								
	Mineralized Zones: 23.8 to 26.4								
	40.0 to 52.2	9168	23.5	27	3.5'	1.50	0.018	.03	.57
	At 24.5 8" zone of Qtz-carb stringers - very irregular								
	10-20% sulphides								
	At 25.8 9" zone of Qtz-carb - strongly contorted								
	10-20% sulphides - some sphalerite								

LOGGED BY: J. Der Weduwen DATE: Nov. 1979

PROPERTY Chester 53

HOLE No. Ches-53-5 PAGE No. 2

FROM - TO		DESCRIPTION	SAMPLE No.	FROM - TO		SAMPLE LENGTH	ASSAYS				AVERAGES AND REMARKS
				Cu	Zn		Au	Ag			
11.7	77.1	Con't									
		At 27.2									
		9" Qtz-carb zone - very strongly contorted									
		strongly foliated at 45° to C.A.									
		At 31.4									
		8" granodiorite dyke									
		contacts very irregular									
		At 41.5									
		1½" quartz vein at 60° to C.A., parallel to foliation									
		minor Py									
		At 41.9									
		½" quartz vein at 60° to C.A., parallel to foliation									
		minor Py									
		At 44.8									
		1½" quartz carb vein at 40° to C.A., parallel to foliation									
		40% sulphides	9169	40	45	5'	1.30	0.019	.03	.40	
		At 47.2									
		2-4" quartz zone, very irregular									
		20% sulphides									
		At 48.1									
		¼" quartz vein at 30° to C.A., perpendicular to foliation									
		minor Py									
		At 48.5									
		¼" quartz vein at 30° to C.A., perpendicular to foliation	9170	45	50	5'	0.72	0.011	.025	.16	
		At 51.8									
		Quartz-carb-chlorite zone at 50° to C.A., parallel to foliation									
		2% sulphides	9171	50	55	5'	0.046	0.005	Tr	Tr	
		At 52.8									
		Qtz-carb vein at 50° to C.A., parallel to foliation									
		barren									
		At 65.6									
		1½" granodiorite dyke at 55° to C.A., parallel to foliation									
		At 67.4									
		2" granodiorite dyke at 55° to C.A., parallel to foliation									

LOGGED BY: J. Der Weduwen DATE: Nov. 1979

PROPERTY Chester 53

HOLE No. Ches-53-5 PAGE No. 3

PROPERTY Chester 53PROJECT #64**Texasgulf**CONTRACTOR Bradley Bros. START 4/11/79 FINISH 5/11/79HOLE No. Ches-53-6 LAT. _____

DEP. _____ ELEV. _____

LOC 37+75W:1+15N AZ. ^{D+E}N60E ANGLE -60° DEPTH 93.2' CASING 6.8'

FROM - TO	DESCRIPTION	SAMPLE No.	FROM - TO	SAMPLE LENGTH	ASSAYS				AVERAGES AND REMARKS
					Cu	Zn	Au	Ag	
0	6.8	OVERBURDEN							
6.8	28.4	QUARTZ DIORITE							
		- medium-dark green, coarse grained							
		- porphyritic - blue qtz-eyes							
		- chloritic throughout							
		- minor disseminated Py, Cpy							
		- entire unit can be divided into a number of phases							
	6.8 to 10.3	dark green coarse grained							
	10.3 to 11.2	medium green, medium grained partially brecciated							
	11.2 to 15.6	medium green, medium grained							
	15.6 to 17.4	light green, medium grained							
	17.4 to 21.7	medium green, medium grained							
	21.7 to 24.1	light green, medium grained							
	24.1 to 25.0	dark green, medium grained							
	25.0 to 28.4	medium green, medium grained							
		- entire unit has a weak foliation at 35-40° to C.A.							
	At 8.7	½" carb vein at 35° to C.A., parallel to foliation							

LOGGED BY: J. Der Weduwen DATE: Nov. 1979PROPERTY Chester 53HOLE No. Ches-53-6 PAGE No. 1

FROM - TO		DESCRIPTION	SAMPLE No.	FROM - TO		SAMPLE LENGTH	ASSAYS				AVERAGES AND REMARKS	
							Cu	Zn	Au	Ag		
6.8	28.4	Con't										
		At 10.9 1½" brecciated zone at 50° to C.A., parallel to foliation										
		light coloured fragments in a chloritic matrix										
		At 15.7 8" granodiorite dyke at 45° to C.A., parallel to foliation										
		At 18.8 5" granodiorite dyke - hazy broken contacts										
28.4	43.0	GRANODIORITE	9172	30	35	5'	0.008	0.004	Tr	Tr		
		- gradational - hazy contact with quartz diorite	9173	35	40	5'	0.031	0.003	Tr	Tr		
		- light grey, medium grained	9174	40	43	3'	0.075	0.004	Tr	Tr		
		- speckled - fibrous chlorite specks throughout										
		- foliated at 50° to C.A.										
		- occasional large blue quartz-eyes - not common										
		- sericitic										
		- minor disseminated Py, Cpy throughout										
		At 36.9 1-2" irregular felsic zone										
		At 37.2 ½-¾" quartz-carb vein at 45° to C.A., parallel to foliation										
		From 39.6 to 43.0 strong foliation at 40° to C.A. - slight increase in mineralization										
43.0	45.2	CARBONATE-QUARTZ-CHLORITIC ZONE	9175	43	45	2'	0.49	0.010	.005	.13		
		80% carbonate in contorted bands										
		carbonate does not effervesce										
LOGGED BY: J. Der Weduwen			DATE: Nov. 1979			PROPERTY Chester 53			HOLE No Ches-53-6			PAGE No. 2

FROM - TO		DESCRIPTION	SAMPLE No.	FROM-TO		SAMPLE LENGTH	ASSAYS				AVERAGES AND REMARKS
				Cu	Zn		Au	Ag			
43.0	45.2	Con't									
		- minor quartz									
		- minor chlorite along edges of bands - 5% sulphides									
45.2	50.1	QUARTZ DIORITE?	9176	45	50	5'	0.82	0.011	0.005	0.20	
		- strongly altered zone (Shear Zone?)									
		- dark grey-green to dark grey									
		- coarse grained									
		- porphyritic - very prominent large blue quartz-eyes									
		- strongly foliated at 30-35° to C.A.									
		Unit well mineralized throughout									
50.1	93.2	GRANODIORITE	9177	50	55	5'	0.24	0.005	0.025	0.07	
		- light grey, medium grained									
		- minor chlorite - speckled throughout									
		- occasional small blue quartz-eyes									
		- foliated at 30° to C.A.									
		From 52.5 to 68.1 - ALTERED GRANODIORITE	9178	55	60	5'	0.016	0.003	Tr	Tr	
		- light to dark blue grey									
		- medium grained									
		- foliated at 25-30° to C.A.									
		- Porphyritic - blue quartz-eyes									
LOGGED BY: <u>J. Der Weduwen</u> DATE: <u>Nov. 1979</u> PROPERTY <u>Chester 53</u> HOLE No. <u>Ches-53-6</u> PAGE No. <u>3</u>											

FROM - TO	DESCRIPTION	SAMPLE No.	FROM - TO		SAMPLE LENGTH	ASSAYS				AVERAGES AND REMARKS
						Cu	Zn	Au	Ag	
50.1	93.2									
	Con't									
	- disseminated sulphides throughout									
	- The mineralization continues as disseminations until 78.5 with some disseminated Py at 83.5-85.0'									
	At 53.6 1-2" quartz-carbonate vein at 40° to C.A., parallel to foliation	9179	60	63	3'	0.030	0.002	Tr	Tr	
	At 63.4 8" quartz-feldspar zone - irregular 10% sulphides	9180	63	66	3'	0.016	0.002	Tr	Tr	
	At 64.1 16" strongly sericitized unit, light grey often contorted									
	At 67.7 ½-1" quartz vein at 65° to C.A., parallel to foliation	9181	66	68	2'	0.064	0.005	Tr	Tr	
	At 68.2 1" Quartz carbonate vein at 80° to C.A., perpendicular to foliation - 20% sulphides	9182 9183	68 70	70 75	2' 5'	0.044 0.030	0.002 0.002	Tr Tr	Tr Tr	
	At 74.8 1-1½" quartz vein at 20° to C.A., parallel to foliation	9184	75	80	5'	0.036	0.002	Tr	Tr	
	minor sulphides	9185	80	85	5'	0.008	0.002	Tr	Tr	
	At 85.0 1-1½" carbonate vein at 30° to C.A., parallel to foliation									
	93.2 END OF HOLE									
	<i>D. de H. H.</i>									
	<i>J. Der Weduwen</i>									

PROPERTY Chester 53 PROJECT #64 **Texasgulf** CONTRACTOR Bradley Bros START 5/11/79 FINISH 7/11/79
 HOLE No. Ches-53-7 LAT. _____ DEP. _____ ELEV. _____ LOC. _____ AZ. ^{DUE}NORTH ANGLE -60° DEPTH 76.2' CASING _____

FROM - TO	DESCRIPTION	SAMPLE No.	FROM - TO	SAMPLE LENGTH	ASSAYS				AVERAGES AND REMARKS
					Cu	Zn	Au	Ag	
0	18.6								
	GRANODIORITE								
	- speckled, light grey, medium grained								
	- speckled - fibrous chlorite spots								
	- scattered small blue quartz-eyes								
	- weak foliation at 45-50° to C.A.								
	- minor disseminated sulphides from 16.0-18.6'								
18.6	52.9								
	GRANODIORITE								
	- weak to moderate alteration								
	- medium blue-grey, medium grained								
	- weak foliation at 45° to C.A.								
	- minor blue quartz-eyes								
	- minor chlorite								
	Mineralized from 47.3 to 52.9 as								
	(1) Po filled fractures								
	(2) Disseminated Py, Po and Cpy								
	At 21.1 ½-1" quartz vein at 70° to C.A., parallel to foliation								
	10% chlorite on contacts								
	At 23.7 ¼" quartz vein at 40° to C.A., parallel to foliation								

LOGGED BY: J. Der Weduwen DATE: Nov. 1979

PROPERTY Chester 53

HOLE No. Ches-53-7 PAGE No. 1

FROM - TO	DESCRIPTION	SAMPLE No.	FROM - TO	SAMPLE LENGTH	ASSAYS				AVERAGES AND REMARKS	
					Cu	Zn	Au	Ag		
18.6	52.9	Con't								
	At 25.7 to 28.0	Coarse grained granodiorite								
		Porphyritic - white feldspars								
		Not mineralized								
		Light grey	9186	43 45	2'	0.005	0.002	Tr	Tr	
	At 48.4	Carbonate zone at 45° to C.A., parallel to foliation								
		20% sulphides - predominately Po	9187	45 50	5'	0.029	0.002	Tr	.02	
	At 52.0	¼" quartz vein at 50° to C.A., parallel to foliation								
		chloritic								
	At 52.1	2" quartz blob - very irregular								
		20% sulphides								
			9187	50 53	3'	0.024	0.004	Tr	Tr	
52.9	76.2	GRANODIORITE								
		- light grey to medium blue-grey, becoming very light grey down hole								
		- medium grained								
		- a few, scattered, small blue quartz-eyes								
		- sericitic								
		- minor chloritic - not speckled								
		- very minor Po disseminations								
	At 61.2	¼" quartz vein at 60° to C.A., parallel to foliation								
	At 62.5	¼" quartz vein at 60° to C.A., parallel to foliation								
	At 66.5	¼" quartz carbonate-chlorite vein at 65° to C.A.								
LOGGED BY: J. Der Weduwen			DATE: Nov. 1979			PROPERTY: Chester 53			HOLE No. Ches-53-7 PAGE No. 2	

FROM - TO	DESCRIPTION	SAMPLE No.	FROM-TO	SAMPLE LENGTH	ASSAYS				AVERAGES AND REMARKS
					Cu	Zn	Au	Ag	
52.9	76.2								
	Con't								
	At 66.5 (con't)								
	At 67.4								
	$\frac{1}{2}$ " quartz vein at 70° to C.A., perpendicular to foliation 30% sulphides, 5% biotite on contacts	9189	67	69	2'	0.005	0.003	Tr	Tr
	At 72.2								
	$\frac{1}{4}$ - $\frac{3}{4}$ " quartz vein at 55° to C.A., perpendicular to foliation								
	At 75.9								
	$\frac{1}{2}$ " quartz vein at 60° to C.A., parallel to foliation								
76.2	END OF HOLE								
	<i>K. M.</i>								

LOGGED BY: J. Der Weduwen DATE: Nov. 1979

PROPERTY Chester 53

HOLE No. Ches-53-PAGE No. 3

PROPERTY Chester 53

PROJECT #64

Texasgulf

CONTRACTOR Bradley Bros START 8/11/79 FINISH 10/11/79

HOLE No. Ches-53-8 LAT. _____

DEP. _____ ELEV. _____

LOC. 29+13W; 7+69N

AZ. 105° ANGLE -55° DEPTH 90.0' CASING _____

FROM - TO	DESCRIPTION	SAMPLE No.	FROM - TO		SAMPLE LENGTH	ASSAYS				AVERAGES AND REMARKS
						Cu	Zn	Au	Ag	
0	25.9									
25.9	78.1									

LOGGED BY: J. Der Weduwen DATE: Nov. 1979

PROPERTY Chester 53

HOLE No. Ches-53-8 PAGE No. 1

FROM - TO	DESCRIPTION	SAMPLE No.	FROM - TO	SAMPLE LENGTH	ASSAYS				AVERAGES AND REMARKS
					Cu	Zn	Au	Ag	
25.9	78.1								
	Con't								
	-weakly sericitized								
	- non altered sections - speckled - 5% fibrous chlorite								
	- minor Py								
	- weakly foliated at 35-40° to C.A.								
	Altered Sections								
	- Blue-grey colour								
	- mineralized								
	- distinctive blue quartz-eyes								
	From (1) 27.4 to 35.0								
	(2) 46.8 to 48.5								
	(3) 51.3 to 52.3								
	(4) 53.0 to 65.1								
	(5) 73.6 to 78.1								
	At 28.2								
	½" quartz vein at 40° to C.A, parallel to foliation								
	minor Py								
	At 29.7								
	¼-½" quartz vein at 60° to C.A., perpendicular to foliation								
	minor Py								
	At 30.2								
	¼" quartz vein at 30° to C.A., perpendicular to foliation								
	barren								
	At 33.1								
	¼-1" quartz-carbonate vein at 40° to C.A., parallel to foliation, 5% Cpy, Py, Po								
LOGGED BY: <u>J. Der Weduwen</u> DATE: <u>Nov. 1979</u> PROPERTY <u>Chester 53</u> HOLE No. <u>Ches-53-8</u> PAGE No. <u>2</u>									

FROM - TO		DESCRIPTION	SAMPLE No.	FROM - TO		SAMPLE LENGTH	ASSAYS				AVERAGES AND REMARKS
				Cu	Zn		Au	Ag			
25.9	78.1	Con't									
		At 34.1 ½" carbonate vein at 50° to C.A., parallel to foliation minor Py									
		At 34.2 ½-1" carbonate vein at 50° to C.A., parallel to foliation minor Py	9193	35	40	5'	0.010	0.002	Tr	Tr	
		At 41.6 ½" quartz vein at 25° to C.A., perpendicular to foliation barren	9194	40	45	5'	0.005	0.002	Tr	Tr	
		At 45.6 ½" carbonate zone at 40° to C.A., perpendicular to foliation minor Py	9195	45	47	2'	0.023	0.003	Tr	Tr	
		At 47.1 ½" quartz vein at 50° to C.A., parallel to foliation 50-60% sulphides	9196	47	48.5	1.5'	0.018	0.002	0.005	Tr	
		At 47.3 ½-1" quartz vein at 40° to C.A., parallel to foliation 30% sulphides	9197	48.5	51.5	3'	0.017	0.002	Tr	Tr	
		At 51.8 ½-½" quartz zone at 40° to C.A., parallel to foliation 50% sulphides									
		At 52.3 3" quartz-carbonate vein at 80° to C.A., perpendicular to foliation - 10% sulphides	9198	51.5	53	1.5'	0.023	0.002	0.005	Tr	
		At 54.4 ½-½" quartz-vein at 45° to C.A., perpendicular to foliation 30% sulphides	9199	53	58	5'	0.043	0.002	0.005	Tr	
		54.0 ½-½" Carbonate zone at 40° to C.A., parallel to foliation 10% sulphides	9200	58	62	4'	0.018	0.002	Tr	Tr	
			9201	62	65	3'	0.004	0.011	Tr	Tr	
			9202	65	68	3'	0.003	0.011	Tr	Tr	
		63.4 ½-½" carbonate-chlorite zone at 15° to C.A., parallel to	9203	68	70	2'	0.025	0.004	Tr	Tr	

LOGGED BY: J. Der Weduwen DATE: Nov. 1979

PROPERTY Chester 53

HOLE No. Ches-53-8 PAGE No. 3

FROM - TO		DESCRIPTION	SAMPLE No.	FROM - TO		SAMPLE LENGTH	ASSAYS				AVERAGES AND REMARKS
							Cu	Zn	Au	Ag	
25.9	78.1	Con't	9304	70	73	3'	0.005	0.005	Tr	Tr	
		63.4 (con't) foliation, 10% Py									
			9305	73	75	2'	0.001	0.006	Tr	Tr	
78.1	90.0	QUARTZ DIORITE									
		- dark green, coarse grained									
		- foliated at 30° to C.A.									
		- porphyritic - large blue quartz-eyes									
		- massive									
		At 83.9 7½" granodiorite dyke									
		very irregular contacts									
		At 84.6 3" granodiorite dyke									
		very irregular									
		At 89.1 1" granodiorite dyke at 15° to C.A. parallel to foliation									
90.0		END OF HOLE									

Duc M...

P. Der Weduwen

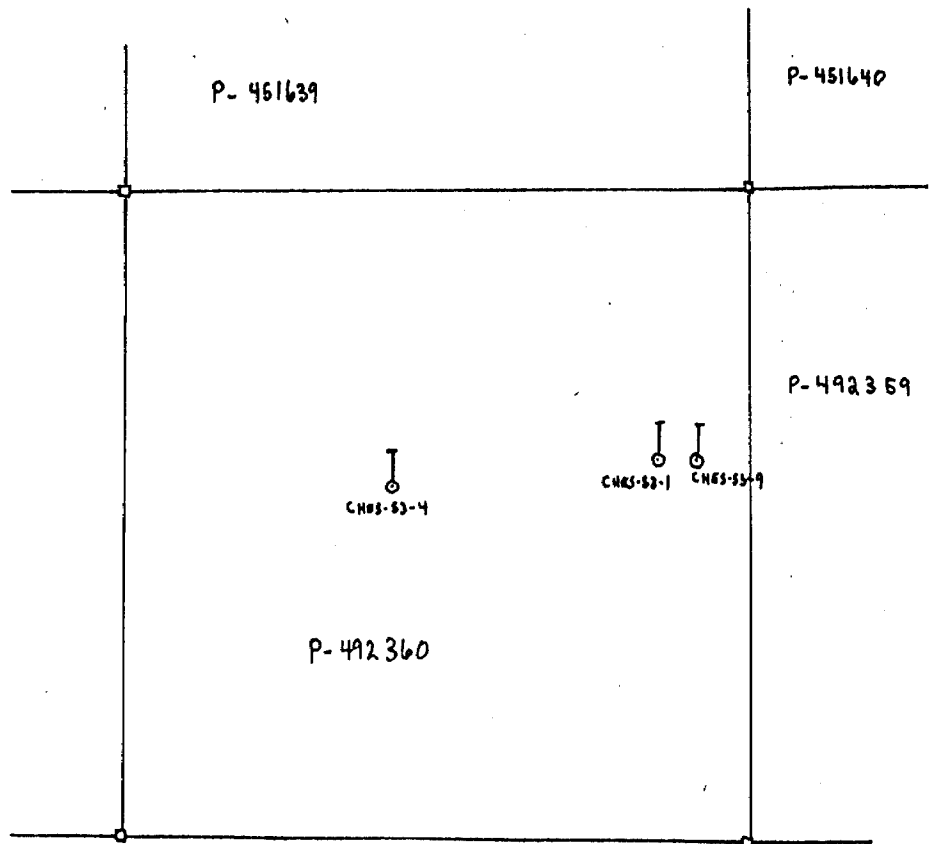

TEXASGULF INC.
DIAMOND DRILLING
CHESTER TWP. #82-80

SCALE: 1" TO 400'
DRAWN BY: D.V. MULLEN

D.V. Mullen

PROPERTY Chester 53

PROJECT #64

Texasgulf

CONTRACTOR Bradley Bros START 22/10/79 FINISH 25/10/79

HOLE No. Ches-53-1 LAT. _____ DEP. _____ ELEV. _____ LOC. 30=25W:1+75N AZ. 000° ANGLE -60° DEPTH 115.8' CASING 2 1/2"

FROM - TO	DESCRIPTION	SAMPLE No.	FROM-TO	SAMPLE LENGTH	ASSAYS				AVERAGES AND REMARKS
0	25								
	QUARTZ DIORITE:								
	Light to medium green,								
	fine to course grained - can be divided into several distinct phases								
	0 6.0 med. grained, dark green								
	6.0 10.4 coarse grained, dark green								
	10.4 16.8 coarse grained, light green								
	16.8 22.3 med. grained, medium green								
	22.3 25.0 fine grained, med. green								
	Porphyritic - blue qtz-eyes								
	- very distinctive in Cs. grained sections								
	Minor Py								
	Minor Mt - disseminated throughout								
	- weakly magnetic								
	Weakly Carbonated								
	Weakly Foliated at 45°-50° to C.A.								
	At 8.9' - 1 1/2" Granodiorite Dyke at 80° to C.A., grey, medium grained								
	From 9.9 - 10.4' Qtz-feldspar rich portion								
	At 16.8' - 14" Granodiorite dyke								
	upper contact at 15° to C.A.								

LOGGED BY: J. Der Weduwen DATE: Nov. 1979

PROPERTY Chester 53

HOLE No. Ches-53-1 PAGE No. 1

FROM - TO		DESCRIPTION	SAMPLE No.	FROM - TO		SAMPLE LENGTH	ASSAYS				AVERAGES AND REMARKS	
								Cu	Zn	Au		Ag
0	25	Con't										
		lower contact at 70° to C.A.										
		At 23.9' 1½" Granodiorite dyke, grey, medium green, irregular contacts										
25	46.2	GRANODIORITE:										
		- light to medium grey, medium grained										
		- 5% chlorite as fibrous masses giving rock a speckled appearance										
		- some pale blue Qtz-eyes										
		- minor Py and Mt										
		At 41.0' 1" qtz-carb vein - irregular and branching 5% magnetite along contacts										
			9124	45	50	5'	0. 32	0. 007	.005	.09		
46.2	70.7	ALTERED GRANODIORITE:	9125	50	55	5'	0. 82	0. 009	.005	.26		
		- medium blue-grey colour	9126	55	60	5'	0. 35	0. 009	.005	.11		
		- medium grained	9127	60	65	5'	0. 24	0. 009	.003	.10		
		- porphyritic - large blue Qtz-eyes	9128	65	70	5'	0. 091	0. 004	.003	.04		
		- 10% chlorite, very fine grained and evenly distributed throughout core										
		- moderately sericitic										
		This is the rock type that hosts the sulphides as										
		(1) fine grained disseminations										
		(2) fracture fillings parallel to foliation										
		At 48.6' 1" Qtz vein - 30-40% Cpy, Py, Po										
LOGGED BY: J. Der Weduwen			DATE: Nov, 1979			PROPERTY: Chester 53			HOLE No. Ches-53-1			PAGE No. 2

FROM - TO	DESCRIPTION	SAMPLE No.	FROM - TO		SAMPLE LENGTH	ASSAYS				AVERAGES AND REMARKS
						Cu	Zn	Au	Ag	
46.2	70.7									
	Con't									
	From 48.6 to 57.0' numerous fractures filled with sulphides									
	- sulphides disseminated to 70.7'									
	At 66.9' ½" Qtz vein at 65° to C.A. - white, barren									
	At 68.8' ½" Qtz vein at 45° to C.A. - 15% sulphides									
70.7	115.8									
	GRANODIORITE:									
	- light grey, medium grained									
	- slightly porphyritic - blue Qtz-eyes									
	- speckled - 5% chlorite as fibrous masses	9129	80.5	81.5	1'	0.021	0.002	Tr	Tr	
	- slightly carbonated									
	- sericitic									
	- minor Py									
	- minor sulphides disseminated through core until 89.9'									
	- some fractures filled with sulphides, not consistent									
	At 79.3' ½" Qtz-carb vein at 70° to C.A., barren, minor tourmaline									
	At 80.9' 3" Qtz vein at 50° to C.A., 10% sulphides, minor carbonate									
	At 83.6' 2" Qtz-carb vein at 80°, 20% sulphides, minor chlorite	9130	83	84	1'	0.045	0.002	Tr	.02	
	From 89.9 to 90.7' Altered granodiorite									
	From 92.3 to 93.9' Altered granodiorite									
	- blue grey colour, medium grained									
	- porphyritic - blue Qtz-eyes									
LOGGED BY: <u>J. Der Weduwen</u> DATE: <u>Nov, 1979</u> PROPERTY <u>Chester 53</u> HOLE No. <u>Ches-53-1</u> PAGE No. <u>3</u>										

FROM - TO		DESCRIPTION	SAMPLE No.	FROM - TO		SAMPLE LENGTH	ASSAYS				AVERAGES AND REMARKS
								Cu	Zn	Au	
70.7	115.8	Con't									
		- good disseminated sulphides	9131	90	95	5'	0. 34	0. 007	.003	.13	
		At 94.8' Qtz-carb vein at 55° to C.A. - 10% sulphides									
		94.7 to 95.4' Altered granodiorite	9132	95	97	2'	0. 27	0. 008	.003	.13	
		97.3 to 99.0' Altered granodiorite	9133	97	98	1'	0. 84	0. 019	.005	.31	
		- blue-grey colour, medium grained	9134	98	100	2'	0. 018	0. 002	Nil	Tr	
		- porphyritic - blue Qtz-eyes									
		- disseminated sulphides									
		At 106.5' ¼ to 1" Qtz-carb vein at 70° to C.A. - 5% sulphides									
		At 112.8' ½" Qtz-carb stringers at 60° to C.A. - 2% sulphides									
	115.8	END OF HOLE									

LOGGED BY: *J. Der Weduwen* DATE: Nov. 1979

10/11/79

PROPERTY Chester 53

HOLE No. Ches-53-1 PAGE No. 4

PROPERTY Chester 53PROJECT #64

Texasgulf

CONTRACTOR Bradley Bros START 30/10/79 FINISH 1/11/79HOLE No. Ches-53-4 LAT. _____

DEP. _____

ELEV. _____

LOC. L35+40W; 0+95N AZ. DIVE NORTH ANGLE -55° DEPTH 99.4' CASING 6.5'

FROM - TO		DESCRIPTION	SAMPLE No.	FROM - TO		SAMPLE LENGTH	ASSAYS				AVERAGES AND REMARKS
								Cu	Zn	Au	
0	6.5	OVERBURDEN:									
6.5	19.8	GRANODIORITE:	9157	6.5	10	3.5'	0.067	0.003	Tr	.02	
		- light to medium grey, medium grained									
		- porphyritic - blue Qtz eyes	9158	10	15	5'	0.051	0.002	Tr	Tr	
		- minor chlorite									
		- sericitic, foliated at 40-45°, weakly minor sulphides									
		throughout									
		At 14.2' 1/2-1" Qtz-carb zone at 30° to C.A., parallel									
			9159	15	19.8	4.8'	0.044	0.002	Tr	Tr	
19.8	35.1	DIABASE:									
		- black, fine grained									
		- equigranular									
		- fractured in places - carbonate filled, very minor Py									
		Upper contact at 10° to C.A., perpendicular to fol.									
		Lower contact at 25° to C.A., perpendicular to fol.									
35.1	36.2	GRANODIORITE:	9160	35	36.2	1.2'	0.094	0.002	Tr	.02	
		- similar to granodiorite at 6.5'									

LOGGED BY: J. Der Weduwen DATE: Nov. 1979PROPERTY Chester 53HOLE No. Ches-53-4 PAGE No. 1

FROM - TO		DESCRIPTION	SAMPLE No.	FROM - TO		SAMPLE LENGTH	ASSAYS				AVERAGES AND REMARKS
				Cu	Zn		Au	Ag			
35.1	36.2	Con't									
		- slightly altered									
		- disseminated sulphides throughout									
		At 35.5 1/8 to 1/4" fracture at 35° to C.A., perpendicular to fol.									
		5-10% arsenopyrite									
36.2	37.2	DIABASE:									
		- black, fine grained, equigranular									
		- upper contact at 50° to C.A., parallel to fol.									
		- lower contact at 30° to C.A., perpendicular to fol.									
37.2	54.7	GRANODIORITE:									
		- light to medium grey, medium grained	9161	41	42	1'	0.007	0.002	Tr	Tr	
		- speckled - chlorite as fibrous masses									
		- porphyritic - scattered blue Qtz-eyes									
		- moderately sericitic									
		At 39.0 1" Carb-chlorite zone at 60° to C.A., perpendicular to fol.									
		At 41.6 3/4-1 1/4" Qtz-carb vein at 85° to C.A., perpendicular to fol.									
		2-5% Py, Po.									
		At 42.6 1/2" Qtz vein at 55° to C.A., parallel to fol.									
		chlorite on contacts, barren									
		At 48.2 9" zone of strong sericitization									
LOGGED BY: J. Der Weduwen			DATE: Nov. 1979		PROPERTY: Chester 53			HOLE No. Ches-53-4 PAGE No. 2			

FROM - TO	DESCRIPTION	SAMPLE No.	FROM - TO	SAMPLE LENGTH	ASSAYS				AVERAGES AND REMARKS
					Cu	Zn	Au	Ag	
54.7	56.4								
	MAFIC ZENOLITH:								
	- light to dark green								
	- fine grained								
	- both sericitic and chloritic								
	- foliated at 70° to C.A., often contorted								
	At 55.5 1½" granodiorite dyke at 45° to C.A., parallel								
	to foliation								
56.4	57.5								
	Granodiorite:								
	- light grey, medium grained								
	- speckled - fibrous chlorite scattered throughout core								
	- weak sericitization								
	- disseminated Py throughout								
	At 57.2' ½" Carb-chlorite-sericite zone at 70° to C.A.								
	parallel to foliation.								
57.5	58.3								
	MAFIC ZENOLITH:								
	- medium green, fine grained								
	- foliated at 65° to C.A.								
	- contacts very irregular and hazy								
LOGGED BY: <u>J. Der Weduwen</u> DATE: <u>Nov. 1979</u> PROPERTY <u>Chester 53</u> HOLE No. <u>Ches-53-4</u> PAGE No. <u>3</u>									

FROM - TO		DESCRIPTION	SAMPLE No.	FROM - TO		SAMPLE LENGTH	ASSAYS				AVERAGES AND REMARKS
								Cu	Zn	Au	
58.3	82.8	GRANODIORITE:									
		- light grey, medium grained									
		- porphyritic - occasional blue Qtz-eyes									
		- speckled - fibrous chlorite									
		- disseminated Py until 79.4'									
		- moderate sericitization									
		Several altered zones									
		blue-grey colour, medium grained									
		large blue Qtz-eyes stand out									
		At 63.3 to 63.7									
		65.0 to 66.3									
		66.8 to 67.4									
		69.7 to 82.8									
		from 76.2 to 82.8', very strongly altered - very low Qtz-eyes									
		- foliated at 55° to C.A.	9162	58.5	60	1.5'	0.009	0.002	Tr	Tr	
		At 60.5' 1" chlorite rich zone at 60° to C.A., parallel to Foliation									
		2% sulphides	9163	60	65	5'	0.23	0.004	.005	.05	
		At 65.9' ¼-½" Qtz-carb-chlorite zone at 65° to C.A., parallel to foliation									
		20% sulphides	9164	65	70	5'	0.096	0.002	Tr	.02	
		At 70.9' 1-1½" Quartz vein at 65° to C.A., perpendicular to foliation									
		5% sulphides									
		At 72.6' 1½" quartz vein at 55° to C.A., perpendicular to foliation									
LOGGED BY: J. Der Weduwen			DATE: Nov. 1979		PROPERTY Chester 53		HOLE No. Ches-53-4		PAGE No. 4		

FROM - TO		DESCRIPTION	SAMPLE No.	FROM - TO		SAMPLE LENGTH	ASSAYS				AVERAGES AND REMARKS
				Cu	Zn		Au	Ag			
58.3	82.8	Con't									
		72.6(Con't) 30% sulphides along contact									
		At 73.4 1/4 - 1" Qtz vein at 40° to C.A., parallel to foliation									
		10-15% sulphides									
		At 74.3 1/4" Qtz vein at 60° to C.A., irregular, 40% sulphides									
		At 74.7 2-3" Qtz blob at ≈ 60°, perpendicular to foliation									
		20-25% sulphides	9165	70	75	5'	0. 84	0. 012	.015	.25	
		At 75.6 1/2" Q.C. zone at 65° to C.A., parallel to foliation									
		10% sulphides									
		At 77.2 4-5" Q.C. zone at 75° to C.A., parallel to foliation, barren	9166	75	80	5'	0. 60	0. 010	.015	.14	
		At 80.3 1" Qtz vein at 75° to C.A., parallel to foliation, barren									
		At 80.6 3/4" Qtz vein at 75° to C.A., parallel to foliation, barren									
82.8	99.4	QUARTZ DIORITE:	9167	80	82.5	2.5'	0. 017	0. 006	Tr	Tr	
		Dark grey-green, coarse grained									
		Porphyritic - white quartz surrounded by rim of creamy feldspars									
		Minor epidote throughout									
		At 86.0 1" Carb-epidote zone at 35°, perpendicular to foliation									
		At 90.0 2 1/2" Qtz-carb-epidote zone - blotchy									
		At 94.0 3" Qtz-carb vein at 75° to C.A., parallel to foliation									
		At 94.9 2" granodiorite dyke at 80° to C.A., parallel to foliation									
LOGGED BY: J. Der Weduwen DATE: Nov. 1979			PROPERTY Chester 53			HOLE No. Ches-53-4			PAGE No. 5		

PROPERTY Chester 53

PROJECT #64

Texasgulf

CONTRACTOR Bradley Bros

START 11/11/79 FINISH 13/11/79

HOLE No. Ches-53-9 LAT. _____

DEP. _____

ELEV. _____

LOC 29+50W:1+75N

AZ. _____

ANGLE -60°

DEPTH 99.5' CASING _____

FROM - TO	DESCRIPTION	SAMPLE No.	FROM - TO	SAMPLE LENGTH	ASSAYS				AVERAGES AND REMARKS
					Cu	Zn	Au	Ag	
0	1.2								
1.2	8.3								
	QUARTZ DIORITE								
	- dark green, coarse grained								
	- porphyritic - large blue quartz-eyes								
	- minor Mt. cubes throughout								
	- minor Py								
	- moderately carbonated								
	At 3.4 ¼-½" carbonate vein at 25° to C.A., crossing to foliation								
8.3	23.0								
	GRANODIORITE								
	- light to medium green, medium grained								
	- slightly speckled - fibrous chlorite								
	- occasional small blue quartz-eyes								
	- minor Py, Cpy								
	- weak foliation at 45-50° to C.A.								
	- no altered or sulphide zones								
	At 13.7 2½" quartz vein at 75° to C.A.								
	very irregular, barren								

LOGGED BY: J. Der Weduwen DATE: Nov 1979

PROPERTY Chester 53

HOLE No. Ches-53-9 PAGE No. 1

FROM - TO	DESCRIPTION	SAMPLE No.	FROM - TO	SAMPLE LENGTH	ASSAYS				AVERAGES AND REMARKS
					Cu	Zn	Au	Ag	
8.3	23.0	Con't							
	At 15.4	1/8-1/2" carb zone at 25° to C.A., perpendicular to foliation							
		minor chlorite							
	At 20.5	1/8" quartz vein at 25° to C.A., perpendicular to foliation							
		5% sulphides							
	At 20.6	1/4" quartz vein at 40° to C.A., perpendicular to foliation							
		1% sulphides							
23.0	51.7	QUARTZ DIORITE							
		- medium to dark green							
		- porphyritic blue quartz-eyes							
		- minor Py, Po							
		- minor magnetite							
		Occurs in distinct phases							
		23.0 to 27.3 medium grained, dark green							
		27.3 to 30.0 coarse grained, dark green							
		30.0 to 42.0 coarse grained, light green							
		splotchy - clear quartz-eyes							
		surrounded by white feldspars							
		- unit epidotized							
		42.0 to 51.7 coarse grained, medium green							
	At 27.8	1/4" carbonate vein at 45° to C.A., perpendicular to foliation							
LOGGED BY: <u>J. Der Weduwen</u> DATE: <u>Nov. 1979</u> PROPERTY <u>Chester 53</u> HOLE No. <u>Ches-53-9</u> PAGE No. <u>2</u>									

FROM - TO	DESCRIPTION	SAMPLE No.	FROM - TO	SAMPLE LENGTH	ASSAYS				AVERAGES AND REMARKS
					Cu	Zn	Au	Ag	
23.0	51.7	Con't							
	At 29.4	1/4-1/2" carbonate vein at 65° to C.A., parallel to foliation							
	At 33.7	2-2 1/2" epidote rich zone at 80° to C.A., perpendicular to foliation - several large quartz-eyes							
	At 35.6	1" epidote zone at 65° to C.A. minor quartz-eyes, upper contact sharp lower contact hazy							
	At 36.3	3/4" epidote-carbonate zone at 30° to C.A., perpendicular to foliation							
	At 37.5	3/4" epidote zone at 50° to C.A., parallel to foliation							
	At 44.1	1/2" carbonate zone at 35° to C.A., parallel to foliation							
	At 45.5	1/2-3/4" carbonate zone at 50° to C.A., parallel to foliation minor Py							
	At 48.4	1/2" quartz carbonate vein at 60° to C.A., perpendicular to foliation							
51.7	99.5	GRANODIORITE - light to medium grey, medium grained - unaltered zones - speckled, fibrous chlorite - moderately sericitized - minor Py, Po - scattered blue quartz-eyes							

LOGGED BY: J. Der Weduwen DATE: Nov. 1979

PROPERTY Chester 53

HOLE No. Ches-53-9 PAGE No. 3

FROM - TO	DESCRIPTION	SAMPLE No.	FROM - TO	SAMPLE LENGTH	ASSAYS				AVERAGES AND REMARKS
					Cu	Zn	Au	Ag	
51.7	99.5								
	Con't								
	- altered zones - blue grey, medium grained distinct blue quartz-eyes								
	from (1) 51.7 to 55								
	(2) 55.5 to 56.1								
	(3) 57.3 to 57.7								
	(4) 68.3 to 80.0								
	These altered zones host the main mineralized zones.								
	At 53.4 ½" carb vein at 75° to C.A., parallel to foliation 20% graphite, 5% Py	9306	52 55	3'	0. 021	0. 003	Tr	.02	
	At 57.4 ½" quartz vein at 50° to C.A., parallel to foliation chloritic, 10% sulphides								
	At 60.2 ½" carb-chlorite zone at 80° to C.A., parallel to foliation 20% sulphides	9307	55 60	5'	0. 060	0. 003	Tr	Tr	
	At 61.5 ½" carb-chlorite zone at 70° to C.A., parallel to foliation 10% sulphides	9308	60 65	5'	0. 017	0. 002	Tr	Tr	
	At 66.5 ½" quartz zone at 65° to C.A., perpendicular to foliation very irregular, 5% sulphides	9309	65 68	3'	0. 016	0. 003	Tr	Tr	
	At 67.0 ½" Quartz vein at 80° to C.A., perpendicular to foliation barren								
	At 68.7 ½"-¾" quartz vein at 65° to C.A., parallel to foliation 30-40% Py, Po	9310	68 70	2'	0. 26	0. 004	Tr	.05	
LOGGED BY: J. Der Weduwen DATE: Nov. 1979 PROPERTY: Chester 53 HOLE No. Ches-53-9 PAGE No. 4									

FROM - TO		DESCRIPTION	SAMPLE No.	FROM - TO		SAMPLE LENGTH	ASSAYS				AVERAGES AND REMARKS
							Cu	Zn	Au	Ag	
51.7	99.5	Con't									
		At 69.8 ½" quartz vein at 65° to C.A., parallel to foliation, 20% sulphides	9311	70	75	5'	0. 29	0. 007	.005	.09	
		At 71.8 ½" quartz vein at 70° to C.A., parallel to foliation chloritic, 30% sulphides									
		At 73.5 ½" quartz vein at 35° to C.A., parallel to foliation 10% sulphides	9312	75	80	5'	0. 48	0. 014	.01	.13	
		At 82.3 ¼-½" quartz carbonate vein at 55° to C.C., perpendicular to foliation - minor sulphides									
		At 82.9 ¼" quartz-carbonate vein at 50° to C.A., parallel to foliation chloritic	9313	80	85	5'	0. 030	0. 002	Tr	Tr	
		At 91.7 1½" quartz vein at 70° to C.A., parallel to foliation minor sulphides	9314	85	89	4'	0. 017	0. 002	Tr	.02	
			9315	89	91	2'	0. 013	0. 002	Tr	Tr	
			9316	91	92	1"	0. 005	0. 002	Tr	Tr	
			9317	92	95	3'	0. 005	0. 002	Tr	Tr	
	99.5	END OF HOLE	9318	95	99.5	4.5'	0. 006	0. 002	Tr	Tr	

LOGGED BY: *J. Der Weduwen* DATE: Nov. 1979

PROPERTY Chester 53

HOLE No. Ches-53 - PAGE No. 5