



Ministry of  
Northern Development  
and Mines

Ministère du  
Développement du Nord  
et des Mines

**Diamond Journal de  
Drilling forage au  
Log diamant**

Complete this form and  
related sketch in duplicate.  
Remplir en deux exemplaires la  
présente formule et le croquis annexé

Fill in on every page  
Remplir ces cases à  
chaque page

Note No. Forage n°	Page No. Page n°
NV-02-07A	1

Drilling Company Compagnie de forage <b>RonKor Diamond Drilling Ltd.</b>		Collar Elevation Élévation du collier <b>397.5 m</b>	Bearing of hole from true North/Position du forage par rapport au nord vrai <b>240 deg. Az</b>	Total Footage Avancement total du forage <b>750 ft</b>	Dip of Hole at Inclinaison du forage au Collar/collier <b>- 45</b>	Address/Location where core stored Adresse/l'endroit où la carotte est stockée <b>Klondike Lodge (Northville Gold Corp. Core Shack Facilities) Chester Township</b>	Map Reference No. N° de référence sur la carte <b>NTS 41P/12SW</b>	Claim No. N° de concession ministre <b>PATENT - S19971 G-60-00249</b>
Date Hole Started Date de commencement du forage <b>Aug 1, 2002</b>	Date Completed Date d'achèvement <b>Aug 3, 2002</b>	Date Logged Date d'inscription au journal <b>Oct 7, 2002</b>	Logged by Inscrit par <b>Dr. Peter Fischer</b>		F./P.		Location (Twp, Lot, Con. or Lat. and Long.) Emplacement (town, lot, concession, ou latitude et longitude) <b>430595 E 5267094 N UTM Zone 17 NAD83</b>	
Exploration Co., Owner or Optionee Compagnie d'exploration, propriétaire ou titulaire d'option <b>Northville Gold. Corp.</b>		Date Submitted Date de dépôt <b>Oct 24, 2002</b>	Submitted by (Signature) Déposé par (signature) <b>JOHN R BOISSONEAULT</b> <i>John R Boissoneault</i>		F./P.			
					F./P.			Property Name Nom de la propriété

FROM	TO	LITHOLOGY	DESCRIPTION	STRUCTURE	COMMENTS
0	5	Overburden			
5	387.7	Granodiorite (Quartz Feldspar porphyry with 10% greisen)			
387.7	405	Greisen (Quartz porphyry)			
405	564	Granodiorite (Feldspar porphyry) minor greenstone, greisen			
564	618	Diorite			
618	705	Granodiorite (Feldspar porphyry) with diorite, minor greisen			
705	750	Diorite			EOH at 750.0 feet

2002-10-24



41P12SW2011 2.24387

CHESTER

010

**Diamond Drill Hole Locations-NV-02-07 & 07A**  
**Surface Plan**  
**Chester Township**  
**Northville Gold Corp.**

October 2002  
 1:5,000  
 NAD83 - UTM Zone 17

0 0.1 0.2  
 Kilometers

5267500  
 5267000

5267500  
 5267000

Cote  
 Lake

1213793

Cote

Lake

S19971

S20

**NV-02-07**  
 -50 degrees  
 330 degrees Az  
 EOH - 400 feet

**NV-02-07A**  
 -45 degrees  
 240 degrees Az  
 EOH - 750 feet



186  
 397

1213796

430000

430500

431000

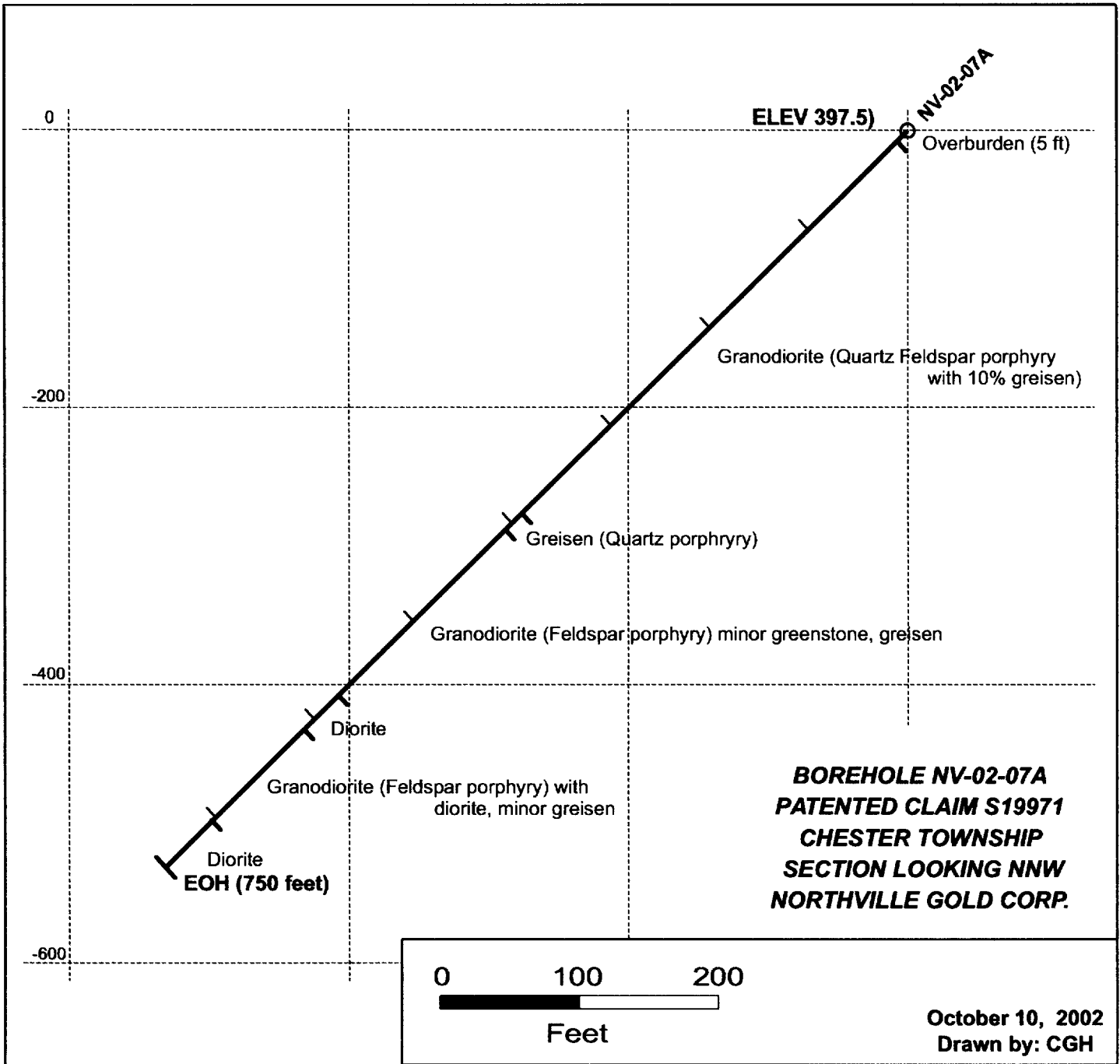

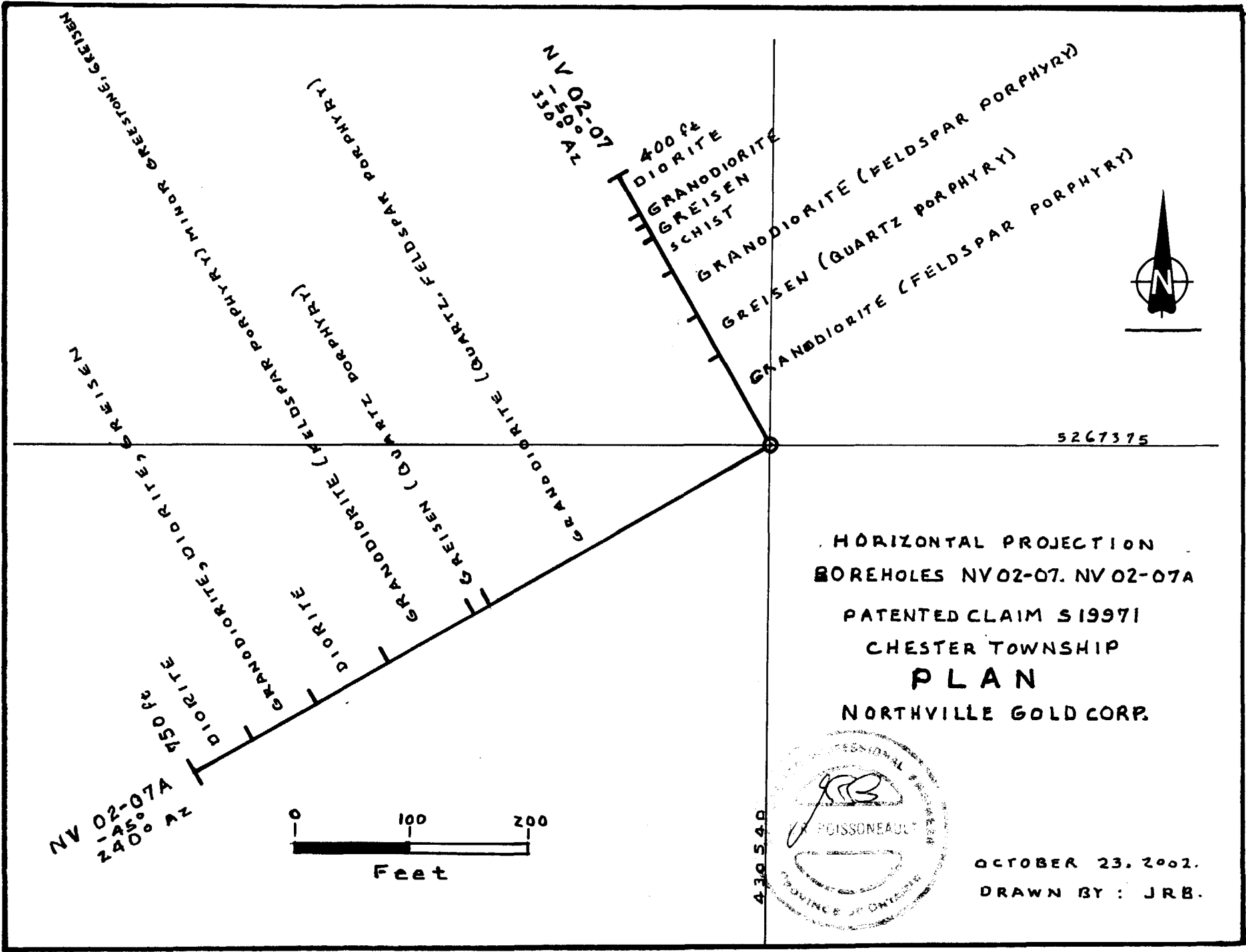

HORIZONTAL PROJECTION  
 BOREHOLES NV 02-07, NV 02-07A  
 PATENTED CLAIM S19971  
 CHESTER TOWNSHIP  
**PLAN**  
 NORTHVILLE GOLD CORP.

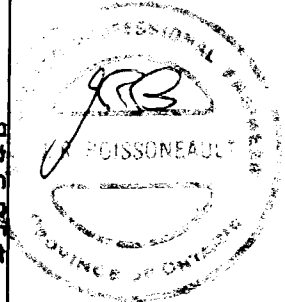

OCTOBER 23, 2002.  
 DRAWN BY : JRB.



Ministry of  
Northern Development  
and Mines

Ministère du  
Développement du Nord  
et des Mines

**Diamond Journal de  
Drilling forage au  
Log forage au  
diamant**

Complete this form and  
related sketch in duplicate.  
Remplir en deux exemplaires la  
présente formule et le croquis annexé

Fill in on every page  
Remplir ces cases à  
chaque page

Hole No. Forage n°	Page No. Page n°
NV-02-07	1

Drilling Company Compagnie de forage <b>RonKor Diamond Drilling Ltd.</b>		Collar Elevation Élévation du collier <b>397.5 m</b>	Bearing of hole from true North/Position du forage par rapport au nord vrai <b>330 deg. Az</b>	Total Footage Avancement total du forage <b>400 ft</b>	Dip of Hole at Inclinaison du forage au Collar/collier <b>-50</b>	Address/Location where core stored Adresse/endroit où la carotte est stockée <b>Klondike Lodge (Northville Gold Corp. Core Shack Facilities) Chester Township</b>	Map Reference No. N° de référence sur la carte <b>NTS 41P/12SW</b>	Claim No. N° de concession minière <b>PATENT - S19971 G-60-00249</b>
Date Hole Started Date de commencement du forage <b>July 30, 2002</b>	Date Completed Date d'achèvement <b>July 31, 2002</b>	Date Logged Date d'inscription au journal <b>Sept 10, 2002</b>	Logged by Inscrit par <b>Dr. Peter Fischer</b>		FL/PI		Location (Twp, Lot, Con. or Lat. and Long.) Emplacement (canton, lot, concession, ou latitude et longitude) <b>430595 E 5267094 N UTM Zone 17 NAD83</b>	Property Name Nom de la propriété
Exploration Co., Owner or Optionee Compagnie d'exploration, propriétaire ou titulaire d'option <b>Northville Gold. Corp.</b>		Date Submitted Date de dépôt <b>Oct 24, 2002</b>	Submitted by (Signature) Déposé par (signature) <b>JOHN R. BOISSONEAU John R Boissoneau</b>		FL/PI			
					FL/PI			

FROM	TO	LITHOLOGY	DESCRIPTION	STRUCTURE	COMMENTS
0	6	Overburden			
6	134.8	Granodiorite (Feldspar porphyry)			
134.8	189.3	Greisen (Quartz porphyry)			
189.3	252.5	Granodiorite (Feldspar porphyry)			
252.5	307.5	Schist			
307.5	318.5	Greisen (Quartz porphyry)			
318.5	352	Granodiorite (Feldspar porphyry)			
352	400	Diorite			EOH at 400.0 feet

10 09 07

JRS



430000

430500

431000

**Northville Gold Corp.**

**Diamond Drill Hole Locations-NV-02-07 & 07A**  
**Chester Township**

October 2002  
 1:5,000  
 NAD83 - UTM Zone 17

5267500

5267500

Cote  
Lake  
**1213793**

Cote

**S19971**

**S20**

Lake

**NV-02-07**

-50 degrees  
330 degrees Az  
400 feet

**NV-02-07A**

-45 degrees  
240 degrees Az  
750 feet

5267000

5267000

17

24387



**1213796**

430000

430500

431000

2 243 87

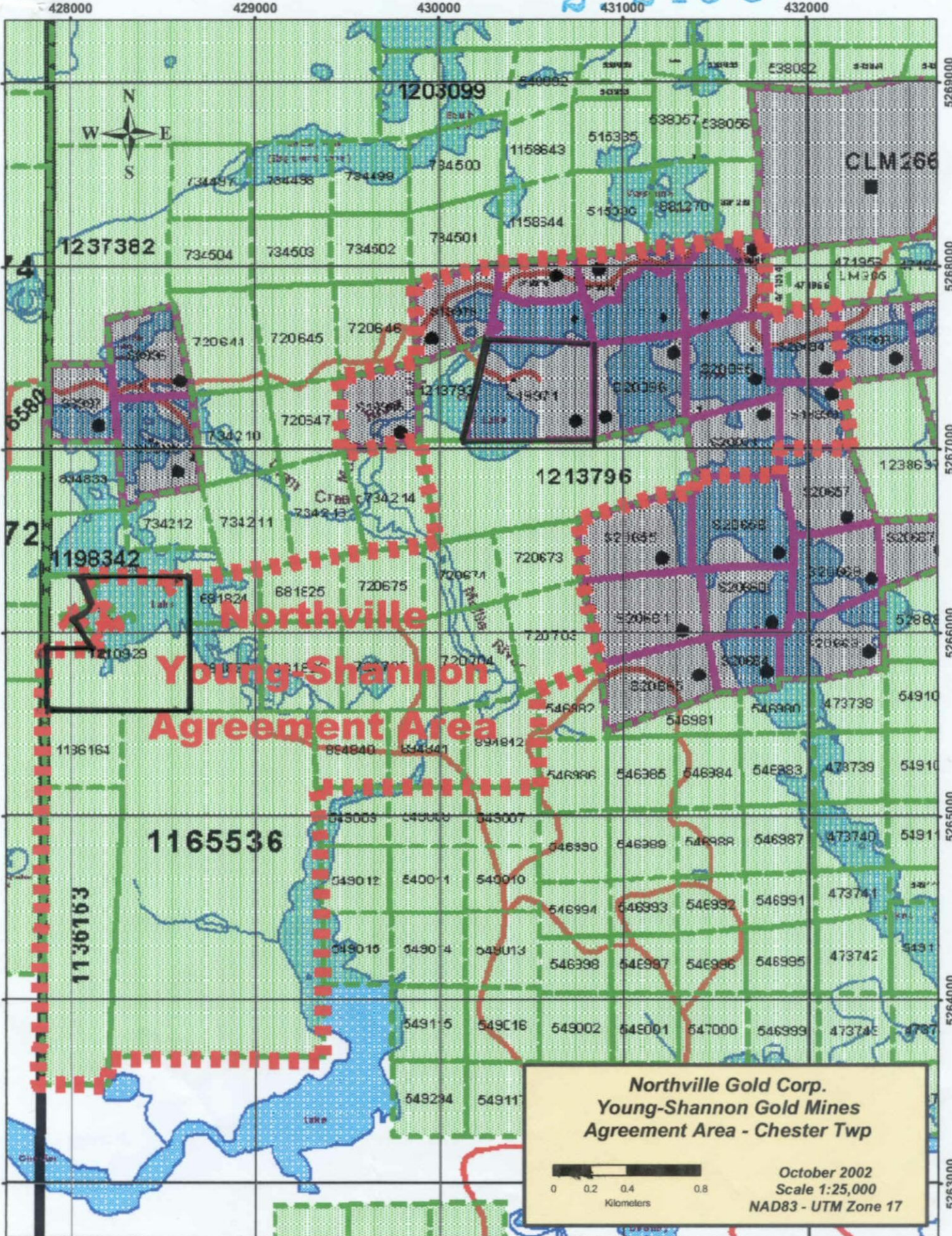

**Northville**  
**Young-Shannon**  
**Agreement Area**

**Northville Gold Corp.**  
**Young-Shannon Gold Mines**  
**Agreement Area - Chester Twp**

0 0.2 0.4 0.8  
 Kilometers

October 2002  
 Scale 1:25,000  
 NAD83 - UTM Zone 17

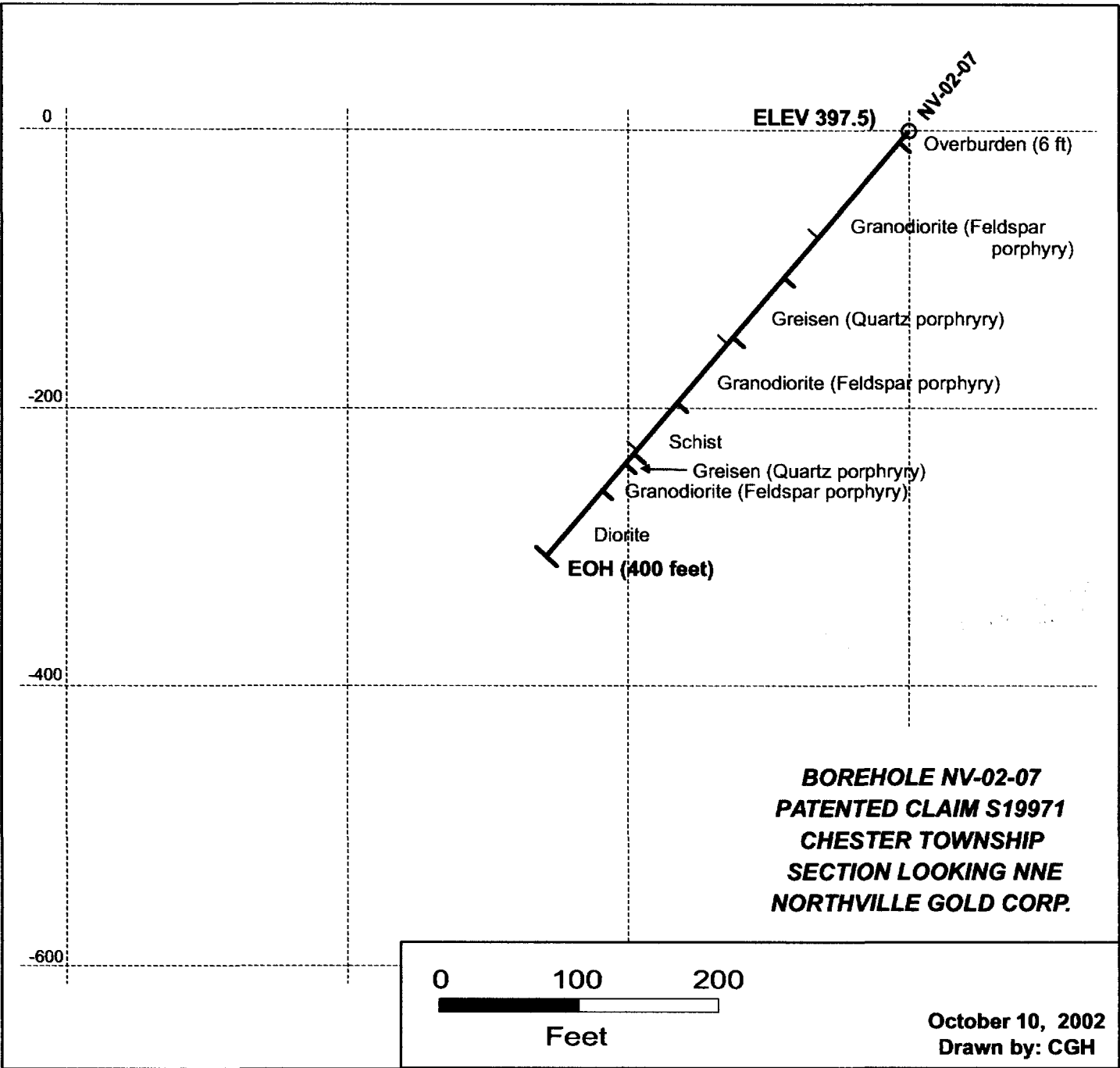

*Handwritten signature: JRS*

*Faint circular stamp:*  
 NORTHVILLE GOLD CORP.  
 CHESTER TOWNSHIP  
 SECTION





Date: 2002-OCT-29

GEOSCIENCE ASSESSMENT OFFICE  
933 RAMSEY LAKE ROAD, 6th FLOOR  
SUDBURY, ONTARIO  
P3E 6B5

YOUNG-SHANNON GOLD MINES, LIMITED  
106 FIELDING ROAD  
LIVELY, ONTARIO  
P3Y 1L5 CANADA

Tel: (888) 415-9845  
Fax: (877) 670-1555

**Submission Number:** 2.24387  
**Transaction Number(s):** W0260.01616

Dear Sir or Madam

**Subject: Approval of Assessment Work**

We have approved your Assessment Work Submission with the above noted Transaction Number(s). The attached Work Report Summary indicates the results of the approval.

At the discretion of the Ministry, the assessment work performed on the mining lands noted in this work report may be subject to inspection and/or investigation at any time.

If you have any question regarding this correspondence, please contact STEVEN BENETEAU by email at [steve.beneteau@ndm.gov.on.ca](mailto:steve.beneteau@ndm.gov.on.ca) or by phone at (705) 670-5855.

Yours Sincerely,



Ron Gashinski  
Senior Manager, Mining Lands Section

**Cc:** Resident Geologist

Young-Shannon Gold Mines, Limited  
(Claim Holder)

Assessment File Library

Young-Shannon Gold Mines, Limited  
(Assessment Office)



MINISTRY OF  
NORTHERN DEVELOPMENT  
AND MINES  
PROVINCIAL MINING  
RECORDERS OFFICE

**MINING LAND TENURE  
MAP**

Date / Time of Issue Oct 21 2002 08:40h Eastern

TOWNSHIP / AREA PLAN

CHESTER G-3223

**ADMINISTRATIVE DISTRICTS / DIVISIONS**

Mining Division Porcupine  
Land Title/Registry Division SUDBURY  
Ministry of Natural Resources District TIMMINS

**TOPOGRAPHIC**

- Administrative Boundary
- Contour
- Concession Lot
- Provisional Part
- Water Feature
- City/Town Boundary
- Control
- Control - (Special Admin. 2-10-1997)
- Shed
- Fire Hydrant
- Roadway
- Road
- Trail
- Natural Gas Pipeline
- Utility Line
- Communication Line
- Wooded Area
- Man-made - Cultural/Historical Note - Cairn

**LAND TENURE**

- Framework Patent
  - Surface and Mining Rights
  - Surface Rights Only
  - Mining Rights Only
- Leasehold Patent
  - Surface and Mining Rights
  - Surface Rights Only
  - Mining Rights Only
- Litigation of Occupancy
  - Not Satisfied
  - Surface and Mining Rights
  - Surface Rights Only
  - Mining Rights Only

- Land Use Permit
- Open Pit Control
- Water Power Lease Approval
- Mining Claims

**LAND TENURE WITHDRAWALS**

- Areas Withdrawn From Disposition
  - Mining Act Withdrawal Types
    - Surface and Mining Rights Withdrawal
    - Surface Rights Only Withdrawal
    - Mining Rights Only Withdrawal
  - Order In Course Withdrawal Types
    - Surface and Mining Rights Withdrawal
    - Surface Rights Only Withdrawal
    - Mining Rights Only Withdrawal

**IMPORTANT NOTICES**



**LAND TENURE WITHDRAWAL DESCRIPTIONS**

Mineral	Type	Date	Description
6454	Wm	Aug 1 2001	FLOODING TO CONTOUR 180 FEET RESERVED TO DARTMOUTH HYDRO LOCATION HYSL L.O.7945 FILE 18821
W760	Wm	Aug 24 1998	NEW ADJUDICATIONS AND (MATH) DISPOSAL (S14)
W47-760	Wm	Oct 19 1998	SURFACE AND MINING RIGHTS WITHDRAWN FROM STAMING UNDER SEC 108 OF THE MINING ACT A.S.O. 1998 ORDER W47-760 BN DATED OCT. 19/1998
W770C	Wm	Feb 19 1992	SURFACE RIGHTS ONLY WITHDRAWN UNDER 103 OF THE MINING ACT A.S.O. 1978 ORDER W47-770C DATED FEB. 19/1992

**IMPORTANT NOTICES**

Areas under which a special regulatory regime or conditions apply that affect mineral prospecting, mining and/or development activities.

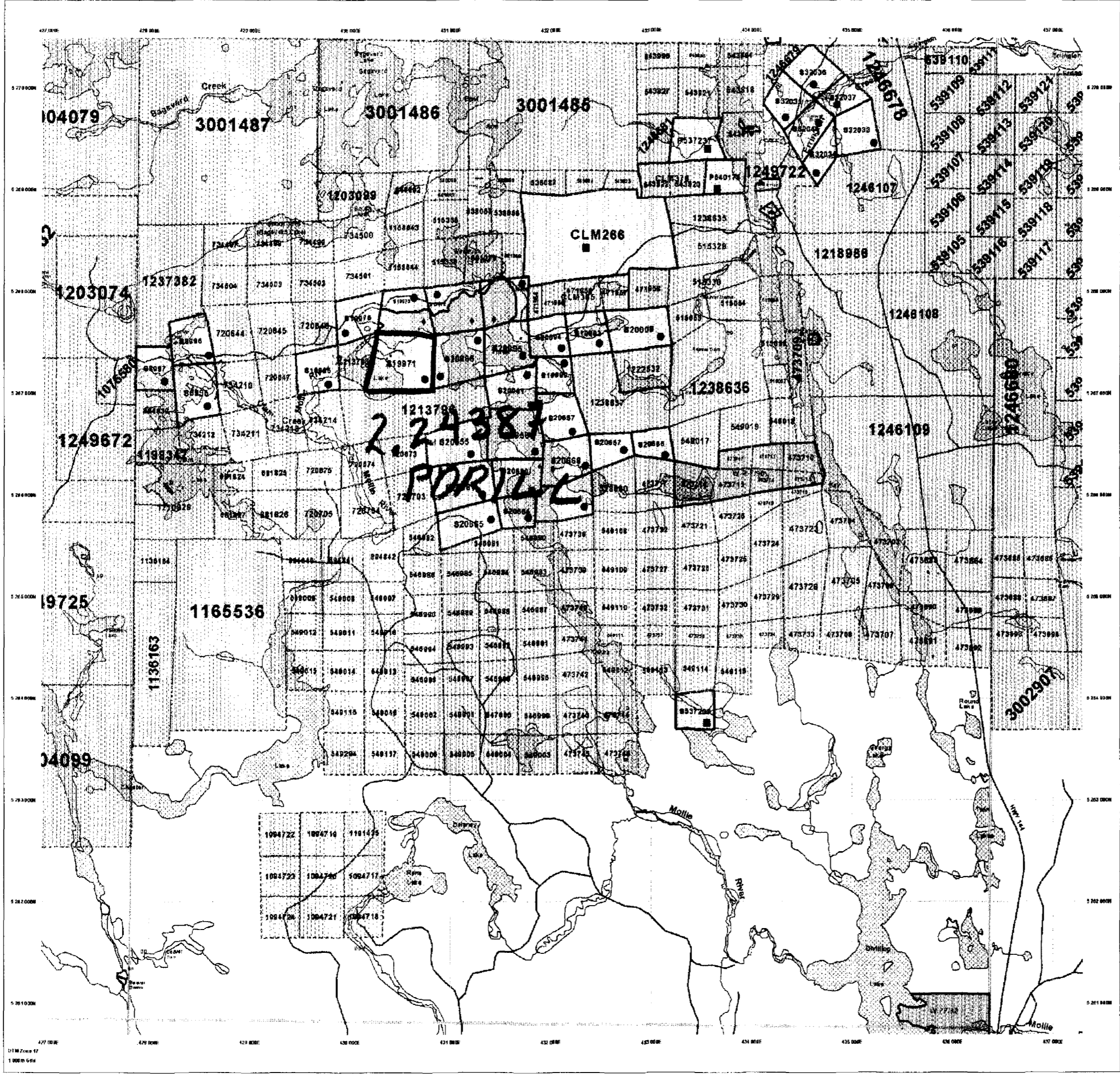

41P125W2011 2.24387 CHESTER 200

Those wishing to make mining claims should consult with the Provincial Mining Records Office of the Ministry of Northern Development and Mines for additional information on the status of the lands shown herein. This map is not intended for navigation, survey, or land title determination purposes and the information on this map is compiled from various sources. Completeness and accuracy are not guaranteed. Additional information may be obtained through the Social and Title of Registry Office, or the Ministry of Natural Resources. The information shown is derived from digital data available to the Provincial Mining Records Office as a result of downloading from the Ministry of Northern Development and Mines web site.

**General Information and Limitations**  
 Contact Information:  
 Provincial Mining Records Office  
 633 Highway 124, Sudbury, ON P3B 5B5  
 Tel: 1 (800) 415-8848  
 Fax: 1 (807) 673-1444  
 Home Page: www.mdm.gov.on.ca/MNDM/MINE/SLANDS/SLANDS.htm

This map may not show all registered land uses and is not intended to be used for any other purpose. It is not a warranty, representation, or guarantee of any kind. The Province of Ontario is not responsible for any errors or omissions in this map. The Province of Ontario is not responsible for any damages or losses resulting from the use of this map. The Province of Ontario is not responsible for any claims or liabilities arising from the use of this map. The Province of Ontario is not responsible for any claims or liabilities arising from the use of this map.