

Hole No.	Claim No.	Location	Company	Azimuth	Dip	Depth
YS-04.01	20096	Chester Twp.	Young-Shannon Gold Mines, Limited	335°	-50°	700.0'

Footage		Description	Sample No.	Footage		Smple Length	Assay				
From	To			From	To		Au(g/t)	Au(g/t)			
0.0	5.0	Casing	23402	42.0	45.0	3.0	0.27				
5.0	324.7	Trondhemites (Tron)	403	58.0	61.5	3.5	0.27				
		Grey-green, fine grained with white quartz	404	78.0	81.0	3.0	5.76*	5.21			
		Veins at low angles to the core axis containing	405	81.0	84.5	3.5	0.35				
		disseminated pyrite + chalcopryrite. At 55.2' and 79.7'	406	88.0	92.0	4.0	0.11				
		2-3" py-cpy quartz vein and disseminated sulfides	407	96.5	99.5	3.0	0.17				
		Alternating fine grained and mottled medium grained	408	99.5	103.5	4.0	0.29				
		Trondhemites from 80.0' onwards	409	113.0	115.0	2.0	0.49				
			410	115.0	119.0	4.0	0.46				
		From 195.0'-195.5' green, fine grained Diorite - core is blocky	411	150.0	153.0	3.0	0.16				
		From 200.0' - 209.0' weathered, pale green Tron.	412	153.0	156.5	3.5	.69				
		with disseminated pyrite + cpy + quartz veins	413	165.5	169.5	4.0	1.00	0.98			
		Blocky core stops at 230.0'. From 260.0'-260.7'	414	169.5	172.0	2.5	0.33				
		an 8" quartz vein containing py-cpy	415	172.0	175.0	3.0	0.13				
		Grey-green Tron. from 235.0' onwards. Sharp out contact	416	185.0	189.0	4.0	0.23				
			417	189.0	192.5	3.5	0.44				
324.7	596.5	Fine grained, blocky Diorite.	418	202.0	205.0	3.0	0.20				
		Dark green in colour with irregular Tron. fragments	419	205.0	207.0	2.0	0.35				
		Ending at 353.8'. From 373.5' calcite veins	420	207.0	210.0	3.0	0.31				
		- barren.	421	229.0	232.0	3.0	0.01				
		From 409.0' - 414.3' quartz veins with pyrite and calcite + py.	422	232.0	235.0	3.0	0.46				
		Diorite continues with feldpathized patches and barren quartz	423	258.5	261.5	3.0	0.28				
		Veins at 451.0' - 457.0', 427.7' - 473.1' and 478.8' - 479.1'	424	296.0	299.0	3.0	0.10				
			425	299.0	301.0	2.0	0.18				
		By 555.5' cove becomes blocky with numerous shear zones.	426	372.0	375.5	3.0	0.16				
		At 596.5' sharp out contact.	427	408.0	411.0	3.0	0.02				
			428	411.0	413.6	2.6	0.75	0.96			



Hole No.	Claim No.	Location	Company	Azimuth	Dip	Depth
YS-04.01	20096	Chester Twp.	Young-Shannon Gold Mines, Limited	335°	-50°	700.0'

Footage		Description	Sample No.	Footage		Smple Length	Assay				
From	To			From	To		Au(g/t)				
596.5	700.0	Trondhemite	429	451.0	454.0	3.0	0.12				
		Fractured with minor disseminated py ± cpy and narrow veins	430	454.0	458.0	5.0	0.66				
			431	472.5	475.0	2.5	0.07				
		From 698.6'-700.0' quartz vein with py-cpy.	432	475.0	480.0	5.0	0.06				
			433	698.0	700.0	2.0	0.15				
		End of hole at 700.0'									

*V. Hill P. Eng.*  
July 28, 09

Hole No.	Claim No.	Location	Company	Azimuth	Dip	Depth
YS-04.02	20096	Chester Twp.	Young-Shannon Gold Mines, Limited	335°	-70°	785.0'

Footage		Description	Sample No.	Footage		Sample Length	Assay				
From	To			From	To		Au(g/t)	Au(g/t)	Au(g/t)	Au(g/t)	av.
0.0	5.0	Casing	23 434	5.0	8.0	3.0	1.03				
5.0	450.1	Trondhjemite	435	8.0	10.5	2.5	0.61				
		Grey-green, fine grained, surgary with a few quartz veins, quartz flooding and disseminated pyrite and quartz eyes.	436	37.0	40.5	3.5	0.80				
			437	40.5	44.5	4.0	0.72				
		From 60.5'-65.8' series of rusty quartz veins (weathering).	438	60.5	62.5	2.0	2.06*				
		best vein is 3"+ wide at 61.2' with cpy. This rock unit continues	439	62.5	66.0	3.5	0.09				
		Through 150' with fine grained Tron + a few narrow quartz	440	88.0	91.0	3.0	0.60				
		+ py + cpy and disseminated py + cpy in rock.	441	91.0	94.0	3.0	1.23	1.10			
		At 120.7' a 2" cpy-py vein with visible gold.	442	94.0	96.0	2.0	0.38				
			443	99.5	102.0	2.5	3.84				
			444	112.5	115.0	2.5	0.50*				
		Tron. is well mineralized with 1-3" wide quartz veins + py+ cpy and quartz eyes. At 243.7' sharp contact with fine grained	445	120.0	122.0	2.0	155.59*	152.92	119.18	87.09	(128.70)
		Diorite unit – well sheared and ending at 255.0'.	446	122.0	124.0	2.0	6.93				
			447	140.0	142.0	2.0	0.60				
		Back into fine grained, quartz eyed Tron.	448	148.5	152.0	3.5	0.40				
		At 275.7' a 3" cpy quartz vein. Lots of py + cpy mineralization	449	155.0	158.0	3.0	0.69				
		disseminated in Tron. through 278.0' to 450.0'	450	158.0	162.0	4.0	0.60				
		Some well mineralized sections but very few veins except at	451	174.0	177.0	3.0	0.22				
		356.0' a 5" quartz vein with py-cpy.	452	177.0	180.5	3.5	0.10				
		Unit is siliceous at bottom.	453	180.5	182.5	2.0	2.09	1.99			
			454	182.5	185.0	2.5	0.61				
			455	185.0	187.5	2.5	0.58				

2.28188  
W0460.01201





Hole No.	Claim No.	Location	Company	Azimuth	Dip	Depth
YS-04.02	20096	Chester Twp.	Young-Shannon Gold Mines, Limited	335°	-70°	785.0'

Footage		Description	Sample No.	Footage		Sample Length	Assay			
From	To			From	To		Au(g/t)	Au(g/t)	Au(g/t)	av. Au(g/t)
			23478	355.0	359.0	4.0	1.53			(0.95)
			479	363.5	365.0	1.5	13.37	8.91	12.93	(11.74)
			480	365.0	368.0	3.0	1.30			
			481	368.0	371.5	3.5	0.11			
			482	371.5	375.0	3.5	0.14			
			483	375.0	377.5	2.5	0.37			
			484	378.0	380.0	2.0	0.32			
			485	380.0	382.5	2.5	0.28			
			486	420.0	422.0	2.0	4.46	5.49		(4.98)
			487	424.0	427.0	3.0	1.92			
			488	439.0	441.5	2.5	1.71			
			489	453.0	455.0	2.0	4.77			
			490	455.0	459.0	4.0	0.20			
			491	469.0	462.0	3.0	0.39			
			492	462.0	465.0	3.0	0.17			
			493	465.0	467.5	2.5	1.69			
			494	467.6	470.0	2.5	0.11			
			495	470.0	472.5	2.5	0.05			
			496	472.5	475.0	2.5	0.09			
			497	475.0	479.0	4.0	0.01			
			498	479.0	482.0	3.0	0.56			
			499	482.5	485.0	2.5	1.35			
			500	485.0	487.0	2.0	0.08			
			28121	537.0	540.0	3.0	Nil			
			23122	540.0	543.0	3.0	Nil			
			123	613.0	616.0	3.0	0.15			
			124	763.0	765.0	2.0	10.97			
			125	765.0	768.0	3.0	6.31			
			126	768.0	771.0	3.0	4.29			
			127	771.0	775.0	4.0	0.83			
			128	775.0	779.0	4.0	1.14			
			129	779.0	783.0	4.0	0.67			

*Handwritten signature*  
July 20/09

Hole No.	Claim No.	Location	Company	Azimuth	Dip	Depth
YS-04.03	20096	Chester Twp.	Young-Shannon Gold Mines, Limited	000°	-80°	1285.0'

Footage		Description	Sample No.	Footage		Smple Length	Assay				
From	To			From	To		Au(g/t)				
0.0	5.5	Casing	23251	190.8	194.2	3.4	0.01				
5.5	870.0	Trondhjemite	252	194.2	197.0	2.8	0.03				
		Green, fine grained, siliceous unit with blue quartz eyes.	253	197.0	200.2	3.2	0.14				
		Minor quartz veins 1-2" wide at 25.0', 27.0', 48.4', 58.0',	254	200.2	202.0	1.8	6.48				
		69.5', 84.2' and 118.7'	255	260.0	261.0	1.0	0.02*				
		Most contain py ± cpy	256	337.0	339.2	2.2	2.42*				
			257	339.0	341.8	2.6	0.02				
			258	341.8	344.5	2.7	0.04				
		More minor quartz veins at 210.0'	259	344.5	347.0	2.5	Nil				
		From 240.7'-259.8' minor Diorite unit followed by a 6" quartz	260	348.5	351.5	3.5	1.48				
		vein with chlorite and hornblende.	261	407.7	410.8	3.1	0.04				
		From 259.8'-285' darker colour mottled Tron.	262	436.8	439.7	2.9	0.33				
			263	439.7	443.5	3.8	0.01				
		From 350.0' – 383.0' dark Tron.	264	459.0	461.5	1.5	1.8*				
		From 383.0' onwards – siliceous Tron. with minor quartz veins,	265	461.5	464.0	2.5	0.07				
		eg. 2" at 407.7' and 459.0' – 460.5'- py+cpy and carbonates plus	266	464.0	465.8	1.8	0.04				
		molybdenite.	267	465.8	469.0	3.2	1.20				
		By 492.5' change into darker, softer Tron. which continues	268	504.5	508.5	4.0	0.53				
		to 596.0'. Diorite filled shear at 558.0' and at 561.0' at 30° to	269	621.8	625.0	3.2	2.33*				
		core axis.	270	625.0	627.0	2.0	0.74				
		Minor quartz veins at 623.0', 630.5' 695.7' and 645.0' – 647.0'	271	670.0	673.0	3.0	0.06				
		fractures with Mo	272	673.0	677.0	4.0	0.06				
870.0	927.0	Diorite	273	765.5	770.5	5.0	0.07				
		Dark green, sheared rock unit with trace to 3% py	274	870.0	875.0	5.0	1.56				
		disseminations. Begins with brecciated Tron. fragments and	275	875.0	880.0	5.0	0.14				
		silicified patches. Rock has a texture parallel to 40°	276	880.0	883.0	3.0	0.31				
		to core axis from 887.0' - 896.0' shear zone. Out contact is sheared.	277	895.0	897.7	2.7	6.22*				



Hole No.	Claim No.	Location	Company	Azimuth	Dip	Depth
YS-04.03	20096	Chester Twp.	Young-Shannon Gold Mines, Limited	000°	-80°	1285.0'

Footage		Description	Sample No.	Footage		Smple Length	Assay					
From	To			From	To		Au(g/t)	Au(g/t)				
			23278	897.7	897.7	1.5	0.13*					
927.0	1004.3	Trondhjemite	279	899.2	899.2	3.2	0.32					
		Silicified and fine – grained with quartz eyes.	280	918.0	924.0	6.0	0.22					
		From 999.0' – 1004.3' sheared zone.	281	953.0	955.0	2.0	1.00					
1004.3	1020.0	Diorite	282	976.0	978.0	2.0	2.19	2.08				
		Fine – grained and green. Sheared at end and back into	283	1105.0	1109.0	4.0	0.23					
		herd fine – grained rock.	284	1109.0	1112.0	3.0	0.71					
1020.0	1285.0	Trondhjemite	285	1152.0	1155.0	3.0	0.24					
		Siliceous with shear zones. Fine – grained and many	286	1164.5	1167.0	2.5	0.07					
		Quartz eyes.	287	1216.0	1218.5	2.5	0.29					
		At 1197.0' a shear zone at 50° to core axis.	288	1218.5	1221.0	2.5	0.19					
		From 1216.0' – 1253.6' siliceous Tron with 1-2% py ± cpy	289	1225.0	1230.0	5.0	0.19					
		From 1253.6' – 1278.8' Sharp contact into feldpotherized	290	1230.0	1233.0	3.0	0.13					
		Hermotized Tron.	291	1250.0	1254.0	4.0	0.36					
		From 1278.8' – 1285.0' siliceous, fine – grained, quartz										
		eyed Tron										
		END of Hole at 1285.0'										

*J. Paul P. Eng.*  
 July 20/04

Hole No.	Claim No.	Location	Company	Azimuth	Dip	Depth
Ys-04.04	20096	Chester Twp.	Young-Shannon Gold Mines, Limited	020°	-80°	850.0'

Footage		Description	Sample No.	Footage		Smple Length	Assay				
From	To			From	To		Au(g/t)	Au(g/t)			
0.0	5.0	Casing	23292	47.0	52.0	5.0	0.18				
5.0	850.0	Trondhjemite	293	52.0	55.0	3.0	0.01				
		Siliceous, fine – grained unit with round quartz eyes and	294	190.0	194.0	4.0	Nil				
		irregular quartz veins. 2" vein at 14.0' with cpy –py -	295	200.0	204.0	4.0	3.15				
		vuggy, 19.0' – 2" massive py – cpy, ½ inch quartz vein at	296	193.5	198.0	4.5	Nil				
		33.0'. Again at 36.2' a ½ inch quartz vein. Tron. contains	297	198.0	203.0	5.0	2.41				
		to 1% disseminated pyrite and blue quartz eyes. At 62.5'	298	241.5	245.5	4.0	0.09				
		and 79.5' – 1" quartz veins with py+cpy.	299	245.5	247.5	2.0	0.18				
		At 86.8' – 1/2 " pyrrhotite – cpy – specularite vein and	300	260.0	267.0	7.0	0.05				
		Again at 100.6' and 124.8'. All contain cpy-py+mo.	301	322.0	325.0	3.0	0.12				
		From 157.0' – 158.5' fracture filled with blocky core.	302	335.5	339.5	4.0	0.39				
		From 161.0', 76.0', 190.0' and 200.5' quartz veins with	303	383.0	386.0	3.0	0.03				
		sulfides and tourmaline. At 222.5' a small mineralized	304	386.0	388.5	2.5	0.02				
		quartz vein.	305	388.5	392.5	4.0	0.05				
			306	392.5	396.0	3.5	0.04				
		From 243.1' – 319.0' Dioritic section of fractured rock	307	396.0	401.0	5.0	0.04				
		slightly mineralized with pyrite. The Tron around the	308	401.0	404.5	3.5	0.39				
		Diorite unit is darker and coarser – grained. At 254.8'	309	404.5	407.0	2.5	0.04				
		quartz vein and again at 313.4', 336.0', 340.3', 357.2',	310	407.0	409.5	2.5	0.21				
		366.5' and 375.0' – veins vary from ½" to 3" wide.	311	422.0	425.0	3.0	1.21	1.35			
		Other quartz veins at 383.0', 400.2', 422.0' with py-cpy-	312	519.5	522.0	2.5	0.37				
		specularite and mo. From 445.0' – 446.0' a band of	313	522.0	525.5	3.5	0.09				
		Dioritic rock surrounded by darker Tron. which continues	314	525.0	529.0	3.5	0.56				
		to 581.0'. After 581.0' Tron. is lighter coloured fine -	315	529.0	533.0	4.0	0.08				
		grained and siliceous with 1 – 2% disseminated in a	316	543.0	547.0	4.0	0.31				
		siliceous Tron. by 725.4' back into darker Tron.	317	547.0	549.5	2.5	0.12				
		774.3' – 777.0' siliceous Tron. again with 1 – 2% coarse	318	555.0	560.0	5.0	0.06				





Hole No.	Claim No.	Location	Company	Azimuth	Dip	Depth
Ys-04.04	20096	Chester Twp.	Young-Shannon Gold Mines, Limited	020°	-80°	850.0'

Footage		Description	Sample No.	Footage		Smple Length	Assay				
From	To			From	To		Au(g/t)	Au(g/t)			
		From 774.3' - 777.0' siliceous Tron. again with 1 - 2% coarse pyrite.	23319	566.5	569.5	3.0	0.07				
			320	569.5	573.0	3.5	0.01				
			321	608.5	614.0	5.5	0.05				
			322	617.0	620.0	3.0	0.39				
			323	620.0	622.5	2.5	0.22				
			324	636.5	640.0	3.5	0.04				
			325	646.0	651.5	5.5	0.01				
			326	651.5	653.0	1.5	0.10				
			327	678.0	683.0	5.0	0.01				
			328	687.0	692.0	5.0	Nil				
			329	692.0	699.0	3.0	0.05				
			330	706.0	711.0	5.0	0.06				
			331	745.0	748.0	3.0	0.19				
			332	748.0	751.0	3.0	0.03				
		From 805.0' - 807.0' siliceous with quartz vein	333	805.0	807.5	2.5	7.23	6.69			
		containing py-cpy-mo. At 847.7' is a 2" quartz vein and	334	810.0	812.0	2.0	0.28*				
		Again at 829.2'. From 845.0' - 850.0' a shear with	335	812.0	815.0	3.0	0.23				
		Irregular quartz vein.	336	845.0	850.0	5.0	0.41				
		END of Hole 850.0'									

*F. H. W. P. ENG* July 20/09

Hole No.	Claim No.	Location	Company	Azimuth	Dip	Depth
Ys-04.05	20096	Chester Twp.	Young-Shannon Gold Mines, Limited	040°	-80°	850.0'

Footage		Description	Sample No.	Footage		Smple Length	Assay		
From	To			From	To		Au(g/t)	Au(g/t)	Av. Au(g/t)
0.0	5.0	Casing	23337	381.0	385.0	4.0	0.83		
5.0	850.0	Trondhjemite	338	385.0	388.0	3.0	0.16		
		Green, fine - grained rock with trace to nil sulfides.	339	388.0	392.0	4.0	0.20		
		Massive 1" pyrite band at 33.0' and a 1" quartz vein at 77.8' with py-cpy.	340	392.0	395.0	3.0	26.61	26.74	(26.68)
		At 193.6' is a 2" quartz vein with pyrite, cpy and visible gold.	341	395.0	396.0	1.0	2.71*		
		At 193.6' is a 2" quartz vein with pyrite, cpy and visible gold.	342	455.0	460.0	5.0	0.05		
		At 201.2' another 2" quartz vein with py-cpy.	343	460.0	463.0	3.0	0.05		
			344	482.0	485.0	3.0	0.16		
			345	504.0	509.5	5.5	0.10		
		From 234.3' - 259.0' Dioritic unit with sheared contacts	346	520.0	524.0	4.0	0.57		
		And a barren 4" quartz vein at the upper contact.	347	530.0	535.5	5.5	0.11		
		From 259.0' - 308.0' chloritic Tron. possibly from assimilated Dorite.	348	542.0	546.5	4.5	0.05		
			349	560.0	564.0	4.0	0.10		
		After 323.0', 366.5' and 367.5' narrow quartz - py-cpy+mo vein.	350	564.0	567.5	3.5	0.13		
			351	573.5	567.5	3.0	0.12		
		From 392.0' - 392.7' is a quartz vein with py-cpy and lots Of visible gold followed by siliceous variety of Tron with quartz eyes and trace to 2% pyrite ±cpy.	352	576.5	580.5	4.0	0.28		
			353	605.0	609.0	4.0	0.21		
			354	627.0	632.0	5.0	0.09		
		From 457.5' - 460.0' siliceous breccia zone minor quartz veins. This continues unchanged for several hundred feet with only minor veining.	355	632.0	637.0	5.0	0.03		
			356	665.0	670.0	5.0	0.10		
			357	699.0	703.0	4.0	0.06		
		At 683.5' Dioritic zone with significant shearing.	358	703.0	705.0	2.0	0.22		
		At 698.5' a 10" quartz vein with cpy-py-mo	359	736.0	739.5	3.5	0.21		
		From 762.3' - 768.1' sheared Diorite.	360	739.5	749.0	5.5	0.09		
			361	743.0	747.0	4.0	0.03		
			362	747.0	752.0	5.0	0.25		
			363	766.0	768.0	2.0	0.05		
			364	771.0	774.0	3.0	0.41		
			365	778.0	781.0	3.0	0.57	0.49	
			366	781.0	788.0	7.0	0.22		
			367	793.0	795.0	2.0	0.15		
			368	823.0	828.0	5.0	0.02		
		END of hole at 850.0'	369	828.0	831.0	3.0	0.21		



41P12SW2016 2.28188

CHESTER

050

*Robert P. Eng.*  
July 20/04

Hole No.	Claim No.	Location	Company	Azimuth	Dip	Depth
Ys-04.06	20096	Chester Twp.	Young-Shannon Gold Mines, Limited	335°	-55°	650.0'

Footage		Description	Sample No.	Footage		Smple Length	Assay			Av.
From	To			From	To		Au(g/t)	Au(g/t)		Au(g/t)
0.0	5.0	Casing	23370	149.0	152.0	3.0	0.01			
5.0	349.7	Trondhjemite	371	152.0	156.0	4.0	0.23			
		Grey, mottled medium – grained and soft with several	372	266.8	269.3	2.5	0.13			
		mineralized quartz veins up to 1.5' wide with cpy-py+mo	373	287.5	290.5	3.0	0.46			
		at 17.5', 25.8' and 56.6' at 90° to 50° to core axis.	374	290.5	294.5	4.0	0.07			
		At 66.5' change into grey to green Diorite with minor	375	294.5	297.5	3.0	0.09			
		Quartz veins with cpy-py. Diorite ends at 83.1' followed	376	297.5	300.5	3.0	0.37			
		by mottled, medium - grained darker Tron.	377	300.5	304.0	3.5	2.02			
		Rusty section from 149.8' to 155.5' with quartz veining	378	304.0	306.0	2.0	1.82	2.09		(1.96)
		(1" – 2" wide) containing cpy-py-mo and disseminated py	379	306.0	309.5	3.5	0.46			
		in matrix. At 158.9', 165.0', 170.2', 186.7', 208.7', 228.0'	380	309.5	315.0	5.5	0.18			
		and 229.1' - 1"-2" wide quartz veins with cpy-py-mo	381	363.0	368.0	5.0	0.08			
		Rust at 205.0' and 210.0' veins again in py-cpy matrix	382	368.0	374.0	6.0	0.01			
		at 268.2' and 281.3'. From 285.7' onwards Tron. goes	383	404.0	408.0	4.0	0.02			
		fine-grained with py-cpy in matrix. Siliceous, with quartz	384	408.0	413.0	5.0	0.50			
		eye developments. Quartz vein at 287.7' and continues	385	413.0	418.0	5.0	0.20			
		intermittedly to 307.6'	386	428.0	432.0	4.0	0.08			
			387	438.0	442.0	4.0	0.07			
			388	442.0	445.0	3.0	0.09			
			389	445.0	449.0	4.0	0.15			
			390	458.0	461.5	3.5	0.41			
349.7	385.7	Diorite	391	470.5	475.5	5.0	0.28			
		Sharp in contact at 25° to core axis. Tron fragments from	392	499.5	503.0	3.5	0.78			
		364.3' – 366.5' and again from 369.2' – 373.5'. At 336.5' is	393	514.5	518.5	4.0	0.99			
		A 5" barren white quartz vein. Sharp out contact at 80°	394	526.5	530.0	3.5	0.69			
		Core axis followed by shared areas of Diorite to	395	530.0	533.0	4.0	1.07			
		398.4'	396	533.0	535.0	3.5	1.58	1.99		(1.79)
385.7	650.0	Fine – grained with twice to 1% py+cpy in matrix by 475'	397	535.0	539.0	3.0	0.56			
		Core becomes broken with minor quartz veins (1"-2")	398	539.0	542.0	2.0	0.41			
		At 499.3' a 4" barren quartz vein and at 502.7' sheared	399	542.0	545.0	3.0	1.14	1.74		(1.44)



Hole No.	Claim No.	Location	Company	Azimuth	Dip	Depth
Ys-04.06	20096	Chester Twp.	Young-Shannon Gold Mines, Limited	335°	-55°	650.0'

Footage		Description	Sample No.	Footage		Smple Length	Assay				
From	To			From	To		Au (g/t)				
		Dioritic areas to 514.0'. After 514.0' back into green	400	584.0	587.5	3.5	0.26				
		Tron. with minor sulfides in Matrix	401	596.5	600.5	4.0	0.35				
		At 585.5' a 2" quartz py-cpy vein and a small insert of									
		Diorite from 590.2'-590.9' Rock is blocky from 585.0' -									
		50.0'. From 600.5' - 631.8' sheared Diorite.									
		END of Hole at 650.0'									

*W. B. P. Eng.*  
*Jul 20/07*



Date: 2004-AUG-30

GEOSCIENCE ASSESSMENT OFFICE  
933 RAMSEY LAKE ROAD, 6th FLOOR  
SUDBURY, ONTARIO  
P3E 6B5

NORTHVILLE GOLD CORP.  
390 BAY STREET, SUITE 2020  
TORONTO, ONTARIO  
M5H 2Y2 CANADA

Tel: (888) 415-9845  
Fax: (877) 670-1555

**Submission Number:** 2.28188  
**Transaction Number(s):** W0460.01201

Dear Sir or Madam

**Subject: Approval of Assessment Work**

We have approved your Assessment Work Submission with the above noted Transaction Number(s). The attached Work Report Summary indicates the results of the approval.

At the discretion of the Ministry, the assessment work performed on the mining lands noted in this work report may be subject to inspection and/or investigation at any time.

If you have any question regarding this correspondence, please contact STEVEN BENETEAU by email at [steve.beneteau@ndm.gov.on.ca](mailto:steve.beneteau@ndm.gov.on.ca) or by phone at (705) 670-5855.

Yours Sincerely,



Ron.C. Gashinski  
Senior Manager, Mining Lands Section

**Cc:** Resident Geologist

Edward James Stringer  
(Agent)

Northville Gold Corp.  
(Claim Holder)

Assessment File Library

Young-Shannon Gold Mines, Limited  
(Claim Holder)

Northville Gold Corp.  
(Assessment Office)

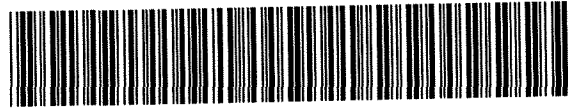

41P12SW2016 2.28188 CHESTER

200

ONTARIO CANADA

MINISTRY OF NORTHERN DEVELOPMENT AND MINES  
PROVINCIAL MINING RECORDERS' OFFICE

Mining Land Tenure Map

Date / Time of Issue: Wed Oct 06 11:31:48 EDT 2004

TOWNSHIP / AREA  
CHESTER

PLAN  
G-3223

ADMINISTRATIVE DISTRICTS / DIVISIONS

Mining Division  
Land Titles/Registry Division  
Ministry of Natural Resources District

Porcupine  
SUDBURY  
TIMMINS

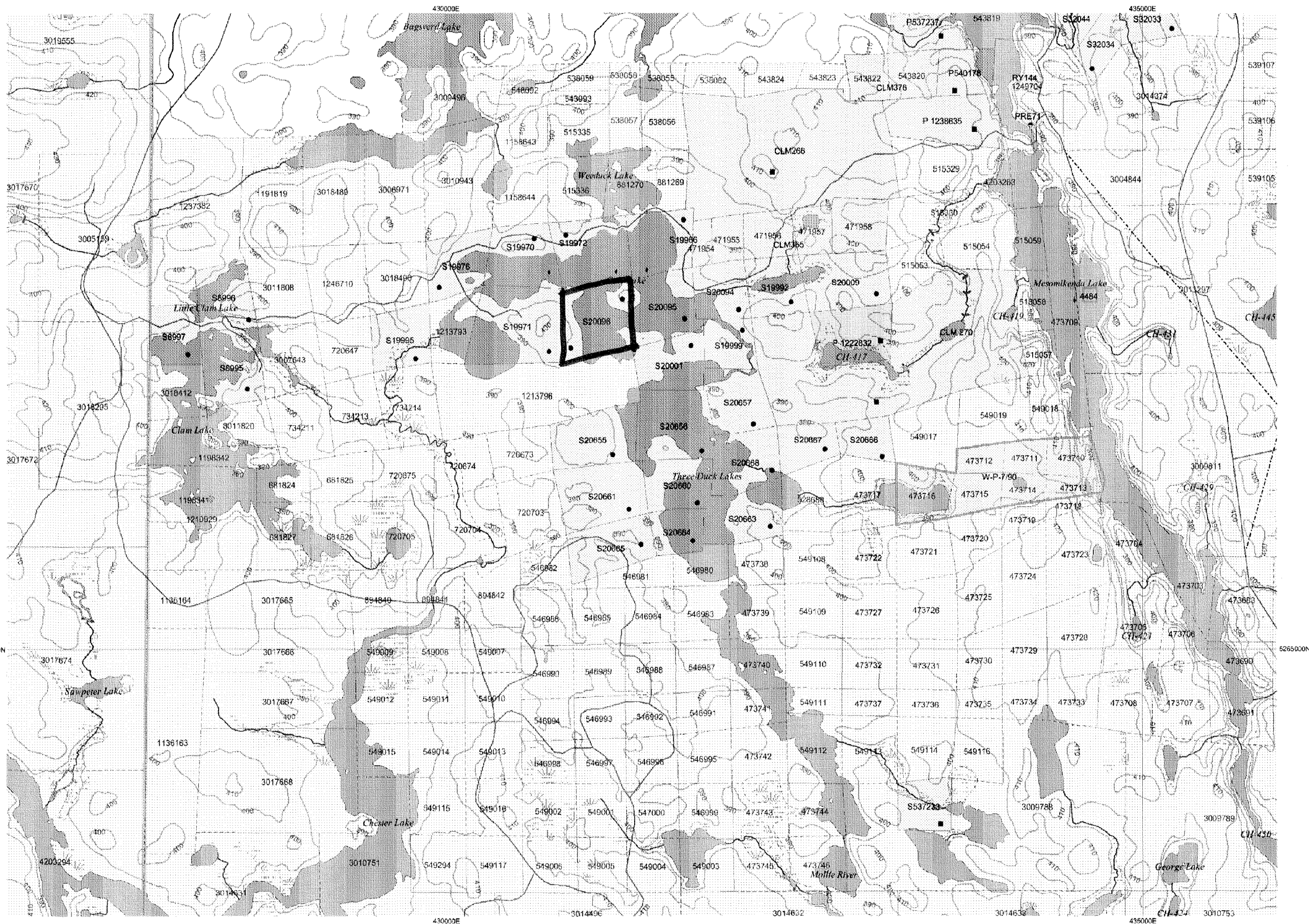

TOPOGRAPHIC

- Administrative Boundaries
Township
Concession Lot
Provincial Park
Indian Reserve
Cliff, Pt & Pile
Contour
Mine Shafts
Mine Headframe
Railway
Road
Trail
Natural Gas Pipeline
Utilities
Tower

Land Tenure

- Freehold Patent
Surface And Mining Rights
Surface Rights Only
Mining Rights Only
Leasehold Patent
Surface And Mining Rights
Surface Rights Only
Mining Rights Only
Licence of Occupation
Uses Not Specified
Surface And Mining Rights
Surface Rights Only
Mining Rights Only
Land Use Permit
Order In Council (Not open for staking)
Water Power Lease Agreement

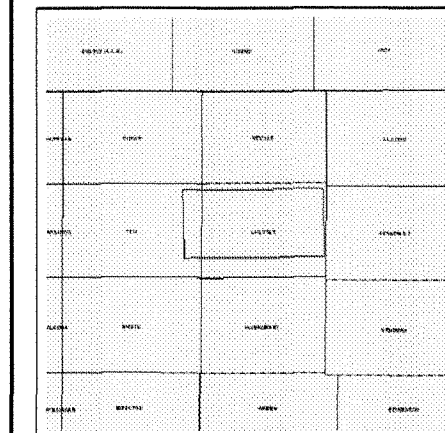

LAND TENURE WITHDRAWALS

- Areas Withdrawn from Disposition
Mining Acts Withdrawal Types
Surface And Mining Rights Withdrawn
Surface Rights Only Withdrawn
Mining Rights Only Withdrawn
Order In Council Withdrawal Types
Surface And Mining Rights Withdrawn
Surface Rights Only Withdrawn
Mining Rights Only Withdrawn

IMPORTANT NOTICES



LAND TENURE WITHDRAWAL DESCRIPTIONS

Table with 4 columns: Identifier, Type, Date, Description. Contains details for mining claim 4484 and other withdrawals.

2.28188
PDRILL
ASSAY

UTM Zone 17
5000m grid

Those wishing to stake mining claims should consult with the Provincial Mining Recorders' Office of the Ministry of Northern Development and Mines for additional information on the status of the lands shown hereon.

General Information and Limitations

Contact Information: Provincial Mining Recorders' Office, Willet Green Miller Centre 933 Ramsey Lake Road, Sudbury ON P3E 6B5

Toll Free Tel: 1 (888) 415-9845 ext 5777 Fax: 1 (877) 670-1444

Map Datum: NAD 83 Projection: UTM (6 degree) Topographic Data Source: Land Information Ontario Mining Land Tenure Source: Provincial Mining Recorders' Office

This map may not show unregistered land tenure and interests in land including certain patents, leases, easements, right of ways, flooding rights, licences, or other forms of disposition of rights and interest from the Crown.

The information shown is derived from digital data available in the Provincial Mining Recorders' Office at the time of downloading from the Ministry of Northern Development and Mines web site.



2.28188

# Chester Township 2004 Drilling Location

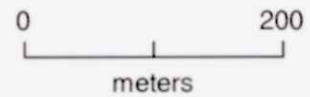
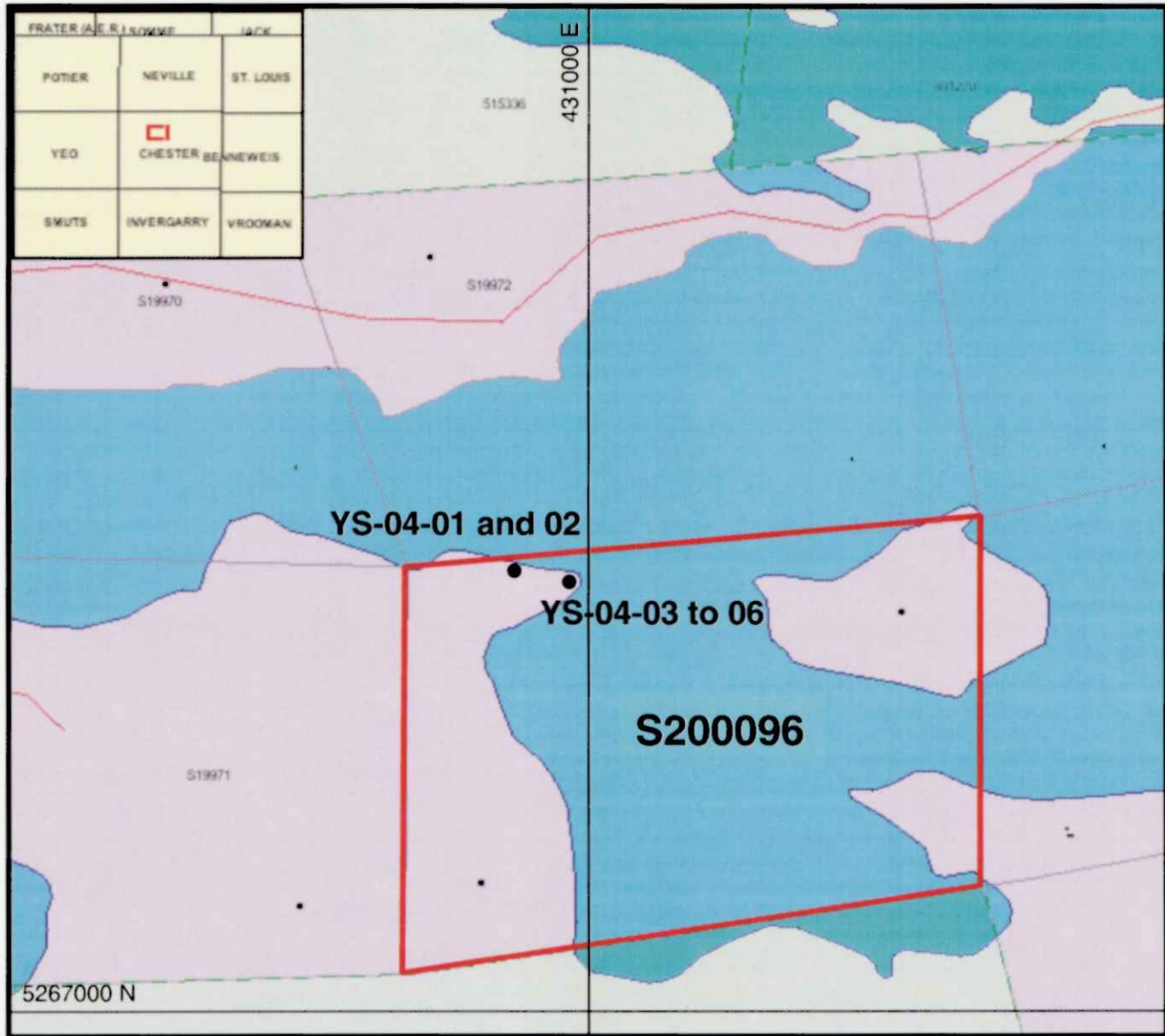



88182.2

201006 101 West of 2nd St  
400' x 400' (38' x 40')  
41' x 350' x  
EL. = 9971.4

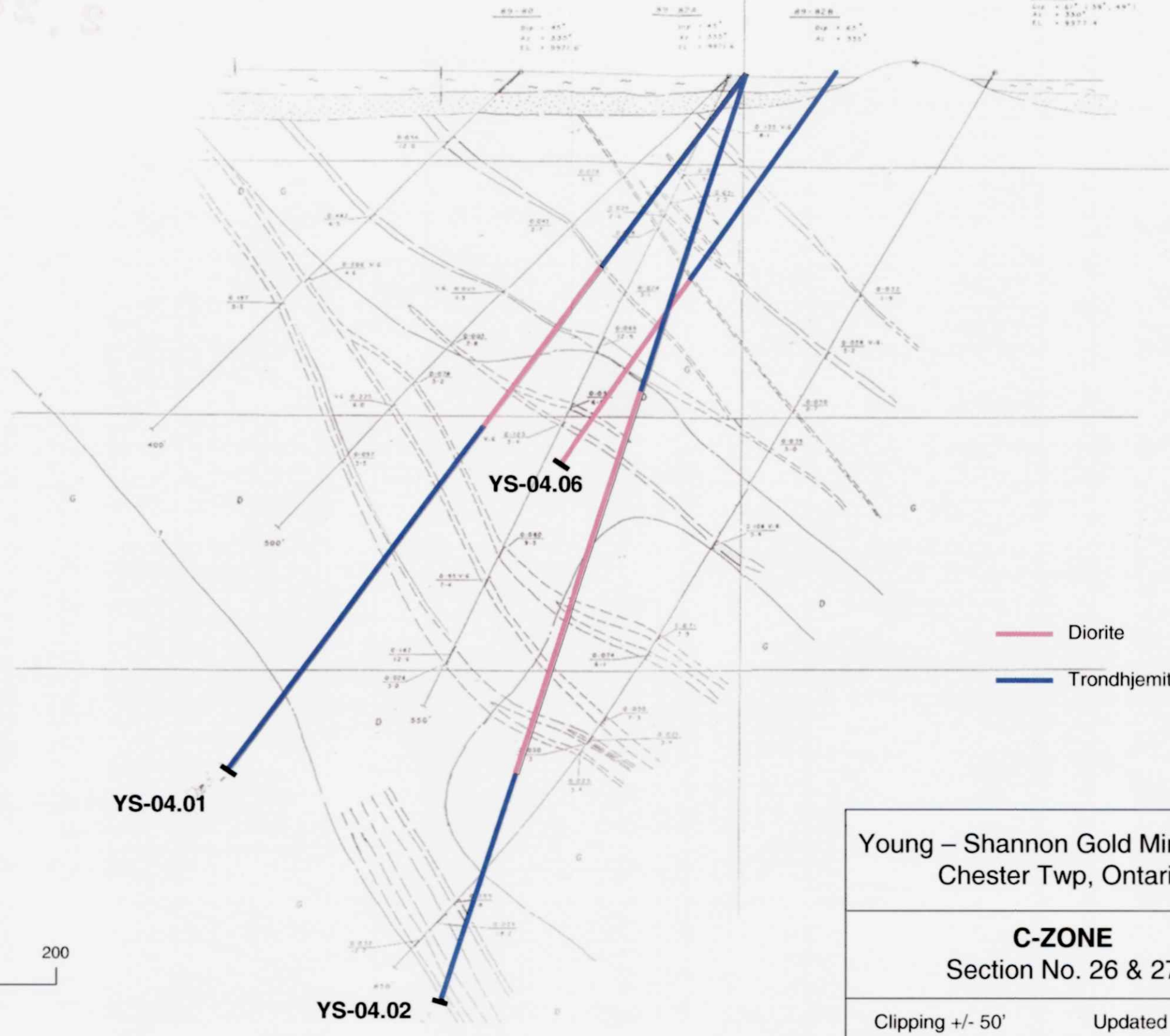

Young – Shannon Gold Mines, Ltd.  
Chester Twp, Ontario

**C-ZONE**  
Section No. 26 & 27

Clipping +/- 50'      Updated July 2004



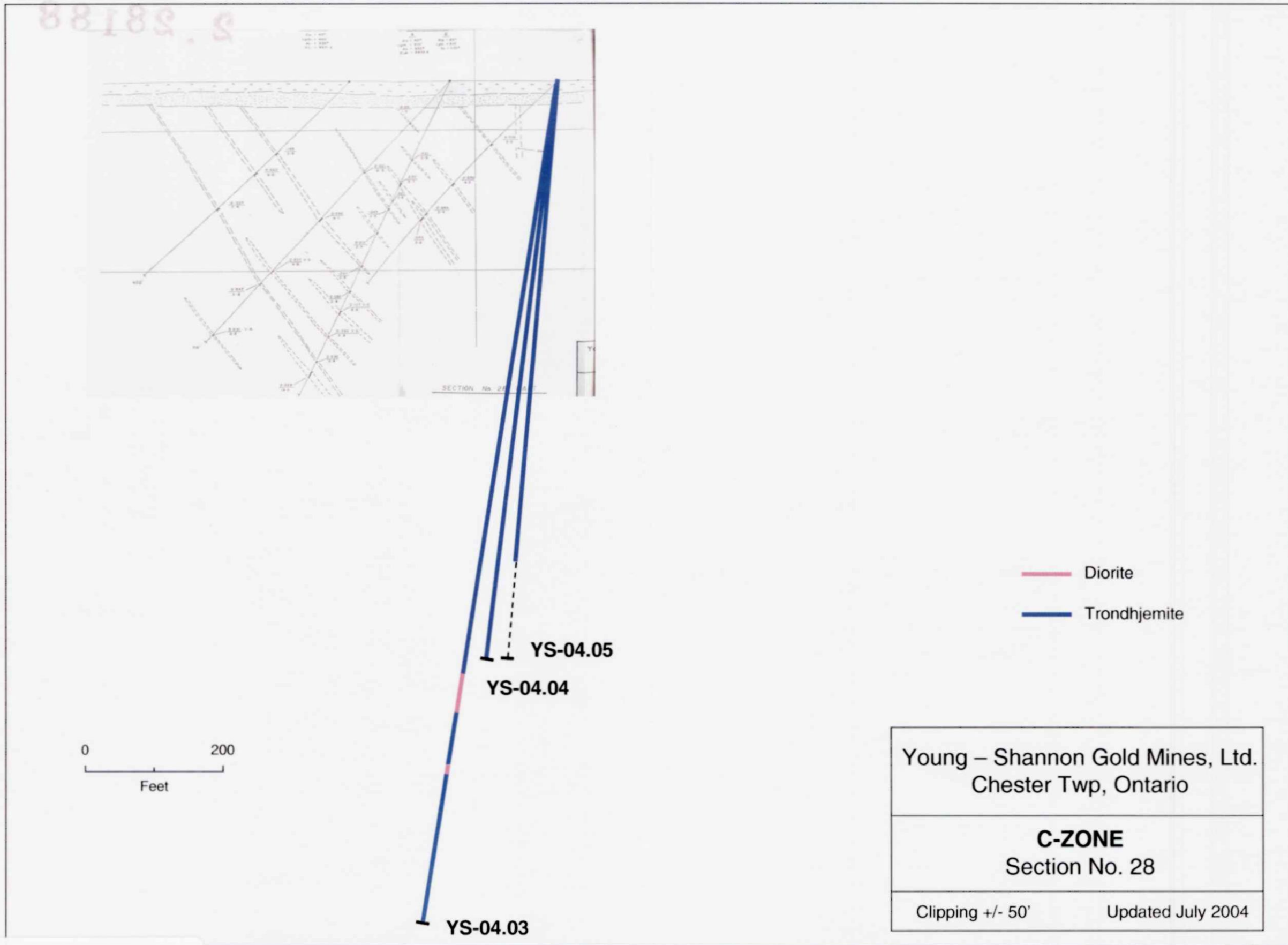

88189.S

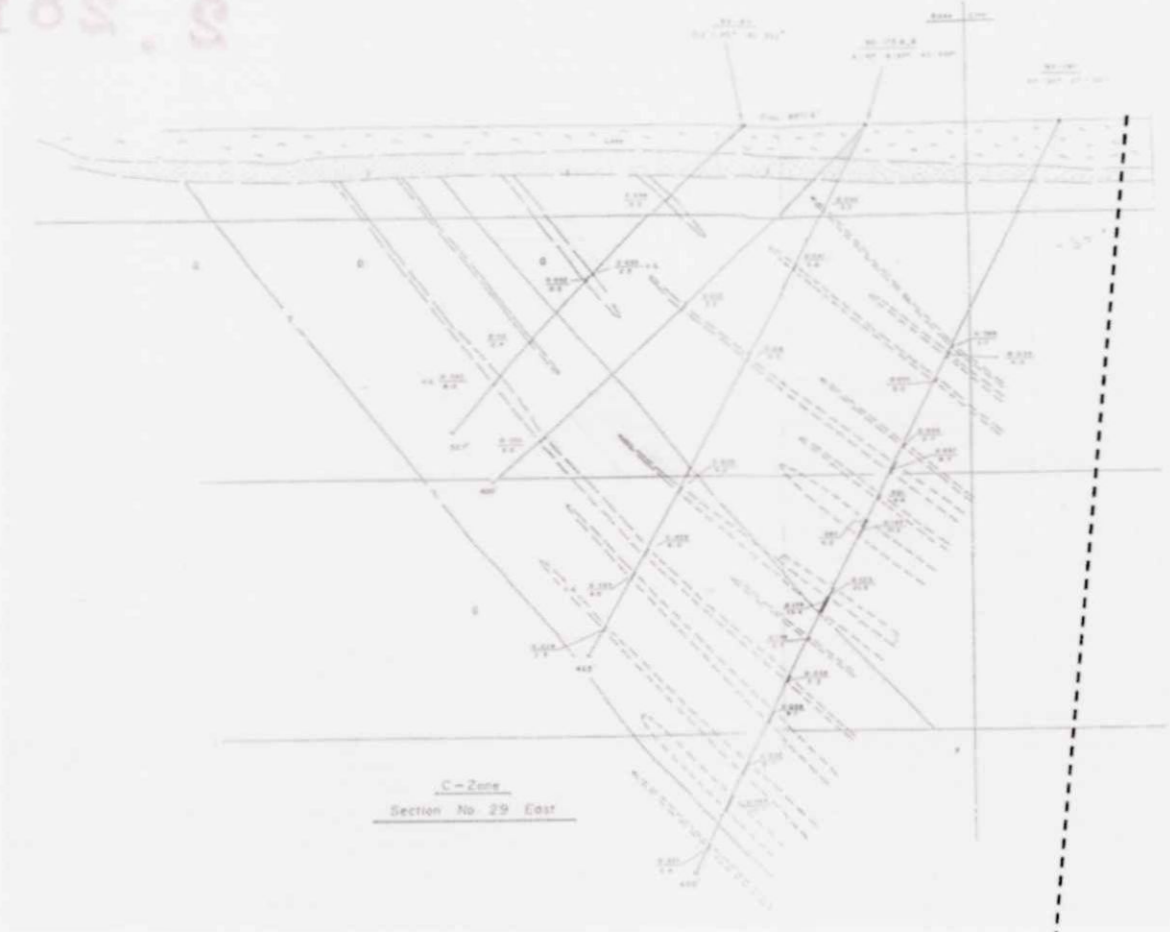

C-Zone  
Section No. 29 East

- Diorite
- Trondhjemite

YS-04.05

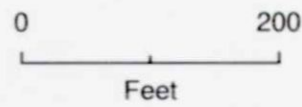

Young – Shannon Gold Mines, Ltd.  
Chester Twp, Ontario

**C-ZONE**  
Section No. 29

Clipping +/- 50'      Updated July 2004

