

Amended DOCUMENT 880 Mining A



Name and Postal Address of Recorded Holder: **BLUE FALCON MINES LTD. 20 Advance Blvd Brampton, Ontario L6T 4R7**

Prospector's Licence No.: **T1441**

Yeo Twp.

DOCUMENT NO. W 8806-222

Total Work Days Cr. claimed 1,500 1200	Mining Claim		Work Days Cr.	Mining Claim		Work Days Cr.	Mining Claim		Work Days Cr.
	Prefix	Number		Prefix	Number		Prefix	Number	
<input type="checkbox"/> Manual Work <input type="checkbox"/> Shaft Sinking Drifting or other Lateral Work. <input type="checkbox"/> Compressed Air, other Power driven or mechanical equip. <input checked="" type="checkbox"/> Power Stripping <input type="checkbox"/> Diamond or other Core drilling <input type="checkbox"/> Land Survey									
SEE ATTACHED LIST ONTARIO GEOLOGICAL SURVEY ASSESSMENT FILES OFFICE AUG 25 1988 RECEIVED									

All the work was performed on Mining Claim(s): P. 957535, 957536, 957537, 878872, 878873, 878875, 957263.

Required Information eg: type of equipment, Names, Addresses, etc. (See Table Below)

Work completed by: Bobex Resources Inc. 20 Advance Blvd., Brampton, Ontario L6T 4R7
 Operator: Bob Leliever
 Helper: Vital Larche

Used: 1 John Deere muskeg/tractor with backhoe for powerstripping and trenching with Mark 4 wajax pump, chainsaws and 2 operators.

155 hrs. backhoe/muskeg tractor @ \$50/hr	=	\$ 7,750.00
155 hrs. operator @ \$25/hr	=	3,875.00
155 hrs. helper @ \$17.50/hr.	=	2,712.50
62.5 hrs. Mark 4 wajax pump @ \$8.50/hr.	=	531.25
56 hrs. chainsaw @ \$2.50/hr.	=	140.00
		\$15,008.75

* Excess credits of 300.8 days available!

RECORDED MAR 14 1988

Date of Report: July 20, 1988
 Recorded Holder or Agent (Signature): *[Signature]*

Certification Verifying Report of Work
 I hereby certify that I have a personal and intimate knowledge of the facts set forth in the Report of Work annexed hereto, having performed the work or witnessed same during and/or after its completion and the annexed report is true.

Name and Postal Address of Person Certifying: **Gordon Leliever 20 Advance Blvd., Brampton, Ontario L6T 4R7**

Date Certified: July 20, 1988
 Certified by (Signature): *[Signature]*

Type of Work	Specific Information on per type	Other information (Common to 2 or more types)	Attachments
Manual Work			
Shaft Sinking, Drifting or other Lateral Work	Note: Use First Recoval date of March 14/88	Names and addresses of men who performed manual work/operated equipment, together with dates and hours of employment.	Work Sketch: these are required to show the location and extent of work in relation to the nearest claim post
Compressed air, other power driven or mechanical equip.	Type of equipment		
Power Stripping	Type of equipment and amount expended. Note: Proof of actual cost must be submitted within 30 days of recording.	Names and addresses of owner or operator together with dates when drilling/stripping done.	
Diamond or other core drilling	Signed core log showing: footage, diameter of core, number and angles of holes.		Work Sketch (as above) in duplicate
Land Survey	Name and address of Ontario land surveyer.	Nil	Nil

P. 924048 20
 924049 20
 924050 20
 924051 20
 924052 20
 924053 20
 924054 20
 924210 20
 924211 20
 924212 20
 924213 20
 924214 20
 924215 20
 924216 20
 924217 20
 933487 20
 933490 20
 933491 20
 950699 20
 950700 20
 950701 20
 950702 20
 950703 20
 950704 20
 950705 20
 950706 20
~~950713~~ 20
 952167 20
 957263 20
 957264 20
 957265 20
 957266 20
 957267 20
 957268 20
 957269 20
 987533 20
 987534 20
~~987535~~ 20
~~987536~~ 20
~~987537~~ 20
 987538 20

Cancelled Dec. 10/87!

Cancelled May 30/88

" "
" "

~~P. 987539~~ 20 *Cancelled May 30/88*
~~987540~~ 20 *" "*
~~987541~~ 20 *" "*
~~987542~~ 20 *" "*
~~987543~~ 20 *" "*
~~987544~~ 20 *" "*
~~987545~~ 20 *" "*
~~987546~~ 20 *" "*
~~987547~~ 20 *" "*
~~987548~~ 20 *" "*
~~987549~~ 20 *" "*
 995811 20
 995812 20
 995813 20
 995814 20
 995815 20
 995816 20
 995817 20
 995818 20
 995819 20
 995820 20
 995821 20
 995822 20
 995823 20
 995824 20
 995825 20
 995826 20
 995827 20
 995828 20
 995829 20
 995830 20
 995831 20
 995832 20
 995833 20

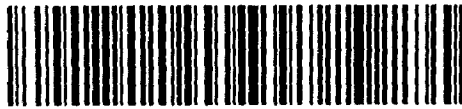

41P12SW5007 W8806-00222 YEO

900

INVOICE #82

TO: MONTE CARLO GOLD MINES LTD.

FROM: BOBEX RESOURCES INC.

DATE: DECEMBER 4, 1987

Final billing re; stripping and trenching on properties located ^{properties} in Yeo Township, Porcupine Mining Division, Ontario. These ~~companies~~ are owned by KiddiResources Ltd. and Blue Falcon Mines Ltd., the number of hours on each company's property as shown on appendix "A".

Kidd Resources Ltd.	142 hours = 14.2 days	
	@ \$1,000/day	= \$14,200.00
Blue Falcon Mines Ltd.	155 hours = 15.5 days	
	@ \$1,000/day	= \$15,500.00
		<u>\$29,700.00</u>

Kess Interim payments

October 26, 1987	\$ 5,600.00
November 16, 1987	\$ 6,500.00
November 16, 1987	\$ 7,800.00
November 16, 1987	\$ 6,000.00

AMOUNT STILL OUTSTANDING OF \$ 3,800.00

Dec 4/1987
RE K.I.A. - BFM (Yeo)

3 m. fuel Dec 4/87

INVOICE #3M

TO: BLUE FALCON MINES LTD .
FROM: MONTE CARLO GOLD MINES LTD .
DATE: DECEMBER 4, 1987

For stripping and trenching done on properties
located in Yeo Township, work done by Bobex Resources Ltd.

Blue Falcon Mines Ltd. 155 hours = 15.5 days
@ \$1,000.00/day = \$15,500.00

PAID

P.2. 878871

P.3. 878874

P.1. 878876

P.4. 878875

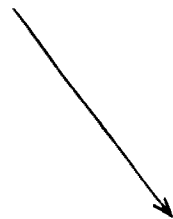

685' at 142°

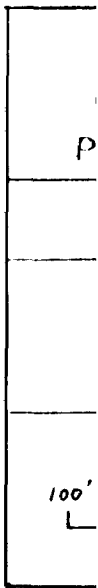
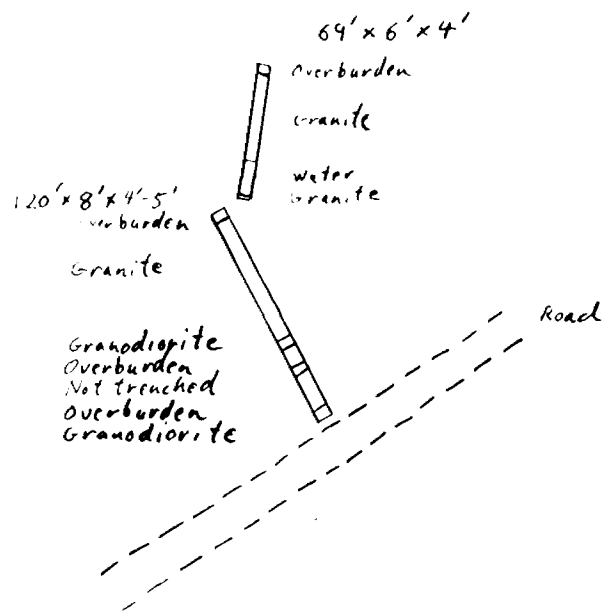

N

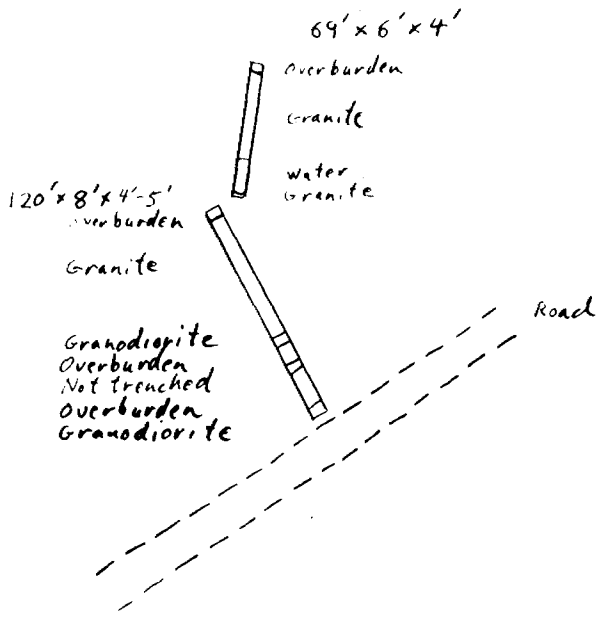

SKETCH #7

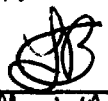
BLUE FALCON MINES LTD, POWERSTRIPPING PROGRAM
CENTRAL YEO TWP.
work: december 1987 L.A.B. drawn: January 1988 M.T.A.
Scale 1"=100' 
March 10/88
100' 50' 0 100' 200'

BLUE FALCON MINES LTD
 POWER STRIPPING PROGRAM
 NORTHEAST YEO TWP.

November, 1987 By: LAB
 Scale: 1" = 100'
 March 11/88

SKETCH # 1

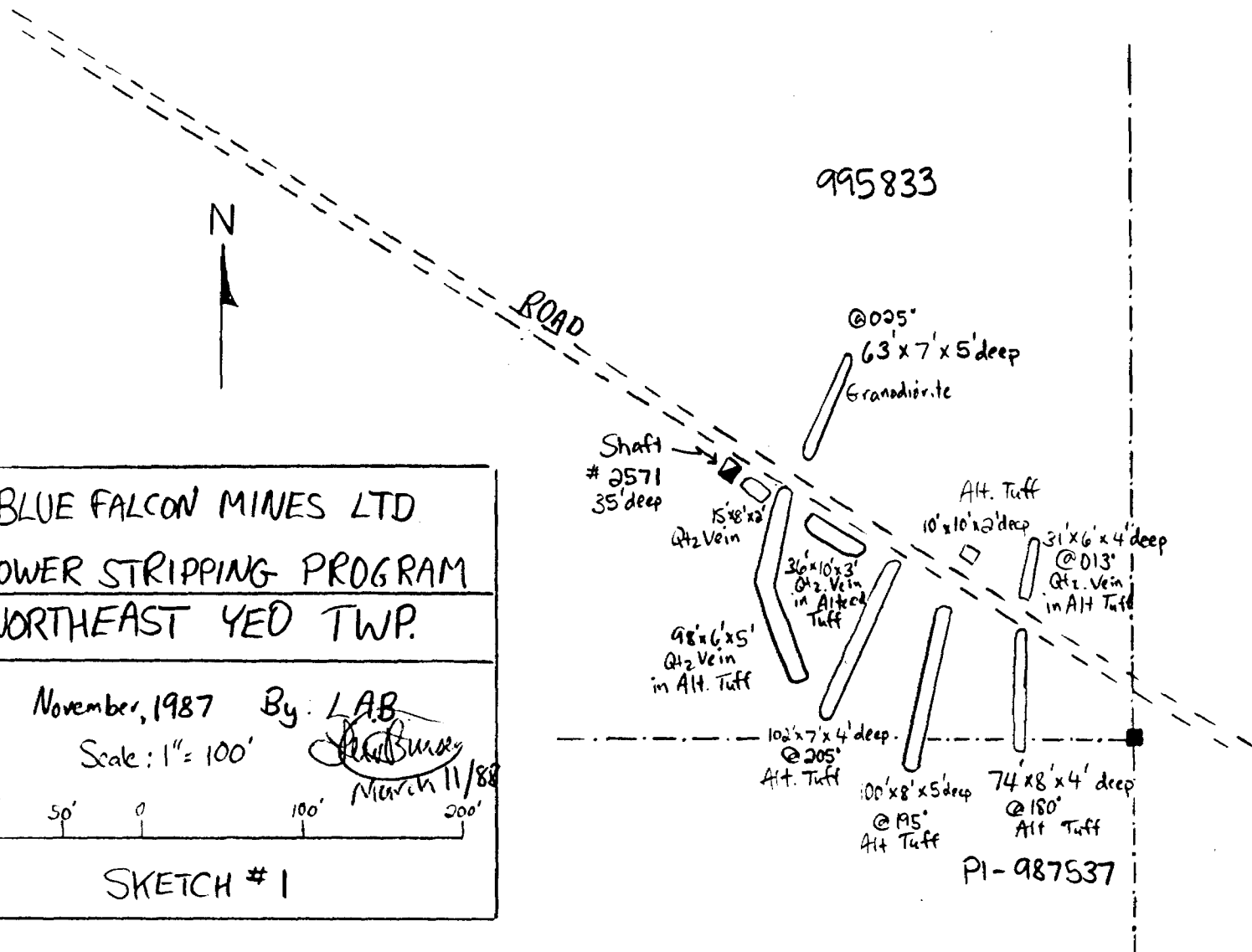

120' x 8' x 4' deep
Granodiorite
Water
Granodiorite
Water
Diorite

Diorite
Water filled
Granodiorite (tr. to 1% P₂ locally)
Granodiorite
115' x 8' x 3-4' deep



ONTARIO GEOLOGICAL SURVEY
ASSIGNMENT FILES
OFFICE
AUG 25 1988
RECEIVED

BLUE FALCON MINES LTD.
POWER STRIPPING PROGRAM
EAST CENTRAL YEO TWP.
November, 1987 By: L.A.B.
Scale: 1" = 100'
March 11/88
100' 50' 0 100' 500'

SKETCH # 8

445' @ 499°
P3-957263

P1. 878873

P4. 878872

170' at 129°

70' at 171°

N

SKETCH #6

93' x 8' x 3'-6' (avg. 4' depth)

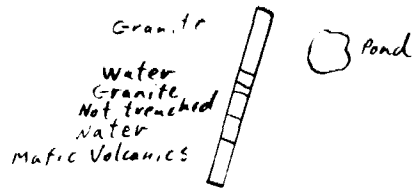

180' x 8' x 1'-7' (3' avg. depth)

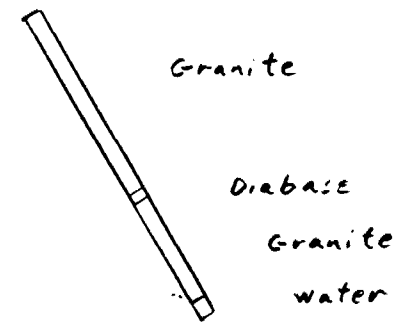

P. + 878873

470' at 173°

168' x 8' x 1'-5' (3' avg. depth)



Intermediate Volcanics

water

Intermediate Volcanics
+ 1"-2" Quartz Veins

Diorite

Intermediate Volcanics
water

SKETCH #5

BLUE FALCON MINES LTD.
POWERSTRIPPING PROGRAM

CENTRAL YEO TWP.

work: december 1987 L.A.B.
drawn: January 1988 M.T.A.

Scale 1" = 100'

[Signature]
March 11/88



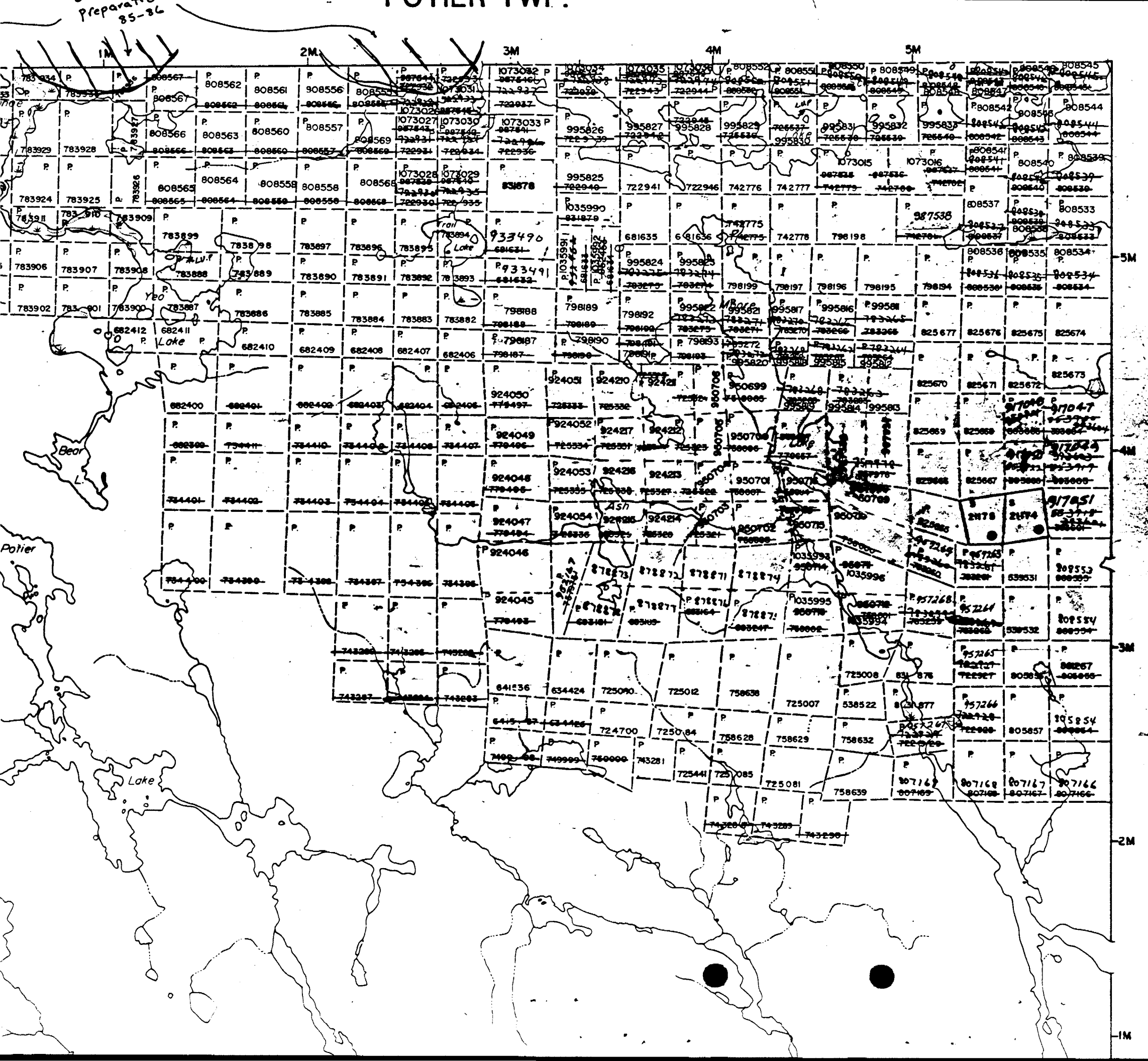

HIGHWAY AND ROUTE NO.

OTHER ROADS

TRAILS

SURVEYED LINES:
 TOWNSHIPS, BASE LINES, ETC.

LOTS, MINING CLAIMS, PARCELS, ETC.

UNSURVEYED LINES:
 LOT LINES

PARCEL BOUNDARY

MINING CLAIMS ETC.

RAILWAY AND RIGHT OF WAY

UTILITY LINES

NON-PERENNIAL STREAM

FLOODING OR FLOODING RIGHTS

SUBDIVISION OR COMPOSITE PLAN

RESERVATIONS

ORIGINAL SHORELINE

MARSH OR MUSKEG

MINES

TRAVERSE MONUMENT

DISPOSITION OF CROWN LANDS

TYPE OF DOCUMENT	SYMBOL
PATENT, SURFACE & MINING RIGHTS	
SURFACE RIGHTS ONLY	
MINING RIGHTS ONLY	
LEASE, SURFACE & MINING RIGHTS	
SURFACE RIGHTS ONLY	
MINING RIGHTS ONLY	
LICENCE OF OCCUPATION	
ORDER-IN-COUNCIL	
RESERVATION	
CANCELLED	
SAND & GRAVEL	

NOTE: MINING RIGHTS IN PARCELS PATENTED PRIOR TO MAY 6, 1913, VESTED IN ORIGINAL PATENTEE BY THE PUBLIC LANDS ACT, R.S.O. 1970, CHAP. 380, SEC. 63, SUBSEC. 1.

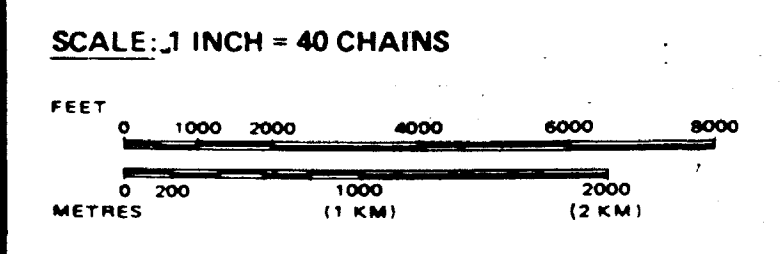

TOWNSHIP

YEO

M.N.R. ADMINISTRATIVE DISTRICT

GOGAMA

MINING DIVISION

CHESTER TWP.

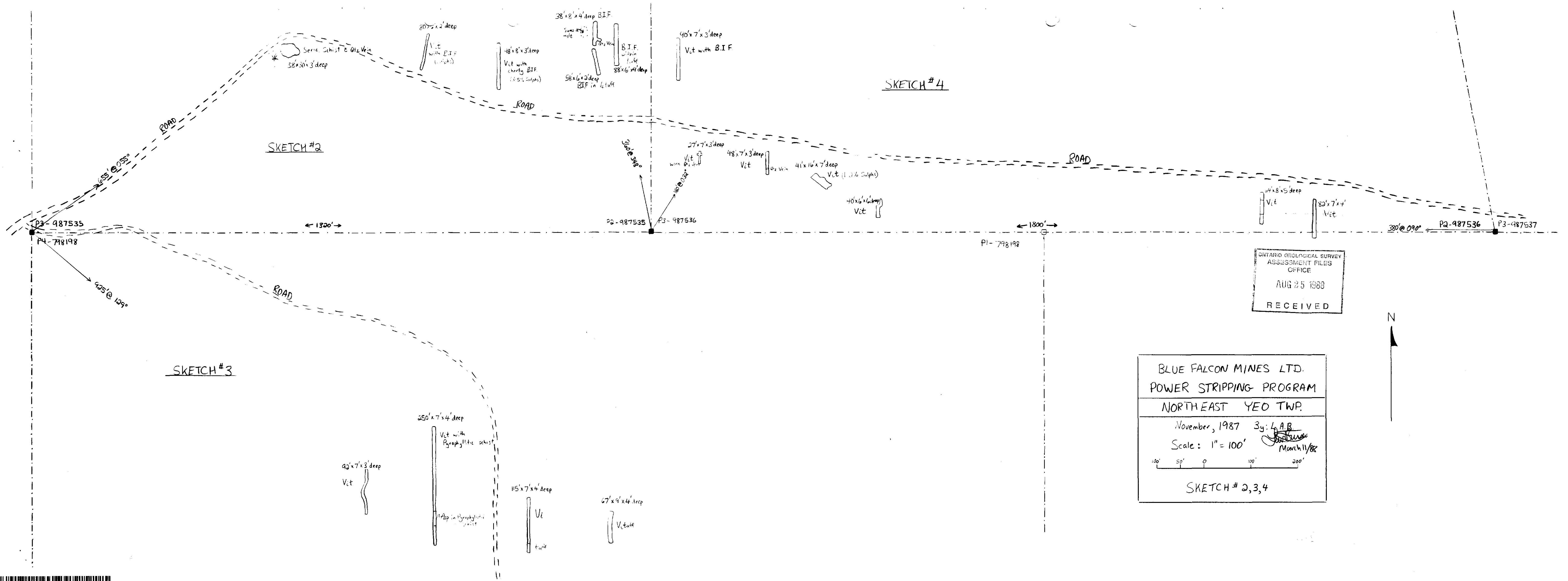

ONTARIO GEOLOGICAL SURVEY
 ASSESSMENT FILES
 OFFICE
 AUG 25 1988
 RECEIVED

BLUE FALCON MINES LTD.
 POWER STRIPPING PROGRAM
 NORTHEAST YEO TWP.
 November, 1987 By: LAB
 Scale: 1" = 100' *March 11/88*
 SKETCH # 2,3,4

