



226/86

Instructions - Supply required data on a separate form for each type of work to be recorded (see table below).
- For Geo-technical work use form no. 1362 "Report of Work (Geological, Geophysical, Geochemical and Expenditures)".

Mining Act

Name and Postal Address of Recorded Holder: **B & B Mining (Canada) Ltd.**
 505 - 340 West Cordova St., Vancouver B.C. V6C 2V3

Prospector's Licence No.: **T 3615**

YEO TWP.

Summary of Work Performance and Distribution of Credits

Total Work Days Cr. claimed <i>3.8 days</i>	Mining Claim		Work Days Cr.	Pr
	Prefix	Number		
for Performance of the following work. (Check one only) <input checked="" type="checkbox"/> Manual Work <input type="checkbox"/> Shaft Sinking Drifting or other Lateral Work. <input checked="" type="checkbox"/> Compressed Air, other Power driven or mechanical equip. <input type="checkbox"/> Power Stripping <input type="checkbox"/> Diamond or other Core drilling <input type="checkbox"/> Land Survey	P	783922	1.0	
		783923	1.0	
		783924	1.0	
		783925	0.8	



41P12SW5014 W8606-00226 YEO

010

All the work was performed on Mining Claim(s): *P. 783922, 783923, 783924, 783925, 783927, 783929, 783931*

Required Information eg: type of equipment, Names, Addresses, etc. (See Table Below)

See attach listing.
ALL CLAIMS IN YEO TP.

Date of Report: *June 23/86*
 Recorded Holder or Agent (Signature): *[Signature]*

Certification Verifying Report of Work
 I hereby certify that I have a personal and intimate knowledge of the facts set forth in the Report of Work annexed hereto, having performed the work or witnessed same during and/or after its completion and the annexed report is true.

Name and Postal Address of Person Certifying: *NEIL D. NOUAK, 818-60 SOUTHPORT ST. TORONTO ONT.*
M6S 3N4

Date Certified: *June 23/86*
 Certified by (Signature): *[Signature]*

Table of Information/Attachments Required by the Mining Recorder

Type of Work	Specific information per type	Other information (Common to 2 or more types)	Attachments
Manual Work	Nil	Names and addresses of men who performed manual work/operated equipment, together with dates and hours of employment.	Work Sketch: these are required to show the location and extent of work in relation to the nearest claim post.
Shaft Sinking, Drifting or other Lateral Work			
Compressed air, other power driven or mechanical equip.	Type of equipment	Names and addresses of owner or operator together with dates when drilling/stripping done.	
Power Stripping	Type of equipment and amount expended. Note: Proof of actual cost must be submitted within 30 days of recording.		
Diamond or other core drilling	Signed core log showing; footage, diameter of core, number and angles of holes.	Nil	Work Sketch (as above) in duplicate
Land Survey	Name and address of Ontario land surveyor.		Nil

Manual work

Attached General Labour Record indicates that a total of 23 hours were worked on this project.

Total of 23 hours ÷ 6 = 3.8 days assessment credit.

GENERAL LABOUR RECORD

Date	Labourer	Hours	Function
Nov 9	R. Leliever	2h	mucking out blast
Nov 12	D. Graham	2h	mucking out trench
Nov 16	V. Lanche	4h	mucking out blast
Nov 19	D. Graham	3h	digging trenches
Nov 28	V. Lanche	8h	mucking out trench
Dec 5	V. Lanche	4h	mucking out blast
Total		23 hours	



41P12SW5014 W8606-00226 YEO

900

APPENDIX V

TRENCH LOCATION BY CLAIM NUMBER

(Note: All claims are located in Yeo Twp.)

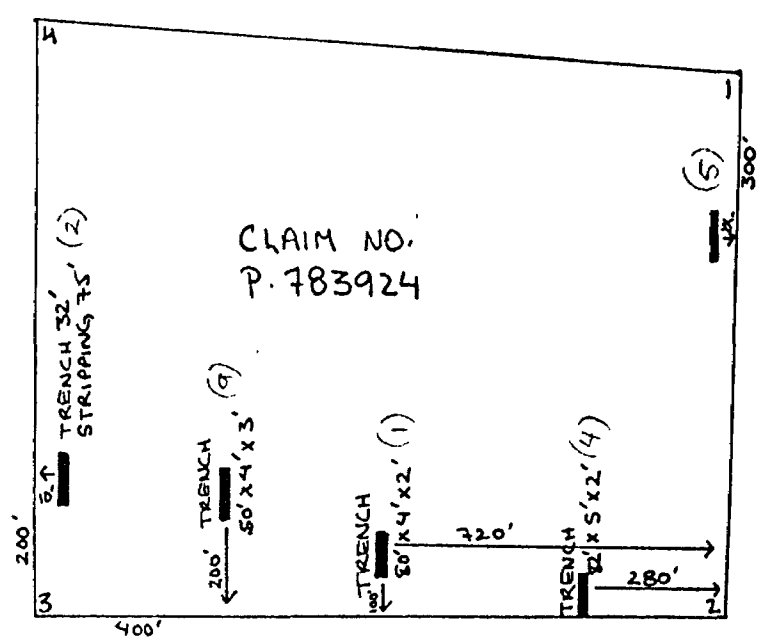

TRENCHES T-1, T-2, T-4, T-5, T-9

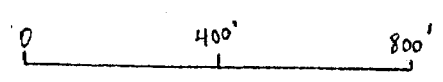

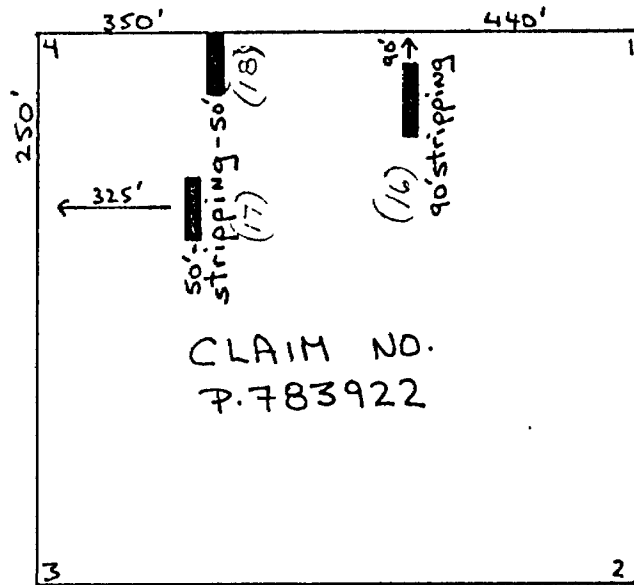

TRENCHES T-16, T-17, T-18

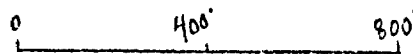

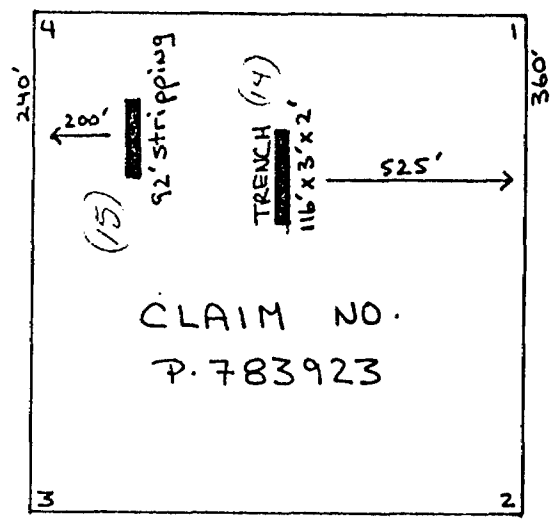

TRENCHES T-14, T-15

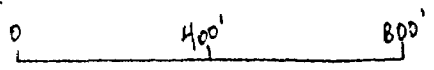

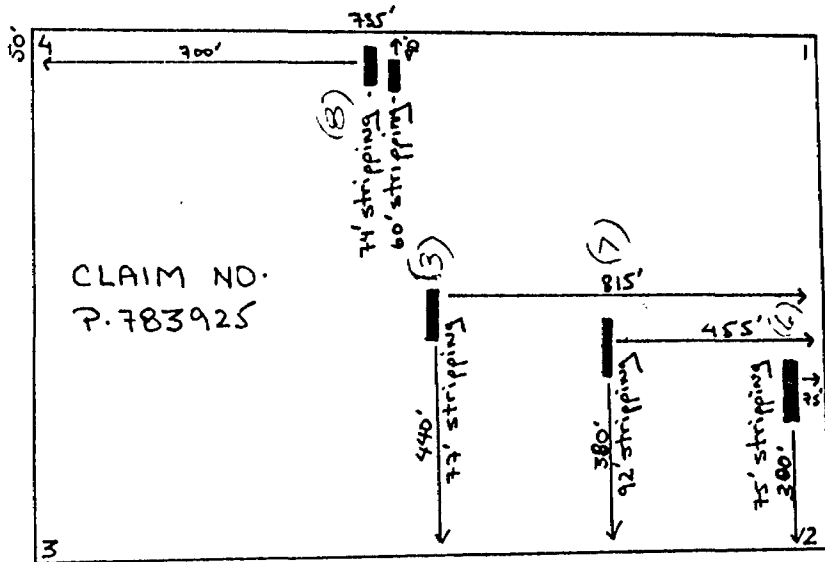

TRENCHES T-3 , T-6 , T-7 , T-8

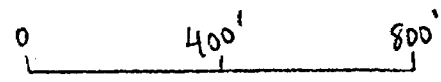

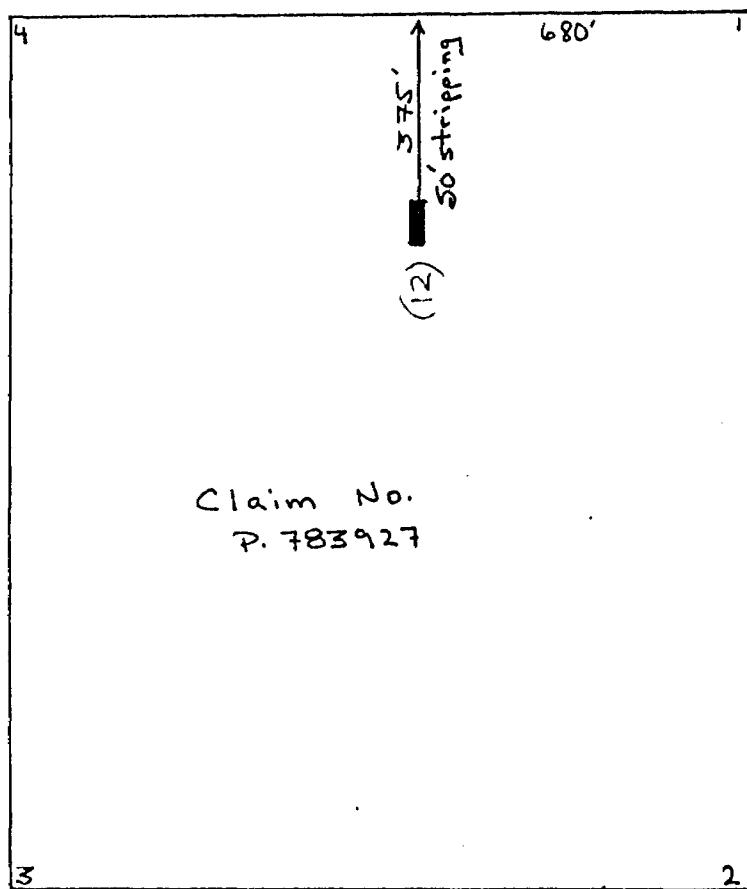

TRENCHES T-12

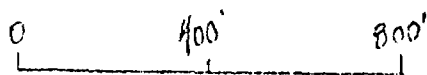

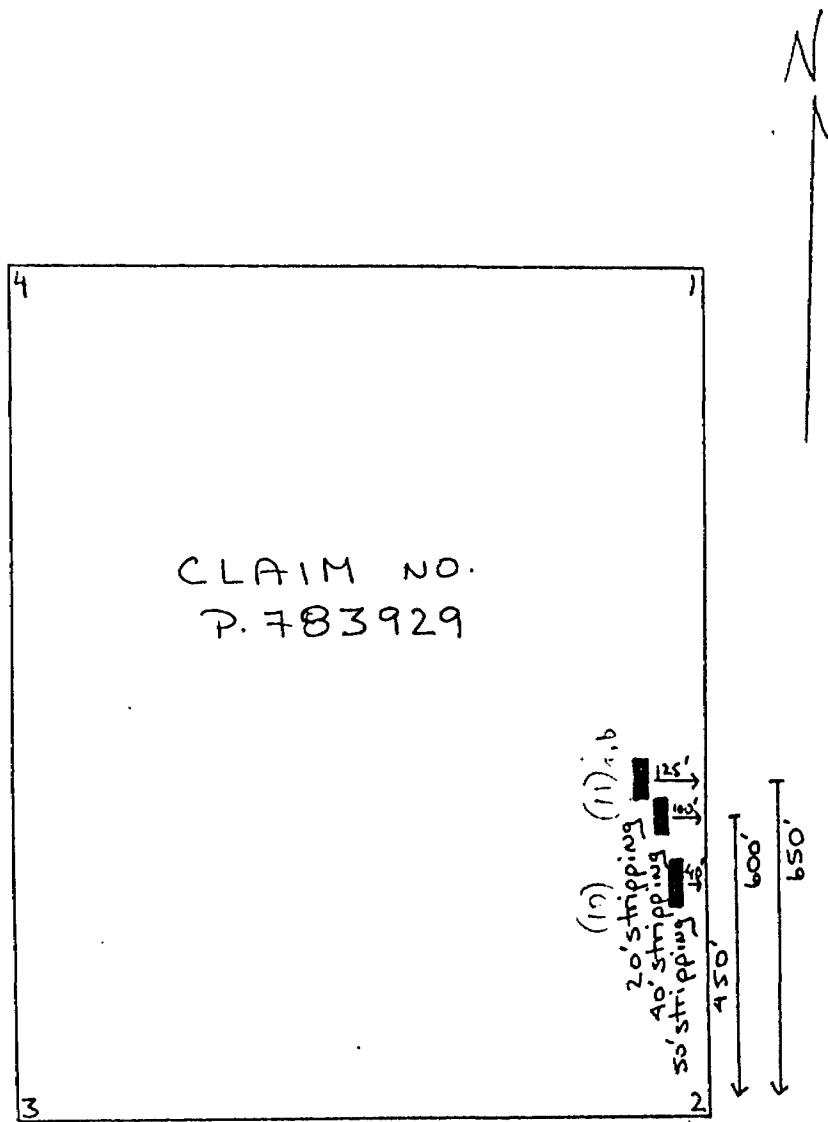

TRENCHES T-10, T-11 a, b

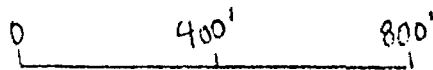

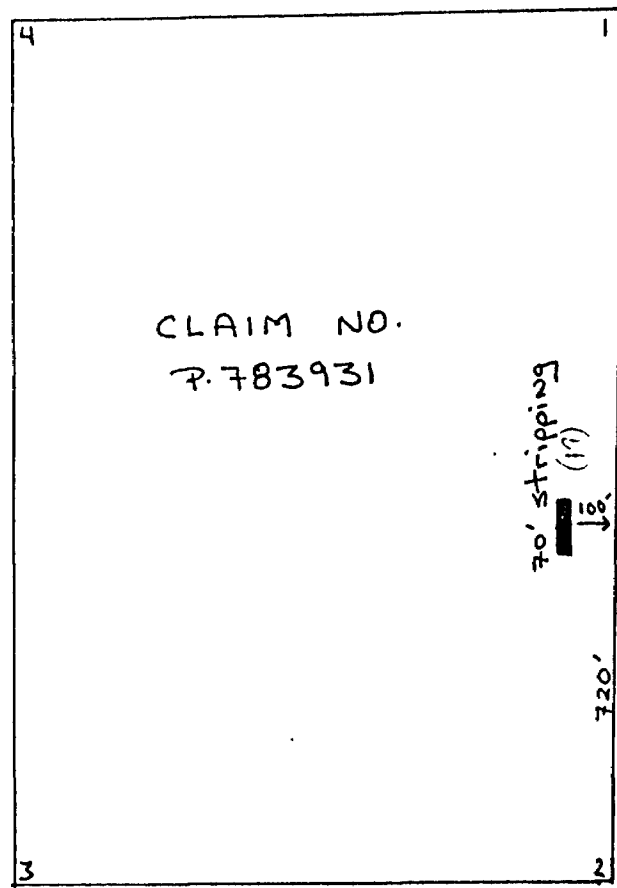

TRENCHES T-19

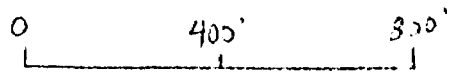

REFERENCES

WITHDRAWN FROM DISPOSITION

R.O. - MINING RIGHTS ONLY

S.O. - SURFACE RIGHTS ONLY

+ S. - MINING AND SURFACE RIGHTS

Order No. Date Disposition File

Geo Twp.

POTIER TWP.

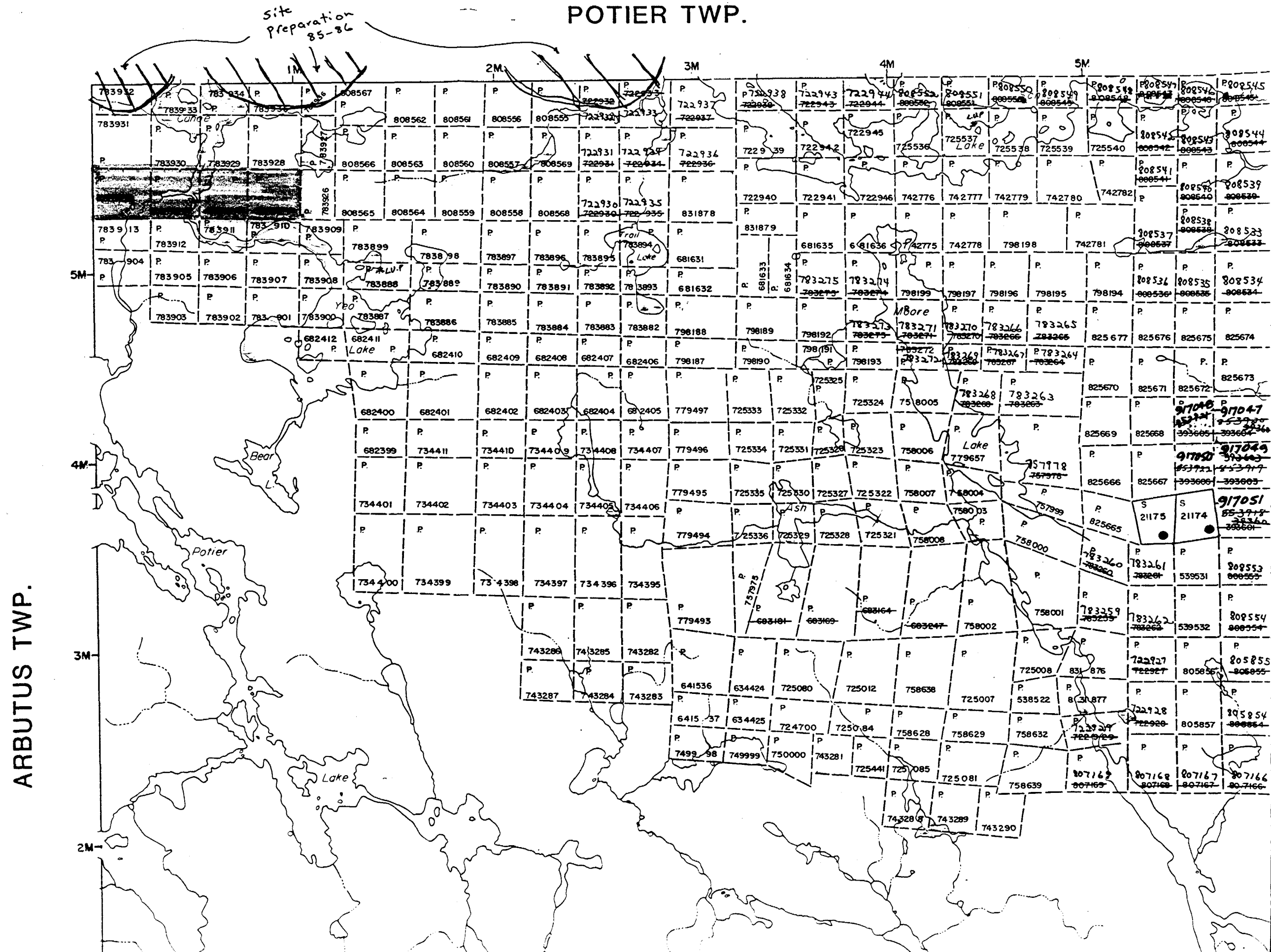

ARBUTUS TWP.