

Department

Report of Work

410-792-23

205/8
Mining



41P125W5088 W8706-00205 CHESTER

010

Postal Address of Recorder Holder

Prospector's Licence No.

THE FALCON MINES LTD.

T-1441

20 Advance Blvd., Brampton, Ontario, L6T 4R7

Summary of Work Performance and Distribution of Credits

Total Work Days (or Claimed)	Mining Claim			Mining Claim			Work Days Cr.
	Prefix	Number	Work Days Cr.	Prefix	Number	Work Days Cr.	
6.00							
for Performance of the following work. (Check one only): <input checked="" type="checkbox"/> Manual Work <input type="checkbox"/> Shaft Sinking, Drifting or other Lateral Work. <input type="checkbox"/> Compressed Air, other Power driven or mechanical equip. <input type="checkbox"/> Power Stripping <input type="checkbox"/> Diamond or other Core drilling <input type="checkbox"/> Land Survey	P	809409	1.9				
		809410	1.6				
		809411	1.6				
		809419	1.6				

All the work was performed on Mining Claim(s) **p-809419**

Required Information (eq: type of equipment, Names, Addresses, etc.) (See Table Below)

SEE ATTACHMENT
WORK SKETCH ATTACHED

RECEIVED
AUG 17 1987

RECORDED
AUG 17 1987

DATE OF REPORT: Aug 13/87
RECORDED HOLDER OR AGENT (SIGNATURE): [Signature]

Certification Verifying Report of Work

I hereby certify that I have a personal and intimate knowledge of the facts set forth in the Report of Work annexed hereto, having performed the work or witnessed same during and/or after its completion and the annexed report is true.

Name and Postal Address of Person Certifying

NEIL D. NOVAK 20 Advance Blvd., Brampton, Ontario L6T 4R7

Date Certified

Aug 13/87

Certified by (Signature)

[Signature]

Table of Information Attachments Required by the Mining Recorder

Type of Work	Specific information per type	Other information (Common to 2 or more types)	Attachments
Manual Work	Nil	Names and addresses of men who performed manual work / operated equipment, together with dates and hours of employment.	Work Sketch, these are required to show the location and extent of work in relation to the nearest claim post.
Shaft Sinking, Drifting or other Lateral Work			
Compressed air, other power driven or mechanical equip.	Type of equipment	Names and addresses of owner or operator together with dates when drifting/stripping done.	
Power Stripping	Type of equipment and amount expended. Note: Proof of actual cost must be submitted within 30 days of recording.		
Diamond or other core drilling	Signed core log showing footage, diameter of core, number and angles of holes.	Nil	Work Sketch (as above) in duplicate
Land Survey	Name and address of Ontario land surveyor.		

MANUAL WORK

Claims P.809409, 809410, 809411, 809419 located in Chester Twp.

2 men employed for 2.5 days August 4 & 5, 1987

Ron Lawson 20 hours

Gerald Gilmore 20 hours

TOTAL HOURS 40 hours

Work credits = 1 day for each 6 hours employed = 6.66 days.



41P12SW5088 W8706-00205 CHESTER

Handwritten signature or note.

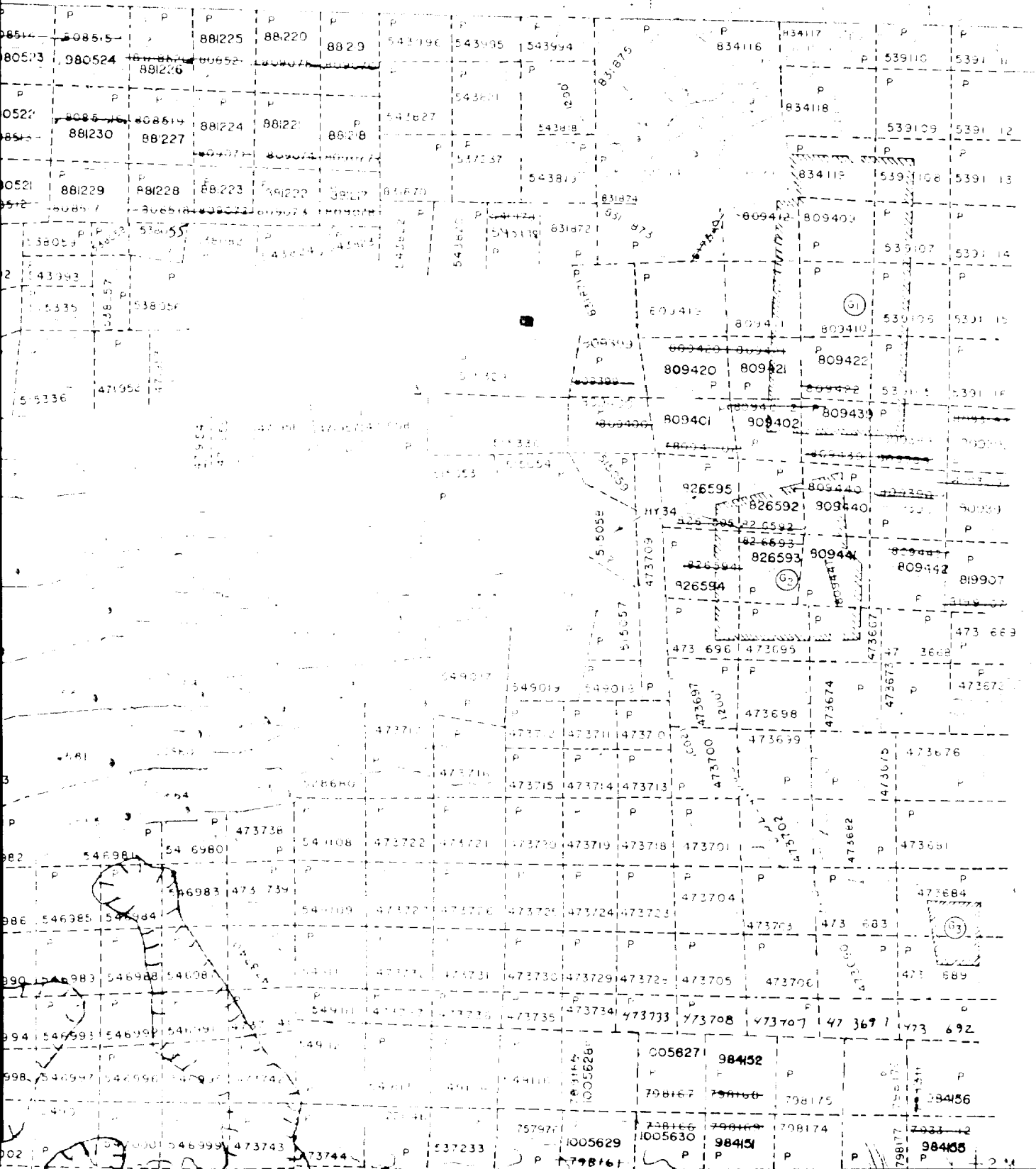

2-831873

2-538086

70'

90°

155'

20'

AST

17W
L30S

PICKET LINE

PICKET LINE 160°

40
20
60
80
100

- ☒ CLAIM POST
- PICKET LINE
- - - GEOLOGICAL CONTACT
- ✱ LOW, SWAMPY
- - - LIMIT OF POWER STRIPPING
- ⋯ QUARTZ VEINS

M. CLARKE
AUG./87

1" = 20'
CLAIM P-809419
CHESTER TOWNSHIP