



Ministry of Natural Resources Ontario

Chester + Brunnewiss Twp. #337

P-473081

W8106-337

THE MINING ACT REP
PORCUPINE MINING DIVI



41P125W5112 W8106-00337 CHESTER

010

To the Recorder of.....

I, HARGOR RESOURCES INC. T-954
name of Recorded Holder Prospector's Licence

3 Pine Street S. Suite 204, Timmins, Ontario P4N 2T9
Post Office Address

do hereby report the performance of 1,944 days of Power Stripping (Bulldozing)
type of work

not before reported to be applied on the following contiguous claims

Claim No.	Days	Claim No.	Days	Claim No.	Days
(SEE ATTACHED)					
.....
.....
.....
.....
.....
.....
.....

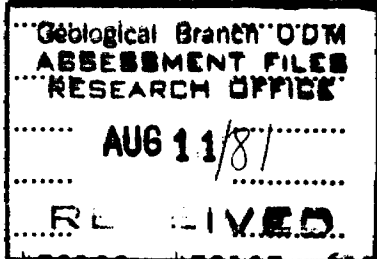

All the work was performed on Mining Claim (s) P-473103, 473107, 473120, 538086
(In the case of geological and/or geophysical survey (s) where more than 18 claims are involved attach a schedule)

READ CAREFULLY: THE FOLLOWING INFORMATION IS REQUIRED BY THE MINING RECORDER.

- For Manual Work, Stripping or Opening up of Mines, Sinking Shafts or Other Actual Mining Operations - Names and addresses of the men who performed the work and the dates and hours of their employment.
- For Diamond and other Core Drilling - Footage, No. and angle of holes and diameter of core. Name and address of owner or operator of drill. Dates when drilling was done. Signed core log and sketch in duplicate.
- For Compressed Air or Other Power Driven or Mechanical Equipment
Type of drill or equipment. Names and addresses of men engaged in operating equipment and the dates and hours of their employment.
- For Power Stripping - Type of equipment. Name and address of owner or operator. Amount expended. Dates on which work was done. Proof of actual cost must be submitted within 30 days of recording.
- With each of the above types of work sketches are required to show the location and extent of the work in relation to the nearest claim post. In the case of diamond or other core drilling the sketch must be submitted in duplicate.
- For Geophysical, Geological, Geochemical Surveys and Expenditure Credits - the name of author of report. Covering dates of survey (linecutting & office). Type of instrument used. Total amount of expenditure. Technical reports, maps, expenditure breakdown, receipts must be filed in duplicate with the Minister within 60 days of recording.
- For Land Survey - the name and address of Ontario Land surveyor.

The Required Information is as Follows: (Attach a list if this space is insufficient)

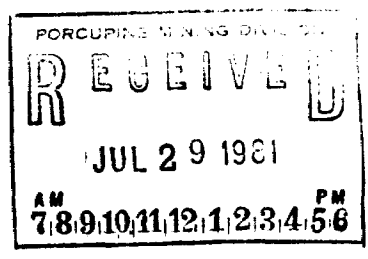
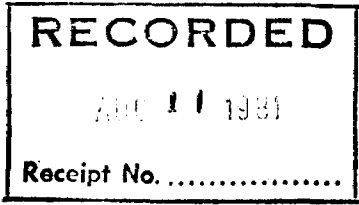

Date July 24, 1981

Lee Baucher
Signature of Recorded Holder or Agent

The Mining Act
Certificate Verifying Report of Work

I, Gordon Leliever
3 Pine Street S., Timmins, Ontario
(Post Office Address)

hereby certify:

- That I have a personal and intimate knowledge of the facts set forth in the report of work annexed hereto, having performed the work or witnessed same during and/or after its completion.
- That the annexed report is true.

Dated July 24, 1981

Gordon Leliever
Signature

THE PENALTY FOR MAKING A FALSE STATEMENT IN THIS REPORT AND/OR CERTIFICATE IS \$500. OR SIX MONTHS IMPRISONMENT OR BOTH

HARGOR RESOURCES

CHESTER & BENNEWEISS TOWNSHIP

<u>CLAIM NUMBERS</u>	<u>DAYS WORK</u>
P-473081	40
P-473082	40
P-473083	40
P-473084	40
P-473085	40
P-473086	90
P-473087	90
P-473088	90
P-473089	40
P-473090	40
P-473091	40
P-473092	100
P-473093	60
P-473094	60
P-473095	60
P-473096	60
P-473097	60
P-473098	60
P-473099	60
P-473100	60
P-473101	60
P-473102	100
P-473103	100
P-473104	120
P-473105	60
P-473106	60
P-473107	60
P-617820	140
P-539977	80

POWER STRIPPING

EQUIPMENT: Backhoe
MAKE: John Deere
OPERATOR: Robert Leliever & Gordon Leliever
Box 189, Gogama, Ontario
DATES: May 20 to June 10th, 1981
DAYS WORKED: 20
TOTAL HOURS: 12 X 20 days = 240 hours
RATES: \$54.00/hr. including operator

EXPENDITURE: \$54.00 x 240 = 12,960.
TOTAL DAYS: \$12,960. + 10 = 1,296 days

EQUIPMENT: Bulldozer
MAKE: John Deere
OPERATOR: Breck Manderstom, Box 189, Gogama,
Ontario
DATES: May 15 to June 3rd, 1981
DAYS WORKED: 10
TOTAL HOURS: 12 X 10 = 120 hours
RATES: \$54.00/hr. including operator
EXPENDITURE: \$54.00 x 120 = \$6,480.
TOTAL DAYS: \$6,480. + 10 = 648 days





TOTAL ASSESSMENT: 1,944 days

CLAIMS 32034 + 617820

TOWNSHIP OF CHESTER

SCALE: 1 INCH = 10 FEET

LEGEND

-  EDGE OF CLEARED LAND
-  TRENCH OR PIT
- 32033 CLAIM NUMBER
-  CLAIM LINE
-  CLAIM POST



41P125W5112 W8106-00337 CHESTER

900

32034

32033

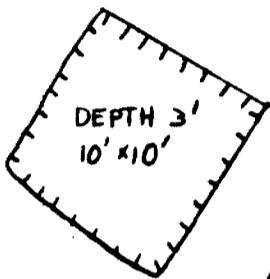

BEARING 260° - 23'

BEARING 242° - 23'

617820

473107

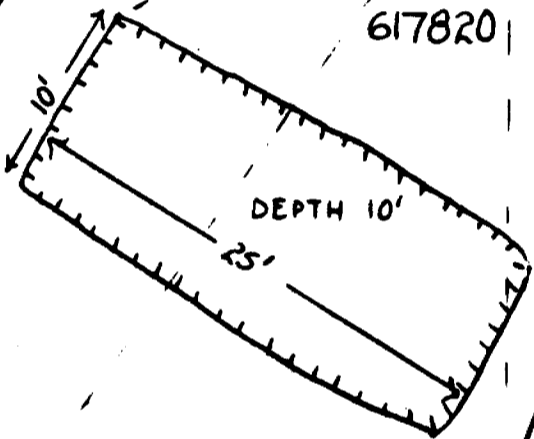

DEPTH 10'

25'

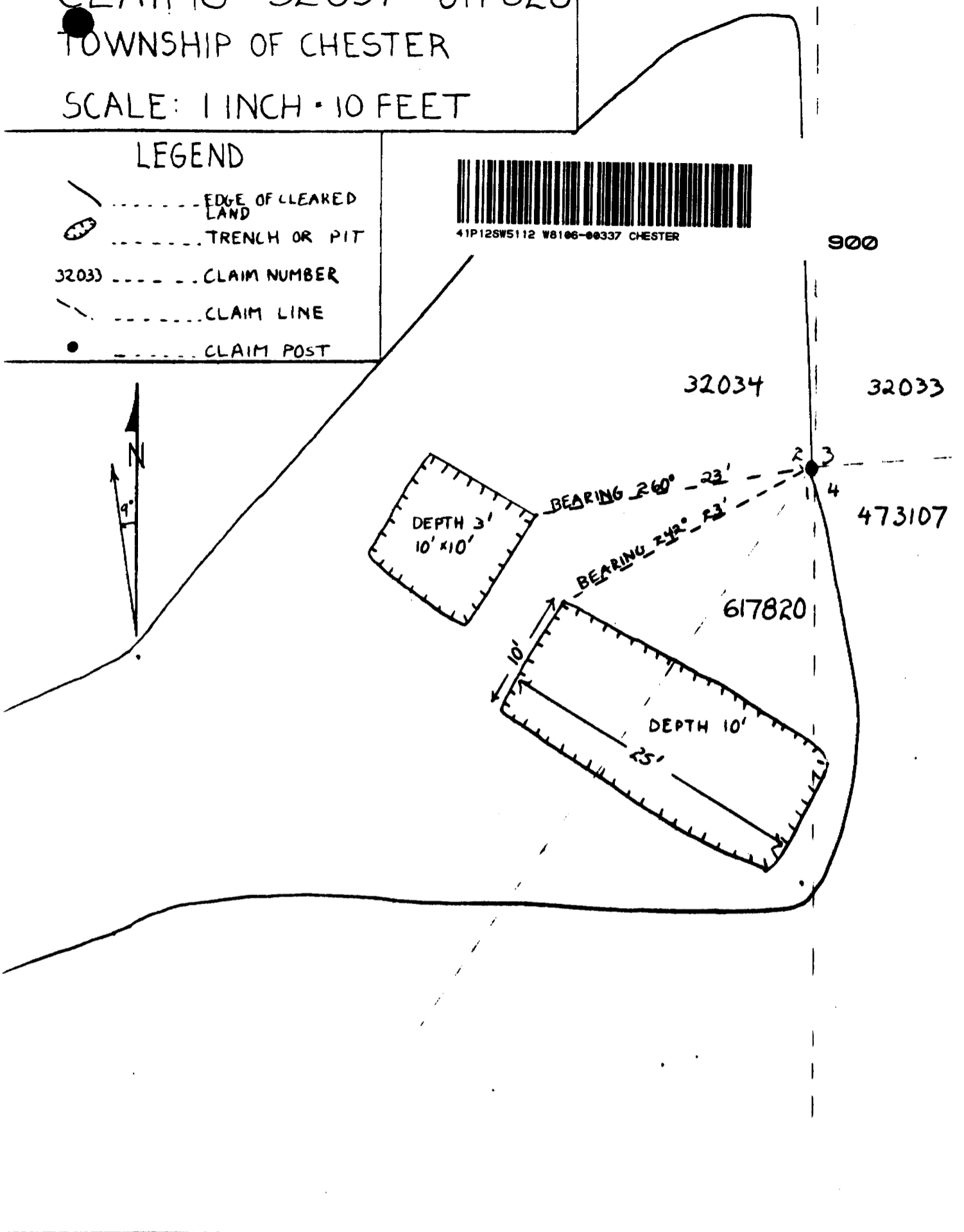

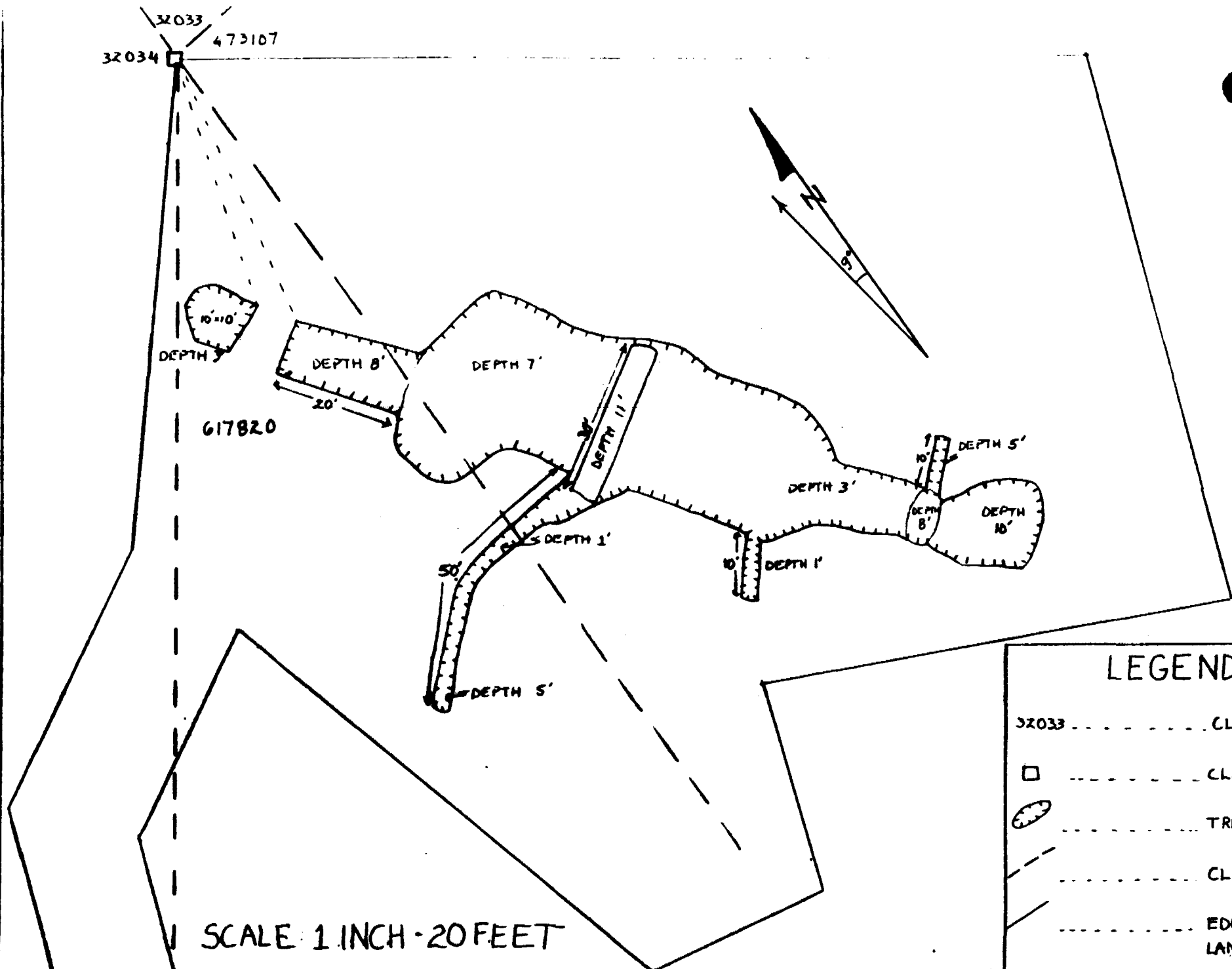

SCALE 1 INCH = 20 FEET

CLAIMS 473107 • 617820 TOWNSHIP OF CHESTER

LEGEND

- 32033 CLAIM NUMBER
- CLAIM POST
- TRENCH OR PIT
- - - - - CLAIM LINE
- EDGE OF CLEARED LAND

DATE: JUNE '81
DRAWN BY J. KUEHN

CLAIMS 538086, 473103 + 617820
 TOWNSHIP OF CHESTER

SCALE: 1 INCH = 20 FEET

DATE: MAY '81
 DRAWN BY: J KUEHN

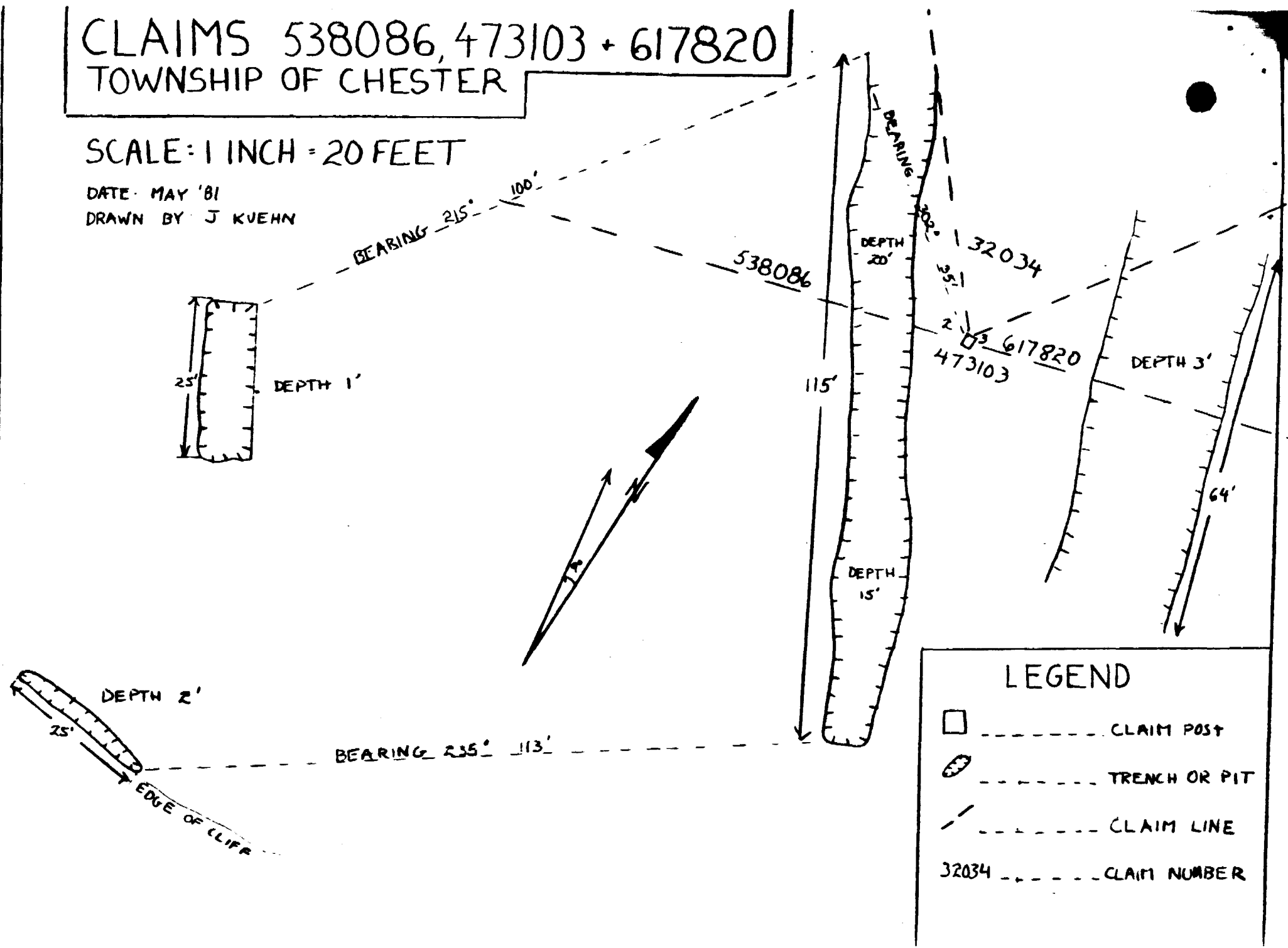

LEGEND

- CLAIM POST
- TRENCH OR PIT
- - - - CLAIM LINE
- 32034 CLAIM NUMBER