



Ministry of Natural Resources

OK
Chester J.P.
#165

W7906-11
THE MINING ACT REI



41P125W5152 W7906-00165 CHESTER

P. 438426

010

To the Recorder of TIMMINS

I, CANADIAN GHOST GOLD MINES LTD
name of Recorded Holder

Prospector's Licence

106 FIELDING ROAD SUDBURY
Post Office Address

do hereby report the performance of 48 days of

COBRA PLUGGER (Mechanical Equipment)
type of work

not before reported to be applied on the following contiguous claims

Claim No.	Days	Claim No.	Days
<u>438 431</u>	<u>5</u>	<u>438 426</u>	<u>5</u>
<u>438 432</u>	<u>5</u>	<u>438 427</u>	<u>5</u>
<u>438 433</u>	<u>5</u>	<u>438 428</u>	<u>8</u>
<u>438 434</u>	<u>5</u>		
<u>438 429</u>	<u>5</u>		
<u>438 430</u>	<u>5</u>		

Claim No. _____ Days _____
 Geological Branch ODM
 ASSESSMENT FILES
 RESEARCH OFFICE
 NOV 28 1979
 RECEIVED

All the work was performed on Mining Claim (s) 438 429
(In the case of geological and/or geophysical survey (s) where more than 18 claims are involved attach a schedule)

READ CAREFULLY: THE FOLLOWING INFORMATION IS REQUIRED BY THE MINING RECORDER.

- For Manual Work, Stripping or Opening up of Mines, Sinking Shafts or Other Actual Mining Operations - Names and addresses of the men who performed the work and the dates and hours of their employment.
- For Diamond and other Core Drilling - Footage, No. and angle of holes and diameter of core. Name and address of owner or operator of drill. Dates when drilling was done. Signed core log and sketch in duplicate.
- For Compressed Air or Other Power Driven or Mechanical Equipment
Type of drill or equipment. Names and addresses of men engaged in operating equipment and the dates and hours of their employment.
- For Power Stripping - Type of equipment. Name and address of owner or operator. Amount expended. Dates on which work was done. Proof of actual cost must be submitted within 30 days of recording.
- With each of the above types of work sketches are required to show the location and extent of the work in relation to the nearest claim post. In the case of diamond or other core drilling the sketch must be submitted in duplicate.
- For Geophysical, Geological, Geochemical Surveys and Expenditure Credits - the name of author of report. Covering dates of survey (linecutting & office). Type of instrument used. Total amount of expenditure. Technical reports, maps, expenditure breakdown, receipts must be filed in duplicate with the Minister within 60 days of recording.
- For Land Survey - the name and address of Ontario Land surveyor.

The Required Information is as Follows: (Attach a list if this space is insufficient)

COPECO COBRA PLUGGER - GAS DRIVEN. ROCK TRENCH
HAROLD BARRY 1260 ARVO ST SUDBURY - 6 DAYS AT 12 HRS PER DAY
ART ELLIOTT - BIRCH ISLAND ONT 6 DAYS AT 12 HRS PER DAY
WORK DONE ON JUNE 3, 4, 5, 6, 7, 8, 1979 BOTH MEN 12 HRS PER DAY
TOTAL OF 144 HRS 3 | 144 = 48 DAYS

Date Nov- 6 1979

Ed. Bloncourt
Signature of Recorded Holder or Agent

The Mining Act
Certificate Verifying Report of Work

I, Ed. Bloncourt
P.R.# 2 Site 38 Box 5 Sudbury
 (Post Office Address)

RECORDED
 NOV 16 1979
 Receipt No. _____

hereby certify:

- That I have a personal and intimate knowledge of the facts set forth in the report of work annexed here-to, having performed the work or witnessed same during and/or after its completion.
- That the annexed report is true.

Dated Nov- 6 1979 19

PORCUPINE MINING DIVISION
RECEIVED
 NOV 14 1979
 AM PM
 7 | 8 | 9 | 10 | 11 | 12 | 1 | 2 | 3 | 4 | 5 | 6

Ed. Bloncourt
Signature

file on 438429

THE PENALTY FOR MAKING A FALSE STATEMENT IN THIS REPORT AND/OR CERTIFICATE IS \$500. OR SIX MONTHS IMPRISONMENT OR BOTH



41P125W5152 W7906-00165 CHESTER

900

ROAD - CAN BE
TRAVELLED BY CAR

TO BAXTER
MINE
500'

BAXTER
MINERALS
100 TPD
FLotation
PLANT

CLAIM
8995

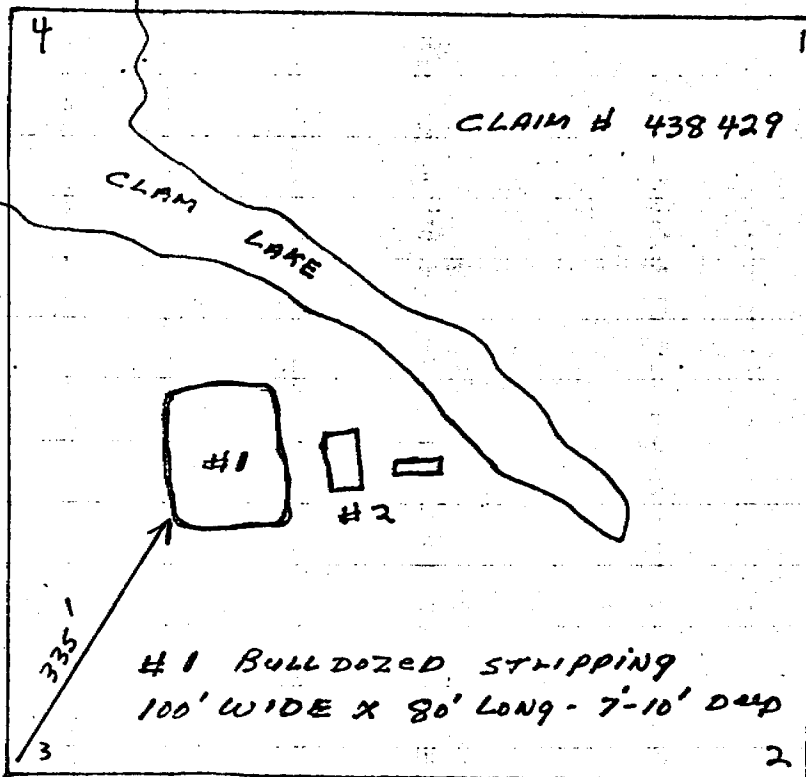

#1 BULLDOZED STRIPPING
100' WIDE X 80' LONG - 7'-10' DEEP

#2 ROCK TRENCH FOR BULK SAMPLE
TRENCH 6' DEEP 30' ~~LONG~~ LONG 8' WIDE
~~FOR~~ 50 TONS REMOVED FOR TEST.