

W7207-3



ONTARIO



41P126V5184 W7207-00003 CHESTER

010

THE MINING ACT REPORT OF WORK

recorded.

To the Recorder of SUDBURY Mining Division

KING BRIDGE MINES LTD T343
name of Recorded Holder Miner's Licence

SUITE 304, 67 YONGE ST TORONTO
Post Office Address

do hereby report the performance of 576 days of BULLDOZER STRIPPING type of work

not before reported to be applied on the following contiguous claims

Claim No.	Days	Claim No.	Days	Claim No.	Days
15212460	90 ✓	5220607	40 ✓	5220613	40 ✓
x5220602	40 ✓	5220608	40 ✓	5121594	3 ✓
x5220603	40 ✓	5220609	40 ✓	5118910	2 ✓
x5220604	40 ✓	5220610	40 ✓		
x5220605	40 ✓	5220611	41 ✓		
x5220606	40 ✓	5220612	40 ✓		

All the work was performed on Mining Claim (s) 5118910, 5121594, 5220611
(In the case of geological and/or geophysical survey (s) where more than 18 claims are involved attach a schedule)

READ CAREFULLY: THE FOLLOWING INFORMATION IS REQUIRED BY THE MINING RECORDER.

- For Manual Work, Stripping or Opening up of Mines, Sinking Shafts or Other Actual Mining Operations - Names and addresses of the men who performed the work and the dates and hours of their employment.
- For Diamond and other Core Drilling - Footage, No. and angle of holes and diameter of core. Name and address of owner or operator of drill. Dates when drilling was done. Signed core log and sketch in duplicate.
- For Compressed Air or Other Power Driven or Mechanical Equipment
Type of drill or equipment. Names and addresses of men engaged in operating equipment and the dates and hours of their employment.
- For Power Stripping - Type of equipment. Name and address of owner or operator. Amount expended. Dates on which work was done. Proof of actual cost must be submitted within 30 days of recording.
- With each of the above types of work sketches are required to show the location and extent of the work in relation to the nearest claim post. In the case of diamond or other core drilling the sketch must be submitted in duplicate.
- For Geological and Geophysical Survey - The names and addresses of men employed as well as dates. Type of instrument used in the case of geophysical survey. Reports and maps in duplicate must be filed with the Minister within 60 days of recording.
- For Land Survey - the name and address of Ontario Land surveyor.

The Required Information is as Follows: (Attach a list if this space is insufficient)

See attached Proof of cost.
WORK WAS PAID FOR BY BRIDGE HILL MINES LIMITED,
SYNTHOUSE SUITE, 121 RICHMOND ST., W., TORONTO, AND
PERFORMED BY W.R. MILLER, 9 FOXCOVE CR, FT. OBCOKE, ONT.
USING A JOHN DEERE 1010 BULLDOZER, CAB + WINCH, INCLUDING
OPERATING BY A. GUERTIN, KIRKLAND LAKE, ONT. KING BRIDGE MINES LIMITED.
LAWRENCE MURPHY DIRECTOR
 Date Dec 31/71 per W.R. Miller Agent
 Signature of Recorded Holder or Agent

The Mining Act Certificate Verifying Report of Work

KING BRIDGE MINES LIMITED W.R. Miller Agent
9 FOXCOVE CR FT OBCOKE ONT.
(Post Office Address)

hereby certify:

- That I have a personal and intimate knowledge of the facts set forth in the report of work mentioned here to, having performed the work or witnessed same during and/or after its completion.
- That the annexed report is true.

Dated Dec 31 19 71 W.R. Miller Signature JAN 4 1972

RECEIVED 7 8 9 10 11 12 13 14 15 16

5118910

LIABILITY FOR MAKING A FALSE STATEMENT IN THIS REPORT AND/OR CERTIFICATE IS \$500. OR SIX MONTHS IMPRISONMENT OR BOTH

JAN 4 1972



CHESTER TOWNSHIP, ONTARIO.

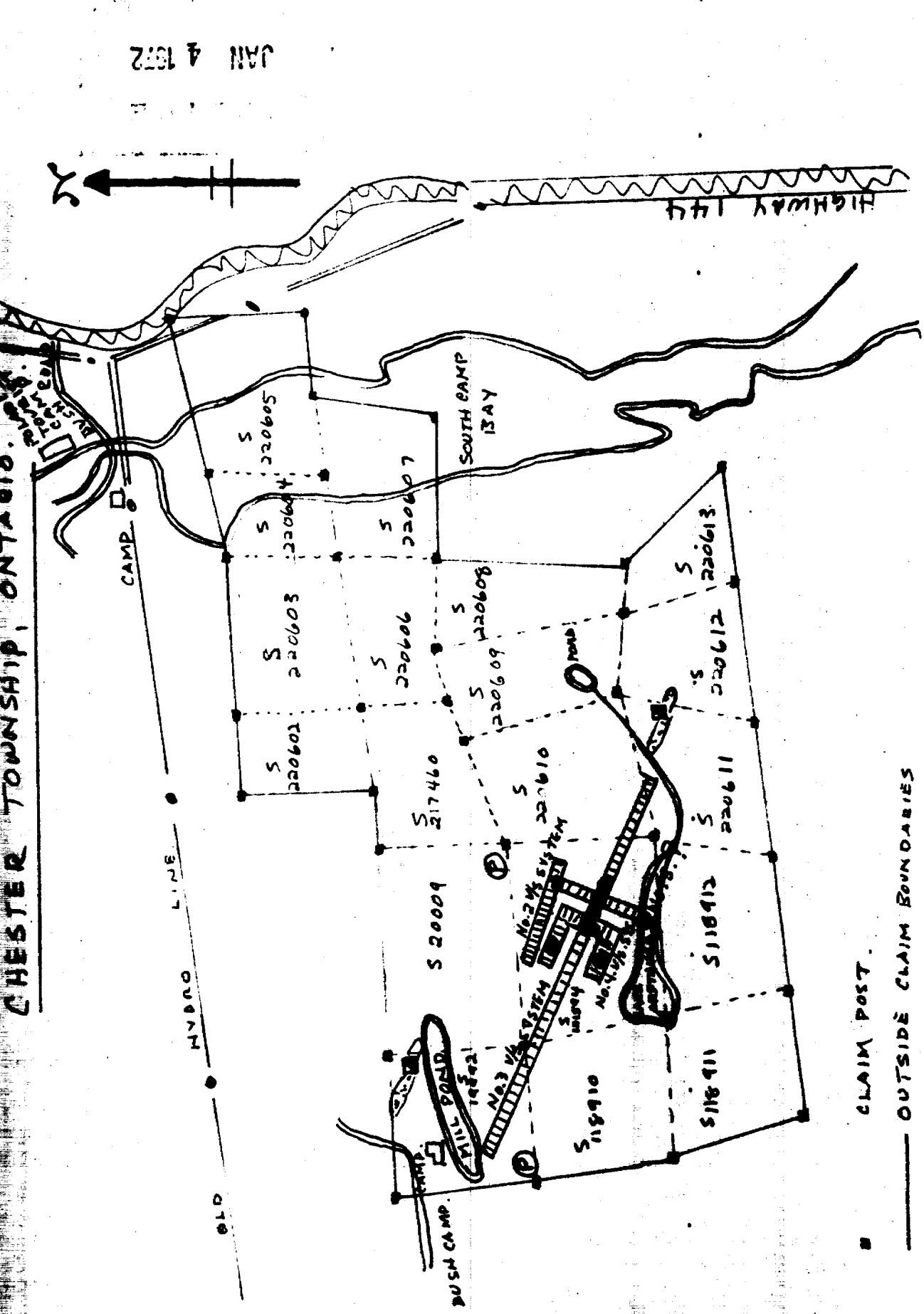

SCALE 0 M. 1/4 M. 1/2 M.

1" = 1/4 MILE.
 2" = 1/2 MILE.
 3" = 3/4 MILE.

- CLAIM POST.
- OUTSIDE CLAIM BOUNDARIES
- - - INSIDE CLAIM BOUNDARIES.
- OLD SHAFTS
- ▨ STRIPPED + CLEARED AREA.
- HIGH GRADE GOLD
- ▭ UNDERGROUND WORKINGS.

Sketch by
 W.K. Dicks Dec 31, 1971

9 Foxcote Cres..
Etobicoke, Ont..
Nov 22 1971.

To The President & Directors,
Bridgehill Mines Ltd.,
Penthouse Suite,
121 Richmond St. W.,
Toronto, Ont.

Subject: Detailed break down promised by letter dated
Sept 27, 1971 in regards to con tracts # 1 and
2 dated July 14th 1971 on the company's
Chester township claims.

Dear Sirs:

Please be advised that by order of the company's
consultant W. Walker, P. Eng. that # 2 contract, although
prepared for, was pre-empted by a continuance of # 1 contract
because of excellent results of the # 1 contract exploration
methods. The following is a fully explained breakdown & costs.

1. Bulldozer (John Deere 1010) with operator 480 hours @ \$12.00 per hour	\$5760.00
2. Slesher with chain saw 3 weeks @ \$125.00 per week	\$ 375.00
3. Helper for shovel mucking, plugger, small tools etc. 16 weeks @ \$125.00 per week	\$2000.00
4. Foreman (dynamite detonator, plugger operator mechanic etc.) 4 weeks @ \$150.00 per week	\$ 600.00
5. Supervision W.R. Miller includes accomodating Company officials, guests, expediting, sampling etc. 8 weeks @ \$200.00 per week	\$1600.00
6. Plugger (Punjar portable gasoline powered) 4 months @ \$150.00 per month	\$ 600.00
7. Jeeps 2-4 by 4 full time vehicles including repairs, gasoling and maintenance 16 weeks @ \$50.00 per week for each vehicle	\$1600.00
8. Pumps for 1 month @ 50.00 per month	\$ 50.00
9. G.W.10 Winkie Drill available for 2 months fully equipped including diamond bits 2 months @ \$250.00 per month	\$ 500.00
10. Company Consultant Assistance by E. Logan for W. Walker and W. Hammerstrom includes petrographic sampling and regular sampling 6 weeks @ \$150.00 per week	\$ 900.00
11. Access Bush Road (see bulldozer)	N.C.
TOTAL	\$13,985.00

N.B. As agreed by letter dated Sept 27/71 the undersigned
agrees to accept the amount of \$12,000.00 as payment in full.

Received July 15 1971	\$4000.00
Received July 15 1971	\$4000.00
Received Sept 8 1971	\$4000.00

This account is now paid in full.

JAN 4 1972

Respectfully submitted,

W. R. Miller
W. R. Miller.