



41P14NE0003 35 MIDLOTHIAN

010

DIAMOND DRILLING

TOWNSHIP: MIDLOTHIAN

REPORT NO: 35

WORK PERFORMED FOR: Gold Mines Ltd.

RECORDED HOLDER: Same as Above [xx]  
: Other [ ]

<u>Claim No.</u>	<u>Hole No.</u>	<u>Footage</u>	<u>Date</u>	<u>Note</u>
943481	G-38	269.5 M	Jan/88	(1)

Notes: (1) #W8806.214, filed in Dec/88

GOLDTECK MINES LTD.  
DIAMOND  
DRILL LOG AND SAMPLE RECORD  
HOLE NUMBER: G-38

Location: Stairs Project  
Northing: 55+10  
Easting: 29+50  
Elevation: .0  
Length: 269.5

Core Size: BQ  
Date Collared: December 16, 1987  
Date Completed: January 7, 1988  
Logged By: P. Folk

Depth	Dip	Azimuth
0.	-50.0	132.0
25.5	-49.0	132.0
85.5	-35.5	134.0
145.5	-30.0	137.0
205.5	-26.0	142.0
265.5	-22.0	145.0

*W.A. Seeger, P. Eng.*

From(m)	To(m)	Code	Core Description
0.	4.5	OB	OVERBURDEN
4.5	26.5	3A	CONGLOMERATE Greenish, a few qtz. veinlets 8.0 5cm qtz., tr py, chlorite 21.4 3cm banded limonitic qtz. 21.8-26.5 abundant marcasite nodules
26.5	39.7	3C	SANDSTONE & SILTSTONE Fine grained, with sheared argillite beds.
39.7	43.2	3B	PEBBLE CONGLOMERATE Traces py.
43.2	54.0	3C-D	ARKOSE AND ARGILLITE Mixed, well banded, fine grained. Tops up hole. 51.2-52.3 irregular white qtz. veining
54.0	58.0	3B	FOLIATED PEBBLE CONGLOMERATE Marcasite rich near bottom contact.
58.0	63.1	3CR	FELSIC ROCKS . SEDIMENT OR VOLCANIC Light greenish, fine grained. Pebble conglomerate interbeds. 62.5-63.1 pebble conglomerate, 3B. 10cm qtz. vein at bottom
63.1	73.8	2BR	RHYOLITE LAPILLI TUFF Sericitic rich, 2% argillite. Small rounded clasts. 69.4 10cm qtz. vein
73.8	79.4	3D	ARGILLITE
79.4	82.6	2BR	RHYOLITIC LAPILLI TUFF Sericitic alteration. Note leucoxene.
82.6	95.4	2CR	RHYOLITE TUFF Fine grained. Increasingly hard downwards, ie. decreasing sericitic alteration. A few coarse interbeds. 90.0 26cm white qtz.

m(m)	To(m)	Code	Core Description
95.4	100.2	2BR	RHYOLITE LAPILLI TUFF 2% dark argillite shards
100.2	114.4	2CR	RHYOLITE TUFF Fine grained. Sandy qtz. rich tuff. 104.2-103.7 sandy argillite beds
114.4	122.2	3B	PEBBLY GREYWACKE 10% argillite pebbles. Some argillite beds. Faulted lower contact with qtz. veining. 122.7 24cm qtz. ser.
122.2	133.3	2CR	RHYOLITE TUFF Sericitic.
133.3	139.4	3B	PEBBLY SEDIMENTS Mixed with thin bedded argillites, 10% argillite pebbles 137.0-137.4 white qtz., traces py on fractures, 1% py in walls
139.4	146.0	2CR	RHYOLITE TUFF Weakly sericitic, fine grained.
146.0	147.7	3B	PEBBLY SEDIMENTS Thin bedded, finer grained interbeds.
147.7	157.4	2BR	RHYOLITE LAPILLI TUFF With minor sedimentary interbeds. 156.7 qtz. veinlets in sedimentary bed
157.4	170.5	2CR	CRYSTAL TUFF Hard, qtz. rich and siliceous gritty ash. Weak qtz. veining. Light grey- brown-green volcanic flows, dykes or sills at 168.4-169.2, 169.5-170.0 168.4 5cm banded qtz., tr py, ser, chlorite 170 - 22 cm pyritic qtz. 1% py, broken, sericitic bands. Note specks leucoxene
170.5	203.7	3D	ARGILLITE AND GREYWACKE Argillite is thinly bedded and greywacke is fine grained. 1-2% qtz. veinlets throughout. Traces py. 195 - note greenish blue mineral on shear planes 198.8 - 199.1 white qtz., weakly pyritized walls
203.7	212.8	2CR	RHYOLITE PYROCLASTIC Spotted, fine grained.
212.8	214.5	3D	ARGILLITE 212.5 24cm qtz. at pyroclastic- sediment contact.

From(m)	To(m)	Code	Core Description
214.5	236.3	2CR	RHYOLITE PYROCLASTIC Fine grained with a few sedimentary beds containing qtz. 228.5-229.7 qtz. veinlets associated with contorted sediments 234.4 35cm qtz. veinlets with black sediments. Tr py.
236.3	243.4	2BR	RHYOLITE LAPILLI TUFF Weakly silicified. 1% qtz. veinlets. Traces chromic mica. 241.0 7cm qtz. vein, black banding
243.4	254.5	3D-2CR	RHYOLITE PYROCLASTICS AND SEDIMENTS Mixed, fine grained. Qtz. stringers throughout. Traces fine py along bedding. 254.0 10cm true width banded qtz.- sericite, tr py.
254.5	269.5 269.5	2CR	RHYOLITE CRYSTAL TUFF E.O.H.

# MONTROSE

HALLIDAY TWP. (M. 910)

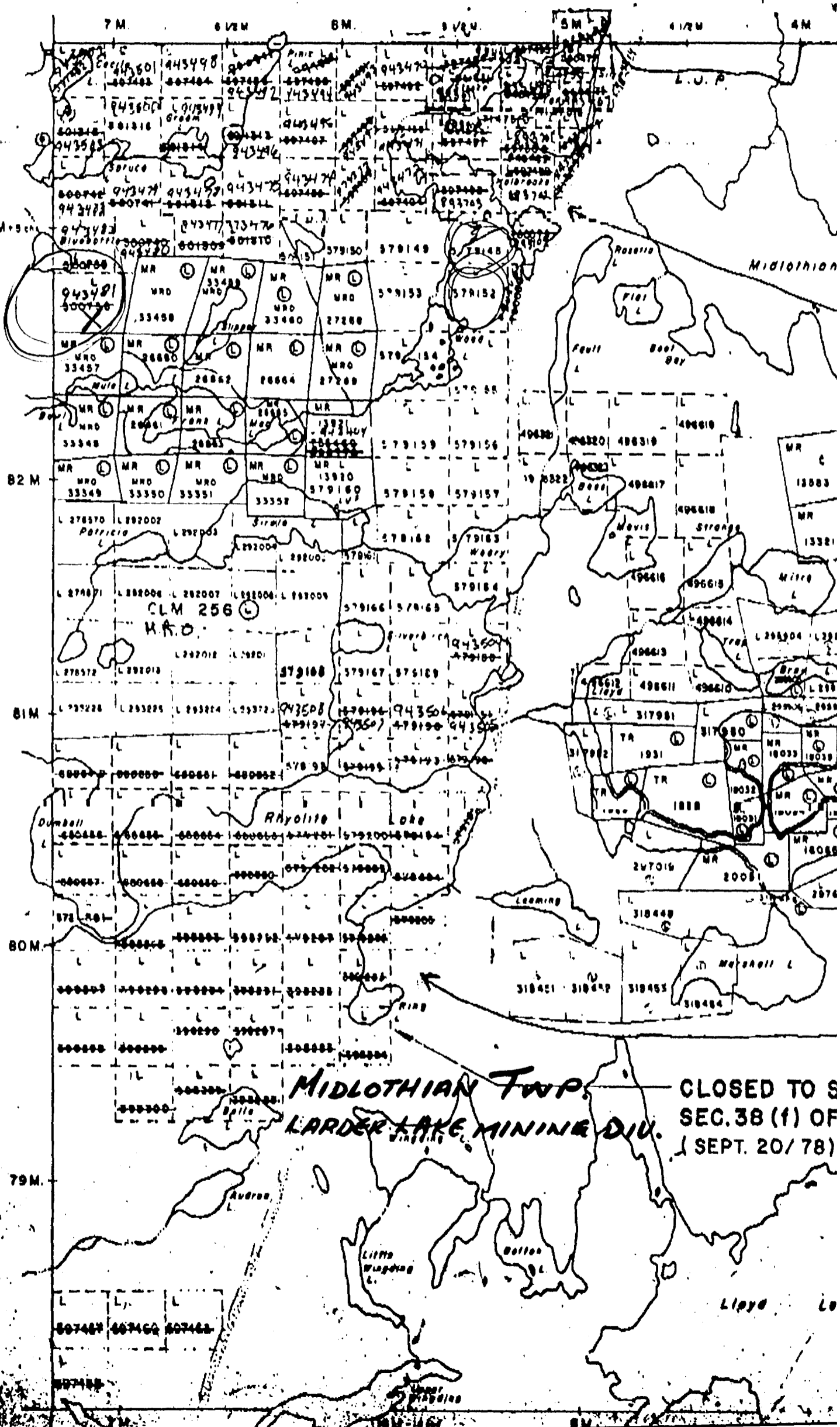

**MIDLOTHIAN TWP.**  
**LARDER LAKE MINING DIV.**  
 CLOSED TO S. SEC. 38 (1) OF (SEPT. 20/78)

PI 943521

Scale: 1:2000

T.L. 55-00m

CEDAR BOG

60 00m

G33

G38

G24

G30

60 00m

E3034/30  
E3035/30  
D3040/30

P3 943481

P2 943516

PI 943515

PI 943522

L. 943522

CEDAR BOG

CEDAR RES

Baseline 50-00m

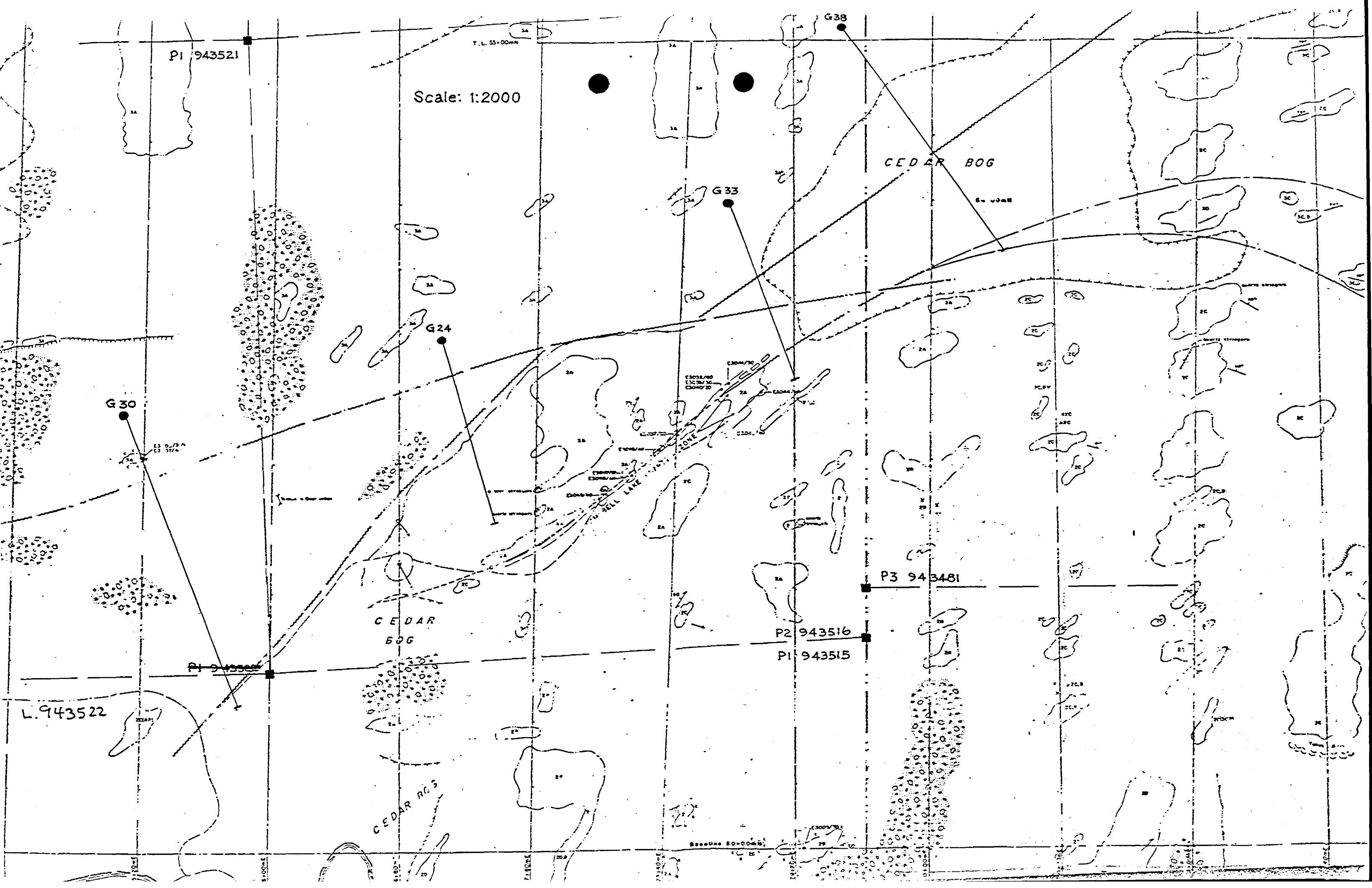



W8806.214 Minin

Name and Postal Address of Recorded Holder  
**Goldteck Mines Limited** | T - 4753  
 P.O. Box 170, 1 First Canadian Place, Toronto, Ontario | **HALLIDAY TWP M5X 1G9**

Summary of Work Performance and Distribution of Credits

Total Work Days pr. claimed 3400	Mining Claim			Mining Claim			Mining Claim		
	Prefix	Number	Work Days Cr.	Prefix	Number	Work Days Cr.	Prefix	Number	Work Days Cr.
for Performance of the following work. (Check one only)  <input type="checkbox"/> Manual Work  <input type="checkbox"/> Shaft Sinking Drifting or other Lateral Work.  <input type="checkbox"/> Compressed Air, other Power driven or mechanical equip.  <input type="checkbox"/> Power Stripping  <input checked="" type="checkbox"/> Diamond or other Core drilling  <input type="checkbox"/> Land Survey	P	984160	200	P	984168	200	P	984180	200
		984161	200		984169	200		984181	200
		984162	200		984170	200		984182	200
		984163	200					984183	200
		984164	200					984184	200
		984165	200					984185	200
		984166	200						
	984167	200							

All the work was performed on Mining Claim(s): 943516, 943521 & 943522 (Halliday); 943481' (Midlothian)

Required Information eg: type of equipment, Names, Addresses, etc. (See Table Below)

Don Groleau Diamond Drilling Ltd.,  
 P.O. Box 98, 324 Government Road, Kapuskasing, Ontario P5N 2Y1

Hole No.	Drilling dates	Depths (metres)
G 24	Dec 1 - 6, 1987	240.5
G 30	Dec 7 - 11, 1987	293.9
G 33	Dec 11-15, 1987	232.9
G 38	Dec 16/87-Jan 7/88	269.5

Total 1036.8 metres = 3401.1887

APR 14 1988

ONTARIO GEOLOGICAL SURVEY  
 ASSESSMENT FILES  
 OFFICE  
 JUL 21 1988  
 RECEIVED

RECORDED  
 APR 14 1988

Date of Report: April 11/88  
 Recorded By (Signature): *[Signature]*

Certification Verifying Report of Work

I hereby certify that I have a personal and intimate knowledge of the facts set forth in the Report of Work annexed hereto, having performed the work or witnessed same during and/or after its completion and the annexed report is true.

Name and Postal Address of Person Certifying  
**T. G. Robinson** 1390 Copeland Street  
 North Bay, Ontario P1B 3G3  
 Date Certified: April 11/88  
 Certified by (Signature): *[Signature]*

Table of Information/Attachments Required by the Mining Recorder

Type of Work	Specific information per type	Other information (Common to 2 or more types)	Attachments
Manual Work	Nil	Names and addresses of men who performed manual work/operated equipment, together with dates and hours of employment.	Work Sketch: these are required to show the location and extent of work in relation to the nearest claim post.
Shaft Sinking, Drifting or other Lateral Work			
Compressed air, other power driven or mechanical equip.	Type of equipment	Names and addresses of owner or operator together with dates when drilling/testing	
Power Stripping	Type of equipment and amount expended. Note: Proof of actual cost must be submitted within 30 days of recording.		