



41P14NE0007 37 MIDLOTHIAN

010

DIAMOND DRILLING

TOWNSHIP: MIDLOTHIAN

REPORT NO: 37

WORK PERFORMED FOR: Goldteck Mines Ltd.

RECORDED HOLDER: Same as Above [xx]
: Other []

| <u>Claim No.</u> | <u>Hole No.</u> | <u>Footage</u> | <u>Date</u> | <u>Note</u> |
|------------------------------|-----------------|----------------|-------------|-------------|
| 579148 | G 25 | 204m | Dec/87 | (1) |
| | G 23 | 177m | Dec/87 | (1) |
| 579152 | G 23 | 177m | Dec/87 | (1) |
| | G 68 | 228m | Feb/87 | (1) |
| 893704/ 579152/ 943405 | G 68 | 228m | Feb/87 | (1) |

5 5041

1014 m

Notes: (1) #W8806.215, filed in Dec/88

GOLDTECK MINES LTD.
DIAMOND
DRILL LOG AND SAMPLE RECORD
HOLE NUMBER: G-23

Location: Stairs Project
Northing: 56+40
Easting: 60+40
Elevation: .0
Length: 177.0

Core Size: BQ
Date Collared: December 1, 1987
Date Completed: December 3, 1987
Logged By: P.Folk

| Depth | Dip | Azimuth |
|-------|-------|---------|
| 0. | -45.0 | 187.0 |
| 29.0 | -44.0 | 187.0 |
| 65.0 | -42.5 | 185.0 |
| 101.0 | -39.5 | 185.0 |
| 137.0 | -37.0 | 182.0 |
| 173.0 | -34.5 | 181.0 |

W.A. Bejcek P.Eng

| From(m) | To(m) | Code | Core Description |
|---------|-------|-------|--------------------------------------------------------------------------------------------------------------------------------------------------------------------------------------------------------------------------------------------------------------------------------------------------------------------------------------------------------------------------------------------------------------------------------------------------------------------------------------------------------|
| .0 | 3.0 | OB | OVERBURDEN |
| 3.0 | 51.3 | 3A | CONGLOMERATE Weakly altered, chloritic alt, traces weakly alteration. 12. Marcasite nodules with silica rinds. 21.7 5 cm banded qtz. vein, brown sericite-chlorite bands tr. py. marcasite in footwall. 22.7 5 cm similar vein traces py. 26.1 2cm lim. qtz. 37.5 - 38.7 Qtz. veinlets at poor angle. Weak chromic alt. 43.5 6 cm qtz. plus stringers. Chromic alt. Tr py. 47.9 - 48.6 Qtz. stringers. 49.4 - 51.2 Qtz. stringers, chromic alt. Tr Py. |
| 51.3 | 55.8 | 3C | ARKOSE Fine bedded with some gritty sections. 52.5 - 53.1 3 qtz. veins each about 3 cm traces Cp. |
| 55.8 | 83.0 | 3A | CONGLOMERATE Weakly altered conglomerate minor ser, shl. silica. 77. 2 lcm qtz. veinlets. |
| 83.0 | 104.7 | 3A Cr | CONGLOMERATE Foliated chromic. Strong chromic alteration, sericite - Fe Carb. Polymict. 83.5 13 cm sheared broken qtz. vein. 84.5 5 cm sheared broken qtz. vein. Shear on hanging wall. |

| From(m) | To(m) | Code | Core Description |
|---------|-------|-------|----------------------------------------------------------------------------------------------------------------------------------------------------------------------------------------------------------------------------------------------------------------------------------------------|
| 83.0 | 104.7 | 3ACr | CONGLOMERATE (Con't) 91.7 - 98.5 Weak qtz. stringer zone, 12 stringers about 1 cm or less. Most of them are almost perpendicular to the foliation. Zone contains abundant bright green chromic alteration. |
| 104.7 | 109.5 | 3C | ARKOSE Brownish. Weak sericitic and Fe carb alt. 109 - 109.5 Foliated, sericitic. |
| 109.5 | 119.4 | 3A Cr | CONGLOMERATE Chromic gradually decreasing grain size. Bright green chromic alt. Weakly foliated. 119.0 2 cm grey dolomite vein with qtz. |
| 119.4 | 128.6 | 3B | PEBBLY CONGLOMERATE TO BROWN PEBBLY ARKOSE down hole. 122.2 9 cm pyritic qtz. dolomitic vein within a dark grey brown pyrite zone. 126. Note: Pebbly arkose is somewhat similar to coarse qtz. crystal tuff. |
| 128.6 | 134.2 | 3C | ARKOSE & CLAYSTONE Arkose is brown and fine grained. Qtz. vein and stringer zones. 129.4 nicely banded qtz.-dol vein py, chl. white sericite. Brown foliated rock with marcasite in footwall. 131.2 4 cm qtz.-dol-chlorite vein. 132. - 132.9 Weak irregular qtz. stringer zone. |
| 134.2 | 137.1 | 3A Cr | CONGLOMERATE Chromic, pebbles and cobbles. |
| 137.1 | 140.7 | 3C | ARKOSE & MUDSTONE Arkose is fine grained, leucoxene spots and Fe Carb spotted alteration. 139.6 5 cm sheared qtz. vein. 140.8 two 1 cm stringers at 30 degrees. 142.5 3 cm white qtz.' |
| 140.7 | 177.0 | 3A Si | CONGLOMERATE Buff colored silicified. Traces chromic alt. 145.5 1 cm qtz. 146.4 4 cm white qtz. Tr Py, ser. 148.9 2 cm qtz. vein with hairline sulfide band in middle. Note increase in Fe Carb, alt. spots |

| From(m) | To(m) | Code | Core Description |
|---------|-------|------|------------------|
|---------|-------|------|------------------|

| | | | |
|-------|-------|-------|-------------------------------------------------------------------------------------------------------------------------------------------------------------------------|
| 140.7 | 177.0 | 3A Si | CONGLOMERATE (Con't) downward. 153 Small fracture zone traces qtz. 160 A few qtz. stringers to end of hole. 176.5 2 cm irregular banded qtz. veinlet. |
| | 177.0 | | EOH |

GOLDTECK MINES LTD.
 ASSAYS AND SAMPLE RECORD
 HOLE NUMBER:

G-23

| Sample No. | From | To | Au(ppb) | Au(ckpt) | Ag(ppm) |
|------------|-------|-------|---------|----------|---------|
| S1460 | 21.0 | 22.0 | 28 | -123.0 | -123.0 |
| S0224 | 21.6 | 22.7 | 6 | -123.0 | -123.0 |
| S0225 | 37.4 | 38.8 | -5 | -123.0 | -123.0 |
| S0226 | 43.2 | 43.8 | 5 | -123.0 | -123.0 |
| S0227 | 47.9 | 48.6 | -5 | -123.0 | -123.0 |
| S0228 | 49.4 | 50.4 | -5 | -123.0 | -123.0 |
| S0229 | 50.4 | 51.0 | -5 | -123.0 | -123.0 |
| S0230 | 51.0 | 51.8 | -5 | -123.0 | -123.0 |
| S0231 | 51.8 | 57.5 | 16 | -123.0 | -123.0 |
| S0232 | 52.5 | 53.1 | 12 | -123.0 | -123.0 |
| S0235 | 83.4 | 84.5 | 16 | -123.0 | -123.0 |
| S0236 | 93.0 | 94.5 | 230 | -123.0 | -123.0 |
| S0237 | 94.5 | 96.0 | 16 | -123.0 | -123.0 |
| S0238 | 96.0 | 97.5 | 20 | -123.0 | -123.0 |
| S0239 | 108.8 | 109.6 | 65 | -123.0 | -123.0 |
| S1454 | 121.0 | 122.0 | 8 | 8.0 | -123.0 |
| S1455 | 122.5 | 123.5 | 21 | -123.0 | -123.0 |
| S0240 | 122.0 | 122.5 | 629 | -123.0 | -123.0 |
| S1453 | 127.9 | 128.9 | 12 | -123.0 | -123.0 |
| S0241 | 128.9 | 129.7 | 2450 | -123.0 | -123.0 |
| S0242 | 129.7 | 130.9 | 64 | -123.0 | -123.0 |
| S0243 | 130.9 | 131.4 | 104 | -123.0 | -123.0 |
| S0244 | 131.4 | 132.9 | 99 | -123.0 | -123.0 |
| S0245 | 139.5 | 141.0 | 21 | -123.0 | -123.0 |
| S1461 | 143.6 | 144.6 | 12 | -123.0 | -123.0 |
| S0246 | 145.4 | 146.5 | 25 | -123.0 | -123.0 |
| S0247 | 148.8 | 149.0 | 30 | -123.0 | -123.0 |
| S1462 | 149.2 | 150.2 | -5 | -123.0 | -123.0 |
| S1463 | 158.0 | 159.0 | 96 | 75.0 | -123.0 |
| S0249 | 176.4 | 176.7 | 12 | -123.0 | -123.0 |

130

GOLDTECK MINES LTD.
DIAMOND
DRILL LOG AND SAMPLE RECORD
HOLE NUMBER: G-25

Location: Stairs Project
Northing: 57+50
Easting: 59+60
Elevation: .0
Length: 204.0

Core Size: BQ
Date Collared: December 3, 1987
Date Completed: December 5, 1987
Logged By: P.Folk

| Depth | Dip | Azimuth |
|-------|-------|---------|
| 0. | -44.0 | 183.0 |
| 8.0 | -43.0 | 183.0 |
| 56.0 | -41.0 | 183.0 |
| 104.0 | -38.0 | 182.0 |
| 152.0 | -38.0 | 184.0 |
| 200.0 | -37.0 | 181.0 |

WR Hoyer P. Folk

| From(m) | To(m) | Code | Core Description |
|---------|-------|-------|------------------------------------------------------------------------------------------------------------------------------------------------------------------------------------------------------------------------------------------------------------------------------------------------------------------------------------------------------------------------------------------------------------------------------------------------------------------------------------------------------------------------------------------------------------------------------------------------------------------------------------------------------------------------------------------------------------------------------------------------------------------------------------------------------------------------------------------------------------------------------------------------------------------|
| .0 | 4.5 | OB | OVERBURDEN |
| 4.5 | 12.3 | 3A CR | CONGLOMERATE & PEBBLE CONGLOMERATE Chromic. A few qtz.-dolomite veinlets. 5.3 2 banded limonitic qtz. veinlets. Traces Cp and Py. Relatively weak chromic alteration. 7.1 5 cm well banded qtz. vein chloritic bands. 10.2 White-grey 5 cm qtz. vein traces Py, Cp. Weakly altered. 23.0 9 cm rusty qtz. 31.7 12 cm qtz. vein with rusty walls, minor py, sericite. specks tourmaline? 34.2 6 cm qtz. vein. 43.6 foliated qtz.-sericite zone at poor core angle. 46. Note irregular dolomitic alteration as tension fractures and veins. 47.3 qtz. dolomite veining at 25 degrees. 53 Dolomite- Qtz. alt and veining. 67.4 Patchy dolomite alt. 68 Qtz. at 68.1 73.8 3 cm qtz.. vein and 2 cm qtz. dol vein Tr py marc. nodules in footwall. 80.0 5 cm banded qtz. vein traces py. 85 Increasing silicification |

| From(m) | To(m) | Code | Core Description |
|---------|-------|-------|-------------------------------------------------------------------------------------------------------------------------------------------------------------------------------------------------------------------------------------------------------------------------------------------------------------------------------------------|
| 12.3 | 127.2 | 3A | CONGLOMERATE & PEBBLY CONGLOMERATE (Con't) 87.4 2 CM qtz.-dol. 88.2 3 cm Dark grey banded qtz. vein. 96.7 Cp bearings white qtz in siliceous altered conglomerate, weak foliation. 105.6 4 cm qtz. traces Cp. Traces chromic alt. 107.9 12 cm qtz. 116 A few marcasite nodules. 119.1 6 cm banded qtz. vein with py. |
| 127.2 | 133.2 | 3C | SEDIMENTS Massive to schistose and foliated. Light to dark grey. 130.2 12 cm bed of marcasite nodules. 125.5 5 cm qtz. |
| 133.2 | 178.6 | 3A | CONGLOMERATE Weakly silicified, sericitized. 138.0 4 cm qtz.-dol wein in a foliated zone. Traces only py. 141.6 3 cm banded qtz. dol. 145 1 cm qtz. 154.3 3 cm grey banded qtz. 152 Weak chromic alt. 153 Scattered marcasite nodules. 171 Weak chromic alt. |
| 178.6 | 186.7 | 3C | SANDSTONE & GRIT. Poorly bedded with weak sericit alt. towards bottom contact. |
| 186.7 | 193.8 | 3A Si | CONGLOMERATE Strongly foliated silicified . Only a few small qtz. veinlets. Brown sericitic alt. Only traces py. Spotted carbonate alt. |
| 193.8 | 199.8 | 3C | SANDSTONE Fine grained grey sediment. 198.8 4cm qtz.-dol Tr Py. |
| 199.8 | 204.0 | 3A Si | CONGLOMERATE Silicified, carbonate spotted. 203 5 cm mixed qt6z.-carb-sericite. |
| | 204.0 | | EOH |

GOLDTECH MINES LTD.
 ASSAYS AND SAMPLE RECORD
 HOLE NUMBER:

G-25

| Sample No. | From | To | Au(ppb) | Au(chk) | Ag(ppm) |
|------------|-------|-------|---------|---------|---------|
| S0248 | 5.0 | 5.5 | 18 | 17.0 | -123.0 |
| S0301 | 6.9 | 7.2 | 17 | -123.0 | -123.0 |
| S0302 | 10.1 | 10.9 | 14 | -123.0 | -123.0 |
| S0303 | 22.9 | 23.5 | 17 | -123.0 | -123.0 |
| S0304 | 25.5 | 26.4 | 16 | -123.0 | -123.0 |
| S0337 | 31.4 | 32.2 | 21 | -123.0 | -123.0 |
| S0338 | 34.0 | 34.4 | -5 | -123.0 | -123.0 |
| S0339 | 43.5 | 44.1 | 21 | -123.0 | -123.0 |
| S0340 | 47.2 | 47.5 | 14 | -123.0 | -123.0 |
| S0341 | 51.8 | 52.5 | 8 | -123.0 | -123.0 |
| S0342 | 52.5 | 54.0 | 53 | -123.0 | -123.0 |
| S0343 | 67.4 | 68.3 | 10 | -123.0 | -123.0 |
| S0344 | 73.5 | 74.5 | 11 | -123.0 | -123.0 |
| S0345 | 79.7 | 80.5 | 14 | -123.0 | -123.0 |
| S0346 | 87.4 | 88.3 | 10 | -123.0 | -123.0 |
| S0347 | 96.5 | 97.0 | -5 | -123.0 | -123.0 |
| S0348 | 105.5 | 105.7 | 5 | -123.0 | -123.0 |
| S0349 | 107.8 | 108.0 | 10 | -123.0 | -123.0 |
| S0350 | 119.0 | 119.2 | -5 | -123.0 | -123.0 |
| S0351 | 130.1 | 130.8 | 20 | -123.0 | -123.0 |
| S0352 | 132.0 | 132.6 | 9 | -123.0 | -123.0 |
| S0354 | 137.9 | 138.1 | 11 | -123.0 | -123.0 |
| S0355 | 154.2 | 154.5 | 11 | -123.0 | -123.0 |
| S0356 | 186.7 | 187.5 | 25 | -123.0 | -123.0 |
| S0357 | 187.5 | 189.0 | 5 | -123.0 | -123.0 |
| S0358 | 189.0 | 190.5 | 6 | -123.0 | -123.0 |
| S0359 | 190.5 | 192.0 | -5 | -123.0 | -123.0 |
| S0360 | 192.0 | 193.5 | 9 | -123.0 | -123.0 |
| S0361 | 193.5 | 195.0 | 8 | -123.0 | -123.0 |
| S0362 | 198.2 | 199.0 | -5 | -123.0 | -123.0 |
| S0363 | 203.0 | 203.6 | 16 | -123.0 | -123.0 |

31

GOLDTECK MINES LTD.
DIAMOND
DRILL LOG AND SAMPLE RECORD
HOLE NUMBER: G-68

Location: Stairs Project
Northing: 56+20
Easting: 61+20
Elevation: .0
Length: 228.0

Core Size: BQ
Date Collared: February 11, 1988
Date Completed: February 13, 1988
Logged By: P.FOLK

| Depth | Dip | Azimuth |
|-------|-------|---------|
| .0 | -44.0 | 183.0 |
| 20.0 | -44.0 | 183.0 |
| 68.0 | -40.0 | 180.0 |
| 116.0 | -28.5 | 174.0 |
| 164.0 | -25.5 | 176.0 |

W.R. Meyer, P.Eng

| From(m) | To(m) | Code | Core Description |
|---------|-------|-------|---------------------------------------------------------------------------------------------------------------------------------------------------------------------------------------------------------------|
| .0 | 3.0 | OB | OVERBURDEN |
| 3.0 | 12.0 | 3A | CONGLOMERATE Slightly bleached. Broken and limonitic from 3.0 - 7.0. 8.9 5 cm qtz. vein. |
| 12.0 | 37.3 | 3A CR | CONGLOMERATE Foliated chromic. Some sericite alt. 17.8 - 18.9 qtz. stringer zone. 20.9 - 23.9 1 to 2 cm limonitic quartz vein parallel to core. 29.0 2 cm quartz at 10 degrees. |
| 37.3 | 42.0 | 3A | CONGLOMERATE Sericite alt. with qtz. veins. 40.2 10 cm qtz-dolomite vein at 60 degrees. |
| 42.0 | 47.2 | 3B | PEBBLY CONGLOMERATE With sandy greywacke. |
| 47.2 | 49.2 | 3C | GREYWACKE Sheared fine grained. |
| 49.2 | 68.3 | 3A CR | CONGLOMERATE Well foliated chromic. 56.5 3cm quartz. 58.0 22 cm quartz. Traces py, some shearing. 62.0 35 cm broken qtz. Quartz veining in footwall. 64.7 - 65.4 irregular qtz. veining. |
| 68.3 | 74.8 | 3C | SEDIMENTS Fine grained grey and brown. |
| 74.8 | 116.8 | 3A CR | CONGLOMERATE Chromic. 78.6 1 cm qtz. vein. 85.6 - 86.5 2 cm qtz. parallel to core. |

| From(m) | To(m) | Code | Core Description |
|---------|-------|-------|---------------------------------------------------------------------------------------------------------------------------------------------------------------|
| 116.8 | 118.2 | 3B | GREYWACKE-CONGLOMERATE Sheared. |
| 118.2 | 137.8 | 3A CR | CONGLOMERATE Weakly chromic altered. |
| 137.8 | 140.8 | 3B | PEBBLY ARKOSE |
| 140.8 | 159.4 | 3A CR | CONGLOMERATE Highly altered chromic. Bleaching towards lower contact. 154.8 3cm quartz. 156.1 5 cm qtz.-dolomite vein. In marcasite nodules. |
| 159.4 | 183.0 | 3A SI | CONGLOMERATE Spotted buff colored silicified. 174.2 3 cm qtz.-dolomite vein. 176.3 25 cm qtz.-dolomite vein zone, weak shearing and sericite alt. |
| 183.0 | 228.0 | 3A | CONGLOMERATE Green relatively unaltered. 218.8 2 cm banded qtz. vein at 65 degrees. 228.0 E.O.H. |

HOLBROOKE

LAKE

Scale: 1:2000

BOG

CEDAR BOG

CEDAR BOG

579148

893704

G25

G23

G68

PI 579152

579152

943405

ALTERATION

ZONE

CARBONATE

CEDAR

BOG

LAKE

P2 943405
P3 943405

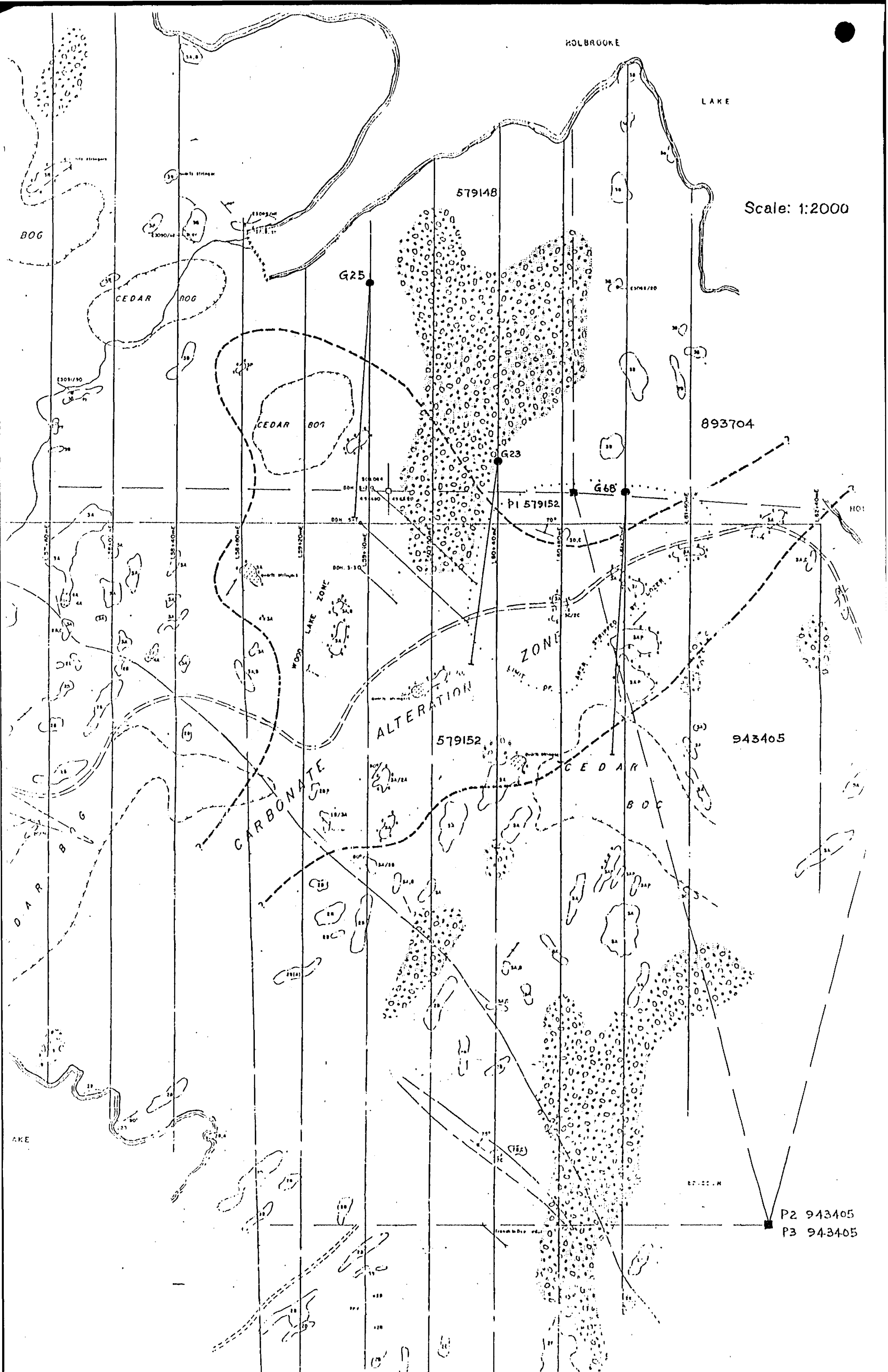



Ministry of Northern Development and Mines

Report of Work

W8806.00215

C (R) 60C

Mining 8



41P14NE0007 37 MIDLOTHIAN

900

| | |
|-----------------------------------------------------------------------------|---------------------------------------------|
| Name and Postal Address of Recorded Holder Goldteck Mines Limited | Prospector's Licence No. T - 4753 |
| P.O. Box 170, 1 First Canadian Place, Toronto, Ontario M5X 1G9 | |

| Total Work Days Cr. claimed 1920 | Mining Claim | | | Mining Claim | | | Mining Claim | | |
|-------------------------------------------------------------------------------------------------------------------------------------------------------------------------------------------------------------------------------------------------------------------------------------------------------------------------------------------------------------------------------------------------------------------------|--------------|--------|---------------|--------------|--------|---------------|--------------|--------|---------------|
| | Prefix | Number | Work Days Cr. | Prefix | Number | Work Days Cr. | Prefix | Number | Work Days Cr. |
| for Performance of the following work. (Check one only) <input type="checkbox"/> Manual Work <input type="checkbox"/> Shaft Sinking Drifting or other Lateral Work. <input type="checkbox"/> Compressed Air, other Power driven or mechanical equip. <input type="checkbox"/> Power Stripping <input checked="" type="checkbox"/> Diamond or other Core drilling <input type="checkbox"/> Land Survey | L | 943532 | 80 | L | 943540 | 80 | L | 943548 | 80 |
| | | 943533 | 80 | | 943541 | 80 | | 943549 | 80 |
| | | 943534 | 80 | | 943542 | 80 | | 943550 | 80 |
| | | 943535 | 80 | | 943543 | 80 | | 943551 | 80 |
| | | 943536 | 80 | | 943544 | 80 | | 943552 | 80 |
| | | 943537 | 80 | | 943545 | 80 | | 943553 | 80 |
| | | 943538 | 80 | | 943546 | 80 | | 943554 | 80 |
| | 943539 | 80 | | 943547 | 80 | | 943555 | 80 | |

All the work was performed on Mining Claim(s): **(579148, 579152, 893704 & 943405)**

Required Information eg: type of equipment, Names, Addresses, etc. (See Table Below)

**St. Lambert Drilling Co., Ltd.,
P.O. Box 473, Valleyfield, Quebec J6S 4V7**

**ONTARIO GEOLOGICAL SURVEY
ASSESSMENT FILES
OFFICE
JUL 21 1988
RECEIVED**

| Hole No. | Drilling Dates | Depths (metres) |
|--------------|-------------------|---------------------------------|
| G 23 | Dec 1 - 3, 1987 | 177.0 |
| G 25 | Dec 3 - 5, 1987 | 204.0 |
| G 68 | Feb 11 - 13, 1988 | 228.0 |
| Total | | 609.0 metres = 1997 feet |

**RECEIVED
MAY 3 1988**

**RECORDED
MAY 03 1988**

| | |
|--------------------------------------|---------------------------------------------------------------|
| Date of Report April 11/88 | Recorded by Holder or Agent (Signature) <i>T. Robinson</i> |
| Revised April 29/88 | |

Certification Verifying Report of Work
I hereby certify that I have a personal and intimate knowledge of the facts set forth in the Report of Work annexed hereto, having performed the work or witnessed same during and/or after its completion and the annexed report is true.

| | | |
|--------------------------------------------------------------------------------------------|--------------------------------------|------------------------------------------------|
| Name and Postal Address of Person Certifying T. G. Robinson 1390 Copeland Street | Date Certified April 11/88 | Certified by (Signature) <i>T. Robinson</i> |
| North Bay, Ontario P1B 3G3 | April 29/88 | |

| Type of Work | Specific information per type | Other information (Common to 2 or more types) | Attachments |
|---------------------------------------------------------|--------------------------------------------------------------------------------------------------------------------|-----------------------------------------------------------------------------------------------------------------------|----------------------------------------------------------------------------------------------------------------|
| Manual Work | Nil | Names and addresses of men who performed manual work/operated equipment, together with dates and hours of employment. | Work Sketch: these are required to show the location and extent of work in relation to the nearest claim post. |
| Shaft Sinking, Drifting or other Lateral Work | Type of equipment | | |
| Compressed air, other power driven or mechanical equip. | Type of equipment and amount expended Note: Proof of actual cost must be submitted within 30 days of recording. | Names and addresses of owner or operator together with dates when drilling/stripping | |
| Power Stripping | | | |

HUTT Twp. M-943

SOTIMAN Twp. M-1121

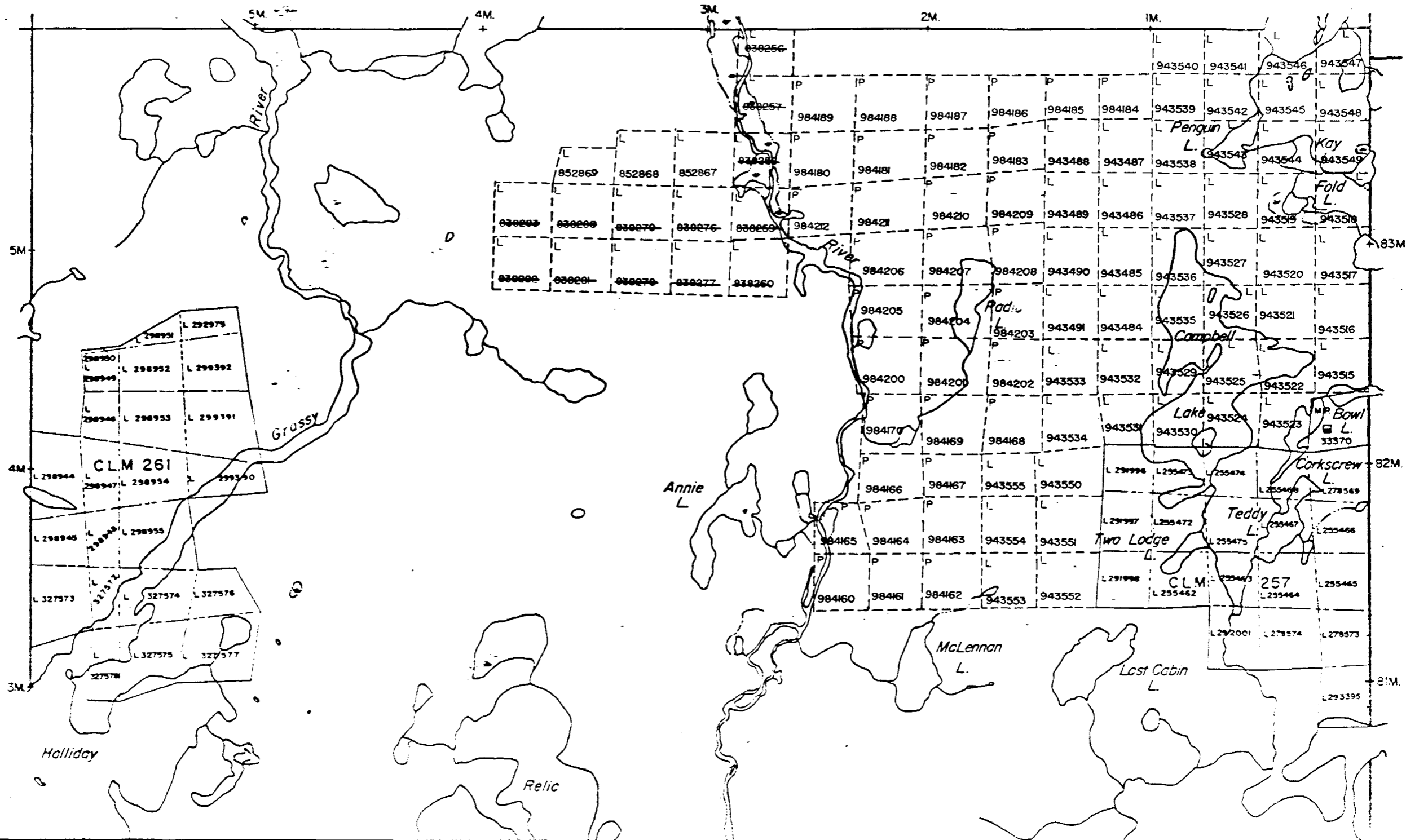

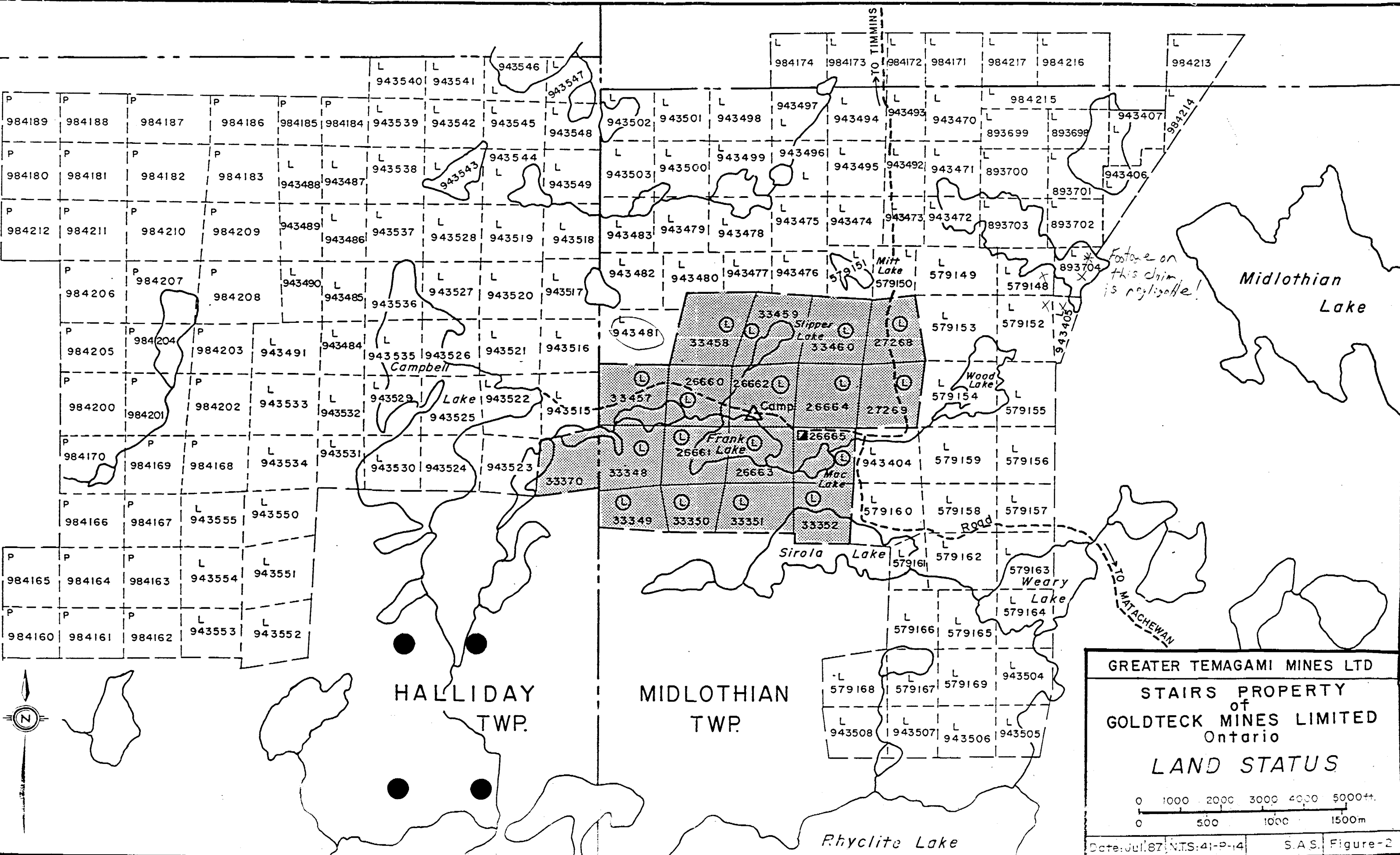

GREATER TEMAGAMI MINES LTD

STAIRS PROPERTY
of
GOLDTECK MINES LIMITED
Ontario

LAND STATUS

0 1000 2000 3000 4000 5000ft.
0 500 1000 1500m

Date: Jul. 87 N.T.S.: 41-P-14 S.A.S. Figure-2