



41P14NE0015 32 MIDLOTHIAN

010

DIAMOND DRILLING

TOWNSHIP: MIDLOTHIAN TWP.

REPORT NO:32

WORK PERFORMED FOR: Goldteck Mines Ltd.

RECORDED HOLDER: Same as Above [xx]  
: Other [ ]

<u>Claim No.</u>	<u>Hole No.</u>	<u>Footage</u>	<u>Date</u>	<u>Note</u>
L 579152	S-1	130m	Feb/87	(1) (2) (3)
	S-2	130m	Feb/87	(1) (2) (3)
	S-3	47m	Feb/87	(1) (2) (3)

NOTES: (1) #404-87, filed in April/88.

(2) 3 pgs DDH sections added from OM86-6-P-258,  
July 1989

(3) <sup>For</sup> DDH summary, refer to TORONTO file #63.5024

L59+20mE

L59+60mE

L60+00mE

L60+40mE

L60+80mE . . . L61

D.D.H. S-2

#1 Post  
CLAIM L 579152

D.D.H. S-1

D.D.H. S-3

LIMIT . . . OF . . .

AREA . . . STRIPPED

C E D A

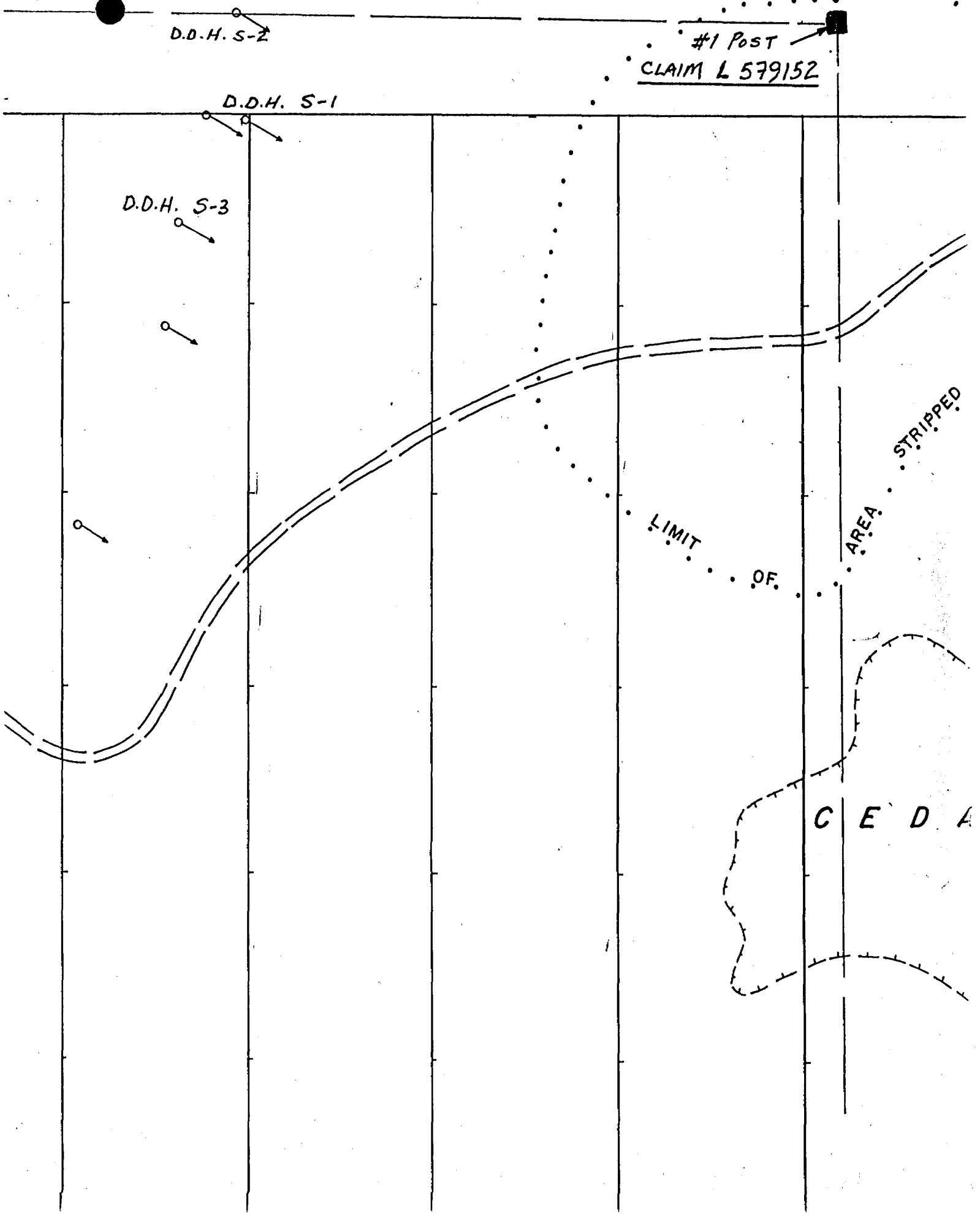









L 943555	L 943550
L 943554	L 943551
L 943553	L 943552

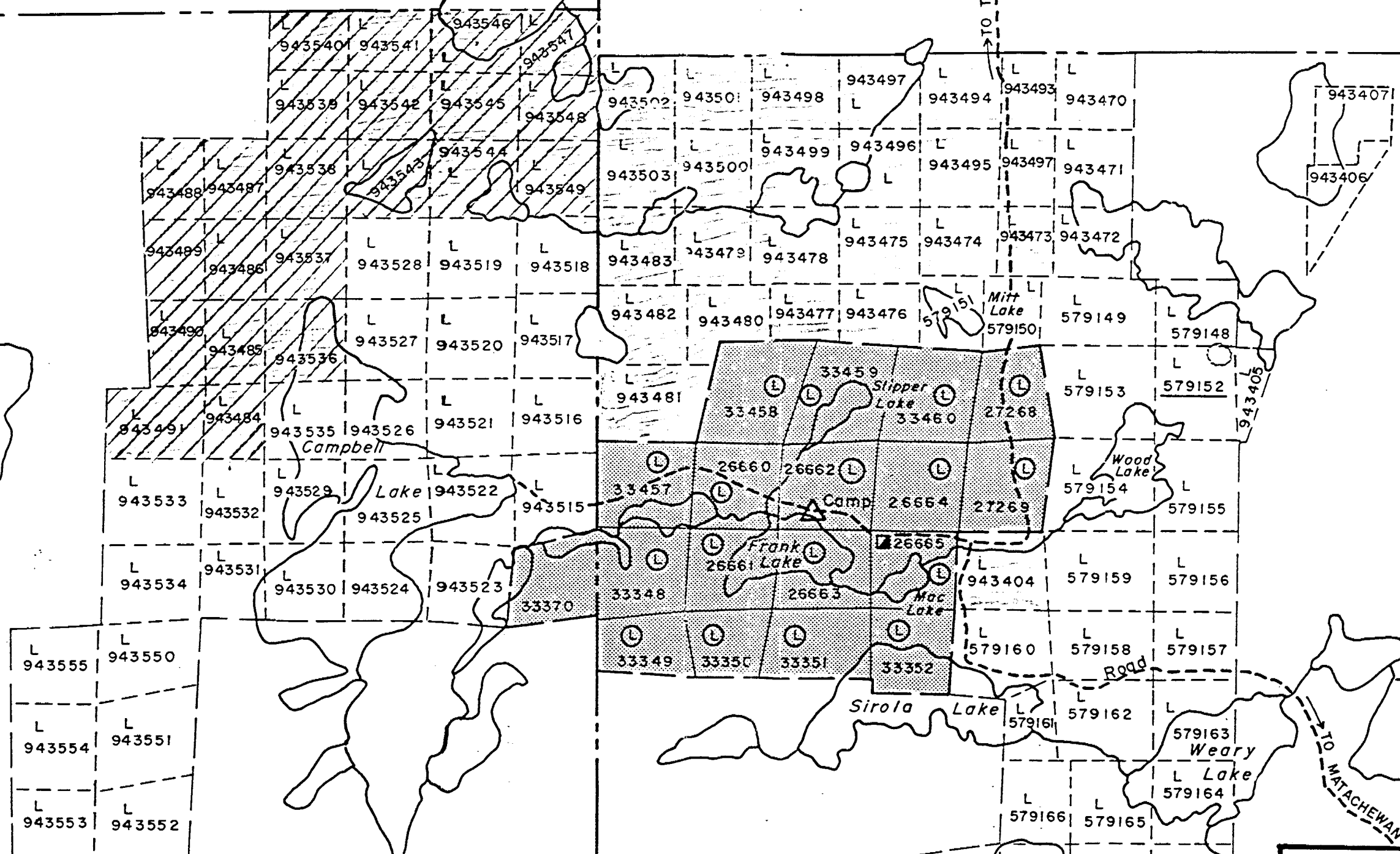

HALLIDAY  
TWP.

MIDLOTHIAN  
TWP.

Midlothian  
Lake

Rhyolite Lake

GREATER TEMAGAMI MINES LTD		
STAIRS PROPERTY of GOLDTECK MINES LIMITED Ontario		
LAND STATUS		
0 1000 2000 3000 4000 5000ft. 0 500 1000 1500m		

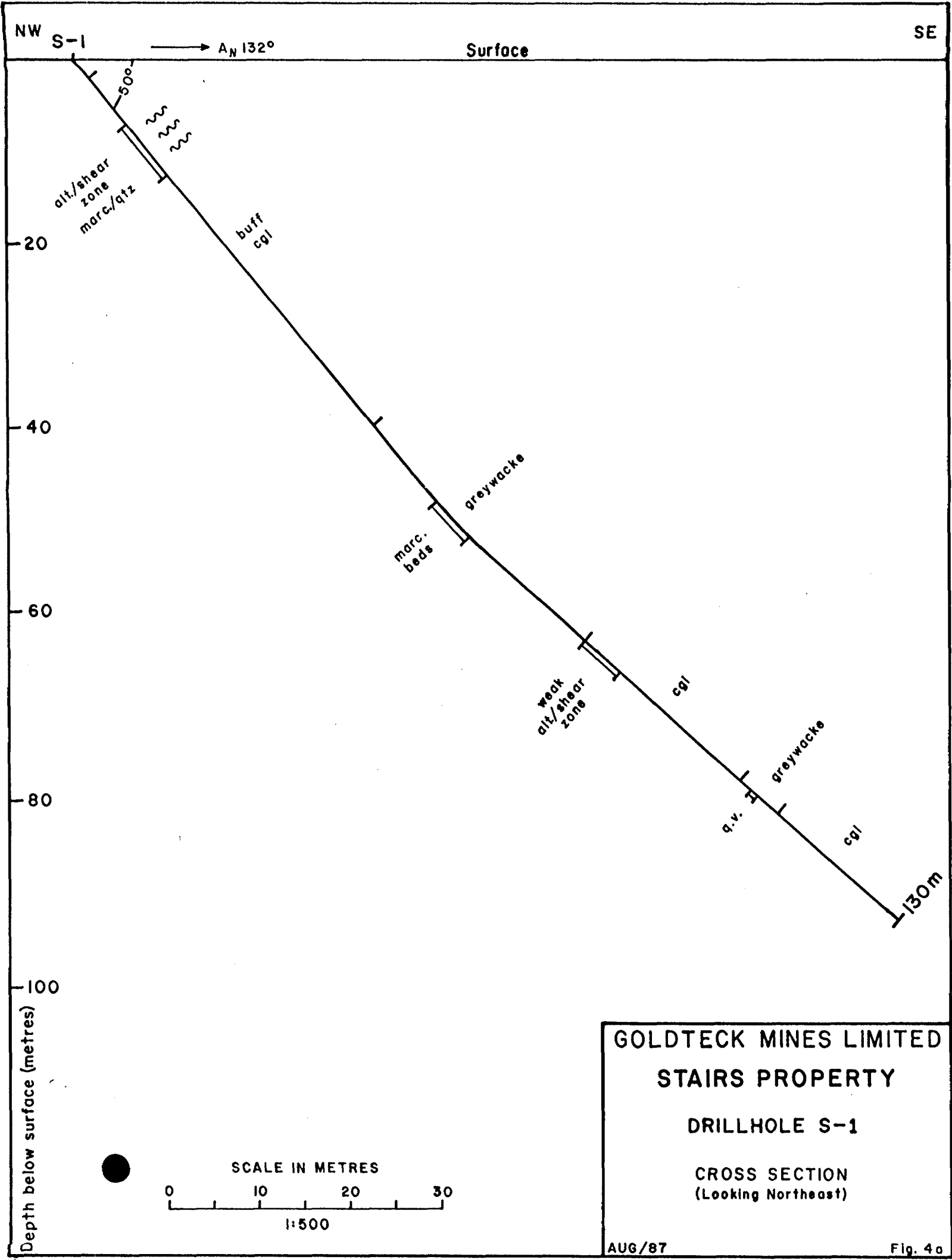

NW S-2 AN 132° Surface SE

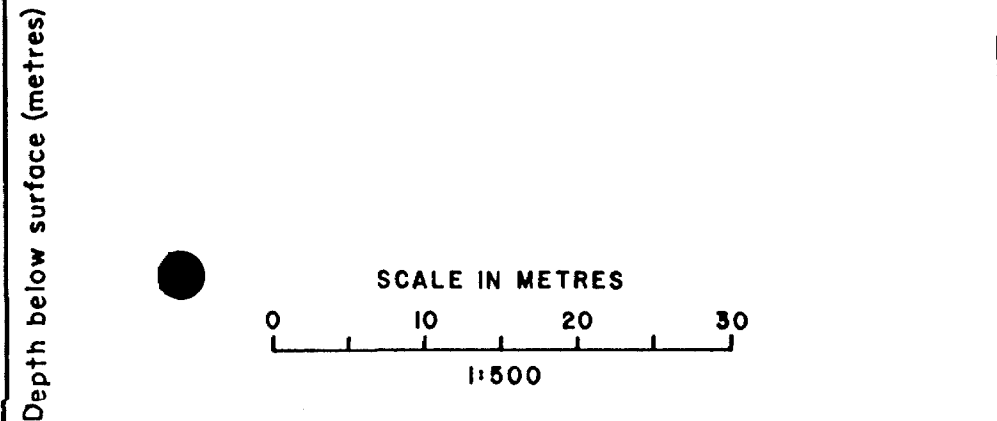
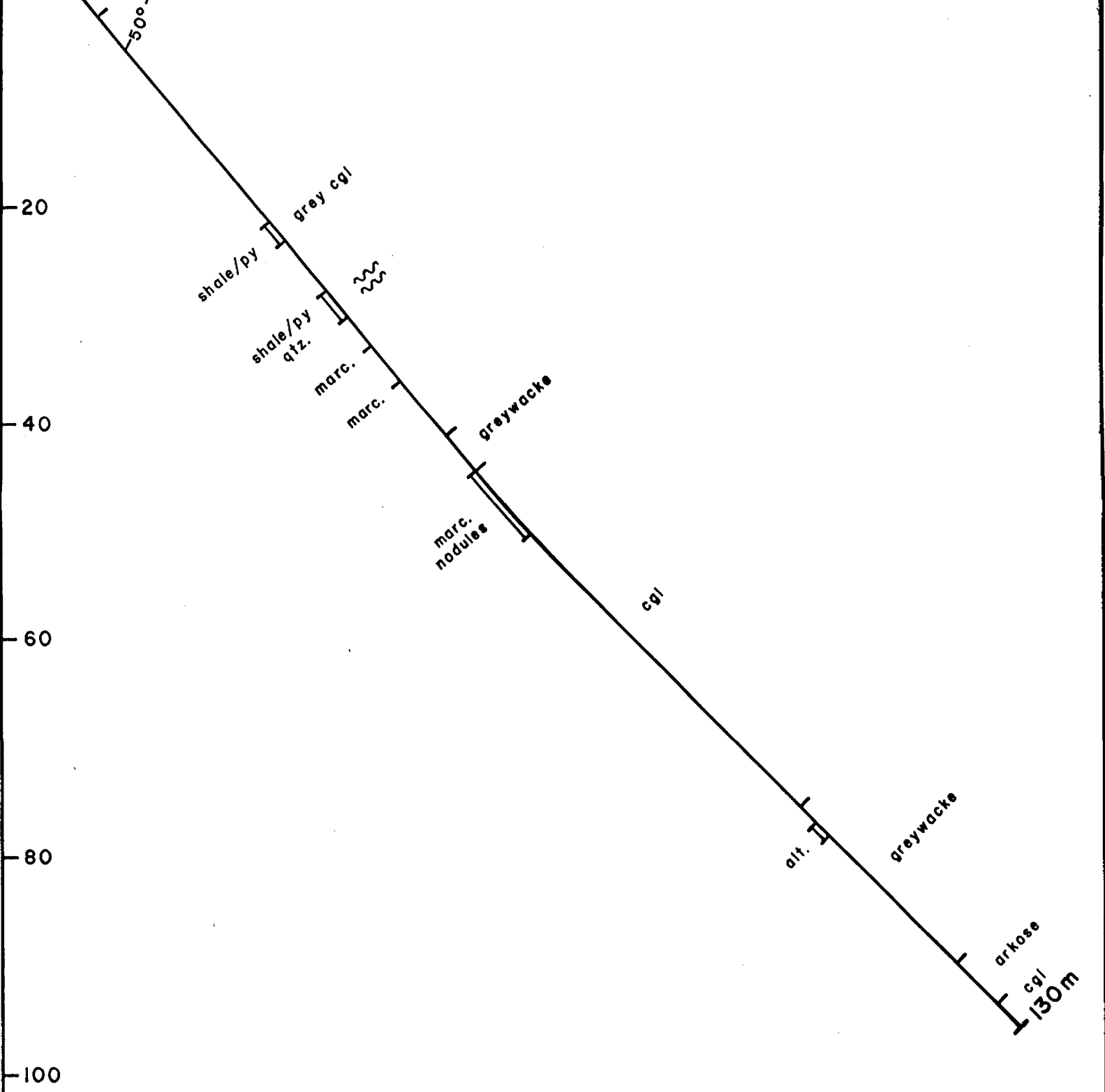

GOLDTECK MINES LIMITED  
 STAIRS PROPERTY  
 DRILLHOLE S-2  
 CROSS SECTION  
 (Looking Northeast)

AUG/87

Fig. 4b



NW

SE

S-3

A<sub>N</sub> 132°

Surface

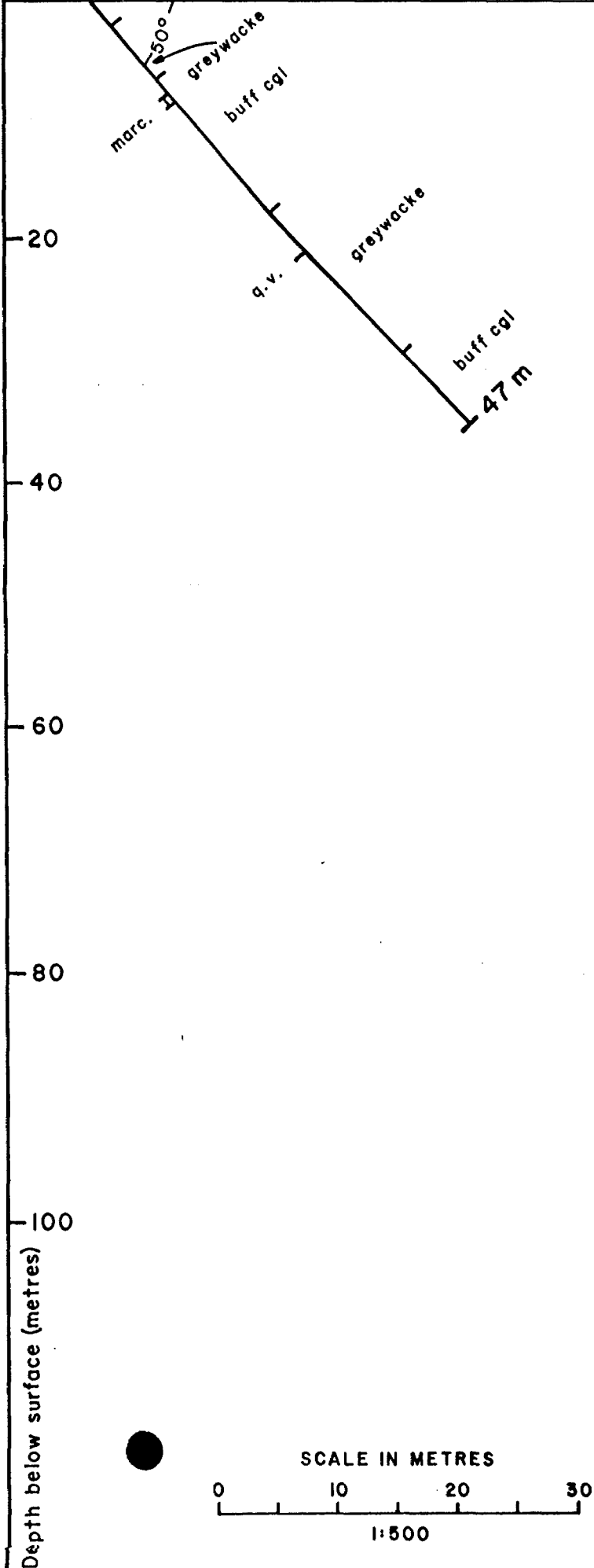

GOLDTECK MINES LIMITED  
 STAIRS PROPERTY  
 DRILLHOLE S-3  
 CROSS SECTION  
 (Looking Northeast)

AUG/87

Fig. 4c



Middlethian Twp The Mir

Name and Postal Address of Recorded Holder

GOLDTECK MINES LTD.

T 4753

P.O. Box 170, FIRST CANADIAN PLACE, TORONTO, ONT.

Summary of Work Performance and Distribution of Credits

Total Work Days Cr. claimed 560	Mining Claim			Mining Claim			Mining Claim		
	Prefix	Number	Work Days Cr.	Prefix	Number	Work Days Cr.	Prefix	Number	Work Days Cr.
for Performance of the following work. (Check one only) <input type="checkbox"/> Manual Work <input type="checkbox"/> Shaft Sinking Drifting or other Lateral Work. <input type="checkbox"/> Compressed Air, other Power driven or mechanical equip. <input type="checkbox"/> Power Stripping <input checked="" type="checkbox"/> Diamond or other Core drilling <input type="checkbox"/> Land Survey	L	943404	20	L	943476	20	L	943492	20
		943405	20		943477	20		943493	20
		943470	20		943478	20		943494	20
		943471	20		943479	20		943495	20
		943472	20		943480	20		943496	20
		943473	20		943481	20		943497	20
		943474	20		943482	20		(FOR REMAINDER	
		943475	20		943483	20		SEE ATTACHED)	

All the work was performed on Mining Claim(s): L579152 (LARDER LAKE M.D.)

Required Information eg: type of equipment, Names, Addresses, etc. (See Table Below)

WORK PERFORMED BY: KIT ENTERPRISES, NEW LISKEARD, ONT.

DATES OF WORK: FEB. 10 - FEB. 15, 1987

DIAMOND DRILL HOLES: S-1 426 FEET  
 S-2 426 "  
 S-3 154 "  
 TOTAL 1006 "

NOTE:  
 440 DAYS WORK  
 RECORDED IN  
 PORCUPINE M.D.  
 OCT. 8 1987  
 Receipt # \_\_\_\_\_

- 2 COPIES OF LOGS ATTACHED

- 2 COPIES OF SKETCH SHOWING LOCATION OF WORK

Date of Report: Oct. 2/87  
 Recorded Holder or Agent (Signature): W.M. Bergey, V.P.

Certification Verifying Report of Work

I hereby certify that I have a personal and intimate knowledge of the facts set forth in the Report of Work annexed hereto, having performed the work or witnessed same during and/or after its completion and the annexed report is true.

Name and Postal Address of Person Certifying

WILLIAM R. BERGEY, #501, 710 CHIRCO ST.

VANCOUVER, B.C. V6G 2P9

Date Certified

Oct. 2/87

Certified by (Signature)

W.M. Bergey

Table of Information/Attachments Required by the Mining Recorder

Type of Work	Specific Information per Type	Other information (Common to 2 or more types)	Attachments
Manual Work	RECEIVED OCT 8 1987	Names and addresses of men who performed manual work/operated equipment, together with dates and hours of employment.	Work Sketch: these are required to show the location and extent of work in relation to the nearest claim post.
Shaft Sinking, Drifting or other Lateral Work			
Compressed air, other power driven or mechanical equip.	Type of equipment: G. QUAM	Names and addresses of owner or operator together with dates when drilling/stripping done.	Work Sketch (as above) in duplicate
Power Stripping	Type of equipment and amount expended. Note: Proof of actual cost must be submitted within 30 days of recording.		
Diamond or other core drilling	Signed core log showing: footage, diameter of core, number and angles of holes.	Nil	Nil
Land Survey	Name and address of Ontario land surveyer.		

Instructions - Supply required data on a separate form for each type of work to be recorded (see table below).  
 - For Geo-technical work use form no. 1362 "Report of Work (Geological, Geophysical, Geochemical and Expenditures)".

The Mining Act

Name and Postal Address of Recorded Holder: GOLDTECK MINES LTD.  
 Prospector's Licence No. \_\_\_\_\_  
 (SHEET 2)

Summary of Work Performance and Distribution of Credits

Total Work Days Cr. claimed	Mining Claim			Work Days Cr.	Mining Claim			Work Days Cr.
	Prefix	Number	Work Days Cr.		Prefix	Number	Work Days Cr.	
SEE SHEET 1	L	943498	20					
<input type="checkbox"/> Manual Work <input type="checkbox"/> Shaft Sinking Drifting or other Lateral Work. <input type="checkbox"/> Compressed Air, other Power driven or mechanical equip. <input type="checkbox"/> Power Stripping <input type="checkbox"/> Diamond or other Core drilling <input type="checkbox"/> Land Survey		943499	20					
		943500	20					
		943501	20					
		943502	20					
		943503	20					

All the work was performed on Mining Claim(s): L 579152

Required Information eg: type of equipment, Names, Addresses, etc. (See Table Below)

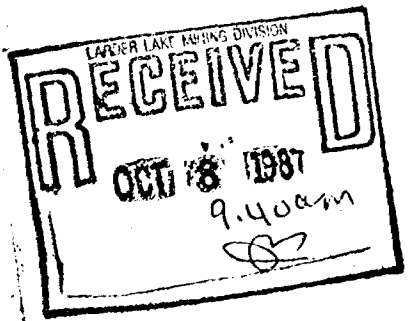

Date of Report \_\_\_\_\_ Recorded Holder or Agent (Signature) \_\_\_\_\_

Certification Verifying Report of Work

I hereby certify that I have a personal and intimate knowledge of the facts set forth in the Report of Work annexed hereto, having performed the work or witnessed same during and/or after its completion and the annexed report is true.

Name and Postal Address of Person Certifying \_\_\_\_\_  
 Date Certified \_\_\_\_\_ Certified by (Signature) \_\_\_\_\_

Table of Information/Attachments Required by the Mining Recorder

Type of Work	Specific information per type	Other information (Common to 2 or more types)	Attachments
Manual Work	Nil	Names and addresses of men who performed manual work/operated equipment, together with dates and hours of employment.	Work Sketch: these are required to show the location and extent of work in relation to the nearest claim post.
Shaft Sinking, Drifting or other Lateral Work			
Compressed air, other power driven or mechanical equip.	Type of equipment	Names and addresses of owner or operator together with dates when drilling/stripping done.	
Power Stripping	Type of equipment and amount expended. Note: Proof of actual cost must be submitted within 30 days of recording.		
Diamond or other core drilling	Signed core log showing; footage, diameter of core, number and angles of holes.		Work Sketch (as above) in duplicate
Land Survey	Name and address of Ontario land surveyor.	Nil	Nil

MO

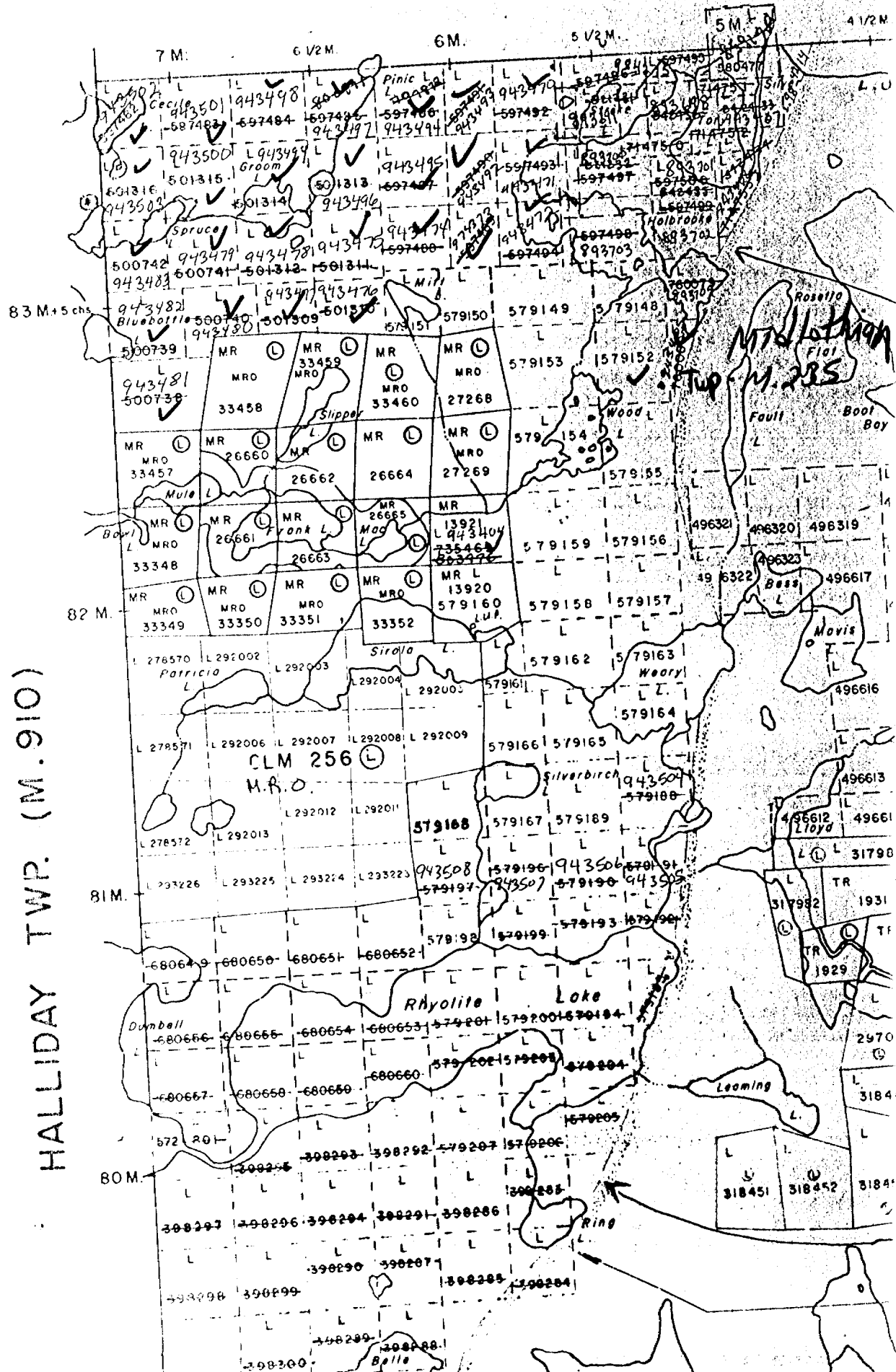

HALLIDAY TWP. (M. 910)