



41P14NE0056 37 HALLIDAY

010

DIAMOND DRILLING

TOWNSHIP: HALLIDAY

REPORT NO: 37

WORK PERFORMED FOR: Goldteck Mines Ltd.

RECORDED HOLDER: Same as Above [xx]
: Other []

<u>Claim No.</u>	<u>Hole No.</u>	<u>Footage</u>	<u>Date</u>	<u>Note</u>
P2 943616	G-24/	240.5	Dec/87	(1)
	G-33	232.9	Dec/87	(1)
	G-38	269.5	Jan/88	(1)
P1 943521	G-30	293.9	Dec/87	(1)
P1 943522				

Notes: (1) #W8806.214, filed in Dec/88

GOLDTECK MINES LTD.
DIAMOND
DRILL LOG AND SAMPLE RECORD
HOLE NUMBER: G-38

Location: Stairs Project

Northing: 55+10

Easting: 29+50

Elevation: .0

Length: 269.5

Depth Dip Azimuth

0. -50.0 132.0

25.5 -49.0 132.0

85.5 -35.5 134.0

145.5 -30.0 137.0

205.5 -26.0 142.0

265.5 -22.0 145.0

Core Size: BQ

Date Collared: December 16, 1987

Date Completed: January 7, 1988

Logged By: P. Folk

W.R. Seeger, P. Eng.

From(m)	To(m)	Code	Core Description
0.	4.5	OB	OVERBURDEN
4.5	26.5	3A	CONGLOMERATE Greenish, a few qtz. veinlets 8.0 5cm qtz., tr py, chlorite 21.4 3cm banded limonitic qtz. 21.8-26.5 abundant marcasite nodules
26.5	39.7	3C	SANDSTONE & SILTSTONE Fine grained, with sheared argillite beds.
39.7	43.2	3B	PEBBLE CONGLOMERATE Traces py.
43.2	54.0	3C-D	ARKOSE AND ARGILLITE Mixed, well banded, fine grained. Tops up hole. 51.2-52.3 irregular white qtz. veining
54.0	58.0	3B	FOLIATED PEBBLE CONGLOMERATE Marcasite rich near bottom contact.
58.0	63.1	3CR	FELSIC ROCKS . SEDIMENT OR VOLCANIC Light greenish, fine grained. Pebble conglomerate interbeds. 62.5-63.1 pebble conglomerate, 3B. 10cm qtz. vein at bottom
63.1	73.8	2BR	RHYOLITE LAPILLI TUFF Sericitic rich, 2% argillite. Small rounded clasts. 69.4 10cm qtz. vein
73.8	79.4	3D	ARGILLITE
79.4	82.6	2BR	RHYOLITIC LAPILLI TUFF Sericitic alteration. Note leucoxene.
82.6	95.4	2CR	RHYOLITE TUFF Fine grained. Increasingly hard downwards, ie. decreasing sericitic alteration. A few coarse interbeds. 90.0 26cm white qtz.

From(m)	To(m)	Code	Core Description
95.4	100.2	2BR	RHYOLITE LAPILLI TUFF 2% dark argillite shards
100.2	114.4	2CR	RHYOLITE TUFF Fine grained. Sandy qtz. rich tuff. 104.2-103.7 sandy argillite beds
114.4	122.2	3B	PEBBLY GREYWACKE 10% argillite pebbles. Some argillite beds. Faulted lower contact with qtz. veining. 122.7 24cm qtz. ser.
122.2	133.3	2CR	RHYOLITE TUFF Sericitic.
133.3	139.4	3B	PEBBLY SEDIMENTS Mixed with thin bedded argillites, 10% argillite pebbles 137.0-137.4 white qtz., traces py on fractures, 1% py in walls
139.4	146.0	2CR	RHYOLITE TUFF Weakly sericitic, fine grained.
146.0	147.7	3B	PEBBLY SEDIMENTS Thin bedded, finer grained interbeds.
147.7	157.4	2BR	RHYOLITE LAPILLI TUFF With minor sedimentary interbeds. 156.7 qtz. veinlets in sedimentary bed
157.4	170.5	2CR	CRYSTAL TUFF Hard, qtz. rich and siliceous gritty ash. Weak qtz. veining. Light grey- brown-green volcanic flows, dykes or sills at 168.4-169.2, 169.5-170.0 168.4 5cm banded qtz., tr py, ser, chlorite 170 - 22 cm pyritic qtz. 1% py, broken, sericitic bands. Note specks leucoxene
170.5	203.7	3D	ARGILLITE AND GREYWACKE Argillite is thinly bedded and greywacke is fine grained. 1-2% qtz. veinlets throughout. Traces py. 195 - note greenish blue mineral on shear planes 198.8 - 199.1 white qtz., weakly pyritized walls
203.7	212.8	2CR	RHYOLITE PYROCLASTIC Spotted, fine grained.
212.8	214.5	3D	ARGILLITE 212.5 24cm qtz. at pyroclastic- sediment contact.

From(m)	To(m)	Code	Core Description
214.5	236.3	2CR	RHYOLITE PYROCLASTIC Fine grained with a few sedimentary beds containing qtz. 228.5-229.7 qtz. veinlets associated with contorted sediments 234.4 35cm qtz. veinlets with black sediments. Tr py.
236.3	243.4	2BR	RHYOLITE LAPILLI TUFF Weakly silicified. 1% qtz. veinlets. Traces chromic mica. 241.0 7cm qtz. vein, black banding
243.4	254.5	3D-2CR	RHYOLITE PYROCLASTICS AND SEDIMENTS Mixed, fine grained. Qtz. stringers throughout. Traces fine py along bedding. 254.0 10cm true width banded qtz.- sericite, tr py.
254.5	269.5 269.5	2CR	RHYOLITE CRYSTAL TUFF E.O.H.

PI 943521

Scale: 1:2000

T. L. 55+00m

CEDAR BOG

G 30

G 24

G 33

G 38

P3 943481

P2 943516

PI 943515

L. 943522

CEDAR BOG

CEDAR REES

Baseline 50+00m

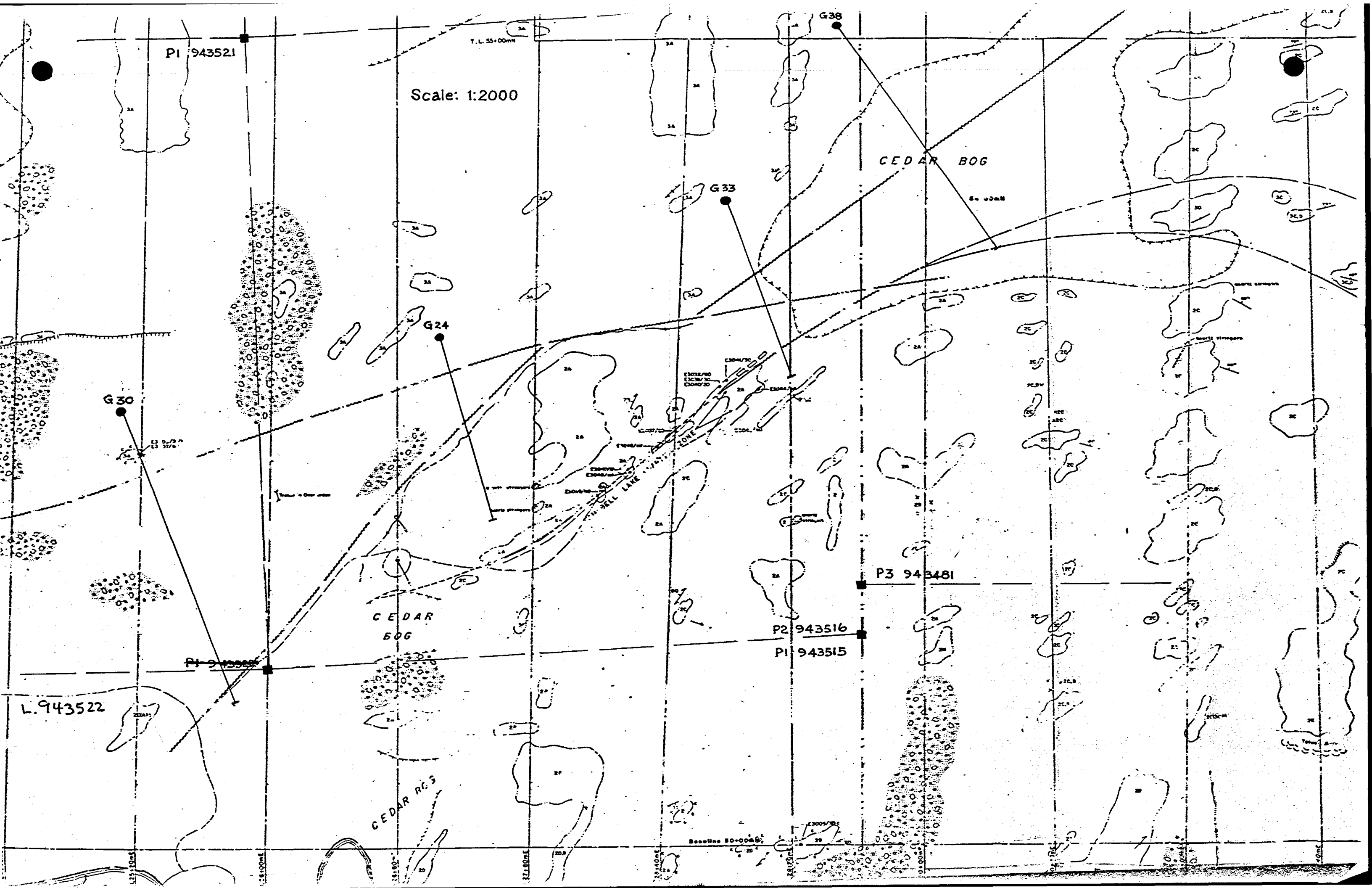

JUL 21 1988

RECEIVED

GOLDTECK MINES LTD.
DIAMOND
DRILL LOG AND SAMPLE RECORD
HOLE NUMBER: G-24

Location: Stairs Project

Northing: 53+17

Easting: 27+06

Elevation: .0

Length: 240.5

Core Size: BQ

Date Collared: November 30, 1987

Date Completed: December 6, 1987

Logged By: P.Folk

Depth	Dip	Azimuth
0.	-60.0	164.0
45.0	-60.0	164.0
93.0	-61.0	164.0
141.0	-61.0	164.0
189.0	-61.0	164.0
237.0	-60.0	164.0

H.R. Seeger, P. Eng.

From(m)	To(m)	Code	Core Description
.0	3.8	OB	OVERBURDEN
3.8	13.7	3A Cr	CONGLOMERATE Chromic, silicified. 4.4 13cm pyrite bed. 90% pyrite with siliceous matrix-angular crackle breccia. 11 Fracture zone. 13.1 - 13.7 argillite.
13.7	17.5	2CR	QTZ. RICH TUFF Sericitic foliated gritty qtz. rich tuff.
17.5	25.1	3A CR	CONGLOMERATE Silicified chromic, irregular qtz. veining. No core 18.0 - 19.5. Sample 0307 - poor recovery, broken qtz. veining.
25.1	36.5	2 CR	RHYOLITE TUFF Fine to medium grained sericitic.
36.5	38.0	2 BR	RHYOLITE, QTZ RICH LAPILLI TUFF With a greyish matrix coarse rhyolite qtz. crystal tuff clasts.
38.0	104.5	2 CR	RHYOLITE QTZ. CRYSTAL & ASH TUFF Grades to a tan to white colored massive to slightly bedded, uniform qtz. ash tuff. 47.7 15 cm broken qtz. with shear on hanging wall. 51.5 6 cm banded qtz.-ser-py. Irregular bands. 59.0 5 cm qtz. vein with 1mm py bands speck v.g. 71.2 4 cm qtz. vein traces py in

HOLE NUMBER:

bands.
G24

PAGE: 3

From(m)	To(m)	Code	Core Description
38.0	104.5	2 CR	RHYOLITE QTZ. CRYSTAL & ASH TUFF (Con't) 73. Gradational to coarse qtz. crystal tuf. Weak sericitic alt. 96.8 7 cm qtz. vein at 10 degrees py in vein and in walls.
104.5	107.5	2F	COARSE QTZ. CRYSTAL TUFF With a few brown altered lapilli sixed clasts.
107.5	114.7	2 CR	RHYOLITE TUFF Fine grained rhyolite tuff.
114.7	117.9	2F	RHYOLITE QTZ. CRYSTAL TUFF Coarse. Rhyolite qtz. crystal tuff.
117.9	129.0	2 CR	RHYOLITE TUFF Fine grained rhyolite tuff.
129.0	130.8	3C	ARKOSE Fine grained, weakly calcareous. 4 cm qtz.calcite 5 cm qtz.calcite
130.8	144.6	2 CR	RHYOLITE Fine grained tuff with some qtz crystal
144.6	146.0	1	ALTERED VOLCANIC Green, sheared,. Qtz. calcite py shear zone weak chromic alt.
146.0	148.0	2 CR	SILICEOUS TUFF Light greenish fine grained .
148.0	149.2	1	ALTERED VOLCANICS Sheared green. Qtz Calcite chlorite.
149.2	205.0	2 CR	RHYOLITE TUFF Fine grained sand sized grains. 155.0 - 156.0 quartz vein zone, white qtz. with py traces on walls. 60% qtz. Sericite alteration. 156.0 - 158.5 Qtz. stringer zone. 171.6 5 cm white qtz. 178 qtz.-sericite vein. 188 sericite alt. near vein. 190 40 cm qtz. sericite vein, weak py mineralization. 0.5 m of fine grained tuff in footwall of vein.
205.0	209.0	2F	QTZ. CRYSTAL TUFF Coarse.
209.0	240.5	2 CR	RHYOLITE TUFF Fine grained, massive, featureless
	240.5		EOH

ASSAYS AND SAMPLE RECORD
HOLE NUMBER:

6-24

Sample No.	From	To	Au(ppb)	Au(chk)	Ag(ppm)
S0305	4.3	4.6	314	-123.0	-123.0
S0306	17.5	18.0	92	-123.0	-123.0
S0307	19.5	21.0	553	-123.0	-123.0
S0314	23.6	25.1	46	-123.0	-123.0
S0310	47.3	48.2	59	-123.0	-123.0
S0308	51.5	51.7	73	47.0	-123.0
S0309	58.9	59.1	64	-123.0	-123.0
S0311	71.1	71.4	21	-123.0	-123.0
S0312	96.3	97.2	33	-123.0	-123.0
S0313	111.9	112.1	23	-123.0	-123.0
S0325	121.8	130.9	115	-123.0	-123.0
S0326	144.6	146.0	142	-123.0	-123.0
S0327	146.0	147.0	27	-123.0	-123.0
S0328	147.0	148.3	163	-123.0	-123.0
S0329	148.3	149.2	471	-123.0	-123.0
S0330	152.0	153.5	36	-123.0	-123.0
S0331	153.5	155.0	19	-123.0	-123.0
S0332	155.0	156.0	20	36.0	-123.0
S0333	156.0	157.5	40	-123.0	-123.0
S0334	157.5	158.0	171	-123.0	-123.0
S0335	176.7	176.9	30	-123.0	-123.0
S0336	188.9	189.5	25	-123.0	-123.0

GOLDTECK MINES LTD.
DIAMOND
DRILL LOG AND SAMPLE RECORD
HOLE NUMBER: G-30

Location: Stairs Project
Northing: 52+72
Easting: 25+08
Elevation: 0.
Length: 293.9

Core Size: BQ
Date Collared: December 7, 1987
Date Completed: December 11, 1987
Logged By: P.Folk

Depth	Dip	Azimuth
0.	-50.0	158.0
50.0	-48.0	152.0
110.0	-48.0	155.0
170.0	-48.0	157.0
230.0	-45.5	159.0
290.0	-45.0	159.0

W.A. Geary, P. Eng.

From(m)	To(m)	Code	Core Description
.0	8.0	OB	OVERBURDEN
8.0	20.5	2BR	RHYOLITE LAPILLI TUFF A few specks of chromic alt. Weak sericitic alt.
20.5	55.4	2CR	RHYOLITE TUFF Fine to medium grained. Some sections contain coarse qtz. crystals and a few lapilli sized pumice fragments. 32.2 2 cm limonitic, pyritic qtz. Dissem py in walls. 33.4 5 cm pyritized qtz. with grey vein walls. Presumably fine grained sulfides. 44.0 4 cm qtz. with tr. py, sericitic walls. 48.4 9 cm weakly pyritized white qtz.
55.4	56.6	1	DYKE Light green weakly pyritized, 3 cm pyritic qtz. vein @ contact.
56.6	57.2	Q.V.	QTZ. VEIN 50% vein material and 50 % 2 cr.
57.2	58.3	1	DYKE Light green weakly pyritized with qtz. veinlets.
58.3	59.2	Q.V.	QTZ. VEIN White with minor py tr. lim.
59.2	72.8	2CR	62.6 - 62.8 Small dyke qtz. veinlets on each wall
72.8	140.7	2BR	RHYOLITE LAPILLI TUFF With sections of rhyolite qtz. crystal tuff. Traces chromic alteration. 118.6 - start of qtz. stringer zone.

From(m)	To(m)	Code	Core Description
72.8	140.7	2BR	RHYOLITE LAPILLI TUFF (Con't) 122.1 Small shear zone, py-ser-qtz.-alt. 122.7 25 cm white qtz. Traces py in walls. 123.5 6 cm vuggy qtz. vein, sericitic walls Tr. Py. 125.5 42 cm qtz. Fine py in hairline bands. 136.5 - 140. Weak disseminated pyrite, weak sericite alt. 136.5 - 140 Weak disseminated pyrite, weak sericite alt. 138.4 4 cm white qtz.
140.7	152.2	2CR	RHYOLITE TUFF Fine grained 5% qtz. veinlets, some with grey bands of fine py. Fract zone 140 - 141.4 Small fault at bottom contact.
152.2	155.4	1	VOLCANIC Green probably dyke?
155.4	166.7	2BR	RHYOLITE LAPILLI TUFF
166.7	167.5	2F	QTZ.-FELD CRYSTAL TUFF Coarse
167.5	173.4	2BR	RHYOLITE LAPILLI TUFF 173.3 2 cm Dark grey pyritic qtz. vein.
173.4	198.8	2CR	RHYOLITE TUFF Fine grained some coarser crystal-lapilli tuff sections. 182.8 2 cm well pyritized qtz. veinlet. 193.9 3 cm grey py qtz. vein. 198.8 3 cm qtz.-py, 4 cm pyritic fault gouge.
198.8	199.6	1	DYKE Pyritized green dyke or flow, a few dykes in next section.
199.6	203.8	2BR	ALTERED RHYOLITE LAPILLI TUFF Qtz.-chromic mica breccia.
203.8	206.6	3D	ARGILLITE PEBBLE BRECCIA Silicified, chromic altered. Cut by dykes. Qtz. veinlets throughout.
206.6	259.0	2CR	RHYOLITE AND CRYSTAL TUFF Sandy with some coarse sections. 221.8 - 222.3 White qtz. 244 3 cm qtz. 245.3 1 cm qtz. - graphite. 249.5 3 cm qtz.-ser.

From(m)	To(m)	Code	Core Description
259.0	279.9	2BR	RHYOLITE LAPILLI TUFF 269.7 9 cm white qtz. 270.2 4 cm white qtz. 273.6 6 cm qtz. - chl. sericite some fine py. 276.2 20 cm qtz. 279.2 - 279.9 qtz. stringers in sericitic foliation zone.
279.9	293.9	2CR	RHYOLITE TUFF Fine grained. 286.1 Banded qtz. vein 5 cm weak py. EOH
	293.9		

GOLDTECK MINES LTD.
DIAMOND
DRILL LOG AND SAMPLE RECORD
HOLE NUMBER: G-33

Location: Stairs Project

Northing: 54+00

Easting: 28+80

Elevation: .0

Length: 232.9

Depth	Dip	Azimuth
0.	-60.0	160.0
28.0	-60.0	160.0
37.0	-60.0	162.0
85.0	-60.0	164.0
133.0	-60.0	166.0
181.0	-59.0	166.0
229.0	-59.0	164.0

Core Size: BQ

Date Collared: December 8, 1987

Date Completed: December 15, 1987

Logged By: P.Folk

W.A. Sejer, P. Eng.

From(m)	To(m)	Code	Core Description
0.	2.7	OB	CASING
2.7	6.9	3D	ARGILLITE Sandy
6.9	7.4	3B	CONGLOMERATE Pebbly, argillite rich.
7.4	17.1	3A Cr	CONGLOMERATE Weak chromic alt., numerous argillite clasts.
17.1	29.1	3C-3D	ARGILLITE Mixed, thinly bedded-white arkose. 19.5 18 cm qtz.-banded chlorite traces py.
29.1	30.6	3B	ARKOSE Pebbly.
30.6	32.8	3A	CONGLOMERATE Weakly chromic.
32.8	40.4	3C-3D	BEDDED ARGILLITE - ARKOSE Thinly mixed. Note: splotted carbonate alteration.
40.4	43.0	3A	CONGLOMERATE
43.0	45.4	3C	ARKOSE Medium grained.
45.4	106.0	3D	ARGILLITE With pygmatic, irregular qtz. veinlets and shears. 50 - 50.8 white qtz. with 20 cm altered country rock. Sheared walls. 78.0 - 78.8 Grey-white qtz.-dolomite 85.3 - 85.7 White qtz.-dolomite. Stringers in hangingwall. 101.4 20 cm qtz. vein with argillite bands minor py on upper contact.

From(m)	To(m)	Code	Core Description
106.0	137.9	2CR	RHYOLITE TUFF Fine grained, with a few argillite beds and shard-like clasts. 133.5 30 cm qtz. vein traces py, 20 cm shearing on upper contact. Stringer zone downwards. 135.9 6 cm white qtz. 137.0 20 cm qtz.-shearing with py-sericite. 137.6 10 cm pyritic qtz.-fault zone at bottom. Green chromic alt.
137.9	161.4	2F	RHYOLITE CRYSTAL AND LAPILLI TUFF Coarse. 153.0 - 156.0 Weak qtz. stringer zone. 159.4 - 162.8 Weak qtz. stringer zone.
161.4	191.1	2CR	RHYOLITIC TUFF Fine grained light tan colored. 188.6 - 189.5 Sericitic shear zone with 40 cm qtz.-vein. A few qtz. stringers in hanging wall.
191.1	201.3	2BR	RHYOLITE LAPILLI TUFF Weakly sericitic.
201.3	226.0	2CR	RHYOLITIC TUFF Fine grained. 201.5 - 202.4 sericite shear zone with 25 cm white qtz. 3% py in walls. 203.5 8 cm banded qtz. Tr. Cp Py. 206.9 Very well banded qtz.-sericite-chlorite? Vein 22 cm thick. 210.5 2 cm qtz.
226.0	226.7	3D	ARGILLITE Sandy with traces Py and green chromic beds.
226.7	232.9	2CR	RHYOLITE TUFF Fine grained.
	232.9		EOH



41P14NE0056 37 HALLIDAY

900



Report of Work

(A) DOCUMENT No. W8806-214

Mining Act

Instructions - Supply required data on a separate form for each type of work to be recorded (see table below).
 - For Geo-technical work use form no. 1362 "Report of Work (Geological, Geophysical, Geochemical and Expenditures)".

HALLIDAY TWP.

Name and Postal Address of Recorded Holder Goldteck Mines Limited	Prospector's Licence No. T - 4753
P.O. Box 170, 1 First Canadian Place, Toronto, Ontario M5X 1G9	

Summary of Work Performance and Distribution of Credits

Total Work Days Cr. claimed 3400	Mining Claim			Work Days Cr.	Mining Claim			Work Days Cr.	
	Prefix	Number	Work Days Cr.		Prefix	Number	Work Days Cr.		
for Performance of the following work. (Check one only) <input type="checkbox"/> Manual Work <input type="checkbox"/> Shaft Sinking Drifting or other Lateral Work. <input type="checkbox"/> Compressed Air, other Power driven or mechanical equip. <input type="checkbox"/> Power Stripping <input checked="" type="checkbox"/> Diamond or other Core drilling <input type="checkbox"/> Land Survey	P	984160	200	P	984168	200	P	984180	200
		984161	200		984169	200		984181	200
		984162	200		984170	200		984182	200
		984163	200					984183	200
		984164	200					984184	200
		984165	200					984185	200
		984166	200						
		984167	200						

All the work was performed on Mining Claim(s): **943516, 943521 & 943522 (Halliday); 943481' (Midlothian)**

Required Information eg: type of equipment, Names, Addresses, etc. (See Table Below)

Don Groleau Diamond Drilling Ltd.,
 P.O. Box 98, 324 Government Road, Kapuskasing, Ontario P5N 2Y1

Hole No.	Drilling dates	Depths (metres)
G 24	Dec 1 - 6, 1987	240.5
G 30	Dec 7 - 11, 1987	293.9
G 33	Dec 11-15, 1987	232.9
G 38	Dec 16/87-Jan 7/88	269.5

Total **1036.8 metres = 3401 feet**

APR 14 1988

RECEIVED
 ONTARIO GEOLOGICAL SURVEY
 ASSESSMENT FILES
 OFFICE
 JUL 21 1988

RECORDED
 APR 14 1988

Date of Report: **April 11/88**
 Recorded/Holder or Agent (Signature): *[Signature]*

Certification Verifying Report of Work

I hereby certify that I have a personal and intimate knowledge of the facts set forth in the Report of Work annexed hereto, having performed the work or witnessed same during and/or after its completion and the annexed report is true.

Name and Postal Address of Person Certifying T. G. Robinson 1390 Copeland Street	Date Certified April 11/88	Certified by (Signature) <i>[Signature]</i>
North Bay, Ontario P1B 3G3		

Table of Information/Attachments Required by the Mining Recorder

Type of Work	Specific information per type	Other Information (Common to 2 or more types)	Attachments
Manual Work	Nil	Names and addresses of men who performed manual work/operated equipment, together with dates and hours of employment.	Work Sketch: these are required to show the location and extent of work in relation to the nearest claim post.
Shaft Sinking, Drifting or other Lateral Work			
Compressed air, other power driven or mechanical equip.	Type of equipment	Names and addresses of owner or operator together with dates when drilling/stripping done.	Work Sketch (as above) in duplicate
Power Stripping	Type of equipment and amount expended. Note: Proof of actual cost must be submitted within 30 days of recording.		
Diamond or other core drilling	Signed core log showing; footage, diameter of core, number and angles of holes.		
Land Survey	Name and address of Ontario land surveyor.	Nil	Nil

SOTHMAN Twp. M-1121

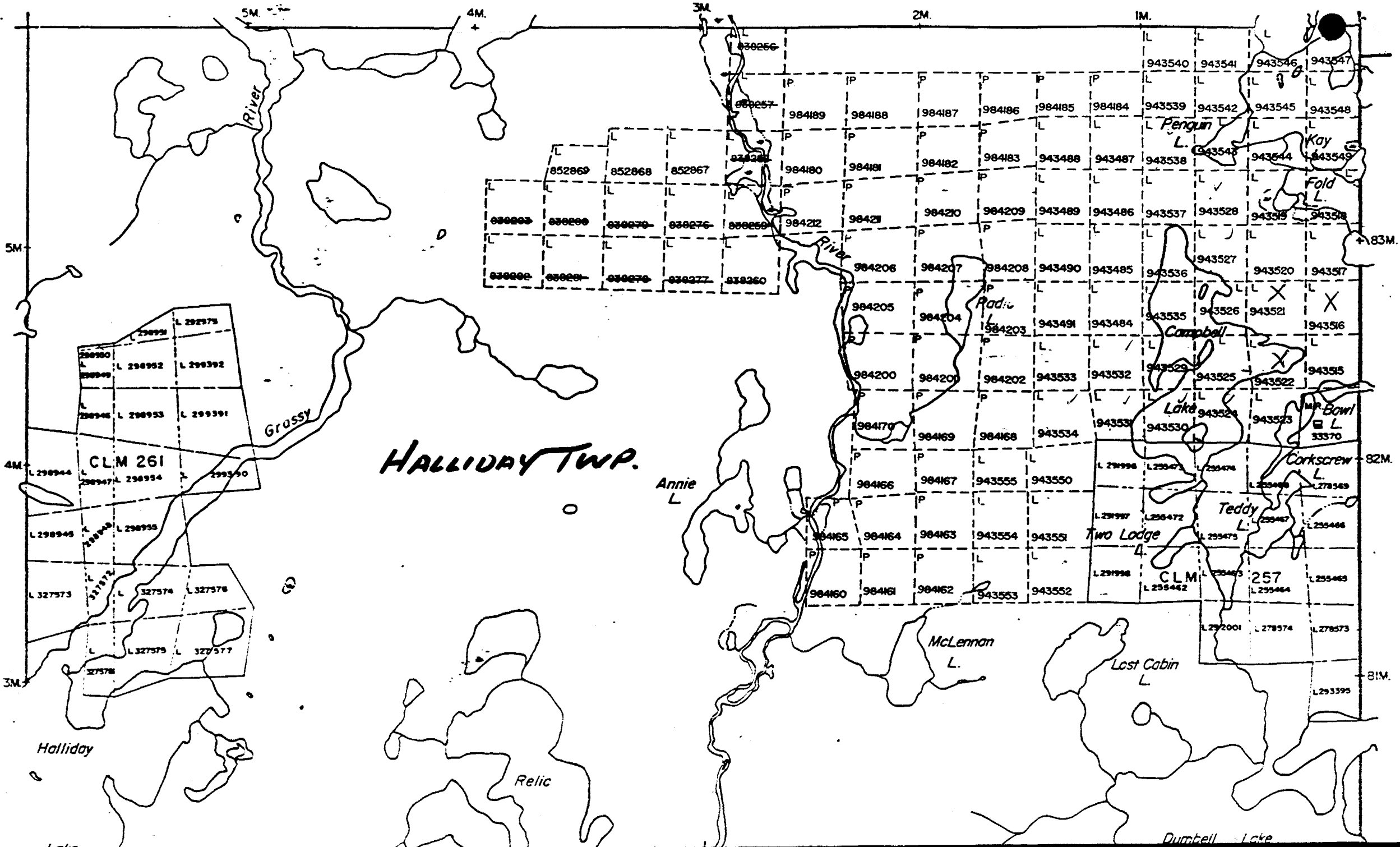

MONTROSE

HALLIDAY TWP. (M. 910)

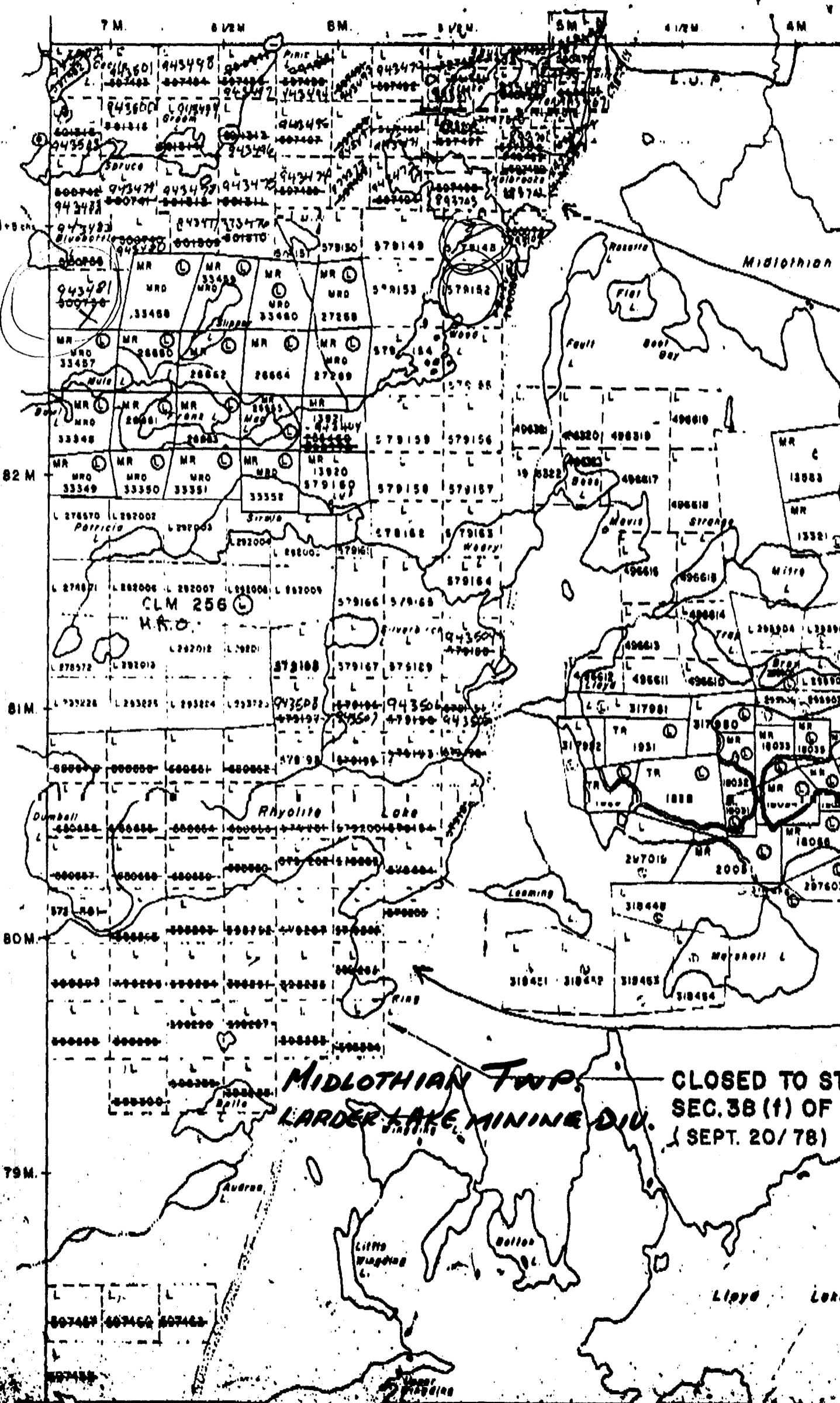

MIDLOTHIAN TWP.
LARDER LAKE MINING DIV.

CLOSED TO ST
SEC. 38 (1) OF
(SEPT. 20/78)