

1



41P14NE0203 63.5760 KELVIN

010

PROSPECTING REPORT

KELVIN - CABOT TOWNSHIPS AREA #2

FILE NUMBER OP90 - 122

INTRODUCTION

Prospecting was carried out in portions of the townships of Kelvin and Cabot during the summer of 1990 under OPAP Grant OP90 - 122. Emphasis was placed on examining and sampling zones of shearing and/or alteration, quartz veins and sulphide mineralization for evidence of gold mineralization. Of 58 samples collected and analysed by DCP for geochemical gold, 7 were reported to contain greater than 20 ppb Au. These samples all occur in one area, in a highly iron-carbonated, mafic volcanic rock. Further exploration of this occurrence would require mechanical stripping of heavy overburden, however, the results of sampling carried out to date do not suggest that such a programme is warranted.

While several other zones of iron carbonate alteration were discovered, as well as zones of quartz veining and/or sulphide mineralization, none were found to carry significant gold mineralization.

Further prospecting in Area #2 under this programme is not recommended.

LOCATION AND ACCESS

Area #2 is located in the eastern part of Cabot Township and the western part of Kelvin Township in the Larder Lake Mining Division.

Access to Kelvin Township is by way of the Grassy River Road which branches off Highway 560 east of the town of Shiningtree. The north part of Cabot Township is accessible from an unmaintained road branching off the Grassy River Road in Kemp Township approximately 20 km. north of the junction with Highway 560. Numerous old pulp-haulage roads, now mostly overgrown, provide further access to the northern and eastern parts of Area #2, but a considerable portion of the Area (southwest and central) is readily accessible only by aircraft.

GEOLOGY

The northeast part of Cabot Township and the northwest part of Kelvin Township are underlain by a northeasterly-trending series of mainly intermediate to felsic volcanics with a large component of coarse pyroclastic material (lapilli tuff and agglomerate) and

lesser amounts of more mafic volcanic rocks. Airphoto lineaments with a northeasterly trend were examined on the ground but nowhere could they be tied to bedrock sources. Near one such lineament which passes through the north bay of Little Claw Lake, outcrops of a variably altered (iron carbonate) mafic volcanic carry narrow, cross-cutting quartz veins with minor, but anomalous, gold.

Much of this portion of Area #2 is covered by deposits of fine, outwash sand that now support second-growth pine.

The eastern part of Kelvin Township, essentially west of the Grassy River Road, is underlain by ultramafic(?) to intermediate volcanic rocks, sediments and diabasic and gabbroic intrusives. Greywacke is thought to be more common than is shown on OGS Map 2470 and, in the vicinity of Triangle Lake, the strike of the formations appears to be more northerly than that indicated on Map 2470.

A northeasterly-trending airphoto lineament passing just east of Triangle Lake probably represents a strong strike fault. Outcrops of a sheared, highly altered (iron carbonate) rock, possibly originally an ultramafic, occur along this lineament and as such may be close to a major formational contact.

WORK DONE

Prospecting was carried out along traverses in areas where airphoto interpretation suggested the presence of structural anomalies and where previous geological mapping indicated rock types favourable to gold mineralization. Samples were collected of quartz vein and/or sulphide mineralization, and in particular, rocks exhibiting iron carbonate alteration. In one area, resampling of material found to be anomalous in gold, was carried out.

Prospecting traverses have been plotted on maps (West Sheet and East Sheet) at a scale of 1:10,000, together with outcrop locations and sample sites. Descriptions of the samples are given in a separate list.

RESULTS

Although several outcrop areas were thought to be favourable for gold mineralization only one showed anomalous values in gold. This one occurrence, on the shore of Little Claw lake, consists of several narrow, cross-cutting quartz veins in a highly altered portion of a mafic volcanic unit. Values of up to 610 ppb Au were obtained in a grab sample from a 3.8 cm quartz vein with minor pyrite. A sample of possibly the same vein from a location about

30 m along strike assayed 230 ppb Au, but another vein in the same area assayed <1 ppb. Samples of altered wallrock with some coarse pyrite assayed up to 70 ppb Au.

RECOMMENDATIONS

Moderately anomalous gold was found in only one occurrence in Area #2. Further exploration of this occurrence would require the use of mechanical equipment to remove overburden and such an operation at this time does not appear warranted. For the most part, sampling carried out in other parts of Area #2 indicates a low level of gold mineralization and therefore further prospecting cannot be recommended.

The presence of coarse fragmental felsic and intermediate volcanics in portions of northeastern Cabot Township suggest that exploration for base metal deposits using airborne geophysics is a possibility, although beyond the scope of the current prospecting programme.

Mississauga, Ontario
October 9, 1990

L. B. Halladay

TRAVERSES 1705
 CABOT TWP
 JUNE 12, 1990

Scale
 1:20,000

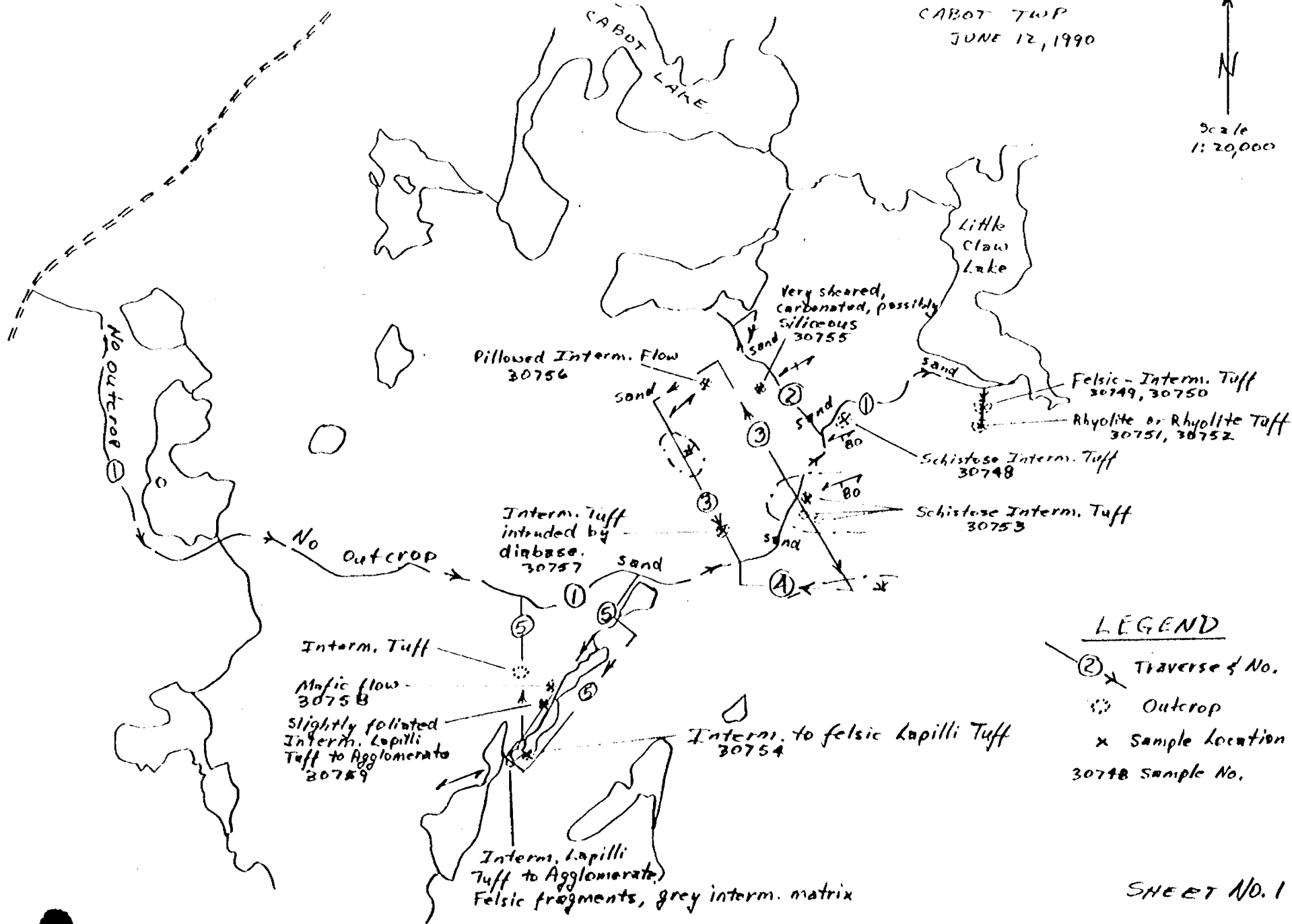

LEGEND

- ② → Traverse & No.
- ⊕ Outcrop
- x Sample Location
- 30748 Sample No.

SHEET NO. 1

TRAVERSES 6, 7, 8
CABOT TWP
JUNE 13, 1990

BURROUGHS TWP
CABOT TWP



Scale
1:20,000

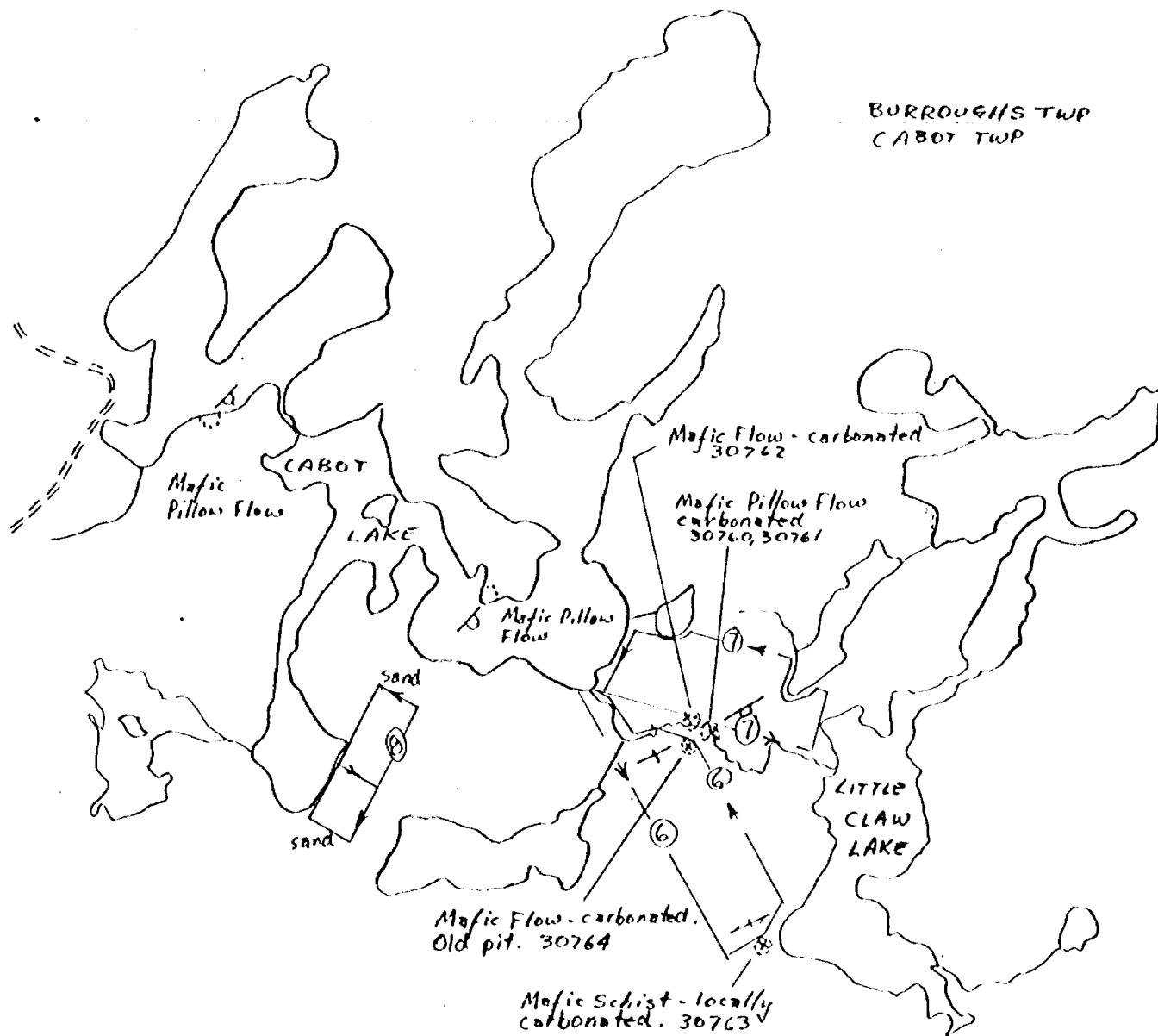

KELVIN TWP
CABOT TWP

FOR LEGEND see
SHEET NO. 1

SHEET NO. 2

TRAVERSES 9, 10, 11
CABOT TWP
JUNE 14, 1990

BURROUGHS TWP
CABOT TWP

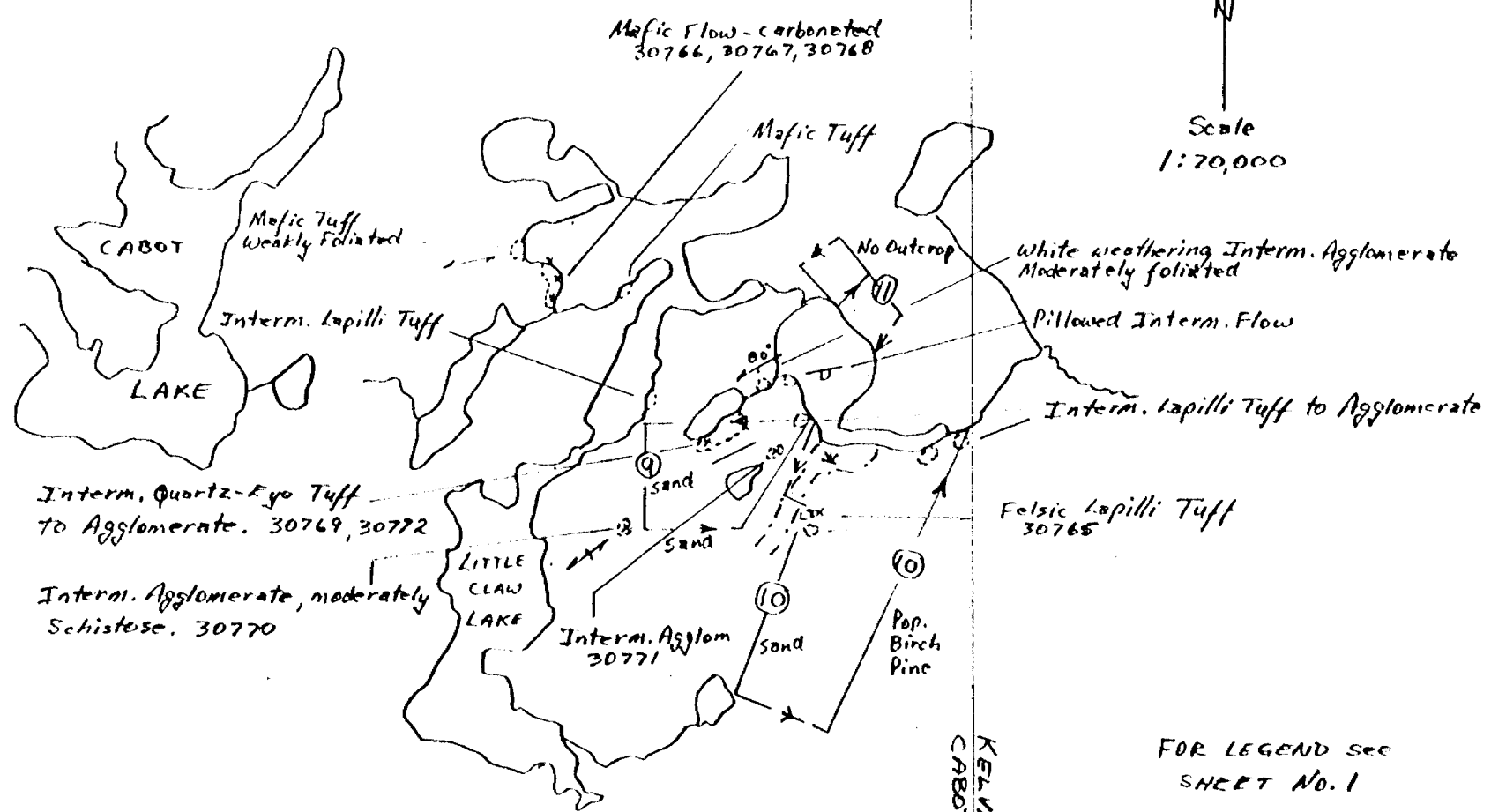

Scale
1:70,000

FOR LEGEND see
SHEET No. 1

SHEET No. 3

KELVIN TWP
CABOT TWP

TRAVERSES 12, 13, 14, 15, 16, 17
KELVIN TWP
JUNE 15, 1990

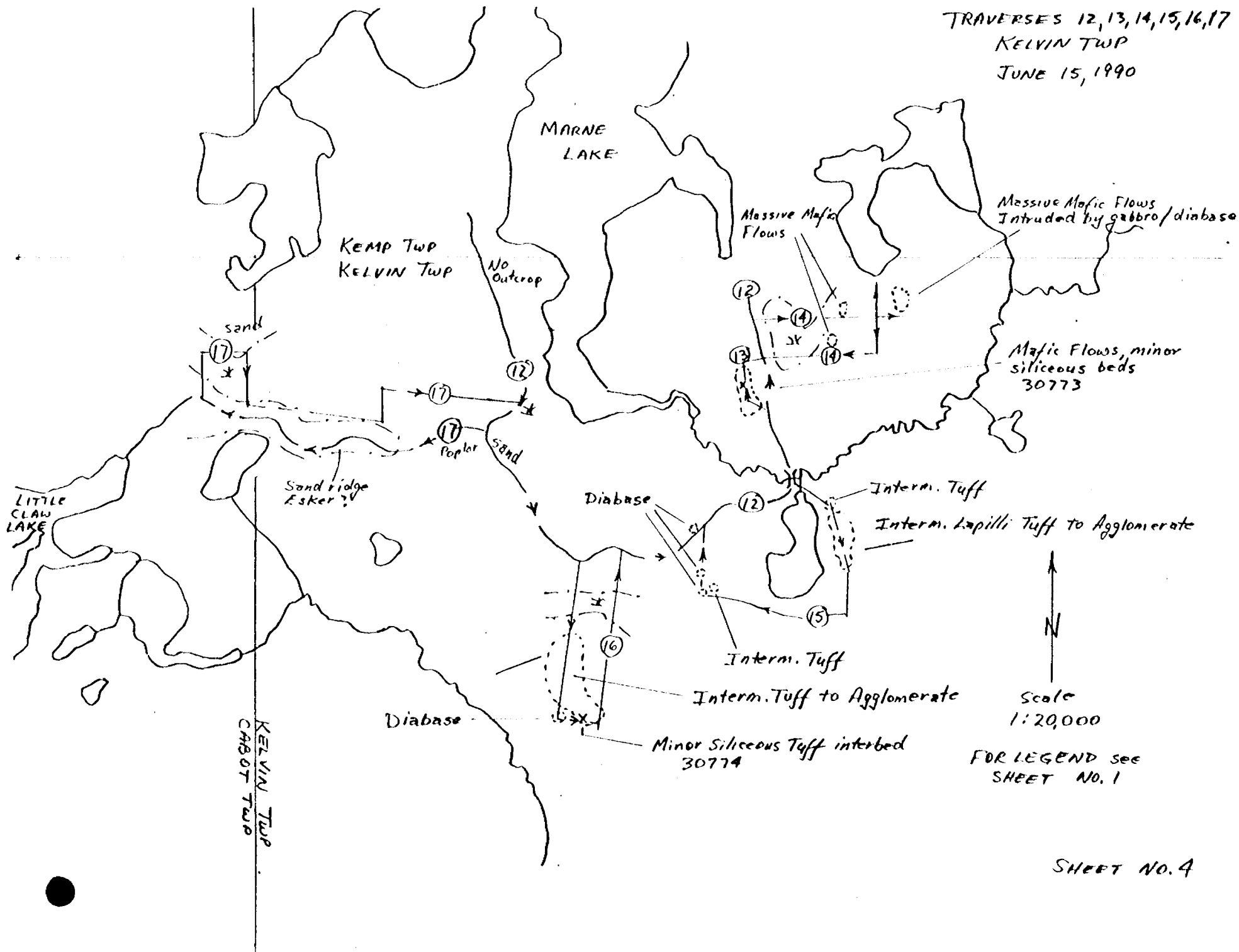

SHEET NO. 4

TRAVERSES 18, 19, 20, 21, 22
 CABOT TWP
 AUG. 21, 1990

BURROUGHS TWP
 CABOT TWP

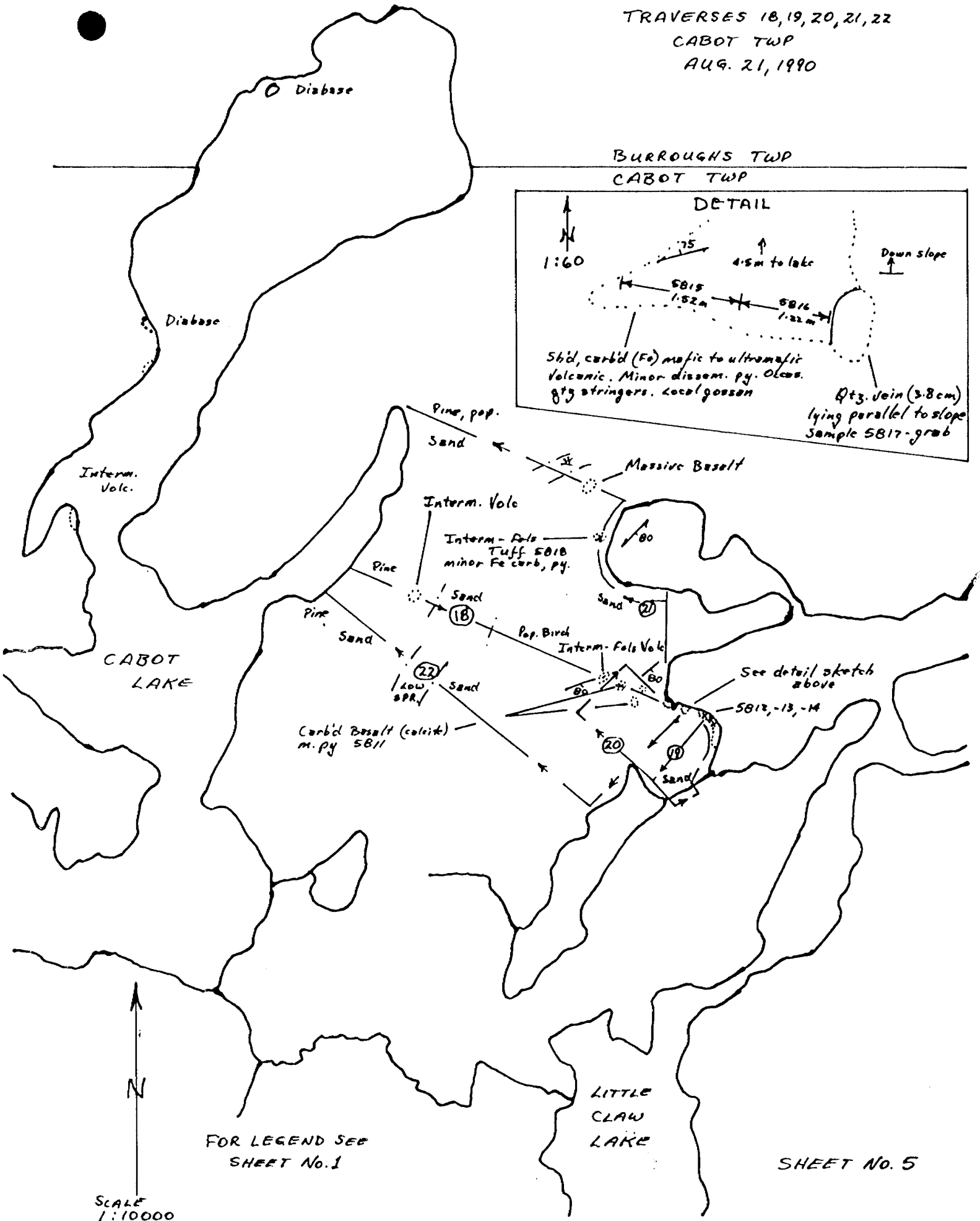
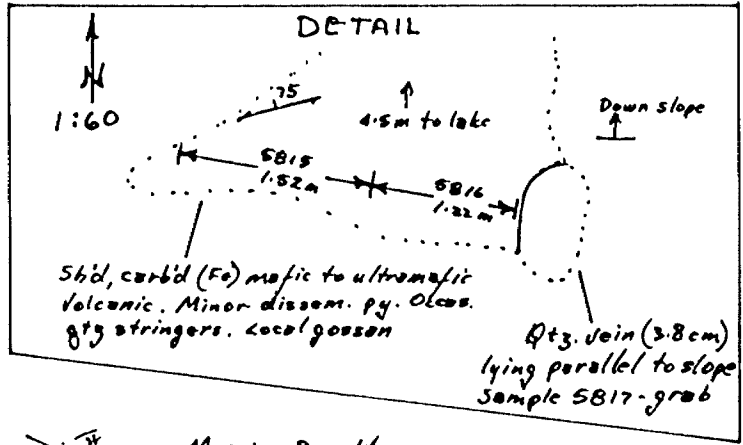

SCALE 1:10000

FOR LEGEND SEE SHEET No. 1

SHEET No. 5

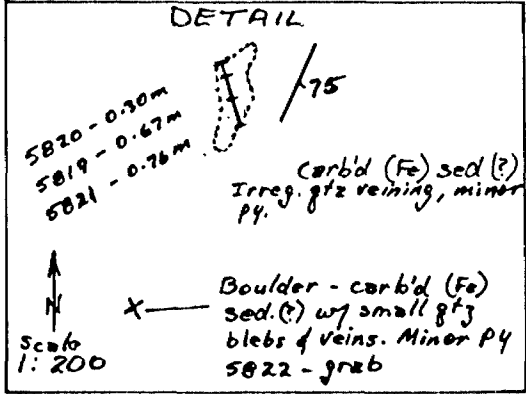
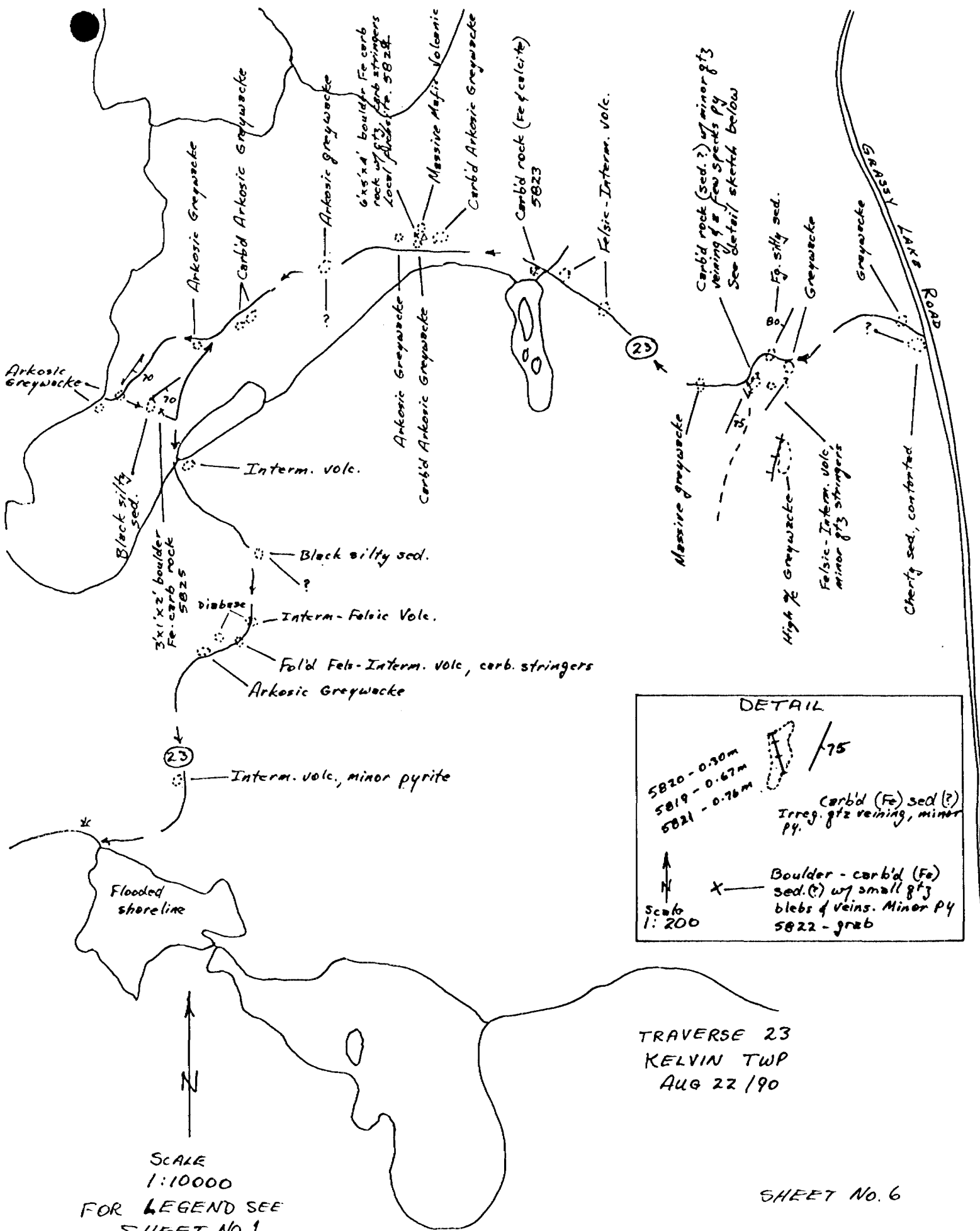

TRAVERSE 23
 KELVIN TWP
 AUG 22 190

SCALE
 1:10000
 FOR LEGEND SEE
 SHEET NO. 1

TRAVERSES 24, 25
AUG. 23 190
KELVIN TWP

KEMP TWP.
KELVIN TWP.



1: 10000

Highly carb'd (Fe, calcite) rock possibly originally feldspathic. Occas. gtz / carb veinlets w/ minor py. 5830-grab

Sheared ultramafic (75% Fe carb on west side) elsewhere massive white carb (Fe) and quartz, minor py. 5827, 28, 29, 31, 32, 33
See detail sheet No. 8

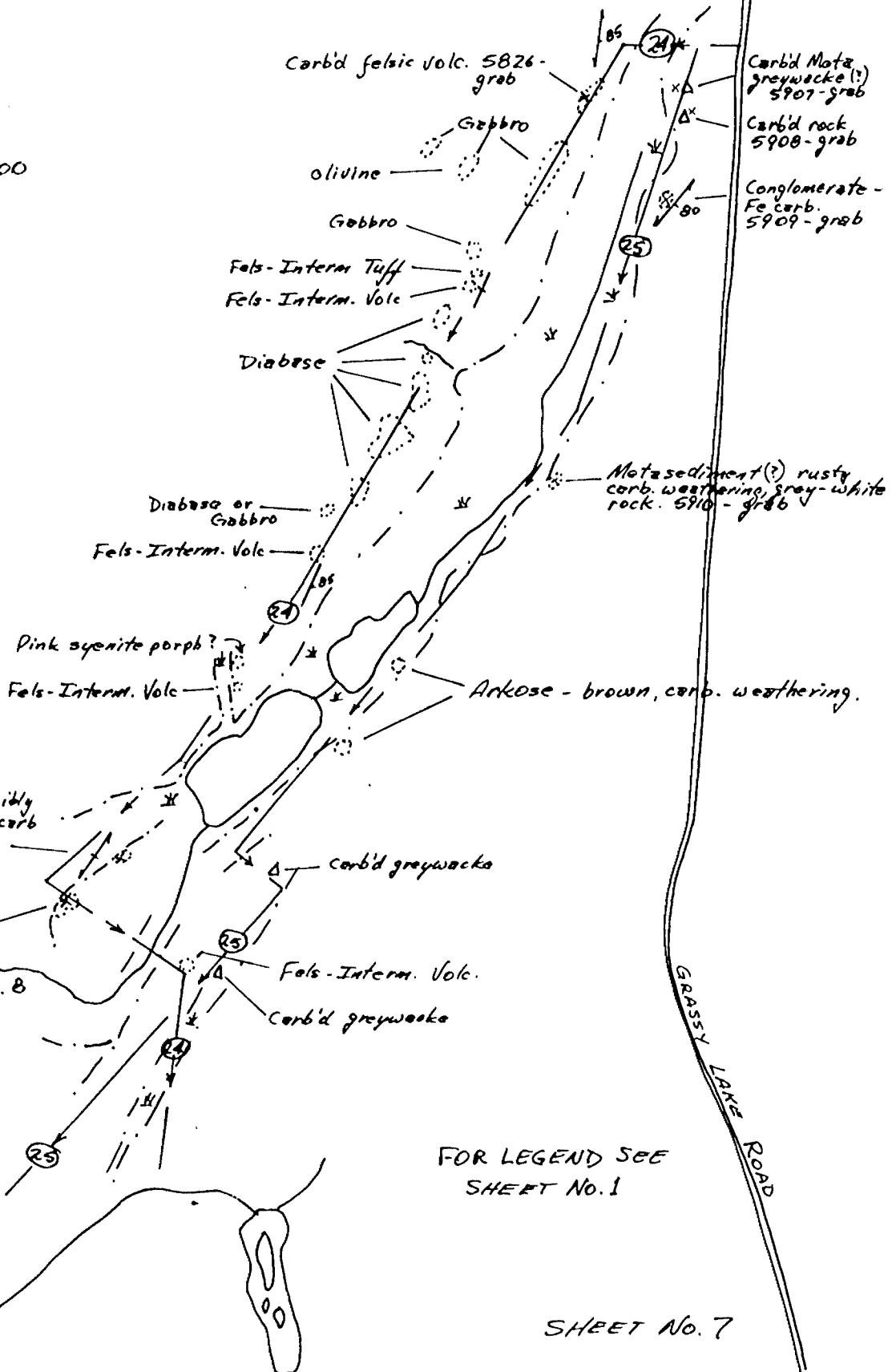

FOR LEGEND SEE
SHEET No. 1

SHEET No. 7

DETAIL SAMPLING
 TRAVERSE No. 24
 KELVIN TWP
 Aug. 24/90

See SHEET No. 7 For Location

FOR LEGEND SEE SHEET No. 1

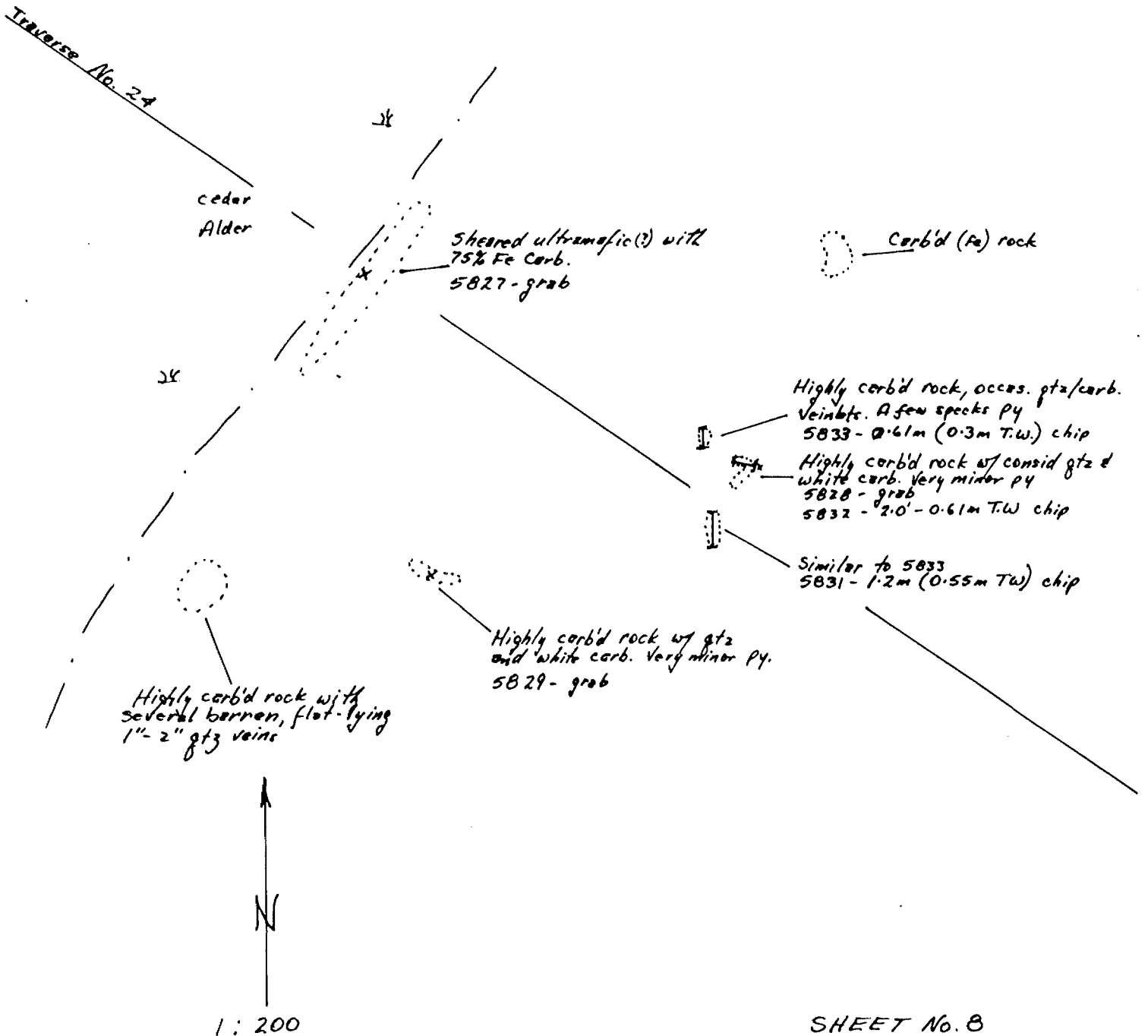

TRAVERSE 26
KELVIN TWP
AUG. 24 /90

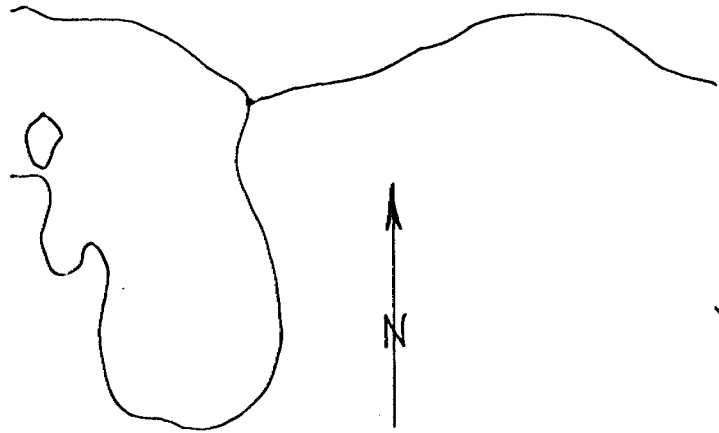

Scale
1:10000

GRASSY LAKE ROAD

Brown weathering corbid ultramafic

30775 - grab

Shear zone, very strong, brown corb. w/ fuchsite
& 873 veinlets. 5913 - grab

Altered corbid rock w/ some
873 veinlets. 5912 - grab

Shear zone - rusty corbid
5911 - grab.

85 Greywacke

Ultramafic

Basalt?

Chert greywacke

Greywacke

Siliceous sed. & Greywacke
minor pyrite. 5834 - grab

Siliceous sed.

KELVIN - CASOT AREA

SAMPLE NUMBER	TRAVERSE NUMBER	TYPE LENGTH	TRUE WIDTH	ASSAY Au, ppm	DESCRIPTION
30748	1	Grab		41	Schistose interm. tuff. feldspar and chloritic frags. No sulph.
30749	1	Grab		41	Barren cross-cutting Qtz. vein
30750	1	Grab		41	Fels. - interm. tuff. sil. & chlor. frags. A few specks py.
30751	1	Grab		41	Irreg. Qtz. veins & stringers in rhyolite tuff
30752	1	Grab		41	Gossan zone widest 3m. irreg. over 18m. 10% py. in rhyolite
30753	3	Grab		41	Sheared interm. tuff
30754	3	Grab		41	Sil. folic interm. - fels. lapilli tuff
30755	2	Grab		41	Shear zone 2 - 12m wide. carbonated
30756	3	Grab		41	Chlor. mafic volc., occas. Qtz. blowouts
30757	3	Grab		41	White weather interm. tuff with Qtz. veins up to 30cm
30758	5	Grab		41	Basalt with Qtz. veinlets and blebs to 30cm
30759	5	Grab		41	Interm. lapilli tuff - agglom., sil. folic
30760	7	Grab		41	Carb'd mafic pillow volc., minor py.
30761	7	Grab		41	Qtz. vein to 7cm. Few specks py. in wallrock
30762	7	Grab		41	Massive carb'd mafic volc., minor py.
30763	6	Grabs / 2m		41	Mafic schist, occas. 7 - 10cm Qtz. veinlets
30764	6	Grab		140	Qtz. vein in old pit. +60cm wide. minor py. in chlor. basalt
30765	10	Grab		41	Brown weather. fels. lapilli tuff, carb'd.
30766	11. Claw Lake	Grab		41	3m wide zone highly carb'd mafic volc. A few specks py.
30767	11. Claw Lake	Grab		41	Cross-cutting Qtz. veinlets in carb'd volc.
30768	11. Claw Lake	Grab		610	3.8cm vein Qtz. & orange carb., a few specks py
30769	9	Grab		41	10 - 30cm Qtz. vein in Qtz-eye interm. tuff to agglom
30770	9	Grab		41	Mod. schistose interm. agglom
30771	9	Grab		41	Mod. schistose interm. agglom., local brown weather
30772	9	Grab		41	30cm Qtz. vein
30773	13	Grabs / etc		41	Mafic volc., minor hematite, py. A few Qtz. veinlets
30774	16	Grab		16	Sil. rusty. minor py., sil. tuff in interm. agglom
30775	26	Grab		41	Brown weather., carb'd ultramafic
5811	18	Grab		3	Carb'd (calcite) basalt, minor py
5812	18	Grab		140	Same as 30768. 3.8cm Qtz./carb. vein, a few specks py
5813	18	Grab		70	Carb'd (Fe) country rock for 5812. minor coarse py
5814	18	Grab		23	Highly carb'd (Fe) rock with 1 - 2% coarse py
5815	18	Chip / 1.52m	0.75m	64	Carb'd (Fe) mafic volc., minor py., occas. Qtz. str.
5816	18	Chip / 1.22m	0.55m	13	Similar to 5815. local gossan
5817	18	Grab		230	3.8cm barren Qtz. vein lying parallel to slope
5818	21	Grab		2	Interm. - fels. tuff with local fine specks carb.(Fe)
5819	23	Chip / 0.67m	0.45m	1	Highly carb'd (Fe,Ca) sediment(?). irreg. Qtz. veining & as small blebs. few specks py
5820	23	Chip / 0.30m	0.20m	2	Carb'd rock, minor Qtz. veining. few specks py

KELVIN - CABOT AREA

SAMPLE NUMBER	TRAVERSE NUMBER	TYPE LENGTH	TYPE WIDTH	AGGAY Au. dbb	DESCRIPTION
5821	23	Chip / 0.76m	0.55m	41	Carbid rock, small dtz. blebs, minor disse. py
5822	23	Grab		1	Foot of highly carbid bld. with dtz. veinlets, minor py
5823	23	Grab		41	Hi. carbid rock (Fe,Ca), dtz./carb. veinlets, minor py
5824	23	Grab		3	2 * 1.5 * 1 m boulder carbid(Fe) rock, dtz./carb. stringers, minor fuchsite
5825	23	Grab		41	0.6 * 1.2 * 0.8 m carbid(Fe) boulder, a few specks py
5826	24	Grab		41	Locally sheared, carbid(Fe) fels. volc., few specks py
5827	24	Grab		2	Sheared - 75% Fe carb., 25% mafic, minor magnetite(?)
5828	24	Grab		3	Predom. white carb.(Fe?) & dtz., a few specks py
5829	24	Grab		41	Similar to 5828
5830	24	Grab		2	Carbid(Fe,Ca) rock, appearance of breccia or mylonite, possibly feldspathic. Occas. dtz./carb veinlets, py
5831	24	Chip / 1.2m	0.5m	41	Hi. carbid rock, occas. dtz./carb. veinlets, specks py
5832	24	Chip / 0.6m	0.6m	41	Similar to 5828, same location
5833	24	Chip / 0.6m	0.3m	41	Similar to 5831
5834	26	Grab		1	Fine grained, black, sil. sed. & greywacke, minor py
5907	25	Grab		41	Boulders metagreywacke(?), carbid
5908	25	Grab		4	Large, angular boulder, carbid rock
5909	25	Grab		41	Carbid(Fe) conglomerate, sil. folid
5910	25	Grab		1	Rusty, carb. weather., grey - white, metasediment
5911	26	Grab		4	Rusty, carbid shear zone
5912	26	Grab		4	Altered, carbid rock with some dtz. veinlets
5913	26	Grab		2	Sheared brown carb. with fuchsite, dtz. veinlets



X-RAY ASSAY LABORATORIES

A DIVISION OF SGS SUPERVISION SERVICES INC.

1885 LESLIE STREET • DON MILLS, ONTARIO M3B 3J4 • CANADA
TEL: (416)445-5755 TELEX: 06-986947 FAX: (416)445-4152

CERTIFICATE OF ANALYSIS REPORT 12175

TO: L.B. HALLADAY
2159 PARKER DRIVE
MISSISSAUGA, ONTARIO
L5B 1W3

CUSTOMER No. 1400

DATE SUBMITTED
18-Jun-90

REF. FILE 7696-D4

Total Pages 1

28 ROCKS

	METHOD	DETECTION LIMIT
AU PPB	FADCP	1.

*** UNLESS INSTRUCTED OTHERWISE WE WILL DISCARD PULPS 90 DAYS ***
AND REJECTS 30 DAYS FROM DATE OF THIS REPORT

DATE 26-JUN-90

CERTIFIED BY 

Philip Boctor, Laboratory Manager

SAMPLE AU PPB

30748	<1
30749	<1
30750	<1
30751	<1
30752	<1
30753	<1
30754	<1
30755	<1
30756	<1
30757	<1
30758	<1
30759	<1
30760	<1
30761	<1
30762	<1
30763	<1
30764	140
30765	<1
30766	<1
30767	<1
30768	610
30769	<1
30770	<1
30771	<1
30772	<1
30773	<1
30774	16
30775	<1



X-RAY ASSAY LABORATORIES

A DIVISION OF SGS SUPERVISION SERVICES INC.

1885 LESLIE STREET • DON MILLS, ONTARIO M3B 3J4 • CANADA
TEL: (416)445-5755 TELEX: 06-986947 FAX: (416)445-4152

CERTIFICATE OF ANALYSIS

REPORT 12963

TO: L.B. HALLADAY
2159 PARKER DRIVE
MISSISSAUGA, ONTARIO
L5B 1W3

CUSTOMER No. 1400

DATE SUBMITTED
27-Aug-90

REF. FILE 8198-M3

Total Pages 1

31 ROCKS

AU PPB	METHOD FADCP	DETECTION LIMIT 1.
--------	-----------------	-----------------------

DATE 07-SEP-90

CERTIFIED BY 

Philip Boctor, Laboratory Manager

SAMPLE	AU PPB
5811	3
5812	140
5813	70
5814	23
5815	64
5816	13
5817	230
5818	2
5819	1
5820	2
5821	<1
5822	1
5823	<1
5824	3
5825	<1
5826	<1
5827	2
5828	3
5829	<1
5830	2
5831	<1
5832	<1
5833	<1
5834	1
597	<1
598	4
599	<1
5910	1
5911	4
5912	4
5913	2

II. LIST OF EXPENDITURES

DATE	RECIPIENT	EXPLANATION	AMOUNT
May 17	M.N.R.	Airphotos, topo map	70.69
May 23	Gateway Reproductions	Prints	14.71
Jun 3	M.N.D.R.	Claim map	1.00
Jun 5	Willson Stationers	Scale	2.80
Jun 7	Grand & Toy	Office supplies	17.01
Jun 8	A & P	Groceries - lunches	16.35
Jun 11	McDonalds	Lunches(2)	10.71
Jun 11	Loblaws	Groceries	37.21
Jun 11	Country Store	Outboard oil	3.51
Jun 14	Country Store	Groceries	1.50
Jun 15	Three Bears Camp	Cabin rent	236.25
		Meals	87.88
		Outboard gas	6.00
		Tips	12.25
Jun 16	McDonalds	Lunches(2)	9.78
Jun 21	Gateway Reproductions	Map enlargement	40.46
Jul 3	Bell	Telephone	12.83
Jul 3	X-Ray Assay Labs	Assays	343.00
Jul 6	Willies Prints	Photocopies	1.76
Jul 9	Entire Reproductions	Prints	7.51
Jul 12	Food City	Groceries - lunches	16.54
Jul 13	A & P	Groceries - lunches	11.69
Jul 16	McDonalds	Lunches(2)	10.28
Jul 17	Pizza Hut	Dinner + tip	17.61
Jul 18	Bamboo Hut	Dinner + tip	24.86
Jul 19	Casey's Rest.	Dinner + tip	30.52
Jul 21	Bon Air Motel	Rooms and meals	548.87
		Tips on meals	10.25
Jul 21	McDonalds	Lunches(2)	9.78
Jul 23	M.N.R.	Claim map	1.00
Jul 26	Willies Prints	Photocopies	1.76
Jul 27	Entire Reproductions	Map Enlargement	41.93
Jul 31	M.N.D.M.	Claim map	1.00
Aug 6	X-Ray Assay Labs	Assays	196.00
Aug 14	Entire Reproductions	Prints	10.63
Aug 17	A & P	Groceries	50.11
Aug 19	Apple Market	Groceries	12.24
Aug 19	A & P	Groceries	28.31
Aug 19	Food City	Groceries - lunches	15.07
Aug 20	McDonalds	Lunches(2)	9.78
Aug 20	Country Store	Outboard gas	2.36
Aug 24	Three Bears Camp	Cabin rent	236.25
Aug 25	McDonalds	Lunches(2)	10.28
Sep 12	X-Ray Assay Labs	Assays	379.75
Sep 14	A & P	Groceries - lunches	13.75
Sep 14	Entire Reproductions	Prints	6.13
Sep 15	Loblaws	Groceries - lunches	14.87
Sep 17	Country Style	Lunches(2)	9.64

11.

LIST OF EXPENDITURES

DATE	RECIPIENT	EXPLANATION	AMOUNT
Sep 18	Imperial Oil	Outboard gas	2.44
Sep 18	The Fishbowl	Dinner + tip	31.56
Sep 19	Casey's Rest.	Dinner + tip	31.46
Sep 20	Pizza Hut	Dinner + tip	24.55
Sep 21	Golden Stone Rest.	Dinner + tip	30.00
Sep 22	Bon Air Motel	Rooms and meals:	555.93
		Tips on meals:	9.75
Sep 22	Harvey's	Lunches(2)	10.93
Sep 24	Bell	Telephone	4.20
Oct 3	X-Ray Assay Labs	Assays	196.00
Oct 10	Willies Prints	Photocopies	1.46
Oct 10	Entire Reproductions	Prints	6.13
	Mileage rate claimed	7729 km @ 30c/km	2318.70
	TOTAL		\$ 5872.58

NOTE: Includes food and accommodation for helper as per proposed budget



41P14NE0203 63.5760 KELVIN

020

PROSPECTING REPORT

MONTROSE - HUTT TOWNSHIPS AREA #1

FILE NUMBER OP 90 - 122

INTRODUCTION

Basic prospecting was carried out in portions of the townships of Montrose and Hutt during the summer of 1990 under OPAP Grant OP90 - 122. Outcrops in the vicinity of old surface showings (with minor gold), located northeast of Hutt lake, were examined although no evidence of reported trenches was found. In addition, zones of quartz veining, sulphides mineralization and iron carbonate alteration were sampled. None of the samples collected were found to contain anomalous gold values and, for the most part, are probably lower in gold than average.

The conclusion is that this Area #1 has a low gold potential and, as such, further prospecting cannot be recommended.

LOCATION AND ACCESS

Area #1 is located in the eastern part of Hutt Township and in the western part of Montrose Township, respectively in the Porcupine and Larder Lake Mining Divisions.

Access to the north parts of the two townships is by way of the westerly extension of Highway 566, from Matachewan, about 45 km to the east. This road also connects with roads passing through Lanouan Township to South Porcupine or through Bartlett Township to Timmins, a distance of approximately 90 km.

Branching off the road at the north end of the townships are three roads in Hutt Township which make the northwest part of Area #1 accessible, and one road in Montrose Township which accesses most of the western part of that township. None of these roads are maintained.

Numerous old, pulp-haulage roads, now mostly overgrown, provide further access to the northern and eastern parts of the Area, however, the remainder of the Area is readily accessible only by aircraft.

GEOLOGY

The north part of Area #1 is underlain by a series of northeasterly-trending volcanic units, mainly of mafic to intermediate composition which show little in the way of structure, alteration or mineralization. In short, not very attractive prospecting ground.

Of more interest are the felsic to intermediate fragmental rocks occurring in the southwest part of Montrose Township as far north as Melick Lake. Lavilla tuff and agglomerate units appear to make up a large proportion of outcropping rocks in this area.

A prominent north-south airphoto lineament passing east of Hutt Lake marks the trace of the extension of the Mitt Lake Fault mapped in Middleham Township to the south. West of this fault the formations strike more northerly than the regional northeast trend, suggesting left-hand movement along the fault.

Rocks in this part of Area #1 are more sheared, with zones of iron carbonate alteration.

Along the northern boundary of Area #1 deposits of fine outwash sand obscure much of the bedrock. Similar deposits of sand are found in a lobe extending south, part way along the eastern boundary. Much of the Area, except for a portion in the southwest corner west of Hutt Lake and south of Shear Lake, has been logged. Second-growth deciduous trees and old slash make foot travel in many areas extremely difficult.

WORK DONE

Initially, attempts were made to locate a series of old trenches reportedly put down in an area northeast of the north end of Hutt Lake and from which several low gold assays were obtained from quartz veins in sediments. All of this area has been logged and is now overgrown with alders and moose maple making for an unsuccessful search.

Basic prospecting was carried out along traverses in areas accessible by foot and canoe, although in general, outcrops along the shores of the larger lakes were ignored. Zones of shearing, quartz veining, sulphide mineralization and iron carbonate alteration located along the traverses were sampled and analysed by PCP for geochemical gold. No base metal mineralization, other than scattered chalcopyrite, was noted.

RESULTS

Outcrops in the north part of Area #1 show little in the way of mineralization or deformation and gold content of samples from this portion is uniformly low.

Rocks in the southeast part of the Area exhibit more in the way of sulphide mineralization and alteration (iron carbonate) and, in general, appear to be better prospecting ground for gold. However, the gold content of samples from this part of the Area

is also low.

Prospection traverses have been plotted on maps (North Sheet and South Sheet) at a scale of 1 : 10,000, together with outcrop locations and sample sites. Descriptions of the samples are given in a separate list.

RECOMMENDATIONS

The north part of Area #1 appears to have little potential for gold or base metal deposits. While the southeast portion of the Area is somewhat more favourable for gold deposits, the sampling results fail to give any encouragement. Thus it is recommended that no further prospecting under this Grant be carried out in Area #1.

The Ministry of Natural Resources airborne electromagnetic survey of Montrose Township (Preliminary Map 1020) located no anomalies in the area of fragmental volcanic rocks in the southwest part of the Township but this may be due to line direction and/or lack of coverage.

Mississauga, Ontario,
October 10, 1990

L. B. Halladay

TRAVERSES 1 to 5
 Montrose Twp.
 July 17, 18, 1990

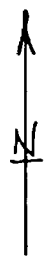
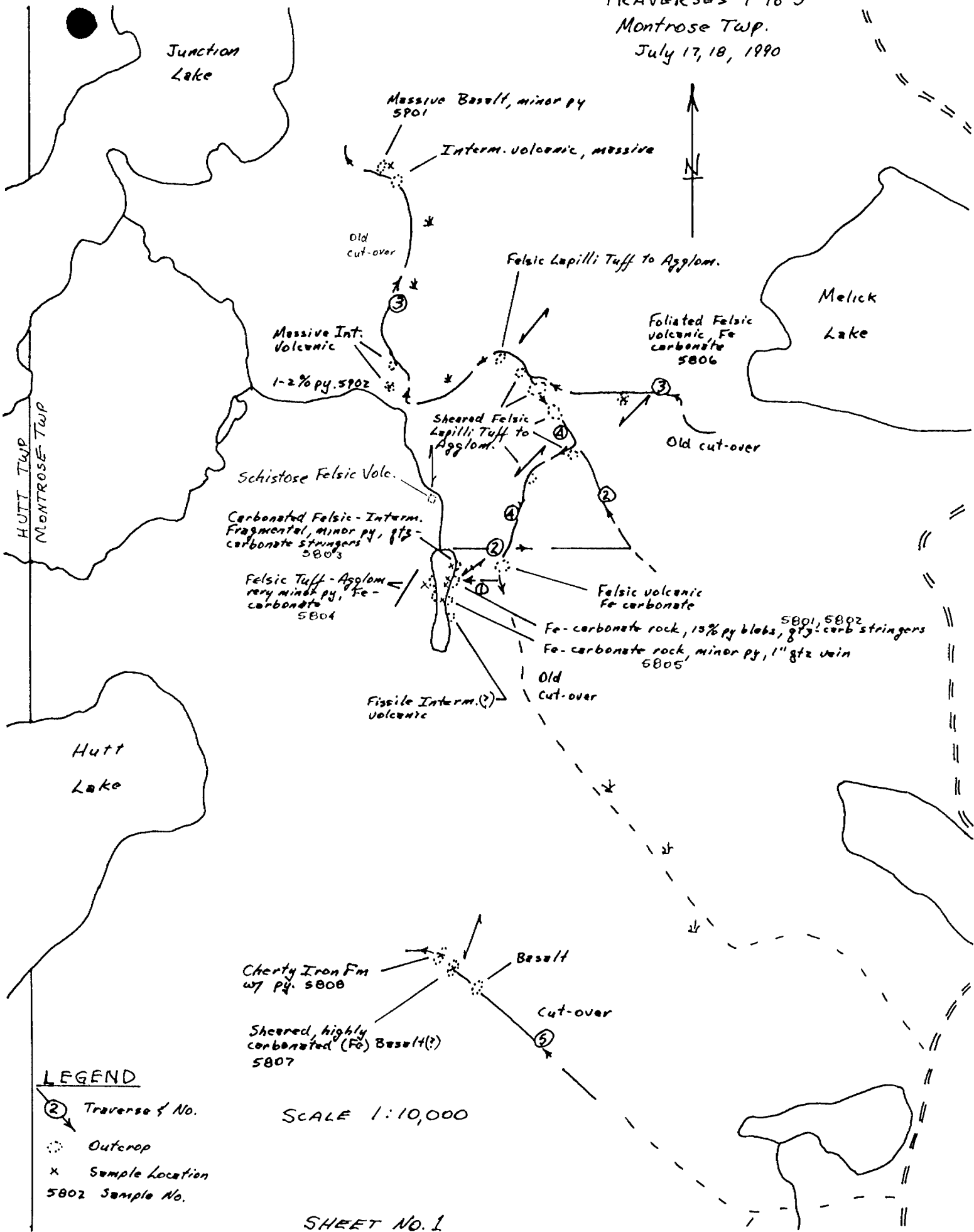

HUTT TWP
 MONTROSE TWP

- LEGEND**
- ② Traverse & No.
 - Outcrop
 - x Sample Location
 - 5802 Sample No.

SCALE 1:10,000

SHEET NO. 1

TRAVERSES 6,7,8
 HUTT TWP
 July 19, 1990

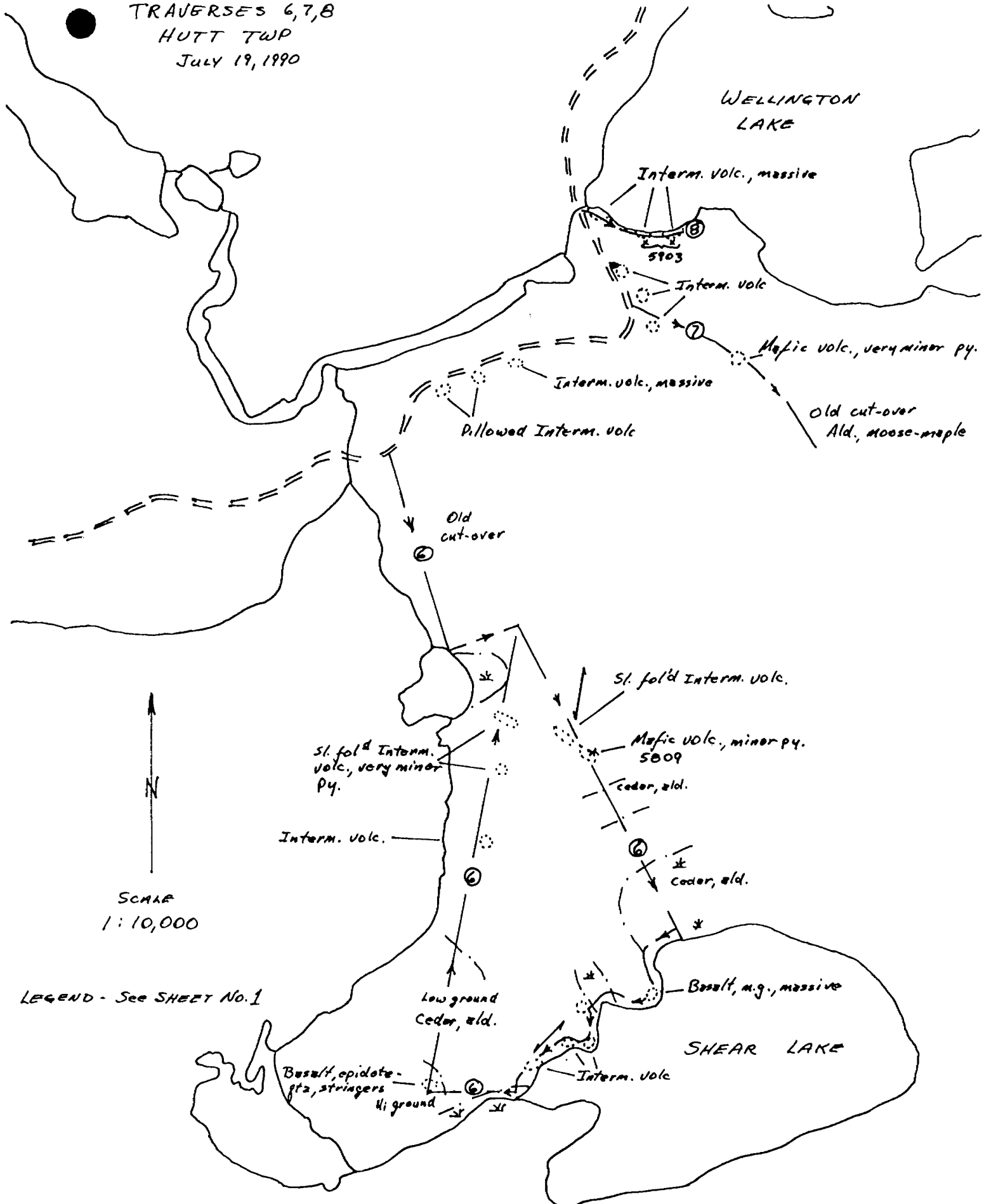

TRAVERSE 9
HUTT TWP
JULY 20, 1990

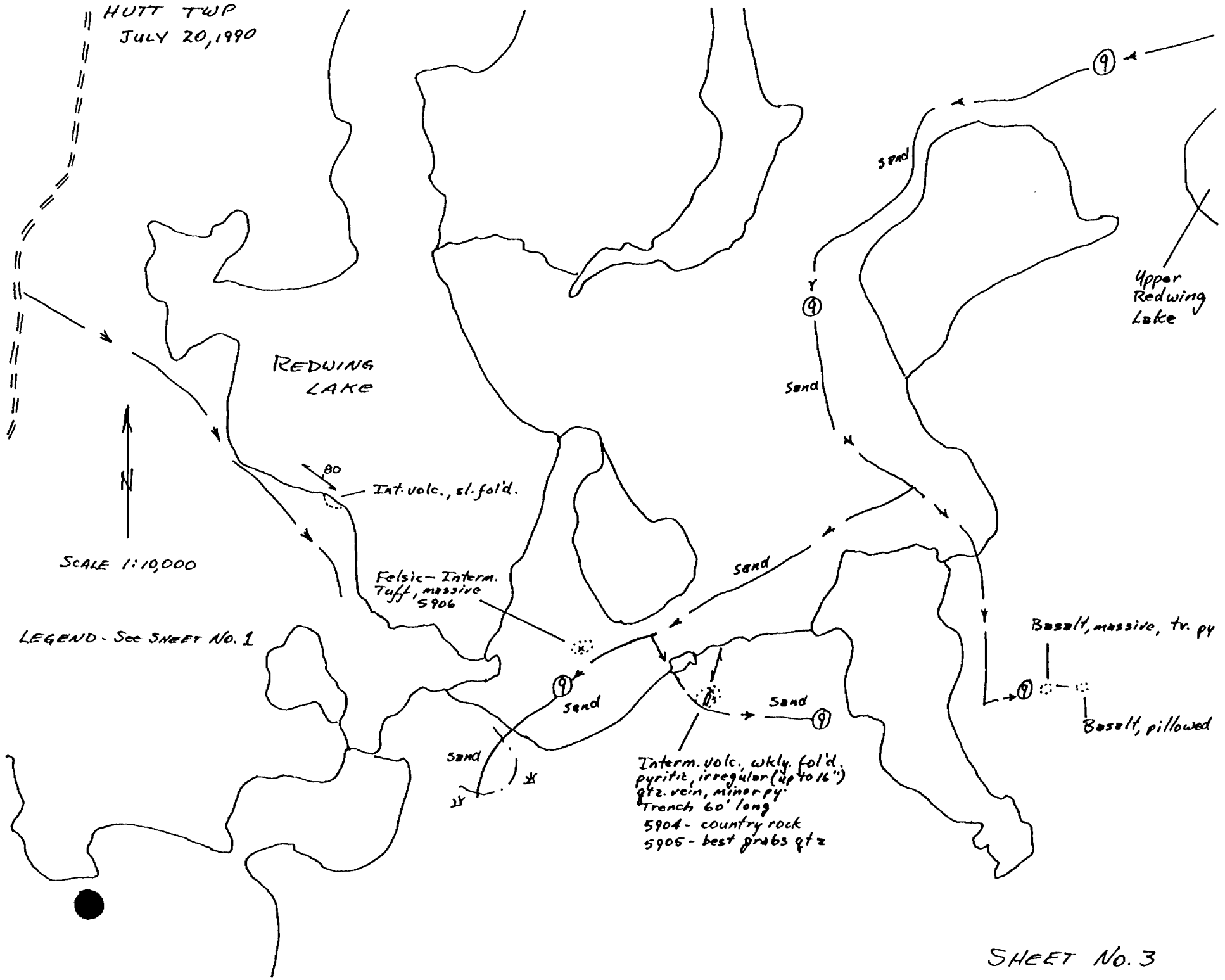

REDWING LAKE

Upper Redwing Lake

Int. volc., sl. fold.

Felsic-Interm. Tuff, massive 5906

Interm. volc. wkly. fold. pyritic, irregular (up to 16") qtz. vein, minor py. Trench 60' long 5904 - country rock 5905 - best grabs qtz

Basalt, massive, tr. py

Basalt, pillowed

SCALE 1:10,000

LEGEND - See SHEET No. 1

SHEET No. 3

TRAVERSES 10, 11, 12
JULY 20, 1990
MONTROSE TWP.

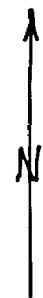

SCALE 1:10,000

LEGEND - See SHEET NO. 1

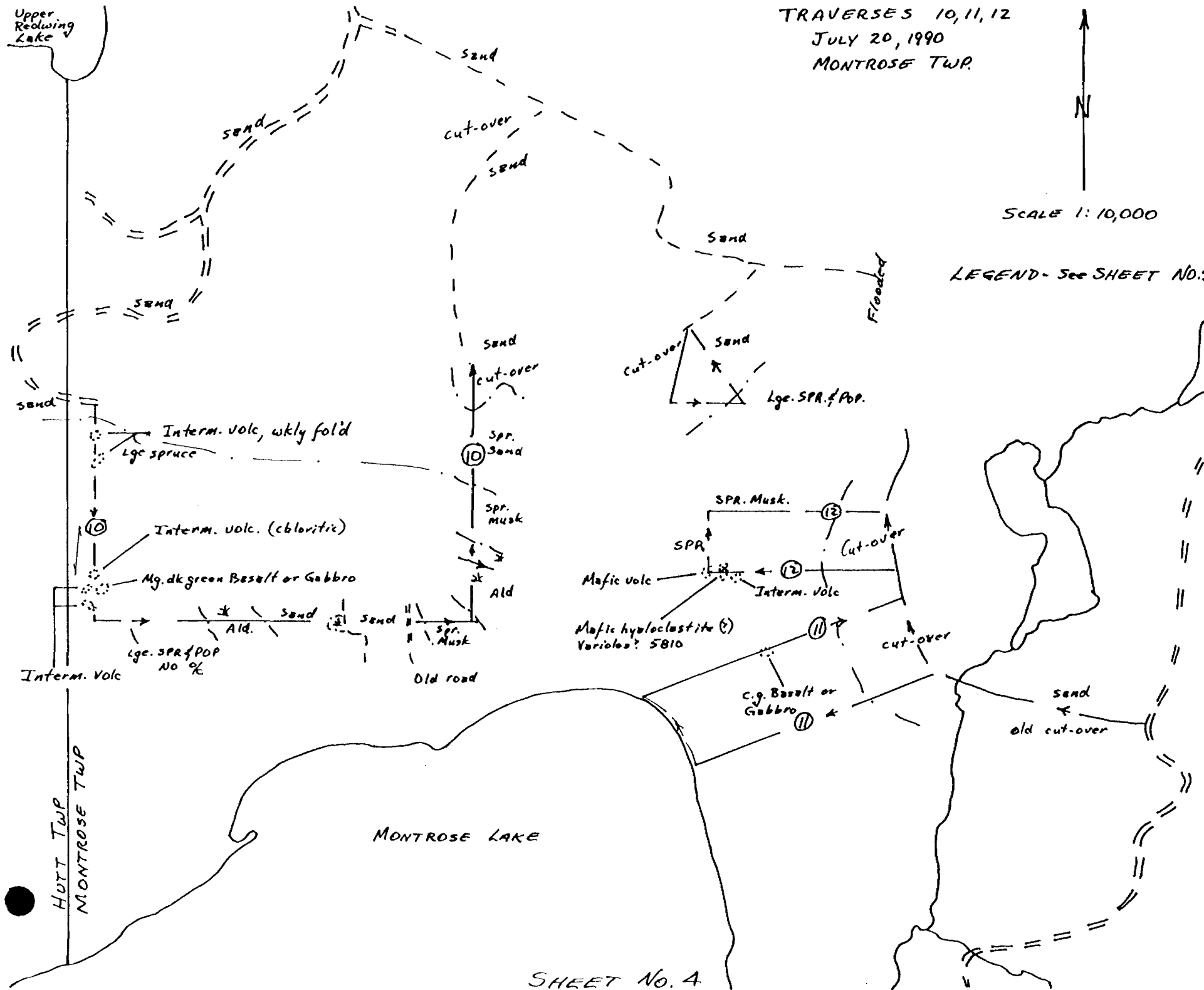

TRaverse 13
 HUTT TOWNSHIP
 SEPT. 10, 1990

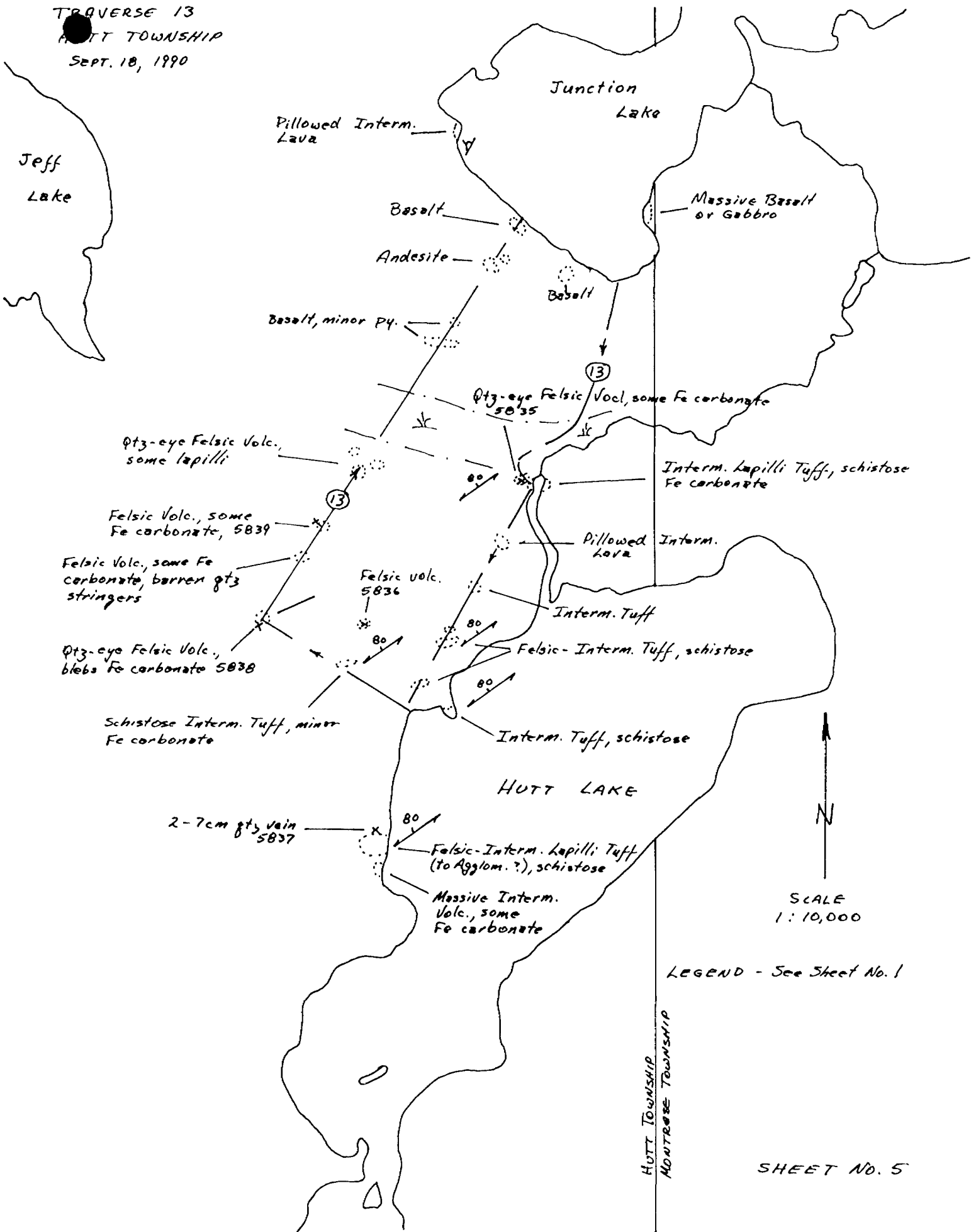

TRAVERSE 14
MONTROSE TOWNSHIP
SEPT. 19, 1990

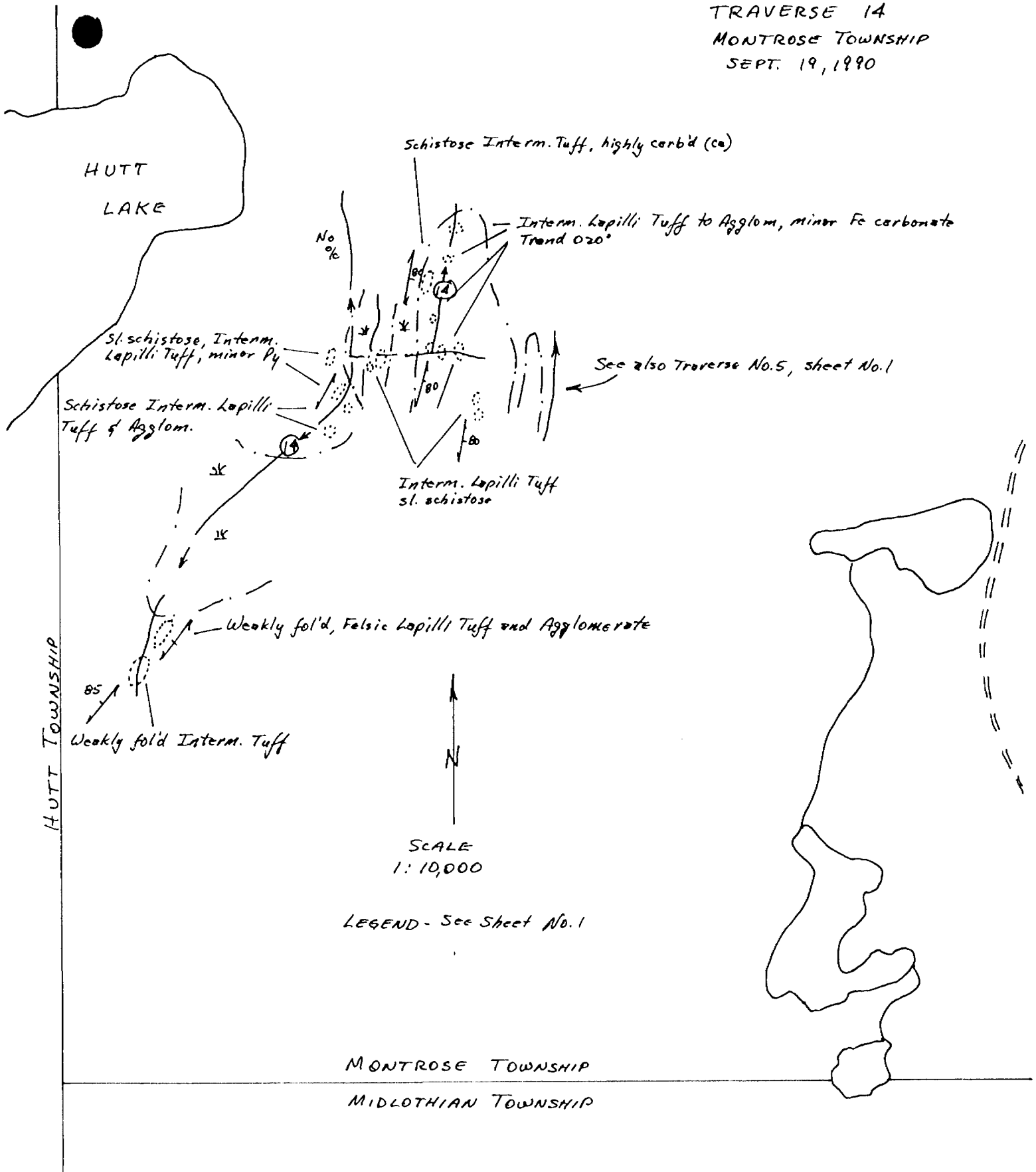

TRAVERSES 15, 16
 HUTT & MONTROSE TOWNSHIPS
 SEPT. 20, 1990

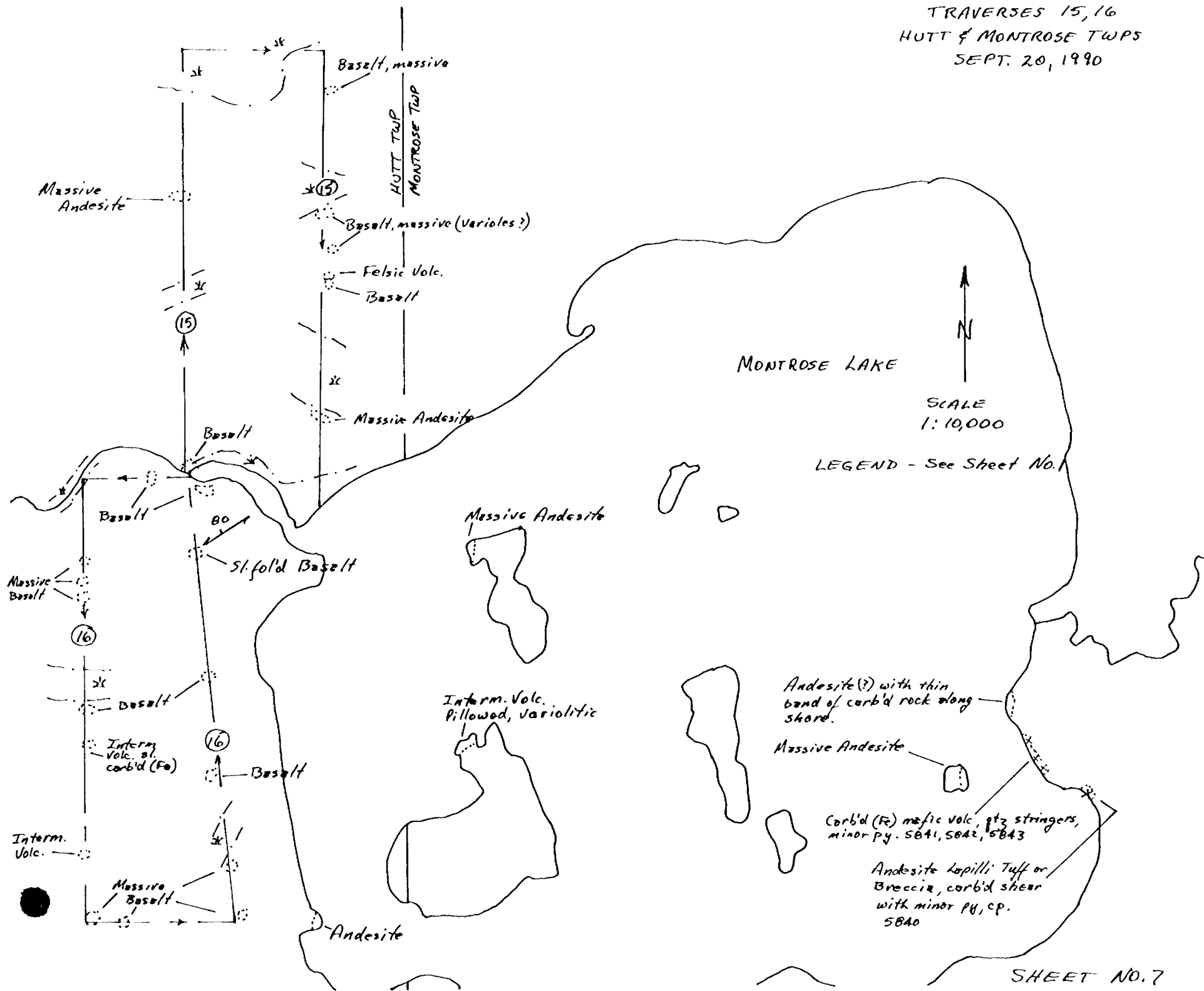

MONTROSE LAKE

SCALE
 1:10,000

LEGEND - See Sheet No. 1

SHEET NO. 7

HUTT
LAKE

TRAVERSE 17
MONTROSE TOWNSHIP
SEPT. 19, 21, 1990

SCALE
1:10,000

LEGEND - See sheet No. 1

HUTT TWP.
MONTROSE TWP.

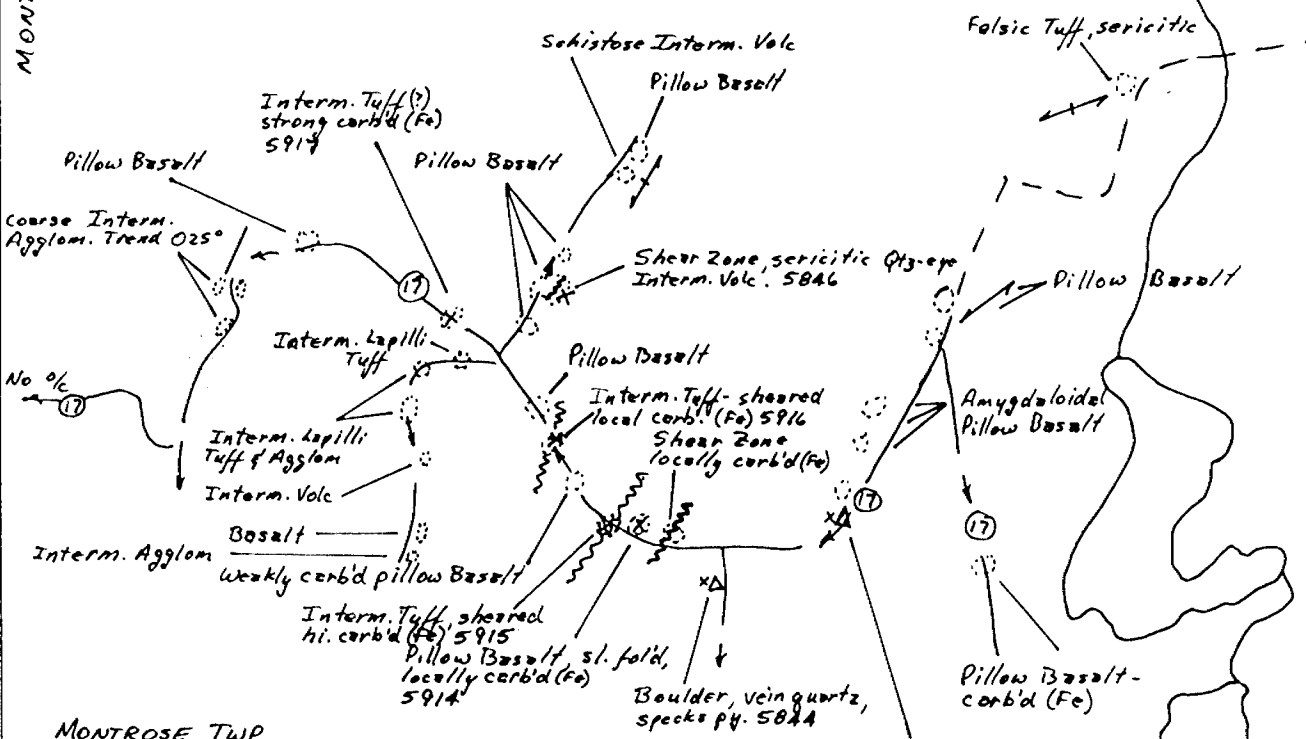

MONTROSE TWP
MIDLOTHIAN TWP

Boulder - carb'd (Fe) rock,
fuchsitic, specks py
5845

MONTROSE - HUTT AREA

SAMPLE NUMBER	TRAVERSE NUMBER	TYPE LENGTH	TRUE WIDTH	ASSAY Au. gbb	DESCRIPTION
5801	1	Grab		14	15% py. in carb'd(Fe) rock. occas. dtz/carb. veinlets
5802	1	Grab		2	Hl. carb'd rock. minor dtz. stringers. minor py
5803	1	Grab		<1	Carb'd fels. - interm. fragmental. minor py. & cross-cutting dtz. & carb. stringers
5804	1	Grab		2	Rhyolite tuff to agglom., minor py., pin-point Fe carb
5805	1	Grab		<1	Hl. carb'd rock. 3cm dtz. vein. minor py
5806	2	Grab		<1	Brown weather., siliceous volc., folid. minor py
5807	5	Grab		<1	Hl. carb'd schist (pillow basalt?)
5808	5	Grab		<1	Cherty iron formation with up to 10% py
5809	6	Grab		<1	Mafic volc., a few dtz. stringers. minor dissem. py
5810	12	Grab		<1	Mafic hyaloclastite
5835	12	Grab		<1	Qtz-eye rhyolite. Fe carb. alteration. specks py
5836	12	Grab		<1	Felsic volc., random dtz. veinlets to 5cm., minor py
5837	12	Grab		<1	Felsic to interm. fragmental. 2 - 7cm dtz. vein
5838	12	Grab		<1	Qtz-eye rhyolite. dtz. stringers. small blebs Fe carb
5839	12	Grab		<1	Moderately carb'd (Fe) rhyolite(?)
5840	Montrose L.	Grab		<1	Shear(?) with buff carb. frags., chlor. matrix. py. on
5841	Montrose L.	Grab		2	Hl. carb'd (Fe) green rock. micro dtz. stringers. minor py. in dtz. & wallrock. Possible spinifex
5842	Montrose L.	Grab		<1	Similar to 5841. dtz. veinlets to 2cm
5843	Montrose L.	Grab		<1	Qtz. veinlet 2 - 7cm in hl. carb'd (Fe) rock
5844	17	Grab		<1	Angular dtz. boulder (45x25x25cm). some orange-weather carb. minor py
5845	17	Grab		6	Boulder (25x12x7cm) carb'd (Fe). fuchsitic. specks py
5846	17	Grab		<1	Shear. carb'd (Fe). sericitic. dtz-eye interm. volc
5901	3	Grab		<1	Massive, brown weather basalt. trace py., on
5902	3	Grab		2	Massive dacite. 1 - 2 % py.
5903	3	Grabs/1.80m		<1	Massive interm. volcanic
5904	9	Grab		<1	Interm. volcanic. 4 - 5 % py. host to 5905
5905	9	Grab		<1	Qtz. veins to 40cm & stringers. minor py. Old trench
5906	9	Grab		<1	Massive, felsic - interm. tuff
5914	17	Grab		<1	Pillow basalt. local strong carb. (Fe)
5915	17	Grab		<1	Sheared interm. tuff. local heavy carb. (Fe)
5916	17	Grab		<1	Similar to 5915. occas. dtz. veinlets. minor py
5917	17	Grab		<1	Sheared & carb'd (Fe) interm. tuff. minor dtz. string



X-RAY ASSAY LABORATORIES

A DIVISION OF SGS SUPERVISION SERVICES INC.

1885 LESLIE STREET • DON MILLS, ONTARIO M3B 3J4 • CANADA
TEL: (416)445-5755 TELEX: 06-986947 FAX: (416)445-4152

CERTIFICATE OF ANALYSIS

REPORT 12503

TO: L.B. HALLADAY
2159 PARKER DRIVE
MISSISSAUGA, ONTARIO
L5B 1W3

CUSTOMER No. 1400

DATE SUBMITTED
24-Jul-90

REF. FILE 7937-E4

Total Pages 1

16 ROCKS

AU PPB	METHOD FADCP	DETECTION LIMIT 1.
--------	-----------------	-----------------------

DATE 26-JUL-90

CERTIFIED BY *[Signature]*

[Signature] Philip Boctor, Laboratory Manager

SAMPLE	AU PPB
--------	--------

5801	14
5802	2
5803	<1
5804	2
5805	<1
5806	<1
5807	<1
5808	<1
5809	<1
5810	<1
5901	<1
5902	9
5903	<1
5904	<1
5905	<1
5906	<1

XRAL

X-RAY ASSAY LABORATORIES

A DIVISION OF SGS SUPERVISION SERVICES INC.

1885 LESLIE STREET • DON MILLS, ONTARIO M3B 3J4 • CANADA
TEL: (416)445-5755 TELEX: 06-986947 FAX: (416)445-4152

CERTIFICATE OF ANALYSIS
REPORT 13270

TO: L.B. HALLADAY
2159 PARKER DRIVE
MISSISSAUGA, ONTARIO
L5B 1W3

CUSTOMER No. 1400

DATE SUBMITTED
24-Sep-90

REF. FILE 8468-A1

Total Pages 1

16 ROCKS

	METHOD	DETECTION LIMIT
AU PPB	FADCP	1.

DATE 01-OCT-90

CERTIFIED BY 

Philip Boctor, Laboratory Manager



SAMPLE AU PPB

5835	<1
5836	<1
5837	<1
5838	<1
5839	<1
5840	<1
5841	3
5842	<1
5843	<1
5844	<1
5845	6
5846	<1
5914	<1
5915	<1
5916	<1
5917	<1



41P14NE0203 63.5760 KELVIN

900

63.5760

OP90-122

2159 Parker Drive
Mississauga, Ontario
L5B 1W3
October 15, 1990

Ontario Prospectors Assistance Program
Incentives Office
Ministry of Northern Development and Mines
3rd Floor, 880 Bay Street
Toronto M5S 1Z8

Dear Sirs:

Re: File Number OP90 - 122

Enclosed herewith is a completed Final Submission Form with respect to this OPAP Grant, as well as two sets of the required data, each set consisting of data for two Project Areas, as follows:

- 1) report
- 2) detailed field sketches
- 3) plans of prospecting (2 sheets each Area)
- 4) description of samples
- 5) assay reports

As noted on the List Of Expenditures the total amount spent was \$5872.58.

Should you require clarification or additional data with respect to the enclosed, I may be reached at the above address.

Yours very truly,

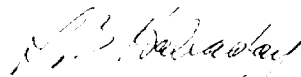
L. B. Halladay

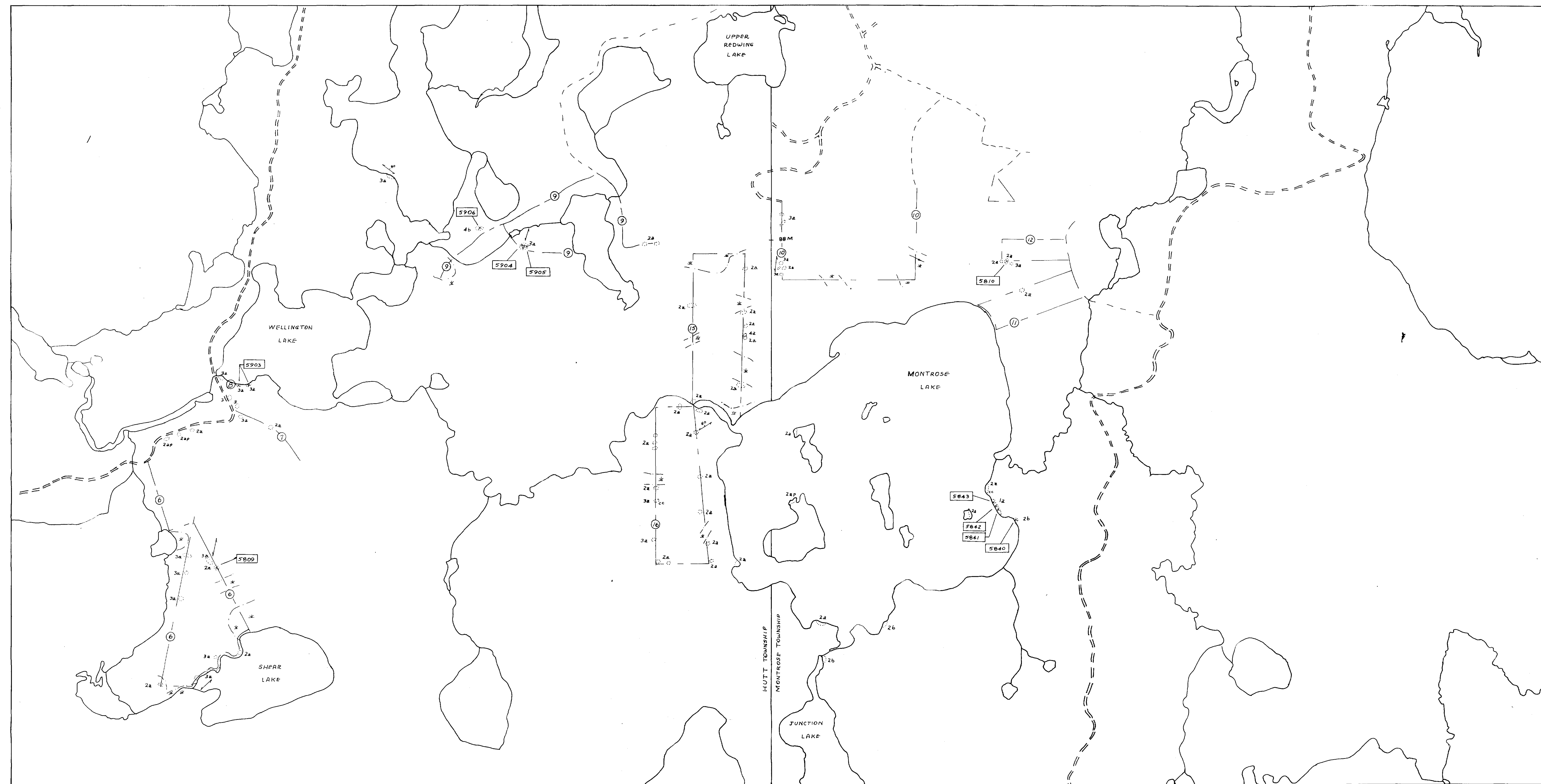

LEGEND

- 5 IRON FORMATION
- 4 FELSIC VOLCANICS - 4a flows; 4b tuff; 4c agglomerate
- 3 INTERMEDIATE VOLCANICS - 3a flows; 3b tuff; 3ap pillowed; 3c agglomerate
- 2 MAFIC VOLCANICS - 2a flows; 2ap pillowed; 2b tuff
- 1 ULTRAMAFIC VOLCANICS - 1a Fe-carbonate rock

SYMBOLS

- ④ TRAVERSE # NO.
- OUTCROP
- △ BOULDER
- x SAMPLE LOCATION
- 5804 SAMPLE NO.
- cc FE-CARBONATE ALTERATION
- ~ FAULT

**PROSPECTING MAP
MONTROSE - HUTT AREA**

NORTH SHEET

SCALE 1:10,000

OCTOBER 1990 Z.B. HALLADAY

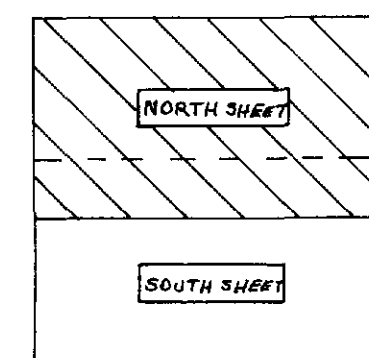

KEY MAP

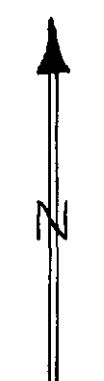
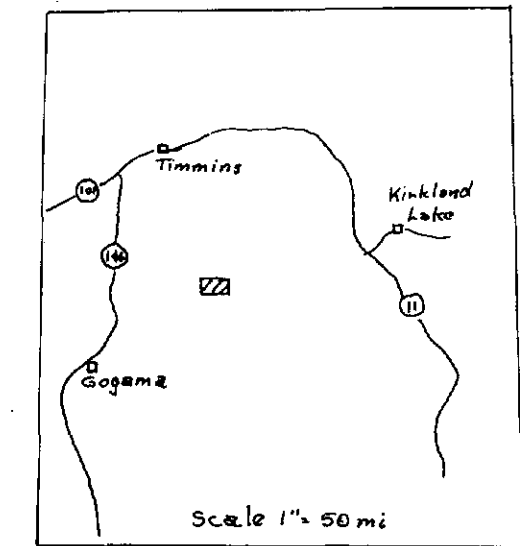

63.5760

63.5760



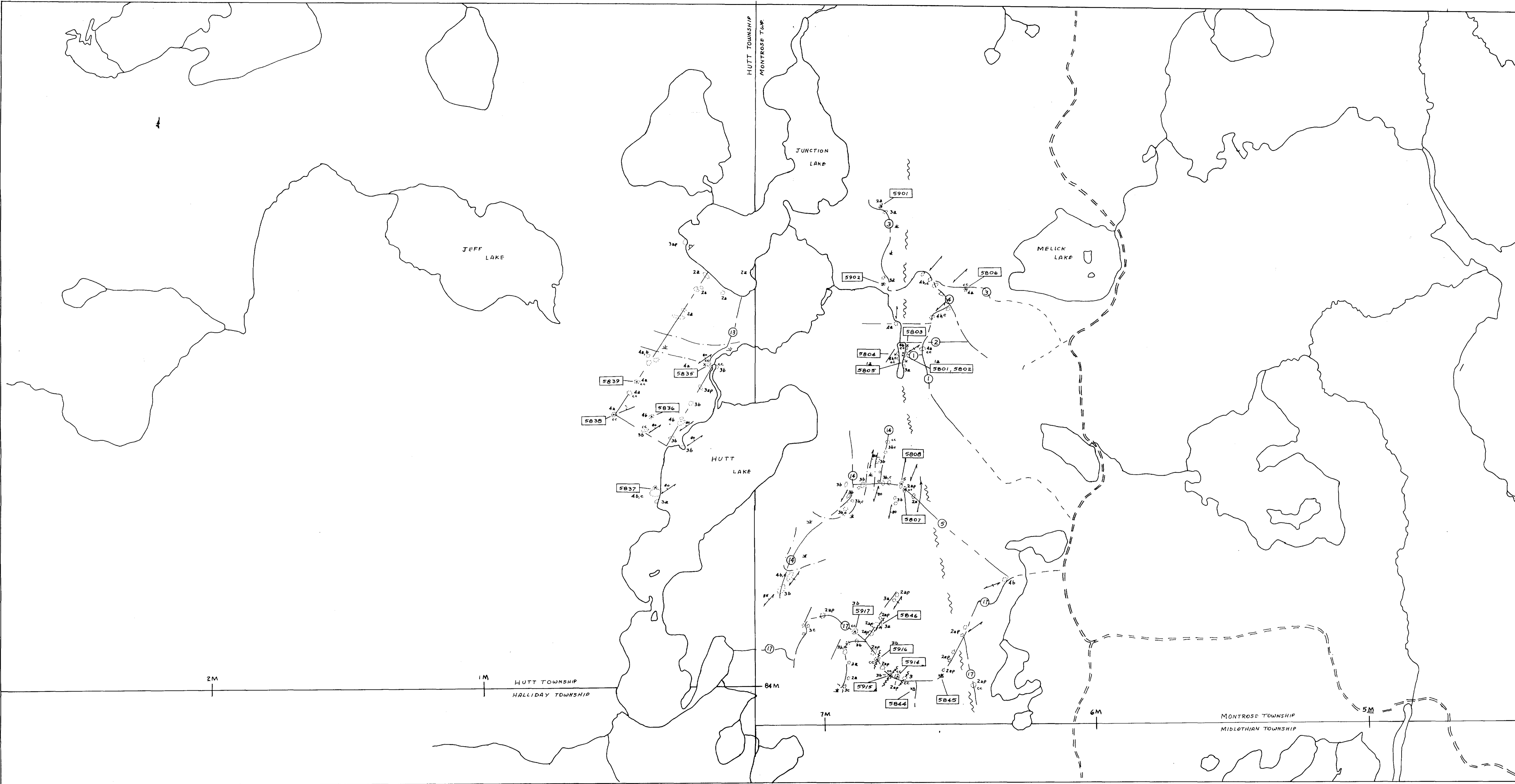

PROSPECTING MAP
 MONTROSE - HUTT AREA
 SOUTH SHEET
 SCALE 1:10,000

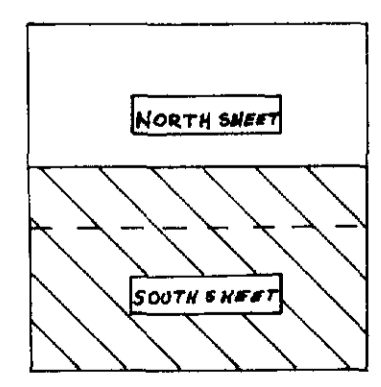

63.5760

OCTOBER 1990 L.B. HALLADAY

63.5760



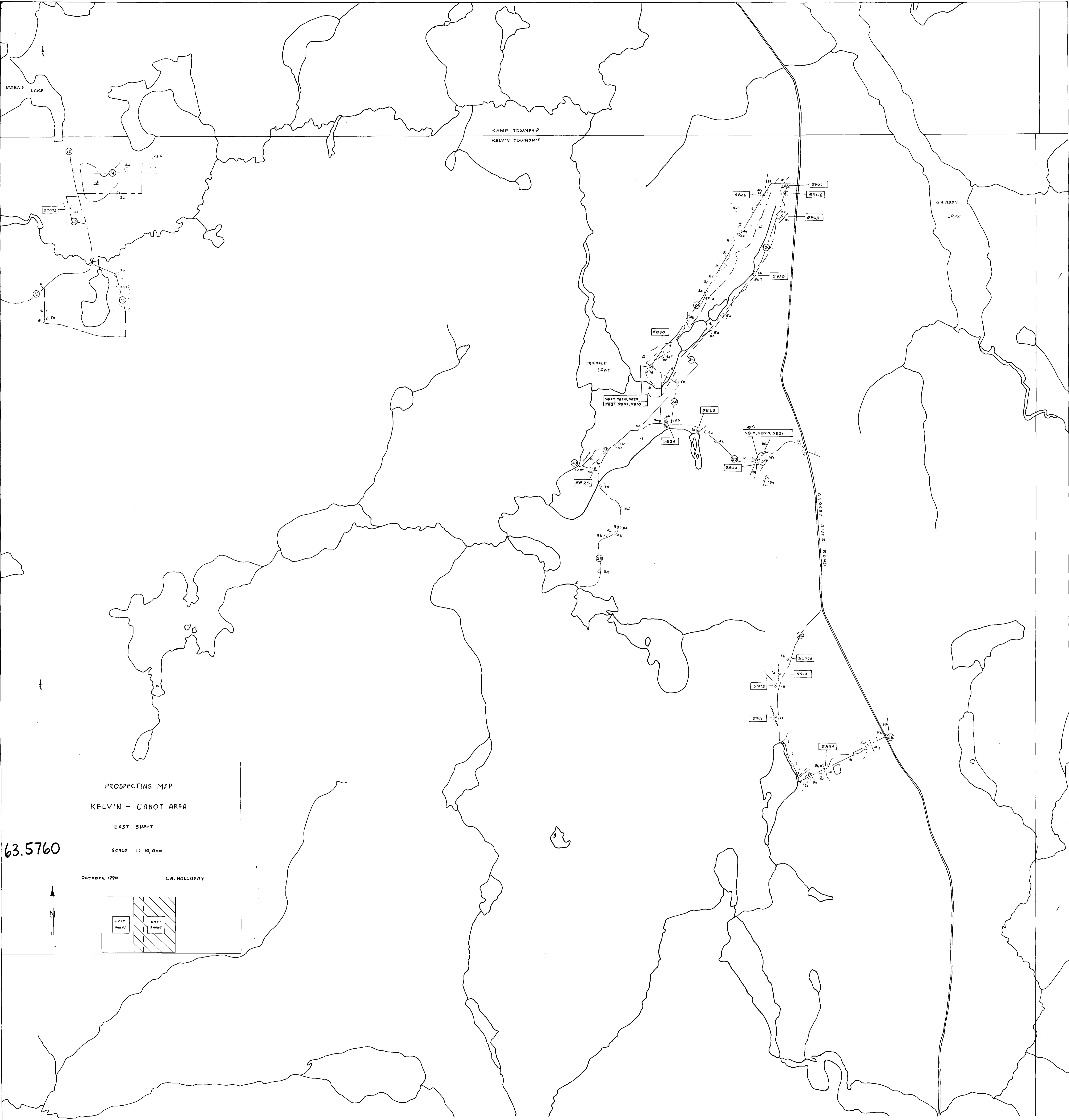

PROSPECTING MAP
 KELVIN - CABOT AREA

EAST SHEET
 SCALE 1:10,000

63.5760

OCTOBER 1990 L.B. HALLADAY

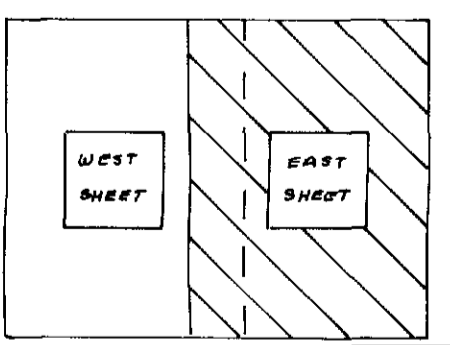
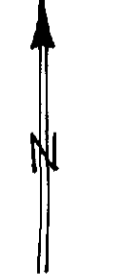

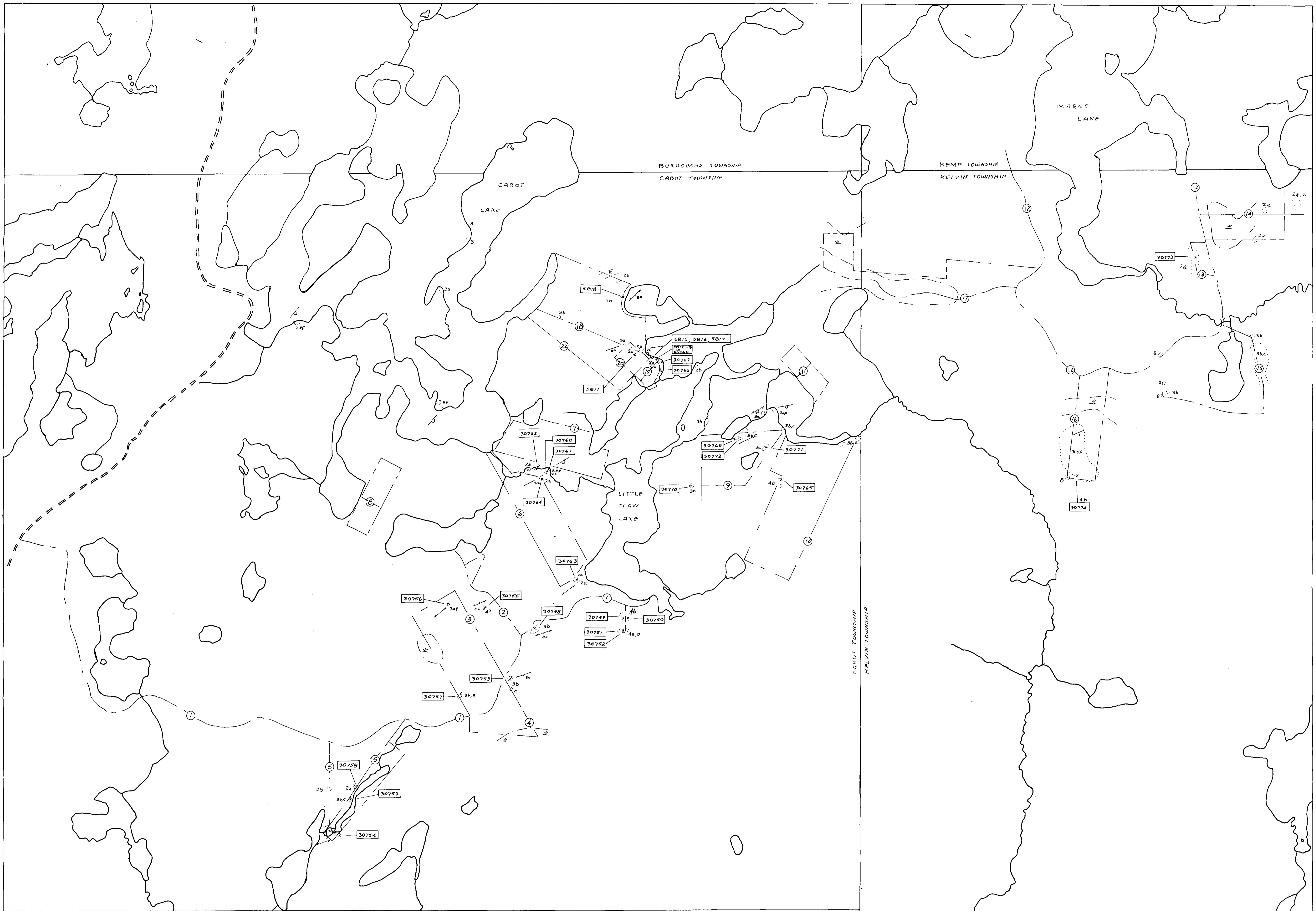

PROSPECTING MAP
 KELVIN - CABOT AREA
 WEST SHEET
 SCALE 1:10,000

OCTOBER 1990 L.B. HALLADAY

63.5760

LEGEND

- 8 DIABASE
- 7 FELSIC INTRUSIVES
- 6 MAFIC - INTERMEDIATE INTRUSIVES
- 5 SEDIMENTS - 5a Arkose; 5b Arkose greywacke; 5c Arkose; 5d Silt. sediment
- 4 FELSIC VOLCANIC - 4a flows; 4b tuff
- 3 INTERMEDIATE VOLCANIC - 3a flows; 3b pillowed; 3c tuff; 3d agglomerate
- 2 MAFIC VOLCANIC - 2a flows; 2b tuff; 2c pillowed
- 1 ULTRAMAFIC FLOW - 1a Fe-carbonate rock

SYMBOLS

- ③ TRAVERSE # No.
- OUTCROP
- △ BOULDER
- x SAMPLE LOCATION
- 5803 SAMPLE No.
- cc FE-CARBONATE ALTERATION

