



41P14NE8391 16 HUTT

010

DIAMOND DRILLING

TOWNSHIP: HUTT

REPORT NO.16

WORK PERFORMED FOR: Amax Exploration Inc.

RECORDED HOLDER: Same as above [xx]
: Other []

<u>Claim No.</u>	<u>Hole No.</u>	<u>Footage</u>	<u>Date</u>	<u>Note</u>
MR 45862	KX 14	810'	July-Aug/67	(1)
MR 45862-63	KX 9	450'	June/67	(1)
MR 45863-64	KX 8	445'	June/67	(1)
	KX 15	420'	Aug/67	(1)
	KX 16	281'	Aug/67	(1)

NOTES: (1) Received from the Mining Recorder - cancelled claims
- placed on file in Toronto Jan 18/88.

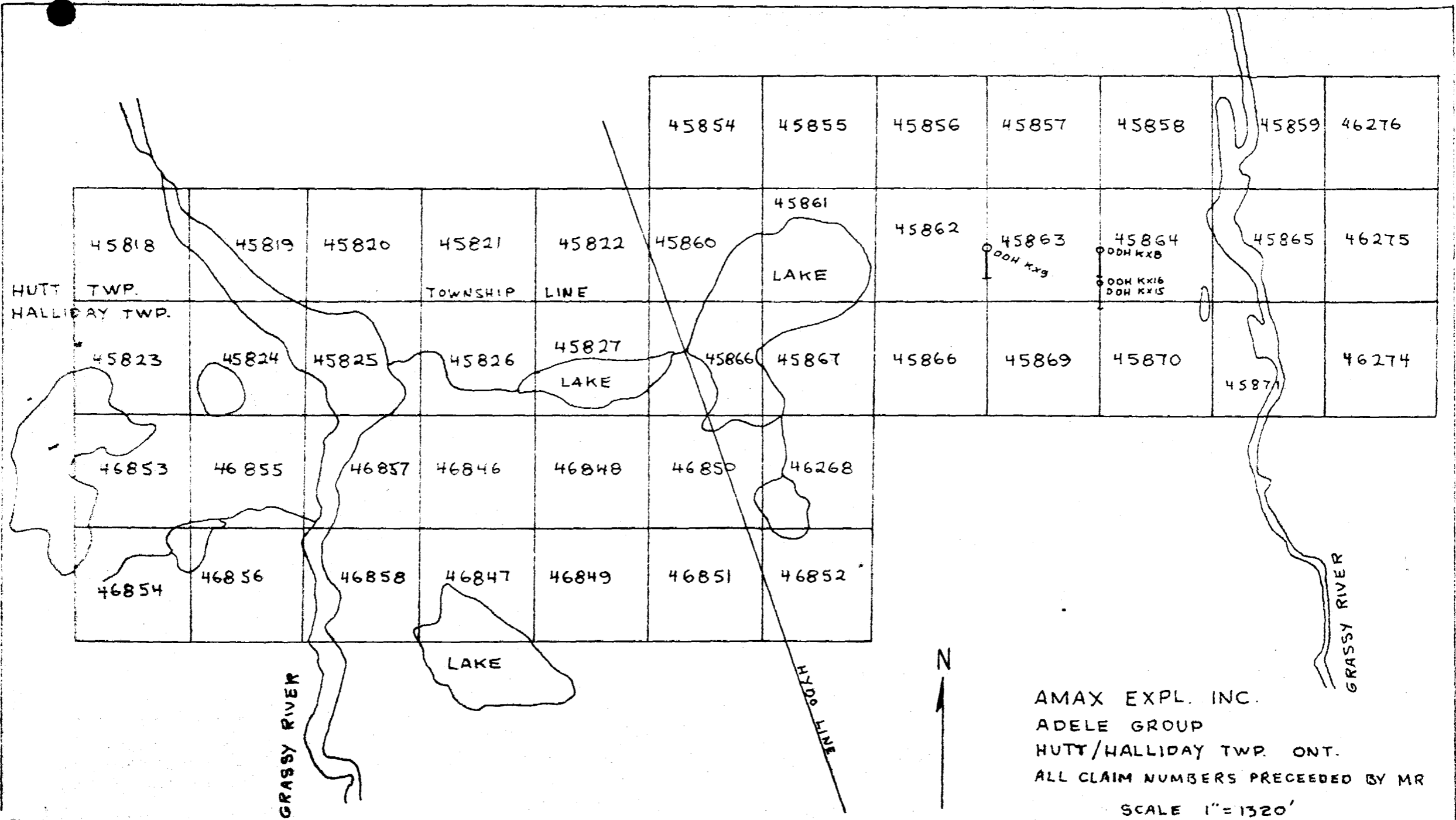

HUTT TWP.
HALLIDAY TWP.

TOWNSHIP LINE

LAKE

LAKE

LAKE

HYDRO LINE

GRASSY RIVER



AMAX EXPL. INC.
ADELE GROUP
HUTT/HALLIDAY TWP. ONT.
ALL CLAIM NUMBERS PRECEDED BY MR
SCALE 1"=1320'

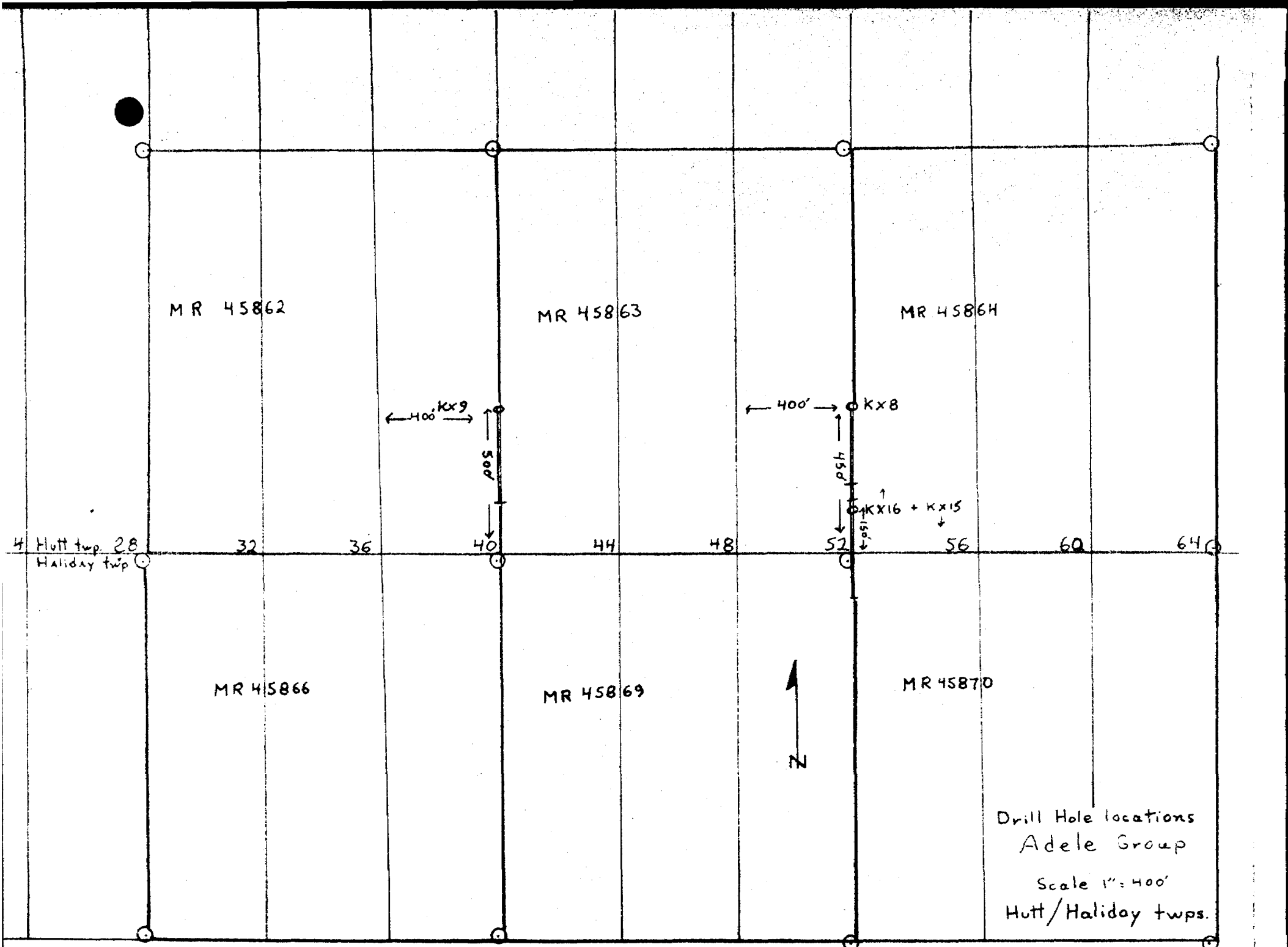

Amax Exploration Inc.

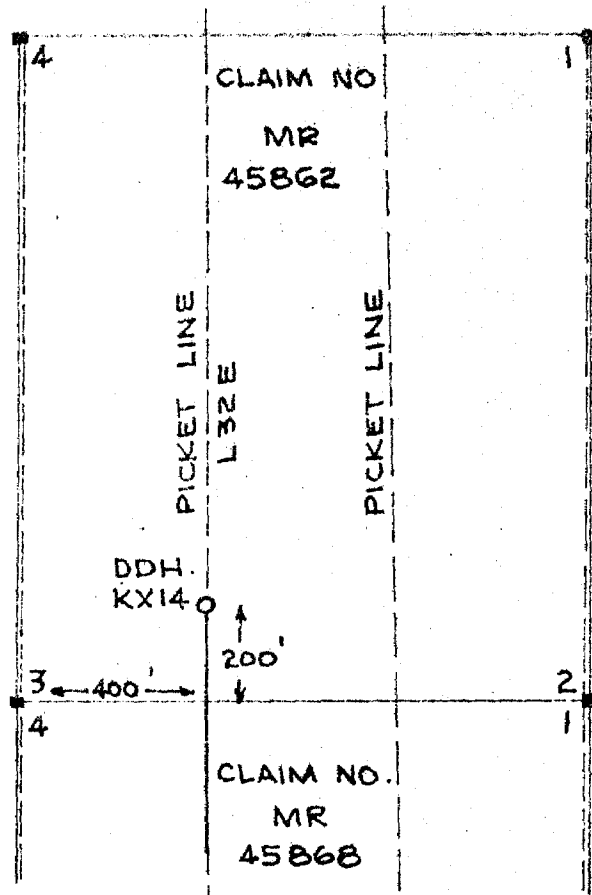

DDH. LOCATION SKETCH



SCALE 1"=400'

AMAX EXPLORATION INC.
ADELE GROUP

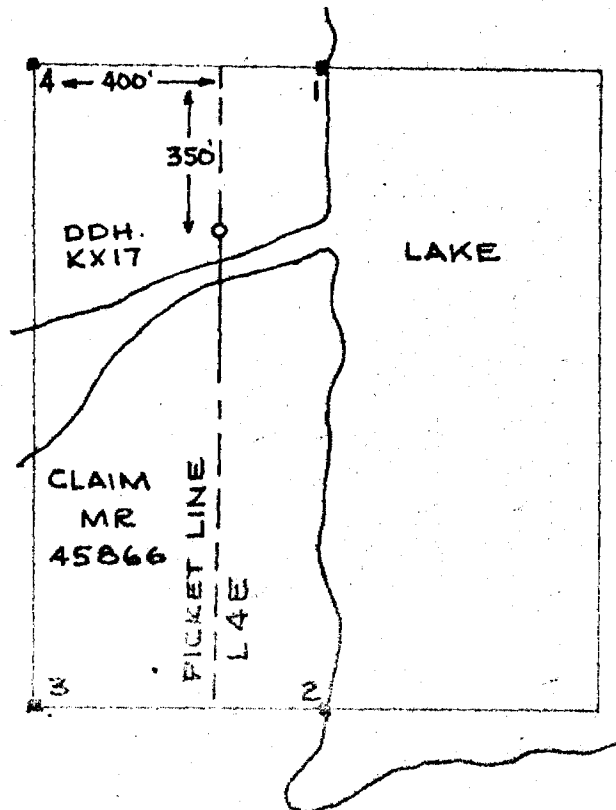

Hole No. KX8-67 Sheet 1

DIAMOND DRILL RECORD

Property ADELE GROUP Length 445' (at June 7th) Lat. LINE 52+00E Hor. Comp. TO CONTINUE Ver. Comp. -----
 Location HUTT TWP., ONT. Bearing DUE SOUTH Dep. 4+50N Etch at ----- Total Recovery % -----
 Commenced JUNE 6, 1967 Dip -45° Elev. ----- True Dip ----- Logged by J.N. OKELL
 Completed JUNE 9, 1967 Objective TEST E.M. CONDUCTOR 16 - 20

FOOTAGE		DESCRIPTION	SHORTS FEET	SAMPLE NO.	LENGTH FEET	ANALYSIS					RECOVERY %
FROM	TO					Cu	Pb	Zn	Au	Ag	
0	6	<u>OVERBURDEN</u> - Soil									
6	23	<u>ANDESITE</u> Medium to fine-grained, grey-green rock - massive.									
23	31	<u>RHYOLITE</u> Hard, fine-grained, structureless, light grey rock partially fractured and recemented by colourless quartz. White quartz vein at 29 feet ($\frac{1}{2}$ ") - no mineralization.									
31	44.5	<u>DACITE</u> Fine to medium-grained, grey-green granular rock. The granular fragments are rounded and elongated at 70° to core axis and more sialic than the matrix. At 43 feet - 2-inch white quartz vein occurs.									
44.5	153	<u>RHYO-DACITE</u> Medium to fine-grained rock composed of sialic bands at 35 to 40° to core axis, shearing and iron staining between 57 to 58' - 60 to 63' - 68 to 72' - 77 to 78' - 83 to 87' - 87.5 to 88'. The iron staining appears to be associated with the shearing, the rock being discoloured close to fractures. Lost core between 58 to 60' - 72 to 75' - 104 to 105' - 125 to 126'.	138 - 149'		(828)	.01	Trace	Nil			

Hole No. KX8-67 Sheet 2

DIAMOND DRILL RECORD

Property..... Length..... Lat..... Hor. Comp..... Ver. Comp.....
 Location..... Bearing..... Dep..... Etch at..... Total Recovery %.....
 Commenced..... Dip..... Elev..... True Dip..... Logged by.....
 Completed..... Objective.....

FOOTAGE		DESCRIPTION	SHORTS FEET	SAMPLE NO.	LENGTH FEET	ANALYSIS					RECOVERY %
FROM	TO					Cu	Pb	Zn	Au	Ag	
153	223	<p>Traces of pyrite are noted along a small number of the shears - chalcopyrite at 146 feet in rhyolite associated with small 1/2 inch quartz vein.</p> <p><u>FLOW BANDED RHYOLITE</u></p> <p>Light grey, medium green, hard rhyolite with banding at 40 to 45° to core axis. This section is broken and brecciated and appears to represent broken rhyolitic flows and not agglomerates as the fragments are angular and of the same composition. Fragment size is up to 2 inches.</p> <p>154 - 155' Disseminated pyrite (3%) in dark-banded and spotted rhyolite.</p> <p>155 - 157' Lost core</p> <p>157.5 - One-half inch band of conductive (80%) pyrite</p> <p>158 - 160' Lost core</p> <p>160 - 172' Fragmental Zone - fragment/matrix ratio 4 to 1 containing bands of pyrite at 167 feet (3/4") - 168 feet (1/2") - 171 feet (1/2") - 171.5 (3/4") - disseminated pyrite to 3% in above section.</p>	160 - 172'	(829)	.02	Trace	Nil				
223	445	<p><u>RHYOLITE</u></p> <p>Rhyolite becoming increasingly massive and hard at depth, less broken than above (colour variation from light grey to medium green-grey).</p> <p>Amygdaloidal zones with siliceous "eyes" are present to 380 feet.</p>	405 - 421'	(826) - (827)	.07 - .01	Trace	Trace				
			410 - 415'	(873)	.09						
			415.2 - 416'	(871)	3.74	.02	.04	Nil	.39 oz.		
			416 - 421'	(872)	.05						
			421 - 425'	(827)	.01	.01	Trace				

Hole No. KX9-67 Sheet 1

DIAMOND DRILL RECORD

Property ADELE GROUP

Length 450'

Lat. LINE 40+00E

Hor. Comp. 322'

Ver. Comp. 322'

Location HUTT TWP., ONT.

Bearing DIRECT SOUTH

Dep. 5+00N

Etch at NO TEST

Total Recovery % ---

Commenced JUNE 12, 1967

Dip -45°

Elev. ----

True Dip NO ACID TEST

Logged by J.N. OKELL

Completed JUNE 16, 1967

Objective TEST E.M. CONDUCTOR - 20

FOOTAGE		DESCRIPTION	SHORTS FEET	SAMPLE NO.	LENGTH FEET	ANALYSIS		RECOVERY %
FROM	TO							
0	20	<u>OVERBRUDEN</u>						
20	74	<u>RHYO-DACITE</u> Medium to fine-grained, grey-green siliceous flows banded at 55 to 60° to core axis - weathering present but decreasing with depth - no mineralization.						
74	168	<u>TUFF - SIALIC</u> Small (1/4") rounded siliceous fragments set in fine-grained, grey-green matrix. Ratio of fragments to matrix, one to three. 133-138' Graphitic tuff, small carbonaceous fragments and siliceous fragments (50-50) set in dark, fine-grained matrix. Pyrite to 3 percent occurs as disseminated crystals.						
168	188	<u>GRAPHITE</u> Massive graphite containing up to 8 percent pyrite as stringers and rounded blebs - zone 80 percent conductive. Lost core between 170 to 172' and 173 to 173.5'.						
188	300	<u>RHYOLITE</u> Hard structureless, light grey, fine-grained siliceous rock. Randomly orientated fractures filled with black						

DIAMOND DRILL RECORD

Hole No. KX14 Sheet 2
 Property ADELE GROUP Length 810' Lat. LINE 32+00E Hor. Comp. 521' Ver. Comp. 618'
 Location HUTT/HALLIDAY TWP. Bearing SOUTH Dep. 2+00N Etch at NO TEST Total Recovery % 81
 Commenced JULY 27, 1967 Dip -50⁰ Elev. ----- True Dip ----- Logged by P. Kolbe
 Completed AUG. 6, 1967 Objective TEST I.P. ANOMALY

FOOTAGE		DESCRIPTION	SHORTS FEET	SAMPLE NO.	LENGTH FEET	ANALYSIS					RECOVERY %
FROM	TO										
722	755	<u>SILICEOUS DACITE</u> As 514-722, but more massive, slightly coarser grained, only trace disseminated py.									99
755	810	<u>DACITE</u> Medium grey, sections brecciated; containing grey-green, fine-grained, angular, 1", fragments (25%) in a steel-grey, fine-grained matrix (75%). Py averages 4% over total sections and occurs as finely disseminated crystals in the matrix.									99
810		End of hole KX14.									

P. Kolbe

Hole No. KX15-67 Sheet 1

DIAMOND DRILL RECORD

Property ADELE GROUP

Length 420'

Lot. LINE 52'00E

Hor. Comp. 297'

Ver. Comp. 297'

Location HUFF/HALLIDAY TWP., ONT

Bearing GRID SOUTH (SOUTH)

Dep. 1.50N

Ech at NO TEST

Total Recovery % 92

Commenced AUG. 9, 1967

Dip -45°

Elev. 55' below 4 50N (KX8-67) true Dip

Logged by P. KOLBE

Completed AUG. 12, 1967

Objective FURTHER EXPLORE I.P. ANOMALY ON L52E AND INTERSECT CHALCOPYRITE MINERALIZATION FOUND IN KX8-5'

FOOTAGE		DESCRIPTION	SHORTS FEET	SAMPLE NO.	LENGTH FEET	ANALYSIS
FROM	TO					
0	20	<u>OVERBURDEN</u> Medium grey-brown, clayey silt.				
20	46	<u>GRAPHITIC TUFF BRECCIA - G1 (breccia)</u> Total graphite 15%, conductivity low to medium. Dark, angular, graphitic, 1/2" to 2" fragments (50%) are set in an acid, medium-grey, carbonate-altered groundmass. <u>Sulphides</u> - Pyrite 5%, mainly disseminated and as a few small globules up to 1/4" in the groundmass associated with the carbonate alteration. 39 - 46' - Angular, fine-grained, acid tuff fragments (70%) up to 2" set in a dark graphitic groundmass. Strongly altered by carbonate. Py 10-15% as small nodules and disseminated, mainly associated with carbonate.				
46	79	<u>RHYODACITE</u> Light brownish-grey, fine-grained. Unevenly fractured, cemented by dark, graphitic (?), carbonate and a little quartz. Pyrite, 3%, disseminated, concentrated near fractures. A few thin (1/4") carbonate veins. At 79 feet, a 1 1/2" barren carbonate vein at 45° to core axis shows some quartz.				
79	173	<u>GRAPHITIC TUFF</u> Unevenly dark-grey to black, fractured, in places brecciated. Total average graphite 18%. Conductivity low,				

Hole No. KX15-67 Sheet 2

DIAMOND DRILL RECORD

Property	Length	Lat.	Hor. Comp	Ver. Comp
Location	Bearing	Dep	Etch at	Total Recovery %
Commented	Dip	Elev	True Dip	Logged by
Completed	Objective			

FOOTAGE		DESCRIPTION	SHORTS FEET	SAMPLE NO	LENGTH FEET	ANALYSIS
FROM	TO					
		<p>rising to medium in sections of 2-3' showing higher (up to 30%) graphite, e.g. 119-122', 152-154', 163-166'.</p> <p><u>Sulphides</u> - Average 5% pyrite, patchily disseminated and as some 1/4" blebs. Broken remnants of concentrically layered 1/2" nodules occur at 111.5'.</p> <p>108.5-110.5' - 20% pyrite as 1/4" globules, disseminated and as a few irregular stringers (best pyrite section).</p> <p>92-105' - Graphitic tuff breccia as 20-46'.</p> <p>105-112' - Acid tuff, medium-grey, with gradational contact above and below, slightly fractured with dark graphitic (?) material cementing fractures.</p> <p>145-170' - Many carbonate veins up to 1" (av. 1/4") white, occasionally slightly pink, barren, cut core axis at all angles.</p>				
173	353	<p><u>RHYODACITE</u></p> <p>Fine-grained, light grey, fairly soft, somewhat altered by carbonation, strongly fractured, with mm-wide fractures cemented by white carbonate and to a lesser degree by fine-grained, dark-grey, slightly graphitic material.</p> <p>273-326.5' - This subsection is more strongly fractured, in places to the point of incipient brecciation. Many post-fracture, irregular 1/4" to 1" barren, white, carbonate veinlets and a few barren quartz stringers (1/4 - 1/2") cut the core at randomly varying angles. A few composite quartz-carbonate veinlets occur, where quartz may be earlier (?).</p>				

DIAMOND DRILL RECORD

Property..... Length..... Lat..... Hor. Comp..... Ver. Comp.....
 Location..... Bearing..... Dip..... Etch at..... Total Recovery %.....
 Commenced..... Dia..... Elev..... True Dip..... Logged by.....
 Completed..... Objective.....

FOOTAGE		DESCRIPTION	SHORTS FEET	SAMPLE NO.	LENGTH FEET	ANALYSIS	
FROM	TO						
		<p><u>Sulphides</u> - 3-5% pyrite occurs as 1/4" blebs and disseminated concentrated in and near slightly darker fracture zones.</p>					
353	20	<p><u>RHYODACITE</u></p> <p>Fine-grained, becoming slightly coarser with depth; medium-grey; only slightly fractured, becoming more massive with depth; hard, only very slightly altered by carbonate. Only few 1/4" carbonate stringers occur, becoming fewer with depth. A few of the fractures show light green epidote (?) alteration extending to 1" into the rock.</p> <p>Pyrite, less than 3%, occurs as a few irregular, 1/8" stringers and irregular blebs associated with occasional fractures in the upper section and as disseminated crystals, some euhedral cubic, 1mm and smaller, also becoming less frequent with depth.</p> <p style="text-align: center;">END OF HOLE</p>					

DIAMOND DRILL RECORD

Property **ADELE GROUP** Length **281'** Lat. **LINE 52.00E** Hor. Comp. **25'** Ver. Comp. **280'**
 Location **HUTT/HALLIDAY TWP., ONT.** Bearing **GRID NORTH (NORTH)** Dep. **1.50N** Etc. at **NO TEST** Total Recovery % **87**
 Commenced **AUG. 12, 1967** Dip **-85°** Elev **55' BELOW 4.50N (KX8-67)** True Dip
 Completed **AUG. 14, 1967** Object **FURTHER EXPLORE I.P. ANOMALY ON L52E AND INTERSECT CHALCOPYRITE MINERALIZATION FOUND IN KX8-67** Logged by **P. KOLBE**

FOOTAGE		DESCRIPTION	SHORTS FEET	SAMPLE NO.	LENGTH FEET	ANALYSIS	RECOVERY %
FROM	TO						
0	19	<u>OVERBURDEN</u> Grey-brown clayey silt.					
19	100	<u>GRAPHITE TUFF</u> Dark grey to black with graphite content varying between 5% to 20%, average 20%. Conductivity varies with graphite and sulphide content from low to medium. Rock is strongly fractured, in places brecciated, with subsequent carbonate cementation. Sulphides average 10-15% pyrite occurring in decreasing amounts as (1) irregular stringers and blebs up to 1/4", concentrated near fracturing and brecciation, (2) disseminated, very fine-grained, associated mainly with carbonaceous cement in the matrix of brecciated sections, (3) disseminated, discreet crystals, less than 1mm, scattered throughout, and as (4) rare, irregularly shaped to sub-rounded nodules, up to 1" diameter, some embedded in a 1mm-thick white carbonate film, found especially in the more strongly graphitic sections. 74-79' - Brecciated and fractured, consisting of irregularly shaped, grey, soft and strongly carbonate-altered acid tuff fragments of up to 2" in a dark graphitic matrix, the latter constituting 20%. Pyrite, 35%, occurs throughout as numerous 1/4" blebs, in places coalescing into stringers and disseminated in fragments, associated with carbonate. 79-100' - Tectonic (?) breccia of irregularly shaped graphitic tuff fragments (85%) in a light carbonate matrix. A few later (?) barren carbonate veinlets up to 1/2" cut the section randomly.					73

DIAMOND DRILL RECORD

Property: _____ Length: _____ Lat: _____ Hor. Comp: _____ Ver. Comp: _____
 Location: _____ Bearing: _____ Dep: _____ Etch at: _____ Total Recovery %: _____
 Commenced: _____ Dip: _____ Elev: _____ True Dip: _____ Logged by: _____
 Completed: _____ Objective: _____

FOOTAGE		DESCRIPTION	SHORTS FEET	SAMPLE NO	LENGTH FEET	ANALYSIS		RECOVERY %
FROM	TO							
100	139	<p>Complete core loss at: 26-30', 37.5-39', 69-70', 71.5-72.5', 73--73.8'.</p> <p><u>ACID LAPILLI TUFF</u></p> <p>Light grey-brown kaolinized (?), acid, fine-grained, angular fragments of up to 2" are set in a fine-grained acid, grey to dark, slightly graphitic, non-conductive matrix. Most to matrix ratio averages 1:1. Breccia may be volcanic with a gradational contact over 1' from the granitic, probably tectonic tuff breccia at 100'. Suggestion of some length-wise orientation of fragment at 25° to core axis.</p> <p>A few barren carbonate stringers up to 1/2" follow earlier fractures at 45° and 135°.</p> <p>Three percent pyrite occurs as irregular blebs and disseminated, associated with the darker matrix.</p>						91
139	241	<p><u>PHYTODACITE</u></p> <p>Fine-grained, light to medium grey with gradational contact over 139-149' from the above breccia.</p> <p>Competent, nearly massive rock, with occasional fractures marked by a darker grey colour over lengths of up to 1' and associated with later white carbonate stringers of up to 1/2".</p> <p>Pyrite, 2% or less, occurs only as rare 1/8" blebs or stringers associated with fractures.</p>						92

DIAMOND DRILL RECORD

Property _____ Length _____
 Location _____ Bearing _____
 Commenced _____ Dip _____
 Completed _____ Objective _____
 Lat. _____
 Dep. _____
 Elev. _____
 Hor. Comp. _____
 Etch at _____
 True Dip _____
 Ver. Comp. _____
 Total Recovery % _____
 Logged by _____

FOOTAGE		DESCRIPTION	SHORTS FEET	SAMPLE NO.	LENGTH FEET	ANALYSIS	RECD. #
FROM	TO						
		At 202', 4" barren white carbonate vein at 65° to core axis.					
		213-222' - Sheared zone, altered by barren carbonate, marked by strong flow of underground water.					
241	281	<u>RHYODACITE</u> Fine-grained, medium-grey, massive, showing some 1/8 to 1/4" light and dark carbonate-filled specs. Pyrite less than 2% occurs only as rare 1/8" angular blebs.					50 98
		272-281' - Core shattered, no core loss.					
		END OF HOLE					



41P14NE8391 16 HUTT

900

ONTARIO

required for each type of work to be recorded.

THE MINING ACT REPORT OF WORK

To the Recorder of Montreal River Mining Division

I, Amax Exploration, Inc. name of Recorded Holder A-38495 Miner's Licence

Suite 1302, 7 King Street East, Toronto 1, Ontario, Post Office Address

do hereby report the performance of 1596 days of Diamond Drill Coring type of work

not before reported to be applied on the following contiguous claims (Total 45)

Table with columns: Claim No., Days, Claim No., Days, Claim No., Days. Lists claims MR45818 through MR45855 and MR45856 through MR45867 with 35 days each.

All the work was performed on Mining Claim (s) MR45862, 45863, 45864, Hutt Ave. (In the case of geological and/or geophysical survey (s) where more than 18 claims are involved attach a schedule)

READ CAREFULLY: THE FOLLOWING INFORMATION IS REQUIRED BY THE MINING RECORDER.

For Manual Work, Stripping or Opening up of Mines, Sinking Shafts or Other Actual Mining Operations - Names and addresses of the men who performed the work and the dates and hours of their employment.

For Diamond and other Core Drilling - Footage, No. and angle of holes and diameter of core. Name and address of owner or operator of drill. Dates when drilling was done. Signed core log and sketch in duplicate.

For Compressed Air or Other Power Driven or Mechanical Equipment

Type of drill or equipment. Names and addresses of men engaged in operating equipment and the dates and hours of their employment.

For Power Stripping - Type of equipment. Name and address of owner or operator. Amount expended. Dates on which work was done. Proof of actual cost must be submitted within 30 days of recording.

With each of the above types of work sketches are required to show the location and extent of the work in relation to the nearest claim post. In the case of diamond or other core drilling the sketch must be submitted in duplicate.

For Geological and Geophysical Survey - The names and addresses of men employed as well as dates. Type of instrument used in the case of geophysical survey. Reports and maps in duplicate must be filed with the Minister within 60 days of recording.

For Land Survey - the name and address of Ontario Land surveyor.

The Required Information is as Follows: (Attach a list if this space is insufficient)

No. of Holes: KX8, KX9, KX15, KX16
Footage: 445', 450', 420', 281'
Angle: -45°, -45°, -45°, -85°
Diameter of Core: AXT
Drillers: Boyles Bros. (Quebec) Ltd., Noranda, Quebec.
Dates: June 6 to August 14, 1967.

Date 30 October, 1968

Signature of Recorded Holder or Agent (Peter Kolbe)

The Mining Act Certificate Verifying Report of Work

I, Peter Kolbe P. O. Box 277, Kirkland Lake, Ontario. (Post Office Address)

hereby certify:

- 1. That I have a personal and intimate knowledge of the facts set forth in the report of work annexed here-to, having performed the work or witnessed same during and/or after its completion.
2. That the annexed report is true.

Dated 30 October, 1968

Signature (Peter Kolbe)

Peter Kolbe

RECORDED NOV 1 1968 REC. No.

THE PENALTY FOR MAKING A FALSE STATEMENT IN THIS REPORT AND/OR CERTIFICATE IS \$500. OR SIX MONTHS IMPRISONMENT OR BOTH



ONTARIO

THE MINING ACT REPORT OF WORK

A separate form is required for each type of work to be recorded.

To the Recorder of Montreal River Mining Division

I, Amax Exploration, Inc. name of Recorded Holder A-38495 Miner's Licence

Suite 1302, 7 King Street East, Toronto 1, Ontario Post Office Address

do hereby report the performance of 1596 days of Diamond Drill Goring type of work

not before reported to be applied on the following contiguous claims

Table with 6 columns: Claim No., Days, Claim No., Days, Claim No., Days. Contains entries for MR46276, MR46846, and MR46851-56 with 35 days each, plus MR46857 and MR46858.

All the work was performed on Mining Claim (s) (In the case of geological and/or geophysical survey (s) where more than 18 claims are involved attach a schedule)

READ CAREFULLY: THE FOLLOWING INFORMATION IS REQUIRED BY THE MINING RECORDER.

- For Manual Work, Stripping or Opening up of Mines, Sinking Shafts or Other Actual Mining Operations - Names and addresses of the men who performed the work and the dates and hours of their employment.
For Diamond and other Core Drilling - Footage, No. and angle of holes and diameter of core. Name and address of owner or operator of drill. Dates when drilling was done. Signed core log and sketch in duplicate.
For Compressed Air or Other Power Driven or Mechanical Equipment
Type of drill or equipment. Names and addresses of men engaged in operating equipment and the dates and hours of their employment.
For Power Stripping - Type of equipment. Name and address of owner or operator. Amount expended. Dates on which work was done. Proof of actual cost must be submitted within 30 days of recording.
With each of the above types of work sketches are required to show the location and extent of the work in relation to the nearest claim post. In the case of diamond or other core drilling the sketch must be submitted in duplicate.
For Geological and Geophysical Survey - The names and addresses of men employed as well as dates. Type of instrument used in the case of geophysical survey. Reports and maps in duplicate must be filed with the Minister within 60 days of recording.
For Land Survey - the name and address of Ontario Land surveyor.

The Required Information is as Follows: (Attach a list if this space is insufficient)

See report dated Oct 30/62 attached hereto

Date 30 October, 1968

P Kolbe Signature of Recorded Holder or Agent

The Mining Act Certificate Verifying Report of Work

I, Peter Kolbe P. O. Box 277, Kirkland Lake, Ontario (Post Office Address)

hereby certify:

- 1. That I have a personal and intimate knowledge of the facts set forth in the report of work annexed hereto, having performed the work or witnessed same during and/or after its completion.
2. That the annexed report is true.

Dated 30 October, 1968

P. Kolbe Signature

Peter Kolbe

RECORDED NOV 1 1968 (page 2 of 2) REC. No.

THE PENALTY FOR MAKING A FALSE STATEMENT IN THIS REPORT AND/OR CERTIFICATE IS \$500. OR SIX MONTHS IMPRISONMENT OR BOTH



ONTARIO

THE MINING ACT REPORT OF WORK

45818

A separate form is required for each type of work to be recorded.

To the Recorder of Montreal River Mining Division
I, Amax Exploration, Inc. name of Recorded Holder
25 Adelaide Street West, Room 1101, Toronto 1, Ontario Miner's Licence
Post Office Address

do hereby report the performance of 1,264 days of Diamond Drill Coring type of work
not before reported to be applied on the following contiguous claims

Table with columns: Claim No., Days, Claim No., Days, Claim No., Days. Lists various claim numbers and dates, many with checkmarks.

Changed days from 29 to 25

P. Kolbe

All the work was performed on Mining Claim (s) MR45866, MR45862
(In the case of geological and/or geophysical survey (s) where more than 18 claims are involved attach a schedule)

READ CAREFULLY: THE FOLLOWING INFORMATION IS REQUIRED BY THE MINING RECORDER.

- For Manual Work, Stripping or Opening up of Mines, Sinking Shafts or Other Actual Mining Operations - Names and addresses of the men who performed the work and the dates and hours of their employment.
For Diamond and other Core Drilling - Footage, No. and angle of holes and diameter of core. Name and address of owner or operator of drill. Dates when drilling was done. Signed core log and sketch in duplicate.
For Compressed Air or Other Power Driven or Mechanical Equipment
Type of drill or equipment. Names and addresses of men engaged in operating equipment and the dates and hours of their employment.
For Power Stripping - Type of equipment. Name and address of owner or operator. Amount expended. Dates on which work was done. Proof of actual cost must be submitted within 30 days of recording.
With each of the above types of work sketches are required to show the location and extent of the work in relation to the nearest claim post. In the case of diamond or other core drilling the sketch must be submitted in duplicate.
For Geological and Geophysical Survey - The names and addresses of men employed as well as dates. Type of instrument used in the case of geophysical survey. Reports and maps in duplicate must be filed with the Minister within 60 days of recording.
For Land Survey - the name and address of Ontario Land surveyor.

The Required Information is as Follows: (Attach a list if this space is insufficient)

No. of hole: KX14 & KX17 (2)
Footage: 810' 454'
Angle: -50° -45°
Diameter of Core: AXT

Drillers: Boyles Bros. (Quebec) Ltd., Noranda, P.Q.

Dates: July 27th to August 25th, 1967.

Date November 10, 1967

P. Kolbe for Amax Exploration Inc. Signature of Recorded Holder or Agent

The Mining Act Certificate Verifying Report of Work

I, Peter Kolbe
P.O. Box 277, Kirkland Lake, Ontario
(Post Office Address)

hereby certify:

- 1. That I have a personal and intimate knowledge of the facts set forth in the report of work annexed hereto, having performed the work or witnessed same during and/or after its completion.
2. That the annexed report is true.

Dated November 10, 1967

Signature

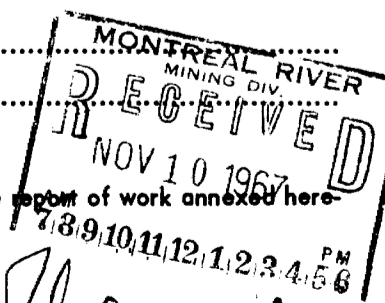

P. Kolbe

Handwritten signature

THE PENALTY FOR MAKING A FALSE STATEMENT IN THIS REPORT AND/OR CERTIFICATE IS \$500. OR SIX MONTHS IMPRISONMENT OR BOTH



ONTARIO

THE MINING ACT REPORT OF WORK

A separate form is required for each type of work to be recorded.

To the Recorder of Montreal River Mining Division

I, Amax Exploration, Inc. A-38495

name of Recorded Holder Miner's Licence

25 Adelaide Street West, Room 1101, Toronto 1, Ontario,

Post Office Address

do hereby report the performance of 1,264 days of Diamond Drill Coring

type of work

not before reported to be applied on the following contiguous claims

Claim No.	Days	Claim No.	Days	Claim No.	Days
MR46276	29.25 ✓	MR46851	29.25 ✓	MR46857	29.25 ✓
MR46846	29.25 ✓52	29.25 ✓58	43.25 ✓
.....47	29.25 ✓53	29.25 ✓		
.....48	29.25 ✓54	29.25 ✓		
.....49	29.25 ✓55	29.25 ✓		
.....50	29.25 ✓56	29.25 ✓		

*changed all days to 25
Peter Kolbe*

All the work was performed on Mining Claim (s) (In the case of geological and/or geophysical survey (s) where more than 18 claims are involved attach a schedule)

READ CAREFULLY: THE FOLLOWING INFORMATION IS REQUIRED BY THE MINING RECORDER.

For Manual Work, Stripping or Opening up of Mines, Sinking Shafts or Other Actual Mining Operations - Names and addresses of the men who performed the work and the dates and hours of their employment.

For Diamond and other Core Drilling - Footage, No. and angle of holes and diameter of core. Name and address of owner or operator of drill. Dates when drilling was done. Signed core log and sketch in duplicate.

For Compressed Air or Other Power Driven or Mechanical Equipment

Type of drill or equipment. Names and addresses of men engaged in operating equipment and the dates and hours of their employment.

For Power Stripping - Type of equipment. Name and address of owner or operator. Amount expended. Dates on which work was done. Proof of actual cost must be submitted within 30 days of recording.

With each of the above types of work sketches are required to show the location and extent of the work in relation to the nearest claim post. In the case of diamond or other core drilling the sketch must be submitted in duplicate.

For Geological and Geophysical Survey - The names and addresses of men employed as well as dates. Type of instrument used in the case of geophysical survey. Reports and maps in duplicate must be filed with the Minister within 60 days of recording.

For Land Survey - the name and address of Ontario Land surveyor.

The Required Information is as Follows: (Attach a list if this space is insufficient)

Date

Signature of Recorded Holder or Agent

The Mining Act Certificate Verifying Report of Work

I,

(Post Office Address)

hereby certify:

1. That I have a personal and intimate knowledge of the facts set forth in the report of work annexed hereto, having performed the work or witnessed same during and/or after its completion.
2. That the annexed report is true.

Dated.....19

Signature

THE PENALTY FOR MAKING A FALSE STATEMENT IN THIS REPORT AND/OR CERTIFICATE IS \$500. OR SIX MONTHS IMPRISONMENT OR BOTH