



41P14SW0051 31 SOTHMAN

010

DIAMOND DRILLING

TOWNSHIP: SOTHMAN

REPORT NO: 31

WORK PERFORMED FOR: Monpre Mining Co. Ltd.

RECORDED HOLDER: Same as Above [xx]
: Other []

<u>Claim No.</u>	<u>Hole No.</u>	<u>Footage</u>	<u>Date</u>	<u>Note</u>
MR 39070	S-1	507'	May/65	(1)
MR 39069	S-2	501'	May/65	(1)
MR 39065-66	S-3	464'	May-June/65	(1)
MR 39065	S-4	125'	June/65	(1)
	S-5	216'	June/65	(1)
MR 39070, 39075	S-6	597'	June/65	(1)
MR 39075, 39076	S-7	303'	June/65	(1)
MR 39075	S-8	305'	June/65	(1)
	<u>8</u>	<u>3018'</u>		

Notes: (1) Received from Mining Recorder - cancelled claims - placed on file in Main Office Aug/88

DIAMOND DRILL RECORD

S4

1

NAME OF PROPERTY MONPRE MINING CO Sothman Twp.
 HOLE NO. S4 LENGTH 125 ft.
 LOCATION 1000 ft.N on line 400 west, Group C
 LATITUDE _____ DEPARTURE S20W
 ELEVATION _____ AZIMUTH June 15/65 DIP 45
 STARTED June 11/65 FINISHED _____

FOOTAGE	DIP	AZIMUTH	FOOTAGE	DIP	AZIMUTH

HOLE NO. _____ SHEET NO. _____

REMARKS testing geophys. anom. near Deratnay lake

LOGGED BY J. Brady

FOOTAGE		DESCRIPTION	SAMPLE				ASSAYS				
FROM	TO		NO.	% SULPHIDES	FOOTAGE			%	%	OZ/TON	OZ/TON
					FROM	TO	TOTAL				
0	125	Overburden: sand, gravel & boulders. Hole abandoned due to broken rod in hole.									

LANGRIDGE LIMITED, 106 RICHMOND STREET WEST, TORONTO, ONT. EM 46-1168

DIAMOND DRILL RECORD

NAME OF PROPERTY MONPRE MINING CO Sothman Twp-Bardwell Lake
 HOLE NO. S-8 LENGTH 305
 LOCATION 600 ft. NW. of Hole S-6 at crossroad
 LATITUDE _____ DEPARTURE _____
 ELEVATION _____ AZIMUTH 135° DIP 45°
 STARTED June 28/65 FINISHED June 30/65

FOOTAGE	DIP	AZIMUTH	FOOTAGE	DIP	AZIMUTH

HOLE NO. S-8 SHEET NO. 1

REMARKS _____

Testing conductor on peridotite-volcanic contact.

LOGGED BY J. Grady *J. Grady*

FOOTAGE		DESCRIPTION	SAMPLE				ASSAYS					
FROM	TO		NO.	% SULPHIDES	FOOTAGE			%	%	OZ/TON	OZ/TON	
					FROM	TO	TOTAL					
0	46	OVERBURDEN: sand										
46	196.5	SERPENTINIZED PERIDOTITE 100-101: sl. shearing with sulphides	F11	3	100	101	1'	.16				
196.5	210	GABBRO PORPHYRY; somewhat altered.										
210	305	" " , relatively massive, unaltered. 251-257: qtz. stringers with minor py										
		END.										

LANGRIDGE LIMITED, 106 RICHMOND STREET WEST, TORONTO, ONT. EM. 6-1168



41P14SW0051 31 SOTHMAN

ONTARIO

THE MINING ACT REPORT OF WORK

required for each type of work to be recorded.

To the Recorder of.....MONTREAL RIVER MINING DIVISION.....Mining Division

I,.....MONPPE MINING CO. LTD.....A 31342 name of Recorded Holder Miner's Licence

.....SUITE 305, 62 RICHMOND ST. W. TORONTO Post Office Address

do hereby report the performance of3018..... days ofDIAMOND DRILLING type of work

not before reported to be applied on the following contiguous claims

Table with 6 columns: Claim No., Days, Claim No., Days, Claim No., Days. Contains handwritten entries for claims 39067-39072 and 39063-39066.

All the work was performed on Mining Claim (s)39069 39070 39066 (In the case of geological and/or geophysical survey (s) where more than 18 claims are involved attach a schedule)

READ CAREFULLY: THE FOLLOWING INFORMATION IS REQUIRED BY THE MINING RECORDER.

- For Manual Work, Stripping or Opening up of Mines, Sinking Shafts or Other Actual Mining Operations - Names and addresses of the men who performed the work and the dates and hours of their employment. For Diamond and other Core Drilling - Footage, No. and angle of holes and diameter of core. Name and address of owner or operator of drill. Dates when drilling was done. Signed core log and sketch in duplicate. For Compressed Air or Other Power Driven or Mechanical Equipment Type of drill or equipment. Names and addresses of men engaged in operating equipment and the dates and hours of their employment. For Power Stripping - Type of equipment. Name and address of owner or operator. Amount expended. Dates on which work was done. Proof of actual cost must be submitted within 30 days of recording. With each of the above types of work sketches are required to show the location and extent of the work in relation to the nearest claim post. In the case of diamond or other core drilling the sketch must be submitted in duplicate. For Geological and Geophysical Survey - The names and addresses of men employed as well as dates. Type of instrument used in the case of geophysical survey. Reports and maps in duplicate must be filed with the Minister within 60 days of recording. For Land Survey - the name and address of Ontario Land surveyor.

The Required Information is as Follows: (Attach a list if this space is insufficient)

Table with columns for claim numbers (S1-S6), footages, angles, and orientations (AX). Includes handwritten notes: 'Drilled by Boyles Bros. Noranda' and 'Dates of drilling May 20, 1965 to July 1, 1965'.

DateO.C.T. 14 1965.....

Signature of Recorded Holder or Agent: John C. Grady P. ENG.

The Mining Act Certificate Verifying Report of Work

I,.....John C. Grady, Geologist..... R.R.1 Glen Williams Ontario (Post Office Address)

hereby certify:

- 1. That I have a personal and intimate knowledge of the facts set forth in the report of work annexed here-to, having performed the work or witnessed same during and/or after its completion. 2. That the annexed report is true.

Dated.....O.C.T. 14..... 19 65

Signature: John C. Grady

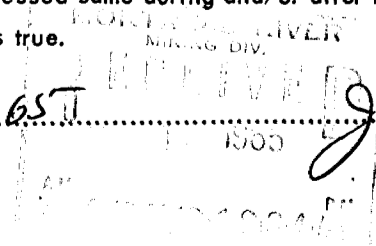

THE PENALTY FOR MAKING A FALSE STATEMENT IN THIS REPORT AND/OR CERTIFICATE IS \$500. OR SIX MONTHS IMPRISONMENT OR BOTH

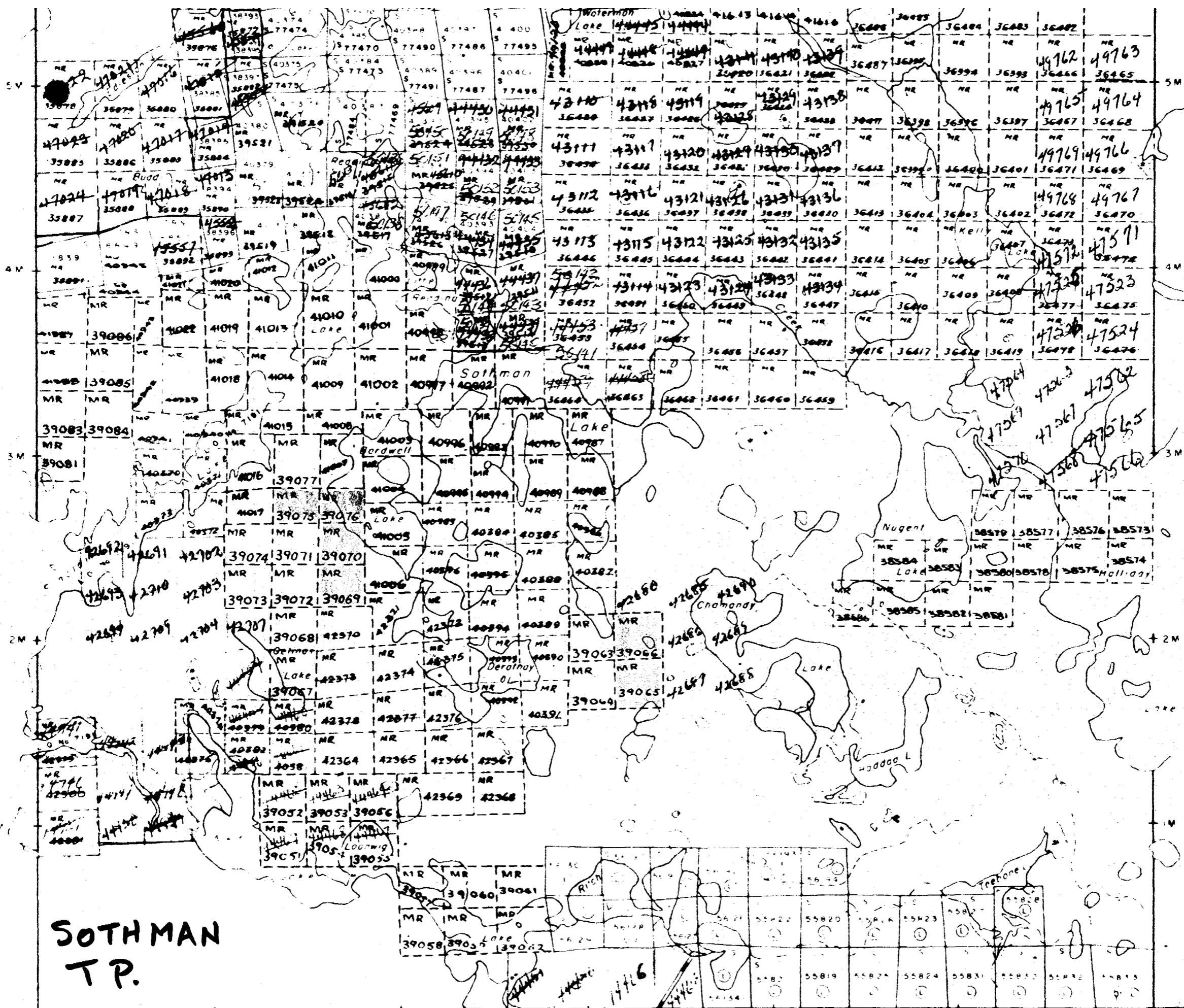

**SOTHMAN
T.P.**

Holiday Twp. - M. 910

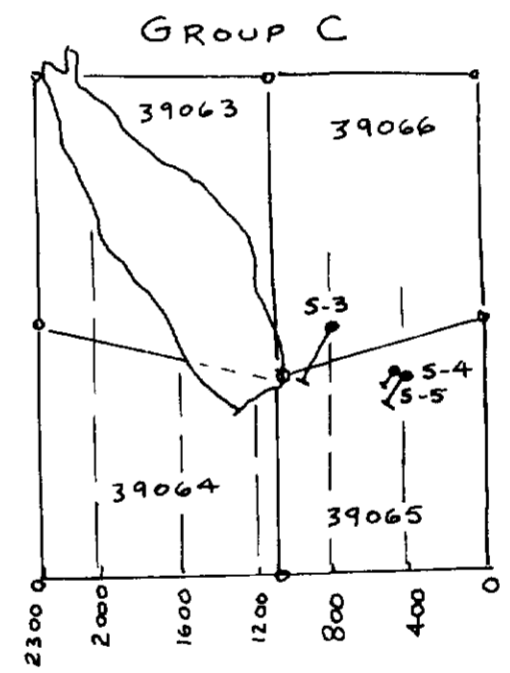
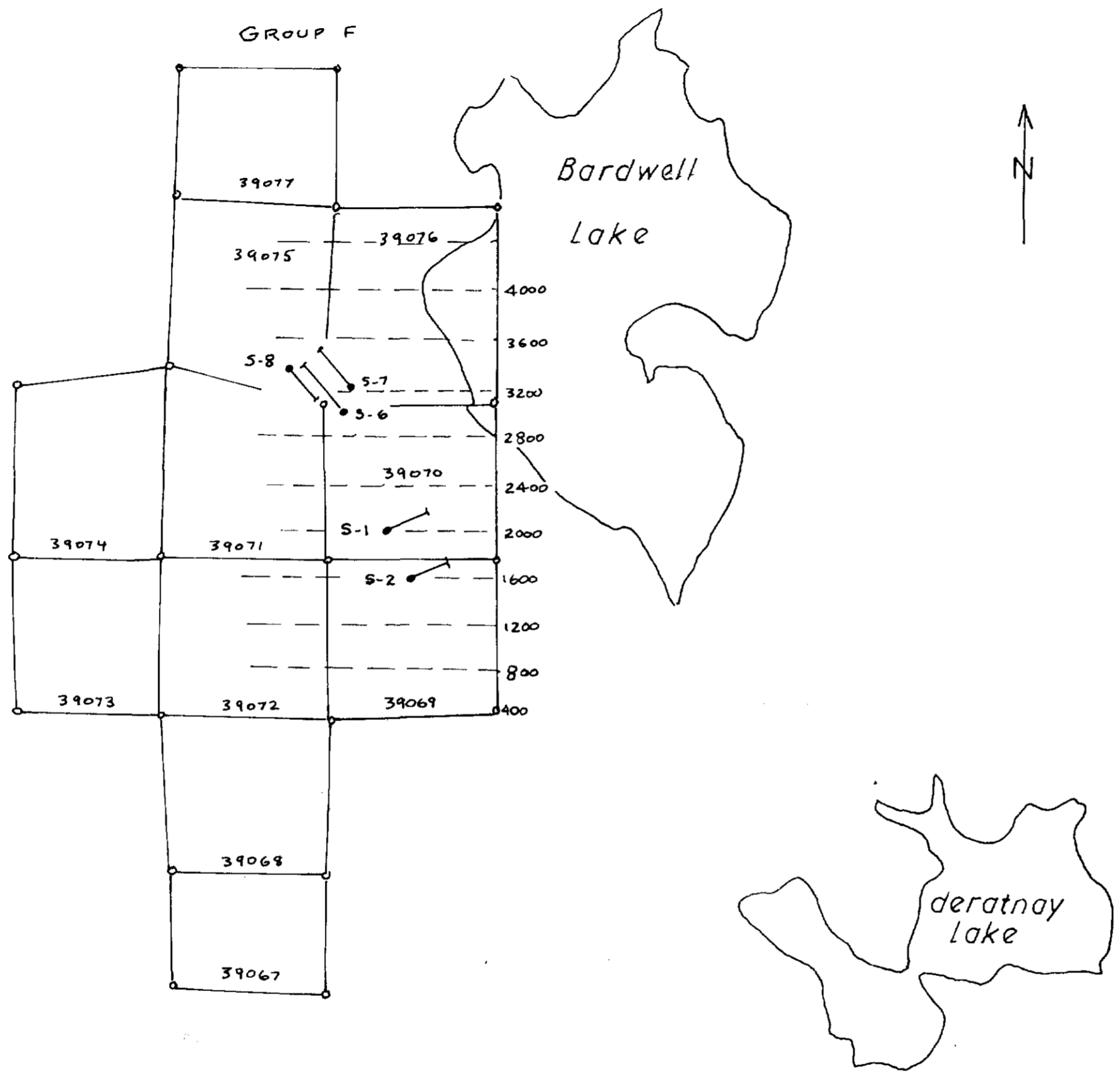

200

SOTHMAN TP. BDR #31

J. Brady

MONPRE MINING CO. LTD.
 Location of drillholes
 in Sothman township
 0 1000
 FEET
 OCT. 14/65 J.C. GRADY, P. ENG.

BASE MAP O.D.M. MAP 1953-3

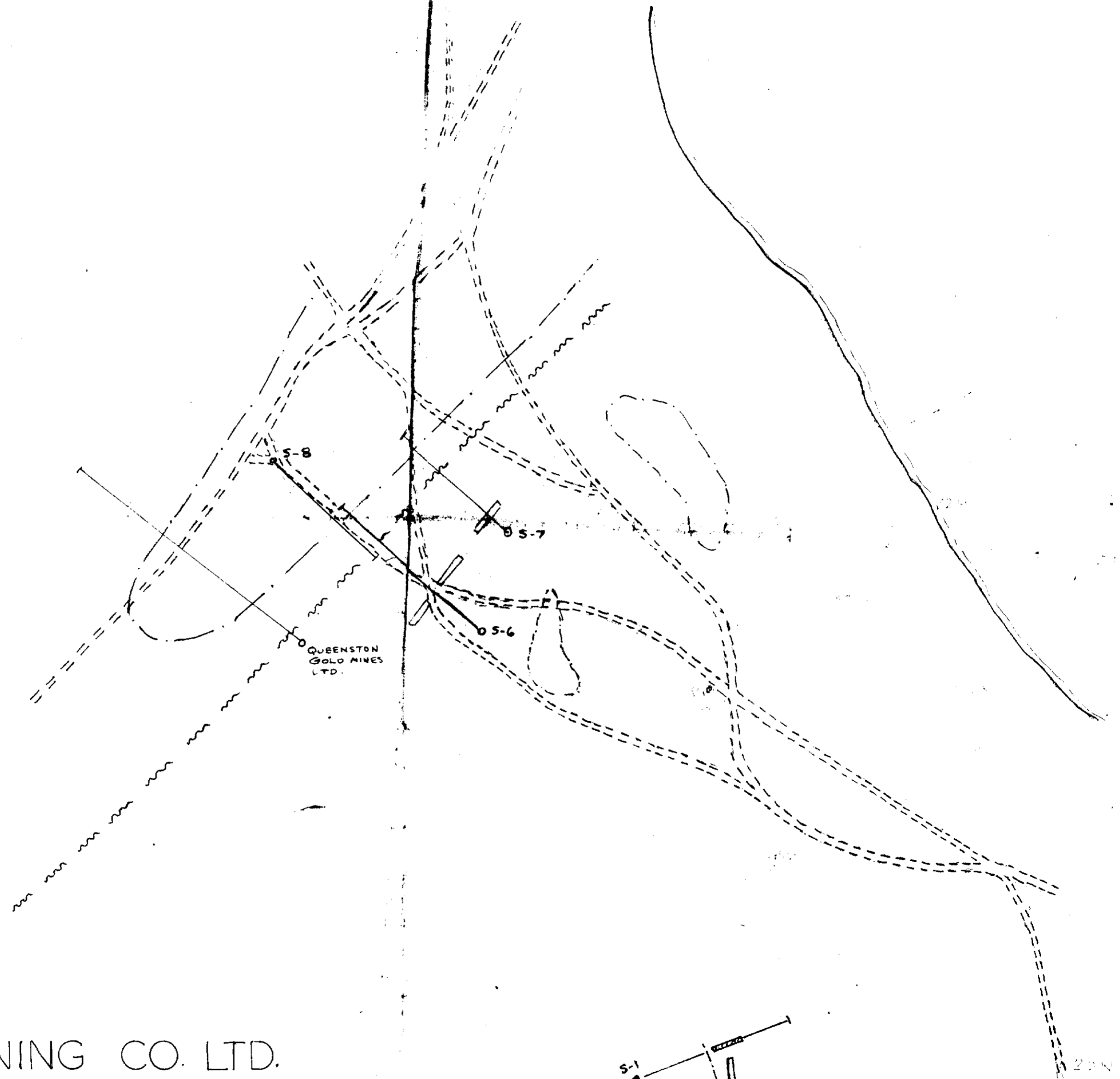

MONPRE MINING CO. LTD.
DETAIL OF BARDWELL LAKE AREA

0 200
FEET

SOTHMAN TP. DRR # 31

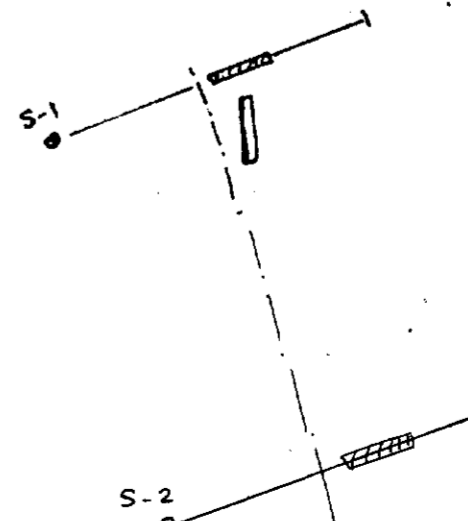

J. Brady
OCT. 15, 1965 1600 N

