



41P15NE0015 W9680.00565 CAIRO

010

ASSESSMENT REPORT

G. KOSY - CROWLEY GROUNDWATER LIMITED JOINT VENTURE

WEBB LAKE AREA

TOWNSHIP OF CAIRO

LARDER LAKE MINING DIVISION

Prepared for: G. Kosy - Crowley Groundwater Limited Joint Venture

October 10, 1996



IAN D. WILSON ASSOCIATES LIMITED
CONSULTING HYDROGEOLOGISTS

STRATFORD, ONT.

519-271-7940

DRAWING SHOWING
LOCATION
OF
CLAIM GROUP

SCALE 1:20,000

FIGURE 1

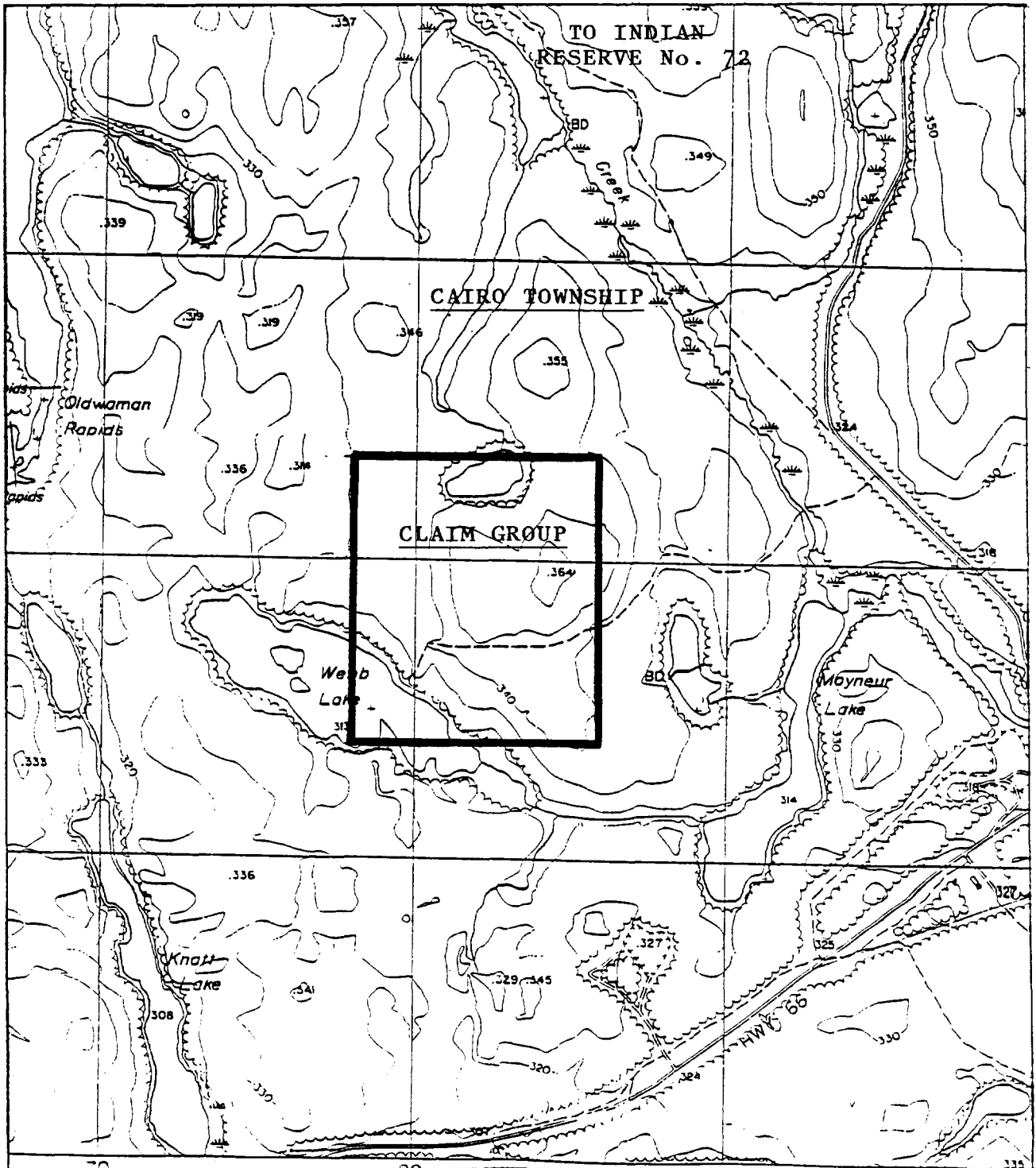

MATACHEWAN TOWNSITE

ASSESSMENT REPORT

G. KOSY - CROWLEY GROUNDWATER LIMITED JOINT VENTURE

WEBB LAKE AREA

TOWNSHIP OF CAIRO

LARDER LAKE MINING DIVISION

1.0 INTRODUCTION

Mining Claim 1202490 consisting of 4 contiguous units belonging to G. Kosy was investigated during 1996 as part of a joint venture between G. Kosy and Crowley Groundwater Limited. The claim group is situated in Cairo Township within the Larder Lake Mining Division. Figure 1 shows the location of the group.

Ian D. Wilson Associates Limited, consulting geologists, was retained by the joint venture to investigate the property along with Mr. H. Lovell, the retired Resident Geologist for the Larder Lake Mining Division, Kirkland Lake. The property was visited during June and again in September, 1996. Mr. D. Crowley of Crowley Groundwater Limited organized and co-ordinated the project. Figure 2 shows the claim group in relation to other claims in the area.

2.0 LOCATION AND ACCESS

The property is located north of Highway 66 approximately 3.3 kilometres northeast of the Matachewan Townsite. The property is reached via the road to the north to the Matachewan Indian Reservation No. 72 which leaves Highway 66 immediately east of the junction of Highways 65 and 66. A logging road leaves the road to the Indian Reserve approximately 0.6 km north of the intersection with Highway 66, crosses Whiskeyjack Creek and travels generally west to the claim group. The location of the access road is shown on Figure 1.

3.0 PREVIOUS WORK ON CLAIMS

In 1966 Midrim Mining Company Limited drilled eleven diamond drill holes based on geophysical and geochemical surveys for a total of 1143 metres (3,749 feet). It is understood that the prime target was copper and molybdenum. Bulldozing and trenching were undertaken as part of the exploration program.

During 1973 a Mr. R. Newman drilled two diamond drill holes for a combined length of 97 metres (317 feet) on the property. It is assumed that the targets were the same as those of Midrim Mining.

In April 1981 Minorex Limited carried out fluxgate magnetometer and VLF-EM surveys of the claims which resulted in a recommendation for the drilling of five diamond drill holes to investigate the central of three conductors located during the geophysical surveys. A total of six diamond drill holes (KL-HW-81-1 to KL-HW-81-6, inclusive) were drilled on the claims for a total of 598.6 metres (1964 feet). KL-HW-81-1 was drilled at an angle of minus 52° while KL-HW-81-2 & 3 were at minus 41.5° and KL-HW-81-4, 5 & 6 were at minus 42°.

No assays were available for drill hole KL-HW-81-1, however, the balance of the holes showed low gold values with some significant intersections assaying up to 1993 parts per billion (one 1.4cm quartz vein assayed 3112 ppb gold). Lead values were shown in drill hole KL-HW-81-5.

4.0 TOPOGRAPHY AND VEGETATION COVER

The 1202490 Group covers an area of dense secondary growth alders, evergreens, poplars and birch with the more accessible lands being the central sector of the group where the rock outcrops or is close to the landsurface. Muskeg surrounds the small lake towards the north end of the claim group.

The lands slope gently upwards from Webb Lake (320 metres above sea level) at the south to a central highland area at approximately 364m asl, then slopes downward to the small lake at the northend (340m asl) and westward to about the same elevation. The small northern lake is shown to drain to the north with a small creek joining the Whiskeyjack Creek system near the northern road to the indian reservation.

Two predominant ridges of Matachewan age diabase dikes cross the property in a roughly north-south direction. The majority of the rock outcrop on the site occurs between the two diabase dikes.

5.0 GEOLOGIC SURVEY

5.1 General Geology:

Old mineral exploration trails, completely grown in, used by Midrim and Minorex in their exploration programs were cleared by hand over a distance of approximately 1.84 kilometres in order to gain access to the site and to clear vegetation for two exploration trenches and the rehabilitation of an old Midrim trench. A tractor-mounted backhoe was used to remove overburden

at the trench sites and to clear the old trench.

Ian D. Wilson, P.Eng. and Howard Lovell traversed the central and northwestern section of the claim group noting the geology and previous work (trenching and drilling) carried out by others. Mr. Lovell spent a day traversing the southern sectors of the claim group and an additional day in the eastern and northeastern sections. The following rock types were identified.

ARCHEAN

Mafic Intrusive Rocks

Matachewan diabase

Intrusive Contact

Silicic Intrusive Rocks

Algoman syenite and syenite porphyry

Intrusive Contact

Sedimentary Rocks

Timiskaming conglomerate
greywacke
quartzite
argillite

The above rocks have been described in detail in previous reports on the property and area and in reports by the Ontario Department of Mines.

5.2 Economic Geology:

A total of two trenches were excavated on site (see Figure 3 taken from the drawing by Minorex Limited) during September 1996; Trench 1 being 37.2m (122.2 ft.) in length while Trench 2 is 70.7m (232 ft.) in length. Trench 1 runs approximately north, northwest-south, southeast and Trench 2 runs about north-south. Both trenches were channel sampled using a diamond circular saw. An old Midrim trench (see Figure 3) was rehabilitated and "bulk" sampled over its 21.6-metre (71 ft.) length. The samples taken were entirely within the Timiskaming sediments and all samples showed sulphide (pyrite) mineralization. A detailed map showing the locations of the trenching (stripping) appears in the map pocket.

The trenches (stripping) were excavated by backhoe equipped with a one-foot bucket to the bedrock surface where rock samples were taken by diamond saw, \pm 8 ins. wide by \pm 2 ins. deep. The following information pertains to the new trenches and the old trench which existed prior to the current fieldwork. The old trench was cleared and bulk sampled. Trenches (stripping) 1 and 2 are the new trenches excavated in 1996.

<u>Trench</u>	<u>Stripping</u>
Length:	122.2 feet
Width:	2 to 3 feet
Depth:	0 to 2.5 feet
Rock samples:	\pm 8 ins. wide by \pm 2 ins. deep

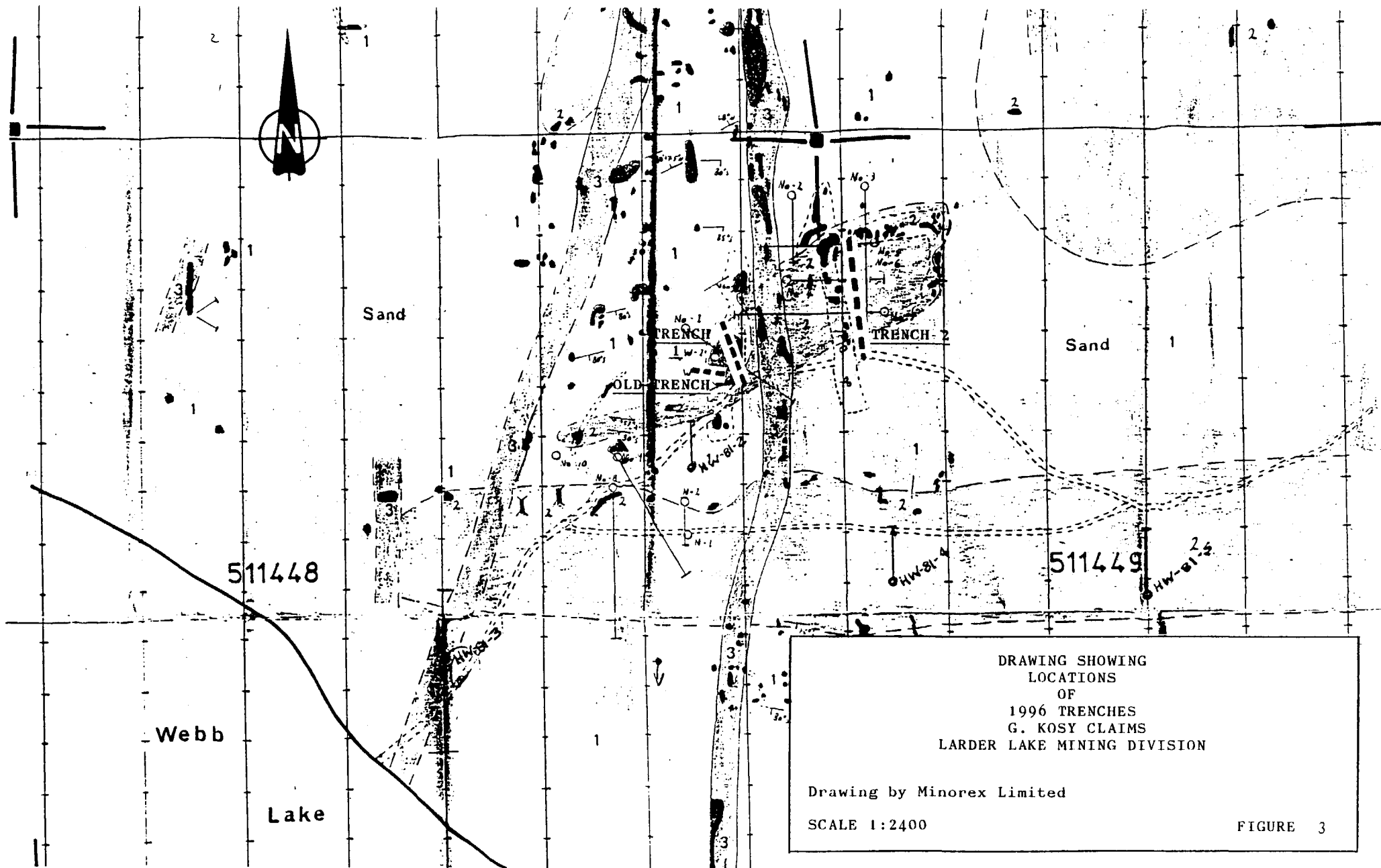

<u>Trench 2</u>	<u>Stripping</u>
Length:	232 feet
Width:	2 to 3 feet
Depth:	0 to 2.5 feet
Rock samples:	± 8 ins. wide by ± 2 ins. deep

<u>Old Trench - Rock</u>	
Length:	71 feet
Width:	2.5 feet ±
Depth:	2 to 3.5 feet
Rock samples:	bulk across the trench

A total of 51 samples were taken from Trenches 1 and 2. One bulk sample weighing 221 lbs. was taken from the old trench after it was cleared out. Four assays were undertaken by Swastika Laboratories on the bulk sample (see appendix).

Rock samples were taken at intervals shown on the Swastika Laboratories' assay sheet (report appendix), starting at the south ends of Trenches 1 and 2 and across the entire length of the old trench.

The sample lengths are shown on the accompanying drawing as follows and were measured from the south ends of the trenches.

<u>TRENCH 1</u>			<u>TRENCH 2</u>		
<u>Sample</u>	<u>Footage</u>	<u>Length (ft.)</u>	<u>Sample</u>	<u>Footage</u>	<u>Length (ft.)</u>
1	13.2 - 15.2	2.0	1	12.5 - 13.2	0.8
2	22.3 - 23.9	1.6	2	14.4 - 15.2	0.8
3	24.7 - 26.5	1.8	3	16.0 - 16.8	0.8
4	28.5 - 30.6	2.1	4	17.5 - 18.3	0.8
5	33.3 - 35.0	1.7	5	23.0 - 24.0	1.0
6	40.5 - 42.1	1.6	6	28.0 - 29.0	1.0
7	47.3 - 51.5	4.2	7	30.3 - 31.2	0.9
8	54.8 - 57.3	2.5	8	31.2 - 33.2	2.0
9	58.0 - 62.3	4.3	9	36.0 - 37.2	1.2
10	65.0 - 67.2	2.2	10	49.0 - 49.7	0.7
11	78.0 - 79.0	1.0	11	52.8 - 53.4	0.6
12	80.2 - 82.0	1.8	12	54.0 - 54.6	0.6
13	84.0 - 86.0	2.0	13	54.6 - 56.6	2.0
14	87.0 - 88.6	1.6	14	57.8 - 59.9	2.1
15	94.6 - 95.6	1.0	15	64.6 - 66.2	1.6
16	97.2 - 102.7	5.5	16	76.6 - 78.2	1.6
17	106.0 - 107.0	1.0	17	90.0 - 91.0	1.0
18	109.4 - 111.0	1.6	18	91.0 - 92.6	1.6
19	116.0 - 117.4	1.4	19	96.0 - 98.0	2.0
20	119.6 - 122.0	<u>2.4</u>	20	175.0 - 176.3	1.3
Totals 122 ft. stripped		43.3 ft. sampled	21	180.6 - 182.0	1.4
			22	188.0 - 189.0	1.0
			23	193.6 - 195.0	1.4

Note: Two samples with same number 96.2 - 102.7 ft.

24	198.0 - 199.0	1.0
25	212.0 - 213.5	1.5
26	214.5 - 215.5	1.0
27	218.0 - 219.0	1.0
28	226.0 - 227.0	1.0
29	229.6 - 230.0	0.4
30	231.0 - 232.0	<u>1.0</u>
Total 232 ft. stripped		35.1 - ft. sampled

The 100.2 kilogram (221 lbs) "bulk" sample showed 0.001 oz/ton gold and 0.001 oz/ton silver. Trench 1 showed varying values from no gold to 0.001 to 0.02 oz/ton. Trench 2 showed gold values of nil to 0.028 oz/ton. (over 0.12m - 0.4 ft., 69.98 to 70.10m - 229.6 to 230.0 ft.). An I.C.A.P. plasma scan of the "bulk" sample showed low concentrations of a number of elements but no potential economic minerals. Copies of the analyses undertaken by Swastika Laboratories appear in the appendix. Figures 4 and 5 show the assay results graphically for Trench 1, while Figures 6 and 7 show the results for Trench 2.

6.0 CONCLUSIONS

The Claim Group 1202490 shows sulphide mineralization (largely pyrite) throughout the sediments and within the syenite with copper, molybdenum, and to a lesser degree fluorite, occurring in quartz-carbonate veinlets.

Although no economic deposits have been found on the property to-date, the area is highly mineralized and with the Cairo syenite stock being present and the syenite porphyry mapped on the claim group, the chances of economic mineralization exist. The drilling by Minorex Limited in 1981 showed encouraging results within the central of three conductive zones delineated.

7.0 RECOMMENDATIONS

1. The eastern and western extensions of the east-west trending "porphyry" (central conductive zone) should be examined further by means of, at least, two additional diamond drill holes.
2. The northern VLF-EM conductor below the northern lake shown on the Minorex Limited drawing (April 1981) should be explored by, at least, two diamond drill holes drilled from the southern shore.
3. The 1.8 metre (6 foot) section from 68.9 to 70.7 metres (226 to 232 feet) in Trench 2 should be opened up for possible additional sampling.

IAN D. WILSON ASSOCIATES LIMITED

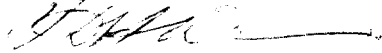

Ian D. Wilson, P.Eng.

October 10, 1996



REFERENCES

Lovell, H.L.

1967: Geology of the Matachewan Area, Ontario Department of Mines, GR 51, 52p.
Accompanied by Maps 2109 and 2110, scale 1 inch to 1/2 mile.

Sinclair, W.D., Copper-molybdenum occurrences of the Matachewan Area, Ontario; in Current Research, Part A, Geol. Surv. Can., Paper 79-1A, p. 253-258, 1997.

Horne, R.J.

1981: Minorex Limited Assessment Report, Hanson-Welch Option, Cairo Township, Larder Lake Mining Division.

APPENDIX

CAIRO TWP. : CLAIM 1202490 - 4 UNITS
TRENCH 1 : GOLD ASSAY

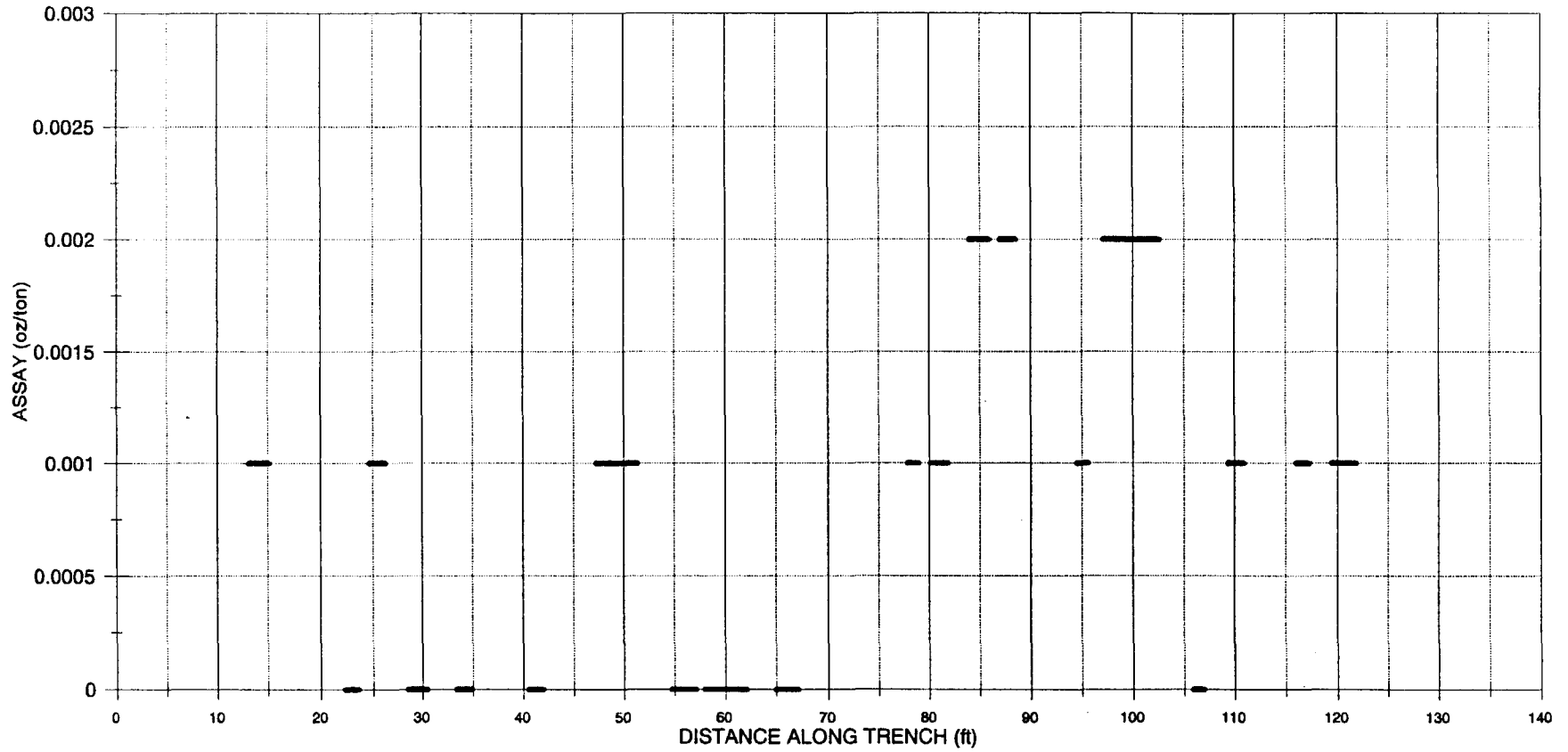

FIGURE 4

CAIRO TWP. : CLAIM 1202490 - 4 UNITS
TRENCH 1 : GOLD ASSAY

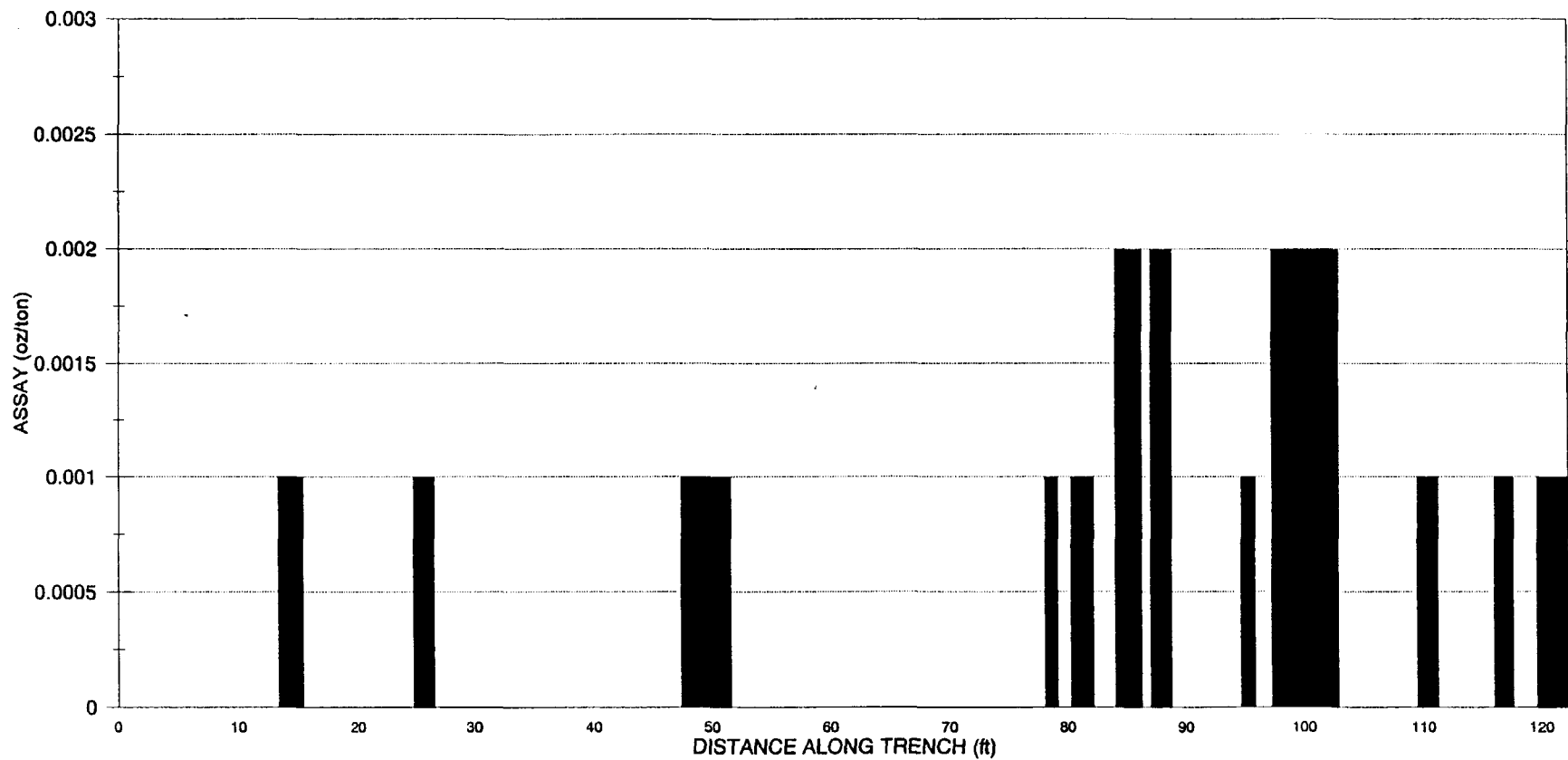

FIGURE 5

CAIRO TWP. : CLAIM 1202490 - 4 UNITS
TRENCH 2 : GOLD ASSAY

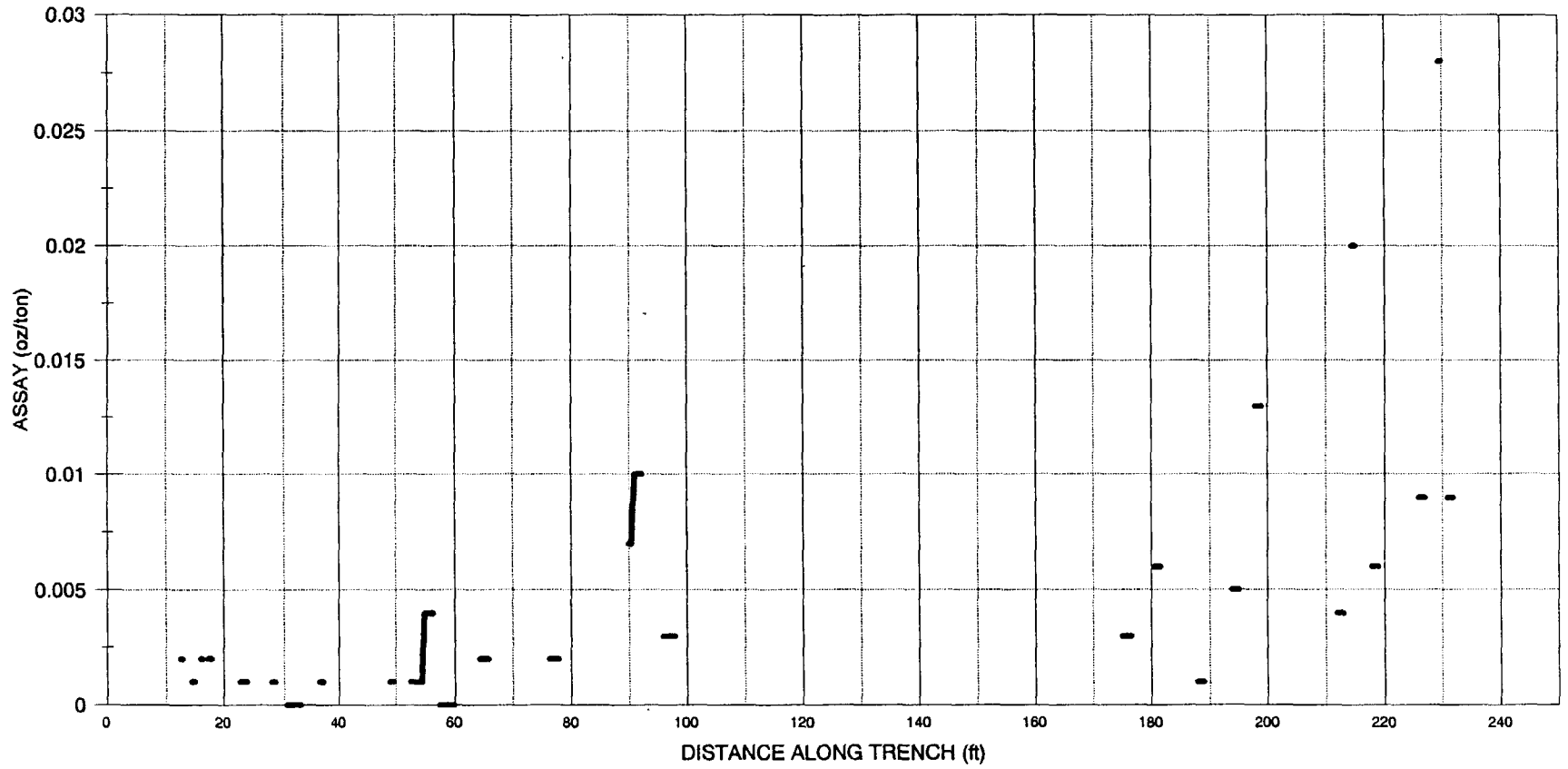

FIGURE 6

CAIRO TWP. : CLAIM 1202490 - 4 UNITS
TRENCH 2 : GOLD ASSAY

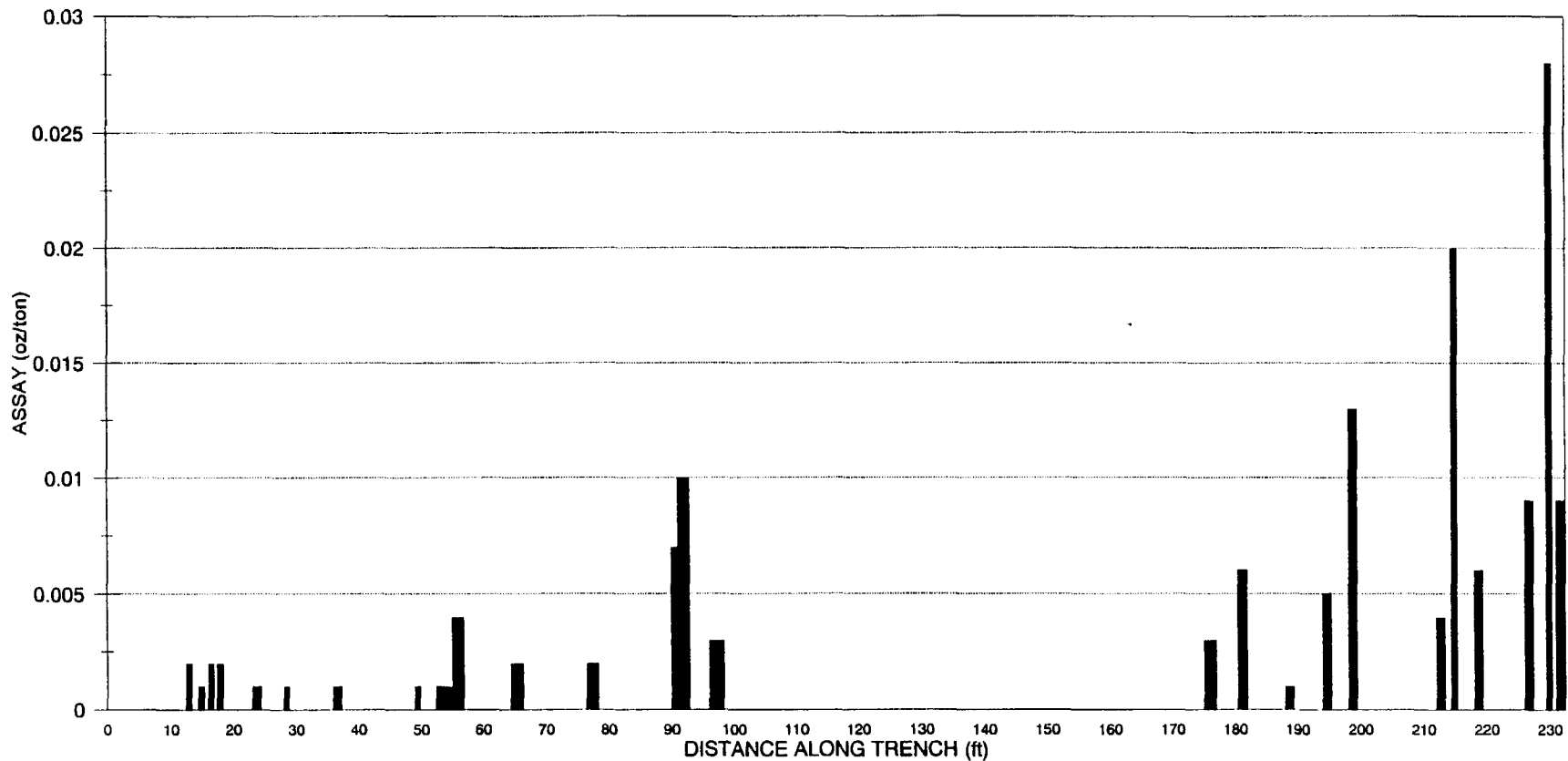

FIGURE 7



Swastika Laboratories

A Division of TSL/Assayers Inc.

Assaying - Consulting - Representation

Established 1928

Assay Certificate

6W-3684-RA1

Company: **CROWLEY GROUNDWATER LTD**

Date: SEP-26-96

Project:

Attn: D. Crowley

We hereby certify the following Assay of 1 bulk rock samples submitted SEP-16-96 by .

Sample Number	Au oz/ton	Au oz/ton	sample weight
BULK "cgw" #1 Tr A	0.001	0.001	221 lbs
B	0.001	0.001	
C	0.001	0.001	
D	0.001	0.001	

The entire sample was crushed to approx 10 mesh and riffled into four parts. A portion was riffled from each quarter, pulverized and assayed using 1 A.T.

Certified by _____

P.O. Box 10, Swastika, Ontario P0K 1T0

Telephone (705) 642-3244

FAX (705) 642-3300

CROWLEY GROUNDWATER LTD.

ATTN: D. CROWLEY

SL/ AYI La Btc :S

1270 FENSTER DRIVE, UNIT 3 MISSISSAUGA, ONTARIO L4W-1A4

PHONE #: (905)602-8236 FAX #: (905)206-0513

REPORT No. : M8114

Page No. : 1 of 1

File No. : 00070A

Date : OCT-07-1996

I.C.A.P. PLASMA SCAN

Aqua-Regia Digestion

6W-3684-RA1

0.
0.

SAMPLE #	Ag	Al	As	B	Ba	Be	Bi	Ca	Cl	Co	Cr	Cu	Pb	Mg	Mn	Mo	Nb	Ni	P	Pb	Sb	Sc	Sn	Sr	Ti	V	W	Y	Zn	Zr
	ppm	%	ppm	ppm	ppm	ppm	ppm	%	ppm	ppm	ppm	ppm	%	%	ppm	ppm	%	ppm	ppm	ppm	ppm	ppm	ppm	ppm	ppm	ppm	ppm	ppm	ppm	
BULK "cgw" #1 TR A	1.1	1.7	< 5	< 10	280	< 1	< 5	1.6	< 1	26	280	660	< 5	1.7	420	210	0.07	87	890	11	< 5	7	< 10	170	2900	73	< 10	12	48	59

0.5 gm sample is digested with 2 ml of 3:1 HCL/HNO3
for 95 min and diluted to 10 ml with DI H2O
This method is partial for many oxide materials

SIGNED :

Ray Good

10-08-96 03:15PM [9] #1



Swastika Laboratories

A Division of TSL/Assayers Inc.

Established 1928

Assaying - Consulting - Representation

Page 1 of 2

Assay Certificate

6W-3683-RA1

Company: **CROWLEY GROUNDWATER LTD**

Date: SEP-26-96

Project:

Att: D. Crowley

We hereby certify the following Assay of 51 Rock samples submitted SEP-16-96 by .

Sample Number	Au oz/ton	Au Check oz/ton
TRENCH#1 13.2-15.2	0.001	-
TRENCH#1 22.3-23.9	Nil	-
TRENCH#1 24.7-26.5	0.001	-
TRENCH#1 28.5-30.6	Nil	-
TRENCH#1 33.3-35.0	Nil	Nil
TRENCH#1 40.5-42.1	Nil	-
TRENCH#1 47.3-51.5	0.001	-
TRENCH#1 54.8-57.3	Nil	-
TRENCH#1 58.0-62.3	Nil	-
TRENCH#1 65.0-67.2	Nil	-
TRENCH#1 78.0-79.0	0.001	0.001
TRENCH#1 80.2-82.0	0.001	-
TRENCH#1 84.0-86.0	0.002	-
TRENCH#1 87.0-88.6	0.002	0.001
TRENCH#1 94.6-95.6	0.001	-
TRENCH#1 97.2-102.7	0.002	-
TRENCH#1 106.0-107.0	Nil	-
TRENCH#1 109.4-111.0	0.001	-
TRENCH#1 116.0-117.4	0.001	-
TRENCH#1 119.6-122.0	0.001	-
TRENCH#2 12.5-13.3	0.002	-
TRENCH#2 14.4-15.2	0.001	Nil
TRENCH#2 16.0-16.8	0.002	-
TRENCH#2 17.5-18.3	0.002	0.003
TRENCH#2 23.0-24.0	0.001	-
TRENCH#2 28.0-29.0	0.001	-
TRENCH#2 30.3-31.2	Nil	-
TRENCH#2 31.2-33.2	Nil	Nil
TRENCH#2 36.0-37.2	0.001	-
TRENCH#2 49.0-49.7	0.001	-

One assay ton portion used. * Indicates there were two samples with the same number.

Certified by

P.O. Box 10, Swastika, Ontario P0K 1T0

Telephone (705) 642-3244

FAX (705) 642-3300



Swastika Laboratories

A Division of TSL/Assayers Inc.

Established 1928

Assaying - Consulting - Representation

Page 2 of 2

Assay Certificate

6W-3683-RA1

Company: **CROWLEY GROUNDWATER LTD**

Date: SEP-26-96

Project:

Attm: D. Crowley

We hereby certify the following Assay of 51 Rock samples submitted SEP-16-96 by .

Sample Number	Au oz/ton	Au Check oz/ton
TRENCH#2 52.8-53.4	0.001	-
TRENCH#2 54.0-54.6	0.001	Nil
TRENCH#2 53.6-56.6	0.004	-
TRENCH#2 57.8-59.9	Nil	-
TRENCH#2 64.6-66.2	0.002	-
TRENCH#2 76.6-78.2	0.002	-
TRENCH#2 90.0-91.0	0.007	-
TRENCH#2 91.0-92.6	0.010	0.010
TRENCH#2 96.0-98.0	0.003	-
TRNCH#2 175.0-176.3	0.003	-
TRNCH#2 180.6-182.0	0.006	-
TRNCH#2 188.0-189.0	0.001	-
TRNCH#2 193.6-195.0	0.005	0.004
TRNCH#2 198.0-199.0	0.013	-
TRNCH#2 212.0-213.5	0.004	-
TRNCH#2 214.5-215.5	0.020	0.014
TRNCH#2 218.0-219.0	0.006	-
TRNCH#2 226.0-227.0	0.009	0.013
TRNCH#2 229.6-230.0	0.028	0.027
TRNCH#2 231.0-232.0	0.009	-
97.2-102.7 *	Nil	-

One assay ton portion used. * Indicates there were two samples with the same number.

Certified by

WM. DALE

WATER WELL DRILLING & PUMP CONTRACTOR

TELEPHONE: BELMONT 644-1020

R R. No. 7, LONDON, ONT.

CON. 5, WESTMINSTER TWP.

New TRENCH No #1

1% per month charged on overdue accounts

South side of road

STAKE	0	BEARING	345°
SAMPLE	13.2	15.2	
"	22.3	23.9	
	24.7	26.5	
	28.5	30.6	
	33.3	35.0	
	40.5	42.1	
	47.3	51.5	
	54.8	57.3	
	58	62.3	
	65	67.2	
	78	79	
	80.2	82	
	84	86	
	87	88.6	
	94.6	95.6	

WM. DALE

WATER WELL DRILLING & PUMP CONTRACTOR

TELEPHONE: BELMONT 644-1020

R R. No. 7, LONDON, ONT.

CON. 5, WESTMINSTER TWP.

TRENCH No #1

1% per month charged on overdue accounts

97.2	102.7
106	107
109.4	111
116	117.4
119.6	122.2
To MOUCH OVER BURDEN.	

WM. DALE

WATER WELL DRILLING & PUMP CONTRACTOR

TELEPHONE: BELMONT 644-1020

R R. No. 7, LONDON, ONT.

CON. 5, WESTMINSTER TWP.

TRENCH No #2
BEARING 352°

1% per month charged on overdue accounts
Au 02-1 Jan

300' east of #1
20' south of south
end of #1

12.5	13.3
14.4	15.2
16	16.8
17.5	18.3
23	24
28	29
30.3	31.2
31.2	33.2
36	37.2
49	48.7
52.8	53.4
54	54.6
53.6	56.6
57.8	59.9

WM. DALE

WATER WELL DRILLING & PUMP CONTRACTOR

TELEPHONE: BELMONT 644-1020

R R. No. 7, LONDON, ONT.

CON. 5, WESTMINSTER TWP.

TRENCH No #2

1% per month charged on overdue accounts

64.6	66.2
76.6	78.2
90	91
91	92.6
96	98
175	176.3
180.6	182
188	189
193.6	195
198	199.5
212	213.5
214.5	215.5
218	219
226	227
229.6	230
231	232

WM. DALE

WATER WELL DRILLING & PUMP CONTRACTOR

TELEPHONE: BELMONT 644-1020

R R. No. 7, LONDON, ONT.

CON. 5, WESTMINSTER TWP.

BROWNING LAKE
TRENCH #3

1% per month charged on overdue accounts

#1	23	24.9	312°
•	17	18	
•	12.3	13.6	
•	12'	-*	
•	74	75.6	130°
•	57		212°
•	75	76	130°

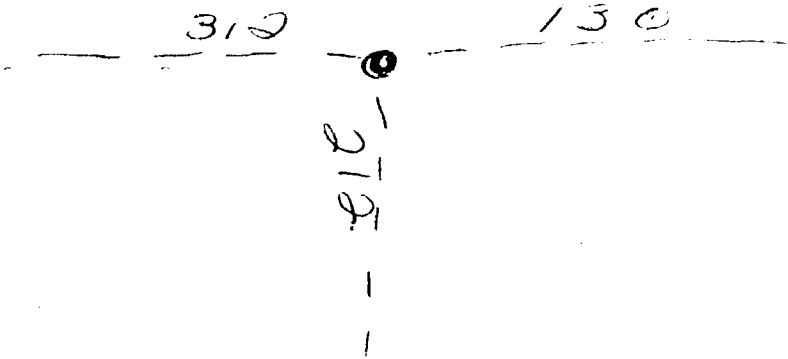

CROWLEY GROUNDWATER LTD.

ATTN: D. CROWLEY

ISL/ANALYTICAL LABORATORIES

1670 FENWICK DRIVE, UNIT 3 MISSISSAUGA, ONTARIO L4W-1A4

PHONE #: (905)602-8236

FAX #: (905)206-0513

REPORT No. : H8114

Page No. : 1 of 1

File No. : OC078A

Date : OCT-07-1996

I.C.A.P. PLASMA SCAN

Aqua-Regia Digestion

6W-3684-RA1

0.03% 0.07%

0.02%

Selenium

0.23%

Vanadium

Tungsten

Yttrium

Zinc

10
0.

SAMPLE #
MULX "cgw" #1 TR A

Ag	Al	As	B	Be	Bi	Ca	Cl	Co	Cr	Cu	Pb	Mg	Mn	Mo	Ni	P	Pb	Sb	Se	Sn	Sr	Tl	V	W	Y	Zn	Zr	
ppm	%	ppm	ppm	ppm	ppm	%	ppm	ppm	ppm	ppm	%	%	ppm	ppm	ppm	ppm	ppm	ppm	ppm	ppm	ppm	ppm	ppm	ppm	ppm	ppm	ppm	
1	1.7	0.5	< 10	100	< 1	1.6	1	26	280	660	2.4	1.7	420	210	0.07	87	890	11	5	7	16	170	1900	73	10	12	48	59

0.5 gm sample is digested with 2 ml of 3:1 HCL/HNO3
for 95 G. for 90 min and diluted to 10 ml with DI H2O
This method is partial for many oxide materials

SIGNED :

Ray Lead

10-08-96 03:15PM [9] H1

CROWLEY GROUNDWATER LIMITED
GROUNDWATER SPECIALISTS
2 BERTRAM DRIVE
DUNDAS - ONTARIO - L9H 4S9

October 29th, 1996

Crowley Groundwater Ltd
& Gary Kosy
Joint Venture

IN ACCOUNT WITH:

Crowley Groundwater Limited
2 Bertram Drive, Dundas, Ont.

TO: Services rendered by J.D. Crowley as outlined below:	RE: Webb Lake, Claim #1202490 - 4 Units Browning Lake, Claim #1202488 - 4 Units & Claim #1202489 - 1 Unit
1996 June 14 - Loading Time	09.0 hrs
June 15 - Travel Time	10.0 hrs
June 16 - Prospecting @ Webb Lake	11.0 hrs
June 17 - Prospecting @ Webb Lake	10.0 hrs
June 18 - Prospecting @ Webb Lake	10.0 hrs
June 19 - Research 1/2 @ Webb, 1/2 Browning	10.0 hrs
June 20 - Co-ordinating	11.0 hrs
June 21 - Travel Time	<u>13.0 hrs</u>
TOTAL TIME:	84.0 hrs
84 hrs @ \$30/hr (1/2 rate)	----- \$2,520.00
1966 Sept 05 - Travel Time	11.0 hrs
Sept 06 - Co-ordinating @ Webb Lake	11.0 hrs
Sept 07 - Co-ordinating @ Webb Lake	11.0 hrs
Sept 08 - Co-ordinating @ Webb Lake	11.0 hrs

Crowley Groundwater Ltd.
& Gary Kosy - Joint Venture

- 2-

October 29th, 1996

1996 Sept 09 - Co-ordinating @ Webb Lake	11.0 hrs	
Sept 10 - Co-ordinating @ Webb Lake	11.0 hrs	
Sept 11 - Sampling @ Webb	11.0 hrs	
Sept 12 - Sampling @ Webb	11.0 hrs	
Sept 13 - Sampling @ Webb	<u>11.0 hrs</u>	
TOTAL TIME:	99.0 hrs	
99 hrs @ \$30/hr (1/2 rate)	-----	\$2,970.00
Sept 14 - Co-ordinating @ Browning Lake	10.0 hrs	
Sept 15 - Co-ordinating @ Browning Lake	10.0 hrs	
Sept 16 - Travel Time	20.0 hrs	
Sept 17	<u> </u>	
TOTAL TIME:	40.0 hrs	
40 hrs @ \$30/hr (1/2rate)	-----	\$1,200.00

MILEAGE:

3/4 Ton Van - 2740 km @ \$.30/km	-----	\$ 822.00
----------------------------------	-------	-----------

DAY LABOUR (LOCAL): Including trucking & saw rental

Sept 09 - Chq #4558 - Kirk Miness	-	\$220.00
Sept 09 - Chq #4559 - R. Charbonneau	-	305.00
Sept 13 - Chq #4560 - R. Charbonneau	-	465.00
Sept 13 - Chq #4561 - Kirk Miness	-	300.00
Sept 15 - Chq #4562 - R. Charbonneau	-	295.00
Sept 15 - Chq #4563 - Kirk Miness	-	<u>250.00</u>
		\$1,835.00

MINERAL ANALYSIS:

Swastika Laboratories as per attached summary	-----	\$1,294.97
--	-------	------------

RECORDER FEES:

Mining Recorder, Kirkland Lake		
Dec 12/95 -	\$30.36	
Feb 26/96 -	\$54.00	
May 29/96 -	<u>\$31.03</u>	
	-----	\$ 115.66

Growley Groundwater Ltd
& Gary Kosy - Joint Venture

- 3 -

October 29th, 1998

ROOM, BOARD, FUEL
& MISCELLANES EXPENSES:

As Per Attached Summary of
Visa Statement and Expenses
Itemized Thereon:

TOTAL EXPENSES:	\$7,384.58	
LESS CAPITAL EXPENSES:	<u>\$1,594.45</u>	
TOTAL EXPENSES CHARGED	\$5,790.13	----- \$5,790.13
SUBTOTAL OF OUR ACCOUNT		<u>\$16,547.76</u>
PLUS 7% GST (#R101213049)		<u>\$ 1,158.34</u>
OUR TOTAL ACCOUNT HEREIN:		----- <u><u>\$17,706.10</u></u>

CERTIFIED CORRECT & SUBMITTED FOR PAYMENT HEREIN:



J.D. Crowley, President Crowley Groundwater Ltd.

E.&O.E.

BREAKDOWN OF COSTS

<u>Area:</u>	<u>Subtotal</u>	<u>+</u>	<u>GST</u>	<u>=</u>	<u>Total</u>
Webb Lake	\$12,451.91	+	\$871.63	=	\$13,323.54
Browning Lake	\$ 4,095.85	+	\$286.71	=	\$ 4,382.56
TOTALS	#15,437.76	+	\$1,158.34	=	\$17,706.10

KOSLY + CROWLEY
JOINT VENTURE .

Summary of Expenses
Paid on VISA - JDC

JUNE 196 = \$ 401.65

JULY 196 = \$ 1,881.71

AUG 196 = \$ 167.50

SEPT 196 = \$ 1,732.23

OCT 196 = \$ 1,607.04

TOTAL TO DATE ON VISA: \$ 5,790.13

PLUS CAPITAL EXPENSES:
ON VISA (NOT INCLUDED ABOVE)

JULY 196 - \$ 424.98

AUG 196 - \$ 1,003.95

SEPT 196 = \$ 165.52

TOTAL CAPITAL EXPENSES \$ 1,594.45

TOTAL EXPENSES ON VISA
{ BOTH CAPITAL + OTHER } \$ 7,384.58

es: Interest
advance or
ved.
to Your
of
ment's receive
de, the interest
the amount of

J.V. = Joint Venture.

[Signature] 1. 41.

GOLD
Elite

VISA Card
PAGE

RETAIN
THIS
PORTION
AMOUNT

CHANDISE	PREVIOUS BALANCE CONSISTED OF:	INTEREST/SERVICE CHARGE	BALANCE FORWARD	
2104.77	0.00	2.29		2107.06
REFERENCE NO.	DESCRIPTION OF TRANSACTION			
0516 03281011	CHAN'S RESTAURANT	DUNDAS CA	29.95	
0517 04432011	LUBRICARE CENTRES	HAMILTON CA	28.70	
0517 02765011	PIONEER PETROLEUM #174	HAMILTON CA	29.00	
0521 26330442	KHALSA AUTO SERVICE	MOUNT FOREST ON	40.00	
0522 03347011	TSC STORES LTD #189	BRANTFORD CA	11.72	
0524 01287055	THE SPOT RESTAURANT	MOUNT FOREST ON	15.68	
0524 01589011	TAMMY'S NO.2	DUNDAS CA	17.03	
0527 12302916	PAYMENT - THANK YOU		2107.06 -	
0527 05477011	CANGO #136	MORRISTON CA	30.00	
0530 14260442	PROVONT-N DEV & MINES	KIRKLAND ON	31.03 JV	
0531 63380342	SHOPPERS DRUG MART #742	MANAGER ON	12.75	
0603 22250192	CDN TIRE STORE # 00027	DUNDAS ON	40.24	
0604 01520011	TAMMY'S NO.2	DUNDAS CA	9.03	
0604 47770342	BEAVER FUELS #5104	CAMBRIDGE ON	30.00	
0605 02891011	PRINCESS AUTO LTD	KITCHENER CA	61.25	
0606 00920011	TAMMY'S NO.2	DUNDAS CA	13.45	
0607 32535075	UNITED REFRIGERATION	MISSISSAUGA ON	159.57	
0610 07242011	PIONEER #119	HAMILTON CA	19.50	
0610 07241011	GRISANTI'S	ETOBICOKE CA	23.36	
0610 64040442	KHALSA AUTO SERVICE	MOUNT FOREST ON	37.00	
0610 02672011	GAS RITE #37	SIMCOE CA	32.09 JV	
0611 06410011	PLM OUTDOOR ENTERPRISE	HEP WORTH CA	22.95 JV	
0611 02019011	MANDARIN RESTAURANT	BURLINGTON CA	34.93	
0611 06410011	THE SPECTATOR	HAMILTON CA	91.00	
0612 00934011	TAMMY'S NO.2	DUNDAS CA	14.88	
0612 01532011	PHOTOMAP AIR SURVEYS	REXDALE CA	209.88 JV	
0613 00970462	LEE'S DUNDAS PHARMACY	DUNDAS ON	69.53	
0613 05400192	CDN TIRE STORE # 00177	HAMILTON ON	79.32 JV	
0614 10020672	SHELL HIGHWAY #11 NORTH	GRAVENHURST ON	19.38 JV	
0614 01675011	PIONEER PETROLEUM #38	HANNON CA	34.50	
0614 01675011	BURLINGTON POST	BURLINGTON CA	224.70	

DUE TO RECENT AIRLINE INDUSTRY CHANGES THE TD GOLD TRAVEL CLUB WILL NO LONGER BE OFFERING 5% DISCOUNTS ON SCHEDULED AIRFARES. YOU CAN STILL EARN 5% DISCOUNTS ON CHARTERED AIRFARES, CRUISES AND PACKAGED HOLIDAYS. MORE DETAILS WILL BE MAILED TO YOU IN AUGUST. IF YOU

[Handwritten signature]

PAYMENTS/CREDITS	INTEREST/SERVICE CHARGE	NEW CHARGES	PRESENT BALANCE
STATEMENT DATE	OVERDUE PAYMENT	THIS MONTH'S PAYMENT	MINIMUM PAYMENT
ACCOUNT NUMBER	CREDIT LINE	CREDIT STILL AVAILABLE	DUE DATE

TOTAL
JOINT
VENTURE
EXPENSES
C/O TIME/96
VISA

Interest to amount of the interest is received & OLD Elite

J.V. = Joint Venture

July 1962
1.072

VISA Card PAGE

RETAIN THIS POSITION AMOUNT

PREVIOUS BALANCE CONSISTED OF:
 STATEMENT NO. 1479.42 CASH ADVANCES 0.00 INTEREST/SERVICE CHARGE 0.00 BALANCE FORWARD 1479.42

REFERENCE NO.	DESCRIPTION OF TRANSACTION				
0617 11141011	FIFTH WHEEL TRUCK STOP	MILTON	CA	19.23	-dv
0617 02174011	ESSO HWY 25 / CHISOLM	MILTON	CA	29.55	-dv
0617 08562011	DELEAN'S GAS BAR	SWASTIKA	CA	36.00	-dv
0617 02272011	BON AIR MOTOR INN	KIRKLAND LA	CA	51.56	-dv
0618 05965035	PINEWOOD PARK MOTOR INN	NORTH BAY	ON	6.63	-dv
0618 05283011	DELEAN'S GAS BAR	SWASTIKA	CA	17.00	-dv
0618 05283011	GOLDEN GRIDDLE FAMILY RES	NEW LISKEARD	CA	19.11	-dv
0618 01599011	BON AIR MOTOR INN	KIRKLAND LA	CA	22.90	-dv
0618 05283011	DELEAN'S GAS BAR	SWASTIKA	CA	42.00	-dv
0618 01599011	BON AIR MOTOR INN	KIRKLAND LA	CA	66.78	-dv
0618 05980035	PINEWOOD PARK MOTOR INN	NORTH BAY	ON	109.76	-dv
0619 00886011	BON AIR MOTOR INN	KIRKLAND LA	CA	13.62	-dv
0619 04505011	DELEAN'S GAS BAR	SWASTIKA	CA	22.00	-dv
0619 00886011	BON AIR MOTOR INN	KIRKLAND LA	CA	57.21	-dv
0619 04505011	PAUL'S NEW & USED STORE	KIRKLAND LK	CA	57.39	-dv
0620 00896011	BON AIR MOTOR INN	KIRKLAND LA	CA	17.00	-dv
0620 00896011	BON AIR MOTOR INN	KIRKLAND LA	CA	19.98	-dv
0620 04714011	DELEAN'S GAS BAR	SWASTIKA	CA	30.00	-dv
0620 00896011	BON AIR MOTOR INN	KIRKLAND LA	CA	57.19	-dv
0621 03361011	BON AIR MOTOR INN	KIRKLAND LA	CA	11.20	-dv
0621 34880342	MACEWEN - NORTH BAY	NORTH BAY	ON	28.00	-dv
0621 03361011	BON AIR MOTOR INN	KIRKLAND LA	CA	49.45	-dv
0624 02753011	BON AIR MOTOR INN	KIRKLAND LA	CA	16.64	-dv
0624 10497011	FIFTH WHEEL TRUCK STOP	MILTON	CA	17.53	-dv
0624 02752011	BON AIR MOTOR INN	KIRKLAND LA	CA	17.74	-dv
0624 07433011	DELEAN'S GAS BAR	SWASTIKA	CA	28.00	-dv
0624 02753011	BON AIR MOTOR INN	KIRKLAND LA	CA	54.86	-dv
0624 03780011	CAPITOL GRILL	KIRKLAND LAKE	CA	58.48	-dv
0624 02752011	BON AIR MOTOR INN	KIRKLAND LA	CA	835.15	-dv
0625 00980462	LEE'S DUNDAS PHARMACY	DUNDAS	ON	117.19	-dv
0627 08846015	PINEWOOD PARK MOTOR INN	NORTH BAY	ON	14.87	-dv
0627 00934011	LUBRICARE CENTRES	HAMILTON	CA	22.95	-dv
0627 01063011	OLIVE GARDEN 00043117	HAMILTON	CA	34.21	-dv
0627 02609011	PIONEER PETROLEUM #19	DUNDAS	CA	37.00	-dv
0627 08855015	PINEWOOD PARK MOTOR INN	NORTH BAY	ON	54.88	-dv
0628 70280342	BEAVER FUELS #5046	HAMILTON	ON	29.00	-dv
0702 15380672	SHELL R R 1	WIARTON	ON	20.90	-dv
0702 03101011	ESSO 062196	MILTON	CA	27.50	-dv
0703 01939011	TAMMY'S NO.2	DUNDAS	CA	9.37	-dv

INTEREST/SERVICE CHARGE PRESENT BALANCE
 OVERDUE PAYMENT THIS MONTH'S PAYMENT MINIMUM PAYMENT
 CREDIT LINE CREDIT STILL AVAILABLE DUE DATE

ANNUAL INTEREST RATE REPORT ANY DISCREPANCIES TO

JOINT VENTURE
 SUB TOTAL 2306.69
 LESS CAPITAL EXPENSE 424.98
 TOTAL 1881.71
 July 1962
 VISA

GOLD
Elite

VISA Card
PAGE

RETAIN
THIS
POSITION
2 OF 2
AMOUNT

July 1996
242.

PREVIOUS BALANCE CONSISTED OF:
MERCHANDISE 1479.42 CASH ADVANCES 0.00 INTEREST/SERVICE CHARGE 0.00 BALANCE FORWARD 1479.42

REFERENCE NO.	DESCRIPTION OF TRANSACTION	CA	ON	CA	ON	CA	ON	CA	ON
0703 08591011	CANGO #1843								
0704 00930462	LEE'S DUNDAS PHARMACY								
0704 03900011	PRINCESS AUTO LTD								
0705 21600055	THE SPOT RESTAURANT								
0705 04497011	PIONEER PETROLEUM #142								
0705 01876011	OLIVE GARDEN 00043117								
0705 01915011	MCKERLIE MILLEN STORE 224								
0705 04497011	CARRIER TRUCK								
0709 01468011	PETROCAN 79 KING ST								
0712 14831916	PAYMENT - THANK YOU								
0715 98850442	KHALSA AUTO SERVICE								
0716 01221011	ESSO								
0716 00025925	INTEREST								

JR CAPITAL
JR CAPITAL

ACCUMULATED DIVIDEND IS \$118.19 .

424.98
Capital

10 of 10
Received
12/29/96

GOLD
Elite

JOV, = JOINT VENTURE

VISA Card
PAGE

RETAIN
THIS
PORTION
AMOUNT

Aug/96
1171

PREVIOUS BALANCE CONSISTED OF:
MERCHANTISE 2829.03 CASH ADVANCES 0.00 INTEREST/SERVICE CHARGE 24.52 BALANCE FORWARD 2853.55

DATE	DESCRIPTION OF TRANSACTION	AMOUNT
0717 01335011	TAMMY'S NO.2 DUNDAS CA	13.21
0718 03614011	WEST END CAR WASH HAMILTON CA	13.00
0719 97880342	TU LANE RESTAURANT CAMBRIDGE ON	5.72 -dr
0719 01960011	MAPLE LEAF PANCAKE HOUSE HAMILTON CA	7.51
0719 03323011	PIONEER PETROLEUM #84 PARIS CA	34.00
0719 12000035	JOHNNY BO'S SIMCOE ON	42.35
0719 03323011	ST GEORGE TIRE ST GEORGE CA	372.60 -dr - Capital
0723 01524011	MAPLE LEAF PANCAKE HOUSE BRANTFORD CA	8.69
0723 05919011	PIONEER PETROLEUM #142 FLAMBOROUGH CA	33.00
0724 01328011	SEAN'S FIFTH WHEEL DORCHESTER CA	6.83
0724 01320011	GAS RITE #17 HAMILTON CA	26.00
0724 09780342	SHOPPERS DRUG MART #742 MANAGER ON	47.88
0726 05597011	TSC STORES LTD #189 BRANTFORD CA	36.80 -dr
0726 04128011	BURLINGTON POST BURLINGTON CA	326.35
0729 19839936	PAYMENT - THANK YOU	1374.13-
0729 02553011	SUNOCO 1050 MAIN ST HAMILTON CA	35.00
0730 01780011	REGIONAL FORD NEW HOLLAND FREELTON CA	6.64
0730 01558011	LUBRICARE CENTRES HAMILTON CA	50.48
0730 18751055	LEE MCBRIDES HAMILTON ON	52.77
0731 02823011	CANGO #136 MORRISTON CA	16.50
0731 49730342	BEAVER FUELS #5046 HAMILTON ON	36.00 -dr. Capital
0731 05211011	TSC STORES LTD STRATFORD CA	631.35
0801 09070342	TU LANE RESTAURANT CAMBRIDGE ON	7.43
0806 01236011	GAS RITE #17 HAMILTON CA	16.50
0806 98270442	KHALSA AUTO SERVICE MOUNT FOREST ON	39.00
0807 04520011	UNIVERSITY HOME HARDWARE DUNDAS CA	8.61
0807 02651011	MANDARIN RESTAURANT BURLINGTON CA	33.14
0808 03847011	WEST END CAR WASH HAMILTON CA	13.00
0808 03847011	PIONEER PETROLEUM #142 FLAMBOROUGH CA	23.20
0809 03347011	GEORGES VILLA RESTAURA ORANGEVILLE CA	10.30
0809 06802011	NEW HOLLAND NORTH AMERICA NEW HOLLAND US	40.87 -dr
29.25 US DLRS		
0812 02510011	HOLIDAY INN - KINGSTON KINGSTON CA	24.28
0812 07043011	PIONEER PETROLEUM #632 KINGSTON CA	33.00
0812 02526011	HOLIDAY INN - OSHAWA OSHAWA CA	49.38
0813 05088011	PIONEER PETROLEUM #142 FLAMBOROUGH CA	16.23
0814 04828011	PIONEER PETROLEUM #174 HAMILTON CA	7.00
0814 03395011	TSC STORES LTD #189 BRANTFORD CA	84.11 -dr
0814 01050462	LEE'S DUNDAS PHARMACY DUNDAS ON	106.11

INTEREST/SERVICE CHARGE PRESENT BALANCE

OVERDUE PAYMENT THIS MONTH'S PAYMENT MINIMUM PAYMENT

CREDIT LINE CREDIT STILL AVAILABLE DUE DATE

ANNUAL INTEREST RATE REPORT ANY DISCREPANCIES TO

JOINT VENTURE # 1171.45

GIB TOTAL - 1,003.95

LESS CAPITAL EXPENSES 167.50

TOTAL - ON AUG/96 VISA

Payment is received by the amount of
 made, the interest
 by the amount of
 "Reques" - Interest
 the advance or
 posted to your
 s received.

J.V. = JOINT VENTURE

Sept 1991
 1 of 1

VISA Card
 PAGE

RETAIN THIS PORTION
 AMOUNT

PREVIOUS BALANCE CONSISTED OF
 MERCHANDISE 3897.66 CASH ADVANCES 0.00 INTEREST/SER 60.20 BALANCE FORWARD 3957.86

		DESCRIPTION OF TRANSACTION			
0819	02579011	GAS RITE #17	HAMILTON	CA	23.41
0819	07081011	PRINCESS AUTO LTD	KITCHENER	CA	171.25 - JV
0820	02381011	MOTEL CALIFORNIA	ANCASTER	CA	8.49
0821	01200192	CDN TIRE STORE # 00027	DUNDAS	ON	31.47 - JV
0821	02636011	PIONEER PETROLEUM #174	HAMILTON	CA	33.00
0821	05274011	TSC STORES LTD #189	BRANTFORD	CA	91.28 - JV
0822	01030462	LEE'S DUNDAS PHARMACY	DUNDAS	ON	6.11
0822	00650342	DAFFODILS	PARIS	ON	11.66
0822	03727011	CANGO #1843	ARTHUR	CA	20.00
0823	05990342	HUNTER PRO HARDWARE	WIARTON	ON	8.94
0823	01966011	KELLY JOES REST & ROAD HS	DURHAM	CA	34.51
0823	05618011	TSC STORES LTD #189	BRANTFORD	CA	44.82 - JV CAPITAL
0823	08854055	G C MCDONALD SUPPLY LTD	BRANTFORD	ON	120.70 - JV " "
0826	09785011	GOLDEN GRIDDLE PANCAKE H	TORONTO	CA	6.19
0826	07822011	BREEZY CORNERS REST.	FREELTON	CA	11.10
0826	05360442	KHALSA AUTO SERVICE	MOUNT FOREST	ON	38.00
0826	07822011	PIONEER PETROLEUM #174	HAMILTON	CA	42.69
0827	01699011	MAPLE LEAF PANCAKE HOUSE	BRANTFORD	CA	6.35
0828	01331011	TAMMY'S NO.2	DUNDAS	CA	12.11
0829	01338011	RADIO SHACK #05-5257	DUNDAS	CA	3.90
0829	01825011	MOTEL CALIFORNIA	ANCASTER	CA	9.68
0830	03045011	MCKERLIE-MILLEN STORE 216	DUNDAS	CA	9.24 - JV
0830	04021011	PRINCESS AUTO	LONDON	CA	10.29 - JV
0830	04021011	PIONEER PETROLEUM #84	PARIS	CA	34.00
0830	04021011	PIONEER PETROLEUM #19	DUNDAS	CA	44.00
0903	26640192	CDN TIRE STORE # 00012	BRANTFORD	ON	30.44 - JV
0903	13173011	TSC STORES LTD #189	BRANTFORD	CA	72.50 - JV
0904	01818011	RADIO SHACK #05-5257	DUNDAS	CA	8.04
0904	01621011	ESSO	WIARTON	CA	20.00
0904	57820442	DAVIS FUEL CO LTD	BRANTFORD	ON	23.00 - JV
0904	06829011	PIONEER PETROLEDM #142	HAMILTON	CA	36.00
0904	15340472	TSC STORES LTD #189	BRANTFORD	ON	105.62 - JV
0905	01140462	LEE'S DUNDAS PHARMACY	DUNDAS	ON	9.75
0905	01850010	MOTEL CALIFORNIA	ANCASTER	CA	10.18
0905	01282010	TAMMY'S NO.2	DUNDAS	CA	11.80
0905	01140462	LEE'S DUNDAS PHARMACY	DUNDAS	ON	129.41 - JV
0906	02335010	NEWMARKET HOME HARDWARE	NEWMARKET	CA	8.60 - JV
0906	46620342	TU LANE RESTAURANT	CAMBRIDGE	ON	20.58

PAYMENTS/CREDITS INTEREST/SERVICE CHARGE NEW CHARGES PRESENT BALANCE
 STATEMENT DATE OVERDUE PAYMENT THIS MONTH'S PAYMENT MINIMUM PAYMENT
 ACCOUNT NUMBER CREDIT LINE CREDIT STILL AVAILABLE DUE DATE

ANNUAL INTEREST RATE REPORT ANY DISCREPANCIES TO

Joint Venture
 SUBTOTAL 1,897.75
 LESS CAPITAL EXPENSE 165.52
 TOTAL - W-SUPPLY VISA 1,732.23

ment is received to the interest the amount of
 Interest advance or paid to your
 billed daily

Sept 196
 207.2

VISA Card
 PAGE 2 OF 3

RETAIN THIS PORTION 3 OF AMOUNT

PREVIOUS BALANCE CONSISTED OF:
 MERCHANDISE 3897.66 CASH ADVANCES 0.00 INTEREST SERVICE CHARGE 60.20 BALANCE FORWARD 3957.86

		DESCRIPTION OF TRANSACTION			
0909	01929010	BON AIR MOTOR INN	KIRKLAND LA	CA	6.18 -dv
0909	38528075	AUSTRIAN VILLAGE INN INC	ST GEORGE	ON	10.82
0909	01802010	PETROCAN HWY 11 NORTH	NORTH BAY	CA	14.65 -dv
0909	06180442	YOUR PLACE EATERY	KIRKLAND LAKEON		19.99 -dv
0909	01801010	PETROCAN HWY 400	KING CITY	CA	24.00 -dv
0909	01936010	BON AIR MOTOR INN	KIRKLAND LA	CA	33.08 -dv
0909	01929010	BON AIR MOTOR INN	KIRKLAND LA	CA	34.73 -dv
0909	01825010	ESSO WOODBINE & RAVENSHOE	KESWICK	CA	41.00 -dv
0909	01801010	PETROCAN HWY 11 NORTH	NORTH BAY	CA	89.20 -dv
0909	02007010	ROYAL OAK INN -BEST WESTE	BARRIE	CA	125.44 -dv
0910	01471010	BON AIR MOTOR INN	KIRKLAND LA	CA	6.18 -dv
0910	05343010	DELEAN'S GAS BAR	SWASTIKA	CA	26.00 -dv
0910	05343010	DELEAN'S GAS BAR	SWASTIKA	CA	35.50 -dv
0910	01471010	BON AIR MOTOR INN	KIRKLAND LA	CA	48.26 -dv
0910	05343010	DELEAN'S GAS BAR	SWASTIKA	CA	56.00 -dv
0910	05343010	BURLINGTON POST	BURLINGTON	CA	224.70
0911	03011010	BON AIR MOTOR INN	KIRKLAND LA	CA	9.81 -dv
0911	00908010	DELEAN'S GAS BAR	SWASTIKA	CA	26.50 -dv
0911	03012010	BON AIR MOTOR INN	KIRKLAND LA	CA	29.13 -dv
0911	02180192	CDN TIRE STORE # 00052	KIRKLAND LAKEON		32.36 -dv
0912	01119010	BON AIR MOTOR INN	KIRKLAND LA	CA	5.72 -dv
0912	01119010	BON AIR MOTOR INN	KIRKLAND LA	CA	8.30 -dv
0912	03880462	NORTHERN AUTO&IND SUPPLY	KIRKLAND LAKEON		22.17 -dv
0912	01119010	BON AIR MOTOR INN	KIRKLAND LA	CA	75.82 -dv
0912	02571010	JC TRAILERS AND EQUIPMENT	KESWICK	CA	113.85 -dv -REPAIR
0913	01664010	BON AIR MOTOR INN	KIRKLAND LA	CA	7.31 -dv
0913	11983075	IRENE'S HOMESTYLE COOKING	BARRIE	ON	8.24 -dv
0913	01664010	BON AIR MOTOR INN	KIRKLAND LA	CA	8.55 -dv
0913	01626010	PETER FORCELLINI LTD	KIRKLAND LAKECA		29.89 -dv
0913	05034010	DELEAN'S GAS BAR	SWASTIKA	CA	57.20 -dv
0916	03447010	MOTEL CALIFORNIA	ANCASTER	CA	7.56
0916	02528010	BON AIR MOTOR INN	KIRKLAND LA	CA	8.03 -dv
0916	02530010	BON AIR MOTOR INN	KIRKLAND LA	CA	8.48 -dv
0916	02522010	BON AIR MOTOR INN	KIRKLAND LA	CA	30.78 -dv
0916	02528010	BON AIR MOTOR INN	KIRKLAND LA	CA	45.48 -dv
0916	02530010	BON AIR MOTOR INN	KIRKLAND LA	CA	90.71 -dv
0916	00025218	INTEREST			6.38

CHANGES ARE BEING MADE TO YOUR TD GOLD

INTEREST/SERVICE CHARGE NEW CHARGES PRESENT BALANCE
 OVERDUE PAYMENT THIS MONTH'S PAYMENT MINIMUM PAYMENT
 ACCOUNT NUMBER CREDIT LINE CREDIT STILL AVAILABLE DUE DATE
 ANNUAL INTEREST RATE REPORT ANY DISCREPANCIES TO

equus*: Interest
the advance of
poster to your
s received.

ment's receive
de, the interest
y the amount of

J.V. = JOINT VENTURE

Oct 1996
1.081.

VISA Card
PAGE

RETAIN
THIS
PORTION
OF
AMOUNT

SEP 26 96 2740.73 0.00 6.38 BALANCE FORWARD 2747.11

PREVIOUS BALANCE CONSISTED OF:							
MERCHANDISE	CASH ADVANCES	INTEREST/SERVICE CHARGE	BALANCE FORWARD				
DESCRIPTION OF TRANSACTION							
0917 00981010	BON AIR MOTOR INN	KIRKLAND LA	CA	16.07	-dr		
0917 05373010	DELEAN'S GAS BAR	SWASTIKA	CA	35.00	-dr		
0917 00981010	BON AIR MOTOR INN	KIRKLAND LA	CA	46.58	-dr		
0917 02860672	SHELL 281 DUNLOP STREET W	BARRIE	ON	59.00	-dr		
0917 01010010	SUNDIAL INN	ORILLIA	CA	61.32	-dr		
0917 05373010	DELEAN'S GAS BAR	SWASTIKA	CA	77.50	-dr		
0918 01113010	BON AIR MOTOR INN	KIRKLAND LA	CA	4.80	-dr		
0918 01159010	SEAN'S FIFTH WHEEL	DORCHESTER	CA	14.15	-dr		
0918 02639010	CANGO #1843	ARTHUR	CA	42.00	-dr		
0918 02639010	MR GAS #075	NORTH BAY	CA	74.00	-dr		
0918 01113010	BON AIR MOTOR INN	KIRKLAND LA	CA	952.55	-dr		
0919 55054085	IRENE'S HOMESTYLE COOKING	BARRIE	ON	13.36	-dr		
0919 01344010	SUNDIAL INN	ORILLIA	CA	51.32	-dr		
0919 01380010	COMFORT INN	BARRIE	CA	118.72	-dr		
0919 01344010	SUNDIAL INN	ORILLIA	ON	61.32	-dr		
0924 35289085	THE SPOT RESTAURANT	MOUNT FOREST	ON	11.80			
0924 01245010	LUBRICARE CENTRES	HAMILTON	CA	28.70			
0924 01258010	PETROCAN HWY 400	KING CITY	CA	34.00			
0924 03930192	CDN TIRE STORE # 00129	HAMILTON	ON	55.18			
0925 01143010	BEAVER LODGE MOTEL &	POWASSAN	CA	11.01			
0925 03530672	SHELL HWY 11 SOUTH	POWASSAN	ON	45.75			
0926 19520342	SHOPPERS DRUG MART #665	NORTH BAY	ON	27.49			
0927 01782010	BEAVER LODGE MOTEL &	POWASSAN	CA	8.55			
0927 01782010	BEAVER LODGE MOTEL &	POWASSAN	CA	8.70			
0927 01782010	BEAVER LODGE MOTEL &	POWASSAN	CA	9.61			
0927 01782010	BEAVER LODGE MOTEL &	POWASSAN	CA	9.86			
0927 01721010	ESSO 091796	ENGLEHART	CA	21.35	-dr		
1001 01575010	BEAVER LODGE MOTEL &	POWASSAN	CA	8.94			
1001 01575010	BEAVER LODGE MOTEL &	POWASSAN	CA	9.15			
1001 01525010	ESSO IMP OIL /HWY 11-H	WY 169 GRAVCA	CA	32.00			
1002 01186010	BEAVER LODGE MOTEL &	POWASSAN	CA	8.69			
1002 01186010	BEAVER LODGE MOTEL &	POWASSAN	CA	10.11			
1003 04580213	PAYMENT - THANK YOU			2747.11			
1003 00843010	BEAVER LODGE MOTEL &	POWASSAN	CA	6.39			
1003 00843010	BEAVER LODGE MOTEL &	POWASSAN	CA	8.46			
1003 03905010	CLEMENT'S IDA PHARMACY	POWASSAN	CA	13.83			
1003 03390672	SHELL HWY 11 SOUTH	POWASSAN	ON	48.17			
1004 01781010	LUBRICARE CENTRES	HAMILTON	CA	28.70			
1004 15358055	PINEWOOD PARK MOTOR INN	NORTH BAY	ON	307.58			

INTEREST/SERVICE CHARGE PRESENT BALANCE
 OVERDUE PAYMENT THIS MONTH'S PAYMENT MINIMUM PAYMENT
 CREDIT LINE CREDIT STILL AVAILABLE DUE DATE
 ANNUAL INTEREST RATE REPORT ANY DISCREPANCIES TO

\$ 1,607.04
 TOTAL JOINT VENTURE
 EXPENSES OCT 1996
 ON VISA

KOSY & CROWLEY
 JOINT VENTURE.
 Summary of Costs
 for Mineral Analysis

SWASTIKA LAB:

1. JUNE 18/96 - CERT # 6W-2128-RA1 = 18.21
2. JUNE 21/96 - CERT # 6W-2168-RA1 = 61.53.
3. JUNE 25/96 - CERT # 6W-2188-RA1 }
 - CERT # 6W-2194-RA1 } = 80.26.
4. JULY 16/96 - CERT # 6W-2487-RA1 = 120.38
5. SEPT. 27/96 - CERT # 6W-3683-RA1 }
 - CERT # 6W-3684-RA1 } = 856.54
6. OCT. 2/96 - CERT # 6W-3685-RA1 = 149.06.
7. OCT 7/96 - CERT # 6W-3684-RA1 = 8.99.

TOTAL TO DATE: \$ 1,294.97

MINING RECORDER OFFICE.
KIRKLAND WARE.

MAY 29/96 = \$ 31.03
 FEB 26/96 = 54.08
 DEC 12/95 = 30.36

TOTAL \$ 115.66. \$ 115.66

Summary of Accounts

WEBB LAKE
CLAIM # 1202490
4 UNITS

BROWNING LAKE
1202488 - 1202489
4 UNIT 1 UNIT

1. Dale	= \$	12,553.70	\$	5,657.54
2. Wilson	= \$	13,744.20	\$	7,941.82
3. Crowley	= \$	13,323.54	\$	4,382.56
		<hr/>	<hr/>	
Totals	= \$	39,621.44	\$	17,981.92

Grand Totals \$ 39,621.44 - WEBB
of all 17,981.92 - BROWNING.
3

Accounts \$ 57,603.36

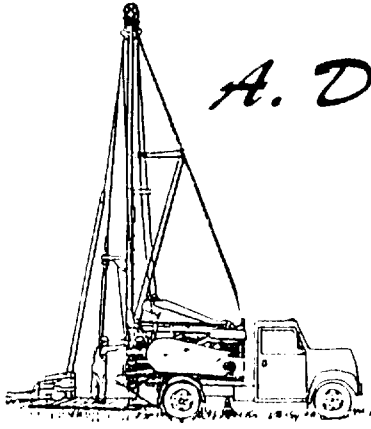

A. Dale Well & Pump Service Limited

WATER WELL DRILLING & PUMP CONTRACTOR

832 Westminster Drive, London, Ontario N6N 1M1
Telephone: (519) 644-1020 Facsimile: (519) 644-2241

September 24th, 1996

TO: Crowley Groundwater Limited
2 Bertram Drive
Dundas, Ontario L9H 4S9

Webb Lake - Claim #1202490, 4 Units
Browning Lake - Claim #1202488, 4 Units
& Claim #1202489, 1 Unit

RE: Gary Kosy
Joint Venture

This invoice covers our work on this project on June 14th to June 22nd, 1996 and on September 5th to September 17th, 1996 and includes the following:

LABOUR:

1996 - June 14 - Load and Travel	10.0 hrs	
- June 15 - Travel and Unload	10.0 hrs	
- June 16 - Beep Map at Webb Lake	11.0 hrs	
- June 17 - Beep Map at Webb Lake	10.5 hrs	
- June 18 - Beep Map at Webb Lake	11.0 hrs	
- June 19 - Beep Map at Browning Lake	10.5 hrs	
- June 20 - Beep Map at Browning Lake	11.0 hrs	
- June 21 - Beep Map & Prospect at Webb Lake	11.0 hrs	
- June 22 - Travel Time & Load and Unload	<u>13.0 hrs</u>	
TOTAL HOURS:	98.0 hrs	
98 hrs @ \$30/hr -----		\$2,940.00

RENTALS:

Honda ATV - 9 days @ \$80/day	-----	720.00
1-ton Trailer - days @ \$25/day	-----	225.00

ROOM, BOARD & FUEL:

Supplied by Crowley Groundwater Ltd.-----

SUBTOTAL #1 ----- \$3,885.00

LABOUR:

1996 - Sept 05 - Travel and Load Backhoe , Float, etc.	11.0 hrs	
- Sept 06 - Unload & Strip at Webb Lake	11.0 hrs	
- Sept 07 - Stripping and Road Building at Webb Lake	12.0 hrs	
- Sept 08 - Stripping and Road Building at Webb Lake	11.0 hrs	
- Sept 09 - Stripping and Road Building at Webb Lake	11.0 hrs	
- Sept 10 - Stripping and Road Building at Webb Lake	11.0 hrs	
- Sept 11 - Stripping and Road Building at Webb Lake	11.0 hrs	
- Sept 12 - Stripping and Road Building at Webb Lake	11.0 hrs	
- Sept 13 - Stripping and Road Building at Webb Lake	<u>11.0 hrs</u>	
TOTAL HOURS:	100.0 hrs	
100 hrs @ \$65/hr	-----	\$6,500.00
- Sept 14 - Hand Trenching & Sampling at Browning Lake	10.0 hrs	
- Sept 15 - Hand Trenching & Sampling at Browning Lake	<u>12.0 hrs</u>	
TOTAL HOURS:	22.0 hrs	
22 hrs @ \$30/hr	-----	\$ 660.00

LABOUR: (continued)

1996 - Sept 16	Travel with	18 hrs.	
and	Truck Float &		
- Sept 17	Backhoe		
	18 hrs @ \$65/hr	-----	\$1,170.00

MILEAGE: (Truck)

2461 km @ \$1/km	-----	\$2,461.00
------------------	-------	------------

RENTALS:

Honda ATV - 13 days @ \$80/day	-----	\$1,040.00
1-ton Trailer - 13 days @ \$25/day	-----	\$ 325.00
Stihl Diamond Saw - 13 days @ \$40/day	-----	\$ 520.00
1- 12" Diamond Blade (Purchased)	-----	\$ 458.85

ROOM, BOARD & FUEL:

Supplied by Crowley Groundwater Ltd.	-----	-----
--------------------------------------	-------	-------

SUBTOTAL #2	-----	\$13,134.85
-------------	-------	-------------

RECAP:

SUBTOTAL # 1	-----	\$3,885.00	
SUBTOTAL # 2	-----	<u>13,134.85</u>	\$17,019.85
PLUS GST @ 7% (#R119435022)			<u>\$ 1,191.39</u>
TOTAL ACCOUNT HEREIN:			<u><u>\$18,211.24</u></u>

TERMS: Net 30 days
 A. Dale Well & Pump Service Ltd.

BREAKDOWN OF COSTS

<u>Area:</u>	<u>Subtotal</u>	<u>+</u>	<u>GST</u>	<u>=</u>	<u>Total</u>
Webb Lake	\$11,732.43	+	\$821.27	=	\$12,553.70
Browning Lake	\$ 5,287.42	+	\$370.12	=	\$ 6,657.54
TOTALS	\$17,019.85	+	\$1,191.39	=	\$18,211.24

IAN D. WILSON ASSOCIATES LIMITED

Highway 19 North
 R.R. 1
 Stratford, Ontario
 N5A 6S2

GST Reg. 102442068

October 28, 1996

G. Kosy - Crowley Groundwater Limited - Joint Venture
 Attn. Mr. D. Crowley
 2 Bertram Drive
 Dundas, Ontario
 L9H 4S9

To Professional ServicesWebb Lake1202490 Claim GroupIan D. Wilson, P.Eng.

1996	June 16	fieldwork	11 hours		
	Sept. 10	fieldwork	11 hours		
	12	fieldwork	11 hours		
	27	report preparation	7 hours		
	30	report preparation	7 hours		
Oct.	1	report preparation	7.5 hours		
	4	report preparation	5 hours		
	21	report preparation	<u>4 hours</u>		
	Total		63.5 hours @ \$80/hr.		\$5080.00

Travel

1996	June 13		5.25 hours		
	14		4 hours		
	16		4 hours		
	17		<u>3.5 hours</u>		
	Total		16.75 hours @ \$40/hr.	\$ 670.00	
	Kilometres 1365 km @ \$0.30/km			<u>409.50</u>	\$1079.50

H. Lowell

1996	June 16	fieldwork	5.25 hours		
	18	fieldwork	11 hours		
	20	fieldwork	11 hours		
July	12	fieldwork	9 hours		
Sept.	10	fieldwork	11 hours		
	11	fieldwork	11 hours		
	12	fieldwork	<u>11 hours</u>		
	Total		74.5 hours @ \$80/hr.		\$5960.00

continued

Labour

1996	Sept.	9	travel & unloading	8.5 hours	
	Sept.	10	fieldwork	11 hours	
	Sept.	12	fieldwork	<u>11 hours</u>	
				30.5 hours @ \$30/hr.	\$ 915.00

Rentals

1996	Sept.	9 to 13 period	Two ATVs 2 days @ \$80/day each		320.00
------	-------	----------------	---------------------------------	--	--------

Incidentals

1996	June & Sept.	- 50% of \$779.39			<u>\$ 389.70</u>
------	--------------	-------------------	--	--	------------------

Total Webb Lake					<u>\$13744.20</u>
-----------------	--	--	--	--	-------------------

IAN D. WILSON ASSOCIATES LIMITED

Highway 19 North
 R.R. 1
 Stratford, Ontario
 N5A 6S2

GST Reg. 102442068

October 28, 1996

G. Kosy - Crowley Groundwater Limited - Joint Venture
 Attn. Mr. D. Crowley
 2 Bertram Drive
 Dundas, Ontario
 L9H 4S9

To Professional ServicesBrowning Lake1202488 Claim Group & Claim 1202489Ian D. Wilson, P.Eng.

1996	June	15	fieldwork	10 hours		
	Sept.	11	fieldwork	11 hours		
	Oct.	9	report preparation	3 hours		
		10	report preparation	7 hours		
		11	report preparation	<u>3 hours</u>		
	Total			34 hours @ \$80/hour		\$2720.00

Travel

1996	Sept.	9		8.5 hours		
		13		<u>9 hours</u>		
	Total			17.5 hours @ \$40/hour	\$ 700	
			Kilometres 1374 km @ \$0.30/km		<u>412.20</u>	\$1112.12

H. Lowell

1996	June	15	fieldwork	11 hours		
	July	9	fieldwork	10 hours		
	Sept.	7	fieldwork	<u>12 hours</u>		
	Total			33 hours @ \$80/hour		\$2640.00

Labour

1996	Sept.	11	fieldwork	11 hour		
		13	travel, load & unload	<u>9 hours</u>		
	Total			20 hours @ \$30/hour		\$ 600.00

Rentals

1996	Sept. 9 - 13 period	Two ATVs 3 days @ \$80/day each				\$ 480.00
------	---------------------	---------------------------------	--	--	--	-----------

Incidentals

1996	June & Sept.	- 50% of \$779.39				<u>\$ 389.70</u>
------	--------------	-------------------	--	--	--	------------------

Total	Browning Lake					<u>\$7941.82</u>
-------	---------------	--	--	--	--	------------------

G. Kosy - Crowley Groundwater Limited - Joint Venture

Incidentals

Accommodation	Juny 13, 1996	North Bay	\$ 54.88	
	July 14	Kirkland Lake	58.74	
	July 15	Kirkland Lake	58.74	
Meals	June 13 - 15		19.61	
Accommodation	Sept. 10	Kirkland Lake	64.34	
	Sept. 11	Kirkland Lake	64.34	
	Sept. 12	Kirkland Lake	64.34	
	Sept. 13	Kirkland Lake	64.34	
Meals	Sept. 9 - 13		229.20	
Maps and reports			68.05	
lagging tape, etc.			<u>32.81</u>	<u>779.39</u>

Note: - The above is for your information only. The total has been divided between the Webb Lake and Browning Lake claims.

amended copy

City of
Northern Development
and Mines

Report of Work Conducted After Recording Claim

Transaction Number
W9680.00565

Mining Act

WEBB LAKE

Information will be used for correspondence. Questions about
Development and Mines, Fourth Floor, 158 Cedar Street,

CLAIM #1202490 - 4 Units

All Inform
Recipients
Copy, Order

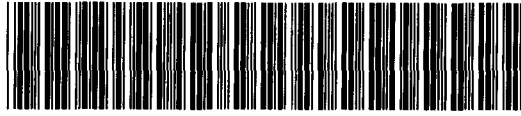

41P15NE0015 W9680.00565 CAIRO

900

filling assessment work or consult the Mining

Instructions

- A separate copy of this form must be completed for each Work Group.
- Technical reports and maps must accompany this form in duplicate.
- A sketch, showing the claims the work is assigned to, must accompany this form.

153728

302647

Recorded Holder(s) GARY DOUGLAS KOSY & CROWLEY GROUNDWATER LIMITED	Claim No.
Address 2 Hilltop Dr. CHARLOTTE-HUGHES, ON POK 1A0	Telephone No. 705-567-3909
Mining Division LARDER LAKE	City or Town DUNDAS, ON L9H 4R6
Work Performed From JUNE 14, 1996	To SEPT. 17, 1996

Work Performed (Check One Work Group Only)

EXPLORATION

Work Group	REPORT - ATTACHED
Geotechnical Survey	
Physical Work, including Drilling	ROAD BUILDING, TRENCHING, SAMPLING
Rehabilitation	FIXED CLAIM BOUNDARIES <i>JDC</i>
Other Authorized Work	NTI
As per Assignment from Reserve	AS PER REPORT OF IAN D. WILSON

Assessment Work Claimed on the Attached Statement of Costs \$ *505,100* 39,621.00

Note: The Minister may reject for assessment work credit all or part of the assessment work submitted if the recorded holder cannot verify expenditures claimed in the statement of costs within 30 days of a request for verification.

Persons and Survey Company Who Performed the Work (Give Name and Address of Author of Report)

Name	Address
Ian D. Wilson Associates Ltd	Hwy 19 North, R.R. #1 Stratford, Ont. N5A 6S2- AUTHOR
A. Dale Well & Pump Service Ltd.	832 Westminster Dr. London, Ont. N6H 1M1
Crowley Groundwater Limited	2 Bertram Dr. Dundas, Ont. L9H 4P6

(attach a schedule if necessary)

Verification of Beneficial Interest - See Note No. 1 on reverse side

certify that at the time the work was performed, the claims covered in this work report were recorded in the current holder's name or held under a beneficial interest of the current recorded holder.

Date: *Oct 30 / 96* Signature: *[Signature]*

Verification of Work Report

certify that I have a personal knowledge of the facts set forth in this Work report, having performed the work or witnessed such during and/or after a completion and annexed report is true.

Name and Address of Person Certifying: **J. David Crowley, President**

Name and Address of Person Recording: **Crowley Groundwater Limited, 2 Bertram Dr. Dundas, Ont. L9H 4P6**

Date: **October 30, 1996**

Office Use Only

Original Value of Recorded Claim <i>\$11,200</i>	Date Recorded <i>Nov. 4/96</i>	Mining Recorder <i>[Signature]</i>	Received Stamp RECEIVED MINING DIVISION FAXED NOV 2 1996 <i>Received Nov 4 / 96</i>
Reserve <i>29905</i>	Date Notice for Amendment Sent <i>97 Jan 30</i>	Date Approved <i>97 March 14</i>	

Revised All March 16 1997

JULEY GROUNDWATER LIMITED

PHONE No. : 1 905 6272929

Nov. 25 1996 1:23PM P03

*2nd amended
w/ 100% copy*

Claim No.	Claim Description	Amount	Date	Priority	Remarks
1					
2					
3					
4					
5					
6					
7					
8					
9					
10					
11					
12					
13					
14					
15					
16					
17					
18					
19					
20					
21					
22					
23					
24					
25					
26					
27					
28					
29					
30					
31					
32					
33					
34					
35					
36					
37					
38					
39					
40					
41					
42					
43					
44					
45					
46					
47					
48					
49					
50					
51					
52					
53					
54					
55					
56					
57					
58					
59					
60					
61					
62					
63					
64					
65					
66					
67					
68					
69					
70					
71					
72					
73					
74					
75					
76					
77					
78					
79					
80					
81					
82					
83					
84					
85					
86					
87					
88					
89					
90					
91					
92					
93					
94					
95					
96					
97					
98					
99					
100					

Claims you are claiming in this report may be out back, in order to minimize the adverse effects of such deletions, please indicate from which claims you wish to prioritize the deletion of credits. Please mark (✓) one of the following:

- Credits are to be set back starting with the claim listed last, working backwards.
- Credits are to be set back equally over all claims contained in the report of work.
- Credits are to be set back as prioritized on the attached spreadsheet.

In the event that you have not specified your choice of priority, option one will be implemented.

Note 1: Examples of beneficial interests are unrecorded transfers, option agreements, memoranda of understandings, etc., with respect to the mining claims.

Note 2: If work has been performed on patented or leased land, please complete the following:

I certify that the recorded folder had a beneficial interest in the patented or leased land at the time the work was performed.

SIGNATURE

DATE

WEBB LAKE

Personal information collected on this form is obtained under the authority of subsection 6(1) of the Assessment Work Regulation 6/96. Under section 6 of the Mining Act, the information is a public record. This information will be used to review the assessment work and correspond with the mining land holder. Questions about this collection should be directed to the Chief Mining Recorder, Ministry of Northern Development and Mines, 6th Floor, 933 Ramsey Lake Road, Sudbury, Ontario, P3E 8B5.

Claim #1202490 - 4 Units

Work Type	Units of Work <small>Depending on the type of work, list the number of hours/days worked, metres of drilling, kilometres of grid line, number of samples, etc.</small>	Cost Per Unit	Total Cost
See attached Invoice of	A. Dale Well & Pump Service Ltd		\$12,553.70
See attached Invoice of	Ian D. Wilson Associates Ltd.		\$13,744.20
See attached Invoice of	Crowley Groundwater Ltd.		\$13,323.54
Associated Costs (e.g. supplies, mobilization and demobilization).			
as per attached invoices			
Transportation Costs			
as per attached invoices			
Food and Lodging Costs			
as per attached invoices & Summary of Visa statements			
Total Value of Assessment Work			\$39,621.44

Calculations of Filing Discounts:

1. Work filed within two years of performance is claimed at 100% of the above Total Value of Assessment Work.
2. If work is filed after two years and up to five years after performance, it can only be claimed at 50% of the Total Value of Assessment Work. If this situation applies to your claims, use the calculation below:

TOTAL VALUE OF ASSESSMENT WORK x 0.50 = Total \$ value of worked claimed.

Note:

- Work older than 5 years is not eligible for credit.
- A recorded holder may be required to verify expenditures claimed in this statement of costs within 45 days of a request for verification and/or correction/clarification. If verification and/or correction/clarification is not made, the Minister may reject all or part of the assessment work submitted.

Certification verifying costs:

J.D. Crowley, President
 I, Crowley Groundwater Ltd. (please print full name), do hereby certify, that the amounts shown are as accurate as may reasonably be determined and the costs were incurred while conducting assessment work on the lands indicated on the accompanying Declaration of Work form as Gary D. Kosy & Crowley Groundwater Ltd. I am authorized (recorded holder, agent, or state company position with signing authority) to make this certification, & to bind the Company

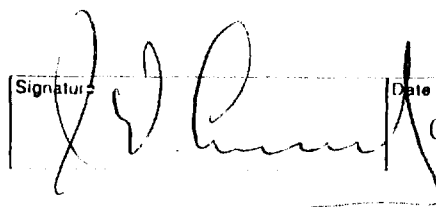
Signature:  Date: October 30, 1996



IAN D. WILSON ASSOCIATES LIMITED

CONSULTING HYDROGEOLOGISTS, GEOLOGISTS & ENGINEERS

March 12, 1997

Ms. Frances Haskins
Mining Recorder's Office
Ministry of Northern Development & Mines
Larder Lake Division
4 Government Road East
Kirkland Lake, Ontario
P2N 1A2

Dear Ms. Haskins:

Re: Assessment Drawings
Claims 1202490, 1202488 and 1202489.
Cairo Township.

Further to your faxes of March 10 and 11, 1997 regarding the assessment drawings which accompanied reports on Claims 1202490, 1202488 and 1202489. enclosed are replacement drawings which, we hope, are now acceptable. Please include these with our reports and discard the old drawings.

With regards to the Browning Lake claims (1202488 and 1202489), the only rock type seen was barren syenite with a quartz vein showing mineralization (pyrite and chalcopyrite) located at the site of the east trench. No visible mineralization was seen at the sites of the island trenches and the drawing is, therefore, simple. In the case of the Webb Lake claim (1202490), sulphide (largely pyrite) mineralization was common throughout but no economic values were seen in trenches during the 1996 field season.

The sample locations are shown at the bottoms of the drawings so that they can be easily read rather than clutter up the drawings. I hope this is acceptable.

Please let me know, if you have any questions.

Yours sincerely
IAN D. WILSON ASSOCIATES LIMITED

Ian D. Wilson, P.Eng.
IW/hb
encls.

2:30

Page #1

Big Pinekey
 FL USA 33043
 Box 431876
 Fax 1-305-872-3077
 Phone 1-305-872-0229

Fax To 1-705-567-5621

Lardet Lake Mining Division

Mining Records Office

A.H. Ms. Francis Hastings

Re Mining Claim L1202490 Coito Twp.

Francis Page #~~3~~³ & #~~4~~⁴ of this box are the amended
 Report of work conducted on this claim. The following
 information is as requested.

liter #3, Type of Eqp. - Power master Ford Tractor
 with Black Hawk Half Tracks (20") with Davis Backhoe
 Digging to 8' deep. Stillh. mod. #350 power saw with
 12" Dia. Diamond Blade 2 - 20" chain saws 3 ATV's
 mts. pumps (3) 1-500watt generator miss power tools & hand tools
 G.P.S. Unit. 2 trucks 1-Box Trailer & 1-Goose Neck Trailer

Questions Re Detailed map etc have been sent to our
 consultant Tom D. Wilson & Associates and he will send
 new maps direct to you.

\$116,00 have been deducted from work report & initial of signed

Re Stripping & Road. Bldg. Trails to these claims had been overgrown
 some brush was 2' in dia. All brush was cleared 10'-15' wide as
 was all mineral showings. Trenches were dug to bed rock. 2'-3' wide
 and samples were taken as indicated in Wilson report by diamond saw

Page #2.

Claim # L1202490 Cairo Trip.

Would you please let me know by fax if the information provided meets your requirements

Jan D Wilson will return from South Africa on Feb 17 and I will see that the new maps are provided as soon as possible. When we become more aware of your requirements I am sure that you will find all our work in order.

Yours Truly
J.W. Crawley President
Crawley Groundwater Limited.

REFERENCES

AREAS WITHDRAWN FROM DISPOSITION

- M.R.O. - MINING RIGHTS ONLY
- S.R.O. - SURFACE RIGHTS ONLY
- M.+S. - MINING AND SURFACE RIGHTS

Description	Order No.	Date	Disposition	File
(R) 566, 567, 568	NRW 65/83	Nov. 16, 1983	M.R.	1989

(R) MINING & SURFACE RIGHTS REOPENED TO PROSPECTING, SALE OR LEASE. ORDER O-L-10/95, PREVIOUSLY WITHDRAWN UNDER ORDER W 65/83.

(R2) Mining and Surface Rights Withdrawn Order No. W-L-17/95 Dated March 30, 1995. Previously withdrawn under Order NWR 65/83.

THE INFORMATION THAT APPEARS ON THIS MAP HAS BEEN COMPILED FROM VARIOUS SOURCES, AND ACCURACY IS NOT GUARANTEED. THOSE WISHING TO STAKE MINING CLAIMS SHOULD CONSULT WITH THE MINING RECORDER, MINISTRY OF NORTHERN DEVELOPMENT AND MINES FOR ADDITIONAL INFORMATION ON THE STATUS OF THE LANDS SHOWN HEREON.

NOTES

LP - LAND USE PERMIT

NOTICE OF FORESTRY ACTIVITY

THIS TOWNSHIP / AREA FALLS WITHIN THE PLONSKI FOREST MANAGEMENT UNIT AND MAY BE SUBJECT TO FORESTRY OPERATIONS. THE MNR UNIT FORESTER FOR THIS AREA CAN BE CONTACTED AT: P.O. BOX 129 SWASTIKA, ONT. POK ITO 705-642-3222

Alma Twp.

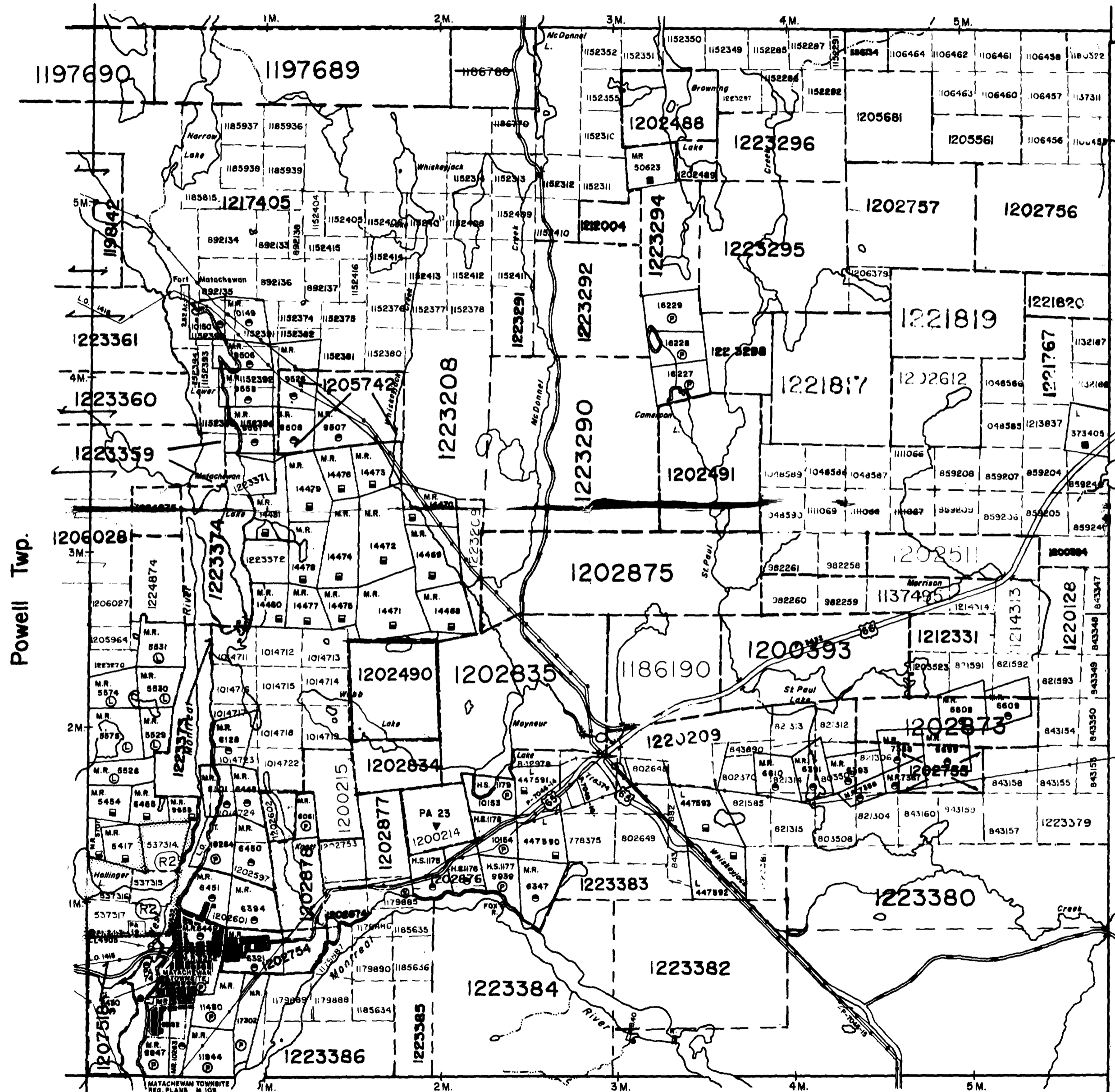

Kimberley Twp.

LEGEND

- HIGHWAY AND ROUTE No.
- OTHER ROADS
- TRAILS
- SURVEYED LINES
- TOWNSHIPS, BASE LINES ETC.
- LOTS, MINING CLAIMS, PARCELS, ETC.
- UNSURVEYED LINES
- LOT LINES
- PARCEL BOUNDARY
- MINING CLAIMS ETC.
- RAILWAY AND RIGHT OF WAY
- UTILITY LINES
- NON-PERENNIAL STREAM
- FLOODING OR FLOODING RIGHTS
- SUBDIVISION OR COMPOSITE PLAN
- RESERVATIONS
- ORIGINAL SHORELINE
- MARSH OR MUSKEG
- MINES
- TRAVERSE MONUMENT

DISPOSITION OF CROWN LANDS

TYPE OF DOCUMENT	SYMBOL
PATENT, SURFACE & MINING RIGHTS	
" SURFACE RIGHTS ONLY	
" MINING RIGHTS ONLY	
LEASE, SURFACE & MINING RIGHTS	
" SURFACE RIGHTS ONLY	
" MINING RIGHTS ONLY	
LICENCE OF OCCUPATION	L.O. or
ORDER-IN-COUNCIL	OC
RESERVATION	
CANCELLED	
SAND & GRAVEL	

NOTE: MINING RIGHTS IN PARCELS PATENTED PRIOR TO MAY 6, 1913, VESTED IN ORIGINAL PATENTEES BY THE PUBLIC LANDS ACT, R.S.O. 1970 CHAP. 380, SEC. 63, SUBSEC. 1.

SCALE: 1 INCH = 40 CHAINS

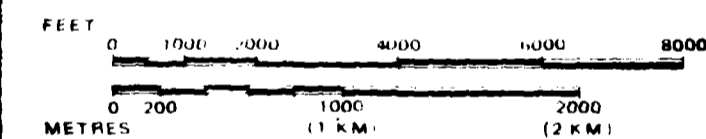

DOCUMENT No. W 00565
 TOWNSHIP prnch
CAIRO
 M.N.R. ADMINISTRATIVE DISTRICT
 KIRKLAND LAKE
 MINING DIVISION
 LARDER LAKE
 LAND TITLES / REGISTRY DIVISION
 TIMISKAMING

DATE OF ISSUE: FEB 13 1997
 LARDER LAKE MINING RECORDER'S OFFICE

Ministry of Natural Resources
 Ministry of Northern Development and Mines

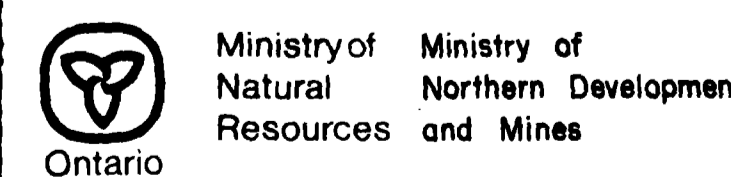

Date: JULY 1986
 Number: G-3209

ARCHIVED JAN 2/97

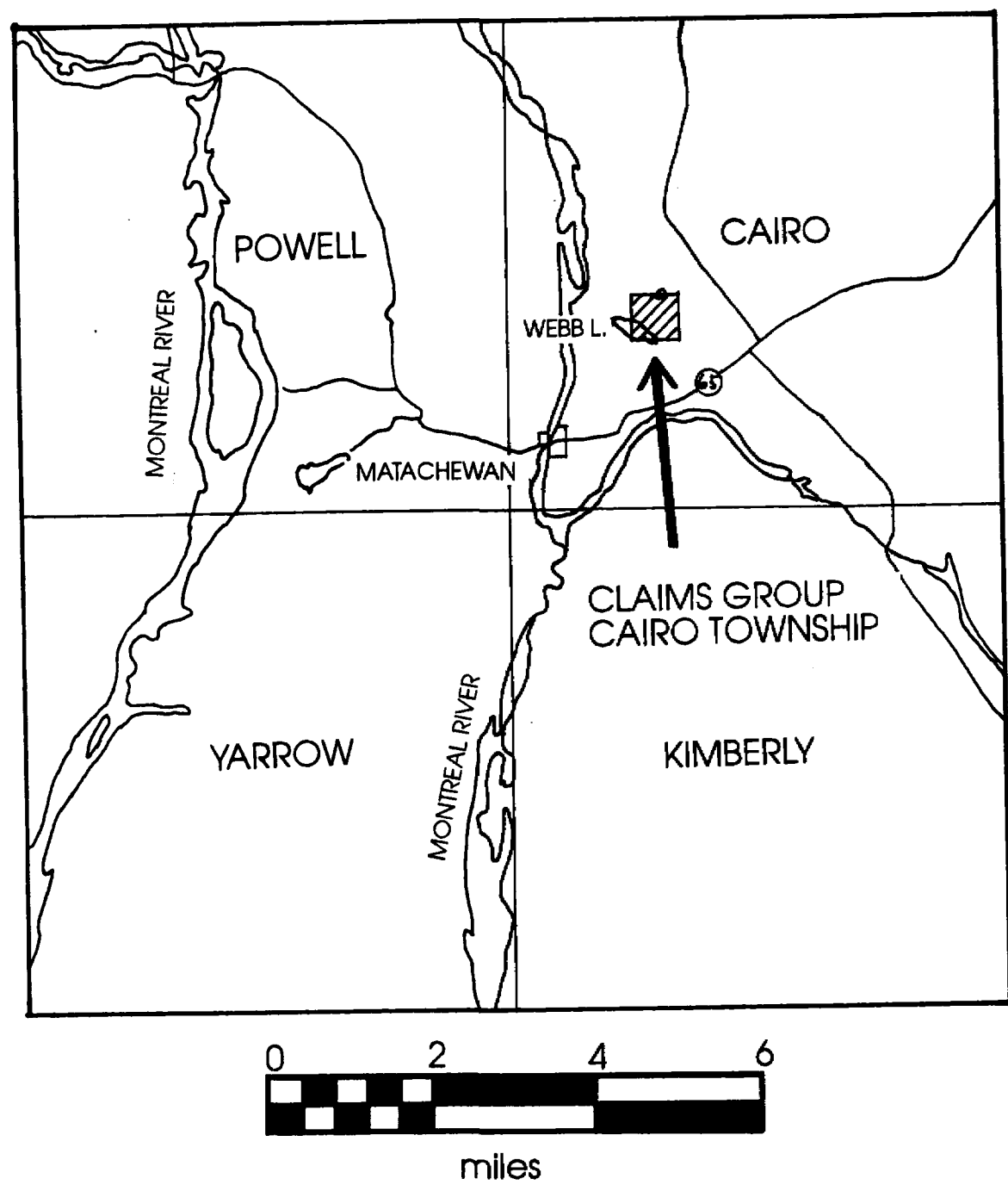
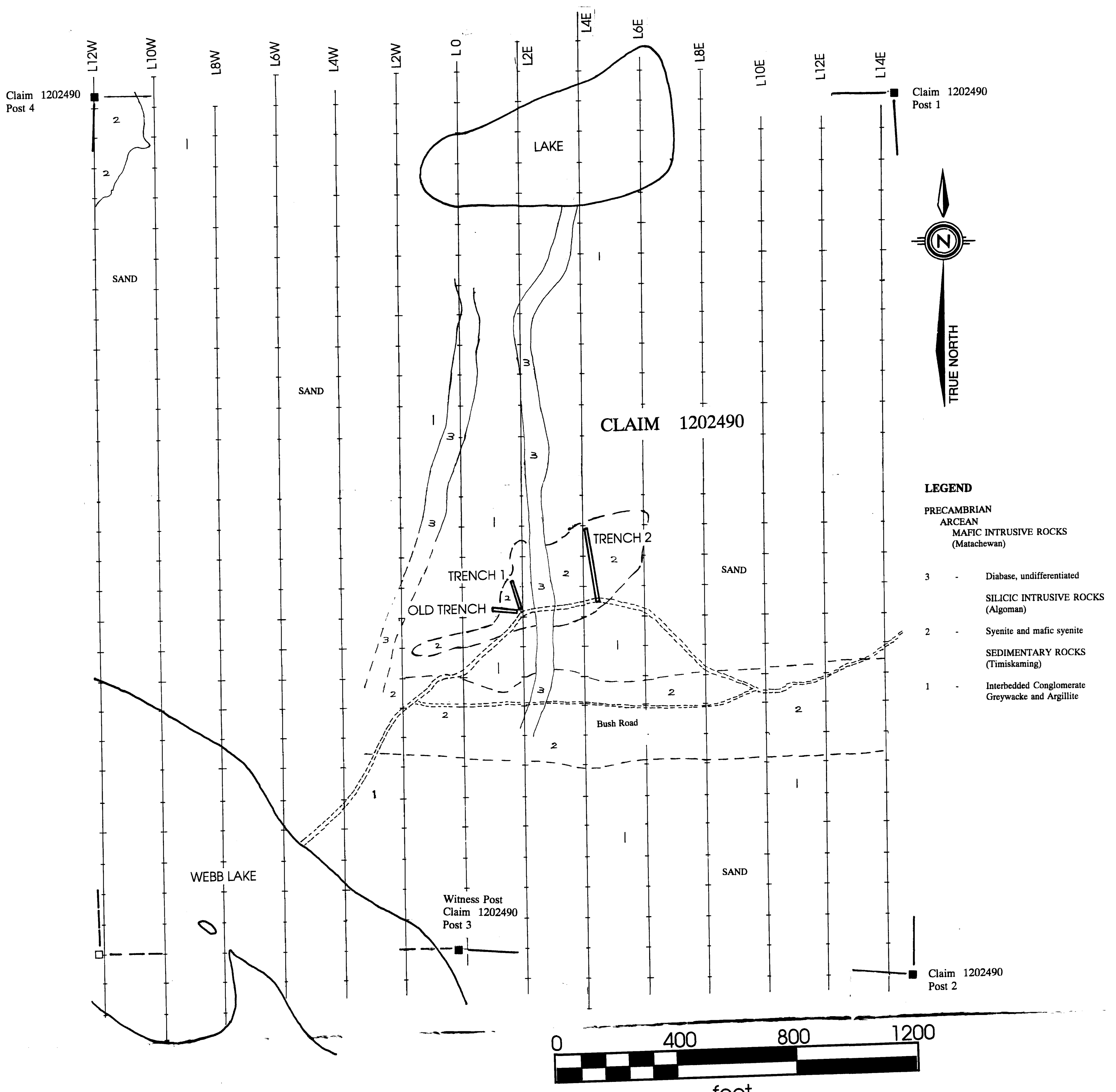

IAN D. WILSON ASSOCIATES LIMITED

LOCATIONS OF
1996 TRENCHES
G. KOSY CLAIMS
LARDER LAKE MINING DIVISION
ONTARIO

FEB./97

SCALE 1"=200' (1 : 2400) FIGURE 3

