

41P15NE0022 2.17201 POWELL

010

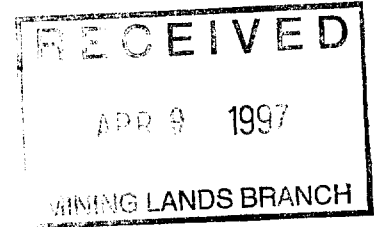

Hawley Lake

Trenching Program

Powell Twp.

Map G32-18

Lat. 80d 40' W Long. 47d 58' N

NTS

41 P/15

42 A/2

2.17201



41P15NE0022 2.17201 POWELL

010C

Table of Contents

Summary	Page:1
Location and Access	Page:1
Regional Geology	Page:1
Property Geology	Page:1
Trenching Program	Page:2
Results and Recommendations	Page:3

Summary:

A trenching program was started on the 18th March, 1997 to evaluate a historic gold showing on claim MR8107 in Powell Township.

A group known as the Peters Syndicate sunk a shaft to the depth of 28ft. into a porphyry body with quartz veins. The shaft is on claim MR8107 on the east shore of Hawley Lake.

The work was done around 1935 and gold values as high as 0.7oz/ton were reported.

Location and Access:

The property is situated 3 km west of Matachewan on highway 565. At the site of the Extender Borite Mill, there is a bush road on the north side of highway 565. This road heads north for 2.5 km and touches the southeast corner of Hawley Lake, which is the south boundary of the claim group.

Regional Geology:

The Matachewan camp is located in an area with a complex structural and intrusive history. The camp is bounded by the Montreal River - Narrow Lake Fault and the Mistinikon Lake Faults to the east and west respectively, and is likely related to the western extension of the Kirkland Lake - Larder Lake Break. In Powell Township, tight folding appears to have repeated a succession of Volcanic and Timiskaming - type sedimentary rocks along an east - west axis.

This steeply dipping sequence is intruded by a large number of dikes, sills and stocks of felsic to intermediate composition. A swarm of later "Matachewan" diabase dikes follow north trending fracture zones. In the southern portion of Powell Township and the majority of Bannockburn Township, a volcano - sedimentary sequence is unconformably overlain by flat lying Cobalt Group. Gold mineralization is related to quartz - carbonate vein systems which crosscut syenite and carbonized volcanic and sedimentary rocks. (Lovell, 1967)

Property Geology:

Outcrop on the claim group appears to be very sparse. Hawley Lake is situated in the center of the 17 claims. The east shore of Hawley Lake appears to be a large syenite porphyry body, while the north end of the claim group was mapped as Timiskaming Sediment by Lovell, 1967.

A large Matachewan diabase strikes north - south near the east side of the claim group.

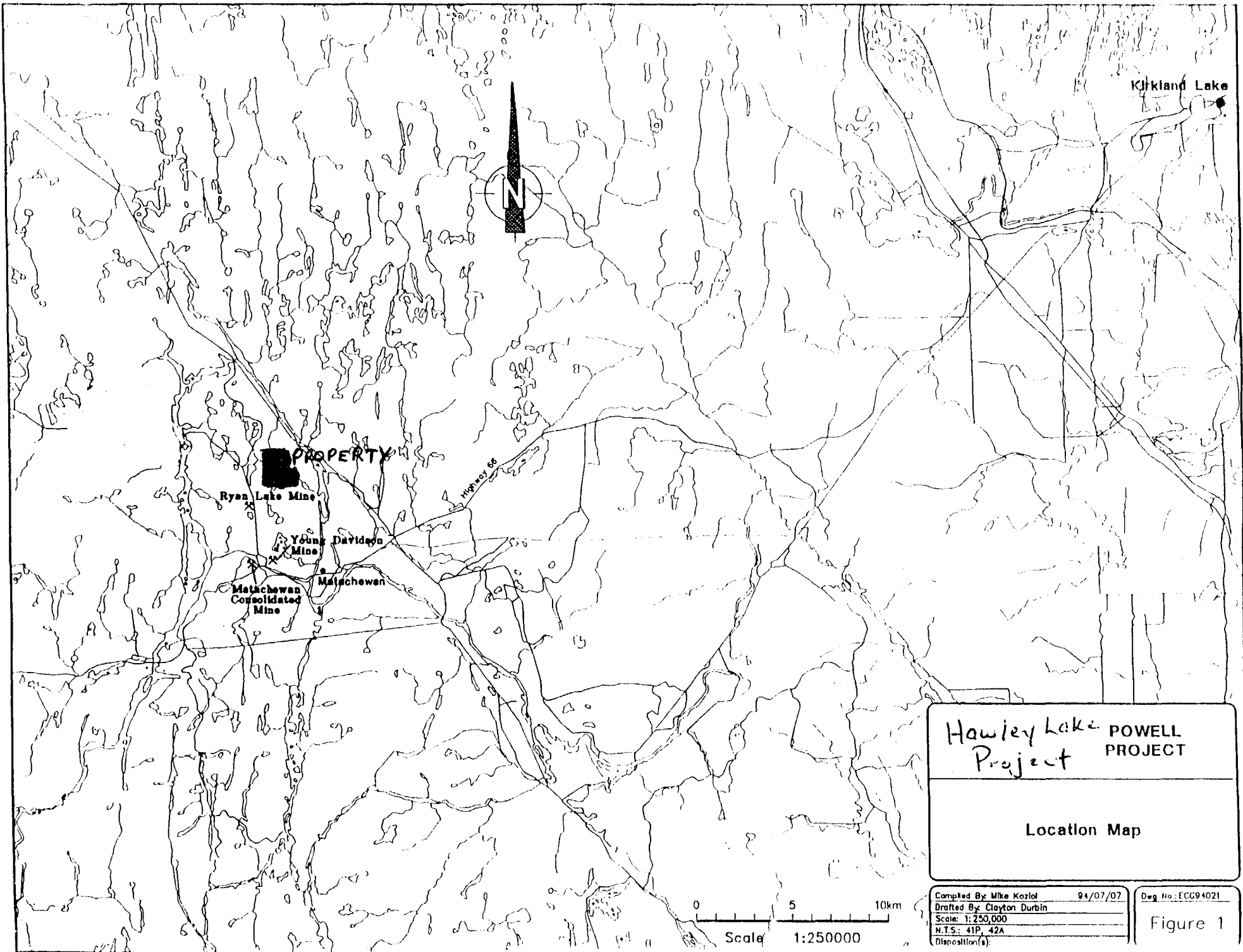

Hawley Lake POWELL
Project PROJECT

Location Map

Figure 1

POWELL

TWP.



Marachewan

Lake

6

10

10

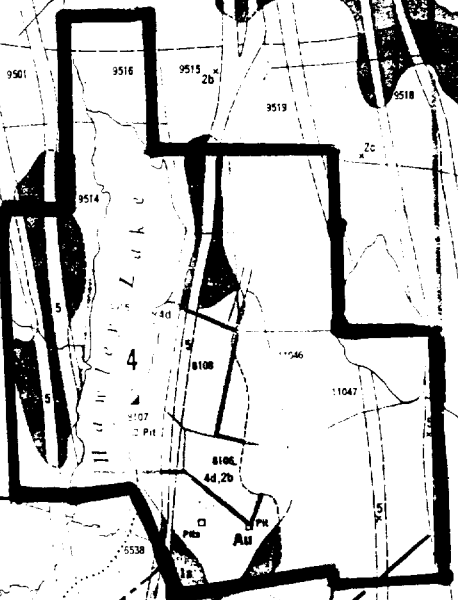

Lug Lake

Hawley Lake

Little 8 Hawley Lake

7

Ryan Lake

Hawley Lake Group

9

3

19

Onsey Lake

Shaft No. 2

No. 1 AU

card

Ray

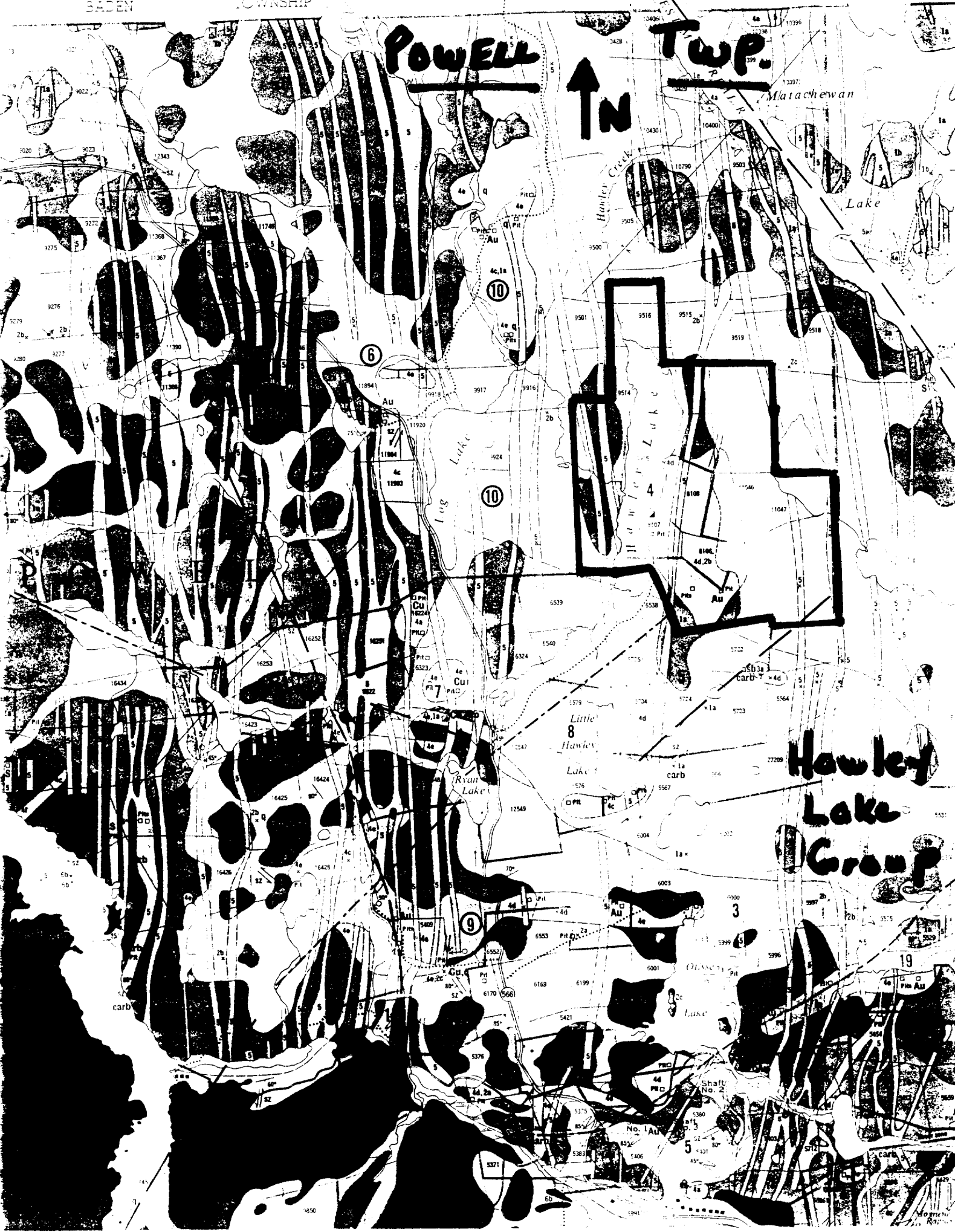

Trenching Program:

On March 18, 1997 a Link Belt Excavator started trenching on claim MR8107 on the east shore of Hawley Lake beside an old shaft put down in the early thirties.

The purpose of the trenching was to evaluate the historic gold showings and the old pits dug by hand.

All trenches were dug west to east as it is thought that the structures run north to south.

Trench A

Trench A is located in the northeast corner of claim MR8107 and consists mainly of porphyry, quartz veins and shearing. The old shaft is on the north side of the new trenching.

Trench B

Trench B starts in the northeast corner of MR9915 and heads east into the northwest corner of MR8108. The start of the trench consists of sheared porphyry for about 20ft., then runs into a small diabase that is about 10ft. wide and the remainder of the trench is in highly sheared barren sediments.

Trench C

Trench C also starts in the northeast corner of MR9915 and heads east into the northwest corner of MR8108. Most of the trench was in diabase so digging was stopped

Trench D

Trench D is about 100ft. east of trench C. This trench started in the sheared barren sediments and ended in diabase further to the east end of the trench.

Trench E

Trench E is located on claim MR8107 and is south of trench A by 100ft. The geology in this trench consists of sheared porphyry and sediments.

Results and Recommendations:

All trenching was successful in that the trenches reached bedrock. The most favourable geology that could host a concentration of gold appears to be around the shaft area, which consists of porphyry, quartz veins and shearing.

Follow up work consisting of washing trenches, mapping, and sampling would better help understand the geology in the shaft area.

This work should start as soon as the weather conditions in the spring allow it.

Powell Twp



*Trenching
around
old shaft*

127444

CAIRO TOWNSHIP

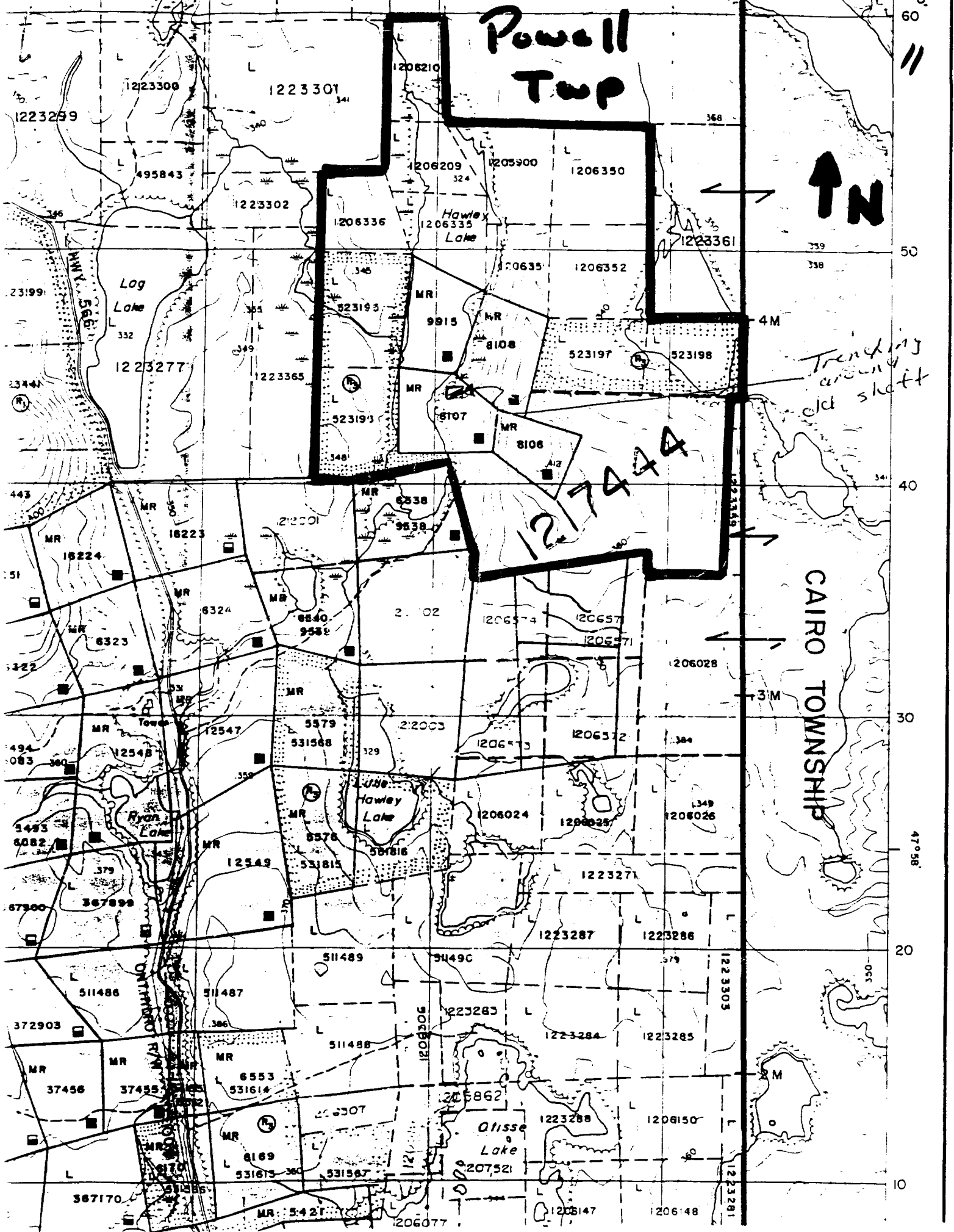

60
50
40
30
20
10

Equipment for trenching.

LINK BELT EXCAVATOR.
March 18/97 9 hr.
19 9 hr.
20 5 hr.
21 9 hr.

32 hr. @ \$80.00 hr,
includes operator.

Fred Kiemille \$250.00 day x 4 days.
Project Supervision

Dennis George Sr.
Dennis George Jr.
Raymond Bisson

> 4 days x \$125.00 day
manual trenching
March 18/ to 21/ 97.



Declaration of Assessment Work Performed on Mining Land

Mining Act, Subsection 65(2) and 66(3), R.S.O. 1990

Transaction Number (office use)
19790.00253
Assessment Files Research Imaging

Personal information c Mining Act, the inform: Questions about this 933 Ramsey Lake Ro:



41P15NE0022 2.17201 POWELL

900

66(3) of the Mining Act. Under section 8 of the ork and correspond with the mining land holder. Northern Development and Mines, 6th Floor.

2.17201

Instructions: - F use form 0240. - Please type or print in ink.

1. Recorded holder(s) (Attach a list if necessary)

Name: ROBERT PETERS (lessee) Client Number: 300771
Address: RR#2 P.O. Box 301 (90%) Telephone Number: 519-586-3779
SIMCOE, ONT. N3Y 4K2 Fax Number:
Name: MRS. JUTTA FULFORD Client Number:
Address: 468 HILCREST RD. (10%) Telephone Number:
Elizabethtown, Ont. K6V 7C3 Fax Number:

2. Type of work performed: Check (✓) and report on only ONE of the following groups for this declaration.

- Geotechnical: prospecting, surveys, assays and work under section 18 (regs)
Physical: drilling, stripping, trenching and associated assays
Rehabilitation

Work Type: Trenching - LinkBelt Excavator + Manual cleaning of trenches
Office Use:
Commodity:
Total \$ Value of Work Claimed: 245
Dates Work Performed: From 18 03 97 To 21 03 97
Global Positioning System Data (if available):
Township/Area: Powell Twp.
M or G-Plan Number: G 32-18
Mining Division: Kirkland Lake
Resident Geologist District: Kirkland Lake

- Please remember to: - obtain a work permit from the Ministry of Natural Resources as required;
- provide proper notice to surface rights holders before starting work;
- complete and attach a Statement of Costs, form 0212;
- provide a map showing contiguous mining lands that are linked for assigning work;
- include two copies of your technical report.

3. Person or companies who prepared the technical report (Attach a list if necessary)

Name: FRED KIERNICKI Telephone Number: 705-567-4858
Address: Box 1143 KIRKLAND LAKE Fax Number: same as above
Name: ONT. P2N-3M7 Telephone Number:
Address: Fax Number:
Name: Telephone Number:
Address: Fax Number:
RECEIVED APR 9 1997 MINING LANDS BRANCH
RECEIVED APR 11 1997 MINING DIVISION

4. Certification by Recorded Holder or Agent

I, FRED KIERNICKI, do hereby certify that I have personal knowledge of the facts set forth in this Declaration of Assessment Work having caused the work to be performed or witnessed the same during or after its completion and, to the best of my knowledge, the annexed report is true.

Signature of Recorded Holder or Agent: Fred Kiernicki Date: March 29/97
Agent's Address: Box 1143 KIRKLAND LAKE, ONT. Telephone Number: 705-567-4858 Fax Number: Same
P2N-3M7

5. Work to be recorded and distributed. Work can only be assigned to claims that are contiguous (adjacent) to the mining land where work was performed, at the time work was performed. A map showing the contiguous claims must accompany this form.

W9780.00253

ACTION # W

Mining Claim Number. Or if work was done on other eligible mining land, show in this column the location number indicated on the claim map.	Number of Claim Units. For other mining land, list hectares.	Value of work performed on this claim or other mining land.	Value of work applied to this claim.	Value of work assigned to other mining claims.	Bank. Value of to be distributed at a future date.
eg TB 7827	16 ha	\$26,825	N/A	\$24,000	\$2,825
eg 1234567	12	0	\$24,000	0	0
eg 1234568	2	\$8,892	\$4,000	0	\$4,892
30006501 ✓ (48393) MR 9915	12.262	1548.		1548.-	
3000652 31 (18054) MR 8107	12.950	2669.-		2669.-	
3000653 4 ✓ (18053) MR 8108	13.395	2028.-		2028.-	
✓ 5 1206350			780.-		
✓ 6 1205900			780.-		
✓ 7 1206351			780.-		
✓ 8 1206352			780.-		
✓ 9 1206335			780.-		
✓ 10 1206336			780.-		
✓ 11 1206209			780.-		
✓ 12 1206210			785.-		
13					
14					
15					
Column Totals		6245. ⁰⁰	6245.-	6245.-	

I, FRED KIERNICKI, do hereby certify that the above work credits are eligible under subsection 7 (1) of the Assessment Work Regulation 6/96 for assignment to contiguous claims or for application to the claim where the work was done.

Signature of Recorded Holder or Agent Authorized in Writing

Fred Kiernicki

Date

March 29/97

6. Instructions for cutting back credits that are not approved.

Some of the credits claimed in this declaration may be cut back. Please check (✓) in the boxes below to show how you wish to prioritize the deletion of credits:

- 1. Credits are to be cut back from the Bank first, followed by option 2 or 3 or 4 as indicated.
- 2. Credits are to be cut back starting with the claims listed last, working backwards; or
- 3. Credits are to be cut back equally over all claims listed in this declaration; or
- 4. Credits are to be cut back as prioritized on the attached appendix or as follows (describe):

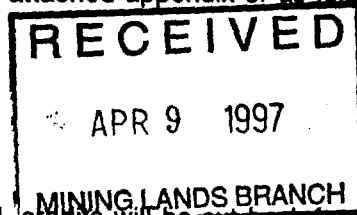

Note: If you have not indicated how your credits are to be deleted, credits will be cut back from the Bank first, followed by option number 2 if necessary.

For Office Use Only

Received Stamp



97 APR 1 10 11 16

Deemed Approved Date

June 29/97

Date Notification Sent

Date Approved

Total Value of Credit Approved

Approved for Recording by Mining Recorder (Signature)

Personal information collected on this form is obtained under the authority of subsection 6(1) of the Assessment Work Regulation 6/96. Under section 8 of the Mining Act, the information is a public record. This information will be used to review the assessment work and correspond with the mining land holder. Questions about this collection should be directed to the Chief Mining Recorder, Ministry of Northern Development and Mines, 6th Floor, 933 Ramsey Lake Road, Sudbury, Ontario, P3E 6B5.

2.17201

Work Type	Units of Work <small>Depending on the type of work, list the number of hours/days worked, metres of drilling, kilometres of grid line, number of samples, etc.</small>	Cost Per Unit of work	Total Cost
Trenching Backhoe	32 hr @ \$80.00/hr.		\$2560.00
Backhoe Supervisor	4 days	250/day	1000.-
Reports	1 day	250/day	250.-
Manual Trenching	3 men x 4 days	125.00/day	\$1500.-
Associated Costs (e.g. supplies, mobilization and demobilization).			
Floot machine	6 hr x \$70.00/hr.		\$420.00
Reports & Maps	\$25.00/hr.		200.00
Transportation Costs			
Truck Rental	\$50/day x 5 days		250.00
Food and Lodging Costs			
GROCERIES			\$65.00

Total Value of Assessment Work RECEIVED 245.00

RECEIVED
 APR 9 1997
 MINING LANDS BRANCH

Calculations of Filing Discounts:

1. Work filed within two years of performance is claimed at 100% of the above Total Value of Assessment Work.
2. If work is filed after two years and up to five years after performance, it can only be claimed at 50% of the Total Value of Assessment Work. If this situation applies to your claims, use the calculation below:

TOTAL VALUE OF ASSESSMENT WORK × 0.50 = Total \$ value of worked claimed.

Note:

- Work older than 5 years is not eligible for credit.
- A recorded holder may be required to verify expenditures claimed in this statement of costs within 45 days of a request for verification and/or correction/clarification. If verification and/or correction/clarification is not made, the Minister may reject all or part of the assessment work submitted.

Certification verifying costs:

I, FRED KIERNICKI (please print full name), do hereby certify, that the amounts shown are as accurate as may reasonably be determined and the costs were incurred while conducting assessment work on the lands indicated on the accompanying Declaration of Work form as AGENT I am authorized (recorded holder, agent, or state company position with signing authority) to make this certification.

Signature: Fred Kiernicki Date: April 29/97

Ministry of
Northern Development
and Mines

Ministère du
Développement du Nord
et des Mines



Geoscience Assessment Office
933 Ramsey Lake Road
6th Floor
Sudbury, Ontario
P3E 6B5

July 7, 1997

Roy Spooner
Mining Recorder
4 Government Road East
Kirkland Lake, ON
P2N 1A2

Telephone: (705) 670-5853
Fax: (705) 670-5863

Dear Sir or Madam:

Submission Number: 2.17201

Status

Subject: Transaction Number(s): W9780.00253 Approval After Notice

We have reviewed your Assessment Work submission with the above noted Transaction Number(s). The attached summary page(s) indicate the results of the review. WE RECOMMEND YOU READ THIS SUMMARY FOR THE DETAILS PERTAINING TO YOUR ASSESSMENT WORK.

If the status for a transaction is a 45 Day Notice, the summary will outline the reasons for the notice, and any steps you can take to remedy deficiencies. The 90-day deemed approval provision, subsection 6(7) of the Assessment Work Regulation, will no longer be in effect for assessment work which has received a 45 Day Notice.

Please note any revisions must be submitted in DUPLICATE to the Geoscience Assessment Office, by the response date on the summary.

NOTE: This correspondence may affect the status of your mining lands. Please contact the Mining Recorder to determine the available options and the status of your claims.

If you have any questions regarding this correspondence, please contact Lucille Jerome by e-mail at jerome_l@torv05.ndm.gov.on.ca or by telephone at (705) 670-5858.

Yours sincerely,

A handwritten signature in black ink, appearing to read "Ron C. Gashinski".

ORIGINAL SIGNED BY
Ron C. Gashinski
Senior Manager, Mining Lands Section
Mines and Minerals Division

Work Report Assessment Results

Submission Number: 2.17201

Date Correspondence Sent: July 07, 1997

Assessor: Lucille Jerome

Transaction Number	First Claim Number	Township(s) / Area(s)	Status	Approval Date
W9780.00253	18393	POWELL	Approval After Notice	July 07, 1997

Section:

10 Physical PMAN
10 Physical PMECH

Correspondence to:

Mining Recorder
Kirkland Lake, ON

Resident Geologist
Kirkland Lake, ON

Assessment Files Library
Sudbury, ON

Recorded Holder(s) and/or Agent(s):

FRED JR. KIERNICKI
KIRKLAND LAKE, ONTARIO, CANADA

ROBERT PALMERSTON PETERS
SIMCOE, ONTARIO

35936

Dennis George
Box 69 Matochewan, Ont.
705-565-2384

Recorded Holder
Powell Twp.

- 120 5900
- 120 6350
- 120 6351
- 120 6352

E.172ⁿ1

(108717)

Raymond Bisson
Box 55 Matochewan, Ont.
705-565-2417

Recorded Holder
Powell Twp.

- 120 6335
- 120 6336
- 120 6209
- 120 6210

RECEIVED
APR 9 1997
MINING LANDS BRANCH

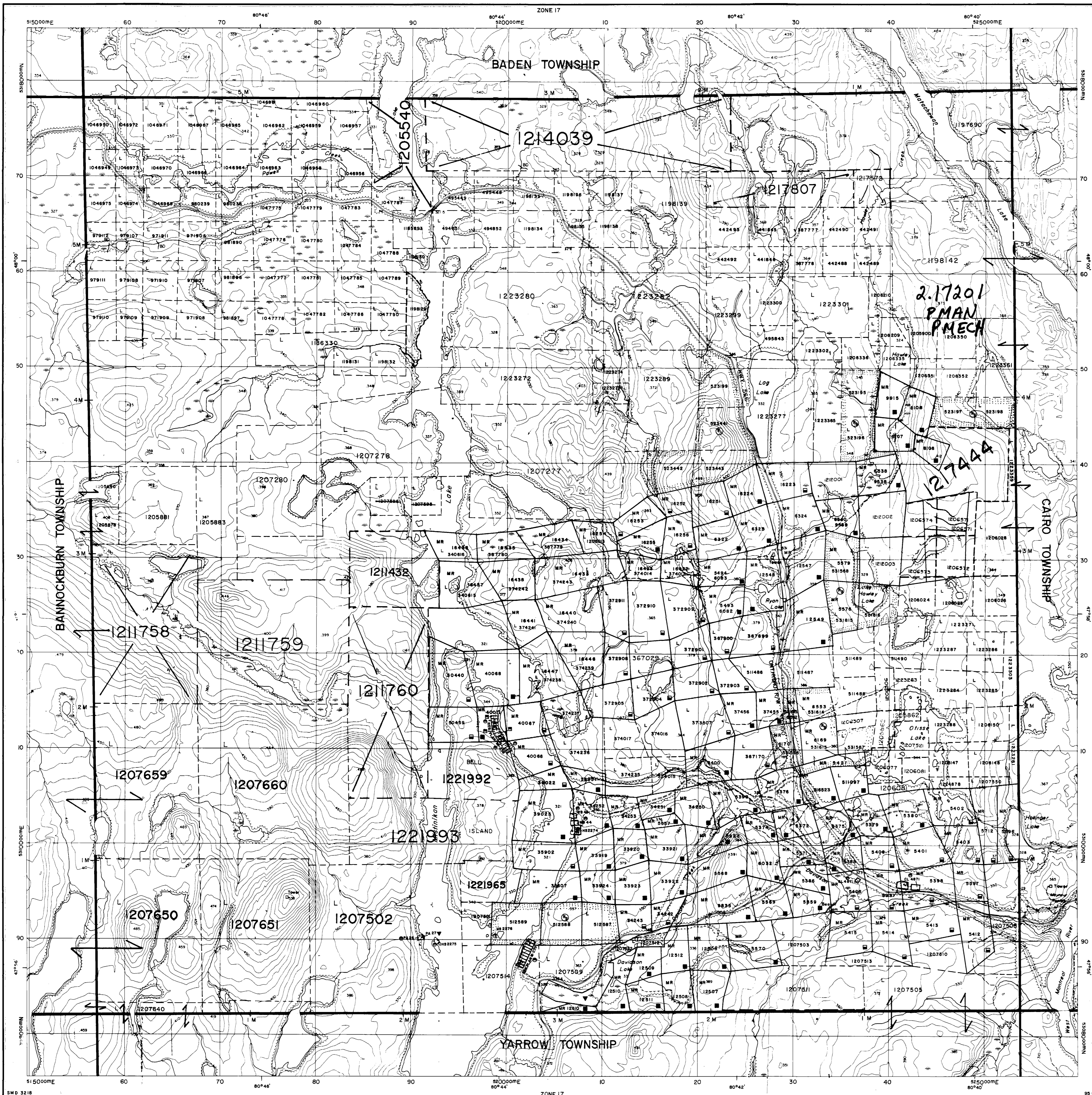

INDEX TO LAND DISPOSITION

PLAN
10321-C
TOWNSHIP
POWELL

M.N.R. ADMINISTRATIVE DISTRICT
KIRKLAND LAKE
MINING DIVISION
LARDER LAKE
LAND TITLES/REGISTRY DIVISION
TIMISKAMING

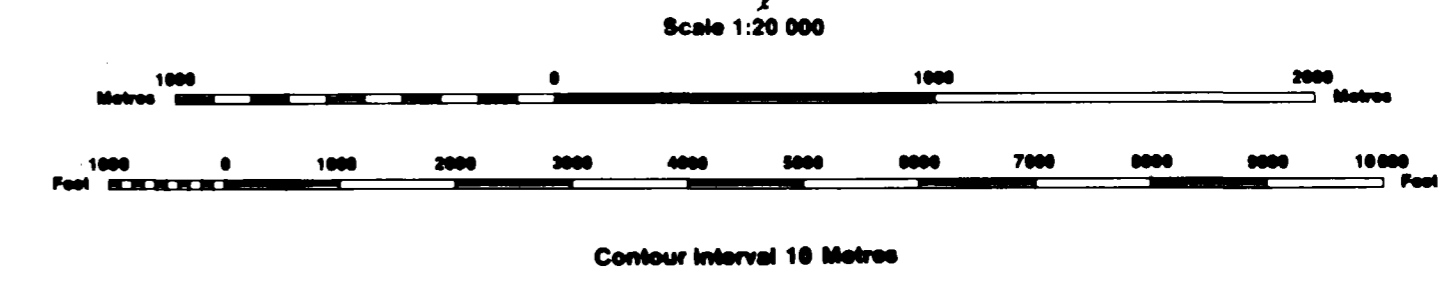

AREAS WITHDRAWN FROM DISPOSITION

MRO - Mining Rights Only
SRO - Surface Rights Only
M + S - Mining and Surface Rights

Description	Order No.	Date	Disposition	File
W-L-18/95	MAR. 30/95	M + S		
W-L-19/95	MAR. 30/95	M + S		
W-L-20/95	MAR. 30/95	M + S		

SYMBOLS

- Boundary
- Township, Meridian, Baseline
- Road allowance; surveyed
- shoreline
- Lot/Concession; surveyed
- unsurveyed
- Parcel; surveyed
- unsurveyed
- Right-of-way; road
- railway
- utility
- Reservation
- Cut, Pit, Pile
- Contour
- Interpolated
- Approximate
- Depression
- Control point (horizontal)
- Flooded land
- Mine head frame
- Pipeline (above ground)
- Railway; single track
- double track
- abandoned
- Road; highway, county, township
- access
- trail, bush
- Shoreline (original)
- Transmission line
- Wooded area

NOTES

L.O. 7601 COVERS FLOODING RIGHTS IN THIS TOWNSHIP TO CONTOUR 870 TO ONTARIO HYDRO. FILE 12280 VOL. 2.

DISPOSITION OF CROWN LANDS

- Patent
- Surface & Mining Rights
- Surface Rights Only
- Mining Rights Only
- Lease
- Surface & Mining Rights
- Surface Rights Only
- Mining Rights Only
- Licence of Occupation
- Order-in-Council
- Cancelled
- Reservation
- Sand & Gravel

CIRCULATED DEC 14, 1995 KP

Powell
Twp.



MR
9915

MR
8108

MR
8107

MR
8106

LEGEND

- ⓐ  Trench
- ClaimLine
- Shaft
-  Swamp
-  River

RECEIVED
JUN 27 1997
MINING LANDS BRANCH

TRENCHES

- ⓐ - 60ft x 20ft x 2ft
158ft x 20ft x 2ft
141ft x 20ft x 2ft
- ⓑ - 75ft x 20ft x 2ft to 6ft
230ft x 20ft x 2ft to 6ft
- ⓒ - 240ft x 20ft x 2ft
- ⓓ - 100ft x 20ft x 2ft
- ⓔ - 100ft x 20ft x 2ft



210

Hawley Lake Project				
Powell Twp., Larder Lake Mining Division				
Trench Locations		List of Revisions		
Drawn by: SAA	Date: Mar 97	No.	By:	Date:
Drawn by:	Date:			
