



41P15NE8255 63.3218 POWELL

010

REPORT
ON
1974 EXPLORATION PROGRAM
MAJESTIC MILY CONTRACTORS LIMITED
POWELL TOP. PROPERTY
HATAGLEMAN AREA, ONTARIO

CG-73

by

New Liskeard, Ont.
Nov.15,1974.

Jack C. Willars B.A.Sc. P.Eng.
Consulting Mining Geologist

REPORT
ON
1974 EXPLORATION PROGRAM
MAJESTIC WILLY CONTRACTORS LIMITED
POWELL TWP. PROPERTY
MATACHEWAN AREA, ONTARIO.

INTRODUCTION

An exploration program was conducted by Majestic Construction Ltd. on six contiguous mining claims numbered 37455 and 6, 372902 and 3, 373507, 367170 in Powell Twp., Ontario during the summer of 1973. At the end of this work it was concluded that a mineralized syenite area in the northwest part of the property warranted further investigation, and that further investigation near the 'A' or original showing was warranted.

The 1974 Exploration Program will be recorded in this report and reviewed. For history of work done to the end of 1973, reference to this author's report dated Nov.19,1973, should be made. Background material and other pertinent data is included in that production.

SCOPE OF 1974 WORK

To expand the area of investigation from last year's program, stripping by bulldozer was initiated. This was followed up by prospectors and by freshening the newly exposed areas by drilling and blasting of the surface rocks.

Previously unexplored areas of the property in the southeast section, the northeast section and the whole of the west side were thoroughly, extensively, and systematically stripped and prospected. Approximately 42,278 cubic yards of material were moved in the 81 trenches recorded. In nearly every one of the trenches a minimum of one or two 'pop-holes' freshened up the surface exposed. Other trenches were exposed much more by rock trending. Approximately three miles of connecting bulldozer roads were necessary for movement in the area.

New mineralized exposures were tested by diamond drilling, as was an untested area of the original 'A' Showing of 1973. Six holes were drilled for a total of 2,864'; three in new areas (1,546') and three in the original area (1,318'). All of the pertinent core of all the holes was split and sent for assay of copper and gold to assure an accurate and factual picture of the results. The core is stored at the premises of S.C. Welsh, Matachewan, Ontario.

RESULTS OF 1974 WORK

Stripping revealed that chalcopyrite and pyrite mineralization was widespread over the whole of the property. In addition some areas contained galena, molybdenite, bornite, and sphalerite mineralization. A few grab samples were taken for assay and they are recorded on the accompanying map. No systematic surface sampling program was undertaken.

Ceological detail and location of trenches and the number of cubic yards of material removed are dutifully recorded on the accompanying map sheet.

A summary list of the diamond drill holes and pertinent data is recorded below. Reference should be made to the Appendix of this report for the detailed and complete logs, and profile sections.

D.D.H. No. 74-1

Location-Claim 372902, 7N on North Base Line, 850' W.
Bearing due south at minus 45° 40' for 499'.

0' - 14'	Overburden		
14' - 226'	0.05% Cu over	212'	core length
226' - 245.5'	0.16% Cu over	19.5'	" "
245.5' - 352'	0.05% Cu over	106.5'	" "
352' - 374'	0.07% Cu over	22'	" "
374' - 499'	0.06% Cu over	125'	" "
14' - 499'	0.06% Cu over	485'	" "

D.D.H. No. 74-2

Location-Claim 373507, 18N, 2600' W of Main Base Line
Bearing due east at minus 36° 30' for 547'.

0' - 12' Overburden
12' - 477' 0.04% Cu over 465' core length.

Balance of core is diabase and not sampled.

D.D.H. No. 74-3

Location -Claims 372902 and 373507, L.10N, 2860' W. of Main base line.
Bearing due east at minus 46° for 500'

0 -8'	Overburden		
8'- 177'	Diabase - not sampled		
177'- 226'	0.05% Cu over	49'	core length
226'- 315'	0.06% Cu over	89'	core length
315'- 424'	0.06% Cu over	109'	core length
424'- 440'	0.07% Cu over	16'	core length
440'- 500'	0.07% Cu over	60'	core length

177'- 500'	0.07% Cu over	323'	core length

D.D.H. No. 74-4

Location-Claims 37455 and 367170, L.250N, 175' E. of main base line.
Bearing 522° E. at minus 45° 30' for 312'

0'- 16'	Overburden		
16'- 312'	0.02% Cu over	296'	core length.

D.D.H. No. 74-5

Location-Claim 37455, L.220N, 175'E. of Main Base Line
Bearing N.22° W. at minus 45° 20' for 505'.

0'- 14'	Overburden		
14'- 430'	0.02% Cu over	416'	core length.
Balance is diabase and was not sampled.			

D.D.H. No. 74-6

Location-Claim 37455, L2N,,125'E. of Main Base Line
Bearing N.86° W. at minus 45° 45' for 501'.

0'- 18'	Overburden		
18'-246'	0.03% Cu over	228'	core length
246'- 263'	Zero Cu (Diabase)	over 17'	core length
263'- 316'	0.095 % Cu	over 53'	" "
316'- 343'	Zero Cu (Diabase)	over 17'	" "
343'- 397'	0.16% Cu	over 54'	" "

Balance is diabase and was not sampled

18'- 397'	0.05% Cu over	379'	core sample
-----------	---------------	------	-------------

Cold values resulting from sampling of the core in all holes were trace amounts or low.

It is observed that chalcopyrite mineralization increases at the contacts of syenite porphyry, both within the porphyry itself and in the country rocks that it intrudes which are usually highly silicified by the intruding porphyry. The mineralization in the porphyry is usually associated with quartz (silica) stringers and veinlets. The central portions of the porphyry are lower in value than the contact areas. The values in the intruded country rock generally decrease as the distance from the syenite increases. Associated metallic mineralization other than pyrite which accompanies the above mentioned chalcopyrite, is nearly always found in the intruded country rocks.

The last stage diabase dikes do not harbour economic minerals on this property.

Syenite porphyry in the west part of the property takes the form of two nearly parallel, but converging dikes. These dikes are 100' wide by 1600' long and 125' wide by 2,000' long, and intersect both greywacke type sediments and conglomerate rocks.

In the central eastern part of the property the syenite porphyry is roughly elliptical shaped and intrudes greywacke type sediments and conglomerate rocks.

Sediments and conglomerates are bleached to a greyish colour in both of the above mentioned areas by siliceous

alteration. Numerous parallel north-south trending diabase dikes intrude all of this rock assemblage.

SUMMARY AND CONCLUSIONS

The 1974 Exploration Program on the Powell Twp. property of Majestic Wiley Contractors Ltd. consisted of trenching by bulldozer in the unexplored areas. This was followed up by rock blasting, mapping, diamond drilling, sampling and assaying. 42,278 cubic yards of material was stripped and 2,864' of diamond drilling was done.

Chalcopyrite and pyrite mineralization was found to be widespread and broadly distributed over the entire property. Minor amounts of molybdenite, galena and sphalerite were observed. Favourable rock associations and siliceous alteration are present.

Respectfully submitted

Jack C. Willars B.A.Sc., P.Eng.
Consulting Mining Geologist

New Liskeard, Ontario,
November 14, 1974.

ASSESSMENT WORK	
Rec'd from	<i>Clarence</i>
	<i>W. J. Smith</i>
Date	<i>Dec 21, 1975</i>
	Resident Geologist

7

CERTIFICATE

This is to certify that:

1. I am a graduate in Mining Geology from the University of Toronto in 1951, and I hold the degree of Bachelor of Applied Science and I have been practising my profession for the past twenty-three years.
2. I am a member in good standing of The Association of Professional Engineers of Ontario, and am certified as a Consultant, and I reside and hold office at 127 Lakeshore Road, New Liskeard, Ontario.
3. I have no direct, indirect or anticipated interest in the properties mentioned in this report nor in the securities of the Company to which they belong.
4. My report is based on familiarity of the area investigated, on current work carried out under my personal supervision, and upon my experience as an exploration Mining Geologist.

New Liskeard, Ontario
November 15, 1974

Jack O. Willars B.A.Sc. P.Eng.
Consulting Mining Geologist

N

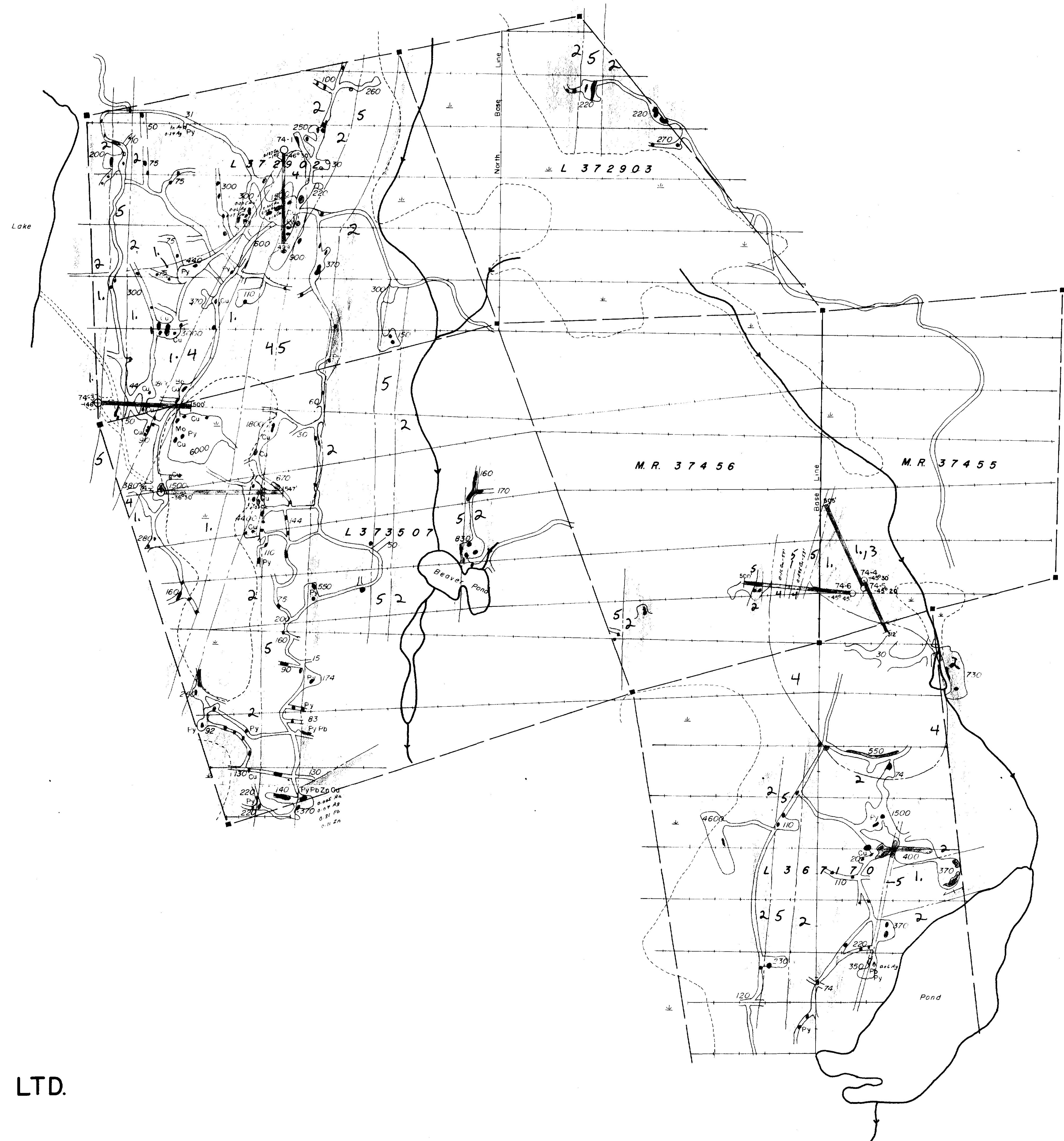

L 12 N
 L 10 N
 L 8 N
 L 6 N
 L 4 N
 L 2 N
 L 12 N
 L 10 N
 L 8 N
 L 6 N
 L 4 N
 L 2 N
 L - 0
 L 2 S
 L 4 S
 L 6 S
 L 8 S
 L 10 S
 L 12 S
 L 14 S
 L 16 S

LEGEND

- 5 [] Diabase
- 4 [] Syenite porphyry
- 3 [] Bleached sediments
- 2 [] Greywacke
- 1 [] Conglomerate

SYMBOLS

- [---] Geological contact
- [~] Swamp
- [^] Outcrop
- [~] Creek
- [---] Road
- [---] Drill road
- [---] Trench
- [---] Claim post & line
- [---] Base & picket line
- [o] Diamond drill hole
- Cu - chalcopyrite
- Ba - bornite
- Pb - galena
- Zn - zinc
- Mo - molybdenite
- Au - gold
- Ag - silver
- Py - pyrite
- 550 Number of cubic yards moved

MAP OF 1974 EXPLORATION
MAJESTIC CONSTRUCTION LTD.
 POWELL TWP, ONT.
 SCALE : 1" = 200'

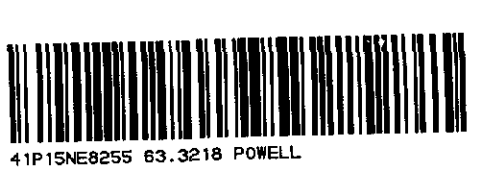

Nov 14/74 [Signature] & WILLIAMS