



41P15NE8318 2.9999 CAIRO

010

GEOLOGY REPORT

CAIRO PROPERTY

CAIRO TOWNSHIP

MATACHEWAN, ONTARIO

NTS 43-P-15

42-A-2

**RECEIVED**

APR 30 1987

**Mining Lands Section**

by

Raymond A. Bernatchez, P. Eng.,  
Consulting Geologist

January 10, 1987

*Inval.*  
*2.3742*



41P15NE8318 2.9999 CAIRO

010C

TABLE OF CONTENTS

INTRODUCTION	1
LOCATION AND OWNERSHIP	1
PHYSICAL GEOGRAPHY	3
HISTORY	3
LOCAL GEOLOGY	11
STRUCTURAL GEOLOGY	11
CONCLUSION	12
RECOMMENDATIONS	12

MAPS

Cairo Claim Group	2
Table 1	4
Exploration Data Map	5
Geology Map	6
Airborne Magnetic Map	7
Geology Map Claim L859204	8
Geology Trench #1 Area	9
Geology Trench #2 Area	10

## INTRODUCTION

The property was staked in the fall of 1985 mainly for its gold potential. The author also recognized, while researching the assessment files in the resident geologist's office in Kirkland Lake, that the property may also have base metal potential.

The area adjacent to the property has been moderately prospected in the past by several mining companies and prospectors.

Work recently carried out by Falconbridge Ltd. on optioned grounds, located south of the property, has revealed the presence of gold associated with sulphide facies iron formation on a stripped area located along the hydro power line south of St. Paul Lake on claims 23515. This area was mapped as intrusive syenite. Recent work done by Falconbridge, however, has revealed the presence of considerably more volcanics than syenite in this area.

The author has found similar discrepancies in the mapping on the west half of the property where cobalt sediments were indicated. The author has found little to no cobalt sediments present in this area and has instead, found the rocks to be mainly syenite, hornblende syenite and some fine-grained mafic volcanics. The mafic volcanics were found to be magnetic, thus causing the magnetic anomaly located over the west half of the property.

The author feels that these new discoveries represent a renewed potential for the discovery of gold and base metal deposits on the property and in the area.

## LOCATION AND OWNERSHIP

The claims were staked on October 18 and 20 of 1985, by the author and G. Bernatchez. The claims were recorded on October 21 and 25, 1985. The claims are numbered 859204 to 859209 inclusive and 859240 to 859242 inclusive and 894164. The claims are recorded in the Larder Lake Mining Division in Kirkland Lake.

The claims are located in Cairo Twp. located approximately  $5\frac{1}{2}$  miles east of Matachewan along Hwy 66 towards Kirkland Lake. The property consists of nine claims containing approximately 360 acres. The east boundary of the property is located at the Cairo-Flavelle Twp. boundary.

The property is held by Biralger Resources Ltd.

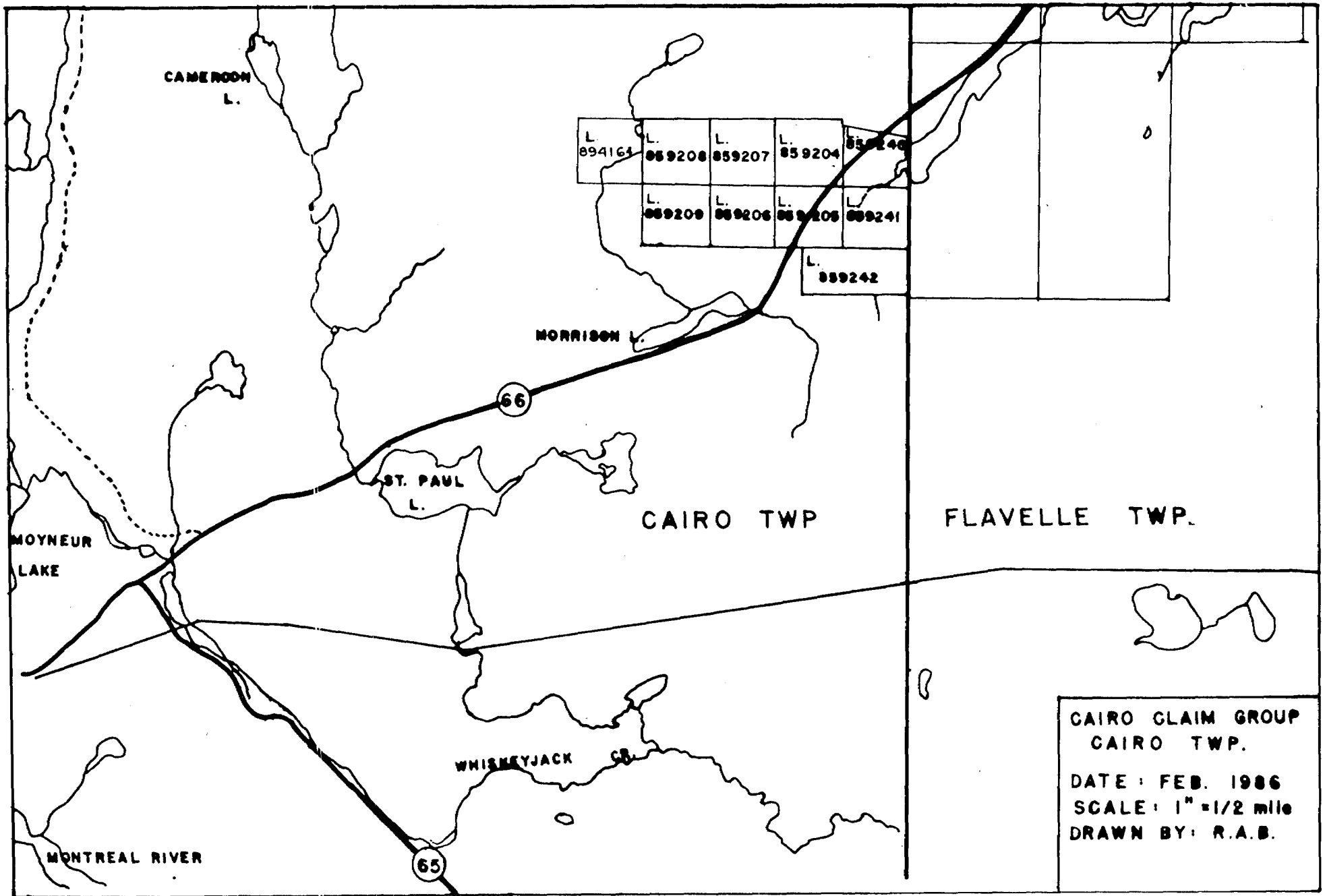

CAIRO CLAIM GROUP  
 CAIRO TWP.  
 DATE: FEB. 1986  
 SCALE: 1" = 1/2 mile  
 DRAWN BY: R.A.B.

PHYSICAL GEOGRAPHY

The rocks form a varied topography caused by two main factors. The Cairo syenite stock forms the highest relief on the property near the north boundary of the claim group. The main Kirkland Lake break passing through the east and south part of the property forms the lowest part of the topography on the property.

The west two claims have a high ridge of syenite traversing in a general north-south direction. This ridge was formerly thought to be caused by cobalt sediments.

The six claims located west of the highway have been logged and have relatively good access by foot. An old logging road was upgraded in the fall of 1985. This logging road is located approximately 430 metres southwest from the Cairo-Flavelle Twp. line on the north side of Hwy. 66. This road exits the property on the north boundary near No.4 post of claim No. 859204.

HISTORY

Some work has been done on the property from 1965 to 1983. Most of the work consists of geophysical surveys (Mag and EM-VLF) and geological mapping. No drilling has been done on the property on any of the anomalies detected by geophysics although all reports recommended follow-up work in the form of geological mapping, I.P. surveys and drilling.

The earliest work on the property area was done by Siscoe Metals of Ontario Ltd., for gold, when they carried out line cutting and magnetic survey over most of claim No. 859240 and to the NE of the property. Drilling was recommended on several mag anomalies but not executed. The area covered was considered to be favourable for low grade gold occurrences in quartz veins in shear zones in the syenite and adjacent rocks. Chalcopyrite and galena was also observed on the property at that time.

No samples were taken or reported during this period of examination.

In 1974, the leased claim L 373405 was surveyed by F.J. Garbutt, P. Eng., using magnetic and geochemical techniques. Anomalous zones of copper and zinc were defined over the claims. In 1979, geological mapping and a radiometric survey was carried out over the same claim. Again, no drilling was carried out on the property, and no samples were taken from any of the old pits known on this claim. It was concluded from the geological mapping that the area may host favourable low-grade copper-gold ore bodies in the syenite and/or near the syenite-volcanic contact.

Ecstall Mining Ltd. carried out a magnetic survey in 1975 over what is today claim No. 833663 and 373405 and other claims. One hole was drilled approximately 200 feet southeast of post No.1 of present claim No. 373405. No assays are reported in the log but abundant zones of mineralization alteration, quartz and quartz-carbonate veining and carbonatization was observed throughout the hole to a depth of 601 feet. Chalcopyrite, pyrite and magnetite, malachite, some bornite mineralization were observed in the core.

Mr. G.S. (Stan) Welsh of Matachewan, carried out a magnetic survey over a good portion of the present claims except claims 859204, 859240, 859242. A report was not submitted with the mag map. The magnetic map, however, appears to coincide with magnetic trends similar to the government airborne magnetic map No. 287 G (revised) (Matachewan Sheet).

In 1982 and 1983, Pamour Porcupine Mines Ltd. carried out a magnetic survey and a VLF survey over a portion of the present property holdings. The magnetic survey covers most of our claim 859204 and possibly the north portion of 859205. The electromagnetic survey covers most of claims 859206 to 859209. A mag trend was picked up on the south half of 859204 and EM-VLF conductors were detected on claims 859206 to 859209. Further work was recommended on the property by Kran A. Jensen but none was reported.

It is worthy to note that none of the EM-VLF anomalies were reported drilled by Pamour.

This completes the exploration work on or near this property to the present. In 1985, the author staked the present nine claims and noted fresh exposures of mineralized syenite on the logging road north of the highway. This logging road is located mainly on claim 859204 and a small portion on 859240. The road traverses in a northwesterly direction and reaches the north boundary of the property near post #4 of 859204.

A zone of mineralized, sheared, altered, carbonatized and silicified syenite porphyry was observed intermittently over a true width of approximately 400 metres along the logging road on claim 859204. Six grab samples were collected over the first third of this zone at various locations along the road where small exposures of bedrock have recently been exposed from bulldozer work while upgrading the old logging road. The gold assays are reported on Table I. Gold and silver is present in some samples. Most of the bedrock is lightly covered with overburden along the entire zone of shearing. The section and area sampled represents only a small portion of the potential shear zone along the road.

TABLE I

<u>SAMPLE No.</u>	<u>DESCRIPTION</u>	<u>ASSAYS</u>	
		Au	Ag
C-1 99503	Syenite, fractured, q.v. min. with py, cp, malachite, chlorite, 3-5% sul.	nil	0.2ppm
C-2 99504	Syenite, fractured, sil., min. with py, cp, malachite, chlorite, 3% sul.	65ppb	2.6ppm
C-3 99505	Syenite min. with py, q.v.		
C-4 not assayed	Syenite, mag, py diss. and in fractures		
C-5 not assayed	same as above		
C-6 99506	Sil. syenite porph., sed. py diss. and in fractures q.v. gausan near mafic dyke	30ppb	0.8ppm



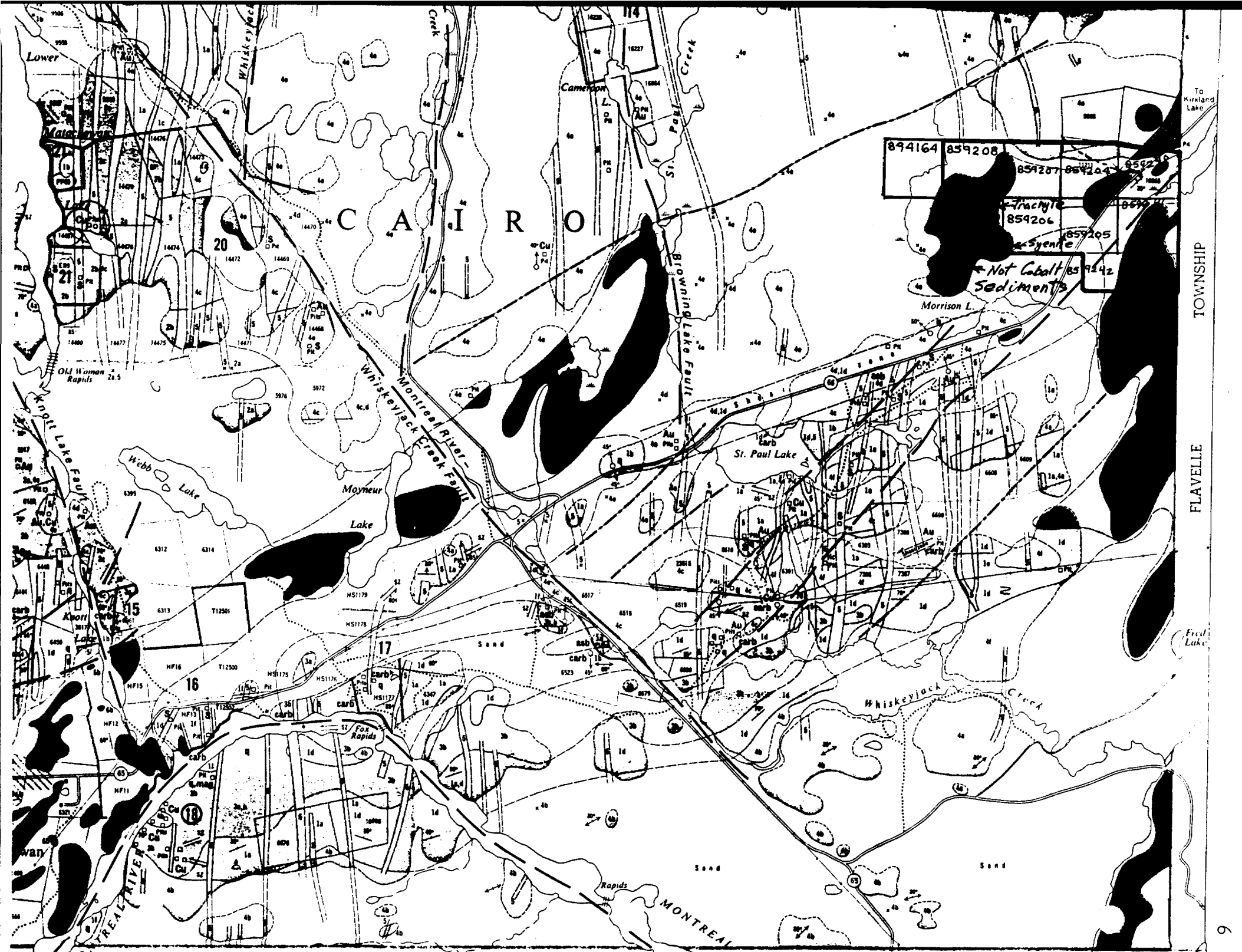

TOWNSHIP  
FLAVELLE



R.A. BERNATCHEZ, P. ENG.  
CONSULTING GEOLOGIST

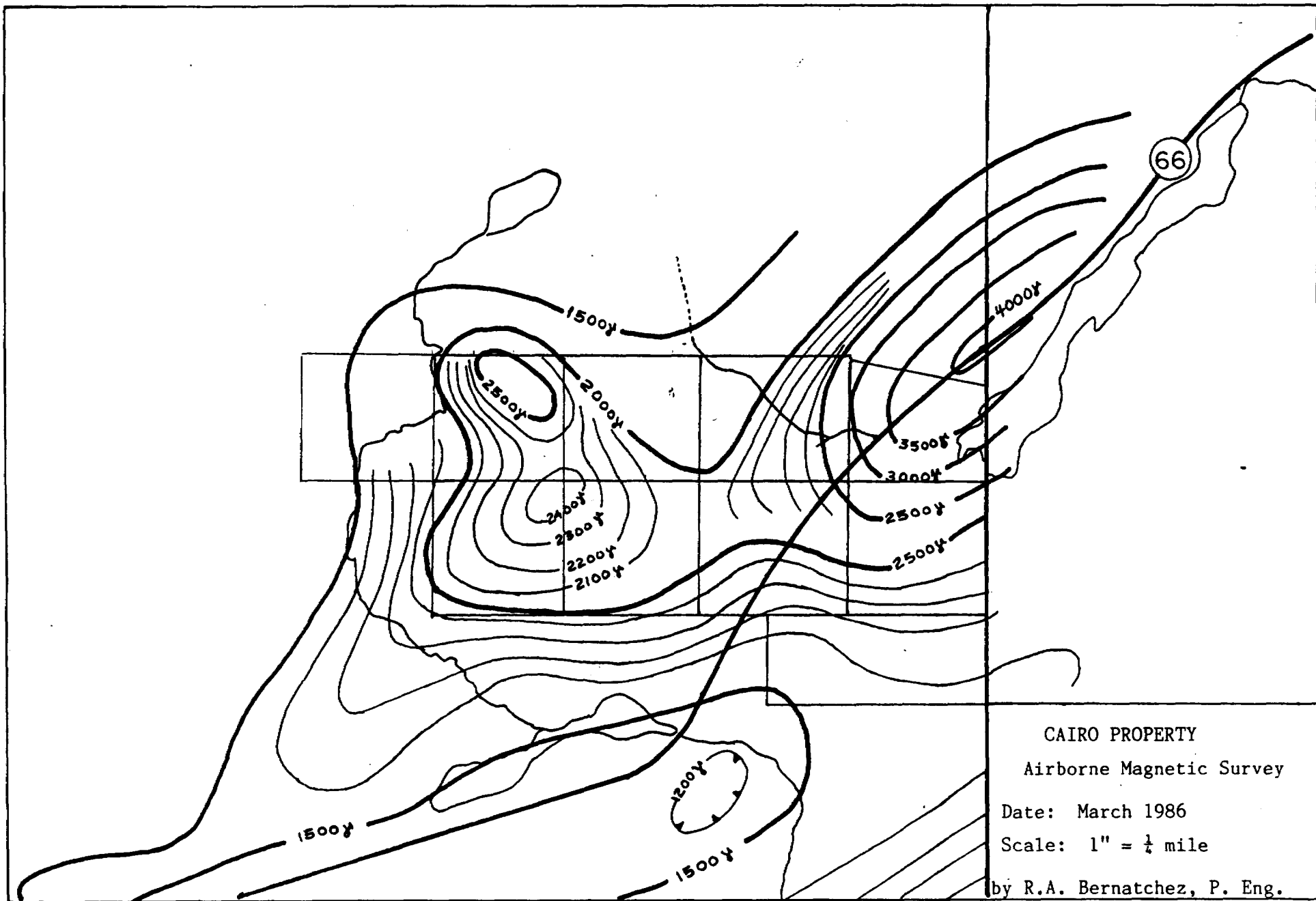

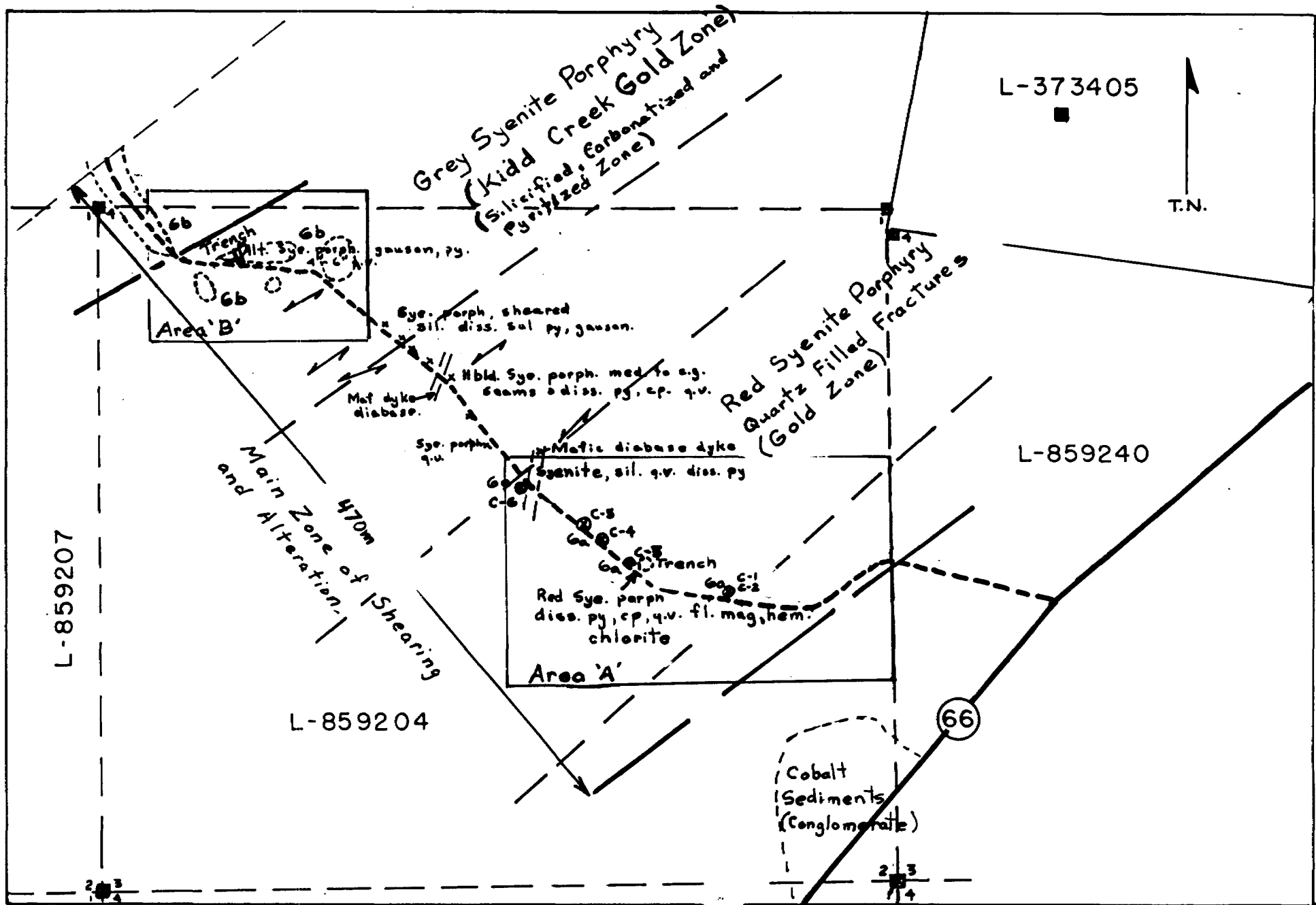

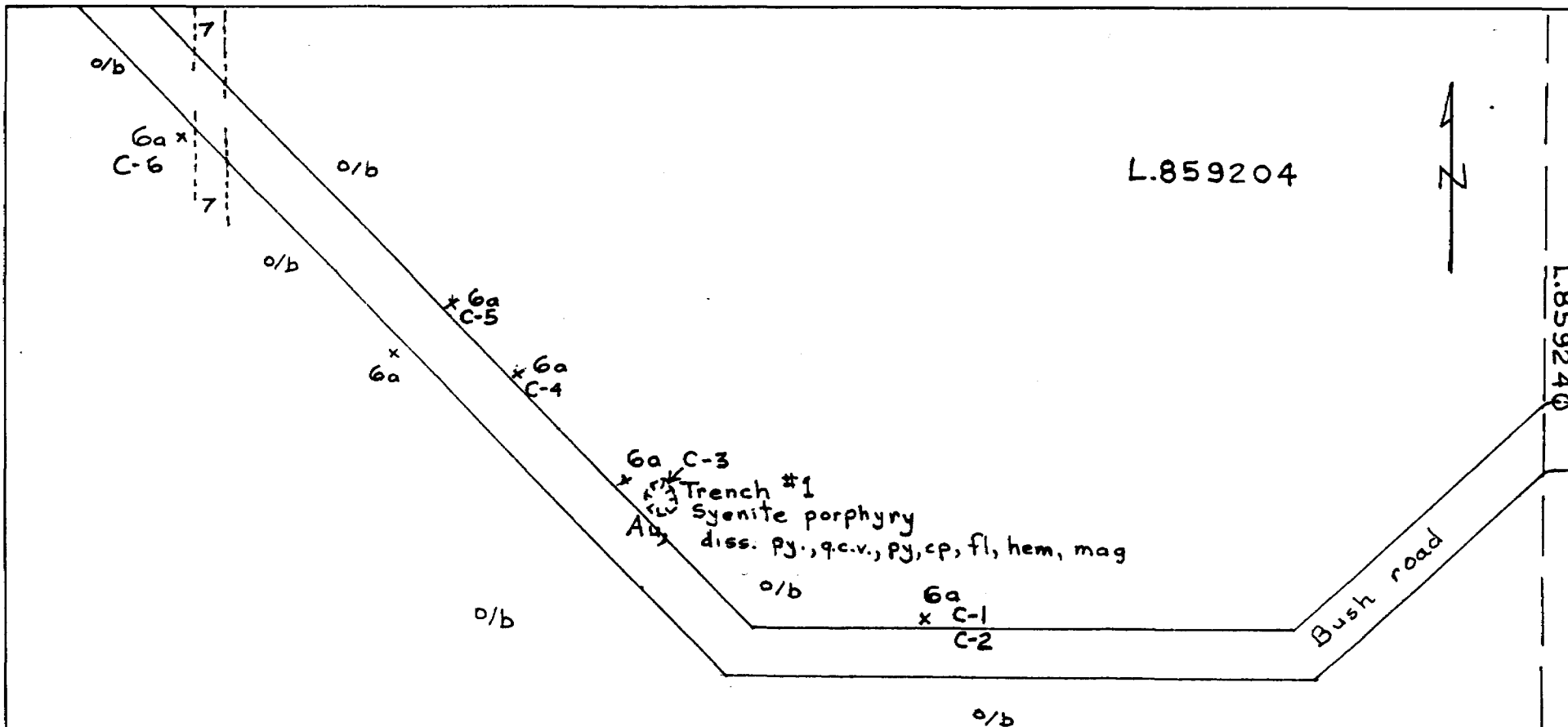

Symbols

- ⊗ - Trench
- x - Small outcrop.
- C-6 - Sample location.
- o/b - overburden
- py - pyrite
- q.c.v - quartz-calcite veins
- cp - chalcopyrite
- fl - fluorite
- hem - hematite

mag - magnetite

Legend

- 7 - Diabase dykes
- 6a - Syenite porphyry

Area 'A'

BIRALGER RES. LTD.  
CAIRO PROPERTY

Trench #1 Showing

Scale: 1:500

Date: Jan 5, 1987

By: R.A. Bernatchez, P.Eng.

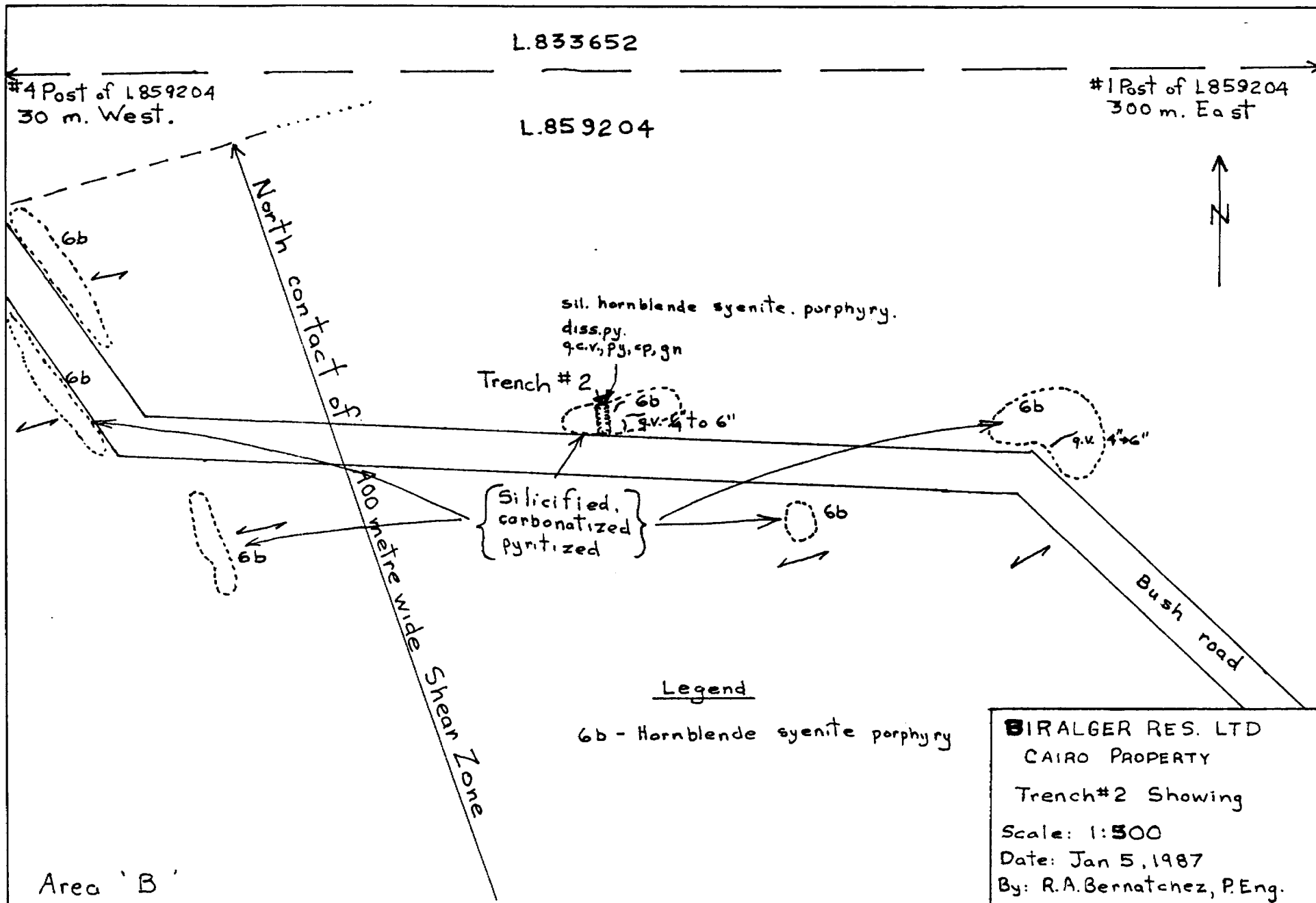

R.A. BERNATCHEZ, P. ENG.  
CONSULTING GEOLOGIST

## LOCAL GEOLOGY

The rock types covered by the claim group are all of Precambrian Age and are represented by both Archean and Proterozoic rock types.

The Archean rocks are composed of mafic to intermediate metavolcanics and derived tuffs and sulphide-oxide iron formation. Some sedimentary rock types are Temiskaming of age and consist of conglomerates and some argillite and possibly greywacke. The above rocks have all been intruded by felsic intrusive syenite porphyry. This porphyry intrusion is known as the Cairo Stock.

Late Proterozoic Cobalt Group sedimentary rocks lie unconformably over the Archean rocks and consist mainly of conglomerates and arkosic quartzite.

Lovell mapped a large outcrop of Cobalt Group sediments on the west portion of the property. The author was unable to confirm the presence of these sediments. Several rock samples examined by the author in this area while staking along the south and west boundary of claim 859208 and 859209 were found to be of syenite composition. The red colour of this rock was similar to the fine-grain sand matrix of the Cobalt conglomerate outcrop on the highway. Some large 1" to 1½" feldspar phenocrysts were observed in the porphyry in the area of post #4 of claim 859209.

The author also observed mafic fine-grain volcanic rocks along the common boundary of claims 859208 and 859209, 100' or so west of post No. 1 of claim 859209. This tends to explain the magnetic trend shown on map No. 3.

## STRUCTURAL GEOLOGY

It has been concluded by various geologists with the O.G.S., that the main Kirkland Lake Break traverses through this area and particularly at the east end of the property. This is evident by the intense shearing of the rock near the syenite-volcanic contact and in the metavolcanic-metasedimentary rocks.

This structural shearing has allowed abundant migration of hydrothermal fluids through the rocks along this break, thus causing the extensive alteration of the volcanic, metasediments and the syenite porphyry rocks.

Strong evidence is shown on an outcrop along the highway, south of Morrison Lake, of syenitization of the Timiskaming conglomerates. This area has been mapped mainly as mafic syenite and lamprophyre. An 800 ft. wide shear zone has been outlined south of Morrison Lake and north of St. Paul Lake, striking parallel to Highway 66.

### CONCLUSION

The author concludes that the property should be investigated for its gold and base metal potential.

The magnetic high trends across the east-west trend of the property appears to represent a magnetite-bearing mafic volcanic rock and may host gold-bearing mineralization of economic importance. This appears to be the case on the Falconbridge property to the south where high gold values were found in the magnetite-sulphide bearing mafic tuffs and/or interbedded sediments.

The 400 metre wide zone of sheared porphyry on the north-east part of the property should also be investigated for its gold, silver and base metal potential.

The author also concludes that the geology of the property requires thorough remapping.

### RECOMMENDATIONS

The property should have a new grid established and the following surveys should be carried out on the property in the following order:

- (a) Magnetic survey
- (b) Electromagnetic (VLF) survey
- (c) Geological mapping
- (d) Stripping
- (e) Geochemical surveys
- (f) Diamond drilling

Submitted by

  
*Raymond A. Bernatchez, P. Eng.*

January 10, 1987



# SWASTIKA LABORATORIES LIMITED

P.O. BOX 10, SWASTIKA, ONTARIO P0K 1T0

TELEPHONE: (705) 642-3244

ANALYTICAL CHEMISTS • ASSAYERS • CONSULTANTS

## Certificate of Analysis

Certificate No. 61470

Date: Nov. 1, 1985

Received Oct. 28, 1985 6 Samples of rock

Submitted by R.A. Bernatchez, Atikokan, Ontario

SAMPLE NO.	GOLD PPB	SILVER PPM	COPPER PPM
99503	Nil	0.2	
99504	60 70	2.6	
99505	Nil	0.6	
99506	30	0.8	
99507	50		
99508	Nil	0.2	647

Per   
G. Lebel, Manager

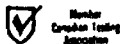

ESTABLISHED 1928



# SWASTIKA LABORATORIES LIMITED

P.O. BOX 10, SWASTIKA, ONTARIO POK 1T0

TELEPHONE: (705) 642-3244

ANALYTICAL CHEMISTS • ASSAYERS • CONSULTANTS

## Certificate of Analysis

Certificate No. 63280

Date: June 17, 1986

Received June 6, 1986 11 Samples of ore

Submitted by Queenston Gold Mines Ltd., Kirkland Lake, Ontario

Att'n: E. Andersen

SAMPLE NO.	GOLD PPB	SILVER PPM	COPPER PPM	NICKEL PPM	LEAD PPM	ZINC PPM
2204	100 130					
2205	Nil					
2206	20					
2207	Nil					
2208	70					
2209	10					
2210	Nil					
2211	Nil	Nil	35	39	11	46
2212	Nil					
2213	Nil					
2214	10					

*From Bernatchez Claims  
Cairo & Flavell Townships*

Per *G. Lebel*  
G. Lebel, Manager

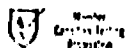

ESTABLISHED 1928



- Sample 2209 - Bernatchez - Flavelle: sample of dark, chloritized, rusted fine grained mafic volcanic from Leahy claim, Flavelle Township (not part of group). The rock is moderately foliated, strongly chloritized and locally silicified, and contains a moderate amount of finely disseminated and fine grained aggregates of pyrite. 10 ppb.
- 2210 - Bernatchez - Flavelle: sample from roughly midway down the outcrop exposure, and apparently within the zone designated as iron formation. The rock is very fine grained and varies from dark greyish brown to dark green and dark grey green in colour. The sample is essentially composed of silica with narrow, fine grained lamellae of dark chloritized  $\pm$  amphibolitized mafic volcanics (?). The sample is unveined but does contain trace amounts of pyrite. NIL
- 2211 - Bernatchez - Flavelle: sample from northeast end of sulphide pit on Lovell's map of Flavelle Township. The sample is partly gossaned iron formation - fine grained, rusty, vuggy rock with a fair amount of pyrite and rusting from pyrite. There are relict bits of sugary textured quartz in the sample - there are no blasted boulders available around the area and the deeply weathered sulphide section prevents collection of a fresh sample from the water-filled pit.
- Assay also for Cu Pb Zn Ni Ag ppm  
 Pit is 30'W of #1 post 812718, Bernatchez. NIL  
 Ag NIL; Cu 35ppm; Ni 37ppm; Pb 11ppm; Zn 46ppm.
- 2212 - Bernatchez - Flavelle: sample from northwest side of pit mentioned above. Dull grey to white, fine grained, sugary textured, partly vuggy iron formation with accessory pyrite (to 10%). The grey component appears partly related to traces of graphite (?) or perhaps granulated sulphides. NIL



# SWASTIKA LABORATORIES LIMITED

P.O. BOX 10, SWASTIKA, ONTARIO P0K 1T0  
TELEPHONE: (705) 642-3244  
ANALYTICAL CHEMISTS • ASSAYERS • CONSULTANTS

## Certificate of Analysis

Certificate No. 61470

Date: Nov. 1, 1985

Received Oct. 28, 1985 6 Samples of rock

Submitted by R.A. Bernatchez, Atikokan, Ontario

	SAMPLE NO.	GOLD PPB	SILVER PPM	COPPER PPM
C-1	99503	Nil	0.2	
C-2	99504	60 70	2.6	
C-3	99505	Nil	0.6	
C-4	99506	30	0.8	
C-5	99507	50		
C-6	99508	Nil	0.2	647

Per   
G. Lebel, Manager

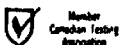

ESTABLISHED 1928





# SWASTIKA LABORATORIES LIMITED

P.O. BOX 10, SWASTIKA, ONTARIO P0K 1T0  
TELEPHONE: (705) 642-3244  
ANALYTICAL CHEMISTS • ASSAYERS • CONSULTANTS

## Certificate of Analysis

Certificate No. 63280

Date: June 17, 1986

Received June 6, 1986 11 Samples of ore

Submitted by Queenston Gold Mines Ltd., Kirkland Lake, Ontario

Att'n: E. Andersen

Cairo  
Property.

SAMPLE NO.	GOLD PPB	SILVER PPM	COPPER PPM	NICKEL PPM	LEAD PPM	ZINC PPM
2204	100 130					
2205	Nil					
2206	20					
2207	Nil					
2208	70					
2209	10					
2210	Nil					
2211	Nil	Nil	35	39	11	46
2212	Nil					
2213	Nil					
2214	10					

From Bernatchez Claims  
Cairo & Flavell Townships

Per G. Lebel  
G. Lebel, Manager

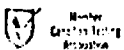

Bernatchez Properties  
Matachewan Area

Samples for Au ppb

- Sample 2204 - Bernatchez - Cairo property - samples 2204 - 2208 incl.  
spread over 600-700' along logging road on northeast part of property  
(Samples proceed from east to west). On claim L 859204  
Sample of fine to medium grained, brick red, to slightly orangish  
syenite. The syenite is partly fractured with chlorite and contains  
a moderate amount of finely disseminated to fine cubic pyrite. There  
is no veining in the sample. The pyrite, although sprinkled through-  
out, is most often confined along or near the chloritic slips and  
fractures. 115 ppb.
- 2205 - Bernatchez - Cairo property: syenite - much darker brick red syenite  
with accessory chlorite and a minor amount of disseminated pyrite.  
There are a few very fine quartz veins in this sample. NIL.
- 2206 - Bernatchez - Cairo property: dark greenish-red, fine to medium grained,  
partly brecciated (??), chloritized syenite. The rock is lightly  
mineralized with pyrite and contains a few fine quartz ± carbonate -  
filled fractures. Pyrite mineralization, however, is usually not re-  
lated to veining - more often it is finely disseminated to partly  
localized along chloritic fractures. 20 ppb.
- 2207 - Bernatchez - Cairo property: Dull brick red to slightly greyish syenite.  
The rock is fine to medium grained, partly fractured with chlorite and  
is very sparsely mineralized with pyrite. The rock has a somewhat  
sugary texture. NIL
- 2208 - Bernatchez - Cairo property: Grey green, medium grained porphyritic  
syenite: The rock is sugary textured, partly chloritized and is spar-  
sely mineralized with pyrite. There are some narrow, 5-8 mm, quartz ±  
carbonate veins in the sample. This sample is near the north boundary  
of the claim group. 70 ppb



Ontario

Ministry of  
Northern Development  
and Mines

Ministère du  
Développement du Nord  
et des Mines



41P15NE8318 2.9999 CAIRO

900

September 18, 1987

Your File: 102/87  
Our File: 2.9999

Mining Recorder  
Ministry of Northern Development and Mines  
4 Government Road East  
Kirkland Lake, Ontario  
P2N 1A2

Dear Sir:

RE: Notice of Intent dated August 26, 1987  
Assaying on Mining Claims L 859242, et al, in Cairo Township

The assessment work credits, as listed with the above-mentioned  
Notice of Intent, have been approved as of the above date.

Please inform the recorded holder of these mining claims and  
so indicate on your records.

Yours sincerely,

R.M. Charnesky (Mrs.)  
Acting Manager  
Mining Lands Section  
Mineral Development and Lands Branch  
Mines and Minerals Division

Whitney Block, Room 6610  
Queen's Park  
Toronto, Ontario  
M7A 1W3

Telephone: (416) 965-4888

AB AB:p1

cc: Biralger Resources Ltd.  
Suite 300  
106 Adelaide Street West  
Toronto, Ontario

Mr. R.A. Bernatchez  
126 Willow Road  
Atikokan, Ontario  
POT 1C0

Mr. G.H. Ferguson  
Mining & Lands Commissioner  
Toronto, Ontario



Ontario

Ministry of Northern Development and Mines

Technical Assessment Work Credits

File 2.9999

Date August 26, 1987 Mining Recorder's Report of Work No. 102/87

Recorded Holder: BIRALGER RESOURCES LTD
Township or Area: CAIRO TOWNSHIP

Table with 2 columns: Type of survey and number of Assessment days credit per claim; Mining Claims Assessed. Includes sections for Geophysical, Geological, and Geochemical surveys.

Special credits under section 77 (16) for the following mining claims

No credits have been allowed for the following mining claims
not sufficiently covered by the survey
insufficient technical data filed
NO GEOLOGY CREDITS FOR CLAIM L 859242 AS WORK WAS PERFORMED ON CLAIM L 859204.

The Mining Recorder may reduce the above credits if necessary in order that the total number of approved assessment days recorded on each claim does not exceed the maximum allowed as follows: Geophysical - 80; Geological - 40; Geochemical - 40; Section 77(19) - 60.

SUMMARY OF WORK PERFORMED ON CAIRO PROPERTY

Assessment Days  
Credit

Geological Mapping & Report

Mapping - July 15, 16, 17, 18, 1986

$$4 \text{ days} \times 8 = \frac{32}{3}$$

Report - December 20, 21, 22, 23

$$4 \text{ days} \times 8 = \frac{32}{3}$$

$$= \frac{64}{3}$$

= 21.3 days

Geology By Raymond A. Bernatchez, P. Eng.  
Consulting Geologist  
Atikokan, Ontario POT 1C0

Trenching (Drilling & Blasting)

Date - July 19, 20, 21

3 men for 3 days - 8 hr./day

(Labour) Gerry Bernatchez - 3 days X 8 hr. = 24 man hours

(Supervisor) Ray Bernatchez - 3 days X 8 hr. = 24 " "

(Labour) David Payne - 3 days X 8 hr. = 24 " "

---

72 man hours

= 12.0 days

Assaying -  $\frac{\$120.00}{15}$

8.0 days

TOTAL

---

41.3 days

Gerry Bernatchez (labour) - Matachewan, Ontario POK 1M0

David Payne (labour) - Timmins, Ontario

Ray Bernatchez (supervisor) - Atikokan, Ontario POT 1C0



**REFERENCES**

**AREAS WITHDRAWN FROM DISPOSITION**

- M.R.O. - MINING RIGHTS ONLY
- S.R.O. - SURFACE RIGHTS ONLY
- M. + S. - MINING AND SURFACE RIGHTS

Description	Order No.	Date	Disposition	File
(R) MINING AND SURFACE RIGHTS NOT OPEN TO STAKING, APPLICATION UNDER SECTION 3(b) JUNE 12, 1987.				

(R) MINING AND SURFACE RIGHTS NOT OPEN TO STAKING, APPLICATION UNDER SECTION 3(b) JUNE 12, 1987.

Alma Twp.

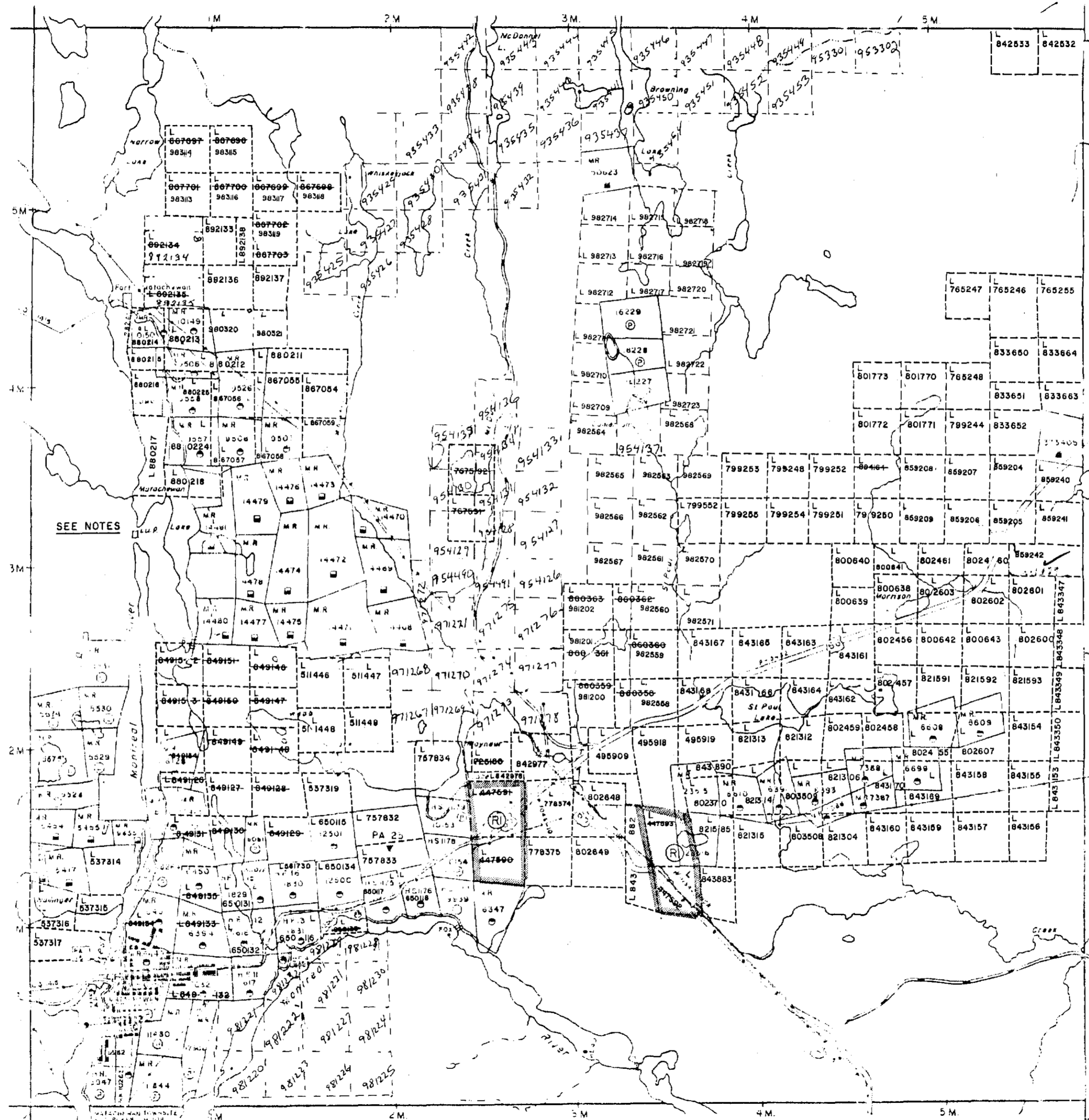

SEE NOTES

**NOTES**

AREA WEST OF WEST MONTREAL RIVER CLOSED TO STAKING SUBJECT TO SEC. 38(F) OF THE MINING ACT, 20 SEPT. 1978.

**LEGEND**

- HIGHWAY AND ROUTE NO.
- OTHER ROADS
- TRAILS
- SURVEYED LINES:
  - TOWNSHIPS, BASE LINES, ETC.
  - LOTS, MINING CLAIMS, PARCELS, ETC.
- UNSURVEYED LINES:
  - LOT LINES
  - PARCEL BOUNDARY
  - MINING CLAIMS ETC.
- RAILWAY AND RIGHT OF WAY
- UTILITY LINES
- NON-PERENNIAL STREAM
- FLOODING OR FLOODING RIGHTS
- SUBDIVISION OR COMPOSITE PLAN
- RESERVATIONS
- ORIGINAL SHORELINE
- MARSH OR MUSKEG
- MINES
- TRAVERSE MONUMENT

**DISPOSITION OF CROWN LANDS**

TYPE OF DOCUMENT	SYMBOL
PATENT, SURFACE & MINING RIGHTS	
" SURFACE RIGHTS ONLY	
" MINING RIGHTS ONLY	
LEASE, SURFACE & MINING RIGHTS	
" SURFACE RIGHTS ONLY	
" MINING RIGHTS ONLY	
LICENCE OF OCCUPATION	
ORDER-IN-COUNCIL	
RESERVATION	
CANCELLED	
SAND & GRAVEL	

NOTE: MINING RIGHTS IN PARCELS PATENTED PRIOR TO MAY 8 1913, VESTED IN ORIGINAL PATENTEE BY THE PUBLIC LANDS ACT, R.S.O. 1970, CHAP. 380, SEC. 63, SUBSEC. 1

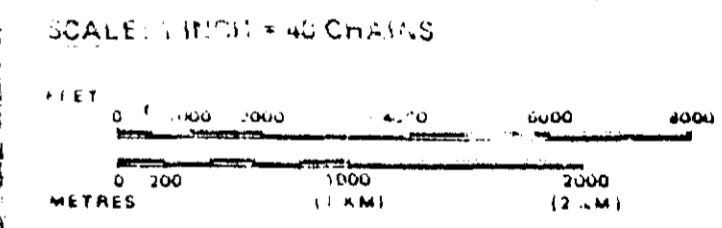

DATE OF ISSUE  
SEP 4 1987  
LARDER LAKE  
MINING RECORDS OFFICE

TOWNSHIP  
**CAIRO**  
M.M.R. ADMINISTRATIVE DISTRICT  
KIRKLAND LAKE  
MINING DIVISION  
LARDER LAKE  
LAND TITLES / REGISTRY DIVISION  
TIMISKAMING

Ministry of Natural Resources Ontario  
Ministry of Northern Development and Mines

DATE JULY 1988  
Number  
**G-3209**



Kimberley Twp.