

L 387568

L 387565

Base Line

CF36

CF35

CF40

CF30

F29

F28

CF33

CF31

CF32

F27

CF39

CF38

CF37

CF45

CF42

3747

373405



CAIRO TWP
Flavelle Twp.

Scale
1" = 200'

41P15NE8352 2.1963 CAIRO



010

12/10/1975

CF-27	200'	1975
28	200'	
29	200'	
30	160'	
31	200'	
32	150'	
33	200'	
-		
35	200'	
36	200'	
37	200'	
38	200'	
39	200'	
40	200'	
41	200'	
42	200'	
43	200'	
<hr/>		
	3110'	

Recorded Holder Texasgulf Canada Limited
Township or Area Cairo Township

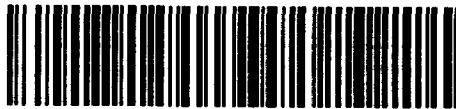

41P15NE8352 2.1963 CAIRO

900

Type of survey and number of Assessment days credit per claim	PERCUSSION DRILLING
<p>Geophysical</p> <p>Electromagnetic _____ days</p> <p>Magnetometer _____ days</p> <p>Radiometric _____ days</p> <p>Induced polarization _____ days</p> <p>Section 86 (18) <u>19 & 20</u> see across _____ days</p> <p>Geological _____ days</p> <p>Geochemical _____ days</p> <p>Man days <input type="checkbox"/> Airborne <input type="checkbox"/></p> <p>Special provision <input type="checkbox"/> Ground <input checked="" type="checkbox"/></p>	<p>Location of (16) Drill Holes:</p> <p>Mining Claims - L. 373405 387568</p> <p>Cost of drilling (3,110 ft. X \$4.75 per foot) = \$14,772.50</p> <p>Total assessment days credit allowed= 985</p> <p>The above two mining claims may be grouped under Section 85 (6) for the purposes of recording the work credits of <u>985 days</u>.</p> <p><i>Leo Bunnies</i></p> <p>Approved - March 1, 1976</p>
<p>Notice of Intent to be issued:</p> <p><input type="checkbox"/> Credits have been reduced because of partial coverage of claims.</p> <p><input type="checkbox"/> Credits have been reduced because of corrections to work dates and figures of applicant.</p> <p><input type="checkbox"/> No credits have been allowed for the following mining claims as they were not sufficiently covered by the survey:</p> <p>_____</p> <p>_____</p> <p>_____</p> <p>_____</p> <p>_____</p>	<p>Previous work files:</p> <p>2.1855 - Geophysical</p> <p>2.1679 - Geophysical</p> <p>2.1530 - Geophysical &</p> <p>2.1531 - Geochemical</p> <p>63.1516 - Geophysical</p> <p>63.243 - Geophysical</p>

Cairn Top

DISTRICT **M 22**
TIMISKAMING

LARDER LAKE
MINING DIVISION

SCALE: 1-INCH = 40 CHAINS

LEGEND

- PATENTED LAND
- CROWN LAND SALE
- LEASES
- LOCATED LAND
- LICENSE OF OCCUPATION
- MINING RIGHTS ONLY
- SURFACE RIGHTS ONLY
- ROADS
- IMPROVED ROADS
- KING'S HIGHWAYS
- RAILWAYS
- POWER LINES
- MARSH OR MUSKEG
- MINES
- CANCELLED

NOTES

400' Surface Rights Reservation along the shores of all lakes and rivers

AREAS WITHDRAWN FROM STAKING

S.R. - SURFACE RIGHTS M.R. - MINING RIGHTS

Section District No. Range

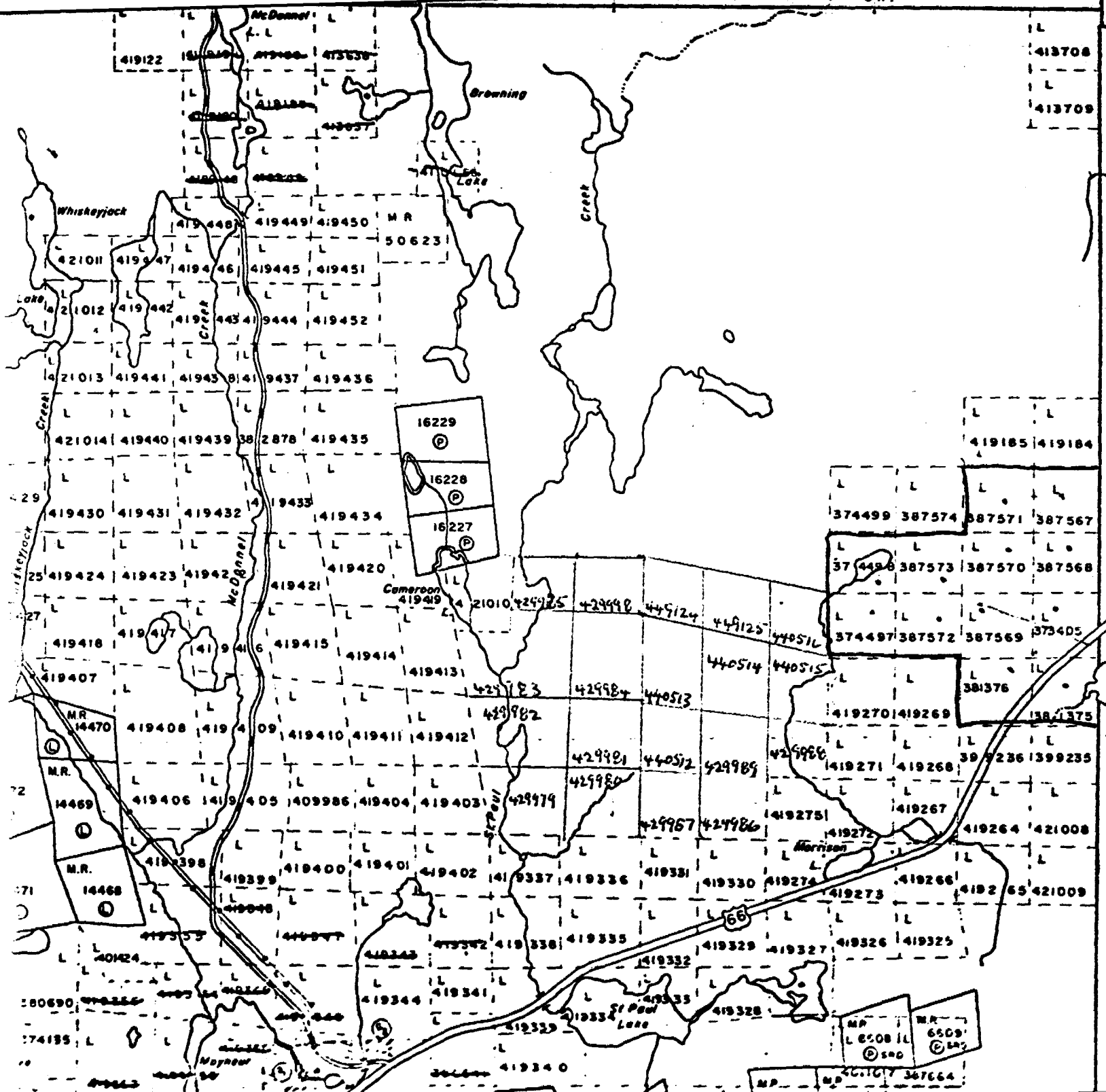

Flavelle Twp. - M/22

g the shore

ship into
ily annulled.

HOLM

12 11 10 9 8

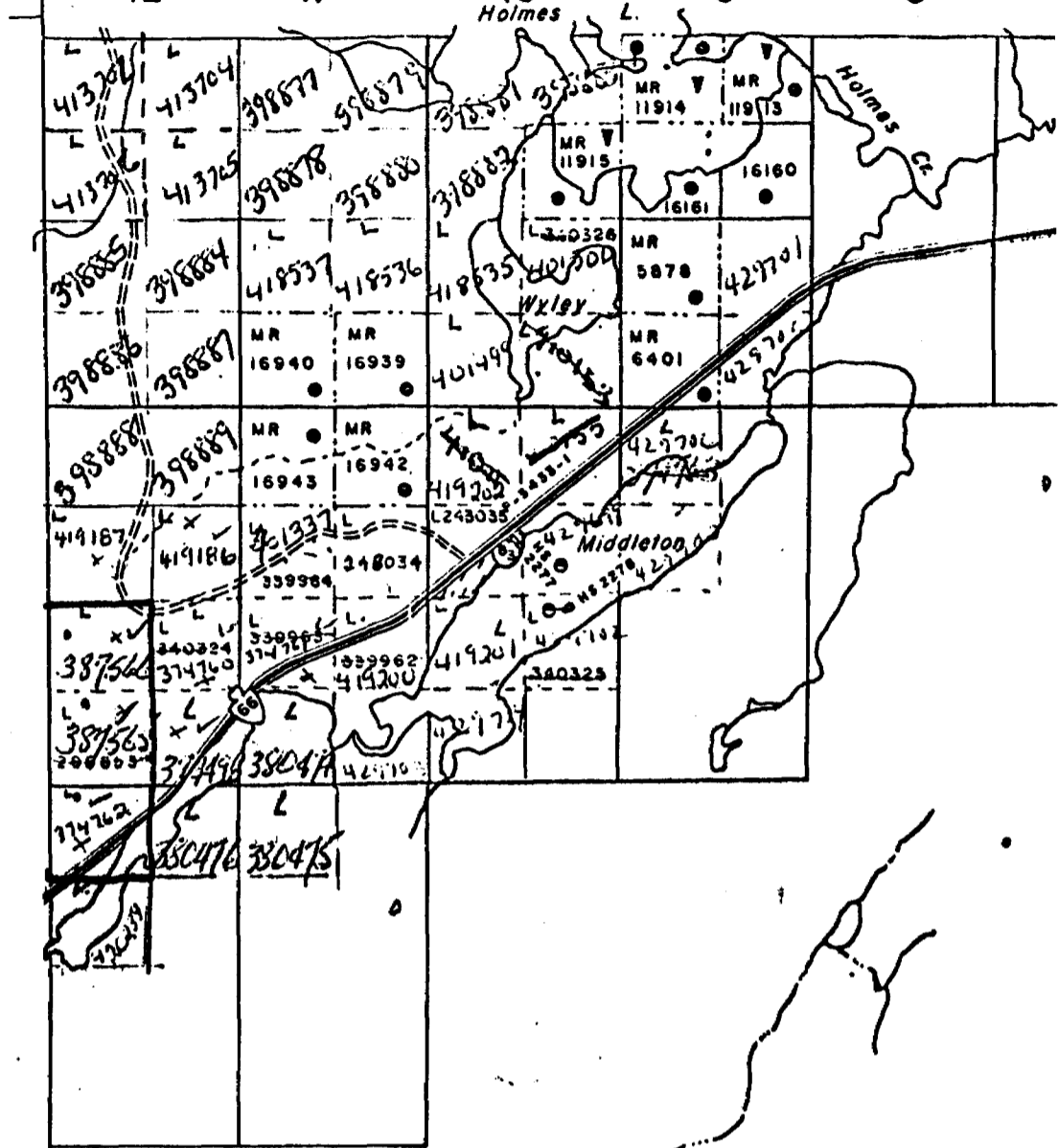

Flavelle
top
M 220.

CAIRO Tp. M. 210

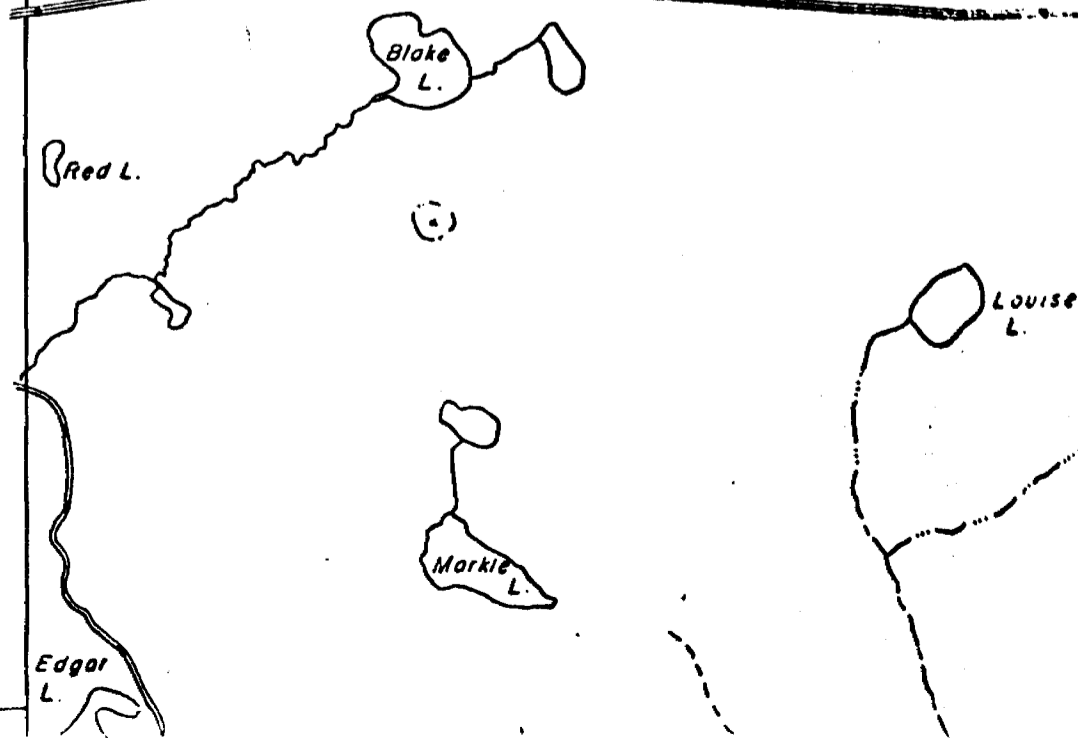

PM
316

Alma Twp. - M.202















THE TOWNSHIP OF
OF **2-1963**
CAIRO

DISTRICT OF
TIMISKAMING

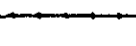
LARDER LAKE
MINING DIVISION

SCALE: 1-INCH = 40 CHAINS

LEGEND

- PATENTED LAND 
- CROWN LAND SALE 
- LEASES 
- LOCATED LAND 
- LICENSE OF OCCUPATION 
- MINING RIGHTS ONLY 
- SURFACE RIGHTS ONLY 
- ROADS 
- IMPROVED ROADS 
- KING'S HIGHWAYS 
- RAILWAYS 
- POWER LINES 
- MARSH OR MUSKOG 
- MINES 
- CANCELLED 

NOTES

400' Surface Rights Reservation along the shores of all lakes and rivers

AREAS WITHDRAWN FROM STAKING				
S.R. - SURFACE RIGHTS		M.R. - MINING RIGHTS		
Section	Order No.	Date	Disposition	File
(R)	42	1/8/68	S.R.	15376 v.2
(R)	43	7/1/75	S.R.	177224
			S.R.	177224

SAND and GRAVEL				
M.T.C.	Gravel Pit	File	M.N.R.	Gravel
(G)	Gravel Pit 206	127307	(G)	Gravel Pit 205
(G)	Gravel Pit 1313		(G)	Gravel Pit
(G)	Gravel Pit 204, File 127307		(G)	Gravel Pit

MINING LANDS
DATE OF ISSUE
NOV 12 1975
MINISTRY
OF NATURAL RESOURCES

PLAN NO. **M.210**

ONTARIO
MINISTRY OF NATURAL RESOURCES
SURVEYS AND MAPPING BRANCH

Powell Twp. - M.241

Flavelle Twp. - M.220

Kimberley Twp. - M.226



41P15NE8352 2.1963 CAIRO

David B. ...
 LEGEND
 Description: ...

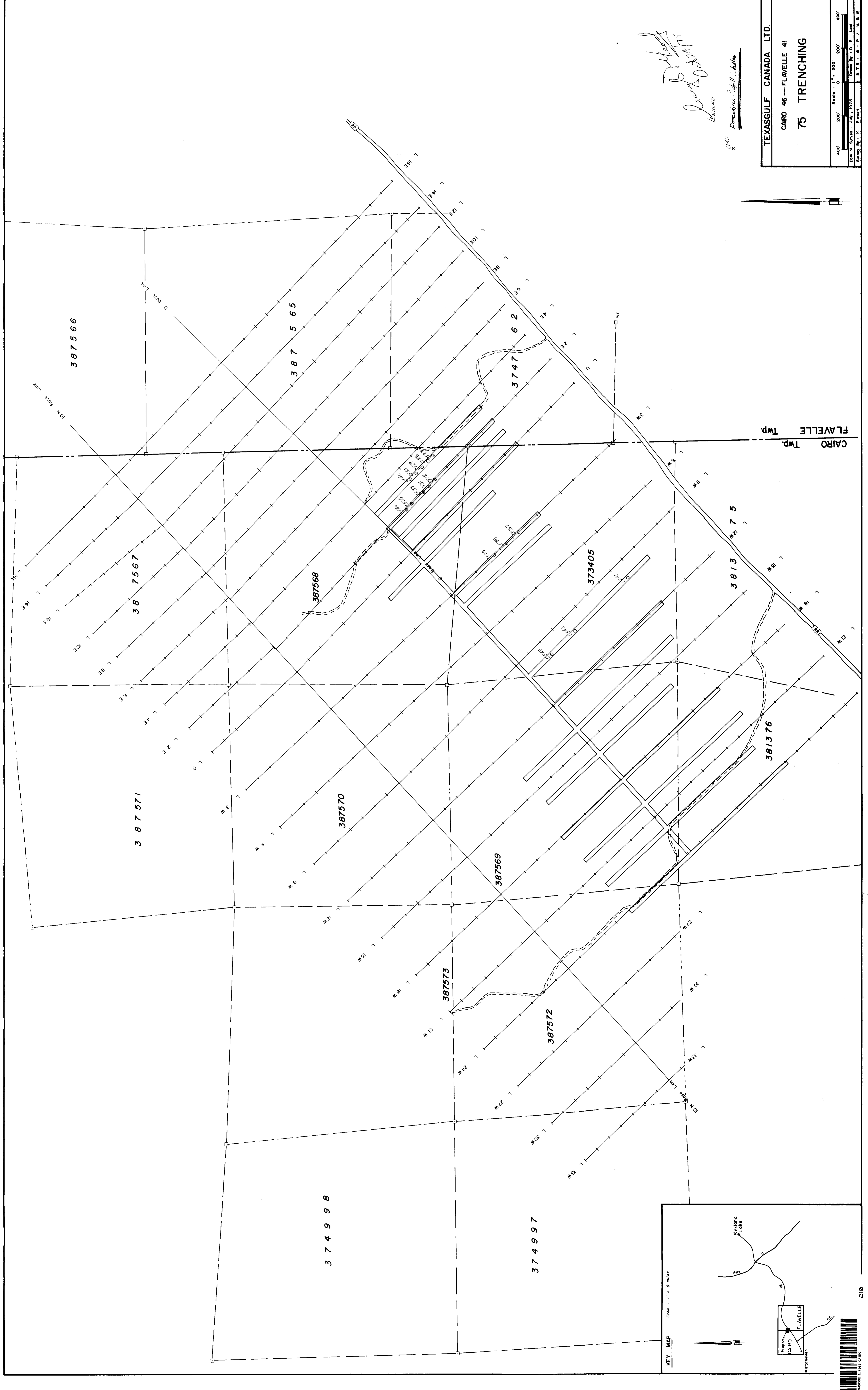

CAIRO Twp
 FLAVELLE Twp

