



41P16SW2004 2.18674 FARR

010

TRENCHING & STRIPPING REPORT

- CLAIMS 1217593, 1217594, and 1217595 -
- FARR TOWNSHIP -

2.18674

Prepared by:

Robert G. Komarechka P.Geol.
of BEDROCK CONSULTING
#1 - 537 Haig St.
Sudbury, Ontario
P3C 1E2

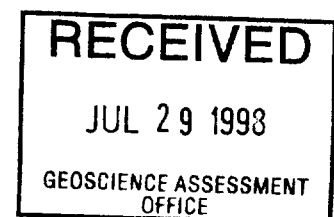

mk



TRENCHING & STRIPPING REPORT - FARR TOWNSHIP.

CONTENTS

Introduction	2
Location & Access	2
Mining Claims Examined	2
Previous Exploration Work	3
Stripping and Trenching Program.....	3
Mapping Program	3
Sampling Program	4
Discussion of Results	4
- Rock Types	4
- Fractures	4
- Veins.....	5
- Assay Results	5
Conclusion & Recommendations.....	6
Certificate	7
Appendices	8
- Appendix # 1 - Assays	9
Maps - Index Location Map 1.....	2-i
- Geology Map 2	2-ii
Appendix #2 - DIMENSION OF TRENCHES	10.



TRENCHING & STRIPPING REPORT - FARR TOWNSHIP.

INTRODUCTION

In early July 1998, Bedrock Consulting was contracted by Michael Opara of Lake Superior Resources Corp. to conduct mapping, collect assay samples and prepare a report on a recently conducted trenching and stripping program in Farr Twp.

LOCATION & ACCESS

The study area is located in south central Farr township midway between Moses and Planty Lakes. The location is shown on the index map 1. The site is located within the Larder Lake Mining Recorders District at a latitude of 47°46.21" and longitude of 80° 27.62".

Access to the site is obtained by taking highway 63 just north of Elk Lake and traveling northward for 12.9 kilometers then turn left on a gravel road underneath a power line. Travel 5.3 kilometers and turn left alongside a small sand pile. Take the left fork at 1.1 kilometers and continue until arriving at another fork an additional 1.35 kilometers past the last fork the road splits shortly after this again. Take the left fork and the site is about 1/2 kilometer on the left.

MINING CLAIMS EXAMINED

The work described herein was performed over the following contiguous claims:

Claim Number	Number of Units	Name and Address of Claimholder
L1217593	4x4	Lake Superior Resources Corp.
L1217594	3x4	Lake Superior Resources Corp.
L1217595	1x1	Lake Superior Resources Corp.

Contour Interval 10 Metres

INFORMATION FROM
PLAN
G-3635
TOWNSHIP
FARR

INDEX MAP 1

1217598

1217597

1217594

1217596

1217595

1217593

1218931

1217592

FARR TOWNSHIP

MICKLE TOWNSHIP



SEE MAP 2
NOTE: CLAIMS ARE NOT SHOWN
LOCATED CORRECTLY ON
THIS MAP

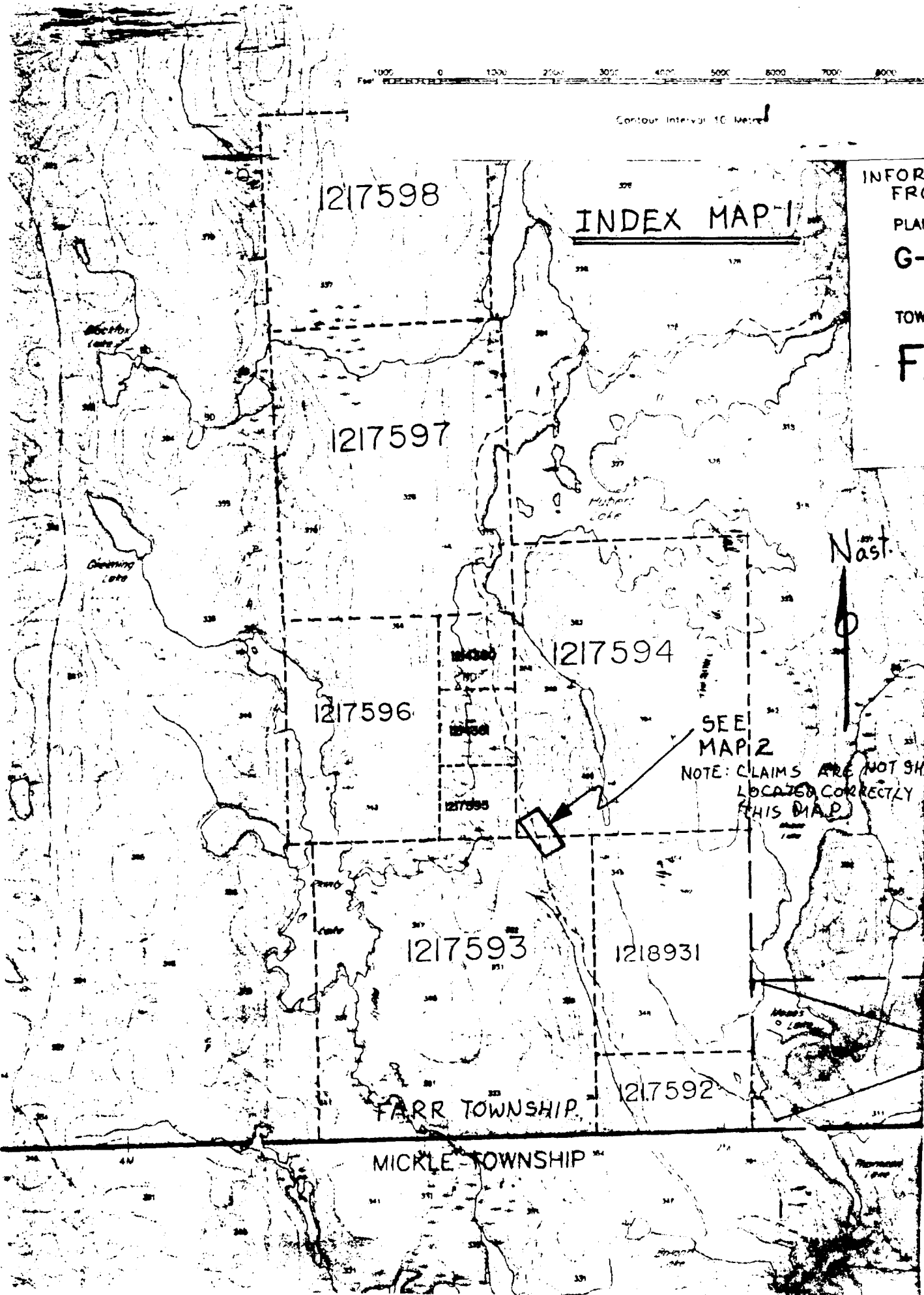

PREVIOUS EXPLORATION WORK

Numerous old pits, shafts and trenches exist on the property many made by parties unknown.

STRIPPING AND TRENCHING PROGRAM

From May 9, 1998 to May 26, 1998 a program of stripping and trenching was undertaken in Farr Township.

The equipment and operator were supplied by Fred Swain. The equipment model was a Cat backhoe 416B.

Stripping and trenching took place over irregular terrain with considerable overburden. The overburden depth varied between one and six feet with the average depth of four feet in trenches and three feet in the stripped areas. The stripping and trenching exposed an area of 2168 sq. metres.

The mechanical and manual overburden stripping was continuous over a 15 day period which included 12 hour days with the exception of a few minor breakdowns. Two days before the 15 day period were spent transporting supplies and equipment to the site. The equipment was floated to the site from Bracebridge, Ont. because of a better rate. The equipment utilized during the manual stripping included 2 pumps, 1000 ft of fire hose, fire nozzle, 2 chain saws, suction hose, generator, extension cord, winch and numerous shovels and axes. Hand grubbing and subsequent washing were extensively carried out due to hard clay layer and numerous cracks, dips and crevices in the rock.

Sherry Swain was the site supervisor.

This stripping program consisted of 4 trenches and 11 stripped areas. The location of this work is shown on Map 1 and 2.

MAPPING PROGRAM

Mapping was undertaken by first surveying out the course of the road relative to existing claim lines and posts. The location of the various trenches were then located along the road and were mapped.

Locations along the trenches adjacent stripped areas were marked and used as datums for subsequent mapping of stripped areas.

A 50 meter measuring tape was laid out on the ground along the trenches and along specific bearings top aid in the mapping of stripped areas. This data was plotted in a gridded metric field book for later collage transferring on to a larger mylar sheet to produce the composite geology map 2. This work was performed from July 8-11, 1998 inclusive. The report being prepared on July 26-27, 1998.

SAMPLING PROGRAM

After mapping out all the veins the sites were revisited and samples collected from the various veins. Generally this was done with a hammer and chisel. Care was exercised to avoid extraneous non vein material contaminating the sample. This process was very time consuming fro the smaller or deeply eroded veins. Samples were sent out to Swastika Laboratories and analyzed via Atomic Absorption for copper, cobalt, silver, bismuth and nickel. Gold was analyzed by fire assaying. Anomalously high metals were reassayed via conventional means. The samples were collected on July 12, 98.

DISCUSSION OF RESULTS

Rock Types

Nipissing Diabase was the primary rock type underlying the whole stripped area. There appeared to be a slight increase in mafic content going eastward across the sill. There also appeared to be some evidence for possible multiple intrusions within this sill due to abrupt changes in mafic content of this sill.

Fractures

An attempt was made to map out fractures in an effort to try and find some sort of trend for vein development. No obvious trends were evident. Four general major trends of fracturing were observed these are:

1) Fractures along the strike of the sill (possibly related to folding or perhaps chill margin effects),

- 2) Fractures across the sill (generally contemporaneous with type 1 and possibly due to the same reasons)
- 3) Circular concentric fractures (due to cooling of the diabase in individual thermal cells) and
- 4) A curvilinear fracture pattern that appears to separate regimes of the circular concentric fractures (a possible release of internal stress caused by numerous independent thermal cells).

Of all the above fracture types type 4 seemed to have the greatest frequency of metallic and carbonate veining.

Veins

There appears to be at least three separate mineral vein emplacement events. The first and most pervasive of these are the mafic specularite veins. These veins are the most abundant in the area and consist of coarsely crystalline dark amphibole and specularite. Plagioclase is uncommon in these veins so perhaps it may represent a tapping of a deep seated intrusion or perhaps an iron rich residual of Nipissing diabase. Generally these veins tend to be less than 2 centimeters wide. Very occasionally chalcopyrite has been observed in these veins.

The next vein event, although not very pervasive appears to be of massive chalcopyrite followed by chalcopyrite with calcite and cobalt and finally just calcite which is most common. As silver was not observed in the area its order of emplacement can not be determined although it is probably toward the end of the cobalt deposition.

The whole series of deposition, less silver, is observable as discreet contiguous symmetrical parallel ribbon veins in stripped area 11.

Assay Results

Anomalous values of metals were noted in most of the vein samples with copper being the most highly anomalous followed by cobalt. Silver nickel and gold while being elevated were of a significantly lower amount. The highest values came from the major

vein in stripped area 11 and also from the old deep slot trench to the east of trench 2.

CONCLUSION & RECOMMENDATIONS

As a result of the above study the following is evident:

- 1) Silver mineralization is uncommon in the veins tested.
- 2) There appears to be local areas with elevated copper and cobalt values in the study area.
- 3) It is suggested that the two anomalous areas i.e.: area 11 and the old slot trench be examined closer followed by a fine resolution EM survey and perhaps tested with a small portable drill for continuity.
- 4) It is also suggested that the lower depressions, devoid of outcrop be examined by an EM survey to determine potential vein mineralization. The association of recursively weathering carbonate and the number of nearby shafts may give credence for studying these areas. One of these areas lies just east and beyond the depth of the trenches.

CERTIFICATE

I, Robert G. Komarechka, of the City of Sudbury, in the Province of Ontario hereby certify as follows:

1. That I am a consulting geologist currently residing in Sudbury.
2. That I am a graduate, B.Sc. Geology major, of Laurentian University of Sudbury, Ontario, a registered professional geologist in the Province of Alberta affiliated with the Canadian Council of Professional Engineers, and that I have been practicing my profession for fourteen years.
3. That I do not have an interest in the properties.
4. That this report is based on field observations and information collected over the months of July, of 1998.



Robert G. Komarechka P. Geol.

Dated at Sudbury, Ontario, this 29th day of July, 1998.

APPENDICES

APPENDIX #1

Assays



Swastika Laboratories

A Division of Assayers Corporation Ltd.

Assaying - Consulting - Representation

Established 1928

Page 1 of 2

Geochemical Analysis Certificate

8W-1991-RG1

Company: **LAKE SUPERIOR RESOURCES**

Date: JUL-21-98

Project:

Attn: **B. Komarechka/F. Swain**

We hereby certify the following Geochemical Analysis of 35 Rock samples submitted JUL-16-98 by .

Sample Number	Au PPB	Au Check PPB	Ag PPM	Bi PPM	Co PPM	Cu PPM	Cu %	Ni PPM
BK0001	10	-	1.0	1	231	248	-	36
BK0002	72	86	6.5	1	200	4040	-	28
BK0003	14	-	1.1	2	1170	1850	-	69
BK0004	27	-	1.6	1	545	500	-	59
BK0005	Nil	-	0.2	1	132	169	-	39
BK0006	7	-	0.1	1	93	172	-	41
BK0007	24	31	0.1	1	225	539	-	31
BK0008	10	-	1.0	1	403	1890	-	34
BK0009	5	-	0.5	1	42	98	-	15
BK0010	3	-	3.0	1	186	173	-	72
BK0011	Nil	-	0.2	1	76	267	-	32
BK0012	Nil	-	0.1	1	87	459	-	32
BK0013	22	-	1.5	1	539	753	-	33
BK0014	12	-	0.8	1	168	760	-	8
BK0015	51	51	0.1	1	378	133	-	29
BK0016	2	-	0.1	1	194	604	-	24
BK0017	7	-	0.6	1	1090	339	-	84
BK0018	26	-	29.2	24	292	4660	-	75
BK0019	3	-	0.8	1	184	481	-	38
BK0020	Nil	-	0.1	1	272	489	-	42
BK0021	139	137	57.9	8	3170	>20000	7.21	153
BK0022	87	-	14.4	1	1980	12400	-	61
BK0023	70	-	145.8	53	6750	4240	-	534
BK0024	Nil	-	2.2	1	55	971	-	14
BK0025	2	-	0.7	1	73	650	-	21
BK0026	**	-	0.2	1	79	982	-	38
BK0027	22	-	0.7	1	78	1530	-	21
BK0028	14	-	7.1	1	497	>20000	4.70	47
BK0029	24	-	8.8	1	290	>20000	4.38	40
BK0030	48	45	98.8	144	7670	>20000	21.75	288

One assay ton portion used.

** Indicates insufficient sample for gold assay.

Certified by

1 Cameron Ave., P.O. Box 10, Swastika, Ontario P0K 1T0

Telephone (705)642-3244 Fax (705)642-3300



Established 1928

Swastika Laboratories

A Division of Assayers Corporation Ltd.

Assaying - Consulting - Representation

Page 2 of 2

Geochemical Analysis Certificate

8W-1991-RG1

Company: LAKE SUPERIOR RESOURCES

Date: JUL-21-98

Project:

Aun: B. Komarechka/F. Swain

We hereby certify the following Geochemical Analysis of 35 Rock samples submitted JUL-16-98 by .

Sample Number	Au PPB	Au Check PPB	Ag PPM	Bi PPM	Co PPM	Cu PPM	Cu %	Ni PPM
BK0031	144	-	45.8	80	16100	>20000	10.32	854
BK0032	39	-	38.8	91	13500	>20000	4.31	752
BK0033	151	165	4.1	10	1050	2870	-	72
BK0034	14	-	0.3	1	70	891	-	25
BK0035	Nil	-	0.1	1	74	243	-	34

One assay ton portion used.

Certified by

APPENDIX 2

DIMENSIONS OF TRENCHES

FARR TWP

TO: ~~Bob K~~ - BOB K.
FROM: FRED SWAIN

FARR TWP.

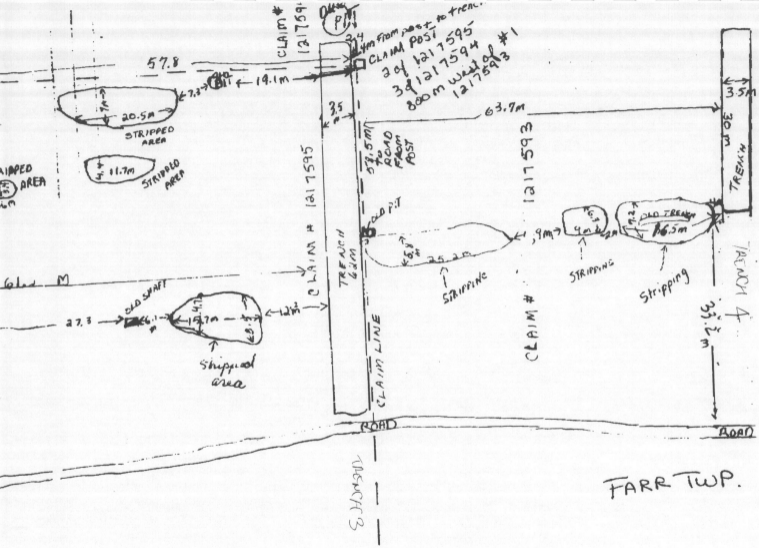

CLAIM # 1217594

CLAIM # 1217595

CLAIM # 1217593

SHARPS

ROAD

ROAD

TRENCH #1

TRENCH #4

STRIPPED AREA

STRIPPED AREA

STRIPPED AREA

662 M

stripped area

STRIPPING

STRIPPING

Stripping

TRENCH #3

OLD PIT

ROAD TO ROOM FROM POST

35m

34m from post to trench
CLAIM POST
3 of 1217595
3 of 1217594
800m West of #1
1217593

OLD SHAFT
27.3

57.8

19.1m

20.5m

11.7m

35m

37.5m

63.7m

121m

121m

9m

4m

2m

16.5m

31.2m

30m

13m

5m

27.3

4.7m

19.7m

6.5m

ROAD

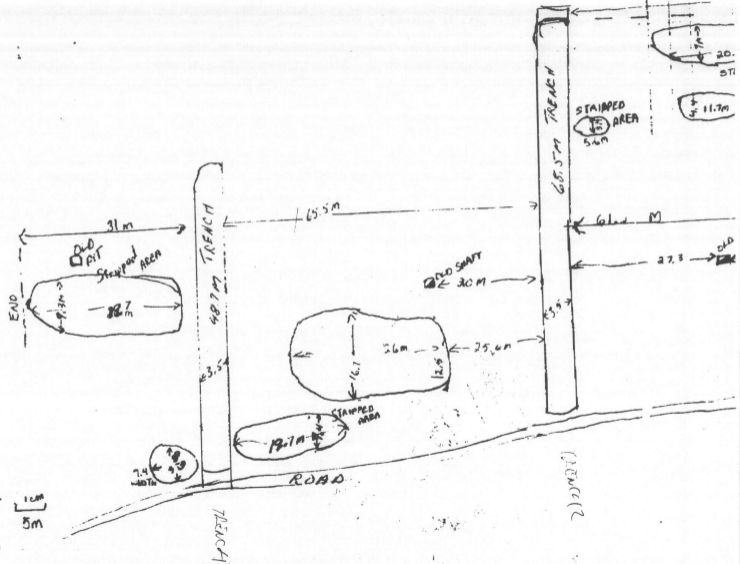
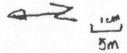



Declaration of Assessment Work Performed on Mining Land

Mining Act, Subsection 65(2) and 66(3), R.S.O. 1990

Transaction Number (office use) W9880,00455 Assessment File Research Imaging



41P16SW2004 2.18674 FARR

900

of subsections 65(2) and 66(3) of the Mining Act. Under section 8 of the o review the assessment work and correspond with the mining land holder. g Recorder, Ministry of Northern Development and Mines, 6th Floor,

Instructions: - For work performed on Crown Lands before recording a claim, use form 0240. - Please type or print in ink.

2.18674

1. Recorded holder(s) (Attach a list if necessary)

Form with fields for Name, Address, Client Number, Telephone Number, Fax Number for Lake Superior Resources Corporation.

2. Type of work performed: Check (✓) and report on only ONE of the following groups for this declaration.

Geotechnical: prospecting, surveys, assays and work under section 18 (regs) Physical: drilling, stripping, trenching and associated assays Rehabilitation

Form with fields for Work Type (Stripping, Trenching), Office Use, Dates Work Performed, Global Positioning System Data, Township/Area, Mining Division, Resident Geologist District.

Please remember to: - obtain a work permit from the Ministry of Natural Resources as required; - provide proper notice to surface rights holders before starting work; - complete and attach a Statement of Costs, form 0212; - provide a map showing contiguous mining lands that are linked for assigning work; - include two copies of your technical report.

3. Person or companies who prepared the technical report (Attach a list if necessary)

Form with fields for Name, Address, Telephone Number, Fax Number for Bedrock Consulting.

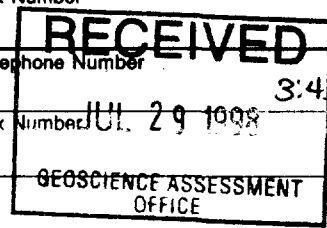

4. Certification by Recorded Holder or Agent

I, SHERRY SWAIN (Print Name), do hereby certify that I have personal knowledge of the facts set forth in this Declaration of Assessment Work having caused the work to be performed or witnessed the same during or after its completion and, to the best of my knowledge, the annexed report is true.

Form with fields for Signature of Recorded Holder or Agent (S. Swain), Date (July 28/98), Agent's Address (Box 1325, BRACEBRIDGE ON. P1L 1V4), Telephone Number (705-645-4109), Fax Number (same).

5. Work to be recorded and distributed. Work can only be assigned to claims that are contiguous (adjoining) to the mining land where work was performed, at the time work was performed. A map showing the contiguous link must accompany this form.

W9980.00485

Mining Claim Number. Or if work was done on other eligible mining land, show in this column the location number indicated on the claim map.	Number of Claim Units. For other mining land, list hectares.	Value of work performed on this claim or other mining land.	Value of work applied to this claim.	Value of work assigned to other mining claims.	Bank. Value of work to be distributed at a future date.
eg TB 7827	16 ha	\$26,825	N/A	\$24,000	\$2,825
eg 1234567	12	0	\$24,000	0	0
eg 1234568	2	\$8,892	\$4,000	0	\$4,892
1 1217593	16	\$6,500	\$6,400	\$100	0
2 1217595	1	\$23,217	400	\$22,817	0
3 1217594	12		4,800		
4 1218931	6		2,400		
5 1217592	2		800		
6 1217605	4		1,600		
7 1207400	10		4,000		
8 1213467	4		1,600		
9 1217613	3		1,200		
10 1217612	3		1,200		
11 1217606	1		400		
12 1213476	4		1,600		
13 1223944	6		2,400		
14 1217597	12		917		
15				\$22,917	
Column Totals		\$29,717	\$29,717	\$22,917	0

I, SHERY SWAIN (Print Full Name), do hereby certify that the above work credits are eligible under subsection 7 (1) of the Assessment Work Regulation 6/96 for assignment to contiguous claims or for application to the claim where the work was done.

Signature of Recorded Holder or Agent Authorized in Writing: S. Swain Date: July 28/98

6. Instructions for cutting back credits that are not approved.

Some of the credits claimed in this declaration may be cut back. Please check (✓) in the boxes below to show how you wish to prioritize the deletion of credits:

- 1. Credits are to be cut back from the Bank first, followed by option 2 or 3 or 4 as indicated.
- 2. Credits are to be cut back starting with the claims listed last, working backwards; or
- 3. Credits are to be cut back equally over all claims listed in this declaration; or
- 4. Credits are to be cut back as prioritized on the attached appendix or as follows (describe):

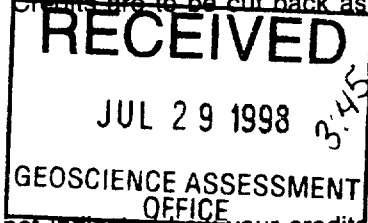

Note: If you have not indicated how your credits are to be deleted, credits will be cut back from the Bank first, followed by option number 2 if necessary.

For Office Use Only

Received Stamp	Deemed Approved Date	Date Notification Sent
	Date Approved	Total Value of Credit Approved
Approved for Recording by Mining Recorder (Signature)		



Statement of Costs for Assessment Credit

Transaction Number (office use)
W9880.00455

Personal information collected on this form is obtained under the authority of subsection 6(1) of the Assessment Work Regulation 6/96. Under section 8 of the Mining Act, the information is a public record. This information will be used to review the assessment work and correspond with the mining land holder. Questions about this collection should be directed to the Chief Mining Recorder, Ministry of Northern Development and Mines, 6th Floor, 933 Ramsey Lake Road, Sudbury, Ontario, P3E 6B5.

21,186.74

Work Type	Units of Work <small>Depending on the type of work, list the number of hours/days worked, metres of drilling, kilometres of grid line, number of samples, etc.</small>	Cost Per Unit of work	Total Cost
Mechanical overburden stripping	12 hr/day - 15 days	\$70/hr \$840/day	\$12,600
Manual labour	12 hr/day - 17 days	1 x \$168/day	\$ 2856
" "	" "	1 x \$216/day	\$ 3672
Manual labour included washing, stripping with shovels, digging			
Field supervision	12 hr/day - 17 days	1 x \$250/day	\$ 4250
Associated Costs (e.g. supplies, mobilization and demobilization).			
Rental costs including 2 pumps, 1000' fire hose, suction hose, fire nozzle, 2 chain saws, generator, 100' extension cord, winch, bush saw	2 weeks		\$ 1457
Supplies			\$ 274
Transportation Costs			
Truck & tandem trailer rental		\$145/day x 17	\$ 2465
ATV & trailer rental		2 weeks	\$1000
Food and Lodging Costs			
Lodging			\$ 500
Food			\$ 643
Total Value of Assessment Work			\$ 29717

Calculations of Filing Discounts:

1. Work filed within two years of performance is claimed at 100% of the above Total Value of Assessment Work.
2. If work is filed after two years and up to five years after performance, it can only be claimed at 50% of the Total Value of Assessment Work. If this situation applies to your claims, use the calculation below:

TOTAL VALUE OF ASSESSMENT WORK × 0.50 = Total \$ value of worked claimed.

Note:

- Work older than 5 years is not eligible for credit.
- A recorded holder may be required to verify expenditures claimed in this statement of costs within 15 days of a request for verification and/or correction/clarification. If verification and/or correction/clarification is not made, the Minister may reject all or part of the assessment work submitted.

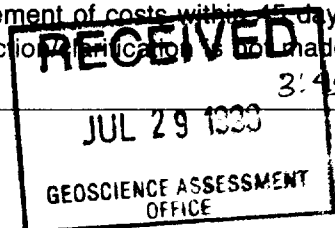

Certification verifying costs:

I, SHERRY SWAIN (please print full name), do hereby certify, that the amounts shown are as accurate as may reasonably be determined and the costs were incurred while conducting assessment work on the lands indicated on the accompanying Declaration of Work form as agent S. Swain (recorded holder, agent, or state company position with signing authority) I am authorized to make this certification.

Signature <u>S. Swain</u>	Date <u>July 28/98</u>
------------------------------	---------------------------



Declaration of Assessment Work Performed on Mining Land

Mining Act, Subsection 65(2) and 66(3), R.S.O. 1990

Transaction Number (office use) W9880 00456 Assessment Files Research Imaging

Personal information collected on this form is obtained under the authority of subsections 65(2) and 66(3) of the Mining Act. Under section 8 of the Mining Act, the information is a public record. This information will be used to review the assessment work and correspond with the mining land holder. Questions about this collection should be directed to the Chief Mining Recorder, Ministry of Northern Development and Mines, 6th Floor, 933 Ramsey Lake Road, Sudbury, Ontario, P3E 6B5.

Instructions: - For work performed on Crown Lands before recording a claim, use form 0240. - Please type or print in ink.

2.18674

1. Recorded holder(s) (Attach a list if necessary)

Name: Lake Superior Resources Corporation, Client Number: 302231, Address: 35 Deloraine Ave., Toronto, ON M5M 2A8, Telephone Number: 416-488-1345

2. Type of work performed: Check (✓) and report on only ONE of the following groups for this declaration.

- Geotechnical: prospecting, surveys, assays and work under section 18 (regs)
Physical: drilling, stripping, trenching and associated assays
Rehabilitation

Work Type: Assays, Geological mapping on mapped and stripped areas, Office Use: Commodity, Total \$ Value of Work Claimed: 3680, Dates Work Performed: From 8/7/98 To 27/7/98, Township/Area: Farr Twp., Mining Division: Sudb. Lake, Resident Geologist District: Kirkland Lake

Please remember to: - obtain a work permit from the Ministry of Natural Resources as required; - provide proper notice to surface rights holders before starting work; - complete and attach a Statement of Costs, form 0212; - provide a map showing contiguous mining lands that are linked for assigning work; - include two copies of your technical report.

3. Person or companies who prepared the technical report (Attach a list if necessary)

Name: Bedrock Consulting, Telephone Number: 705-673-0873, Address: Suite 1, 537 Haig St., Sudbury, ON P3C 1E2, Fax Number: 705-673-0873

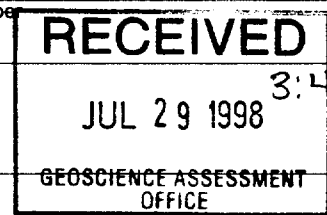

4. Certification by Recorded Holder or Agent

I, SHERRY SWAIN, do hereby certify that I have personal knowledge of the facts set forth in this Declaration of Assessment Work having caused the work to be performed or witnessed the same during or after its completion and, to the best of my knowledge, the annexed report is true.

Signature of Recorded Holder or Agent: S. Swain, Date: July 28/98, Agent's Address: Box 1375, Bracebridge ON, P1L1V4, Telephone Number: 705-6454109, Fax Number: same

** Amendment*

JUL 30 '98 10:04 FR GEOSCIENCE ASSESSMENT 7056705881 1U 817056454109 P.02/02

5. Work to be recorded and distributed. Work can only be assigned to claims that are contiguous (adjoining) to the mining land where work was performed, at the time work was performed. A map showing the contiguous link must accompany this form.

W9880.00456

Mining Claim Number. Or if work was done on other eligible mining land, show in this column the location number indicated on the claim map.	Number of Claim Units. For other mining land, list hectares.	Value of work performed on this claim or other mining land.	Value of work applied to this claim.	Value of work assigned to other mining claims.	Bank. Value of work to be distributed at a future date.
eg TB 7627	16 ha	\$26,825	N/A	\$24,000	\$2,825
eg 1234567	12	0	\$24,000	0	0
eg 1234560	2	\$ 9,892	\$ 1,000	0	\$4,892
1 1217593	16	\$1030	0	0	\$1030
2 1217595	1	\$2650	\$400	<i>1143 JB.</i> \$3183	<i>1107 JB.</i> \$1067 JB.
3 1077201	3	0	\$400		
4 1217597	12	0	\$743		
5					
6					
7					
8					
9					
10					
11					
12					
13					
14					
16					
Column Totals		\$3660	\$1543	<i>1143 JB.</i> \$3183	<i>2137</i> \$2097

RECEIVED
JUL 30 1998
10:15
GEOSCIENCE ASSESSMENT
OFFICE

I, *SHERY SWAIN* (Print Full Name), do hereby certify that the above work credits are eligible under subsection 7 (1) of the Assessment Work Regulation 6/96 for assignment to contiguous claims or for application to the claim where the work was done.

Signature of Recorded Holder or Agent Authorized in Writing: *A. Swain* Date: *July 28/98*

6. Instructions for cutting back credits that are not approved.

Some of the credits claimed in this declaration may be cut back. Please check (✓) in the boxes below to show how

RECEIVED
JUL 29 1998
8:45
GEOSCIENCE ASSESSMENT
OFFICE

Note: If you have not indicated how your credits are to be deleted, credits will be cut back from the Bank first, followed by option number 2 if necessary.

For Office Use Only

Received Stamp	Deemed Approved Date	Date Notification Sent
	Date Approved	Total Value of Credit Approved
	Approved for Recording by Mining Recorder (Signature)	

Personal information collected on this form is obtained under the authority of subsection 6(1) of the Assessment Work Regulation 6/96. Under section 8 of the Mining Act, the information is a public record. This information will be used to review the assessment work and correspond with the mining land holder. Questions about this collection should be directed to the Chief Mining Recorder, Ministry of Northern Development and Mines, 6th Floor, 933 Ramsey Lake Road, Sudbury, Ontario, P3E 6B5.

Work Type	Units of Work <small>Depending on the type of work, list the number of hours/days worked, metres of drilling, kilometres of grid line, number of samples, etc.</small>	Cost Per Unit of work	Total Cost
Geological mapping	5 days- 35 samples	\$300/day	\$1500
Report preparation	2 days	\$300/day	\$ 600
Associated Costs (e.g. supplies, mobilization and demobilization).			
Assays	35 assays		\$805.74
Supplies			\$23.28
shipping samples			\$12.68
Field Supplies			\$17.30
Transportation Costs			
Vehicle			\$416.25
Food and Lodging Costs			
Lodging			\$225
Food			80.59
Total Value of Assessment Work			\$3680.84

Calculations of Filing Discounts:

1. Work filed within two years of performance is claimed at 100% of the above Total Value of Assessment Work.
2. If work is filed after two years and up to five years after performance, it can only be claimed at 50% of the Total Value of Assessment Work. If this situation applies to your claims, use the calculation below:

$$\text{TOTAL VALUE OF ASSESSMENT WORK} \times 0.50 = \text{Total \$ value of worked claimed.}$$

Note:

- Work older than 5 years is not eligible for credit.
- A recorded holder may be required to verify expenditures claimed in this statement of costs within 45 days of a request for verification and/or correction/clarification. If verification and/or correction/clarification is not made, the Minister may reject all or part of the assessment work submitted.

Certification verifying costs:

I, SHERRY SWAIN (please print full name), do hereby certify, that the amounts shown are as accurate as may reasonably be determined and the costs were incurred while conducting assessment work on the lands indicated on the accompanying Declaration of Work form as agent (recorded holder, agent, or state company position with signing authority) I am authorized to make this certification.

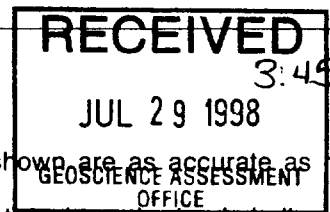

Signature <i>S. Swain</i>	Date <i>July 28/98</i>
------------------------------	---------------------------

Geoscience Assessment Office
933 Ramsey Lake Road
6th Floor
Sudbury, Ontario
P3E 6B5

Telephone: (888) 415-9846
Fax: (877) 670-1555

October 8, 1998

LAKE SUPERIOR RESOURCES CORPORATION
35 DELORAINE AVENUE
TORONTO, ONTARIO
M5M-2A8

Visit our website at:
www.gov.on.ca/MNDM/MINES/LANDS/mlsmnpge.htm

Dear Sir or Madam:

Submission Number: 2.18674

Status

Subject: Transaction Number(s):

W9880.00455	Deemed Approval
W9880.00456	Deemed Approval

We have reviewed your Assessment Work submission with the above noted Transaction Number(s). The attached summary page(s) indicate the results of the review. **WE RECOMMEND YOU READ THIS SUMMARY FOR THE DETAILS PERTAINING TO YOUR ASSESSMENT WORK.**

If the status for a transaction is a 45 Day Notice, the summary will outline the reasons for the notice, and any steps you can take to remedy deficiencies. The 90-day deemed approval provision, subsection 6(7) of the Assessment Work Regulation, will no longer be in effect for assessment work which has received a 45 Day Notice. Allowable changes to your credit distribution can be made by contacting the Geoscience Assessment Office within this 45 Day period, otherwise assessment credit will be cut back and distributed as outlined in Section #6 of the Declaration of Assessment work form.

Please note any revisions must be submitted in **DUPLICATE** to the Geoscience Assessment Office, by the response date on the summary.

If you have any questions regarding this correspondence, please contact Lucille Jerome by e-mail at jeromel2@epo.gov.on.ca or by telephone at (705) 670-5858.

Yours sincerely,



ORIGINAL SIGNED BY
Blair Kite
Supervisor, Geoscience Assessment Office
Mining Lands Section

Work Report Assessment Results

Submission Number: 2.18674

Date Correspondence Sent: October 08, 1998

Assessor: Lucille Jerome

Transaction Number	First Claim Number	Township(s) / Area(s)	Status	Approval Date
W9880.00455	1217593	FARR	Deemed Approval	September 29, 1998

Section:

10 Physical PSTRIP
10 Physical PTRNCH

Transaction Number	First Claim Number	Township(s) / Area(s)	Status	Approval Date
W9880.00456	1217593	FARR	Deemed Approval	September 29, 1998

Section:

12 Geological GEOL

Correspondence to:

Resident Geologist
Kirkland Lake, ON

Assessment Files Library
Sudbury, ON

Recorded Holder(s) and/or Agent(s):

Sherry Swain
BRACEBRIDGE, ONTARIO, CANADA

LAKE SUPERIOR RESOURCES CORPORATION
TORONTO, ONTARIO

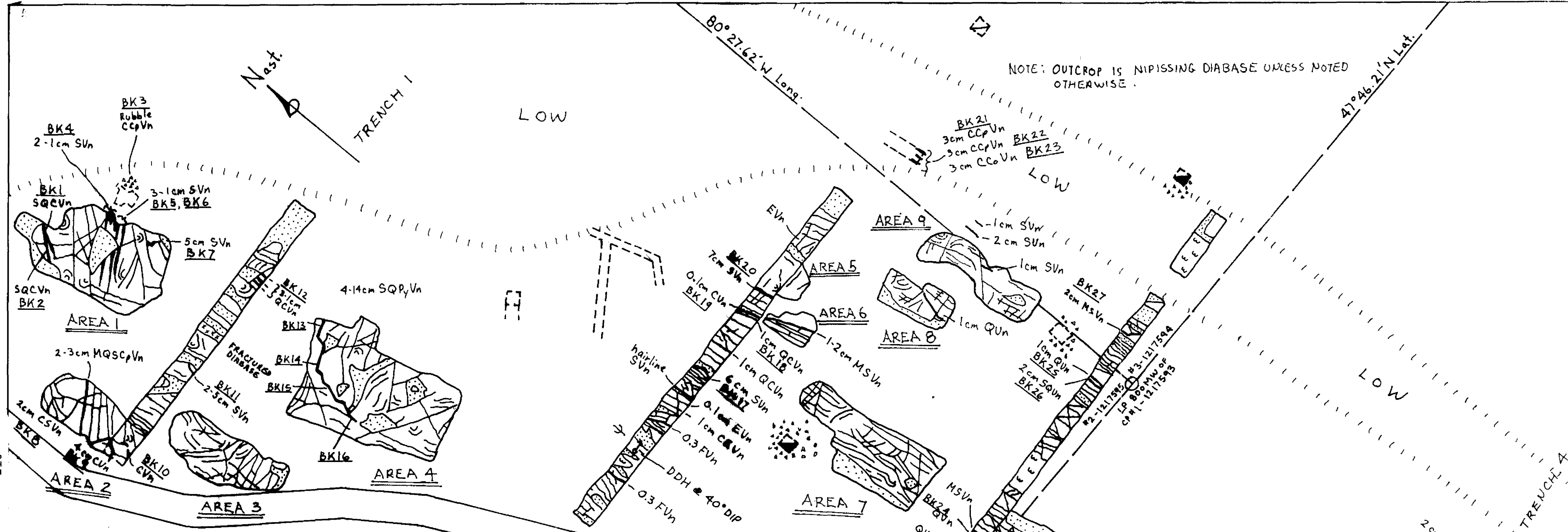

NOTE: OUTCROP IS NIPISSING DIABASE UNLESS NOTED OTHERWISE.

MAP 2 - GEOLOGY

INDEX

- FRACTURES
- DIRT, WATER
- RUBBLE
- VEIN
- 2-3cm MQSCpVn - 2-3cm wide mafic, quartz, specularite, chalcopyrite vein
- FVn - Felsic Vein
- EVn - Epidote Vein
- CCoVn - Carbonate cobalt vein
- BK17 - Sample # Location

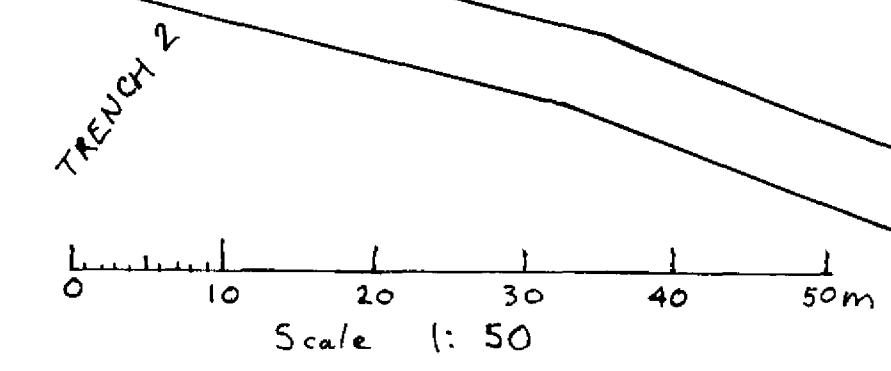

NOTE: DOTTED LINES INDICATES OLD WORKINGS

210
 41P16SW2004 2.18674 FARR