

42A01NE0015 2.15709 MAISONVILLE

010

GEOLOGICAL REPORT

TWIN LAKES PROPERTY

FOR

L. M. DYMENT AND J. A. KIDSTON

MAISONVILLE TOWNSHIP

LARDER LAKE MINING DIVISION

NTS 42A/1

2.15709

NOVEMBER 9, 1994

Deal # 2.2903.

L.M. DYMENT
BOX 66, SWASTIKA, ONTARIO

RECEIVED
NOV 21 1994
K... ..CH



42A01NE0015 2.15709 MAISONVILLE

010C

TABLE OF CONTENTS

	PAGE
1. INTRODUCTION.....	1
1.1 Location and Access.....	1
Figure 1.....Property location map	
Figure 2.....Claim location map	
1.2 Physiography.....	2
1.3 Claim information.....	4
Table 1.....	5
1.4 Property history.....	6
2.0 GEOLOGY.....	8
2.1 Regional geology.....	8
2.2 Stratigraphy and structural geology.....	9
Figure 3.....District geology of Timmins-Kirkland Lake	
2.3 Mineral deposits.....	11
3.0 GEOPHYSICS.....	12
3.1 Airborne geophysics.....	12
4.0 PROPERTY GEOLOGY.....	13
4.1 General.....	13
4.2 Discussion.....	13
APPENDIX 1.....Claim holders	
APPENDIX 2.....Certification	
APPENDIX 3.....RECEIPTS	
MAP #1 Geology plan.....	1 inch = 200 ft

1.

INTRODUCTION

A geological mapping survey was carried out on the Maisonville property from September 4, 1993 to October 31, 1993. The survey was carried out on new lines cut and picketed for that purpose.

A total of 7000' of baseline and tie-lines were cut and 43,300' of crosslines, 300' apart, were cut. The lines were oriented E-W.

LOCATION AND ACCESS

The property is located 10 miles NW of the town of Kirkland Lake. Access to the property from Kirkland Lake is West on HWY 66 11 miles to Kenogami, and North on HWY 11 16 miles to White Clay River bridge. The property can then be accessed on foot, East, 1/2 mile from the bridge. The property is crossed by the TransCanada Pipeline and comprises the N1/ Lot 9 Concession IV, S1/2 Lot 9 Concession IV, S1/2 of the S1/2 Lot 10 Concession IV, Maisonville Township.

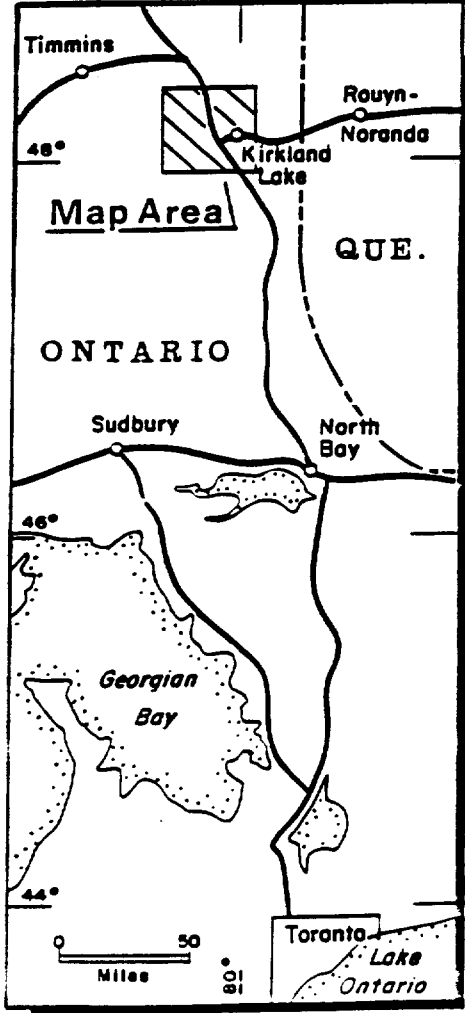
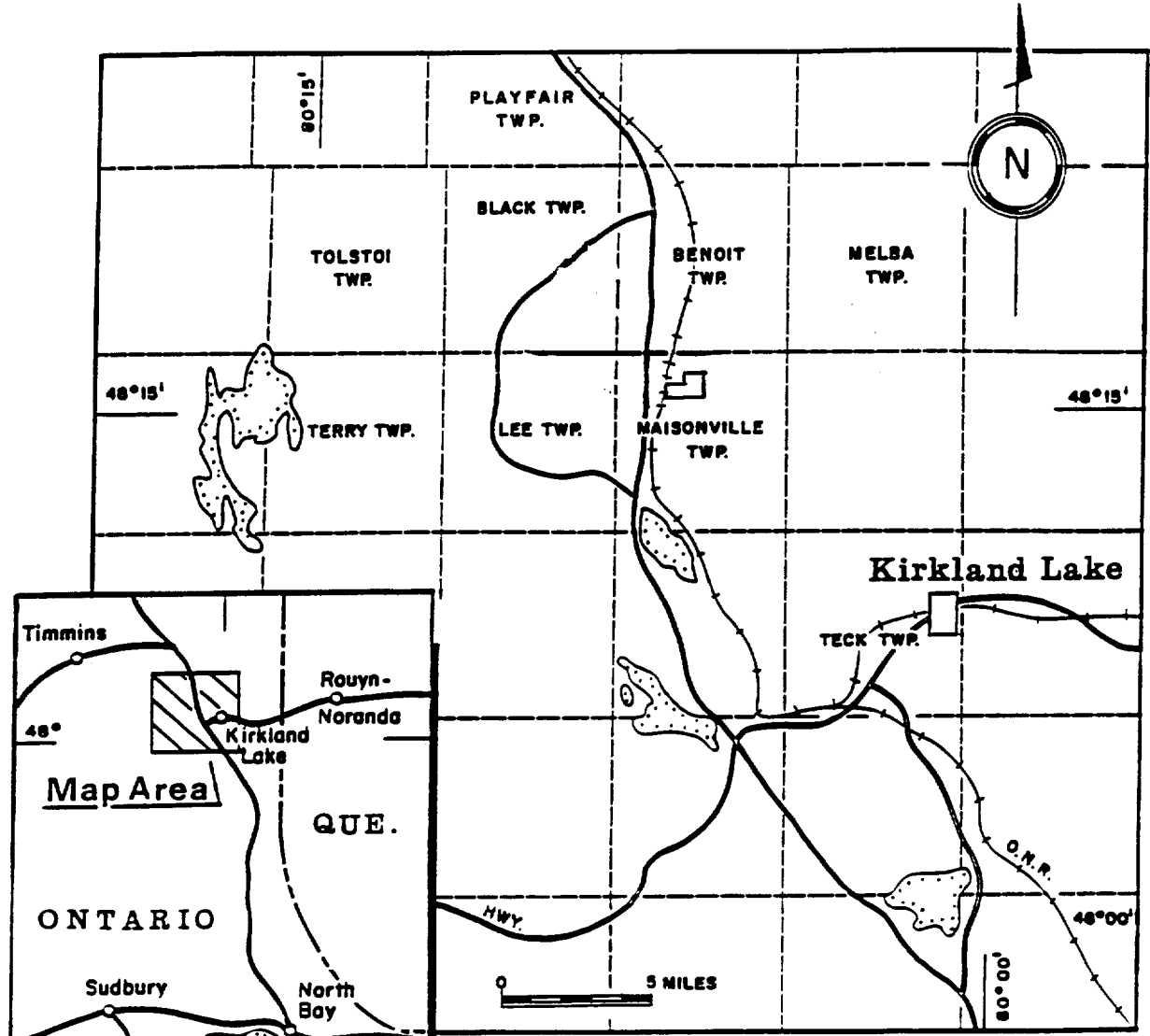

Property Location

fig.1

PHYSIOGRAPHY

Topographical relief in most of the map-area is low, but elevations above sea level range from 1,024 ft at the bench mark at Sese kinika village in Maisonville Township to about 1,400 ft in the West-central part of Black Township. The highest cliff in the map-area is "Defiance Peak", a ridge of typically resistant Cobalt sedimentary rocks rising 350 ft above the surrounding Keewatin volcanic rocks. Defiance Peak is in the Northeastern part of Black Township, about 1/2 Mile West of the South end of Butler Lake.

The height of land separating the watershed of the St. Lawrence River system from the James Bay trends approximately East through the central parts of Terry, Lee, and Maisonville townships. In Maisonville Township on HWY 11 less than 1/2 mile North of its junction with HWY 570 (to Sese kinika village), a signboard marks the location of the Southern boundary of the "Arctic Watershed", where the elevation of the "Hudson Bay-St. Lawrence Divide" is 1,062 ft above sea level.

The map-area has been cut over several times for lumber, firewood and pulpwood. A few whit and red pines are present around Swan and Upper and Lower Twin Lakes. The best stand grows in thin soil on the Cobalt sedimentary rocks.

PHYSIOGRAPHY cont'd

Both Benoit and Maisonville Townships were subdivided into concessions and lots, but in Maisonville Township only a few acres East of Sesekinika village and North of Lower Twin Lake were cleared for farming. Much of the farmland has not been fertilized or tilled sufficiently. Many farms have been abandoned, and several old fields are covered by young poplar and underbrush.

CLAIM INFORMATION

The property consists of 10 unpatented claims containing 25 units. The claims on which work was performed for this report are:

1187030.....4 units
1186913.....4 units
1186821.....2 units

The current expiry dates before approval of the work in this report are shown on Table 1.

The claims are held 50/50 by L. M. Dyment and J. A. Kidston.

CLAIM #	UNITS	RECORD DATE	VALUE APPLIED	RESERVE	EXPIRY DATE
1185611	1	Dec 6, 91	\$2400.00		
1185612	1	Dec 6, 91	\$2400.00		
1185613	1	Dec 6, 91	\$2400.00	\$456.00	
1186821	2	Aug 17, 92	\$5100.00		
1186913	4	Sep 25, 92	\$8300.00		
1187029	2	Feb 23, 93			
1187030	4	Feb 23, 93	\$3375..00		
1179843	1	Mar 25, 91	\$2400.00	\$2385.00	
1179844	1	Mar 25, 91	\$2400.00	\$1565.00	
1200783	8	Nov 2, 93			
TOTAL	25				

PROPERTY HISTORY

A search of the Kirkland Lake assessment files disclosed the following on overlapping and contiguous claims:

ELZINA GML---AFRO 765---PROP RPT---1938
 PETERSON, W--AFRO2260---DDH, RPT---1952
 GSC-----MAP 20, 150 G---AMAG--1975
 OGS-----AEM, AMAG---1979
 BRONSON MINES-AFRO 284--MAF,VLFEM--1980-81
 GOLIATH MINES-AFRO 1019-DDH-----1981
 GLEN AUDEN MINES-AFRO 951-AMAG,AEM-1985
 NORANDA-----AFRO 2017----AMAG,AEM-1985

Several trenches and pits were located for which there are no records. The airborne Mag and EM flown by both government and industry proved very helpful in delineating possible shears and faults. These surveys are listed above with their KL assessment file number and map number.

Following are the descriptions of two historical properties contained within the present claim group:

WARREN PETERSON in the Northwest corner of claim 1186913 In Maisonville Township, Concession IV, Lot 9, S1/2, NW1/4 in the Northwest quarter of the claim is the main (copper) showing. The showing is on the East side of a North-trending ridge of mafic volcanic rocks and consists of syenite and mafic volcanic rocks cut by quartz stringers containing cubic pyrite and fine-grained chalcopyrite. A dike of "pebble" lamprophyre cut by a feldspar porphyry stringer occurs in the Northeast corner of one pit. In 1952, three holes (totalling 1,000.5 ft) drilled near the showings intersected a number of weakly mineralized zones in sheared and massive mafic volcanic rocks cut by syenite dikes (ODMNA files, KL).

PROPERTY HISTORY cont'd

ELZINA MINES LIMITED

In Maisonville Township, Concession IV, Lot 10, S1/2, narrow quartz-carbonate veins cut hornblende syenite and gabbro. The No. 1 vein, striking N60E and dipping 50 to 70N, ranges from 3 to 14 inches wide along its stripped length of 200 feet. Grab samples taken at intervals along the vein returned assays of: 0.02, 0.03, 0.02, 0.01, and 0.25 oz gold/ton (D.K. Burke, 1938). Three holes have been drilled on the property, but no information on them is available.

2.0 GEOLOGY

2.1 REGIONAL GEOLOGY

The Maisonville Township property is situated on the Southwestern flank of the Abitibi Greenstone Belt of the Superior Province. The volcanic and sedimentary rocks of the Timmins-Noranda portion of the Abitibi Greenstone Belt form a large Easterly trending synclinorium. Domal tonalite to trondhjemitic batholiths and gneissic terrains are present to the North, South, and West of this synclinorium. Two major fault zones, the Destor-Porcupine and the Kirkland Lake Cadillac transect the Northern and Southern limbs.

Numerous small plutons of granodiorite to syenitic composition cut all the volcanic and sedimentary rocks. Diabase dykes varying from Archean to Late Proterozoic in age occur throughout the area, and Proterozoic sedimentary rocks of the Huronian Supergroup onlap the Archean rocks to the South (L.S.Jensen, 1986).

2.2
STRATIGRAPHY AND STRUCTURAL GEOLOGY

KINOJEVIS SOUTH ASSEMBLAGE

The main units of the Kinojevis South assemblage include massive and pillowed metabasalt of tholeiitic affinity (Goodwin 1979). Only very local, and minor, metamorphosed interbedded iron formation, tuff and clastic metasedimentary rocks are present (Thomson 1943; Thomson and Griffis, 1944). Metabasalt members locally display amygdules and/or spherules. Intrusions include gabbro, diorite, quartz gabbro, quartz diorite, granite, syenite and feldspar plus or minus quartz porphyry. A syenitic phase of the Winnie stock, the main felsic intrusion within the Kinojevis assemblage is 2677 plus or minus 2 Ma (Frarey and Krogh, 1986).

The assemblage is folded, faulted, and intruded by numerous small felsic intrusions and consequently displays a much more convoluted aeromagnetic pattern. The major structures include the Beaver Lake Syncline and the Spectacle Lake Anticline, the latter being cored by the calc-alkalic Gauthier assemblage (Thomson and Griffis, 1944). These structures are upright, East trending, and shallowly to moderately plunging (Hamilton, 1986). The Spectacle Lake Anticline has Timiskaming assemblage rocks on both limbs (Thomson and Griffis, 1944; Jackson, 1988), and therefore, is a post-Timiskaming structure. The axial surface of the anticline is truncated by the Larder-Cadillac shear zone, and therefore, predates the final development of this shear zone.

STRATIGRAPHY AND STRUCTURAL GEOLOGY cont'd

Metavolcanic rocks of the Kinojevis South assemblage are bounded to the: 1)North by the calc-alkalic Blake River assemblage; 2)South by the Timiskaming assemblage; and 3)West by the Proterozoic Huronian Supergroup and the Archean Watabeag Batholith.

The Kinojevis South assemblage is unconformably overlain by the -2685 to 2675 million-year-old (Corfu et al., in press) Timiskaming assemblage to the South. Detailed mapping indicates that the Kinojevis South assemblage was folded prior to the deposition of the Timiskaming. The Kinojevis South assemblage is more highly folded and contains more intrusions (e.g., Winnie Stock and Crosby gabbro sill).

Most faults are in metavolcanics. They strike North, approximately parallel to the diabase dykes and to the formations in Lee Township and the four Southern concessions of Maisonville Township. The faults are perpendicular to the axis of the older fold, the Southeast-plunging syncline.

East-striking syenite dykes in Maisonville Township intruded what might be a younger system of faults, perpendicular to the axis of the younger fold, the North-plunging synclinorium.

Most shear zones are in metavolcanics, strike North to Northwest (parallel to the volcanic strata in which they occur), and probably result from folding. A prominent exception is the Wendright Creek shear zone, which strikes Northeast along the contact of the Winnie Lake intrusion.

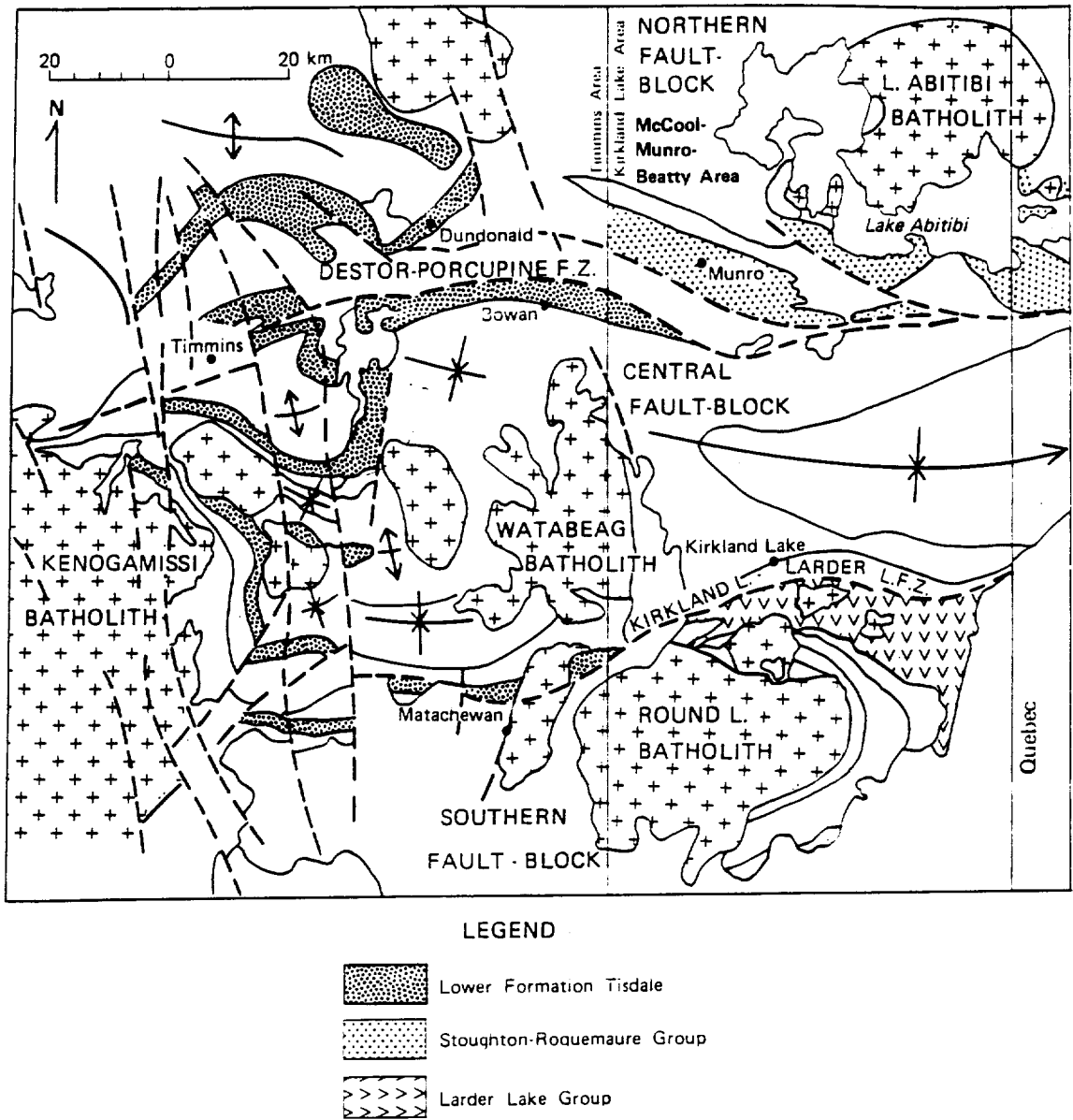

Fig 3. Geological map of the Timmins - Kirkland Lake area showing the distribution of komatiitic volcanic successions.

MINERAL DEPOSITS

Base metals, gold and silver are present in the survey area in economically interesting concentrations. Zinc, lead, and copper occur in quartz-carbonate veins and altered zones in graphitic cherty slate and chert or tuff, as well as in rhyolite breccia, and in sheared dacit, andesite, and basalt. Copper occurs also in quartz veins associated with gabbro, diorite, and granitic rocks. Nickel is in gabbro and diorite and in nearby metavolcanics. Molybdenite is in quartz veins, many of which are associated with granite and syenite. Gold is in grey and white quartz and quartz-carbonate veins and shear zones, much of the gold being associated with syenite. Silver is associated with gold and lead. Esker and glacial outwash sand and gravel are abundant in the survey area.

3.0 GEOPHYSICS

3.1 AIRBORNE GEOPHYSICS

At least three government airborne surveys and several industry airborne surveys have been flown in and around the area of this property. The surveys have been helpful in the interpretation of ground geophysical surveys. A list of these airborne surveys follows:

1975.....GSC map 20.....	AMAG
1979.....OGS KLIP Program.....	AEM, AMAG
1985.....Noranda Mines.....	AEM, AMAG
1990.....Joutel Resources.....	AEM, AMAG
1992.....GSC BLake River Geophysical Study.....	AEM, AMAG

Two examples of the airborne geophysical surveys flown over the claim group are included in this report as figures 4 and 5. The Noranda 1985 Terraquest interpretation map shows a long NE shear zone. Most shear zones in the map area strike North or Northwest with the exception of the Wendright Creek Shear which strikes NE along the contact of the Winnie Lake grabite intrusion.

4.0 PROPERTY GEOLOGY

4.1 GENERAL

From September 4, 1993 to October 31, 1993, geological mapping was conducted over the property by the property holders, L.M. Dyment and J. A. Kidston. The rough copy map was then turned over to Brian Madill Geoservices for drafting. A geological plan at 1"=200' can be found in the back pocket.

4.2 DISCUSSION

A combined geological and prospecting mapping effort was made using the geophysical results from a previous survey as a guide. A geological and sample map is included with this report.

Although no surface evidence of the NE fault zones was found, topographic features give credence to their existence. Abundant syenite intrusives are in close proximity to the inferred NE fault structures. Anomalous samples of Gold appear to be associated with the syenite.

SAMPLES

8M	iron-poor tholeiite garnet epidote 2% sulfide
9M	Qtz chlorite seam no sulfide
10M	iron-poor tholeiite garnet epidote 1% sulfide
11M	iron-poor tholeiite narrow qtz veins aplite 2% sulfide
12M	qtz milky white, pink inclusions 1% sulfide
13M	float qtz seam, gray inclusions 5-10% sulfide
14M	float with inclusions of euhedral pyrite

APPENDIX 1

CLAIM HOLDERS

L. MIKE DYMENT
BOX 66
SWASTIKA, ONTARIO
POK 1T0

50 PER CENT

JOCELYNE KIDSTON
BOX 66
SWASTIKA, ONTARIO
POK 1T0

50 PER CENT

SUPERVISION

L. Mike Dymont and Jocelyne Kidston

APPENDIX 2

CERTIFICATE

I, Leslie Michael Dymont, residing in the township of Marquis, Ontario, and having a mailing address of Jomi Minerals and Expediting Ltd., Box 66, Swastika, Ontario, P0K 1T0, do hereby certify:

- (1) That I am a Mining Technician having taken the two year course at Haileybury School of Mines, Haileybury, Ontario.
- (2) That I have been employed in all phases of mining exploration and development for 34 years.
- (3) That I did personally accumulate and set forth the facts and knowledge in the accompanying report and maps.
- (4) That the accompanying report is true.

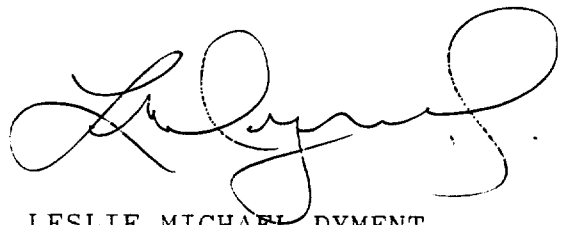
A handwritten signature in black ink, appearing to read 'Leslie Michael Dymont', written in a cursive style.

NOVEMBER 9, 1994
SWASTIKA, ONTARIO

LESLIE MICHAEL DYMENT

APPENDIX 3

Swastika Laboratories
 P.O. Box 10
 Swastika, Ontario
 P0K 1T0

INVOICE

NO.: 28621
 DATE: 08-21-93
 PAGE: 1 of 1

SOLD TO:

L.M. Dymont
 P.O. Box 66
 Swastika, Ontario
 P0K 1T0

SHIP TO:

Same

GST Number: R132862640

ITEM NO	QUANTITY	UNIT	DESCRIPTION	G	P	UNIT PRICE	AMOUNT
7		Code 1	Au Assays	3		8.000	56.00
7		Code 1	Sample Prep	3		3.000	21.00
			Cert #3W-2253-RG1				
			3-GST @ 7 %				5.39

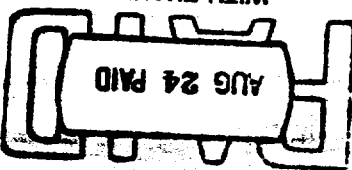
PER
 WITH THANKS

 SWASTIKA LABORATORIES
Paul Charter

COMMENTS:

Net 30 Days

TOTAL

82.39



Swastika Laboratories

A Division of TSL / ASSAYERS INC.

Assaying - Consulting - Representation

Established 1928

Geochemical Analysis Certificate

3W-2253-RG1

Company: **L. M. DYMENT**

Date: AUG-21-93

Project:

Attn:

We hereby certify the following Geochemical Analysis of 7 ROCK samples submitted AUG-16-93 by .

Sample Number	Au PPB	Au PPB
5051 8M	106	
5052 9M	27	
5053 10M	65	
5054 11M	922	922
5055 12M	175	
5056 13M	165	
5065 14M	319	336

Certified by



P.O. Box 10, Swastika, Ontario P0K 1T0

Telephone (705) 642-3244

FAX (705) 642-3300

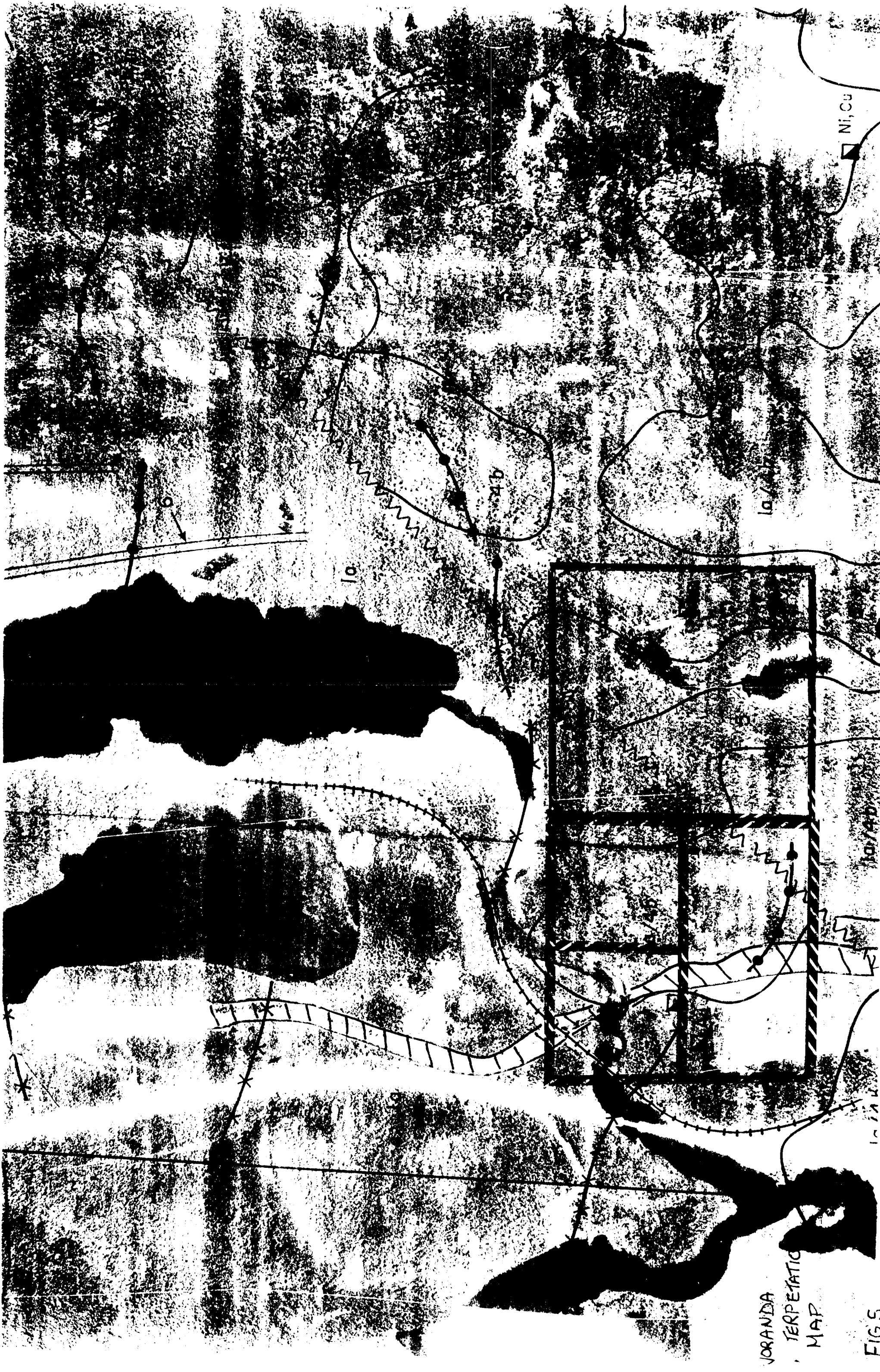

JORANDA
TERPETATIO
MAP

FIG. 5

4.0 PROPERTY GEOLOGY

4.1 GENERAL

From September 4, 1993 to October 31, 1993, geological mapping was conducted over the property by the property holders, L.M. Dymont and J. A. Kidston. The rough copy map was then turned over to Brian Madill Geoservices for drafting. A geological plan at 1"=200' can be found in the back pocket.

4.2 DISCUSSION

A combined geological and prospecting mapping effort was made using the geophysical results from a previous survey as a guide. A geological and sample map is included with this report.

Although no surface evidence of the NE fault zones was found, topographic features give credence to their existence. Abundant syenite intrusives are in close proximity to the inferred NE fault structures. Anomalous samples of Gold appear to be associated with the syenite.

SAMPLES

8M	iron-poor tholeiite garnet epidote 2% sulfide
9M	Qtz chlorite seam no sulfide
10M	iron-poor tholeiite garnet epidote 1% sulfide
11M	iron-poor tholeiite narrow qtz veins aplite 2% sulfide
12M	qtz milky white, pink inclusions 1% sulfide
13M	float qtz seam, gray inclusions 5-10% sulfide
14M	float with inclusions of euhedral pyrite

APPENDIX 1

CLAIM HOLDERS

L. MIKE DYMENT
BOX 66
SWASTIKA, ONTARIO
POK 1T0

50 PER CENT

JOCELYNE KIDSTON
BOX 66
SWASTIKA, ONTARIO
POK 1T0

50 PER CENT

SUPERVISION

L. Mike Dymont and Jocelyne Kidston

APPENDIX 2

CERTIFICATE

I, Leslie Michael Dymont, residing in the township of Marquis, Ontario, and having a mailing address of Jomi Minerals and Expediting Ltd., Box 66, Swastika, Ontario, P0K 1T0, do hereby certify:

- (1) That I am a Mining Technician having taken the two year course at Haileybury School of Mines, Haileybury, Ontario.
- (2) That I have been employed in all phases of mining exploration and development for 34 years.
- (3) That I did personally accumulate and set forth the facts and knowledge in the accompanying report and maps.
- (4) That the accompanying report is true.

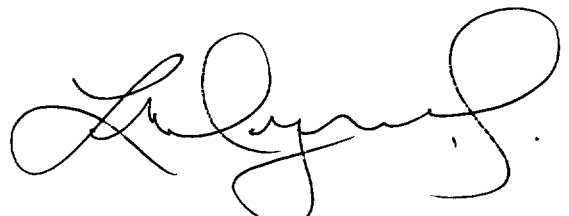

LESLIE MICHAEL DYMENT

NOVEMBER 9, 1994
SWASTIKA, ONTARIO

APPENDIX 3

Swastika Laboratories
P.O. Box 10
Swastika, Ontario
P0K 1T0

INVOICE

NO.: 28621
DATE: 08-21-93
PAGE: 1 of 1

SOLD TO:

L.M. Dymont
P.O. Box 66
Swastika, Ontario
P0K 1T0

SHIP TO:

Same

GST Number: R132862640

ITEM NO	QUANTITY	UNIT	DESCRIPTION	G	P	UNIT PRICE	AMOUNT
7		Code 1	Au Assays	3		8.000	56.00
7		Code 4	Sample Prep	3		3.000	21.00
			Cert #3W-2253-RG1				
			3-GST @ 7 %				5.39

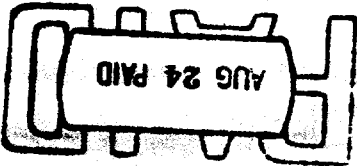
PER
WITH THANKS

SWASTIKA LABORATORIES
Paul Charter

COMMENTS:

Net 30 Days

TOTAL

82.39

SOLD TO MIKE DYMENT & JOCELYN KIDSTON
P.O. BOX 66
SHIP TO SWASTIKA, ONTARIO POK LTD
ADDRESS _____ VIA _____

OUR NUMBER	49389
DATE	NOV 22/93
CUSTOMER'S ORDER	
SALESMAN	B. MADILL
TERMS	
F. O. B.	

INVOICE

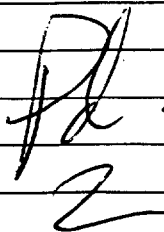
GEOLOGICAL DRAFTING					
PRICE @S AGREED				575	00
					
		TOTAL		575	00



Established 1928

Swastika Laboratories

A Division of TSL / ASSAYERS INC.

Assaying - Consulting - Representation

3W-2253-RG1

Date: AUG-21-93

Geochemical Analysis Certificate

Company: **L. M. DYMENT**

Project:

Attn:

We hereby certify the following Geochemical Analysis of 7 ROCK samples submitted AUG-16-93 by .

Sample Number	Au PPB	Au PPB
5051 8M	106	
5052 9M	27	
5053 10M	65	
5054 11M	922	922
5055 12M	175	
5056 13M	165	
5065 14M	319	336

Certified by *Dennis Chantre*



N.A.U.

Report of Work Conducted After Recording Claim

W 9480-00541

Transaction Number	0009
--------------------	------

Mining Act

Personal information collected on this form is obtained under the authority of the... his collection should be directed to the Provincial Manager, Mining Lands, 1 Sudbury, Ontario, P3E 6A5, telephone (705) 670-7264.



42A01NE0015 2.15708 MAISONVILLE

900

- Instructions:**
- Please type or print and submit in duplicate.
 - Refer to the Mining Act and Regulations for re... Recorder.
 - A separate copy of this form must be completed for each Work Group.
 - Technical reports and maps must accompany this form in duplicate.
 - A sketch, showing the claims the work is assigned to, must accompany this form.

Recorded Holder(s) L.M. DYMENT & J.A. KIDSTON		Client No. 128504 & 151995
Address BOX 66, SWASTIKA, ONT POK ITO		Telephone No. 642-3062
Mining Division LARDER LAKE	Township/Area MAISONVILLE	M or G Plan No. G-3669
Date Work Performed	From: SEPT 4, 1993	To: OCT 31, 1993

Work Performed (Check One Work Group Only)

Work Group	Type
<input checked="" type="checkbox"/> Geotechnical Survey	GEOLOGICAL
<input type="checkbox"/> Physical Work, Including Drilling	
<input type="checkbox"/> Rehabilitation	
<input type="checkbox"/> Other Authorized Work	
<input type="checkbox"/> Assays	
<input type="checkbox"/> Assignment from Reserve	

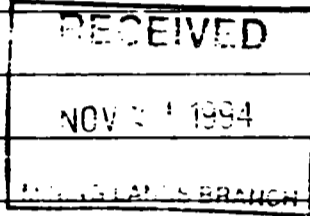

Total Assessment Work Claimed on the Attached Statement of Costs \$ 6177⁰⁰

Note: The Minister may reject for assessment work credit all or part of the assessment work submitted if the recorded holder cannot verify expenditures claimed in the statement of costs within 30 days of a request for verification.

Persons and Survey Company Who Performed the Work (Give Name and Address of Author of Report)

Name	Address
BRIAN MADILL	142 CARTER AVE KIRKLAND LAKE P2N 4Z4
SWASTIKA LAB	SWASTIKA, ONT POK ITO
L.M. DYMENT	BOX 66 SWASTIKA, ONT POK ITO
J.A. KIDSTON	BOX 66 SWASTIKA, ONT POK ITO

(attach a schedule if necessary)

Certification of Beneficial Interest * See Note No. 1 on reverse side

I certify that at the time the work was performed, the claims covered in this work report were recorded in the current holder's name or held under a beneficial interest by the current recorded holder.

Date	Recorded Holder or Agent (Signature)
NOV 10/94	<i>[Signature]</i>

Certification of Work Report

I certify that I have a personal knowledge of the facts set forth in this Work report, having performed the work or witnessed same during and/or after its completion and annexed report is true.

Name and Address of Person Certifying
L.M. DYMENT BOX 66 SWASTIKA, ONT POK ITO

Telephone No.	Date	Certified By (Signature)
642-3062	NOV. 10/94	<i>[Signature]</i>

For Office Use Only

Total Value Cr. Recorded	Date Recorded	Mining Recorder	Received Stamp
\$6177.	NOV. 01/94	<i>[Signature]</i>	<i>[Stamp]</i>
	Deemed Approval Date	Date Approved	
	Jan 9, 95		
	Date Notice for Amendments Sent		



Ministry of
Northern Development
and Mines

Ministère du
Développement du Nord
et des mines

**Statement of Costs
for Assessment Credit**

**État des coûts aux fins
du crédit d'évaluation**

Mining Act/Loi sur les mines

Transaction No./N° de transaction

W 00541

2.15709

Personal information collected on this form is obtained under the authority of the Mining Act. This information will be used to maintain a record and ongoing status of the mining claim(s). Questions about this collection should be directed to the Provincial Manager, Minings Lands, Ministry of Northern Development and Mines, 4th Floor, 159 Cedar Street, Sudbury, Ontario P3E 6A5, telephone (705) 670-7264.

Les renseignements personnels contenus dans la présente formule sont recueillis en vertu de la Loi sur les mines et serviront à tenir à jour un registre des concessions minières. Adresser toute question sur la collecte de ces renseignements au chef provincial des terrains miniers, ministère du Développement du Nord et des Mines, 159, rue Cedar, 4^e étage, Sudbury (Ontario) P3E 6A5, téléphone (705) 670-7264.

1. Direct Costs/Coûts directs

Type	Description	Amount Montant	Totals Total global
Wages Salaires	Labour Main-d'oeuvre	4500 ⁰⁰	
	Field Supervision Supervision sur le terrain		4500 ⁰⁰
Contractor's and Consultant's Fees Droits de l'entrepreneur et de l'expert- conseil	Type Report	300 ⁰⁰	
	DRAFTING	575 ⁰⁰	
	ASSAYS	82 ³⁹	957 ⁰⁰
Supplies Used Fournitures utilisées	Type		
Equipment Rental Location de matériel	Type		
Total Direct Costs Total des coûts directs			5457⁰⁰

2. Indirect Costs/Coûts indirects

** Note: When claiming Rehabilitation work Indirect costs are not allowable as assessment work.
Pour le remboursement des travaux de réhabilitation, les coûts indirects ne sont pas admissibles en tant que travaux d'évaluation.

Type	Description	Amount Montant	Totals Total global
Transportation Transport	Type 30 days X 80 KM X .30	720 ⁰⁰	
			720 ⁰⁰
Food and Lodging Nourriture et hébergement			
Mobilization and Demobilization Mobilisation et démobilisation			
Sub Total of Indirect Costs Total partiel des coûts indirects			720⁰⁰
Amount Allowable (not greater than 20% of Direct Costs) Montant admissible (n'excedant pas 20 % des coûts directs)			720⁰⁰
Total Value of Assessment Credit (Total of Direct and Allowable Indirect costs)			6197⁰⁰
Valeur totale du crédit d'évaluation (Total des coûts directs et indirects admissibles)			6197⁰⁰

Note: The recorded holder will be required to verify expenditures claimed in this statement of costs within 30 days of a request for verification. If verification is not made, the Minister may reject for assessment work all or part of the assessment work submitted.

Note : Le titulaire enregistré sera tenu de vérifier les dépenses déclarées dans le présent état des coûts dans les 30 jours suivant une demande à cet effet. Si la vérification n'est pas effectuée, le ministre peut rejeter tout ou une partie des travaux d'évaluation présentés.

Filing Discounts

1. Work filed within two years of completion is claimed at 100% of the above Total Value of Assessment Credit.
2. Work filed three, four or five years after completion is claimed at 50% of the above Total Value of Assessment Credit. See calculations below:

Total Value of Assessment Credit	Total Assessment Claimed
	× 0.50 =

Remises pour dépôt

1. Les travaux déposés dans les deux ans suivant leur achèvement sont remboursés à 100 % de la valeur totale susmentionnée du crédit d'évaluation.
2. Les travaux déposés trois, quatre ou cinq ans après leur achèvement sont remboursés à 50 % de la valeur totale du crédit d'évaluation susmentionné. Voir les calculs ci-dessous.

Valeur totale du crédit d'évaluation	Evaluation totale demandée
	× 0.50 =

Certification Verifying Statement of Costs

I hereby certify:
that the amounts shown are as accurate as possible and these costs were incurred while conducting assessment work on the lands shown on the accompanying Report of Work form.

that as RECORDED HOLDER I am authorized
(Recorded Holder, Agent, Position in Company)

to make this certification

Attestation de l'état des coûts

J'atteste par la présente :
que les montants indiqués sont le plus exact possible et que ces dépenses ont été engagées pour effectuer les travaux d'évaluation sur les terrains indiqués dans la formule de rapport de travail ci-joint.

Et qu'à titre de _____ je suis autorisé
(titulaire enregistré, représentant, poste occupé dans la compagnie)

à faire cette attestation.

Signature _____ Date NOV 10/94

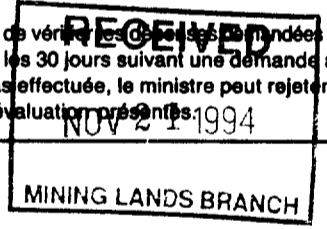



Ontario

Ministry of
Northern Development
and Mines

Ministère du
Développement du Nord
et des Mines

Geoscience Approvals Office
933 Ramsey Lake Road
6th Floor
Sudbury, Ontario
P3E 6B5

Telephone: (705) 670-5853
Fax: (705) 670-5863

December 14, 1994

Our File: 2.15709
Transaction#: W9480.00541

Mining Recorder
Ministry of Northern
Development and Mines
4 Government Road East
Kirkland Lake, Ontario
P2N 1A2

Dear Mr. Spooner:

**RE: Approval of Assessment Work on mining claim L1186821 et. al. in
Maisonville Township.**

The assessment credits for Geology, section 12 of the Mining Act Regulations, as listed on the original Report of Work, have been approved as of December 12, 1994.

Please indicate this approval on the claim record sheets.

If you have any questions concerning this submission please contact Dale Messenger at 670-5858.

ORIGINAL SIGNED BY:

Yours sincerely,

Ron C. Gashinski
Senior Manager, Mining Lands Section
Mining and Land Management Branch
Mines and Minerals Division

Wol
DEM/dl
Enclosures:

cc: Assessment Files Office ✓
Sudbury, Ontario

Resident Geologist
Kirkland Lake, Ontario

BENOIT TWP - M 326

2.15709
MAISONVILLE

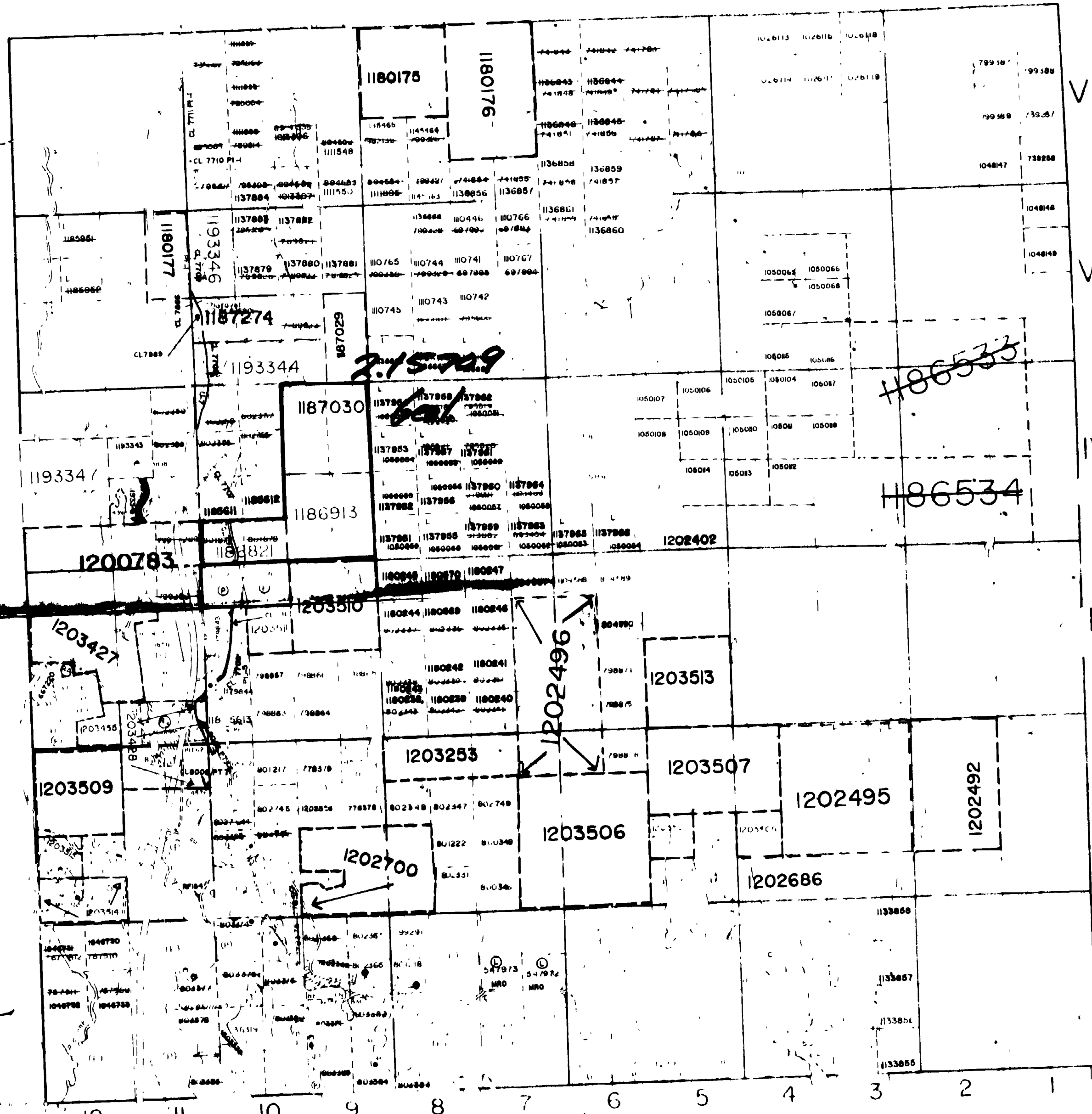

RECEIVED
NOV 21 1994
MINING LANDS BRANCH
TIMISKAMING
ARLBER LAKE
MINING DISTRICT

SCALE 1:50,000
NOTES

400' surface rights reserved by the state of Ontario
PENDING APPLICATION UNDER PUBLIC LANDS ACT
ALL CLAIMS IN CELEKINIA AREA ARE WITHDRAWN FROM STAKING BY ORDER IN COUNCIL DATED DEC 7 1991
SURFACE RIGHTS WITHDRAWN FROM STAKING, SEC. 43(7) NOV. 8, 1970 FILE 22032
SURFACE RIGHTS WITHDRAWN FROM STAKING, SEC. 43(7) NOV. 8, 1970 FILE 22032
SURFACE AND MINING RIGHTS WITHDRAWN FROM STAKING BY ORDER IN COUNCIL DATED JAN 27 1992

NOV 10 1994
Surface Rights Withdrawn under Sec 36 of the Mining Act R.S.O. 1980, ORDER NO. W-01/01/01/01
Trans Canada Pipeline Right of Way and Buffer Zone particularly 40.25 meters or 132 ft on either side of centre line of right of way
DATE RECEIVED JAN 20/89

PLAN NO G-3669

NOTICE OF FORESTRY ACTIVITY
THIS TOWNSHIP / AREA FALLS WITHIN THE TIMISKAMING MANAGEMENT UNIT AND MAY BE SUBJECT OF FORESTRY OPERATIONS. THE MNR UNIT FORESTER FOR THIS AREA CAN BE CONTACTED AT: P.O. BOX 129 SWASTIKA, ONT. POKITO 705-642-3222

COPY OF THIS MYLAR ARCHIVED DEC 04/91
COPY OF THIS MYLAR ARCHIVED JUN 1, 1992

THE INFORMATION THAT APPEARS ON THIS MAP HAS BEEN COMPILED FROM VARIOUS SOURCES, AND ACCURACY IS NOT GUARANTEED. THOSE WISHING TO STAKE MINING CLAIMS SHOULD CONSULT WITH THE MINING RECORDER, MINISTRY OF NORTHERN DEVELOPMENT AND MINES, FOR ADDITIONAL INFORMATION ON THE STATUS OF THE LANDS SHOWN HEREON



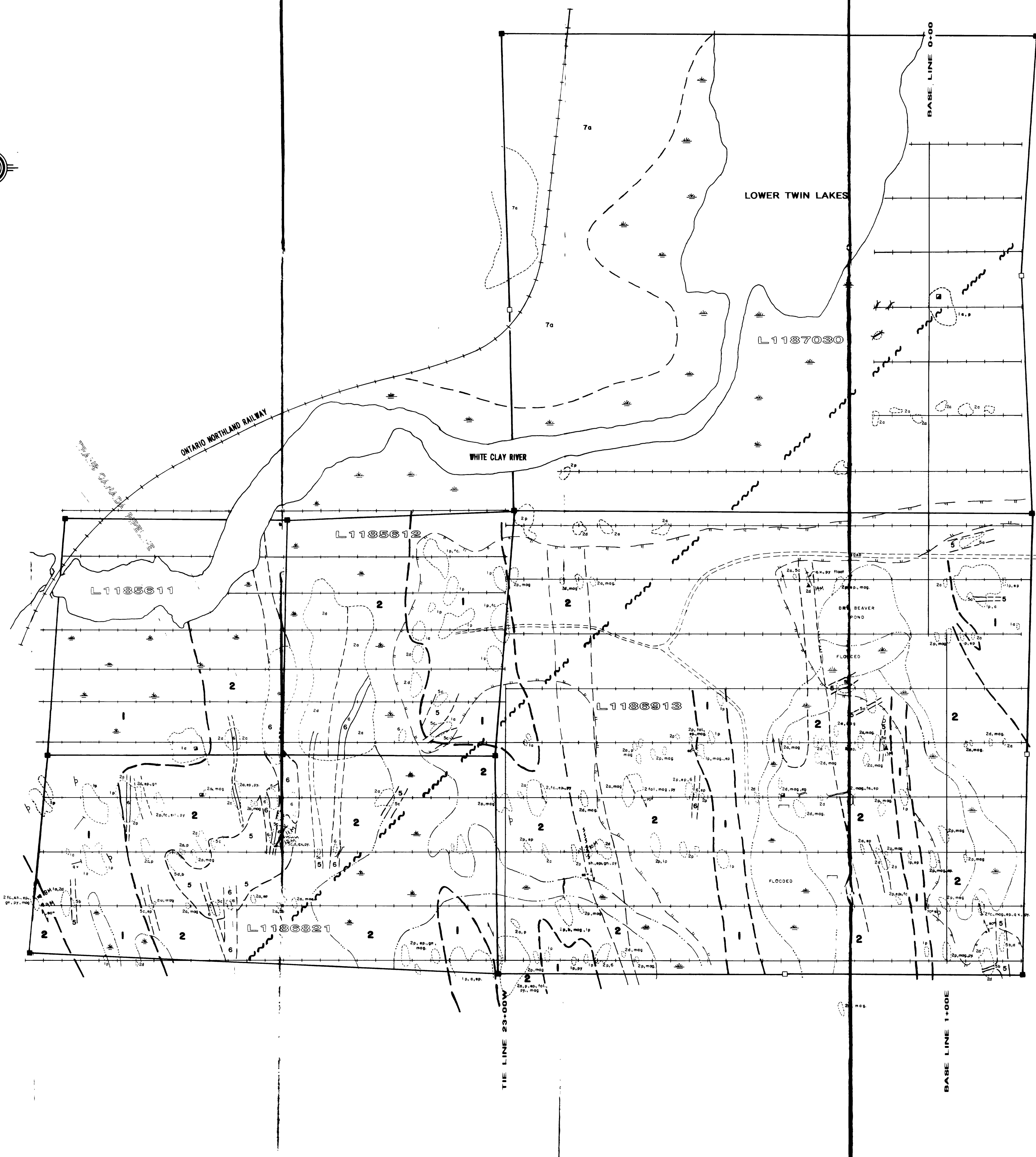
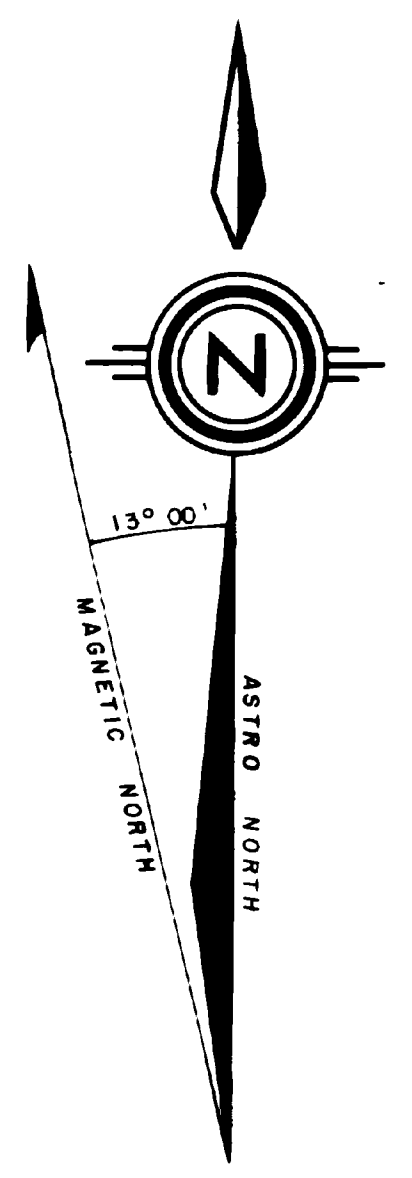

LEGEND

- VOLCANICS**
- 1 Iron-poor Basalts (NON-MAGNETIC)
 - a - massive
 - p - pillowed
 - 2 Iron-rich Basalts (MAGNETIC)
 - a - massive
 - d - coarse grained, dioritic/gabbroic
 - p - pillowed
- INTRUSIVES**
- 5 Felsic Intrusives
 - a - Quartz Porphyry
 - b - Feldspar Porphyritic Syenite
 - c - Syenite, red/pink
 - d - Mafic Syenite
 - 6 Diabase
- SEDIMENTS**
- 7a Conglomerate

SYMBOLS

- ep - epidote
- fc - fractured
- fol - foliated
- gn - garnet
- mag - magnetic
- py - pyrite
- qv - quartz vein
- sh - sheared
- pit
- trench
- pillow, strike, dip, tops
- foliation
- jointing
- grab sample 5M
- outcrop
- geological boundary
- geological boundary, assumed
- out over area
- swamp, flooded area

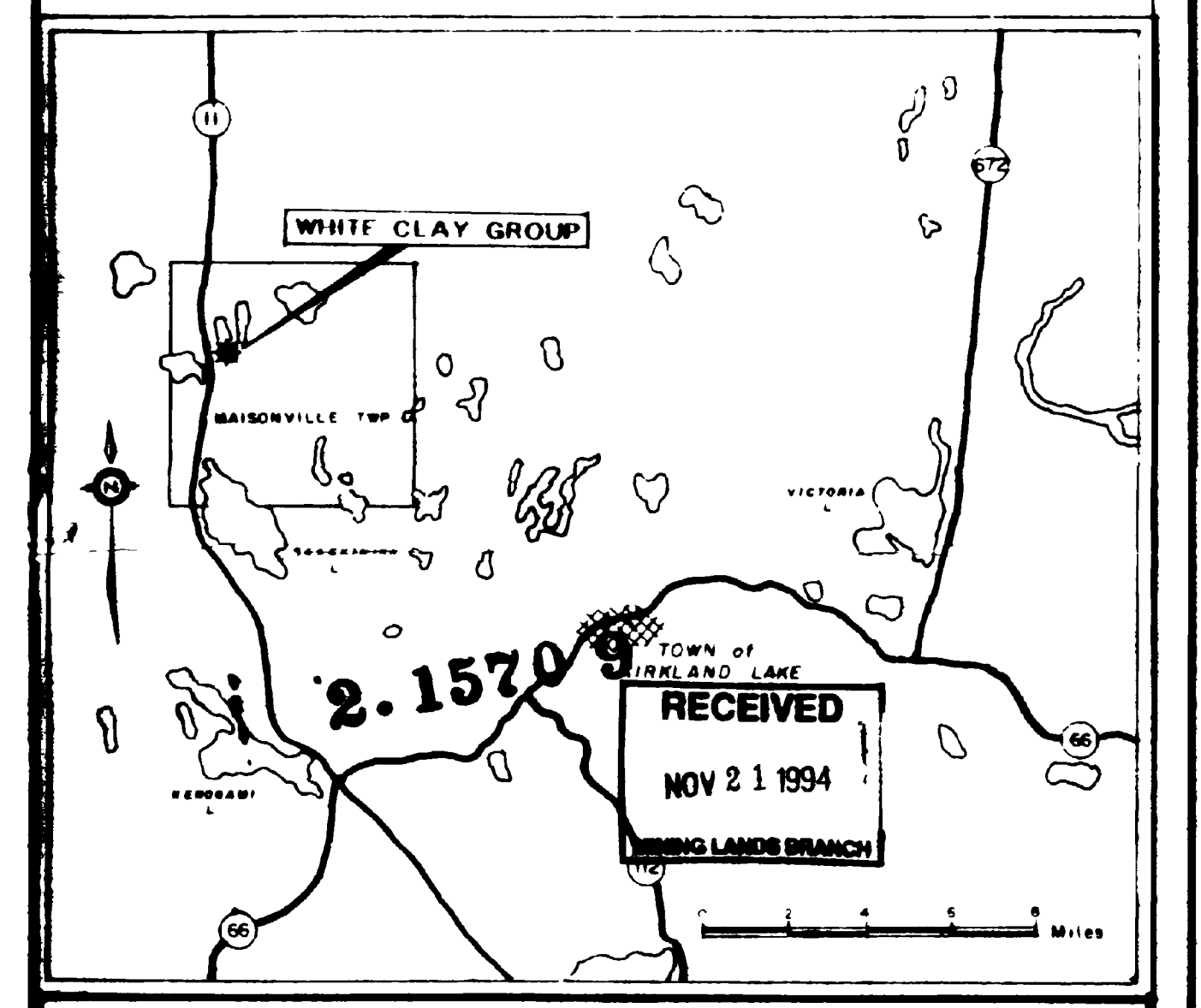

WHITE CLAY GROUP
 MAISONVILLE TOWNSHIP, ONTARIO
 LARDE LAKE MINING DIVISION
 DISTRICT OF TIMISKAMING

GEOLOGY PLAN

PROJECT No.: WCG - 93	DATA BY: M. DYMENT
N.T.S.: 42A / SE	DRAWN BY: B.H. MADILL
DRAWING No.: WCG 93 - 01	DATE: NOVEMBER, 1993
SCALE: 0 100 200 300 400 500 600 700 800 1 inch = 200 feet	