



42A01NE0040 24 MAISONVILLE

010

DIAMOND DRILLING

Township: Maisonville

Report No: 24

WORK PERFORMED FOR: Queeston Gold Mines Ltd.

RECORDED HOLDER: SAME AS ABOVE [x]

: OTHER []

<u>CLAIM NO.</u>	<u>HOLE NO.</u>	<u>FOOTAGE</u>	<u>DATE</u>	<u>NOTE</u>
L 797359	W-86-2	158	April/86	(1)

NOTES: (1) #149-86

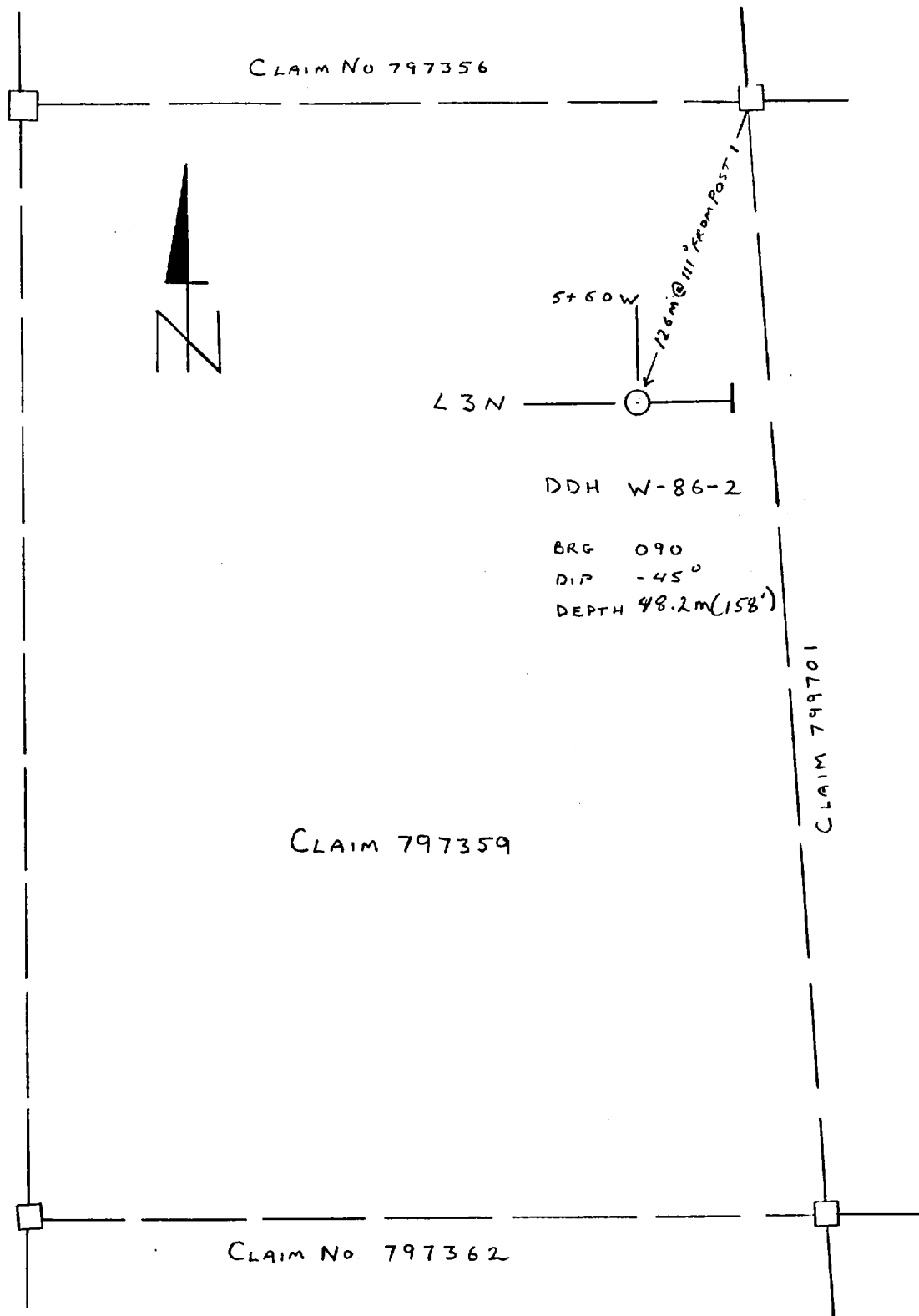

QUEENSTON GOLD MINES LIMITED

LOCATION OF DDH W-86-2
 MAISONVILLE TWP. LARDE LAKE MINING DIV.
 DISTRICT OF TIMISKAMING
 WEG GROUP CLAIM 797359

1 cm = 25 m KD, APR/86

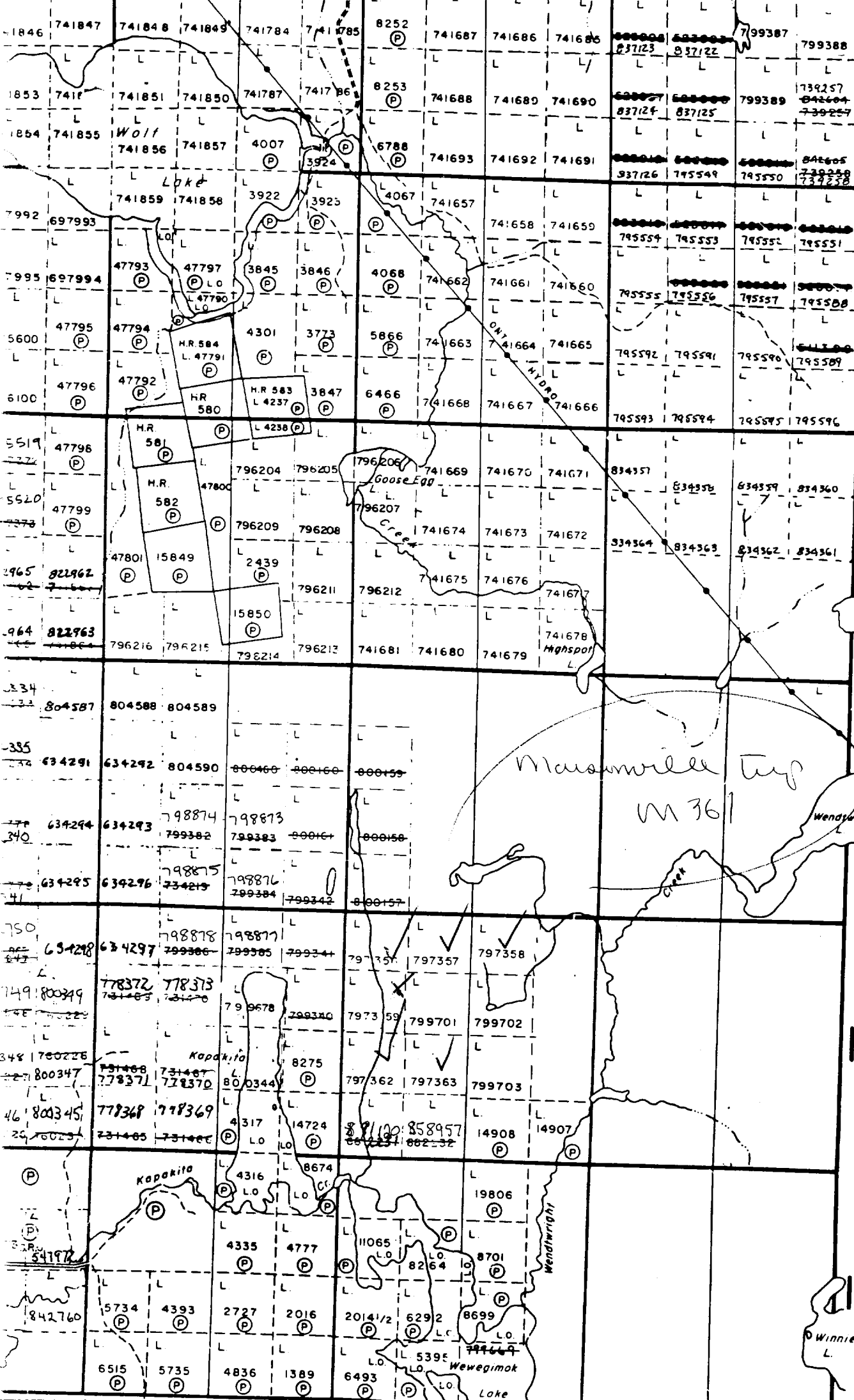

VI

V

IV

BERNHARDT TWP. - M. 327

Mansville Twp
M 361

Wendwright

Winnie L.

Parcel numbers and annotations on the map include:
 8252, 8253, 6788, 4007, 3924, 3922, 3923, 4067, 4068, 4069, 4070, 4071, 4072, 4073, 4074, 4075, 4076, 4077, 4078, 4079, 4080, 4081, 4082, 4083, 4084, 4085, 4086, 4087, 4088, 4089, 4090, 4091, 4092, 4093, 4094, 4095, 4096, 4097, 4098, 4099, 4100, 4101, 4102, 4103, 4104, 4105, 4106, 4107, 4108, 4109, 4110, 4111, 4112, 4113, 4114, 4115, 4116, 4117, 4118, 4119, 4120, 4121, 4122, 4123, 4124, 4125, 4126, 4127, 4128, 4129, 4130, 4131, 4132, 4133, 4134, 4135, 4136, 4137, 4138, 4139, 4140, 4141, 4142, 4143, 4144, 4145, 4146, 4147, 4148, 4149, 4150, 4151, 4152, 4153, 4154, 4155, 4156, 4157, 4158, 4159, 4160, 4161, 4162, 4163, 4164, 4165, 4166, 4167, 4168, 4169, 4170, 4171, 4172, 4173, 4174, 4175, 4176, 4177, 4178, 4179, 4180, 4181, 4182, 4183, 4184, 4185, 4186, 4187, 4188, 4189, 4190, 4191, 4192, 4193, 4194, 4195, 4196, 4197, 4198, 4199, 4200, 4201, 4202, 4203, 4204, 4205, 4206, 4207, 4208, 4209, 4210, 4211, 4212, 4213, 4214, 4215, 4216, 4217, 4218, 4219, 4220, 4221, 4222, 4223, 4224, 4225, 4226, 4227, 4228, 4229, 4230, 4231, 4232, 4233, 4234, 4235, 4236, 4237, 4238, 4239, 4240, 4241, 4242, 4243, 4244, 4245, 4246, 4247, 4248, 4249, 4250, 4251, 4252, 4253, 4254, 4255, 4256, 4257, 4258, 4259, 4260, 4261, 4262, 4263, 4264, 4265, 4266, 4267, 4268, 4269, 4270, 4271, 4272, 4273, 4274, 4275, 4276, 4277, 4278, 4279, 4280, 4281, 4282, 4283, 4284, 4285, 4286, 4287, 4288, 4289, 4290, 4291, 4292, 4293, 4294, 4295, 4296, 4297, 4298, 4299, 4300, 4301, 4302, 4303, 4304, 4305, 4306, 4307, 4308, 4309, 4310, 4311, 4312, 4313, 4314, 4315, 4316, 4317, 4318, 4319, 4320, 4321, 4322, 4323, 4324, 4325, 4326, 4327, 4328, 4329, 4330, 4331, 4332, 4333, 4334, 4335, 4336, 4337, 4338, 4339, 4340, 4341, 4342, 4343, 4344, 4345, 4346, 4347, 4348, 4349, 4350, 4351, 4352, 4353, 4354, 4355, 4356, 4357, 4358, 4359, 4360, 4361, 4362, 4363, 4364, 4365, 4366, 4367, 4368, 4369, 4370, 4371, 4372, 4373, 4374, 4375, 4376, 4377, 4378, 4379, 4380, 4381, 4382, 4383, 4384, 4385, 4386, 4387, 4388, 4389, 4390, 4391, 4392, 4393, 4394, 4395, 4396, 4397, 4398, 4399, 4400, 4401, 4402, 4403, 4404, 4405, 4406, 4407, 4408, 4409, 4410, 4411, 4412, 4413, 4414, 4415, 4416, 4417, 4418, 4419, 4420, 4421, 4422, 4423, 4424, 4425, 4426, 4427, 4428, 4429, 4430, 4431, 4432, 4433, 4434, 4435, 4436, 4437, 4438, 4439, 4440, 4441, 4442, 4443, 4444, 4445, 4446, 4447, 4448, 4449, 4450, 4451, 4452, 4453, 4454, 4455, 4456, 4457, 4458, 4459, 4460, 4461, 4462, 4463, 4464, 4465, 4466, 4467, 4468, 4469, 4470, 4471, 4472, 4473, 4474, 4475, 4476, 4477, 4478, 4479, 4480, 4481, 4482, 4483, 4484, 4485, 4486, 4487, 4488, 4489, 4490, 4491, 4492, 4493, 4494, 4495, 4496, 4497, 4498, 4499, 4500, 4501, 4502, 4503, 4504, 4505, 4506, 4507, 4508, 4509, 4510, 4511, 4512, 4513, 4514, 4515, 4516, 4517, 4518, 4519, 4520, 4521, 4522, 4523, 4524, 4525, 4526, 4527, 4528, 4529, 4530, 4531, 4532, 4533, 4534, 4535, 4536, 4537, 4538, 4539, 4540, 4541, 4542, 4543, 4544, 4545, 4546, 4547, 4548, 4549, 4550, 4551, 4552, 4553, 4554, 4555, 4556, 4557, 4558, 4559, 4560, 4561, 4562, 4563, 4564, 4565, 4566, 4567, 4568, 4569, 4570, 4571, 4572, 4573, 4574, 4575, 4576, 4577, 4578, 4579, 4580, 4581, 4582, 4583, 4584, 4585, 4586, 4587, 4588, 4589, 4590, 4591, 4592, 4593, 4594, 4595, 4596, 4597, 4598, 4599, 4600, 4601, 4602, 4603, 4604, 4605, 4606, 4607, 4608, 4609, 4610, 4611, 4612, 4613, 4614, 4615, 4616, 4617, 4618, 4619, 4620, 4621, 4622, 4623, 4624, 4625, 4626, 4627, 4628, 4629, 4630, 4631, 4632, 4633, 4634, 4635, 4636, 4637, 4638, 4639, 4640, 4641, 4642, 4643, 4644, 4645, 4646, 4647, 4648, 4649, 4650, 4651, 4652, 4653, 4654, 4655, 4656, 4657, 4658, 4659, 4660, 4661, 4662, 4663, 4664, 4665, 4666, 4667, 4668, 4669, 4670, 4671, 4672, 4673, 4674, 4675, 4676, 4677, 4678, 4679, 4680, 4681, 4682, 4683, 4684, 4685, 4686, 4687, 4688, 4689, 4690, 4691, 4692, 4693, 4694, 4695, 4696, 4697, 4698, 4699, 4700, 4701, 4702, 4703, 4704, 4705, 4706, 4707, 4708, 4709, 4710, 4711, 4712, 4713, 4714, 4715, 4716, 4717, 4718, 4719, 4720, 4721, 4722, 4723, 4724, 4725, 4726, 4727, 4728, 4729, 4730, 4731, 4732, 4733, 4734, 4735, 4736, 4737, 4738, 4739, 4740, 4741, 4742, 4743, 4744, 4745, 4746, 4747, 4748, 4749, 4750, 4751, 4752, 4753, 4754, 4755, 4756, 4757, 4758, 4759, 4760, 4761, 4762, 4763, 4764, 4765, 4766, 4767, 4768, 4769, 4770, 4771, 4772, 4773, 4774, 4775, 4776, 4777, 4778, 4779, 4780, 4781, 4782, 4783, 4784, 4785, 4786, 4787, 4788, 4789, 4790, 4791, 4792, 4793, 4794, 4795, 4796, 4797, 4798, 4799, 4800, 4801, 4802, 4803, 4804, 4805, 4806, 4807, 4808, 4809, 4810, 4811, 4812, 4813, 4814, 4815, 4816, 4817, 4818, 4819, 4820, 4821, 4822, 4823, 4824, 4825, 4826, 4827, 4828, 4829, 4830, 4831, 4832, 4833, 4834, 4835, 4836, 4837, 4838, 4839, 4840, 4841, 4842, 4843, 4844, 4845, 4846, 4847, 4848, 4849, 4850, 4851, 4852, 4853, 4854, 4855, 4856, 4857, 4858, 4859, 4860, 4861, 4862, 4863, 4864, 4865, 4866, 4867, 4868, 4869, 4870, 4871, 4872, 4873, 4874, 4875, 4876, 4877, 4878, 4879, 4880, 4881, 4882, 4883, 4884, 4885, 4886, 4887, 4888, 4889, 4890, 4891, 4892, 4893, 4894, 4895, 4896, 4897, 4898, 4899, 4900, 4901, 4902, 4903, 4904, 4905, 4906, 4907, 4908, 4909, 4910, 4911, 4912, 4913, 4914, 4915, 4916, 4917, 4918, 4919, 4920, 4921, 4922, 4923, 4924, 4925, 4926, 4927, 4928, 4929, 4930, 4931, 4932, 4933, 4934, 4935, 4936, 4937, 4938, 4939, 4940, 4941, 4942, 4943, 4944, 4945, 4946, 4947, 4948, 4949, 4950, 4951, 4952, 4953, 4954, 4955, 4956, 4957, 4958, 4959, 4960, 4961, 4962, 4963, 4964, 4965, 4966, 4967, 4968, 4969, 4970, 4971, 4972, 4973, 4974, 4975, 4976, 4977, 4978, 4979, 4980, 4981, 4982, 4983, 4984, 4985, 4986, 4987, 4988, 4989, 4990, 4991, 4992, 4993, 4994, 4995, 4996, 4997, 4998, 4999, 5000.

Fill in on every page

Hole No. 1-56-2

Map Reference No. Claim No. 797359
 Location (Twp., Lot, Con. or Lat. and Long.)
 Property Name WEG

Location of hole in relation to a fixed point on the claim.
 126 m @ 111° FROM POST # 1

Dip of Hole at Collar - 45°
 Bearing of hole from true North 090°
 Logged by KEN DONNER
 Submitted by (Signature) Ken Donner

Collar Elevation
 Date Logged APRIL 15/86
 Date Submitted APRIL 15/86

Company WEATH & SHERWOOD
 Date Completed APRIL 14/86

From	To	Rock Type	Description Colour, grain size, texture, minerals, alteration, etc.	CRA	Your Sample No	Sample Footage		Assays
						From	To	
0	18.9	CASING						
18.7	48.2	GREYWACKE	- GREYWACKE IS LT-MED GREY FINE GRAINED	45°				
		ARGILLITE SEQUENCE	- ARGILLITE IS BLACK, APHANITIC, WELL BANNED.	50°				
			- CORE VERY RUBBLY, DIFFICULTIES ENCOUNTERED DURING DRILLING RESULTS IN SLOW PROGRESS AND SOME LOST CORE.					
			- FAULT ZONE FROM 18.9 m (TOP OF BEDROCK INTERSECTION) TO 32.2 m.					
			- ROCK WITHIN FAULT IS BRECCIATED FRAGMENTS BEING SUB-PARALLEL, GENERALLY < 50mm IN DIAM.					
			- MATRIX IN F.Z. IS APHANITIC, SILICIFIED.					
			- MINERALIZATION WITHIN THE FAULT ZONE IS					
			DOMINANTLY PYRITE OCCURRING IN CONCENTRATIONS TO 5% OVER SMALL INTERSECTIONS					
			- BELOW FAULT ZONE ROCK IS PRIMARILY					
			GREYWACKE (80%) WITH SMALL BANDS (< 1m WIDE) OF ARGILLITE OCCURRING. GENERALLY ARGILLITE IS NOTED AT LEAST ONE PER METER OF CORE, THE AMOUNT OF ARGILLITE INCREASING WITH DEPTH.					
			- PREDOMINANT SULPHIDE MINERALIZATION IS					

ONTARIO GEOLOGICAL SURVEY
 ASSESSMENT FILES
 RESEARCH OFFICE
 MAY 14 1986
 RECEIVED

Diamond Drilling Log



Fill in on every page

Hole No. W-35-2

Drilling Company

Date Completed

Collar Elevation

Bearing of hole from true North

Total Footage

Dip of Hole at Collar

Location of hole in relation to a fixed point on the claim.

Map Reference No.

Claim No.

Date Hole Started

Date Logged

Date Submitted

Logged by

Submitted by (Signature)

Location (Twp., Lot, Con. or Lat. and Long.)

Property Name

Footage From To

Rock Type

Description

Colour, grain size, texture, minerals, alteration, etc.

Your Sample No

Sample Footage From To

Sample Length

Assays

PYRITE OCCURRING AS STRINGERS, FRACTURE FILLINGS
 AND OCCASIONALLY DISSEMINATED IN TRACE AMOUNTS
 20.0-20.1 2% PY IN DISCONTINUOUS STRINGERS
 31.8-32.1 NEAR LOWER FAULT CONTACT, WELL
 BRECCIATED, PERVASIVE PY MINERALIZATION TO 5%
 38.2-38.7 QUARTZ FLOODED (CHERTY) ZONE
 NO SIGNIFICANT ASSOCIATED MINERALIZATION
 ECH @ 482M (158')

ONTARIO GEOLOGICAL SURVEY
 ASSESSMENT FILES
 RESEARCH OFFICE

MAY 14 1985

RECEIVED

149/8



42A01NE0040 24 MAISONVILLE

900

Mining

Name and Postal Address of Recorded Holder: **QUEENSTON GOLD MINES LIMITED**
 MAISONVILLE TWP. Prospector's Licence No. **T 770**
P O BOX 193 KIRKLAND LAKE ONT P2N 3H7

Summary of Work Performance and Distribution of Credits

Total Work Days Cr. claimed	Mining Claim		Work Days Cr.	Mining Claim		Work Days Cr.	Mining Claim		Work Days Cr.
	Prefix	Number		Prefix	Number		Prefix	Number	
170	L	797356	20						
for Performance of the following work. (Check one only)	<input type="checkbox"/> Manual Work	797357	20						
	<input type="checkbox"/> Shaft Sinking Drifting or other Lateral Work.	797358	20						
	<input type="checkbox"/> Compressed Air, other Power driven or mechanical equip.	797362	40						
	<input type="checkbox"/> Power Stripping	797363	40						
	<input checked="" type="checkbox"/> Diamond or other Core drilling								
<input type="checkbox"/> Land Survey									

ONTARIO GEOLOGICAL SURVEY
 ASSESSMENT FILE
 RESEARCH OFFICE
 MAY 14 1986
 RECEIVED

All the work was performed on Mining Claim(s): **797359**

Required Information eg: type of equipment, Names, Addresses, etc. (See Table Below)

HEATH AND SHERWOOD DRILLING
 34 DUNCAN AVE N
 KIRKLAND LAKE ONT

RECEIVED
 APR 15 1986

COMMENCED DRILLING APR 10/86 ; COMPLETED APR 14/86

L 797359
 W-86-2
 48.2 M (158')
 APPLIED FOR DR. 10/86 140'
 BAL FOR FUTURE USE 18'
 BQ CORE

RECORDED
 APR 15 1986
 Receipt # _____

Date of Report: **APRIL 15/86**
 Recorded by (Signature): *[Signature]*

Certification Verifying Report of Work

I hereby certify that I have a personal and intimate knowledge of the facts set forth in the Report of Work annexed hereto, having performed the work or witnessed same during and/or after its completion and the annexed report is true.

Name and Postal Address of Person Certifying: **KEN DONNER**
Box 224 MATACHEWAN ONT POKIMO
 Date Certified: **APRIL 15/86**
 Certified by (Signature): *[Signature]*

Table of Information/Attachments Required by the Mining Recorder

Type of Work	Specific information per type	Other information (Common to 2 or more types)	Attachments
Manual Work	Nil	Names and addresses of men who performed manual work/operated equipment, together with dates and hours of employment.	Work Sketch: these are required to show the location and extent of work in relation to the nearest claim post.
Shaft Sinking, Drifting or other Lateral Work			
Compressed air, other power driven or mechanical equip.	Type of equipment	Names and addresses of owner or operator together with dates when drilling/stripping done.	Work Sketch (as above) in duplicate
Power Stripping	Type of equipment and amount expended. Note: Proof of actual cost must be submitted within 30 days of recording.		
Diamond or other core drilling	Signed core log showing; footage, diameter of core, number and angles of holes.	Nil	Nil
Land Survey	Name and address of Ontario land surveyor.		