



42A01NE0148 67 TECK

010

DIAMOND DRILLING

TOWNSHIP: TECK

REPORT NO: 67

WORK PERFORMED FOR: Goldhunter Explorations Inc.

RECORDED HOLDER: Same as Above [xx]
: Other []

| <u>Claim No.</u> | <u>Hole No.</u> | <u>Footage</u> | <u>Date</u> | <u>Note</u> |
|---------------------|-----------------|----------------|-------------|-------------|
| L 856543/ 856544 | G-88-9 | 610' | Mar-Apr/88 | (1) |

Notes: (1) #W8808.201, filed in Oct/88

GOLDHUNTER EXPLORATIONS INC. - FEDERAL PROPERTY
Kirkland Lake, Ontario

STRIKE: (Collar) 180 degrees LOCATION: L21W, 1+00S
 DIP: -45 degrees DATE DRILLED: March 24 - April 2, 1988
 LOGGED BY: T. Twomey
 DRILLED BY: Exploration Diamond Drilling
 PURPOSE: Test zone 100' above G-88-8.

=====

FOOTAGE DESCRIPTION
=====

0 - 50.8' OVERBURDEN

50.8 - 258.7' BIMODAL FELDSPAR PORPHYRY

Coarse, euhedral feldspars with medium-grained
 anhedral feldspars in massive, very fine-grained,
 pink matrix. Porphyry is well-fractured.

57 - 58.3' FAULT - chlorite slips at
 40 degrees to CA, in bleached
 porphyry.

127.9 - 128.3' FAULT - as above.

157.1 - 159.1' FAULT - chlorite slips and quartz
 veining at 65 degrees to CA,
 in bleached porphyry.

258.7' Sharp, intrusive contact at
 20 degrees to CA.

258.7 - 436.6' TRACHYTE TUFF and AGGLOMERATE

Generally well-bedded, well sorted, sand sized
 beds, intercalated with lapilli tuff beds and
 agglomerate. Rusty to brown to green coloured,
 magnetic. Bedding dominantly at 25 degrees to CA.

274 - 302' Bleached, fractured tuff.

326 - 337' FEDERAL ZONE. Bleached, fractured
 tuff at 35 degrees to CA, less
 than 1% pyrite. Minor quartz
 veinlets.

436.6 - 610' MAFIC SYENITE

Medium-grained, melanocratic, massive, magnetic.

457.0 - 457.5' FAULT - chloritic slips at
 30 degrees to CA.

610' END OF HOLE.

DRILL LOG

HOLE: G-88-9

PAGE: 2

=====

| FOOTAGE | DESCRIPTION |
|---------|-------------|
|---------|-------------|

=====

BORE HOLE DATA

BH NO. G-88-9

=====

| DATE | DEPTH | ACID | WEDGE | WEDGE | AZIMUTH | DIP |
|------|--------|------|-------|-------|-----------|-----------|
| 1988 | (feet) | TEST | TOP | TYPE | (degrees) | (degrees) |

=====

| | | | | | | | |
|--------|--------|---|--|--|-----|-------|-------------|
| Mar 24 | Collar | | | | 180 | -45 | |
| Mar 27 | 330 | x | | | | -42.5 | |
| Apr 2 | 610 | x | | | | -39 | END OF HOLE |

=====

SIGNED: *Timothy J. Twomey*

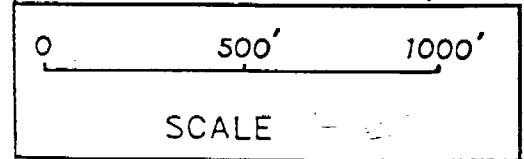
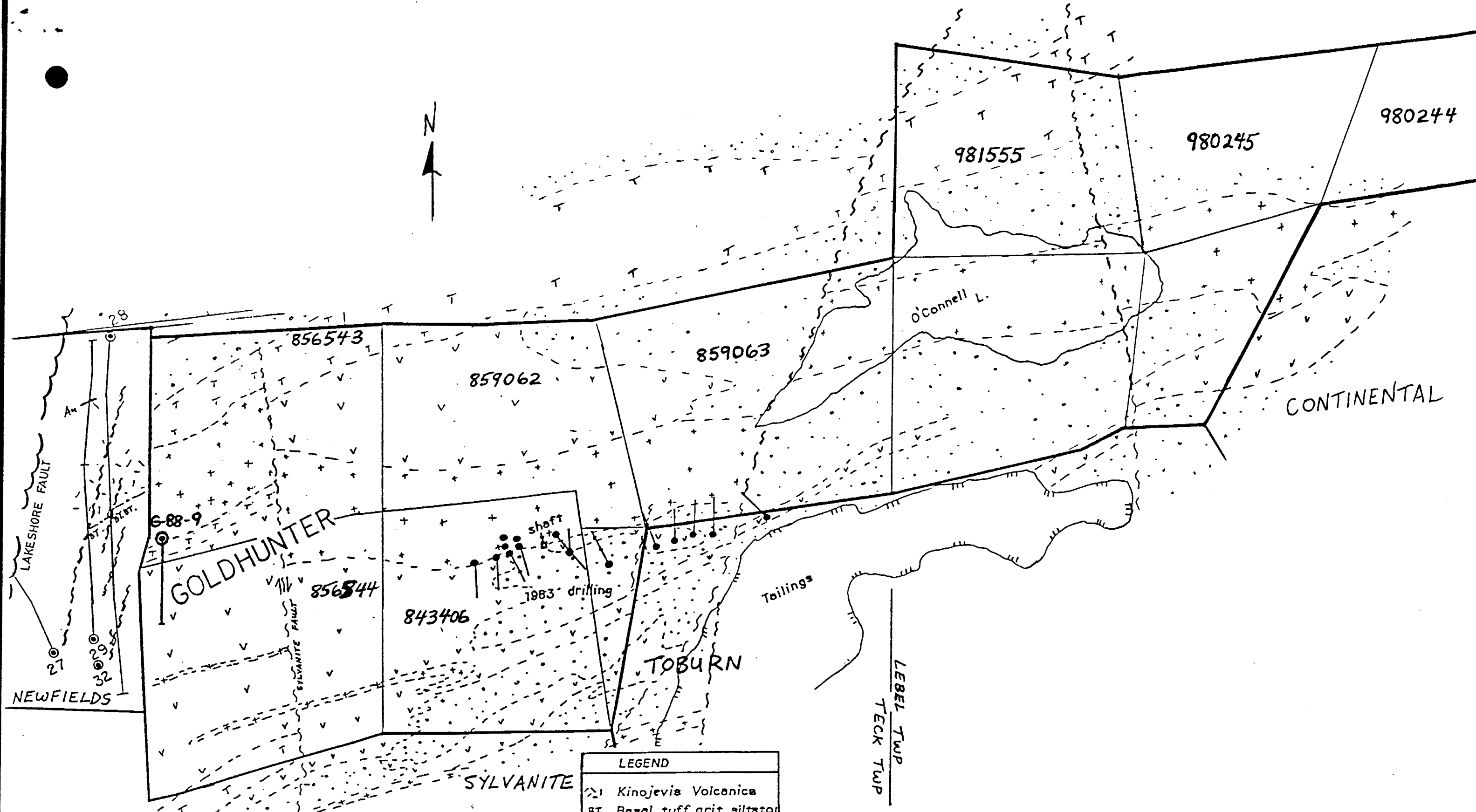

T. Twomey, 1988

| LEGEND | |
|--------|--------------------------------|
| | Kinojevis Volcanics |
| | Basal tuff, grit, siltstone |
| | Trachyte Tuff |
| | Conglomerate/wacke |
| | Porphyry (feldspar +/- quartz) |
| | Augite Syenite |



W8808-21
Assessment Label Type Mining

Name and Postal Address of Recorded Holder

GOLDHUNTER EXPLORATIONS INC
Box 40 Kirkland Lake, Ont P2N 3M6 TECK

Summary of Work Performance and Distribution of Credits

| Total Work Days Cr. claimed | Mining Claim | | | Work Days Cr. | Mining Claim | | | Work Days Cr. |
|-----------------------------|--------------|--------|---------------|---------------|--------------|--------|---------------|---------------|
| | Prefix | Number | Work Days Cr. | | Prefix | Number | Work Days Cr. | |
| 600 | L. | 981555 | 200 | | | | | |
| | | 980244 | 200 | | | | | |
| | | 980245 | 200 | | | | | |

All the work was performed on Mining Claim(s): L. 856543, 856544

Required Information eg: type of equipment, Names, Addresses, etc. (See Table Below)

BQ Diamond Drilling by:
EXPLORATION DRILLING INC.
50 Linden Lane
Stouffville, Ontario
LOH 1LO

DDH. G-88-9 drilled on L. 856543 and L. 856544
total length: 610', BQ core.
Date drilled: March 24 to April 2/88

ONTARIO GEOLOGICAL SURVEY
ASSESSMENT FILES
OFFICE
MAY 25 1988
RECEIVED

Certification Verifying Report of Work

I hereby certify that I have a personal and intimate knowledge of the facts set forth in the Report of Work annexed hereto, having performed the work or witnessed same during and/or after its completion and the annexed report is true.

Name and Postal Address of Person Certifying
TIMOTHY J. TWOMEY 47 Algonquin Ave 7-3462
Kirkland Lake, Ont.

Date Certified: May 4/88
Certified by (Signature): Timothy Twomey

Table of Information/Attachments Required by the Mining Recorder

| Type of Work | Specific information per type | Other Information (Common to 2 or more types) | Attachments |
|---|---|---|--|
| Manual Work | | | |
| Shaft Sinking, Drifting or other Lateral Work | LARDER LAKE MINING DIV. RECEIVED | Names and addresses of men who performed manual work/operated equipment, together with dates and hours of employment. | Work Sketch: these are required to show the location and extent of work in relation to the nearest claim post. |
| Compressed air, other power driven or mechanical equip. | Type of equipment | | |
| Power Stripping | Type of equipment and amount expended. Note: Proof of actual cost must be submitted | Names and addresses of owner or operator together with dates when drilling/stripping done. | Work Sketch (as above) in duplicate |
| Diamond or other core drilling | Signed core log showing: footage, diameter of core, number and angles of holes. | | |



GANI

Lake

O'Connell L.

DAL

9073

3122

5136

5285
9084

5137

5289

1000

1687

1898

2862

2855

2728

2739

120

5287
9059

3588

3587

3588

4726

2860

2861

2010

1808

667601
121
662601

618796
2854

619004

4991

246

13202

6173
9074

3588

3587

5524

3287

800872

2311

7839

2010

1808

662601

618796
2854

619004

4991

246

5287
9059

5288
9058

2370

2092

2090

2026

1804

2008

2009

1045800
251339
260831
780884
822941

2443

2440

246

14895
17020

4554

2380

2091

2093

2159

2026

1804

2008

641332

2445

2444

2470

548124
14895
17023

1045893

2380

2091

2093

2455

1893

221226

858901

25810

2257

2459

2808

548124
14895
17023

1045893

2322

2298

556543
2260
2485

854062

HR. 1434
2228
2229

221226

858901

25810

2452

2677

2807

548124
14895
17023

1045893

2299

2299

43406
6527
401832

43406
6527
401832

HR. 1440
2376

2177
6637

2378
6638

2430

2452

2677

2807

548124
14895
17023

1045893

2102

2299

43406
6527
401832

43406
6527
401832

HR. 1441
2376

1442

2378
6638

2430

2452

2677

2807

548124
14895
17023

1045893

2101

2227

43406
6527
401832

43406
6527
401832

HR. 1441
2376

1443

2372

2430

2452

2677

2807

548124
14895
17023

1045893

2100

2100

TC. 708
1830

TC. 708
1830

HR. 1444
2374

1444

2374

2430

2452

2677

2807

548124
14895
17023

1045893

2101

2227

TC. 708
1830

TC. 708
1830

HR. 1444
2374

1444

2374

2430

2452

2677

2807