



42A01NE0171 53 TECK

DIAMOND DRILLING

Township: TECK

Report No: 53

WORK PERFORMED FOR: F.T. O'CONNOR

RECORDED HOLDER: SAME AS ABOVE [X]
: OTHER []

<u>CLAIM No.</u>	<u>HOLE No.</u>	<u>FOOTAGE</u>	<u>DATE</u>	<u>NOTE</u>
L 800872	Teck-86-1	305'	July/86	(1)
	Teck-86-2	300'	July/86	(1)

2004/605'

NOTES: (1) # 270-85

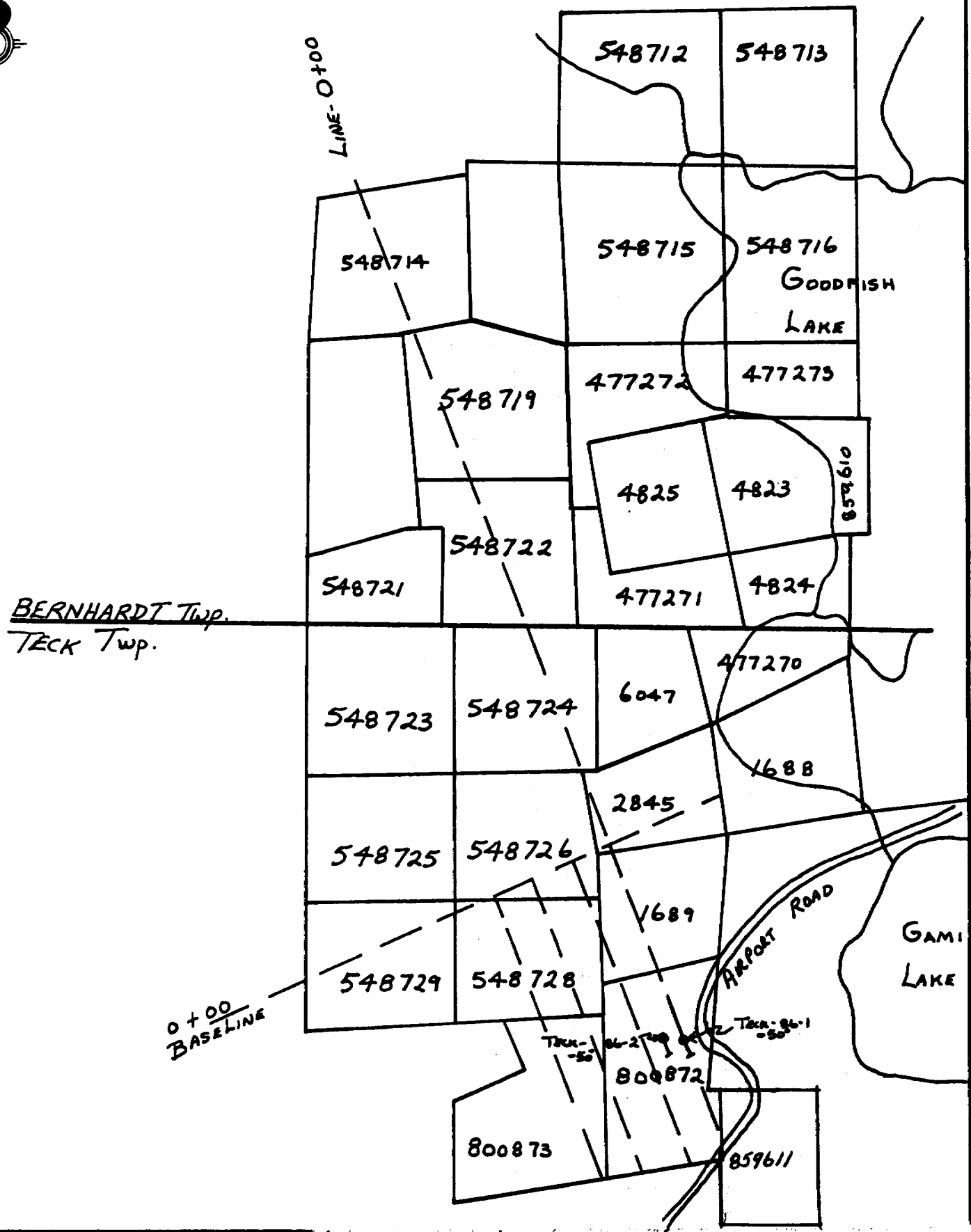

BERNHARDT Twp.
TECK Twp.

0+00
BASELINE

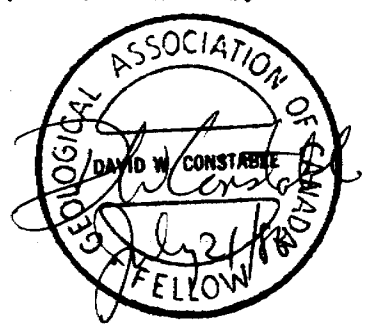

F. T. O'CONNOR
GOODFISH LAKE PROPERTY
TECK - BERNHARDT TOWNSHIPS
ONTARIO
DRILL HOLE LOCATION PLAN

SCALE 1 inch = 1/4 mile

DIAMOND DRILL RECORD

LOGGED BY D. Constable

Constable Consulting Inc.

PROPERTY Kirana-Teck: F.T.O'Connor

D.D.H. No. Teck-86-1 PAGE 1/2

LATITUDE 0+00 BEARING OF HOLE 150°

STARTED July 3/86

CLAIM No. L 800872

DEPARTURE 19+50 South DIP OF HOLE -50°

COMPLETED July 8/86

DIRECTION AND DISTANCE FROM

ELEVATION - DIP TESTS NIL

DEPTH 305.0

NE. CLAIM POST

IAX Core (! 3/8" Diameter)

FOOTAGE		DESCRIPTION	SAMPLE No.	FOOTAGE		SAMPLE LENGTH	ASSAY						
FROM	TO			FROM	TO								
0.0	10.0	Casing											
10.0	305.0	Altered Vesicular Flow											
		Grey, fine-grained, carbonated, silicified and brecciated rock with varying amounts of vesicles, presently filled with silica. Irregular areas of quartz-carbonate-filled breccia are present throughout unit. Rock also contains less than 1% finely disseminated pyrite. Rock is slightly harder than average.											
		From 10.0 - 23.0 core is extremely blocky-(Cemented) only 20% recovery.											
		From 66.3 - 69.5 Concentration of white quartz-carbonate veins (60%)											
		From 69.5' onwards rock is greyer and more competent. Contains more breicca and less quartz-carb.veins.											

ONTARIO GEOLOGICAL SURVEY
ASSESSMENT FILES
RESEARCH OFFICE
AUG 13 1986
RECEIVED

DIAMOND DRILL RECORD

LOGGED BY D. Constable

Constable Consulting Inc.

D.D.H. No. Teck-86-1 PAGE 2/2

PROPERTY _____
 LATITUDE _____ BEARING OF HOLE _____ STARTED _____
 DEPARTURE _____ DIP OF HOLE _____ COMPLETED _____
 ELEVATION _____ DIP TESTS _____ DEPTH _____

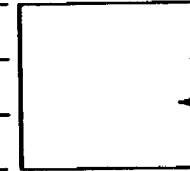

↑
 CLAIM No. _____
 ← DIRECTION AND DISTANCE FROM
 NE. CLAIM POST

FOOTAGE		DESCRIPTION	SAMPLE No.	FOOTAGE		SAMPLE LENGTH	ASSAY							
FROM	TO			FROM	TO									
		From 115.0' onward the rock becomes 75% breccia and the matrix a cherty graphitic mass.												
		From 145.0' - 156.0' several breccias contain 2-3% sulfide (pyrite) clasts.												
		From 161.0 - 185.0 rock is extremely blocky. Core Recovery is 80%.												
		In the 192.0' area some small (< 1/8") vesicles are observed.												
		Pattern of breccia (25%), sulfide clasts (1%) and quartz-carbonate veins (2%) repeats itself to the end of the hole.												
		End of Hole Teck-86-1 is at 305.0'.												

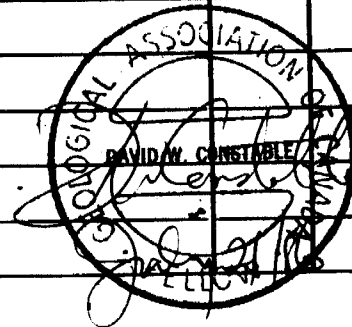

DIAMOND DRILL RECORD

LOGGED BY D. Constable

Constable Consulting Inc.

D.D.H. No. Teck-86-2 PAGE 2/2

PROPERTY _____

LATITUDE _____

BEARING OF HOLE _____

STARTED _____

DEPARTURE _____

DIP OF HOLE _____

COMPLETED _____

ELEVATION _____

DIP TESTS _____

DEPTH _____

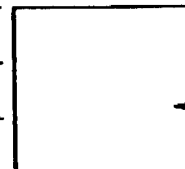

CLAIM No. _____

DIRECTION AND DISTANCE FROM

NE. CLAIM POST

FOOTAGE		DESCRIPTION	SAMPLE No.	FOOTAGE		SAMPLE LENGTH	ASSAY						
FROM	TO			FROM	TO								
137.5	300.0	Mafic Flow											
		Green, soft, fine-grained, blocky with relatively few features and infrequent, narrow, erratic quartz veins. Traces to nil sulfides.											
		This unit also contains hematized jasperite-filled pillow selvages and by 256.5 minor breccia zones.											
		End of Hole Teck-86-2 is at 300.0'											

ONTARIO GEOLOGICAL SURVEY
ASSESSMENT FILES
RESEARCH OFFICE
AUG 13 1986
RECEIVED

ASSOCIATION OF
GEOLOGICAL ENGINEERS
OF ONTARIO
DAVID W. CONSTABLE
21/86
FELLOW



Report of Work

#270/85



42A01NE0171 53 TECK

900

Teck & Burnhamdt Teck

The Mining Act

Expenditures)

Name and Postal Address of Recorded Holder F. T. O'Connor	Prospector's Licence No. (567-5732) K15849
--	--

Toburn Property, Kirkland Lake, Ontario

Summary of Work Performance and Distribution of Credits

	Mining Claim			Mining Claim			Mining Claim		
	Prefix	Number	Work Days Cr.	Prefix	Number	Work Days Cr.	Prefix	Number	Work Days Cr.
Total Work Days Cr. claimed <i>605 days</i>									
for Performance of the following work. (Check one only)	L.	800872	20	L.	548714	31	L.	548726	7
<input type="checkbox"/> Manual Work		800873	14		548715	31		548727	32
<input type="checkbox"/> Shaft Sinking Drifting or other Lateral Work.		799960	40		548719	31		548728	7
<input type="checkbox"/> Compressed Air, other Power driven or mechanical equip.		799961	40		548721	32			
<input type="checkbox"/> Power Stripping		859610	120		548722	32			
<input checked="" type="checkbox"/> Diamond or other Core drilling		859611	140		548723	32			
<input type="checkbox"/> Land Survey		548712	31		548724	32			
		548713	21		548725	32			

All the work was performed on Mining Claim(s): L. 800872

Required Information eg: type of equipment, Names, Addresses, etc. (See Table Below)

Contractor : Stringer Exploration Services Limited
Edward Stringer (Owner and Contractor)
Box 136
Garson, Ontario
POM 1V0

Drill Rig : J.K. Smit Model 300

Dates : July 3 to July 11, 1986

Core Size and Total: IAX Core (1 3/8" Diameter) and a Total of 605.0 feet.

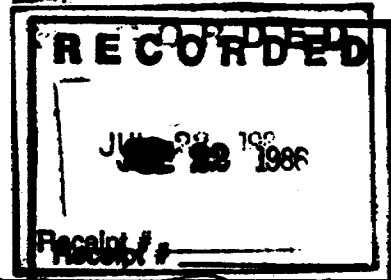
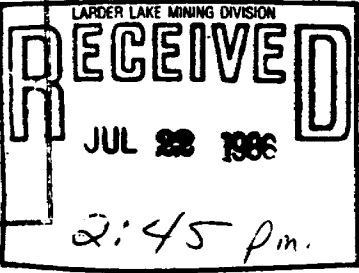
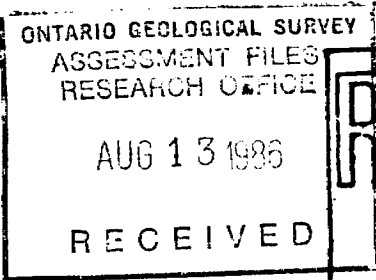
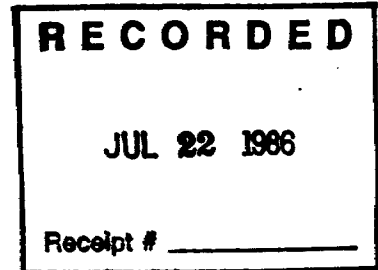

Date of Report July 21/86	Recorded by (Signature) <i>DW Constable</i>
------------------------------	--

Certification Verifying Report of Work

I hereby certify that I have a personal and intimate knowledge of the facts set forth in the Report of Work annexed hereto, having performed the work or witnessed same during and/or after its completion and the annexed report is true.

Name and Postal Address of Person Certifying
David Constable 10 Kingston Court

Sudbury, Ontario P3A 1C9

Date Certified July 21/86	Certified by (Signature) <i>DW Constable</i>
------------------------------	---

Table of Information/Attachments Required by the Mining Recorder

Type of Work	Specific information per type	Other information (Common to 2 or more types)	Attachments
Manual Work	Nil	Names and addresses of men who performed manual work/operated equipment, together with dates and hours of employment.	Work Sketch: these are required to show the location and extent of work in relation to the nearest claim post.
Shaft Sinking, Drifting or other Lateral Work			
Compressed air, other power driven or mechanical equip.	Type of equipment	Names and addresses of owner or operator together with dates when drilling/stripping done.	Work Sketch (as above) in duplicate
Power Stripping	Type of equipment and amount expended. Note: Proof of actual cost must be submitted within 30 days of recording.		
Diamond or other core drilling	Signed core log showing; footage, diameter of core, number and angles of holes.		

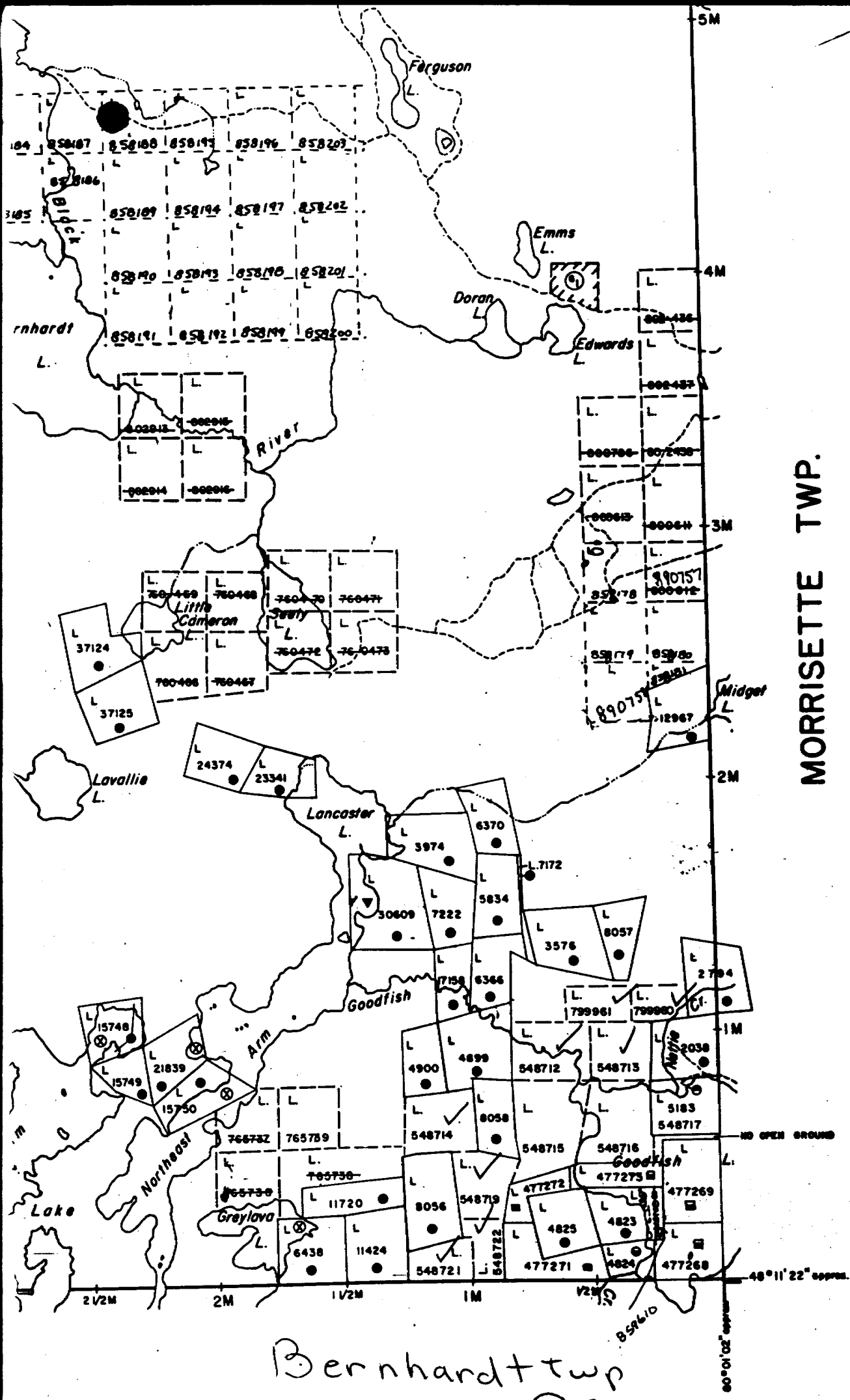

Bernhardt twp
G 3201

ORIGINAL S
MARSH OR
MINES
TRAVERSE

DISPO

TYPE OF D
PATENT, SU
" , SU
" , MI
LEASE, SUR
" , SUR
" , MIN
LICENCE O
ORDER-IN-C
RESERVAT
CANCELLE
SAND & GR

NOTE: MININ
1913,
LAND

SCALE: 1

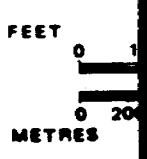

TOWNSH

BER

M.N.R. A
KIRKL
MINING
LARD
LAND TI
TIMIS



Date JAN

Bernhardt Twp. M.327

THE TOWNSH OF

TEC

DISTRICT C
TIMISKAMIN

LARDER LA
MINING DIVIS

SCALE: 1-INCH=20

DISPOSITION OF CROW

- PATENT, SURFACE AND MINING RIGHTS
- " SURFACE RIGHTS ONLY
- " MINING RIGHTS ONLY
- LEASE, SURFACE AND MINING RIGHTS
- " SURFACE RIGHTS ONLY
- " MINING RIGHTS ONLY
- LICENCE OF OCCUPATION
- ROADS
- IMPROVED ROADS
- KING'S HIGHWAYS
- RAILWAYS
- POWER LINES
- MARSH OR MUSKEG
- MINES
- CANCELLED

NOTES

400' surface rights reservation at shores of all lakes and rivers

Areas shown thus  for sli

Mining claim L.5779 - Mining Rights to Sec. 36 of the Mining Act (R.S.)

AREAS WITHDRAWN FROM ST

S.R. SECTION	ORDER No.	DATE	DISPOSITION
(1) 43/RSO 1970/1	W 76/80	7/2/80	S.R.
(2) 36/RSO 1980/1	W 108/82	12/2/82	S.R.
(3) 36/80	W 81/86	20/6/86	S.R.
Mineral rights withdrawn from prospecting claim L.5779 to Sec. 36 of the Mining Act Reopened NRO on 1/8/84 Sept 20/84			
(4) Sec 36/80	W 91/86	24/10/86	M.T.
(5) Sec 36/80	W 111/86	14/12/86	M.T.

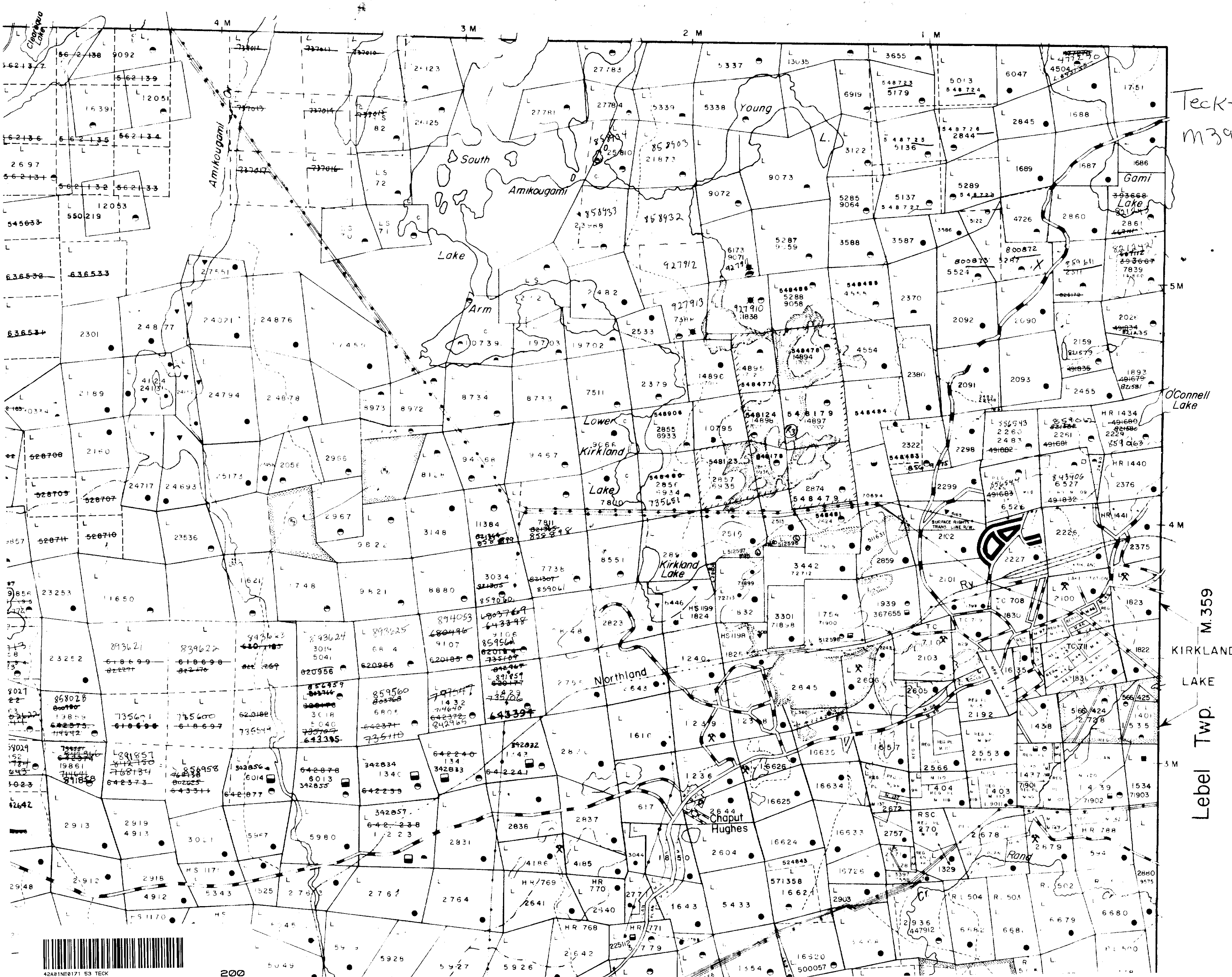

Teck Twp
M392

M.359
KIRKLAND
LAKE
Lebel Twp.

