



42A01NE0196 37 TECK

010

DIAMOND DRILLING

TOWNSHIP: TECK

REPORT No.: 37

WORK PERFORMED BY: GUARANTY TRUST

<u>CLAIM No.</u>	<u>HOLE No.</u>	<u>FOOTAGE</u>	<u>DATE</u>	<u>NOTE</u>
L 512596	T-81-2	161.0	May/81	(1)
L 512597	T-81-3	161.0	May/81	(2)
L 512598	T-81-4	161.0	June/81	(3)

NOTES:

(1) #231 - 81

(2) #250 - 81

(3) #290 - 81

DIAMOND DRILL RECORD

Hole No. T-81-2 Sheet No. 1

DIAMOND DRILL XRP-7/8"

Property Guaranty Trust Co
 Location TRUCK TOWNSHIP NORTH OF HIRKLAND
LOOKE STONE BASIN ON CLAIM
L-512596 - EAST OF NO 1 road post
 Latitude _____
 Departure _____
 Bearing South

Dip
50°

 Total Footage 161'

Elev. Collar _____
 Datum _____
 Date Started MAY 4/81
 Date Completed MAY 20/81
 Drilled by G. S. POTTER
 Logged by FRANCIS T. D. GARDNER

Footage		Formation	Sample Number	Sample Footage	Sample Width	Gold Sample	Gold Sludge	Remarks
From	To							
0'	19'	CASING						
19'	41'	CONGLOMERATE - Jasper 1/8" to 1/2"						
41'	42.2'	CONGLOMERATE - Ground and BARKED CORE						
42.5'	44'	LOST CORE						
44'	47.7'	" "						
47.7'	49'	CONGLOMERATE - SOME GROUND CORE						
49'	50'	LOST CORE						
50'	54'	CONGLOMERATE - Rusty CORE with SOME Qtz. Fracturing						
54'	62'	CONGLOMERATE - SOME JASPER.						
62'	63.3'	CONGLOMERATE - ground and lost CORE						
63.3'	70.5'	CONGLOMERATE.						
70.5'	72.5'	LOST CORE.						
72.5'	76'	CONGLOMERATE.						
76'	76.6'	LOST CORE.						
76.6'	86.7'	CONGLOMERATE.						
86.7'	87.2'	LOST CORE.						
87.3'	91.6'	CONGLOMERATE.						
91.6'	92.5'	LOST CORE.						
92.5'	99'	CONGLOMERATE.						
99'	101'	LOST CORE.						
101'	114.5'	CONGLOMERATE.						
114.5'	115.9'	GROUND CORE.						
115.9'	124'	CONGLOMERATE - SOME Qtz STRIPERS.						
124'	125'	CONGLOMERATE - Rusty with Qtz STRIPERS.						
125'	127'	LOST CORE.						
127'	128.8'	CONGLOMERATE - FILTERED, CARBONATED, Rusty SOME SHEPPING and Qtz FRACTURING.						
128.8'	140'	CONGLOMERATE - ALTERED CARBONATED.						

Date of Examination _____

DIAMOND DRILL RECORD

Hole No. T-81-2 Sheet No. 2
 DIAMOND DRILL X.P.P. - 7/8"

Property GUARANTEE TRUST Co L-512596
 Location TECK TOWNSHIP NORTH OF
KIRKLAND LAKE SLIM BASIN
ON CLAIM L-512596 EAST OF NO 1 POST.
 Latitude _____
 Departure _____
 Bearing South

Dip
50°

 Total Footage 161'

Elev. Collar _____
 Datum _____
 Date Started May 4/81
 Date Completed May 20/81
 Drilled by G.S. POTTER Contract
 Logged by FRANCIS T.O. GARDNER

Footage		Formation	Sample Number	Sample Footage	Sample Width	Gold Sample	Gold Sludge	Remarks
From	To							
140'	141'	LOST CORE						
141'	146'	Carbonate some shearing carbonated red Jasper						
146'	147.5'	LOST CORE						
147.5'	148.3'	Carbonate - Carbonated pale to med green						
148.3'	149'	Basalt Qtz vein with some pyrite						
149'	153'	Carbonate - Carbonated pale to med green with Jasper						
153'	153.9'	LOST CORE						
153.9'	155'	Carbonate - Carbonated pale to med green						
155'	156'	LOST CORE						
156'	161'	Carbonate - Carbonated pale to med green some Qtz stringers some pyrite and Jasper						
	161'	END OF HOLE						

Date of Examination _____

DRILLER: JIM LANDRY.
MATACHEWAN, ONT.

CONTRACTOR:
G.S. POTTER,
SWASTIKA, ONT.

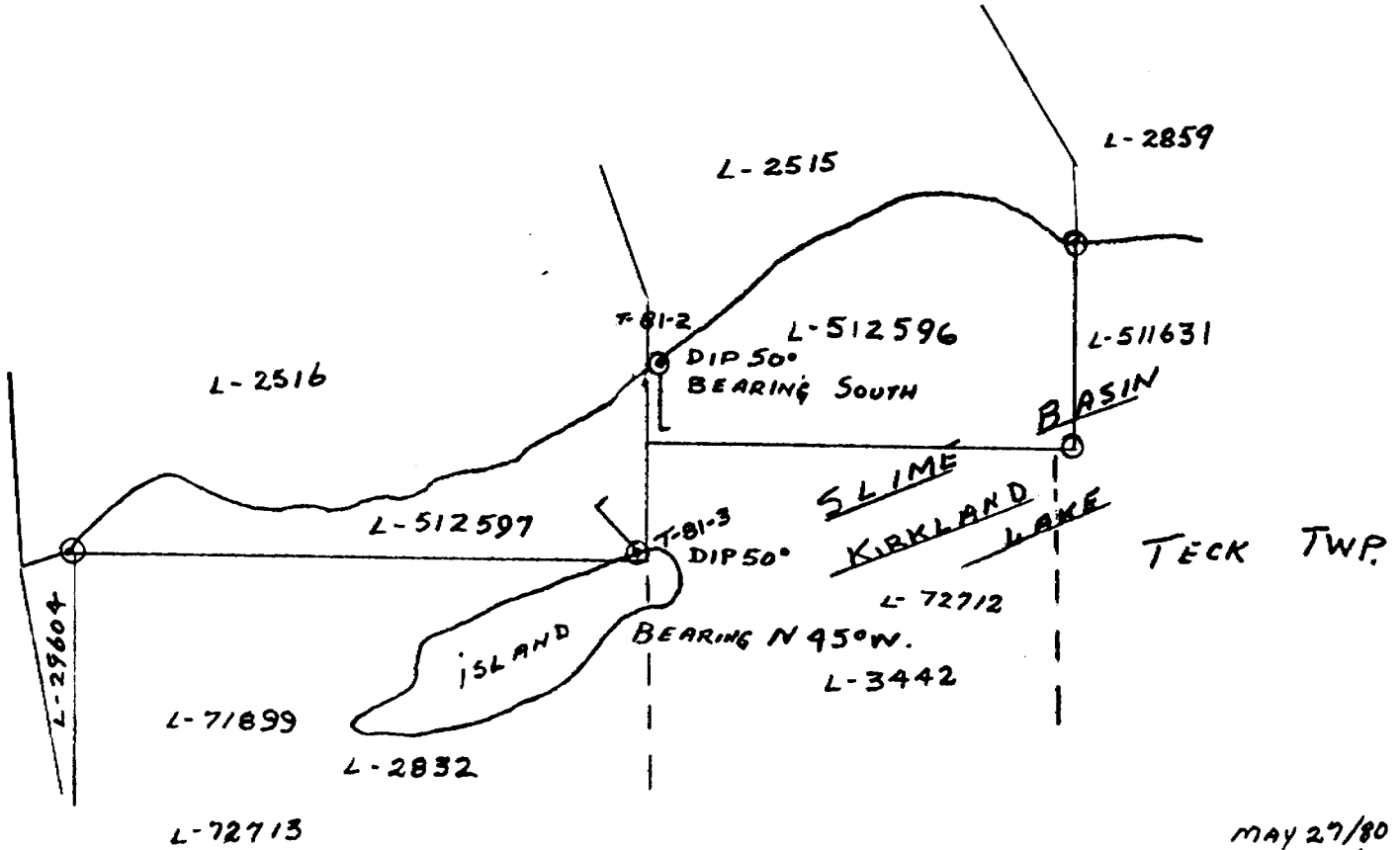

MAY 27/80
F.T. O'CONNOR

DIAMOND DRILL RECORD

Hole No. T-81-3 Sheet No. 1
DIAMOND DRILL XRP-7/8"Property GURRANTY TRUST COMPANY
Location TECK TOWN SHIP CLAIM L-512597
R.T. NUMBER TWO POST BEARING N 45° W.

Dip

50°Latitude _____
Departure _____
Bearing N-45° WTotal Footage 161'Elev. Collar _____
Datum _____
Date Started MAY 22/81
Date Completed JUNE 6/81
Drilled by G.S. POTTER
Logged by FRANCIS T.O. LAMAR

Footage		Formation	Sample Number	Sample Footage	Sample Width	Gold Sample	Gold Sludge	Remarks
From	To							
0	12'	CASING						
2'	9'	FELDSPAR PORPHYRY						
9'	9.3'	QTZ VEIN						
9.3'	20.5'	FELDSPAR PORPHYRY WITH SOME CALCITE & QTZ FRACTURING						
20.5'	21.5'	QTZ FRACTURING / SOME BRECCIA.						
21.5'	39.5'	QTZ VEIN						
39.5'	50.3'	FELDSPAR PORPHYRY						
50.3'	51.0'	QTZ VEINING						
51.0'	52.5'	SEYENITE PORPHYRY WITH SOME QTZ FRACTURING SOME PYRITE						
52.5'	87.0'	SOME OR REMAIN FELDSPAR PORPHYRY WITH SOME QTZ FRACTURING						
87.0'	87.3'	SERRATION INCLUSION						
87.3'	93.0'	FELDSPAR PORPHYRY						
93.0'	94.2'	LOST CORE						
94.2'	99.0'	FELDSPAR PORPHYRY WITH SOME CALCITE & QTZ FRACTURING						
99.0'	99.8'	LOST CORE						
99.8'	108.0'	FELDSPAR PORPHYRY WITH SOME QTZ FRACTURING						
108.0'	109.5'	LOST CORE						
109.5'	121.6'	FELDSPAR PORPHYRY WITH SOME QTZ FRACTURING						
121.6'	125.0'	LOST CORE						
125.0'	129.0'	SEYENITE PORPHYRY WITH SOME QTZ & CALCITE FRACTURING						
129.0'	132.5'	LOST CORE						
132.5'	134.2'	CARBONATED SEYENITE WITH QTZ FRACTURING.						
134.2'	136.5'	LOST CORE						
136.5'	140.0'	CARBONATED SEYENITE WITH SOME QTZ FRACTURING						
140.0'	143.3'	LOST CORE						
143.3'	145.0'	SEYENITE WITH QTZ VEINING						
145.0'	146.2'	LOST CORE						

Date of Examination

JUNE 9/81

Francis T.O. Lamar

DIAMOND DRILL RECORD

Hole No. T-91-3 Sheet No. 2
 DIAMOND DRILL X.R.P. - 78°

Property GUARANTY TRUST COMPANY
 Location TECK TOWNSHIP CLAIM L-512597
AT NUMBER POST BEARING N-45°W

Dip 50°

Elev. Collar _____
 Datum _____
 Date Started _____
 Date Completed _____
 Drilled by G.S. POTTER
 Logged by FRANCIS T.D. GANNON

Latitude _____
 Departure _____
 Bearing N-45°W

Total Footage 161

Footage		Formation	Sample Number	Sample Footage	Sample Width	Gold Sample	Gold Sludge	Remarks
From	To							
146.2'	147.0'	SEYENITE						
147.0'	148.0'	FELDSPAR PORPHYRY						
148.0'	150.0'	LOST CORE						
150.0'	154.2'	RUSTY FELDSPAR PORPHYRY						
154.2'	156.0'	LOST CORE						
156.0'	157.2'	FELDSPAR PORPHYRY						
157.2'	158.3'	LOST CORE						
158.3'	158.6'	LOSE FELDSPAR PORPHYRY						
158.6'	159.3'	LOST CORE						
159.3'	161.0'	FELDSPAR PORPHYRY WITH SOME Qtz FRACTURING						

Date of Examination JUNE 9/81

Francis T. Gannon

DRILLER: JIM LANDRY.
MATACHEWAN, ONT.

CONTRACTOR:

G.S. POTTER,
SWASTIKA, ONT.

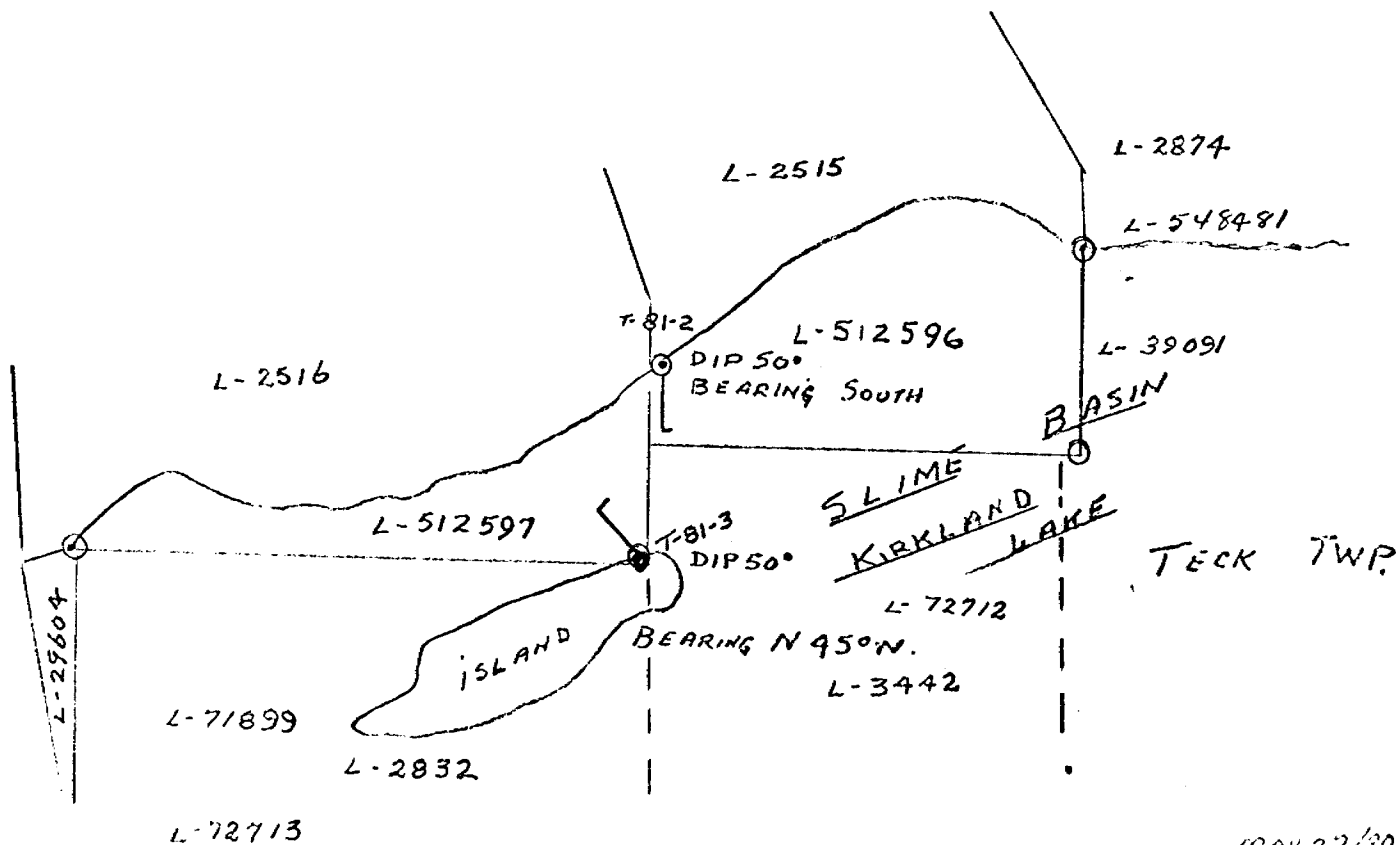

MAY 27/30
P.T.O. [unclear]

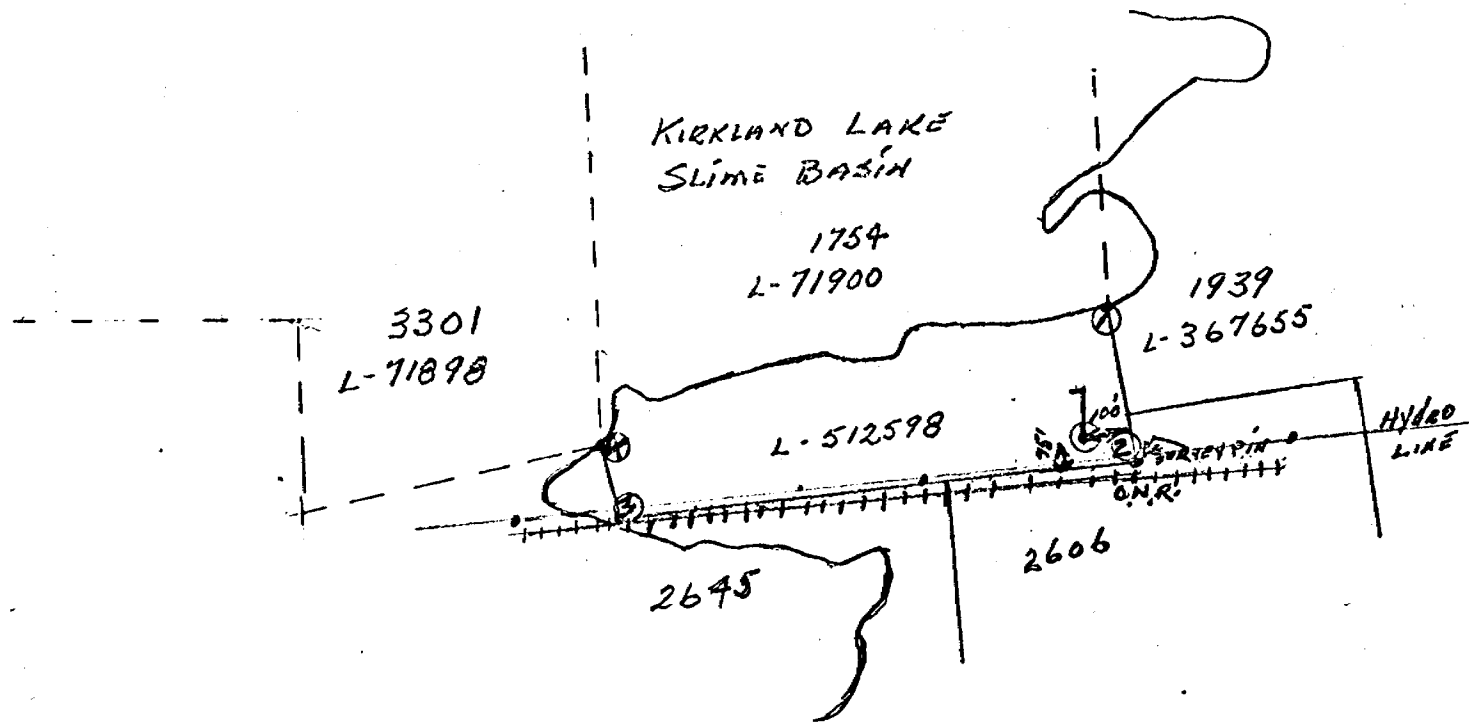

TRUCK TOWNSHIP
DUE NORTH
DIAMOND DRILL HOLE
T-81-4-161'
SCALE 1" = 500'
F.T.O'CONNOR
JUNE 25/81

DIAMOND DRILL RECORD

Hole No. T81-4

Sheet No. 1

CLAIM L512598, 75' N & 100° W

Property Location **GUARANTY TRUST**
335 Bay Street
102 Auto
Ontario N 54 3 N 8

Latitude
 Departure
 Bearing approx. True North

Collar
 Dip **45°**
 Total Footage **161'**

Elev. Collar
 Datum
 Date Started
 Date Completed **1981.06.26**
 Drilled by **Guaranty Trust**
 Logged by **Howard Lovell & Gary Grabowski**

Footage		Formation	Sample Number	Sample Footage	Sample Width	Gold Sample	Gold Sludge	Remarks
From	To							
0'	44'	collared in Timiskaming greywacke (medium grained sandstone). Bedding indistinct therefore thick (or d.d. along strike)						
26'		fine-grained sandstone						
28'		medium-grained sandstone						
34-1/2'		medium-grained sandstone with jasper pebbles 3 mm long						
35-1/2'		fine-grained sandstone						
40'		very fine-grained sandstone						
42-1/2'		medium-grained sandstone						
44'		trachyte contact @ 45° to core with fine-grained banded chilled contact 10 cm thick and then medium-grained syenite						
48-1/2'		Mud Seam						
49-1/2'		Banding 1 cm thick						
50-1/2'		Mud Seam						

Date of Examination

CLAIM L512598, 75' N & 100° W

DIAMOND DRILL RECORD

Hole No. _____ Sheet No. 2

Property GUARANTY TRUST

Dip

Location _____

Latitude _____
 Departure _____
 Bearing approx. true North

Total Footage _____

Elev. Collar _____
 Datum _____
 Date Started _____
 Date Completed _____
 Drilled by _____
 Logged by Howard Lovell & Gary Grabowski

Footage		Formation	Sample Number	Sample Footage	Sample Width	Gold Sample	Gold Sludge	Remarks
From	To							
58'		Red fine-grained syenite, then banding (trachyte tuff?) to 6.3'						
63'		Mud Seam 10 cm wide, then Brown medium-grained trachyte flows to 68'						
68'	69'	Trachyte flow delineated by pale fine-grained at its up-hole ends and then sharp contact against -7						
69'	73' -7	pale fine-grained trachyte to flow top to a mud seam @ 74', then brown trachyte flow with some subhedral and some euhedral crystals						
78'	85'	Brown trachyte flow						
85'	92'	Pale fine-grained topped brown trachyte flow						
92'	123'	Fine & medium-grained (pebbly) greywacke						
123'	127½'	Pale pink trachyte tuff or feldspathic greywacke						
127½'	129	Syenite dike?						
129'	160'	Fine-grained bedding tops followed by medium-grained pebbly greywacke						

Date of Examination _____

DIAMOND DRILL RECORD

Hole No.

Sheet No. 3

L5122598, 75' N & 100° W

Property GUARANTY TRUST
Location

Dip

Latitude,
Departure,
Bearing

Total Footage

Ele. Collar
Datum
Date Started
Date Completed
Drilled by
Logged by Howard Lovell & Gary Grabowski

Footage		Formation	Sample Number	Sample Footage	Sample Width	Gold Sample	Gold Sludge	Remarks
From	To							
160'	161'	Fine-grained greywacke sharp contact with medium-grained brown feldspar porphyry having euhedral & zoned subhedral pink feldspar crystals						

Date of Examination