

**REPORT ON STRIPPING ON THE
BARRY McCOMBE GRENFELL-WEST GROUP,
GRENFELL TOWNSHIP
FOR THE YEARS 1995 & 1996.**

2.17298



PREPARED BY: F.R. PLOEGER, B.Sc., FGAC

APRIL 16, 1997

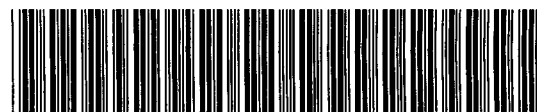

42A01NE0307 2.17298 GRENFELL

LOCATION: The property comprises 6 unpatented mining claims in south central Grenfell Township (G- 3212) numbered 1205807, 1206101, 1206152, 1206394, 1211513, and 1211515 totalling 18 units. The latter two claims represent small fractions or wedges along the Blanche River. The groups are located at approximately 80° 13' W longitude and 48° 07' N latitude (NTS 559000E & 5329500N).

ACCESS: The south part of the property touches the Blanche River and the west boundary roughly parallels Hwy 11. The Trans Canada Gas Pipeline bisects the claim group along its north-south axis. Access to the northerly claims is via gravel roads running east from Hwy 11, and to the central and southern parts by a gravel bush road and a pipeline right-of-way road.

GEOLOGY: The south part of Grenfell Twp was mapped by Thomson (1950) and the entire township by Grant (1962). A report on the McCombe group was published following a property visit by Guindon (Meyer et. al., 1995). According to these earlier publications, the area is underlain by massive and pillowed mafic flows of probable Mg-tholeiitic Kinojevis Group affinity. Coarse-grained massive flow units often are gabbroic-textured. The overall strike of the mafic assemblage in the vicinity of the claims is reported at 330° with dips and tops facing steeply east. Regional metamorphism has altered the flows to lower greenschist facies.

ECONOMIC GEOLOGY: The economic geology of Grenfell Twp was summarized by Grant as gold occurring in quartz veins with sulphides and some carbonate. Guindon quoted old reports that describe an association of gold mineralization with northwest trending shear zones on the claim group and the former Four Nations mine.

Previous work on the McCombe Property includes: a) 4 short holes drilled near the bend in the gas pipeline by Hecmac Syndicate (file KL 1114). The best value returned 0.10/3.5' in a silicified, brecciated zone.

b) A report written in 1960 by H.D. McLeod of Sogemines Development Co. Ltd. for the Legace Showing (file KL 1550) described a showing exposed by bulldozing and trenching which has subsequently been covered. He reported values from 11 samples, 10 of which averaged \$4.00 (0.115 opt) with a range of \$1.75 (0.05 opt) to \$6.65 (0.19 opt) and one that assayed \$16.80 (0.48 opt);

c) In 1975, the Grenfell Syndicate (file KL 1049) put down one hole near the end of the dump road near the current north boundary of the claim group. All values were trace;

d) A series of new and old trenches east of the access road to the Nor-Gro Nursery and the dump access road were stripped, blasted and sampled by Grant Sirola (file KL 2512) in 1980. According to the reports, the pits were put down on carbonatized and mineralized quartz veins. Values from the various trenches ranged from tr to 0.183 ppt with several in the 0.12-0.16 opt range ;

e) Between 1981 and 1985, Orcana Minerals (file KL 2512) performed a number of different surveys on the Sirola group including magnetometer and VLF-EM (1981), geological (1983), and basal till (1983). Although no significant conductors or new showings were located with the surveys, and the best value from the basal till survey was 127 ppb, two follow-up diamond drill holes were collared in 1984 & 1985. Both holes intersected mafic flows containing local narrow quartz/quartz carbonate veins to 12" with minor pyritic halos and values to 0.005 &

0.016 opt respectively;

f) Immediately north of the McCombe-west group, Grenfell Kirkland Gold Mines Ltd sank 2 shafts on quartz veins and silicified mafic volcanics with assays on the shaft walls returning values to 95.5 OPT. Drilling of 18 short holes in the vicinity of the shafts gave assays to 0.567/3' ;

g) The Trembley claim which is located between the 2 southerly claims of the McCombe-west group, has yielded grab samples ranging up to 2.76 OPT and channel samples of 0.255/2.6' over a strike length of 51' ;

h) Mylake Mines Ltd sank a shaft on a quartz vein structure about 3000' northeast of the group and examined a total of 12 quartz-bearing structures. Assays from the first level of the mine yielded chip samples of 0.91/2.1' over a strike length of 57 feet;

I) Extensive work was done on the Four Nations property between the southern parts of the two McCombe groups. Chip samples from trenches north of the Blanche River returned 0.25/7.8' over a 200 foot length while face samples of a development drift on the 375' level yielded 0.277/2' over 200 feet.

STRIPPING: Both the McCombe west and east groups were prospected by Mr McCombe and his assistants/ helpers in 1995 following the completion of staking of the claims (April 16) until the onset of winter (October 27). While prospecting, he noted and flagged old pits, trenches and shafts for follow up examination and stripping. In total, Mr McCombe logged 33 days stripping and his helpers, 29 days . In 1996, Mr McCombe spent a total of 54 days stripping outcrops and cleaning out old pits and trenches, while his assistants spent a total of 51 days helping him. In addition, Mr McCombe and his helpers each spent 3 days mechanical stripping between September 24 and 30, 1996 using their own d-3 bulldozer. A prospecting report has been submitted separately. To do the stripping and cleaning of old trenches Mr McCombe employed Ernie Chi Chi, Eric Marion, Claude Petit, Erle Boyce, Gaston Gagne, Albert Arcand Jr, Derrick Laing and George Thompson as helpers on various occasions. All the areas covered by this report are displayed on Maps 1 and 2.

As Mr McCombe was relatively inexperienced at prospecting, traverses initially followed the roads, gas pipeline and claim lines until he became familiar with the terrain and topography of the west group. He then began short traverses into the central portions of the group and utilized the Blanche River to get into the southeasterly part of the group. At certain times he operated from a tent base camp set up in the middle of the group just west of the gas pipeline right-of-way. The accompanying maps outline the dominant areas that were prospected by Mr McCombe in 1995 and 1996 and particularly highlight the areas of stripping with corresponding dimensions.

In general, Mr McCombe found a fairly even outcrop distribution covering the property except for the northern three-quarters of claim 1206101 which is mainly underlain by sandy jack pine and mixed bush covered areas with only scattered outcrop. This hosted only local areas containing a few scattered old trenches. The major portion of the property is literally peppered with old workings of various dimensions according to Mr McCombe. Most of the host rocks in which these old trenches, pits and shafts occur, comprised dark mafic fine to coarse grained mafic flows with occasional pillowed, fragmental and porphyritic horizons. Cobalt conglomerates outcrops occur along the south one third of claim 1201652. The numerous old trenches and pits were investigated and flagged for follow-up cleaning/ stripping and sampling.

Mineralization in these old trenches, pits and shafts comprised sheared, altered and quartz vein zones in the mafic volcanic host rocks that have been variably silicified, carbonatized, pyritized and oxidized. Several grab samples of host rock and mineralized vein and dump material were taken during the traverses. A number of new areas of interest that had not previously been worked were uncovered by Mr McCombe near rock cuts adjacent to the gas pipeline. One of these, the "gossan zone" near the south end of the group, was originally thought to be a piece of float and yielded initial values of 0.08 opt. Another area about 4000' north of the "gossan zone" returned assays of up to 0.144 opt from grab samples. The property was visited by the writer on June 29, 1996, and again on July 18, 1996, to examine, map and sample the major new zones stripped by Mr McCombe. This report is appended.

The "gossan" zone received most of the attention by Mr McCombe and his helpers. Ultimately, an area measuring approximately 40' by 25' was hand stripped using a cum-a-long, winch and truck to remove stumps and roots and a high pressure pump to wash the outcrop. Various grab samples from different parts of this exposure yielded assays of 1522, 2258, 63, 2, 1238, 890 ppb and 0.017, 0.028, 0.001, & 0.048 opt.

Another area of intensive stripping was in the vicinity of the collar of the 36' deep shaft located in the southeast corner of claim 1205807 approximately 450' west of the pipeline. The shaft was sunk on a 3-4" quartz vein rimmed by a bleached, silicified, pyritized envelope up to 12" wide. Assays from the walls of the shaft returned 2883, 2795, 17, 2696 ppb and 0.018, 0.040, 0.098 & 0.110 opt.

The rock cuts on both sides of the pipeline near the north central boundary of claim 1205807 were cleaned and sampled. Values on the east side ranged from 103 to 784 ppb and 0.009 to 0.051 opt while those on the west side ran from 273 to 2057 ppb and 0.002 to 0.052 opt.

Considerable emphasis was also placed on the area surrounding the Sirola pits in the southwest corner of claim 1206101. Most of the pits were cleaned out or stripped along their perimeters. A number of samples were taken which yielded values up to 2597 ppb and 0.093 opt gold.

As a result of the extensive prospecting and follow-up stripping of old trenches, pits and areas of interest, Mr McCombe was able to option his property to a major company in early 1997.

QUALIFICATIONS

I, FRANK R. PLOEGER, DECLARE THAT:

- 1) I reside at 71 Ninth Avenue in Larder Lake, Ontario, Canada, P0K 1L0;
- 2) I graduated from Queens University in Kingston in 1973 with a B.Sc degree in Applied Science (Geology);
- 3) I have practiced my profession as a geologist continuously since graduation;
- 4) I am a Fellow of the Geological Association of Canada;
- 5) I twice visited the property and examined and documented most of the pertinent areas referred to in this report;
- 6) This report and the associated costs are based on information such as receipts, work records, assay certificates, etc. supplied by Mr McCombe as well as interviews with Mr McCombe and personal knowledge of the property from the two site visits mentioned above.

Apr 18/97 
F.R. Ploeger, B.Sc, FGAC

McCOMBE (BARRY) SHOWING, GRENFELL TWP
PROPERTY REPORT - VISITED JUNE 20, 1996, by F.R.PLOEGER.

INTRODUCTION: On June 20, 1996, the McCombe property was visited with Doug Cater, Alister Still and the owner. Outcrops and showings along the gas pipeline and the Nor-Gro nursery area were examined.

LOCATION: The property comprises 6 unpatented mining claims numbered 1205807, 1206101, 1206152, 1206394, 1211513, and 1211515 totalling 18 units in the south central part of Grenfell Twp (G- 3212). The latter two claims represent small fractions or wedges along the Blanche River. The group is located at approximately 80° 13' W longitude and 48 07' N latitude (NTS 559000E & 5329500N).

ACCESS: The south part of the property touches the Blanche River and the west boundary roughly parallels Hwy 11. The Trans Canada Gas Pipeline bisects the claim group along its north-south axis. Access to the northerly claims is via gravel roads running east from Hwy 11, and to the central and southern parts by a gravel bush road and a pipeline right-of-way road.

GEOLOGY: The south part of Grenfell Twp was mapped by Thomson (1950) and the entire township by Grant (1962). A report on the McCombe group was published following a property visit by Guindon (Meyer et. al., 1995). According to these earlier publications, the area is underlain by massive and pillowed mafic flows of probable Mg-tholeiitic Kinojevis Group affinity. Coarse-grained massive flow units often are gabbroic-textured. The overall strike of the mafic assemblage in the vicinity of the claims is reported at 330° with dips and tops facing steeply east. Regional metamorphism has altered the flows to lower greenschist facies. The host lithologies of the showings seen during the current visit all appeared to be fine to medium grained massive mafic flows with occasional "pillow-form" textures.

PAST WORK: The economic geology of Grenfell Twp was summarized by Grant as gold occurring in quartz veins with sulphides and some carbonate. Guindon quoted old reports that describe an association of gold mineralization with northwest trending shear zones on the claim group and the former Four Nations mine. Previous work in the vicinity of the McCombe Property is summarized below:

Four Nations Consolidated Gold Mines Ltd: At some time prior to 1933, a 500' deep shaft was sunk which was followed by considerable u/g development to November 1934. The Four Nations shaft is located approximately 3000' southeast of the centre of the McCombe group although his easterly claim fraction ties onto the shaft claim. Mafic flows with local porphyritic horizons host the gold-bearing quartz structures; at the shaft the veins strike N55-60°E and dip 65-75°S. On the 125' level, the vein "consists of a 4' width of quartz veinlets and pyritized wall rock" with assays ranging up to 0.11 opt "across drift width". On the 500' level, a 30-40' wide shear zone striking N70°E and dipping steeply south had undergone considerable development. Although the shear structure contained white quartz stringers, the values were "generally low". In a crosscut to the north on the 500' level, a vein zone consisting of "white quartz stringers and pyritized wall rock" with "a few

assays of medium grade" were also developed by drifting. Further north, this crosscut encountered a vein comprising "quartz stringers and vein breccia with low gold values" which may correspond to the vein on surface north of the river. This vein zone is paralleled on the north by a 4-5' gouge fault.

Hecmac Syndicate (file KL 1114): In 1959, the Hecmac Syndicate drilled 4 short diamond drill holes under an old reported showing at the base of the high area of outcrop near the bend in the gas pipeline on the present McCombe property. The holes intersected sequences of mafic volcanics with the best value of 0.10/3.5' obtained from a silicified, brecciated zone.

Legace Showing (file KL 1550): A report written in 1960 by H.D. McLeod of Sogemines Development Co. Ltd. described a showing exposed by bulldozing and trenching which has subsequently been covered. He reported values from 11 samples, 10 of which averaged \$4.00 (0.115 opt) with a range of \$1.75 (0.05 opt) to \$6.65 (0.19 opt) and one that assayed \$16.80 (0.48 opt).

Grenfell Syndicate (file KL 1049): In 1975, the Grenfell Syndicate put down one hole near the end of the dump road near the current north boundary of the claim group. All values were trace.

Sirola, Grant Trenching (file KL 2512): A series of new and old trenches east of the access road to the Nor-Gro Nursery and the dump access road were stripped, blasted and sampled by Sirola in 1980. According to the reports, the pits were put down on carbonatized and mineralized quartz veins. Values from the various trenches ranged from tr to 0.183 ppt with several in the 0.12-0.16 opt range in pits subsequently sampled during this visit.

Orcana Minerals (file KL 2512): Between 1981 and 1985, Orcana Minerals performed a number of different surveys on the Sirola group including magnetometer and VLF-EM (1981), geological (1983), and basal till (1983). Although no significant conductors or new showings were located with the surveys, and the best value from the basal till survey was 127 ppb, two follow-up diamond drill holes were collared in 1984 & 1985. Both holes intersected mafic flows containing local narrow quartz/quartz carbonate veins to 12" with minor pyritic halos and values to 0.005 & 0.016 opt respectively.

Guindon, Dave Property Visit: Dave Guindon of the Kirkland Lake Resident Geologist's office visited the McCombe property in 1995 and reported his trip in the Summary of Field Work of the Regional and Resident Geologists. His observations and NTS locations are included in the description of the sites sampled during the current visit.

CURRENT VISIT: During the visit of June 20, 1996, five outcrop areas were examined and sampled. These are described below along with their corresponding sketches and summaries which are appended to the end of the report.

Gossan Zone (559907E, 5328589N): The gossan zone occurs on the west edge of the gas pipeline in the central unit of claim 1206152. This was originally believed by Guindon to be a large piece of float with a 4-5' wide accompanying gossan zone however, when examined by the writer was determined to be in place. The gossan zone comprises angular, well fractured, in-situ rock fragments that are cemented by oxidized sulphides and carbonate from the altered volcanics and vein material. The fractured and mineralized mafic flows contain approximately 15% quartz-carbonate veining and silicification with up to 8% pyrite. McCombe reported values to 0.08 opt which is partially confirmed by samples 3423 of the rock fragments and 3424 of the soil which ran 0.044 & 0.066 respectively. A sample of foliated flow material west of the gossan assayed only 63 ppb.

Old 36' Shaft (559625E, 5328865N): An old 3' by 5' shaft for which there is no historical record, was measured by McCombe to be 36' deep. The shaft is located in the southeast corner of

claim 1205807 and is cribbed with lagging to the collar. It appears to be sunk on a 3-4" quartz vein enveloped in a 6-12" bleached (carbonatized-sericitized-silicified) halo which contains 7% sulphides (pyrite). Samples of vein material from both sides of the shaft (4605 & 4607) returned 0.082 & 0.079 opt respectively. This compares favourably with a grab sample of 0.10 reported by McCombe. A sample (2606) of a parallel vein structure in the rim of the shaft yielded only 17 ppb.

While returning from the shaft area, 2 old pits were spotted and sampled in an outcrop in a swamp. Two samples, 4608-09 of well-altered (sericitized-carbonatized) and weakly to moderately foliated, silicified, and pyritized flow assayed 9 & 27 ppb.

Pipeline (east side)(559256E, 5329357N): A number of samples were taken from the face of a rock cut to the east of the pipeline where McCombe had reported assays to 0.144 opt and where the Hecmac Syndicate had drilled 4 holes (see above). The host rock comprises massive fine grained mafic flows that are fractured and fresh to very mildly altered. Quartz carbonate veins with their alteration halos make up less than 0.5% of the rock. Veins strike at 260° with a steep rolling dip and range up to about 2" in width (average is 1") with negligible to narrow weakly-pyritic alteration rims. Three samples of vein material taken at equal intervals along the exposure yielded anomalous values of 103, 396, & 784 ppb gold.

Pipeline (west side): A series of outcrops exposed along the west edge of the pipeline were also examined. In travelling up the hill from north to south these are as follow: a) near bottom of hill - mafic flow, fine grained, non to slightly magnetic, dark green on fresh surface with a bright orange weathered rind, leathery (crocodile) -type weathering similar to komatiitic polyhedral joints, weakly carbonatized with about 1% disseminated pyrite crystals, weak fabric/fractures @ 280° with widely scattered 1/4" quartz stringers -not sampled; b) middle of hill- massive, coarse grained flow, also with oxidized rind, outcrop is cut by a series of quartz stringers to 1", strike @ 305° with vertical dip, local concentrations of sulphides in weak alteration halos, sample 4610 ran 45 ppb; c) at brow of hill - massive mafic flow, little or no pervasive carbonatization (oxidized weathering), minor vein-filled fractures to 1.5", strike is 010° with a vertical dip- not sampled; d) approximately 75' west of c - massive fine grained flow with local "pillow-like" forms that may be related to fracturing or jointing, several vein sets parallel to joints @ 262° dipping 18°N, minor quartz veins to 1" @ 305° & 005° with vertical dips and oxidized rims - not sampled; e) on crest of hill- similar rock cut to that on east side of pipeline, massive mafic flows, scattered quartz veins to 1" near south end with minor splays, strike @ 260° with undulating subvertical dips, sample 4614 returned 273 ppb.

Nor-Gro/Sirola pits (558396E, 5329454N): Access to this area was gained from Hwy 11 via the Nor-Gro nursery road. Chip samples of 2 veins were taken by the writer from the edge of the water-filled pit. Samples of the main vein from opposite sides of the pit yielded 830 & 2597 (0.076 opt) ppb respectively whereas the alteration rim ran only 389 ppb. Two samples from a parallel vein assayed 321 & 718 ppb. The main quartz vein strikes @ 290°, dips steeply north, and is flanked by a silicified, pyritized(5%), carbonatized alteration rim up to 12" wide. The parallel vein comprises a quartz breccia zone up to 16" wide with 70% included wall rock fragments and weak associated alteration. This vein system strikes @ 274° and dips 82°N. Several additional samples were taken by D. Cater from pits about 100' south. Sample 3425 is from a 12" iron-stained quartz vein with 3% pyrite which ran 878 ppb and 3426 from silicified, pyritized (3%) mafic host rock yielding 81 ppb.

APPENDIX: A- Sample Record Table: Summarizes all the samples taken and their assays.

Sample Record Table:

Barry McCombe Grenfel Township property visit 20 / 06 / 1996

Sample Number	Sample Location	Description	Assay Elements	Assay
3423	Gas line gossan	consists of numerous Fe stained rock fragments / mafic volc. host 5% py	31 element + Au	1522 ppb (0.044 opt)
3424	Geochem	as above but soil / sub-soil material	as above	2258 ppb (0.066 opt)
4604	Gas line area	sheared and bx mafic volcanic	Au only	63 ppb
4605, 06, 07	36' Shaft	4605 - Main vein, from the top of o/c 4606 - parallel qtz vein sample. 4607 - qtz vein and wallrock alteration on shaft bench area.	31 element / Au Au only Au only	2795 ppb (0.082 opt) 17 ppb 2696 ppb (0.079 opt)
4608 / 09	Swamp o/c	highly altered, sericite, py , mafic volc 08 = north pit / 09 is south o/c	31 element / Au Au only	9 ppb 27 ppb
4610	Tent o/c	Mafic flow, weak alteration, minor silicification and qtz vn / little to no sulf.	Au. Only	45 ppb
4611 - 4613	Swamp area	Quartz veins / local qtz bx with hostrock intrusions - minor pyrite content.	Au only 31 element on #13 -northern most sample location	103 ppb 396 ppb 784 ppb

4614	Last o/c site north of Tent-site on W. Side of gasline.	-1" quartz vein with trace to 1% pyrite. Hostrock was mafic flow.	Au. Only	273 ppb
4615 - 4619	Nor-gro Location	4615- Sirola Pit Alteration of the vein wall 4616- Sirola Pit - Main quartz vein. o/c 4617- parallel vein on west side of pit. Contained bx fragments of wall rock. 4618- parallel vein on east side of pit. Breccia type 16" wide quartz vein. 4619 - Main Vein - sampled from the bench- vein material + wallrock	Au - only 4619 sent for multi-element analysis.	389 ppb 830 ppb 321 ppb 718 ppb 2597 ppb (0.076 opt)
3425 - 3426	Nor-gro location southeast of Sirola pits	3425 -1' quartz vein, Fe stain, 3% py, mafic flow wallrock. Vein only. 3426 - silicified hostrock 2% py.	Multi element Au only.	878 ppb 81 ppb

NOTE: conversion factor is: ppb * 0.0000291667 = opt

filename\explore\mecombe.wp

B- Sample Location Sketches: Sketches of individual areas showing geology, locations, pits, assays, structure

GRENFELL WEST GROUP - STRIPPING
Submission Number: 2.17298

REVISIONS

- ◆ Location map relating the detailed maps to the property disposition
- ◆ Signatures from those that performed the work
- ◆ Please note that additional stripped areas uncovered largely massive and fresh volcanics which revealed no significant mineralization warranting follow-up mapping

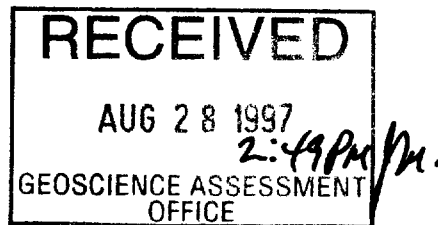

GRENFELL WEST GROUP - STRIPPING

August 21, 1997

This is to certify that all reported information related to stripping on the Grenfell West group of claims is a fair and reasonably accurate account of work that I personally conducted and supervised on the dates listed in the report.

B. McCombe Barry McCombe (LIC) K22-682

This certifies that the following persons listed below, did in fact assist Mr. McCombe with stripping on the Grenfell west group of claims.

E. Chi Chi E Chi Chi (NO LIC #)

E. Marion _____ - UNAVAILABLE

C. Petit Receipt Enclosed

~~G. Gagne~~ Staking Only

E. Boyce _____ - UNAVAILABLE

A. Arcand Jr. Albert Arcand JR K22719

D. Laing D Laing K22-727

G. Thompson G Thompson K22-737



BLUELINE

DATE June 2¹ 1995

RECEIVED FROM
REÇU DE

B. M. C. Combe 3000

For prospecting. Trenching

DOLLARS
100

FOR
POUR

30 day 100⁰⁰ per day

FROM
DE

May 1st

TO
A June 2nd

\$ 3000⁰⁰

BY
PAR

Ernie H. Chi

2550B

McCombe { Barry } Property
 Grenfell Tp { South Central Part }
 Sketch for Reference Only
 Not to Scale

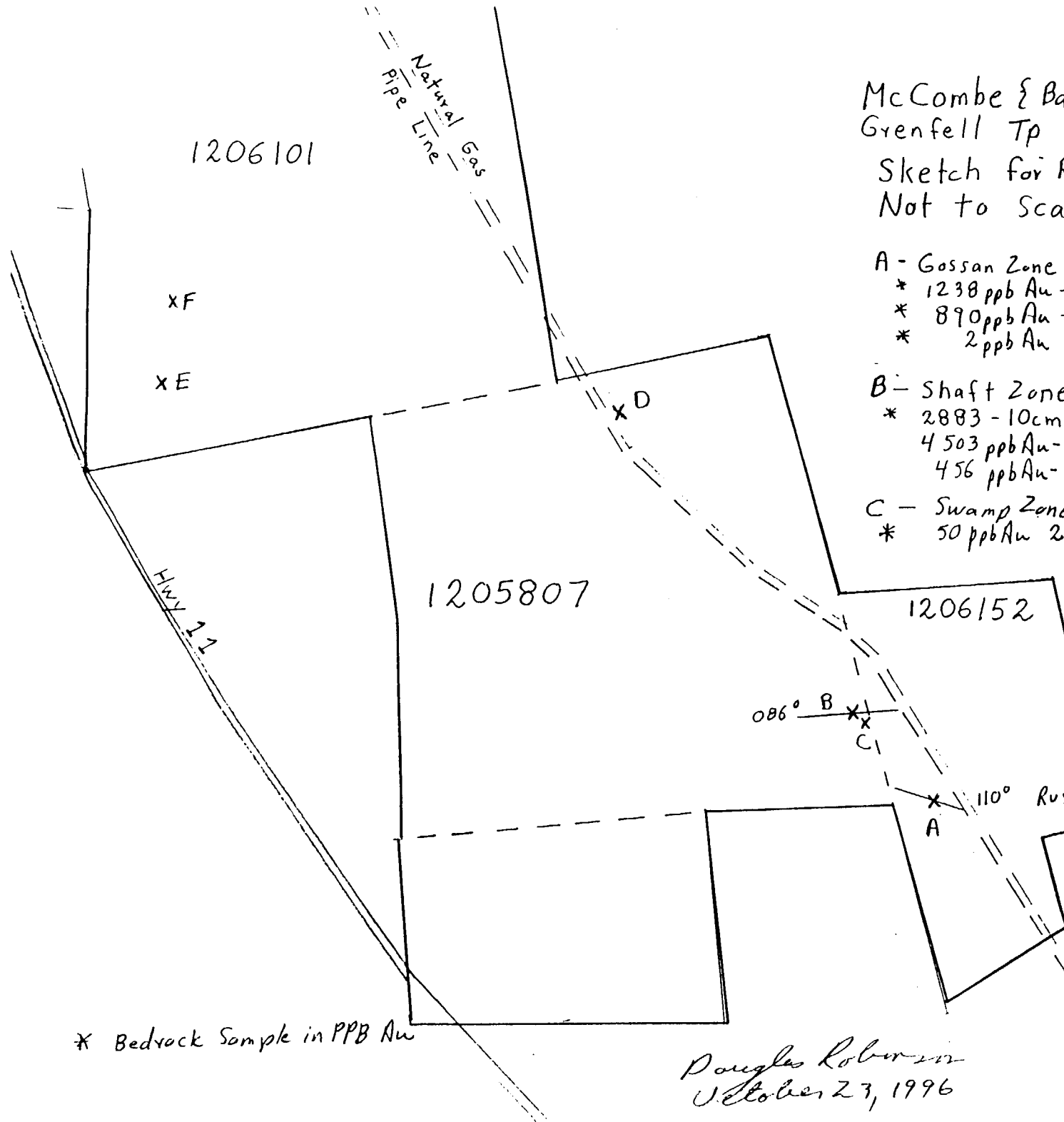

- A - Gossan Zone
 * 1238 ppb Au - 0.5 m Rusty Shear 5% Qtz Vein
 * 890 ppb Au - 0.3 m Rusty Shear 15% Qtz Vein
 * 2 ppb Au 1.0 m Shear 5% Py, 10% Qtz Veining

- B - Shaft Zone
 * 2883 - 10 cm Qtz Vein 1 m N of Shear 2-5% Py
 4503 ppb Au - 5 cm QV + 4 cm Pyritic Wall Rx.
 456 ppb Au - 5 cm Bleached Alteration 3% Py

- C - Swamp Zone
 * 50 ppb Au 2% Py from Wide { 20 m ± } Alteration Z

- D - Pipeline Rockcut.
 1090 ppb Au - 6 cm Banded Vague Qtz + Wall Rock 3% Py
 * 1195 ppb Au 4 cm Bleached Alteration (Calcite and Silicification?) 3% Py

110° Rusty Shear with Qtz Veining

- D Continued
 1982 ppb Au from Blast Muck Intense Siln, 5% Py
 1817 ppb Au from Blast Muck 60% Qtz Veining 3% Py
 Note Muck May be From Zone Trending SE parallel Pipeline

* Bedrock Sample in PPB Au

Douglas Robinson
 October 27, 1996

Enlargement
Main Pit.

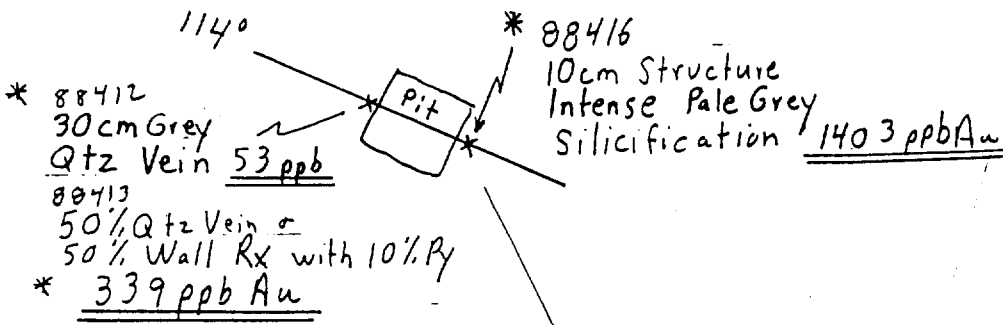

Pit
□ 144 ppb Au
Sample From Muck
5% Qtz Stockwork
30% Bleached Alteration
Centred on Stockwork
5% Py in Alteration

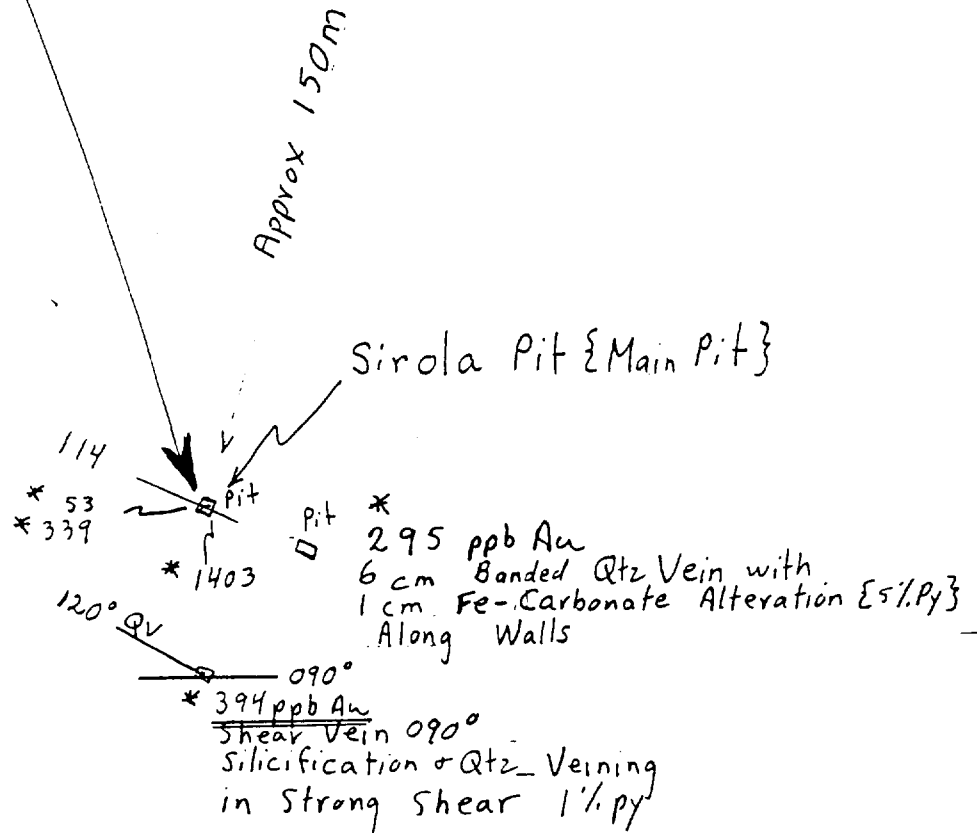

See Location Map - S1

Douglas Robinson
October 23, 1996

* Bedrock Samples ppb Au

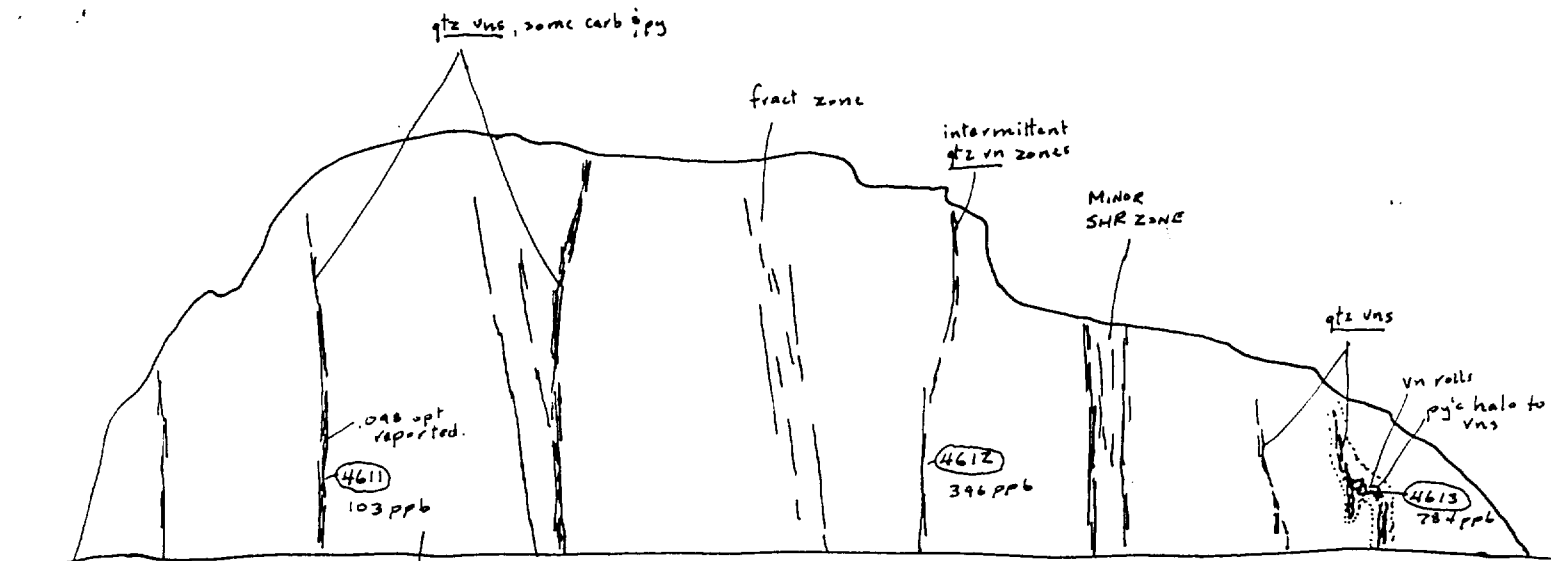

Host Rock - Mafic flows, f.g'rd, mass fract'd, med gy-blue, v. mildly alt'd to unalt'd - s. carb vns.

VEINS - qtz with minor carb
 - local bx zones/inclusions
 - local minor py lenses & splashes, to 1/4" wide
 - dips subvert (roll steep N to S)
 - about 6-10 narrow vns in face
 - discontinuous along fract's
 - v. little alt'n

SECTION OF AREA "E"
 ALONG/PARALLEL TO THE PIPELINE

-not to scale

June 20/96 JRP

-See Location Map S3
 Stripped 6'x12'

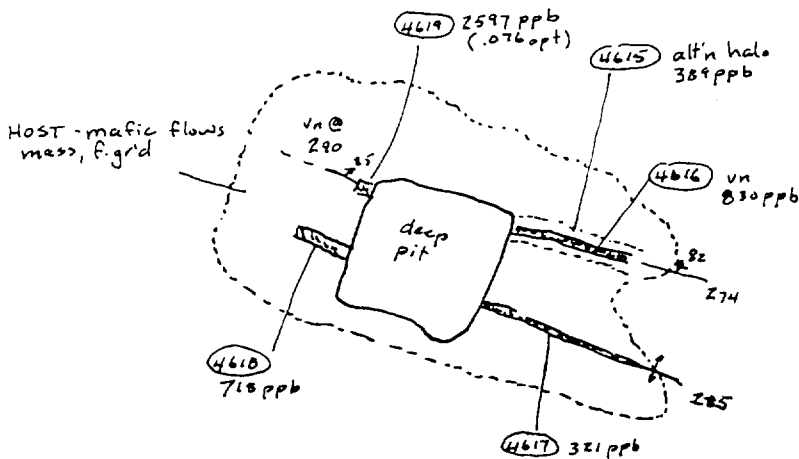

Mc COMBE - GRENFELL TWP
 NOR-GRO / SIROLA PIT AREA

-not to scale

June 20/96 JRP

See Location Map S4

Stripped ~ 10'x10'

- VEIN SAMPLES - 4615 - wall rock of main vn
 4616 - vn mat'l from main vn
 4617 - in wall of o/c, 4" bx vn
 4618 - mostly exfol'd pieces, bx vn up to 16" wide (ie qtz with wall rock frag's), not much alt'n of walls
 4619 - from inside pit - 2-4" vn with alt'd wall

NOTE: 2 samples taken by D. CATER about 50-100' to southeast
 3425 - 1' qtz vn, ox'd, 3% py in mafic flows (870 ppb)
 3426 - sil'd zone, 2% py (81 ppb)

McCOMBE: GRENFELL TWP
GOSSAN ZONE - NEW STRIPPING

JULY 18/96 VISIT
NOT TO SCALE
* - denotes June 23/96 sample result

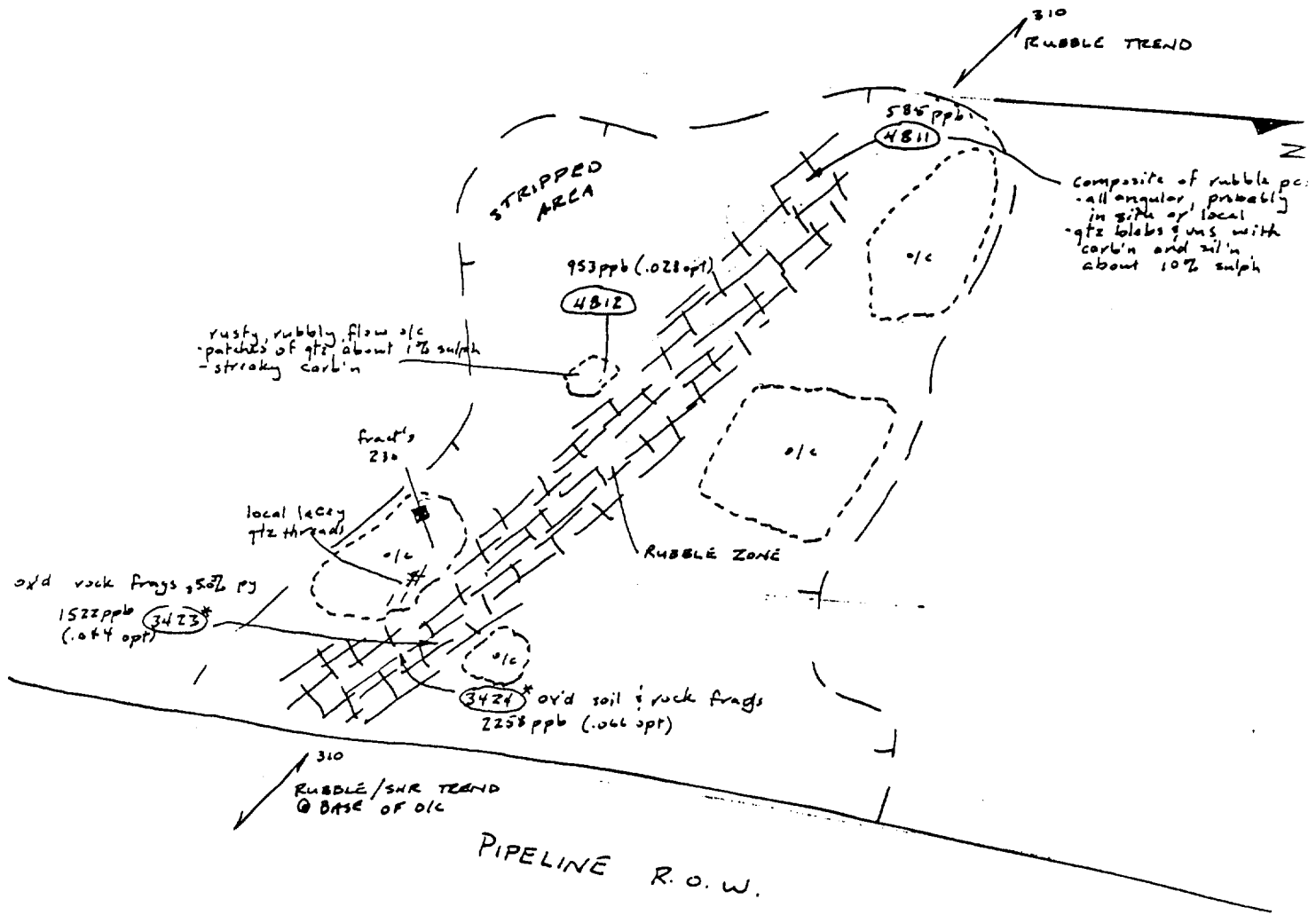
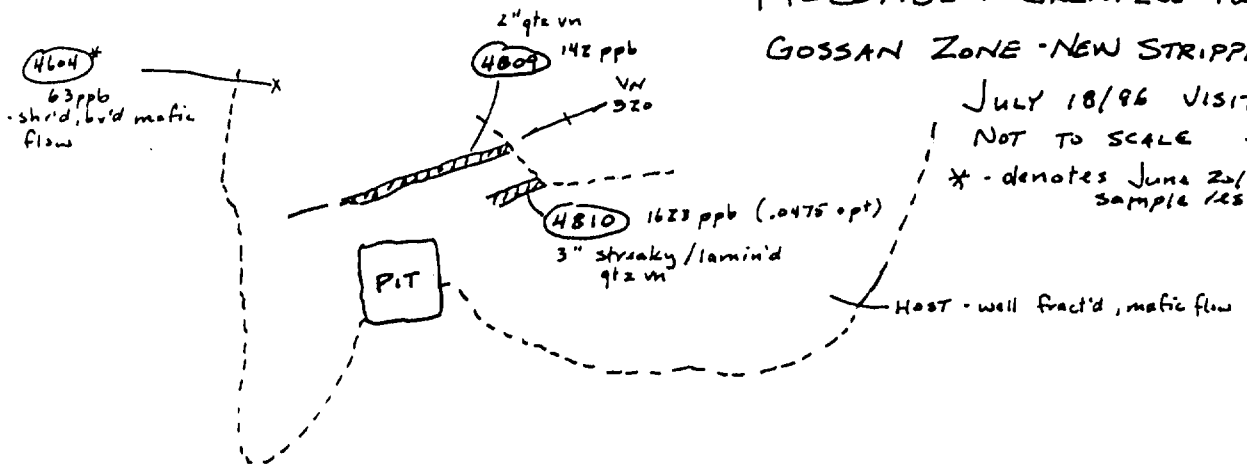

See Location Map S-2
STRIPPED AREA - 25'x40'

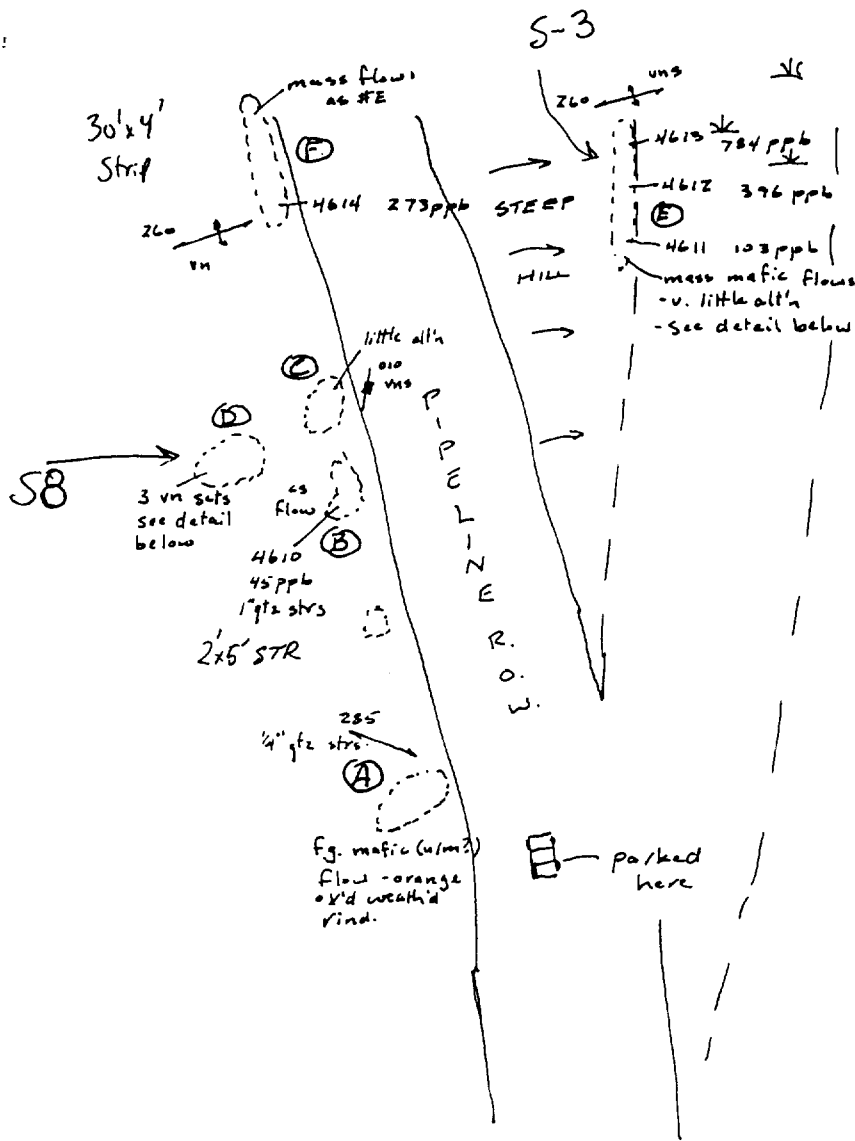

McCOMBE - GRENELL TWP
 PIPELINE SHOWINGS
 not to scale
 June 20/96 HAP.

SEE DETAILED DESCRIPTIONS
 BELOW

Map 2A

← Closeup from Map #2

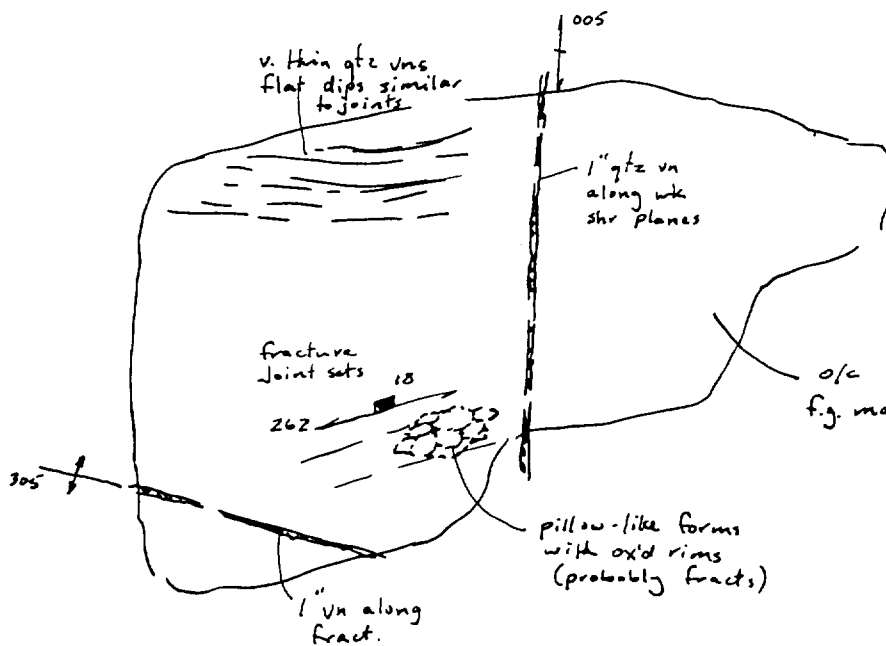

DETAIL SKETCH
 OF AREA "D"

- not to scale
 June 20/96 HAP.

- no samples taken
 - SEE LOCATION MAP S8

STRIPPED 20'x25'

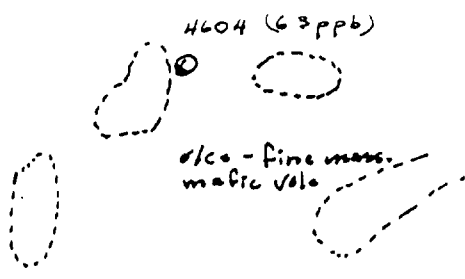

McCOMBE - GRENFELL TWP
GOSSAN ZONE

not to scale

June 20/96 JRP

See Location Map S5

Stripped 5'x11"

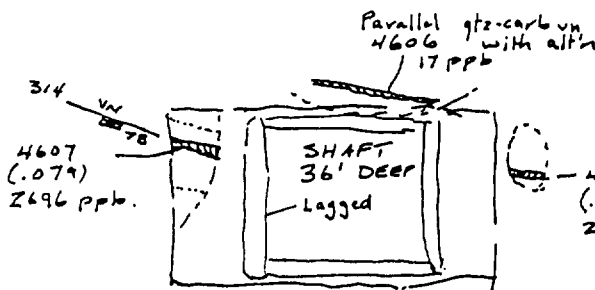
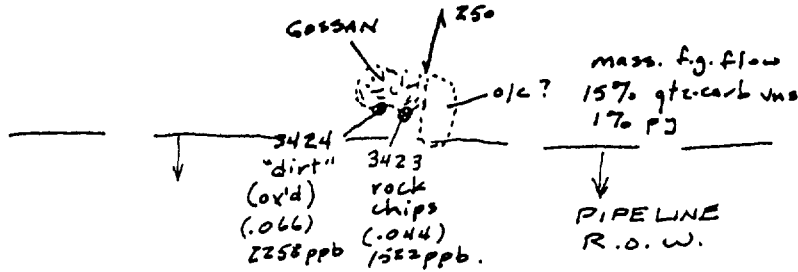

McCOMBE - GRENFELL TWP

SHAFT ZONE

not to scale

June 20/96 JRP

See Location Map S6

Stripped 10'x40'
Total

VEIN ZONES - 3"-4" qtz(carb)vns material with 6"-12" alt'n rims in the walls.
- about 7% py in the alt'n rims of the vein.

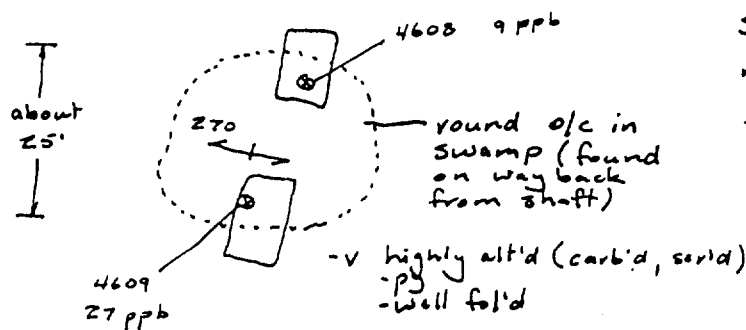

McCOMBE - GRENFELL TWP

SWAMP ZONE (near shaft)

not to scale

June 20/96 JRP

See Location Map S7

McCOMBE (BARRY) SHOWING, GRENFELL TWP
PROPERTY REPORT - VISITED JULY 18, 1996, by F.R. PLOEGER

INTRODUCTION: On July 18, 1996, the McCombe property was visited with Doug Cater and the owner. The newly stripped area surrounding the Gossan zone was examined and sampled during the current visit.

LOCATION, ACCESS, GEOLOGY, PAST WORK: see previous report (June 20, 1996)

CURRENT VISIT: Since the writers' previous visit, Mr McCombe had contracted to have the area of the gossan zone stripped. The stripping commenced at the site of the original gossan showing (0.044 & 0.066 opt) at the base of the outcrop and continued through the centre and around the base to the southwest. An area of approximately 1200 sq ft was uncovered. The stripping revealed a sheared/broken rubbly core of the outcrop which trended at 310°. Samples of angular float derived from this rubble contained veinlets and patches of quartz within carbonatized, silicified, and pyritized (to 10%) zones. Samples from this and in situ altered host mafic volcanics yielded 0.017 & 0.028, respectively.

Several 2-3" wide quartz veins in well-fractured mafic flows were uncovered near a trench approximately 50' west of the stripped area. The two veins which trended @ 320° and dipped vertically assayed 0.001 & 0.048 opt. It appears that the gossan zone and vein systems are associated with an overall northwesterly trending structural and alteration regime.



Swastika Laboratories

A Division of TSL/Assayers Inc.

Assaying - Consulting - Representation

Established 1928

Assay Certificate

5W-3611-RA1

Company: **B. McCOMBE**

Date: SEP-20-95

Project:

Attn: **B. McCombe**

We hereby certify the following Assay of 1 Rock samples submitted SEP-15-95 by .

Sample Number	Au oz/ton	Au Check oz/ton	Te PPM
M-1 w of tent	0.029	0.026	2

4

Certified by *Diana Christie*

P.O. Box 10, Swastika, Ontario P0K 1T0
Telephone (705) 642-3244 FAX (705) 642-3300



Swastika Laboratories

A Division of TSL/Assayers Inc.

Assaying - Consulting - Representation

Established 1928

Assay Certificate

5W-3541-RA1

Company: **B. McCOMBE**

Date: SEP-12-95

Project:

Attn: **B. McCombe**

We hereby certify the following Assay of 5 Rock samples submitted SEP-08-95 by .

Sample Number	Au oz/ton	Au Check oz/ton
B-1	0.016	-
B-2	0.043	0.041
B-3	0.050	0.050
B-4	0.015	-
B-5	0.007	-

E of pipeline

3

N-S

Certified by



SWASTIKA LABORATORIES

A Division of TSL/Assayers Inc.

Assaying - Consulting - Representation

Established 1928

Assay Certificate

5W-3433-RA1

Company: **B. McCOMBE**

Date: AUG-30-95

Project:

Attn: B. McCombe

We hereby certify the following Assay of 3 rock samples submitted AUG-28-95 by .

Sample Number	Au oz/ton	Au Check oz/ton
C1	0.035	0.035
A-shaft	0.018	-
B-1 B-zone	0.009	0.009



Certified by

P.O. Box 10, Swastika, Ontario P0K 1T0

Telephone (705) 642-3244

FAX (705) 642-3300



Established 1928

Swastika Laboratories

A Division of TSL/Assayers Inc.

Assaying - Consulting - Representation

Assay Certificate

5W-2298-RA1

Company: **B. McCOMBE**
Project:
Attn: **B. McCombe**

Date: MAY-23-95

We hereby certify the following Assay of 6 Rock samples submitted MAY-16-95 by .

Sample Number	Au oz/ton	Au Check oz/ton
C-1	0.062	0.060
C-2	0.002	-
C-3	0.004	-
C-4-A	0.002	-
C-5	0.028	-
C-6	0.052	-

pipeliner

Certified by

P.O. Box 10, Swastika, Ontario P0K 1T0
Telephone (705) 642-3244 FAX (705) 642-3300



Swastika Laboratories

A Division of TSL/Assayers Inc.

Established 1928

Assaying - Consulting - Representation

Assay Certificate

5W-3759-RA1

Company: **B. McCOMBE**
Project:
Attn: B. McCombe

Date: SEP-29-95

We hereby certify the following Assay of 2 Rock samples submitted SEP-27-95 by .

Sample Number	Au oz/ton	Au Check oz/ton
2953	0.098	0.092
2954	0.040	0.036

shaft

5

Certified by *Dennis Chantre*

P.O. Box 10, Swastika, Ontario P0K 1T0
Telephone (705) 642-3244 FAX (705) 642-3300

26030



Swastika Laboratories

A Division of TSL/Assayers Inc.

Assaying - Consulting - Representation

Established 1928

Assay Certificate

6W-2043-RA1

Company: **B. McCOMBE**

Date: JUN-12-96

Project:

Attn: B. McCombe

We hereby certify the following Assay of 1 Mill Residue samples submitted JUN-10-96 by .

Sample Number	Au oz/ton	Au Check oz/ton
#1 <i>shaft area</i>	0.110	0.102

shaft
(?)

One assay ton portion used.

Certified by *Dennis Chate*



Swastika Laboratories

A Division of TSL/Assayers Inc.

Assaying - Consulting - Representation

Established 1928

Assay Certificate

6W-2417-RA1

Company: **B.McCOMBE**
Project:
Attn: **B.McCombe**

Date: JUL-11-96

We hereby certify the following Assay of 4 Rock samples submitted JUL-08-96 by .

Sample Number	Au oz/ton	Au Check oz/ton
Part B	0.045	-
Part C	0.093	0.090
Part D	0.058	0.062
S. Pit #1	0.054	-

Swastika pits

2

One assay ton portion used.

Certified by *Denis Chah*

P.O. Box 10, Swastika, Ontario P0K 1T0
Telephone (705) 642-3244 FAX (705) 642-3300



Swastika Laboratories

A Division of TSL/Assayers Inc.

Assaying - Consulting - Representation

Established 1928

Assay Certificate

6W-3244-RA1

Company: B. MCCOMBE

Date: SEP-03-96

Project:

Attn: B. McCombe

We hereby certify the following Assay of 1 Rock samples submitted AUG-26-96 by .

Sample Number		Au oz/ton	Au check oz/ton
#1	River dm trunch	0.002	0.002

(Handwritten mark)

One assay ton portion used.

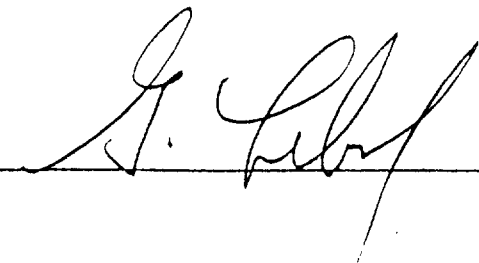
Certified by 



Swastika Laboratories

E.M.

A Division of TSL/Assayers Inc.

Established 1928

Assaying - Consulting - Representation

Geochemical Analysis Certificate

5W-3547-RG1

Company: **E. MARION**

Date: SEP-19-95

Project:

Attn: E. Marion

We hereby certify the following Geochemical Analysis of 4 Rock samples submitted SEP-11-95 by .

Sample Number		Au PPB	Au Check PPB	Te PPM	Multi Element
E-1	} <i>Wast of camp</i>	RUSTY GRB - 7	-	-	Results to follow
E-2		EPIDORITE AZ - Nil	-	-	
E-3		PINKISH AZ - 1419	1368	-	
E-4	TECK TWP 134264	129670	3.92 opt.		

10

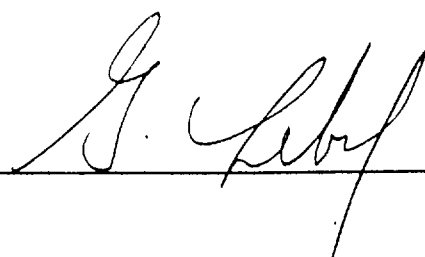
Certified by 



Swastika Laboratories

A Division of TSL/Assayers Inc.

Established 1928

Assaying - Consulting - Representation

Geochemical Analysis Certificate

Barry McCombe Properties
Grenfell Twp.

6W-4054-RG1

Company: **G. CHITARONI**
Project: Grenfel
Attn: G. Chitaroni/D. Robinson

Date: OCT-22-96

We hereby certify the following Geochemical Analysis of 17 Rock samples submitted OCT-09-96 by .

Sample Number	Au PPB	Au Check PPB	
88401 Gossan Zone on Gas Line	238	-	
88402 " "	890	-	
88403 S/Py in Shear - "	2	-	
88404 Shaft west of Pipe Line	2883	2671	
88405 ≈ 1/4 km N of Gossan Zone	503	4217	5' shaft
88406 " "	454	-	
88407 swamp O.C. wide Altn Zone	50	-	South + East of Shaft (75m SE)
88408 Pipe Line Rock Cut	1090	-	
88409 and Muck ≈ 3/4 km	1195	-	both sides mostly w
88410 North Gossan Zone	1982	1961	
88411	1817	2057	
88412 Sitola Pits and	53	-	
88413 Area	339	358	
88414	295	-	
88415	144	-	
88416	1403	-	Northern Pit ≈ 150 m N of Main Pit (Muck)
88417	394	-	

One assay ton portion used.

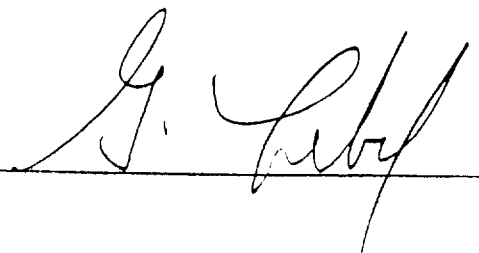
Certified by 

P.O. Box 10, Swastika, Ontario P0K 1T0
Telephone (705) 642-3244 FAX (705) 642-3300



Swastika Laboratories

A Division of TSL/Assayers Inc.

Established 1928

Assaying • Consulting • Representation

Geochemical Analysis Certificate

6W-4636-RG1

Company: **KINROSS GOLD CORPORATION**
 Project: **Macassa Division PO# 42192**
 Attn: **F. Ploeger**

Date: NOV-07-96

We hereby certify the following Geochemical Analysis of 1 Rock samples submitted NOV-05-96 by .

Sample Number	Au PPB	Au Check PPB
FRP #2	686	653

See notes
Greenfill

B. McCORME
350' E of Siroda pits
.02

40% gte stockworks in silica
matrix fill?

One assay ton portion used.

Certified by

P.O. Box 10, Swastika, Ontario P0K 1T0
 Telephone (705) 642-3244 FAX (705) 642-3300



Swastika Laboratories

A Division of TSL/Assayers Inc.

Assaying - Consulting - Representation

Established 1928

Geochemical Analysis Certificate

6W-2573-RG1

Company: **KINROSS GOLD CORPORATION**
Project: Macassa Division PO# 42192
Attn: F.Ploeger

Date: JUL-23-96

We hereby certify the following Geochemical Analysis of 4 Rock samples submitted JUL-18-96 by .

Sample Number	Au PPB	Au Check PPB	Au oz/ton	Au Check oz/ton
4809	142	-	0.001	-
4810	1575	1670	0.046	0.049
4811	597	573	0.017	0.017
4812	953	-	0.028	-

One assay ton portion used.

Certified by

P.O. Box 10, Swastika, Ontario P0K 1T0
Telephone (705) 642-3244 FAX (705) 642-3300



Swastika Laboratories

A Division of TSL/Assayers Inc.

Assaying - Consulting - Representation

Established 1928

Geochemical Analysis Certificate

6W-2198-RG1

Company: **KINROSS GOLD CORPORATION**
Project: PO# 42170
Attn: D.Cater/F.Ploeger

Date: JUN-26-96

We hereby certify the following Geochemical Analysis of 20 Rock samples submitted JUN-21-96 by .

Sample Number	Au PPB	Au Check PPB	Multi Element	\bar{X}_{PPB}	$\equiv OPT$
3423	1500	1543	Results to follow	1521.5	.044
3424	2261	2254		2257.5	.066
3425	878	-			.026
3426	81	-			.002
4604	63	-			.002
4605	2950	2640		2795	.082
4606	17	-			
4607	2674	2717		2695.5	.079
4608	9	-			
4609	27	-			
4610	45	-			
4611	103	-			.003
4612	396	-			.012
4613	813	754		783.5	.023
4614	273	-			.008
4615	389	-			.011
4616	830	-			.024
4617	321	-			.009
4618	694	742		718	.021
4619	2897	2297		2597	.076

One assay ton portion used.

Certified by _____

P.O. Box 10, Swastika, Ontario P0K 1T0
Telephone (705) 642-3244 FAX (705) 642-3300

KINROSS GOLD CORPORATION

ATTN: D. CATER & F. FLOEGER

PROJ:

6W-2198-R01

TSL/ASSAY Laboratories

1270 PEWSTER DRIVE, UNIT 3 MISSISSAUGA, ONTARIO L4W 1A4

PHONE #: (905)602-8236

FAX #: (905)206-0513

REPORT NO. : M7652

Page No. : 1 of 1

File No. : JN25MB

Date : JUN-27-1996

I.C.A.P. PLASMA SCAN

Aqua-Regia Digestion

SAMPLE #	Ag	Al	As	B	Ba	Be	Bi	Ca	Cd	Co	Cr	Cu	Fe	Mg	Mn	Mo	Na	Ni	P	Pb	Sb	Se	Sn	Sr	Tl	V	W	Y	Zn	Zr
	ppm	%	ppm	ppm	ppm	ppm	ppm	%	ppm	ppm	ppm	ppm	%	%	ppm	ppm	%	ppm	ppm	ppm	ppm	ppm	ppm	ppm	ppm	ppm	ppm	ppm	ppm	ppm
3423	3	2.3	< 5	< 10	1	< 1	< 5	0.31	< 1	33	160	95	9.3	2.0	670	< 2	0.04	50	510	< 1	< 5	20	< 10	6	160	370	< 10	7	69	6
3425	< 1	0.22	5	< 10	2	< 1	< 5	0.63	< 1	38	260	15	5.3	0.27	770	8	0.04	23	590	32	< 5	9	< 10	12	140	64	< 10	5	20	5
4605	14	1.8	< 5	< 10	17	< 1	< 5	8.1	< 1	51	95	340	6.8	1.0	1300	< 2	0.02	26	470	2	< 5	14	< 10	75	56	150	< 10	6	54	7
4608	1	1.5	< 5	< 10	4	< 1	< 5	7.3	< 1	31	75	83	7.9	1.6	1700	< 2	0.02	48	370	< 1	< 5	13	< 10	32	24	91	< 10	6	85	4
4613	2	1.6	5	< 10	< 1	< 1	< 5	7.3	< 1	28	160	77	4.7	1.7	820	24	0.03	32	220	1	< 5	12	< 10	29	1300	150	< 10	6	53	7
4619	2	1.9	< 5	< 10	13	< 1	< 5	0.65	< 1	37	340	23	5.2	0.80	780	4	0.03	37	530	< 1	< 5	12	< 10	10	110	120	< 10	6	53	7

TSL/ASSAY 60:00 96. 02 H11C

A .5 gm sample is digested with 2 ml of 3:1 HCL/HNO3 at 95 C for 90 min and diluted to 10 ml with DI H2O
 This method is partial for many oxide materials

SIGNED: 



Declaration of Assessment Work Performed on Mining Land

Mining Act, Subsection 65(2) and 66(3), R.S.O. 1990

Transaction Number (office use)
W9780.00315
Assessment Files Research Imaging

Personal information collected under the Mining Act, the information is for the purposes of the Mining Act. Questions about this collection of information should be directed to the Ministry of Northern Development and Mines, 6th Floor, 933 Ramsey Lake Road, Sudbury, Ontario N2T 1K6.

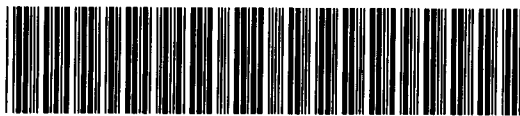

42A01NE0307 2.17298 GRENFELL

the Mining Act. Under section 8 of the Mining Act, the information is for the purposes of the Mining Act. Questions about this collection of information should be directed to the Ministry of Northern Development and Mines, 6th Floor, 933 Ramsey Lake Road, Sudbury, Ontario N2T 1K6.

900

Instructions: - For work performed on Crown Lands before recording a claim, use form 0240.
- Please type or print in ink.

1. Recorded holder(s) (Attach a list if necessary)

Name <u>KINROSS GOLD CORPORATION</u>	Client Number <u>130666</u>
Address <u>40 KING ST W 56th FLOOR</u>	Telephone Number <u>416-365-5123</u>
<u>TORONTO ONT M5H 3Y2</u>	Fax Number
Name	Client Number
Address	Telephone Number
	Fax Number

RECEIVED
APR 24 1997
MINING LANDS BRANCH

2. Type of work performed: Check (✓) and report on only ONE of the following groups for this declaration.

Geotechnical: prospecting, surveys, assays and work under section 18 (regs) Physical: drilling, stripping, trenching and associated assays Rehabilitation

Work Type <u>STRIPPING - GOLD (GRENFELL WEST)</u>	Office Use
	Commodity
	Total \$ Value of Work Claimed <u>25646</u>
Dates Work Performed From <u>16</u> <u>04</u> <u>95</u> To <u>27</u> <u>10</u> <u>96</u>	NTS Reference
Global Positioning System Data (if available) <u>NTS - 559000 E</u> <u>5329500 N</u>	Mining Division <u>Kirkland Lake</u>
Township/Area <u>GRENFELL</u>	Resident Geologist District <u>Kirkland Lake</u>
M or G-Plan Number <u>G-3212</u>	

Please remember to: - obtain a work permit from the Ministry of Natural Resources as required;
- provide proper notice to surface rights holders before starting work;
- complete and attach a Statement of Costs, form 0212;
- provide a map showing contiguous mining lands that are linked for assigning work;
- include two copies of your technical report.

3. Person or companies who prepared the technical report (Attach a list if necessary)

Name <u>F.R. PLOEGER 9/6 KINROSS GOLD CORPORATION</u>	Telephone Number <u>705-567-5208</u>
Address <u>Box 550, KIRKLAND LAKE, ONT, P2N 3J7</u>	Fax Number <u>705-568-3136</u>
Name	Telephone Number
Address	Fax Number
Name	Telephone Number
Address	Fax Number

RECEIVED
APR 21 1997
MINING DIVISION
KIRKLAND LAKE

4. Certification by Recorded Holder or Agent

I, F.R. PLOEGER (Print Name), do hereby certify that I have personal knowledge of the facts set forth in this Declaration of Assessment Work having caused the work to be performed or witnessed the same during or after its completion and, to the best of my knowledge, the annexed report is true.

Signature of Recorded Holder or Agent <u>[Signature]</u>	Date <u>Apr 19/97</u>
Agent's Address <u>see above</u>	Telephone Number
	Fax Number

3. Work to be recorded and distributed. Work can only be assigned to claims that are contiguous (adjoint) the mining land where work was performed, at the time work was performed. A map showing the contiguous must accompany this form.

129790.00315 25646

Mining Claim Number. Or if work was done on other eligible mining land, show in this column the location number indicated on the claim map.	Number of Claim Units. For other mining land, list hectares.	Value of work performed on this claim or other mining land.	Value of work applied to this claim.	Value of work assigned to other mining claims.	Bank. Value to be distributed at a future date.
eg TB 7827	16 ha	\$26,825	N/A	\$24,000	\$2,825
eg 1234567	12	0	\$24,000	0	0
eg 1234568	2	\$8,892	\$4,000	0	\$4,892
1 1205807-	4	5514-	3200-	714-	1600-
2 1206101.	7	5514-	15600-	-	-
3 1206152,	3	12823-	2400-	1177	9246 ✓
4 1206394-	2	513-	1600-	-	-
5 1211513-	1	0-	800-	-	-
6 1211515-	1	1282-	800-	82	400-
7					
8					
9					
10					
11					
12					
13					
14					
15					
Column Totals		25646	14400	1973	11,246

10 claims
18 units

I, F. R. PLOEGER, do hereby certify that the above work credits are eligible under subsection 7 (1) of the Assessment Work Regulation 6/96 for assignment to contiguous claims or for application to the claim where the work was done.

Signature of Recorded Holder or Agent Authorized in Writing: [Signature] Date: Apr 19/97

6. Instructions for cutting back credits that are not approved.

Some of the credits claimed in this declaration may be cut back. Please check (✓) in the boxes below to show how you wish to prioritize the deletion of credits:

- 1. Credits are to be cut back from the Bank first, followed by option 2 or 3 or 4 as indicated.
- 2. Credits are to be cut back starting with the claims listed last, working backwards; or
- 3. Credits are to be cut back equally over all claims listed in this declaration; or

Credits are to be cut back as prioritized on the attached appendix or as follows (describe):

RECEIVED
APR 24 1997
MINING DIVISION

8.12298

Note: If you have not indicated how your credits are to be deleted, credits will be cut back from the Bank first, followed by option number 2 if necessary.

For Office Use Only
Received Stamp: 97 APR 21 PM 1 46
MINING DIVISION
LANDER LAKE

Deemed Approved Date: July 20/02
Date Approved: [Signature]
Total Value of Credit Approved: _____
Approved for Recording by Mining Recorder (Signature): [Signature]

Personal information collected on this form is obtained under the authority of subsection 6(1) of the Assessment Work Regulation 6/96. Under section 8 of the Mining Act, the information is a public record. This information will be used to review the assessment work and correspond with the mining land holder. Questions about this collection should be directed to the Chief Mining Recorder, Ministry of Northern Development and Mines, 6th Floor, 933 Ramsey Lake Road, Sudbury, Ontario, P3E 6B5.

Work Type	Units of Work <small>Depending on the type of work, list the number of hours/days worked, metres of drilling, kilometres of grid line, number of samples, etc.</small>	Cost Per Unit of work	Total Cost
STRIPPING - GREENFELL WEST.			
B. McCOMBE ('95)	33 days	@ 150"/day	4950
HELPERS ('95)	29 "	@ 100"/day	2900
B. McCOMBE ('96)	57 "	@ 150"/day	8550
HELPERS ('96)	54 "	@ 100"/day	5400
Associated Costs (e.g. supplies, mobilization and demobilization).			3208
Assays			352.00
Rentals			790.00
Supplies - maps, reports, stationery, etc.			557.00
Report & Maps / consulting			300.00
Transportation Costs			
GAS			1050.00
Food and Lodging Costs			
Accommodation			200.00
Meals			597.00
Total Value of Assessment Work			25646.00

RECEIVED
 APR 24 1997
 MINING LANDS BRANCH

Calculations of Filing Discounts:

1. Work filed within two years of performance is claimed at 100% of the above Total Value of Assessment Work.
2. If work is filed after two years and up to five years after performance, it can only be claimed at 50% of the Total Value of Assessment Work. If this situation applies to your claims, use the calculation below:

TOTAL VALUE OF ASSESSMENT WORK $\times 0.50 =$ Total \$ value of worked claimed.

Note:
 - Work older than 5 years is not eligible for credit.
 - A recorded holder may be required to verify expenditures claimed in this statement of costs within 45 days of a request for verification and/or correction/clarification. If verification and/or correction/clarification is not made, the Minister may reject all or part of the assessment work submitted.

Certification verifying costs:

I, F. R. ROEGER (please print full name), do hereby certify, that the amounts shown are as accurate as may reasonably be determined and the costs were incurred while conducting assessment work on the lands indicated on the accompanying Declaration of Work form as AGENT - KINROSS GOLD CORP. I am authorized (recorded holder, agent, or state company position with signing authority) to make this certification.

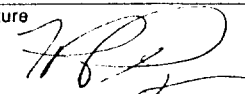
Signature 	Date Apr 19/97
---	-------------------

September 24, 1997

KINROSS GOLD CORPORATION
40 KING STREET WEST
56TH FLOOR
TORONTO, Ontario
M5H-3Y2

Geoscience Assessment Office
933 Ramsey Lake Road
6th Floor
Sudbury, Ontario
P3E 6B5

Telephone: (888) 415-9846
Fax: (705) 670-5863

Dear Sir or Madam:

Submission Number: 2.17298

Status

Subject: Transaction Number(s): W9780.00315 Approval After Notice

We have reviewed your Assessment Work submission with the above noted Transaction Number(s). The attached summary page(s) indicate the results of the review. **WE RECOMMEND YOU READ THIS SUMMARY FOR THE DETAILS PERTAINING TO YOUR ASSESSMENT WORK.**

If the status for a transaction is a 45 Day Notice, the summary will outline the reasons for the notice, and any steps you can take to remedy deficiencies. The 90-day deemed approval provision, subsection 6(7) of the Assessment Work Regulation, will no longer be in effect for assessment work which has received a 45 Day Notice.

Please note any revisions must be submitted in DUPLICATE to the Geoscience Assessment Office, by the response date on the summary.

If you have any questions regarding this correspondence, please contact Bruce Gates by e-mail at gates_b@torv05.ndm.gov.on.ca or by telephone at (705) 670-5856.

Yours sincerely,



ORIGINAL SIGNED BY
Blair Kite
Supervisor, Geoscience Assessment Office
Mining Lands Section

Work Report Assessment Results

Submission Number: 2.17298

Date Correspondence Sent: September 24, 1997

Assessor: Bruce Gates

Transaction Number	First Claim Number	Township(s) / Area(s)	Status	Approval Date
W9780.00315	1200393	GRENFELL	Approval After Notice	September 01, 1997

Section:

10 Physical PSTRIIP

The revisions outlined in the Notice dated July 18, 1997, have for the most part been corrected. Accordingly, assessment work credit has been approved as outlined on the Declaration of Assessment Work Form accompanying this submission.

Correspondence to:

Resident Geologist
Kirkland Lake, ON

Assessment Files Library
Sudbury, ON

Recorded Holder(s) and/or Agent(s):

Alastair C. Still
KIRKLAND LAKE, ON, CANADA

KINROSS GOLD CORPORATION
TORONTO, Ontario

INDEX TO LAND DISPOSITION

PLAN
G-3212
 TOWNSHIP

M.N.R. ADMINISTRATIVE DISTRICT
KIRKLAND LAKE
 MINING DIVISION
LARDER LAKE
 LAND TITLES/REGISTRY DIVISION
TIMISKAMING

GRENFELL

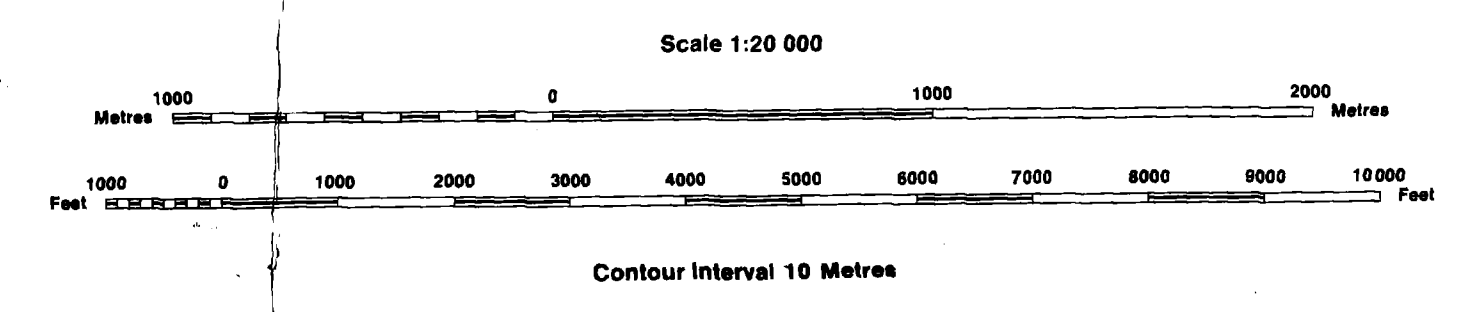

SYMBOLS

Boundary	
Township, Meridian, Baseline	—
Road allowance; surveyed	—
shoreline	—
Loi/Concession; surveyed	—
unsurveyed	—
Parcel; surveyed	—
unsurveyed	—
Right-of-way; road	—
railway	—
utility	—
Reservation	—
Cliff, Pit, Pile	—
Contour	—
Interpolated	—
Approximate	—
Depression	—
Control point (horizontal)	—
Flooded land	—
Mine head frame	—
Pipeline (above ground)	—
Railway; single track	—
double track	—
abandoned	—
Road; highway, county, township	—
access	—
trail, bush	—
Shoreline (original)	—
Transmission line	—
Wooded area	—

AREAS WITHDRAWN FROM DISPOSITION

MRO - Mining Rights Only
 SRO - Surface Rights Only
 M+S - Mining and Surface Rights

SAND AND GRAVEL

GRAVEL FILE 127536
 GRAVEL FILE 127784
 M.T.C. GRAVEL PIT
 GRAVEL FILE 64647

PENDING APPLICATION FOR SURFACE RIGHTS UNDER THE PUBLIC LANDS ACT

TCPL [PIPELINE] APPLICATION FOR RIGHT OF WAY

Surface Rights Withdrawn under Sec. 36, The Mining Act R.S.O. 1980, ORDER NO. W-01/91/OVT (Trans Canada Pipeline Right of Way and Buffer Zone particularly 40.25 metres or 132 ft. on either side of centre line of right of way)

SURFACE AND MINING RIGHTS WITHDRAWN FROM PROSPECTING, STAKING OUT, SALE OR LEASE SECTION, THE MINING ACT, RSO 1990

W-L-19/96 NER

NOTES

ALL ISLANDS IN SESEKINIKA LAKE ARE WITHDRAWN FROM STAKING BY ORDEN-IN-COUNCIL DATE DECEMBER 7, 1991

NOTICE OF FORESTRY ACTIVITY

THIS TOWNSHIP/AREA FALLS WITHIN THE TIMISKAMING MANAGEMENT UNIT AND MAY BE SUBJECT TO FORESTRY OPERATIONS. THE MNR UNIT FORESTER FOR THIS AREA CAN BE CONTACTED AT: P.O. BOX 129 SWASTIKA, ONTARIO P.O.K. -170 705-642-3222

DISPOSITION OF CROWN LANDS

Patent	
Surface & Mining Rights	●
Surface Rights Only	○
Mining Rights Only	○
Lease	
Surface & Mining Rights	■
Surface Rights Only	□
Mining Rights Only	□
Licence of Occupation	▽
Order-in-Council	OC
Cancelled	○
Reservation	○
Sand & Gravel	○

ARCHIVED JUNE 12, 1996

CIRCULATED AUG. 11, 1992 B.R.B.
 ARCHIVED DECEMBER 19, 1992

ARCHIVED JUNE 01/96

Map base and land disposition drafting by Surveys and Mapping Branch, Ministry of Natural Resources

The disposition of land, location of lot fabric and parcel boundaries on this index was compiled for administrative purposes only.

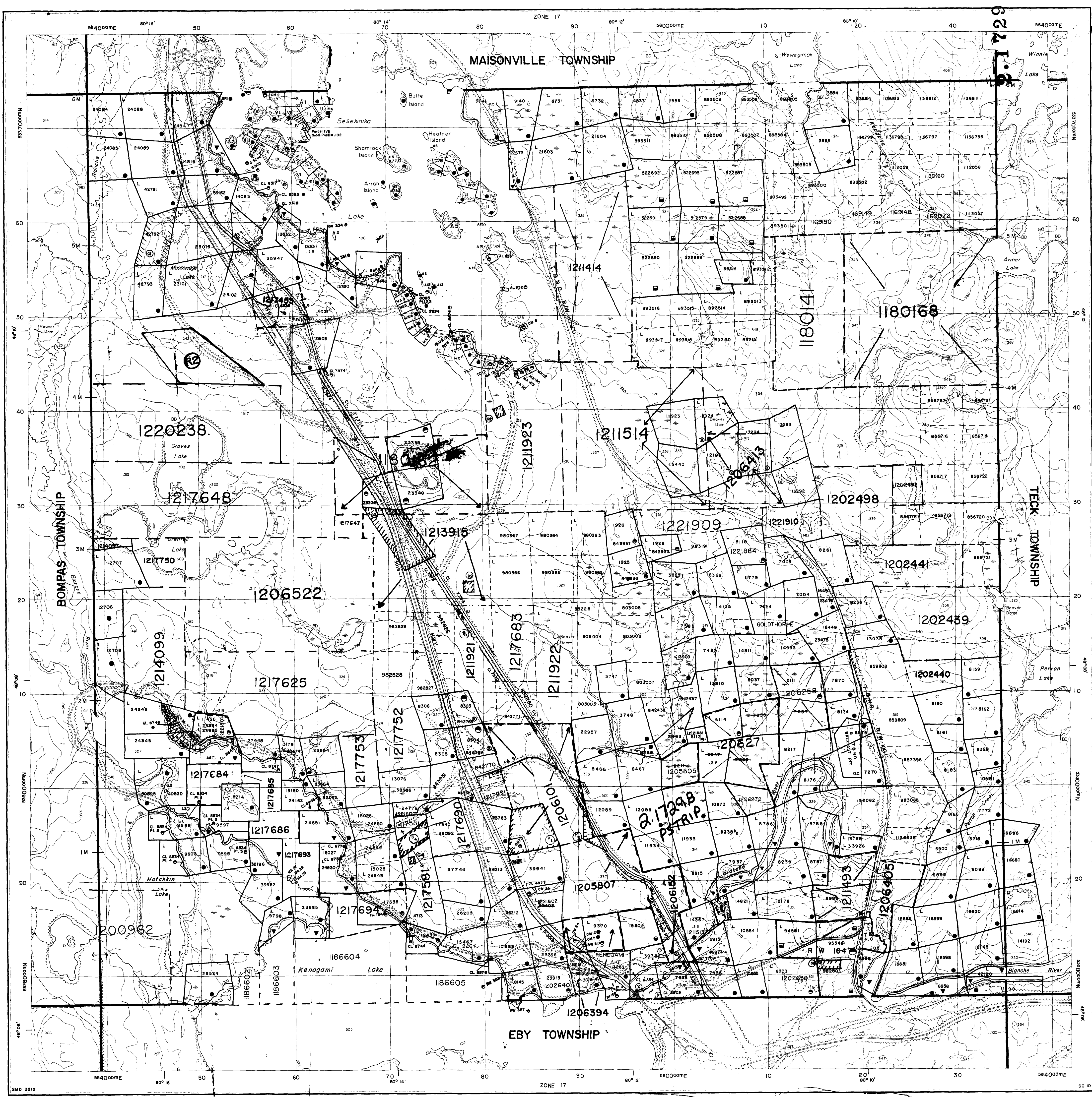

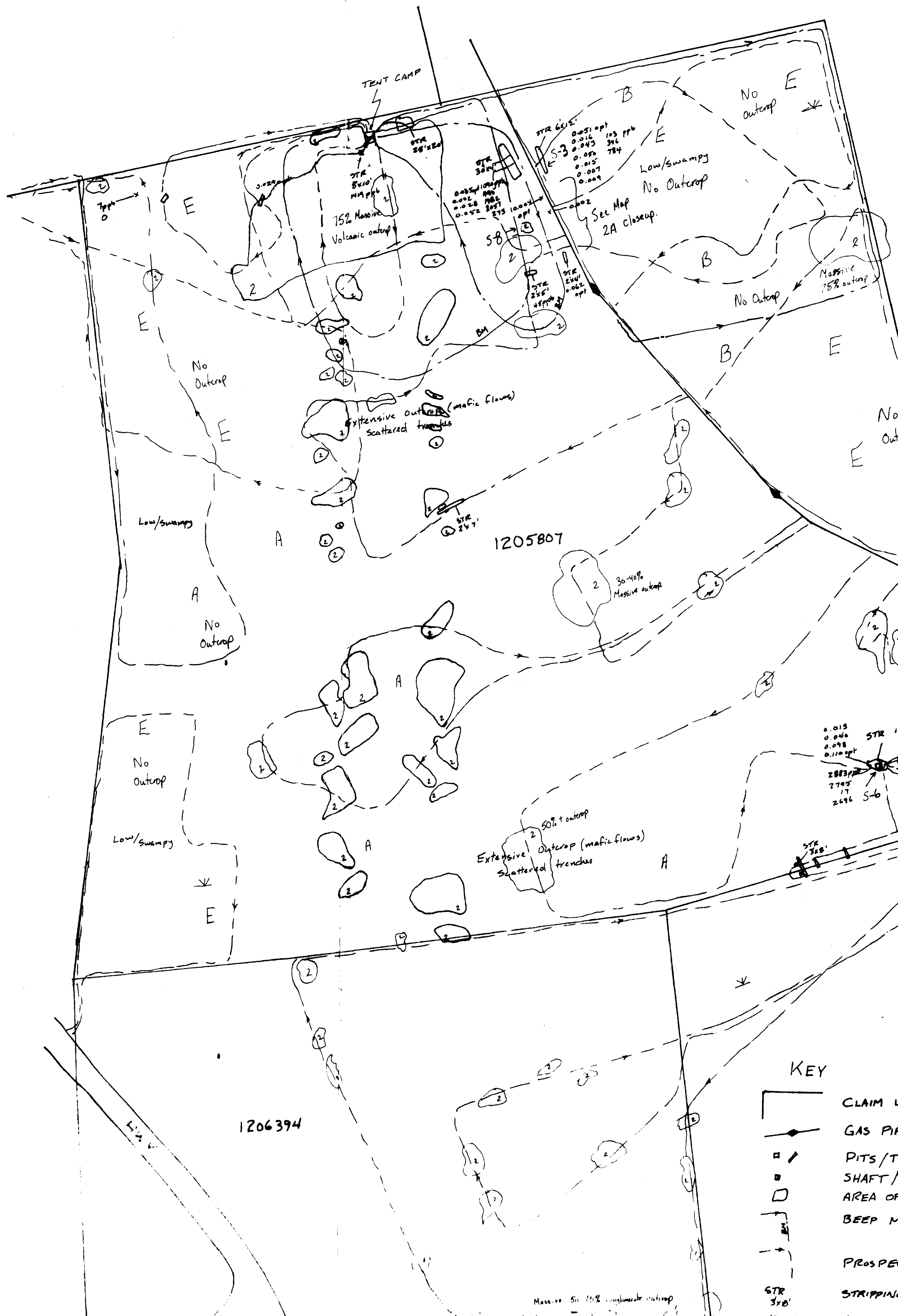

- VEGETATION**
- A - No outcrop. Mainly mature Poplar with minor spruce and jackpine. Solid high ground.
 - B - No outcrop. Denser mature spruce and jackpine with minor Poplar and cedar. High sandy ground.
 - C - No outcrop. Mainly mature and scrubby cedar with minor spruce and jackpine. Low poorly drained ground.
 - D - No outcrop. Mature spruce and jackpine with very little brush cover. Well drained sandy soil.
 - E - No outcrop. Scrubby bush with mainly tree aspen and small poplars. Low poorly drained areas.

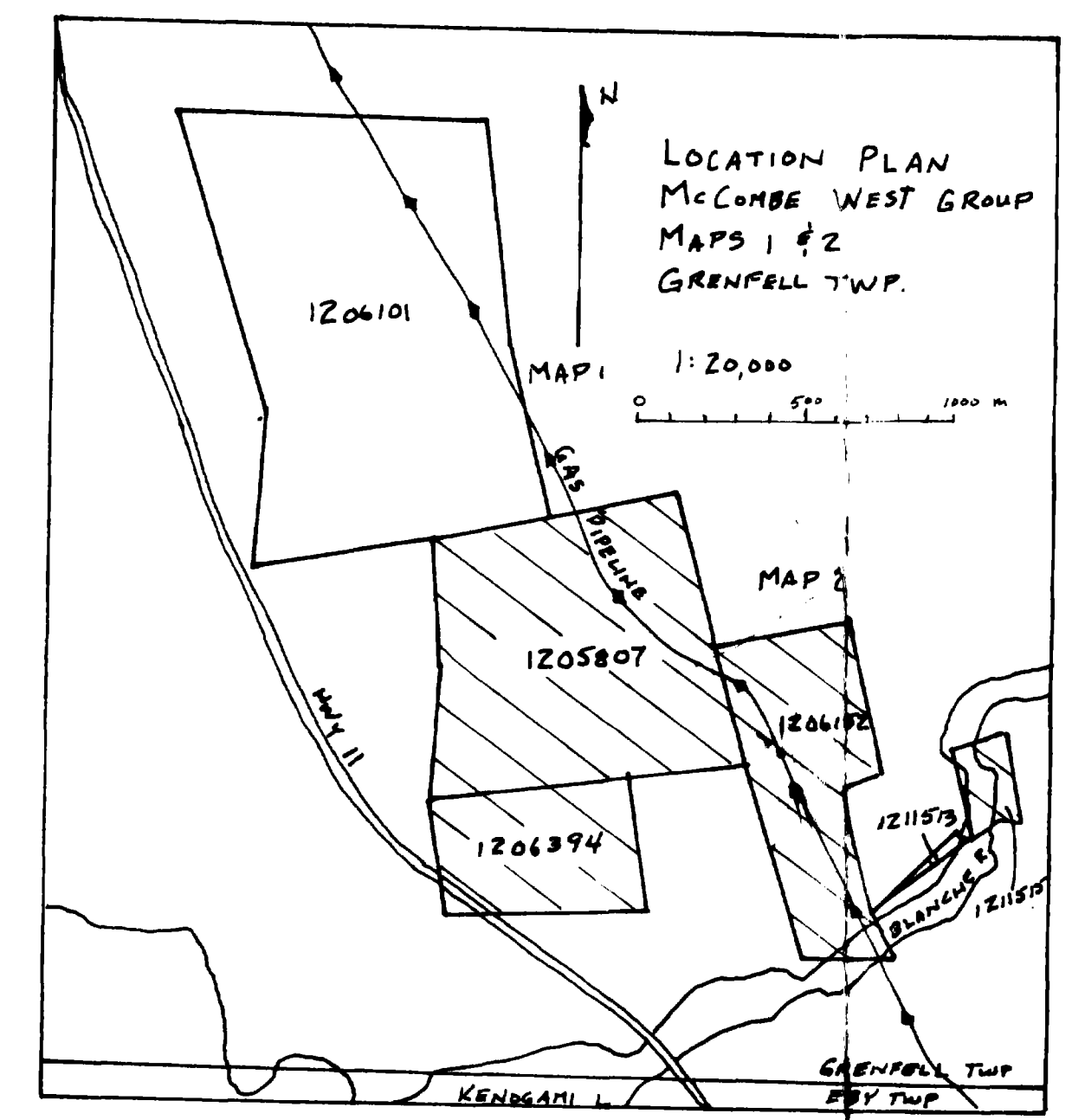

- KEY**
- CLAIM LINE
 - GAS PIPELINE
 - / PITS/TRENCHES
 - SHAFT/TIMBERED PIT
 - AREA OF EXTENSIVE STRIPPING
 - BEEP MAP TRAVERSE
 - PROSPECTING TRAVERSE
 - STR STRIPPING / DIMENSIONS
 - Assays
 - Downslope of Ridge
 - Low Swampy Area
 - S-1 Stripped area with detailed sketch attached.

- VEGETATION DESCRIPTIONS (continued)**
- 1a. Conspicuous brush over to brown sandy matrix vegetation
 - 1b. Longbarrel Large pebbles to 20cm diameter, rounded multiple igneous rock types
 - 2a. Dark Green Volcanics. Mafic volcanics, locally with pillow features, fine to medium grained
 - 2b. Rounded to subrounded fragments in volcanics to 15cm diameter possible flow top breccia.
 - 2c. Spotted Vesicular volcanics (to 3cm diam)

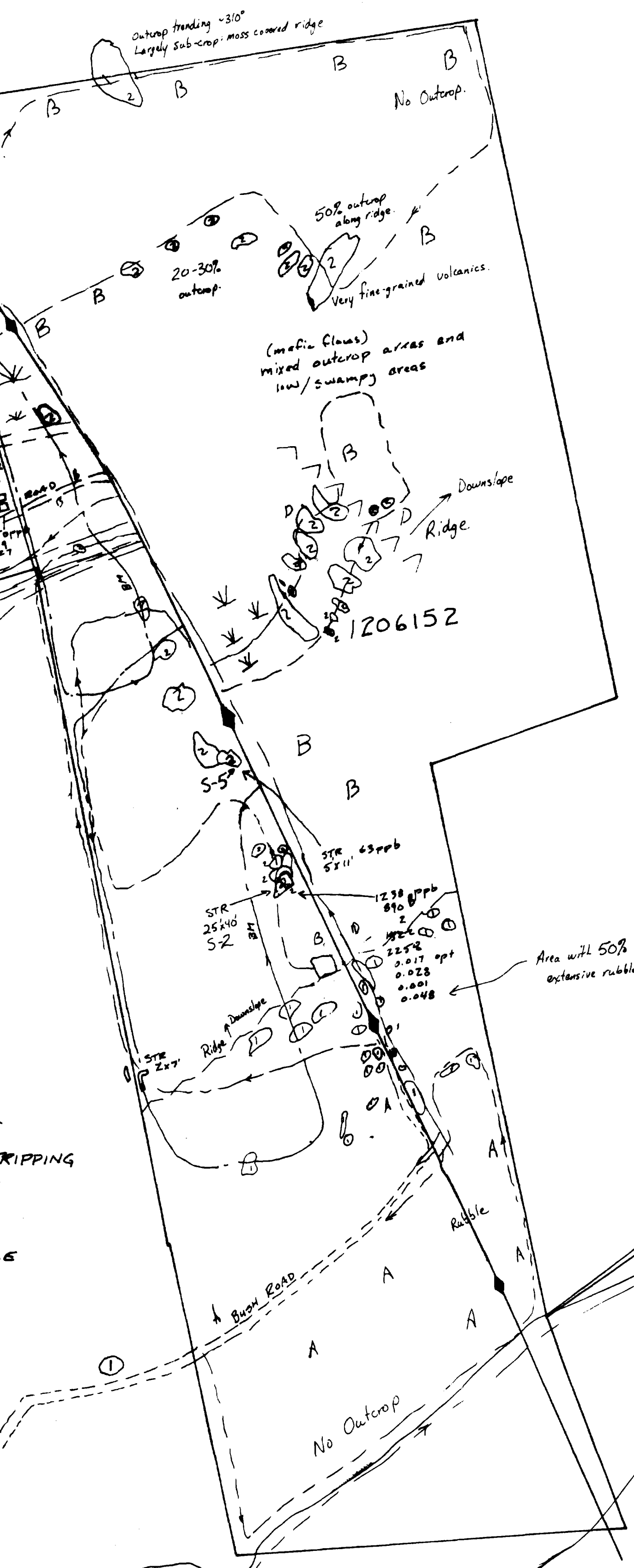

PROSPECTING & STRIPPING
 McCOMBE WEST GROUP
 GREENFELL TWP
 MAP 2
 2.17298
 Scale: 1" = 200'
 DRAWN BY: F.R. PLOEGER APRIL 11/97

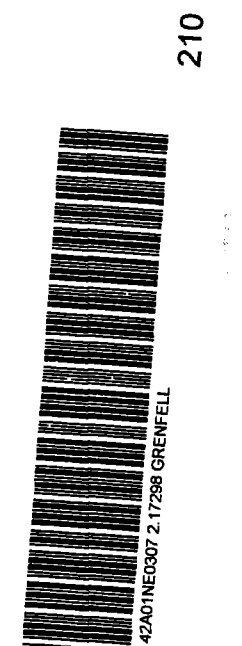

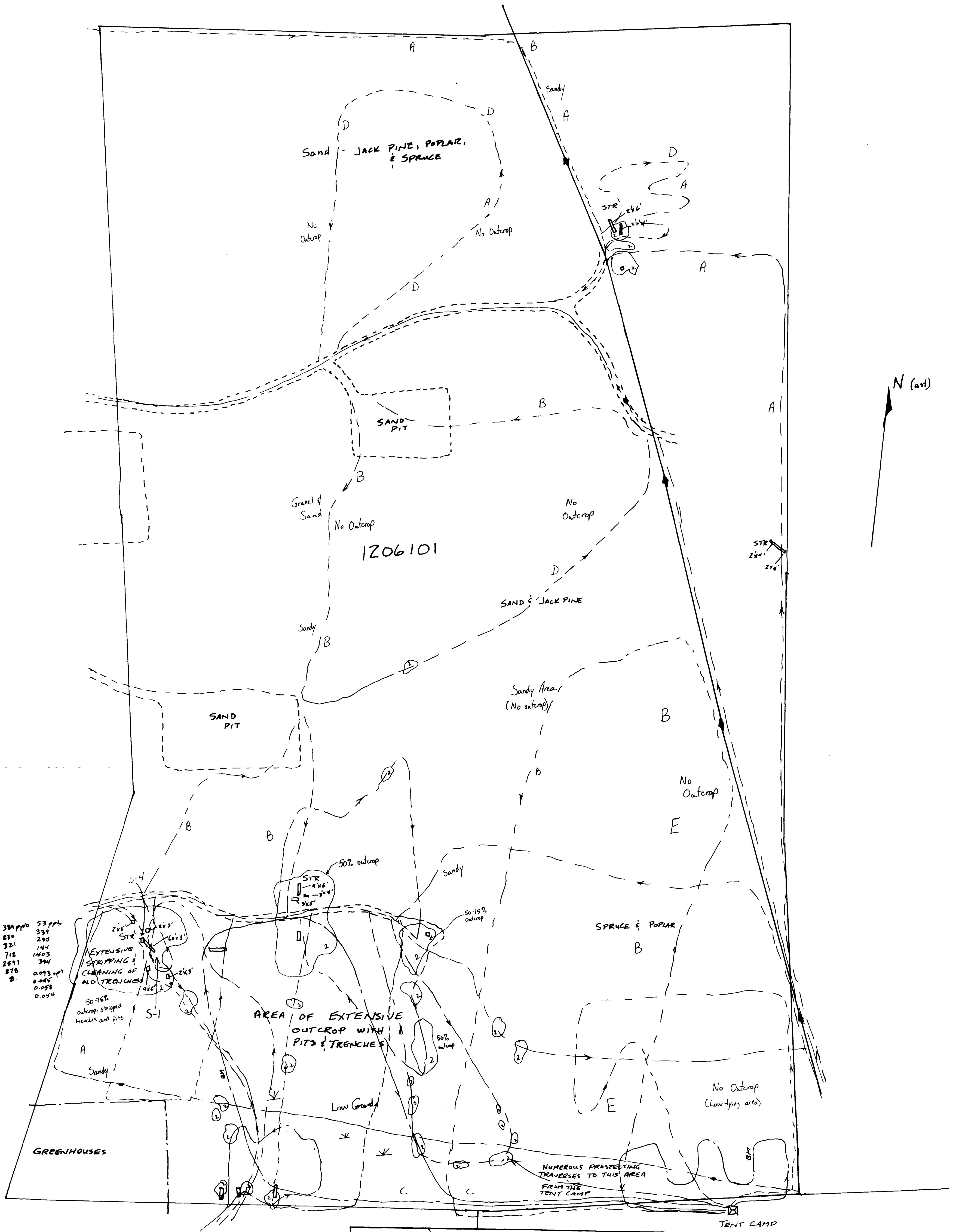

384 ppb	53 ppb
83	339
321	295
718	144
2947	394
878	0.093 ppt
81	0.046
	0.058
	0.054

- VEGETATION**
- A - No outcrop. Mainly mature poplar with minor spruce and jackpine. Solid high ground.
 - B - No outcrop. Dense mature spruce and jackpine with minor poplar and cedar. High sandy ground.
 - C - No outcrop. Mainly mature and scabby cedar with minor spruce and jackpine. Low poorly drained ground.
 - D - No outcrop. Mature spruce and jackpine with very little brush cover. Well drained sandy soil.
 - E - No outcrop. Scabby bush with mainly tag elder and small poplar. Low poorly drained areas.
- KEY**
- CLAIM LINE
 - - - BUSH ROAD
 - GAS PIPELINE
 - PITS/TRENCHES
 - SHAFT/TIMBERED PIT
 - BEEP MAP TRAVERSE
 - PROSPECTING TRAVERSE
 - STR 4' x 2' 344 ppb 0.051 ppt STRIPPING / DIMENSIONS
 - ASSAYS
 - Low swampy Area
 - S-1 Stripped area with detailed sketch attached

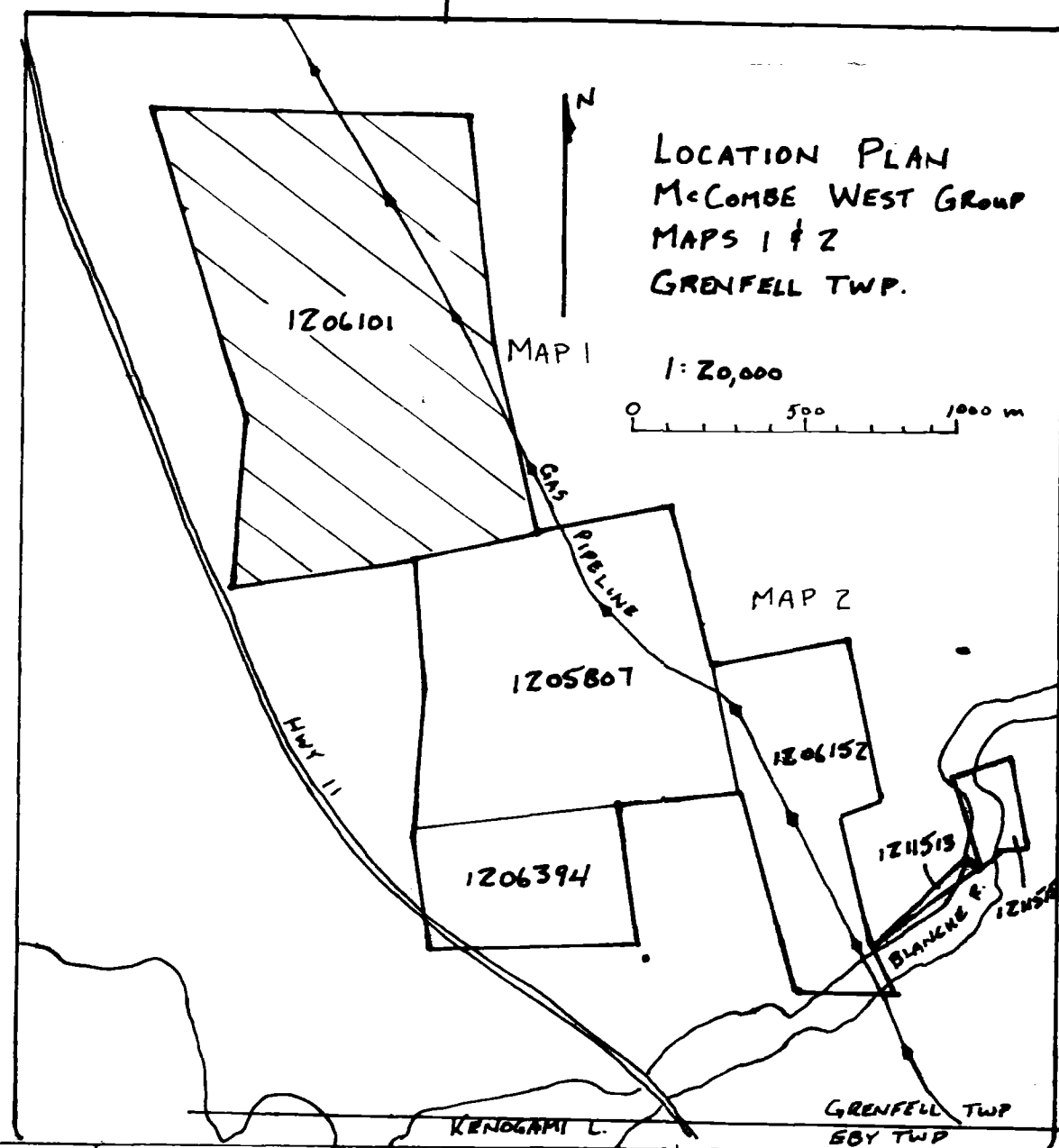

**PROSPECTING & STRIPPING
McCOMBE WEST GROUP
GRENELL TWP.
MAP 1**

- OUTCROP DESCRIPTIONS (GEOLOGY)**
- ① **Conglomerate:** Fresh grey to brown sandy matrix supported conglomerate. Large pebbles to 20cm diameter, rounded, multiple igneous rock types.
 - ② **Dark Green Volcanics:** Mafic volcanics, locally with pillow features, fine to medium grained.

2.17298

Scale: 1" = 200'

Drawn by: FR. PLOEGER April 11/97

2:49M pm.