



42A01NE2041

2.22275

MAISONVILLE

010

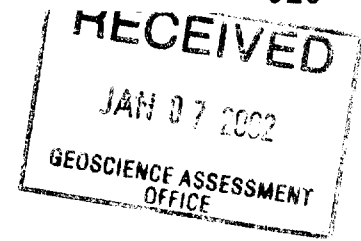

Canadian Royalties Inc.

Bennett Lake Prospect

Assessment Report on Sampling with Assays

2.22275

January 4, 2002

Larry J. Stoliker

The Bennett Lake Gold Mines is located in Maisonville Twp. about 17 kilometers northwest of Kirkland Lake. It consists of four mining claims covering a total area of 183 hectares. Access is via Highway 66 west from the town of Kirkland Lake and then north on Highway 11 to Road 570. Direct access to the property can then be gained by either an old trail that leads to the southwest corner of grid or by logging roads that lead to the east side of claim group.

The claims are held by Canadian Royalties Inc. The work was performed on Mining Claims L-1220218(1 unit) and L-1220284(1 unit). The property also consists of mining Claims L-1220217(6 units) and L-1220285(1 unit).

On August 30, 2001 I was contracted by Canadian Royalties Inc. to visit this property to locate the old shaft and trenched areas and verify previous anomalous gold values on this property. The property had forestry work done on it since the previous visits.

On August 30 I prepared field maps and with the assisted of the owner set of a plan of work.

On August 31, 2001 I drove to the property. I located the property from both the southeast access trail and the east logging roads. I then proceeded to collect a total of 23 random grab samples from the shaft and four trenched areas. All samples were taken from intermediate to mafic volcanics with the presence of quartz and pyrite. The samples were then shipped to Xral Laboratories for assays.

The certificate of analysis and accompanying plans were submitted October 19, 2001. The assays ranged in value from less than 1 ppb of gold to greater than 10,000 pbb or 23.28 G/T.

This recent work has relocated the shaft and trenched areas and shown that significant gold mineralization does occur on the property near the old workings. It also verifies that the area does warrant further exploration workings.

It is recommended that the old claim lines be re-established and an IP Survey done to cover the entire grid. Any significant anomalies should be covered by diamond drilling with the priority being the anomalous areas associated with magnetic and VLF anomalies.

I was contracted out at \$ 200.00 per day. I spent one day in the field and 1 day doing field preparations, sample preparations, photocopying, plotting samples and travel time in Ontario from the Quebec border to grid site and back.

The company also paid me \$ 100.00 for truck rental and mileage to and from work. (I have only included mileage from the Ontario border to grid site.

Respectfully submitted

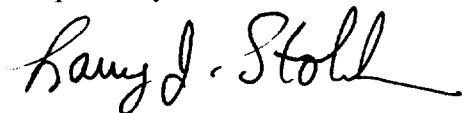

Larry J. Stoliker
Laureate Resources Management



LES LABORATOIRES XRAL LABORATORIES

UNE DIVISION DE / A DIVISION OF SGS CANADA INC.
 129 AVE. MARCEL BARIL • ROUYN-NORANDA • QUÉBEC J9X 7B9
 TÉL.: (819) 764-9108 FAX: (819) 764-4673

CERTIFICAT D'ANALYSE/CERTIFICATE OF ANALYSIS

R20734

Nom de la Compagnie/Company: Canadian Royalties Inc.
 Bon de Commande No/ P.O. No:
 Projet/ Project No : Bennette L.
 Date Soumis/ Submitted : Aug 31, 2001
 Attention : Glenn Mullan

Sep 08, 2001

No. D'Echantillon Sample No.	AU PPB	AU PPB	CHK G/T
---------------------------------	-----------	-----------	------------

31351	>10000		23.28
31352	132		
31353	26		
31354	35		
31355	12		
31356	15		
31357	8		
31358	660		
31359	96		
31360	100		
31361	9		
31362	64		
31363	83	90	
31364	5		
31365	1		
31366	5		
31367	7		
31368	<1		
31369	8		
31370	1		
31371	18		
31372	52		
31373	33		

Certifie par / Certified by :



 Membre du Groupe SGS (Société Générale de Surveillance)

Work Report Summary

Transaction No: W0180.30951

Status: APPROVED

Recording Date: 2001-OCT-19

Work Done from: 2001-AUG-30

Approval Date: 2002-JAN-07

to: 2001-AUG-31

Client(s):

392527 CANADIAN ROYALTIES INC.

Survey Type(s):

ASSAY

Work Report Details:

Claim#	Perform	Perform Approve	Applied	Applied Approve	Assign	Assign Approve	Reserve	Reserve Approve	Due Date
L 1220217	\$0	\$0	\$412	\$412	\$0	0	\$0	\$0	2002-OCT-25
L 1220218	\$653	\$653	\$0	\$0	\$230	230	\$423	\$423	2002-OCT-25
L 1220284	\$182	\$182	\$0	\$0	\$182	182	\$0	\$0	2002-OCT-25
	\$835	\$835	\$412	\$412	\$412	\$412	\$423	\$423	

Status of claim is based on information currently on record.



42A01NE2041 2.22275 MAISONVILLE

900

Date: 2002-JAN-07

GEOSCIENCE ASSESSMENT OFFICE
933 RAMSEY LAKE ROAD, 6th FLOOR
SUDBURY, ONTARIO
P3E 6B5

CANADIAN ROYALTIES INC.
152 CHEMIN DE LA MINE ECOLE
VAL D'OR, QUEBEC
J9P 7B6 CANADA

Tel: (888) 415-9845
Fax: (877) 670-1555

Submission Number: 2.22275
Transaction Number(s): W0180.30951

Dear Sir or Madam

Subject: Approval of Assessment Work

We have approved your Assessment Work Submission with the above noted Transaction Number(s). The attached Work Report Summary indicates the results of the approval.

At the discretion of the Ministry, the assessment work performed on the mining lands noted in this work report may be subject to inspection and/or investigation at any time.

If you have any question regarding this correspondence, please contact LUCILLE JEROME by email at lucille.jerome@ndm.gov.on.ca or by phone at (705) 670-5858.

Yours Sincerely,



Ron Gashinski
Supervisor, Geoscience Assessment Office

Cc: Resident Geologist

Larry James Stoliker
(Agent)

Canadian Royalties Inc.
(Assessment Office)

Assessment File Library

Canadian Royalties Inc.
(Claim Holder)



MINING LAND TENURE MAP

Date / Time of Issue Jan 7 2002 10:11h Eastern
 TOWNSHIP / AREA MAISONVILLE PLAN G-3869
 ADMINISTRATIVE DISTRICTS / DIVISIONS
 Mining Division Larder Lake
 Land Titles/Registry Division TIMISKAMING
 Ministry of Natural Resources District KIRKLAND LAKE

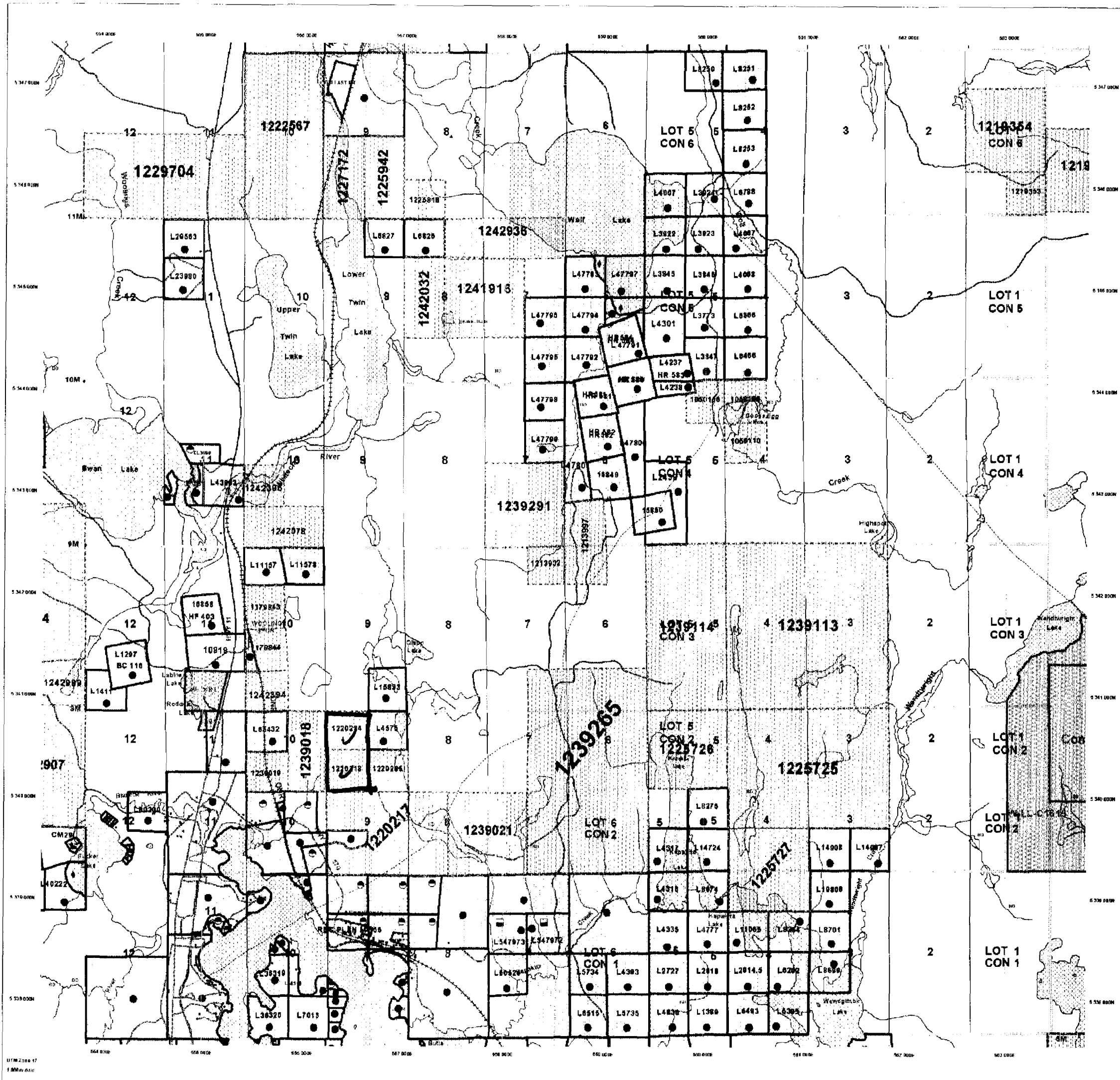

TOPOGRAPHIC

- Administrative Boundary
- Township
- Concession Lot
- Private Path
- Linear Feature
- City, P.W. or P.E.
- Center - Approx. 4.00m/20.00m
- Street
- Water Headstone
- Palace
- Road
- Tier
- Natural Gas Pipeline
- Hydro Line
- Communication Line
- Municipal Area
- Municipal-Cadastral Relationship Cover

LAND TENURE

Feehold Patent

- Surface And Mining Rights
- Surface Rights Only
- Mining Rights Only

Leasehold Patent

- Surface And Mining Rights
- Surface Rights Only
- Mining Rights Only

Types of Occupancy

- Leasehold Specified
- Surface And Mining Rights
- Surface Rights Only
- Mining Rights Only

LAND TENURE WITHDRAWALS

- Area Withdrawn From Disposition Mining Act Withdrawal Types
- Wm Surface And Mining Rights Withdrawal
- Wn Mining Rights Only Withdrawal
- Wm Surface Rights Only Withdrawal
- Wn Surface Rights Only Withdrawal
- Wm Mining Rights Only Withdrawal
- Wn Mining Rights Only Withdrawal

IMPORTANT NOTICES

Area Withdrawn From Disposition Mining Act Withdrawal Types

LAND TENURE WITHDRAWAL DESCRIPTIONS

Number	Type	Date	Description
3840	Wm	Jan 1 2001	PATENT IN SUBJ. PLAN N-167
3740	Wm	Jan 1 2001	WITHDRAWN FROM STAKING, SECTION 51 APPLICABLE UNDER PUBLIC LAWS ACT
W 081	Wn	Jan 23 1991	SURFACE RIGHTS WITHDRAWN FROM STAKING, SEC. 45(2) MINING ACT, 1963, P.L. 22002
3794	Wn	Jan 1 2001	SURFACE RIGHTS WITHDRAWN FROM STAKING, SEC. 45(2) MINING ACT, 1963, P.L. 22002
W 11 C 615	Wm	Nov 11 1992	Sec 35 W.L. C 615 ONT. May 1989 N.E.S.
CONF 20704	Wm	Apr 6 2001	See Article 26 (b) of the Mining Act

IMPORTANT NOTICES

Area Withdrawn From Disposition Mining Act Withdrawal Types

42A01M2041 2.22275 MAISONVILLE
 200

General Information and Limitations

This map may not show all rights and interests and is not intended to be a legal document. It is for informational purposes only. The Ministry of Natural Resources and Forestry is not responsible for any errors or omissions. The user assumes all liability for any use of this map. For more information, contact the Ministry of Natural Resources and Forestry, 1111 St. George Street, Toronto, Ontario M5E 1A5. Telephone: (416) 325-1500. Fax: (416) 325-1544. Website: www.mnr.gov.on.ca

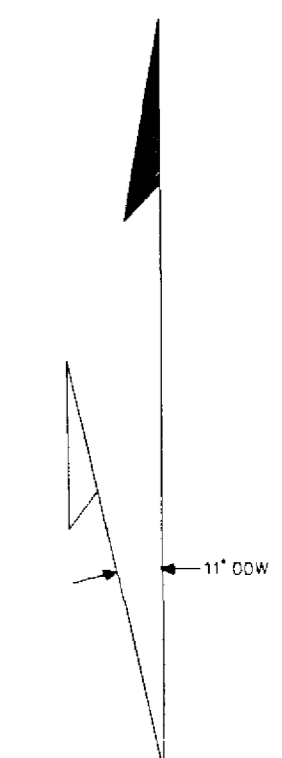

Samples from the shaft muck pile
(0+00 E, 0+00 N, and around...):
 283284 - 4.34 g/t Au
 283285 - 25 ppb Au
 283286 - 230 ppb Au
 283287 - 24.75 g/t Au
 283288 - 65 ppb Au
 283289 to 283290
 283291 - 80 ppb Au
 283292 to 283297
 283298 - 100 ppb Au
 283299
 283300 - 220 ppb Au
 283301
 13633, 0+00 E, 1+20 S, 0.035% Cu

GEOLOGICAL LEGEND
(see the M.N.R.Q. legend - MB-96-28)

- I2 Intermediate intrusive
- I3 Mafic intrusive
- Y3A Intermediate to mafic volcanics
- n Vein
- CC Calcite
- EP Epidote
- HM Hematite
- MC Malachite
- MG Magnetite
- Py Pyrite
- QZ Quartz
- + Alteration (enrichment)
- [R] Injections
- [S] Interstitial
- [MA] Massore
- [CO] Pillow lava
- [CS] Sheared
- () ... stands for "some", "possible" or a "doubt"
- / ... stands for "alternating sequence"
- ... stands for "stratigraphic sequence"
- ... stands for "and/or"
- Fracture or shear: vertical or dipping
- Contact: vertical or dipping
- x Outcrop group and spot
- 1221651 P4 Claim post, with claim and post numbers
- Trench
- Road
- DDH Diamond drill hole
- Samples 283281 to 283313 sampled by Anglomaque personnel.
- Anglomaque sampling site
- Samples 12738 to 12744, 13632 to 13650, and 28501 to 28503 sampled by Géola Lié.
- x Rock Samples August 30, 2001 (see assay sheets attached)

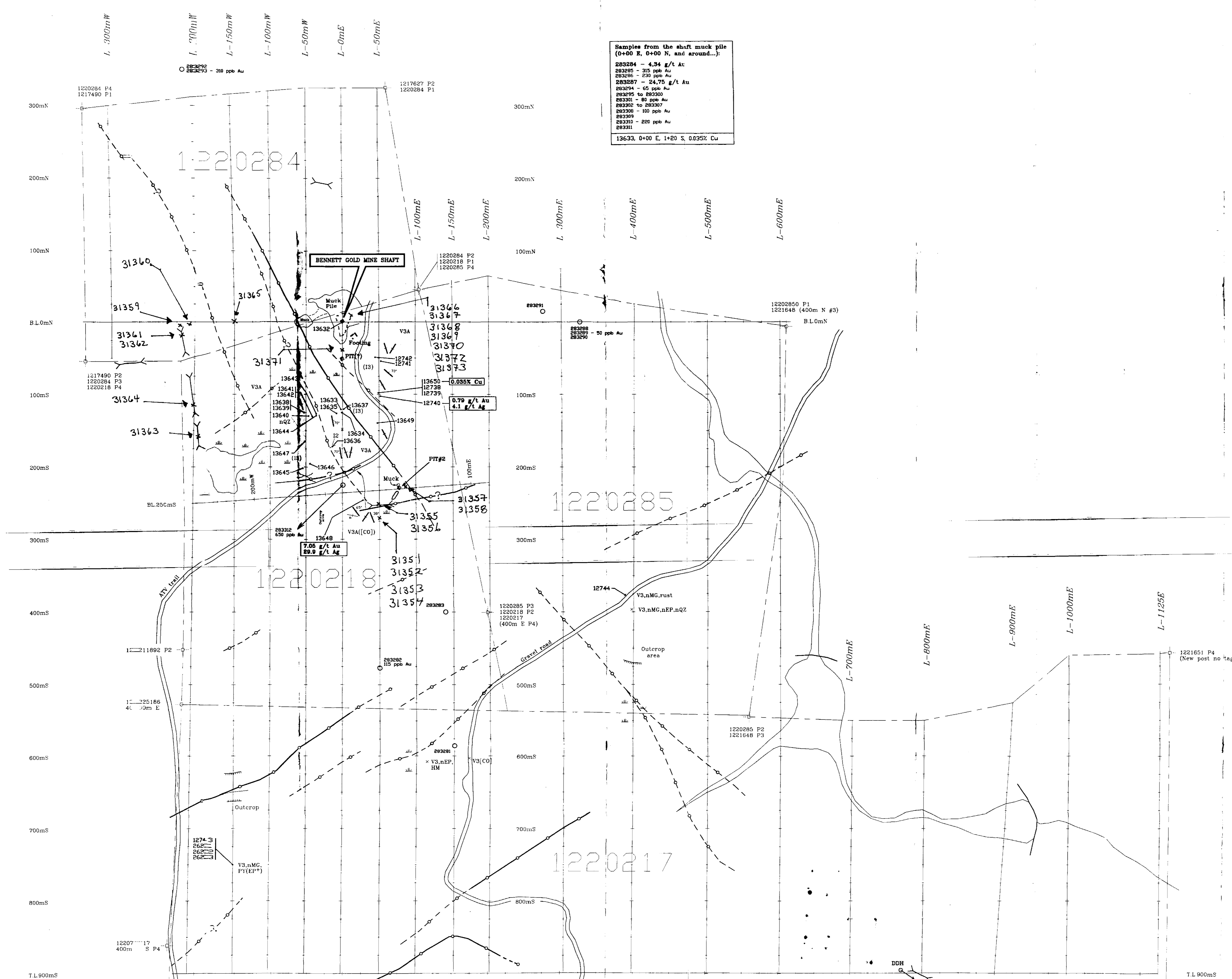

FOR: Anglomaque Explorations Inc.	
SURVEY: GEOLOGY (RECONNAISSANCE) AND PROSPECTING	
BY: GEOLA LTEE	
EXECUTED BY: L.Plante Ing. Nov. 1997	BENNETT GOLD MINE PROSPECT. Maisenville Twp., Ont.
INTERPRETED BY: L.Plante Ing. Nov. 1997	
DRAWN BY: J.Frouin Tech. Nov. 1997	
APPROVED BY: L.J. Stalker Oct. 2001	LAT: 48°12' 30" LONG: 80°14' 30"
PLAN No: 97-345	N.T.S.: 424/01
SCALE 1:2500	
0 25 50 75 100 Metres	