



Ministry of Natural Resources

Teck



42A01NES087 W7608-00313 TECK

010

W7608-313

A separate form is required for each type of work to be recorded.

THE MINING ACT REPORT OF WORK

To the Recorder of Richard Lake Mining Division

1. Dennis Daily name of Recorded Holder Prospector's Licence

84 Prospect Ave. Richard Lake, Ont. K13916 Post Office Address

do hereby report the performance of 101 days of stripping & trenching type of work

not before reported to be applied on the following contiguous claims

Claim No.	Days	Claim No.	Days	Claim No.	Days
L 400638	30	L 401104	31	L 401105	30
.....
.....
.....
.....

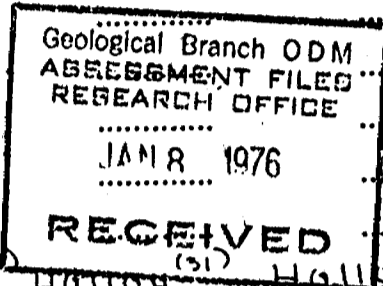

All the work was performed on Mining Claim (s) 400638, 401104, 401105 (In the case of geological and/or geophysical survey (s) where more than 18 claims are involved attach a schedule)

READ CAREFULLY: THE FOLLOWING INFORMATION IS REQUIRED BY THE MINING RECORDER.

For Manual Work, Stripping or Opening up of Mines, Sinking Shafts or Other Actual Mining Operations - Names and addresses of the men who performed the work and the dates and hours of their employment.

For Diamond and other Core Drilling - Footage, No. and angle of holes and diameter of core. Name and address of owner or operator of drill. Dates when drilling was done. Signed core log and sketch in duplicate.

For Compressed Air or Other Power Driven or Mechanical Equipment Type of drill or equipment. Names and addresses of men engaged in operating equipment and the dates and hours of their employment.

For Power Stripping - Type of equipment. Name and address of owner or operator. Amount expended. Dates on which work was done. Proof of actual cost must be submitted within 30 days of recording.

With each of the above types of work sketches are required to show the location and extent of the work in relation to the nearest claim post. In the case of diamond or other core drilling the sketch must be submitted in duplicate.

For Geophysical, Geological, Geochemical Surveys and Expenditure Credits - the name of author of report. Covering dates of survey (linecutting & office). Type of instrument used. Total amount of expenditure. Technical reports, maps, expenditure breakdown, receipts must be filed in duplicate with the Minister within 60 days of recording.

For Land Survey - the name and address of Ontario Land surveyor.

The Required Information is as Follows: (Attach a list if this space is insufficient)

1975
 May 15 16 17 18 19 20 21 22 23 24 25 26 27 28 29 30 31
 June 3 4 5 6 7 8 9 10 11 12 13 14 15 16 17 18 19 20 21 22 23 24 25 26 27 28 29 30 31
 July 1 2 3 4 5 6 7 8 9 10 11 12 13 14 15 16 17 18 19 20 21 22 23 24 25 26 27 28 29 30 31
 Aug 1 2 3 4 5 6 7 8 9 10 11 12 13 14 15 16 17 18 19 20 21 22 23 24 25 26 27 28 29 30 31
 Sept 1 2 3 4 5 6 7 8 9 10 11 12 13 14 15 16 17 18 19 20 21 22 23 24 25 26 27 28 29 30 31
 27, 29, 30, Worked 6 hrs each day

Date Dec 10 1975

Dennis Daily Signature of Recorded Holder or Agent

The Mining Act Certificate Verifying Report of Work

1. Dennis Daily
84 Prospect Ave. Richard Lake, Ont. K13916
(Post Office Address)

hereby certify:
1. That I have a personal and intimate knowledge of the facts set forth in the report of work annexed hereto, having performed the work or witnessed same during and/or after its completion.
2. That the annexed report is true.

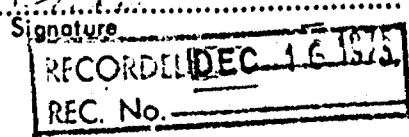
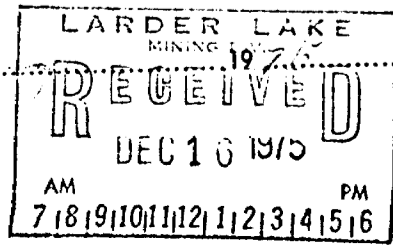

File (2400638)

THE PENALTY FOR MAKING A FALSE STATEMENT IN THIS REPORT AND/OR CERTIFICATE IS \$500. OR SIX MONTHS IMPRISONMENT OR BOTH



42A01NE5087 W7608-00313 TECK

900

Old Copper Mine

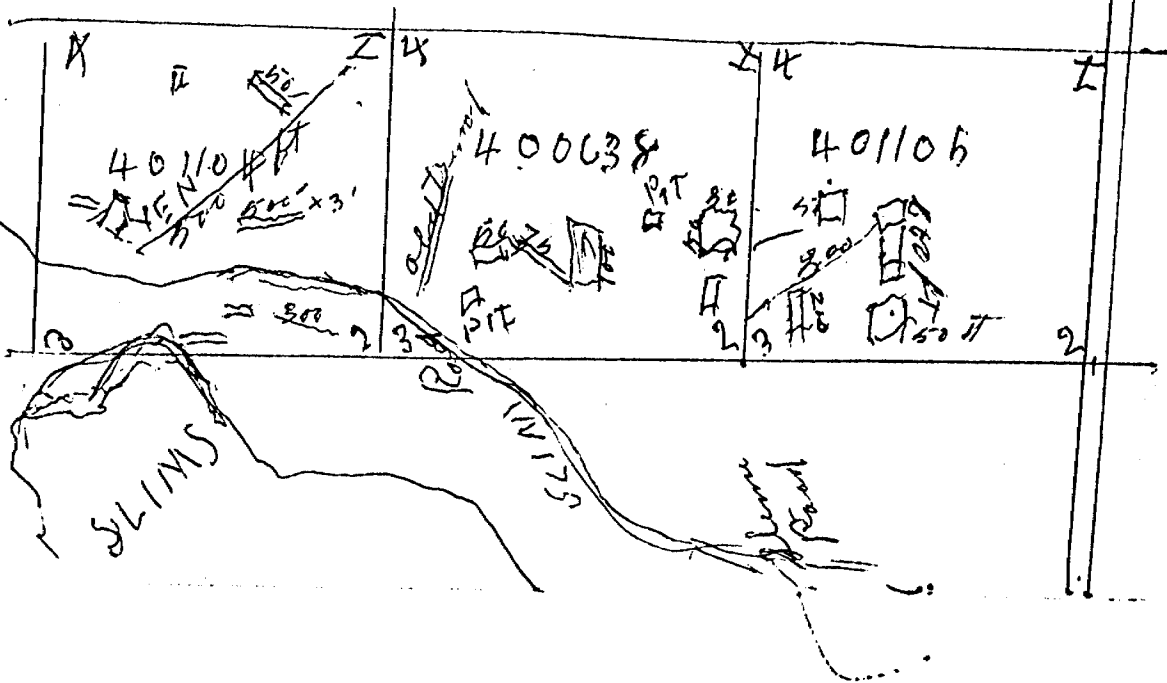

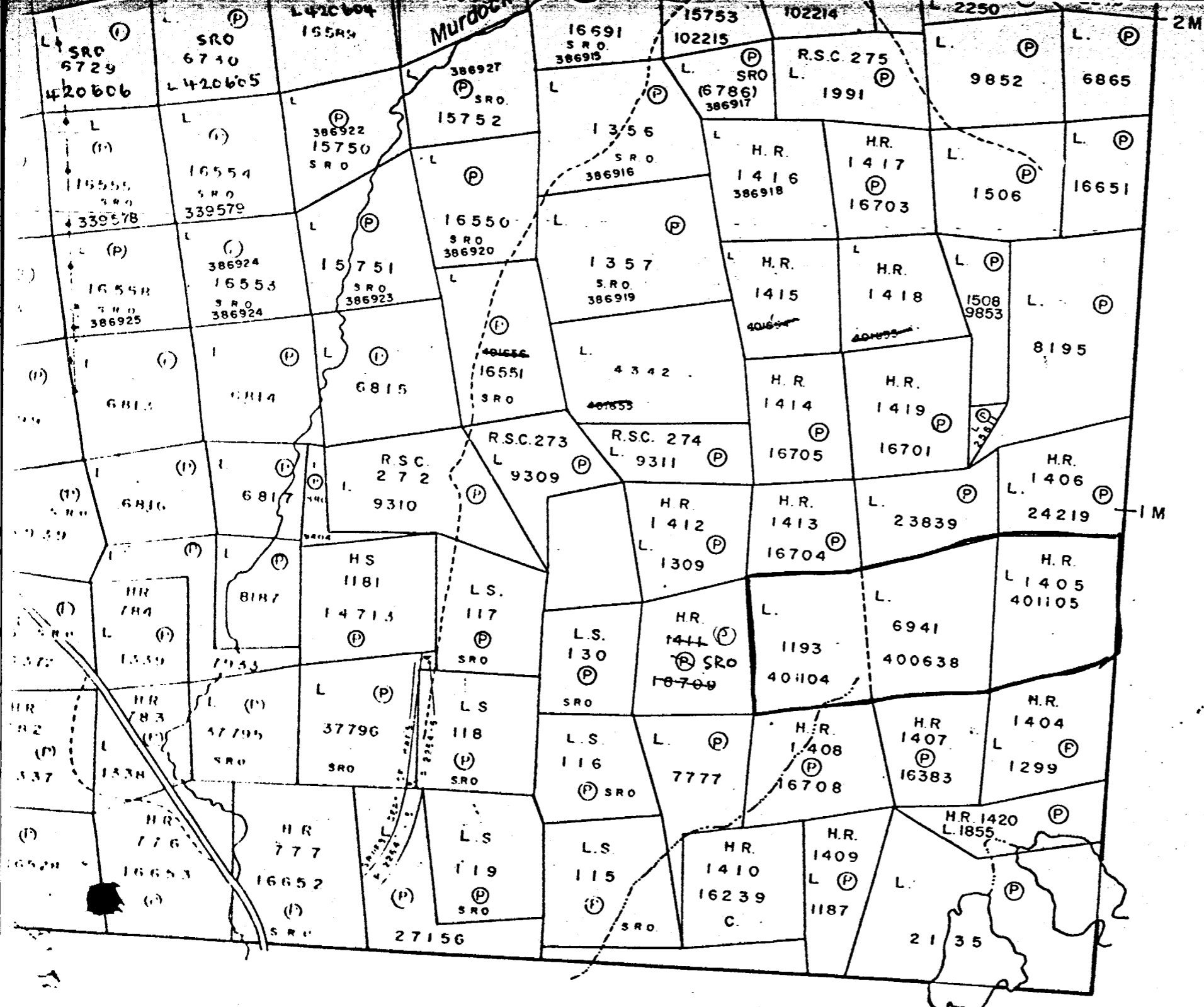

*Track map
M392.*

LARDER LAKE
MINING DIV.
RECEIVED
APR 21 1975
AM
7 18 19 10 11 12 1 2 3 4 5 6 PM

DATE OF ISSUE
APR 14 1975