



42A01NE8949 2.14892 MAISONVILLE

010

GEOLOGICAL REPORT

PIPELINE NORTH PROPERTY

MAISONVILLE TOWNSHIP

LARDER LAKE MINING DIVISION

NTS 42A/1

2.14892

RECEIVED

JAN 27 1993

MINING LANDS BRANCH

Qual.

2.2903

DECEMBER 12, 1992

L.M. DYMENT
BOX 66, SWASTIKA, ONTARIO



42A01NE8949 2.14892 MAISONVILLE

010C

TABLE OF CONTENTS

	PAGE
INTRODUCTION.....	1
LOCATION AND ACCESS.....	2
AREA GEOLOGY.....	3
PREVIOUS WORK.....	4
MAPPING PROCEDURE.....	5
RESULTS.....	6
CONCLUSION.....	6

APPENDIX 1 - CLAIM HOLDERS AND SUPERVISION

APPENDIX 2 - ASSAYS

APPENDIX 3 - CERTIFICATION

FIGURES

- | | |
|----------------------|---------------------|
| 1) Regional location | Scale 1" = 8 miles |
| 2) Claim location | Scale 1" = 1/2 mile |
| 3) Geology map | Scale 1" = 200 ft |
| 4) Sample area #1 | Scale 1" = 200 ft |
| 5) Sample area #2 | Scale 1" = 50 ft |

LEE TWP. - M.360

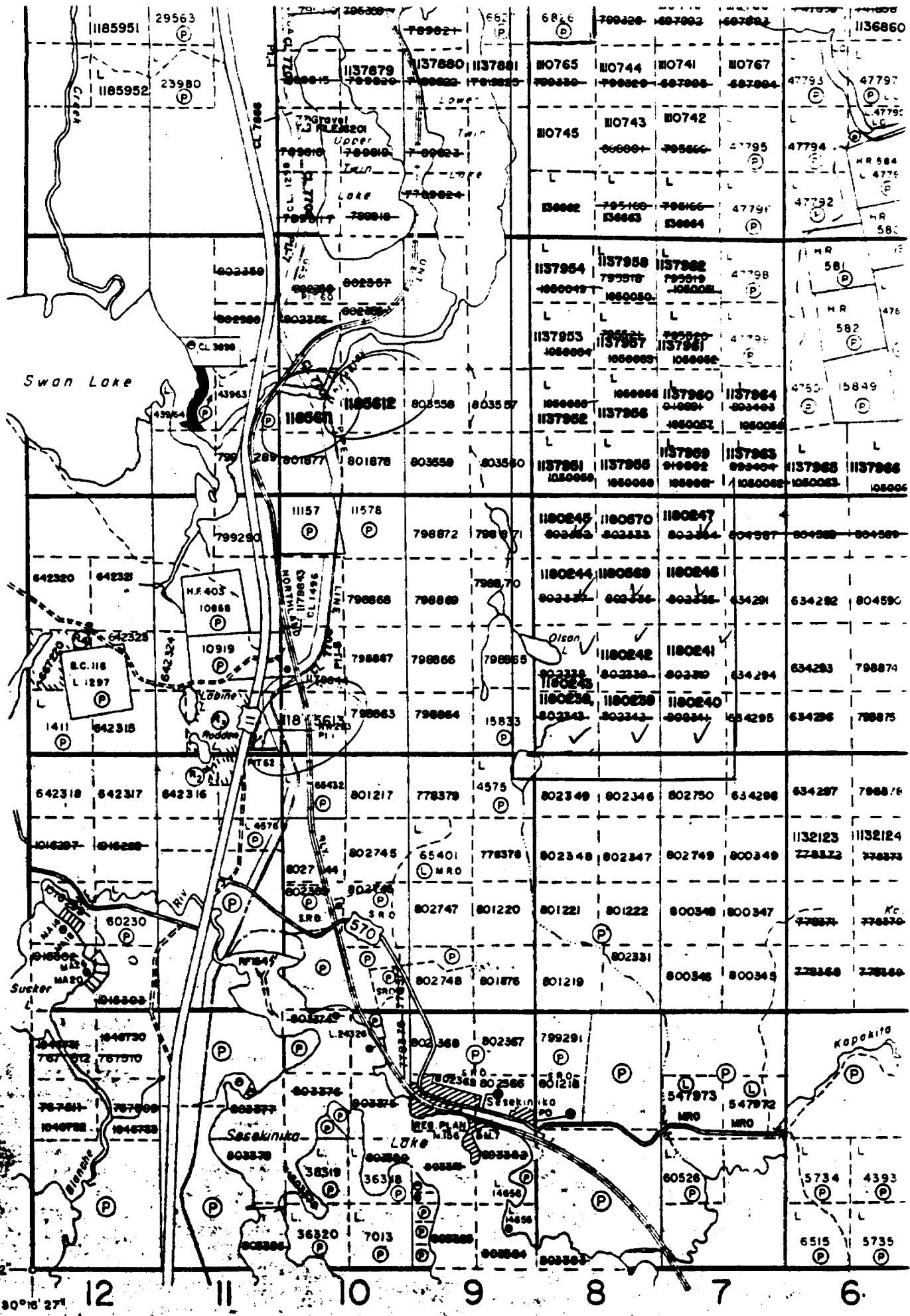

48° 12' 22"
80° 16' 27"

12 11 10 9 8 7 6

INTRODUCTION

Claims 1185611 and 1185612 were staked on behalf of Jocelyne Kidston (50%) and L.Mike Dymont (50%) on Dec 3, 1991.

The claims were staked to gain a land position in the area for exploration. Since that time, six more claims have been added to the property as the claims become available. The property has a good database on nearby contiguous claims. Recent twinning of the TransCanada Pipeline has exposed interesting geology, and numerous airborne surveys (see PREVIOUS WORK) enhance the grassroots exploration possibilities. The property was geologically mapped over a 5 day period from September 9, 1992 to September 13, 1992.

LOCATION AND ACCESS

The property is located 10 miles NW of the town of Kirkland Lake. Access to the property from Kirkland Lake is West on HWY 66 11 miles to Keno-gami, and North on HWY 11 16 miles to White Clay River bridge. The property can then be accessed on foot, East 1/2 mile from the bridge. The property is crossed by the TransCanada Pipeline and comprises the NW1/4 and NE1/4 of the S1/2, Lot 10, Concession V, Maisonville Township.

AREA GEOLOGY

The surrounding area consists of a sequence of tholeiitic pillow basalt flows. The flows generally strike 0 degrees, dipping steeply to the East, and, from pillow facings, tops are to the East.

Cutting the volcanic assemblage is a series of Easterly trending, narrow, medium-grained, pink feldspar-porphyry syenite dykes and associated minor dykelets.

Intruding the above lithologies are North-striking, steeply dipping diabase dykes.

PROPERTY GEOLOGY

The property is underlain by Iron-rich and Iron-poor tholeiitic basalts, easily distinguished by eye and with the use of a magnet.

The tholeiitic basalts are intruded by East-West and North-South striking porphyry syenites.

Two diabase dykes trending N-S cut the coarse grained tholeiitic basalt. In the sampled area #2, a narrow (1 meter) lamprophyre dyke was uncovered.

LITHOLOGIES

The following are more detailed descriptions of the major rock types based on examination of outcrops and hand samples:

(1) Iron-poor tholeiitic basalt

This Magnesium-rich basalt was easily distinguished by its light green to grayish color on both weathered and fresh surfaces. Within this group fine and coarse grained flows were noted along with pillow breccia. Intact pillows were mapped on L0+00 with tops to the East.

RECEIVED

APR 05 1993

MINING LANDS BRANCH

LITHOLOGIES cont'd

(2) Iron-rich tholeiitic basalt

These rocks are dark green to black and magnetic. The rocks contain dark green to black pyroxene and abundant titaniferous magnetite. The surface appears fresh and not weathered to a rusty brown as is the habit of most Iron-rich basalts. The rocks were identifiable both by eye and with the use of a magnet.

(6) Diabase

Matachewan dykes of gabbroic composition and diabasic textures are found to cut both the Iron-rich and Iron-poor tholeiites in a N-S direction. The weathered surfaces are dark gray or rusty brown and are more magnetic than the Iron-rich basalts.

(5b) Porphyry syenite

Numerous small (less than 2 feet) dykes were mapped on the property, the majority of these in the sample #2 area. These dykes tend to intrude in all directions and are pale pink in color and lack mineralization.

RECEIVED

APR 05 1993

MINING LANDS BRANCH

ALTERATION

Alteration was noted in both sample areas. Sample area #1 shows weak and narrow (10 feet) alteration with 1" quartz veining and less than 2 % pyrite.

Sample area #2 shows more prevalent alteration within a small shear zone with brecciation and quartz flooding with up to 30 % mineralization.

Both areas were lamped with an ultra-violet lamp and area #2 showed minor Scheelite and Powellite fluorescence.

LITHOGEOCHEMISTRY

A total of 25 samples were analyzed for Gold by atomic absorption at Swastika Laboratories. Both sampled areas returned anomalous Gold. Maps detailing sampled areas #1 and #2 are contained within this report.

RECEIVED

APR 05 1993

MINING LANDS BRANCH

PREVIOUS WORK

PIPELINE NORTH PROPERTY

A search of the Kirkland Lake assessment files disclosed the following on overlapping and contiguous claims:

ELZINA GML---AFRO 765---PROP RPT---1938
PETERSON, W.-AFRO2260---DDH,RPT----1952
GSC-----Map 20, 150G---AMAG---1975
OGS-----AEM,AMAG---1979
BRONSON MINES-AFRO 284--MAG,VLFEM--1980-81
GOLIATH MINES-AFRO 1019-DDH-----1981
GLEN AUDEN MINES-AFRO 951-AMAG,AEM-1985
NORANDA-----AFRO 2017-----AMAG,AEM-1985

Several trenches and pits were located for which there is no record.

MAPPING PROCEDURE

Mapping was aided by lines that were cut and chained during July. Also, from a previous prospecting report, areas of interest could now be properly located.

From the magnetometer survey done in the latter part of August, several North striking diabase dykes were confirmed and several more dykes were inferred. (see fig 3 geological map).

A hand magnet was used to distinguish the Iron-rich from the Iron-poor tholeiites as well color identification.

RESULTS

The Iron-rich and Iron-poor tholeiitic flow contact was easily determined in the field and from magnetometer results.

An undocumented pit and trench system in the SE corner of claim 1185612 was located, mapped and sampled and yielded anomalous Au values.

From mapping it would appear that the North-South striking diabase dykes follow along the contact of the tholeiitic flows.

CONCLUSION

Mechanical stripping of the undocumented pit and trench system in the SE corner of claim 1185612 is warranted.



SAMPLING MAP
PIPELINE NORTH PROP.
MAISONVILLE TWP.

 Stripped Area
Sample No. PN# 3



SCALE: 1" = 200 FT

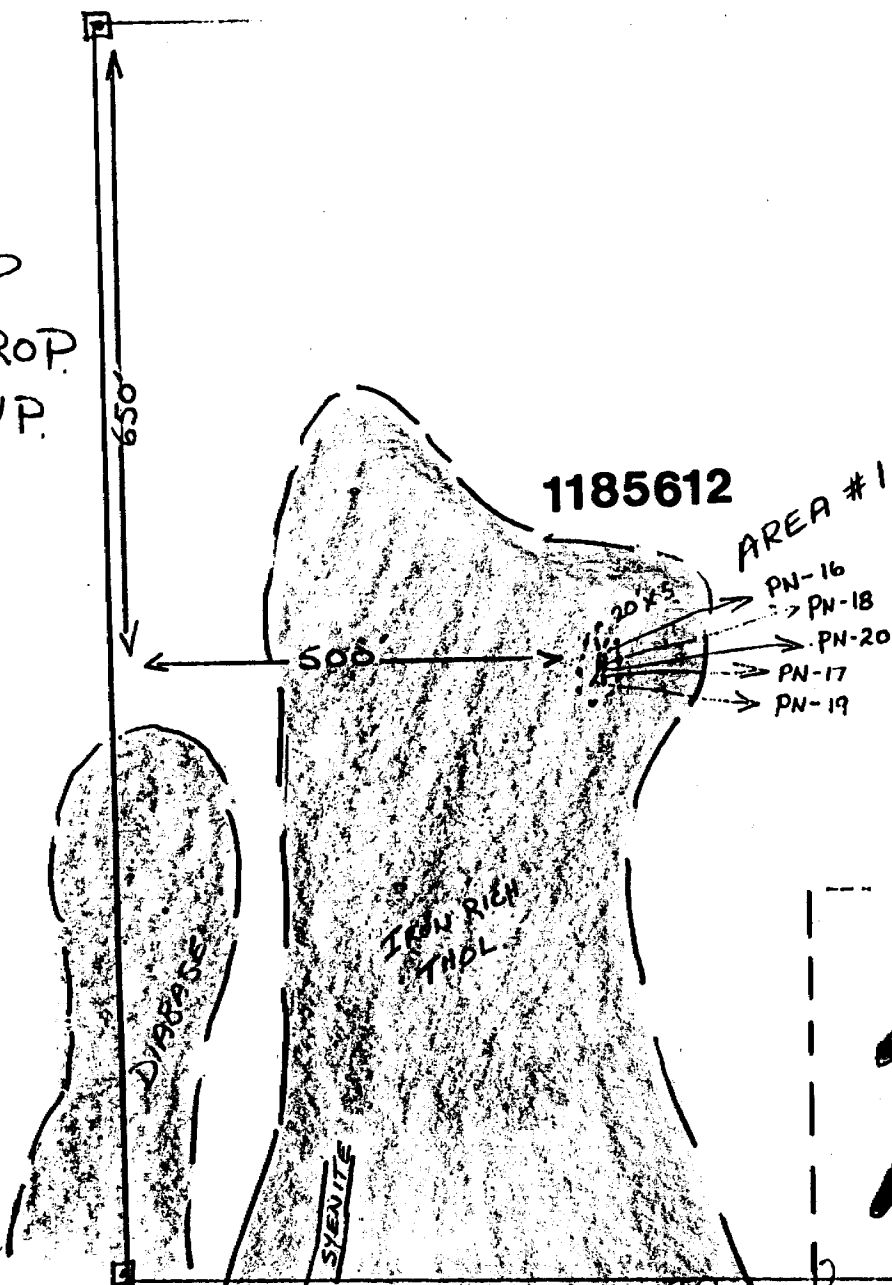

See Fig 3 For Sample
LOCATION

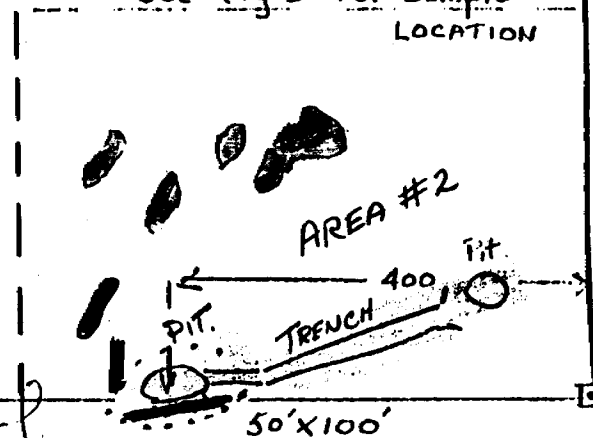



SAMPLING MAP
PIPELINE NORTH PROP.
MAISONVILLE TWP.

 Stripped Area
Sample No. PN#3

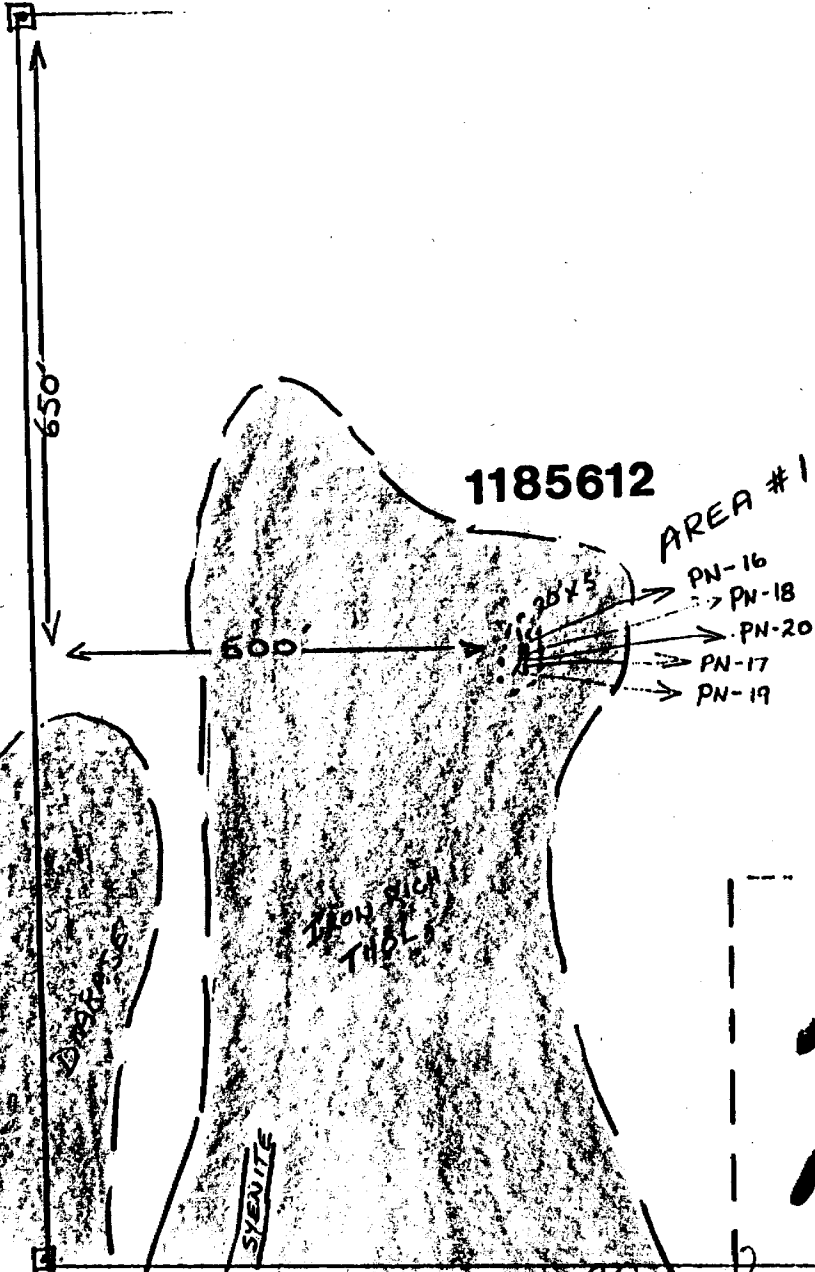

See Fig 3 for Sample LOCATION

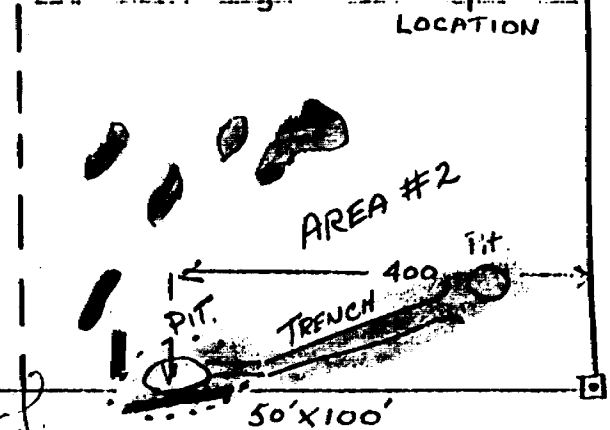

SCALE: 1" = 200 FT

SAMPLING MAP - AREA #2
FROM FIG 2

PIPELINE NORTH PROP.
MAISONVILLE TWP.



LEGEND

- ⋯ Brushed & stripped
- XX Muck pile
- Sample No. PN-21
- IRON POOR THOL.
- PORPHYRY SYENITE
- LAMPROPHIRE
- DIABASE

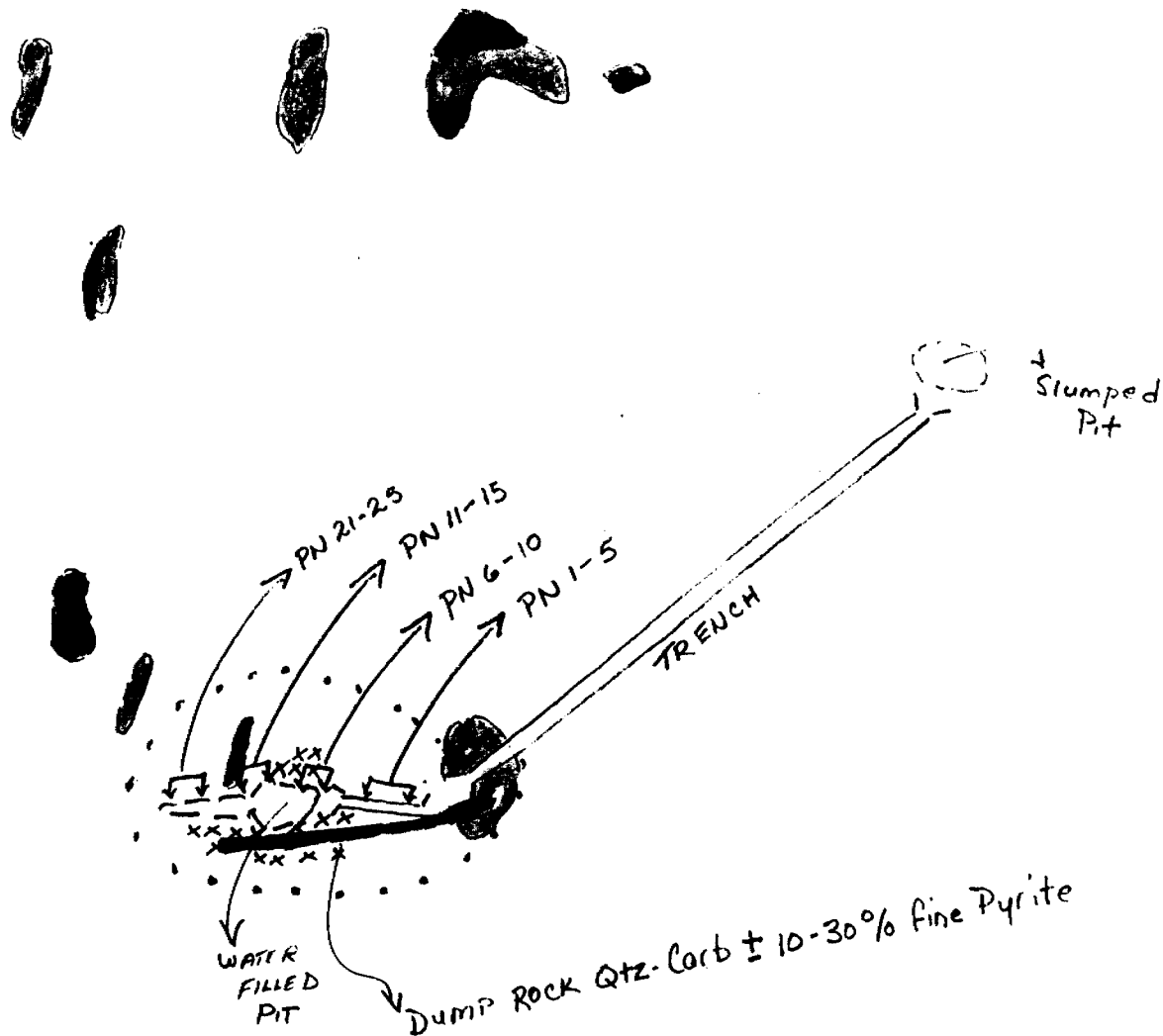

SCALE 1" = 50 FT.

Fig 3.



SAMPLING MAP
PIPELINE NORTH PROP.
MAISONVILLE TWP.

 Stripped Area
Sample No. PN# 3

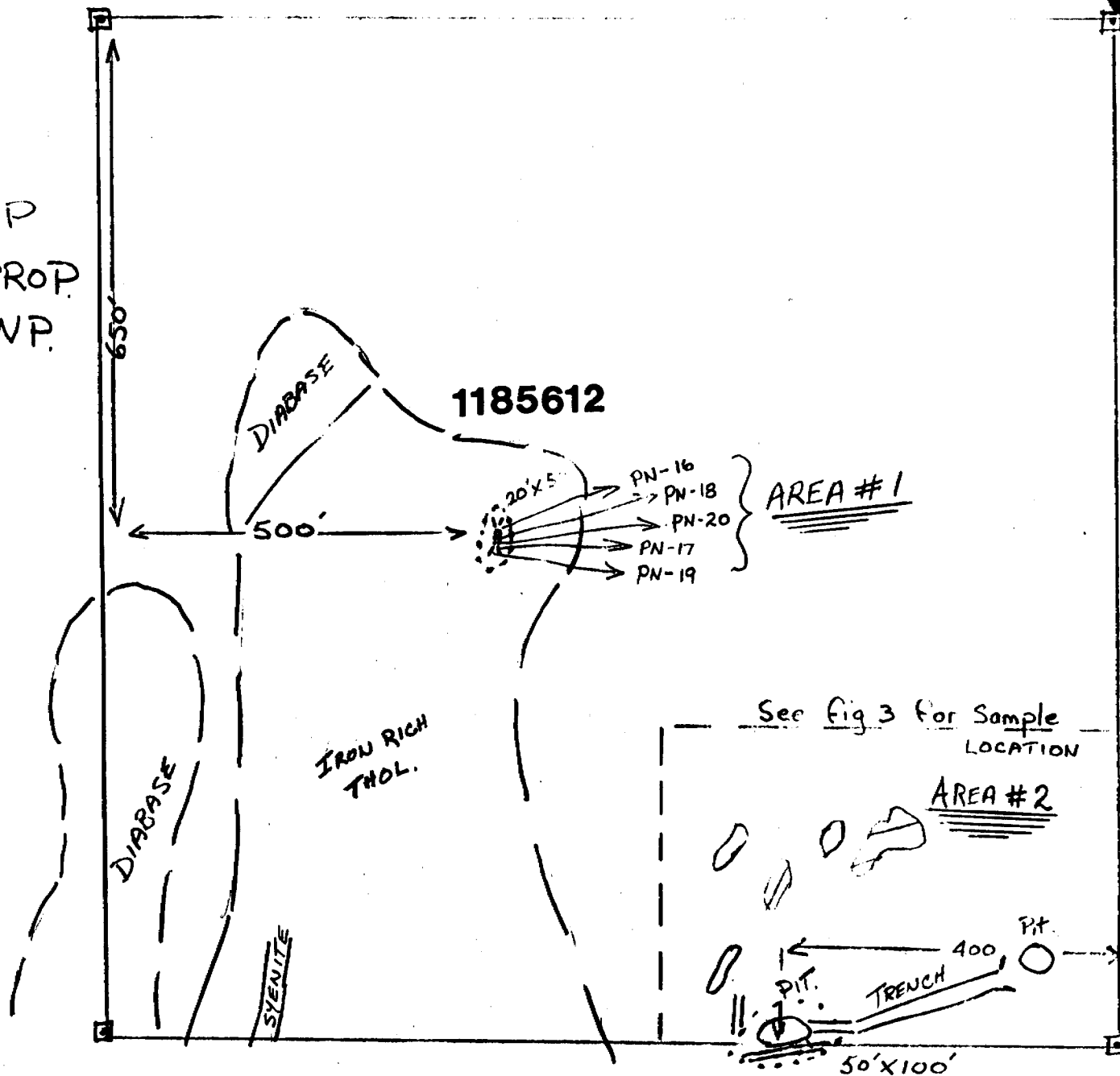

SCALE: 1" = 200 FT

Fig. 2

APPENDIX 1

CLAIM HOLDERS

Jocelyne Kidston
Box 66
Swastika, Ontario
P0K 1T0

L. Mike Dymont
Box 66
Swastika, Ontario
P0K 1T0

SUPERVISION

Jocelyne Kidston and L. Mike Dymont



LEGEND

ARCHEAN

- 6 Diabase
- 5b Porphyry Syenite
- 2 Iron-rich Thol.
- 1 Iron-poor Thol.
- a fine-grained
- b Pillowed
- c Pillow breccia
- d Coarse-grained
- D→ Pillow top
- Timbered Area

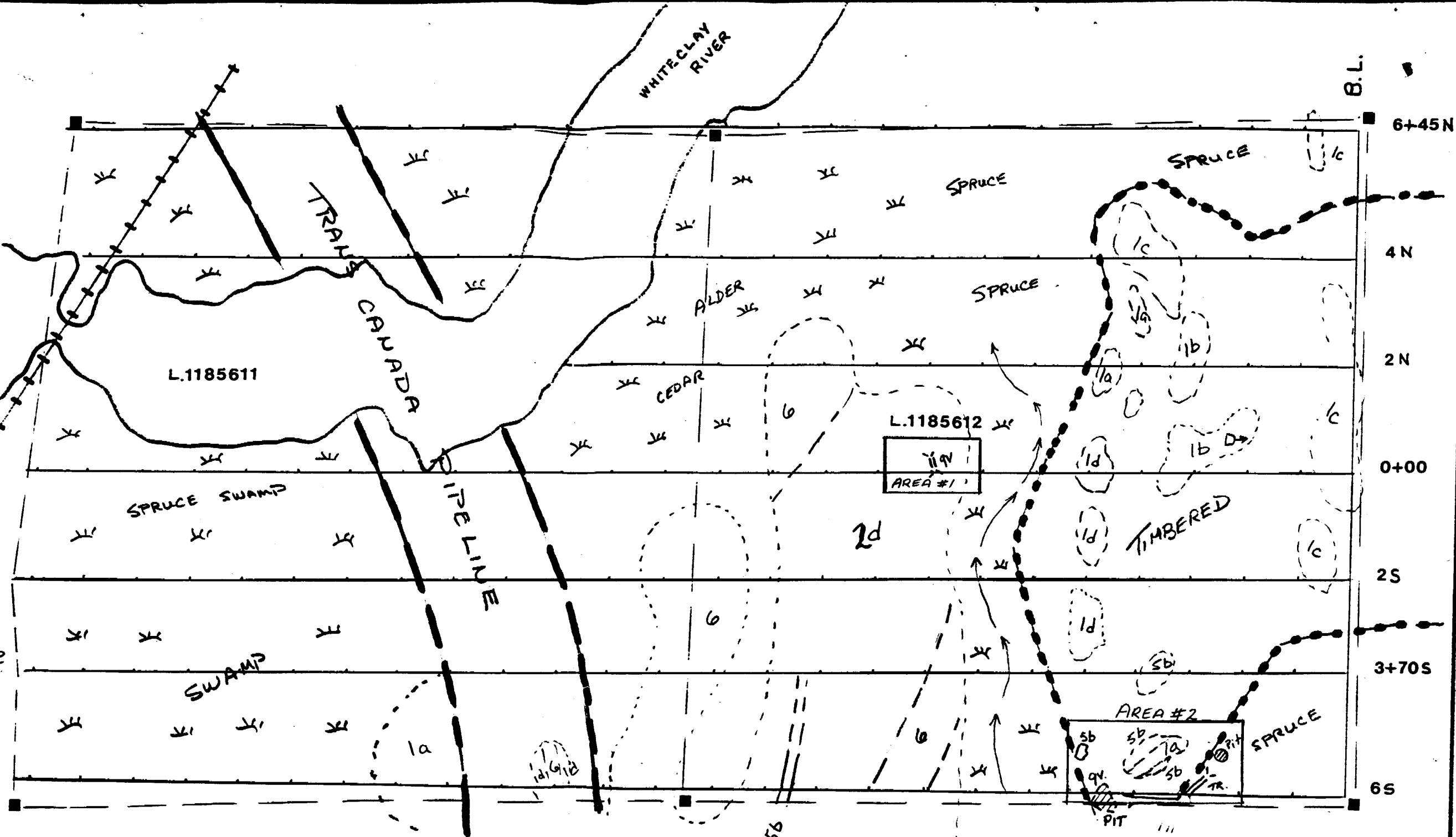
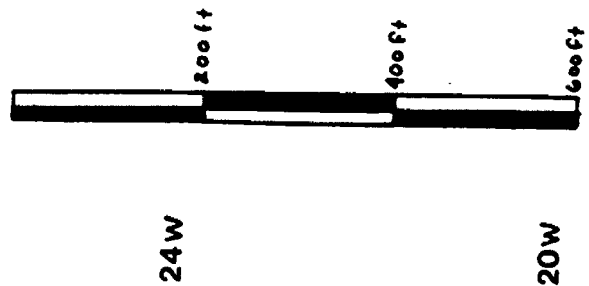

**PIPELINE NORTH
Maisonville Twp.
Larder Lake Mining Div.**

Handwritten signature
Apr. 1/73
Revised



LEGEND

ARCHEAN

- Diabase
- Porphyry Syenite
- Iron-rich Thol.
- Iron-poor Thol.
- a fine-grained
- b Pillowed
- c Pillow breccia
- d Coarse-grained
- ▷ Pillow top
- ▨ Inferred Diabase (from Geophysics)

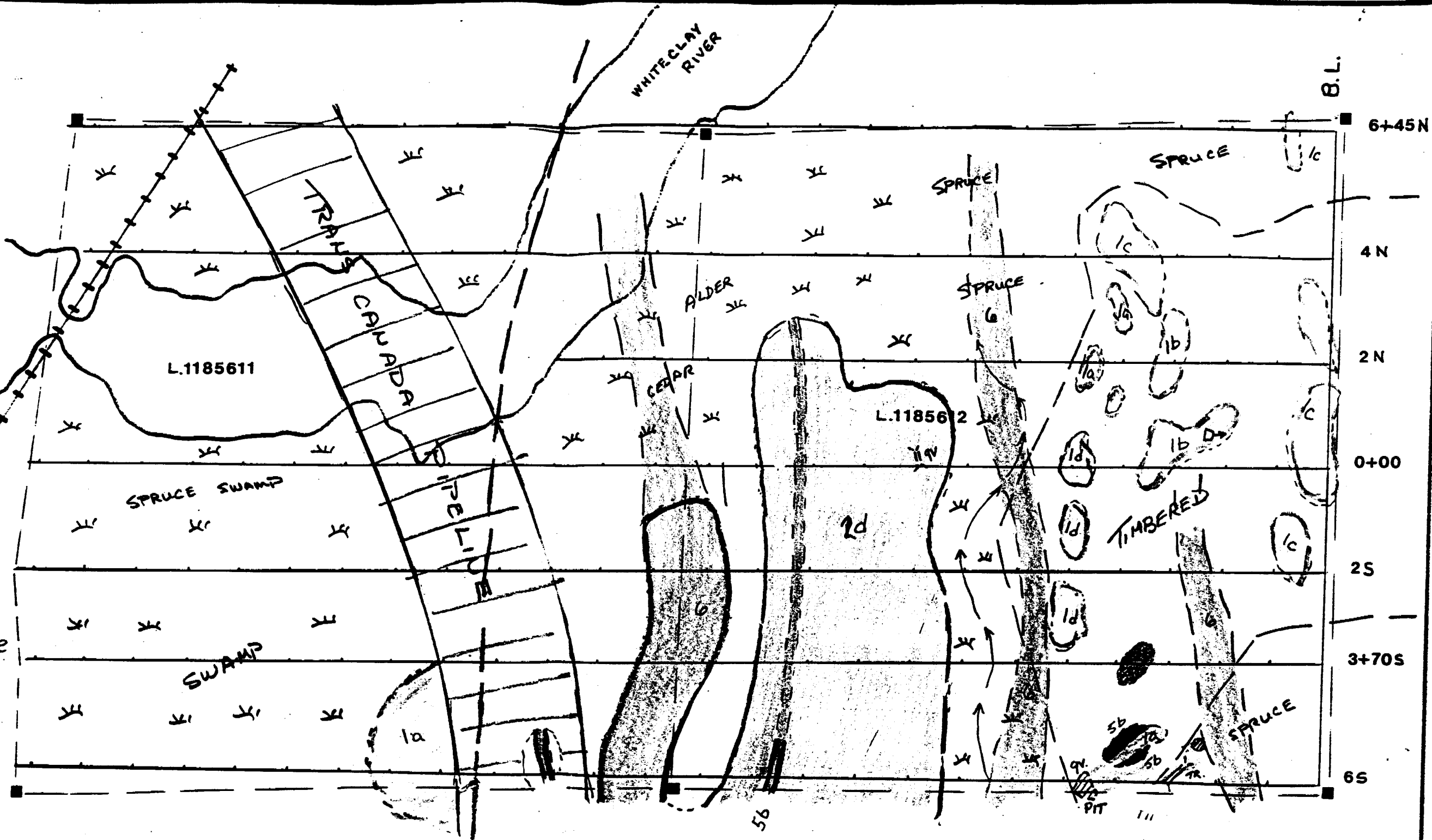
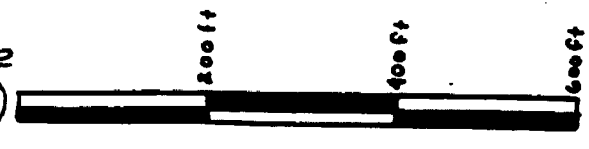

PIPELINE NORTH
Maisonville Twp.
Larder Lake Mining Div.

2.14892

APPENDIX 2

Swastika Laboratories
 P.O. Box 10
 Swastika, Ontario
 P0K 1T0

INVOICE

NO: 27811
 DATE: 10-08-92
 PAGE: 1 of 1

SOLD TO:
 J. Kidston
 R.R. #1
 Tarzwell, Ontario
 P0K 1V0

SHIP TO:
 Same

ST Number: R132862640

ITEM NO.	QUANTITY	UNIT	DESCRIPTION	G	P	UNIT PRICE	AMOUNT
	15	Code 1	Au Assays	3		8.750	131.25
	2	Code 1	Ag	3		2.000	4.00
	1	Code 1	Pb Zn	3		3.000	3.00
	15	Code 4	Sample Handling Cert#2W-1065-RG1 Pipe-north 3-GST @ 7 %	3		3.000	45.00
						WASTIKA LABORATORIES OCT 13 / 92 WITH THANKS PER <i>[Signature]</i>	
TERMS: Net 30 Days						TOTAL	196.00

Swastika Laboratories
 P.O. Box 10
 Swastika, Ontario
 P0K 1T0

INVOICE

NO: 27675

DATE: 08-28-92

PAGE: 1 of 1

SOLD TO:

J. Kidston
 R.R. #1
 Tarzwell, Ontario
 P0K 1V0

SHIP TO:

Same

BST Number: R132862640

ITEM NO.	QUANTITY	UNIT	DESCRIPTION	G	P	UNIT PRICE	AMOUNT
10		Code 1	Au Assays	3		8.750	87.50
2		Code 1	Ag Cu	3		3.000	6.00
10		Code 4	Sample Handling	3		3.000	30.00
			Cert#2W-0938-R01				
			3-BST @ 7 %				8.65
						TOTAL	132.15

SWASTIKA LABORATORIES

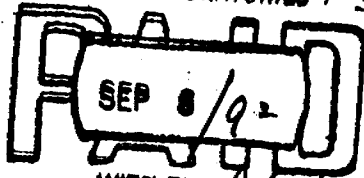

WITH THANKS

PER

COMMENTS:

Net 30 Days



Swastika Laboratories

A Division of Assayers Corporation Ltd.

Assaying - Consulting - Representation

Geochemical Analysis Certificate

2W-0938-RG1

Company: **J. KIDSTON**
Project: **PIPE NORTH**
Attn:

Date: AUG-28-92

We hereby certify the following Geochemical Analysis of 10 ROCK samples submitted AUG-24-92 by .

Sample Number	Au PPB	Au check PPB	Ag PPM	Cu PPM
PN-1	27			
PN-2	230 ✓	233		
PN-3	285 ✓			
PN-4	264 ✓		1.8	36
PN-5	182 ✓		1.2	30
PN-6	154 ✓			
PN-7	96 ✓			
PN-8	178 ✓			
PN-9	1190 ✓	1269		
PN-10	14			

Certified by Donna Gardner

P.O. Box 10, Swastika, Ontario P0K 1T0
Telephone (705) 642-3244 FAX (705) 642-3300



Established 1928

Swastika Laboratories

A Division of TSL/Assayers Inc.

Assaying - Consulting - Representation

Geochemical Analysis Certificate

2W-1065-RG1

Company: **J. A. KIDSTON**
Project: Pipe - North
Attn:

Date: OCT-08-92

Copy 1. box 66 Swastika, Ont. P0K 1T0

We hereby certify the following Geochemical Analysis of 15 rock samples submitted OCT-05-92 by J. A. Kidston.

Sample Number	Au ppb	Ag ppm	Pb ppm	Zn ppm
PN #11	302 ✓	1.8	27	67
PN #12	175/178 ✓			
PN #13	394 ✓			
PN #14	14			
PN #15	216 ✓			
PN #16	137			
PN #17	10			
PN #18	185			
PN #19	10			
PN #20	302/298			
PN #21	226 ✓			
PN #22	333 ✓			
PN #23	336 ✓			
PN #24	86/93 ✓	0.6		
PN #25	62 ✓			

Certified by Donna Gardner

P.O. Box 10, Swastika, Ontario P0K 1T0
Telephone (705) 642-3244 FAX (705) 642-3300

APPENDIX 3

CERTIFICATE

I, Leslie Michael Dymont, residing in the township of Marquis, Ontario, and having a mailing address of Joml Minerals and Expediting Ltd., Box 66, Swastika, Ontario, P0K 1T0, do hereby certify:

- (1) That I am a Mining Technician having taken the two year course at Haileybury School of Mines, Haileybury, Ontario.
- (2) That I have been employed in all phases of mining exploration and developement for 32 years.
- (3) That I did personally accumulate and set forth the facts and knowledge in the accompanying report and maps.
- (4) That the accompanying report is true.

DECEMBER 12, 1992
SWASTIKA, ONTARIO



LESLIE MICHAEL DYMENT



Ontario



42A01NE8949 2.14892 MAISONVILLE

900

Ministry of
Northern Development
and Mines

Ministère du
Développement du Nord
et des Mines

Geoscience Approvals Section
Mining Lands Branch
Willet Green Miller Centre
933 Ramsey Lake Road
6th Floor
Sudbury, Ontario
P3E 6B5

Telephone: (705) 670-5853
Fax: (705) 670-5863

Our File: 2.14892
Transaction #: W9380.00008

May 14, 1993

Mining Recorder
Ministry of Northern Development
and Mines
4 Government Road East
Kirkland Lake, Ontario
P2N 1A2

Dear Sir:

**RE: APPROVAL OF ASSESSMENT WORK ON MINING CLAIMS L 1185611 ET AL IN
MAISONVILLE TOWNSHIP.**

The Assessment credits for Geology and Assaying, sections 12 and 17 of the Mining Act Regulations, as listed on the original submission, have been approved as of APRIL 5, 1993.

Please indicate this approval on the claim record sheets.

If you have any questions please call Clive Stephenson at (705) 670-5856.

Yours sincerely,

Blair Kite
(Acting) Senior Manager, Mining Lands Branch
Mines and Minerals Division

CD
CDS/jl
Enclosures:

Assessment Files Office
Toronto, Ontario

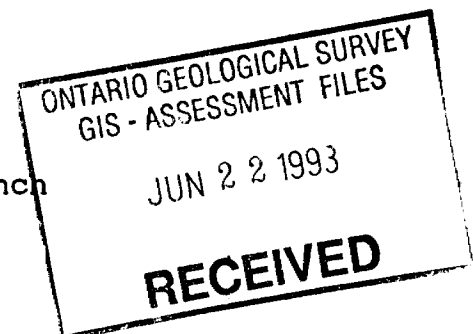

Resident Geologist
Kirkland Lake, Ontario

**Report of Work Conducted
 After Recording Claim**
 Mining Act

Transaction Number
U9380.00008

2.14892

Personal information collected on this form is obtained under the authority of the Mining Act. This information will be used for correspondence. Questions about this collection should be directed to the Provincial Manager, Mining Lands, Ministry of Northern Development and Mines, Fourth Floor, 159 Cedar Street, Sudbury, Ontario, P3E 6A5, telephone (705) 870-7264.

- Instructions:**
- Please type or print and submit in duplicate.
 - Refer to the Mining Act and Regulations for requirements of filing assessment work or consult the Mining Recorder.
 - A separate copy of this form must be completed for each Work Group.
 - Technical reports and maps must accompany this form in duplicate.
 - A sketch, showing the claims the work is assigned to, must accompany this form.

Recorded Holder(s) L. M. DYMENT & J. A. KIDSTON		Client No. 128504 + 151995
Address Box 66, SWASTIKA, ONT POK ITO		Telephone No. 705-642-3062
Mining Division LARDER LAKE	Township/Area MAISONVILLE	M or G Plan No. 6-3669
Dates Work Performed From: May 9, 1992		To: Sept. 13, 1992

Work Performed (Check One Work Group Only)

Work Group	Type
Geotechnical Survey	GEOLOGICAL (ASSAYS)
Physical Work, Including Drilling	RECEIVED
Rehabilitation	
Other Authorized Work	JAN 27 1993
Assays	MINING LANDS BRAN
Assignment from Reserve	

Total Assessment Work Claimed on the Attached Statement of Costs \$ **2257.00**

Note: The Minister may reject for assessment work credit all or part of the assessment work submitted if the recorded holder cannot verify expenditures claimed in the statement of costs within 30 days of a request for verification.

Persons and Survey Company Who Performed the Work (Give Name and Address of Author of Report)

Name	Address
L. M. DYMENT	Box 66, SWASTIKA, ONT. POK ITO
J. A. KIDSTON	Box 66, SWASTIKA, ONT. POK ITO
SWASTIKA LAB	SWASTIKA, ONT.

(attach a schedule if necessary)

Certification of Beneficial Interest * See Note No. 1 on reverse side

I certify that at the time the work was performed, the claims covered in this work report were recorded in the current holder's name or held under a beneficial interest by the current recorded holder.	Date JAN 15/93	Recorded Holder or Agent (Signature) <i>[Signature]</i>
--	--------------------------	--

Certification of Work Report

I certify that I have a personal knowledge of the facts set forth in this Work report, having performed the work or witnessed same during and/or after its completion and annexed report is true.		
Name and Address of Person Certifying L. M. DYMENT, BOX 66, SWASTIKA, ONT POK ITO		
Telephone No. 705-642-3062	Date JAN. 15/93	Certified By (Signature) <i>[Signature]</i>

For Office Use Only

Total Value Cr. Recorded Reserve 2257	Date Recorded Jan. 15/93	Mining Recorder <i>[Signature]</i>	Received Stamp RECEIVED JAN 15 1993
	Deemed Approval Date Apr. 15/93	Date Approved	
	Date Notice for Amendments Sent		

Statement of Costs for Assessment Credit

Transaction No./N° de transaction
W. 9380.02008.

État des coûts aux fins du crédit d'évaluation

Mining Act/Loi sur les mines

Personal information collected on this form is obtained under the authority of the Mining Act. This information will be used to maintain a record and ongoing status of the mining claim(s). Questions about this collection should be directed to the Provincial Manager, Minings Lands, Ministry of Northern Development and Mines, 4th Floor, 159 Cedar Street, Sudbury, Ontario P3E 6A5, telephone (705) 870-7284.

Les renseignements personnels contenus dans la présente formule sont recueillis en vertu de la Loi sur les mines et serviront à tenir à jour un registre des concessions minières. Adresser toute question sur la collecte de ces renseignements au chef provincial des terrains miniers, ministère du Développement du Nord et des Mines, 159, rue Cedar, 4^e étage, Sudbury (Ontario) P3E 6A5, téléphone (705) 870-7284.

1. Direct Costs/Coûts directs

Type	Description	Amount Montant	Totals Total global
Wages Salaires	Labour GEOL MAP Main-d'oeuvre	1500.00	
	Field Supervision RPT. Supervision sur le terrain	300.00	1800.00
Contractor's and Consultant's Fees Droits de l'entrepreneur et de l'expert-conseil	Type ASSAYS	328.23	
			328.23
Supplies Used Fournitures utilisées	Type		
Equipment Rental Location de matériel	Type JAN 27 1993 MINING LANDS BRANCH		
Total Direct Costs Total des coûts directs			2128.23

2. Indirect Costs/Coûts indirects

** Note: When claiming Rehabilitation work Indirect costs are not allowable as assessment work.
 Pour le remboursement des travaux de réhabilitation, les coûts indirects ne sont pas admissibles en tant que travaux d'évaluation.

Type	Description	Amount Montant	Totals Total global
Transportation Transport	Type VEHICLE 5 days x 80km x 30¢	129.00	
			129.00
Food and Lodging Nourriture et hébergement			
Mobilization and Demobilization Mobilisation et démoblisation			
Sub Total of Indirect Costs Total partiel des coûts indirects			129.00
Amount Allowable (not greater than 20% of Direct Costs) Montant admissible (n'exécédant pas 20 % des coûts directs)			129.00
Total Value of Assessment Credit (Total of Direct and Allowable Indirect costs)			2257.23

Note: The recorded holder will be required to verify expenditures claimed in this statement of costs within 30 days of a request for verification. If verification is not made, the Minister may reject for assessment work all or part of the assessment work submitted.

Note : Le titulaire enregistré sera tenu de vérifier les dépenses demandées dans le présent état des coûts dans les 30 jours suivant une demande à cet effet. Si la vérification n'est pas effectuée, le ministre peut rejeter tout ou une partie des travaux d'évaluation présentés.

Filing Discounts

1. Work filed within two years of completion is claimed at 100% of the above Total Value of Assessment Credit.
2. Work filed three, four or five years after completion is claimed at 50% of the above Total Value of Assessment Credit. See calculations below:

Total Value of Assessment Credit	Total Assessment Claimed
	× 0.50 =

Remises pour dépôt

1. Les travaux déposés dans les deux ans suivant leur achèvement sont remboursés à 100 % de la valeur totale susmentionnée du crédit d'évaluation.
2. Les travaux déposés trois, quatre ou cinq ans après leur achèvement sont remboursés à 50 % de la valeur totale du crédit d'évaluation susmentionné. Voir les calculs ci-dessous.

Valeur totale du crédit d'évaluation	Evaluation totale demandée
	× 0,50 =

Certification Verifying Statement of Costs

I hereby certify: that the amounts shown are as accurate as possible and these costs were incurred while conducting assessment work on the lands shown on the accompanying Report of Work form.

that as RECORDED HOLDER I am authorized
 (Recorded Holder, Agent, Position in Company)

to make this certification

Attestation de l'état des coûts

J'atteste par la présente : que les montants indiqués sont le plus exact possible et que ces dépenses ont été engagées pour effectuer les travaux d'évaluation sur les terrains indiqués dans la formule de rapport de travail ci-joint.

Et qu'à titre de _____ je suis autorisé
 (titulaire enregistré, représentant, poste occupé dans la compagnie)

à faire cette attestation.

Signature [Signature] Date JAN 15/93

Nota : Dans cette formule, lorsqu'il désigne des personnes, le masculin est utilisé au sens neutre.

BENOIT TWP. - M.326

THE TOWNSHIP OF

MAISONVILLE

DISTRICT OF
TIMISKAMING

DATE OF ISSUE
JAN 25 1988

LARDER LAKE
MINING DIVISION

SCALE: 1-INCH 40 CHAINS

LEE TWP. - M.360

BERNHARDT TWP. - M.327

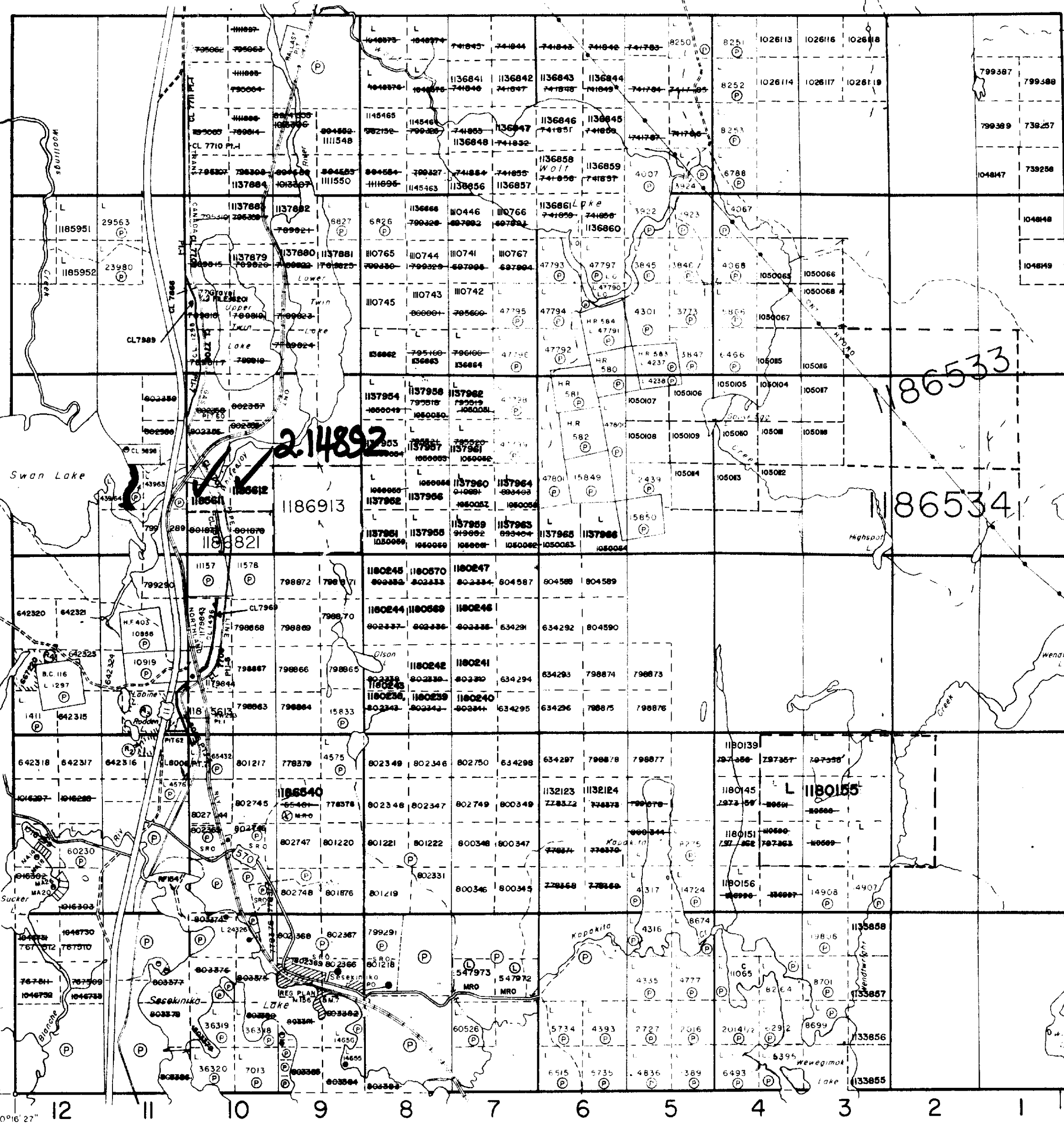

GRENFELL TWP. - M.351

THE INFORMATION THAT APPEARS ON THIS MAP HAS BEEN COMPILED FROM VARIOUS SOURCES, AND ACCURACY IS NOT GUARANTEED. THOSE WISHING TO STAKE MINING CLAIMS SHOULD CONSULT WITH THE MINING RECORDER, MINISTRY OF NORTHERN DEVELOPMENT AND MINES, FOR ADDITIONAL INFORMATION ON THE STATUS OF THE LANDS SHOWN HEREON.

LEGEND

- PATENTED LAND ● or P
- CROWN LAND SALE C.S.
- LEASES L
- LOCATED LAND L.C.
- LICENSE OF OCCUPATION L.O.
- MINING RIGHTS ONLY M.R.O.
- SURFACE RIGHTS ONLY S.R.G.
- ROADS
- IMPROVED ROADS
- KING'S HIGHWAYS
- RAILWAYS
- POWER LINES
- MARSH OR MUSKOG
- MINES
- CANCELLED
- PATENTED S.R.O.

NOTES

- 400' surface rights reservation along the shores of all lakes and rivers
- Areas withdrawn from staking
- WITHDRAWN FROM STAKING, SECTION 31-F
- PENDING APPLICATION UNDER PUBLIC LANDS ACT
- ALL ISLANDS IN SESEKINIKIA LAKE ARE WITHDRAWN FROM STAKING BY ORDER-IN- COUNCIL DATED DEC. 7, 1921
- R2 SURFACE RIGHTS WITHDRAWN FROM STAKING, SEC. 43/70 NOV. 8, 1970. FILE 22032
- R3 SURFACE RIGHTS WITHDRAWN FROM STAKING, SEC. 43/70. N.R.W. 5/81 JAN. 23, 1981, FILE 22032
- R4 SURFACE AND MINING RIGHTS WITHDRAWN FROM STAKING SEC. 36/80, W. 8/86, JAN. 20, 1986

Surface Rights Withdrawn under Sec. 35.
The Mining Act R.S.O. 1980, ORDER NO. W-01/91/ONT
(Trans Canada Pipeline Right of Way and Buffer
Zone particularly 40.25 meters or 132 ft. on
either side of centre line of right of way)

DATE RECEIVED JAN 20/88

PLAN NO. G - 3669

MINISTRY OF NORTHERN
DEVELOPMENT AND MINES

NOTICE OF FORESTRY ACTIVITY

THIS TOWNSHIP / AREA FALLS WITHIN THE
TIMISKAMING MANAGEMENT UNIT
AND MAY BE SUBJECT OF FORESTRY OPERATIONS,
THE MNR UNIT FORESTER FOR THIS AREA CAN BE
CONTACTED AT: P.O. BOX 129
SWASTIKA, ONT.
POK ITO
705-642-3222

COPY OF THIS MYLAR ARCHIVED DEC 06/91
COPY OF THIS MYLAR ARCHIVED JUNE 1, 1992

