



42A01NW0043 2.14498 BOMPAS

010

**REPORT on**  
**HLEM (MAX MIN) SURVEY**  
**GEOLOGICAL SURVEY**  
**DIAMOND DRILLING**  
**LADY LOU PROPERTY**  
**BOMPAS TOWNSHIP**  
**LARDER LAKE MINING DIVISION**  
**ONTARIO**

M. Leahy *Qual. No. : 2.2689*  
December, 1991

**2. 14498**

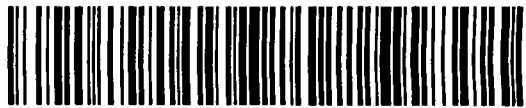

## TABLE OF CONTENTS

	Page #
INTRODUCTION	
Location	2
Access	2
History	2
Geology - Regional	2
Geology - Lady Lou Claim	2 - 3
1991 EXPLORATION PROGRAM	
Line Cutting Program	3
Max Min HLEM Survey	3
Geological Survey	3
Diamond Drilling Program	4 - 5
Self - Potential Survey	5
CONCLUSIONS	
Max Min HLEM Survey	5
Geological Survey	6
Diamond Drilling Program	6
Self - Potential Survey	6
RECOMMENDATIONS	6

1991 EXPLORATION PROGRAM

## TABLE OF CONTENTS

### APPENDICES

Claim Map	I
Geology Map	II
Sample Descriptions	III
Whole Rock Analysis	IV
Jensen Cation Plot	V
Geochemical Analysis	VI
Drill Plan	VII
Drill Logs	VIIIa, VIIIb, VIIIc
Max Min Map	IX
S-P Chart <i>(Map)</i>	X
Certificate	XI

## INTRODUCTION

### Location:

The property herein described consists of one unpatented mining claim, L-1110266, located about 1 1/4 mile north of the SE corner of Bompas Township, Larder Lake Mining Division, Ontario. The claim lies just west of the north end of Kenogami Lake and 1/2 mile northwest of Hotchkin (Little Kenogami) Lake. The town of Kirkland Lake lies about 11 miles to the east.

### Access:

Grenfell Road leads west from Highway 11 at Kenogami and passes within 2,000' of the property along the eastern boundary of Bompas Township. The road is maintained year-round for about 3 miles from the Trans-Canada where it becomes passable only by pickup truck. A trail was cut in June of 1991, from Grenfell road to the #1 shaft. The trail is passable by light all-terrain vehicles, only.

### History:

The property covers the old Lady Lou shaft area which was first discovered and worked around 1940. At that time, two shallow shafts (approximately 50' deep), were sunk and some surface trenching was done. In 1990, a Magnetic Survey, Electromagnetic Survey and Self-Potential Survey were performed.

### Geology - Regional:

The property lies near Kirkland Lake in the Abitibi super-group of steeply dipping Archean metavolcanics and metasediments which straddles the Ontario - Quebec border. The famed E-W striking Larder - Cadillac break passes about 2 1/2 miles to the south. The property lies on a thin, 5 mile wide, N-S trending outlier of flat lying Huronian sediments bound on the east by mafic Kijovis metavolcanics and on the west by the Watabeag batholith (Algomian).

### Geology - Lady Lou Claim:

The property is underlain by Huronian sediments 1/4 mile west of the eastern edge of the above mentioned Huronian outlier. Mineralization and geology were described by Lovell, 1980.

"Mineralized rock in dumps consists of quartz veins cutting Cobalt Group Gowganda Formation Coleman Member feldspathic sandstone (arkose). The quartz veins are vuggy in places, with euhedral crystals of quartz as drusy linings of gas spaces. Metallic minerals in the veins are chalcopyrite, pyrite, sphalerite and gold.

Geology - Lady Lou Claim, cont'd.:

Quartz veins of an aggregate width of about 0.6m (2') strike N 30 W and dip 75 SW, and cut Cobalt Group arkose. The veins contain pyrite, chalcopyrite and gold. A brecciated fracture zone containing pyrite, chalcopyrite and galena strikes across about perpendicular to the quartz band."

### 1991 EXPLORATION PROGRAM

Line Cutting Program:

Three new picket lines (L9W, L11W and L13W) were added to last year's grid, (2,200', in 1991). Deadfall was cleared from last year's grid and a trail was cut from Grenfell road to the #1 shaft.

Max Min Horizontal Loop EM Survey:

On September 20, 1991, three lines were read on the property in search of possible EM conductors beneath the flat - lying Huronian sediments. A total of 50 readings were taken at 50' or 100' intervals along L8W, L10W and the south part of the baseline. Two frequencies were read (444, 1777khz), along all lines at a 300' coil separation. Results were plotted on a map with a scale of 1" = 200'. No conductive zones were detected.

Geological Survey:

The entire claim was mapped using grid lines for control. All outcrops, pits, veins and topo features were noted and plotted on a map with a scale of 1" = 200'. The claims are underlain by Huronian arkose dipping very gently west. A few narrow quartz veins were found with minor pyrite, chalcopyrite and galena. At the #2 shaft dump angular, epidotized basalt and epidotized Huronian arkose were found indicating the shaft penetrated through to basement. Whole rock analyses define the basalt as a high magnesium Tholeite, (see Jensen Cation plot, attached). Several samples were taken, mostly from the shaft dumps, and all were assayed for gold with disappointing results.

## 1991 EXPLORATION PROGRAM

### Diamond Drilling Program:

Three short diamond drill holes were put down as follows:

DDH LL - 1 - Collared at L10W + 160S at #1 shaft.

- Bearing 40
- Dip 45
- Depth 60'
- Target: 1. - testing depth of Huronian sediments,  
2. - search for veins parallel to #1 shaft vein.
- Results: - hole stopped in Huronian sediments,  
- only a few narrow barren quartz veins encountered.
- Assays - none taken.

DDH LL - 2 - Collared at L10W + 160S at #1 shaft.

- Bearing 90
- Dip 45
- Depth 28'
- Target: 1. - shear under gully & perpendicular to shaft vein,  
2. - collared in shaft vein to get core sample of chalcopyrite in quartz.
- Result: - hole caved, jammed rods at 28' after grinding core.
- Assays: - none taken.

## 1991 EXPLORATION PROGRAM

Diamond Drilling Program, cont'd.:

DDH LL -3- Collared at 1150W + 2S at #2 shaft.

- Bearing 315
- Dip 45
- Depth 12'
- Target: - shear zone joining #1 and #2 shafts.
- Result: - hole lost in cave; abandoned at 12'.
- Assays: - none taken.

The Boyle Bros. "XRay" diamond drill employed in the program was unable to core through broken ground or to collar through overburden. Anchor bolts had to be set in bedrock to hold the drill stationary. The two speed transmission did not give the flexibility needed to handle varying ground conditions. Even when operated by a professional driller, the "XRay" is difficult and dangerous to work with and should only be used under ideal drilling conditions.

Self - Potential Survey:

A follow-up S-P survey was done to further test subtle responses detected during the 1990 program. A Micronta model 22-185A LCD digital multimeter with an accuracy of +/- 0.8% of reading and +/- 0.2% of full scale was used with porous porcelain pots containing CuSO<sub>4</sub> and H<sub>2</sub>O. The long wire technique was used giving readings relative to a single base point along the base line. Drought conditions during 1991 contrasted with wet soil conditions in 1990 which gave relatively high background potentials. The 1991 survey, under dry conditions gave smoother and lower readings effectively erasing the subtle responses (+ or - 100mv) recorded last year. A total of 79 readings were taken and plotted on a map with a scale of 1" = 200'. All the 1991 readings were low enough to be interpreted as zero.

## CONCLUSIONS

Max/Min HLEM Survey:

There were no conductors detected in traverses across the shaft vein or across the shear zone along the creek between the #1 and #2 shafts.

## CONCLUSIONS

### Geological Survey:

All out crops are gently dipping arkose with a few narrow quartz veins, some containing chalcopyrite, galena and pyrite. Underlying basalts are within about 50' of surface at the #2 shaft, as indicated by angular basalt boulders and epidotized arkose in shaft dump. There were no assays of economic interest; basement rocks have little base metal potential.

### Diamond Drilling Program:

Short holes gave little information and many problems. The XRay drill has severe limitations. No mineralization of interest intersected.

### Self - Potential Survey:

Dry conditions in 1991, gave smoother, lower readings discounting the possibility that subtle highs from the 1990 survey were caused by sulfides.

## RECOMMENDATIONS

The Lady Lou claim appears to have no economic potential at this time. No further exploration is recommended. The property does, however, have historic value. The shaft area is picturesque with a small intermittent stream flowing through the #1 shaft then down a narrow mossy canyon to the beaver ponds below. The partially collapsed hoist room contains a steam powered hoist and water pump as well as parts of the boiler system and other artifacts. At the #2 shaft a short tramway runs for 50' along a moss covered muck pile. An old side-dump ore car and hoisting bucket lie nearby. Efforts should be made to preserve the site and equipment and consideration should be given to restoring the site as an historic landmark.

*Michael Leahy*  
*Dec 91*



ELL TOWNSHIP

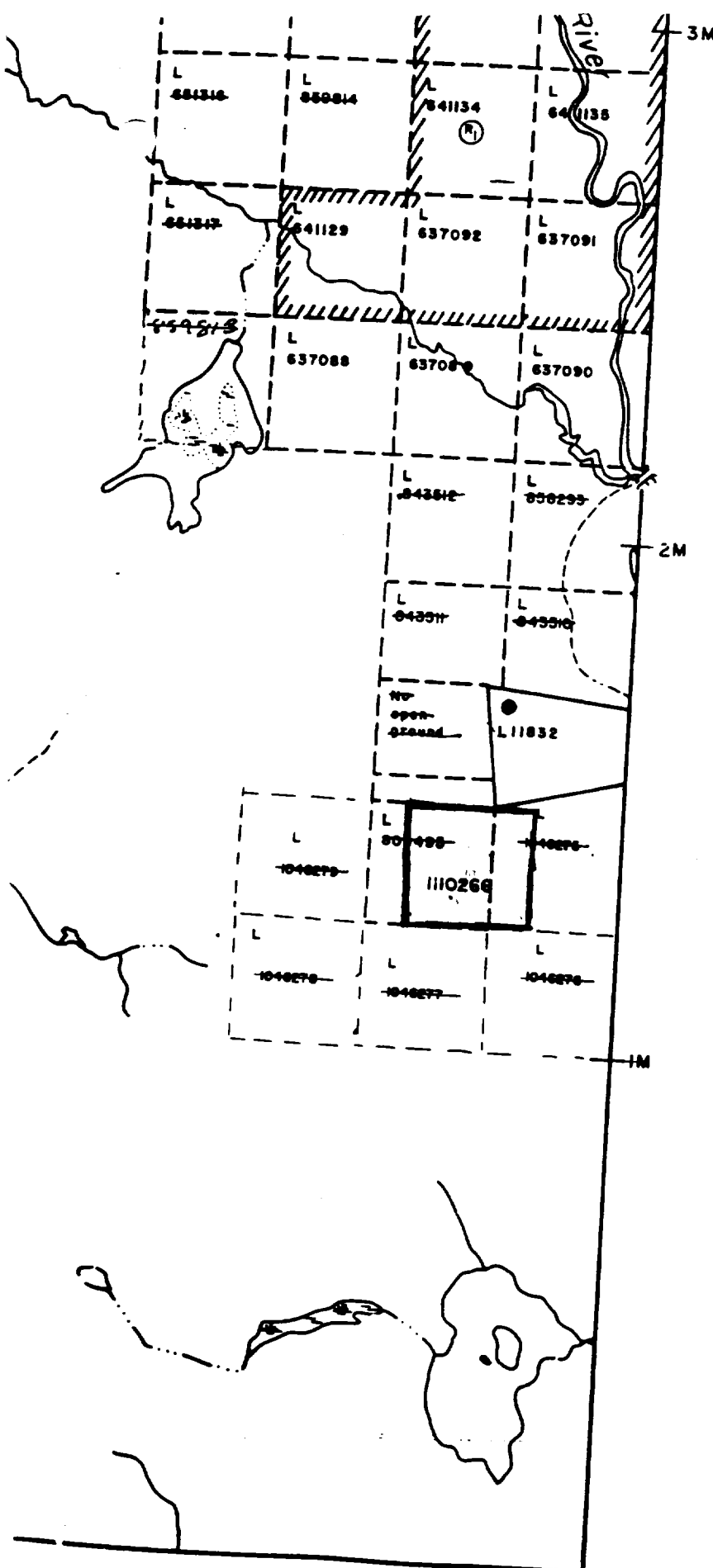

LADY LOU

PROSPECT

THE INFO  
APPEARS  
HAS BEEN  
FROM VAF  
AND ACCI  
GUARANT  
WISHING  
ING CLAIMS  
SULT WITH  
RECORDER,  
NORTHERN  
MENT AND  
DITIONAL  
ON THE ST.  
LANDS SHO

March 28 / 90

TOWNSHIP

**BOMPAS**

M.N.R. ADMINISTRATIVE DISTRICT

**KIRKLAND LAKE**

MINING DIVISION

**LARDER LAKE**

LAND TITLES / REGISTRY DIVISION

**TIMISKAMING**



Ministry of  
Natural  
Resources  
Ontario

Ministry of  
Northern Deve  
and Mines

# on MAP	SAMPLE #	LOCATION	DESCRIPTION	Au	Cu	Pb
1	12-540-A	L12W + 450S	Arkose, fine to med. grained. 1% py.	NIL		
2	12-544-A	L9W + 50N + 40'SW #2 shaft dump	Arkose, fine grained, silicified, breccia, QV, Cp. Basalt, black, fine grained weakly magnetic.	NIL	19	
3	12-550 *	#2 shaft dump		NIL		
4	12-547	#1 shaft dump	Arkose, QV.	NIL		
5	12-548	#1 shaft dump	Arkose, QV, Cp.	NIL	1760	
6	12-549	#2 shaft dump	Arkose, silicified, epidote, QCV, Py, galena.	NIL	444	2710
7	V-4792	#2 shaft dump	Arkose, med. grained, dark, > 1% fine diss. Py.	NIL		
8	V-4793 *	#2 shaft dump	Arkose, epidote, fine Py.	NIL		
9	V-4794	#2 shaft dump	Basalt, black, fine grained, epidote.	NIL		
10	V-4795 *	#2 shaft dump	Basalt, black, fine grained, carbonate stringers.	NIL		
11	V-4796	#2 shaft dump	Basalt, black, fine grained, rusty rind, slightly magnetic.	NIL		
12	V-4797	#2 shaft dump	Arkose, QV, epidote, Py.	NIL	4220	5540

\* See Whole Rock Analysis.

Very nice - v. m.

**SWASTIKA LABORATORIES**

P.O. BOX 10, SWASTIKA, ONTARIO  
PHONE #: (705) - 642 - 3244 FAX #: (705) - 642 - 3300

REPORT No. : **M9924**

Page No. : 1 of 1

File No. : OC11RA

Date : OCT-23-1991

**I.C.A.P. WHOLE ROCK ANALYSIS**

Lithium Metaborate Fusion

ANN BLACK CO.

1W-4125-RG1

SAMPLE #	SiO2 %	Al2O3 %	Fe2O3 %	CaO %	MgO %	Na2O %	K2O %	TiO2 %	MnO %	P2O5 %	Be %	Sr ppm	Y ppm	Zr ppm	LOI %
V-4793	58.13	13.86	9.24	6.82	4.95	3.12	1.40	0.52	0.16	0.10	0.76	864	14	78	1.91
V-4795	46.52	13.90	11.99	4.42	10.13	2.60	1.76	0.76	0.77	0.08	0.47	45	18	19	7.72
12-550	49.19	13.43	11.51	8.14	8.71	2.14	2.48	0.71	0.31	0.08	0.04	293	14	31	2.26

SIGNED :

- V 4793
- V 4795
- 12-550

FeO\* + TiO<sub>2</sub>

1ADYUOU

Cation %

Jensen 1976

MgO

Al<sub>2</sub>O<sub>3</sub>

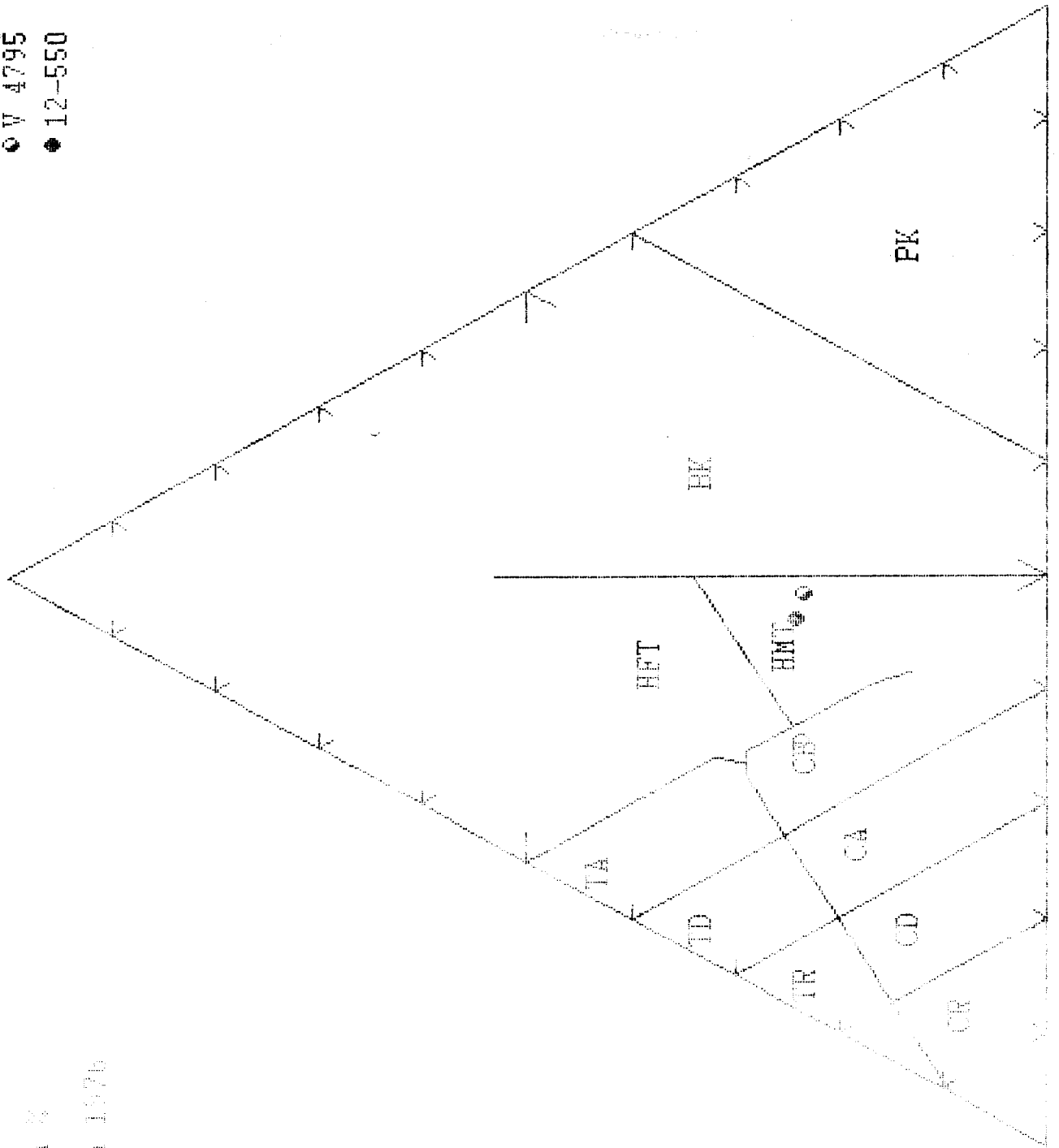



Established 1928

# Swastika Laboratories

A Division of Assayers Corporation Ltd.

Assaying - Consulting - Representation

## Geochemical Analysis Certificate

1W-4125-RG1

Company: **ANN BLACK**

Date: OCT-07-91

Project:

Copy 1. 139 CARTER AVE, KIRKLAND LAKE P2N 2A1

Attn:

2. 567-4696

We hereby certify the following Geochemical Analysis of 12 ROCK samples submitted OCT-04-91 by .

Sample Number	Au ppb	Cu ppm	Pb ppm	WRA ppm
V-4792	Nil			
V-4793	Nil			
V-4794	Nil			
V-4795	Nil			
V-4796	Nil			
V-4797	Nil/Nil	4220	5540	
12-540	Nil			
12-544	Nil	19		
12-547	Nil			
12-548	Nil	1760		
12-549	Nil	444	2710	
12-550	Nil			

Certified by Donna Gardner

DIAMOND DRILL SECTIONS  
LADY LOU PROPERTY  
BOMPAS TOWNSHIP  
1" = 50'

LL-1 AT L10W + 1608 BEARING 40 DEPTH 60'

ARKOSE

LL-2 AT L10W + 1608 BEARING 90 DEPTH 28'

GV, Py  
CP

ARKOSE

LL-3 AT J150W + 2008 BEARING 315 DEPTH 12'

ARKOSE

# LADY LOU PROPERTY

Bompas Township, Ontario

Larder Lake Mining Division

## (SELF-POTENTIAL SURVEY)

(Readings in Millivolts)

SCALE: 1" = 200ft.



DATE: January, 1992

NTS: 42 A / SE

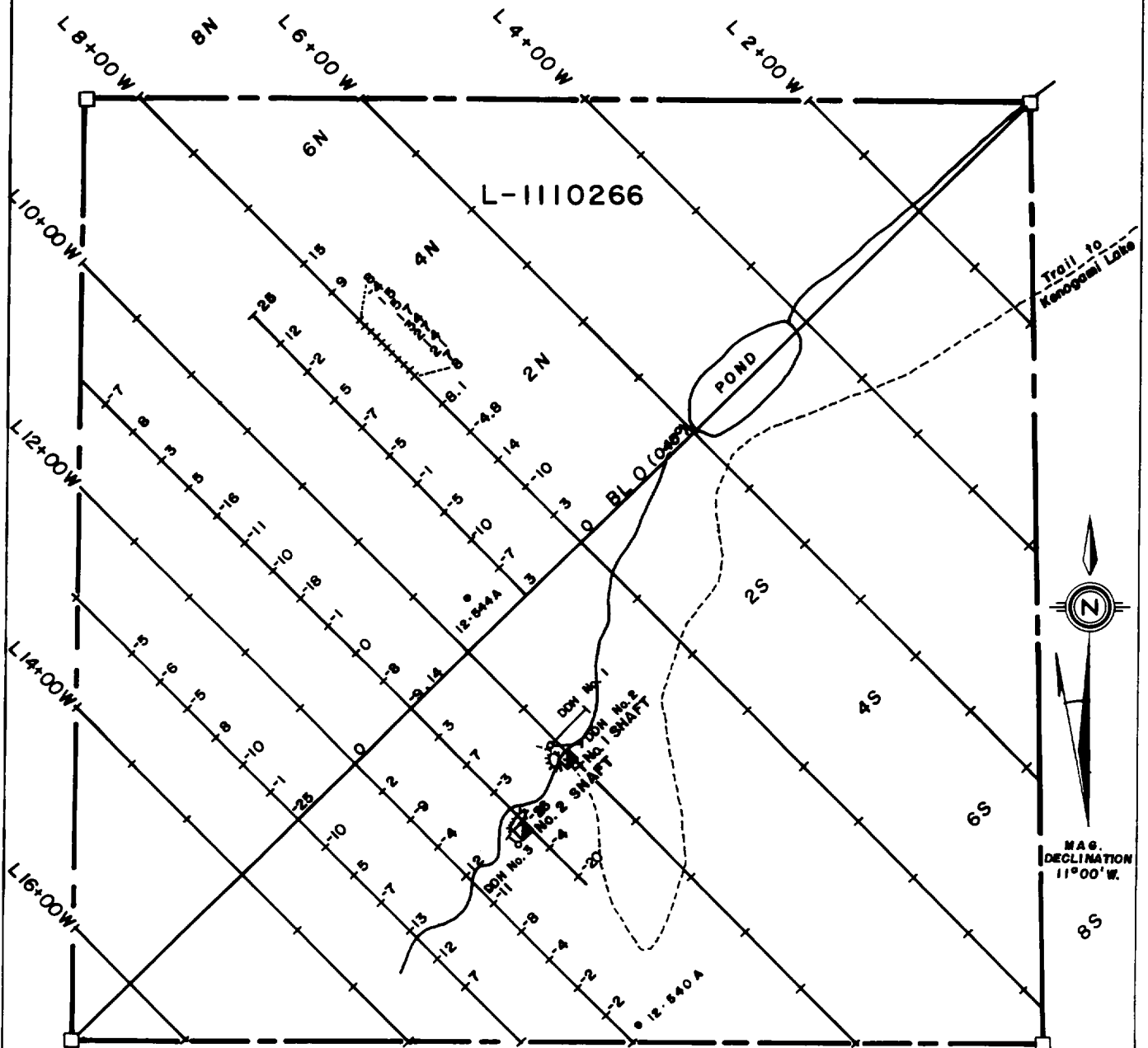

## FEATURES

The MICRONTA<sup>®</sup> LCD Digital Multimeter is a portable 3-2/3 digit, compact-sized multimeter ideally suited for field, lab, shop, bench and home applications. Here is a review of some of the features that qualify your new digital multimeter as real "pro".

- The latest IC and display technology is used to achieve the lowest possible component count. This, in turn, ensures reliability, accuracy, stability and a really rugged, easy-to-handle instrument. Two analog-to-digital converters are used for many special features.
- Conveniently positioned range and function switch knobs for one-hand range/function control.
- Colored indication of the referential ranges to the selected function.
- Effective overload and transient protection on all ranges except DC/AC 10A range.
- Continuity function for quick continuity check — buzzer sounds when circuit resistance is approximately 300 ohms or less.

© Copyright 1988 InterTAN Canada Limited  
All Rights Reserved

Micronta is a registered trademark of Tandy Corporation

2

## SPECIFICATIONS

### Ranges & Accuracy

#### DC VOLTS

300 mV-3-30-300-3000 V  
(Maximum Measurement  
= 1000 Volts)

±0.8% of reading and  
±0.2% of full scale,  
±1 in last digit

#### AC VOLTS

3-30-300-3000 V  
(Maximum Measurement  
= 750 Volts RMS)  
at 50/60 Hz

±1% of reading and  
±0.5% of full scale,  
±1 in last digit

45 Hz to 500 Hz  
at 30 Volt Range

±1.5% of reading and  
±0.5% of full scale,  
±1 in last digit

500 Hz to 10 kHz  
at 30 Volt Range

±10% of reading and  
±0.5% of full scale,  
±1 in last digit

4



# APEX

# MAXIMUM PORTABLE

- Five frequencies: 222, 444, 888, 1777 and 3555 Hz.
- Maximum coupled (horizontal-loop) operation with reference cable.
- Minimum coupled operation with reference cable.
- Vertical-loop operation without reference cable.
- Coil separations: 25, 50, 100, 150, 200 and 250 m (with cable) or 100, 200, 300, 400, 600 and 800 ft.
- Reliable data from depths of up to 180m (600 ft).
- Built-in voice communication circuitry with cable.
- Tilt meters to control coil orientation.



## CERTIFICATE

THIS IS TO CERTIFY:

1. I am a graduate in Prospecting Techniques from the Northern College of Applied Arts and Technology, Haileybury campus, 1976 and have completed the Haileybury School of Mines, Geophysical Field School, 1990, and the Interpretation of Ground and Airborne Geophysical Data Course, 1991. I have been active as a prospector and exploration contractor since 1974.
2. I am a member in good standing of the P.D.A., past president of the N.P.A., and director of O.M.E.F., and C.I.M.M.
3. I reside and hold office at 139 Carter Ave., Kirkland Lake, Ontario, P2N 2A1.
4. I have an interest in the property.
5. My report is based upon having personally participated in each program herein described, a review of published information on the property, consultation with local geologists and upon my familiarity and experience as a prospector in the Kirkland Lake camp.

2714408

*Michael Leaky*  
Dec 91

# DIAMOND DRILL RECORD

Hole No. LL - 2

Sheet No. 1

450

Dip

Property Lady Lou L-1110266  
Location Bompas Township  
L10W + 160S  
core at K-L core library  
Latitude 450  
Departure 900 (E)  
Bearing .....

Total Footage 28'

Elev. Collar .....  
Datum .....  
Date Started 24/09/91  
Date Completed 25/09/91  
Drilled by Richard Plaunt  
Logged by Michael Leahy

Footage		Formation	Sample Number	Sample Footage	Sample Width	Gold Sample	Gold Sludge	Remarks
From	To							
0	4'	Arkose - quartz - carbonate vein - breccia vuggy, white quartz and a few coarse (1.2 cm) blebs of chalcopyrite.						
4	24'	Arkose - feldspathic, medium to fine grained, "ground granite". - less than 1% fine disseminated pyrite.						
24	28'	Arkose - mostly ground and broken core. FOH						

Date of Examination November 18, 1991*Michael Leahy***2.14**

# DIAMOND DRILL RECORD

Hole No. LL - 3 Sheet No. 1

Property Lady Lou L-1110266  
Location Bompas Township  
1150 W + 2S  
Core at K-L cone library

Elev. Collar 450 Dip           

Latitude             
Departure 450  
Bearing 3150

Total Footage 12' - 7/8" E core  
Elev. Collar             
Datum             
Date Started 26/09/91  
Date Completed 26/09/91  
Drilled by Richard Plaunt  
Logged by Michael Leahy

Footage		Formation	Sample Number	Sample Footage	Sample Width	Gold Sample	Gold Sludge	Remarks
From	To							
0	7'	Arkose - pink feldspathic, medium grained, "ground granite" - less than 1% fine disseminated pyrite.						
7	12'	Ground core - caving at 12'. EOH						

Date of Examination November 18, 1991

Michael Leahy

**2.1428**





# Report of Work Conducted After Recording Claim

Mining Act

Transaction Number: 9280-00021

Personal information collected on this form is obtained under the authority of the MI this collection should be directed to the Provincial Manager, Mining Lands, Mini Sudbury, Ontario, P3E 8A5, telephone (705) 870-7284.



42A01NW0043 2.14498 BOMPAS

900

- Instructions:**
- Please type or print and submit in duplicate.
  - Refer to the Mining Act and Regulations for requirements of filing assessment work or consult the Mining Recorder.
  - A separate copy of this form must be completed for each Work Group.
  - Technical reports and maps must accompany this form in duplicate.
  - A sketch, showing the claims the work is assigned to, must accompany this form.

Recorded Holder(s) <b>Michael LEAHY</b>		Client No. <b>158198</b>
Address <b>139 Carter Ave Kirkland Lake Ont</b>		Telephone No. <b>705-567-4696</b>
Mining Division <b>Harder Lake</b>	Township/Area <b>BOMPAS Twp.</b>	M or G Plan No.
Dates Work Performed From: <b>06/06/91</b>		To: <b>03/01/92</b>

**Work Performed (Check One Work Group Only)**

Work Group	Type
<input checked="" type="checkbox"/> Geotechnical Survey	<b>HLEM (MAX-MIN) survey, Self-Potential survey, geological survey</b>
<input type="checkbox"/> Physical Work, including Drilling	
<input type="checkbox"/> Rehabilitation	<b>RECEIVED</b>
<input type="checkbox"/> Other Authorized Work	<b>MAR 11 1992</b>
<input type="checkbox"/> Assays	
<input type="checkbox"/> Assignment from Reserve	<b>MINING LANDS BRANCH</b>

Total Assessment Work Claimed on the Attached Statement of Costs \$ 1231.40 # 1232-Round

**Note:** The Minister may reject for assessment work credit all or part of the assessment work submitted if the recorded holder cannot verify expenditures claimed in the statement of costs within 30 days of a request for verification.

**Persons and Survey Company Who Performed the Work (Give Name and Address of Author of Report)**

Name	Address
<b>Ron Crichton</b>	<b>65 Tweedsmuir Rd Kirkland Lake Ont</b>
<b>S. Carmichael</b>	<b>42 Rand Ave East Kirkland Lake Ont</b>
<b>B. Madill</b>	<b>7 Hudson Bay Ave Kirkland Lake Ont</b>
<b>M. Leahy &amp; A. Black</b>	<b>139 Carter Ave Kirkland Lake Ont P2N2A1</b>

(attach a schedule if necessary)

**Certification of Beneficial Interest \* See Note No. 1 on reverse side**

I certify that at the time the work was performed, the claims covered in this work report were recorded in the current holder's name or held under a beneficial interest by the current recorded holder.	Date <b>Jan 9/92</b>	Recorded Holder or Agent (Signature) <b>Michael Leahy</b>
--	-------------------------	--

**Certification of Work Report**

I certify that I have a personal knowledge of the facts set forth in this Work report, having performed the work or witnessed same during and/or after its completion and annexed report is true.		
Name and Address of Person Certifying <b>M. LEAHY 139 Carter Ave. Kirkland Lake Ont P2N2A1</b>		
Telephone No. <b>705-567-4696</b>	Date <b>Jan 9/92</b>	Certified By (Signature) <b>Michael Leahy</b>

**For Office Use Only**

Total Value Cr. Recorded <b>Applied \$1040</b>	Date Recorded <b>January 10, 1992</b>	Mining Recorder 	Received Stamp <b>JAN 10 PM 2:20</b>
<b>Banked \$192</b>	Deemed Approval Date <b>April 9/92</b>	Date Approved	
Date Notice for Amendments Sent			





Ministry of  
Northern Development  
and Mines

Ministère du  
Développement du Nord  
et des mines

**Statement of Costs  
for Assessment Credit**

**État des coûts aux fins  
du crédit d'évaluation**

**Mining Act/Loi sur les mines**

Transaction No./N° de transaction

Personal information collected on this form is obtained under the authority of the Mining Act. This information will be used to maintain a record and ongoing status of the mining claim(s). Questions about this collection should be directed to the Provincial Manager, Minings Lands, Ministry of Northern Development and Mines, 4th Floor, 159 Cedar Street, Sudbury, Ontario P3E 6A5. telephone (705) 670-7264.

Les renseignements personnels contenus dans la présente formule sont recueillis en vertu de la Loi sur les mines et serviront à tenir à jour un registre des concessions minières. Adresser toute question sur la collecte de ces renseignements au chef provincial des terrains miniers, ministère du Développement du Nord et des Mines, 159, rue Cedar, 4<sup>e</sup> étage, Sudbury (Ontario) P3E 6A5, téléphone (705) 670-7264.

**1. Direct Costs/Coûts directs**

Type	Description	Amount Montant	Totals Total global
Wages Salaires	Labour Main-d'oeuvre	600-	
	Field Supervision Supervision sur le terrain		600-
Contractor's and Consultant's Fees Droits de l'entrepreneur et de l'expert- conseil	Type linecutting	250-	
	drafting	156.40	
			406.40
Supplies Used Fournitures utilisées	Type		
Equipment Rental Location de matériel	Type MAX MIN	120	
			120
<b>Total Direct Costs Total des coûts directs</b>			<b>1126.40</b>

**2. Indirect Costs/Coûts indirects**

\*\* Note: When claiming Rehabilitation work Indirect costs are not allowable as assessment work.  
Pour le remboursement des travaux de réhabilitation, les coûts indirects ne sont pas admissibles en tant que travaux d'évaluation.

Type	Description	Amount Montant	Totals Total global
Transportation Transport	Type Truck	105-	
			105-
Food and Lodging Nourriture et hébergement			
Mobilization and Demobilization Mobilisation et démobilisation			
<b>Sub Total of Indirect Costs Total partiel des coûts indirects</b>			<b>105-</b>
<b>Amount Allowable (not greater than 20% of Direct Costs) Montant admissible (n'excedant pas 20 % des coûts directs)</b>			
<b>Total Value of Assessment Credit (Total of Direct and Allowable indirect costs)</b>			<b>1231.40</b>
<b>Valeur totale du crédit d'évaluation (Total des coûts directs et indirects admissibles)</b>			

Note: The recorded holder will be required to verify expenditures claimed in this statement of costs within 30 days of a request for verification. If verification is not made, the Minister may reject for assessment work all or part of the assessment work submitted.

Note : Le titulaire enregistré sera tenu de vérifier les dépenses demandées dans le présent état des coûts dans les 30 jours suivant une demande à cet effet. Si la vérification n'est pas effectuée, le ministre peut rejeter tout ou une partie des travaux d'évaluation présentés.

**Filing Discounts**

1. Work filed within two years of completion is claimed at 100% of the above Total Value of Assessment Credit.
2. Work filed three, four or five years after completion is claimed at 50% of the above Total Value of Assessment Credit. See calculations below:

Total Value of Assessment Credit	Total Assessment Claimed
	× 0.50 =

**Remises pour dépôt**

1. Les travaux déposés dans les deux ans suivant leur achèvement sont remboursés à 100 % de la valeur totale susmentionnée du crédit d'évaluation.
2. Les travaux déposés trois, quatre ou cinq ans après leur achèvement sont remboursés à 50 % de la valeur totale du crédit d'évaluation susmentionné. Voir les calculs ci-dessous.

Valeur totale du crédit d'évaluation	Évaluation totale demandée
	× 0,50 =

**Certification Verifying Statement of Costs**

I hereby certify:  
that the amounts shown are as accurate as possible and these costs were incurred while conducting assessment work on the lands shown on the accompanying Report of Work form.

that as Recorded Holder I am authorized  
(Recorded Holder, Agent, Position in Company)

to make this certification

**Attestation de l'état des coûts**

J'atteste par la présente :  
que les montants indiqués sont le plus exact possible et que ces dépenses ont été engagées pour effectuer les travaux d'évaluation sur les terrains indiqués dans la formule de rapport de travail ci-joint.

Et qu'à titre de \_\_\_\_\_ je suis autorisé  
(titulaire enregistré, représentant, poste occupé dans la compagnie)

à faire cette attestation.

Signature <u>Michael Leaky</u>	Date <u>Jan 9/92</u>
-----------------------------------	-------------------------

Note : Dans cette formule, lorsqu'il désigne des personnes, le masculin est utilisé au sens neutre.





Ministry of  
Northern Development  
and Mines

Ministère du  
Développement du Nord  
et des Mines

Mining Lands Branch  
Geoscience Approvals Section  
159 Cedar Street  
4th Floor  
SUDBURY, Ontario  
P3E 6A5

Toll Free: 1-800-465-3880  
Telephone: (705) 670-7264  
Fax: (705) 670-7262

March 20, 1992

Our File: 2.14498  
Your File: W. 9280.00021

Mining Recorder  
Ministry of Northern Development  
and Mines  
4 Government Road East  
Kirkland Lake, Ontario  
P2N 1A2

Dear Sir:

**SUBJECT: APPROVAL OF ASSESSMENT WORK SUBMITTED ON MINING CLAIM  
L 1110266, BOMPAS TWP..**

The assessment work credits for the Geological and Geophysical Surveys, under Sections 12 and 14 respectively of the Mining Act Regulations submitted on the above Report of Work has been approved as of March 17, 1992.

Please indicate this on your records.

Yours sincerely,

A handwritten signature in cursive script, appearing to read "Ron C. Gashinski".

Ron C. Gashinski  
Senior Manager, Mining Lands Branch  
Mines and Minerals Division

DT/jl  
Enclosures:

cc: Assessment Files Office  
Toronto, Ontario

Resident Geologist  
Kirkland Lake, Ontario

G-3602

AREAS WITHDRAWN FROM DISPOSITION

M.R.O. - MINING RIGHTS ONLY  
S.R.O. - SURFACE RIGHTS ONLY  
M.+S. - MINING AND SURFACE RIGHTS

Description	Order No.	Date	Disposition	File
SEC 36/60	WB/88	24/01/88	M+S	

TOWNSHIP SUBJECT  
FORESTRY OPERATIONS

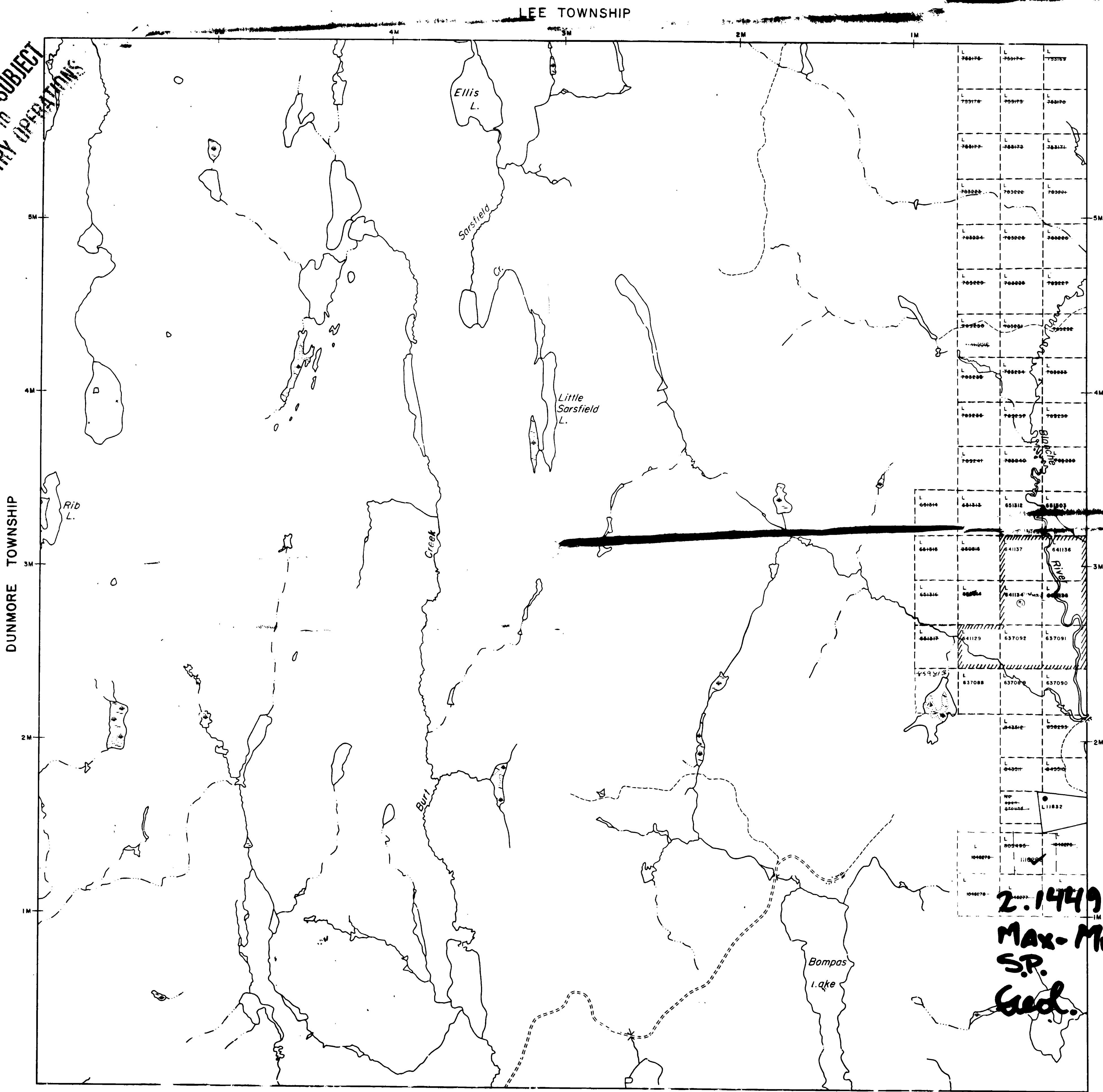

**LEGEND**

HIGHWAY AND ROUTE No.	
OTHER ROADS	
TRAILS	
SURVEYED LINES	
TOWNSHIPS, BASE LINES, ETC.	
LOTS, MINING CLAIMS, PARCELS, ETC.	
UNSURVEYED LINES	
LOT LINES	
PARCEL BOUNDARY	
MINING CLAIMS ETC.	
RAILWAY AND RIGHT OF WAY	
UTILITY LINES	
NON PERENNIAL STREAM	
FLOODING OR FLOODING RIGHTS	
SUBDIVISION OR COMPOSITE PLAN	
RESERVATIONS	
ORIGINAL SHORELINE	
MARSH OR MUSKIEG	
MINES	
TRAVERSE MONUMENT	

**DISPOSITION OF CROWN LANDS**

TYPE OF DOCUMENT	SYMBOL
PATENT, SURFACE & MINING RIGHTS	
" SURFACE RIGHTS ONLY	
" MINING RIGHTS ONLY	
LEASE, SURFACE & MINING RIGHTS	
" SURFACE RIGHTS ONLY	
" MINING RIGHTS ONLY	
LICENCE OF OCCUPATION	
ORDER IN COUNCIL	
RESERVATION	
CANCELLED	
SAND & GRAVEL	

NOTE: MINING RIGHTS IN PARCELS PATENTED PRIOR TO MAY 6 1913 VESTED IN ORIGINAL PATENTEE BY THE PUBLIC LANDS ACT, R.S.O. 1910, CHAP. 380, SEC. 63, SUBSEC. 1.

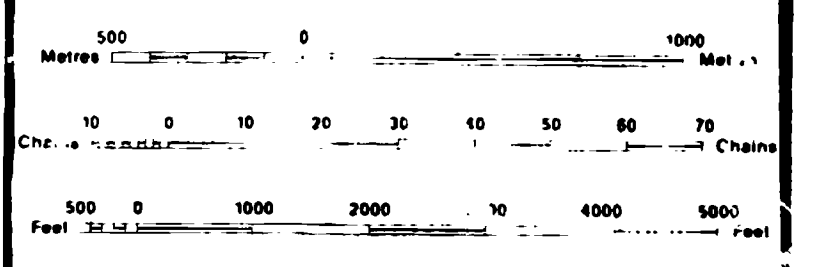

DATE OF ISSUE  
**WAR 10 1992**  
 LARDER LAKE  
 MINING RECORDER'S OFFICE

THE INFORMATION THAT APPEARS ON THIS MAP HAS BEEN COMPILED FROM VARIOUS SOURCES AND ACCURACY IS NOT GUARANTEED. THOSE WISHING TO STAKE MINING CLAIMS SHOULD CONSULT WITH THE MINING RECORDER, MINISTRY OF NORTHERN DEVELOPMENT AND MINES, FOR ADDITIONAL INFORMATION ON THE STATUS OF THE LANDS SHOWN HEREON.

NOTICE OF FORESTRY ACTIVITY  
 THIS TOWNSHIP AREA FALLS WITHIN THE  
 PLONSKI FOREST MANAGEMENT UNIT  
 AND MAY BE SUBJECT TO FORESTRY ACTIVITY OPERATIONS.  
 THE MNR UNIT FORESTER FOR THIS AREA CAN BE  
 CONTACTED AT:  
 P.O. BOX 129  
 SHASTIKA, ONTARIO  
 POK 1T0  
 705-642-3222

**2.14498**  
**Max-Min II**  
**S.P.**  
**Geol.**

TOWNSHIP **2.14498**  
**BOMPAS**  
 M.N.R. ADMINISTRATIVE DISTRICT  
**KIRKLAND LAKE**  
 MINING DIVISION  
**LARDER LAKE**  
 LAND TITLES / REGISTRY DIVISION  
**TIMISKAMING**

Ministry of Natural Resources Ontario  
 Ministry of Northern Development and Mines  
 G-3605  
 Date: AUGUST, 1988  
 Number: 7005



LEGEND

- Claim Post
- - - Claim Line
- · - · - Trail
- Outcrop Boundary
- ⊠ Pit
- Shaft
- qv Quartz Vein
- py Pyrite
- cp Chalcopyrite
- gal Galena
- 1 Arkose

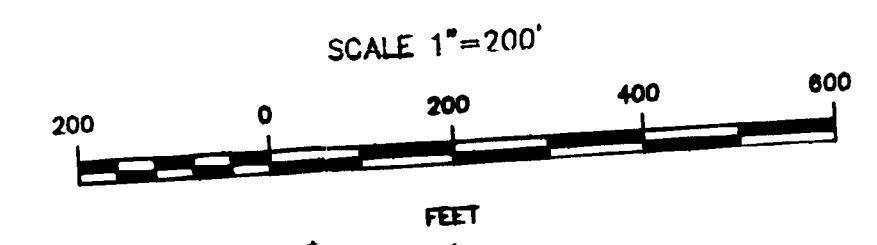

2.14498  
**LADY LOU PROPERTY**  
 SURFACE GEOLOGY  
 BOMPAS TOWNSHIP  
 DISTRICT OF TIMISKAMING  
 LARDER LAKE MINING DIVISION

Date: October, 1991  
 Scale: 1"=200 Ft.  
 NTS 42 A/SE  
 Data by: M. Leahy  
 Revised: Drawing No. 1  
 Project No. OP81-172

*Michael Leahy*

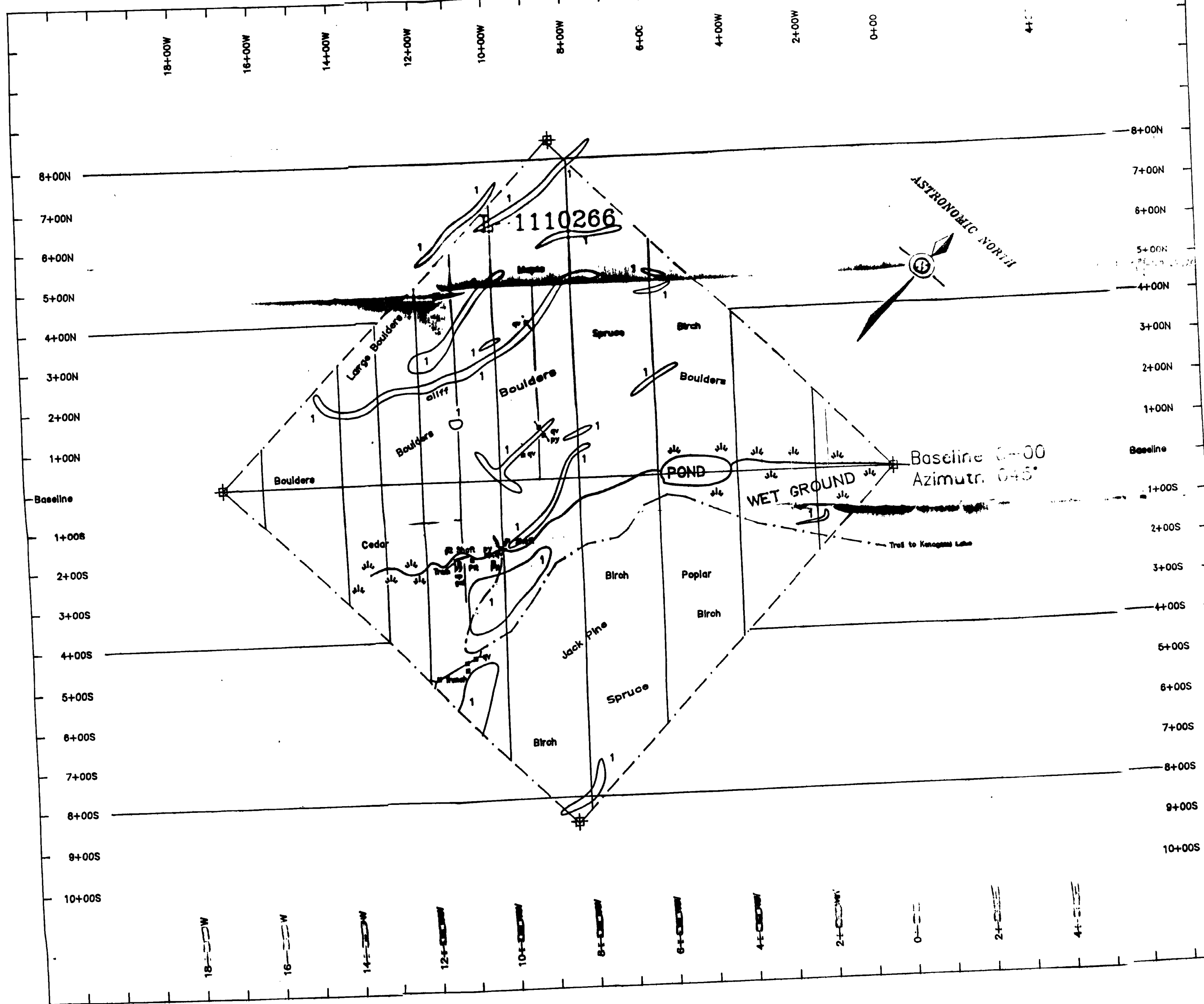

18+00W 16+00W 14+00W 12+00W 10+00W 8+00W 6+00W 4+00W 2+00W 0+00 2+00E 4+00E

# LEGEND

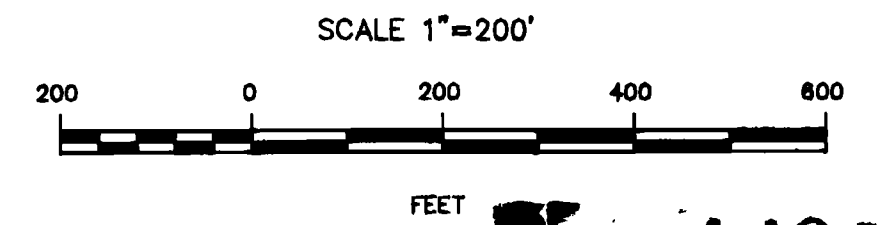
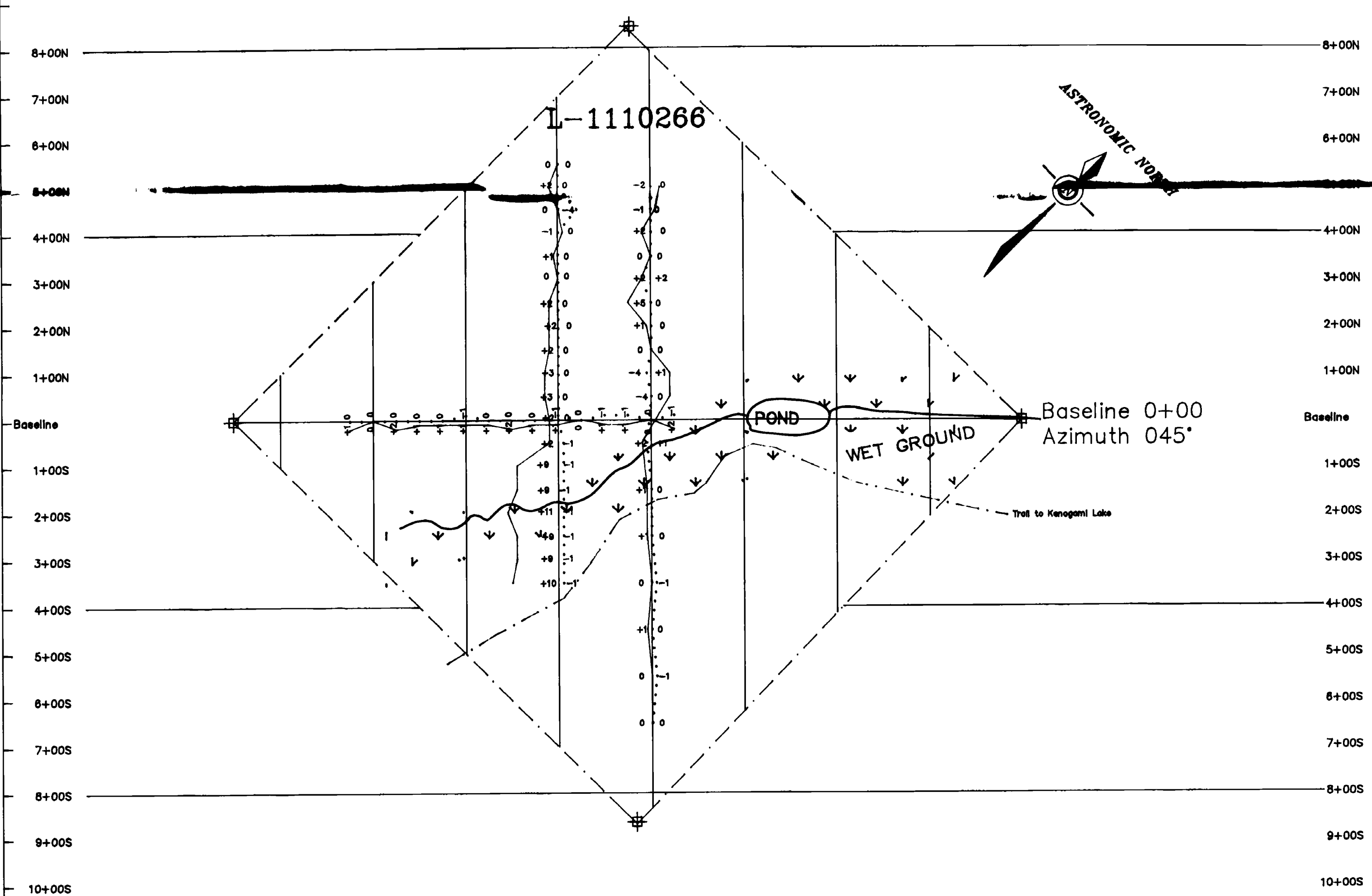
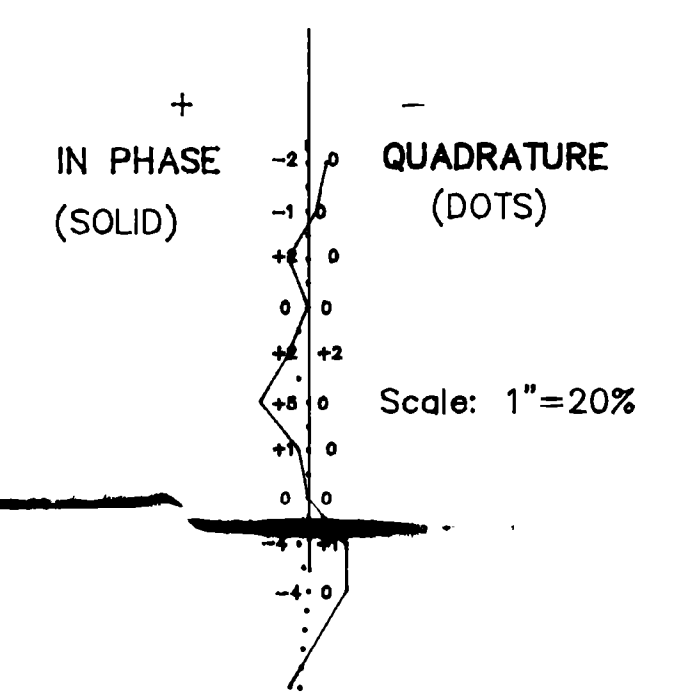

2.14408

## LADY LOU PROPERTY

MAX-MIN II SURVEY  
444 Hz.

BOMPAS TOWNSHIP  
DISTRICT OF TIMISKAMING  
LARDER LAKE MINING DIVISION

Date: October, 1991	Scale: 1"=200 Ft.	Revised: Drawing No. 3
NTS 42 A/SE	Date by: T. Obradovich	Project No. OP91-172

*Michael Leas*



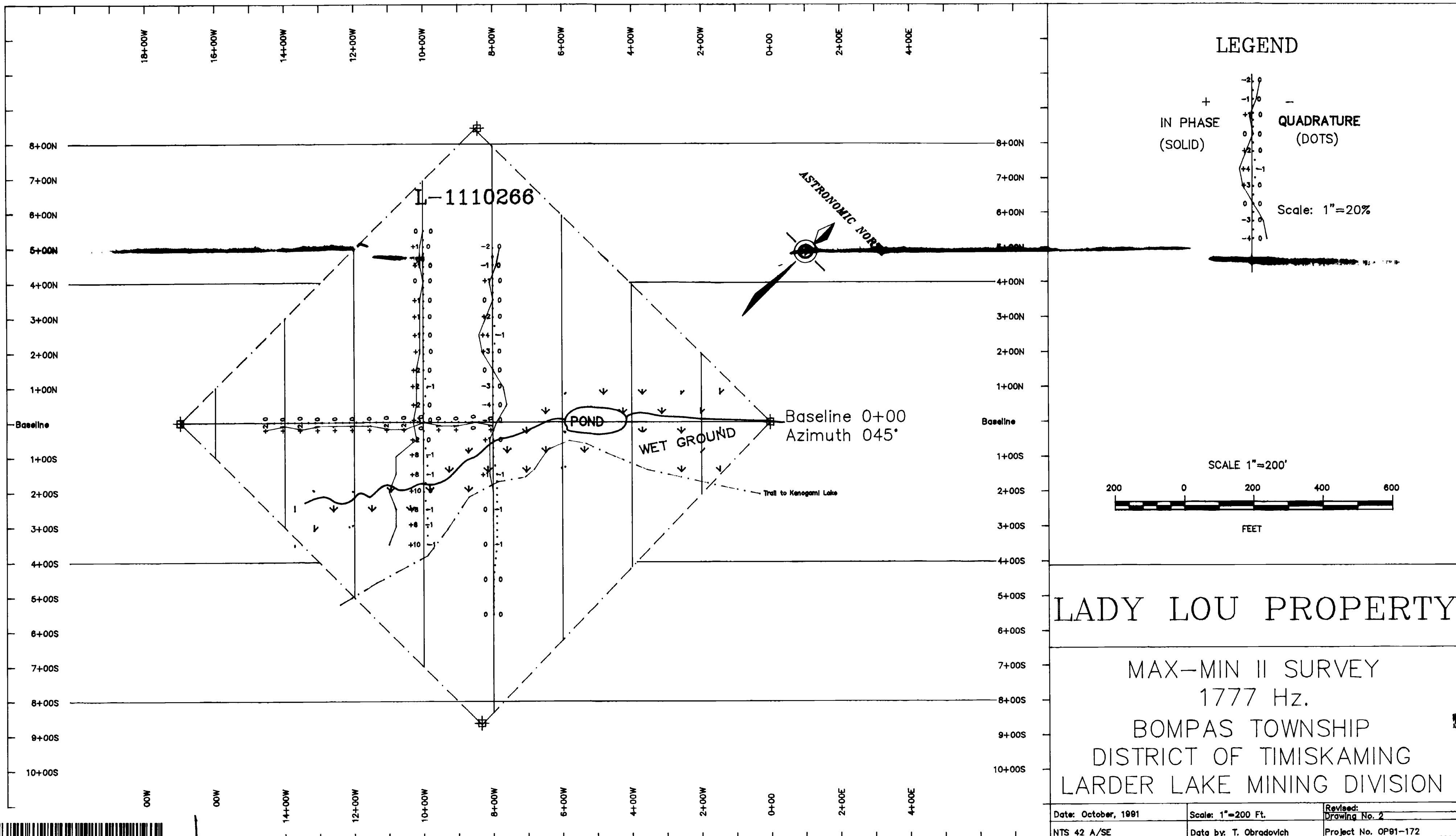

LADY LOU PROPERTY

MAX-MIN II SURVEY  
1777 Hz.

BOMPAS TOWNSHIP  
DISTRICT OF TIMISKAMING  
LARDER LAKE MINING DIVISION

Date: October, 1991	Scale: 1"=200 Ft.	Revised: Drawing No. 2
NTS 42 A/SE	Date by: T. Obradovich	Project No. OP91-172

*Michael Lesky*