



Claim No. L-803495

Bompas Township

Location

Claim L-803495 is located in the South East corner of Bompas Township approximately one half mile south west of the north end of Kenogami Lake.

History

No record of ground geophysical work in this area could be found.

Geophysics paper 289G (Rev.) 1970 gives airborne magnetics from flight lines flown at an altitude of 500 feet above ground level. Total field magnetics vary from 760 gammas at the south east corner of the claim to 880 gammas at the north west corner.

Ontario Geological Survey, preliminary map P2262A Grenfell Township extends into the south east corner of Bompas Township and covers this area. Flight lines 43951S and 43943N cross claim L-803495. This is a total intensity magnetic survey flown at 400 feet altitude. The magnetic contours vary from 59,440 gammas at the south east corner of the claim to 59,590 at the north west corner. The contour pattern is similar to that on geophysics paper 289G (Rev.).

A ground magnetometer survey was conducted on June 9th and 22nd 1986 using a Scentrex Magnetometer Model MF-1, serial no. 908479.

This magnetometer has 5 scales covering 0 to 1000 gammas, 0 - 3000, 0 - 10,000, 0 - 30,000 and 0 - 100,000 gammas. It was found that the 0 to 3000 gamma scale was most suitable for this area.

Readings were taken along all picket lines and boundary lines at 50 foot intervals. A total of 315 readings were taken.

For the most part the readings fall between 2000 and 3000 gammas. One anomalous low reading of 1100 gammas was encountered on line 0 + 40 at 100 west. Readings of 3200 and 3000 gammas were encountered on line 1 + 00 at 150 and 200 west respectively. This is in the area of the old workings and dumps and scrap metal in the area is suspected as the reason for the higher than normal readings.

No coherent pattern is observed from the magnetometer map. Trends, lineaments, etc. are totally absent.

No significant magnetic anomalies appear to be present on this claim.

LKO:nem

**RECEIVED**

AUG 5 1986

MINING LANDS SECTION

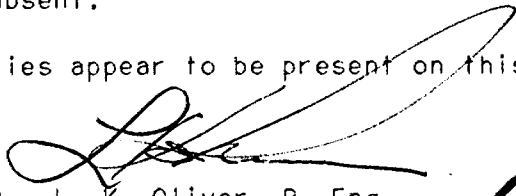
  
L. K. Oliver, P. Eng.,  
Kirkland Lake, Ont.,  
June 25, 1986.



CLAIM L-803495

BOMPAS TOWNSHIP

May 10    May 24    May 31    June 9    June 22

Line Cutting & Chaining  
(Hours)

Arden Stewart	6	6	6	6	8	32
Robert Dans	6	6	6	6	8	32
L. K. Oliver	6	6		6		18
S. L. Oliver (mag Ass't)			6			<u>6</u>
						<u>88</u>

$88 \div 8 = 11$  days

Magnetometer Survey

L. K. Oliver			6		8	14
--------------	--	--	---	--	---	----

Research, Report & Drafting

L. K. Oliver			18 hours total			<u>18</u>
--------------	--	--	----------------	--	--	-----------

32

$32 \div 8 = 4 \times 7 = 28$  days

Total  $11 + 28 = 39$  days

PERSONAL

1) L. K. Oliver, P. Eng.  
65 Federal St.,  
Kirkland Lake, Ont.  
P2N 1G1.

Mr. Oliver graduated from the Haileybury School of Mines in 1952 and subsequently worked in various positions in exploration, development and operations. He joined the Adams Mine in 1962, obtained his Professional Engineer status in 1970 and is presently Mining Engineer, a position he has held for over 20 years.

(705) 567-7074

2) Arden Stewart  
22 O'Meara Ave  
Kirkland Lake, Ont.  
P2N 2T6

Prospector

(705) 567-6659

3) Robert Dans  
79 Queen Street  
Kirkland Lake, Ont.  
P2N 2R5.

Prospector

(705) 567-7558

4) S. L. Oliver  
65 Federal St.,  
Kirkland Lake, Ont.,  
P2N 1G1

Student

(705) 567-7074

15 1986

PLAN OF  
**BOMPAS TWP.**  
 LARDER LAKE MINING DIVISION.  
 DISTRICT OF TIMISKAMING

— Scale, 40 chains to an inch —

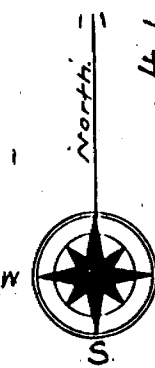

DUNMORE TWP.

G. RENFELL TWP.

LEE TWP.

BURT TWP.

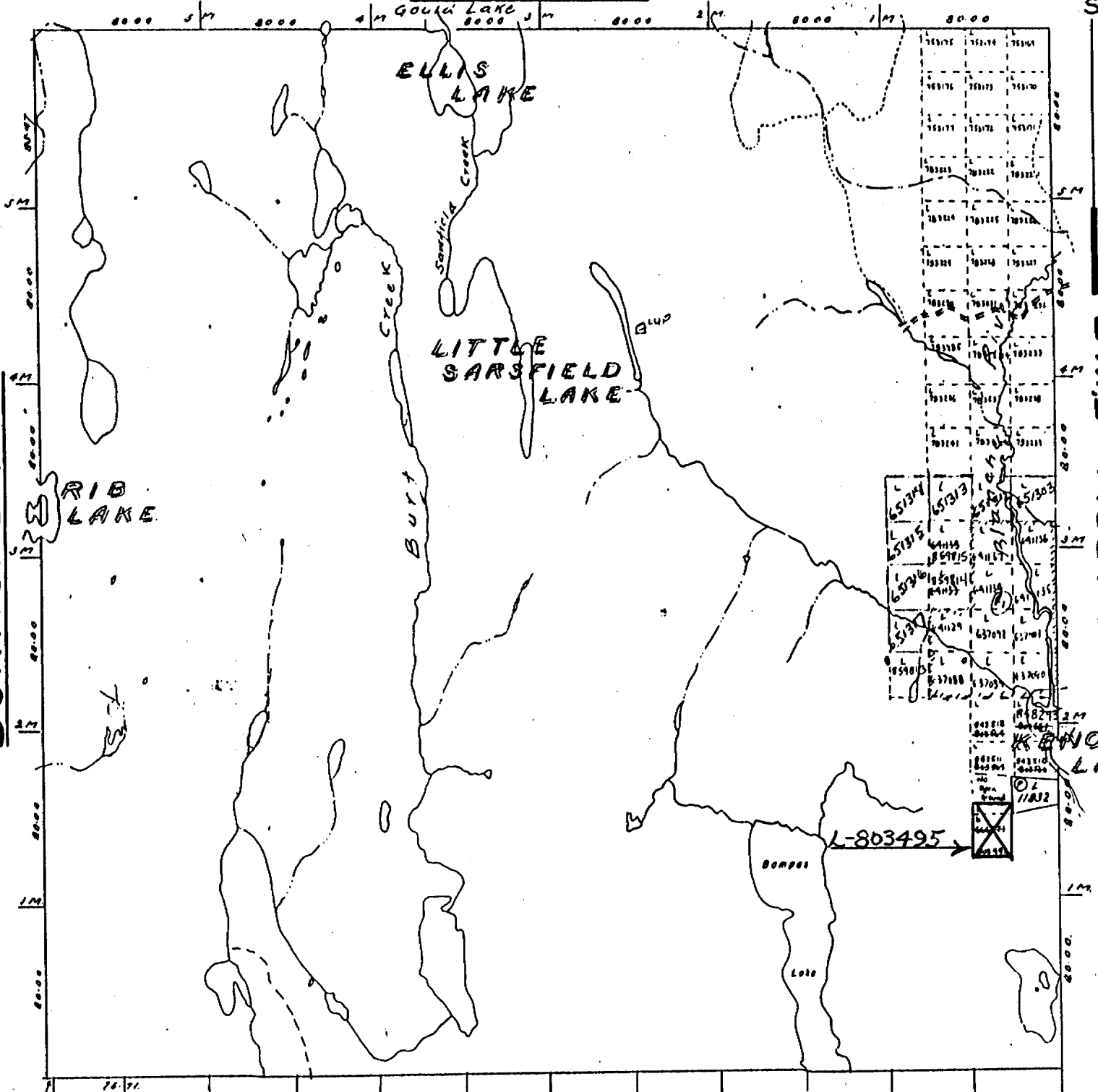

Notes

- Railways shown .....
- Paved Highways .....
- Gravel .....
- Highway Route No. ....

- Non-perennial streams .....
- Bridges .....
- Buildings .....
- Swamp .....

CROWN LAND SALE  
 LOCATED LAND  
 MINING RIGHTS ONLY  
 SURFACE RIGHTS ONLY



Ministry of Natural Resources  
Ontario

Report of Work  
(Geophysical, Geological, Geochemical and Expenditures)

8608242 The Mini

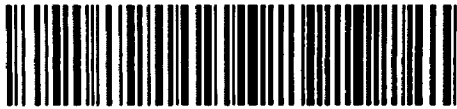

42A01NW0050 2.9305 BOMPAS

900

Type of Survey(s): **MAGNETOMETER** Township or Area: **BOMPAS**  
 Claim Holder(s): **A STEWART KIRKLAND LAKE ONT** Prospector's Licence No.: **K-16711**  
 Survey Company: **22 O'MEARA BLVD** Survey Dates (linecutting to office): **10 5 86 24 6 86** Total Miles of line Cut: **2.04**  
 Name and Address of Author (of Geo-Technical report): **L.K. OLIVER 65 FEDERAL ST. KIRKLAND LAKE**

Special Provisions Credits Requested

Instructions	Geophysical	Days per Claim
For first survey: Enter 40 days. (This includes line cutting)	- Electromagnetic	
	- Magnetometer	
For each additional survey: using the same grid: Enter 20 days (for each)	- Radiometric	
	- Other	
	Geological	
	Geochemical	

Mining Claims Traversed (List in numerical sequence) **P2N1G1**

Mining Claim		Expend. Days Cr.	Mining Claim		Expend. Days Cr.
Prefix	Number		Prefix	Number	
L	803495				

Man Days

Instructions	Geophysical	Days per Claim
Complete reverse side and enter total(s) here	- Electromagnetic	
	- Magnetometer	<b>39</b>
	- Radiometric	
	- Other	
	Geological	
	Geochemical	

Airborne Credits

Note: Special provisions credits do not apply to Airborne Surveys.	Days per Claim
Electromagnetic	
Magnetometer	
Radiometric	

Expenditures (excludes power stripping)

Type of Work Performed: ~~MAGNETOMETER SURVEY~~

Performed on Claim(s): ~~803495~~ **P2N1G1**

Calculation of Expenditure Days Credits

Total Expenditures \$  ÷ 15 = Total Days Credits

Instructions: Total Days Credits may be apportioned at the claim holder's choice. Enter number of days credits per claim selected in columns at right.

Report Completed

Date of Report: **25 06 86**

Recorded By or Agent (Signature): *[Signature]*

For Office Use Only

Total Days Cr. Recorded: **39**

Date Recorded: **June 26/86**

Date Approved as Recorded: **76.9.19**

Mining Recorder: *[Signature]*

Regional/Branch Director: *[Signature]*

Certification Verifying Report of Work **AGENT**

I hereby certify that I have a personal and intimate knowledge of the facts set forth in the Report of Work annexed hereto, having performed the work or witnessed same during and/or after its completion and the annexed report is true.

Name and Postal Address of Person Certifying: **L.K. OLIVER 65 FEDERAL ST. KIRKLAND LAKE ONTARIO P2N1G1**

Date Certified: **JUNE 26/86**

Certified by (Signature): *[Signature]*

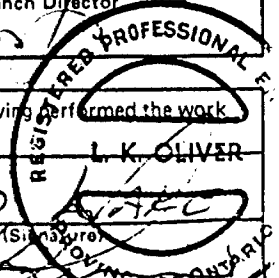
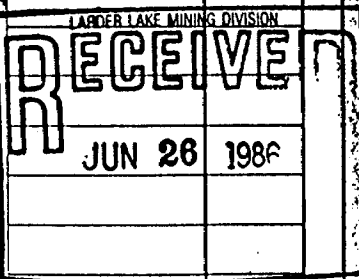

AREAS WITHDRAWN FROM DISPOSITION

Description	Order No.	Date	Disposition	File
M.R.O. - MINING RIGHTS ONLY				
S.R.O. - SURFACE RIGHTS ONLY				
M.+S. - MINING AND SURFACE RIGHTS				
SEC 36/80	W9/86	24/01/86	M+S	

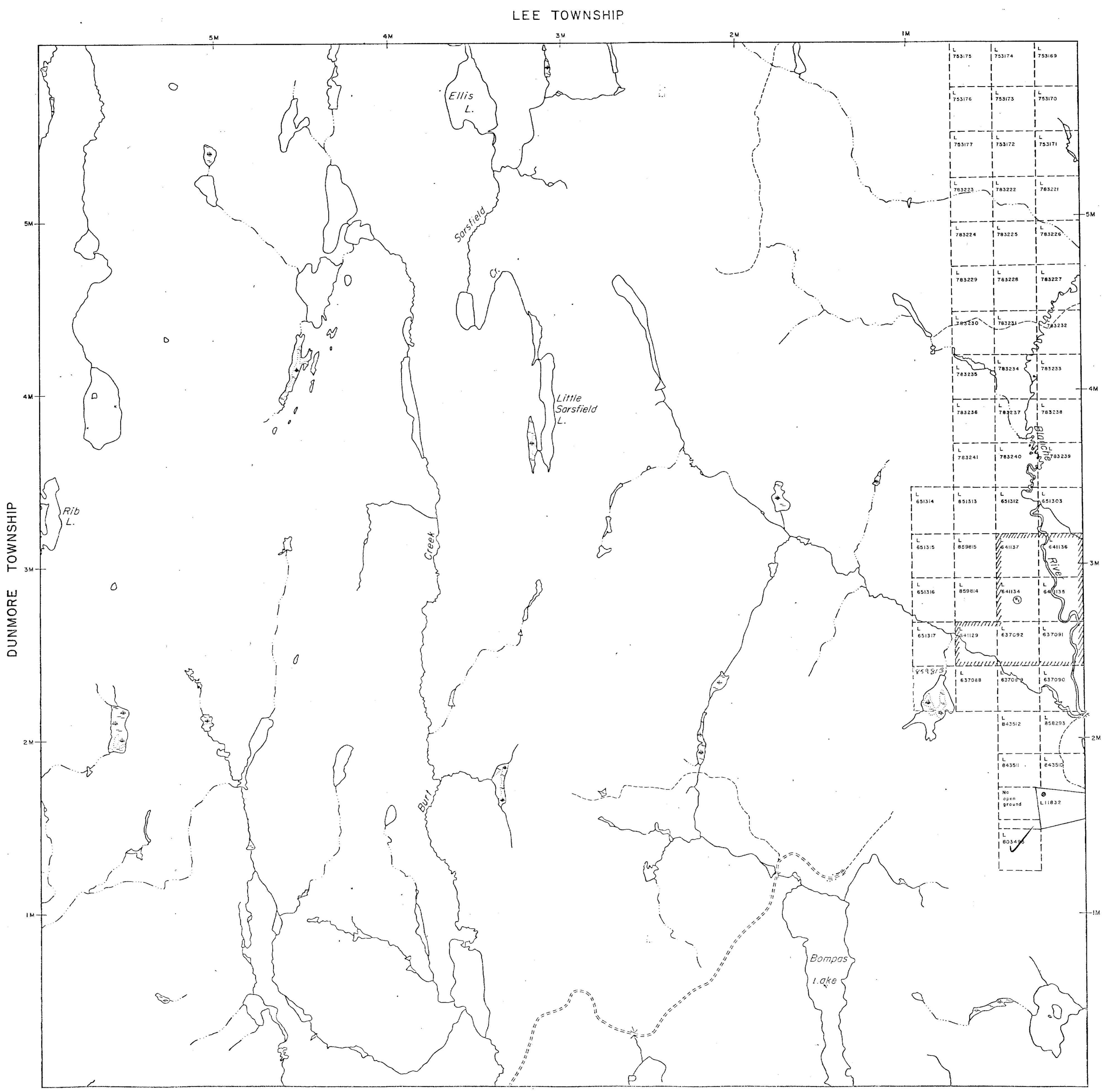

LEGEND

- HIGHWAY AND ROUTE No
- OTHER ROADS
- TRAILS
- SURVEYED LINES
- TOWNSHIPS, BASE LINES, ETC
- LOTS, MINING CLAIMS, PARCELS, ETC
- UNSURVEYED LINES
- LOT LINES
- PARCEL BOUNDARY
- MINING CLAIMS ETC
- RAILWAY AND RIGHT OF WAY
- UTILITY LINES
- NON PERENNIAL STREAM
- FLOODING OR FLOODING RIGHTS
- SUBDIVISION OR COMPOSITE PLAN
- RESERVATIONS
- ORIGINAL SHORELINE
- MARSH OR MUSKEG
- MINES
- TRAVERSE MONUMENT

DISPOSITION OF CROWN LANDS

TYPE OF DOCUMENT	SYMBOL
PATENT, SURFACE & MINING RIGHTS	●
" SURFACE RIGHTS ONLY	○
" MINING RIGHTS ONLY	○
LEASE, SURFACE & MINING RIGHTS	■
" SURFACE RIGHTS ONLY	■
" MINING RIGHTS ONLY	■
LICENCE OF OCCUPATION	▼
ORDER-IN-COUNCIL	○
RESERVATION	○
CANCELLED	○
SAND & GRAVEL	○

NOTE: MINING RIGHTS IN PARCELS PATENTED PRIOR TO MAY 6, 1913, VESTED IN ORIGINAL PATENTEE BY THE PUBLIC LANDS ACT, R.S.O. 1970, CHAP. 380, SEC. 63, SUBSEC. 1.

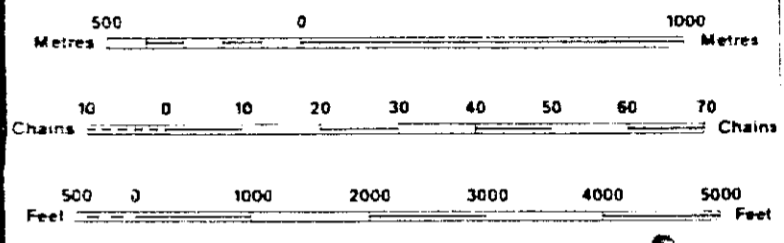

SCALE 1:20 000

BOM 1692

TOWNSHIP  
**BOMPAS**

M.N.R. ADMINISTRATIVE DISTRICT  
**KIRKLAND LAKE**  
MINING DIVISION SEP 17 1986  
**LARDER LAKE**  
LAND TITLES / REGISTRY DIVISION  
**TIMISKAMING**

Ministry of Natural Resources Ontario  
Ministry of Northern Development and Mines

Date: AUGUST, 1985  
Number: **G-3605**

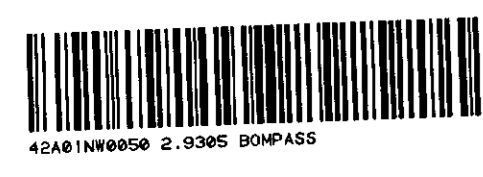

# MAGNETOMETER SURVEY

L-803495

BOMPAS TWP

2.9305

SCALE 1" = 100'

