

DIAMOND DRILL RECORD



42A01SE0170 2.13686 EBY

010

Company:	Fern Rivard	Hole No.	E-90-2
Location:	Eby Township	Date Started:	June 30, 1990
Level:	Surface	Page No.	1
Bearing:	322 degrees	Date Finished:	August 2, 1990
Inclination:	-50 degrees	Core Size:	EX
		Logged:	S. Carnichael
		Test-Acid:	Discarded:
		Core Saved?	Yes
		Discarded:	Discarded:
		Casing:	Left
		Elevation:	N/A
		At:	
		Clair No.:	L-738546
		At:	
		Dep:	213m W #2 Post
		At:	
Total Depth:	512.5 feet		
Coords Collar - Lat:	118m North of #2 Post		
Drilled by:	F. Rivard	Date Logged:	October 6, 1990

FOOTAGE From - To	GEOLOGICAL & PHYSICAL DESCRIPTION	SAMPLE NUMBER	FROM - TO	AU PPB	AU GRAMS/TON	AU OZ/TON	LENGTH
0.0-6.0 feet	Casing						
6.0-66.0 feet	Tuff						
	Buff grey-green intermediate tuffaceous volcanics. Locally interbedded with carbonaceous chert. Minor sulfide mineralization in chert sections.						
	12.0-18.5' - carbonaceous chert	1241	23.1-27.0 feet	21.0			3.9 ft.
	23.1-27.0' - grey chert, 2% pyrite in bands. Banding at 54 deg. to C.A.	1242	49.0-53.0 feet	7.0			4.0 ft.
	46.4-52.6' - black carbonaceous chert						
66.0-112.0 feet	Sandstone/Wacke						
	Buff green well foliated sandstone. Clasts of quartz and feldspar up to 1mm in size. Foliation at 96.0' at 44 deg. to C.A.						
112.0-125.2 feet	Siltstone						
	Very fine grained dark grey to black laminated siltstone. Locally carbonaceous.						
125.2-142.0 feet	Sandstone/Wacke						
	Continuation of unit from 66.0-112.0'.						
142.0-170.5 feet	Chert						
	Buff green to grey cherty sediment. Moderately laminated with trace to 2% pyrite in local concentrations.						
	142.0-147.0' - 4% pyrite.	1243	142.0-147.0 feet	Nil			5.0 ft.
	147.0-152.0' - 25% core recovery						
	152.0-165.0' - intercalated wacke and						

	chert.					
170.5-287.0 feet	Graphitic Sediment Intercalated dark gray/black graphitic sediment and dull green cherty siltstone. 2-4% pyrite throughout with local concentrations up to 10%. Section averages 75% core recovery.					
	180.0-185.0' - buff carbonate clasts in graphitic siltstone to 181.0'.	1244	180.0-185.0 feet	3.0		5.0 ft.
	185.0-190.0' - 4% pyrite	1245	185.0-190.0 feet	5.0		5.0 ft.
	190.0-195.0' - 5-8% pyrite	1246	190.0-195.0 feet	17.0		5.0 ft.
	195.0-200.0' - graphitic with 10% py. from 195.0-196.0'. 50% core recovery.	1247	195.0-200.0 feet	Nil		5.0 ft.
	246.0-251.0' - buff chert with 10% py.	1248	246.0-251.0 feet	Nil		5.0 ft.
	251.0-256.0' - brecciated chert/sandstone. 5% pyrite with 70% recovery.	1249	251.0-256.0 feet	Nil		5.0 ft.
	273.5-280.0' - grey chert, 4% pyrite.	1250	273.5-280.0 feet	Nil		6.5 ft.
287.0-339.5 feet	Siltstone Light green-colored fine grained laminated siltstone. Locally intercalated with dark carbonaceous sections.					
239.5-351.0 feet	Iron Formation Dark grey fine grained magnetic siltstone. Moderately to highly magnetic with magnetite + pyrrhotite. Unit is not banded.					
351.0-389.0 feet	Siltstone Continuation of unit above iron formation.					
389.0-512.5 feet	Carbonaceous Mudstone Intercalated grey chert and black mudstone. Minor quartz stringers throughout.					
	397.0-402.0' - graphitic mudstone, 2% pyrite.	121599	397.0-402.0 feet	10.0		5.0 ft.
	453.0' - foliation at 48 deg. to C.A.					
	464.0-469.0' - 10% disseminated py.	121600	464.0-469.0 feet	Nil		5.0 ft.
512.5 feet	End of Hole					

Sludge Assays (Au PPB)

10.0-20.0 ft.	10	370.0-380.0 ft.	Nil
20.0-30.0 ft.	5	380.0-390.0 ft.	16
30.0-40.0 ft.	<5	390.0-400.0 ft.	7
40.0-50.0 ft.	7	400.0-410.0 ft.	Nil

50.0-60.0 ft.	12	410.0-420.0 ft.	10
60.0-70.0 ft.	11	420.0-430.0 ft.	7
70.0-80.0 ft.	9	430.0-440.0 ft.	Nil
80.0-90.0 ft.	9	440.0-450.0 ft.	3
90.0-100.0 ft.	9	450.0-460.0 ft.	Nil
100.0-110.0 ft.	9	460.0-470.0 ft.	Nil
110.0-120.0 ft.	9	470.0-480.0 ft.	12
120.0-130.0 ft.	17	480.0-490.0 ft.	14
130.0-140.0 ft.	7	490.0-500.0 ft.	28
140.0-150.0 ft.	14	500.0-512.5 ft.	9
150.0-160.0 ft.	Nil		
160.0-170.0 ft.	27		
170.0-180.0 ft.	Nil		
180.0-190.0 ft.	Nil		
190.0-200.0 ft.	31	0.2 ppe Ag 184 ppe Cu 225 ppe Zn <5 ppe Pb	
200.0-210.0 ft.	Nil		
240.0-250.0 ft.	Nil		
250.0-260.0 ft.	Nil		
270.0-280.0 ft.	7	295 ppe Cu 438 ppe Zn	
280.0-290.0 ft.	Nil		
290.0-300.0 ft.	12	298 ppe Cu 354 ppe Zn	
300.0-310.0 ft.	5		
310.0-320.0 ft.	Nil		
320.0-330.0 ft.	Nil		
330.0-340.0 ft.	3	172 ppe Cu 187 ppe Zn	
340.0-350.0 ft.	3	171 ppe Cu 180 ppe Zn	
350.0-360.0 ft.	7	288 ppe Cu 293 ppe Zn	
360.0-370.0 ft.	12	0.2 ppe Ag 274 ppe Cu 306 ppe Zn	

Additional Core Assays

185.0-190.0 ft.	342ppe Zn
190.0-195.0 ft.	107ppe Zn
246.0-251.0 ft.	333ppe Zn

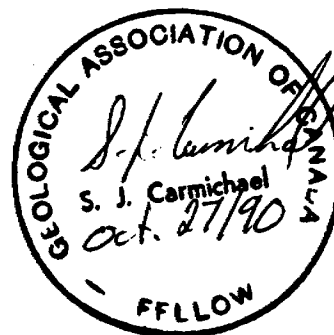

EM Conductor

Collar E-90-2

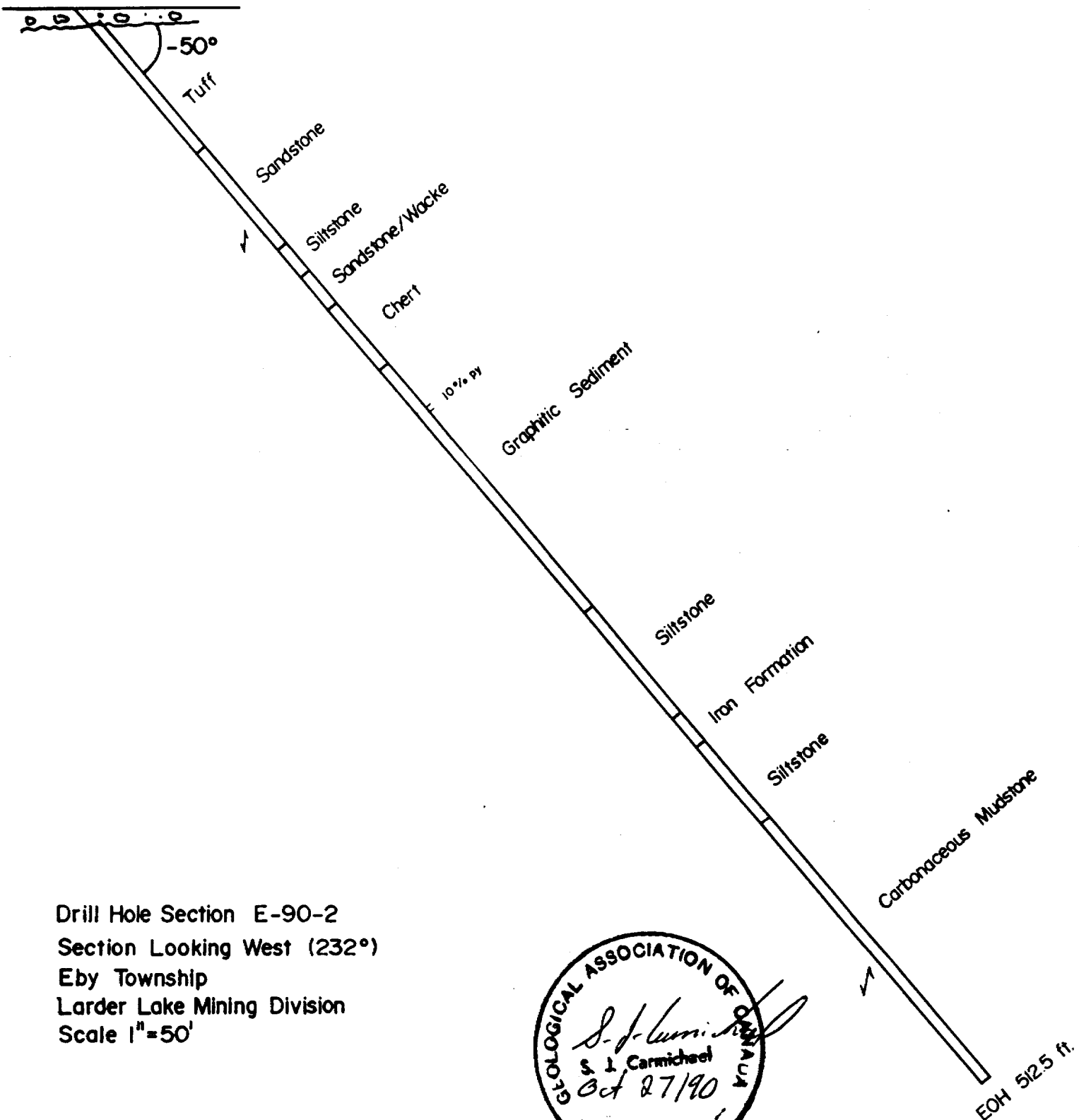

Drill Hole Section E-90-2
Section Looking West (232°)
Eby Township
Larder Lake Mining Division
Scale 1"=50'

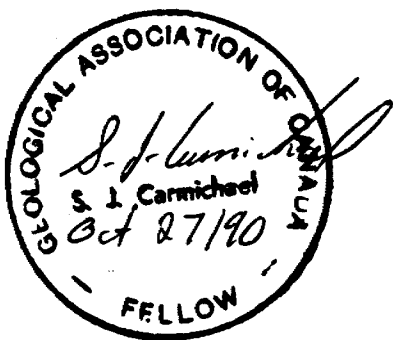

DRILL HOLE LOCATION PLAN
EBY TOWNSHIP
DISTRICT of TIMISKAMING
Concession IV
Lot 2, S 1/2, NE 1/4

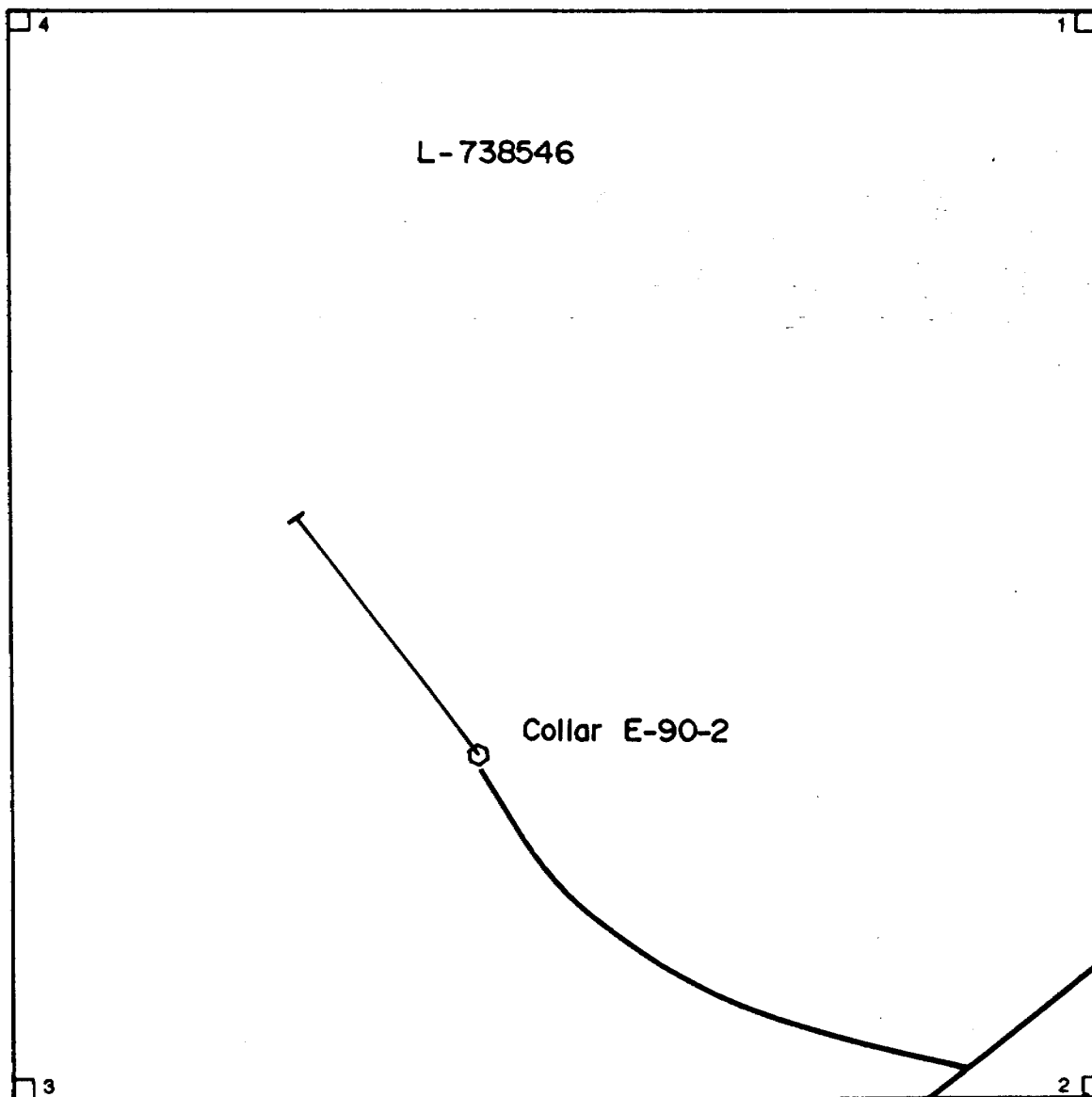
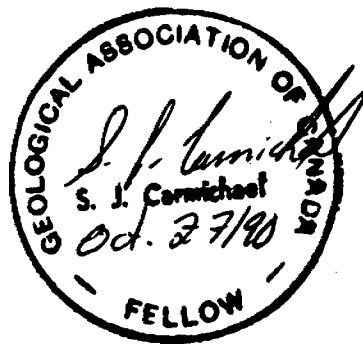

Scale 1" = 200'

Oct. 1990

Memo Rec

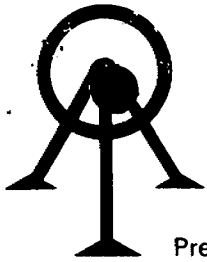

ACCURASSAY LABORATORIES LTD.

P.O. BOX 426
KIRKLAND LAKE, ONTARIO, CANADA P2N 3J1
TEL.: (705) 567-3361

President: Dr. GEORGE DUNCAN, M.Sc., Ph. D., C. Chem (Ont.), C. Chem (U.K.), M.C.I.C., M.R.S.C., A.R.C.S.T.

EBY
E2-90

Certificate of Analysis

Page: 1

33909 Mr. Fernand Rivard
Box 1091
Kirkland Lake, Ontario
P2N 2C9

Date: July 10 19 90

Work Order # : 900395
Project :

E2-90

SAMPLE NUMBERS			Gold
Accurassay	Customer		ppb
219212 20-30	192370		5
219213 30-40	192371		<5
219214 40-50	192372		7
219215 50-60	192373		12
219216 60-70	192374		11
219217 70-80	192375		9
219218 E2-90	NO SAMPLE # 10-20		7
219218 E2-90	NO SAMPLE # 10-20 FT	10	Check

2.13686

TOTAL
Assay costs
827.40
[Signature]

Handwritten calculations:
15 | 827.40
 150

 677
 150

 827.40

Handwritten calculations:
55
15

70
15

85

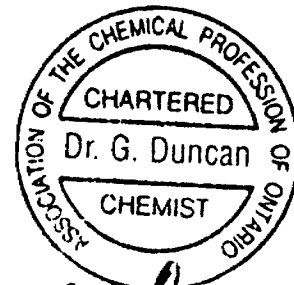

G Duncan

Per: _____



ACCURASSAY LABORATORIES LTD.

P.O. BOX 426
KIRKLAND LAKE, ONTARIO, CANADA P2N 3J1
TEL.: (705) 567-3361

President: Dr. GEORGE DUNCAN, M.Sc., Ph. D., C. Chem (Ont.), C. Chem (U.K.), M.C.I.C., M.R.S.C., A.R.C.S.T.

Certificate of Analysis

Page: 1

33925 Mr. Fernand Rivard
Box 1091
Kirkland Lake, Ontario
P2N 2C9

Date: July 12 19 90

Work Order # : 900407
Project :

E 2-90

SAMPLE NUMBERS		Gold
Accurassay	Customer	ppb
219330 <i>80 - 90</i>	192376	9
219331 <i>90 - 100</i>	192377	9
219332 <i>100 - 110</i>	192378	9
219333 <i>110 - 120</i>	192379	9
219334 <i>120 - 130</i>	192380	22
219334	192380	12 Check

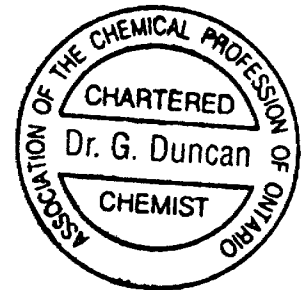

Per: *G Duncan*



Established 1928

Swastika Laboratories

A Division of Assayers Corporation Ltd.

Assaying - Consulting - Representation

Geochemical Analysis Certificate

0W-0980-RG1

Company: **F. RIVARD**

Date: JUL-17-90

Project:

Attn: *F 2-90*

We hereby certify the following Geochemical Analysis of 8 D.D. SLUDGE samples submitted JUL-12-90 by .

Sample Number	Au PPB	Au PPB	Ag PPM	Cu PPM	Zn PPM	Pd PPB
1201 <i>130-140</i>	7					
1202 <i>140-150</i>	14					
1203 <i>150-160</i>	Nil					
1204 <i>160-170</i>	27	34				
1205 <i>170-180</i>	Nil					
1206 <i>180-190</i>	Nil					
1207 <i>190-200</i>	31		0.2	184	225	<5
1208 <i>200-210</i>	Nil					

Certified by _____

G. Lebel
G. Lebel / Manager

P.O. Box 10, Swastika, Ontario P0K 1T0

Telephone (705) 642-3244

FAX (705) 642-3300



Established 1928

Swastika Laboratories

A Division of Assayers Corporation Ltd.

Assaying - Consulting - Representation

Geochemical Analysis Certificate

0W-1002-RG1

Company: F. RIVARD

Date: JUL-19-90

Project:

Copy 1. BOX 1091, KIRKLAND LAKE, ONT. P2N 3L5

Attn: F. RIVARD E 2/90

We hereby certify the following Geochemical Analysis of 2 SLUDGE samples submitted JUL-17-90 by F. RIVARD.

Sample Number	Au ppb
1212 240-250	Nil
1213 250-260	Nil

Certified by

G. Lebel / Manager

P.O. Box 10, Swastika, Ontario P0K 1T0

Telephone (705) 642-3244

FAX (705) 642-3300



Established 1928

Swastika Laboratories

A Division of Assayers Corporation Ltd.

Assaying - Consulting - Representation

Geochemical Analysis Certificate

0W-1057-RG1

Company: **F. RIVARD**

Date: **JUL-27-90**

Project:

Copy 1. Box 1091, Kirkland Lake, Ont. P2N 3L5

Attn: **E 7-90**

We hereby certify the following Geochemical Analysis of 4 SLUDGE samples submitted JUL-25-90 by .

Sample Number	Au ppb	Cu ppm	Zn ppm
1214 260 - 270	7	295	438
1216 270 - 280	Nil		
1217 280 - 290	Nil		
1218 290 - 300	14/10	298	354

Certified by

G. Lebel / Manager

P.O. Box 10, Swastika, Ontario P0K 1T0

Telephone (705) 642-3244

FAX (705) 642-3300



Swastika Laboratories

A Division of Assayers Corporation Ltd.

Assaying - Consulting - Representation

Geochemical Analysis Certificate

0W-1086-RG1

Company: **F. RIVARD**

Date: AUG-02-90

Project:

Copy 1. Box 1091 KIRKLAND LAKE, ONT. P2N 3L5

Attn: **F. RIVARD**

E 2-90

We hereby certify the following Geochemical Analysis of 4 SLUDGES samples submitted JUL-27-90 by .

Sample Number	Au ppb	Cu ppm	Zn ppm
1219 <u>300-310</u>	317		
1220 <u>310-320</u>	Nil		
1221 <u>320-330</u>	Nil		
1222 <u>330-340</u>	3	172	187

E B Y

Certified by

G. Lebel / Manager

P.O. Box 10, Swastika, Ontario P0K 1T0

Telephone (705) 642-3244

FAX (705) 642-3300



Established 1928

Swastika Laboratories

A Division of Assayers Corporation Ltd.

Assaying - Consulting - Representation

Geochemical Analysis Certificate

0W-1085-RG1

Company: **F. RIVARD**

Project:

Attn: **F. RIVARD**

F 2-90

Date: **AUG-02-90**

Copy 1. P.O. BOX 1091, KIRKLAND LAKE, ONT. P2N 3L5

We hereby certify the following Geochemical Analysis of 3 SLUDGE samples submitted JUL-31-90 by .

Sample Number	Au ppb	Ag ppm	Cu ppm	Zn ppm
1223 <i>340 - 350</i>	3		171	180
1224 <i>350 - 360</i>	7		288	293
1225 <i>360 - 370</i>	10/14	0.2	274	306

EBY

Certified by

G. Lebel / Manager

P.O. Box 10, Swastika, Ontario P0K 1T0

Telephone (705) 642-3244

FAX (705) 642-3300



Swastika Laboratories

A Division of Assayers Corporation Ltd.

Assaying - Consulting - Representation

Geochemical Analysis Certificate

0W-1126-RG1

Company: **F.RIVARD**

Date: **AUG-10-90**

Project:

Copy 1. BOX 1091, KIRKLAND LAKE, P2N 3L5

Attn:

We hereby certify the following Geochemical Analysis of 6 SLUDGES samples submitted AUG-08-90 by .

Sample Number		Au ppb
1226	376 - 380	Nil
1227	380 - 390	14/17
1228	390 - 400	7
1229	410 - 410	Nil
1230	410 - 420	10
1231	420 - 430	7

EB

Certified by

G. Lebel / Manager

P.O. Box 10, Swastika, Ontario P0K 1T0

Telephone (705) 642-3244

FAX (705) 642-3300



Established 1928

Swastika Laboratories

A Division of Assayers Corporation Ltd.

Assaying - Consulting - Representation

Geochemical Analysis Certificate

0W-1131-RG1

Company: **F. RIVARD**

Date: **AUG-13-90**

Project:

Copy 1. BOX 1091, KIRKLAND LAKE P2N 3L5

Attn:

We hereby certify the following Geochemical Analysis of 2 SLUDGES samples submitted AUG-09-90 by .

Sample Number	Au ppb
1232 <i>E 2-90</i> <i>430-440</i>	Nil
1233 <i>440-450</i>	3

EBY

Certified by

G. Lebel / Manager

P.O. Box 10, Swastika, Ontario P0K 1T0
Telephone (705) 642-3244 FAX (705) 642-3300



Swastika Laboratories

A Division of Assayers Corporation Ltd.

Assaying - Consulting - Representation

Geochemical Analysis Certificate

0W-1136-RG1

Company: **F. RIVARD**

Date: **AUG-13-90**

Project:

Copy 1. P.O.BOX 1091, KIRKLAND LAKE, ONT. P2N 3L5

Attn: **F. RIVARD**

We hereby certify the following Geochemical Analysis of 2 SLUDGE samples submitted AUG-10-90 by F. RIVARD.

Sample Number	Au ppb
<i>E 2-90</i> 1234 <i>450-460</i>	Nil
1235 <i>460-470</i>	Nil

*EB**

Certified by

G. Lebel / Manager



Established 1928

Swastika Laboratories

A Division of Assayers Corporation Ltd.

Assaying - Consulting - Representation

Geochemical Analysis Certificate

0W-1141-RG1

Company: F. RIVARD

Date: AUG-14-90

Project:

Copy 1. BOX 1091, KIRKLAND LAKE P2N 3J5

Attn: F. RIVARD

We hereby certify the following Geochemical Analysis of 4 SLUDGE/ROCK samples submitted AUG-13-90 by F. RIVARD.

Sample Number		Au ppb
1236	470 - 480	12
1237	480 - 490	14
1238	490 - 500	24/31
1239	500 - 510	

CRAB DRAIN SITE

Certified by

G. Lebel / Manager

P.O. Box 10, Swastika, Ontario P0K 1T0

Telephone (705) 642-3244

FAX (705) 642-3300



Established 1928

Swastika Laboratories

A Division of Assayers Corporation Ltd.

Assaying - Consulting - Representation

Geochemical Analysis Certificate

0W-1179-RG1

Company: F. RIVARD
Project:
Attn: F. RIVARD

Date: AUG-17-90

Copy 1. P.O. BOX 1091, KIRKLAND LAKE, ONT. P2N 3L5

We hereby certify the following Geochemical Analysis of 1 SLUDGE samples submitted AUG-16-90 by F. RIVARD.

Sample Number	Au ppb
<i>E 2-90</i> 1240 500-512.5	9

E 137

Certified by *G. Lebel*
G. Lebel / Manager



Established 1928

Swastika Laboratories

A Division of Assayers Corporation Ltd.

Assaying - Consulting - Representation

Geochemical Analysis Certificate

0W-1490-RG1

Company: **F. RIVARD**

Project:

Attn: **R2-90**

STEW

Date: **OCT-05-90**

Copy 1. BOX 1091, KIRKLAND LAKE P2N 3J7

We hereby certify the following Geochemical Analysis of 12 SPLIT CORE samples submitted OCT-03-90 by F. RIVARD.

Sample Number	Au ppb	Zn ppm
1241 23.1 - 27.0	21	
1242 49.0 - 53.0	7	
1243 142.0 - 147.0	Nil	
1244 180.0 - 185.0	3	
1245 185.0 - 190.0	713	342
1246 190.0 - 195.0	17	107
1247 195.0 - 200.0	Nil	355
1248 246.0 - 251.0	Nil	82
1249 251.0 - 256.0	14	
1250 273.5 - 280.0	Nil	
121599 397.0 - 402.0	10	
121600 464.0 - 469.0	Nil/Nil	

Certified by 
G. Lebel / Manager



Mining Act
Report of Work
(Expenditures, Subsection 77(19))

Continued to Mining Lands Section, Mineral Development and Lands Branch.

Type of Work Performed ASSAYS	Mining Division LARDER LAKE	Township or Area ERY
Recorded Holder FERNAND RIVARD	2,13686	Prospector's Licence No. K19102
Address 11 BOV RD WEST KIRKLAND LAKE ONT BOX 1091		Telephone No. 705-567-7344
Work Performed By STASTIKA LABORATORIE & ACCURE ASSAY		
Name and Address of Author (of Submission) FERNAND RIVARD BOX 1091 KIRKLAND LAKE ONT		Date When Work was Performed From: 7 90 To: 5 10 90 Day Mo. Yr. Day Mo. Yr.

All the work was performed on Mining Claim(s): Indicate no. of days performed on each claim. *See Note No. 1 on reverse side				Mining Claim L-738546	No. of Days 55	Mining Claim	No. of Days	Mining Claim	No. of Days	Mining Claim	No. of Days	Mining Claim	No. of Days
Mining Claim	No. of Days	Mining Claim	No. of Days	Mining Claim	No. of Days	Mining Claim	No. of Days	Mining Claim	No. of Days	Mining Claim	No. of Days	Mining Claim	No. of Days
Mining Claim	No. of Days	Mining Claim	No. of Days	Mining Claim	No. of Days	Mining Claim	No. of Days	Mining Claim	No. of Days	Mining Claim	No. of Days	Mining Claim	No. of Days
Instructions Total days credits may be distributed at claim holder's choice. Enter number of days credits per claim in the expenditure days credit column (below).				Calculation of Expenditure Days Credits Total Expenditures \$827.40				Total Days Credits 15		Total Number of Mining Claims Covered by this Report of Work 55		1	

Mining Claims (List in numerical sequence). If space is insufficient, attach schedules with required information

Mining Claim Prefix	Mining Claim Number	Expend. Days Cr.	Mining Claim Prefix	Mining Claim Number	Expend. Days Cr.	Mining Claim Prefix	Mining Claim Number	Expend. Days Cr.	Mining Claim Prefix	Mining Claim Number	Expend. Days Cr.
L	891908	55 14									
* Credit Reduced											
Now at 65 days maximum											
RECEIVED											
NOV 26 1990											
MINING LANDS SECTION											

Total Number of Days Performed 55	Total Number of Days Claimed 55 14	Total Number of Days to be Claimed at a Future Date N/A 41
---	--	--

Certification of Beneficial Interest *See Note No. 2 on reverse side

I hereby certify that, at the time the work was performed, the claims covered in this report of work were recorded in the current recorded holder's name or held under a beneficial interest by the current recorded holder.	Date Oct 29 / 90	Recorded Holder or Agent (Signature) <i>[Signature]</i>
--	----------------------------	--

Certification Verifying Report of Work

I hereby certify that I have a personal and intimate knowledge of the facts set forth in the Report of Work annexed hereto, having performed the work or witnessed same during and/or after its completion and the annexed report is true.		
Name and Address of Person Certifying Stewart Carmichael P.O. Box 271, Swastika Ont. POK 1T0	Telephone No. 705 567-7286	Date Oct 29 / 90
		Certified By (Signature) <i>[Signature]</i>

For Office Use Only

Total Days Cr. Recorded 14	Date Recorded Oct 29 / 90	Mining Recorder <i>[Signature]</i>
	Date Approved as Recorded Jan 21 / 91	Provincial Manager, Mining Lands <i>[Signature]</i>

RECEIVED

30 OCT 29 PM 1 54

MINING DIVISION

LARDER LAKE

ML.

Grenfell Twp. M. 351

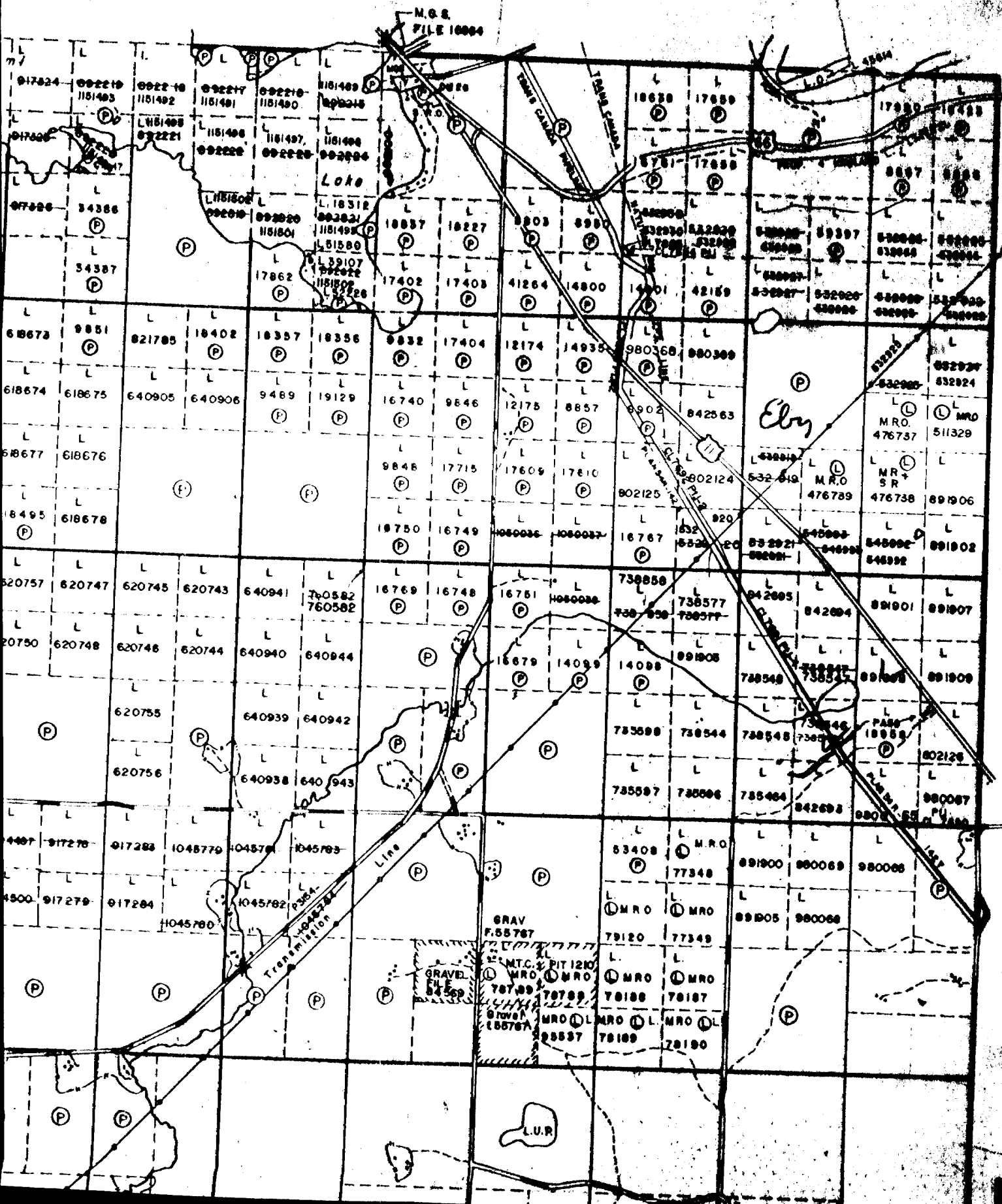

V
V
IV
III

22717



SWASTIKA LABORATORIES

(A DIVISION OF ASSAYERS CORPORATION LIMITED)

P.O. BOX 10, SWASTIKA, ONTARIO POK 1T0
TELEPHONE: (705) 642-3244 FAX (705) 642-3300

VENDU A
SOLD TO

Mr. F. Rivard
Box 1091
Kirkland Lake, Ontario
P2N 3L5

**1.5% LATE CHARGE OVER 30
DAYS (ANNUAL RATE 18%)**

QUANTITY	DESCRIPTION	UNIT PRICE	TOTAL
8	Au assays	\$ 8.75	\$ 70.00
1	Ag Cu Zn	11.50	11.50
1	Pd	8.75	8.75
8	Sample Handling Cert#OW-0980-RG1 July 17,1990	3.00	24.00
<i>114.25</i> <i>73.50</i> <i>63.00</i> <hr/> <i>200.75</i> <i>PAID AUG 2/90</i> <i>mm</i>			
TOTAL.....\$			114.25

FACTURE/INVOICE ANALYTICAL CHEMISTS • ASSAYERS • CONSULTANTS
ESTABLISHED 1928



22819



SWASTIKA LABORATORIES

(A DIVISION OF ASSAYERS CORPORATION LIMITED)

P.O. BOX 10, SWASTIKA, ONTARIO POK 1T0
TELEPHONE: (705) 642-3244 FAX (705) 642-3300

VENDU A
BOLD TO

Mr. F. Rivard
Box 1091
Kirkland Lake, Ontario
P2N 3L5
E 2-90

**1.5% LATE CHARGE OVER 30
DAYS (ANNUAL RATE 18%)**

QUANTITY	DESCRIPTION	UNIT PRICE	TOTAL
4	Au assays	\$ 8.75	\$ 35.00
1	Cu Zn PPM	8.00	8.00
4	Sample Handling Cert.#OW-1086-RG1 Aug. 2, 1990	3.00	12.00
3	Au assays	8.75	26.25
1	Ag assay PPM	4.50	4.50
3	Cu Zn PPM	8.00	24.00
3	Sample Handling Cert.#OW-1085-RG1 Aug. 2, 1990	3.00	9.00
<i>EB-1 fair</i>			
		TOTAL...	\$ 118.75

FACTURE/INVOICE ANALYTICAL CHEMISTS • ASSAYERS • CONSULTANTS
ESTABLISHED 1928



22876



SWASTIKA LABORATORIES

(A DIVISION OF ASSAYERS CORPORATION LIMITED)

P.O. BOX 10, SWASTIKA, ONTARIO POK 1T0
TELEPHONE: (705) 642-3244 FAX (705) 642-3300



VENDU A
SOLD TO

Mr. F. Rivard
Box 1091
Kirkland Lake, Ontario
P2N 3L5
F 2-80

**1.5% LATE CHARGE OVER 30
DAYS (ANNUAL RATE 18%)**



	DESCRIPTION		
2	Au assays	\$ 8.75	\$ 17.50
2	Sample Handling	3.00	6.00
	Cert.#OW-1136-RG1 Aug. 13, 1990		
2	Au assays	8.75	17.50
2	Sample Handling	3.00	6.00
	Cert.#OW-1131-RG1 Aug. 13, 1990		
4	Au assays	8.75	35.00
4	Sample Handling	3.00	12.00
	Cert.#OW-1141-RG1 Aug. 14, 1990		
	<i>F B 1</i>		
	<i>[Signature]</i>		
	TOTAL...	\$	94.00

FACTURE/INVOICE ANALYTICAL CHEMISTS • ASSAYERS • CONSULTANTS
ESTABLISHED 1928



22919



SWASTIKA LABORATORIES

(A DIVISION OF ASSAYERS CORPORATION LIMITED)

P.O. BOX 10, SWASTIKA, ONTARIO P0K 1T0
 TELEPHONE: (705) 642-3244 FAX (705) 642-3300

VENDU A
 SOLD TO

Mr. F. Rivard
 Box 1091
 Kirkland Lake, Ontario
 P2N 3L5

**1.5% LATE CHARGE OVER 30
 DAYS (ANNUAL RATE 18%)**

QUANTITE QUANTITY	DESCRIPTION	TERMS	SALES TAX AMOUNT
1	Au assay	\$ 8.75	\$ 8.75
1	Sample Handling Cert.#OW-1179-RG1 Aug. 17, 1990	3.00	3.00
3	Au assays	8.75	26.25
3	Sample Handling Cert.#OW-1173-RG1 Aug. 16, 1990	3.00	9.00
TOTAL.....			\$47.00

*EBY
E2-90*

*OTTO
DRILL
SITE*

*Pew
CA*

FACTURE/INVOICE ANALYTICAL CHEMISTS • ASSAYERS • CONSULTANTS
 ESTABLISHED 1928



ACCURASSAY LABORATORIES LTD.

CHARTERED CHEMISTS, ASSAYERS, ANALYTICAL CONSULTANTS

Box 426, 3 Industrial Dr., Kirkland Lake
Ontario, Canada P2N 3J1

900446

TO TEL.: (705) 567-3361 - FAX: (705) 567-8368

Mr. Fern Rivard
Box 1091
Kirkland Lake, Ontario
P2N 2C9

DATE	July 11, 1990
CUSTOMER ORDER N°	
WORK ORDER N°	900395
DATE SUBMITTED	

TERMS

net 30 days, 2.0% per month on overdue accounts.

QUANTITY	DESCRIPTION	PRICE	AMOUNT
7	Gold Assays W.O. #900395	7.50	52 50
7	Sample Prep. cert.# 33909	3.95	27 65
	Amount due before August 10, 1990.....		80 15
	Please note: Accounts more than 45 days past due will lose any price discounts		

LF-1297

Thank You!

ACCURASSAY LABORATORIES LTD.

CHARTERED CHEMISTS, ASSAYERS, ANALYTICAL CONSULTANTS

Box 426, 3 Industrial Dr., Kirkland Lake
Ontario, Canada P2N 3J1

900460

TO TEL.: (705) 567-3361 - FAX: (705) 567-8368

Mr. Fern Rivard
Box 1091
Kirkland Lake, Ontario
P2N 2C9

TERMS

DATE	July 13, 1990
CUSTOMER ORDER N°	
WORK ORDER N°	900407
DATE SUBMITTED	

net 30 days, 2.0% per month on overdue accounts.

QUANTITY	DESCRIPTION	PRICE	AMOUNT
5	Gold Assays W.O. #900407	7.50	37 50
5	Sample Prep. cert.# 33925	3.95	19 75
	Amount due before August 12, 1990.....		57 25
	Please note: Accounts more than 45 days past due will lose any price discounts		

*Paid Aug 8/90
OR*

*57.25
80.15

137.40*

LF-1297

Thank You!

Grenfell Twp. M.351

THE TOWNSHIP OF

EBY

DISTRICT OF TIMISKAMING

LARDER LAKE MINING DIVISION

SCALE: 1-INCH=40 CHAINS

LEGEND

PATENTED LAND	Ⓟ
CROWN LAND SALE	C.S.
LEASES	Ⓛ
LOCATED LAND	Loc.
LICENSE OF OCCUPATION	L.O.
MINING RIGHTS ONLY	M.R.O.
SURFACE RIGHTS ONLY	S.R.O.
ROADS	—
IMPROVED ROADS	—
KING'S HIGHWAYS	—
RAILWAYS	—
POWER LINES	—
MARSH OR MUSKEG	—
MINES	ⓧ
CANCELLED	C.

NOTES

400' surface rights reservation along the shores of all lakes and rivers

AREAS WITHDRAWN FROM STAKING

DATE OF ISSUE
NOV 5 1980
LARDER LAKE
MINING RECORDER'S OFFICE

THE INFORMATION THAT APPEARS ON THIS MAP HAS BEEN COMPILED FROM VARIOUS SOURCES, AND ACCURACY IS NOT GUARANTEED. THOSE WISHING TO STAKE MINING CLAIMS SHOULD CONSULT WITH THE MINING RECORDER, MINISTRY OF NORTHERN DEVELOPMENT AND MINES, FOR ADDITIONAL INFORMATION ON THE STATUS OF THE LANDS SHOWN HEREON.

PLAN NO. M-345

MINISTRY OF NORTHERN DEVELOPMENT AND MINES

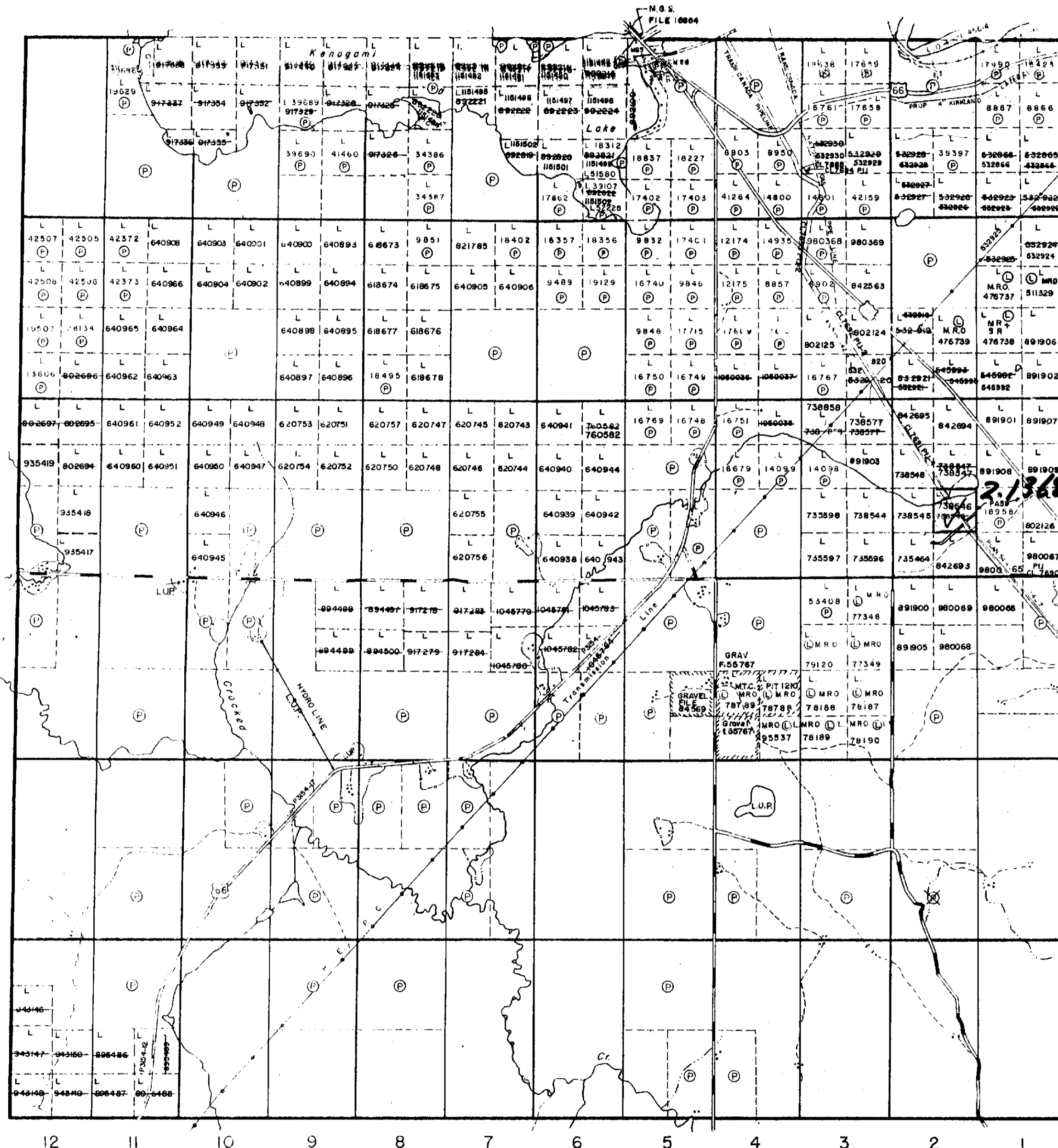

Burt Twp. M.334

Otto Twp. M.379

Blain Twp. M.418



42A015E0170 2.13686 EBY