

DIAMOND DRILLING



42A01SE1015 49 TECK

010

TOWNSHIP: Teck

REPORT No.: 49

WORK PERFORMED BY: Lac Minerals Ltd.

<u>CLAIM No.</u>	<u>HOLE No.</u>	<u>FOOTAGE</u>	<u>DATE</u>	<u>NOTE</u>
L 620179	CS-58	105	Aug/83	(1)
	CS-59	126	Aug/83	(1)

NOTES: (1) #245-83

LAC MINERALS LTD./MACASSA DIV.  
DIAMOND DRILL LOG

Hole No. CS-58

Section 27+25 W Depth 105' Remarks L. Nemecsek Aug 20/83 Dip Tests @ \_\_\_\_\_  
 Location IN S.W. FACE OF PIT WALL Dip -35° \_\_\_\_\_  
 Station 34+00 S Core Size Ext 13.4 STR BRECC. FLT @ 40° TCA \_\_\_\_\_  
 Easting \_\_\_\_\_ Purpose ASSESSMENT 26.0-36.8 Highly Sheared core \_\_\_\_\_  
 Azimuth 167° EXPLORE FOR 73.8 STR BRECC SLIP @ 15° TCA \_\_\_\_\_  
 Elevation \_\_\_\_\_ KIRKLAND - LADDER LAKE 98.2 STR CARB./CHL SLIP @ 15° TCA \_\_\_\_\_  
13ERK

20 sc E	
20 sc G	
100 sc P	
20 sc X	
20 sc L	
100 sc L	

Footage		Description	Core			Sludge				
From	To		From	To	Total	Sample No.	Ozs.	From	To	Ozs.
0	1.1		- broken rock found pit - no core						0	10
1.1		green carbonate (chert?) - with veins of green locally laminated core with locally streaked beige fine grained angular to subangular rock fragments cemented in by both green carbonate and milky white carbonate - reacts milky with HCl						10	20	
		- core is weathered to 2.2'						20	30	
		- very chippy core through to 14' - carbonate appears to generally make up 30-50% of total core.						30	40	
	1.1	4.3' - locally broken core with a 1.1' milky section & trace of chert	1.1	4.3	3.2	78662		40	50	
		& of (white) vein - carbonate is locally laminated @ 40-45° TCA						50	60	
	4.3	7.5' - green carbonate core exhibiting greenish bluish? streaks & streaks through-out the core - section has a continuous band of beige bleached log. grayish fragments cemented by green carbonate < 0.5% dense siliceous	4.3	7.5	3.2	63		60	70	
		7.5-10' - green carbonate as above but with 3-5% dull grayish-beige bluish gray - up to 1% bleached siliceous streaks through out section						70	80	
	10	13.3' - rock broken core consists of green carbonate with a 3" grayish gray laminated streaks @ 11.1' @ 35° TCA - section has a 1/2" bluish	10	13.3	3.3	65		80	90	
		with vein.						90	100	
		@ 13.4' a STR BRECC FLOW @ 40° TCA local all a 2.0' section of bleached beige colored core laminated locally with < 1% streaks of						100	110	
								110	120	
								120	130	
								130	140	
								140	150	
								150	160	
								160	170	
								170	180	
								180	190	
								190	200	



Footage		Description	Core			Sludge					
From	To		From	To	Total	Sample No.	Ozs.	From	To	Ozs.	
			47.2-49.5' - diller indurite, but core - core ends on ground. - generally quite cut to scattered $\frac{1}{16}$ - $\frac{1}{8}$ " dull white carbonates strongly within core @ 30-60° TCA - quartz veins reddish brown thin to 53' & then becomes dark grey in color & quite fig. texture - between 53-56' core is quite blocky with average core lengths of 1-2" 56-57' - diller indurite, but core 1st 57-60' three parallel carbonate leaf slips @ 40° TCA  65-67.7' - indurite chippy core averaging 1-2" - each chd slip in line very core to break up readily. 67.7-68.7' - last core - much broken core between 71-71.8' - generally quartz is medium to dark grey in color with a fig. texture  @ 73.0' STR BIFCC SLIP @ 19° TCA - a 1" zone of coarse lamination controlled by hard black chdite line - then to 100' good core of fig. carbon grey quartz 84.5-86.9' blocky quartz centered on trace 1" grey sty string @ 86.2' 84.5 86.9 2.4 73674 @ 35-50° TCA - zone is run with 1-2% disseminated sph. - @ 95.2' a 0.3' section of reddish granitic looking core followed by 0.3' of broken core on table old slip @ 97.5' - broken mostly core core 0.1' - doesn't appear to be significant structure here - @ 98.2' STR CH23-CHL SLIP @ 13° TCA - a 1" laminated hard line - then to 105' - quartz is dark grey and quite fig. with no glaucophane control - @ 103' last 0.4' of core								

105' end of hole

LAC MINERALS LTD./MACASSA DIV.  
DIAMOND DRILL LOG

Hole No. CS-59

Section 27+68W Depth 126'  
 Location <sup>STN</sup> 33+175 Dip -45°  
 Northing \_\_\_\_\_ Core Size EXT  
 Easting \_\_\_\_\_ Purpose ASSESSMENT  
 Azimuth 177° 00' EXPLORE FOR \_\_\_\_\_  
 Elevation \_\_\_\_\_ KIRKLAND - LARDER LAKE  
BREAK.

Remarks L. Nemeth August  
20/83  
049.0' STR CARB/CHL SLIP

Dip Tests @ \_\_\_\_\_  
 \_\_\_\_\_  
 \_\_\_\_\_  
 \_\_\_\_\_

20 sc E	
20 sc G	
100 sc P	
20 sc X	
20 sc L	
100 sc L	

Footage		Description	Core			Sludge				
From	To		From	To	Total	Sample No.	Ozs.	From	To	Ozs.
0	1.5		Coig						0	10
1.5	2.0	Coig core - quartzite						10	20	
2.0		quartzite - unit is a uniform dark grey fine grained zone 7.8 - 8.5' chiller indicates bit core						20	30	
		○ 12.2' some lamination in the quartzite unit @ 43° TCA - appears to consist of thin calc fractures with abraded dark quartz phenocrysts.						30	40	
		- quartzite has scattered subhedral black finely inconspicuous phenocrysts of quartzite - unit could be called a basic quartzite as primary content is						40	50	
		15-20% - distinction made between basic and felsic/acid quartzite @						50	60	
		Massive						60	70	
		- thin to 50' good coing of dark grey fine grained quartzite						70	80	
		- from 29' onward increasing frequency of scattered thin calc fractures mineralized with green epidote						80	90	
		○ 43.2' calc-chl slip @ 28° TCA						90	100	
		○ 49' STR CARB-CHL SLIP @ 30° TCA						100	110	
		51.5-52' - a 1/4" grey slip string @ 70° TCA mineralized in a 1" diam bleached						110	120	
		had 1/2" mineralized with 1% sulphides						120	130	
		56-57' - some no close quartzite but with up to 2% sulphide min.						130	140	
		- between 66-65' slightly brownish altered - trace of mineral - not sampled						140	150	
		- between 75-100' - very chippy & blocky core						150	160	
								160	170	
								170	180	
								180	190	
								190	200	





Teck Typ

F. The A



42A01SE1015 49 TECK

900

Name and Postal Address of Recorded Holder  
**LAC MINERALS LTD (MACKASSA DIVISION)** **T 664**  
**P.O. Box, 550 KIRKLAND LAKE ONTARIO P2N 3J7**

Summary of Work Performance and Distribution of Credits (705) 567-5208 EXT 118

Total Work Days Cr. claimed <i>231 work days</i>	Mining Claim		Work Days Cr.	Mining Claim		Work Days Cr.	Mining Claim		Work Days Cr.
	Prefix	Number		Prefix	Number		Prefix	Number	
for Performance of the following work. (Check one only)		<b>620179</b>	<b>231</b>						
<input type="checkbox"/> Manual Work									
<input type="checkbox"/> Shaft Sinking Drifting or other Lateral Work.									
<input type="checkbox"/> Compressed Air, other Power driven or mechanical equip.									
<input type="checkbox"/> Power Stripping									
<input checked="" type="checkbox"/> Diamond or other Core drilling									
<input type="checkbox"/> Land Survey									

All the work was performed on Mining Claim(s): **620179**

Required Information eg: type of equipment, Names, Addresses, etc. (See Table Below)

*PLEASE REFER TO ATTACHED SHEET #1*

*LAC MINERALS*

Date of Report: *August 22, 1983* Recorded Holder or Agent (Signature): *Douglas F. Cater*

Certification Verifying Report of Work

I hereby certify that I have a personal and intimate knowledge of the facts set forth in the Report of Work annexed hereto, having performed the work or witnessed same during and/or after its completion and the annexed report is true.

Name and Postal Address of Person Certifying  
**DOUGLAS F. CATER #2-70 GRIERSON ROAD KIRKLAND LAKE**  
**ONTARIO P2N 1E2 567-4304**

Date Certified: **22/8/1983** Certified by (Signature): *Douglas F. Cater*

Table of Information/Attachments Required by the Mining Recorder

Type of Work	Specific information per type	Other information (Common to 2 or more types)	Attachments
Manual Work	Nil	Names and addresses of men who performed manual work/operated equipment, together with dates and hours of employment.	Work Sketch: these are required to show the location and extent of work in relation to the nearest claim post.
Shaft Sinking, Drifting or other Lateral Work			
Compressed air, other power driven or mechanical equip.	Type of equipment	Names and addresses of owner or operator together with dates when drilling/stripping done.	Work Sketch (as
Power Stripping	Type of equipment and amount expended. Note: Proof of actual cost must be submitted within 30 days of recording.		

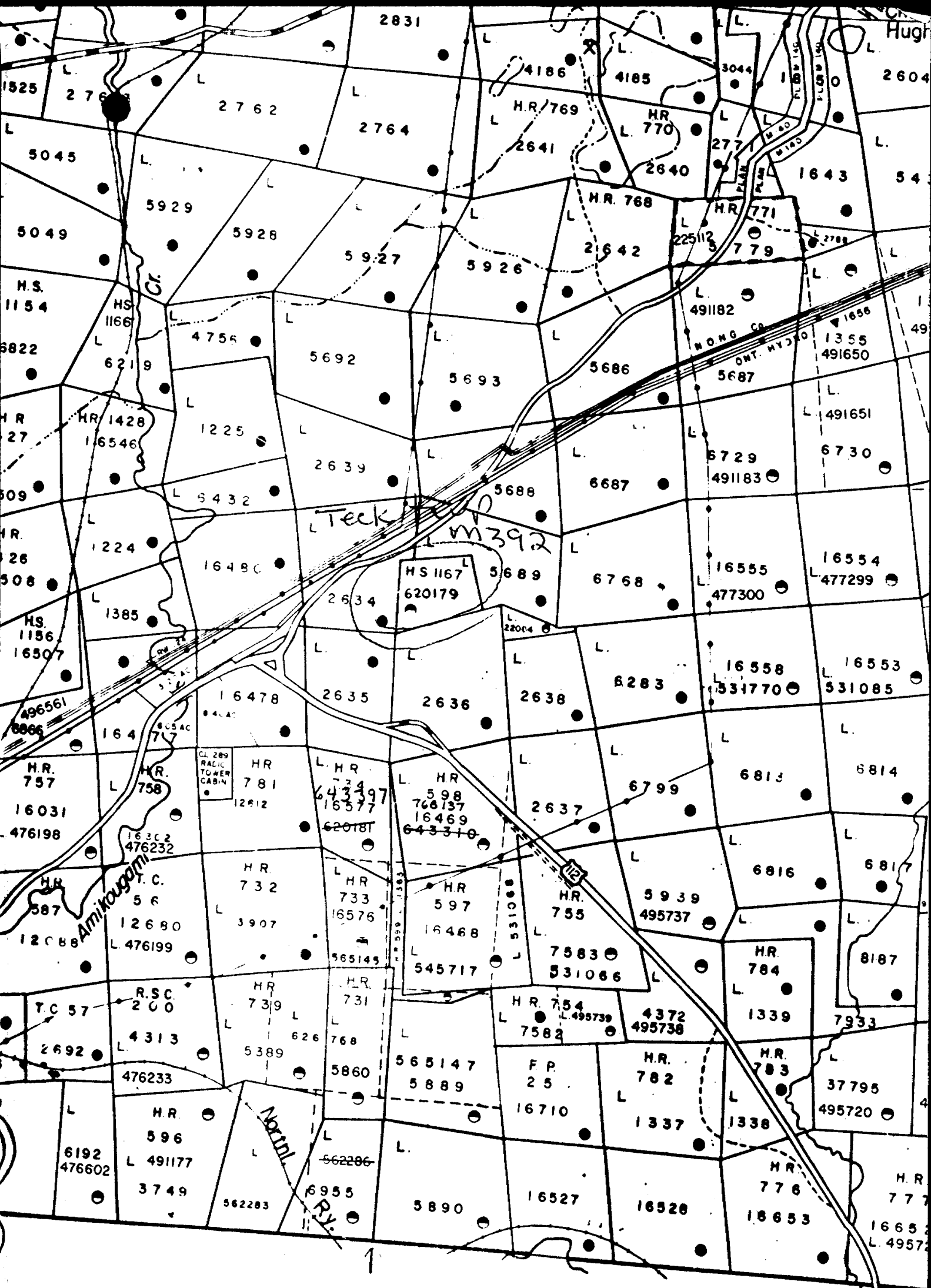

Otto Twp. M370





HIGHWAY 66

TELEPHONE LINE

OLD HIGHWAY

L 5689  
(PATENTED)

23W

25U

Pond

PIT

18

27W

AZIMUTH  
167°

AZIMUTH  
177°

L 2634  
(PATENTED)

L 620179

L 2636  
(PATENTED)

LAC MINERALS LTD.  
(MACASSA DIV.)  
CONDIE CLAIM

DRILL ASSESSMENT  
PROGRAM

AUG 15/83

SCALE 1" = 100'

