

# Gerard Basterache

# 2.19190

## ***Plugger Supervision -***

Aug 1/98	-	8 hrs	= \$100.00
Sept 4/98	-	8 hrs	= \$100.00
Oct 26/98	-	8 hrs	= \$100.00
Nov 6/98	-	8 hrs	= \$100.00

## ***Backhoe Suprevison and Sampling -***

Aug 15/98	-	8 hrs	\$100/day
-----------	---	-------	-----------

## ***Blasting, Cleaning, Sampling and Flagging -***

Aug 2/98	-	8 hrs	sampling	\$100/day
Aug 16/98	-	8 hrs	blasting & cleaning	\$100/day
Aug 22/98	-	8 hrs	sampling & cleaning	\$100/day
Aug 24/98	-	8 hrs	sampling	\$100/day
Aug 30/98	-	8 hrs	blasting	\$100/day
Sept 12/98	-	8 hrs	sampling	\$100/day
Oct 15/98	-	8 hrs	blasting	\$100/day
Oct 27/98	-	8 hrs	blasting	\$100/day
Nov 10/98	-	8 hrs	blasting	\$100/day
Nov 11/98	-	8 hrs	sampling	\$100/day

1) Nature of rocks : Mafic and Intermediate Volcanic Rock

2) Assay Certificates :

3) A) *Fern Rivard with Plugger included*

Sept 4/98	\$100/day
Oct 26/98	\$100/day
Nov 6/98	\$100/day
Aug 1/98	\$100/day

B) *Pierre McLean - Backhoe*

Aug 15/98	4 hrs	8:00-12:00	@\$50.00/hr	\$200.00
-----------	-------	------------	-------------	----------





# Swastika Laboratories

#1

A Division of TSL/Assayers Inc.

Established 1928

Assaying - Consulting - Representation

## Assay Certificate

# 2.19190

8W-2445-RA1

Company: **G. BASTARACHE**

Date: AUG-25-98

Project:

Attn: G. Bastarache

We hereby certify the following Assay of 3 Rock samples submitted AUG-24-98 by .

Sample Number	Au oz / ton	Au Check oz / ton
#1	0.002	-
#2	0.003	0.004
#3	0.002	-

One assay ton portion used.

Certified by Denis Charbon



# Swastika Laboratories

A Division of Assayers Corporation Ltd.

Assaying - Consulting - Representation

#1

Established 1928

## Assay Certificate

8W-1424-RA1

Company: **G. BASTARACHE**

Date: JUN-03-98

Project:

Attn: G. Bastarache

We hereby certify the following Assay of 1 Rock samples submitted JUN-01-98 by .

Sample Number	Au oz / ton	Au Check oz / ton	Cu %
No #	0.002	0.002	0.004

One assay ton portion used.

Certified by Denis Chantre



Established 1928

# Swastika Laboratories

#2

A Division of TSL/Assayers Inc.

Assaying - Consulting - Representation

## Assay Certificate

2.19150

8W-2762-RA1

Company: **G. BASTARACHE**

Date: SEP-22-98

Project:

Attn: G. Bastarache

We hereby certify the following Assay of 5 Rock samples submitted SEP-17-98 by .

Sample Number	Au oz/ton	Au Check oz/ton
#1	0.003	0.003
#2	0.005	-
#3	0.006	-
#4	0.002	-
#5	0.016	0.017

One assay ton portion used.

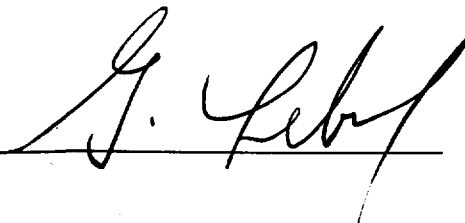
Certified by 

1 Cameron Ave., P.O. Box 10, Swastika, Ontario P0K 1T0  
Telephone (705)642-3244 Fax (705)642-3300



Established 1928

# Swastika Laboratories

A Division of TSL/Assayers Inc.

Assaying - Consulting - Representation

#2

## Assay Certificate

8W-2923-RA1

Company: **G. BASTARACHE**

Date: OCT-02-98

Project:

Attn: G. Bastarache

We hereby certify the following Assay of 1 Rock samples submitted SEP-29-98 by .

Sample Number	Au oz / ton
#1	0.005

One assay ton portion used.

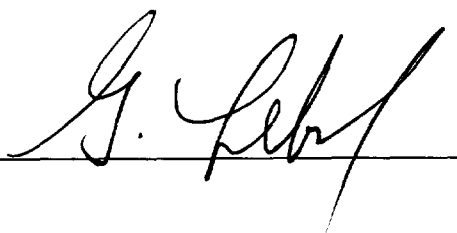
Certified by 

# 2



# Swastika Laboratories

A Division of TSL/Assayers Inc.

Established 1928

Assaying - Consulting - Representation

## Assay Certificate

8W-4064-RA1

Company: **G. BASTARACHE**

Date: OCT-20-98

Project:

Attn: G. Bastarache

We hereby certify the following Assay of 2 Rock samples submitted OCT-19-98 by .

Sample Number	Au oz/ton	Au Check oz/ton
#1	0.015	-
#2	0.025	0.026

One assay ton portion used.

Certified by

1 Cameron Ave., P.O. Box 10, Swastika, Ontario P0K 1T0  
Telephone (705)642-3244 Fax (705)642-3300

#2



# Swastika Laboratories

A Division of TSL/Assayers Inc.

Established 1928

Assaying - Consulting - Representation

## Assay Certificate

8W-2619-RA1

Company: **G. BASTARACHE**

Date: SEP-11-98

Project:

Attn: G. Bastarache

We hereby certify the following Assay of 5 Rock samples submitted SEP-08-98 by .

Sample Number	Au oz / ton	Au Check oz / ton
#1	0.002	-
#2	0.015	-
#3	0.017	0.015
#4	0.004	-
#5	0.012	-

One assay ton portion used.

Certified by: J. Noonan



# Swastika Laboratories

#3

A Division of TSL/Assayers Inc.

Established 1928

Assaying - Consulting - Representation

## Assay Certificate

2.19190

8W-2098-RA1

Company: **G. BASTARACHE**

Date: JUL-31-98

Project:

Attn: G. Bastarache

We hereby certify the following Assay of 3 Rock samples submitted JUL-27-98 by .

Sample Number	Au oz / ton	Au Check oz / ton
1	0.002	-
2	0.002	0.003
3	0.008	0.007

One assay ton portion used.

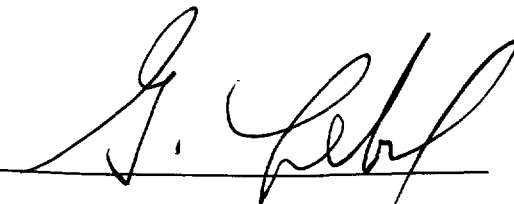
Certified by 





# Swastika Laboratories

#3.

A Division of TSL/Assayers Inc.

Established 1928

Assaying - Consulting - Representation

## Geochemical Analysis Certificate

8W-4199-RG1

Company: **G. BASTARACHE**

Date: NOV-02-98

Project:

Attn: G. Bastarache

We hereby certify the following Geochemical Analysis of 4 Rock samples submitted OCT-28-98 by .

Sample Number	Au PPB	Au Check PPB	Cu PPM
#1	610	-	-
#2	629	-	-
#3	1275	1125	-
#4	588	669	315

One assay ton portion used.

Certified by Denis Charbe



Established 1928

# Swastika Laboratories

#47

A Division of TSL/Assayers Inc.

Assaying - Consulting - Representation

## Geochemical Analysis Certificate

# 2.19190

8W-4518-RG1

Company: **G. BASTARACHE**

Date: NOV-23-98

Project:

Attn: G. Bastarache

We hereby certify the following Geochemical Analysis of 1 Rock samples submitted NOV-19-98 by .

Sample Number	Au PPB	Au Check PPB
#1	903	1051

One assay ton portion used.

Certified by

1 Cameron Ave., P.O. Box 10, Swastika, Ontario P0K 1T0  
Telephone (705)642-3244 Fax (705)642-3300



Established 1928

# Swastika Laboratories

A Division of TSL/Assayers Inc.

Assaying - Consulting - Representation

4

## Assay Certificate

8W-3014-RA1

Company: **G. BASTARACHE**

Date: OCT-09-98

Project:

Attn: G. Bastarache

We hereby certify the following Assay of 4 Rock samples submitted OCT-06-98 by .

Sample Number	Au oz / ton	Au Check oz / ton
#1	0.019	0.019
#2	0.005	-
#3	0.017	0.016
#4	0.016	-

One assay ton portion used.

Certified by Denis Chantre

1 Cameron Ave., P.O. Box 10, Swastika, Ontario P0K 1T0  
Telephone (705)642-3244 Fax (705)642-3300



# Swastika Laboratories

A Division of TSL/Assayers Inc.

Assaying - Consulting - Representation

Established 1928

5

## Geochemical Analysis Certificate

# 2.19190

8W-4839-RG1

Company: **G.BASTARACHE**

Date: DEC-16-98

Project:

Attn: G.Bastarache

We hereby certify the following Geochemical Analysis of 2 Rock samples submitted DEC-14-98 by .

Sample Number		Au PPB	Au Check PPB
#1	0.167 opt	5760	4560
#2		1239	-

One assay ton portion used.

Certified by



Established 1928

# Swastika Laboratories

A Division of TSL/Assayers Inc.

Assaying - Consulting - Representation

5

## Geochemical Analysis Certificate

8W-4755-RG1

Company: **G. BASTARACHE**

Date: DEC-10-98

Project:

Attn: G. Bastarache

We hereby certify the following Geochemical Analysis of 1 Rock samples submitted DEC-07-98 by .

Sample Number	Au PPB	Au Check PPB
#1	5246	5143

One assay ton portion used.

Certified by

1 Cameron Ave., P.O. Box 10, Swastika, Ontario P0K 1T0  
Telephone (705)642-3244 Fax (705)642-3300



Established 1928

# Swastika Laboratories

A Division of TSL/Assayers Inc.

Assaying - Consulting - Representation

5

## Geochemical Analysis Certificate

8W-4652-RG1

Company: **G. BASTARACHE**

Date: DEC-03-98

Project:

Attn: G. Bastarache

We hereby certify the following Geochemical Analysis of 2 Rock samples submitted NOV-30-98 by .

Sample Number	Au PPB	Au Check PPB
#1	765	857
#2	1728	1411

One assay ton portion used.

Certified by Denis Chantre

1 Cameron Ave., P.O. Box 10, Swastika, Ontario P0K 1T0  
Telephone (705)642-3244 Fax (705)642-3300



Established 1928

# Swastika Laboratories

A Division of TSL/Assayers Inc.

Assaying - Consulting - Representation

5

## Geochemical Analysis Certificate

8W-4981-RG1

Company: **G. BASTARACHE**

Date: DEC-30-98

Project:

Attn: G. Bastarache

We hereby certify the following Geochemical Analysis of 1 Rock samples submitted DEC-28-98 by .

Sample Number	Au PPB	Au Check PPB	Ag PPM
#1	2091	2160	0.8

One assay ton portion used.

Certified by

1 Cameron Ave., P.O. Box 10, Swastika, Ontario P0K 1T0  
Telephone (705)642-3244 Fax (705)642-3300



# Swastika Laboratories

A Division of TSL/Assayers Inc.

Assaying - Consulting - Representation

Established 1928

5

## Geochemical Analysis Certificate

8W-4543-RG1

Company: **G. BASTARACHE**

Date: NOV-25-98

Project:

Attn: G. Bastarache

We hereby certify the following Geochemical Analysis of 4 Rock samples submitted NOV-23-98 by .

Sample Number	Au PPB	Au Check PPB
#1	1954	1920
#2	1509	1577
#3	1303	-
#4	<i>Result not listed -5</i>	-

One assay ton portion used.

Certified by

1 Cameron Ave., P.O. Box 10, Swastika, Ontario P0K 1T0  
Telephone (705)642-3244 Fax (705)642-3300





Established 1928

# Swastika Laboratories

A Division of TSL/Assayers Inc.

Assaying - Consulting - Representation

5

## Geochemical Analysis Certificate

8W-4371-RG1

Company: **G. BASTARACHE**

Date: NOV-13-98

Project:

Attn: G. Bastarache

We hereby certify the following Geochemical Analysis of 2 Rock samples submitted NOV-09-98 by .

Sample Number	Au PPB	Au Check PPB
#1	2229	2170
#2	1533	-

One assay ton portion used.

Certified by

1 Cameron Ave., P.O. Box 10, Swastika, Ontario P0K 1T0  
Telephone (705)642-3244 Fax (705)642-3300



Declaration of Assessment Work Performed on Mining Land

Mining Act, Subsection 65(2) and 66(3), R.S.O. 1990

Transaction Number (office use) W9980.00046 Assessment Files Research Imaging



42A01SW2005 2.19190 BURT 900

Section 65(2) and 66(3) of the Mining Act. Under section 8 of the Mining Act, assessment work and correspond with the mining land holder. Questions about this form should be directed to the Ministry of Northern Development and Mines, 3rd Floor, 933 Ramsey Lake Road, Sudbury, Ontario.

Instructions: - For work performed on Crown Lands before recording a claim, use form 0240. - Please type or print in ink.

1. Recorded holder(s) (Attach a list if necessary) 2.19190 Name GERARD BASTARACHE Client Number 105509 Address 60 5TH Street Apt 101 Telephone Number 705-568-8107 KIRKLAND LAKE, ONTARIO

2. Type of work performed: Check (✓) and report on only ONE of the following groups for this declaration. Geotechnical: prospecting, surveys, assays and work under section 18 (regs) Physical: drilling stripping, trenching and associated assays Rehabilitation Work Type ASSAYS, TRENCHING, STRIPPING Office Use Commodity Total \$ Value of Work Claimed 3807 Dates Work Performed From 01 AUG 98 To 11 NOV 98 Mining Division Harder Lake Resident Geologist District Kirkland Lake

Please remember to: - obtain a work permit from the Ministry of Natural Resources as required; - provide proper notice to surface rights holders before starting work; - complete and attach a Statement of Costs, form 0212; - provide a map showing contiguous mining lands that are linked for assigning work; - include two copies of your technical report.

3. Person or companies who prepared the technical report (Attach a list if necessary) Name STEWARD CARMICAL Telephone Number 367-7287 Address 12 GOVERNMENT ROAD WEST KIRKLAND LAKE

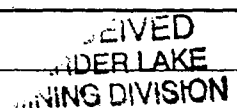
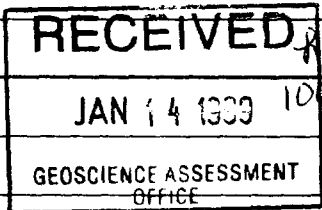

JAN 13/99

4. Certification by Recorded Holder or Agent I, GERARD BASTARACHE, do hereby certify that I have personal knowledge of the facts set forth in this Declaration of Assessment Work having caused the work to be performed or witnessed the same during or after its completion and, to the best of my knowledge, the annexed report is true.

Signature of Recorded Holder or Agent Gerard Bastarache Date Jan 13 1999 Agent's Address Telephone Number 568-8107 Fax Number

Deemed April 13/99

5. Work to be recorded and distributed. Work can only be assigned to claims that are contiguous (adjoining) to the mining land where work was performed, at the time work was performed. A map showing the contiguous link must accompany this form

W9980.00046

Mining Claim Number. Or if work was done on other eligible mining land, show in this column the location number indicated on the claim map.	Number of Claim Units. For other mining land, list hectares.	Value of work performed on this claim or other mining land.	Value of work applied to this claim.	Value of work assigned to other mining claims.	Bank. Value of work to be distributed at a future date
eg TB 7827	16 ha	\$26,825	N/A	\$24,000	\$2,825
eg 1234567	12	0	\$24,000	0	0
eg 1234568	2	\$ 8,892	\$ 4,000	0	\$4,892
1 1226818	16	3.807	3.807		
2					
3					
4					
5					
6					
7					
8					
9					
10					
11					
12					
13					
14					
15					
Column Totals	16	\$3.807	\$ 3.807		

2.19190

I, \_\_\_\_\_, do hereby certify that the above work credits are eligible under subsection 7 (1) of the Assessment Work Regulation 6/96 for assignment to contiguous claims or for application to the claim where the work was done.

(Print Full Name)

Signature of Recorded Holder or Agent Authorized in Writing

*Severid Postancho*

Date

*January 13 1999*

6. Instruction for cutting back credits that are not approved.

Some of the credits claimed in this declaration may be cut back. Please check (✓) in the boxes below to show how you wish to prioritize the deletion of credits:

- 1. Credits are to be cut back from the Bank first, followed by option 2 or 3 or 4 as indicated.
- 2. Credits are to be cut back starting with the claims listed last, working backwards; or
- 3. Credits are to be cut back equally over all claims listed in this declaration; or
- 4. Credits are to be cut back as prioritized on the attached appendix or as follows (describe):

Note: If you have not indicated how your credits are to be deleted, credits will be cut back from the Bank first, followed by option number 2 if necessary.

For Office Use Only

Received Stamp

RECEIVED  
LARDER LAKE  
MINING DIVISION

JAN 13 / 99

0241 (03/97)

Deemed Approved Date	Date Notification Sent
Date Approved	Total Value of Credit Approved
Approved for Recording by Mining Recorder (Signature)	

RECEIVED  
JAN 14 1999  
GEOSCIENCE ASSESSMENT  
OFFICE

2.19190

STATEMENT OF COSTS

*Assaying, 40 samples @ \$14.82 per.....	\$592.87
Backhoe, 4 hrs @ \$50.00/hr.....	200.00
Plugger Rental + man 4 days @ \$100.00/day....	400.00
Explosives.....	118.45
Labour, 15 man days @ \$100.00/day.....	1,500.00
Travel, 2,700 km @ .31/km.....	837.00
* Includes 2 Cu and 1 Ag assay	
Drafting (CAD).....	150.00
Prints.....	8.56
TOTAL.....	\$3,806.88

*Geord Bentinck*

*January 13 1999*

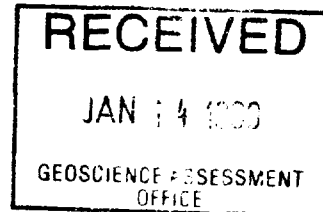

RECEIVED  
UNDER LAKE  
MINING DIVISION

JAN 13 / 99

*LA*

Personal information collected on this form is obtained under the authority of subsection 6 (1) of the Assessment Work Regulation 6/98. Under section 8 of the Mining Act, this information is a public record. This information will be used to review the assessment work and correspond with the mining land holder. Questions about this collection should be directed to a Provincial Mining Recorder, Ministry of Northern Development and Mines, 3rd Floor, 933 Ramsey Lake Road, Sudbury, Ontario, P3E 6B5.

2.19190

Work Type	Units of work Depending on the type of work, list the number of hours/day worked, metres of drilling, kilometres of grid line, number of samples, etc.	Cost Per Unit of work	Total Cost
	See attached statement.		
<b>Associated Costs (e.g. supplies, mobilization and demobilization).</b>			
<b>Transportation Costs</b>			
<b>Food and Lodging Costs</b>			
		<b>Total Value of Assessment Work</b>	

**RECEIVED**  
JAN 14 1999  
GEOSCIENCE ASSESSMENT OFFICE

**Calculations of Filing Discounts:**

Work filed within two years of performance is claimed at 100% of the above Total Value of Assessment Work. If work is filed after two years and up to five years after performance, it can only be claimed at 50% of the Total Value of Assessment Work. If this situation applies to your claims, use the calculation below:

TOTAL VALUE OF ASSESSMENT WORK x 0.50 = Total \$ value of worked claimed

**Note:**

Work older than 5 years is not eligible for credit. A recorded holder may be required to verify expenditures claimed in this statement of costs within 45 days of a request for verification and/or correction/clarification. If verification and/or correction/clarification is not made, the Minister may reject all part of the assessment work submitted.

**Verification verifying costs:**

GERARD BASTARACHE do hereby certify, that the amounts shown are as accurate as may reasonably determined and the costs were incurred while conducting assessment work on the lands indicated on the accompanying

Declaration of Work form as \_\_\_\_\_ I am authorized to make this certification.  
(recorded holder, agent, or state company position with signing authority)

**RECEIVED**  
LARDER LAKE  
MINING DIVISION

JAN 13/99  
LP

Signature: Gerard Bastarache Date: Jan 13/99

Geoscience Assessment Office  
933 Ramsey Lake Road  
6th Floor  
Sudbury, Ontario  
P3E 6B5

Telephone: (888) 415-9846  
Fax: (877) 670-1555

March 23, 1999

GERARD BASTARACHE  
60 5TH STREET  
APT. #101  
KIRKLAND LAKE, ONTARIO  
P2N-3P7

Visit our website at:  
[www.gov.on.ca/MNDM/MINES/LANDS/mlsmnpge.htm](http://www.gov.on.ca/MNDM/MINES/LANDS/mlsmnpge.htm)

Dear Sir or Madam:

**Submission Number:** 2.19190

**Status**

**Subject: Transaction Number(s):** W9980.00046 Deemed Approval

---

We have reviewed your Assessment Work submission with the above noted Transaction Number(s). The attached summary page(s) indicate the results of the review. WE RECOMMEND YOU READ THIS SUMMARY FOR THE DETAILS PERTAINING TO YOUR ASSESSMENT WORK.

If the status for a transaction is a 45 Day Notice, the summary will outline the reasons for the notice, and any steps you can take to remedy deficiencies. The 90-day deemed approval provision, subsection 6(7) of the Assessment Work Regulation, will no longer be in effect for assessment work which has received a 45 Day Notice. Allowable changes to your credit distribution can be made by contacting the Geoscience Assessment Office within this 45 Day period, otherwise assessment credit will be cut back and distributed as outlined in Section #6 of the Declaration of Assessment work form.

Please note any revisions must be submitted in DUPLICATE to the Geoscience Assessment Office, by the response date on the summary.

If you have any questions regarding this correspondence, please contact Steve Beneteau by e-mail at [steve.beneteau@ndm.gov.on.ca](mailto:steve.beneteau@ndm.gov.on.ca) or by telephone at (705) 670-5855.

Yours sincerely,



ORIGINAL SIGNED BY  
Blair Kite  
Supervisor, Geoscience Assessment Office  
Mining Lands Section

# Work Report Assessment Results

---

**Submission Number:** 2.19190

**Date Correspondence Sent:** March 23, 1999

**Assessor:** Steve Beneteau

---

<b>Transaction Number</b>	<b>First Claim Number</b>	<b>Township(s) / Area(s)</b>	<b>Status</b>	<b>Approval Date</b>
W9980.00046	1226818	BURT	Deemed Approval	March 22, 1999

**Section:**

17 Assays ASSAY  
10 Physical PSTRIIP  
10 Physical PTRNCH

**Correspondence to:**

Resident Geologist  
Kirkland Lake, ON

**Recorded Holder(s) and/or Agent(s):**

GERARD BASTARACHE  
KIRKLAND LAKE, ONTARIO

Assessment Files Library  
Sudbury, ON

---

W 334

B0B1 1M5

M 334

# BURT TOWNSHIP

DATE OF ISSUE  
APR 21 1999

PROVINCIAL RECORDING  
OFFICE - SUDBURY

## M.334

Areas withdrawn from staking under Section 43 of the Mining Act (R.S.O. 1970)

**LEGEND**

PATENTED LAND  
CROWN LAND SALE  
LEASES  
LICENSE OF OCCUPATION  
LOCATED LAND  
MINING RIGHTS ONLY  
SURFACE RIGHTS ONLY  
CANCELLED

CS  
L.O.  
M.R.O.  
S.R.O.  
C.

Mineral Surface rights withdrawn from staking out, prospecting  
sale or lease. See 36 The Mining Act, R.S.O. 1970  
Order No. N.R.W. 20/82 No. 24, 1922 190 pm

400' surface rights reservation along the shores  
of all lakes and rivers.

SCALE 40 CHAINS TO ONE INCH

Order No.	File	Date	Disposition
W 7/74	104317	21/2/74	S.R.O.
W 7/78	100561	15/12/78	S.R.O.
NR W 53/70	139557	14/5/70	S.R.O.
NR W 42/80	124365	9/7/80	S.R.O.
W 24/82	158532	29/11/82	S.R. & M.R.

2.19190 BOMPAS TWP.



COPY OF THIS MYLAR  
ARCHIVED AUG 23/93

ARCHIVED ON JUNE 01/95

### NOTICE OF FORESTRY ACTIVITY

THIS TOWNSHIP / AREA FALLS WITHIN THE  
PLONSKI FOREST MANAGEMENT UNIT

AND MAY BE SUBJECT TO FORESTRY OPERATIONS.  
THE MNR UNIT FORESTER FOR THIS AREA CAN BE  
CONTACTED AT: P.O. BOX 129  
SWASTIKA, ONT.  
POK ITO.  
705-642-3222

THE INFORMATION THAT  
APPEARS ON THIS MAP  
HAS BEEN COMPILED  
FROM VARIOUS SOURCES,  
AND ACCURACY IS NOT  
GUARANTEED. THOSE  
WISHING TO STAKE MIN-  
ING CLAIMS SHOULD CON-  
SULT WITH THE MINING  
RECORDER, MINISTRY OF  
NORTHERN DEVELOP-  
MENT AND MINES, FOR AD-  
DITIONAL INFORMATION  
ON THE STATUS OF THE  
LANDS SHOWN HEREON.

ONTARIO  
MINISTRY OF NATURAL RESOURCES  
SURVEYS AND MAPPING BRANCH

W 334

BURT TWP.

M 334



42A015W2005 2.19190 BURT 200



	SAMPLE #	TYPE OF SAMPLE	ASSAY (PPB Au)	ASSAY (GMS/TONNE)	ASSAY (OZ/TON)
TRENCH #1	#1	GRAB	69.0	0.069	.002
	#2	GRAB	103.0	0.103	.003
	#3	GRAB	69.0	0.069	.002
TRENCH #2	#1	GRAB	103.0	0.103	.003
	#2	GRAB	171.4	0.171	.005
	#3	GRAB	208.0	0.208	.006
	#4	GRAB	68.6	0.069	.002
	#5	GRAB	548.6	0.549	.017
	#1A	GRAB	171.4	0.171	0.005
	#1B	GRAB	514.0	0.514	0.015
	#2A	GRAB	857.2	0.857	0.025
	#1C	GRAB	68.6	0.069	0.002
	#2B	GRAB	514.3	0.514	0.015
	#3B	GRAB	548.6	0.549	.016
	#4B	GRAB	137.1	0.137	.004
	#5B	GRAB	411.4	0.411	0.012
TRENCH #3	#1	GRAB	68.6	0.068	0.002
	#2	GRAB	102.9	0.103	0.003
	#3	GRAB	274.3	0.274	0.008
	#1A	GRAB	610.0	0.610	0.018
	#2A	GRAB	629.0	0.629	0.018
	#3A	GRAB	1200.0	1.200	0.035
TRENCH #4	#4	GRAB	629	0.629	0.018
	#1	GRAB	651.4	0.651	0.019
	#2	GRAB	171.4	0.171	0.005
	#3	GRAB	582.9	0.583	0.017
	#4	GRAB	548.6	0.549	0.016
TRENCH #5	#1A	GRAB	977.0	0.977	0.028
	#1	GRAB	2199.5	2.200	0.064
	#2	GRAB	1533.0	1.533	0.045
	#1A	GRAB	1937.0	1.937	0.056
	#2A	GRAB	1543.0	1.543	0.045
	#3	GRAB	1303.0	1.303	0.038
	#4	GRAB	5.0	NIL	NIL
	#1B	GRAB	2125.5	2.126	0.062
	#1C	GRAB	811.0	0.811	0.024
	#2B	GRAB	1569.5	1.570	0.046
	#1D	GRAB	5101.6	5.100	0.152
	#1E	GRAB	5160.0	5.160	0.150
#2C	GRAB	1239.0	1.239	0.036	

ASTRONOMIC NORTH

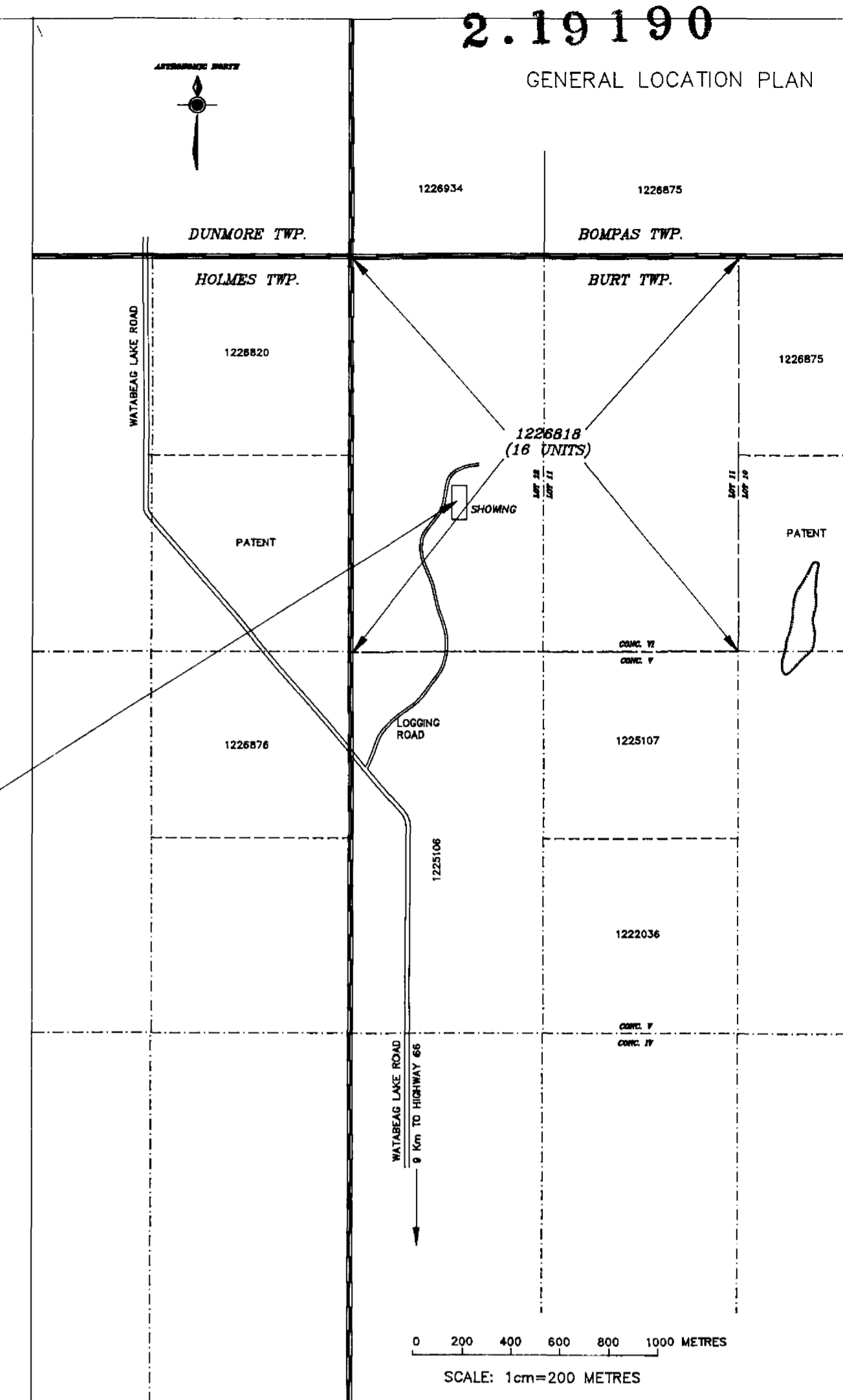
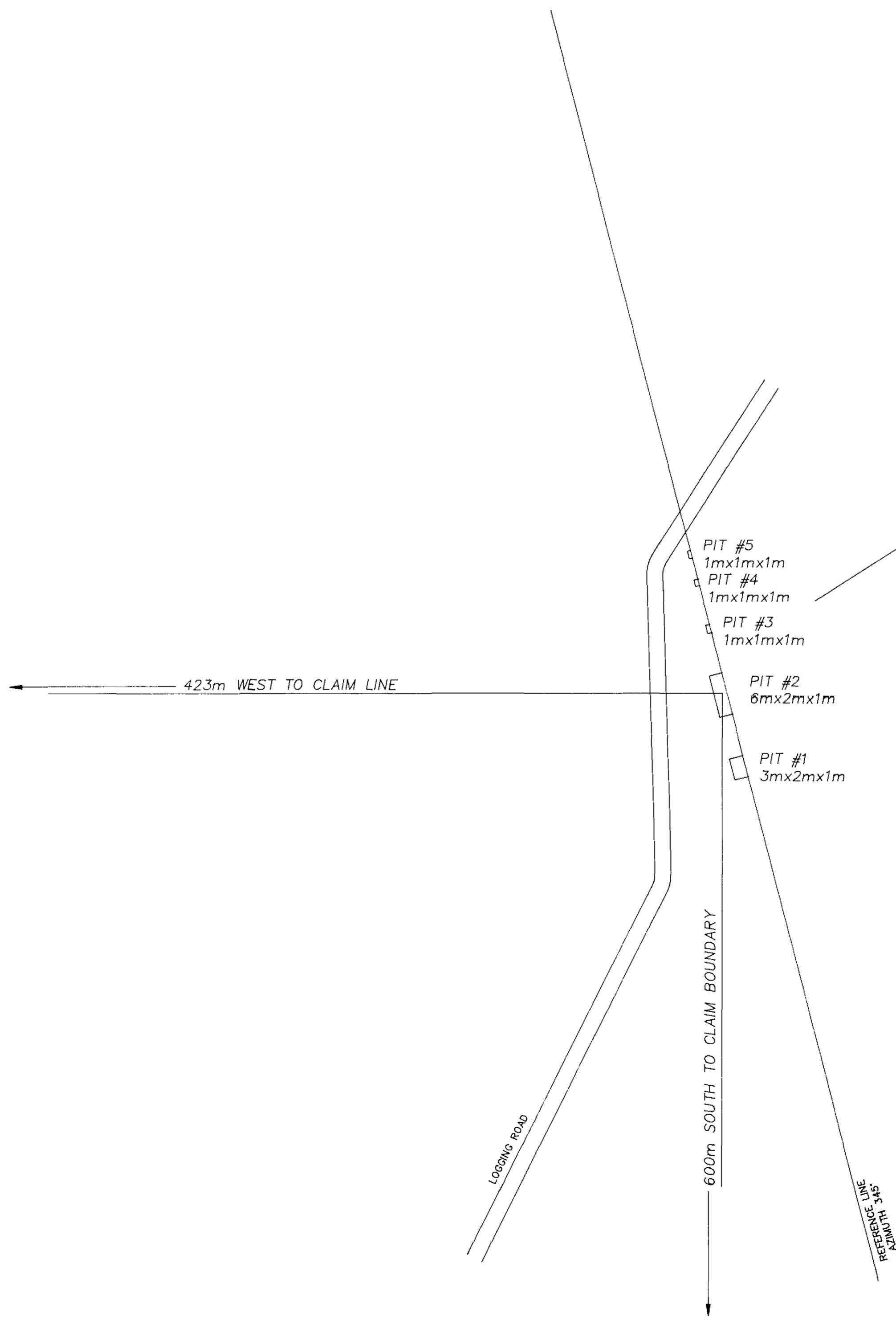
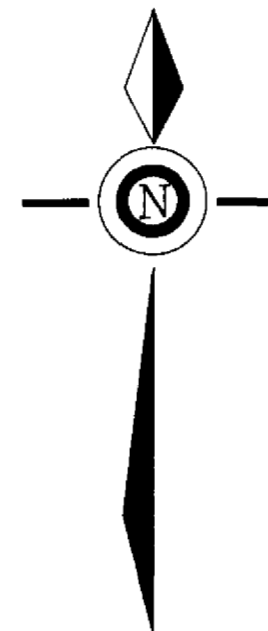

0 10 20 30 40 50 Metres

SCALE: 1cm=5 METRES

**GERRY BASTARACHE PROJECT**

SURFACE PLAN  
TRENCH AND SAMPLE LOCATION PLAN  
BURT TOWNSHIP  
DISTRICT OF TIMISKAMING, ONT.  
LARDER LAKE MINING DIVISION

NTS: 42 A/SE	SCALE: 1:500 METRIC	DATE: JANUARY, 1999
PROJECT: BURT	DRAWN BY: S.J.C.	DRAWING No. 1



Varved clay, boulder clay, silt, pebble gravel, boulder gravel.

2 19190 PRECAMBIAN

**PROTEROZOIC**  
**KEWEENAWAN**



9 Olivine diabase (dike).

**INTRUSIVE CONTACT**

**HURONIAN**

**COBALT GROUP**

Gowganda Formation



8a Conglomerate.  
8b Quartzite.  
8c Slate and argillite.  
8d Greywacke.  
8e Grit.  
8f Arkose.  
8g Argillite.

**UNCONFORMITY**

**ARCHEAN**

**MATACHEWAN**

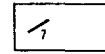

7 Diabase (dikes).

**INTRUSIVE CONTACT**

**PLUTONIC ROCKS**

Granitic Rocks

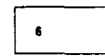

6a Granitic and granodioritic complex undivided.  
6b Porphyritic phases of 6a.  
6c Granitic gneiss.

Syenitic Rocks

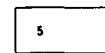

5a Syenitic complex undivided.  
5b Syenite porphyry and (or) feldspar porphyry.  
5c Hornblende syenite.  
5d Syenitic gneiss.

Basic Intrusive Rocks



4 Metadiorite or metagabbro.

**INTRUSIVE CONTACT**

**SEDIMENTARY ROCKS**



3a Conglomerate.  
3b Greywacke.

**METAVOLCANICS**

Mafic and Intermediate Volcanic Rocks



2a Mafic and intermediate volcanic rocks.  
2b Tuffaceous volcanic rocks.  
2c Volcanic breccia and agglomerate.  
2d Amphibolite.



Iron formation.

Felsic and Intermediate Volcanic Rocks



1a Felsic and intermediate volcanic rocks.  
1b Felsic schists, probably originally tuffs.

- Ag Silver
- Au Gold
- Cu Copper
- mo Molybdenite
- q Quartz
- S Sulphide mineralization
- tour Tourmaline

\*Unconsolidated deposits. Cenozoic deposits are not differentiated on the map. For the most part they coincide with the lighter coloured and uncoloured parts of the map.

\*\*Bedrock geology. Outcrops and inferred extensions of each rock unit are shown, respectively, in deep and light tones of the same colour. Where in places a formation is too narrow to show colour and texture...

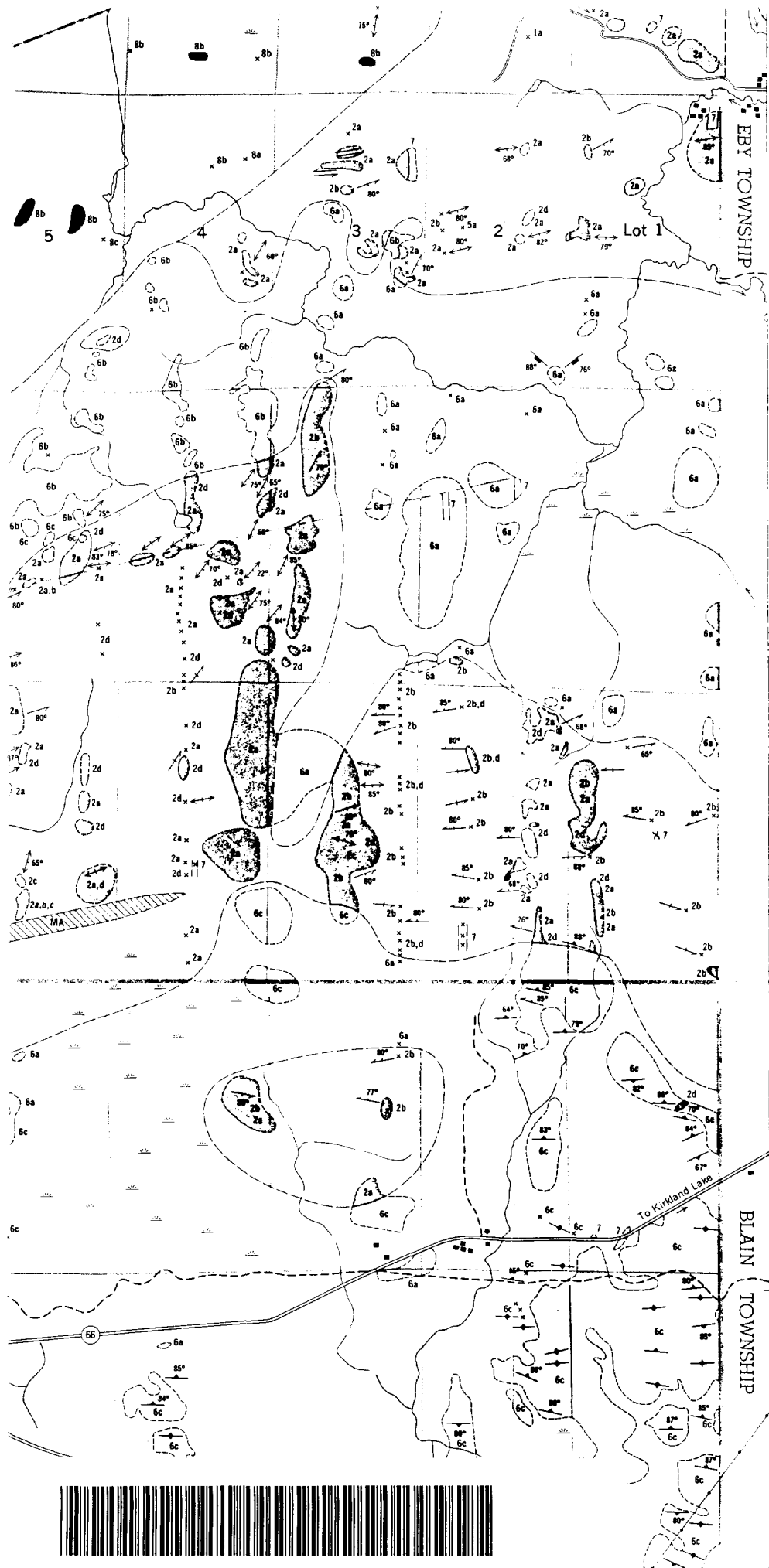

42A01SW2005 2.19190 BURT

220

ODM Map 2078

2.19190

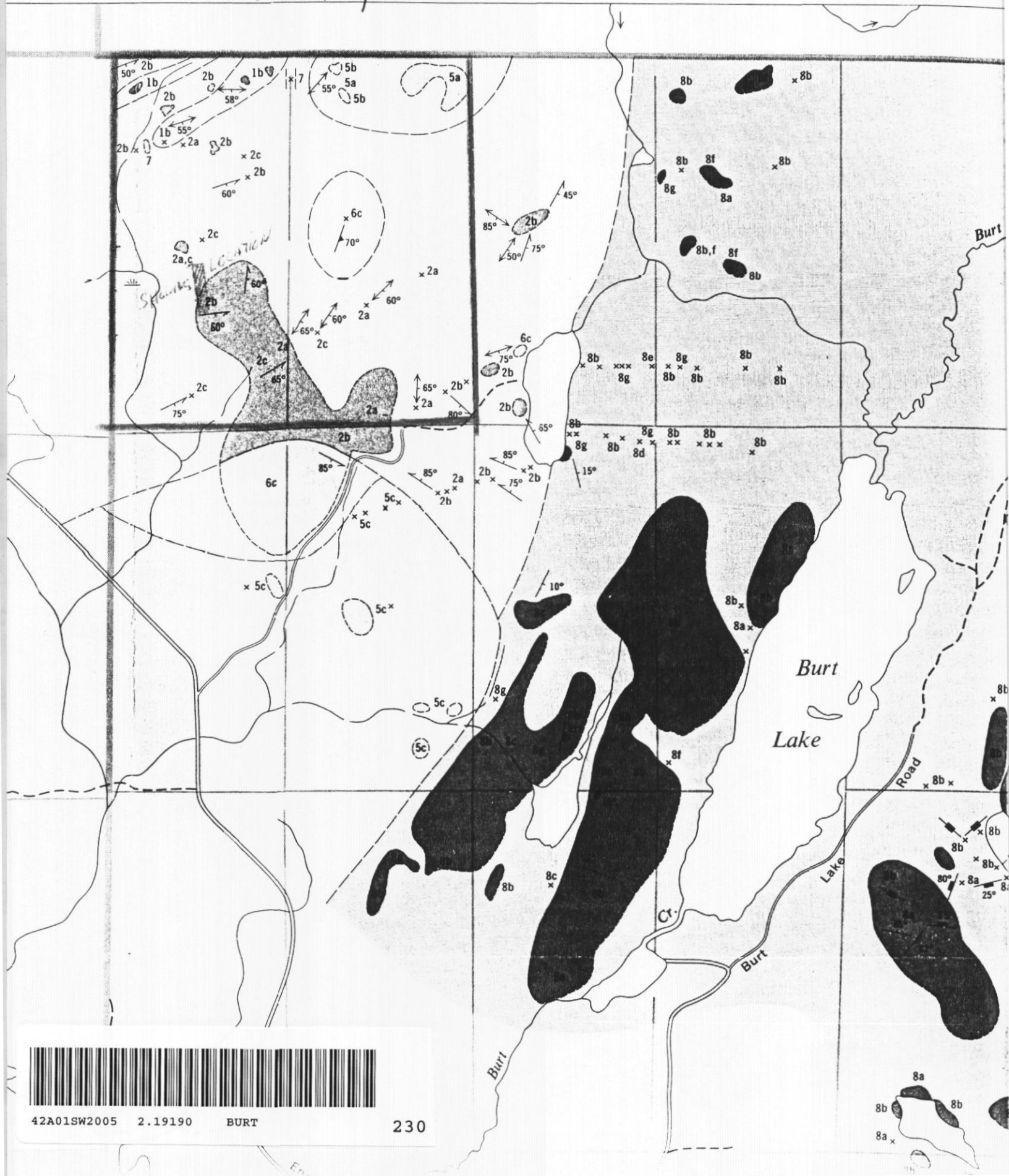

42A01SW2005 2.19190 BURT

230